

Mid-Continent Region
Production United States



P.O. Box 2409
Hobbs, NM 88241-2409
Telephone 505/393-7106

January 9, 1996

JAN 11 1996

Administrative Application For Unorthodox Location
Walter Lynch Well No. 6
Unit Letter F, 2310' FNL & 1980' FWL
Section 1, T-22-S, R-37-E
Blinebry Oil & Gas
Lea County, New Mexico

State of New Mexico
Oil Conservation Division
P.O. Box 2088
Santa Fe, New Mexico 87504-2088

Attn: Mr. William J. Lemay

Gentlemen:

Marathon Oil Company respectfully request your approval of our administrative application for an unorthodox location for the Walter Lynch Well No. 6 in the Blinebry Oil and Gas Pool located in Unit Letter F of Section 1, T-22-S, R-37-E of Lea County, New Mexico.

In support of this application, please find attached plats showing the gas proration unit and offset operators. A copy of this application has been sent by certified mail to all offset operators and should serve as notification.

Sincerely,

A handwritten signature in cursive script, appearing to read 'Ricky D. Gaddis'.

Ricky D. Gaddis
Advanced Production Engineer

State of New Mexico
Energy, Minerals & Natural Resources Department

Form C-102

District I
PO Box 1980, Hobbs, NM 88241-1980
District II
811 S. 1st Street, Artesia, NM 88210-2834
District III
1000 Rio Brazos Rd., Aztec, NM 87410
District IV
PO Box 2088, Santa Fe, NM 87504-2088

OIL CONSERVATION DIVISION
P.O. Box 2088
Santa Fe, NM 87504-2088

Revised February 10, 1994
Instructions on back
Submit to Appropriate District Office
State Lease - 4 Copies
Fee Lease - 3 Copies

☐ AMENDED REPORT

WELL LOCATION AND ACREAGE DEDICATION PLAT

¹ API Number 30-025-25131		² Pool Code 72480		³ Pool Name Blinebry Oil & Gas	
⁴ Property Code 6424		⁵ Property Name Walter Lynch			⁶ Well Number 6
⁷ OGRID No. 014021		⁸ Operator Name Marathon Oil Company			⁹ Elevation GL: 3353'

¹⁰ Surface Location

UL or lot no. F	Section 1	Township 22-S	Range 37-E	Lot. Idn	Feet from the 2310	North/South Line North	Feet from the 1980	East/West line West	County Lea
--------------------	--------------	------------------	---------------	----------	-----------------------	---------------------------	-----------------------	------------------------	---------------

¹¹ Bottom Hole Location If Different From Surface

UL or lot no.	Section	Township	Range	Lot. Idn	Feet from the	North/South Line	Feet from the	East/West line	County
¹² Dedicated Acres 160	¹³ Joint or Infill Y	¹⁴ Consolidation Code NA	¹⁵ Order No. NA						

NO ALLOWABLE WILL BE ASSIGNED TO THIS COMPLETION UNTIL ALL INTERESTS HAVE BEEN CONSOLIDATED
OR A NON-STANDARD UNIT HAS BEEN APPROVED BY THE DIVISION

	<p>¹⁷ OPERATOR CERTIFICATION</p> <p>I hereby certify that the information contained herein is true and complete to the best of my knowledge and belief.</p> <p><i>[Signature]</i></p> <p>Signature Rick Gaddis</p> <p>Printed Name Advanced Production Engineer</p> <p>Title 1/08/96</p> <p>Date</p>

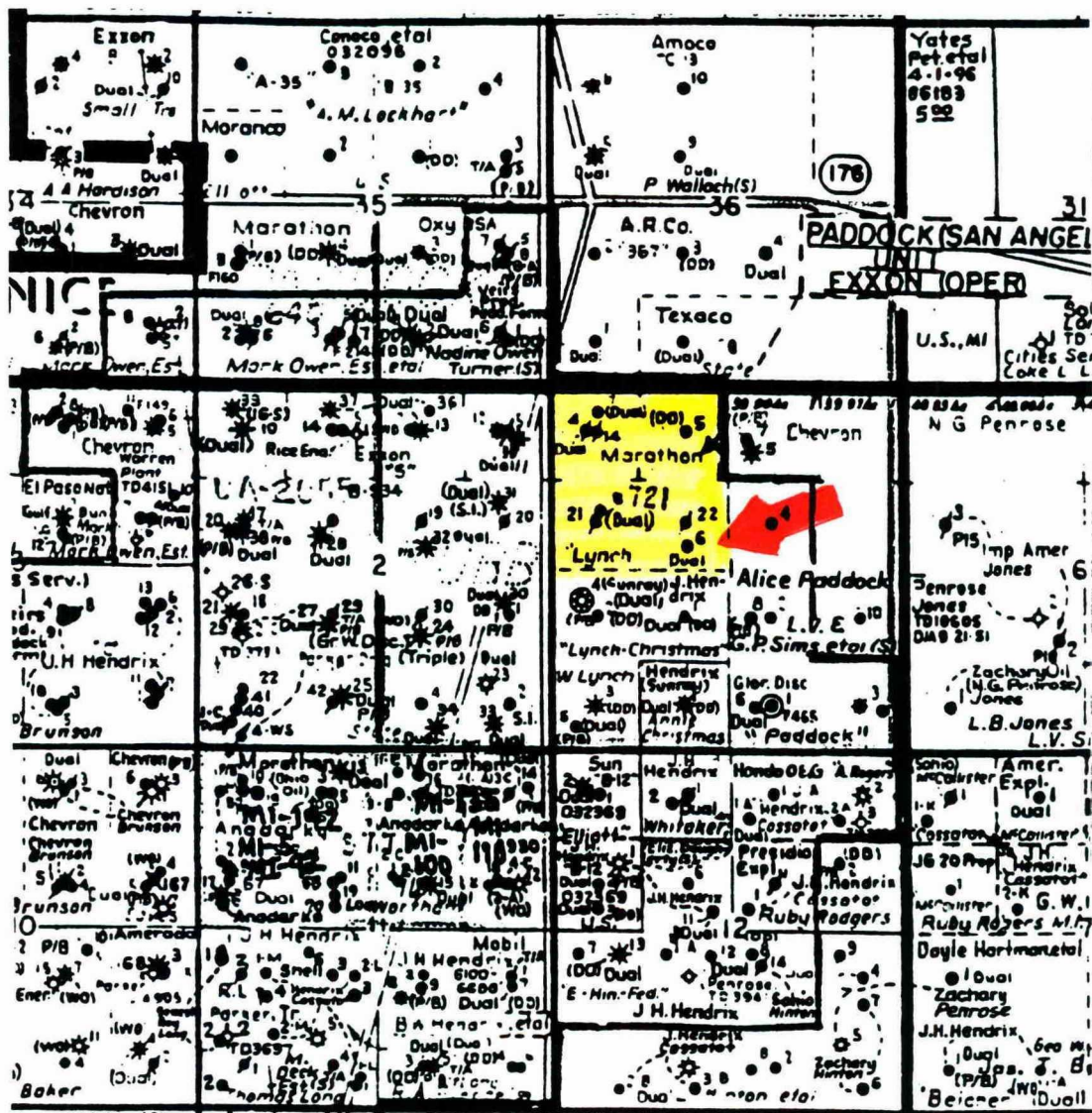

T
21
S

T
22
S

LAND PLAT
DRINKARD AREA

LEA COUNTY, NEW MEXICO

1"= 2800'

MARATHON OIL COMPANY
Walter Lynch Well No. 6

Application for Unorthodox Location
Walter Lynch Well No. 6
Blinebry Oil and Gas Pool
Section 1, T-22-S, R-37-E
Lea County, New Mexico

OFFSET OPERATORS

American Exploration Company
1331 Lamar, Suite 900
Houston, TX 77010-3088

Section 36: S/2
T-22-S, R-37-E

Chevron USA, Inc.
PO Box 1150
Midland, TX 79702

Section 1: E/2 & SW/4
T-22-S, R-37-E

Cross Timbers Oil Company
810 Houston, Ste 2000
Ft. Worth, Texas 76102-6298

Section 36: S/2
T-21-S, R-37-E

Exxon Company USA
PO Box 1600
Midland, TX 79702

Section 2: E/2
T-22-S, R-37-E

John H. Hendrix Corp.
223 W. Wall, Suite 525
Midland, TX 79701-4519

Section 1; E/2 & SW/4
T-22-S, R-37-E

OXY USA, Inc.
PO Box 50250
Midland, TX 79705

Section 35: SE/4
T-22-S, R-37-E

Texaco Exploration and Production Company, Inc.
PO. Box 3109
Midland, TX 79702

Section 36: S/2
T-21-S, R-37-E

January 9, 1996

(Company Name & Address)

Administrative Application for Unorthodox Location
Walter Lynch Well No. 6
Unit Letter F, 2310' FNL & 1980' FWL
Section 1, T-22-S, R-37-E
Blinebry Oil & Gas Pool
Lea County, New Mexico

Gentlemen:

Attached is a copy of Marathon's Oil Company administrative application for NMOCD approval for an unorthodox location for the Walter Lynch Well No. 6 in the Blineby Oil & Gas Pool in an 120 acre proration unit.

As an offset operator, if you do not have any objections to the attached application, please sign the enclosed waivers and mail the original and two copies to the NMOCD in Santa Fe and one copy to the NMOCD in Hobbs. We would also request that you send a copy to Marathon Oil Company in Hobbs. We have enclosed a self addressed, stamped envelope for your convenience.

If you have any questions please contact Rick Gaddis at 505/393-7106 ext 201. Your prompt consideration in the above matter is appreciated.

Sincerely,

Rick Gaddis
Advanced Production Engineer

**MARATHON OIL COMPANY
WALTER LYNCH LEASE**

Application for Unorthodox Location
Walter Lynch Well No. 6
Blinebry Oil & Gas
Section 1 , T-22-S, R-37-E
Lea County, New Mexico

WAIVER TO OBJECTION

We, the undersigned, as an offset operator, waive any objection to Marathon Oil Company's application for NMOCD approval of an Unorthodox location for the Walter Lynch Well No. 6 in the Blinebry Oil & Gas Pool located in Unit Letter F, Section 1, T-22-S, R-37-E of Lea County, New Mexico.

Company: _____

Representative: _____

Signature: _____

Title: _____

Date: _____