

***CFT*** CREATIVE FUTURE TECHNOLOGIES

INDUSTRIAL PRODUCT SALES AND MARKETING

Main Office #505-632-0662

P.O. BOX 364 FARMINGTON, NM 87499 PHONE: (505) 327- 4919

OIL CONSERVATION DIVISION  
STATE OF NEW MEXICO  
2040 S. PACHECO  
SANTA FE NEW MEXICO 87505

DISPOSAL MODIFICATION  
LAND FARM ADDITION FOR  
SUNCO TRUCKING  
FARMINGTON NM 87401  
SECTION 2, T29N, R12W

## TABLE OF CONTENTS

- I. TYPE
- II. OPERATOR NAME AND ADDRESS
- III. LOCATION
- IV. EXPANSION PROPOSAL OF EXISTING FACILITY
- V. NAMES AND ADDRESSES OF LANDOWNERS 1 MILE FROM FACILITY
- VI. FACILITY DESCRIPTION
- VII. ENGINEERING DESIGN
- VIII. CONTINGENCY PLAN
- IX. INSPECTION AND MAINTENANCE PLAN
- X. CLOSURE PLAN
- XI. HYDROLOGY
- XII. 711 REQUIREMENTS
- XIII. H2S CONTINGENCY PLAN
- XIV. CERTIFICATION

I. TYPE

Centralized modification of existing water disposal facility to handle solids produced by current operation and not to be for commercial applications.

II. APPLICANT

Sunco Trucking  
708 S. Tucker  
Farmington NM 87401  
Contact; Chuck Badsgjard  
Phone; 505-327-0416 *dc*

III. LOCATION

Section 2, Township 29N, Range 12W

IV. EXPANSION OF CURRENT FACILITY

Yes

V. LANDOWNERS OF RECORD ONE MILE FROM FACILITY BORDER

Attached

VI. FACILITY DESCRIPTION

The current design will be a five (5) acre area to be adjacent to water disposal well within the fenced in disposal boundaries.  
(See Attached Facility Layout)

VII. ENGINEERING PLANS

The cells will be unlined constructed of native soils (see attached soil samples). The cells shall be contained by a 24x24 inch soil berm and made as level as possible.

The soil to be placed in the cell is from solids accumulation in settling tanks and pond bottoms during the natural disposal process. The solids will be consistent with current water received and (TPH) will not be necessary unless high levels of metals or BTEX are suspected. The solids will be spread on labeled cells with location and date information and in six (6) inch lifts not allowing any apparent surface water or fluid. An absorbent shall be added if necessary to provide proper aeration of product and enhance natural bio-remediation. The cells shall be disced on a routine schedule approximately every six weeks.

The remediated cells after OCD inspection or approval of removal will be recycled as mixture soil or used as deemed fit by current OCD regulations.

## VIII. CONTINGENCY PLAN

In the unlikely event of rainfall sufficient enough to breach the cells boundaries vacuum trucks are already present to contain any extra runoff. All accidental spills or uncontrolled discharges shall be reported as to the extent, time, and place of the incident.

## IX. ROUTINE INSPECTION AND MAINTENANCE PLAN

Cells can be inspected on a daily basis in accordance with days the facility is open. Other times cells shall be confined within a locked gate. Random soil samples shall be taken to monitor any movement of surface solids and bore holes filled with native soils.

## X. CLOSURE PLAN

Upon completion of land farm operations the cells shall be returned to natural grade and seeded with native grasses. After closure is complete no other solids shall be farmed.

## XI. GEOLOGICAL/HYDROLOGY

The hydrology was provided with the water disposal well application and should be on file at the NMOCD office.

## XII. RULE 711

The bond is secured by bank letter of credit and can be updated if necessary.

## XIII. H2S CONTINGENCY PLAN

Should H2S become present at cell facility then treatment of appropriate oxidizer such as potassium permanganate shall be applied to maintain safe and acceptable levels.

## XIV. OCD RULES AND REGULATIONS

Sunco Trucking shall comply with current rules and regulations as regulated by NMOCD.

XV. CERTIFICATION

I hereby certify that the information submitted with this application is true and correct to best of my knowledge.

Name: George E. Coleman

Title: President

Signature: George E. Coleman

Date: 11/16/95

# ATTACHMENTS

## LIST OF NOTIFICATIONS

Charles Foutz  
1550 N. Stapley #35  
Mesa, Arizona 85203

Fay Greer  
2816 Kentucky N.E.  
Albuquerque, New Mexico 87110

Valerie Hatch & Meridee Wynn  
P.O. Box 1506  
Fruitland, New Mexico 87416

Dewey Foutz  
P.O. Box 690  
Farmington, New Mexico 87499-0690

Harold W. Horner  
24423 S. Foxglenn Drive  
Sun Lakes, Arizona 85248-7708

Eugene Watson  
3107 Palomas Circle  
Farmington, New Mexico 87401

Edward E. Condit  
8609 La Sala Grande NE  
Albuquerque, New Mexico 87107

Raymond R. Condit  
#8 CR 5821 NBU 3002 #6  
Farmington, New Mexico 87401

Pauline Sommerfeldt  
P.O. Box 12039 Station F  
Albuquerque, New Mexico 87195

Tierra Environmental  
P.O. Drawer 15250  
Farmington, New Mexico 87401

Environmental Protection Co.  
P.O. Box 1977  
Farmington, N. M. 87499-1977

Morningstar Corporation  
P.O. Box 9  
Farmington, New Mexico 87499

Judith W. Stanley  
P.O. Box 602  
Flora Vista, New Mexico 87415

David W. George  
P.O. Box 1782  
Farmington, New Mexico 87499

Aurthur H. Bichan  
6750 Colby Lane  
Bloomfield Hills, MI 48301

Glenn E. Vaura  
P.O. Box 1  
Farmington, New Mexico 87499

Sierra Oilfield Services  
P.O. Box 6074  
Farmington, New Mexico 87499

Helen D. Foutz  
1550 N. Staple Dr. #35  
Mesa, Arizona 85203

Jack M. Mackey  
#51 CR 4012  
Ignacio, Colorado 81137

John S. Scott  
5301 Marcy Place  
Farmington, New Mexico 87401

Vance L. Roberts  
#419 CR RD 5569  
Farmington, New Mexico 87401

Isaac F. Padilla  
CR 3463 Space 5B  
Flora Vista, New Mexico 87415

Darby L. West  
C/O Wilford Harrison  
P.O. Box 992  
Waterflow, New Mexico 87421

Tammy R. Giant  
465 Idora Ave.  
Vallejo, California 94591

John C. Hargis Jr.  
491 CR 3000  
Aztec, New Mexico 87410

Dugan Production Corp.  
P.O. Box 420  
Farmington, New Mexico 87499

Ed J. Bengfort  
605 N. Allen  
Farmington, New Mexico 87401

Michael W. Conrey  
1617 White Water Ct.  
Berthoud, Colorado 80513

Gary David Lanier  
P.O. Box 1208  
Aztec, New Mexico 87410-1208

Joretta W. Clement  
#78 CR 5500  
NBU 3039  
Farmington, New Mexico 87401

Jack W. Scott  
P.O. Box 149  
Aztec, New Mexico 87410

Katy S. Moss  
275 Lower Cliff Dr.  
Laguna Beach, California 92651

Carrol E. Vaughn  
#8 CR 5151 NBU 1003.3-4  
Bloomfield, New Mexico 87413

Carolyn Johnston  
Box 1432  
Farmington, New Mexico 87499

W.W. Windham  
P.O. BOX 2036  
Farmington, New Mexico 87499

Darby L. West  
#11 CR 5578  
Farmington, New Mexico 87401

Jimmie Becenti  
#17 CR 5517  
Farmington, N.M. 87401-1434

Isaac F. Padilla  
C/O Chris E. Allen  
#4 CR 5221 Box 6  
Bloomfield, New Mexico 87413

Darby L. West  
C/O Robert C. Tapia  
P.O. Box 1658  
Farmington, New Mexico 87499

City of Albuquerque  
C/O Price Family LTD  
P.O. Drawer 28  
Farmington, New Mexico 87499

Ralph Maestas  
#20 CR 3665  
Aztec, New Mexico 87410

Leopaldo Fiberto Maestas  
803 McCoy Avenue  
Aztec, New Mexico 87410



Joe Jacquez  
P.O. Box 526  
Aztec, New Mexico 87410

Paul McQueary  
2609 East 20th  
Farmington, New Mexico 87401

J.B. Cambell & Russell H. Baker  
609 South Carlton  
Farmington, New Mexico 87401

Gorden N. Crane  
C/O Ronald Hastings  
1010 Sycamore  
Farmington, New Mexico 87401

Dan Eric Dombrowski  
#18 CR 2395  
Aztec, New Mexico 87510

Denis L. Brady  
Box 6498  
Farmington, New Mexico 87499

Edna Cambell  
C/O Mary Allison  
RT 2 Box 618  
Laveen, Arizona 85339

Cristina Brouse  
P. O. Box 104  
Flora Vista, New Mexico 87415-0104

James V. Chiaramonte  
403 RD 5569  
Farmington NM. 87401

Nancy C. Bingham  
#22 CR 5190  
Bloomfield, New Mexico 87413

Lloyd Lujan  
P.O. Box 1094  
Farmington, New Mexico 87499

John Paul Boyden  
#8 RD 3146  
Aztec, New Mexico 87410

Eric Peters  
421 N. 4th Street  
Bloomfield, New Mexico 87413

Ray Guy  
P.O. Box 3442  
Farmington, New Mexico 87499

James D. Krass Sr.  
#22 RD 3143  
Farmington, New Mexico 87401

Jerry C. Walker  
P.O. Box 1810  
Aztec, New Mexico 87410

Kelly J. Grabb  
P.O. Box 518  
Flora Vista, New Mexico 87415

Felecia Head  
1824 S. Butler  
Farmington, New Mexico 87401

Ronald Hastings  
1010 Sycamore  
Farmington, New Mexico 87401

Mary J. Miller  
P.O. Box 605  
Chama, New Mexico 87520

Steve Van Houten  
119 RD 3141  
Aztec, New Mexico 87410

Jose M. Grijalva  
P.O. Box 482  
Aztec, New Mexico 87410

Tobin A. Savage  
P.O. Box 880  
Holbrook, Arizona 86025

Raymond W. Stone  
P.O. Box 2183  
Bloomfield, New Mexico 87413

Shawn A. Rants  
P.O. Box 2183  
Bloomfield, New Mexico 87413

Frank A. Waterhouse  
1600 Laguna Ave  
Farmington, New Mexico 87401

Carolina Madrid  
P.O. Box 373  
Flora Vista, NM 87415-0373

Stuart Trapp  
#42 RD 3142  
Aztec, New Mexico 87410

Angela P. Atencio  
800 Tamarack  
Farmington, New Mexico 87401

Victorian Whitaker  
45 RD 3141  
Aztec, New Mexico 87410

Richard Francisco  
P.O. Box 1322  
Farmington, New Mexico 87499

Micheal Booth  
2100 W. Main St.  
Farmington, New Mexico 87401

Leanora D. Johnson  
3401 Edgecliff  
Farmington, New Mexico 87402

Charles Crowley  
#99 CR 3141  
Aztec, New Mexico 87410

Delores Foster  
P.O. Box 3252  
Farmington, New Mexico 87499

Tony L. Snow  
5530 Beach Street  
Farmington, New Mexico 87402

Carroll Brown Jr.  
P.O. Box 1581  
Aztec, New Mexico 87410-4581

Tresa Ransom  
P.O. Box 629  
Farmington, New Mexico 87499

Paul Quintanna  
P.O. Box 413  
Flora Vista, New Mexico 87415

Billy R. Justice  
P.O. Box 1233  
Aztec, New Mexico 87410

Barbara Atencio  
720 Tamarack  
Farmington, New Mexico 87401

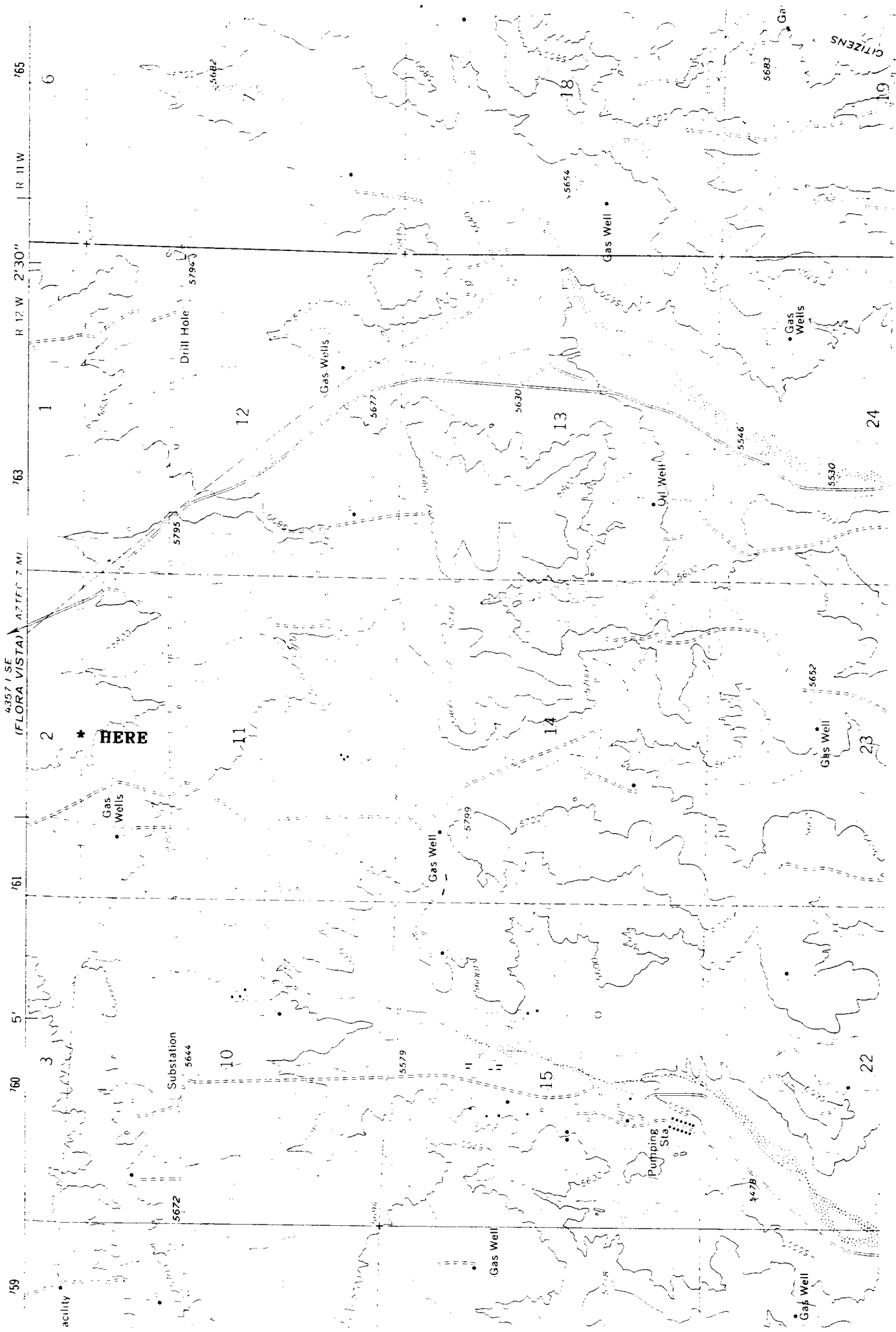

4357 1 SE  
(FLORA VISTA) A77EC 7 MI

765  
R 12 W 2'30"  
763  
761  
760  
5'  
759

2 \* **HERE**

Gas Wells

Substation  
5644

5672

Drill Hole  
5794

Gas Wells

Gas Well  
5799

Gas Well

5677

5630

5654

Pumping  
Sta.

5478

Oil Well

5546

Gas Well

Gas Well

Gas Well  
5652

Gas Wells

5682

5683

CITIZENS

5530

Gas Well

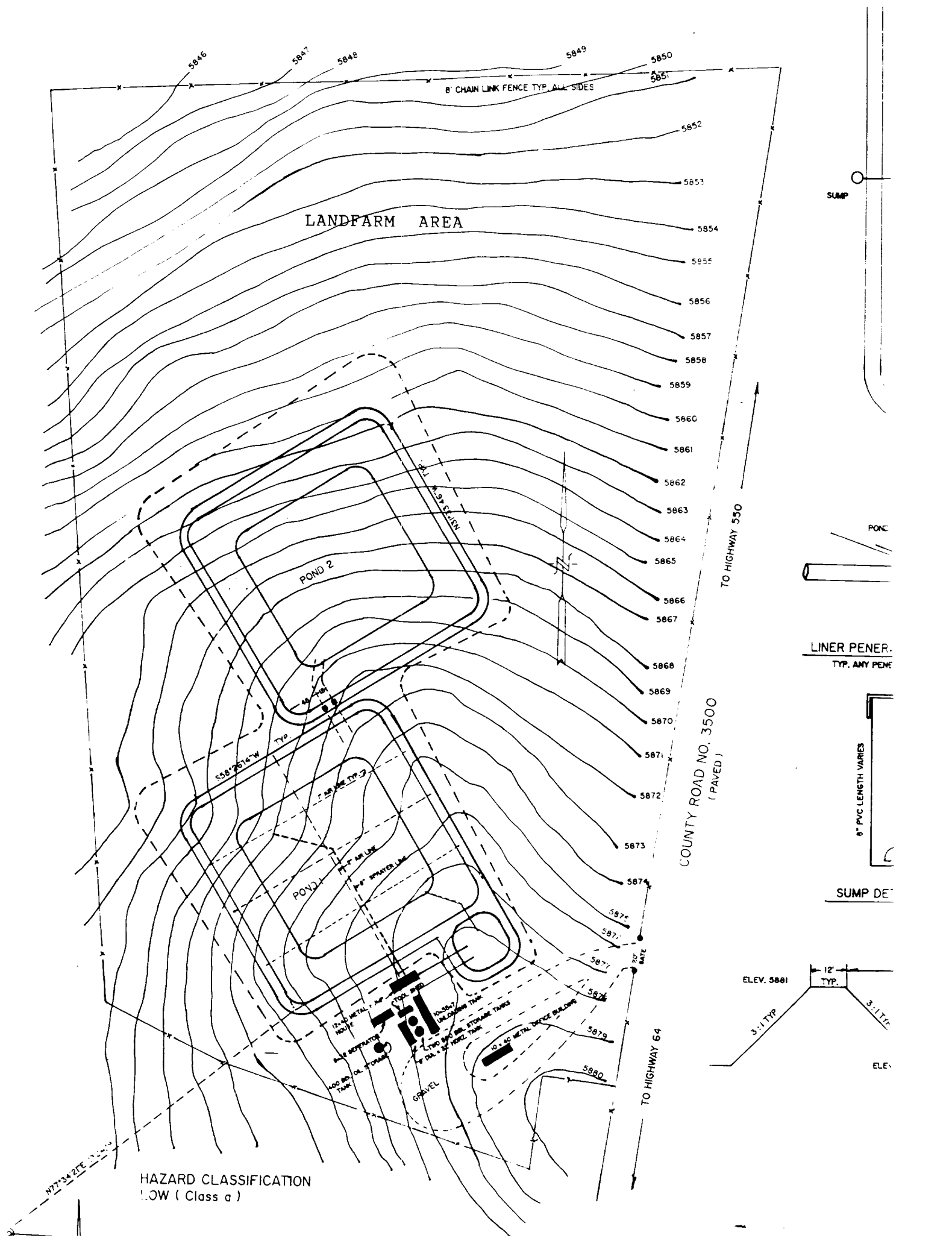

HAZARD CLASSIFICATION  
LOW (Class a)

SUMP

POND

LINER PENER.  
TYP. ANY PENE

6" PVC LENGTH VARIES

SUMP DE

ELEV. 5881

12" TYP.

3:1 TYP.

ELEV.

8" CHAIN LINK FENCE TYP. ALL SIDES

LANDFARM AREA

POND 2

POND 1

HOUSE

WASTE SEPARATOR

100 GAL. OIL STORAGE TANK

GRAVEL

10 x 40 METAL STORAGE TANK

10 x 40 METAL STORAGE TANK

10 x 40 METAL STORAGE TANK

10 x 40 METAL STORAGE TANK

10 x 40 METAL STORAGE TANK

10 x 40 METAL STORAGE TANK

10 x 40 METAL STORAGE TANK

10 x 40 METAL STORAGE TANK

10 x 40 METAL STORAGE TANK

10 x 40 METAL STORAGE TANK

COUNTY ROAD NO. 3500  
(PAVED)

TO HIGHWAY 550

TO HIGHWAY 64

N77°34'21"E D=150'

558'± 16"± W TYP.

12"± AIR LINE TYP.

12"± AIR LINE

12"± AIR LINE

12"± AIR LINE

12"± AIR LINE

12"± AIR LINE

12"± AIR LINE

12"± AIR LINE

12"± AIR LINE

12"± AIR LINE

12"± AIR LINE

12"± AIR LINE

24" AIR LINE

20'± GATE

20'± GATE

20'± GATE

20'± GATE

20'± GATE

20'± GATE

20'± GATE

20'± GATE

20'± GATE

20'± GATE

20'± GATE

20'± GATE



# Earth & Environmental

## LABORATORY REPORT

APPROVED  
BY: \_\_\_\_\_  
DATE: \_\_\_\_\_

Client Tierra Environmental Company  
909 West Apache  
Farmington, NM 87401

Project No. C94-9764  
Client P.O. No. \_\_\_\_\_  
Date of Report 10-14-94

Project Proposed Land Farm  
Location San Juan County, New Mexico  
Type of Material Sandy Lean Clay Source of Material Sunco #2  
Requested By Connie Dinning Date 10-11-94 Sampled By Connie Dinning Date 10-11-94  
Submitted By Connie Dinning Date 10-11-94 Reviewed By L. Waresbach

### Sieve Analysis, ASTM

Sieve Size	Accumulative % Passing	Specification
3"		
2½"		
2"		
1½"		
1"		
¾"		
½"		
¾"	100	
¼"	--	
No. 4	99	
8	99	
10	99	
16	97	
30	92	
40	88	
50	84	
100	75	
200	54	

Moisture Density Relationship, Test Method \_\_\_\_\_

Maximum Dry Density, PCF \_\_\_\_\_ Optimum Moisture, % \_\_\_\_\_

Plasticity Index, ASTM D4318

	Results	Specs.
LL:	26	_____
PL:	18	_____
PI:	8	_____

Other \_\_\_\_\_

Distribution: Client, Billing /mir



**LABORATORY REPORT**

AGRA Earth &  
Environmental, Inc.  
2080 Alton Road  
Farmington, NM, Mexico 87401  
Tel: 505-327-0980  
Fax: 505-327-5701

Client           Tierra Environmental Company  
          909 West Apache  
          Farmington, NM 87401

Project No.           C94-9764  
Client P.O. No.             
Date of Report           10-14-94

Project           Proposed Land Farm  
Location           San Juan County, New Mexico  
Type of Material           SC- Clayey Sand      Source of Material           Sunco #3  
Requested By           Connie Dinning      Date           10-11-94      Sampled By           Connie Dinning      Date           10-11-94  
Submitted By           Connie Dinning      Date           10-11-94      Reviewed By           *S. Waresbeck*

**Sieve Analysis, ASTM**

Sieve Size	Accumulative % Passing	Specification
3"		
2½"		
2"		
1½"		
1"		
¾"		
½"		
⅜"	100	
¼"	--	
No. 4	98	
8	95	
10	94	
16	92	
30	86	
40	82	
50	78	
100	70	
200	48	

Moisture Density Relationship, Test Method             
Maximum Dry Density, PCF                 Optimum Moisture, %           

Plasticity Index, ASTM D4318

	Results	Specs.
LL:	<u>          28</u>	<u>          </u>
PL:	<u>          17</u>	<u>          </u>
Pi:	<u>          9</u>	<u>          </u>

Other           

Distribution:           Client, Billing /mir

Client Tierra Environmental Company  
909 West Apache  
Farmington, NM 87401

Project No. C94-9764  
 Client P.O. No. \_\_\_\_\_  
 Date of Report 10-14-94

Project Proposed Land Farm  
 Location San Juan County, New Mexico  
 Type of Material SC-Clayey Sand Source of Material Sunco #4  
 Requested By Connie Dinning Date 10-11-94 Sampled By Connie Dinning Date 10-11-94  
 Submitted By Connie Dinning Date 10-11-94 Reviewed By L. Wareslack

Sieve Analysis, ASTM

Sieve Size	Accumulative % Passing	Specification
3"		
2½"		
2"		
1½"		
1"		
¾"		
½"		
⅜"	100	
¼"	-	
No. 4	99	
8	96	
10	94	
16	90	
30	83	
40	79	
50	75	
100	65	
200	42	

Moisture Density Relationship, Test Method \_\_\_\_\_  
 Maximum Dry Density, PCF \_\_\_\_\_ Optimum Moisture, % \_\_\_\_\_

Plasticity Index, ASTM D4318

	Results	Specs.
LL:	<u>27</u>	_____
PL:	<u>18</u>	_____
Pi:	<u>9</u>	_____

Other \_\_\_\_\_

Distribution: Client, Billing /mir