

R 27 E

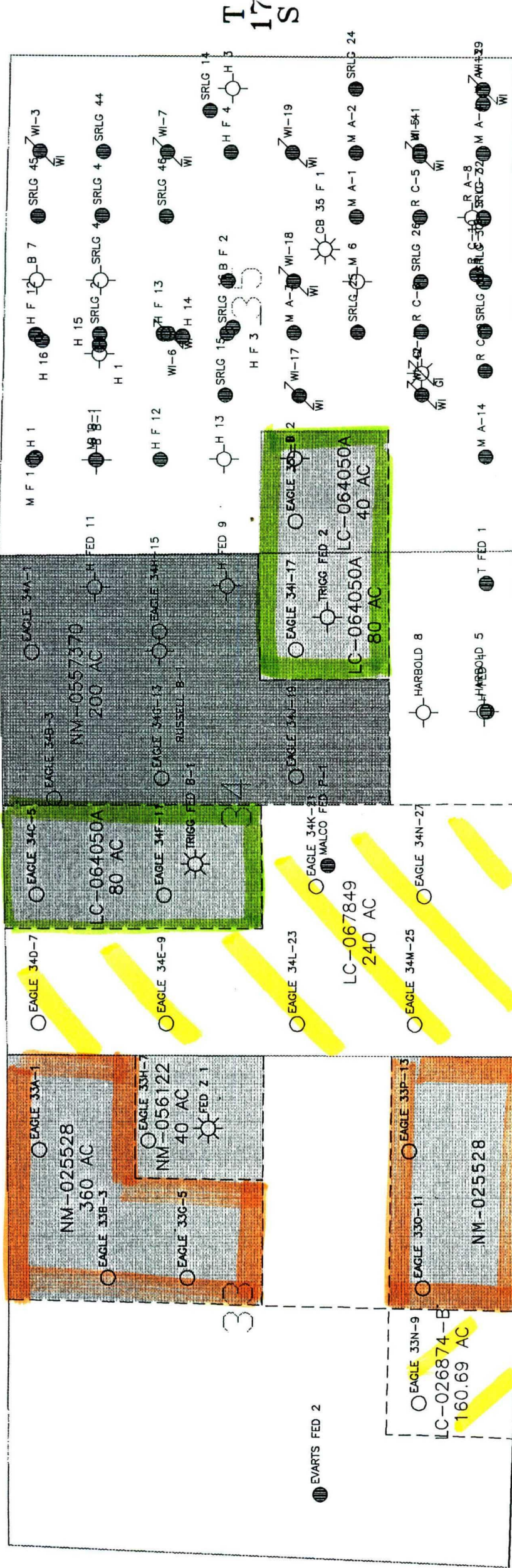

INTEREST OWNERS
Surface Commingling Application Case No. 11693

NM-0557370

Lulu E. Harbold Estate
Howard B. Wright Trust
Summit Energy, Inc.
Joan A. Hudson
Jane Ann Hudson Davis
Jonel Susan Grasso
Amoco Production Company
Devon Energy Corporation (Nevada)

*All Red Lease
CRK: Everybody but
Devon & Amoco*

LC-067849

Joan A. Hudson
Jane Ann Hudson Davis
Jonel Susan Grasso
Amoco Production Company
Devon Energy Corporation (Nevada)

NM-025528

Devon Energy Corporation (Nevada)
Amoco Production Company

LC-064050-A

Trigg Family Trust
Amoco Production Company
Devon Energy Corporation (Nevada)

NM-056122

Amoco Production Company
Devon Energy Corporation (Nevada)

LC-206874-B

Devon Energy Corporation (Nevada)

NEW MEXICO
OIL CONSERVATION DIVISION

Devon EXHIBIT 2

CASE NO. 11693

APPLICATION FOR SURFACE COMMINGLING OFF LEASE STORAGE AND MEASUREMENT APPROVAL

To: Bureau of Land Management
620 E. Greene Street
Carlsbad, New Mexico 88220

Devon Energy Corporation requests approval for surface commingling and off lease storage and measurement of hydrocarbon production from the following wells on Federal Lease No. NM-025528

Lease Name: Eagle "33" Federal

<u>Well No.</u>	<u>UL</u>	<u>Sec</u>	<u>Twp</u>	<u>Rng</u>	<u>Formation</u>
1	A	33	17S	27E	Grayburg/San Andres
3	B	33	17S	27E	Grayburg/San Andres
5	G	33	17S	27E	Grayburg/San Andres
11	O	33	17S	27E	Grayburg/San Andres
13	P	33	17S	27E	Grayburg/San Andres

with hydrocarbon production from the following wells on Federal Lease No. NM-056122

Lease Name: Eagle "33" Federal

<u>Well No.</u>	<u>UL</u>	<u>Sec</u>	<u>Twp</u>	<u>Rng</u>	<u>Formation</u>
7	H	33	17S	27E	Grayburg/San Andres

with hydrocarbon production from the following wells on Federal Lease No. LC 026874-B

Lease Name: Eagle "33" Federal

<u>Well No.</u>	<u>UL</u>	<u>Sec</u>	<u>Twp</u>	<u>Rng</u>	<u>Formation</u>
9	N	33	17S	27E	Grayburg/San Andres

with hydrocarbon production from the following wells on Federal Lease No. NM-0557370

Lease Name: Eagle "34" Federal

<u>Well No.</u>	<u>UL</u>	<u>Sec</u>	<u>Twp</u>	<u>Rng</u>	<u>Formation</u>
1	A	34	17S	27E	Grayburg/San Andres
3	B	34	17S	27E	Grayburg/San Andres
13	G	34	17S	27E	Grayburg/San Andres
15	H	34	17S	27E	Grayburg/San Andres
19	J	34	17S	27E	Grayburg/San Andres

with hydrocarbon production from the following wells on Federal Lease No. LC-064050-A

Lease Name: Eagle "34" Federal

<u>Well No.</u>	<u>UL</u>	<u>Sec</u>	<u>Twp</u>	<u>Rng</u>	<u>Formation</u>
5	C	34	17S	27E	Grayburg/San Andres
11	F	34	17S	27E	Grayburg/San Andres
17	I	34	17S	27E	Grayburg/San Andres

Lease Name: Eagle "35" Federal

1	L	35	17S	27E	Grayburg/San Andres
---	---	----	-----	-----	---------------------

with hydrocarbon production from the following wells on Federal Lease No. LC-067849

Lease Name: Eagle "34" Federal

<u>Well No.</u>	<u>UL</u>	<u>Sec</u>	<u>Twp</u>	<u>Rng</u>	<u>Formation</u>
7	D	34	17S	27E	Grayburg/San Andres
9	E	34	17S	27E	Grayburg/San Andres
21	K	34	17S	27E	Grayburg/San Andres
23	L	34	17S	27E	Grayburg/San Andres
25	M	34	17S	27E	Grayburg/San Andres
27	N	34	17S	27E	Grayburg/San Andres

NEW MEXICO
OIL CONSERVATION DIVISION

3

EXHIBIT

Devon

1/693

CASE NO

Production from the wells involved is as follows:

<u>Well</u>	<u>BOPD</u>	<u>Oil Gravity</u>	<u>MCFPD</u>
Eagle "33A" #1	TO BE DRILLED, TEST TO FOLLOW.		
Eagle "33B" #3	TO BE DRILLED, TEST TO FOLLOW.		
Eagle "33G" #5	TO BE DRILLED, TEST TO FOLLOW.		
Eagle "33H" #7	TO BE DRILLED, TEST TO FOLLOW.		
Eagle "33N" #9	TO BE DRILLED, TEST TO FOLLOW.		
Eagle "33O" #11	TO BE DRILLED, TEST TO FOLLOW.		
Eagle "33P" #13	TO BE DRILLED, TEST TO FOLLOW.		
Eagle "34A" #1	TO BE DRILLED, TEST TO FOLLOW.		
Eagle "34B" #3	TO BE DRILLED, TEST TO FOLLOW.		
Eagle "34C" #5	TO BE DRILLED, TEST TO FOLLOW.		
Eagle "34D" #7	TO BE DRILLED, TEST TO FOLLOW.		
Eagle "34E" #9	TO BE DRILLED, TEST TO FOLLOW.		
Eagle "34F" #11	TO BE DRILLED, TEST TO FOLLOW.		
Eagle "34G" #13	TO BE DRILLED, TEST TO FOLLOW.		
Eagle "34H" #15	TO BE DRILLED, TEST TO FOLLOW.		
Eagle "34I" #17	COMPLETING, TEST TO FOLLOW		
Eagle "34J" #19	TO BE DRILLED, TEST TO FOLLOW.		
Eagle "34K" #21	TO BE DRILLED, TEST TO FOLLOW.		
Eagle "34L" #23	TO BE DRILLED, TEST TO FOLLOW.		
Eagle "34M" #25	TO BE DRILLED, TEST TO FOLLOW.		
Eagle "34N" #27	TO BE DRILLED, TEST TO FOLLOW.		

Exhibit I is a schematic which shows the equipment that will be utilized to determine well production from each lease. A map (Exhibit II) is enclosed that shows the lease numbers and location of all leases and wells that will contribute production to the proposed commingled facility.

The storage and measuring facility will be located in UL K in the NE/SW of Section 34, T17S, R 27E on lease No. LC-067849 in Eddy County, New Mexico. The BLM will be notified if there is any future change in the facility location.

Process and Flow Description: Under the proposed flow system, gas will be flowed out the casing from each well and will be tested at the well using an orifice well tester. Oil and water will be pumped out the tubing and will go through a flowline to a header at the battery. Wells will be tested by switching into the test treater which will separate the oil and water and allow the oil to be measured in a test tank and the water by means of a meter.

Production Allocation: Production allocation will be based on periodic well tests as described above. Allocation of total gas recorded by the Sales Gas Meter will be based on these tests.

The overriding royalty owners, and NMOCD have been notified of this proposal.

The proposed commingling of production is in the interest of conservation and will not result in reduced royalty or improper measurement of production.

The proposed commingling is necessary for hydrocarbon development and operation on the above referenced Federal leases.

We understand that the requested approval will not constitute the granting of any right-of-way or construction rights not granted by the lease instrument. We have submitted an application for the necessary right-of-way approvals to the BLM's Realty Section.

Signed: E. L. Buttross Jr.

Name: E. L. Buttross, Jr.

Title: District Engineer

Date: October 28, 1996

Devon Energy Corporation (Nevada)
20 N. Broadway, Suite 1500
Oklahoma City, OK 736102

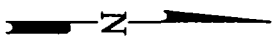
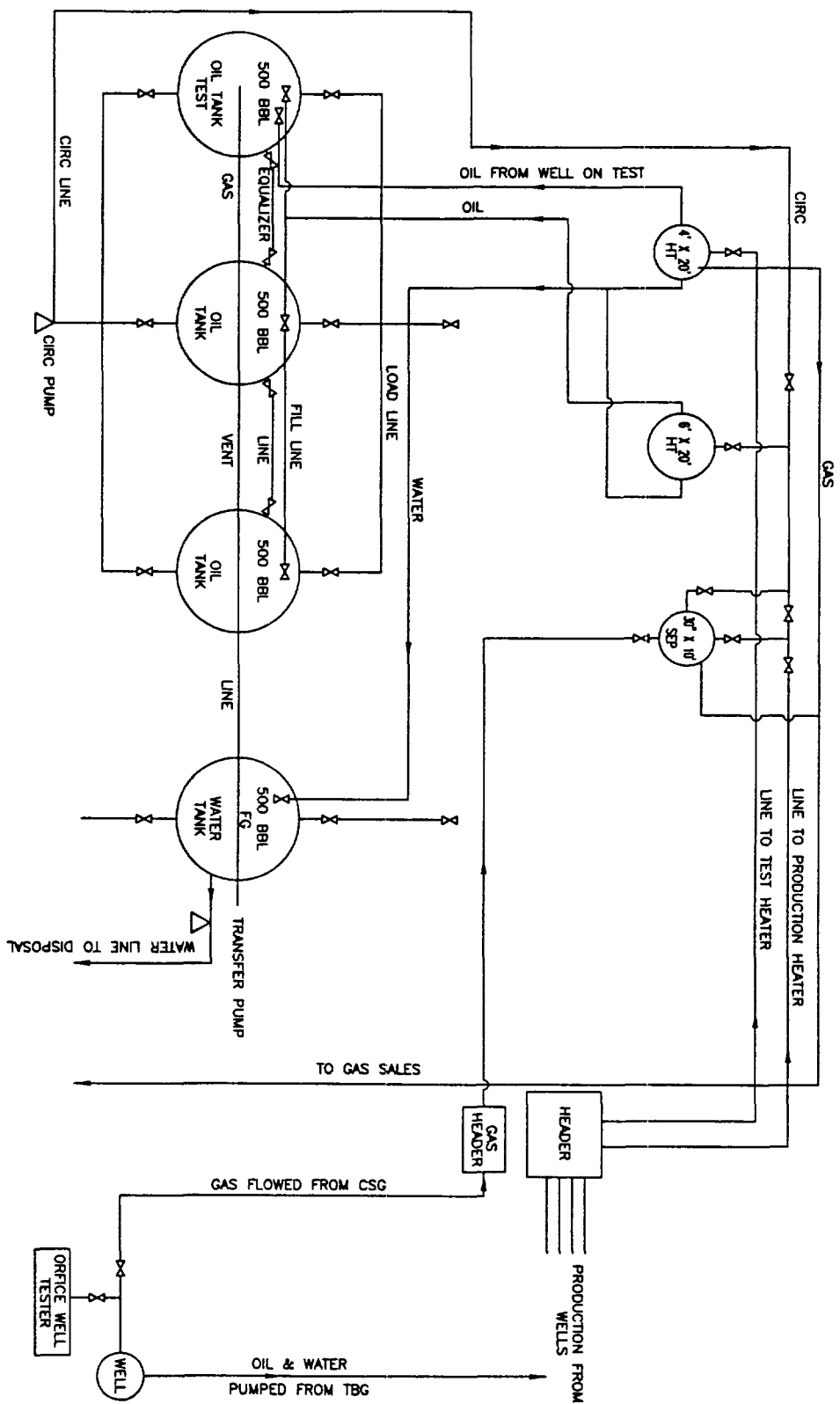

EGL-BATT

denon

RED LAKE AREA

EDDY COUNTY, NEW MEXICO

EXHIBIT # 1

EAGLE

FEDERAL BATTERY

FLOW DIAGRAM

F CORNELL

10/96

BEFORE THE NEW MEXICO OIL CONSERVATION DIVISION

APPLICATION OF DEVON ENERGY
CORPORATION (NEVADA) FOR
SURFACE COMMINGLING,
EDDY COUNTY, NEW MEXICO.

Case No. 11693

AFFIDAVIT REGARDING NOTICE

STATE OF NEW MEXICO)
COUNTY OF SANTA FE) ss.

James Bruce, being duly sworn upon his oath, deposes and states:

1. I am over the age of 18, and have personal knowledge of the matters stated herein.

2. I am an attorney for Applicant.

3. Applicant has conducted a good faith, diligent effort to find the names and correct addresses of the interest owners entitled to receive notice of the Application filed herein.

4. Notice of the Application was provided to the interest owners at their correct addresses by certified mail. Copies of the notice letter and certified return receipts are attached hereto as Exhibit A.

5. Applicant has complied with the notice provisions of Division Rule 1207.

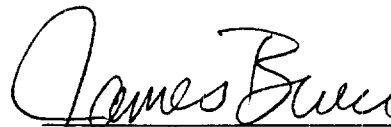

James Bruce

SUBSCRIBED AND SWORN TO before me this 8th day of January, 1997, by James Bruce.

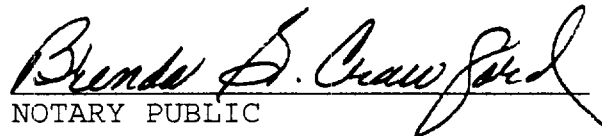
NOTARY PUBLIC

My Commission Expires:

10-29-99

NEW MEXICO
OIL CONSERVATION DIVISION

Devon EXHIBIT 4

CASE NO. 11693

HINKLE, COX, EATON, COFFIELD & HENSLEY,
L.L.P.

ATTORNEYS AT LAW

218 MONTEZUMA POST OFFICE BOX 2068
SANTA FE, NEW MEXICO 87504-2068
(505) 982-4554 FAX (505) 982-8623

LEWIS C. COX, JR. (1924-1993)
CLARENCE E. HINKLE (1904-1988)

OF COUNSEL
O. M. CALHOUN* JOE W. WOOD
RICHARD L. CAZZELL* RAY W. RICHARDS*

AUSTIN AFFILIATION
HOFFMAN & STEPHENS, P.C.
KENNETH R. HOFFMAN*
TOM D. STEPHENS*
RONALD C. SCHULTZ, JR.*
JOSE CANO*

THOMAS E. HOOD*
REBECCA NICHOLS JOHNSON
STANLEY K. KOTOVSKY, JR.
ELLEN S. CASEY
MARGARET CARTER LUDEWIG
S. BARRY PAISNER
WYATT L. BROOKS*
DAVID M. RUSSELL*
ANDREW J. CLOUTER
STEPHANIE LANDRY
KIRT E. MOELLING*
DIANE FISHER
JULIE P. NEERKEN
WILLIAM P. SLATTERY
CHRISTOPHER M. MOODY
JOHN D. PHILLIPS
EARL R. NORRIS
JAMES A. GILLESPIE
MARGARET R. MCNETT

GARY W. LARSON
LISA K. SMITH*
NORMAN D. EWART
DARREN T. GROCE*
WOLLY MCINTOSH
MARCIA B. LINCOLN
SCOTT A. SHUART*
PAUL G. NASON
AMY C. WRIGHT*
BRADLEY G. BISHOP*
KAROLYN KING NELSON
ELLEN T. LOUDERBOUGH
JAMES H. WOOD*
NANCY L. STRATTON
TIMOTHY R. BROWN
JAMES C. MARTIN
KATHLEEN N. HALL

*NOT LICENSED IN NEW MEXICO

December 20, 1996

CERTIFIED MAIL
RETURN RECEIPT REQUESTED

To: Persons on Exhibit A

Enclosed is a copy of an application filed at the New Mexico Oil Conservation Division by Devon Energy Corporation (Nevada) requesting approval to surface commingle Red Lake Queen-Grayburg-San Andres Pool production from its Eagle Federal Leases, located in Sections 33-35, Township 17 South, Range 27 East, Eddy County, New Mexico. This matter will be heard at 8:15 a.m. on Thursday, January 9, 1997 at the Division's offices at 2040 South Pacheco Street, Santa Fe, New Mexico 87505. As an interest owner, you have the right to appear at the hearing and present evidence. Failure to appear at the hearing will preclude you from contesting this matter at a later date.

Very truly yours,

HINKLE, COX, EATON, COFFIELD
& HENSLEY, L.L.P.

James Bruce
James Bruce

Attorneys for Devon Energy
Corporation (Nevada)

sc.nl

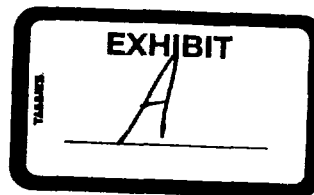

POST OFFICE BOX 10
ROSWELL, NEW MEXICO 88202
(505) 622-6510
FAX (505) 623-9332

POST OFFICE BOX 3580
MIDLAND, TEXAS 79702
(915) 683-4691
FAX (915) 683-6518

POST OFFICE BOX 9238
AMARILLO, TEXAS 79105
(806) 372-5569
FAX (806) 372-9761

POST OFFICE BOX 2043
ALBUQUERQUE, NEW MEXICO 87103
(505) 768-1500
FAX (505) 768-1529

401 W. 15TH STREET, SUITE 800
AUSTIN, TEXAS 78701
(512) 476-7137
FAX (512) 476-9431

EXHIBIT "A"

Lulu E. Harbold Estate
Ruth Turbefill, Individually
and as Executrix
Post Office Box 504
Mesa Park, NM 88047-0504

Howard B. Wright Trust
Wells Fargo Bank, Trustee
Trust Natural Resources
Post Office Box 5825
Denver, CO 80217-5825

Summitt Energy, Inc.
Irongate 3, Suite 201
777 S. Wadsworth Blvd.
Lakewood, CO 80226

Trigg Family Trust
John H. Trigg and
Pauline V. Trigg, Trustees
Post Office Box 520
Roswell, NM 88201

Joan A. Hudson
8053 San Vista Circle
Naples, FL 33942

Jane Ann Hudson Davis
Post Office Box 2660
Ruidoso, NM 88345-2660

Minerals Management Service
Royalty Program
Post Office Box 5810, T.A.
Denver, CO 80217

Minerals Management Service
Royalty Management Program
Building 85, Denver Federal Center
Room A-212, Revenue Document Proc.
Denver, CO 80225-0001

Jonel Susan Grasso
11 Ocean Ridge
Laguna Niguel, CA 92677

Amoco Production Company
Attn: Jerry West
501 Westlake Park Blvd.
Post Office Box 4891
Houston, TX 77210

Eott Energy Operating Ltd. Partnership
Post Office Box 4666
Houston, TX 77210-4666

GPM Gas Services Corp.
4044 Penbrook
Odessa, TX 79762

Bureau of Land Management
620 East Greene
Carlsbad, NM 88220

BEFORE THE NEW MEXICO OIL CONSERVATION DIVISION

RECEIVED

DEC 17 1996

ADMINISTRATIVE APPLICATION OF DEVON
ENERGY CORPORATION (NEVADA) FOR
SURFACE COMMINGLING, EDDY COUNTY,
NEW MEXICO.

Oil Conservation Division

CASE NO. _____

APPLICATION

Devon Energy Corporation (Nevada) hereby applies for an exception to Division Rule 303.A to permit surface commingling, as described further below:

1. Applicant is the operator of the Eagle "33" Federal, Eagle "34" Federal, and Eagle "35" Federal Leases, comprised of United States Oil and Gas Leases LC 206874-B, NM 025528, NM 0557370, LC 064050-A, and LC 067849, which cover all or parts of Sections 33, 34, and 35 of Township 17 South, Range 27 East, NMPM.

2. Working interests and royalty interests under the aforesaid leases are common, but overriding royalty interest ownership differs among the subject leases.

3. Applicant proposes to surface commingle Red Lake Queen-Grayburg-San Andres Pool production from 22 wells drilled or to be drilled on the foregoing leases, without separately metering production, as described on Exhibit A attached hereto.

4. Notice has been given to all interest owners in the affected leases, by certified mail.

5. The granting of this application is in the interests of conservation, the prevention of waste, and the protection of correlative rights.

WHEREFORE, Applicant requests that the Division approve

surface commingling of Red Lake Queen-Grayburg-San Andres Pool
production from the foregoing leases.

Respectfully submitted,

HINKLE, COX, EATON, COFFIELD
& HENSLEY, L.L.P.

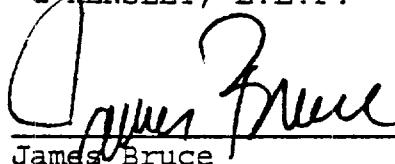
A handwritten signature in dark ink, appearing to read "James Bruce", is written over a horizontal line.

James Bruce
P. O. Box 2068
Santa Fe, New Mexico 87504
(505) 982-4554

Attorneys for Devon Energy
Corporation (Nevada)

APPLICATION FOR SURFACE COMMINGLING OFF LEASE STORAGE AND MEASUREMENT APPROVAL

To: Bureau of Land Management
620 E. Greene Street
Carlsbad, New Mexico 88220

Devon Energy Corporation requests approval for surface commingling and off lease storage and measurement of hydrocarbon production from the following wells on Federal Lease No. NM-025528

Lease Name: Eagle "33" Federal

Well No.	UL	Sec	Twp	Rng	Formation
1	A	33	17S	27E	Grayburg/San Andres
3	B	33	17S	27E	Grayburg/San Andres
5	G	33	17S	27E	Grayburg/San Andres
11	O	33	17S	27E	Grayburg/San Andres
13	P	33	17S	27E	Grayburg/San Andres

with hydrocarbon production from the following wells on Federal Lease No. NM-056122

Lease Name: Eagle "33" Federal

Well No.	UL	Sec	Twp	Rng	Formation
7	H	33	17S	27E	Grayburg/San Andres

with hydrocarbon production from the following wells on Federal Lease No. LC 026874-B

Lease Name: Eagle "33" Federal

Well No.	UL	Sec	Twp	Rng	Formation
9	N	33	17S	27E	Grayburg/San Andres

with hydrocarbon production from the following wells on Federal Lease No. NM-0557370

Lease Name: Eagle "34" Federal

Well No.	UL	Sec	Twp	Rng	Formation
1	A	34	17S	27E	Grayburg/San Andres
3	B	34	17S	27E	Grayburg/San Andres
13	G	34	17S	27E	Grayburg/San Andres
15	H	34	17S	27E	Grayburg/San Andres
19	J	34	17S	27E	Grayburg/San Andres

with hydrocarbon production from the following wells on Federal Lease No. LC-064050-A

Lease Name: Eagle "34" Federal

Well No.	UL	Sec	Twp	Rng	Formation
5	C	34	17S	27E	Grayburg/San Andres
11	F	34	17S	27E	Grayburg/San Andres
17	I	34	17S	27E	Grayburg/San Andres

Lease Name: Eagle "35" Federal

Well No.	UL	Sec	Twp	Rng	Formation
1	L	35	17S	27E	Grayburg/San Andres

with hydrocarbon production from the following wells on Federal Lease No. LC-067849

Lease Name: Eagle "34" Federal

Well No.	UL	Sec	Twp	Rng	Formation
7	D	34	17S	27E	Grayburg/San Andres
9	E	34	17S	27E	Grayburg/San Andres
21	K	34	17S	27E	Grayburg/San Andres
23	L	34	17S	27E	Grayburg/San Andres
25	M	34	17S	27E	Grayburg/San Andres
27	N	34	17S	27E	Grayburg/San Andres

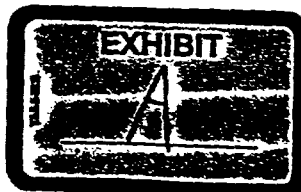

Production from the wells involved is as follows:

<u>Well</u>	<u>BOPD</u>	<u>Oil Gravity</u>	<u>MCEPD</u>
Eagle "33A" #1	TO BE DRILLED, TEST TO FOLLOW.		
Eagle "33B" #3	TO BE DRILLED, TEST TO FOLLOW.		
Eagle "33G" #5	TO BE DRILLED, TEST TO FOLLOW.		
Eagle "33H" #7	TO BE DRILLED, TEST TO FOLLOW.		
Eagle "33N" #9	TO BE DRILLED, TEST TO FOLLOW.		
Eagle "33O" #11	TO BE DRILLED, TEST TO FOLLOW.		
Eagle "33P" #13	TO BE DRILLED, TEST TO FOLLOW.		
Eagle "34A" #1	TO BE DRILLED, TEST TO FOLLOW.		
Eagle "34B" #3	TO BE DRILLED, TEST TO FOLLOW.		
Eagle "34C" #5	TO BE DRILLED, TEST TO FOLLOW.		
Eagle "34D" #7	TO BE DRILLED, TEST TO FOLLOW.		
Eagle "34E" #9	TO BE DRILLED, TEST TO FOLLOW.		
Eagle "34F" #11	TO BE DRILLED, TEST TO FOLLOW.		
Eagle "34G" #13	TO BE DRILLED, TEST TO FOLLOW.		
Eagle "34H" #15	TO BE DRILLED, TEST TO FOLLOW.		
Eagle "34I" #17	COMPLETING, TEST TO FOLLOW		
Eagle "34J" #19	TO BE DRILLED, TEST TO FOLLOW.		
Eagle "34K" #21	TO BE DRILLED, TEST TO FOLLOW.		
Eagle "34L" #23	TO BE DRILLED, TEST TO FOLLOW.		
Eagle "34M" #25	TO BE DRILLED, TEST TO FOLLOW.		
Eagle "34N" #27	TO BE DRILLED, TEST TO FOLLOW.		

Exhibit I is a schematic which shows the equipment that will be utilized to determine well production from each lease. A map (Exhibit II) is enclosed that shows the lease numbers and location of all leases and wells that will contribute production to the proposed commingled facility.

The storage and measuring facility will be located in UL K in the NE/SW of Section 34, T17S, R. 27E on lease No. LC-067849 in Eddy County, New Mexico. The BLM will be notified if there is any future change in the facility location.

Process and Flow Description: Under the proposed flow system, gas will be flowed out the casing from each well and will be tested at the well using an orifice well tester. Oil and water will be pumped out the tubing and will go through a flowline to a header at the battery. Wells will be tested by switching into the test treater which will separate the oil and water and allow the oil to be measured in a test tank and the water by means of a meter.

Production Allocation: Production allocation will be based on periodic well tests as described above. Allocation of total gas recorded by the Sales Gas Meter will be based on these tests.

The overriding royalty owners, and NMOCD have been notified of this proposal.

The proposed commingling of production is in the interest of conservation and will not result in reduced royalty or improper measurement of production.

The proposed commingling is necessary for hydrocarbon development and operation on the above referenced Federal leases.

We understand that the requested approval will not constitute the granting of any right-of-way or construction rights not granted by the lease instrument. We have submitted an application for the necessary right-of-way approvals to the BLM's Realty Section.

Signed:

E. L. Buttross, Jr.

Name: E. L. Buttross, Jr.

Title: District Engineer

Date: October 28, 1996

Devon Energy Corporation (Nevada)
20 N. Broadway, Suite 1500
Oklahoma City, OK 736102



Is your RETURN ADDRESS completed on the reverse?

SENDER:

- Complete items 1 and/or 2 for additional services.
- Complete items 3, 4a, and 4b.
- Print your name and address on the reverse of this form so that we can return this card to you.
- Attach this form to the front of the mailpiece, or on the back if space does not permit.
- Write "Return Receipt Requested" on the mailpiece below the article number.
- The Return Receipt will show to whom the article was delivered and the date delivered.

I also wish to receive the following services (for an extra fee):

1. ☐ Addressee's Address
2. ☐ Restricted Delivery

Consult postmaster for fee.

3. Article Addressed to:

Howard B. Wright Trust
Wells Fargo Bank, Trustee
Trust Natural Resources
Post Office Box 5825
Denver, CO 80217-5825

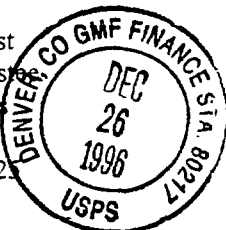
**4a. Article Number**

P502 240 010

4b. Service Type

- ☐ Registered ☒ Certified
☐ Express Mail ☐ Insured
☐ Return Receipt for Merchandise ☐ COD

7. Date of Delivery

12-26

5. Received By: (Print Name)**6. Signature: (Addressee or Agent)**

X

8. Addressee's Address (Only if requested and fee is paid)

PS Form 3811, December 1994

Domestic Return Receipt

Thank you for using Return Receipt Service.

Is your RETURN ADDRESS completed on the reverse side?

SENDER:

- Complete items 1 and/or 2 for additional services.
- Complete items 3, 4a, and 4b.
- Print your name and address on the reverse of this form so that we can return this card to you.
- Attach this form to the front of the mailpiece, or on the back if space does not permit.
- Write "Return Receipt Requested" on the mailpiece below the article number.
- The Return Receipt will show to whom the article was delivered and the date delivered.

I also wish to receive the following services (for an extra fee):

1. ☐ Addressee's Address
2. ☐ Restricted Delivery

Consult postmaster for fee.

3. Article Addressed to:

Summitt Energy, Inc.
Irongate 3, Suite 201
777 S. Wadsworth Blvd.
Lakewood, CO 80226

4a. Article Number

P502 240 011

4b. Service Type

- ☐ Registered ☒ Certified
☐ Express Mail ☐ Insured
☐ Return Receipt for Merchandise ☐ COD

7. Date of Delivery

12/30

5. Received By: (Print Name)**6. Signature: (Addressee or Agent)**

X [Signature]

8. Addressee's Address (Only if requested and fee is paid)

PS Form 3811, December 1994

Domestic Return Receipt

Thank you for using Return Receipt Service.

Is your RETURN ADDRESS completed on the reverse side?

SENDER:

- Complete items 1 and/or 2 for additional services.
- Complete items 3, 4a, and 4b.
- Print your name and address on the reverse of this form so that we can return this card to you.
- Attach this form to the front of the mailpiece, or on the back if space does not permit.
- Write "Return Receipt Requested" on the mailpiece below the article number.
- The Return Receipt will show to whom the article was delivered and the date delivered.

I also wish to receive the following services (for an extra fee):

1. ☐ Addressee's Address
2. ☐ Restricted Delivery

Consult postmaster for fee.

3. Article Addressed to:

Joan A. Hudson
8053 San Vista Circle
Naples, FL 33942

4a. Article Number

P502 240 013

4b. Service Type

- ☐ Registered ☒ Certified
☐ Express Mail ☐ Insured
☐ Return Receipt for Merchandise ☐ COD

7. Date of Delivery

12-30-96

5. Received By: (Print Name)**6. Signature: (Addressee or Agent)**

X [Signature]

8. Addressee's Address (Only if requested and fee is paid)

PS Form 3811, December 1994

Domestic Return Receipt

Thank you for using Return Receipt Service.

Is your RETURN ADDRESS completed on the reverse side?

SENDER:

- Complete items 1 and/or 2 for additional services.
- Complete items 3, 4a, and 4b.
- Print your name and address on the reverse of this form so that we can return this card to you.
- Attach this form to the front of the mailpiece, or on the back if space does not permit.
- Write "Return Receipt Requested" on the mailpiece below the article number.
- The Return Receipt will show to whom the article was delivered and the date delivered.

I also wish to receive the following services (for an extra fee):

- ☐ Addressee's Address
- ☐ Restricted Delivery

Consult postmaster for fee.

3. Article Addressed to:

Lulu E. Harbold Estate
Ruth Turbfill, Individually
and as Executrix
Post Office Box 504
Mesa Park, NM 88047-0504

4a. Article Number

7502 240 009

4b. Service Type

- ☐ Registered ☒ Certified
☐ Express Mail ☐ Insured
☐ Return Receipt for Merchandise ☐ COD

7. Date of Delivery

12-27-96

5. Received By: (Print Name)

6. Signature: (Addressee or Agent)

X *[Signature]*

8. Addressee's Address (Only if requested and fee is paid)

PS Form 3811, December 1994

Domestic Return Receipt

Thank you for using Return Receipt Service.

Is your RETURN ADDRESS completed on the reverse side?

SENDER:

- Complete items 1 and/or 2 for additional services.
- Complete items 3, 4a, and 4b.
- Print your name and address on the reverse of this form so that we can return this card to you.
- Attach this form to the front of the mailpiece, or on the back if space does not permit.
- Write "Return Receipt Requested" on the mailpiece below the article number.
- The Return Receipt will show to whom the article was delivered and the date delivered.

I also wish to receive the following services (for an extra fee):

- ☐ Addressee's Address
- ☐ Restricted Delivery

Consult postmaster for fee.

3. Article Addressed to:

Minerals Management Service
Royalty Program
Post Office Box 5810, T.A.
Denver, CO 80217

4a. Article Number

7502 240 015

4b. Service Type

- ☐ Registered ☒ Certified
☐ Express Mail ☐ Insured
☐ Return Receipt for Merchandise ☐ COD

7. Date of Delivery

12/24

5. Received By: (Print Name)

Minerals Management Service

6. Signature: (Addressee or Agent)

X *[Signature]*

8. Addressee's Address (Only if requested and fee is paid)

PS Form 3811, December 1994

Domestic Return Receipt

Thank you for using Return Receipt Service.

Is your RETURN ADDRESS completed on the reverse side?

SENDER:

- Complete items 1 and/or 2 for additional services.
- Complete items 3, 4a, and 4b.
- Print your name and address on the reverse of this form so that we can return this card to you.
- Attach this form to the front of the mailpiece, or on the back if space does not permit.
- Write "Return Receipt Requested" on the mailpiece below the article number.
- The Return Receipt will show to whom the article was delivered and the date delivered.

I also wish to receive the following services (for an extra fee):

- ☐ Addressee's Address
- ☐ Restricted Delivery

Consult postmaster for fee.

3. Article Addressed to:

GPM Gas Services Corp.
4044 Penbrook
Odessa, TX 79762

4a. Article Number

7502 240 007

4b. Service Type

- ☐ Registered ☒ Certified
☐ Express Mail ☐ Insured
☐ Return Receipt for Merchandise ☐ COD

7. Date of Delivery

12-26-96

5. Received By: (Print Name)

6. Signature: (Addressee or Agent)

X *[Signature]*

8. Addressee's Address (Only if requested and fee is paid)

PS Form 3811, December 1994

Domestic Return Receipt

Thank you for using Return Receipt Service.

Is your RETURN ADDRESS completed on the reverse side?

SENDER:

- Complete items 1 and/or 2 for additional services.
- Complete items 3, 4a, and 4b.
- Print your name and address on the reverse of this form so that we can return this card to you.
- Attach this form to the front of the mailpiece, or on the back if space does not permit.
- Write "Return Receipt Requested" on the mailpiece below the article number.
- The Return Receipt will show to whom the article was delivered and the date delivered.

I also wish to receive the following services (for an extra fee):

- ☐ Addressee's Address
- ☐ Restricted Delivery

Consult postmaster for fee.

3. Article Addressed to:

Trigg Family Trust
John H. Trigg and
Pauline V. Trigg, Trustees
Post Office Box 520
Roswell, NM 88201

4a. Article Number

P502 240 012

4b. Service Type

- ☐ Registered ☒ Certified
☐ Express Mail ☐ Insured
☐ Return Receipt for Merchandise ☐ COD

7. Date of Delivery

12-24-96

5. Received By: (Print Name)

WAGGONER

6. Signature: (Addressee or Agent)

X

8. Addressee's Address (Only if requested and fee is paid)

PS Form 3811, December 1994

Domestic Return Receipt

Thank you for using Return Receipt Service.

Is your RETURN ADDRESS completed on the reverse side?

SENDER:

- Complete items 1 and/or 2 for additional services.
- Complete items 3, 4a, and 4b.
- Print your name and address on the reverse of this form so that we can return this card to you.
- Attach this form to the front of the mailpiece, or on the back if space does not permit.
- Write "Return Receipt Requested" on the mailpiece below the article number.
- The Return Receipt will show to whom the article was delivered and the date delivered.

I also wish to receive the following services (for an extra fee):

- ☐ Addressee's Address
- ☐ Restricted Delivery

Consult postmaster for fee.

3. Article Addressed to:

Minerals Management Service
Royalty Management Program
Building 85, Denver Federal Center
Room A-212, Revenue Document Proc.
Denver, CO 80225-0001

4a. Article Number

P502 240 003

4b. Service Type

- ☐ Registered ☒ Certified
☐ Express Mail ☐ Insured
☐ Return Receipt for Merchandise ☐ COD

7. Date of Delivery

DEC 30 1996

5. Received By: (Print Name)

6. Signature: (Addressee or Agent)

X

8. Addressee's Address (Only if requested and fee is paid)

PS Form 3811, December 1994

Domestic Return Receipt

Thank you for using Return Receipt Service.

Is your RETURN ADDRESS completed on the reverse side?

SENDER:

- Complete items 1 and/or 2 for additional services.
- Complete items 3, 4a, and 4b.
- Print your name and address on the reverse of this form so that we can return this card to you.
- Attach this form to the front of the mailpiece, or on the back if space does not permit.
- Write "Return Receipt Requested" on the mailpiece below the article number.
- The Return Receipt will show to whom the article was delivered and the date delivered.

I also wish to receive the following services (for an extra fee):

- ☐ Addressee's Address
- ☐ Restricted Delivery

Consult postmaster for fee.

3. Article Addressed to:

Eott Energy Operating Ltd. Partnership
Post Office Box 4666
Houston, TX 77210-4666

4a. Article Number

P502 240 006

4b. Service Type

- ☐ Registered ☒ Certified
☐ Express Mail ☐ Insured
☐ Return Receipt for Merchandise ☐ COD

7. Date of Delivery

12-24-96

5. Received By: (Print Name)

6. Signature: (Addressee or Agent)

X

8. Addressee's Address (Only if requested and fee is paid)

PS Form 3811, December 1994

Domestic Return Receipt

Thank you for using Return Receipt Service.

Is your RETURN ADDRESS completed on the reverse side?

SENDER:

- Complete items 1 and/or 2 for additional services.
- Complete items 3, 4a, and 4b.
- Print your name and address on the reverse of this form so that we can return this card to you.
- Attach this form to the front of the mailpiece, or on the back if space does not permit.
- Write "Return Receipt Requested" on the mailpiece below the article number.
- The Return Receipt will show to whom the article was delivered and the date delivered.

I also wish to receive the following services (for an extra fee):

- ☐ Addressee's Address
- ☐ Restricted Delivery

Consult postmaster for fee.

3. Article Addressed to:

Jane Ann Hudson Davis
Post Office Box 2660
Ruidoso, NM 88345-2660

4a. Article Number

P 502 240 014

4b. Service Type

- ☐ Registered ☒ Certified
☐ Express Mail ☐ Insured
☐ Return Receipt for Merchandise ☐ COD

7. Date of Delivery

12-24-96

5. Received By: (Print Name)

JANE ANN HUDSON DAVIS

6. Signature: (Addressee or Agent)

X

8. Addressee's Address (Only if requested and fee is paid)

PS Form 3811, December 1994

Domestic Return Receipt

Thank you for using Return Receipt Service.

Is your RETURN ADDRESS completed on the reverse side?

SENDER:

- Complete items 1 and/or 2 for additional services.
- Complete items 3, 4a, and 4b.
- Print your name and address on the reverse of this form so that we can return this card to you.
- Attach this form to the front of the mailpiece, or on the back if space does not permit.
- Write "Return Receipt Requested" on the mailpiece below the article number.
- The Return Receipt will show to whom the article was delivered and the date delivered.

I also wish to receive the following services (for an extra fee):

- ☐ Addressee's Address
- ☐ Restricted Delivery

Consult postmaster for fee.

3. Article Addressed to:

Bureau of Land Management
620 East Greene
Carlsbad, NM 88220

4a. Article Number

P 502 240 008

4b. Service Type

- ☐ Registered ☒ Certified
☐ Express Mail ☐ Insured
☐ Return Receipt for Merchandise ☐ COD

7. Date of Delivery

12-23

5. Received By: (Print Name)

6. Signature: (Addressee or Agent)

X J. Peniston

8. Addressee's Address (Only if requested and fee is paid)

PS Form 3811, December 1994

Domestic Return Receipt

Thank you for using Return Receipt Service.

Is your RETURN ADDRESS completed on the reverse side?

SENDER:

- Complete items 1 and/or 2 for additional services.
- Complete items 3, 4a, and 4b.
- Print your name and address on the reverse of this form so that we can return this card to you.
- Attach this form to the front of the mailpiece, or on the back if space does not permit.
- Write "Return Receipt Requested" on the mailpiece below the article number.
- The Return Receipt will show to whom the article was delivered and the date delivered.

I also wish to receive the following services (for an extra fee):

- ☐ Addressee's Address
- ☐ Restricted Delivery

Consult postmaster for fee.

3. Article Addressed to:

Amoco Production Company
Attn: Jerry West
501 Westlake Park Blvd.
Post Office Box 4891
Houston, TX 77210

4a. Article Number

P 502 240 005

4b. Service Type

- ☐ Registered ☒ Certified
☐ Express Mail ☐ Insured
☐ Return Receipt for Merchandise ☐ COD

7. Date of Delivery

DEC 23 1996

5. Received By: (Print Name)

6. Signature: (Addressee or Agent)

X Chuck Martin

8. Addressee's Address (Only if requested and fee is paid)

PS Form 3811, December 1994

Domestic Return Receipt

Thank you for using Return Receipt Service.

P 502 240 004

BC
Down

US Postal Service

Receipt for Certified Mail

No Insurance Coverage Provided.

Do not use for International Mail (See reverse)

Sent to	Susan G. Lasso
Street & Number	11 Ocean Ridge
Post Office, State, & ZIP Code	Laguna Niguel CA 92677
Postage	\$ 55
Certified Fee	110
Special Delivery Fee	
Restricted Delivery Fee	
Return Receipt Showing to Whom & Date Delivered	110
Return Receipt Showing to Whom, Date, & Addressee's Address	
TOTAL Postage & Fees	\$ 275
Postmark or Date	APR 1996

PS Form 3800, April 1995