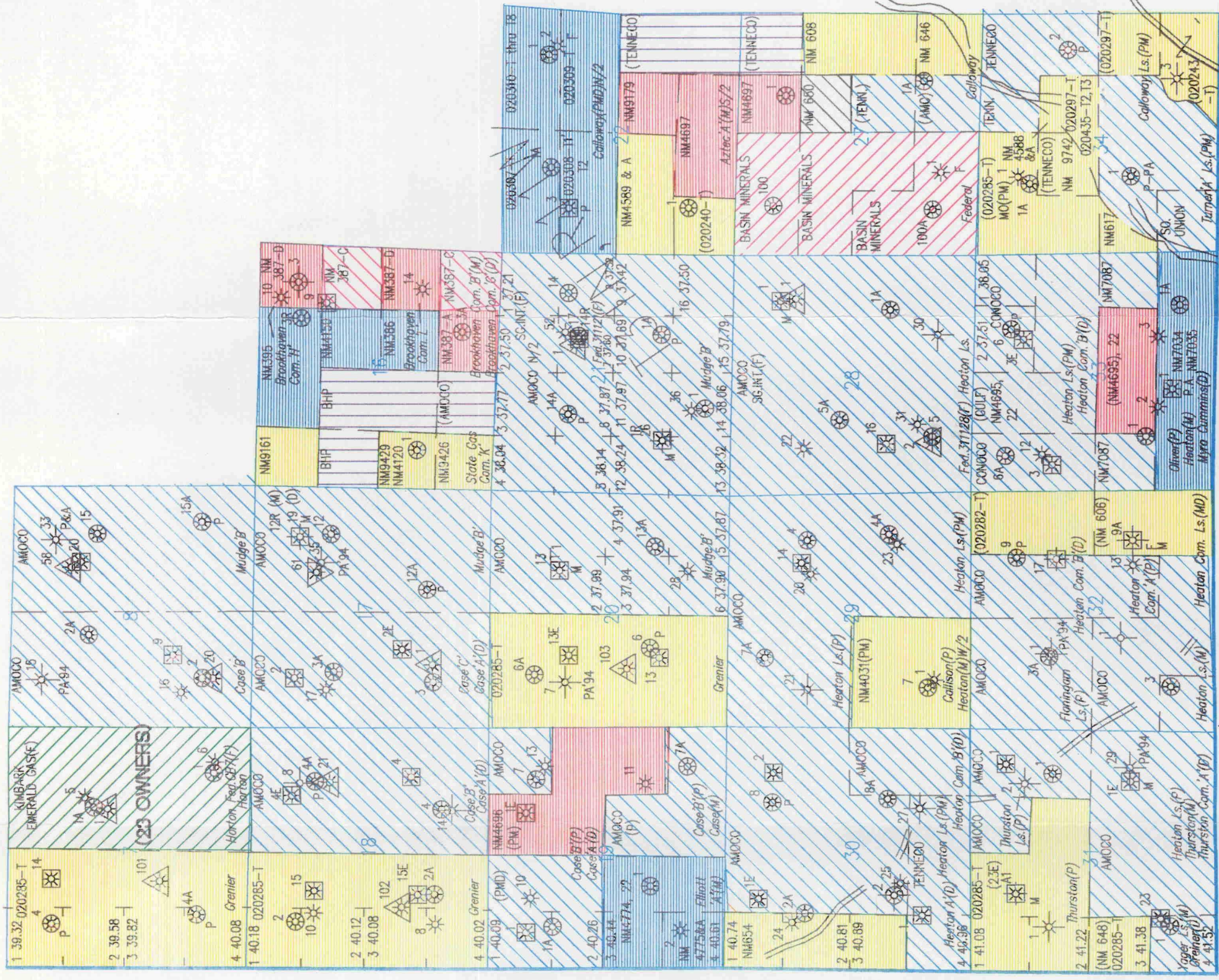
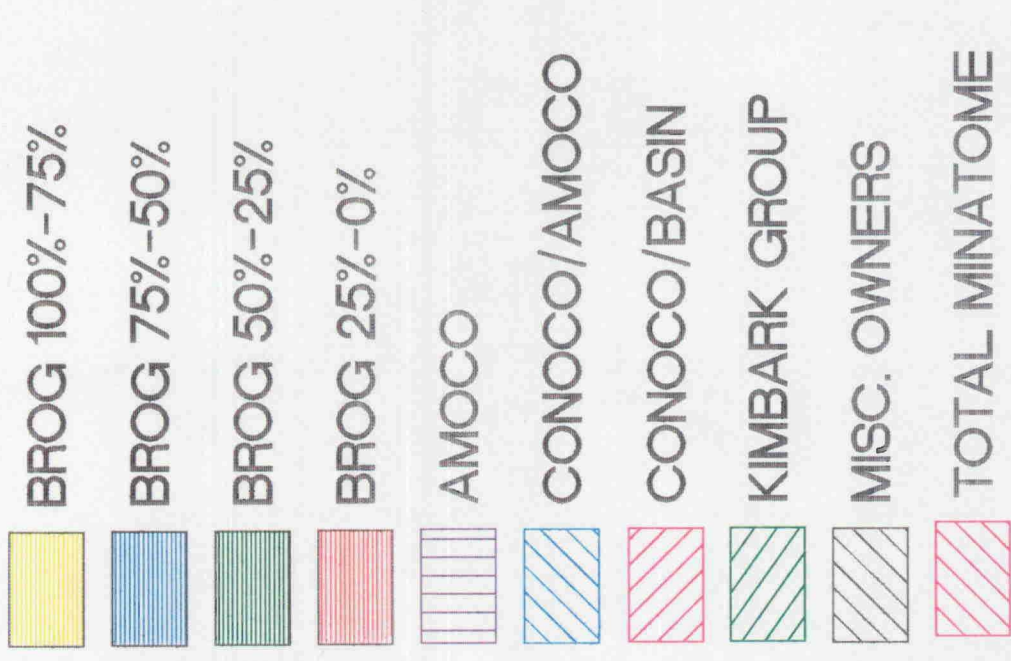

EXHIBIT 4



Burlington Resources
 31-11 AREA
 3/13/97

**31-11 AREA
MARCH 17, 1997**

**Township 31 North, Range 11 West, N.M.P.M.
Sections 7, 8, 16, 17, 18, 19, 20, 21, 22, 27, 28, 29
30, 31, 32, 33 and 34
San Juan County, New Mexico**

<u>WORKING INTERET OWNER</u>	<u>GROSS ACRES</u>	<u>NET ACRES</u>	<u>% PROSPECT</u>
Burlington Resources	3,646.97	2,900.61	26.75%
Conoco	6,434.88	3,214.44	29.68%
Amoco	6,735.93	3,714.71	34.26%
Basin Minerals	320.00	160.00	1.48%
Total Minatome	120.00	90.00	0.83%
Kimbark Group (23 Owners)	320.00	320.00	2.95%
Hugh Mitchell, et al	40.00	40.00	0.37%
Dacresa Group (10 Owners)	160.00	80.00	0.74%
Wayne Moore	280.00	35.00	0.32%
IBEX Partnership, et al	320.00	100.00	0.92%
W P Carr Group (8 Owners)	240.00	102.00	0.94%
Glenn Turner Group (12 Owners)	160.00	70.00	0.65%
Cross Timbers	161.05	12.08	0.11%
TOTALS		10,841.84	100.00%

31-11 AREA OWNERSHIP SUMMARY

Township 31 North, Range 11 West, N.M.P.M.
Section 16: All
Containing 640.00 Acres
San Juan County, New Mexico
Below base of the Dakota Formation

<u>WORKING INTEREST OWNER</u>	<u>GROSS ACRES</u>	<u>NET ACRES</u>	<u>PERCENT OF SECTION</u>	<u>SECTION NRI</u>
Burlington Resources	400.00	222.50	34.7656%	.295507
Amoco	360.00	229.50	35.8594%	.290461
Total Minatome	120.00	90.00	14.0625%	.119531
Dacresa Group (10 Owners)	160.00	80.00	12.5000%	.106250
Cross Timbers	40.00	3.00	0.4688%	.005388
Wayne Moore	120.00	<u>15.00</u>	<u>2.3437%</u>	<u>.020507</u>
		640.00	100.00%	.837644