

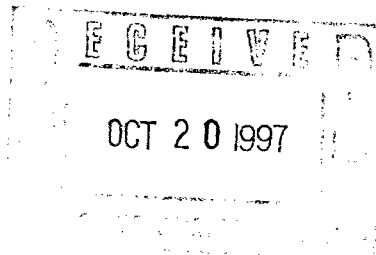

ARCO Permian
600 North Marienfeld
Midland TX 79701-4373
PO Box 1610
Midland TX 79702-1610
Telephone 915 688 5200

NSL 11/10/97



October 16, 1997

11890

NMOCD
2040 S. Pacheco
Santa Fe, New Mexico 87505

Attn: Michael Stogner

Dear Mr. Stogner:

ARCO Permian requests administrative approval for a non-standard surface location and directional drilling for the cited 10,900' Morrow borehole, to drill a previously-approved bottomhole location for the Evelyn "35" State Com #1. Our desired BHL with 100' radius tolerance was previously approved by Order R-10781 dated March 18, 1997 for said Evelyn "35" State Com #1.

ARCO Permian desires to drill a new borehole, since we have abandoned efforts to sidetrack Evelyn "35" State Com #1 (API 30-015-29133). The sidetrack attempt was drilled to 10667' MD (approx 10441' TVD) in June. Heaving shale forced us to abandon drilling before we cut the Morrow objective. A CIBP was set at 9600' with 35' cement on June 30, 1997. A sundry notice was filed containing the above information on July 8, 1997 indicating that it was temporarily abandoned.

ARCO Permian now seeks administrative approval to drill a new directional borehole, Evelyn "35" State Com #2 from an unorthodox surface location 1459'FNL and 349'FEL of Section 35, with the approved BHL (within 100' of a point 1253 FNL and 508'FEL, as cited in R-10781) as a Penetration Point in the Morrow Sand objective at 10500' TVD. The Project area will be the North Half of Section 35, as previously approved. Since notification to offset owners was done for Order R-10781, and the BHL permit will not expire until 5/9/98, additional notification to offset operators is not required.

I have enclosed a copy of the original APD and plat for your perusal. The originals have been sent to Artesia for their consideration after all requirements for your office have been met.

Elizabeth Casbeer and I spoke with you at the NMOCD Seminar held in Midland this week and you indicated that we would have to file all documents, but that you could possibly use the previous Order and apply it to this well, also. Should you have any questions, please call me at 915-688-5532 or Bill Heard at 915-688-5957. Thank you for your assistance with this matter.

Sincerely,

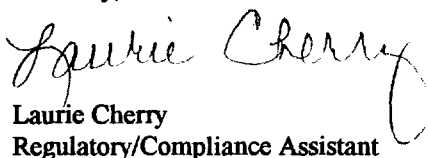
Laurie Cherry
Regulatory/Compliance Assistant

:lc

Attachments

District I
PO Box 1980, Hobbs, NM 88241-1980
District II
811 S. 1st Street, Artesia, NM 88210-2834
District III
1000 Rio Brazos Rd., Aztec, NM 87410
District IV
2040 South Pacheco, Santa Fe, NM 87505

State of New Mexico
Energy, Minerals & Natural Resources Department

OIL CONSERVATION DIVISION
2040 South Pacheco
Santa Fe, NM 87505

Form C-101
Revised October 18, 1994
Instructions on back
Submit to Appropriate District Office
State Lease - 6 Copies
Fee Lease - 5 Copies

☐ AMENDED REPORT

APPLICATION FOR PERMIT TO DRILL, RE-ENTER, DEEPEN, PLUGBACK, OR ADD A ZONE

¹ Operator name and Address ARCO PERMIAN P.O. BOX 1610 MIDLAND, TX 79702		² OGRID Number 000990
		³ API Number 30-0
⁴ Property Code 20644	⁵ Property Name EVELYN 35 STATE COM	⁶ Well No. 2

⁷ Surface Location									
UL or lot no.	Section	Township	Range	Lot. Idn	Feet from the	North/South Line	Feet from the	East/West line	County
H	35	17S	28E		1439	NORTH	349	EAST	EDDY

⁸ Proposed Bottom Hole Location If Different From Surface									
UL or lot no.	Section	Township	Range	Lot. Idn	Feet from the	North/South Line	Feet from the	East/West line	County
A	35	17S	28E		1254	NORTH	508	EAST	EDDY
⁹ Proposed Pool 1					¹⁰ Proposed Pool 2				
EMPIRE. SOUTH (MORROW) 76400									

¹¹ Work Type Code N	¹² Well Type Code G	¹³ Cable/Rotary R	¹⁴ Lease Type Code S	¹⁵ Ground Level Elevation 3672
¹⁶ Multiple NO	¹⁷ Proposed Depth 10,500	¹⁸ Formation MORROW	¹⁹ Contractor NA	²⁰ Spud Date 11/20/97

²¹ Proposed Casing and Cement Program					
Hole Size	Casing Size	Casing weight/foot	Setting Depth	Sacks of Cement	Estimated TOC
17 1/2	13 3/8	48	500	520	SURF
12 1/4	9 5/8	36	2600	900	SURF
8 3/4	5 1/2	17	10,900	1200	5000'

²² Describe the proposed program. If this application is to DEEPEN or PLUG BACK give the data on the present productive zone and proposed new productive zone. Describe the blowout prevention program, if any. Use additional sheets if necessary

NOTE: THE BHL FOR THIS WELLBORE WAS PREVIOUSLY APPROVED, BY ORDER R-10781 FOR THE EVELYN "35" STATE COM #1 WHICH WAS ABANDONED BEFORE CUTTING THE MORROW OBJECTIVE. SAID BHL PERMIT WILL NOT EXPIRE UNTIL 5/9/98.

²³ I hereby certify that the information given above is true and complete to the best of my knowledge and belief. Signature: Elizabeth A. Casbeer	OIL CONSERVATION DIVISION	
Printed name: ELIZABETH A CASBEER	Approved by:	
Title: AGENT	Title:	
	Approval Date:	Expiration Date:

Form C-102
Revised February 10, 1994
Submit to Appropriate District Office
State Lease - 4 Copies
Fee Lease - 3 Copies

☐ AMENDED REPORT

<h1 style="margin: 0;">PROJECT AREA</h1>	<h1 style="margin: 0;">320 AC.</h1>	
<div style="display: flex; justify-content: space-between;"> <div style="width: 60%;"> <h2 style="margin: 0;">PRODUCING AREA</h2> </div> <div style="width: 35%;"> <p>SPC NAD 27 NME BH N=653210 E=559515</p> <p>SURFACE N=653033 E=559674</p> </div> </div>		

<h3>OPERATOR CERTIFICATION</h3>	
<p><i>I hereby certify the the information contained herein is true and complete to the best of my knowledge and belief.</i></p>	
<p><u>Elizabeth Casbeer</u></p>	<p>Signature</p>
<p><u>ELIZABETH CASBEER</u></p>	<p>Printed Name</p>
<p><u>REG/COMP ANALYST</u></p>	<p>Title</p>
<p><u>10-17-97</u></p>	<p>Date</p>

<h3>SURVEYOR CERTIFICATION</h3>	
<p><i>I hereby certify that the well location shown on this plat was plotted from field notes of actual surveys made by me or under my supervision, and that the same is true and correct to the best of my belief.</i></p>	
<p style="text-align: center;">OCTOBER 8, 1997</p>	
<p>Date Surveyed</p>	<p>JLP</p>
<p>Signature & Seal of Professional Surveyor</p>	
<p style="text-align: center;"> </p>	
<p style="text-align: right;">10-09-97</p>	
<p style="text-align: right;">W.G. Num. 97-12-1624</p>	
<p>Certificate No. <u>RONALD J. EIDSON, 3239</u></p>	
<p style="text-align: right;">12641</p>	

VICINITY MAP

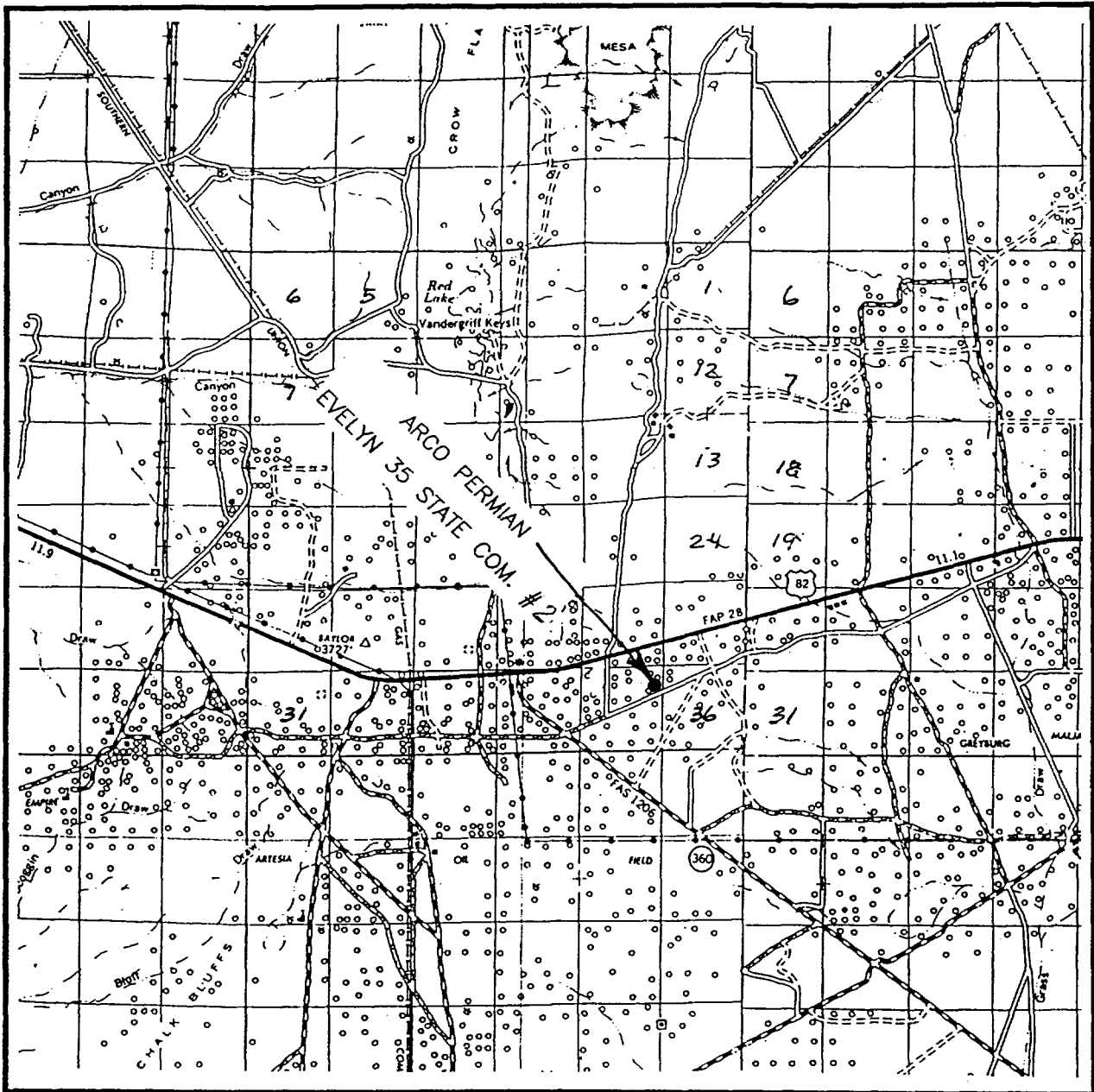

SCALE: 1" = 2 MILES

SEC. 35 TWP. 17-S RGE. 28-E
 SURVEY N.M.P.M.
 COUNTY EDDY
 DESCRIPTION 1439' FNL & 349' FEL
 ELEVATION 3672'
 OPERATOR ARCO PERMIAN
 LEASE EVELYN 35 STATE COM.

JOHN WEST ENGINEERING
HOBBS, NEW MEXICO
(505) 393-3117

LOCATION VERIFICATION MAP

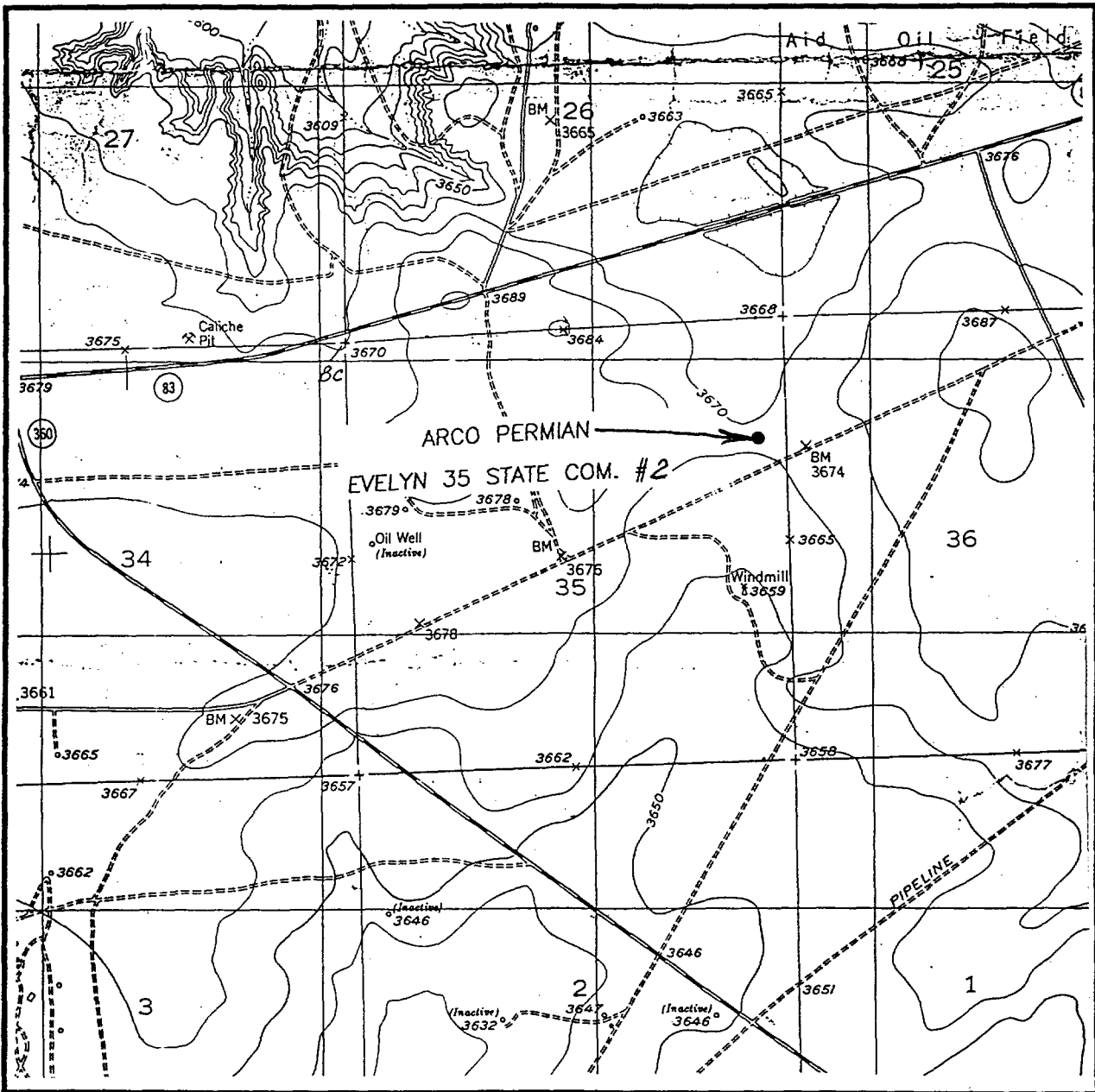

SCALE: 1" = 2000'

CONTOUR INTERVAL - 10'

SEC. 35 TWP. 17-S RGE. 28-E

SURVEY N.M.P.M.

COUNTY EDDY

DESCRIPTION 1439' FNL & 349' FEL

ELEVATION 3672'

OPERATOR ARCO PERMIAN

LEASE EVELYN 35 STATE COM.

U.S.G.S. TOPOGRAPHIC MAP

RED LAKE, N.M.

JOHN WEST ENGINEERING
HOBBS, NEW MEXICO
(505) 393-3117

DRILLING OPERATIONS

CLASS - 1: NORMAL PRESSURE < 10 PPG

OPTION - 1: ARCO STANDARD BOPE STACK

