

CENTRAL TOTAH UNIT # 16
B-34-29N-13W
30-045-07738

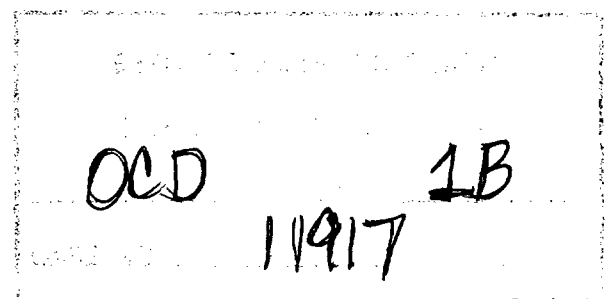

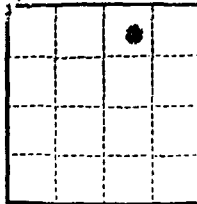

(SUBMIT IN TRIPLICATE)

UNITED STATES
DEPARTMENT OF THE INTERIOR
GEOLOGICAL SURVEY

Land Office Santa Fe
Lease No. SP-477065
Unit Regist

SUNDRY NOTICES AND REPORTS ON WELLS

NOTICE OF INTENTION TO DRILL.....	<input checked="" type="checkbox"/>	SUBSEQUENT REPORT OF WATER SHUT-OFF.....
NOTICE OF INTENTION TO CHANGE PLANS.....		SUBSEQUENT REPORT OF SHOOTING OR ACIDIZING.....
NOTICE OF INTENTION TO TEST WATER SHUT-OFF.....		SUBSEQUENT REPORT OF ALTERING CASING.....
NOTICE OF INTENTION TO RE-DRILL OR REPAIR WELL.....		SUBSEQUENT REPORT OF RE-DRILLING OR REPAIR.....
NOTICE OF INTENTION TO SHOOT OR ACIDIZE.....		SUBSEQUENT REPORT OF ABANDONMENT.....
NOTICE OF INTENTION TO PULL OR ALTER CASING.....		SUPPLEMENTARY WELL HISTORY.....
NOTICE OF INTENTION TO ABANDON WELL.....		

(INDICATE ABOVE BY CHECK MARK NATURE OF REPORT, NOTICE, OR OTHER DATA)

November 11, 1960

Well No. 11-6 is located 1000 ft. from N line and 1000 ft. from E line of sec. 34

NE 1/4, Section 34 29N 13W N.M.P.M.
(1/4 Sec. and Sec. No.) (Twp.) (Range) (Meridian)
Gallop San Juan New Mexico
(Field) (County or Subdivision) (State or Territory)

The elevation of the derrick floor above sea level is 5746 ft. (Ground Elevation)

DETAILS OF WORK

(State names of and expected depths to objective sands; show sizes, weights, and lengths of proposed casings; indicate mud logs, cementing points, and all other important proposed work)

Propose To:

Set 300 feet of 8 5/8" surface casing and cement to surface. NOV 15 1960

Drill with rotary to approximate total depth of 5650 feet or through Gallup formation. Set 3 1/2" production casing at total depth and cement with 250 sz. Set two-stage cement collar approximately 100 feet below the Pictured Cliffs formation. Cement the second stage with 150 sz.

Perforate Gallup formation with four shots per foot. Sand-oil frac with approximately 50,000# sand and 50,000 gals. oil. Run 2 3/8" tubing.

NE 1/4 Section 34, 40 acres, dedicated to well.

I understand that this plan of work must receive approval in writing by the Geological Survey before operations may be commenced.

Company Astec Oil and Gas Company
Address P. O. Drawer 579
Farmington, New Mexico

By Joe C. Salmon
Title District Superintendent

ILLEGIBLE

NEW MEXICO OIL CONSERVATION COMMISSION

Well Location and Acreage Dedication Plat

SECTION A.

Date November 2, 1960

Operator Astec Oil and Gas Company Lease Bagood
 Well No. 11-G Unit Letter B Section 34 Township 29N Range 13W NMPM
 Located 1020 Feet From North Line, 1890 Feet From East Line
 County San Juan G. L. Elevation 5746 Dedicated Acreage 40 Acres
 Name of Producing Formation Gallup Pool Total

1. Is the Operator the only owner* in the dedicated acreage outlined on the plat below? Yes XXX No _____
2. If the answer to question One is "No," have the interests of all the owners been consolidated by communitization agreement or otherwise? Yes _____ No _____. If answer is "Yes," Type of Consolidation _____
3. If the answer to question Two is "No," list all the owners and their respective interests below:

OWNER

LAND DESCRIPTION

SECTION B.

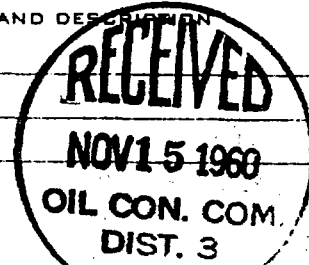
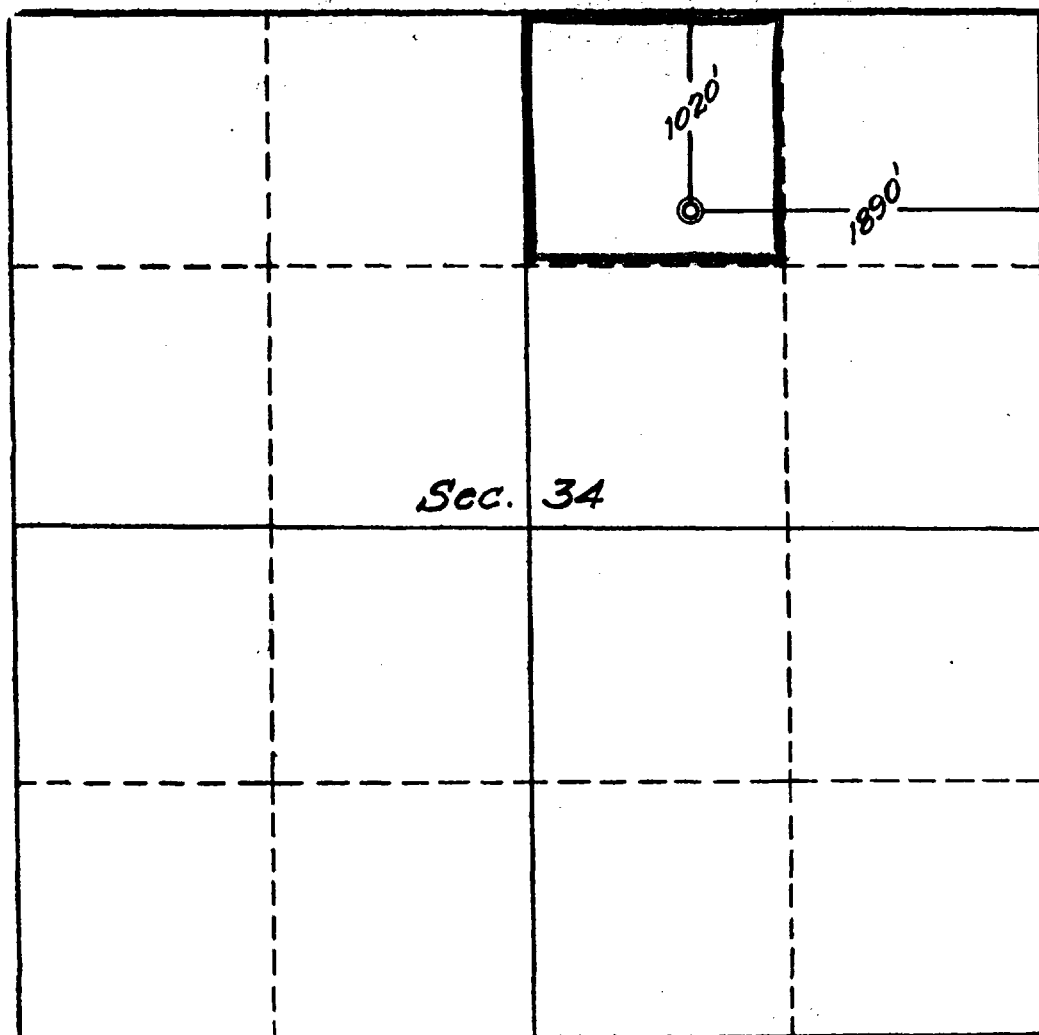

This is to certify that the information in Section A above is true and complete to the best of my knowledge and belief.

Astec Oil and Gas Company
 (OPERATOR)

(REPRESENTATIVE)

Drawer 570, Farmington, N.M.
 (ADDRESS)

This is to certify that the well location shown on the plat in Section B was plotted from field notes of actual surveys made by me or under my supervision and that the same is true and correct to the best of my knowledge and belief.

Date Surveyed 10-29-60

Four States Engineering Co.
 FARMINGTON, NEW MEXICO

E. J. Echibank
 REGISTERED ENGINEER OR
 LAND SURVEYOR

Certificate No. 1545

(SUBMIT IN TRIPLICATE)

UNITED STATES
DEPARTMENT OF THE INTERIOR
GEOLOGICAL SURVEY

Land Office Santa Fe
Lease No. 87 - 979065
Unit Regood

		0	

SUNDRY NOTICES AND REPORTS ON WELLS

NOTICE OF INTENTION TO DRILL	SUBSEQUENT REPORT OF WATER SHUT-OFF	BOX
NOTICE OF INTENTION TO CHANGE PLANS	SUBSEQUENT REPORT OF SHOOTING OR ACIDIZING	
NOTICE OF INTENTION TO TEST WATER SHUT-OFF	SUBSEQUENT REPORT OF ALTERING CASING	
NOTICE OF INTENTION TO RE-DRILL OR REPAIR WELL	SUBSEQUENT REPORT OF RE-DRILLING OR REPAIR	
NOTICE OF INTENTION TO SHOOT OR ACIDIZE	SUBSEQUENT REPORT OF ABANDONMENT	
NOTICE OF INTENTION TO PULL OR ALTER CASING	SUPPLEMENTARY WELL HISTORY	
NOTICE OF INTENTION TO ABANDON WELL		

(INDICATE ABOVE BY CHECK MARK NATURE OF REPORT, NOTICE, OR OTHER DATA)

November 22, 19 60

Regood
Well No. 11-6 is located 1020 ft. from [N] line and 1890 ft. from [E] line of sec. 34

11-6 Section 34 T-29N R-13W N.M.P.M.
(1/4 Sec. and Sec. No.) (Twp.) (Range) (Meridian)

Total Gallup San Juan New Mexico
(Field) (County or Subdivision) (State or Territory)

The elevation of the derrick floor above sea level is 5746 ft. G.L.

DETAILS OF WORK

(State names of and expected depths to objective sands; show sizes, weights, and lengths of proposed casings; indicate mudding jobs, cementing points, and all other important proposed work)

Well was spudded 11/15/60
Set 10 jts., 307' of 8 5/8" casing, landed at 318' with 225 sacks cement
Tested casing with 500# pressure for 30 minutes. No leaks.
Drilled cement plug 11/16/60
Tested with 500# pressure for 30 minutes.
No drop in pressure.

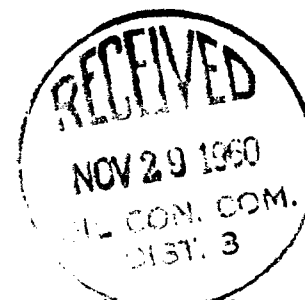

I understand that this plan of work must receive approval in writing by the Geological Survey before operations may be commenced.

Company Astec Oil and Gas Company

Address Drawer # 570

Farmington, New Mexico

By Joe C. PALMON

Title District Superintendent

ILLEGIBLE

OIL CONSERVATION COMMISSION

P. O. BOX 871

SANTA FE, NEW MEXICO

November 30, 1960

Aztec Oil & Gas Company
920 Mercantile Securities Building
Dallas 1, Texas

Attention: Mr. Kenneth A. Swanson

Administrative Order NSL-237

Gentlemen:

Reference is made to your application for approval of an unorthodox well location for your Hagood Well No. 11-G to be located 1020 feet from the North line and 1890 feet from the East line of Section 34, Township 29 North, Range 13 West, Totah-Gallup Oil Pool, San Juan County, New Mexico.

It is our understanding that this unorthodox well location is based upon extreme topographic conditions.

By authority granted me under provisions of Rule 104 (f) of the Commission Rules and Regulations, you are hereby granted approval for the above described unorthodox well location. You must also obtain like approval from the U. S. Geological Survey if the well is located on land subject to the jurisdiction of the U. S. Geological Survey.

Very truly yours,

A. L. PORTER, Jr.
Secretary-Director

ALP/OEP/og

cc: Oil Conservation Commission - Aztec
U. S. Geological Survey - Farmington

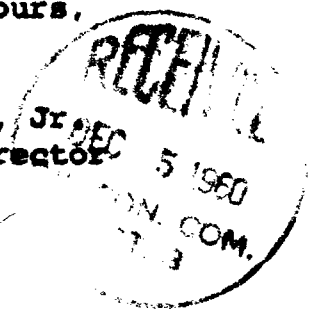

		0	

(SUBMIT IN TRIPLICATE)

UNITED STATES
DEPARTMENT OF THE INTERIOR
GEOLOGICAL SURVEY

Land Office Santa Fe
Lease No. SP 079065
Unit Magood

SUNDRY NOTICES AND REPORTS ON WELLS

NOTICE OF INTENTION TO DRILL.....	SUBSEQUENT REPORT OF WATER SHUT-OFF.....	<input checked="" type="checkbox"/>
NOTICE OF INTENTION TO CHANGE PLANS.....	SUBSEQUENT REPORT OF SHOOTING OR ACIDIZING.....	<input checked="" type="checkbox"/>
NOTICE OF INTENTION TO TEST WATER SHUT-OFF.....	SUBSEQUENT REPORT OF ALTERING CASING.....	<input checked="" type="checkbox"/>
NOTICE OF INTENTION TO RE-DRILL OR REPAIR WELL.....	SUBSEQUENT REPORT OF RE-DRILLING OR REPAIR.....	<input checked="" type="checkbox"/>
NOTICE OF INTENTION TO SHOOT OR ACIDIZE.....	SUBSEQUENT REPORT OF ABANDONMENT.....	<input checked="" type="checkbox"/>
NOTICE OF INTENTION TO PULL OR ALTER CASING.....	SUPPLEMENTARY WELL HISTORY.....	<input checked="" type="checkbox"/>
NOTICE OF INTENTION TO ABANDON WELL.....		

(INDICATE ABOVE BY CHECK MARK NATURE OF REPORT, NOTICE, OR OTHER DATA)

December 9, 1960

Magood

Well No. 11-0 is located 1000 ft. from N line and 1000 ft. from E line of sec. 34

NE 1/4 Section 34

(1/4 Sec. and Sec. No.)

T-29N

(Twp.)

R-15W

(Range)

N.M.P.M.

(Meridian)

Utah Gallup

(Field)

San Juan

(County or Subdivision)

New Mexico

(State or Territory)

The elevation of the derrick floor above sea level is 5746 ft. G.L.

DETAILS OF WORK

(State names of and expected depths to objective sands; show sizes, weights, and lengths of proposed casings; indicate mudding jobs, cementing points, and all other important proposed work)

Total depth - 5698' P.B.T.D. - 5657'

San logs: top of Pictured Cliffs - 1560, Cliff House - 3108, Point Lookout - 4010
Gallup - 5204

Perforated from 5576-5596, with 4 shots per foot

Set 173 jts., 5646' of 4 1/2" casing, landed at 5657

Float collar - 5623', D. V. tool at 1762

Cemented 1st stage with 250 sacks cement, 2nd stage with 150 sacks cement.

Moved in cable tools and drilled cement 12/1/60

Tested for 2 hours with 500 pressure

Pipe Clay.

I understand that this plan of work must receive approval in writing by the Geological Survey before operations may be commenced.

Company Aster Oil and Gas Company

Address Drawer # 570,

Farmington, New Mexico

ORIGINAL SIGNED BY JOE C. SALMON
By

Joe C. Salmon

Tit District Superintendent

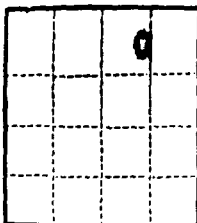

(SUBMIT IN TRIPLICATE)

UNITED STATES
DEPARTMENT OF THE INTERIOR
GEOLOGICAL SURVEY

Land Office Santa Fe
Lease No. 87 079063
Unit Magdol

SUNDRY NOTICES AND REPORTS ON WELLS

NOTICE OF INTENTION TO DRILL.....	SUBSEQUENT REPORT OF WATER SHUT-OFF.....	
NOTICE OF INTENTION TO CHANGE PLANS.....	SUBSEQUENT REPORT OF SHOOTING OR ACIDIZING.....	<input checked="" type="checkbox"/>
NOTICE OF INTENTION TO TEST WATER SHUT-OFF.....	SUBSEQUENT REPORT OF ALTERING CASING.....	
NOTICE OF INTENTION TO RE-DRILL OR REPAIR WELL.....	SUBSEQUENT REPORT OF RE-DRILLING OR REPAIR.....	
NOTICE OF INTENTION TO SHOOT OR ACIDIZE.....	SUBSEQUENT REPORT OF ABANDONMENT.....	
NOTICE OF INTENTION TO PULL OR ALTER CASING.....	SUPPLEMENTARY WELL HISTORY.....	
NOTICE OF INTENTION TO ABANDON WELL.....		

(INDICATE ABOVE BY CHECK MARK NATURE OF REPORT, NOTICE, OR OTHER DATA)

December 9, 1960

Well No. 11-0 is located 1020 ft. from (N) line and 1890 ft. from (E) line of sec. 34
NE 1/4 Section 34 T-49N R-13W S.M.P.M.
(1/4 Sec. and Sec. No.) (Twp.) (Range) (Meridian)
Total Gallup San Juan New Mexico
(Field) (County or Subdivision) (State or Territory)

The elevation of the derrick floor above sea level is 5746 ft. S.L.

DETAILS OF WORK

(State names of and expected depths to objective sands; show sizes, weights, and lengths of proposed casings; indicate mudding jobs, cementing points, and all other important proposed work)

P.B.T.D. - 3657'
Sand-Oil Fraced with 20,000# 20/40sand, 4,000# 10/20 and 627 lbs. oil
Flushed with 151 lbs. oil
Breakdown pr. - 1400#
Max. pressure - 3000#
Avg. treating pr. - 2800
I.R. 28 bps
5-min. shut-in pr. - 1850
Ran 177 jts., 5573' of 2 3/8" tubing, landed at 5582'
Perforated nipple 5572.60 to 5575.60
Pump seating nipple - 5571.60
Flowing through tubing.

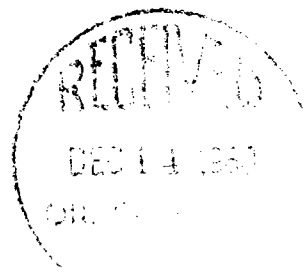

I understand that this plan of work must receive approval in writing by the Geological Survey before operations may be commenced.

Company Astec Oil and Gas Company
Address Drewer # 570
Farmington, New Mexico

By ORIGINAL SIGNED BY JOE C. SALMON
JOE C. SALMON
Title District Superintendent

NEW MEXICO OIL CONSERVATION COMMISSION
SANTA FE, NEW MEXICO

Form C-110
Revised 7/1/55

(File the original and 4 copies with the appropriate district office)

CERTIFICATE OF COMPLIANCE AND AUTHORIZATION
TO TRANSPORT OIL AND NATURAL GAS

Company or Operator Astec Oil and Gas Company Lease Magood

Well No. 11-0 Unit Letter B S 34 T 29N R 13W Pool Totah Gallup

County San Juan Kind of Lease (State, Fed. or Patented) Fed.

If well produces oil or condensate, give location of tanks: Unit S T R

Authorized Transporter of Oil or Condensate El Paso Natural Gas Products Company

Address Box # 1161, El Paso, Texas. (via Luna-Haves Trucking Company)
(Give address to which approved copy of this form is to be sent)

Authorized Transporter of Gas _____

Address _____ Date Connected _____
(Give address to which approved copy of this form is to be sent)

If Gas is not being sold, give reasons and also explain its present disposition:

Reasons for Filing: (Please check proper box) New Well (X)

Change in Transporter of (Check One): Oil () Dry Gas () C'head () Condensate ()

Change in Ownership () Other ()

Remarks: _____ (Give explanation below)

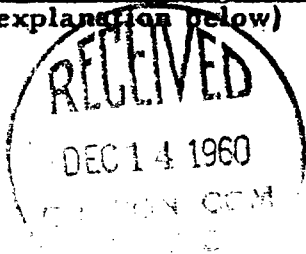

The undersigned certifies that the Rules and Regulations of the Oil Conservation Commission have been complied with.

Executed this the 13th day of December 1960

By ORIGINAL SIGNED BY JOE C. SALMON
Joe C. Salmon

Approved DEC 14 1960 1960

Title District Superintendent

OIL CONSERVATION COMMISSION

Company Astec Oil and Gas Company

By Original Signed Emery C. Arnold

Address Drawer # 570, Farmington, New Mexico

Title Superior Dist. # 2

NEW MEXICO OIL CONSERVATION COMMISSION
Santa Fe, New Mexico

611
(Form C-104)
Revised 7/1/57

REQUEST FOR (OIL) - ~~(GAS)~~ ALLOWABLE

New Well
~~Drilling~~

This form shall be submitted by the operator before an initial allowable will be assigned to any completed Oil or Gas well. Form C-104 is to be submitted in QUADRUPPLICATE to the same District Office to which Form C-101 was sent. The allowable will be assigned effective 7:00 A.M. on date of completion or recompletion, provided this form is filed during calendar month of completion or recompletion. The completion date shall be that date in the case of an oil well when new oil is delivered into the stock tanks. Gas must be reported on 15.025 psia at 60° Fahrenheit.

Farmington, New Mexico

December 13, 1960

(Place)

(Date)

WE ARE HEREBY REQUESTING AN ALLOWABLE FOR A WELL KNOWN AS:

Astec Oil and Gas Company

Leased

, Well No. 11-0, in NE $\frac{1}{4}$ $\frac{1}{4}$,

(Company or Operator)

(Lease)

B 34 29W 13W Total Gallup Pool

Unit Letter

San Juan

County. Date Spudded 11/15/60

Date Drilling Completed 11/26/60

Please indicate location:

Elevation 5746 G. L. Total Depth 5658 PBD 5657

Top Oil/Gas Pay 5804 Name of Prod. Form. Gallup

PRODUCING INTERVAL -

Perforations 8 5576 - 5596

Open Hole _____ Depth _____ Casing Shoe 5657 Depth _____ Tubing 5582

OIL WELL TEST -

Natural Prod. Test: _____ bbls. oil, _____ bbls water in _____ hrs, _____ min. Choke Size _____

Test After Acid or Fracture Treatment (after recovery of volume of oil equal to volume of load oil used): 800.95 bbls. oil, 0 bbls water in 24 hrs, 0 min. Choke Size 20/64"

GAS WELL TEST -

Natural Prod. Test: _____ MCF/Day; Hours flowed _____ Choke Size _____

Method of Testing (pitot, back pressure, etc.): _____

Test After Acid or Fracture Treatment: _____ MCF/Day; Hours flowed _____

Choke Size _____ Method of Testing: _____

Acid or Fracture Treatment (Give amounts of materials used, such as acid, water, oil, and sand): Sand-Oil fraced with 24,000# sand and 627 Bbls. oil

Casing _____ Tubing _____ Date first new _____
Press. _____ Press. _____ oil run to tanks December 8, 1960

Oil Transporter El Paso Natural Gas Products Company (via Luna Hayes Trucking Co.)
Gas Transporter _____

Tubing, Casing and Cementing Record

Size	Feet	Sax
<u>8 5/8</u>	<u>318</u>	<u>223</u>
<u>4 1/2</u>	<u>5657</u>	<u>400</u>
<u>2 3/8</u>	<u>5582</u>	<u>---</u>

Remarks: _____

I hereby certify that the information given above is true and complete to the best of my knowledge.

Approved December 13 DEC 14 1960 Astec Oil and Gas Company

(Company or Operator)

OIL CONSERVATION COMMISSION

By: Original Signed Emery C. Arnold

Title Supervisor Dist. # 3

By: ORIGINAL SIGNED BY JOE C. SALMON
(Signature) Joe C. Salmon

Title District Superintendent
Send Communications regarding well to:

Name Astec Oil and Gas Company

Address Drawer # 570, Farmington, New Mexico

Budget Bureau No. 42-R355.4.
Approval expires 12-31-60.

[illegible]

LOCATE WELL CORRECTLY

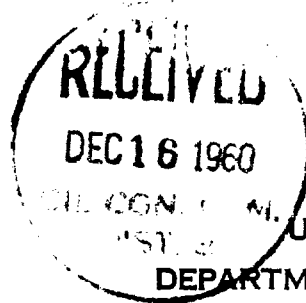
U. S. LAND OFFICE Santa Fe

SERIAL NUMBER **SF - 079065**.....

LEASE OR PERMIT TO PROSPECT -----

Magood

UNITED STATES

DEPARTMENT OF THE INTERIOR

GEOLOGICAL SURVEY

LOG OF OIL OR GAS WELL

Company Astec Oil and Gas Company Address Drawer # 570, Farmington, New Mexico
 Lessor or Tract Magood Field Total Gallup State New Mexico
 Well No. 11-6 Sec. 34 T 29N R 13W Meridian N.M.P.M. County San Juan
 Location 1020 ft. ¹⁰⁰_{S.} of N Line and 1890 ft. ^{NE}_{W.} of N Line of Section 34 Elevation 5746 G.L.
 (Derive floor relative to sea level)

The information given herewith is a complete and correct record of the well and all work done thereon so far as can be determined from all available records.

records. ORIGINAL SIGNED BY JOE C. SALMON
Signed _____
Joe C. Salmon
Title: District Superintendent

Date December 12, 1960

Title ~~District Superintendent~~-----

The summary on this page is for the condition of the well at above date.

Commenced drilling -----**11/15/60**-----, 19----- Finished drilling -----**11/26/60**-----, 19-----

OIL OR GAS SANDS OR ZONES

(Denote gas by G)

No. 1, from 5576 to 5596 ⁽¹⁾ No. 4, from _____ to _____

No. 2, from _____ to _____ No. 5, from _____ to _____

No. 3, from _____ to _____ No. 6, from _____ to _____

IMPORTANT WATER SANDS

No. 1, from _____ to _____ No. 3, from _____ to _____

No. 2, from _____ to _____ No. 4, from _____ to _____

CASING RECORD

Size casing	Weight per foot	Threads per inch	Make	Amount	Kind of shoe	Cut and pulled from	Perforated		Purpose
							From—	To—	
8 5/8	24	8rd	J-55	107	Oil	cut and pulled from	From—	To—	Purpose
4 1/2	11.60	8rd	J-55	107	Oil	cut and pulled from	From—	To—	Purpose
4 1/2	9.5	8rd	J-55	107	Oil	cut and pulled from	From—	To—	Purpose
2 3/8	4.7	8rd	J-55	107	Oil	cut and pulled from	From—	To—	Purpose

MUDDING AND CEMENTING RECORD

Size casing	Where set	Number sacks of cement	Method used	Mud gravity	Amount of mud used
8 5/8	318	225	displacement		ILLEGIBLE
4 1/2	5657	400	two-plug		
2 3/8	5582	---			

ILLEGIBLE

Leaving plug Size
Adapters—Material Size

SHOOTING RECORD

Size	Shell used	Explosive used	Quantity	Date	Depth shot	Depth cleaned out
Sand-Oil fraced with 24,000# sand and 627 lbs. oil. / Flushed with 151 Bulb. oil, Breakdown pr. 1400#						
Max. pressure - 3000#, Avg. treating pr., 2600#, I.R. 28 bpm 3-min. shut-in - 1890#						

TOOLS USED

Rotary tools were used from 0 feet to 5658 feet, and from feet to feet

Cable tools were used from 0 feet to 5657 feet, and from feet to feet

DATES

12/2/60, 19..... Put to producing 12/8/60, 19.....

The production for the first 24 hours was 200.55 barrels of fluid of which 100% was oil; 0% emulsion; 0% water; and 0% sediment. Gravity, °Bé.

If gas well, cu. ft. per 24 hours Gallons gasoline per 1,000 cu. ft. of gas

Rock pressure, lbs. per sq. in.

EMPLOYEES

....., Driller Driller
....., Driller Driller

FORMATION RECORD

FROM—	TO—	TOTAL FEET	FORMATION
0	269	269	Sand and Shale
269	325	56	Shale
325	2368	2043	Sand and Shale
2368	3166	798	Sand and Shale
3166	3996	830	Sand and Shale
3996	4319	323	Sand and Shale
4319	4374	55	Shale
4374	4670	296	Sand and Shale
4670	4765	95	Shale
4765	4916	151	Sand and Shale
4916	4918	2	Sand
4918	5010	92	Shale
5010	5150	140	Sand and Shale
5150	5299	149	Shale
5299	5610	311	Sand and Shale
5610	5650	40	Sand and Shale
5650	5658	8	Sand and Shale
FROM—	TO—	TOTAL FEET	FORMATION

OVER
FORMATION RECORD—CONTINUED
PICTURED CLIFFS - 1360, CLIFF HOUSE - 3108, POINT LOOKOUT - 4010
GALLUP - 5204

10—43094-4

ILLEGIBLE

N. MEXICO OIL CONSERVATION COMMISSION
Well Location and Acreage Dedication Plat

SECTION A.

Date **November 2, 1960**

Operator **Astec Oil and Gas Company** Lease **Hagood**
 Well No **11-0** Unit Letter **B** Section **34** Township **29N** Range **13W** NM
 Located **1020** Feet From **North** Line **1890** Feet From **East**
 County **San Juan** G. L. Elevation **5746** Dedicated Acreage **80** A.
 Name of Producing Formation **Gallup** Pool **Total**

1. Is the Operator the only owner in the dedicated acreage outlined on the plat below? Yes **XXX** No
2. If the answer to question One is "No" have the interests of all the owners been consolidated by community agreement or otherwise? Yes No If answer is "Yes" Type of Consolidation
3. If the answer to question Two is "No" list all the owners and their respective interests below

OWNER

SECTION B.

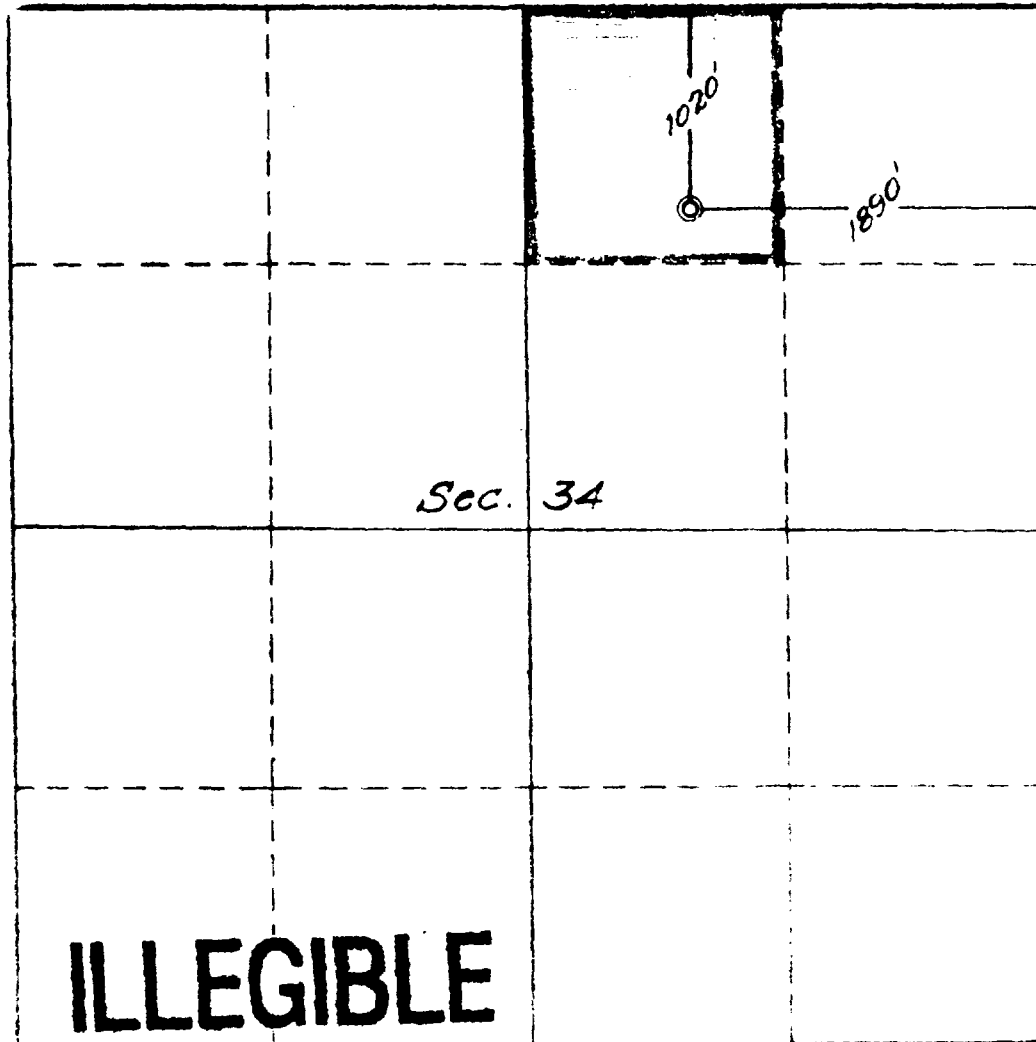

I hereby certify that the information in Section A above is true and complete to the best of my knowledge and belief.

Astec Oil and Gas Company
 OPERATOR

Drawer 570, Farmington, N. M.

I hereby certify that the information in the plat in Section B was made by me or by a competent person under my supervision and to the best of my knowledge and belief.

Four States Engineering Co.

NEW MEXICO OIL CONSERVATION COMMISSION
SANTA FE, NEW MEXICO

Form C-110
Revised 7/1/55

(File the original and 4 copies with the appropriate district office)

CERTIFICATE OF COMPLIANCE AND AUTHORIZATION
TO TRANSPORT OIL AND NATURAL GAS

Company or Operator Astec Oil and Gas Company Lease Hagood

Well No. 11-G Unit Letter B S 34 T 29N R 13W Pool Totah Gallup

County San Juan Kind of Lease (State, Fed. or Patented) Fed.

If well produces oil or condensate, give location of tanks: Unit S T R

Authorized Transporter of Oil or Condensate Four Corners Pipeline Company

Address P.O. Box # 2648, Houston, 1, Texas.

(Give address to which approved copy of this form is to be sent)

Authorized Transporter of Gas _____

Address _____ Date Connected _____

(Give address to which approved copy of this form is to be sent)

If Gas is not being sold, give reasons and also explain its present disposition:

Reasons for Filing: (Please check proper box) New Well ()

Change in Transporter of (Check One): Oil ☒ Dry Gas ☐ C'head ☐ Condensate ☐

Change in Ownership ☐ Other ☐

Remarks: _____ (Give explanation below)

The undersigned certifies that the Rules and Regulations of the Oil Conservation Commission have been complied with.

Executed this the 22nd day of March 19 61

By ORIGINAL SIGNED BY JOE C. SALMON

Joe C. Salmon

Approved MAR 21 1961 19 61

Title District Superintendent

OIL CONSERVATION COMMISSION

Company Astec Oil and Gas Company

Original Signed By
By A. R. KENDRICK

Address Drawer # 570, Farmington, New Mex.

Title PETROLEUM ENGINEER DIST. NO. 3

NUMBER OF COPIES RECEIVED		5	
DISTRIBUTION			
SANTA FE			
FILE			
U.S.G.S.			
LAND OFFICE			
TRANSPORTER	OIL		
	GAS		
PROBATION OFFICE			
OPERATOR			

NEW MEXICO OIL CONSERVATION COMMISSION
SANTA FE, NEW MEXICO
CERTIFICATE OF COMPLIANCE AND AUTHORIZATION
TO TRANSPORT OIL AND NATURAL GAS

FORM C-110
 (Rev. 7-60)

FILE THE ORIGINAL AND 4 COPIES WITH THE APPROPRIATE OFFICE

Company or Operator AZTEC OIL & GAS COMPANY				Lease HAGOOD "G"		Well No. 11	
Unit Letter B	Section 34	Township 29N	Range 13W	County SAN JUAN			
Pool TOTAH GALLUP				Kind of Lease (State, Fed, Fee) FEDERAL			

If well produces oil or condensate give location of tanks		Unit Letter H	Section 34	Township 29N	Range 13W
--	--	-------------------------	----------------------	------------------------	---------------------

Authorized transporter of oil <input checked="" type="checkbox"/> or condensate <input type="checkbox"/>		Address (give address to which approved copy of this form is to be sent) BOX 1588 FARMINGTON, NEW MEXICO	
FOUR CORNERS PIPELINE, INC.		Is Gas Actually Connected? Yes <input checked="" type="checkbox"/> No <input type="checkbox"/>	

Authorized transporter of casing head gas <input checked="" type="checkbox"/> or dry gas <input type="checkbox"/>		Date Connected 6-3-62	Address (give address to which approved copy of this form is to be sent) BOX 5426 TULSA, OKLAHOMA
JALOU GAS CO., INC.			

If gas is not being sold, give reasons and also explain its present disposition:

REASON(S) FOR FILING (please check proper box)

- | | |
|---|--|
| New Well <input type="checkbox"/> | Change in Ownership <input type="checkbox"/> |
| Change in Transporter (check one) | Other (explain below) |
| Oil <input type="checkbox"/> Dry Gas <input type="checkbox"/> | |
| Casing head gas . <input checked="" type="checkbox"/> Condensate . . <input type="checkbox"/> | |

Remarks

The undersigned certifies that the Rules and Regulations of the Oil Conservation Commission have been complied with.

Executed this the 11 day of OCTOBER, 19 63

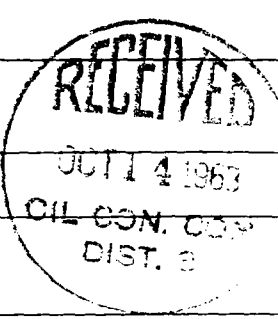
OIL CONSERVATION COMMISSION		By B. H. MEANS
Approved by Original Signed Emery C. Arnold	Title DISTRICT ENGINEER	
Title Superior Dist. # 3	Company AZTEC OIL & GAS COMPANY	
Date	Address DRAWER #570, FARMINGTON, NEW MEXICO	

NUMBER OF COPIES RECEIVED	
DISTRIBUTION	
SANTA FE	
FILE	
U.S.G.S.	
LAND OFFICE	
TRANSPORTER	OIL
	GAS
PRODUCTION OFFICE	
OPERATOR	

NEW MEXICO OIL CONSERVATION COMMISSION
SANTA FE, NEW MEXICO

CERTIFICATE OF COMPLIANCE AND AUTHORIZATION TO TRANSPORT OIL AND NATURAL GAS

FORM C-110
(Rev. 7-60)

FILE THE ORIGINAL AND 4 COPIES WITH THE APPROPRIATE OFFICE

Company or Operator Tanasco Oil Company				Lease Central Totah Unit		Well No. 16
Unit Letter B	Section 34	Township 23N	Range 13E	County San Juan		
Pool Totah Gallup				Kind of Lease (State, Fed, Fee) Federal		
If well produces oil or condensate give location of tanks		Unit Letter	Section	Township	Range	
Authorized transporter of oil <input checked="" type="checkbox"/> or condensate <input type="checkbox"/> Four Corners Pipeline, Incorporated				Address (give address to which approved copy of this form is to be sent) Box 1988, Farmington, New Mexico		
Is Gas Actually Connected? Yes <input checked="" type="checkbox"/> No <input type="checkbox"/>						
Authorized transporter of casing head gas <input checked="" type="checkbox"/> or dry gas <input type="checkbox"/>		Date Connected 6-3-62	Address (give address to which approved copy of this form is to be sent) Box 9486, Tulsa, Oklahoma			
Salon Gas Company, Incorporated						

If gas is not being sold, give reasons and also explain its present disposition:

REASON(S) FOR FILING (please check proper box)

New Well ☐ Change in Ownership ☐
 Change in Transporter (check one)
 Oil ☐ Dry Gas ☐
 Casing head gas . ☐ Condensate.. ☐
Well Name Change
Operator Change

ILLEGIBLE

Remarks

**Formerly Hugood 11-G
Former Operator Antec Oil & Gas Company
Effective January 1, 1964**

The undersigned certifies that the Rules and Regulations of the Oil Conservation Commission have been complied with. **JAN 21 1964**

Executed this the **22** day of **January**, 19 **64**.

OIL CONSERVATION COMMISSION		By
Approved by	ORIGINAL SIGNED BY JOE C. SALMON	JOE C. SALMON
Original Signed Emery C. Arnold	Title	DISTRICT SUPERINTENDENT
Title	Company	ANTEC OIL & GAS COMPANY
Supervisor Dist. # 3	Address	Box 570, Farmington, New Mexico
Date	JAN 21 1964	

NO. OF COPIES RECEIVED	5
DISTRIBUTION	
SANTA FE	1
FILE	1
U.S.G.S.	
LAND OFFICE	
TRANSPORTER	OIL 1 GAS
OPERATOR	2
PRORATION OFFICE	

NEW MEXICO OIL CONSERVATION COMMISSION
REQUEST FOR ALLOWABLE
AND
AUTHORIZATION TO TRANSPORT OIL AND NATURAL GAS

Form C-104
Supersedes C-110 and C-110
Effective 1-1-65

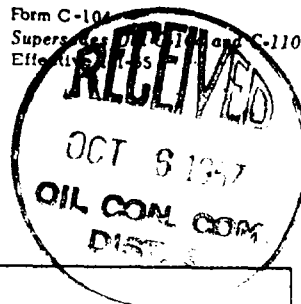

I. Operator
Aztec Oil and Gas Company
Address
Drawer 570, Farmington, New Mexico
Reason(s) for filing (Check proper box)
New Well ☐ Change in Transporter of:
Recompletion ☐ Oil ☐ Dry Gas ☐
Change in Ownership ☒ Casinghead Gas ☐ Condensate ☐
Other (Please explain)
If change of ownership give name and address of previous owner
Tenneco Oil Company, Box 1714, Durango, Colorado

II. DESCRIPTION OF WELL AND LEASE

Lease Name Central Totah Unit	Well No. 16	Pool Name, including Formation Totah Gallup	Kind of Lease State, Federal or Fee Federal SF	Lease No. 079065
Location Unit Letter B ; 1020 Feet From The N Line and 1890 Feet From The E Line of Section 34 Township 29N Range 13W, NMPM, San Juan County				

III. DESIGNATION OF TRANSPORTER OF OIL AND NATURAL GAS

Name of Authorized Transporter of Oil <input checked="" type="checkbox"/> or Condensate <input type="checkbox"/> Four Corners Pipeline Company	Address (Give address to which approved copy of this form is to be sent) Box 1588, Farmington, New Mexico	
Name of Authorized Transporter of Casinghead Gas <input type="checkbox"/> or Dry Gas <input type="checkbox"/>	Address (Give address to which approved copy of this form is to be sent)	
If well produces oil or liquids, give location of tanks.	Unit K	Sec. 27
	Twp. 29N	Rge. 13W
	Is gas actually connected?	When

If this production is commingled with that from any other lease or pool, give commingling order number:

IV. COMPLETION DATA

Designate Type of Completion - (X)	Oil Well	Gas Well	New Well	Workover	Deepen	Plug Back	Same Res'v.	Diff. Res'v.
Date Spudded	Date Compl. Ready to Prod.		Total Depth		P.B.T.D.			
Elevations (DF, RKB, RT, GR, etc.)	Name of Producing Formation		Top Oil/Gas Pay		Tubing Depth			
Perforations					Depth Casing Shoe			
TUBING, CASING, AND CEMENTING RECORD								
HOLE SIZE	CASING & TUBING SIZE		DEPTH SET		SACKS CEMENT			

V. TEST DATA AND REQUEST FOR ALLOWABLE OIL WELL (Test must be after recovery of total volume of load oil and must be equal to or exceed top allowable for this depth or be for full 24 hours)

Date First New Oil Run To Tanks	Date of Test	Producing Method (Flow, pump, gas lift, etc.)	
Length of Test	Tubing Pressure	Casing Pressure	Choke Size
Actual Prod. During Test	Oil - Bbls.	Water - Bbls.	Gas - MCF

GAS WELL

Actual Prod. Test - MCF/D	Length of Test	Bbls. Condensate/MMCF	Gravity of Condensate
Testing Method (pitot, back pr.)	Tubing Pressure (Shut-in)	Casing Pressure (Shut-in)	Choke Size

VI. CERTIFICATE OF COMPLIANCE

I hereby certify that the rules and regulations of the Oil Conservation Commission have been complied with and that the information given above is true and complete to the best of my knowledge and belief.

(Signature)
District Superintendent
(Title)
October 6, 1967
(Date)

OIL CONSERVATION COMMISSION

APPROVED OCT 6 1967
BY Original Signed by Emory C. Arnold
TITLE SUPERVISOR DIST. #3

This form is to be filed in compliance with RULE 1104.

If this is a request for allowable for a newly drilled or deepened well, this form must be accompanied by a tabulation of the deviation tests taken on the well in accordance with RULE 111.

All sections of this form must be filled out completely for allowable on new and recompleted wells.

Fill out only Sections I, II, III, and VI for changes of owner, well name or number, or transporter or other such change of condition.

Separate Forms C-104 must be filed for each pool in multiply completed wells.

UNITED STATES
DEPARTMENT OF THE INTERIOR
GEOLOGICAL SURVEYSUBMIT IN TRIPLICATE*
(Other instructions on re-
verse side)Form approved.
Budget Bureau No. 42-R1424

6. LEASE DESIGNATION AND SERIAL NO.

SF-079065

6. IF INDIAN, ALLOTTED OR TRIBE NAME

7. UNIT AGREEMENT NAME

8. FARM OR LEASE NAME

Central Totah Unit

9. WELL NO.

#16

10. FIELD AND POOL, OR WILDCAT

Totah Gallup

11. SEC., T., R., M., OR BLK. AND
SURVEY OR AREA

Section 34-29N-13W

12. COUNTY OR PARISH 13. STATE

San Juan

New Mexico

SUNDRY NOTICES AND REPORTS ON WELLS

(Do not use this form for proposals to drill or to deepen or plug back to a different reservoir.
Use "APPLICATION FOR PERMIT—" for such proposals.)1. OIL WELL ☒ GAS WELL ☐ OTHER ☐

2. NAME OF OPERATOR

Aztec Oil & Gas Company

3. ADDRESS OF OPERATOR

P. O. Drawer 570, Farmington, New Mexico 87401

4. LOCATION OF WELL (Report location clearly and in accordance with any State requirements.*
See also space 17 below.)
At surfaceSection 34-29N-13W
1020' FNL & 1890' FEL

14. PERMIT NO.

15. ELEVATIONS (Show whether DF, RT, GR, etc.)

5746' GR

16. Check Appropriate Box To Indicate Nature of Notice, Report, or Other Data

NOTICE OF INTENTION TO:

TEST WATER SHUT-OFF ☐FRACTURE TREAT ☐SHOOT OR ACIDIZE ☐REPAIR WELL ☐

(Other)

Temporarily Abandon

PULL OR ALTER CASING ☐MULTIPLE COMPLETE ☐ABANDON* ☐CHANGE PLANS ☐

SUBSEQUENT REPORT OF:

WATER SHUT-OFF ☐FRACTURE TREATMENT ☐SHOOTING OR ACIDIZING ☐

(Other)

REPAIRING WELL ☐ALTERING CASING ☐ABANDONMENT* ☐(NOTE: Report results of multiple completion on Well
Completion or Recompletion Report and Log form.)

17. DESCRIBE PROPOSED OR COMPLETED OPERATIONS (Clearly state all pertinent details, and give pertinent dates, including estimated date of starting and proposed work. If well is directionally drilled, give subsurface locations and measured and true vertical depths for all markers and zones pertinent to this work.)*

This well is not economical to produce under present conditions.
It is located in a secondary recovery project and is a potential
well for additional secondary recovery or tertiary recovery methods
if economics change.

RENTAL AGREEMENT
EXPIRES

JUN 1 1977



RECEIVED

JUN 21 1976

U. S. GEOLOGICAL SURVEY

18. I hereby certify that the foregoing is true and correct

SIGNED

TITLE

District Superintendent

DATE

June 18, 1976

(This space for Federal or State office use)

APPROVED BY

TITLE

DATE

CONDITIONS OF APPROVAL, IF ANY:

*See Instructions on Reverse Side

DISTRIBUTION			
SANTA FE		1	7
FILE		1	
U.S.G.S.			
LAND OFFICE			
TRANSPORTER	OIL	1	
	GAS		
OPERATOR		4	
PRODUCTION OFFICE			

NEW MEXICO OIL CONSERVATION COMMISSION
REQUEST FOR ALLOWABLE
AND
AUTHORIZATION TO TRANSPORT OIL AND NATURAL GAS

Form C-104
Supersedes Old C-104
Effective 1-1-65

Operator **SOUTHLAND ROYALTY COMPANY**

Address **Box 570
Farmington NM 87401**

Reason(s) for filing (Check proper box)

New Well ☐
Recompletion ☐
Change in Ownership ☐

Change in Transporter of:

Oil ☐ Dry Gas ☐
Casinghead Gas ☐ Condensate ☐

Other (Please explain)

Name Change

If change of ownership give name
and address of previous owner

II. DESCRIPTION OF WELL AND LEASE

Lease Name Central Totah Unit	Well No. 16	Pool Name, including Formation Totah Gallup	Kind of Lease State, Federal or Fee Federal	Lease SF
Location Unit Letter B ; 1020 Feet From The North Line and 1890 Feet From The East Line of Section 34 Township 29N Range 13W , NMPLM, San Juan				

III. DESIGNATION OF TRANSPORTER OF OIL AND NATURAL GAS

Name of Authorized Transporter of Oil <input checked="" type="checkbox"/> or Condensate <input type="checkbox"/> Four Corners Pipeline Plateau	Address (Give address to which approved copy of this form is to be sent) Box 1588, Farmington, New Mexico Box 108, Farmington, New Mexico					
Name of Authorized Transporter of Casinghead Gas <input type="checkbox"/> or Dry Gas <input type="checkbox"/>	Address (Give address to which approved copy of this form is to be sent)					
If well produces oil or liquids, give location of tanks.	Unit	Sec.	Twp.	Rge.	Is gas actually connected?	When

If this production is commingled with that from any other lease or pool, give commingling order number:

IV. COMPLETION DATA

Designate Type of Completion - (X)	Oil Well	Gas Well	New Well	Workover	Deepen	Plug Back	Same Res'n.	Drill
Date Spudded	Date Compl. Ready to Prod.		Total Depth		P.E.T.D.			
Elevations (DF, RKB, RT, GR, etc.)	Name of Producing Formation		Top Oil/Gas Pay		Tubing Depth			
Perforations					Depth Casing Shoe			

V. TEST DATA AND REQUEST FOR ALLOWABLE OIL WELL

(Test must be after recovery of total volume of load oil and must be equal to or exceed
able for this depth or be for full 24 hours)

Date First New Oil Run To Tanks	Date of Test	Producing Method (Flow, pump, gas lift, etc.)	
Length of Test	Tubing Pressure	Casing Pressure	Choke Size
Actual Prod. During Test	Oil-Bbls.	Water-Bbls.	Gas-MCF

GAS WELL

Actual Prod. Test-MCF/D	Length of Test	Bbls. Condensate/MMCF	Gravity of Condensate
Testing Method (pilot, back pr.)	Tubing Pressure (shut-in)	Casing Pressure (shut-in)	Choke Size

VI. CERTIFICATE OF COMPLIANCE

I hereby certify that the rules and regulations of the Oil Conservation
Commission have been complied with and that the information given
above is true and complete to the best of my knowledge and belief.

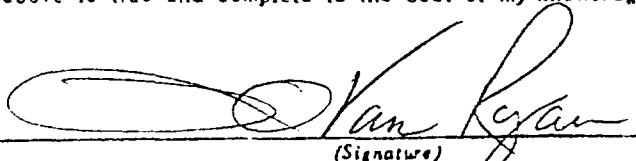
(Signature)
District Production Manager
(Title)
1-1-78
(Date)

OIL CONSERVATION COMMISSION

JAN 12 1978

APPROVED _____, 19__

BY Original Signed by A. R. Kend

TITLE SUPERVISOR DIST. #3

This form is to be filed in compliance with RULE 1104
If this is a request for allowable for a newly drilled or
well, this form must be accompanied by a tabulation of the
tests taken on the well in accordance with RULE 111.

All sections of this form must be filled out completely
able on new and recompleted wells.

Fill out only Sections I, II, III, and VI for changes
well name or number, or transporter, or other such change of c

Separate Forms C-104 must be filed for each pool in
completed wells.

OIL CONSERVATION DIVISION

P. O. BOX 2088

SANTA FE, NEW MEXICO 87501

NO. OF COPIES RECEIVED	
DISTRIBUTION	
SANTA FE	
FILE	
U.S.D.S.	
LAND OFFICE	
TRANSPORTER	OIL GAS
OPERATOR	
PRODUCTION OFFICE	

REQUEST FOR ALLOWABLE
AND
AUTHORIZATION TO TRANSPORT OIL AND NATURAL GAS

Operator	PARAMOUNT PETROLEUM CORPORATION	PARAMOUNT PETROLEUM CORPORATION
Address	P. O. BOX 22763 HOUSTON, TEXAS 77027	P. O. BOX 22763 HOUSTON, TEXAS 77027

Reason(s) for filing (Check proper box)	Other (Please explain)
New Well <input type="checkbox"/>	Change in Transporter of:
Recompletion <input type="checkbox"/>	Oil <input type="checkbox"/> Dry Gas <input type="checkbox"/>
Change in Ownership <input checked="" type="checkbox"/>	Casinghead Gas <input type="checkbox"/> Condensate <input type="checkbox"/>

If change of ownership give name and address of previous owner Southland Royalty Co 1000 Ft Worth Club
Ft Worth, Tx 76102

DESCRIPTION OF WELL AND LEASE				
Lease Name	Well No.	Pool Name, Including Formation	Kind of Lease	Lease No.
Central Jotah Unit	16	Jotah Gallup	State, Federal or Fee <u>Fed</u>	<u>079065</u>
Location				
Unit Letter <u>B</u>	<u>1020</u> Feet From The <u>N</u> Line and <u>1890</u> Feet From The <u>E</u>	<u>NM 0468128</u>		
Line of Section <u>34</u> <u>NWNE</u> Township <u>29N</u> Range <u>13W</u> , <u>NMPM</u> , <u>San Juan</u> County				

DESIGNATION OF TRANSPORTER OF OIL AND NATURAL GAS				
Name of Authorized Transporter of Oil <input type="checkbox"/> or Condensate <input type="checkbox"/>	Address (Give address to which approved copy of this form is to be sent)			
Name of Authorized Transporter of Casinghead Gas <input type="checkbox"/> or Dry Gas <input type="checkbox"/>	Address (Give address to which approved copy of this form is to be sent)			
If well produces oil or liquids, give location of tanks.	Unit	Sec.	Twp.	Rge.
Is gas actually connected?		When		

If this production is commingled with that from any other lease or pool, give commingling order number: _____

COMPLETION DATA									
Designate Type of Completion - (X)									
Date Spudded	Date Compl. Ready to Prod.	Total Depth	P.B.T.D.						
Elevations (Dh, RT, GR, etc.)	Name of Producing Formation	Top Oil/Gas Pay	Tubing Depth						
Perforations				Depth Casing Shoe					

TUBING, CASING, AND CEMENTING RECORD			
HOLE SIZE	CASING & TUBING SIZE	DEPTH SET	SACKS CEMENT

TEST DATA AND REQUEST FOR ALLOWABLE OIL WELL (Test must be after recovery of total volume of load oil and must be equal to or exceed top allowable for this depth or be for full 24 hours)

Date First New Oil Run To Tanks	Date of Test	Producing Method (Flow, pump, gas lift, etc.)	
Length of Test	Tubing Pressure	Casing Pressure	Choke Size
Actual Prod. During Test	Oil - Bbls.	Water - Bbls.	Gas - MCF

GAS WELL			
Actual Prod. Test - MCF/D	Length of Test	Bbls. Condensate/MMCF	Gravity of Condensate
Testing Method (pilot, back pr.)	Tubing Pressure (Shut-in)	Casing Pressure (Shut-in)	Choke Size

CERTIFICATE OF COMPLIANCE

I hereby certify that the rules and regulations of the Oil Conservation Division have been complied with and that the information given above is true and complete to the best of my knowledge and belief.

Robert C Whitworth
(Signature)
VP Operations
(Title)
11/17/80
(Date)

OIL CONSERVATION DIVISION

APPROVED NOV 24 1980, 19____
BY Original Signed by FRANK T. CHAVEZ
TITLE SUPERVISOR DISTRICT # 1

This form is to be filed in compliance with RULE 1104.
If this is a request for allowable for a newly drilled or deepened well, this form must be accompanied by a tabulation of the deviation tests taken on the well in accordance with RULE 111.
All sections of this form must be filled out completely for allowable on new and recompleted wells.
Fill out only Sections I, II, III, and VI for changes of owner, well name or number, or transporter, or other such change of condition.
Separate Form C-104 must be filed for each pool in multiply completed wells.



**NEW MEXICO ENERGY, MINERALS
& NATURAL RESOURCES DEPARTMENT**

OIL CONSERVATION DIVISION
AZTEC DISTRICT OFFICE
1000 RIO BRAZOS ROAD
AZTEC, NEW MEXICO 87410
(505) 334-6178 Fax (505) 334-6170

GARY E. JOHNSON
GOVERNOR

JENNIFER A. SALISBURY
CABINET SECRETARY

June 23, 1997

Rand Carroll
Oil Conservation Division Attorney
2040 S Pacheco
Santa Fe NM 87505

RE: Paramount Petroleum Inc., Federal Orphan Wells

Dear Rand:

The following Aztec Total Unit wells are Federal orphan wells:

#1	A-29-29N-13W	30-045-07923	#2	G-29-29N-13W	30-045-07871
#3	I-29-29N-13W	30-045-07844	#4	C-29-29N-13W	30-045-07919
#5	K-29-29N-13W	No API	#6	E-29-29N-13W	30-045-07890
#8	K-20-29N-13W	30-045-08011	#9	M-20-29N-13W	30-045-07965
#10	I-19-29N-13W	30-045-08014	#13	C-19-29N-13W	30-045-08156
#15	D-34-29N-13W	30-045-13099	#16	B-34-29N-13W	30-045-07738
#17	F-34-29N-13W	30-045-07706	#18	H-34-29N-13W	30-045-07683
#19	L-34-29N-13W	30-045-07665	#20	J-34-29N-13W	30-045-07656
#21	P-34-29N-13W	30-045-07612	#22	N-34-29N-13W	30-045-07608

Steve Mason with the BLM asked that we plug and abandon the wells using the reclamation fund. I have enclosed his plugging procedures for each well. Our inspection didn't find any wells that would be classified as emergency wells but due to the location of the wells (close to Farmington) and the deteriorating conditions of the wellbore, I would like to plug the wells as soon as possible.

Please notify me of your schedule and when I may expect to begin work. If there is any other paper work needed feel free to contact me at 334-6178.

Sincerely,

Johnny Robinson
Deputy O&G Inspector

JR/sh

cc: Steve Mason BLM well files

enc.