

(SUBMIT IN TRIPLICATE)

UNITED STATES
DEPARTMENT OF THE INTERIOR
GEOLOGICAL SURVEY

Land Office Santa Fe
Lease No. 21-079063
Unit Magdalena

SUNDRY NOTICES AND REPORTS ON WELLS

NOTICE OF INTENTION TO DRILL	<input checked="" type="checkbox"/>	SUBSEQUENT REPORT OF WATER SHUT-OFF	
NOTICE OF INTENTION TO CHANGE PLANS		SUBSEQUENT REPORT OF SHOOTING OR ACIDIZING	
NOTICE OF INTENTION TO TEST WATER SHUT-OFF		SUBSEQUENT REPORT OF ALTERING CASING	
NOTICE OF INTENTION TO RE-DRILL OR REPAIR WELL		SUBSEQUENT REPORT OF RE-DRILLING OR REPAIR	
NOTICE OF INTENTION TO SHOOT OR ACIDIZE		SUBSEQUENT REPORT OF ABANDONMENT	
NOTICE OF INTENTION TO PULL OR ALTER CASING		SUPPLEMENTARY WELL HISTORY	
NOTICE OF INTENTION TO ABANDON WELL			

(INDICATE ABOVE BY CHECK MARK NATURE OF REPORT, NOTICE, OR OTHER DATA)

January 16, 1961

Well No. 17-6 is located 300 ft. from N line and 2300 ft. from E line of sec. 29
Mag. Section 29 29N 13W S.M., P.M.
(1/4 Sec. and Sec. No.) (Twp.) (Range) (Meridian)
Gallop San Juan New Mexico
(Field) (County or Subdivision) (State or Territory)

The elevation of the derrick floor above sea level is 573 ft. (Ground Elevation)

DETAILS OF WORK

(State names of and expected depths to objective sands; show sizes, weights, and lengths of proposed casings; indicate mudding jobs, cementing points, and all other important proposed work)

Propose To:

Set 300 feet of 8 1/8" surface casing and cement to surface.
Drill with rotary to approximate total depth of 5600 feet or through Gallup formation. Set 4 1/2" casing at total depth and cement with 275 cu. cement.
Set two-stage cement collar approximately 100 feet below Pictured Cliffs formation and cement with 150 cu.

Perforate Gallup formation with four shots per foot. Sand-oil flow with approximately 50,000 gal. sand and 50,000 gal. oil. Run 2 3/8" tubing.

1/2/61, 40 acres, of Section 29 dedicated to well.

I understand that this plan of work must receive approval in writing by the Geological Survey before operations may be commenced.

Company Astec Oil and Gas Company

Address Drawer 573
Farmington, New Mexico

ORIGINAL SIGNED BY JOE C. SALMON
By Joe C. Salmon
District Superintendent
Title _____

ILLEGIBLE

NEW MEXICO OIL CONSERVATION COMMISSION

Well Location and Acreage Dedication Plat

SECTION A.

Date January 16, 1961

Operator Astec Oil and Gas Company Lease Hagood
 Well No. 17-G Unit Letter 0 Section 29 Township 29N Range 13W NMPM
 Located 880 Feet From North Line, 2300 Feet From West Line
 County San Juan G. L. Elevation 5734 Dedicated Acreage 40 Acres
 Name of Producing Formation Gallup Pool Total

1. Is the Operator the only owner* in the dedicated acreage outlined on the plat below? Yes XXX No _____
2. If the answer to question One is "No," have the interests of all the owners been consolidated by communitization agreement or otherwise? Yes _____ No _____. If answer is "Yes," Type of Consolidation _____
3. If the answer to question Two is "No," list all the owners and their respective interests below:

OWNER

LAND DESCRIPTION

SECTION B.

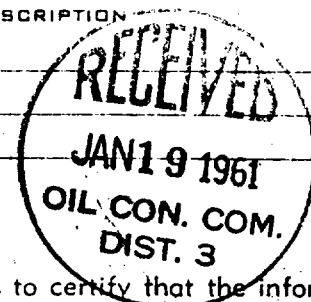
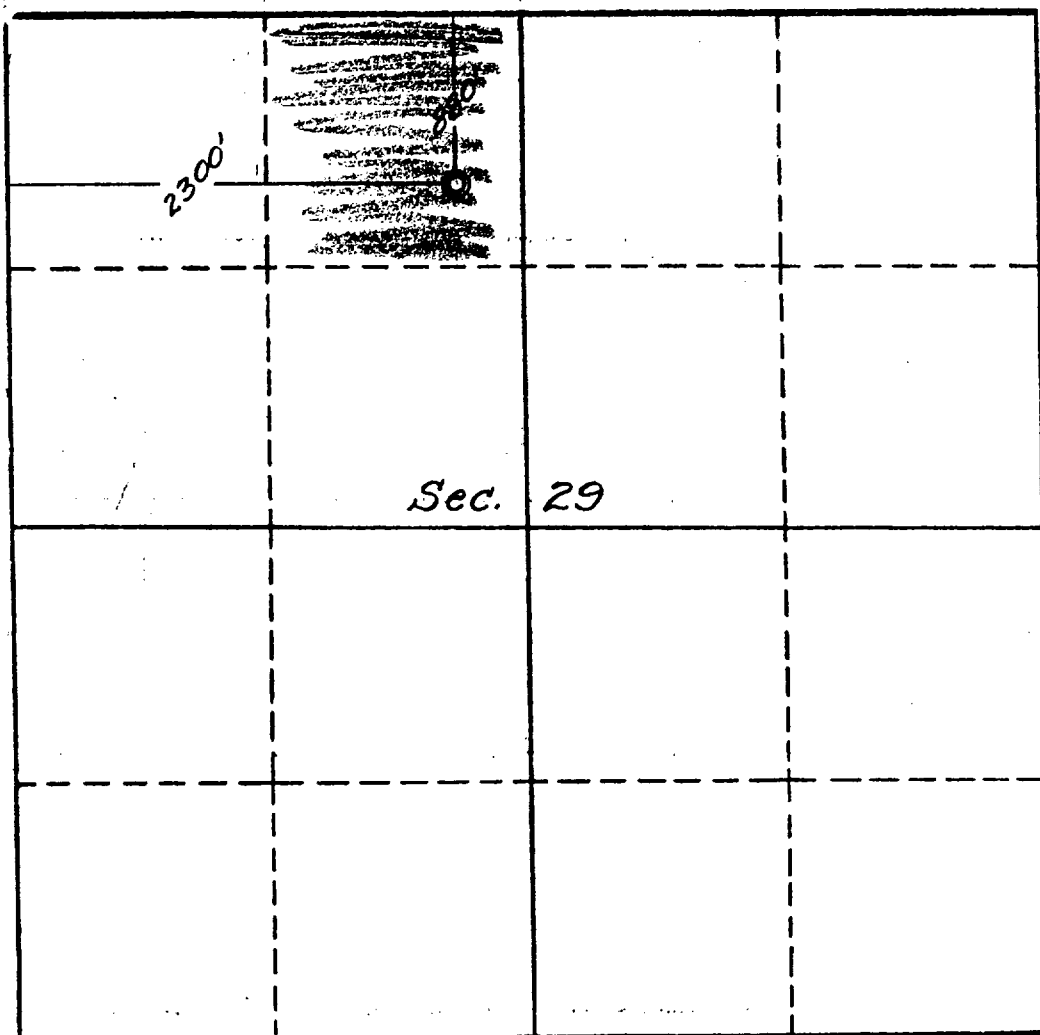

This is to certify that the information in Section A above is true and complete to the best of my knowledge and belief.

Astec Oil and Gas Company
 (OPERATOR)

ORIGINAL SIGNED BY JOE C. SALMON
 (REPRESENTATIVE)

Drawer 570, Farmington, N.M.
 (ADDRESS)

This is to certify that the well location shown on the plat in Section B was plotted from field notes of actual surveys made by me or under my supervision and that the same is true and correct to the best of my knowledge and belief.

Date Surveyed 1-13-61

Four States Engineering Co.
 FARMINGTON, NEW MEXICO

E. N. Edwards
 REGISTERED ENGINEER OR
 LAND SURVEYOR

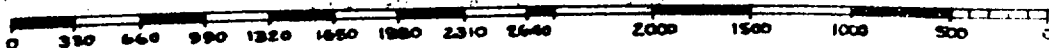
Certificate No. 1545

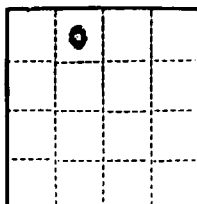

(SUBMIT IN TRIPLICATE)

UNITED STATES
DEPARTMENT OF THE INTERIOR
GEOLOGICAL SURVEY

Land Office Santa Fe
Lease No. NE 079063
Unit Magood

SUNDRY NOTICES AND REPORTS ON WELLS

NOTICE OF INTENTION TO DRILL.....	SUBSEQUENT REPORT OF WATER SHUT-OFF.....	RECEIVED FEB 10 1961
NOTICE OF INTENTION TO CHANGE PLANS.....	SUBSEQUENT REPORT OF SHOOTING OR ACIDIZING.....	
NOTICE OF INTENTION TO TEST WATER SHUT-OFF.....	SUBSEQUENT REPORT OF ALTERING CASING.....	
NOTICE OF INTENTION TO RE-DRILL OR REPAIR WELL.....	SUBSEQUENT REPORT OF RE-DRILLING OR REPAIR.....	
NOTICE OF INTENTION TO SHOOT OR ACIDIZE.....	SUBSEQUENT REPORT OF ABANDONMENT.....	
NOTICE OF INTENTION TO PULL OR ALTER CASING.....	SUPPLEMENTARY WELL HISTORY.....	
NOTICE OF INTENTION TO ABANDON WELL.....		

(INDICATE ABOVE BY CHECK MARK NATURE OF REPORT, NOTICE, OR OTHER DATA)

U. S. GEOLOGICAL SURVEY
FARMINGTON, NEW MEXICO

February 7, 1961

Magood
Well No. 17-G is located 800 ft. from [N] line and 2300 ft. from [W] line of sec. 29
NE 1/4 Section 29 T-29N R-13W N.M.P.M.
(1/4 Sec. and Sec. No.) (Twp.) (Range) (Meridian)
Totah Gallup San Juan New Mexico
(Field) (County or Subdivision) (State or Territory)

The elevation of the derrick floor above sea level is 5785 ft. S.L.

DETAILS OF WORK

(State names of and expected depths to objective sands; show sizes, weights, and lengths of proposed casings; indicate mudding jobs, cementing points, and all other important proposed work)

Well was spudded 1/30/61
Ran 10 jts., 317' of 8 5/8" casing, landed at 329' with 235 sacks out.
Tested casing with 900# pressure for 30 minutes. No leaks.
Drilled cement plug 2/1/61
Tested for 30 minutes with 900# pressure.
No drop in pressure.

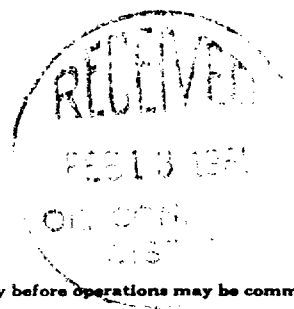

I understand that this plan of work must receive approval in writing by the Geological Survey before operations may be commenced.

Company Antec Oil and Gas Company
Address Drawer # 570
Farmington, New Mexico
By Joe C. Salmon
Title District Superintendent

ORIGINAL SIGNED BY JOE C. SALMON

X			

(SUBMIT IN TRIPLICATE)

UNITED STATES
DEPARTMENT OF THE INTERIOR
GEOLOGICAL SURVEY

Land Office Santa Fe

Lease No. ME 079065

Unit 2000

SUNDRY NOTICES AND REPORTS ON WELLS

NOTICE OF INTENTION TO DRILL.....	SUBSEQUENT REPORT OF WATER SHUT-OFF.....
NOTICE OF INTENTION TO CHANGE PLANS.....	SUBSEQUENT REPORT OF SHOOTING OR ACIDIZING.....
NOTICE OF INTENTION TO TEST WATER SHUT-OFF.....	SUBSEQUENT REPORT OF ALTERING CASING.....
NOTICE OF INTENTION TO RE-DRILL OR REPAIR WELL.....	SUBSEQUENT REPORT OF RE-DRILLING OR REPAIR.....
NOTICE OF INTENTION TO SHOOT OR ACIDIZE.....	SUBSEQUENT REPORT OF ABANDONMENT.....
NOTICE OF INTENTION TO PULL OR ALTER CASING.....	SUPPLEMENTARY WELL HISTORY.....
NOTICE OF INTENTION TO ABANDON WELL.....	

(INDICATE ABOVE BY CHECK MARK NATURE OF REPORT, NOTICE, OR OTHER DATA)

February 14, 1961

Well No. 17-0 is located 880 ft. from N line and 930 ft. from W line of sec. 29
Section 29 T-23N R-19W N.M.P.M.
(1/4 Sec. and Sec. No.) (Twp.) (Range) (Meridian)
Total Gallup San Juan New Mexico
(Field) (County or Subdivision) (State or Territory)

The elevation of the derrick floor above sea level is 5734 ft. O.L.

DETAILS OF WORK

(State names of and expected depths to objective sands; show sizes, weights, and lengths of proposed casings; indicate mudding jobs, cementing points, and all other important proposed work)

Total depth- 5598' P.B.T.D. - 5563'
Run logs: top of Pictured Cliffs- 1415', Cliff House- 3011', Joint Lockout- 3447'
Perforated with 6 shots per foot from 5531-5543
Spotted 700 gals. 17% BM
Set 180 lbs. 5507' of 4 1/2" casing, landed at 5507'
D.V. tool- 1714'
Cemented 1st stage with 250 sacks cement, 2nd stage with 150 sacks cement
Moved in completion unit, drilled cement 2/10/61
Tested for 2 hrs., with 500# pressure
Pipe Clay.

I understand that this plan of work must receive approval in writing by the Geological Survey before operations may be commenced.

Company Asarco Oil and Gas Company

Address Drewer # 570,

Paradise, New Mexico

By ORIGINAL SIGNED BY JOE C. SALMON

Joe C. Salmon

Title District Superintendent

ILLEGIBLE

Form 9-831a
(Feb. 1961)

X			

RECEIVED
FEB 1 1961

(SUBMIT IN TRIPLICATE)
UNITED STATES
DEPARTMENT OF THE INTERIOR
GEOLOGICAL SURVEY

Budget Bureau No. 42-R368.4
Approval expires 12-31-60.

Land Office Santa Fe
Lease No. SM 079065
Unit Magood

SUNDRY NOTICES AND REPORTS ON WELLS

NOTICE OF INTENTION TO DRILL.....	SUBSEQUENT REPORT OF WATER SHUT-OFF.....
NOTICE OF INTENTION TO CHANGE PLANS.....	SUBSEQUENT REPORT OF SHOOTING OR ACIDIZING.....
NOTICE OF INTENTION TO TEST WATER SHUT-OFF.....	SUBSEQUENT REPORT OF ALTERING CASING.....
NOTICE OF INTENTION TO RE-DRILL OR REPAIR WELL.....	SUBSEQUENT REPORT OF RE-DRILLING OR REPAIR.....
NOTICE OF INTENTION TO SHOOT OR ACIDIZE.....	SUBSEQUENT REPORT OF ABANDONMENT.....
NOTICE OF INTENTION TO PULL OR ALTER CASING.....	SUPPLEMENTARY WELL HISTORY.....
NOTICE OF INTENTION TO ABANDON WELL.....	

(INDICATE ABOVE BY CHECK MARK NATURE OF REPORT, NOTICE, OR OTHER DATA)

February 14, 1961

Well No. 17-0 is located 600 ft. from N line and 2300 ft. from W line of sec. 29
NE 1/4 Section 29 T-29N R-13W N.M.P.M.
(1/4 Sec. and Sec. No.) (Twp.) (Range) (Meridian)
Total Gallup San Juan New Mexico
(Field) (County or Subdivision) (State or Territory)

The elevation of the derrick floor above sea level is 5734 ft. 0/1

DETAILS OF WORK

(State names of and expected depths to objective sands; show sizes, weights, and lengths of proposed casings; indicate mudding jobs, cementing points, and all other important proposed work)

P.S.T.D. - 5568'
Sand-Oil found with 15,000' 20/40 sand, 5,000' sand, (10/20) and B&O Hols. oil,
flushed with 230 Hols. oil.
Breakdown pr. - 2200'
Maximum - 2750'
Avg. treating pr. - 2600'
I.S. - 28 bps
5 min. shut-in pr. - 1000'
San 177 lbs., 5531' of 2 1/2" tubing, landed at 5541'
Perforated nipple - 5504-5509
Flowing through tubing.

I understand that this plan of work must receive approval in writing by the Geological Survey before operations may be commenced.

Company Axtor Oil and Gas Company

Address Drawer # 570

Farrington, New Mex.

By ORIGINAL SIGNED BY JOE C. SALMON

Joe C. Salmon

Title District Superintendent

ILLEGIBLE

X			

(SUBMIT IN TRIPLICATE)

UNITED STATES
DEPARTMENT OF THE INTERIOR
GEOLOGICAL SURVEY

Land Office **Santa Fe**
Lease No. **SM 079065**
Unit **Regood**

SUNDRY NOTICES AND REPORTS ON WELLS

NOTICE OF INTENTION TO DRILL.....	SUBSEQUENT REPORT OF WATER SHUT-OFF.....
NOTICE OF INTENTION TO CHANGE PLANS.....	SUBSEQUENT REPORT OF SHOOTING OR ACIDIZING.....
NOTICE OF INTENTION TO TEST WATER SHUT-OFF.....	SUBSEQUENT REPORT OF ALTERING CASING.....
NOTICE OF INTENTION TO RE-DRILL OR REPAIR WELL.....	SUBSEQUENT REPORT OF RE-DRILLING OR REPAIR.....
NOTICE OF INTENTION TO SHOOT OR ACIDIZE.....	SUBSEQUENT REPORT OF ABANDONMENT.....
NOTICE OF INTENTION TO PULL OR ALTER CASING.....	SUPPLEMENTARY WELL HISTORY.....
NOTICE OF INTENTION TO ABANDON WELL.....	

(INDICATE ABOVE BY CHECK MARK NATURE OF REPORT, NOTICE, OR OTHER DATA)

February 14, 1961

Well No. **17-0** is located **880** ft. from **N** line and **2300** ft. from **W** line of sec. **29**
NE 1/4 Section 29 (1/4 Sec. and Sec. No.) **T-23N R-13W** (Twp.) (Range) **N.M.P.M.** (Meridian)
Total Gallup (Field) **San Juan** (County or Subdivision) **New Mexico** (State or Territory)

The elevation of the derrick floor above sea level is **5734** ft. **0/L**

DETAILS OF WORK

(State names of and expected depths to objective sands; show sizes, weights, and lengths of proposed casings; indicate mudding jobs, cementing points, and all other important proposed work)

P.M.P.D. - 5568'
 Sand-Oil fraced with 15,000# 20/40 sand, 5,000# sand, (10/20) and 240 Hbls. oil,
 Flushed with 830 Hbls. oil.
 Breakdown pr. - 2200#
 Maximum - 2750#
 Avg. treating pr. - 2600#
 I.R. - 28 bpm
 5 min. shut-in pr. - 1000#
 Has 177 lbs., 5531' of 2 1/8" tubing, landed at 5941'
 Perforated slip. - 5906-5909
 Flowing through tubing.

I understand that this plan of work must receive approval in writing by the Geological Survey before operations may be commenced.

Company **Antec Oil and Gas Company**

Address **Drawer # 370**

Farmington, New Mex.

ORIGINAL SIGNED BY JOE C. SALMON

By **Joe C. Salmon**
 Title **District Superintendent**

U. S. LAND OFFICE **Santa Fe**
SERIAL NUMBER **NM 079065**
LEASE OR PERMIT TO PROSPECT _____
Hagood

UNITED STATES
DEPARTMENT OF THE INTERIOR
GEOLOGICAL SURVEY

LOG OF OIL OR GAS WELL

LOCATE WELL CORRECTLY

Company Artec Oil and Gas Company Address Dresser # 570, Farmington, New Mex.
Lessor or Tract Magood Field Total Gallup State New Mexico
Well No. 17-4 Sec. 29 T. 29N R. 13W Meridian N.M.P.M. County San Juan
Location 880 ft. ^{XX} S. of N Line and 2300 ft. ^{XX} E. of W Line of Section 29 Elevation 5734 G.L.
(Mark first relative to corner)

The information given herewith is a complete and correct record of the well and all work done thereon so far as can be determined from all available records.

Signed ORIGINAL SIGNED BY JOE C. SALMON

Date February 21, 1961 Title Joe C. Salmon
District Superintendent

The summary on this page is for the condition of the well at above date.

Commenced drilling 1/30/61, 1961 Finished drilling 2/8/61, 1961

OIL OR GAS SANDS OR ZONES

(Denote gas by G)

No. 1, from 5531 to 5543 No. 4, from _____ to _____
 No. 2, from _____ to _____ No. 5, from _____ to _____
 No. 3, from _____ to _____ No. 6, from _____ to _____

IMPORTANT WATER SANDS

No. 1, from _____ to _____

No. 2, from _____ to _____

No. 3, from _____ to _____

No. 4, from _____ to _____

CASING RECORD

Size casting	Weight per foot	Threads per inch	Make	Amount	Kind of shoe	Cut and pulled from	Perforated		Purpose
							From—	To—	
0 7/8	4.6	8	1-33	339	one kind of material used' position	and location of binding of or pulling			
1 3/8	5.5	8	1-33	339	"the men are never glassed" and	of the men's position' and manner			
2 3/8	7.7	8	1-33	339	any changes made in the casing	where they stand if they cover all			
					of the men' biggest size in q	on the side of body and torso			
HISTORY OF ONE OR TWO MEN									
							IN ORDER TO BE COMPLETED EARLIER DATE		

MUDDING AND CEMENTING RECORD

Size casing	Where set	Number sacks of cement	Method used	Mud gravity	Amount of mud used
8 5/8	329	235	displacement two plug		
4 1/2	3297	400			
2 3/8	3241	---			

PLUGS AND ADAPTERS

Heaving plug—Material	Length	Depth set
Adapters—Material	Size	

SHOOTING RECORD

Size	Shell used	Explosive used	Quantity	Date	Depth shot	Depth cleaned out
<p>Sand-Oil fraced with 15,000# sand, 20/40 5,000# sand (10/29) 840 Hbls. oil, Flushed with 230 Hbls oil. Breakdown pr. 2200#, Maximum - 2750#, Avg. treating pr. 2600#</p> <p>I.R. - 26 bpm, 5 min. shut in- 1000#</p>						

TOOLS USED

Rotary tools were used from 0 feet to 5598 feet, and from _____ feet to _____ feet

Cable tools were used from 0 feet to 5568 feet, and from _____ feet to _____ feet

DATES

Put to producing 2/17/61, 19

The production for the first 24 hours was 345.51 barrels of fluid of which 100 % was oil; 0 % emulsion; 0 % water; and 0 % sediment. Gravity, °Bé. _____

If gas well, cu. ft. per 24 hours ----- Gallons gasoline per 1,000 cu. ft. of gas -----

FOLD | MARK

No. 1, from _____ to _____ No. 3, from _____ to _____

Size casing	Weight per foot	Threads per inch	Make	Amount	Kind of shoe	Cut and pulled from	Perforated		Purpose
							From—	To—	
8 5/8	24	8rd	J-55	377	one kind of metal	central pump location	and change of boundary	of perforation	
4 1/2	9.5	8rd	J-55	155	one kind of metal	central pump location	and change of boundary	of perforation	
2 3/8	4.7	8rd	J-55	333	one kind of metal	central pump location	and change of boundary	of perforation	
HISTORY OF OIL OR GAS WELL									
							IN 1900-5	IN 1905-10	IN 1910-15

Size casing	Where set	Number sacks of cement	Method used	Mud gravity	Amount of mud used
8 5/8	329	235	displacement taper plug		
4 1/2	5597	400			
2 3/8	5541	--			

Heaving plug—Material	Length	Depth set
Adapters—Material	Size	

Size	Shell used	Explosive used	Quantity	Date	Depth shot	Depth cleaned out
Sand-Oil fraced with 15,000# sand,	29/40	5,000# sand	(10/20)	840 Hbls.	oil, Flushed with	
230 Hbls oil. Breakdown pr. 2200#		Maximum - 2750#	Avg. treating pr. 2600#			
I.R. - 28 bpm, 5 min. shut in- 1000#						

Rotary tools were used from 0 feet to 5598 feet, and from _____ feet to _____ feet
Cable tools were used from 0 feet to 5568 feet, and from _____ feet to _____ feet

-----, 19-----	Put to producing ----- <u>2/17/61</u> -----, 19-----
The production for the first 24 hours was <u>345.51</u> barrels of fluid of which <u>100</u> % was oil; <u>0</u> % emulsion; <u>0</u> % water; and <u>0</u> % sediment.	Gravity, °Bé. -----
If gas well, cu. ft. per 24 hours -----	Gallons gasoline per 1,000 cu. ft. of gas -----
Rock pressure, lbs. per sq. in. -----	

		, Driller	, Driller
		, Driller	, Driller

FROM—	TO—	TOTAL FEET	FORMATION
0	255	255	surface
255	531	276	sand and shale
531	2776	2245	sand and shale
2776	3320	544	sand and shale
3320	4048	728	sand and shale
4048	4976	928	sand and shale
4976	5388	412	sand and shale
5388	5590	202	sand and shale

PICTURED CLIFFS - 1416, CLIFF HOUSE - 2007, POINT LOOKOUT - 3947, GALLUP - 5160

NEW MEXICO OIL CONSERVATION COMMISSION
SANTA FE, NEW MEXICO

Form C-110
Revised 7/1/55

(File the original and 4 copies with the appropriate district office)

CERTIFICATE OF COMPLIANCE AND AUTHORIZATION
TO TRANSPORT OIL AND NATURAL GAS

Company or Operator Astec Oil and Gas Company Lease Good

Well No. 17-G Unit Letter C S 29 T89E R 13W Pool Totah Gallup

County San Juan Kind of Lease (State, Fed. or Patented) Fed.

If well produces oil or condensate, give location of tanks: Unit S T R

Authorized Transporter of Oil or Condensate El Paso Natural Gas Products Company

Address Box # 1161, El Paso, Texas, (via Luna-Harves Trucking)
(Give address to which approved copy of this form is to be sent)

Authorized Transporter of Gas _____

Address _____ Date Connected _____
(Give address to which approved copy of this form is to be sent)

If Gas is not being sold, give reasons and also explain its present disposition:

Reasons for Filing: (Please check proper box) New Well ☒

Change in Transporter of (Check One): Oil () Dry Gas () C'head () Condensate ()

Change in Ownership () Other ()

Remarks: _____ (Give explanation below)

The undersigned certifies that the Rules and Regulations of the Oil Conservation Commission have been complied with.

Executed this the 21 day of February 19 61

ORIGINAL SIGNED BY JOE C. SALMON
By Joe C. Salmon

Approved _____ 19 _____

Title District Superintendent

OIL CONSERVATION COMMISSION

Company Astec Oil and Gas Company

By Original Signed Emery C. Arnold

Address Drewer # 570, Farmington, New Mex.

Title Supervisor Dist. # 3

NUMBER OF COPIES RECEIVED	
DISTRIBUTION	
SANTA FE	
FILE	
U.S.G.S.	
LAND OFFICE	
TRANSPORTER	OIL GAS
PRODUCTION OFFICE	
OPERATOR	

NEW MEXICO OIL CONSERVATION COMMISSION Santa Fe, New Mexico

(Form C-104)
Revised 7/1/57

REQUEST FOR (OIL) - ~~XXXX~~ ALLOWABLE

New Well
~~Recompletion~~

This form shall be submitted by the operator before an initial allowable will be assigned to any completed Oil or Gas well. Form C-104 is to be submitted in QUADRUPPLICATE to the same District Office to which Form C-101 was sent. The allowable will be assigned effective 7:00 A.M. on date of completion or recompletion, provided this form is filed during calendar month of completion or recompletion. The completion date shall be that date in the case of an oil well when new oil is delivered into the stock tanks. Gas must be reported on 15.025 psia at 60° Fahrenheit.

Farmington, New Mexico February 21, 1961
(Place) (Date)

WE ARE HEREBY REQUESTING AN ALLOWABLE FOR A WELL KNOWN AS:

Astec Oil and Gas Company (Company or Operator) **Bigood** (Owner), Well No. **17-0**, in **NW** 1/4, 1/4.

C (Unit Letter), Sec. **29**, T. **29N**, R. **13W**, NMPM., **Total Gallup** Pool

San Juan

County. Date Spudded **1/30/61** Date Drilling Completed **2/8/61**

Please indicate location:

Elevation **5734 S.L.** Total Depth **5998** PBD **5568**

Top Oil/Gas Pay **5160** Name of Prod. Form. **Gallup**

PRODUCING INTERVAL -

Perforations **5532 - 5543 with 6 shots per foot**

Open Hole Depth **5998** Casing Shoe **5997** Depth **5541** Tubing

OIL WELL TEST -

Natural Prod. Test: _____ bbls. oil, _____ bbls. water in _____ hrs, _____ min. Size _____ Choke

Test After Acid or Fracture Treatment (after recovery of volume of oil equal to volume of load oil used): **345.51** bbls. oil, **0** bbls. water in **24** hrs, **--** min. Size **20/64** Choke

GAS WELL TEST -

Natural Prod. Test: _____ MCF/Day; Hours flowed _____ Choke Size _____

Method of Testing (pilot, back pressure, etc.): _____

Test After Acid or Fracture Treatment: _____ MCF/Day; Hours flowed _____

Choke Size _____ Method of Testing: _____

Acid or Fracture Treatment (Give amounts of materials used, such as acid, water, oil, and sand): **sand-oil fraced w/ 20,000# sand and 850 bbls. oil, flush with 230 bbls. oil**

Casing Tubing Date first new **2/17/61**
Press. Press. oil run to tanks

Oil Transporter **El Paso Natural Gas Products Co. (via Luna-Eaves Truckin**

Gas Transporter _____

Remarks: _____

I hereby certify that the information given above is true and complete to the best of my knowledge.

Approved **February 21, 1961** **Astec Oil and Gas Company** (Company or Operator)

OIL CONSERVATION COMMISSION

ORIGINAL SIGNED BY JOE C. SALMON

By: **Joe C. Salmon** (Signature)

By: (Original Signed) **Emery C. Arnold**

Title: **District Superintendent**

Send Communications regarding well to:

Title **Supervisor Dist. # 3**

Name: **Astec Oil and Gas Company**

Address: **Drawer # 570, Farmington, N.Mex.**

NEW MEXICO OIL CONSERVATION COMMISSION
SANTA FE, NEW MEXICO

Form C-110
Revised 7/1/55

(File the original and 4 copies with the appropriate district office)

CERTIFICATE OF COMPLIANCE AND AUTHORIZATION
TO TRANSPORT OIL AND NATURAL GAS

Company or Operator Astec Oil and Gas Company Lease Leased

Well No. 17-0 Unit Letter C S 29W T 29W R 13W Pool Totah Gallup

County San Juan Kind of Lease (State, Fed. or Patented) Federal

If well produces oil or condensate, give location of tanks: Unit S T R

Authorized Transporter of Oil or Condensate Four Corners Pipe Line Co.

Address Box 2648, Houston 1, Texas

(Give address to which approved copy of this form is to be sent)

Authorized Transporter of Gas _____

Address _____ Date Connected _____

(Give address to which approved copy of this form is to be sent)

If Gas is not being sold, give reasons and also explain its present disposition:

Reasons for Filing: (Please check proper box) New Well ()

Change in Transporter of (Check One): Oil ☒ Dry Gas ☐ C'head ☐ Condensate ☐

Change in Ownership ☐ Other ☐

Remarks: _____ (Give explanation below)

The undersigned certifies that the Rules and Regulations of the Oil Conservation Commission have been complied with.

Executed this the 1 day of March 19 61

By ORIGINAL SIGNED BY JOE C. SALMON

Joe C. Salmon

Approved MAR 2 1961 19 61

Title District Superintendent

OIL CONSERVATION COMMISSION

By Original Signed Emery C. Arnold

Company Astec Oil and Gas Company

Title Supervisor Dist. # 3

Address Drawer 570, Farmington, N.M.

Well Location and Acreage Dedication Plat

SECTION A.

Date **January 16, 1961**

Operator **Astec Oil and Gas Company** Lease **Hagood**
 Well No **17-0** Unit Letter **C** Section **29** Township **29N** Range **13W** NM
 Located **880** Feet From **North** Line **2300** Feet From **West**
 County **San Juan** G. L. Elevation **5734** Dedicated Acreage **80** A
 Name of Producing Formation **Gallup** Pool **Total**

1. Is the Operator the only owner* in the dedicated acreage outlined in the plat below? **XXX** No
2. If the answer to question One is "No," have the interests of all the owners been consolidated by community agreement or otherwise? Yes **No** If answer is "Yes" Type of Consolidation
3. If the answer to question Two is "No" list all the owners and their respective interests below

OWNER

LAND DEPARTMENT

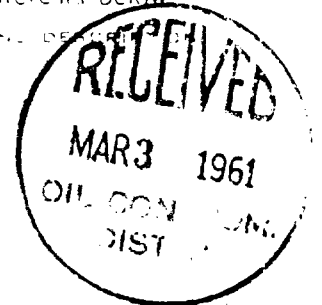

SECTION B.

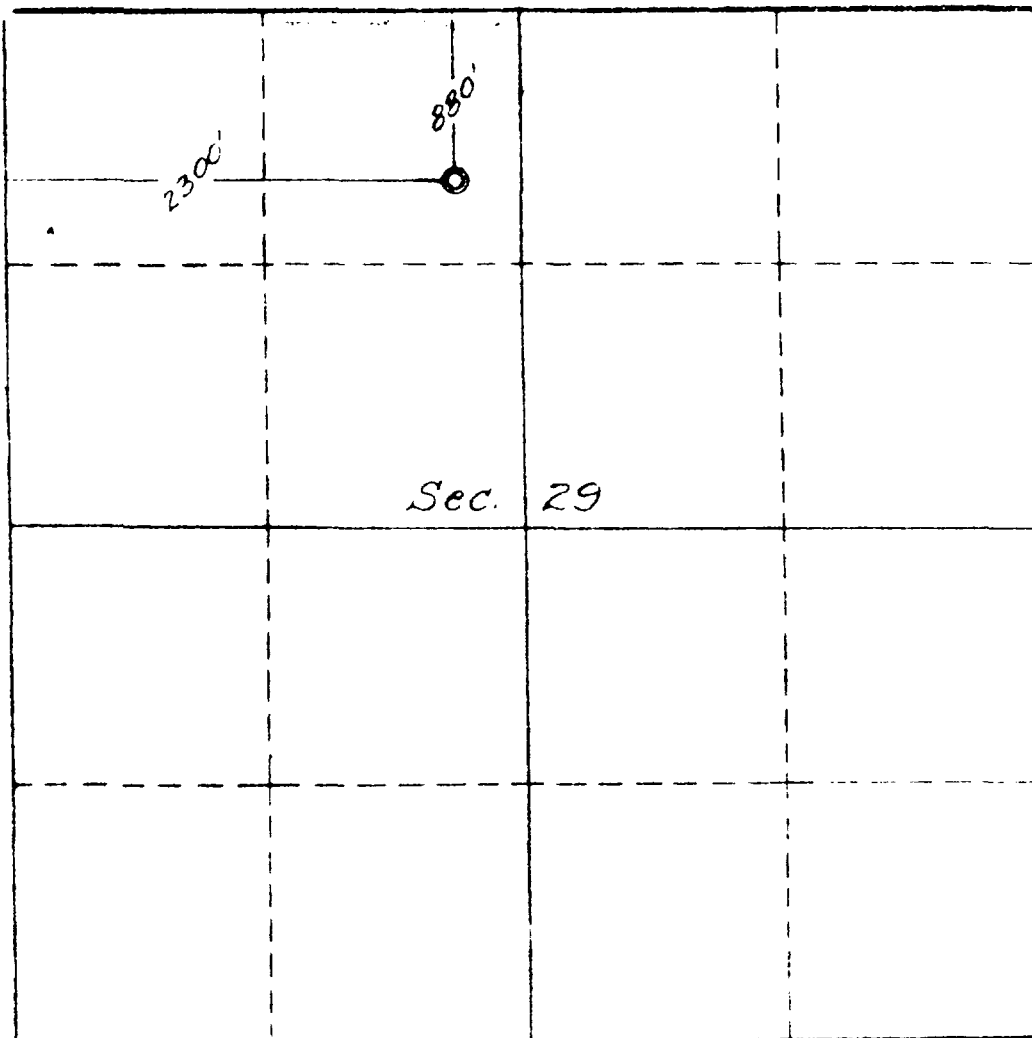

The undersigned certifies that the information furnished in Section A above is true and complete to the best of my knowledge and belief.

Astec Oil and Gas Company

ORIGINAL SIGNED BY **IQE.C. SALMON**

Drawer 570, Farmington, N.M.

The undersigned certifies that the well shown on the plat is located within the dedicated acreage and that the information furnished in Section A above is true and complete to the best of my knowledge and belief.

1-17-61

Four States Engineering Co.

Permit No. **1545**

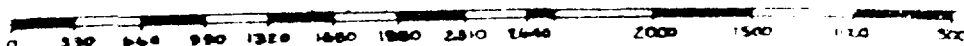

NUMBER OF COPIES RECEIVED	
DISTRIBUTION	
SANTA FE	
FILE	
U.S.S.	
LAND OFFICE	
TRANSPORTER	OIL
	GAS
PRODUCTION OFFICE	
OPERATOR	

NEW MEXICO OIL CONSERVATION COMMISSION
SANTA FE, NEW MEXICO
CERTIFICATE OF COMPLIANCE AND AUTHORIZATION
TO TRANSPORT OIL AND NATURAL GAS

FORM C-110
 (Rev. 7-60)

BT

FILE THE ORIGINAL AND 4 COPIES WITH THE APPROPRIATE OFFICE

Company or Operator AZTEC OIL AND GAS COMPANY				Lease ENGWOOD "B"		Well No. 17	
Unit Letter C	Section 29	Township 29N	Range 13W	County San Juan			
Pool Totah Gallup				Kind of Lease (State, Fed, Fee) Federal			
If well produces oil or condensate give location of tanks		Unit Letter 0	Section 29	Township 29	Range 13		
Authorized transporter of oil <input checked="" type="checkbox"/> or condensate <input type="checkbox"/> Four Corners Pipeline				Address (give address to which approved copy of this form is to be sent) Box # 1588, Farmington, New Mexico			
Is Gas Actually Connected? Yes <input checked="" type="checkbox"/> No <input type="checkbox"/>							
Authorized transporter of casing head gas <input checked="" type="checkbox"/> or dry gas <input type="checkbox"/>		Date Connected 9/15/61	Address (give address to which approved copy of this form is to be sent) P.O. Box # 5426, Tulsa, Oklahoma				
Jalou Gas Co., Inc.,							

If gas is not being sold, give reasons and also explain its present disposition:

REASON(S) FOR FILING (please check proper box)

New Well ☐ Change in Ownership ☐
 Change in Transporter (check one) Other (explain below)
 Oil ☐ Dry Gas ☐
 Casing head gas ☒ Condensate ☐



Remarks

The undersigned certifies that the Rules and Regulations of the Oil Conservation Commission have been complied with.

Executed this the 29th day of November, 19 61.

OIL CONSERVATION COMMISSION		By	
Approved by Original Signed By A. R. KENDRICK		Title Production Foreman	
Title PETROLEUM ENGINEER DIST NO. 3		Company Aztec Oil & Gas Company	
Date DEC 1 1961		Address Drewer # 570, Farmington, New Mexico	

NUMBER OF COPIES RECEIVED	
DISTRIBUTION	
SANTA FE	
FILE	
U.S.G.S.	
LAND OFFICE	
TRANSPORTER	OIL GAS
PRODUCTION OFFICE	
OPERATOR	

NEW MEXICO OIL CONSERVATION COMMISSION
SANTA FE, NEW MEXICO
**CERTIFICATE OF COMPLIANCE AND AUTHORIZATION
TO TRANSPORT OIL AND NATURAL GAS**

FORM C-110
(Rev. 7-60)

[Signature]

FILE THE ORIGINAL AND 4 COPIES WITH THE APPROPRIATE OFFICE

Company or Operator AZTEC OIL AND GAS COMPANY				Lease AZTEC TOTAL UNIT		Well No. 4	
Unit Letter C	Section 29	Township 29N	Range 13W	County San Juan			
Pool Totah Gallup				Kind of Lease (State, Fed, Fee) Fed.			

If well produces oil or condensate give location of tanks	Unit Letter 0	Section 29	Township 29	Range 13
--	-------------------------	----------------------	-----------------------	--------------------

Authorized transporter of oil <input type="checkbox"/> or condensate <input type="checkbox"/>	Address (give address to which approved copy of this form is to be sent)
---	--

Is Gas Actually Connected? Yes _____ No _____

Authorized transporter of casing head gas <input type="checkbox"/> or dry gas <input type="checkbox"/>	Date Connected	Address (give address to which approved copy of this form is to be sent)
--	----------------	--

If gas is not being sold, give reasons and also explain its present disposition:

REASON(S) FOR FILING (please check proper box)

New Well <input type="checkbox"/>	Change in Ownership <input type="checkbox"/>
Change in Transporter (check one)	Other (explain below)
Oil <input type="checkbox"/> Dry Gas <input type="checkbox"/>	Change of Name.....XX
Casing head gas . <input type="checkbox"/> Condensate.. <input type="checkbox"/>	

Remarks

This well formerly named the Hagood 17-0

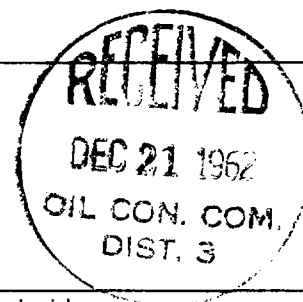

The undersigned certifies that the Rules and Regulations of the Oil Conservation Commission have been complied with.

Executed this the 18th day of December, 19 62.

OIL CONSERVATION COMMISSION		By
Approved by	Original Signed by W. B. Smith	ORIGINAL SIGNED BY JOE C. SALMON
Title	DEPUTY OIL & GAS INSPECTOR DIST. NO. 3	Title Joe C. Salmon District Superintendent
Date	DEC 21 1962	Company Astec Oil & Gas Company
		Address Drawer # 570, Farmington, New Mexico

NUMBER OF COPIES RECEIVED	
DISTRIBUTION	
SANTA FE	
FILE	
U.S.G.S.	
LAND OFFICE	
TRANSPORTER	OIL
	GAS
PRODUCTION OFFICE	
OPERATOR	

NEW MEXICO OIL CONSERVATION COMMISSION
SANTA FE, NEW MEXICO
CERTIFICATE OF COMPLIANCE AND AUTHORIZATION
TO TRANSPORT OIL AND NATURAL GAS

FORM C-110
 (Rev. 7-60)

FILE THE ORIGINAL AND 4 COPIES WITH THE APPROPRIATE OFFICE

Company or Operator AZTEC OIL AND GAS COMPANY				Lease AZTEC TOTAL UNIT		Well No. 4
Unit Letter C	Section 29	Township 29N	Range 13W	County San Juan		

Pool Total Gallup				Kind of Lease (State, Fed, Fee) Fed.		
If well produces oil or condensate give location of tanks		Unit Letter C	Section 29	Township 29N	Range 13W	

Authorized transporter of oil <input checked="" type="checkbox"/> or condensate <input type="checkbox"/>	Address (give address to which approved copy of this form is to be sent)
Four Corners Pipeline, Inc.	Box # 1588, Farmington, New Mexico

Is Gas Actually Connected? Yes ☒ No ☐

Authorized transporter of casing head gas <input checked="" type="checkbox"/> or dry gas <input type="checkbox"/>	Date Connected 9/15/61	Address (give address to which approved copy of this form is to be sent)
Jalou Gas Co., Inc.		Box # 5426, Tulsa, Oklahoma

If gas is not being sold, give reasons and also explain its present disposition:

REASON(S) FOR FILING (please check proper box)

- | | |
|--|--|
| New Well <input type="checkbox"/> | Change in Ownership <input type="checkbox"/> |
| Change in Transporter (check one) | Other (explain below) |
| Oil <input type="checkbox"/> Dry Gas <input type="checkbox"/> | Change of Name-----XX |
| Casing head gas <input type="checkbox"/> Condensate <input type="checkbox"/> | |

Remarks

This well was formerly named the Hagood 17-G
Now changed to Aztec Total Unit # 4

(Corrected Copy)

The undersigned certifies that the Rules and Regulations of the Oil Conservation Commission have been complied with.

Executed this the 12th day of February, 19 63.

OIL CONSERVATION COMMISSION		By
Approved by	Original Signed by W. D. Smith	Title B. H. Means
Title	DEPUTY OIL & GAS INSPECTOR DIST. NO. 3	Company Aztec Oil & Gas Company
Date	FEB 13 1963	Address Drawer # 570, Farmington, New Mexico

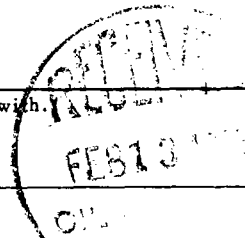

UNITED STATES
DEPARTMENT OF THE INTERIOR
GEOLOGICAL SURVEY

APPLICATION FOR PERMIT TO DRILL, DEEPEN, OR PLUG BACK

1a. TYPE OF WORK

DRILL ☒ REPAIR HOLE ☐ DEEPEN ☐ PLUG BACK ☐

b. TYPE OF WELL

OIL WELL ☐ GAS WELL ☒ OTHER ☐ SINGLE ZONE ☐ MULTIPLE ZONE ☐

2. NAME OF OPERATOR

Anzac Oil & Gas Company

3. ADDRESS OF OPERATOR

Drawer 570, Farmington, New Mexico

4. LOCATION OF WELL (Report location clearly and in accordance with any State requirements.)*

At surface 380' FWL 2300 FWL

At proposed prod. zone

14. DISTANCE IN MILES AND DIRECTION FROM NEAREST TOWN OR POST OFFICE*

15. DISTANCE FROM PROPOSED*

LOCATION TO NEAREST
PROPERTY OR LEASE LINE, FT.
(Also to nearest drlg. unit line, if any)18. DISTANCE FROM PROPOSED LOCATION*
TO NEAREST WELL, DRILLING, COMPLETED,
OR APPLIED FOR, ON THIS LEASE, FT.

16. NO. OF ACRES IN LEASE

19. PROPOSED DEPTH

17. NO. OF ACRES ASSIGNED
TO THIS WELL

20. ROTARY OR CABLE TOOLS

21. ELEVATIONS (Show whether DF, RT, GR, etc.)

573' Ground Elevation

22. APPROX. DATE WORK WILL START*

23.

PROPOSED CASING AND CEMENTING PROGRAM

SIZE OF HOLE	SIZE OF CASING	WEIGHT PER FOOT	SETTING DEPTH	QUANTITY OF CEMENT

Full tubing. Check for hole in casing. In case hole is encountered, it
will be squeezed off. Re-run tubing.

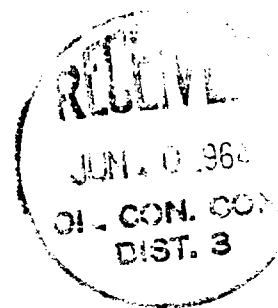

IN ABOVE SPACE DESCRIBE PROPOSED PROGRAM: If proposal is to deepen or plug back, give data on present productive zone and proposed new productive zone. If proposal is to drill or deepen directionally, give pertinent data on subsurface locations and measured and true vertical depths. Give blowout preventer program, if any.

24.

SIGNED

TITLE

District Engineer

DATE

6-10-64

(This space for Federal or State office use)

PERMIT NO.

APPROVAL DATE

APPROVED BY

TITLE

DATE

CONDITIONS OF APPROVAL, IF ANY:

DEPARTMENT OF THE INTERIOR
GEOLOGICAL SURVEY

SUNDRY NOTICES AND REPORTS ON WELLS

(Do not use this form for proposals to drill or to deepen or plug back to a different reservoir.
Use "APPLICATION FOR PERMIT" for such proposals.)

1. OIL WELL <input checked="" type="checkbox"/> GAS WELL <input type="checkbox"/> OTHER <input type="checkbox"/>		6. CESS DESIGNATION AND SERIAL NO. ST 072065	
2. NAME OF OPERATOR Artco Oil & Gas Company		7. UNIT AGREEMENT NAME	
3. ADDRESS OF OPERATOR Dumas #570, Farmington, New Mexico		8. FARM OR LEASE NAME ARTCO TOWNE UNIT	
4. LOCATION OF WELL (Report location clearly and in accordance with any State requirements. See also space 17 below.) At surface 880 FWL 2300 FWL		9. WELL NO. 4	
14. PERMIT NO.		10. FIELD AND POOL, OR WILDCAT TOWNE GALLUP	
15. ELEVATIONS (Show whether DF, RT, GR, etc.) 5734' Ground		11. SEC., T., R., M., OR BLE. AND SURVEY OR AREA Sec. 23, T29N, R13W	
		12. COUNTY OR PARISH San Juan	
		13. STATE New Mexico	

16. Check Appropriate Box To Indicate Nature of Notice, Report, or Other Data

NOTICE OF INTENTION TO:		SUBSEQUENT REPORT OF:	
TEST WATER SHUT-OFF <input type="checkbox"/>	PULL OR ALTER CASING <input type="checkbox"/>	WATER SHUT-OFF <input type="checkbox"/>	REPAIRING WELL <input type="checkbox"/>
FRACTURE TREAT <input type="checkbox"/>	MULTIPLE COMPLETE <input type="checkbox"/>	FRACTURE TREATMENT <input type="checkbox"/>	ALTERING CASING <input type="checkbox"/>
SHOOT OR ACIDIZE <input type="checkbox"/>	ABANDON* <input type="checkbox"/>	SHOOTING OR ACIDIZING <input type="checkbox"/>	ABANDONMENT* <input type="checkbox"/>
REPAIR WELL <input type="checkbox"/>	CHANGE PLANS <input type="checkbox"/>	(Other) REPAIR WELL IN CASING	
(Other)		(NOTE: Report results of multiple completion on Well Completion or Recompletion Report and Log form.)	

17. DESCRIBE PROPOSED OR COMPLETED OPERATIONS (Clearly state all pertinent details, and give pertinent dates, including estimated date of starting any proposed work. If well is directionally drilled, give subsurface locations and measured and true vertical depths for all markers and zones pertinent to this work.) *

6-9-64 Moved On Workover Rig
6-10-64 Run Casing Inspection Log. Found 10 to 12 holes from 2750-3590.
Set Bridge Plug 5450. Set packer at 2536. Squeezed hole with 150 sacks WOC 18 hours.
Cleaned out cement. Pressured casing to 1600#. Would not hold. Reset packer 2536.
Squeezed holes with 100 sacks. WOC 18 hours. Cleaned out cement. Pressured to 1600#.
Casing held O.K. Drilled Bridge Plug and cleaned out. Run tubing, rods, and pump.
Moved Off Workover Rig



18. I hereby certify that the foregoing is true and correct

SIGNED **ORIGINAL SIGNED BY JOE C. SALMON** TITLE **District Superintendent** DATE **6-17-64**

(This space for Federal or State office use)

APPROVED BY _____ TITLE _____ DATE _____

CONDITIONS OF APPROVAL, IF ANY:

*See Instructions on Reverse Side

UNITED STATES
DEPARTMENT OF THE INTERIOR
GEOLOGICAL SURVEY

SUBMIT IN TRIPLICATE*
(Other instructions on re-
verse side)

Form approved.
Budget Bureau No. 42-R1424.

SUNDRY NOTICES AND REPORTS ON WELLS

(Do not use this form for proposals to drill or to deepen or plug back to a different reservoir.
Use "APPLICATION FOR PERMIT—" for such proposals.)

1. OIL WELL <input checked="" type="checkbox"/> GAS WELL <input type="checkbox"/> OTHER <input type="checkbox"/>	5. LEASE DESIGNATION AND SERIAL NO. <u>NM-079065</u>
2. NAME OF OPERATOR <u>Astec Oil & Gas Company</u>	6. IF INDIAN, ALLOTTEE OR TRIBE NAME
3. ADDRESS OF OPERATOR <u>Drawer 570, Farmington, New Mexico</u>	7. UNIT AGREEMENT NAME
4. LOCATION OF WELL (Report location clearly and in accordance with any State requirements.* See also space 17 below.) At surface <u>380 ENL & 2300 ENL, Section 29-29-13</u>	8. FARM OR LEASE NAME <u>Astec Totah Unit</u>
14. PERMIT NO.	9. WELL NO. <u>#4</u>
15. ELEVATIONS (Show whether DF, RT, GR, etc.) <u>5734 Gr</u>	10. FIELD AND POOL, OR WILDCAT <u>Totah Gallup</u>
	11. SEC., T., R., M., OR BLK. AND SURVEY OR AREA <u>Section 29-29-13</u>
	12. COUNTY OR PARISH <u>San Juan</u>
	13. STATE <u>New Mexico</u>

Check Appropriate Box To Indicate Nature of Notice, Report, or Other Data

NOTICE OF INTENTION TO:

TEST WATER SHUT-OFF	<input type="checkbox"/>	PULL OR ALTER CASING	<input type="checkbox"/>
FRACTURE TREAT	<input type="checkbox"/>	MULTIPLE COMPLETE	<input type="checkbox"/>
SHOOT OR ACIDIZE	<input type="checkbox"/>	ABANDON*	<input type="checkbox"/>
REPAIR WELL	<input checked="" type="checkbox"/>	CHANGE PLANS	<input type="checkbox"/>
(Other)	<input type="checkbox"/>		<input type="checkbox"/>

SUBSEQUENT REPORT OF:

WATER SHUT-OFF	<input type="checkbox"/>	REPAIRING WELL	<input type="checkbox"/>
FRACTURE TREATMENT	<input type="checkbox"/>	ALTERING CASING	<input type="checkbox"/>
SHOOTING OR ACIDIZING	<input type="checkbox"/>	ABANDONMENT*	<input type="checkbox"/>
(Other)	<input type="checkbox"/>		<input type="checkbox"/>

(NOTE: Report results of multiple completion on Well Completion or Recompletion Report and Log form.)

17. DESCRIBE PROPOSED OR COMPLETED OPERATIONS (Clearly state all pertinent details, and give pertinent dates, including estimated date of starting any proposed work. If well is directionally drilled, give subsurface locations and measured and true vertical depths for all markers and zones pertinent to this work.)*

PROPOSE TO: Squeeze off existing perforations 5531-5543.
Reperforate 5484-5494.
San oil frac rerun tubing and rods. Put back on pump.



RECEIVED

SEP 25 1969

U. S. GEOLOGICAL SURVEY
FARMINGTON, N. M.

18. I hereby certify that the foregoing is true and correct

SIGNED

W. C. Allen Jr.

TITLE

District Superintendent

DATE

September 24, 1969

(This space for Federal or State office use)

APPROVED BY

TITLE

DATE

CONDITIONS OF APPROVAL, IF ANY:

*See Instructions on Reverse Side

UNITED STATES
DEPARTMENT OF THE INTERIOR
GEOLOGICAL SURVEYSUBMIT IN TRIPLICATE*
(Other instructions on re-
verse side)Form approved.
Budget Bureau No. 42-R1424.

6. LEASE DESIGNATION AND SERIAL NO.

SF-079065

8. IF INDIAN, ALLOTTEE OR TRIBE NAME

7. UNIT AGREEMENT NAME

9. FARM OR LEASE NAME

Aztec Totah Unit

10. WELL NO.

#4

11. FIELD AND POOL, OR WILDCAT

Totah Gallup

12. SEC., T., R., M., OR BLK. AND
SURVEY OR AREA

Section 29-29N-13W

13. COUNTY OR PARISH

San Juan

New Mexico

SUNDRY NOTICES AND REPORTS ON WELLS

(Do not use this form for proposals to drill or to deepen or plug back to a different reservoir.
Use "APPLICATION FOR PERMIT—" for such proposals.)1. OIL WELL ☒ GAS WELL ☐ OTHER ☐

2. NAME OF OPERATOR

Aztec Oil and Gas Company

3. ADDRESS OF OPERATOR

Drawer 570, Farmington, New Mexico

4. LOCATION OF WELL (Report location clearly and in accordance with any State requirements.
See also space 17 below.)

At surface

880 ENL & 2500 FWL, Section 29-29N-13W

14. PERMIT NO.

15. ELEVATIONS (Show whether DF, RT, GR, etc.)

5734 Gr

16. Check Appropriate Box To Indicate Nature of Notice, Report, or Other Data

NOTICE OF INTENTION TO:

TEST WATER SHUT-OFF

FRACTURE TREAT

SHOOT OR ACIDIZE

REPAIR WELL

(Other)

PULL OR ALTER CASING

MULTIPLE COMPLETE

ABANDON*

CHANGE PLANS

SUBSEQUENT REPORT OF:

WATER SHUT-OFF

FRACTURE TREATMENT

SHOOTING OR ACIDIZING

(Other)

REPAIRING WELL

ALTERING CASING

ABANDONMENT*

(Note: Report results of multiple completion on Well
Completion or Recompletion Report and Log form.)17. DESCRIBE PROPOSED OR COMPLETED OPERATIONS (Clearly state all pertinent details, and give pertinent dates, including estimated date of starting any
proposed work. If well is directionally drilled, give subsurface locations and measured and true vertical depths for all markers and zones perti-
nent to this work.)*9-25-69 Pulled rods and tubing. Went in to. Ran ez drill. Packer set at 420'.
Came out and picked up drill collars, casing scraper, & bit. Drlg on
packer.9-26-69 Drlg packer out. Cleaned out to TD. Went in with E-Z drill. Packer set
at 5510' Pressure up on back side pump in at 1500#. Cmt perf off at
5531-43. Ran McCullough casing inspection log. Found holes at 2700 to 3600.9-27-69 Ran a E-Z drill. Packer set at 2307' cmt with 350 sks of class "C".
6 of 1% Halad-9 2% calc. Squeeze to 800#. WOC

9-28-69 Drilled E-Z drill out found top of cmt at 2500'. Drilled cmt out.

9-29-69 Drlged out 1175' cmt.

9-30-69 Cleaned out to 5510'. Perf 5484 to 5494, 2 shots per foot. Ran n-80
2-3/8 tubing with rtts packer. set at 4454'. Frac with 7,000# 20/40
sand, Fr-12, 100# water 8,930, Break down @ 3450, Max 4500, Avg 4100.
Sand off. Clean out sand.

10-8-69 Put back on production.

RECEIVED

OCT 6 1969

U. S. GEOLOGICAL SURVEY
WASHINGTON, D. C.

18. I hereby certify that the foregoing is true and correct

SIGNED Lee C. Johnson (S)TITLE District SuperintendentDATE October 3, 1969

(This space for Federal or State office use)

APPROVED BY _____
CONDITIONS OF APPROVAL, IF ANY:

TITLE _____

DATE _____

(May 1963)

UNITED STATES
DEPARTMENT OF THE INTERIOR
GEOLOGICAL SURVEY

SUBMIT IN TRIPLICATE*
(Other instructions on re-
verse side)

Form approved.
Budget Bureau No. 42-R142

6. LEASE DESIGNATION AND SERIAL NO

SF-079065

8. IF INDIAN, ALLOTTEE OR TRIBE NAME

7. UNIT AGREEMENT NAME

8. FARM OR LEASE NAME

Aztec Totah Unit

9. WELL NO.

#4

10. FIELD AND POOL, OR WILDCAT

Totah Gallup

11. SEC., T., R., M., OR BLK. AND
SURVEY OR AREA

Section 29-29N-13W

12. COUNTY OR PARISH

San Juan

13. STATE

New Mexico

SUNDRY NOTICES AND REPORTS ON WELLS

(Do not use this form for proposals to drill or to deepen or plug back to a different reservoir.
Use "APPLICATION FOR PERMIT—" for such proposals.)

1.

OIL WELL ☒ GAS WELL ☐ OTHER

2. NAME OF OPERATOR

Aztec Oil & Gas Company

3. ADDRESS OF OPERATOR

P. O. Drawer 570, Farmington, New Mexico 87401

4. LOCATION OF WELL (Report location clearly and in accordance with any State requirements.*

See also space 17 below.)
At surface

Section 29-29N-13W

880' FNL & 2300' FWL

14. PERMIT NO.

15. ELEVATIONS (Show whether DF, RT, GR, etc.)

5734' GR

16.

Check Appropriate Box To Indicate Nature of Notice, Report, or Other Data

NOTICE OF INTENTION TO:

TEST WATER SHUT-OFF

FRACTURE TREAT

SHOOT OR ACIDIZE

REPAIR WELL

(Other)

PULL OR ALTER CASING

MULTIPLE COMPLETE

ABANDON*

CHANGE PLANS

Temporarily Abandon

SUBSEQUENT REPORT OF:

WATER SHUT-OFF

FRACTURE TREATMENT

SHOOTING OR ACIDIZING

(Other)

REPAIRING WELL

ALTERING CASING

ABANDONMENT*

(NOTE: Report results of multiple completion on Well
Completion or Recompletion Report and Log form.)

17. DESCRIBE PROPOSED OR COMPLETED OPERATIONS (Clearly state all pertinent details, and give pertinent dates, including estimated date of starting an proposed work. If well is directionally drilled, give subsurface locations and measured and true vertical depths for all markers and zones pertinent to this work.)*

This well is not economical to produce under present conditions.
It is located in a secondary recovery project and is a potential
well for additional secondary recovery or tertiary recovery methods
if economics change.

TEMPORARY ASSIGNMENT
EXPIRES

JUN 1 1977

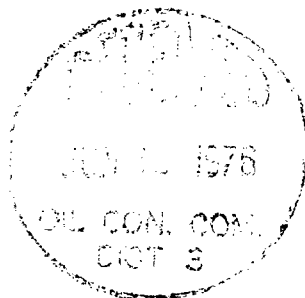

RECEIVED

JUN 21 1976

U.S. GEOLOGICAL SURVEY

18. I hereby certify that the foregoing is true and correct

SIGNED

Van Ryan

TITLE

District Superintendent

DATE

June 18, 1976

(This space for Federal or State office use)

APPROVED BY

TITLE

DATE

CONDITIONS OF APPROVAL, IF ANY:

*See Instructions on Reverse Side

NO. OF COPIES RECEIVED		
DISTRIBUTION		
SANTA FE		7
FILE		1
U.S.G.S.		1
LAND OFFICE		
TRANSPORTER	OIL	1
	GAS	
OPERATOR		4
PRORATION OFFICE		

NEW MEXICO OIL CONSERVATION COMMISSION
REQUEST FOR ALLOWABLE
AND
AUTHORIZATION TO TRANSPORT OIL AND NATURAL GAS

Form C-104
Supersedes Old C-104 and C-11
Effective 1-1-65

I. OPERATOR
Operator SANTA FE OIL ROYALTY COMPANY
Address Box 570
Farmington, N.M. 87401
Reason(s) for filing (Check proper box)
New Well ☐ Change in Transporter of:
Recompletion ☐ Oil ☐ Dry Gas ☐
Change in Ownership ☐ Casinghead Gas ☐ Condensate ☐ Other (Please explain)
Name change

If change of ownership give name
and address of previous owner _____

II. DESCRIPTION OF WELL AND LEASE

Lease Name <u>Aztec Totah Unit</u>	Well No. <u>4</u>	Pool Name, including Formation <u>Totah Gallup</u>	Kind of Lease State, Federal or Fee <u>SF-079065</u>	Lease No. <u>065</u>
Location Unit Letter <u>C</u> : <u>880</u> Feet From The <u>North</u> Line and <u>2300</u> Feet From The <u>West</u> Line of Section <u>29</u> Township <u>29N</u> Range <u>13W</u> , NMFM, <u>San Juan</u> County				

III. DESIGNATION OF TRANSPORTER OF OIL AND NATURAL GAS

Name of Authorized Transporter of Oil <input checked="" type="checkbox"/> or Condensate <input type="checkbox"/> <u>Four Corners Pipeline</u>	Address (Give address to which approved copy of this form is to be sent) <u>Box 1588, Farmington, New Mexico</u>					
Name of Authorized Transporter of Casinghead Gas <input type="checkbox"/> or Dry Gas <input type="checkbox"/>	Address (Give address to which approved copy of this form is to be sent) _____					
If well produces oil or liquids, give location of tanks.	Unit	Sec.	Twp.	Rge.	Is gas actually connected?	When

If this production is commingled with that from any other lease or pool, give commingling order number: _____

IV. COMPLETION DATA

Designate Type of Completion - (X)	Oil Well	Gas Well	New Well	Workover	Deepen	Plug Back	Same Res'v.	Diff. Res'v.
Date Spudded	Date Compl. Ready to Prod.		Total Depth			P.B.T.D.		
Elevations (DF, RKB, RT, CR, etc.)	Name of Producing Formation		Top Oil/Gas Pay			Tubing Depth		
Perforations						Depth Casing Shoe		
TUBING, CASING, AND CEMENTING RECORD								
HOLE SIZE	CASING & TUBING SIZE		DEPTH SET		SACKS CEMENT			

V. TEST DATA AND REQUEST FOR ALLOWABLE OIL WELL (Test must be after recovery of total volume of load oil and must be equal to or exceed top allowable for this depth or be for full 24 hours)

Date First New Oil Run To Tanks	Date of Test	Producing Method (Flow, pump, gas lift, etc.)	
Length of Test	Tubing Pressure	Casing Pressure	Choke Size
Actual Prod. During Test	Oil - Bbls.	Water - Bbls.	Gas - MCF

GAS WELL

Actual Prod. Test-MCF/D	Length of Test	Bbls. Condensate/MMCF	Gravity of Condensate
Testing Method (pitot, back pr.)	Tubing Pressure (Shut-in)	Casing Pressure (Shut-in)	Choke Size

VI. CERTIFICATE OF COMPLIANCE

I hereby certify that the rules and regulations of the Oil Conservation Commission have been complied with and that the information given above is true and complete to the best of my knowledge and belief.

(Signature)

District Production Mgr.

(Title)

1-1-78

(Date)

OIL CONSERVATION COMMISSION

JAN 12 1978

APPROVED _____, 19 _____

BY Original Signed by A. R. Kendrick

TITLE SUPERVISOR DIST. #3

This form is to be filed in compliance with RULE 1104.

If this is a request for allowable for a newly drilled or deepened well, this form must be accompanied by a tabulation of the deviation tests taken on the well in accordance with RULE 111.

All sections of this form must be filled out completely for allowable on new and recompleted wells.

Fill out only Sections I, II, III, and VI for changes of owner, well name or number, or transporter, or other such change of condition.

OIL CONSERVATION DIVISION

P. O. BOX 2088
SANTA FE, NEW MEXICO 87501

RECEIVED
MAR 09 1981
OIL CONSERVATION DIVISION
SANTA FE

REQUEST FOR ALLOWABLE
AND
AUTHORIZATION TO TRANSPORT OIL AND NATURAL GAS

I. Operator
Paramount Petroleum Corp.
Address
P.O. Box 22763 Houston, Tx. 77027
Reason(s) for filing (Check proper box)
New Well ☐ Change in Transporter of:
Recompletion ☐ Oil ☒ Dry Gas ☐
Change in Ownership ☒ Casinghead Gas ☐ Condensate ☐
Other (Please explain)
If change of ownership give name and address of previous owner Southland Royalty Co. 1000 Ft. Worth Club Tower, Ft. Worth, Tx.

II. DESCRIPTION OF WELL AND LEASE
Lease Name Aztec Totah Unit Well No. 4 Location Gallup
Kind of Lease FEDERAL State, Federal or Fee Lease No. SF 07966
Location
Unit Letter C : 880 Feet From The N Line and 2300 Feet From The W
Line of Section 29 Township 29 N Range 13 W , NMPM, San Juan Co. County

III. DESIGNATION OF TRANSPORTER OF OIL AND NATURAL GAS
Name of Authorized Transporter of Oil ☒ or Condensate ☐
Plateau Inc. Address (Give address to which approved copy of this form is to be sent)
501 Airport #151 Farmington, N.M. 87401
Name of Authorized Transporter of Casinghead Gas ☐ or Dry Gas ☐
Address (Give address to which approved copy of this form is to be sent)
If well produces oil or liquids, give location of tanks. Unit Sec. Twp. Rge. Is gas actually connected? When

If this production is commingled with that from any other lease or pool, give commingling order number:

IV. COMPLETION DATA
Designate Type of Completion - (X)
Oil Well Gas Well New Well Workover Deepen Plug Back Same Res'v. Diff. Res'
Date Spudded Date Compl. Ready to Prod. Total Depth P.B.T.D.
Elevations (D, RT, GR, etc.) Name of Producing Formation Top Oil/Gas Pay Tubing Depth
Perforations Depth Casing Shoe

TUBING, CASING, AND CEMENTING RECORD
HOLE SIZE CASING & TUBING SIZE DEPTH SET SACKS CEMENT

V. TEST DATA AND REQUEST FOR ALLOWABLE OIL WELL
(Test must be after recovery of total volume of load oil and must be equal to or exceed top allowable for this depth or be for full 24 hours)
Date First New Oil Run To Tanks Date of Test Producing Method (Flow, pump, gas lift, etc.)
Length of Test Tubing Pressure Casing Pressure Choke Size
Actual Prod. During Test Oil-Bbls. Water-Bbls. Gas-MCF

GAS WELL
Actual Prod. Test-MCF/D Length of Test Bbls. Condensate/MCF Gravity of Condensate
Testing Method (pilot, back pr.) Tubing Pressure (shut-in) Casing Pressure (shut-in) Choke Size

VI. CERTIFICATE OF COMPLIANCE
I hereby certify that the rules and regulations of the Oil Conservation Division have been complied with and that the information given above is true and complete to the best of my knowledge and belief.
Robt A. Brown (Signature)
V.P. Operations (Title)
03/03/81 (Date)

OIL CONSERVATION DIVISION
APPROVED MAR 10 1981
BY Original Signed by FRANK T. CHAVEZ
SUPERVISOR DISTRICT 3
TITLE

This form is to be filed in compliance with RULE 1104.
If this is a request for allowable for a newly drilled or deepen well, this form must be accompanied by a tabulation of the deviate tests taken on the well in accordance with RULE 111.
All sections of this form must be filled out completely for all wells on new and recompleted wells.
Fill out only Sections I, II, III, and VI for changes of own well name or number, or transporter, or other such change of condition.
Separate Forms C-104 must be filed for each pool in multi-



NEW MEXICO ENERGY, MINERALS
& NATURAL RESOURCES DEPARTMENT

OIL CONSERVATION DIVISION
AZTEC DISTRICT OFFICE
1000 RIO BRAZOS ROAD
AZTEC, NEW MEXICO 87410
(505) 334-6178 Fax (505) 334-6170

GARY E. JOHNSON
GOVERNOR

JENNIFER A. SALISBURY
CABINET SECRETARY

June 23, 1997

Rand Carroll
Oil Conservation Division Attorney
2040 S Pacheco
Santa Fe NM 87505

RE: Paramount Petroleum Inc., Federal Orphan Wells

Dear Rand:

The following Aztec Totah Unit wells are Federal orphan wells:

#1	A-29-29N-13W	30-045-07923	#2	G-29-29N-13W	30-045-07871
#3	I-29-29N-13W	30-045-07844	#4	C-29-29N-13W	30-045-07919
#5	K-29-29N-13W	No API	#6	E-29-29N-13W	30-045-07890
#8	K-20-29N-13W	30-045-08011	#9	M-20-29N-13W	30-045-07965
#10	I-19-29N-13W	30-045-08014	#13	C-19-29N-13W	30-045-08156
#15	D-34-29N-13W	30-045-13099	#16	B-34-29N-13W	30-045-07738
#17	F-34-29N-13W	30-045-07706	#18	H-34-29N-13W	30-045-07683
#19	L-34-29N-13W	30-045-07665	#20	J-34-29N-13W	30-045-07656
#21	P-34-29N-13W	30-045-07612	#22	N-34-29N-13W	30-045-07608

Steve Mason with the BLM asked that we plug and abandon the wells using the reclamation fund. I have enclosed his plugging procedures for each well. Our inspection didn't find any wells that would be classified as emergency wells but due to the location of the wells (close to Farmington) and the deteriorating conditions of the wellbore, I would like to plug the wells as soon as possible.

Please notify me of your schedule and when I may expect to begin work. If there is any other paper work needed feel free to contact me at 334-6178.

Sincerely,

Johnny Robinson
Deputy O&G Inspector

JR/sh

cc: Steve Mason BLM well files

enc.