

AZTEC TOTAH UNIT # 9
M-20-29N-13W
30-045-07965

BEFORE EXAMINATION	
OLD	1P
CASE NO.	11917

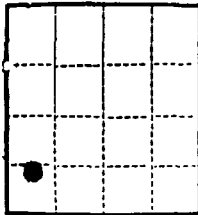

(SUBMIT IN TRIPLICATE)

UNITED STATES
DEPARTMENT OF THE INTERIOR
GEOLOGICAL SURVEY

Land Office Santa Fe
Lease No. 67-07964
Unit Maguel

SUNDRY NOTICES AND REPORTS ON WELLS

NOTICE OF INTENTION TO DRILL.....	<input checked="" type="checkbox"/> SUBSEQUENT REPORT OF WATER SHUT-OFF.....
NOTICE OF INTENTION TO CHANGE PLANS.....	SUBSEQUENT REPORT OF SHOOTING OR ACIDIZING.....
NOTICE OF INTENTION TO TEST WATER SHUT-OFF.....	SUBSEQUENT REPORT OF ALTERING CASING.....
NOTICE OF INTENTION TO RE-DRILL OR REPAIR WELL.....	SUBSEQUENT REPORT OF RE-DRILLING OR REPAIR.....
NOTICE OF INTENTION TO SHOOT OR ACIDIZE.....	SUBSEQUENT REPORT OF ABANDONMENT.....
NOTICE OF INTENTION TO PULL OR ALTER CASING.....	SUPPLEMENTARY WELL HISTORY.....
NOTICE OF INTENTION TO ABANDON WELL.....	

(INDICATE ABOVE BY CHECK MARK NATURE OF REPORT, NOTICE, OR OTHER DATA)

February 21, 1961

Well No. 22-6 is located 660 ft. from N line and 660 ft. from W line of sec. 22
SW 1/4, Section 20 20N 13W N.M.P.M.
(1/4 Sec. and Sec. No.) (Twp.) (Range) (Meridian)
Dotah Gallup San Juan New Mexico
(Field) (County or Subdivision) (State or Territory)

The elevation of the derrick floor above sea level is 5422 ft. (Ground Elevation)

DETAILS OF WORK

(State names of and expected depths to objective sands; show sizes, weights, and lengths of proposed casings; indicate important jobs, cementing points, and all other important proposed work)

Propose To:

Set 300 feet of 8 5/8" surface casing and cement to surface.
Drill with rotary to approximate total depth of 530 feet
or through Gallup formation. Set 5 1/2" production casing at
total depth and cement with 250 sacks. Set two-stage cement
collar approximately 100 feet below Pictured Cliffs formation,
cement with 150 sacks.

Perforate Gallup formation. Sand-oil frac with 50,000 gal. sand
and 50,000 gals. oil. Run 2 1/8" tubing.

SW 1/4, Section 20, 40 acres, dedicated to well.

I understand that this plan of work must receive approval in writing by the Geological Survey before operations may be commenced.

Company Artes Oil and Gas Company

Address Drawer 570

Farmington, New Mexico

By ORIGINAL SIGNED BY JOE C. SALMON

Joe C. Salmon
Title District Superintendent

ILLEGIBLE

NEW MEXICO OIL CONSERVATION COMMISSION

Well Location and Acreage Dedication Plat

SECTION A.

Date. February 21, 1961

Operator Aztec Oil and Gas Company Lease Hagood
 Well No. 22-8 Unit Letter M Section 20 Township 29N Range 13W NMPM
 Located 660 Feet From South Line, 660 Feet From West Line
 County San Juan G. L. Elevation 5482 Dedicated Acreage 40 Acres
 Name of Producing Formation Gallup Pool Total

1. Is the Operator the only owner* in the dedicated acreage outlined on the plat below? Yes. XXX No. _____
2. If the answer to question One is "No," have the interests of all the owners been consolidated by communitization agreement or otherwise? Yes _____ No _____. If answer is "Yes," Type of Consolidation _____
3. If the answer to question Two is "No," list all the owners and their respective interests below:

OWNER

LAND DESCRIPTION

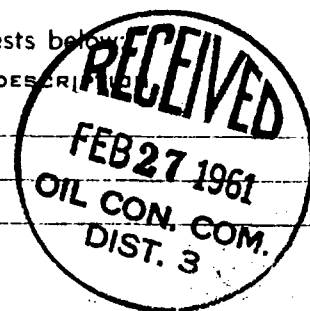

SECTION B.

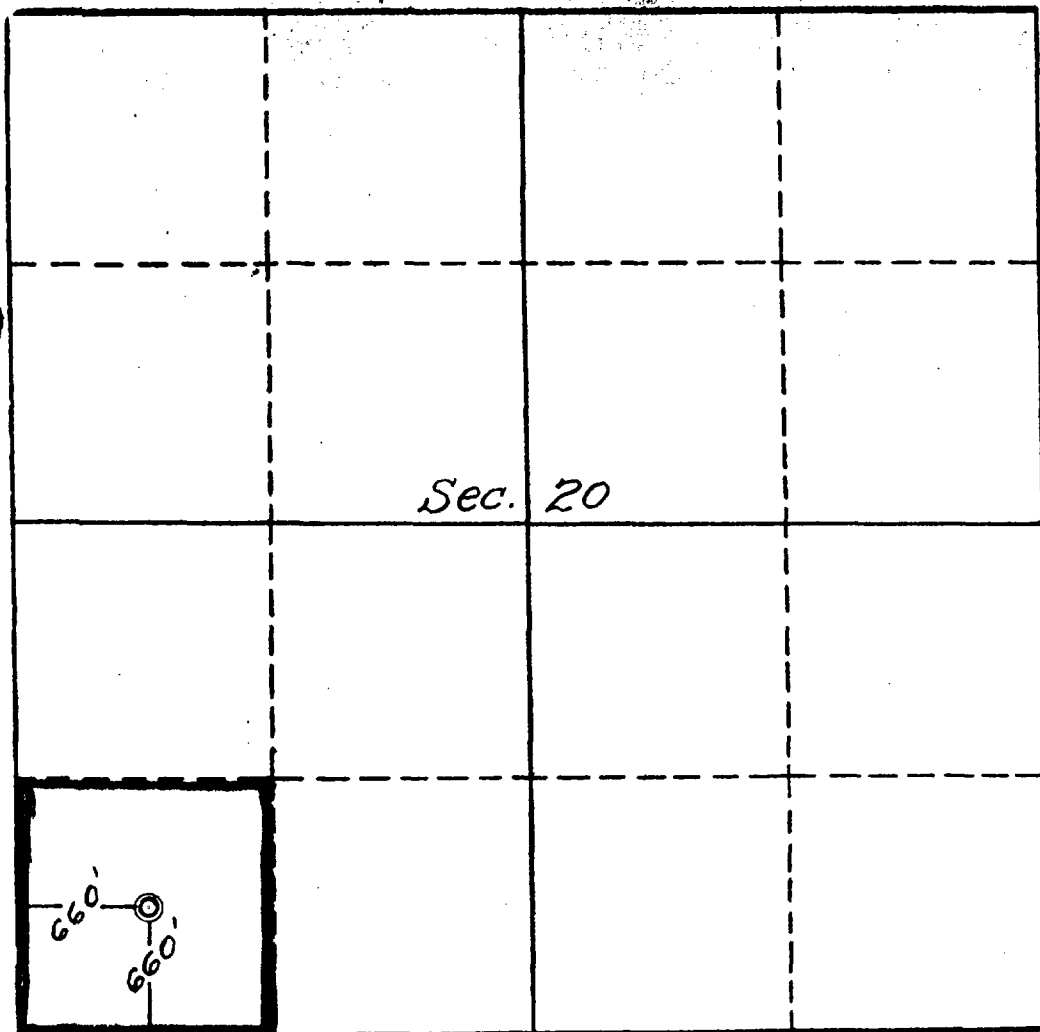

This is to certify that the information in Section A above is true and complete to the best of my knowledge and belief.

Aztec Oil and Gas Company
 (OPERATOR)

ORIGINAL SIGNED BY JOE C. SALMON
 (REPRESENTATIVE)

Drawer 570, Farmington, N.M.
 (ADDRESS)

This is to certify that the well location shown on the plat in Section B was plotted from field notes of actual survey made by me or under my supervision and that the same is true and correct to the best of my knowledge and belief.

Date Surveyed 2-17-61

Four States Engineering Co.
 FARMINGTON, NEW MEXICO

C. L. Potal
 REGISTERED ENGINEER OR
 LAND SURVEYOR

Certificate No. 3084



0			

(SUBMIT IN TRIPLICATE)

UNITED STATES
DEPARTMENT OF THE INTERIOR
GEOLOGICAL SURVEY

Land Office Santa Fe
Lease No. 87-079065
Unit Block

SUNDRY NOTICES AND REPORTS ON WELLS

NOTICE OF INTENTION TO DRILL.....	SUBSEQUENT REPORT OF WATER SHUT-OFF.....
NOTICE OF INTENTION TO CHANGE PLANS.....	SUBSEQUENT REPORT OF SHOOTING OR ACIDIZING.....
NOTICE OF INTENTION TO TEST WATER SHUT-OFF.....	SUBSEQUENT REPORT OF ALTERING CASING.....
NOTICE OF INTENTION TO RE-DRILL OR REPAIR WELL.....	SUBSEQUENT REPORT OF RE-DRILLING OR REPAIR.....
NOTICE OF INTENTION TO SHOOT OR ACIDIZE.....	SUBSEQUENT REPORT OF ABANDONMENT.....
NOTICE OF INTENTION TO PULL OR ALTER CASING.....	SUPPLEMENTARY WELL HISTORY.....
NOTICE OF INTENTION TO ABANDON WELL.....	

(INDICATE ABOVE BY CHECK MARK NATURE OF REPORT, NOTICE, OR OTHER DATA)

U. S. GEOLOGICAL SURVEY
FARMINGTON, NEW MEXICO

February 28, 19 61

Well No. 22-4 is located 660 ft. from S line and 660 ft. from W line of sec. 20

SW 1/4 Section 20, T-49N R-13W N.M.P.M.
(1/4 Sec. and Sec. No.) (Twp.) (Range) (Meridian)
Totah Gallup San Juan New Mexico
(Field) (County or Subdivision) (State or Territory)

The elevation of the derrick floor above sea level is 5480 ft. G.L.

DETAILS OF WORK

(State names of and expected depths to objective sands; show sizes, weights, and lengths of proposed casings; indicate mudding jobs, cementing points, and all other important proposed work)

Well was spudded 2/24/61
Set 6 jts., 181' of 8 5/8" casing, landed at 192' with 170 sacks out.
Tested with 500# pressure for 30 minutes. No leaks.
Drilled cement plug 2/26/61
Tested with 500# pressure for 30 minutes.
No drop in pressure.

I understand that this plan of work must receive approval in writing by the Geological Survey before operations may be commenced.

Company Astec Oil and Gas Company
Address Drawer # 570
Farmington, New Mexico
By Joe C. Salmon
Title District Superintendent

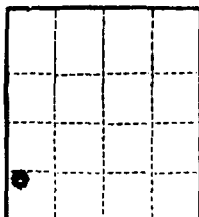

(SUBMIT IN TRIPLICATE)

UNITED STATES
DEPARTMENT OF THE INTERIOR
GEOLOGICAL SURVEY

Land Office **Santa Fe**
Lease No. **27-073063**
Unit **Flagstaff**

SUNDRY NOTICES AND REPORTS ON WELLS

NOTICE OF INTENTION TO DRILL.....		SUBSEQUENT REPORT OF WATER SHUT-OFF.....	
NOTICE OF INTENTION TO CHANGE PLANS.....	XX	SUBSEQUENT REPORT OF SHOOTING OR ACIDIZING.....	
NOTICE OF INTENTION TO TEST WATER SHUT-OFF.....		SUBSEQUENT REPORT OF ALTERING CASING.....	
NOTICE OF INTENTION TO RE-DRILL OR REPAIR WELL.....		SUBSEQUENT REPORT OF RE-DRILLING OR REPAIR.....	
NOTICE OF INTENTION TO SHOOT OR ACIDIZE.....		SUBSEQUENT REPORT OF ABANDONMENT.....	
NOTICE OF INTENTION TO PULL OR ALTER CASING.....		SUPPLEMENTARY WELL HISTORY.....	
NOTICE OF INTENTION TO ABANDON WELL.....			

RECEIVED
1961
U. S. GEOLOGICAL SURVEY
FLAGSTAFF, NEW MEXICO

(INDICATE ABOVE BY CHECK MARK NATURE OF REPORT, NOTICE, OR OTHER DATA)

March 6, 1961

Well No. **22-0** is located **660** ft. from **N** line and **460** ft. from **E** line of sec. **20**
SW 1/4, Section 20 (1/4 Sec. and Sec. No.)
SW (Twp.) **13N** (Range) **N.M.P.M.** (Meridian)
Basin Dakota (Field) **San Juan** (County or Subdivision) **New Mexico** (State or Territory)

The elevation of the derrick floor above sea level is **4600** f (Ground Elevation)

DETAILS OF WORK

(State names of and expected depths to objective sands; show sizes, weights, and lengths of proposed casings; indicate mudding jobs, cementing points, and all other important proposed work)

Propose To: Deepen well to a depth of approximately 6090 or through Dakota formation. Run 4 1/2" casing to total depth and cement with 270 cu. Set two-stage cement collar approximately 100 feet below the Pictured Cliffs formation and cement with 170 cu.

Perforate Dakota formation with four shots per foot. Sand-water frac with 80,000 gals water and 80,000 lbs. sand. Run 2 1/8" tubing.

West one-half, 360 acres, Section 20 dedicated to well.

I understand that this plan of work must receive approval in writing by the Geological Survey before operations may be commenced.

Company **Antco Oil and Gas Company**

Address **Drawer 370,**
Farmington, New Mexico

ORIGINAL SIGNED BY JOE C. SALMON

By **Joe C. Salmon**
Title **District Superintendent**

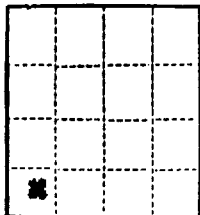

(SUBMIT IN TRIPLICATE)

UNITED STATES
DEPARTMENT OF THE INTERIOR
GEOLOGICAL SURVEY

Land Office Santa Fe
Lease No. 87 07506
Unit 88004

SUNDRY NOTICES AND REPORTS ON WELLS

NOTICE OF INTENTION TO DRILL.....	SUBSEQUENT REPORT OF WATER SHUT-OFF.....
NOTICE OF INTENTION TO CHANGE PLANS.....	SUBSEQUENT REPORT OF SHOOTING OR ACIDIZING.....
NOTICE OF INTENTION TO TEST WATER SHUT-OFF.....	SUBSEQUENT REPORT OF ALTERING CASING.....
NOTICE OF INTENTION TO RE-DRILL OR REPAIR WELL.....	SUBSEQUENT REPORT OF RE-DRILLING OR REPAIR.....
NOTICE OF INTENTION TO SHOOT OR ACIDIZE.....	SUBSEQUENT REPORT OF ABANDONMENT.....
NOTICE OF INTENTION TO PULL OR ALTER CASING.....	SUPPLEMENTARY WELL HISTORY.....
NOTICE OF INTENTION TO ABANDON WELL.....	

(INDICATE ABOVE BY CHECK MARK NATURE OF REPORT, NOTICE, OR OTHER DATA)

U. S. GEOLOGICAL SURVEY
SANTA FE, NEW MEXICO

March 16, 1961

Well No. 82-C is located 660 ft. from (N) line and 650 ft. from (E) line of sec. 80
SW 1/4 Section 80, T-29N R-1W R.M.P.M.
(1/4 Sec. and Sec. No.) (Twp.) (Range) (Meridian)
Basin Dakota San Juan New Mexico
(Field) (County or Subdivision) (State or Territory)

The elevation of the derrick floor above sea level is 5400 ft. G.L.

DETAILS OF WORK

(State names of and expected depths to objective sands; show sizes, weights, and lengths of proposed casings; indicate mudding jobs, cementing points, and all other important proposed work)

P.B.T.D. - 5340'
Sand-Oil fraced with 18,000' 20/40 sand, 10,000' 10/20 sand, 750 lbs. oil
flushed with 220 lbs. oil
Breakdown pr. - 2300
5 min. shut-in pr. - 750'
Maximum - 3000'
Avg. treating pr. - 2500'
I.R. - 28.5 bpr
Ran 155 jts., 2 1/8" tubing, landed at 5272'
Perforated nipple from 5235-41
Flowing through tubing.

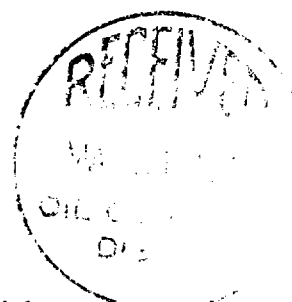

I understand that this plan of work must receive approval in writing by the Geological Survey before operations may be commenced.

Company Astec Oil and Gas Company
Address Drawer # 570, Farmington, New Mex.

By ORIGINAL SIGNED BY JOE C. SALMON
Joe C. Salmon
Title District Superintendent

ILLEGIBLE

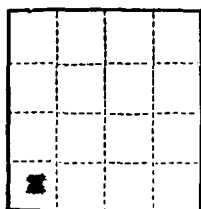

(SUBMIT IN TRIPLICATE)

UNITED STATES
DEPARTMENT OF THE INTERIOR
GEOLOGICAL SURVEY

Land Office Santa Fe
Lease No. W 079063
Unit Reynolds

SUNDRY NOTICES AND REPORTS ON WELLS

NOTICE OF INTENTION TO DRILL	SUBSEQUENT REPORT OF WATER SHUT-OFF	<input checked="" type="checkbox"/>
NOTICE OF INTENTION TO CHANGE PLANS	SUBSEQUENT REPORT OF SHOOTING OR ACIDIZING	
NOTICE OF INTENTION TO TEST WATER SHUT-OFF	SUBSEQUENT REPORT OF ALTERING CASING	
NOTICE OF INTENTION TO RE-DRILL OR REPAIR WELL	SUBSEQUENT REPORT OF RE-DRILLING OR REPAIR	
NOTICE OF INTENTION TO SHOOT OR ACIDIZE	SUBSEQUENT REPORT OF ABANDONMENT	
NOTICE OF INTENTION TO PULL OR ALTER CASING	SUPPLEMENTARY WELL HISTORY	
NOTICE OF INTENTION TO ABANDON WELL		

(INDICATE ABOVE BY CHECK MARK NATURE OF REPORT, NOTICE, OR OTHER DATA)

March 16, 1961

Well No. 22-0 is located 600 ft. from [N] line and 600 ft. from [E] line of sec. 20
SW 1/4 Section 20, T-23N R-13W N.M.P.M.
(1/4 Sec. and Sec. No.) (Twp.) (Range) (Meridian)
Basin Dakota San Juan New Mexico
(Field) (County or Subdivision) (State or Territory)

The elevation of the derrick floor above sea level is 5400 ft. G.L.

DETAILS OF WORK

(State names of and expected depths to objective sands; show sizes, weights, and lengths of proposed casings; indicate mudding jobs, cementing points, and all other important proposed work)

Total depth- 5267, P.S.F.A. - 5340
Base layer: top of Flintwood Shale- 1200, Gallas - 4898, Point Lookout- 3650, Dakota 3791
-Sample top of Harrison- 6046
Drill stem test - 6046-6046, WSP-3115, WSP-3100, WSP-2700, Flank FF- 2650, WSP-2700, WSP-2700
Packer set at 6046
Spotted 10 sacks cement across Harrison
Run 151 lbs., 6030 of 1 1/2" casing, set at 6040, D.V. tool- 1500
Cemented 1st stage with 300 sacks, 2nd stage with 150 sacks
Drilled D V tool and cleaned out to 5400
Set cast iron bridge plug at 5340
Perforated with 1 shot per foot from 5269-51
Spotted 300 gals. 15% HCl
Moved in completion unit and cleaned out to 5340, tested 2 hrs. with 300# pr. Pipe C

I understand that this plan of work must receive approval in writing by the Geological Survey before operations may be commenced.

Company Amoco Oil and Gas Company
Address Drawer # 370
Farmington, New Mex.
ORIGINAL SIGNED BY JOE C. SALMON
By Joe C. Salmon
Title Minerals Superintendent

ILLEGIBLE

OIL CONSERVATION COMMISSION

P. O. BOX 871

SANTA FE, NEW MEXICO



March 20, 1961

Astec Oil & Gas Company
920 Mercantile Securities Building
Dallas 1, Texas

Attention: Mr. Kenneth A. Swanson

Administrative Order NSL-247

Gentlemen:

Reference is made to your application for approval of an unorthodox well location for your Hagoood No. 22-G Well to be located 660 feet from the South line and 660 feet from the West line of Section 20, Township 29 North, Range 13 West, Basin-Dakota Pool, San Juan County, New Mexico.

It is our understanding that this unorthodox well location is occasioned by the recompletion of a well previously drilled to another horizon.

By authority granted me under provisions of Order No. R-1670, as amended, you are hereby granted approval for the above described unorthodox well location. You must also obtain like approval from the U. S. Geological Survey if the well is located on land subject to the jurisdiction of the U. S. Geological Survey.

Very truly yours,

A. L. PORTER, Jr.,
Secretary-Director

ALP/OEP/og

cc: Oil Conservation Commission - Aztec
U. S. Geological Survey - Farmington

U. S. LAND OFFICE Santa Fe
SERIAL NUMBER SP 079065
LEASE OR PERMIT TO PROSPECT Hasgood

UNITED STATES
DEPARTMENT OF THE INTERIOR
GEOLOGICAL SURVEY

LOG OF OIL OR GAS WELL

LOCATE WELL CORRECTLY

Company Astec Oil and Gas Company Address Drewer # 570, Farmington, New Mex.
Lessor or Tract Hagood Field ~~Franklin~~ State New Mexico
Well No. 22-G Sec. 20 T. 29N R. 13W Meridian N.M.P.M. County San Juan
Location 660 ft. West of N Line and 660 ft. West of E Line of Sec. 20 Elevation 5482 G.I.
(Depth 400 relative to sea level)

The information given herewith is a complete and correct record of the well and all work done thereon so far as can be determined from all available records.

ORIGINAL SIGNED BY JOE C. SALMON

Signed _____

Title _____ **Joe C. Salmon**
District Superintendent

Date March 21, 1961

Title-----**District Superintendent**

The summary on this page is for the condition of the well at above date.

Commenced drilling 2/24/61, 1961 Finished drilling 3/9/61, 1961

OIL OR GAS SANDS OR ZONES

(Denote gas by G)

No. 1, from 5269 to 5281 No. 4, from _____ to _____
 No. 2, from _____ to _____ No. 5, from _____ to _____
 No. 3, from _____ to _____ No. 6, from _____ to _____

IMPORTANT WATER SANDS

No. 1, from _____ to _____

No. 2, from _____ to _____

No. 3, from _____ to _____

No. 4, from _____ to _____

CASING RECORD

Size casing	Weight per foot	Threads per inch	Make	Amount	Kind of shoe	Cut and pulled from	Perforated		Purpose
							From—	To—	
8 5/8	24.8	8rd	J-55	1.88	1/2" x 1/2" x 1/2"	1/2" x 1/2" x 1/2"	1/2" x 1/2" x 1/2"	1/2" x 1/2" x 1/2"	1/2" x 1/2" x 1/2"
4 1/2	11.6	8rd	J-55	1.05	1/2" x 1/2" x 1/2"	1/2" x 1/2" x 1/2"	1/2" x 1/2" x 1/2"	1/2" x 1/2" x 1/2"	1/2" x 1/2" x 1/2"
4 1/8	9.9	8rd	J-55	1.75	1/2" x 1/2" x 1/2"	1/2" x 1/2" x 1/2"	1/2" x 1/2" x 1/2"	1/2" x 1/2" x 1/2"	1/2" x 1/2" x 1/2"
2 3/8	4.7	8rd	J-55	1.00	1/2" x 1/2" x 1/2"	1/2" x 1/2" x 1/2"	1/2" x 1/2" x 1/2"	1/2" x 1/2" x 1/2"	1/2" x 1/2" x 1/2"
TOTAL							10-13034-3	12' COLLEGE HALL BUILDING OFFICE	

MUDDING AND CEMENTING RECORD

Size casing	Where set	Number sacks of cement	Method used	Mud gravity	Amount of mud used
8 5/8	192	170	displacement		
4 1/2	6040	500	two plug		
2 3/8	5272	---			

PLUGS AND ADAPTERS

Heaving plug—Material	Length	Depth set
Adapters—Material	Size	

SHOOTING RECORD

	Quantity	Date	Dents shot	Dents cleaned out
1				
2				
3				
4				
5				
6				
7				
8				
9				
10				
11				
12				
13				
14				
15				
16				
17				
18				
19				
20				
21				
22				
23				
24				
25				
26				
27				
28				
29				
30				
31				
32				
33				
34				
35				
36				
37				
38				
39				
40				
41				
42				
43				
44				
45				
46				
47				
48				
49				
50				
51				
52				
53				
54				
55				
56				
57				
58				
59				
60				
61				
62				
63				
64				
65				
66				
67				
68				
69				
70				
71				
72				
73				
74				
75				
76				
77				
78				
79				
80				
81				
82				
83				
84				
85				
86				
87				
88				
89				
90				
91				
92				
93				
94				
95				
96				
97				
98				
99				
100				

ILLEGIBLE

QUESTION	ANSWER	MARK
----------	--------	------

MUDDING AND CEMENTING RECORD

Size casing	Where set	Number sacks of cement	Method used	Mud gravity	Amount of mud used
8 5/8	192	170	displacement		
4 1/2	6040	500	two plug		
2 3/8	5272				

PLUGS AND ADAPTERS

Heaving plug—Material Length Depth set
 Adapters—Material Size

SHOOTING RECORD

Size	Shell used	Explosive used	Quantity	Date	Depth shot	Depth cleaned out
Sand-Oil fraced with 28,000# sand, 750 Bbls. oil, flushed with 220 Bbls. oil Breakdown pr. - 2300, 5 min. shut-in 750#, Maximum - 3000#, Avg. treating pr. - 2500# I.R. - 38.5 bpm						

TOOLS USED

Rotary tools were used from 0 feet to 6247 feet, and from feet to feet
 Cable tools were used from 0 feet to 5340 feet, and from feet to feet

DATES

3/13/61 19..... Put to producing 19.....
 The production for the first 24 hours was 503 barrels of fluid of which 100 % was oil; 0 %
 emulsion; 0 % water; and 0 % sediment. Gravity, °Bé.
 If gas well, cu. ft. per 24 hours Gallons gasoline per 1,000 cu. ft. of gas
 Rock pressure, lbs. per sq. in.

EMPLOYEES

....., Driller Driller
 Driller Driller

FORMATION RECORD

FROM—	TO—	TOTAL FEET	FORMATION
0	195	195	surface
195	1385	1190	sand and shale
1385	2872	1487	sand and shale
2872	3654	782	sand and shale
3654	4094	440	sand and shale
4094	4531	437	sand and shale
4531	5012	481	sand and shale
5012	5838	826	sand and shale
5838	6025	187	sand and shale
6025	6057	32	sand and shale
6057	6198	141	sand and shale
6198	6246	48	sand and shale

PICURES CLUTTS- 1204
 CALLUP - 4898
 POINT LOOKOUT- 3690
 DAKOTA - 5791

NUMBER OF COPIES RECEIVED	
DISTRIBUTION	
SANTA FE	
FILE	
U.S.G.S.	
LAND OFFICE	
TRANSPORTER	OIL GAS
PRODUCTION OFFICE	
OPERATOR	

NEW MEXICO OIL CONSERVATION COMMISSION Santa Fe, New Mexico

(Form C-104)
Revised 7/1/57

REQUEST FOR (OIL - ~~WATER~~) ALLOWABLE

New Well
~~Recompletion~~

This form shall be submitted by the operator before an oil or gas allowable will be assigned to any completed Oil or Gas well. Form C-104 is to be submitted in QUADRUPPLICATE to the same District Office to which Form C-101 was sent. The allowable will be assigned effective 7:00 A.M. on date of completion or recompletion, provided this form is filed during calendar month of completion or recompletion. The completion date shall be that date in the case of an oil well when new oil is delivered into the stock tanks. Gas must be reported on 15.025 psia at 60° Fahrenheit.

Farmington, New Mexico
(Please)

March 21, 1961
(Date)

WE ARE HEREBY REQUESTING AN ALLOWABLE FOR A WELL KNOWN AS:

Astec Oil and Gas Company

Leased

Well No. 22-4 in SW $\frac{1}{4}$ SW $\frac{1}{4}$

(Company or Operator)

(Lease)

N Sec. 20 T. 29N R. 13W NMPM, Totah Gallup Pool

Unit Letter

San Juan

County. Date Spudded 2/24/61 Date Drilling Completed 3/9/61

Please indicate location:

Elevation 5462 G.L. Total Depth 6247 PBTD 5340

Top Oil/Gas Pay 4898 Name of Prod. Form. Gallup

PRODUCING INTERVAL -

Perforations 2869-2901 with 4 shots per foot

Open Hole _____ Depth _____ Casing Shoe _____ Depth _____ Tubing _____

OIL WELL TEST -

Natural Prod. Test: _____ bbls. oil, _____ bbls water in _____ hrs, _____ min. Size _____ Choke

Test After Acid or Fracture Treatment (after recovery of volume of oil equal to volume of load oil used): 503 bbls. oil, 0 bbls water in 24 hrs, _____ min. Size 20/64 Choke

GAS WELL TEST -

Natural Prod. Test: _____ MCF/Day; Hours flowed _____ Choke Size _____

Method of Testing (pilot, back pressure, etc.): _____

Test After Acid or Fracture Treatment: _____ MCF/Day; Hours flowed _____

Choke Size _____ Method of Testing: _____

Acid or Fracture Treatment (Give amounts of materials used, such as acid, water, oil, and sand): 85,000# sand, 750 bbls. oil, Flushed with 200 bbls. oil

Casing _____ Tubing _____ Date first new oil run to tanks 3/17/61

Oil Transporter El Paso Natural Gas Products Co. (via Luna Eaves)

Gas Transporter _____

Remarks: _____

I hereby certify that the information given above is true and complete to the best of my knowledge.

Approved March 21 MAR 21 1961 61

Astec Oil and Gas Company

(Company or Operator)

ORIGINAL SIGNED BY JOE C. SALMON

By: _____ (Signature) Joe C. Salmon

OIL CONSERVATION COMMISSION

By: Original Signed Emery C. Arnold

Title: District Superintendent

Send Communications regarding well to:

Title Supervisor Dist. # 3

Name: Astec Oil and Gas Company

Address: Drawer # 570, Farmington, New Mexico

NEW MEXICO OIL CONSERVATION COMMISSION
SANTA FE, NEW MEXICO

Form C-110
Revised 7/1/55

(File the original and 4 copies with the appropriate district office)

CERTIFICATE OF COMPLIANCE AND AUTHORIZATION
TO TRANSPORT OIL AND NATURAL GAS

Company or Operator Astec Oil and Gas Company Lease Leased

Well No. 22-6 Unit Letter M S 80 T 29N R 13W Pool Totah Gallup

County San Juan Kind of Lease (State, Fed. or Patented) Fed.

If well produces oil or condensate, give location of tanks: Unit S T R

Authorized Transporter of Oil or Condensate El Paso Natural Gas Products Company

Address Box # 1161, El Paso, Texas. (via Luna Hayes Trucking Co.)
(Give address to which approved copy of this form is to be sent)

Authorized Transporter of Gas _____

Address _____ Date Connected _____
(Give address to which approved copy of this form is to be sent)

If Gas is not being sold, give reasons and also explain its present disposition:

Reasons for Filing: (Please check proper box) New Well ☒ ★

Change in Transporter of (Check One): Oil ☐ Dry Gas ☐ C'head ☐ Condensate ☐

Change in Ownership ☐ Other ☐

Remarks: _____ (Give explanation below)

The undersigned certifies that the Rules and Regulations of the Oil Conservation Commission have been complied with.

Executed this the 21 day of March 19 61

ORIGINAL SIGNED BY JOE C. SALMON
By _____

Joe C. Salmon

Approved MAR 21 1961 19 _____

Title District Superintendent

Company Astec Oil and Gas Company

Address Drawer # 570, Farmington, New Mex.

OIL CONSERVATION COMMISSION
(Original Signed By)
By A. R. KENDRICK

Title PETROLEUM ENGINEER DIST NO 3

MEXICO OIL CONSERVATION COMMISSION

Well Location and Acreage Dedication Plot

SECTION A.

Date February 21, 1961

Operator **Aztec Oil and Gas Company** Lease **Hagood**
 Well No **22-6** Unit Letter **M** Section **20** Township **29N** Range **13W** T.M.P.A.
 Located **660** Feet From **South** Line **660** Feet From **West** Line
 County **San Juan** G. L. Elevation **5482** Dedicated Acreage **80**
 Name of Producing Formation **Gallup** Prod. **Total**

1. Is the Operator the only owner of the dedicated acreage outlined in the plot below? **XXX**
2. If the answer to question One is "No," have the interests of all the owners been included in a joint venture agreement or otherwise? Yes **No** If answer is "Yes" Type of Consortium

3. If the answer to question Two is "No," list all the owners and their respective interests below:

OWNER

ACRES INTEREST

SECTION B.

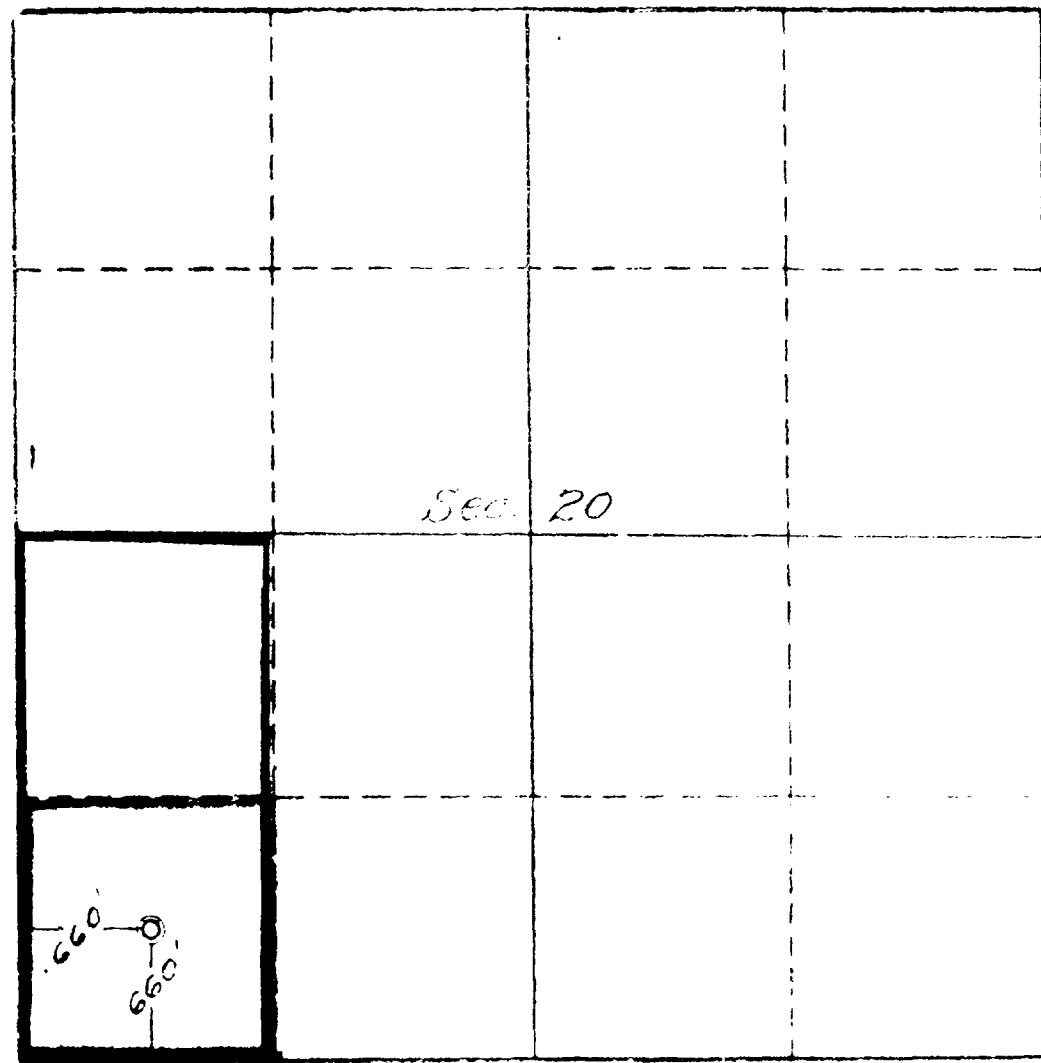

This is to certify that the information furnished in Section A above is true and complete to the best of my knowledge and belief.

Aztec Oil and Gas Company

(Signature)

ORIGINAL SIGNED BY JOE C. SALMON

(Signature)

Drawer 570, Farmington, N.M.

(Signature)

This is to certify that the well location marked on the plot in Section B above is true and complete to the best of my knowledge and belief.

Four States Engineering Co.

(Signature)

Four States Engineering Co.

(Signature)

(Signature)

30%

ILLEGIBLE

RECEIVED
MAR 27 1961
U.S. DEPT. OF THE INTERIOR
BUREAU OF LAND MANAGEMENT

NUMBER OF COPIES RECEIVED	
DISTRIBUTION	
SANTA FE	
FILE	
U.S.G.S.	
LAND OFFICE	
TRANSPORTER	OIL
	GAS
PROMOTION OFFICE	
OPERATOR	

NEW MEXICO OIL CONSERVATION COMMISSION
SANTA FE, NEW MEXICO
CERTIFICATE OF COMPLIANCE AND AUTHORIZATION
TO TRANSPORT OIL AND NATURAL GAS

FORM C-110
 (Rev. 7-60)

BT.

FILE THE ORIGINAL AND 4 COPIES WITH THE APPROPRIATE OFFICE

Company or Operator AZTEC OIL AND GAS COMPANY				Lease MACOOD "U"		Well No. 22	
Unit Letter M	Section 20	Township 29N	Range 13W	County San Juan			
Pool Totah Gallup				Kind of Lease (State, Fed, Fee) Fed.			
If well produces oil or condensate give location of tanks			Unit Letter M	Section 20	Township 29N	Range 13W	
Authorized transporter of oil <input checked="" type="checkbox"/> or condensate <input type="checkbox"/> Four Corners Pipeline, Inc.				Address (give address to which approved copy of this form is to be sent) Box # 1588, Farmington, New Mexico			
Is Gas Actually Connected? Yes <input checked="" type="checkbox"/> No <input type="checkbox"/>							
Authorized transporter of casing head gas <input checked="" type="checkbox"/> or dry gas <input type="checkbox"/> Jalou Gas Co. Inc			Date Connected 9/15/61	Address (give address to which approved copy of this form is to be sent) P.O. Box # 5426, Tulsa, Oklahoma			

If gas is not being sold, give reasons and also explain its present disposition:

REASON(S) FOR FILING (please check proper box)

New Well ☐

Change in Ownership ☐

Change in Transporter (check one)

Other (explain below)

Oil ☐ Dry Gas ☐

Casing head gas ☒ Condensate.. ☐

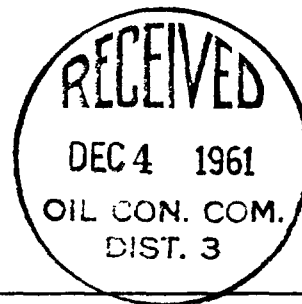

Remarks

The undersigned certifies that the Rules and Regulations of the Oil Conservation Commission have been complied with.

Executed this the 29th day of November, 19 61.

OIL CONSERVATION COMMISSION

By

Approved by

Original Signed By
A. R. KENDRICK

Title

H. M. Perdue
Production Foreman

Title

PETROLEUM ENGINEER DIST. NO. 3

Company

Aztec Oil & Gas Company

Date

DEC 4 1961

Address

Drawer # 570, Farmington, New Mexico

NUMBER OF COPIES RECEIVED	
DISTRIBUTION	
SANTA FE	
FILE	
U.S.S.	
LAND OFFICE	
TRANSPORTER	OIL
	GAS
PRODUCTION OFFICE	
OPERATOR	

NEW MEXICO OIL CONSERVATION COMMISSION
SANTA FE, NEW MEXICO
CERTIFICATE OF COMPLIANCE AND AUTHORIZATION
TO TRANSPORT OIL AND NATURAL GAS

FORM C-110
 (Rev. 7-60)

B.T.

FILE THE ORIGINAL AND 4 COPIES WITH THE APPROPRIATE OFFICE

Company or Operator Artes Oil and Gas Company	Lease Leased	Well No. 28-6
---	------------------------	-------------------------

Unit Letter M	Section 20	Township 29N	Range 13W	County San Juan
-------------------------	----------------------	------------------------	---------------------	---------------------------

Pool Totah Gallup	Kind of Lease (State, Fed, Fee) Federal
-----------------------------	---

If well produces oil or condensate give location of tanks	Unit Letter	Section	Township	Range
--	-------------	---------	----------	-------

Authorized transporter of oil <input checked="" type="checkbox"/> or condensate <input type="checkbox"/> Four Corners Pipeline Co.	Address (give address to which approved copy of this form is to be sent) Box 2648, Houston, Texas
--	---

Is Gas Actually Connected? Yes _____ No _____

Authorized transporter of casing head gas <input type="checkbox"/> or dry gas <input type="checkbox"/>	Date Connected	Address (give address to which approved copy of this form is to be sent)
--	----------------	--

If gas is not being sold, give reasons and also explain its present disposition:

REASON(S) FOR FILING (please check proper box)	
New Well <input type="checkbox"/> Change in Transporter (check one) Oil <input checked="" type="checkbox"/> Dry Gas <input type="checkbox"/> Casing head gas . <input type="checkbox"/> Condensate.. <input type="checkbox"/>	Change in Ownership <input type="checkbox"/> Other (explain below)



Remarks

The undersigned certifies that the Rules and Regulations of the Oil Conservation Commission have been complied with.

Executed this the 28th day of April, 1961

OIL CONSERVATION COMMISSION	By
Approved by Original Signed Emery C. Arnold	Title L.M. Stevens Production Engineer
Title Supervisor Dist. # 3	Company Artes Oil and Gas Company
Date APR 28 1961	Address Drawer 570, Farmington, New Mexico

NUMBER OF COPIES RECEIVED	
DISTRIBUTION	
SANTA FE	
FILE	
U.S.G.S.	
LAND OFFICE	
TRANSPORTER	OIL
	GAS
PRODUCTION OFFICE	
OPERATOR	

NEW MEXICO OIL CONSERVATION COMMISSION

SANTA FE, NEW MEXICO

FORM C-110

(Rev. 7-60)

CERTIFICATE OF COMPLIANCE AND AUTHORIZATION TO TRANSPORT OIL AND NATURAL GAS

FILE THE ORIGINAL AND 4 COPIES WITH THE APPROPRIATE OFFICE

Company or Operator AZTEC OIL & GAS COMPANY				Lease AZTEC TOTAH UNIT		Well No. #9	
Unit Letter M	Section 20	Township 29N	Range 13W	County SAN JUAN			
Pool TOTAH GALLUP UNIT				Kind of Lease (State, Fed, Fee) FED.			
If well produces oil or condensate give location of tanks			Unit Letter M	Section 20	Township 29N	Range 13W	
Authorized transporter of oil <input type="checkbox"/> or condensate <input type="checkbox"/>				Address (give address to which approved copy of this form is to be sent)			
Is Gas Actually Connected? Yes <input type="checkbox"/> No <input type="checkbox"/>							
Authorized transporter of casing head gas <input type="checkbox"/> or dry gas <input type="checkbox"/>			Date Connected	Address (give address to which approved copy of this form is to be sent)			

If gas is not being sold, give reasons and also explain its present disposition:

REASON(S) FOR FILING (please check proper box)

New Well ☐

Change in Ownership ☐

Change in Transporter (check one)

Other (explain below)

Oil ☐ Dry Gas ☐

Casing head gas ☐ Condensate ☐

NAME CHANGE

X

Remarks

**THIS WELL FORMERLY NAMED HAGOOD "G" - 22
NOW CHANGED TO AZTEC TOTAH UNIT #9**

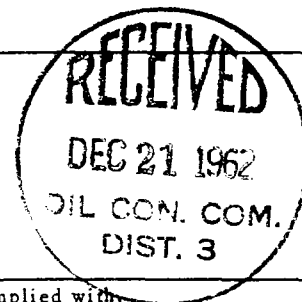

The undersigned certifies that the Rules and Regulations of the Oil Conservation Commission have been complied with.

Executed this the 19th day of DECEMBER, 1962.

OIL CONSERVATION COMMISSION

By

Approved by

ORIGINAL SIGNED BY JOE C. SALMON

Original Signed by W. B. Smith

Title

DISTRICT SUPERINTENDENT

JOE C. SALMON

Title

Company

DEPUTY OIL & GAS INSPECTOR DIST. NO. 3

AZTEC OIL & GAS COMPANY

Date

Address

DEC 21 1962

**P. O. DRAWER 570
FARMINGTON, NEW MEXICO**

NUMBER OF COPIES RECEIVED		DISTRIBUTION	
SANTA FE			
FILE			
U.S.G.P.			
LAND OFFICE			
TRANSPORTER	OIL		
	GAS		
PRODUCTION OFFICE			
OPERATOR			

NEW MEXICO OIL CONSERVATION COMMISSION

SANTA FE, NEW MEXICO

FORM C-110

(Rev. 7-60)

CERTIFICATE OF COMPLIANCE AND AUTHORIZATION TO TRANSPORT OIL AND NATURAL GAS

FILE THE ORIGINAL AND 4 COPIES WITH THE APPROPRIATE OFFICE

Company or Operator AZTEC OIL AND GAS COMPANY				Lease AZTEC TOTAH UNIT		Well No. 9	
Unit Letter M	Section 20	Township 29N	Range 13W	County SAN JUAN			
Pool TOTAH GALLUP UNIT				Kind of Lease (State, Fed, Fee) FED.			
If well produces oil or condensate give location of tanks			Unit Letter N	Section 20	Township 29N	Range 13W	
Authorized transporter of oil <input checked="" type="checkbox"/> or condensate <input type="checkbox"/> FOUR CORNERS PIPELINE				Address (give address to which approved copy of this form is to be sent) P. O. BOX 1588 - FARMINGTON, NEW MEXICO			
Is Gas Actually Connected? Yes <input checked="" type="checkbox"/> No <input type="checkbox"/>							
Authorized transporter of casing head gas <input checked="" type="checkbox"/> or dry gas <input type="checkbox"/> JALOU GAS CO. INC.			Date Con- nected 9/15/61	Address (give address to which approved copy of this form is to be sent) P. O. BOX 5426 - TULSA, OKLAHOMA			

If gas is not being sold, give reasons and also explain its present disposition:

REASON(S) FOR FILING (please check proper box)

New Well ☐
Change in Transporter (check one)
Oil ☐ Dry Gas ☐
Casing head gas ☐ Condensate ☐

Change in Ownership ☐
Other (explain below)
NAME CHANGE XX

Remarks

THIS WELL FORMERLY NAMED HAGOOD "G" - 22
NOW CHANGED TO AZTEC TOTAH UNIT #9.

(CORRECTED COPY)

The undersigned certifies that the Rules and Regulations of the Oil Conservation Commission have been complied with.

Executed this the 12th day of FEBRUARY, 19 63.

FEB 13 1963

OIL CONSERVATION COMMISSION

Approved by

Title

Date

By

Title

Company

Address

PETROLEUM ENGINEER DIST. NO. 3

AZTEC OIL AND GAS COMPANY

P. O. DRAWER 570 - FARMINGTON, NEW MEXICO

FEB 13 1963

JOE C. SALMON
DISTRICT SUPERINTENDENT

UNITED STATES
DEPARTMENT OF THE INTERIOR
GEOLOGICAL SURVEYSUBMIT IN TRIPLICATE*
(Other instructions on re-
verse side)Form approved.
Budget Bureau No. 42-R1424.
5. LEASE DESIGNATION AND SERIAL NO.

SF - 079063

6. IF INDIAN, ALLOTTEE OR TRIBE NAME

7. UNIT AGREEMENT NAME

8. FARM OR LEASE NAME

Antec Total Unit

9. WELL NO.

9

10. FIELD AND POOL, OR WILDCAT

Total Gallup

11. SEC., T., R., M., OR BLK. AND
SURVEY OR AREA

Sec. 20, T-29N, R-13W

12. COUNTY OR PARISH

San Juan

13. STATE

New Mexico

SUNDRY NOTICES AND REPORTS ON WELLS

(Do not use this form for proposals to drill or to deepen or plug back to a different reservoir.
Use "APPLICATION FOR PERMIT—" for such proposals.)1. ☒ OIL
WELL ☐ GAS
WELL ☐ OTHER

2. NAME OF OPERATOR

Antec Oil & Gas Company

3. ADDRESS OF OPERATOR

Drawer 570, Farmington, New Mexico

4. LOCATION OF WELL (Report location clearly and in accordance with any State requirements.*
See also space 17 below.)
At surface

660 FWL, 660 FWL, Sec. 20, T-29N, R-13W

14. PERMIT NO.

15. ELEVATIONS (Show whether DF, RT, GR, etc.)

5482 OL

16. Check Appropriate Box To Indicate Nature of Notice, Report, or Other Data

NOTICE OF INTENTION TO:

TEST WATER SHUT-OFF



PULL OR ALTER CASING



FRACTURE TREAT



MULTIPLE COMPLETE



SHOOT OR ACIDIZE



ABANDON*



REPAIR WELL



CHANGE PLANS



(Other)

SUBSEQUENT REPORT OF:

WATER SHUT-OFF



FRACTURE TREATMENT



SHOOTING OR ACIDIZING



(Other)



REPAIRING WELL



ALTERING CASING



ABANDONMENT*

(Note: Report results of multiple completion on Wells
Completion or Recompletion Report and Log form.)

17. DESCRIBE PROPOSED OR COMPLETED OPERATIONS (Clearly state all pertinent details, and give pertinent dates, including estimated date of starting any proposed work. If well is directionally drilled, give subsurface locations and measured and true vertical depths for all markers and zones pertinent to this work.)*

Propose to:

Pull rods and tubing.

Set bridge plug immediately above Gallup perforations.

Run casing inspection log to locate holes in casing.

Squeeze holes with approximately 250 sacks cement.

Drill cement and pressure test casing.

Rerun tubing and rods and put well back on production.

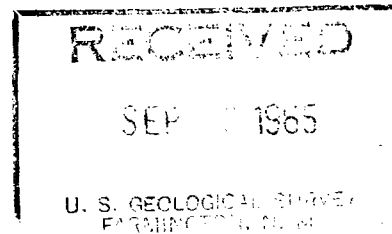
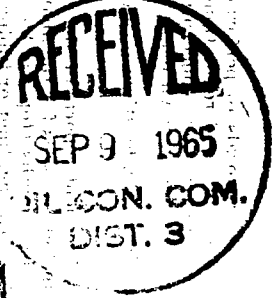

18. I hereby certify that the foregoing is true and correct

SIGNED Carl E. Jameson Carl E. Jameson District EngineerDATE 9-7-65

(This space for Federal or State office use)

APPROVED BY [Signature]
CONDITIONS OF APPROVAL, IF ANY:

TITLE

DATE

*See Instructions on Reverse Side

(May 1963)

DEPARTMENT OF THE INTERIOR (Other instructions on reverse side)
GEOLOGICAL SURVEY

SUNDRY NOTICES AND REPORTS ON WELLS

(Do not use this form for proposals to drill or to deepen or plug back to a different reservoir. Use "APPLICATION FOR PERMIT—" for such proposals.)

5. LEASE DESIGNATION AND SERIAL NO.

SP - 079065

6. IF INDIAN, ALLOTTEE OR TRIBE NAME

7. UNIT AGREEMENT NAME

8. FARM OR LEASE NAME

Artes Total Unit

9. WELL NO.

9

10. FIELD AND POOL, OR WILDCAT

Total Gallup

11. SEC., T., R., M., OR BLK. AND SURVEY OR AREA

Sec. 20, T-29N, R-13W

1.

OIL WELL ☒ GAS WELL ☐ OTHER ☐

2. NAME OF OPERATOR

Artes Oil & Gas Company

3. ADDRESS OF OPERATOR

Drawer 570, Farmington, New Mexico

4. LOCATION OF WELL (Report location clearly and in accordance with any State requirements.* See also space 17 below.)
At surface

660 PBL, 660 PVL, Sec. 20, T-29N, R-13W

14. PERMIT NO.

15. ELEVATIONS (Show whether DF, RT, GR, etc.)

5482 GL

12. COUNTY OR PARISH

San Juan

13. STATE

New Mexico

16.

Check Appropriate Box To Indicate Nature of Notice, Report, or Other Data

NOTICE OF INTENTION TO:

TEST WATER SHUT-OFF

FRACTURE TREAT

SHOOT OR ACIDIZE

REPAIR WELL

(Other)

PULL OR ALTER CASING

MULTIPLE COMPLETE

ABANDON*

CHANGE PLANS

SUBSEQUENT REPORT OF:

WATER SHUT-OFF

FRACTURE TREATMENT

SHOOTING OR ACIDIZING

(Other)

REPAIRING WELL

ALTERING CASING

ABANDONMENT*

(NOTE: Report results of multiple completion on Well Completion or Recompletion Report and Log form.)

17. DESCRIBE PROPOSED OR COMPLETED OPERATIONS (Clearly state all pertinent details, and give pertinent dates, including estimated date of starting any proposed work. If well is directionally drilled, give subsurface locations and measured and true vertical depths for all markers and zones pertinent to this work.)*

Moved in pulling unit September 4, 1965.

Pull rods and pump.

Pull 2-3/8" tubing.

Set Bridge Plug at 5200'.

Run casing inspection log.

Found holes from 3000 to 3200'.

Squeezed with 250 sacks class "C" cement to 2500'.

Drill cement out to 3250'.

Pressure up 1000# - casing okay.

Drill out Bridge Plug.

Run 2-3/8" tubing.

Run rods and pump.

Moved off pulling unit September 11, 1965

RECEIVED

SEP 29 1965

U. S. GEOLOGICAL SURVEY
FARMINGTON, N. M.

RECEIVED
SEP 30 1965

CON. COM.
DIST. 3

18. I hereby certify that the foregoing is true and correct

ORIGINAL SIGNED BY JOE C. SALMON

SIGNED

Joe C. Salmon

TITLE

District Sup't.

DATE

9-24-65

(This space for Federal or State office use)

APPROVED BY

TITLE

DATE

CONDITIONS OF APPROVAL, IF ANY:

*See Instructions on Reverse Side

UNITED STATES
DEPARTMENT OF THE INTERIOR
GEOLOGICAL SURVEYSUBMIT IN TRIPLICATE*
(Other instructions on re-
verse side)Form approved.
Budget Bureau No. 42-R1424.

5. LEASE DESIGNATION AND SERIAL NO.

SF 079065

6. IF INDIAN, ALLOTTEE OR TRIBE NAME

SUNDRY NOTICES AND REPORTS ON WELLS

(Do not use this form for proposals to drill or to deepen or plug back to a different reservoir.
Use "APPLICATION FOR PERMIT—" for such proposals.)

1. OIL WELL <input checked="" type="checkbox"/> GAS WELL <input type="checkbox"/> OTHER <input type="checkbox"/>	7. UNIT AGREEMENT NAME Artesian
2. NAME OF OPERATOR Artesian Oil & Gas Company	8. FARM OR LEASE NAME Artesian
3. ADDRESS OF OPERATOR P. O. Drawer 770, Farmington, New Mexico	9. WELL NO. 4
4. LOCATION OF WELL (Report location clearly and in accordance with any State requirements.* See also space 17 below.) At surface 660' TBL, 660' TBL, Section 20, T-20N, R-13W	10. FIELD AND POOL, OR WELLBOAT Artesian
14. PERMIT NO.	15. ELEVATIONS (Show whether DF, RT, GR, etc.) 5402 GL
	11. SEC. T. R. M. OR BLM. SURVEY OR AREA Sec. 20, T-20N, R-13W
	12. COUNTY OR PARISH San Juan
	13. STATE New Mexico

16. Check Appropriate Box To Indicate Nature of Notice, Report, or Other Data

NOTICE OF INTENTION TO:		SUBSEQUENT REPORT OF:	
TEST WATER SHUT-OFF <input type="checkbox"/>	PULL OR ALTER CASING <input type="checkbox"/>	WATER SHUT-OFF <input type="checkbox"/>	REPAIRING WELL <input type="checkbox"/>
FRACTURE TREAT <input type="checkbox"/>	MULTIPLE COMPLETION <input type="checkbox"/>	FRACTURE TREATMENT <input checked="" type="checkbox"/>	ALTERING CASING <input type="checkbox"/>
SHOOT OR ACIDIZE <input type="checkbox"/>	ABANDON* <input type="checkbox"/>	SHOOTING OR ACIDIZING <input type="checkbox"/>	ABANDONING <input type="checkbox"/>
REPAIR WELL <input type="checkbox"/>	CHANGE PLANS <input type="checkbox"/>	(Other) <input type="checkbox"/>	
(Other) <input type="checkbox"/>		(NOTE: Report results of multiple completion on Well Completion or Recompletion Report and Log form.)	

17. DESCRIBE PROPOSED OR COMPLETED OPERATIONS (Clearly state all pertinent details, and give pertinent dates, including estimated date of starting any proposed work. If well is directionally drilled, give subsurface locations and measured and true vertical depths for all markers and zones pertinent to this work.)*

- 3/17/66 - Moved on pulling unit, pulled 2-3/8" tubing.
3/18/66 - Re-run 2-3/8" tubing and Michel "X" Packer - landed 122'. Packer set 200'.
Paul Tracer Survey checked water entry into perforations from 122' to 121'. Lost oil
treated with 13,000# 20/40 sand, 25,230 gallons oil. API - 4000, API - 7.3,
Instant GIP - 1000'.
3/19/66 - Re-run Tracer Survey and checked flow entry.
3/20/66 - Re-run pump and rods and put well back on production.

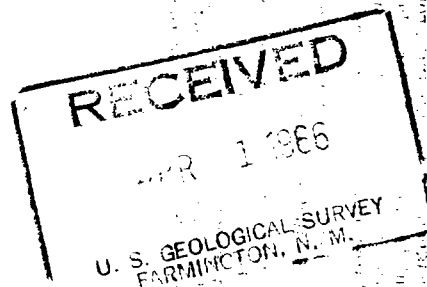

18. I hereby certify that the foregoing is true and correct

ORIGINAL SIGNED BY JOE C. SALMON
SIGNED Joe C. SalmonTITLE District SuperintendentDATE March 31, 1966

(This space for Federal or State office use)

APPROVED BY _____
CONDITIONS OF APPROVAL, IF ANY:

TITLE _____

DATE _____

ILLEGIBLE

*See Instructions on Reverse Side

UNITED STATES
DEPARTMENT OF THE INTERIOR
GEOLOGICAL SURVEY

SUBMIT IN TRIPPLICATE*
(Other instructions on re-
verse side)

Form approved,
Budget Bureau No. 42-R1424.

5. LEASE DESIGNATION AND SERIAL NO.

SF-079065

6. IF INDIAN, ALLOTTEE OR TRIBE NAME

7. UNIT AGREEMENT NAME

8. FARM OR LEASE NAME

Aztec Totah Unit

9. WELL NO.

#9

10. FIELD AND POOL, OR WILDCAT

Totah Gallup

11. SEC., T., R., M., OR BLK. AND
SURVEY OR AREA

Section 20-29N-13W

14. PERMIT NO.

15. ELEVATIONS (Show whether DF, RT, GR, etc.)

5482' GL

12. COUNTY OR PARISH

San Juan

13. STATE

New Mexico

16. Check Appropriate Box To Indicate Nature of Notice, Report, or Other Data

NOTICE OF INTENTION TO:

TEST WATER SHUT-OFF

<input type="checkbox"/>
<input type="checkbox"/>
<input type="checkbox"/>
<input checked="" type="checkbox"/>
<input type="checkbox"/>

PULL OR ALTER CASING

<input type="checkbox"/>
<input type="checkbox"/>
<input type="checkbox"/>
<input type="checkbox"/>
<input type="checkbox"/>

FRACTURE TREAT

MULTIPLE COMPLETE

SHOOT OR ACIDIZE

ABANDON*

REPAIR WELL

CHANGE PLANS

(Other)

SUBSEQUENT REPORT OF:

WATER SHUT-OFF

<input type="checkbox"/>
<input type="checkbox"/>
<input type="checkbox"/>

FRACTURE TREATMENT

SHOOTING OR ACIDIZING

(Other)

REPAIRING WELL

ALTERING CASING

ABANDONMENT*

<input type="checkbox"/>
<input type="checkbox"/>
<input type="checkbox"/>
<input type="checkbox"/>

(NOTE: Report results of multiple completion on Well
Completion or Recompletion Report and Log form.)

17. DESCRIBE PROPOSED OR COMPLETED OPERATIONS (Clearly state all pertinent details, and give pertinent dates, including estimated date of starting any proposed work. If well is directionally drilled, give subsurface locations and measured and true vertical depths for all markers and zones pertinent to this work.) *

PROPOSE TO:

Pull 2-3/8" tubing, run packer.
Squeeze off existing perforations from 5269-81.
Re-perforate from 5220-40.
Acidize with 1000 gallons of 28% acid.
Swab test well.
Return to production.

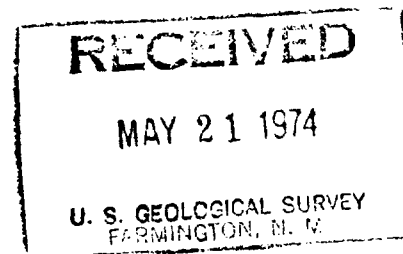

18. I hereby certify that the foregoing is true and correct

SIGNED

[Signature]

TITLE

District Superintendent

DATE

May 20, 1974

(This space for Federal or State office use)

APPROVED BY

TITLE

DATE

CONDITIONS OF APPROVAL, IF ANY:



OIL CONSERVATION COMMISSION

STATE OF NEW MEXICO
1000 RIO BRAZOS RD. - AZTEC

87410

DIRECTOR
JOE D. RAMEY

LAND COMMISSIONER
PHIL R. LUCERO



STATE GEOLOGIST
EMERY C. ARNOLD

August 9, 1976

Mr. L. O. Van Ryan
Aztec Oil & Gas Co.
P. O. Drawer 570
Farmington, New Mexico

Re: Aztec Oil & Gas Co.
Aztec Totah Unit #~~18~~ 9
M-20-29N-13W

Dear Mr. Van Ryan:

An intention to repair the subject well was filed in May, 1974.

A subsequent report of repair has not been received.

A suspected casing leak was reported in 1975. No report of remedial action has been received.

If remedial action has not commenced on November 1, 1976, a case will be called before the Commission to allow all interested parties to appear and to show why the well should not be repaired or plugged.

If there are questions, please contact us.

Yours very truly,

A. R. Kendrick
A. R. Kendrick
Supervisor, District #3

ARK:mc

Attachment

xc: Oil Conservation Commission
Santa Fe, New Mexico

NO. OF COPIES RECEIVED		
DISTRIBUTION		7
SANTA FE		1
FILE		1
U.S.G.S.		
LAND OFFICE		
TRANSPORTER	OIL	1
	GAS	
OPERATOR		4
PRORATION OFFICE		

NEW MEXICO OIL CONSERVATION COMMISSION
REQUEST FOR ALLOWABLE
AND
AUTHORIZATION TO TRANSPORT OIL AND NATURAL GAS

Form C-104
Supersedes Old C-104 and C-110
Effective 1-1-65

Operator		SOUTHLAND ROYALTY COMPANY	
Address		P.O. Drawer 570 Farmington, N.M. 87401	
Reason(s) for filing (check proper box)		Other (Please explain)	
New Well	<input type="checkbox"/>	Change in Transporter of:	
Recompletion	<input type="checkbox"/>	Oil	<input type="checkbox"/>
Change in Ownership	<input type="checkbox"/>	Casinghead Gas	<input type="checkbox"/>
		Dry Gas	<input type="checkbox"/>
		Condensate	<input type="checkbox"/>
		Name change	

If change of ownership give name
and address of previous owner

II. DESCRIPTION OF WELL AND LEASE

Lease Name	Well No.	Pool Name, Including Formation	Kind of Lease	Lease No.
Aztec Totah Unit	9	Totah Gallup	State, Federal or Fee	SF-079065
Location				
Unit Letter	M	660	South	660
Feet From The		Line and	Feet From The	
Line of Section	20	Township	29N	Range
		13W	San Juan	
		NMPM,	County	

III. DESIGNATION OF TRANSPORTER OF OIL AND NATURAL GAS

Name of Authorized Transporter of Oil <input checked="" type="checkbox"/> or Condensate <input type="checkbox"/>	Address (Give address to which approved copy of this form is to be sent)	
Four Corners Pipeline	Box 1588, Farmington, New Mexico	
Name of Authorized Transporter of Casinghead Gas <input type="checkbox"/> or Dry Gas <input type="checkbox"/>	Address (Give address to which approved copy of this form is to be sent)	
If well produces oil or liquids, give location of tanks.	Unit	Sec.
	Twp.	Rge.
	Is gas actually connected?	When

If this production is commingled with that from any other lease or pool, give commingling order number:

IV. COMPLETION DATA

Designate Type of Completion - (X)	Oil Well	Gas Well	New Well	Workover	Deepen	Plug Back	Same Res'v.	Diff. Res'v.
Date Spudded	Date Compl. Ready to Prod.		Total Depth		P.B.T.D.			
Elevations (DF, RKB, RT, GR, etc.)	Name of Producing Formation		Top Oil/Gas Pay		Tubing Depth			
Perforations					Depth Casing Shoe			
TUBING, CASING, AND CEMENTING RECORD								
HOLE SIZE	CASING & TUBING SIZE		DEPTH SET		SACKS CEMENT			

V. TEST DATA AND REQUEST FOR ALLOWABLE OIL WELL (Test must be after recovery of total volume of load oil and must be equal to or exceed top allowable for this depth or be for full 24 hours)

Date First New Oil Run To Tanks	Date of Test	Producing Method (Flow, pump, gas lift, etc.)	
Length of Test	Tubing Pressure	Casing Pressure	Choke Size
Actual Prod. During Test	Oil-Bbls.	Water-Bbls.	Gas-MCF

GAS WELL

Actual Prod. Test-MCF/D	Length of Test	Bbls. Condensate/MMCF	Gravity of Condensate
Testing Method (pitot, back pr.)	Tubing Pressure (shut-in)	Casing Pressure (shut-in)	Choke Size

VI. CERTIFICATE OF COMPLIANCE

I hereby certify that the rules and regulations of the Oil Conservation Commission have been complied with and that the information given above is true and complete to the best of my knowledge and belief.

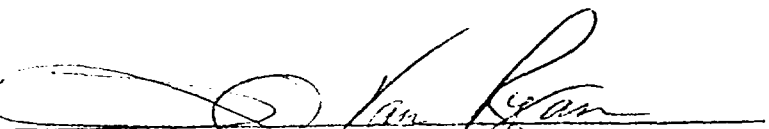
District Production Mgr.
1-1-78
(Date)

OIL CONSERVATION COMMISSION
JAN 12 1978
APPROVED
BY Original Signed by A. R. Kendrick
TITLE SUPERVISOR DIST. #3

This form is to be filed in compliance with RULE 1104.
If this is a request for allowable for a newly drilled or deepened well, this form must be accompanied by a tabulation of the deviation tests taken on the well in accordance with RULE 111.

All sections of this form must be filled out completely for allowable on new and recompleted wells.

Fill out only Sections I, II, III, and VI for changes of owner, well name or number, or transporter, or other such change of condition.

Separate Forms C-104 must be filed for each pool in multiply completed wells.

DEPARTMENT OF THE INTERIOR
GEOLOGICAL SURVEY

SF-179065

SUNDRY NOTICES AND REPORTS ON WELLS

(Do not use this form for proposals to drill or to deepen or plug back to a different reservoir.
Use "APPLICATION FOR PERMIT—" for such proposals.)

1. OIL WELL <input checked="" type="checkbox"/> GAS WELL <input type="checkbox"/> OTHER <input type="checkbox"/>		7. UNIT AGREEMENT NAME	
2. NAME OF OPERATOR Aztec Oil & Gas Company		8. FARM OR LEASE NAME Aztec Totah Unit	
3. ADDRESS OF OPERATOR P. O. Drawer 570, Farmington, New Mexico 87401		9. WELL NO. #9	
4. LOCATION OF WELL (Report location clearly and in accordance with any State requirements.* See also space 17 below.) At surface 660' FSL & 660' FWL Section 20-29N-13W		10. FIELD AND POOL, OR WILDCAT. Totah Gallup	
14. PERMIT NO.		11. SEC., T., R., M., OR BLK. AND SURVEY OR AREA Section 20-29N-13W	
15. ELEVATIONS (Show whether DF, RT, OR, etc.) 5482		12. COUNTY OR PARISH San Juan	
		13. STATE New Mex	

16. Check Appropriate Box To Indicate Nature of Notice, Report, or Other Data

NOTICE OF INTENTION TO:

TEST WATER SHUT-OFF

FRACTURE TREAT

SHOOT OR ACIDIZE

REPAIR WELL

(Other)

FULL OR ALTER CASING

MULTIPLE COMPLETE

ABANDON*

CHANGE PLANS

Temporarily Abandon

SUBSEQUENT REPORT OF:

WATER SHUT-OFF

FRACTURE TREATMENT

SHOOTING OR ACIDIZING

(Other)

REPAIRING WELL

ALTERING CASING

ABANDONMENT*

(Note: Report results of multiple completion on Well Completion or Recompletion Report and Log form.)

17. DESCRIBE PROPOSED OR COMPLETED OPERATIONS (Clearly state all pertinent details, and give pertinent dates, including estimated date of starting proposed work. If well is directionally drilled, give subsurface locations and measured and true vertical depths for all markers and zones pertinent to this work.)*

This well is not economical to produce under present conditions.
It is located in a secondary recovery project and is a potential well for additional secondary recovery or tertiary recovery methods if economics change.

TEMPORARY ABANDONMENT
EXPIRES

OCT 31 1976



RECEIVED

JUN 21 1976

U. S. GEOLOGICAL SURVEY

18. I hereby certify that the foregoing is true and correct

SIGNED

TITLE

District Superintendent

DATE

June 18, 1976

(This space for Federal or State office use)

APPROVED BY

TITLE

DATE

CONDITIONS OF APPROVAL, IF ANY:

*See Instructions on Reverse Side

UNITED STATES
DEPARTMENT OF THE INTERIOR
GEOLOGICAL SURVEYSUBMIT IN TRIPPLICATE*
(Other instructions on reverse side)Form approved,
Budget Bureau No. 42-R1424.

5. LEASE DESIGNATION AND SERIAL NO.

SF-079065

6. IF INDIAN, ALLOTTEE OR TRIBE NAME

7. UNIT AGREEMENT NAME

8. FARM OR LEASE NAME

Aztec Totah Unit

9. WELL NO.

#9

10. FIELD AND POOL, OR WILDCAT

Totah Gallup

11. SEC., T., R., M., OR BLK. AND
SURVEY OR AREA

Section 20, T29N, R13W

12. COUNTY OR PARISH 13. STATE

San Juan

New Mexico

SUNDRY NOTICES AND REPORTS ON WELLS

(Do not use this form for proposals to drill or to deepen or plug back to a different reservoir.
Use "APPLICATION FOR PERMIT—" for such proposals.)

1.

OIL ☐ WELL GAS ☒ WELL OTHER

2. NAME OF OPERATOR

Southland Royalty Company

3. ADDRESS OF OPERATOR

P. O. Drawer 570, Farmington, New Mexico 87401

4. LOCATION OF WELL (Report location clearly and in accordance with any State requirements.*
See also space 17 below.)

At surface

660' FSL & 660' FWL

14. PERMIT NO.

15. ELEVATIONS (Show whether DF, RT, GR, etc.)

5482' GL

16. Check Appropriate Box To Indicate Nature of Notice, Report, or Other Data

NOTICE OF INTENTION TO:

TEST WATER SHUT-OFF ☐FRACTURE TREAT ☐SHOOT OR ACIDIZE ☐REPAIR WELL ☐

(Other) Repair casing leak

PULL OR ALTER CASING ☐MULTIPLE COMPLETE ☐ABANDON* ☐CHANGE PLANS ☐☒

SUBSEQUENT REPORT OF:

WATER SHUT-OFF ☐FRACTURE TREATMENT ☐SHOOTING OR ACIDIZING ☐(Other) ☐REPAIRING WELL ☐ALTERING CASING ☐ABANDONMENT* ☐(NOTE: Report results of multiple completion on Well
Completion or Recompletion Report and Log form.)

17. DESCRIBE PROPOSED OR COMPLETED OPERATIONS (Clearly state all pertinent details, and give pertinent dates, including estimated date of starting any proposed work. If well is directionally drilled, give subsurface locations and measured and true vertical depths for all markers and zones pertinent to this work.)*

1. MIRU.
2. Pull tubing, kill well if necessary, lay down bad tubing.
3. Run casing inspection log and TDT. Set wire line bridge plug above Gallup perfs at 5220'.
4. Squeeze holes in casing. Waiting on cement 12 hours. Drill out cement and test squeeze. Drill bridge plug.
5. Swab well and test lower zone.
6. Acidize with 500 gals 15% Hcl with nonionic surfactant (D 600). Swab test.
7. Run 2-3/8" tubing with tubing pump.
8. Run pump and rods.
9. Moved in pumping unit.
10. Space out pump. Release rig.

18. I hereby certify that the foregoing is true and correct

SIGNED

TITLE District Production Manager DATE January 23, 1978

(This space for Federal or State office use)

APPROVED BY

TITLE

DATE

CONDITIONS OF APPROVAL, IF ANY:

RECEIVED

JAN 24 1978

*See Instructions on Reverse Side

OIL CONSERVATION DIVISION

P. O. BOX 2088

SANTA FE, NEW MEXICO 87501

REQUEST FOR ALLOWABLE
AND
AUTHORIZATION TO TRANSPORT OIL AND NATURAL GASMAR 09 1981
OIL CONSERVATION DIVISION
SANTA FE

1. OPERATOR

Paramount Petroleum Corp.

Address

P.O. Box 22763

Houston, Tx.

77027

Reason(s) for filing (Check proper box)

New Well ☐Recompletion ☐Change in Ownership ☒

Change in Transporter of:

Oil ☒Casinghead Gas ☐Dry Gas ☐Condensate ☐

Other (Please explain)

If change of ownership give name
and address of previous owner

Southland Royalty Co.

1000 Ft. Worth Club Tower, Ft. Worth

II. DESCRIPTION OF WELL AND LEASE

Lease Name Attec Totah Unit	Well No. 9	Pool Name, Including Formation Gallup	Kind of Lease State, Federal or Fee FEDERAL
Location Unit Letter M : 660 Feet From The S Line and 660 Feet From The W Line of Section 20 Township 29 N Range 13 W , NMPM, San Juan Co.			

III. DESIGNATION OF TRANSPORTER OF OIL AND NATURAL GAS

Name of Authorized Transporter of Oil <input checked="" type="checkbox"/> or Condensate <input type="checkbox"/> Plateau Inc.	Address (Give address to which approved copy of this form is to be sent) 501 Airport #151 Farmington, N.M. 87401				
Name of Authorized Transporter of Casinghead Gas <input type="checkbox"/> or Dry Gas <input type="checkbox"/>	Address (Give address to which approved copy of this form is to be sent)				
If well produces oil or liquids, give location of tanks.	Unit	Sec.	Twp. Rge.	Is gas actually connected?	When

If this production is commingled with that from any other lease or pool, give commingling order number:

IV. COMPLETION DATA

Designate Type of Completion - (X)		Oil Well	Gas Well	New Well	Workover	Deepen	Plug Back	Same Res'tv.	DI
Date Spudded	Date Compl. Ready to Prod.	Total Depth			P.B.T.D.				
Elevations (D, RT, GR, etc.)	Name of Producing Formation	Top Oil/Gas Pay			Tubing Depth				
Perforations						Depth Casing Shoe			
TUBING, CASING, AND CEMENTING RECORD									
HOLE SIZE	CASING & TUBING SIZE		DEPTH SET			SACKS CEMENT			

V. TEST DATA AND REQUEST FOR ALLOWABLE OIL WELL

(Test must be after recovery of total volume of load oil and must be equal to or exceed able for this depth or be for full 24 hours)

Date First New Oil Run To Tanks	Date of Test	Producing Method (Flow, pump, gas lift, etc.)	
Length of Test	Tubing Pressure	Casing Pressure	Choke Size
Actual Prod. During Test	Oil-Bbls.	Water-Bbls.	Gas-MCF

GAS WELL

Actual Prod. Test-MCF/D	Length of Test	Bbls. Condensate/MMCF	Gravity of Condensate
Testing Method (pilot, back pr.)	Tubing Pressure (Shut-in)	Casing Pressure (Shut-in)	Choke Size

VI. CERTIFICATE OF COMPLIANCE

I hereby certify that the rules and regulations of the Oil Conservation Division have been complied with and that the information given above is true and complete to the best of my knowledge and belief.

V.P. Operations

03/03/81

OIL CONSERVATION DIVISION

APPROVED MAR 11 1981, 19

BY _____

TITLE SUPERVISOR DISTRICT #This form is to be filed in compliance with RULE 110.
If this is a request for allowable for a newly drilled or well, this form must be accompanied by a tabulation of the tests taken on the well in accordance with RULE 111.

All sections of this form must be filled out completely able on new and recompleted wells.

Fill out only Sections I, II, III, and VI for changes well name or number, or transporter, or other such change of Separate Forms C-104 must be filed for each pool in



NEW MEXICO ENERGY, MINERALS & NATURAL RESOURCES DEPARTMENT

OIL CONSERVATION DIVISION
AZTEC DISTRICT OFFICE
1000 RIO BRAZOS ROAD
AZTEC, NEW MEXICO 87410
(505) 334-6178 Fax (505) 334-6170

GARY E. JOHNSON
GOVERNOR

JENNIFER A. SALISBURY
CABINET SECRETARY

June 23, 1997

Rand Carroll
Oil Conservation Division Attorney
2040 S Pacheco
Santa Fe NM 87505

RE: Paramount Petroleum Inc., Federal Orphan Wells

Dear Rand:

The following Aztec Totah Unit wells are Federal orphan wells:

#1	A-29-29N-13W	30-045-07923	#2	G-29-29N-13W	30-045-07871
#3	I-29-29N-13W	30-045-07844	#4	C-29-29N-13W	30-045-07919
#5	K-29-29N-13W	No API	#6	E-29-29N-13W	30-045-07890
#8	K-20-29N-13W	30-045-08011	#9	M-20-29N-13W	30-045-07965
#10	I-19-29N-13W	30-045-08014	#13	C-19-29N-13W	30-045-08156
#15	D-34-29N-13W	30-045-13099	#16	B-34-29N-13W	30-045-07738
#17	F-34-29N-13W	30-045-07706	#18	H-34-29N-13W	30-045-07683
#19	L-34-29N-13W	30-045-07665	#20	J-34-29N-13W	30-045-07656
#21	P-34-29N-13W	30-045-07612	#22	N-34-29N-13W	30-045-07608

Steve Mason with the BLM asked that we plug and abandon the wells using the reclamation fund. I have enclosed his plugging procedures for each well. Our inspection didn't find any wells that would be classified as emergency wells but due to the location of the wells (close to Farmington) and the deteriorating conditions of the wellbore, I would like to plug the wells as soon as possible.

Please notify me of your schedule and when I may expect to begin work. If there is any other paper work needed feel free to contact me at 334-6178.

Sincerely,

Johnny Robinson
Deputy O&G Inspector

JR/sh

cc: Steve Mason BLM well files

enc.