

**SAN JUAN 31-6 UNIT
PA OWNERSHIP SUMMARY**

**I. FRUITLAND PARTICIPATING AREA, FIFTEENTH EXPANSION
EFFECTIVE 6/1/95, 9729.38**

<u>OWNER NAME</u>	<u>PERCENTAGE</u>
Phillips-San Juan Partners, L. P.	49.577210%
Burlington Resources Oil & Gas Company	22.556790%
Williams Production Company	16.934550%
CBP San Juan Limited Partnership	2.878050%
Wiser Oil Company	1.644500%
Conoco Inc.	1.642970%
Amoco Production Company	1.642960%
Four Star Oil & Gas Company	1.573250%
Cross Timbers Production Company	1.549720%

**II. MESAVERDE PARTICIPATING AREA, SIXTEENTH EXPANSION
EFFECTIVE 1/1/86, 7809.38 ACRES**

<u>OWNER NAME</u>	<u>PERCENTAGE</u>
Phillips Petroleum Company	46.035470%
Burlington Resources Oil & Gas Company	28.102570%
Williams Production Company	11.498540%
Cinco General Partnership	3.585630%
Amoco Production Company	3.071310%
Wiser Oil Company	2.048820%
Conoco Inc.	2.046900%
Cross Timbers Production Company	1.930730%
Four Star Oil & Gas Company	1.680030%

**III. DAKOTA PARTICIPATING AREA, ELEVENTH EXPANSION
EFFECTIVE 11/1/84, 6577.37 ACRES**

<u>OWNER NAME</u>	<u>PERCENTAGE</u>
Phillips-New Mexico Partners, L. P.	90.982410%
Amoco Production Company	2.432590%
Four Star Oil & Gas Company	2.432580%
Wiser Oil Company	2.432580%
Cross Timbers Production Company	1.341470%
Burlington Resources Oil & Gas Company	0.378370%

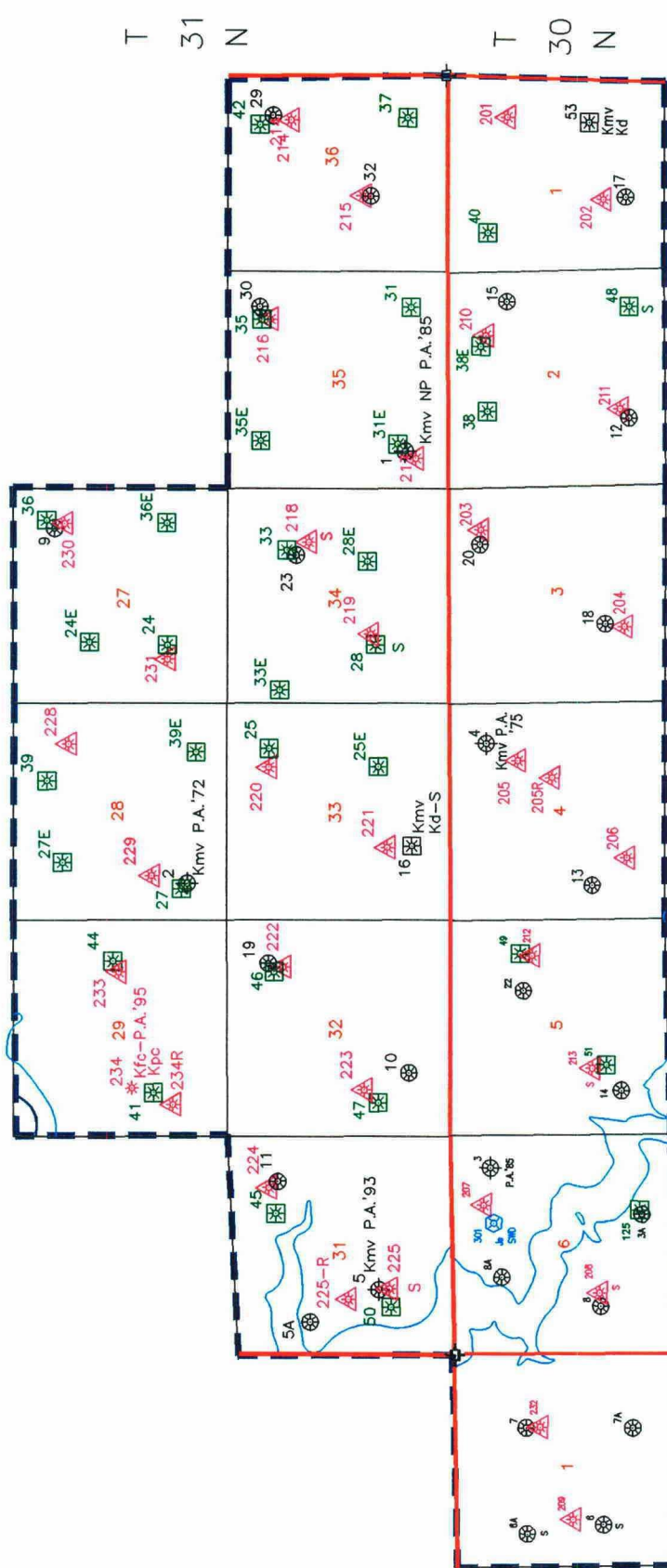

R-7-W

R-6-W

PHILLIPS PETR. CO.

SAN JUAN 31-6 UNIT

RIO ARRIBA CO, NM

March 4, 1999

J. Hopkins

- ▲ FRUITLAND Kf
- MESAVERDE Kmv
- DAKOTA Kd
- ALL PRODUCTION BELOW CRETACEOUS
- ▲ CLIFFHOUSE MENEFEE POINT LOOKOUT
- ENTRADA PARADOX BARKER CREEK LEADVILLE

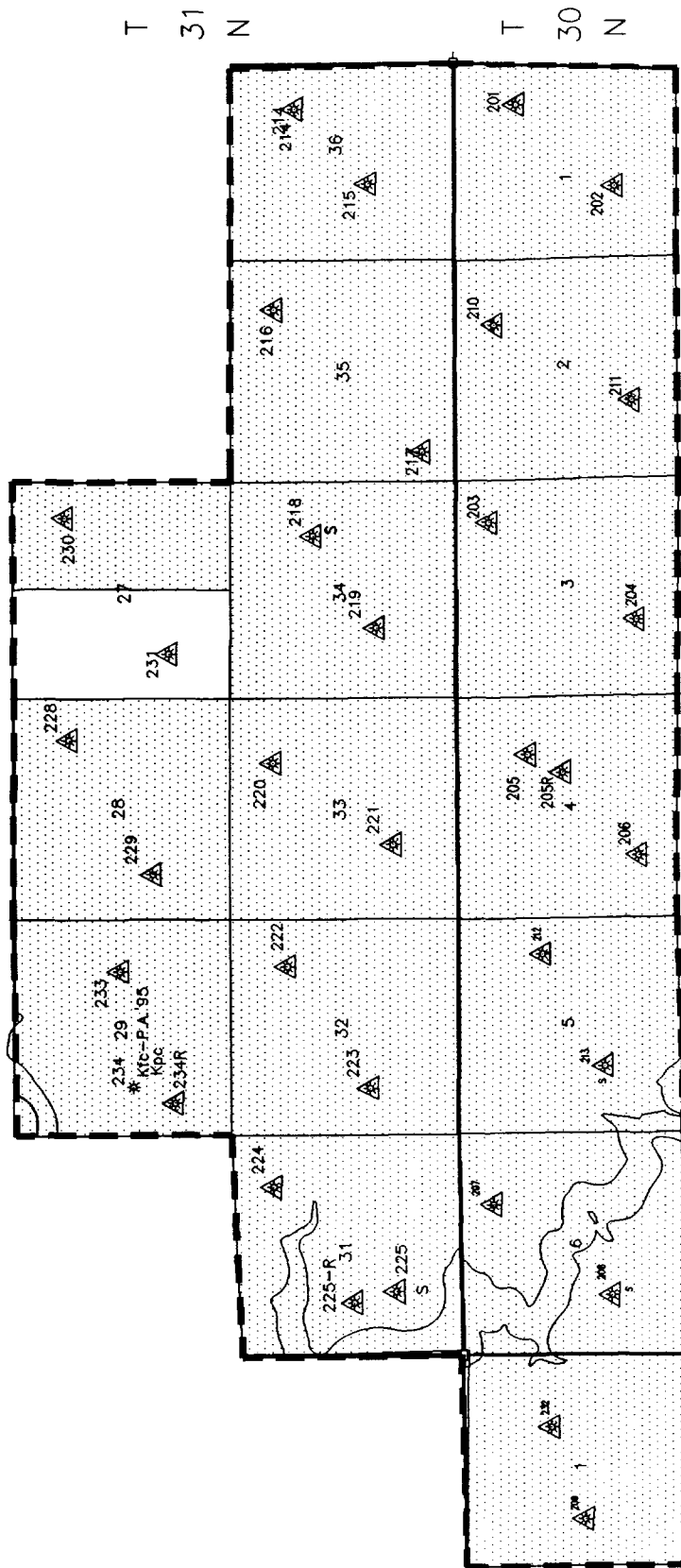

R-7-W

R-6-W

Fruitland Coal Participating Area
15th expansion Eff. 6/1/95

PHILLIPS PETR. CO.

SAN JUAN 31-6 UNIT
RIO ARRIBA CO, NM

March 4, 1999 J. Hopkins

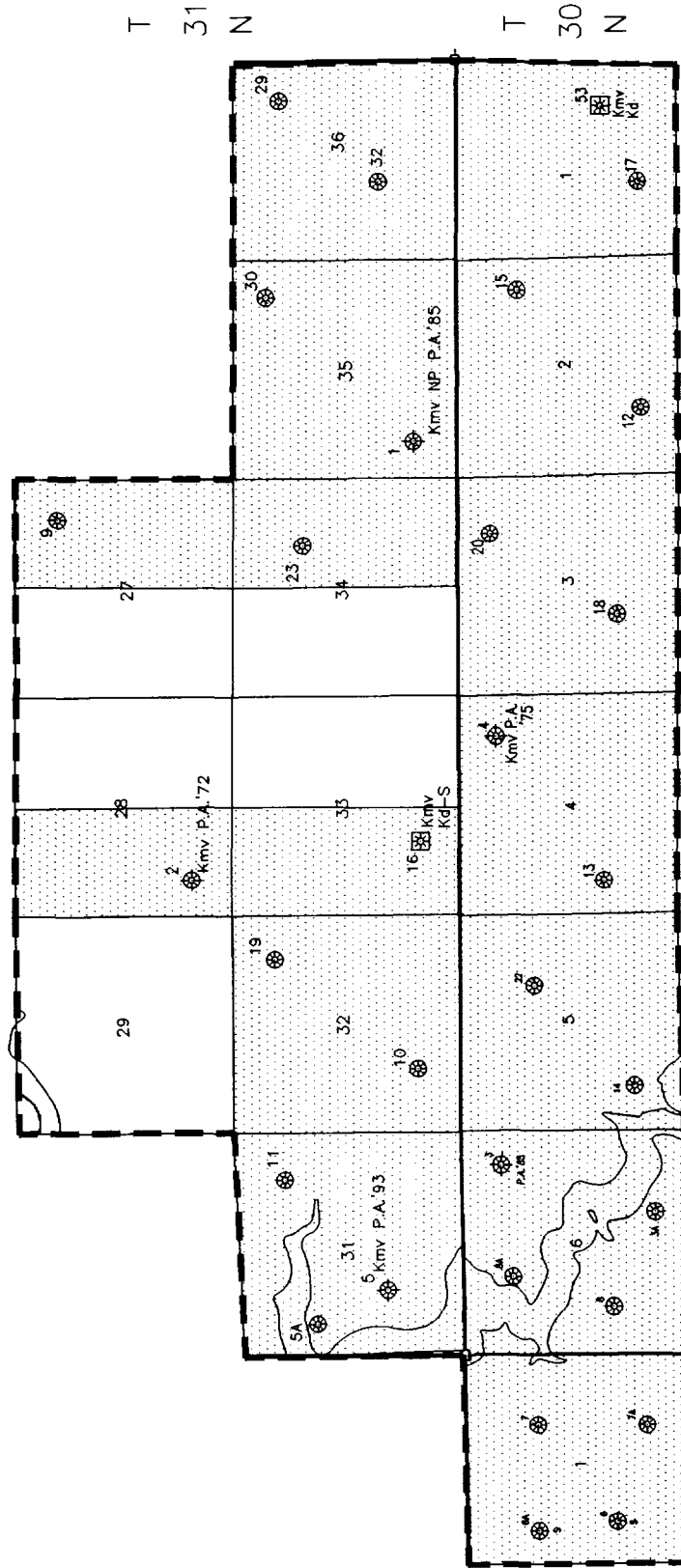

R-6-W

R-7-W

PHILLIPS PETR. CO.

SAN JUAN 31-6 UNIT

RIO ARRIBA CO, NM

March 4, 1999 J. Hopkins

Mesaverde Participating Area
16th expansion Eff. 1/1/86



CLIFFHOUSE
MENEFE
POINT LOOKOUT

{ Kch
Kmv
Kpl

⊗ MESAVERDE- Kmv

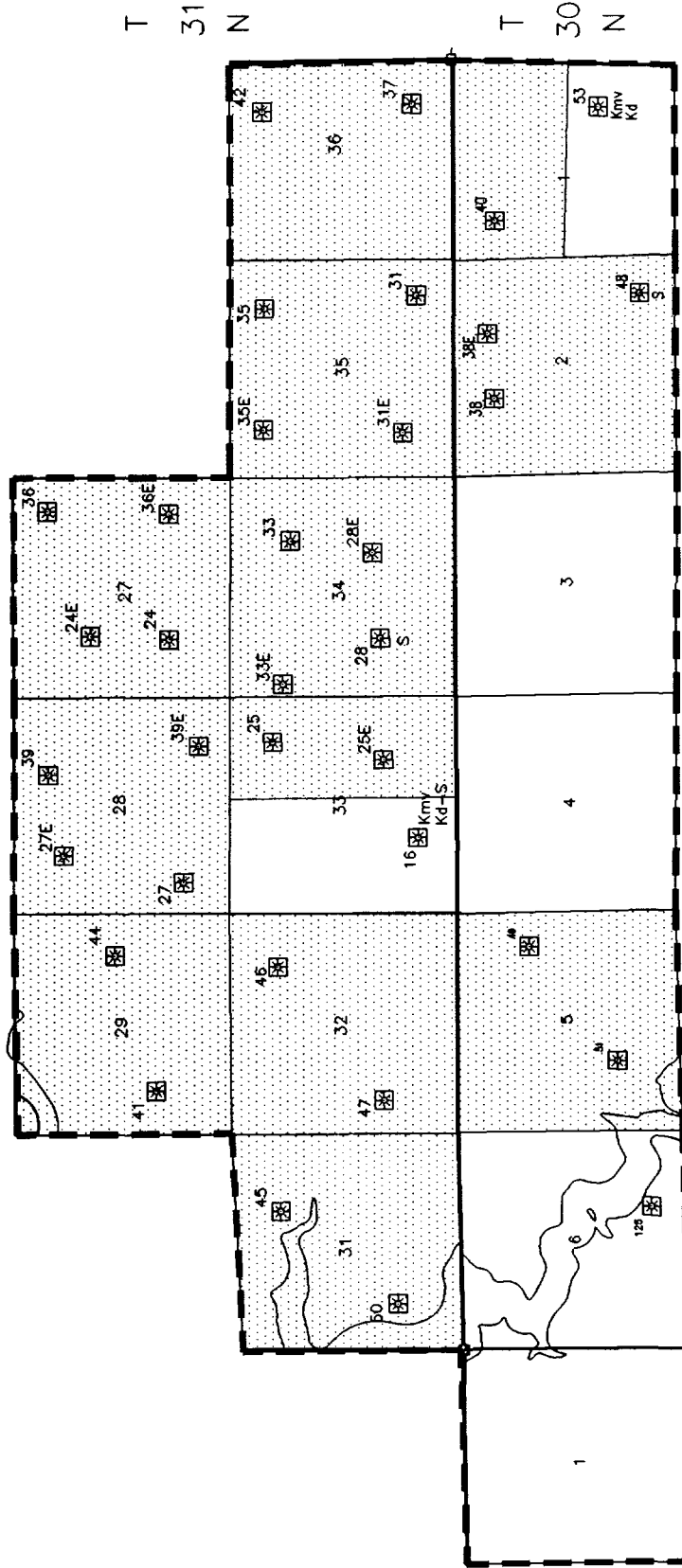

R-6-W

R-7-W

PHILLIPS PETR. CO.

SAN JUAN 31-6 UNIT

RIO ARRIBA CO, NM

March 4, 1999 J. Hopkins

Dakota Participating Area
11th expansion Eff. 11/1/84



DAKOTA Kd