

NEW MEXICO OIL CONSERVATION COMMISSION
WELL LOCATION AND ACREAGE DEDICATION PLAT

Form C-102
Supersedes C-128
Effective 1-1-65

All distances must be from the outer boundaries of the Section.

| | | | | | |
|--|---------------------|---------------------------|----------------------|----------------------|--|
| Operator CONTINENTAL OIL COMPANY | | Lease WELLS B-1 | | Well No. 4 | |
| Unit Letter I | Section 1 | Township 25-S | Range 36-E | County LEA | |

| | | | | | |
|---|--------------------------------------|---------------------------|--|--|--|
| Actual Footage Location of Well: 660 feet from the EAST line and 1980 feet from the SOUTH line | | | | | |
| Ground Level Elev. 3215 | Producing Formation JALMAT | Pool JALMAT GAS | Dedicated Acreage: 160 Acres | | |

- Outline the acreage dedicated to the subject well by colored pencil or hachure marks on the plat below.
- If more than one lease is dedicated to the well, outline each and identify the ownership thereof (both as to working interest and royalty).
- If more than one lease of different ownership is dedicated to the well, have the interests of all owners been consolidated by communitization, unitization, force-pooling, etc?

☐ Yes ☐ No If answer is "yes," type of consolidation _____

If answer is "no," list the owners and tract descriptions which have actually been consolidated. (Use reverse side of this form if necessary.) _____

No allowable will be assigned to the well until all interests have been consolidated (by communitization, unitization, forced-pooling, or otherwise) or until a non-standard unit, eliminating such interests, has been approved by the Commission.

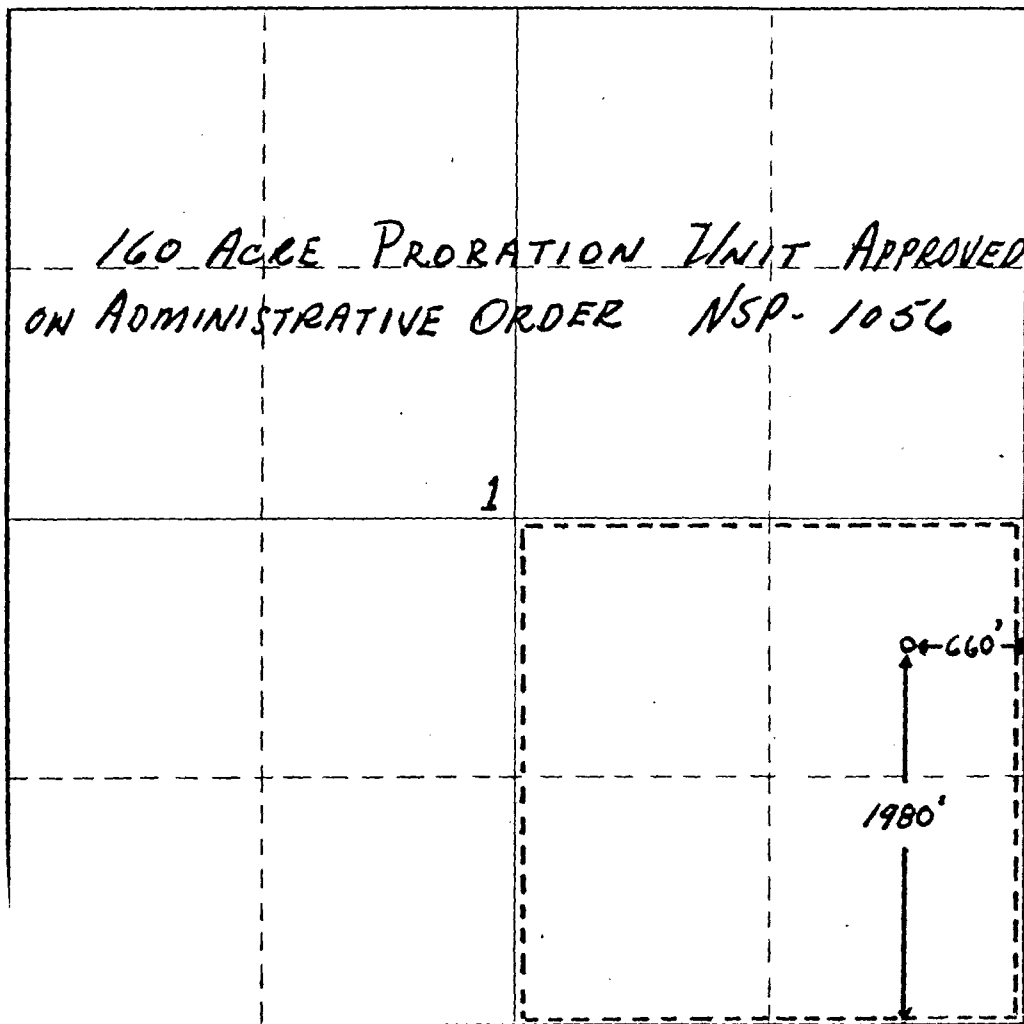

CERTIFICATION

I hereby certify that the information contained herein is true and complete to the best of my knowledge and belief.

Name
Don A. Lee
Position
Admin. Supervisor
Company
CONTINENTAL OIL Co.
Date
8-31-77

I hereby certify that the well location shown on this plat was plotted from field notes of actual surveys made by me or under my supervision, and that the same is true and correct to the best of my knowledge and belief.

Date Surveyed

Registered Professional Engineer and/or Land Surveyor

Certificate No.

MOCC. HOBBS (3) - ARCO - CHEVRON - AMOCO - FILE

actual reclassification date 11/95: ONGARD Can't
accommodate: per Ed Martin use 3-11-96 date
NSP-1056-B (L) 3/11/96 #4 40ac Jalmat Oil well
#7 200ac Jalmat Gas 8/10/95
NSP-1056 A (L) (SD) 240ac Jalmat
7/6/95 1/2 NE/4 + SE/4 Share #7