

NSL(SD) 11/1/99

SDX RESOURCES, INC.

P.O. BOX 5061
MIDLAND, TEXAS 79704
(915) 685-1761

Sept. 9, 1999

NMOCD
2040 South Pacheco Street
Santa Fe, NM 87505

Attention: Mr. Mike Stogner

RE: EJ Wells Fed. #25
Sec. 5, T25S, R37E
2180' FSL, 1980 FWL
Lea County, New Mexico

OCT 1 1999

(136)

Dear Mr. Stogner,

SDX Resources, Inc. is the operator of the EJ Wells Fed. #13 and #16 wells located in unit L of sec. 5 T25S R37E of Lea Co., N.M.. These wells are dedicated to a 120 acre non-standard gas proration unit created by NSL #1823 (6/22/84) and consisting of units K,L,& M of sec. 5. SDX is planning to drill the EJ Wells Fed. #25 well on the same 120 acre proration unit at the above-mentioned location. This will be a non-standard location as the location has been moved due to the wells proximity to a pipeline and an existing 7-Rivers oil well.. SDX request that this letter serve as application to simultaneously dedicate this 120 acre non-standard proration unit to the EJ Wells Fed. #13, # 16, and the #25 wells, and as application for administrative approval of the non-standard location. BLM form 3160 and OCD form C-102 for the #25 well, an outlined lease map, and other pertinent information is attached to this application. All offset operators have been notified and proof of notification is attached. Your assistance on this is appreciated.

Sincerely,



Chuck Morgan

Enclosures

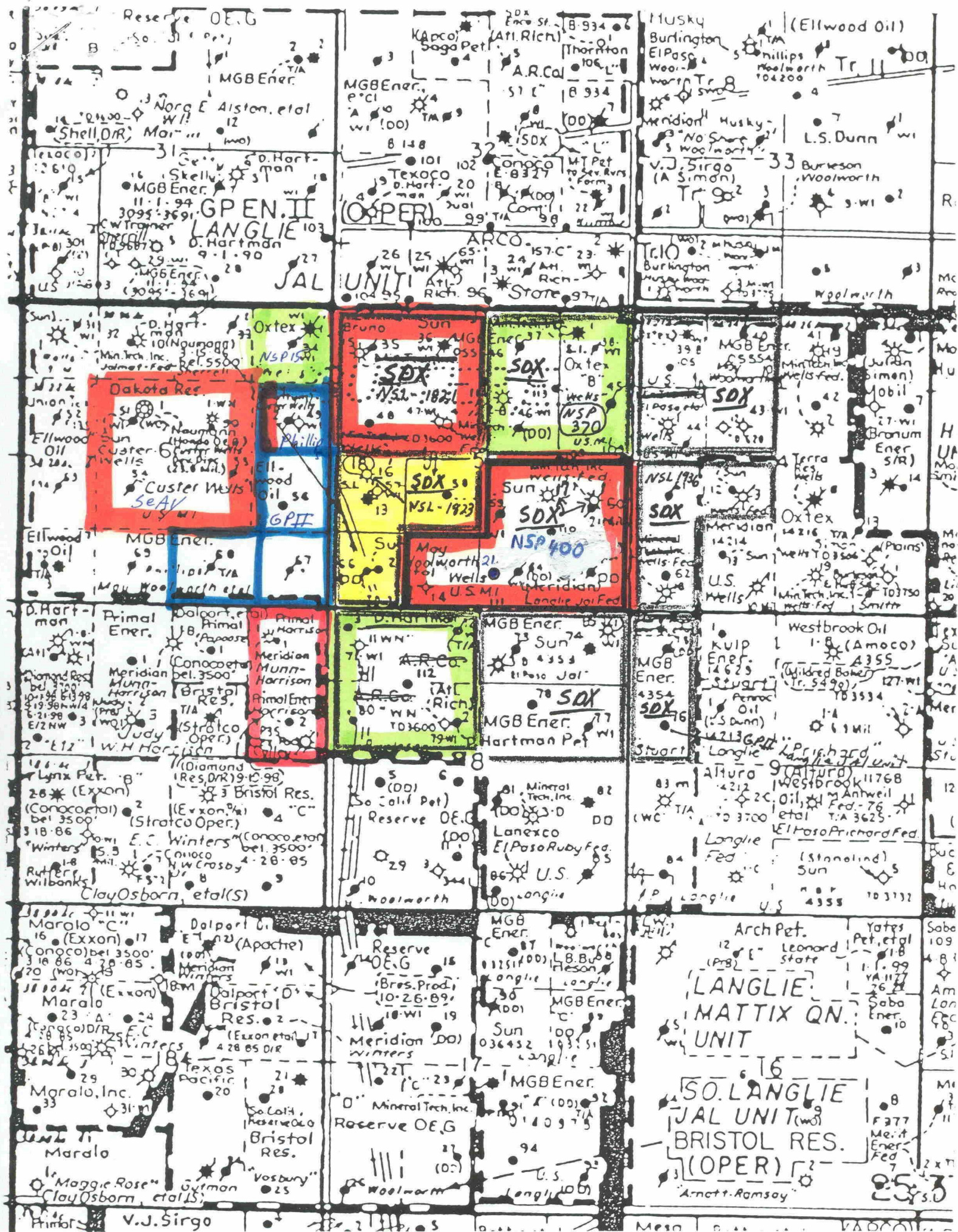

UNITED STATES
DEPARTMENT OF THE INTERIOR
BUREAU OF LAND MANAGEMENT

SUBMIT IN TRIPLICATE*
(Other instructions on
reverse side)

FORM APPROVED
OME NO. 1004-0136
Expires: February 28, 1995

APPLICATION FOR PERMIT TO DRILL OR DEEPEN

1a. TYPE OF WORK DRILL <input checked="" type="checkbox"/> DEEPEN <input type="checkbox"/>			5. LEASE DESIGNATION AND SERIAL NO LC-055546	
b. TYPE OF WELL OIL WELL <input type="checkbox"/> GAS WELL <input checked="" type="checkbox"/> OTHER <input type="checkbox"/> SINGLE ZONE <input checked="" type="checkbox"/> MULTIPLE ZONE <input type="checkbox"/>			6. IF INDIAN, ALLOTTEE OR TRIBE NAME	
2. NAME OF OPERATOR SDX Resources, Inc.			7. UNIT AGREEMENT NAME	
3. ADDRESS AND TELEPHONE NO PO Box 5061, Midland, TX 79704			8. FARM OR LEASE NAME, WELL NO EJ Wells Federal #25	
4. LOCATION OF WELL (Report location clearly and in accordance with any State requirements *) At surface 2180' FSL, 1980' FWL, Unit K At proposed prod. zone Same			9. API WELL NO	
14. DISTANCE IN MILES AND DIRECTION FROM NEAREST TOWN OR POST OFFICE* 2.5 miles NE of Jal, NM			10. FIELD AND POOL, OR WILDCAT Jalmat Gas	
15. DISTANCE FROM PROPOSED* LOCATION TO NEAREST PROPERTY OR LEASE LINE, FT (Also to nearest drlg. unit line, if any) 660			11. SEC., T., R., M., OR BLK AND SURVEY OR AREA Sec. 5, T25S, R37E	
16. NO. OF ACRES IN LEASE 918			12. COUNTY OR PARISH Lea	
17. NO. OF ACRES ASSIGNED TO THIS WELL 120			13. STATE NM	
18. DISTANCE FROM PROPOSED LOCATION* TO NEAREST WELL, DRILLING, COMPLETED, OR APPLIED FOR, ON THIS LEASE, FT 3200			20. ROTARY OR CABLE TOOLS Rotary	
21. ELEVATIONS (Show whether DF, RT, GR, etc.) 3217			22. APPROX. DATE WORK WILL START* 10/15/99	

23. PROPOSED CASING AND CEMENTING PROGRAM				
SIZE OF HOLE	GRADE, SIZE OF CASING	WEIGHT PER FOOT	SETTING DEPTH	QUANT. TY OF CEMENT
12-1/4"	8-5/8"	24#	600'	350 sx
7-7/8"	4-1/2 - 5-1/2"	9.5 - 17#	3200'	400 sx Lite + 200 sx C

Plan to drill 12-1/4" hole to appx 600'. Set 8-5/8" surface csg. Circ Class C cmt. Drill 7-7/8" hole to 3200'. Set 4-1/2" or 5-1/2" csg & circ cmt. Perf Yates gas zone & stimulate as necessary for optimum production.

Specific Program:

- Exhibit #1: BOP Diagram
- Exhibit #2: Survey Plat
- Exhibit #3: Existing & Proposed Road Map
- Exhibit #4: Producing Well Area Map
- Exhibit #5: Drill Site Layout

IN ABOVE SPACE DESCRIBE PROGRAM: If proposal is to deepen, give data on present productive zone and proposed new productive zone. If proposal is to drill or deepen directionally, give pertinent data on subsurface locations and measured and true vertical depths. Give blowout preventer program, if any.

24. SIGNED Bonnie Attwater TITLE Regulatory Tech. DATE 09/23/99
(This space for Federal or State office use)

PERMIT NO. APPROVAL DATE

Application approval does not warrant or certify that the applicant holds legal or equitable title to those rights in the subject lease which would entitle the applicant to conduct operations thereon
CONDITIONS OF APPROVAL, IF ANY

APPROVED BY TITLE DATE

*See Instructions On Reverse Side

Title 18 U.S.C. Section 1001, makes it a crime for any person knowingly and wilfully to make to any department or agency of the United States any false, fictitious or fraudulent statements or representations as to any matter within its jurisdiction.

NEW MEXICO OIL CONSERVATION COMMISSION
WELL LOCATION AND ACREAGE DEDICATION AT

Form C-102
Supersedes C-12H
Effective 1-1-65

All distances must be from the outer boundaries of the Section

Aerator		Lease		Well No.	
DOYLE HARTMAN		E. J. WELLS		16	
Lot Letter	Section	Township	Range	County	
	5	T-25-S	R-37-E	N.M.	
Actual Footage Location of Well:					
2310 feet from the		610 line and		feet from the line	
Ground Level Elev.	Producing Formation	Pool	Dedicated Acreage		
610	YATES-SEVEN RIVERS	JALMAT (GAS)	120 Acres		

- Outline the acreage dedicated to the subject well by colored pencil or hachure marks on the plat below.
- If more than one lease is dedicated to the well, outline each and identify the ownership thereof (both as to working interest and royalty).
- If more than one lease of different ownership is dedicated to the well, have the interests of all owners been consolidated by communitization, unitization, force-pooling, etc?

☐ Yes ☐ No If answer is "yes," type of consolidation _____

If answer is "no," list the owners and tract descriptions which have actually been consolidated. (Use reverse side of this form if necessary.) _____

No allowable will be assigned to the well until all interests have been consolidated (by communitization, unitization, forced-pooling, or otherwise) or until a non-standard unit, eliminating such interests, has been approved by the Commission.

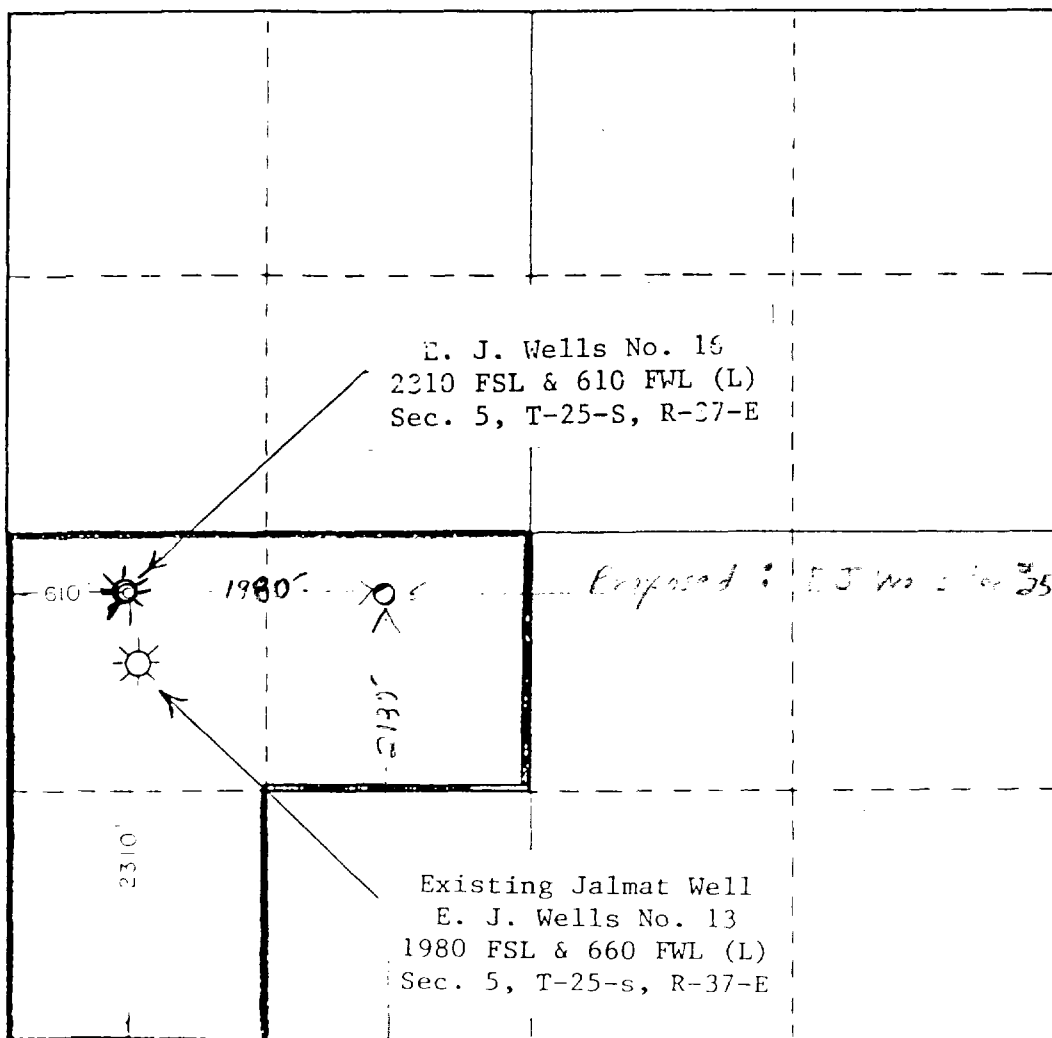

CERTIFICATION

I hereby certify that the information contained herein is true and complete to the best of my knowledge and belief.

Name: Larry A. Nummy
Position: Engineer
Company: Doyle Hartman
Date: May 29, 1984

I hereby certify that the well location shown on this plat was plotted from field notes of actual surveys made by me or under my supervision, and that the same is true and correct to the best of my knowledge and belief.

Date Surveyed: _____
Registered Professional Engineer and Land Surveyor: [Signature]

Certificate No. JOHN W. WEST 676

RONALD J. EIDSON 3239

and 2 4 1984



STATE OF NEW MEXICO
ENERGY AND MINERALS DEPARTMENT
OIL CONSERVATION DIVISION

TONY ANAYA
GOVERNOR

POST OFFICE BOX 2088
STATE LAND OFFICE BUILDING
SANTA FE, NEW MEXICO 87501
(505) 827-5800

June 22, 1984

Doyle Hartman
Oil Operator
P.O. Box 10426
Midland, Texas 79702

Attention: Michelle Hembree

Administrative Order NSL-1823

Gentlemen:

Reference is made to your application for a non-standard location and simultaneous dedication for your E. J. Well No. 16 located 2310 feet from the South line and 610 feet from the West line of Section 5, Township 25 South, Range 37 East, Jalmat Gas Pool, Lea County, New Mexico.

By authority granted me under the provisions of Rule 3, Section 1 of Division Order No. R-1670, the above-described unorthodox location is hereby approved, and is to be simultaneously dedicated to the existing 120-acre non-standard gas proration unit comprising the W/2 SW/4 and NE/4 SW/4 of Section 5 with your E. J. Well No. 13 located in Unit L of said Section, both wells in Township 25 South, Range 37 East, Lea County, New Mexico.

JUN 22 1984

Further, you are hereby permitted to produce the allowable from any of the wells on the proration unit in any proportion.

Sincerely,

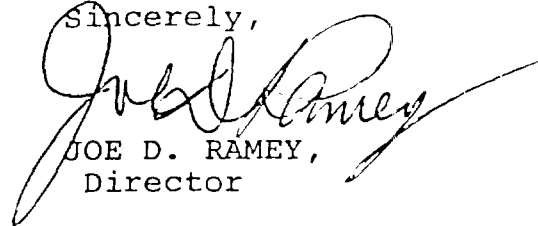
A handwritten signature in cursive script, appearing to read "Joe D. Ramey", written over the typed name and title.

JOE D. RAMEY,
Director

JDR/RLS/dp

cc: Oil Conservation Division - Hobbs
Oil & Gas Engineering Committee - Hobbs
Bureau of Land Management - Hobbs

NEW MEXICO
OIL CONSERVATION COMMISSION

Gas Well Plat

HOBBS OFFICE OCC
Date February 17, 1955

Phillips Petroleum Company C.D. Woolworth Group 1954 FEB 23 AM 9:26
Operator Lease Well No.

Name of Producing Formation Yates Gas Pool Jalnet

No. Acres Dedicated to the Well 160

SECTION 6 TOWNSHIP 25-S RANGE 37-E

			2
			P. 3

I hereby certify that the information given above is true and complete to the best of my knowledge.

Name W. Glendon
Position District Chief Clerk
Representing Phillips Petroleum Company
Address Box 2105, Hobbs, New Mexico

(over)

NTP-91 91005
160 ACRES + SE/4 NE/4
S/2 SE/4 NE/4 SE/4 of 6

DISTRICT I
P.O. Box 1980, Hobbs NM 88240

DISTRICT II
P.O. Drawer DD, Artesia, NM 88210

DISTRICT III
1000 Rio Brazos Rd., Aztec, NM 87410

OIL CONSERVATION DIVISION

P.O. Box 2088
Santa Fe, New Mexico 87504-2088

WELL API NO.	30-025-1147800
5. Indicate Type of Lease	STATE <input type="checkbox"/> FEE <input checked="" type="checkbox"/>
6. State Oil & Gas Lease No.	

SUNDRY NOTICES AND REPORTS ON WELLS (DO NOT USE THIS FORM FOR PROPOSALS TO DRILL OR TO DEEPEN OR PLUG BACK TO A DIFFERENT RESERVOIR. USE "APPLICATION FOR PERMIT" (FORM C-101) FOR SUCH PROPOSALS.)		7. Lease Name or Unit Agreement Name WOOLWORTH GR.3
1. Type of Well: OIL WELL <input type="checkbox"/> GAS WELL <input checked="" type="checkbox"/> OTHER	8. Well No. 002	9. Pool name or Wildcat JALMAT-TANSILL-YATES-SR-QN
2. Name of Operator Phillips Petroleum Company		
3. Address of Operator 4001 Penbrook Street, Odessa, TX 79762		
4. Well Location Unit Letter <u>H</u> : <u>1963</u> Feet From The <u>NORTH</u> Line and <u>643</u> Feet From The <u>EAST</u> Line Section <u>6</u> Township <u>25-S</u> Range <u>37-E</u> NMPM <u>LEA</u> County	10. Elevation (Show whether DF, RKB, RT, GR, etc.) 3235.6' DF	

11. Check Appropriate Box to Indicate Nature of Notice, Report, or Other Data

NOTICE OF INTENTION TO:

PERFORM REMEDIAL WORK ☐ PLUG AND ABANDON ☐
TEMPORARILY ABANDON ☐ CHANGE PLANS ☐
PULL OR ALTER CASING ☐
OTHER: ☐

SUBSEQUENT REPORT OF:

REMEDIAL WORK ☐ ALTERING CASING ☐
COMMENCE DRILLING OPNS. ☐ PLUG AND ABANDONMENT ☒
CASING TEST AND CEMENT JOB ☐
OTHER: PLUG & ABANDON WELL. ☐

12. Describe Proposed or Completed Operations (Clearly state all pertinent details, and give pertinent dates, including estimated date of starting any proposed work) SEE RULE 1103.

07/16/96 MIRU SIERRA WS #12, PMP 11 BBL FW DWN TBG, LOCK UP, PMP 82 BBL DWN CSG, STATIC, NU CL I BOP, LD 96 JTS 2.375" PROD TBG, SDON.
07/17/96 GIH W/CIBP ON 90 JTS 2.375" WS SET @ 2836', MIX 100 BBL 10# BRINE W/50 SX SALT GEL, CIRC W/90 BBLs, PMP PLUG #1 75 SX 2836-2386', TOH W/WS, PU 7" AD-1 RENTAL PKR, GIH T/1009' & SET PKR @ 1009', TST CSG T/350#, 2.375" X 7" ANNULUS WOULD NOT TST, TST BELOW PKR @ 1009' T/500# GOOD, RU WL TRUCK & PERF @ 1275' RD WL TRUCK, ATTEMPT T/ESTAB PI RATE VIA PERFS @ 1275', PRESS UP T/1500#, NO BLEED OFF, NMOC OK'D T/SPOT PLUG F/1325-750+/-, HOLES IN 7" @ 786', LD CSG & PKR, TIH W/WS T/1326', PMP PLUG #2 130 SX 1326-542', WOC & TAG, TOH W/WS, SDON.
07/18/96 TIH & TAG PLUG #2 @ 695', TOH LD WS, GIH W/1 JT WS & PKR, SET @ 31', RU WL TRUCK & PERF W/85 BBLs 10# GELLED BRINE (MLF), DID NOT CIRC, PMP PLUG #3 24 SX 363'-3',
(CONTINUED ON BACK)

I hereby certify that the information above is true and complete to the best of my knowledge and belief.

SIGNATURE Larry M. Sanders TITLE Senior Regulation Analyst DATE 7-22-96
TYPE OR PRINT NAME Larry M. Sanders TELEPHONE NO. (915)368-1488

(This space for State Use)

APPROVED BY Charlie Perry TITLE OIL & GAS INSPECTOR DATE JAN 28 1997
CONDITIONS OF APPROVAL, IF ANY:

JC

WOOLWORTH G3 #2 CONTINUED

07/18/96

CONTINUED

CMT CIRC T/SURF LEAVING INSIDE OF 7" CSG FULL & 9.625 X 7 ANNULUS FULL, DIG OUT CELLAR, CUT & CAP, INSTALL DRY HOLE MARKER, RDMO SIERRA WS #3 & CMT EQMT, PERFORM RECLAMATION WORK, WELL PA'D.

COMPLETE DROP FROM REPORT



DISTRICT I
P.O. Box 1980, Hobbs, NM 88240

DISTRICT II
P.O. Drawer DD, Artesia, NM 88210

DISTRICT III
1000 Rio Brazos Rd., Aztec, NM 87410

OIL CONSERVATION DIVISION 310 Old Santa Fe Trail, Room 206 Santa Fe, New Mexico 87503

WELL API NO. 30-025-23868	
5. Indicate Type of Lease	STATE <input type="checkbox"/> FEE <input checked="" type="checkbox"/>
6. State Oil & Gas Lease No.	

<p align="center">SUNDRY NOTICES AND REPORTS ON WELLS (DO NOT USE THIS FORM FOR PROPOSALS TO DRILL OR TO DEEPEN OR PLUG BACK TO A DIFFERENT RESERVOIR. USE "APPLICATION FOR PERMIT" (FORM C-101) FOR SUCH PROPOSALS.)</p>		<p>7. Lease Name or Unit Agreement Name Langlie Jal Unit</p>	
<p>1. Type of Well: OIL WELL <input type="checkbox"/> GAS WELL <input type="checkbox"/> OTHER <u>Injection</u></p>		<p>8. Well No. 49</p>	
<p>2. Name of Operator GP II Energy, Inc.</p>		<p>9. Pool name or Wildcat Langlie Mattix (Seven Rivers)</p>	
<p>3. Address of Operator P. O. Box 50682 Midland, Tx 79710</p>			
<p>4. Well Location Unit Letter <u>H</u> : <u>1980</u> Feet From The <u>N</u> Line and <u>510</u> Feet From The <u>E</u> Line Section <u>6</u> Township <u>25S</u> Range <u>37E</u> NMPM Lea County</p>			
<p>10. Elevation (Show whether DF, RKB, RT, GR, etc.)</p>			

<p>11. Check Appropriate Box to Indicate Nature of Notice, Report, or Other Data</p>			
NOTICE OF INTENTION TO:		SUBSEQUENT REPORT OF:	
PERFORM REMEDIAL WORK <input type="checkbox"/>	PLUG AND ABANDON <input type="checkbox"/>	REMEDIAL WORK <input type="checkbox"/>	ALTERING CASING <input type="checkbox"/>
TEMPORARILY ABANDON <input type="checkbox"/>	CHANGE PLANS <input type="checkbox"/>	COMMENCE DRILLING OPNS. <input type="checkbox"/>	PLUG AND ABANDONMENT <input type="checkbox"/>
PULL OR ALTER CASING <input type="checkbox"/>		CASING TEST AND CEMENT JOB <input type="checkbox"/>	
OTHER: <u>squeeze perfs, add perfs</u> <input checked="" type="checkbox"/>		OTHER: <input type="checkbox"/>	

12. Describe Proposed or Completed Operations (Clearly state all pertinent details, and give pertinent dates, including estimated date of starting any proposed work) SEE RULE 1103.

On or about February 27, 1996, add perfs 3445' - 3511' & 3370' - 3430'. Squeeze perfs 3260' - 3360'. Stimulate

I hereby certify that the information above is true and complete to the best of my knowledge and belief.

SIGNATURE George P. Mitchell, II TITLE President DATE 2-20-96

TYPE OR PRINT NAME George P. Mitchell, II TELEPHONE NO. 915-684-4748

(This space for State Use)

ORIGINAL SIGNED BY JERRY SEXTON
DISTRICT I SUPERVISOR

APPROVED BY _____ TITLE _____ DATE _____

CONDITIONS OF APPROVAL, IF ANY:

FEB 26 1996

District I
PO Box 1980, Hobbs, NM 88241-1980
District II
PO Drawer DD, Artesia, NM 88211-0719
District III
1000 Rio Diazos Rd., Aztec, NM 87410
District IV
PO Box 2088, Santa Fe, NM 87504-2088

State of New Mexico
Energy, Minerals & Natural Resources Department

Form
Revised February 1
Instructions
Submit to Appropriate District
5

OIL CONSERVATION DIVISION
P.O. Box 2088
Santa Fe, NM 87504-2088

☐ AMENDED RETURN

I. REQUEST FOR ALLOWABLE AND AUTHORIZATION TO TRANSPORT

¹ Operator name and Address GP II ENERGY, INC. P.O. Box 60682 Midland, TX 79710-1810		² OGRID Number 8359
⁴ API Number 30-025-11479	⁵ Pool Name LANGLIE MATTIX 7RIVERS QUEEN	⁶ Pool Code 3724
⁷ Property Code 17180	⁸ Property Name LANGLIE JAL UNIT	⁹ Well Number 54

II. ¹⁰ Surface Location

UL or lot no. NE1SE	Section 6	Township 25S	Range 37E	Lot. Idn	Feet from the 1930	North/South Line N	Feet from the 710	East/West line E	County LEA
------------------------	--------------	-----------------	--------------	----------	-----------------------	-----------------------	----------------------	---------------------	---------------

¹¹ Bottom Hole Location

UL or lot no.	Section	Township	Range	Lot. Idn	Feet from the	North/South Line	Feet from the	East/West line	County
¹² Lse Code F	¹³ Producing Method Code P	¹⁴ Gas Connection Date 3/1/93		¹⁵ C-129 Permit Number		¹⁶ C-129 Effective Date		¹⁷ C-129 Expiration	

III. Oil and Gas Transporters

¹⁸ Transporter OGRID	¹⁹ Transporter Name and Address	²⁰ POD	²¹ O/G	²² POD ULSTR Location and Description
22628	Texas New Mexico Pipeline Co.	1369810	0	** Transporting Only 7-1-95 thru 9-30-95
20809	Sid Richardson Gas Co.	1369830	G	
20667	Shell Pipeline Co	1369810	0	** Resumes Transporting 10-1-95

IV. Produced Water

²³ POD 1369850	²⁴ POD ULSTR Location and Description
------------------------------	--

V. Well Completion Data

²⁵ Spud Date	²⁶ Ready Date	²⁷ TD	²⁸ PBTD	²⁹ Perforations
³⁰ Hole Size	³¹ Casing & Tubing Size	³² Depth Set	³³ Sacks Cement	

VI. Well Test Data

³⁴ Date New Oil	³⁵ Gas Delivery Date	³⁶ Test Date	³⁷ Test Length	³⁸ Tbg. Pressure	³⁹ Csg. Pressure
⁴⁰ Choke Size	⁴¹ Oil	⁴² Water	⁴³ Gas	⁴⁴ AOP	⁴⁵ Test Method

I hereby certify that the rules of the Oil Conservation Division have been complied with and that the information given above is true and complete to the best of my knowledge and belief.

Signature:

Printed name:

Title:

Date:

Phone:

OIL CONSERVATION DIVISION

Approved by: ORIGINAL SIGNED BY JERRY SEXTON
DISTRICT I SUPERVISOR

Title:

Approval Date:

SEP 08 1995

¹⁷ If this is a change of operator fill in the OGRID number and name of the previous operator

MERIDIAN OIL INC.

REGULATORY COMP 5/31/95

Previous Operator Signature

Printed Name

Title

Date

Submit 5 Copies
Appropriate District Office
DISTRICT I
P.O. Box 1980, Hobbs, NM 88240
DISTRICT II
P.O. Drawer DD, Artesia, NM 88210
DISTRICT III
300 Rio Brazos Rd., Aztec, NM 87410

State of New Mexico
Energy, Minerals and Natural Resources Department
OIL CONSERVATION DIVISION
P.O. Box 2088
Santa Fe, New Mexico 87504-2088

Form C-104
Revised 1-1-89
See Instructions
at Bottom of Page

**REQUEST FOR ALLOWABLE AND AUTHORIZATION
TO TRANSPORT OIL AND NATURAL GAS**

Operator Permian Resources, Inc. , d/b/a Permian Partners, Inc. Well API No. 30-025-11467 ✓
Address P. O. Box 590 Midland, Texas 79702
Reason(s) for Filing (Check proper box) ☐ Other (Please explain)
New Well ☐ Change in Transporter of:
Recompletion ☐ Oil ☐ Dry Gas ☐
Change in Operator ☒ Casinghead Gas ☐ Condensate ☐
Change of operator give name and address of previous operator Earl R. Bruno Company P. O. Box 590 Midland, TX 79702

DESCRIPTION OF WELL AND LEASE
Lease Name Wells B-6 Well No. 1 Pool Name, Including Formation Galmat T. Yates Kind of Lease State or Fee Lease No. 12052956(E)
Location Unit Letter A : 330 Feet From The North Line and 330 Feet From The East Line
Section 6 Township 25S Range 37E NMPM Chia County

I. DESIGNATION OF TRANSPORTER OF OIL AND NATURAL GAS
Name of Authorized Transporter of Oil ☐ or Condensate ☐ Address (Give address to which approved copy of this form is to be sent)
Name of Authorized Transporter of Casinghead Gas ☐ or Dry Gas ☒ Address (Give address to which approved copy of this form is to be sent)
Richardson Carbon Sealing Co. 201 Main St., St. Worth, TX 76102
Well produces oil or liquids, ☐ Unit ☐ Sec. ☐ Twp. ☐ Rge. Is gas actually connected? Yes When? N/A
Location of tanks.
This production is commingled with that from any other lease or pool, give commingling order number.

COMPLETION DATA
Designate Type of Completion - (X) ☒ Oil Well ☐ Gas Well ☐ New Well ☐ Workover ☐ Deepen ☐ Plug Back ☐ Same Res'v ☐ Diff Res'v
Le Spudded Date Compl. Ready to Prod. Total Depth P.B.T.D.
Variations (DF, RKB, RT, GR, etc.) Name of Producing Formation Top Oil/Gas Pay Tubing Depth
Formations Depth Casing Shoe

TUBING, CASING AND CEMENTING RECORD			
HOLE SIZE	CASING & TUBING SIZE	DEPTH SET	SACKS CEMENT

TEST DATA AND REQUEST FOR ALLOWABLE
WELL (Test must be after recovery of total volume of load oil and must be equal to or exceed top allowable for this depth or be for full 24 hours.)
First New Oil Run To Tank Date of Test Producing Method (Flow, pump, gas lift, etc.)
Depth of Test Tubing Pressure Casing Pressure Choke Size
Total Prod. During Test Oil - Bbls. Water - Bbls. Gas - MCF

S WELL
Total Prod. Test - MCF/D Length of Test Bbls. Condensate/MMCF Gravity of Condensate
Testing Method (prior, back pr.) Tubing Pressure (Shut-in) Casing Pressure (Shut-in) Choke Size

OPERATOR CERTIFICATE OF COMPLIANCE
I hereby certify that the rules and regulations of the Oil Conservation Division have been complied with and that the information given above is true and complete to the best of my knowledge and belief.
Randy Bruno
Signature Randy Bruno Title President
Signed Name May 17, 1993 Telephone No. 915/685-0113
Date

OIL CONSERVATION DIVISION
Date Approved JUN 14 1993
By ORIGINAL SIGNED BY JERRY SEXTON
DISTRICT I SUPERVISOR
Title

INSTRUCTIONS: This form is to be filed in compliance with Rule 1104
1) Request for allowable for newly drilled or deepened well must be accompanied by tabulation of deviation tests taken in accordance with Rule 111.
2) All sections of this form must be filled out for allowable on new and recompleted wells.
3) Fill out only Sections I, II, III, and VI for changes of operator, well name or number, transporter, or other such changes.
4) Separate Form C-104 must be filed for each well in multiply completed wells.

99 03:10p

Debbie McKelvey

3053323170

Gas Well Plat

OIL CONSERVATION COMMISSION

NSP-218

Seay Exploration
Western Natural Gas Co.Wells on
Wells

Date November 27, 1953

1

Operator

Lease

Well No.

Name of Producing Formation Brown Lime-Vates Pool Jalco

No. Acres Dedicated to the Well 160

SECTION 6 TOWNSHIP 25S RANGE 37E

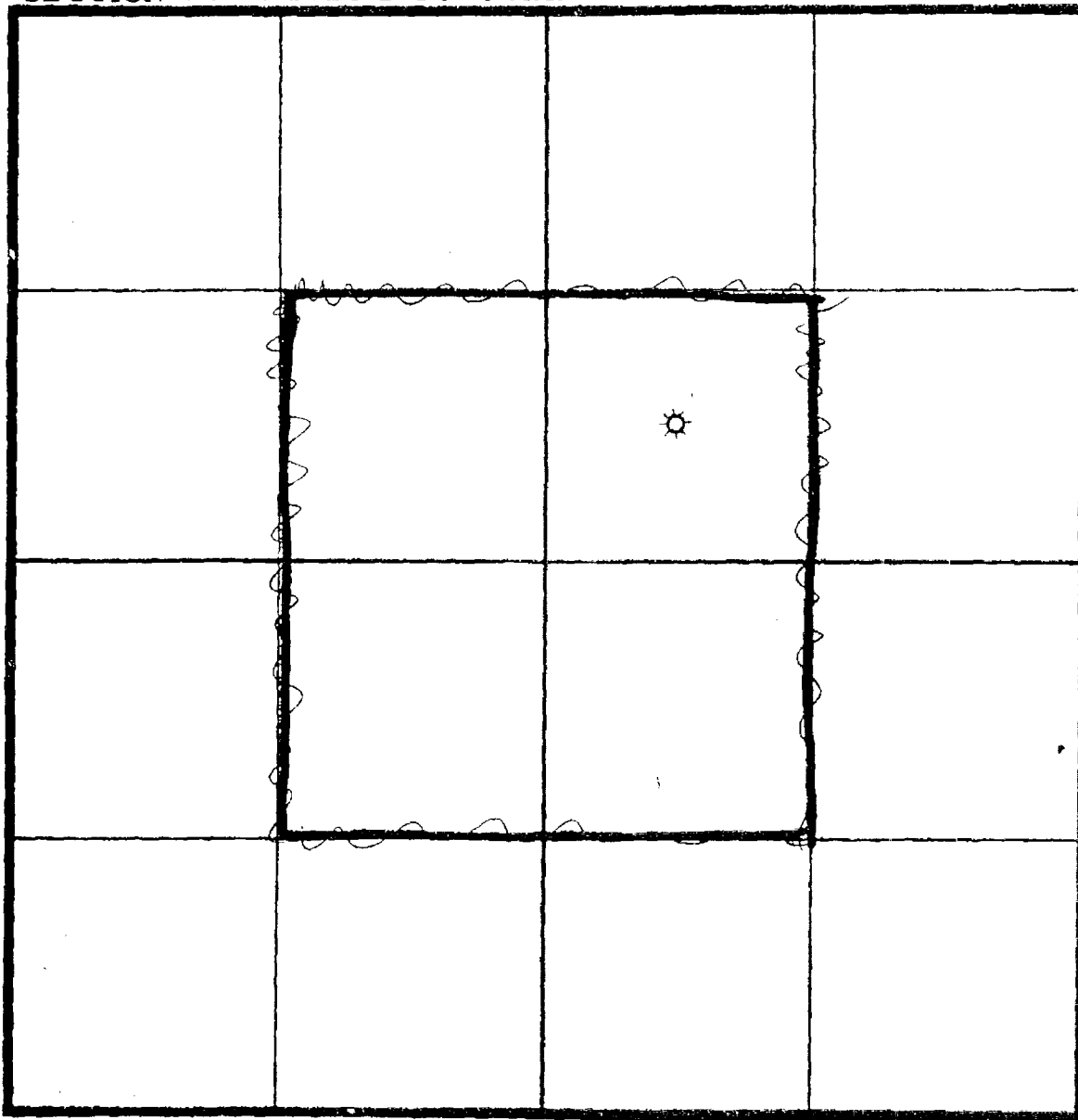

I hereby certify that the information given above is true and complete to the best of my knowledge.

Name R. E. McHale

Position Division Superintendent

Representing Western Natural Gas Company

Address 823 Midland Tower, Midland, Texas

N.M. OIL CONS. COMMISSION
P.O. BOX 1980
HOBBS, NEW MEXICO 88240

Form 3160-5
(June 1990)

UNITED STATES
DEPARTMENT OF THE INTERIOR
BUREAU OF LAND MANAGEMENT

SUNDRY NOTICES AND REPORTS ON WELLS

Do not use this form for proposals to drill or to deepen or reentry to a different reservoir.
Use "APPLICATION FOR PERMIT—" for such proposals

SUBMIT IN TRIPLICATE

1. Type of Well

☐ Oil Well ☒ Gas Well ☐ Other

2. Name of Operator

Seay Exploration, Inc.

3. Address and Telephone No.

407 N. Big Spring, Suite 200, Midland, TX 79701

4. Location of Well (Footage, Sec., T., R., M., or Survey Description)

1980 FNL & 1980 FEL, Unit G, Sec. 6, T25S, R37E

FORM APPROVED

Subject Bureau No. 1006-0135
Expiry: March 31, 1993

5. Lease Designation and Serial No.

LC-055546

6. If Indian, Allotment or Tribal Name

7. If Unit or CA, Agreement Designation

8. Well Name and No.

Wells WN #1

9. API Well No.

30-025-11466

10. Field and Pool, or Exploratory Area

Jalmat (Yates)

11. County or Parish, State

Lea County, NM

12. CHECK APPROPRIATE BOX(S) TO INDICATE NATURE OF NOTICE, REPORT, OR OTHER DATA

TYPE OF SUBMISSION

- ☒ Notice of Lease
☐ Subsequent Report
☐ Final Abandonment Notice

TYPE OF ACTION

- ☐ Abandonment
☐ Reconnection
☐ Plugging Back
☐ Casing Repair
☐ Altering Casing
☒ Other workover old producing
zone.

- ☐ Change of Plans
☐ New Construction
☐ Non-Resident Fracturing
☐ Water Shut-Off
☐ Conversion to Injection
☐ Dispose Water

(Note: Report results of treatment operations on well Completion or Intervention Report and Log form.)

13. Describe Proposed or Completed Operations (Clearly state all pertinent details, and give pertinent detail, including estimated date of starting any proposed work. If well is permanently drilled, give subsurface locations and measured and true vertical depths for all shafts and screen portions to that work.)

Please see attached workover procedure.

14. I hereby certify that the foregoing is true and correct

Signature

J. Seay

Title

Owner

Date

5-18-92

(This space for Federal or State office use)

Approved by

Title

Deborah Mackay

Date

5/29/92

Consent of approval, if any

OIL CONSERVATION COMMISSION

NSP 15

Now
wells B-6

Date Nov. 4, 1953

Westates Pet. Corp.
Operator

E. J. Wells

#1 B 6-1
Well No.

Lease

Name of Producing Formation Y - SR

Pool Jalco

No. Acres Dedicated to the Well 40

SECTION 6 TOWNSHIP 25 S. RANGE 37 E

40 acres		x	
NSP 15			

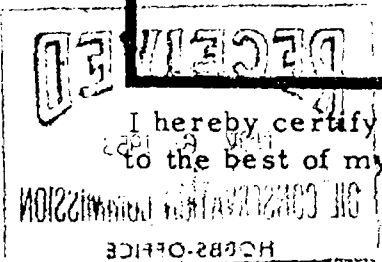
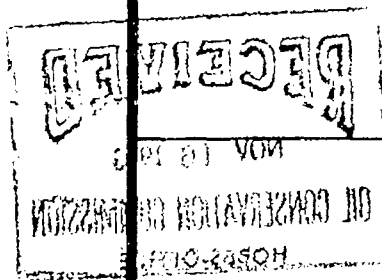

I hereby certify that the information given above is true and complete
to the best of my knowledge.

Name J. Benton
Position Div. Supt.
Representing Westates Pet. Corp.
Address P. O. Box 1381, Jal, N. M.

Pernian Resources, Inc.
P.O. Box 590
Midland, Tx 79702

(over)

NEW MEXICO OIL CONSERVATION COMMISSION
WELL LOCATION AND ACREAGE DEDICATION PLAT

Form C-102
Supersedes C-12
Effective 1-1-65

All distances must be from the outer boundaries of the Section

New SDX

Operator DOYLE HARTMAN		Lease WELLS FEDERAL		Well No. 17
Section 5	Township 25S	Range 37E	County LEA	
Actual Footage Location of Well 1450 feet from the EAST line and 1980 feet from the SOUTH line				
Ground Level Elev 3229.9	Producing Formation YATES-SEVEN RIVERS	Pool JALMAT (GAS)	Dedicated Acreage: 200 Acres	

- Outline the acreage dedicated to the subject well by colored pencil or hachure marks on the plat below.
- If more than one lease is dedicated to the well, outline each and identify the ownership thereof (both as to working interest and royalty).
- If more than one lease of different ownership is dedicated to the well, have the interests of all owners been consolidated by communization, unitization, force-pooling, etc?

☐ Yes ☐ No If answer is "yes," type of consolidation _____

If answer is "no," list the owners and tract descriptions which have actually been consolidated. (Use reverse side of this form if necessary.) _____

No allowable will be assigned to the well until all interests have been consolidated (by communization, unitization, forced-pooling, or otherwise) or until a non-standard unit, eliminating such interests, has been approved by the Commission.

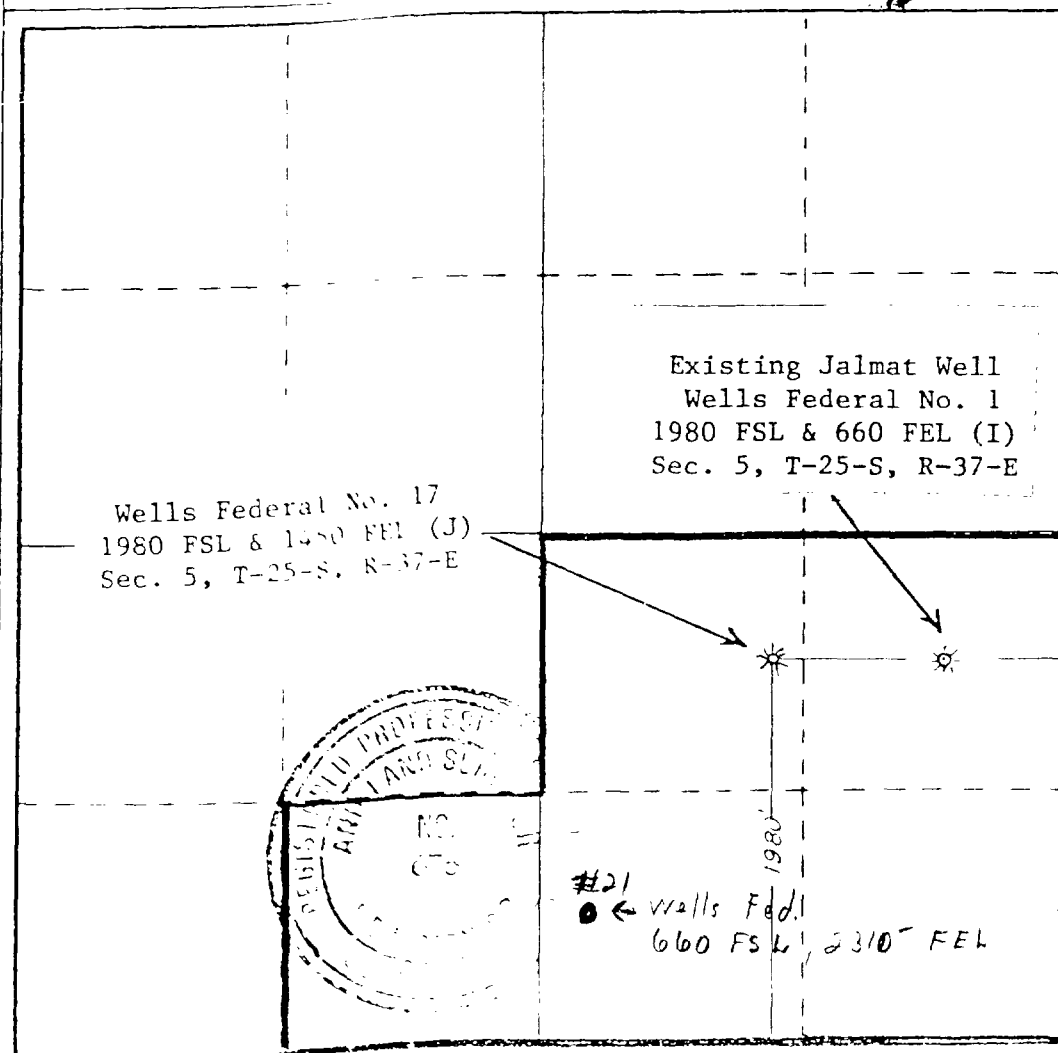

CERTIFICATION

I hereby certify that the information contained herein is true and complete to the best of my knowledge and belief.

Name
Larry A. Nammey

Position
Engineer

Company
Doyle Hartman

Date
JULY 24, 1984

I hereby certify that the well location shown on this plat was plotted from field notes of actual surveys made by me or under my supervision, and that the same is true and correct to the best of my knowledge and belief.

Date Surveyed
4/12/84

Registered Professional Engineer
and or Land Surveyor

John W. West

Certificate No. JOHN W. WEST. 576
RONALD J. E. DSON. 323



NEW MEXICO ENERGY, MINERALS
& NATURAL RESOURCES DEPARTMENT

OIL CONSERVATION DIVISION
2040 South Pacheco Street
Santa Fe, New Mexico 87505
(505) 827-7131

March 31, 1999

SDX Resources, Inc.
P. O. Box 5061
Midland, Texas 79704
Attention: Chuck Morgan

Administrative Order NSL-4248(SD)

Dear Mr. Morgan:

Reference is made to your applications dated March 4, 1999 for two unorthodox Jalmat gas well locations in an existing non-standard 200-acre gas spacing and proration unit ("GPU") for the Jalmat Gas Pool comprising the SE/4 SW/4 and SE/4 of Section 5, Township 25 South, Range 37 East, NMPM, Lea County, New Mexico. This non-standard GPU was established by Division Administrative Order NSP-400, dated November 11, 1957 and had dedicated thereon the Wells Federal Well No. 1 (**API No. 30-025-11462**), located 1980 feet from the South line and 660 feet from the East line (Unit I) of Section 5.

By amendment to Division Administrative Order NSP-400 (L) (SD), dated August 17, 1984, a second well, the Wells Federal Well No. 17 (**API No. 30-025-28850**), located at an unorthodox gas well location 1980 feet from the South line and 1450 feet from the East line (Unit J) of Section 5 was approved for this GPU.

By authority granted me under the provisions of Rule 2(d) of the "*Special Rules and Regulations for the Jalmat Gas Pool*", as promulgated by Division Order No. R-8170, as amended, and Division Rule 104.F (2) the following two wells to be drilled at unorthodox Jalmat gas well locations in Section 5 are hereby approved:

Wells Federal Well No. 20
820' FSL & 1238' FEL (Unit P)

Wells Federal Well No. 21
660' FSL & 2310' FEL (Unit O)

Also, you are hereby authorized to simultaneously dedicate Jalmat gas production from the proposed Wells Federal Wells No. 20 and 21 with the existing Wells Federal Wells No. 1 and 17.

Administrative Order NSL-4248(SD)

SDX Resources, Inc.

March 31, 1999

Page 2

Furthermore, you are hereby permitted to produce the allowable assigned the subject 200-acre GPU from all four wells in any proportion.

Sincerely,

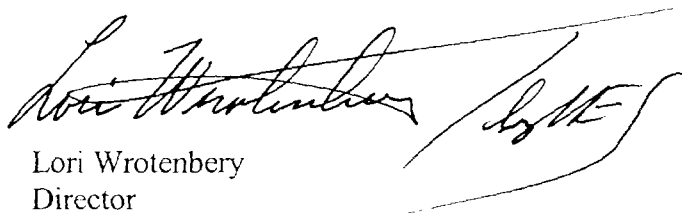
A handwritten signature in cursive script, appearing to read "Lori Wrotenbery", followed by a large, stylized flourish or signature mark that includes the letters "LW" and "MES".

Lori Wrotenbery
Director

LW/MES/kv

cc: New Mexico Oil Conservation Division - Hobbs
U. S. Bureau of Land Management - Carlsbad
File: NSP-400

NEW MEXICO OIL CONSERVATION COMMISSION
WELL LOCATION AND ACREAGE DEDICATION PLAT

Form No. 1
Supersedes Form
No. 1-1-1-1-1-1

New SDX

All distances must be from the outer boundaries of the Section

Owner DOYLE HARTMAN		Lease WELLS "B5"		Acres 2	
Section G	Section 5	Township 25 SOUTH	Range 37 EAST	County LEA	
1552 feet from the NORTH line and		2230 feet from the EAST line and			
Ground Surface Elevation 3249.1	Producing Formation Yates	Pool Jalmat (Gas)	Estimated Pooling Area 160*		

- Outline the acreage dedicated to the subject well by colored pencil or hatchure marks on the plat below.
- If more than one lease is dedicated to the well, outline each and identify the ownership thereof (with its working interest and royalty).
- If more than one lease of different ownership is dedicated to the well, have the interests of all owners been consolidated by communitization, unitization, force-pooling, etc?

Communitization Agreement
(14-08-0001-3889)

☒ Yes ☐ No If answer is "yes," type of consolidation

** Please see reverse side

If answer is "no," list the owners and tract descriptions which have actually been consolidated (on reverse side of this form if necessary.)

No allowable will be assigned to the well until all interests have been consolidated (by communitization, unitization, forced-pooling, or otherwise) or until a non-standard unit, eliminating such interests, has been approved by the Commission.

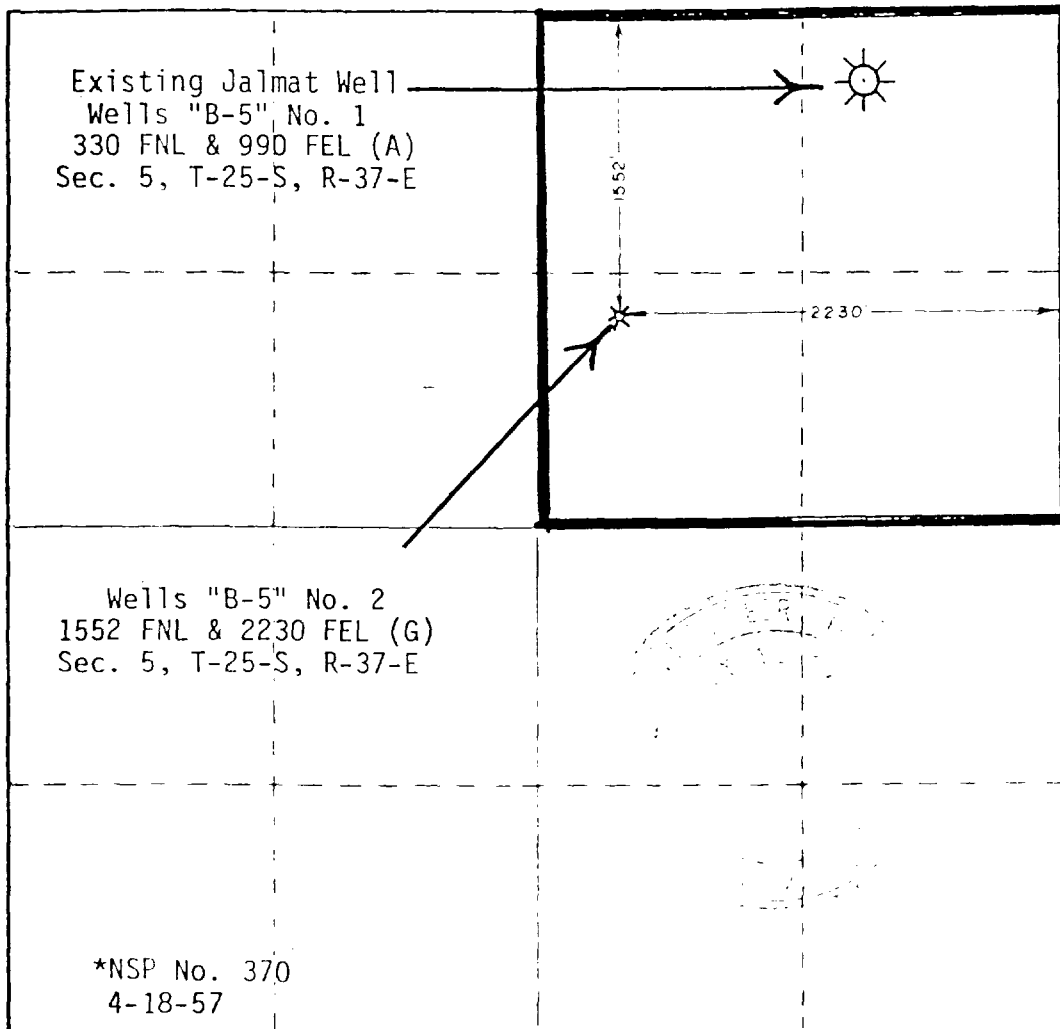

CERTIFICATION

I hereby certify that the information contained herein is true and complete to the best of my knowledge and belief.

Lang A. Romero

Engineer

Doyle Hartman

September 8, 1982

I hereby certify that the well location shown on this plat was plotted from field notes of actual surveys made by me or under my supervision and that the same is true and correct to the best of my knowledge and belief.

10/04/82

Registered Professional Engineer
No. 10,000

John W. West

Certified by JOHN W. WEST 676
PATRICK A. ROMERO 6868
Ronald J. Edison 3239

*NSP No. 370
4-18-57

MEXICO OIL CONSERVATION COMMISSION

~~Well Location and Acreage Dedication Plat~~Date August 2, 1957

Section A.

Operator El Paso Natural Gas Company Lease Wells 3-5
 Well No. 1 Unit Letter A Section 5 Township 25 S Range 37 E NMPM
 Located 330 Feet From North Line, 990 Feet From East Line
 County Lea G. L. Elevation 3262 Dedicated Acreage 160 Acres
 Name of Producing Formation Yates Pool Jalnet

1. Is the Operator the only owner* in the dedicated acreage outlined on the plat below?
 Yes _____ No X.
2. If the answer to question one is "no," have the interests of all the owners been consolidated by communitization agreement or otherwise? Yes X No _____. If answer is "yes," Type of Consolidation Communitization Agreement dated February 1, 1957
3. If the answer to question two is "no," list all the owners and their respective interests below:

OwnerLand Description

Section B

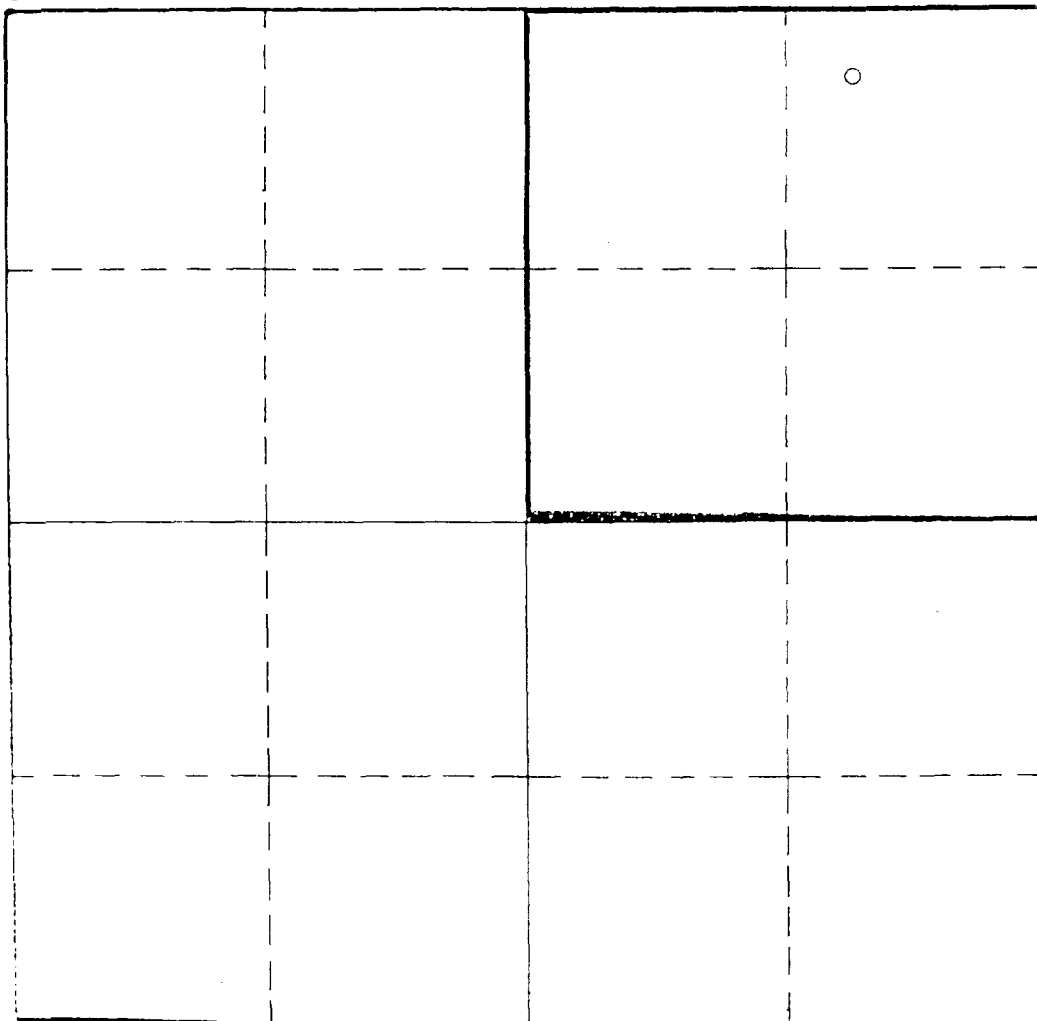

This is to certify that the information in Section A above is true and complete to the best of my knowledge and belief.

El Paso Natural Gas Company
 (Operator)

Lloyd E. Baskin
 (Representative)

Lloyd E. Baskin
501 Wilco Building; Midland, Texas
 Address

This is to certify that the well location shown on the plat in Section B was plotted from field notes of actual surveys made by me or under my supervision and that the same is true and correct to the best of my knowledge and belief.

Date Surveyed _____

Registered Professional
 Engineer and/or Land Surveyor.

Certificate No. 231882

(See instructions for completing this form on the reverse side)

El Paso Natural Gas Company

El Paso, Texas
April 1, 1957

to Hottel OCC

NSP 370

due 5-9-57

New Mexico Oil and Conservation Commission
P. O. Box 871
Santa Fe, New Mexico

Attention: Mr. A. L. Porter, Jr.

Re: Application of El Paso Natural Gas Company for Administrative Approval for a 160.25 acre Non-Standard Gas Proration Unit in the Jalmat Gas Pool for the Westates Petroleum Corporation Wells B-5 #1 Gas Well which is located in Lot 1 of Section 5, Township 25 South, Range 37 East, N.M.P.M. Lea County, New Mexico

Gentlemen:

El Paso Natural Gas Company respectfully requests Administrative Approval under the provisions of Rule 5(a) and 5(b) of Order No. R-520 for a Non-Standard Gas Proration Unit of 160.25 acres, more or less, consisting of Lots 1, 2, and the S/2 NE/4 of Section 5, Township 25 South, Range 37 East, N.M.P.M. Jalmat Gas Pool, Lea County, New Mexico, and in support thereof states the following facts:

1. That effective as of April 1, 1957, Lots 1, 2, and the S/2 NE/4 of Section 5, Township 25 South, Range 37 East, N.M.P.M. was communitized in order to form a 160.25 acres, more or less, Non-Standard Proration Unit for the Wells B-5 #1 Gas Well.

2. That El Paso Natural Gas Company is the Operator of said communitized tract.

3. That the Westates Petroleum Corporation Wells B-5 #1 Gas Well was drilled at a location of 330 feet from the North line and 990 feet from the East line of Section 5, Township 25 South, Range 37 East, N.M.P.M. and was completed on February 13, 1939 at a total depth of 3556 feet and was plugged back to 3380 feet. A deliverability test was taken on this well on June 26, 1954 and the well gaged 2,661 M.C.F.

4. That this well was completed and producing from the Yates and Upper Seven Rivers Formations prior to September 1, 1954, which is the effective date of the Special Rules for the Jalmat Gas Pool.

5. That Rule 5(a) of Order No. R-520 pertaining to the Special Rules of the Jalmat Gas Pool grants a maximum tolerance of 330 feet in respect to spacing requirements for wells drilled and producing prior to the effective date of said order.

6. That the acreage to be dedicated to this proposed Non-Standard Gas Proration Unit will substantially comply with the maximum acreage allowed under the Provisions of Rule 5(a) of Order No. R-520 with respect to the well location plus the allowed tolerances.

7. That the proposed Non-Standard Gas Proration Unit will meet the requirements of Rule 5(b) of Order No. R-520 in that the proposed unit consists of contiguous quarter-quarter sections within a single governmental section, that the length or width thereof does not exceed 5280 feet, and that the entire area of the proposed unit lies within the horizontal limits of the Jalmal Gas Pool and may reasonably be presumed to be productive of gas.

8. That by a copy of this Letter of Applicagion, all of the other operators owning an interest in the section in which the proposed Non-Standard Proration Unit is situated and all operators owning an interest within 1500 feet of the well have by registered mail been notified.

9. That a plat showing the acreage to be dedicated to the proposed Non-Standard Gas Proration Unit, the location of the said well, and the offset ownership is attached hereto.

10. El Paso Natural Gas Company intends to use said well as the unit well.

In view of the existence of the facts herein stated and in compliance with the provisions of Rule 5(b) of Order No. R-520, El Paso Natural Gas Company requests Administrative Approval of said proposed 160.25 acre Non-Standard Gas Proration Unit.

Respectfully submitted,

EL PASO NATURAL GAS COMPANY

BY

R L Hamblin
R. L. Hamblin, Manager
Lease Department



STATE OF NEW MEXICO
ENERGY AND MINERALS DEPARTMENT
OIL CONSERVATION DIVISION

TONY ANAYA
GOVERNOR

POST OFFICE BOX 2088
STATE LAND OFFICE BUILDING
SANTA FE, NEW MEXICO 87501
(505) 827-5800

May 17, 1984

Doyle Hartman
Oil Operator
P. O. BOX 10426
Midland, Texas 79702

Attention: Michelle Hembree, Administrative Assistant

Administrative Order NSL-1821 (SD)

Gentlemen:

Reference is made to your application for a non-standard location and simultaneous dedication for your Wells Federal Well No. 15 located 810 feet from the North line and 460 feet from the West line, NW/4 of Section 5, Township 25 South, Range 37 East, Jalmat Gas Pool, Lea County, New Mexico.

By authority granted me under the provisions of Rule 3, Section 1 of Division Order No. R-1670, the above-described unorthodox location is hereby approved, and is to be simultaneously dedicated to the existing 160-acre non-standard gas proration unit comprising the NW/4 of Section 5 with your Wells Federal Well No. 4 located in Unit F of said section, both wells in Township 25 South, Range 37 East, Lea County, New Mexico.

Further, you are hereby permitted to produce the allowable from any of the wells on the proration unit in any proportion.

Sincerely,

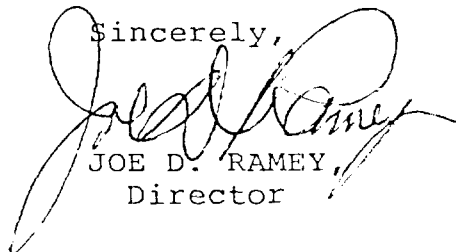

JOE D. RAMEY,
Director

JDR/bok

cc: Oil Conservation Division - Aztec
Oil & Gas Engineering Committee - Hobbs
Bureau of Land Management - Farmington

MAY 24 1984

1670 MAY 17, 1984
NSR-1812

NEW MEXICO OIL CONSERVATION COMMISSION
WELL LOCATION AND ACREAGE DEDICATION PLAT

Form O-102
Superseded O-128
Effective 1-1-85

Now SOX

All distances must be from the outer boundaries of the Section

Operator JALMAT		Lease WELLS FEDERAL		Well No. 15	
Oil Letter 1	Section 5	Township T-25-S	Range R-37-E	County SANTA FE	
Actual Endorse Location of Well:					
feet from the		line and		feet from the	
Ground Level Elev. 460	Producing Formation YATES-SEVEN RIVERS	Pool JALMAT (GAS)	Dedicated Acreage 160 Acres		

1. Outline the acreage dedicated to the subject well by colored pencil or hachure marks on the plat below.
2. If more than one lease is dedicated to the well, outline each and identify the ownership thereof (both as to working interest and royalty).
3. If more than one lease of different ownership is dedicated to the well, have the interests of all owners been consolidated by communitization, unitization, force-pooling, etc?

☐ Yes ☐ No If answer is "yes," type of consolidation _____

If answer is "no," list the owners and tract descriptions which have actually been consolidated. (Use reverse side of this form if necessary.) _____

No allowable will be assigned to the well until all interests have been consolidated (by communitization, unitization, forced-pooling, or otherwise) or until a non-standard unit, eliminating such interests, has been approved by the Commission.

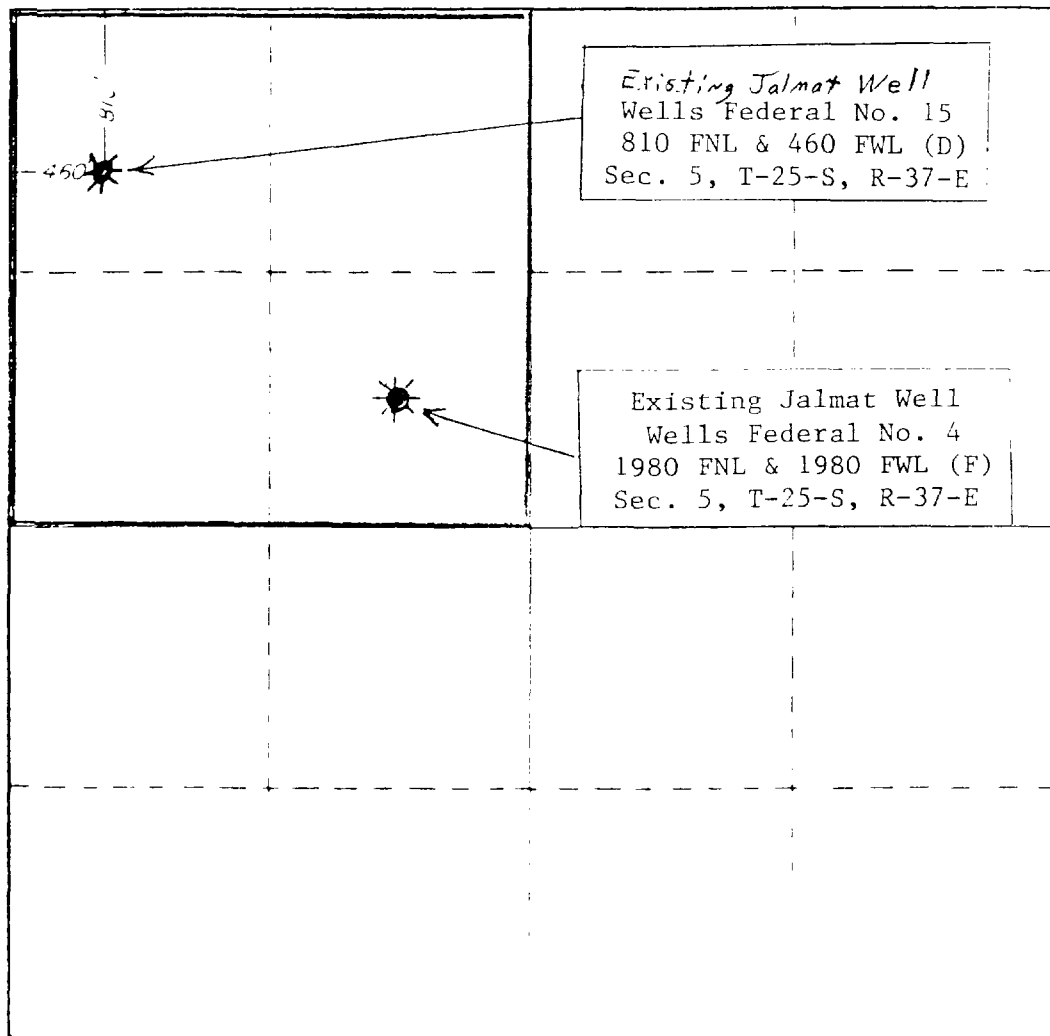

CERTIFICATION

I hereby certify that the information contained herein is true and complete to the best of my knowledge and belief

Name
Larry G. Newman

Position
Engineer

Signature
Doyle Hartman

Date
April 25, 1984

I hereby certify that the well location shown on this plat was plotted from field notes of actual surveys made by me or under my supervision and that the same is true and correct to the best of my knowledge and belief

Date Surveyed

Signature of Professional Engineer
and Surveyor

Doyle Hartman

NSP 471273
Gray Petroleum

NEW MEXICO OIL CONSERVATION COMMISSION
WELL LOCATION AND ACREAGE DEDICATION PLAT

Form
Supplemental
11-1-81

All distances must be from the outer boundaries of the Section.

DOYLE HARTMAN		Munn HARRISON		1	
A	7	25 SOUTH	37 EAST	LEA	
510	NORTH		990	EAST	
3185.0	YATES	JALMAT (GAS)	80		

Outline the acreage dedicated to the subject well by colored pencil or hatchure marks on the plat below.

If more than one lease is dedicated to the well, outline each and identify the ownership thereof (both as to ownership interest and royalty).

If more than one lease of different ownership is dedicated to the well, have the interests of all owners been consolidated by communitization, unitization, forcepooling, etc.

Yes ☐ No ☒ If answer is "Yes," type of consolidation _____

If answer is "No," list the owners and tract descriptions which have actually been consolidated (if so release copy of this form if necessary).

No allowable will be assigned to the well until all interests have been consolidated (the communitization, unitization, forcepooling, or otherwise) or until a non-standard unit, eliminating such interests, has been approved by the Commission.

Proposed Location
Munn-Harrison No. 1
Jalmat (Gas) Well

Tahoe Oil
Harrison No. 1
Langlie-Mattix

Tahoe Oil
Harrison No. 2
Langlie-Mattix

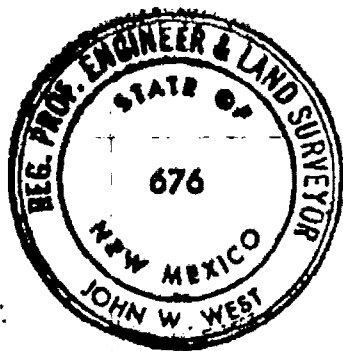

CERTIFICATION

I hereby certify that the information herein is true and correct to the best of my knowledge and belief.

Larry A. Nimmer

ENGINEER

DOYLE HARTMAN

NOVEMBER 12, 1981

I hereby certify that the well location shown on this plat was plotted from field notes of actual surveys made by me under my supervision and that the same is true and correct to the best of my knowledge and belief.

11-9-81

Approved by the Commission

John W. West

NEW MEXICO OIL CONSERVATION COMMISSION WELL LOCATION AND ACREAGE DEDICATION PLAT

Form No. 1
Supersedes L-12
Effective 1-1-65

W. J. Doyle Hartman distances must be from the outer boundaries of the Section
Division of Atlantic Richfield Co.
ARCO Oil & Gas Co.

Lease

F.M. Burleson WN

Well No.

3

Section Letter D	Section 8	Township 25 South	Range 37 East	County Lea
Distance from the location of well:				
330	feet from the North	line and	330	feet from the West
Surface Area 3177.2	Producing Formation Jalmat	Pool Jalmat Gas	Dedicated Acreage 160	

1. Outline the acreage dedicated to the subject well by colored pencil or hatchure marks on the plat below.
2. If more than one lease is dedicated to the well, outline each and identify the ownership thereof (both as to working interest and royalty).
3. If more than one lease of different ownership is dedicated to the well, have the interests of all owners been consolidated by communitization, unitization, force-pooling, etc?

☐ Yes ☐ No If answer is "yes," type of consolidation _____

If answer is "no," list the owners and tract descriptions which have actually been consolidated. (Use reverse side of this form if necessary.) _____

No allowable will be assigned to the well until all interests have been consolidated (by communitization, unitization, forced-pooling, or otherwise) or until a non-standard unit, eliminating such interests, has been approved by the Commission.

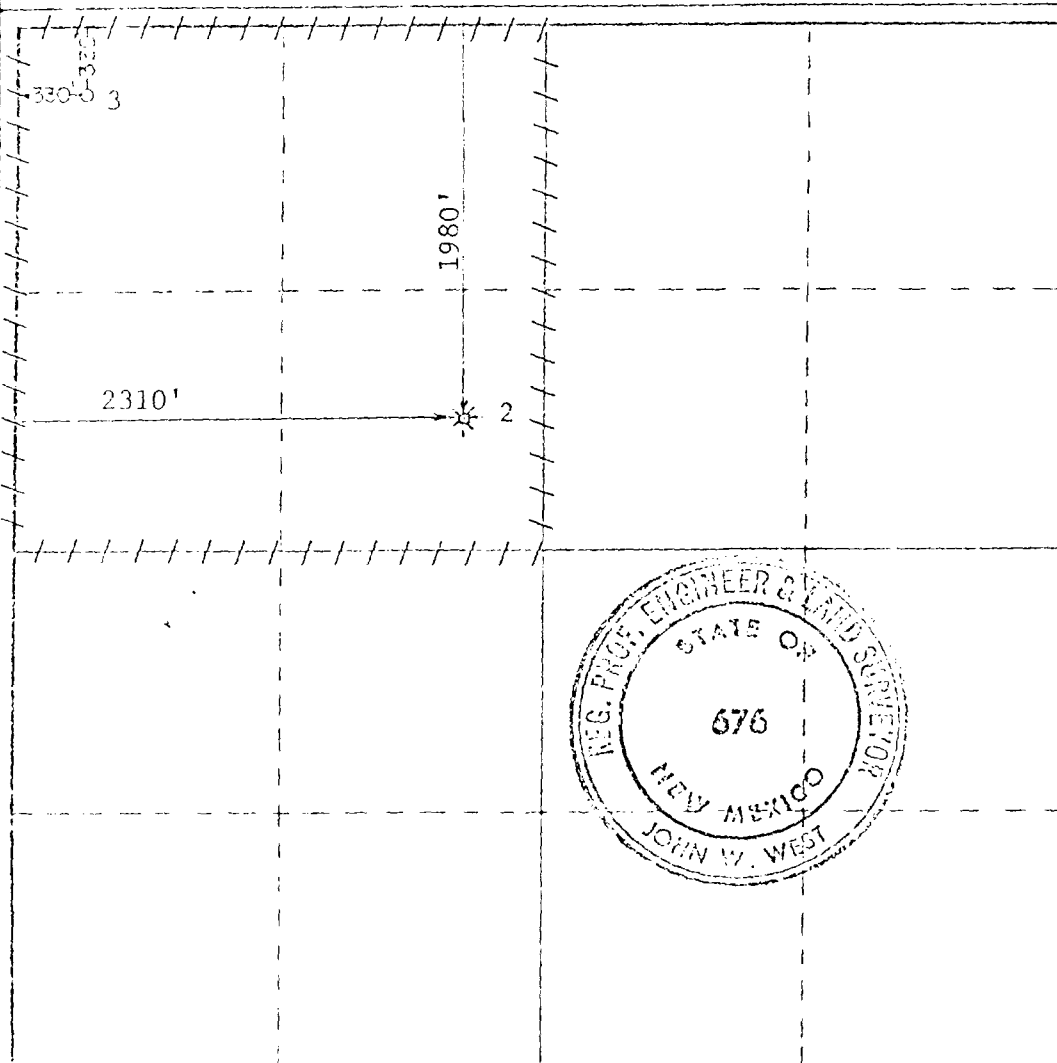

CERTIFICATION

I hereby certify that the information contained herein is true and complete to the best of my knowledge and belief.

Signature: *W.D. McDaniel*

Position: **For: LEROY LANE**

Dist. Dirg. Supt.

ARCO Oil and Gas Company
Division of Atlantic Richfield Company

Date

6/13/80

I hereby certify that the well location shown on this plat was plotted from the notes of actual surveys made by me under my supervision, and that the same is true and correct to the best of my knowledge and belief.

Date Surveyed

May 21, 1980

Registered Professional Engineer and/or Land Surveyor

Signature: *John V. West*

Certificate No. **JOHN V. WEST**
PATRICK A. ROMERO
RONALD J. FIDSON

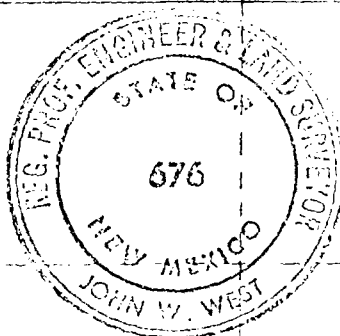

OFFSET OPERATORS

EJ WELLS FEDERAL #25

Seay Exploration Co.
407 N. Big Spring #200
Midland, TX 79701

Gruy Petroleum
ATTN: Zeno Ferris
PO Box 140907
Irving, TX 75014-0907

Doyle Hartman
PO Box 10426
Midland, TX 79702

Permian Resources
PO Box 590
Midland, TX 79702

GP II
731 W. Wadley
Midland, TX 79705

Phillips
4001 Penbrook
Odessa, TX 79762