



STATE OF NEW MEXICO
ENERGY, MINERALS AND NATURAL RESOURCES DEPARTMENT
OIL CONSERVATION DIVISION

GARREY CARRUTHERS
GOVERNOR

September 21, 1990

POST OFFICE BOX 2088
STATE LAND OFFICE BUILDING
SANTA FE, NEW MEXICO 87504
(505) 827-5800

A.P.A. Development Inc.
P. O. Box 215
Cortez, Co. 81321

Attention: Patrick B. Woosley

Re: \$7,500 One-Well Plugging Bond
A.P.A. Development, Inc., Operator
2310' FWL and 990' FSL of Sec. 11,
T-21-N, R-10-W, San Juan County
Bond No. OCD-246

RECEIVED
APR 30 1998
OIL CON. DIV.
DIST. 3

Dear Mr. Woosley:

The Oil Conservation Division hereby approves the above-captioned one-well plugging bond effective this date.

Sincerely,

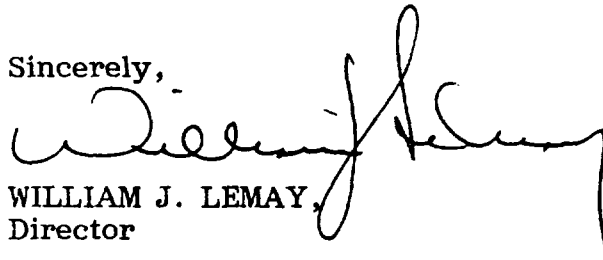

WILLIAM J. LEMAY,
Director

dr/

cc: Oil Conservation Division
Aztec, New Mexico

RECEIVED
90 SEP 24 AM 9 26

ASSIGNMENT OF CASH COLLATERAL DEPOSIT

(Must be a federally-insured bank or savings institution
within the State of New Mexico)

Date September 18, 1990

Pursuant to Section 70-2-14, NMSA (1978), or successor provisions, A:P.A. Development Inc. (hereinafter referred to as "operator") of P.O. Box 215, Cortez, CO 81321 (address) has deposited with the First National Bank of Farmington (name of state or national bank or savings association) of P.O. Box 540, Farmington, NM 87400-0540 (address) (herein termed financial institution), the sum of 7 500 00 dollars in Certificate of Deposit or savings account No. 301519225. Operator hereby assigns and conveys all right, title and interest in the deposited sum to the financial institution in trust for the Oil Conservation Division of the Energy and Minerals Department or successor agency of the State of New Mexico. Operator and the financial institution agree that as to the deposited sum or fund:

- a. The Oil Conservation Division acquires by this assignment the entire beneficial interest in the fund, with the right to order the trustee in writing to distribute the fund to persons determined by the Division to be entitled thereto, including the Division itself, in amounts determined by the Division, or to the operator upon sale or proper plugging of the well covered by this bond.
- b. Operator retains no legal or beneficial interest in the fund and has only the right to interest, if any, thereon, and to return of the fund upon written order of the Division.
- c. The financial institution agrees that the fund may not be assigned, transferred, pledged or distributed except upon written order of the Division or a court of competent jurisdiction made in a proceeding in which the Division is a party. The financial institution waives all statutory or common law liens or rights of set-off against the fund.

Operator agrees that the financial institution may deduct from interest due operator any attorney fees incurred by the financial institution if claim or demand via writ, summons or other process arising from operator's business is made upon the financial institution.

Patrick Woosley
Signature of Operator,
Personally or by Authorized Officer

Cherry Vada
Signature of Authorized Officer of
Financial Institution

President
Title

Operation Officer
Title

STATE OF NEW MEXICO
COUNTY OF SAN JUAN -) ss.

On this 17TH day of SEPTEMBER, 1990, before me personally appeared PATRICK WOOSLEY and Cherry Vada, to me known to be the person (persons) described in and who executed the foregoing instrument and acknowledged that they executed the same as their free act and deed.

IN WITNESS WHEREOF, I have hereunto set my hand and seal on the day and year in this certificate first above written.

Dee Schneider
NOTARY PUBLIC

My Commission expires:
DECEMBER 15, 1993

SINGLE WELL CASH BOND

Know all men by these presents that A.P.A. Development Inc.
(an individual) (a partnership) (a corporation organized
in the State of Colorado with its principal office at
P.O. Box 215 in the city of Cortez, State of Colorado
and authorized to do business in the State of New Mexico) is held and firmly bound to
the Oil Conservation Division of the State of New Mexico (or its successor agency) in
the sum of \$ 7,500.00 (Seven Thousand, Five Hundred Dollars), lawful money of
the United States.

THE CONDITIONS OF THIS OBLIGATION ARE SUCH THAT:

The above applicant/operator desires to drill a well or purchase or operate an
existing well, the depth of which does not exceed 10,000 feet, to
prospect for and produce oil, gas, or carbon dioxide resources on land owned by
private individuals or the State of New Mexico, the particular identification and
footage location of said well being as follows: 990 Feet From The South Line and
2310 Feet From The West Line in Section 11, Township
21N, Range 10W, NMPM, San Juan County, New Mexico.

The applicant has deposited on behalf of the Division \$ 7,500.00, in the manner
indicated on the attachment to this bond being the principal sum intended to be
secured. Applicant pledges this sum as a guarantee that it, its executors, assigns,
heirs or administrators shall plug the well described above if dry, or when abandoned,
in accordance with the rules and orders of the Oil Conservation Division of the State
of New Mexico in such way as to confine the oil, gas, and water in the strata in which
they are found, and to prevent same from escaping to other strata. If the applicant
does not so properly plug and abandon said well upon order of the Division, the total
sum of the bond shall be forfeited to the Division, and such amount as is necessary
may be used to properly plug said well. If the principal sum of this bond is less
than the actual cost incurred by the Division in plugging said well, the applicant,
its successors, assigns, heirs or administrators shall be liable under the provisions
of Section 70-2-38 NMSA (1978) of the Oil and Gas Act, and the Division may take
action, including the filing of legal proceedings, to recover any amounts expended
over and above the principal sum of the bond.

NOW THEREFORE, if the above applicant or its successors, assigns, heirs, or
administrators or any of them shall plug the above-described well when dry or
abandoned, in accordance with the rules, regulations, and orders of the Division, in
such a manner as to confine the oil, gas, and water in the strata in which they
naturally occur, and to prevent them from escaping into other strata, and further to
clean up the surface location of said well, then therefore, this obligation shall be
null and void and the principal sum shall be paid to the applicant, or its successors,
heirs, or administrator, otherwise it shall remain in full force and effect.

A.P.A. Development Inc.

OPERATOR

P.O. Box 215, Cortez, CO 81321

Address

By Patricia B. Wooley

Signature

President

Title

(Note: Principal, if corporation, affix corporate seal here.)

COMPANY H/PA Development Inc		PROPERTY NAME Santa Fe Leggs	WELL NO. 2
DATE	LOCATION (ULSTR) N-11-21N-10W	FOOTAGE 490 FSL 2310 FNL	
API NO. 30-045-23027		POOL Leggs Entrada	
<ol style="list-style-type: none"> ① RU unit + Poch w/ thg + production exp. ② RIH to 5452' + pump a 40' plug. WOC + tag want TOC at least 5350 ③ PUH to 4487' + spot a 30' x plug ④ PUH to 2980' + spot a 30' x plug ⑤ PUH to 1350' + spot a 30' x plug ⑥ PUH to 240' + circulate cement to surface. ⑦ Set P+M marker, cut anchors, clean + level location. 			
CASING RECORD: 95/8" C 183' C 150' x Hole 12 1/4" 7" C 5584' 950' x Hole 8 3/4" Ports C 5415-5422 2 7/8 Tbg C 3019 DU Tool C 2824			

NO. OF COPIES RECEIVED	6
DISTRIBUTION	
SANTA FE	1
FILE	1
U.S.G.S.	2
LAND OFFICE	
OPERATOR	2

NEW MEXICO OIL CONSERVATION COMMISSION

30-045-23027
Form C-101
Revised 1-1-65

5A. Indicate Type of Lease	
STATE <input type="checkbox"/>	FEE <input checked="" type="checkbox"/>
5. State Oil & Gas Lease No.	

APPLICATION FOR PERMIT TO DRILL, DEEPEN, OR PLUG BACK

a. Type of Work		7. Unit Agreement Name	
DRILL <input checked="" type="checkbox"/> DEEPEN <input type="checkbox"/> PLUG BACK <input type="checkbox"/>			
b. Type of Well		8. Farm or Lease Name	
OIL WELL <input checked="" type="checkbox"/> GAS WELL <input type="checkbox"/> OTHER <input type="checkbox"/>		Santa Fe Leggs	
c. Name of Operator		9. Well No.	
Dome Petroleum Corp.		2	
d. Address of Operator		10. Field and Pool, or Wildcat	
K & A, Inc. Minerals Management, 501 Airport Drive, Suite 105, Farmington, New Mexico 87401		Leggs Entrada	
e. Location of Well		12. County	
UNIT LETTER <u>N</u> LOCATED <u>990</u> FEET FROM THE <u>South</u> LINE AND <u>2310</u> FEET FROM THE <u>West</u> LINE OF SEC. <u>11</u> TWP. <u>21N</u> RGE. <u>10W</u> NMPM		San Juan	
19. Proposed Depth		19A. Formation	
5800'		Entrada	
20. Rotary or C.T.		Rotary	
21. Elevations (Show whether DF, RT, etc.)		22. Approx. Date Work will start	
21A. Kind & Status Plug. Bond		21B. Drilling Contractor	
Statewide		4-Corners Drilling	
		June 1, 1978	

PROPOSED CASING AND CEMENT PROGRAM

SIZE OF HOLE	SIZE OF CASING	WEIGHT PER FOOT	SETTING DEPTH	SACKS OF CEMENT	EST. TOP
13 1/4"	9 5/8"	3	200	200	Surface
8 3/4"	7	20 & 23	6500	1000 (2 stage)	Surface

Operator proposes to drill an Entrada test to the depth of 5800'. Completion will be determined from logs. A series 900 (3000 psi WP) blowout preventer will be used during drilling operations below surface pipe.

8-13-78



ABOVE SPACE DESCRIBE PROPOSED PROGRAM; IF PROPOSAL IS TO DEEPEN OR PLUG BACK, GIVE DATA ON PRESENT PRODUCTIVE ZONE AND PROPOSED NEW PRODUCTIVE ZONE. GIVE BLOWOUT PREVENTER PROGRAM, IF ANY.

I hereby certify that the information above is true and complete to the best of my knowledge and belief.

Signature: [Signature] Title: Area Manager Date: May 12, 1978

(This space for State Use)

PROVED BY: [Signature] TITLE: DEPUTY OIL CONSERVATION COMMISSIONER, DIST #3 DATE: MAY 15 1978

CONDITIONS OF APPROVAL, IF ANY:

**NEW MEXICO OIL CONSERVATION COMMISSION
WELL LOCATION AND ACREAGE DEDICATION PLAT**

Form C-102
Supersedes C-128
Effective 1-1-65

All distances must be from the outer boundaries of the Section.

Owner DOMO PETROLEUM CORPORATION			Lease Santa Fe-Leggs		Well No. 2
Unit Letter N	Section 11	Township 21N	Range 10W	County San Juan	
Actual Footage Location of Well: 990 feet from the South line and 2310 feet from the West line					
Ground Level Elev. 6379	Producing Formation Entrada	Pool Leggs Entrada		Dedicated Acreage: 40 Acres	

1. Outline the acreage dedicated to the subject well by colored pencil or hachure marks on the plat below.
2. If more than one lease is dedicated to the well, outline each and identify the ownership thereof (both as to working interest and royalty).
3. If more than one lease of different ownership is dedicated to the well, have the interests of all owners been consolidated by communitization, unitization, force-pooling, etc?

☐ Yes ☐ No If answer is "yes," type of consolidation _____

If answer is "no," list the owners and tract descriptions which have actually been consolidated. (Use reverse side of this form if necessary.) _____

No allowable will be assigned to the well until all interests have been consolidated (by communitization, unitization, forced-pooling, or otherwise) or until a non-standard unit, eliminating such interests, has been approved by the Commission.

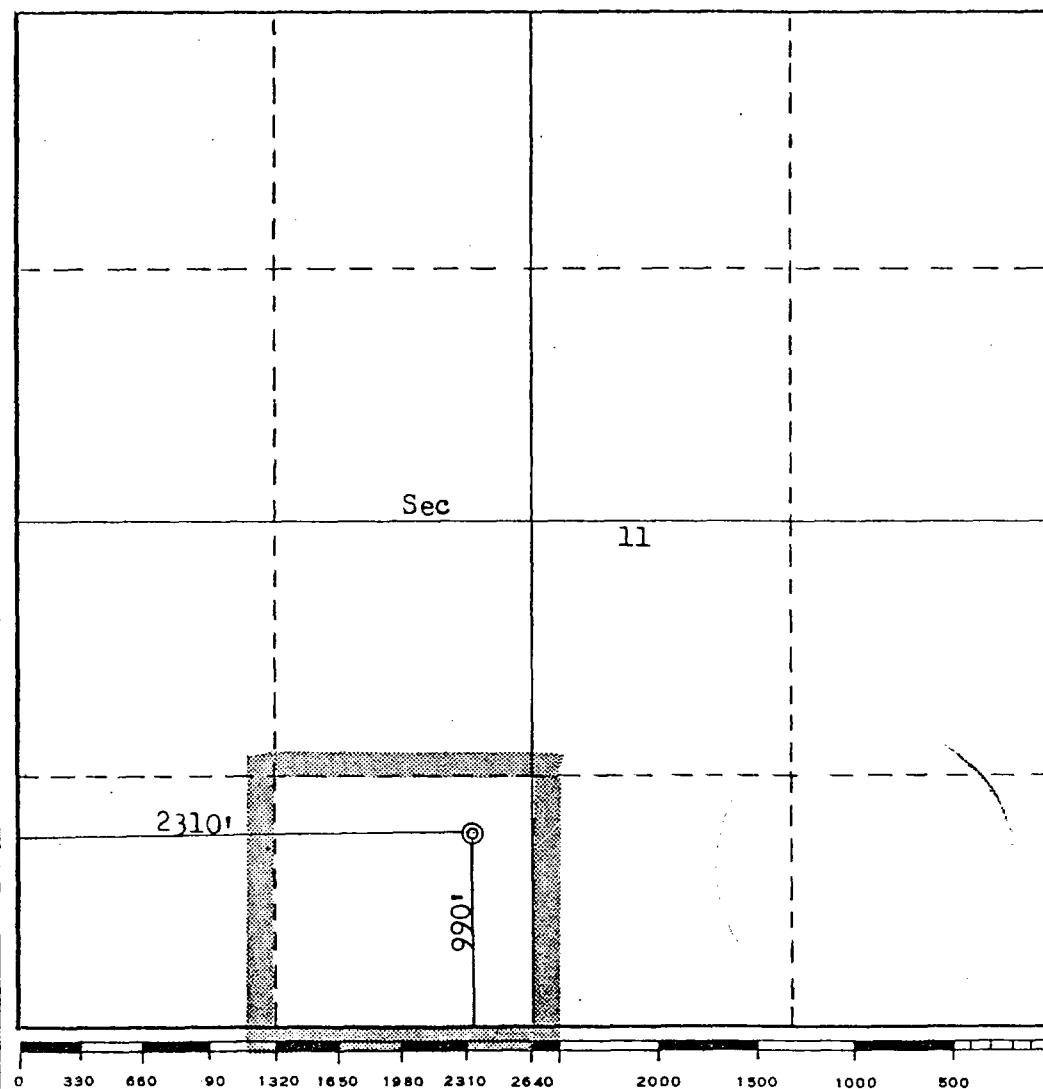

CERTIFICATION

I hereby certify that the information contained herein is true and complete to the best of my knowledge and belief.

Name
Area Manager
Position **K & A, Inc.**
Minerals Management
Company
May 12, 1978
Date

I hereby certify that the well location shown on this plat was plotted from field notes of actual surveys made by me or under my supervision, and that the same is true and correct to the best of my knowledge and belief.

Date Surveyed
May 10, 1978
Registered Professional Engineer
and/or Land Surveyor
Fred B. Kerr Jr.
Certificate No. **3950**
NEW MEXICO
FRED B. KERR, JR.

NO. OF COPIES RECEIVED	6
DISTRIBUTION	
SANTA FE	
FILE	
U.S.G.S.	
LAND OFFICE	
OPERATOR	4

NEW MEXICO OIL CONSERVATION COMMISSION

Form C-103
Supersedes Old
C-102 and C-103
Effective 1-1-65

5a. Indicate Type of Lease	
State <input type="checkbox"/>	Fee <input checked="" type="checkbox"/>
5. State Oil & Gas Lease No.	

SUNDRY NOTICES AND REPORTS ON WELLS	
(DO NOT USE THIS FORM FOR PROPOSALS TO DRILL OR TO DEEPEN OR PLUG BACK TO A DIFFERENT RESERVOIR. USE "APPLICATION FOR PERMIT -" (FORM C-101) FOR SUCH PROPOSALS.)	
1. OIL WELL <input checked="" type="checkbox"/> GAS WELL <input type="checkbox"/> OTHER <input type="checkbox"/>	7. Unit Agreement Name
2. Name of Operator Dome Petroleum Corp.	8. Farm or Lease Name Santa Fe Leggs
3. Address of Operator 501 Airport Drive, Suite 107, Farmington, New Mexico 87401	9. Well No. 2
4. Location of Well UNIT LETTER <u>N</u> <u>990</u> FEET FROM THE <u>South</u> LINE AND <u>2310</u> FEET FROM THE <u>West</u> LINE, SECTION <u>11</u> TOWNSHIP <u>21N</u> RANGE <u>10W</u> N.M.P.M.	10. Field and Pool, or Wildcat Leggs Entrada
15. Elevation (Show whether DF, RT, GR, etc.) 6379 G.L.	12. County San Juan

16. Check Appropriate Box To Indicate Nature of Notice, Report or Other Data
NOTICE OF INTENTION TO: SUBSEQUENT REPORT OF:

PERFORM REMEDIAL WORK <input type="checkbox"/>	PLUG AND ABANDON <input type="checkbox"/>	REMEDIAL WORK <input type="checkbox"/>	ALTERING CASING <input type="checkbox"/>
TEMPORARILY ABANDON <input type="checkbox"/>	CHANGE PLANS <input type="checkbox"/>	COMMENCE DRILLING OPNS. <input type="checkbox"/>	PLUG AND ABANDONMENT <input type="checkbox"/>
PULL OR ALTER CASING <input type="checkbox"/>	OTHER <input type="checkbox"/>	CASING TEST AND CEMENT JOB <input type="checkbox"/>	OTHER <u>Spud & set surface casing</u> <input checked="" type="checkbox"/>

17. Describe Proposed or Completed Operations (Clearly state all pertinent details, and give pertinent dates, including estimated date of starting any proposed work) SEE RULE 1103.

7/4/78 Spudded 12-1/4" hole at 8:00 p.m. 7/4/78

7/5/78 Ran 4 joints (183') 9-5/8" O.D., 32.3#, H-40, ST&C casing
Set at 195' K.B. Cemented with 150 sx Class B cement with
2% CaCl. Plug down at 6:00 a.m. 7/5/78. Circulated cement

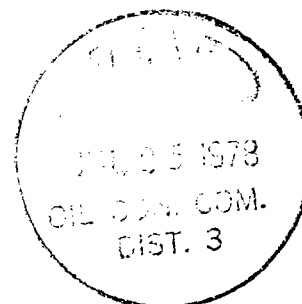

18. I hereby certify that the information above is true and complete to the best of my knowledge and belief.

SIGNED <u>J. Amos</u>	TITLE <u>Drilling & Production Superintendent</u>	DATE <u>7/6/78</u>
APPROVED BY <u>Original Sign</u>	TITLE <u>SUPERVISOR DIST. 3</u>	DATE <u>JUL 6 1978</u>
CONDITIONS OF APPROVAL, IF ANY:		

NO. OF COPIES RECEIVED	6
DISTRIBUTION	
SANTA FE	1
FILE	1
U.S.G.S.	
LAND OFFICE	
OPERATOR	4

NEW MEXICO OIL CONSERVATION COMMISSION

Form C-103
Supersedes Old
C-102 and C-103
Effective 1-1-65

5a. Indicate Type of Lease	
State <input type="checkbox"/>	Fee <input checked="" type="checkbox"/>
5. State Oil & Gas Lease No.	

SUNDRY NOTICES AND REPORTS ON WELLS

(DO NOT USE THIS FORM FOR PROPOSALS TO DRILL OR TO DEEPEN OR PLUG BACK TO A DIFFERENT RESERVOIR.
USE "APPLICATION FOR PERMIT --" (FORM C-101) FOR SUCH PROPOSALS.)

1. OIL WELL <input checked="" type="checkbox"/> GAS WELL <input type="checkbox"/> OTHER <input type="checkbox"/>		7. Unit Agreement Name
2. Name of Operator Dome Petroleum Corp.		8. Farm or Lease Name Santa Fe Leggs
3. Address of Operator 501 Airport Drive, Suite 107 Petroleum Center Bldg., Farmington, NM 87401		9. Well No. 2
4. Location of Well UNIT LETTER <u>N</u> <u>990</u> FEET FROM THE <u>South</u> LINE AND <u>2310</u> FEET FROM THE <u>West</u> LINE, SECTION <u>11</u> TOWNSHIP <u>21N</u> RANGE <u>10W</u> NMPM.		10. Field and Pool, or Wildcat Leggs Entrada
15. Elevation (Show whether DF, RT, GR, etc.)		12. County San Juan

16. Check Appropriate Box To Indicate Nature of Notice, Report or Other Data

NOTICE OF INTENTION TO:

PERFORM REMEDIAL WORK <input type="checkbox"/>	PLUG AND ABANDON <input type="checkbox"/>
TEMPORARILY ABANDON <input type="checkbox"/>	CHANGE PLANS <input type="checkbox"/>
PULL OR ALTER CASING <input type="checkbox"/>	OTHER <input type="checkbox"/>

SUBSEQUENT REPORT OF:

REMEDIAL WORK <input type="checkbox"/>	ALTERING CASING <input type="checkbox"/>
COMMENCE DRILLING OPNS. <input type="checkbox"/>	PLUG AND ABANDONMENT <input type="checkbox"/>
CASING TEST AND CEMENT JOBS <input type="checkbox"/>	OTHER <u>Production Casing</u> <input checked="" type="checkbox"/>

17. Describe Proposed or Completed Operations (Clearly state all pertinent details, and give pertinent dates, including estimated date of starting any proposed work) SEE RULE 1103.

7/16/78 Ran 5584', 133 joints, 7" - 23# & 20#, K55, ST&C casing. Set at 5584.40 KB. Cemented first stage with 385 sx 65/35 Pozmix w/6% gel, 10# Gilsonite/sx. Followed with 100 sx Class B w/10% salt. Plug down at 1:30 a.m. 7/16/78. Opened DV tool at 2824' and circulated 4 hours.

Cemented second stage w/415 sx 65/35 Pozmix w/6% gel, 10# Gilsonite/sx followed with 50 sx Class B w/10% salt. Plug down at 7:30 a.m. 7/16/78. Circulated cement on second stage



18. I hereby certify that the information above is true and complete to the best of my knowledge and belief.

SIGNED J. Arnold Gull TITLE Drilling & Production Superintendent DATE July 16, 1978

Original Signed by A. L. Erickson

APPROVED BY _____ TITLE _____ DATE _____

CONDITIONS OF APPROVAL, IF ANY:

TABULATION OF DEVIATION TEST
DOME PETROLEUM CORP.
SANTA FE-LEGGs #2
SAN JUAN COUNTY, NEW MEXICO

N-11-21N-10W

<u>DEVIATION</u>	<u>DEPTH</u>
3/4°	207'
1/2°	720'
3/4°	1282'
1°	1721'
1 3/4°	2260'
1°	2720'
1°	3267'
3/4°	3797'
3/4°	4329'
1°	4823'
1/2°	5632'



AFFIDAVIT

This is to certify that the above deviation tests are correct to the best of my knowledge.

J. Arnold Snell
J. Arnold Snell
Drilling & Production Supt.

Subscribed and sworn to before me this first day of August, 1978.

Katharine B. Jenkins
Notary Public

My commission expires:
May 12, 1980

DISTRIBUTION	
SANTA FE	1
FILE	2
U.S.G.S.	2
LAND OFFICE	
OPERATOR	3

NEW MEXICO OIL CONSERVATION COMMISSION WELL COMPLETION OR RECOMPLETION REPORT AND LOG

5a. Indicate Type of Lease	
State <input type="checkbox"/>	Fee <input checked="" type="checkbox"/>
5. State Oil & Gas Lease No.	

1a. TYPE OF WELL

OIL WELL ☒ GAS WELL ☐ DRY ☐ OTHER ☐

b. TYPE OF COMPLETION

NEW WELL ☐ WORK OVER ☐ DEEPEN ☐ PLUG BACK ☐ DIFF. RESVR. ☐ OTHER ☐

7. Unit Agreement Name

8. Farm or Lease Name

Santa Fe-Leggs

2. Name of Operator

Dome Petroleum Corp., 501 Airport Drive,

9. Well No.

2

3. Address of Operator

Suite 107, Farmington, New Mexico 87401

10. Field and Pool, or Wildcat

Leggs-Entrada

4. Location of Well

UNIT LETTER N LOCATED 990' FEET FROM THE south LINE AND 2310 FEET FROM

12. County

San Juan

THE west LINE OF SEC. 11 TWP. 21N RGE. 10W NMPM

15. Date Spudded 7/4/78 16. Date T.D. Reached 7/15/78 17. Date Compl. (Ready to Prod.) 7/26/78 18. Elevations (DF, RKB, RT, GR, etc.) 6379' GR

19. Elev. Casinghead

20. Total Depth 5632' 21. Plug Back T.D. 5564' 22. If Multiple Compl., How Many ---- 23. Intervals Drilled By Rotary Tools 0-5632' Cable Tools ----

25. Was Directional Survey Made NO

24. Producing Interval(s), of this completion - Top, Bottom, Name 5415' - 5600' Entrada

27. Was Well Cored NO

26. Type Electric and Other Logs Run Dual Induction Laterolog, CNL-Density/GR

28. CASING RECORD (Report all strings set in well)					
CASING SIZE	WEIGHT LB./FT.	DEPTH SET	HOLE SIZE	CEMENTING RECORD	AMOUNT PULLED
9 5/8	32.3#	1951'	12 1/4	150 sx	none
7"	23# & 20#	5584'	8 3/4	950 sx (2 stage)	none

29. LINER RECORD				30. TUBING RECORD			
SIZE	TOP	BOTTOM	SACKS CEMENT	SCREEN	SIZE	DEPTH SET	PACKER SET
					2 7/8"	3021'	-----

31. Perforation Record (Interval, size and number)

5415'-5422' with 2 jet shots per foot

32. ACID, SHOT, FRACTURE, CEMENT SQUEEZE, ETC.	
DEPTH INTERVAL	AMOUNT AND KIND MATERIAL USED

33. PRODUCTION

Date First Production 7/26/78 Production Method (Flowing, gas lift, pumping - Size and type pump) Pumping Well Status (Prod. or Shut-in) Producing

Date of Test <u>7/28/78</u>	Hours Tested <u>24</u>	Choke Size <u>----</u>	Prod'n. For Test Period <u>-----></u>	Oil - Bbl. <u>62</u>	Gas - MCF <u>TSTM</u>	Water - Bbl. <u>511</u>	Gas-Oil Ratio <u>-----</u>
Flow Tubing Press. <u>----</u>	Casing Pressure <u>----</u>	Calculated 24-Hour Rate <u>-----></u>	Oil - Bbl. <u>62</u>	Gas - MCF <u>TSTM</u>	Water - Bbl. <u>511</u>	Oil Gravity - API (Corr.) <u>-----</u>	

34. Disposition of Gas (Sold, used for fuel, vented, etc.)

Test Witnessed By Ray Sandoval

35. List of Attachments

NONE

36. I hereby certify that the information shown on both sides of this form is true and complete to the best of my knowledge and belief.

SIGNED J. Arnold Sull TITLE Drilling & Production Supt DATE 8/3/78

From	To	Thickness in Feet	Formation	From	To	Thickness in Feet	Formation

NO. OF COPIES RECEIVED		5
DISTRIBUTION		
SANTA FE		
FILE		
U.S.G.S.		
LAND OFFICE		
TRANSPORTER	OIL	1
	GAS	
OPERATOR		2
PRORATION OFFICE		

NEW MEXICO OIL CONSERVATION COMMISSION
REQUEST FOR ALLOWABLE
AND
AUTHORIZATION TO TRANSPORT OIL AND NATURAL GAS

Form C-104
Supersedes Old C-104 and C-110
Effective 1-1-65

B.R.

Operator Dome Petroleum Corp.	
Address 501 Airport Drive, Suite 107 Farmington, NM 87401	
Reason(s) for filing (Check proper box)	
New Well <input checked="" type="checkbox"/>	Change in Transporter of:
Recompletion <input type="checkbox"/>	Oil <input type="checkbox"/> Dry Gas <input type="checkbox"/>
Change in Ownership <input type="checkbox"/>	Casinghead Gas <input type="checkbox"/> Condensate <input type="checkbox"/>
Other (Please explain)	
If change of ownership give name and address of previous owner	

DESCRIPTION OF WELL AND LEASE

Lease Name Santa Fe - Leggs	Well No. 2	Pool Name, including Formation Leggs - Entrada	Kind of Lease State, Federal or Fee Fee	Lease No.
Location				
Unit Letter N : 990 Feet From The South Line and 2310 Feet From The West				
Line of Section 11 Township 21N Range 10W , NMPM, San Juan County				

DESIGNATION OF TRANSPORTER OF OIL AND NATURAL GAS

Name of Authorized Transporter of Oil <input checked="" type="checkbox"/> or Condensate <input type="checkbox"/>	Address (Give address to which approved copy of this form is to be sent)					
Permian Corporation	P.O. Box 1183, Houston, Texas 77001					
Name of Authorized Transporter of Casinghead Gas <input type="checkbox"/> or Dry Gas <input type="checkbox"/>	Address (Give address to which approved copy of this form is to be sent)					
If well produces oil or liquids, give location of tanks.	Unit N	Sec. 11	Twp. 21N	Rge. 10W	Is gas actually connected? NO	When

If this production is commingled with that from any other lease or pool, give commingling order number:

COMPLETION DATA

Designate Type of Completion - (X)	Oil Well X	Gas Well	New Well	Workover	Deepen	Plug Back	Same Res'v.	Diff. Res'v.
Date Spudded 7/4/78	Date Compl. Ready to Prod. 7/26/78	Total Depth 5632	P.B.T.D. 5564					
Elevations (DF, RKB, RT, GR, etc.) 6379' GR	Name of Producing Formation Entrada	Top Oil/Gas Pay 5415	Tubing Depth 3019					
Perforations 5415 - 5422	Depth Casing Shoe 5584							

TUBING, CASING, AND CEMENTING RECORD

HOLE SIZE	CASING & TUBING SIZE	DEPTH SET	SACKS CEMENT
12 1/4"	9 5/8", 32.3#	195'	150 sacks
8 3/4"	7", 23# & 20#	5584'	950 (2 stage)
	2 7/8", 6.5#	3019'	

TEST DATA AND REQUEST FOR ALLOWABLE OIL WELL

(Test must be after recovery of total volume of load oil and must be equal to or exceed top allowable for this depth or be for full 24 hours)

Date First New Oil Run To Tanks 7/26/78	Date of Test 7/28/78	Producing Method (Flow, pump, gas lift, etc.) Pumping	
Length of Test 24 hours	Tubing Pressure ---	Casing Pressure ---	Choke Size ---
Actual Prod. During Test 573 bbls	Oil - Bbls. 62	Water - Bbls. 511	Gas - MCF ---

GAS WELL

Actual Prod. Test-MCF/D	Length of Test	Bbls. Condensate/MMCF	Gravity of Condensate
Testing Method (pilot, back pr.)	Tubing Pressure (shut-in)	Casing Pressure (shut-in)	Choke Size

CERTIFICATE OF COMPLIANCE

I hereby certify that the rules and regulations of the Oil Conservation Commission have been complied with and that the information given above is true and complete to the best of my knowledge and belief.

J. Arnold Shell
Drilling & Production Supt.
August 1, 1978

OIL CONSERVATION COMMISSION

APPROVED AUG 1 1978, 19
BY Original Signed [Signature]
TITLE SUPERVISOR

This form is to be filed in compliance with RULE 1104.
If this is a request for allowable for a newly drilled or deepened well, this form must be accompanied by a tabulation of the deviation tests taken on the well in accordance with RULE 111.
All sections of this form must be filled out completely for allowable on new and recompleted wells.
Fill out only Sections I, II, III, and VI for changes of owner, well name or number, or transporter, or other such change of condition.
Separate Form C-104 must be filed for each pool in multiply



STATE OF NEW MEXICO
ENERGY AND MINERALS DEPARTMENT
OIL CONSERVATION DIVISION

JERRY APODACA
GOVERNOR

NICK FRANKLIN
SECRETARY

October 18, 1978

POST OFFICE BOX 2088
STATE LAND OFFICE BUILDING
SANTA FE, NEW MEXICO 87501
(505) 827-2434

Dome Petroleum Corporation
501 Airport Drive, Suite 107
Farmington, New Mexico 87401

Attention: Mr. J. Arnold Snell

Administrative Order TX-60

Gentlemen:

Reference is made to your request for an exception to the tubing setting requirements as contained in Division Rule 107 (d) (3) for the below-named well.

Pursuant to the authority granted me by Rule 107 (d) (4), you are hereby authorized to set tubing at 3019 feet in the following well:

<u>LEASE NAME</u>	<u>WELL NO.</u>	<u>UNIT</u>	<u>S-T-R</u>
Santa Fe-Leggs	2	N	11-21N-10W

The Division reserves the right to rescind this authority in the event that waste appears to be resulting therefrom.

Very truly yours,

JOE D. RAMEY
Division Director

JDR/DSN/og

cc: Oil Conservation Division
1000 Rio Brazos Road
Aztec, New Mexico

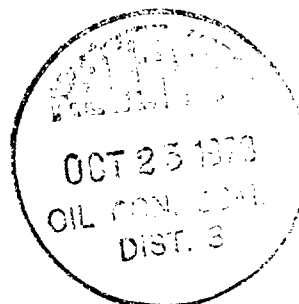

NO. OF COPIES RECEIVED		
DISTRIBUTION		
SANTA FE		
FILE		
U.S.G.S.		
LAND OFFICE		
TRANSPORTER	OIL	
	GAS	
OPERATOR		
PRORATION OFFICE		

NEW MEXICO OIL CONSERVATION COMMISSION
REQUEST FOR ALLOWABLE
AND
AUTHORIZATION TO TRANSPORT OIL AND NATURAL GAS

Form C-104
Supersedes Old C-104 and C-105
Effective 1-1-65

RECEIVED
MAR 14 1984
OIL CON. DIV.
DIST. 3

Operator TEXACO Inc.,	
Address P. O. Box 2100, Denver, Colorado 80201	
Reason for filing (Check proper box)	Other (Please explain)
New Well <input type="checkbox"/>	[REDACTED]
Recompletion <input type="checkbox"/>	
Change in OPERATOR <input checked="" type="checkbox"/>	
Change in Transporter of: Oil <input type="checkbox"/> Dry Gas <input type="checkbox"/> Casinghead Gas <input type="checkbox"/> Condensate <input type="checkbox"/>	

If change of ownership give name and address of previous owner **Dome Petroleum Corp., 1625 Broadway, Denver, Colorado**

II. DESCRIPTION OF WELL AND LEASE

Lease Name SANTA FE LEGGS	Well No. 2	Pool Name, including Formation LEGGS - ENTRADA	Kind of Lease State, Federal or Fee FEE	Lease No.
Location Unit Letter N ; 990 Feet From The SOUTH Line and 2310 Feet From The WEST Line of Section 11 Township 21N Range 10W , NMPM, SAN JUAN County				

III. DESIGNATION OF TRANSPORTER OF OIL AND NATURAL GAS

Name of Authorized Transporter of Oil <input checked="" type="checkbox"/> or Condensate <input type="checkbox"/> PERMIAN CORP.	Address (Give address to which approved copy of this form is to be sent) P.O. Box 1183, HOUSTON, TX 77001	
Name of Authorized Transporter of Casinghead Gas <input type="checkbox"/> or Dry Gas <input type="checkbox"/>	Address (Give address to which approved copy of this form is to be sent)	
If well produces oil or liquids, give location of tanks.	Unit M	Sec. 11
	Twp. 21N	Rge. 10W
	Is gas actually connected? NO	
	When	

If this production is commingled with that from any other lease or pool, give commingling order number:

IV. COMPLETION DATA

Designate Type of Completion - (X)		Oil Well	Gas Well	New Well	Workover	Deepen	Plug Back	Same Res'v.	Diff. Res'v.
Date Spudded	Date Compl. Ready to Prod.	Total Depth		P.B.T.D.					
Elevations (DF, Rkb, RT, GR, etc.)	Name of Producing Formation	Top Oil/Gas Pay		Tubing Depth					
Perforations		Depth Casing Shoe							
TUBING, CASING, AND CEMENTING RECORD									
HOLE SIZE		CASING & TUBING SIZE		DEPTH SET		SACKS CEMENT			

V. TEST DATA AND REQUEST FOR ALLOWABLE OIL WELL (Test must be after recovery of total volume of load oil and must be equal to or exceed top allowable for this depth or be for full 24 hours)

Date First New Oil Run To Tanks	Date of Test	Producing Method (Flow, pump, gas lift, etc.)	
Length of Test	Tubing Pressure	Casing Pressure	Choke Size
Actual Prod. During Test	Oil - Bbls.	Water - Bbls.	Gas - MCF

GAS WELL

Actual Prod. Test - MCF	Length of Test	Bbls. Condensate	Gravity of Condensate
Testing Method (pilot, back prod.)	Tubing Pressure (Shut-in)	Casing Pressure (Shut-in)	Choke Size

VI. CERTIFICATE OF COMPLIANCE

I hereby certify that the rules and regulations of the Oil Conservation Commission have been complied with and that the information given above is true and complete to the best of my knowledge and belief.

TEXACO Inc. as Operator for Texaco Oils

Alan R. Marx
Field Supt. (Signature)

3-9-84
(Date)

OIL CONSERVATION COMMISSION

APPROVED MAY 07 1984, 19
BY Frank J. [Signature]
Inc. TITLE SUPERVISOR DISTRICT # 3

This form is to be filed in compliance with RULE 1104.

If this is a request for allowable for a newly drilled or deepened well, this form must be accompanied by a tabulation of the deviation tests taken on the well in accordance with RULE 111.

All sections of this form must be filled out completely for allowable on new and recompleted wells.

Fill out only Sections I, II, III, and VI for changes of owner, well name or number, or transporter, or other such change of condition.

Separate Forms C-104 must be filed for each pool in multiply

NO. OF COPIES RECEIVED	
DISTRIBUTION	
SANTA FE	
FILE	
U.S.G.S.	
LAND OFFICE	
TRANSPORTER	OIL
	GAS
OPERATOR	
PRORATION OFFICE	

NEW MEXICO OIL CONSERVATION COMMISSION
REQUEST FOR ALLOWABLE
AND
AUTHORIZATION TO TRANSPORT OIL AND NATURAL GAS

Form C-104
Supersedes Old C-104 and C-110
Effective 1-1-85

Operator TEXACO INC.	
Address P.O. Box EE, Cortez, CO. 81321	
Reason(s) for filing (Check proper box)	Other (Please explain)
New Well <input type="checkbox"/>	Change In Transporter of: Oil <input checked="" type="checkbox"/> Dry Gas <input type="checkbox"/> Casinghead Gas <input type="checkbox"/> Condensate <input type="checkbox"/>
Recompletion <input type="checkbox"/>	Previous transporter was Permian, now it is Gary Energy Corp.
Change In Ownership <input type="checkbox"/>	

change of ownership give name
and address of previous owner

DESCRIPTION OF WELL AND LEASE

Lease Name Santa Fe Leggs	Well No. 2	Pool Name, including Formation Leggs - Entrada	Kind of Lease State, Federal or Fee Fee	Lease No.
Location Unit Letter N ; 990' Feet From The South Line and 2310' Feet From The West Line of Section 11 Township 21N Range 10W , NMPM, San Juan County				

DESIGNATION OF TRANSPORTER OF OIL AND NATURAL GAS

Name of Authorized Transporter of Oil <input checked="" type="checkbox"/> or Condensate <input type="checkbox"/> Gary Energy Corp.	Address (Give address to which approved copy of this form is to be sent) 115 Inverness Dr., Englewood, CO. 80112
Name of Authorized Transporter of Casinghead Gas <input type="checkbox"/> or Dry Gas <input type="checkbox"/>	Address (Give address to which approved copy of this form is to be sent)
Does well produce oil or liquids, give location of tanks.	Unit N Sec. 11 Twp. 21N Rge. 10W Is gas actually connected? No When

if this production is commingled with that from any other lease or pool, give commingling order number:

COMPLETION DATA

Designate Type of Completion - (X)	Oil Well	Gas Well	New Well	Workover	Deepen	Plug Back	Same Res'v.	Diff. Res'v.
Date Spudded	Date Compl. Ready to Prod.	Total Depth	P.B.T.D.					
Elevations (DF, RKB, RT, GR, etc.)	Name of Producing Formation	Top Oil/Gas Pay	Tubing Depth					
Perforations	Depth Casing Shoe							

TUBING, CASING, AND CEMENTING RECORD

HOLE SIZE	CASING & TUBING SIZE	DEPTH SET	SACKS CEMENT

TEST DATA AND REQUEST FOR ALLOWABLE
OIL WELL

(Test must be after recovery of total volume of load oil and must be equal to or exceed top allowable for this depth or be for full 24 hours)

Date First New Oil Run To Tanks	Date of Test	Producing Method (Flow, pump, gas lift, etc.)	
Length of Test	Tubing Pressure	Casing Pressure	Choke Size
Actual Prod. During Test	Oil-Bbls.	Water-Bbls.	Gas-MCF.

GAS WELL

Actual Prod. Test-MCF/D	Length of Test	Bbls. Condensate/MMCF	Gravity of Condensate
Testing Method (pitot, back pr.)	Tubing Pressure (shut-in)	Casing Pressure (shut-in)	Choke Size

CERTIFICATE OF COMPLIANCE

I hereby certify that the rules and regulations of the Oil Conservation Commission have been complied with and that the information given above is true and complete to the best of my knowledge and belief.

SIGNED A. R. MARX

(Signature)

AREA SUPERINTENDENT

(Title)

10/10/86

OIL CONSERVATION COMMISSION

APPROVED

BY

TITLE

This form is to be filed in compliance with RULE 1104.

If this is a request for allowable for a newly drilled or deepened well, this form must be accompanied by a tabulation of the deviation tests taken on the well in accordance with RULE 111.

All sections of this form must be filled out completely for allowable on new and recompleted wells.

Fill out only Sections I, II, III, and VI for changes of owner, well name or number, or transporter or other such change of condition.

NO. OF COPIES RECEIVED	
DISTRIBUTION	
SANTA FE	
FILE	
U.S.G.S.	
LAND OFFICE	
TRANSPORTER	OIL GAS
OPERATOR	
PRORATION OFFICE	

**NEW MEXICO OIL CONSERVATION COMMISSION
REQUEST FOR ALLOWABLE
AND
AUTHORIZATION TO TRANSPORT OIL AND NATURAL GAS**

Form C-104
Supersedes Old C-104 and C-110
Effective 1-1-65

I. Operator
TEXACO INC.
Address
P. O. Box EE, Cortez, CO. 81321

Reason(s) for filing (Check proper box)

New Well <input type="checkbox"/>	Change in Transporter of:	Other (Please explain)
Recompletion <input type="checkbox"/>	Oil <input checked="" type="checkbox"/>	Previous transporter was Gary Energy Corp., now it is Giant Industries Inc.
Change in Ownership <input type="checkbox"/>	Casinghead Gas <input type="checkbox"/>	Dry Gas <input type="checkbox"/>
		Condensate <input type="checkbox"/>

If change of ownership give name and address of previous owner

II. DESCRIPTION OF WELL AND LEASE

Lease Name Santa Fe Leggs	Well No. 2	Pool Name, including Formation Leggs-Entrada	Kind of Lease State, Federal or Free Fee	Lease No.
Location Unit Letter N ; 990' Feet From The South Line and 2310' Feet From The West Line of Section 11 Township 21N Range 10W , NMPM, San Juan County				

III. DESIGNATION OF TRANSPORTER OF OIL AND NATURAL GAS

Name of Authorized Transporter of Oil <input checked="" type="checkbox"/> or Condensate <input type="checkbox"/> Giant Industries Inc.	Address (Give address to which approved copy of this form is to be sent) P. O. Box 9156, Phoenix, AZ. 85068
Name of Authorized Transporter of Casinghead Gas <input type="checkbox"/> or Dry Gas <input type="checkbox"/>	Address (Give address to which approved copy of this form is to be sent)
If well produces oil or liquids, give location of tanks.	Unit Sec. Twp. Rge. Is gas actually connected? When N 11 21N 10W No

If this production is commingled with that from any other lease or pool, give commingling order number:

IV. COMPLETION DATA

Designate Type of Completion - (X)	Oil Well	Gas Well	New Well	Workover	Deepen	Plug Back	Same Res'.	Diff. Res'.
Date Spudded	Date Compl. Ready to Prod.	Total Depth	P.B.T.D.					
Elevations (DF, RKB, RT, GR, etc.)	Name of Producing Formation	Top Oil/Gas Pay	Tubing Depth					
Perforations			Depth Casing Shoe					
TUBING, CASING, AND CEMENTING RECORD								
HOLE SIZE	CASING & TUBING SIZE	DEPTH SET	SACKS CEMENT					

V. TEST DATA AND REQUEST FOR ALLOWABLE OIL WELL

(Test must be after recovery of total volume of load oil and must be equal to or exceed top allowable for this depth or be for full 24 hours)

Date First New Oil Run To Tanks	Date of Test	Producing Method (Flow, pump, gas lift, etc.)	
Length of Test	Tubing Pressure	Casing Pressure	Choke Size
Actual Prod. During Test	Oil - Bbls.	Water - Bbls.	Gas - MCF

GAS WELL

Actual Prod. Test - MCF/D	Length of Test	Bbls. Condensate/MMCF	Gravity of Condensate
Testing Method (pitot, back pr.)	Tubing Pressure (shut-in)	Casing Pressure (shut-in)	Choke Size

VI. CERTIFICATE OF COMPLIANCE

I hereby certify that the rules and regulations of the Oil Conservation Commission have been complied with and that the information given above is true and complete to the best of my knowledge and belief.

SIGNATURE OF AREA SUPERINTENDENT

(Signature)

AREA SUPERINTENDENT

(Title)

APR 28 1987

(Date)

OIL CONSERVATION COMMISSION

APPROVED

BY

TITLE

APR 30 1987
SUPERVISOR DISTRICT # 3

This form is to be filed in compliance with RULE 1104.

If this is a request for allowable for a newly drilled or deepened well, this form must be accompanied by a tabulation of the deviation tests taken on the well in accordance with RULE 111.

All sections of this form must be filled out completely for allowable on new and recompleted wells.

Fill out only Sections I, II, III, and VI for changes of owner, well name or number, or transporter, or other such change of condition.

Separate Forms C-104 must be filed for each pool in multiply completed wells.

NO. OF COPIES RECEIVED		
DISTRIBUTION		
SANTA FE		
FILE		
U.S.G.S.		
LAND OFFICE		
TRANSPORTER	OIL	
	GAS	
OPERATOR		
PRORATION OFFICE		

NEW MEXICO OIL CONSERVATION COMMISSION
REQUEST FOR ALLOWABLE
AND
AUTHORIZATION TO TRANSPORT OIL AND NATURAL GAS

Form C-104
Supersedes Old C-104 and C-110
Effective 1-1-65

I. Operator
TEXACO INC.
Address
P. O. Box 2100, Denver, CO. 80201
Reason(s) for filing (Check proper box)
New Well ☐ Change in Transporter of:
Recompletion ☐ Oil ☐ Dry Gas ☐
Change in Ownership ☒ Casinghead Gas ☐ Condensate ☐
Other (Please explain)
This reports change of ownership from ~~Texaco Inc.~~ to ~~Texaco Producing Inc.~~

If change of ownership give name and address of previous owner
Texaco Oils Inc., P. O. Box 2100, Denver, CO. 80201

II. DESCRIPTION OF WELL AND LEASE

Lease Name Santa Fe Leggs	Well No. 2	Pool Name, Including Formation Leggs-Entrada	Kind of Lease State, Federal or Fee Fee	Lease No.
Location Unit Letter <u>N</u> ; <u>990</u> Feet From The <u>South</u> Line and <u>2310</u> Feet From The <u>West</u> Line of Section <u>11</u> Township <u>21N</u> Range <u>10W</u> , NMPM, San Juan County				

III. DESIGNATION OF TRANSPORTER OF OIL AND NATURAL GAS

Name of Authorized Transporter of Oil <input checked="" type="checkbox"/> or Condensate <input type="checkbox"/> Giant Refinery	Address (Give address to which approved copy of this form is to be sent) P.O. Box 9156, Phoenix, AZ 85068	
Name of Authorized Transporter of Casinghead Gas <input type="checkbox"/> or Dry Gas <input type="checkbox"/>	Address (Give address to which approved copy of this form is to be sent)	
If well produces oil or liquids, give location of tanks. <u>NN</u> <u>11</u> <u>21N</u> <u>10W</u>	Unit <u>NN</u>	Sec. <u>11</u>
	Twp. <u>21N</u>	Rge. <u>10W</u>
Is gas actually connected?		When

If this production is commingled with that from any other lease or pool, give commingling order number:

IV. COMPLETION DATA

Designate Type of Completion - (X)	Oil Well	Gas Well	New Well	Workover	Deepen	Plug Back	Same Res'v.	Diff. Res'v.
Date Spudded	Date Compl. Ready to Prod.		Total Depth		P.B.T.D.			
Elevations (DF, RKB, RT, GR, etc.)	Name of Producing Formation		Top Oil/Gas Pay		Tubing Depth			
Perforations					Depth Casing Shoe			
TUBING, CASING, AND CEMENTING RECORD								
HOLE SIZE	CASING & TUBING SIZE		DEPTH SET		SACKS CEMENT			

V. TEST DATA AND REQUEST FOR ALLOWABLE OIL WELL

(Test must be after recovery of total volume of load oil and must be equal to or exceed top allowable for this depth or be for full 24 hours)

Date First New Oil Run To Tanks	Date of Test	Producing Method (Flow, pump, gas lift, etc.)	
Length of Test	Tubing Pressure	Casing Pressure	Choke Size
Actual Prod. During Test	Oil-Bbls.	Water-Bbls.	Gas-MCF

GAS WELL

Actual Prod. Test-MCF/D	Length of Test	Bbls. Condensate/MMCF	Gravity of Condensate
Testing Method (pitot, back pr.)	Tubing Pressure (Shut-in)	Casing Pressure (Shut-in)	Choke Size

VI. CERTIFICATE OF COMPLIANCE

I hereby certify that the rules and regulations of the Oil Conservation Commission have been complied with and that the information given above is true and complete to the best of my knowledge and belief.

TEXACO INC. As Operator for
TEXACO PRODUCING INC.

SIGNED: A. A. KLEIBER

(Signature)

AREA SUPERINTENDENT

(Title)

6/19/87

(Date)

OIL CONSERVATION COMMISSION

APPROVED JUN 26 1987, 19

BY [Signature]

TITLE SUPERVISION DISTRICT #5

This form is to be filed in compliance with RULE 1104.

If this is a request for allowable for a newly drilled or deepened well, this form must be accompanied by a tabulation of the deviation tests taken on the well in accordance with RULE 111.

All sections of this form must be filled out completely for allowable on new and recompleted wells.

Fill out only Sections I, II, III, and VI for changes of owner, well name or number, or transporter, or other such change of condition.

Separate Forms C-104 must be filed for each pool in multiply completed wells.

DISTRICT II
P.O. Drawer DD, Artesia, NM 88210

OIL CONSERVATION DIVISION

P.O. Box 2088

Santa Fe, New Mexico 87504-2088

DISTRICT III
1000 Rio Brazos Rd., Aztec, NM 87410

REQUEST FOR ALLOWABLE AND AUTHORIZATION TO TRANSPORT OIL AND NATURAL GAS

I.

Operator TEXACO INC.		Well API No.
Address 3300 N. Butler, Farmington, NM 87401		
Reason(s) for Filing (Check proper box) New Well <input type="checkbox"/> Recompletion <input type="checkbox"/> Change in Operator <input type="checkbox"/>		Change in Transporter of: Oil <input type="checkbox"/> <input checked="" type="checkbox"/> Dry Gas <input type="checkbox"/> Casinghead Gas <input type="checkbox"/> Condensate <input type="checkbox"/>
If change of operator give name and address of previous operator		<input type="checkbox"/> Other (Please explain) Previous transporter was Giant Industries Inc., now it is Meridian Oil Company effective 10/01/89.

II. DESCRIPTION OF WELL AND LEASE

Lease Name Santa Fe Leggs	Well No. 2	Pool Name, Including Formation Leggs-Entrada	Kind of Lease Fee State, Federal or Fee	Lease No.
Location Unit Letter N : 990 Feet From The S Line and 2310 Feet From The W Line Section 11 Township 21N Range 10W , NMPM, San Juan County				

III. DESIGNATION OF TRANSPORTER OF OIL AND NATURAL GAS

Name of Authorized Transporter of Oil <input checked="" type="checkbox"/> or Condensate <input type="checkbox"/> Meridian Oil Company	Address (Give address to which approved copy of this form is to be sent) P. O. Box 4289, Farmington, NM 87499
Name of Authorized Transporter of Casinghead Gas <input type="checkbox"/> or Dry Gas <input type="checkbox"/>	Address (Give address to which approved copy of this form is to be sent)
If well produces oil or liquids, give location of tanks.	Unit N Sec. 11 Twp. 21N Rge. 10W Is gas actually connected? NO When ?

If this production is commingled with that from any other lease or pool, give commingling order number:

IV. COMPLETION DATA

Designate Type of Completion - (X)	Oil Well	Gas Well	New Well	Workover	Deepen	Plug Back	Same Res'v	Diff Res'v
Date Spudded	Date Compl. Ready to Prod.		Total Depth			P.B.T.D.		
Elevations (DF, RKB, RT, GR, etc.)	Name of Producing Formation		Top Oil/Gas Pay			Tubing Depth		
Perforations						Depth Casing Shoe		

TUBING, CASING AND CEMENTING RECORD

HOLE SIZE	CASING & TUBING SIZE	DEPTH SET	SACKS CEMENT

V. TEST DATA AND REQUEST FOR ALLOWABLE

OIL WELL (Test must be after recovery of total volume of load oil and must be equal to or exceed top allowable for this depth or be for full 24 hours.)

Date First New Oil Run To Tank	Date of Test	Producing Method (Flow, pump, gas lift, etc.)	
Length of Test	Tubing Pressure	Casing Pressure	Choke Size
Actual Prod. During Test	Oil - Bbls.	Water - Bbls.	Gas - MCF

GAS WELL

Actual Prod. Test - MCF/D	Length of Test	Bbls. Condensate/MMCF	Gravity of Condensate
Testing Method (pilot, back pr.)	Tubing Pressure (Shut-in)	Casing Pressure (Shut-in)	Choke Size

VI. OPERATOR CERTIFICATE OF COMPLIANCE

I hereby certify that the rules and regulations of the Oil Conservation Division have been complied with and that the information given above is true and complete to the best of my knowledge and belief.

SIGNED: **A. A. KLEIER**

Signature

Area Manager

Printed Name

SEP 28 1989

Title

Date

Telephone No.

OIL CONSERVATION DIVISION

Date Approved

SEP 28 1989

By

Title

SUPERVISION DISTRICT #3

INSTRUCTIONS: This form is to be filed in compliance with Rule 1104

- 1) Request for allowable for newly drilled or deepened well must be accompanied by tabulation of deviation tests taken in accordance with Rule 111.
- 2) All sections of this form must be filled out for allowable on new and recompleted wells.
- 3) Fill out only Sections I, II, III, and VI for changes of operator, well name or number, transporter, or other such changes.
- 4) Separate Form C-104 must be filed for each pool in multiply completed wells.

NO. OF COPIES RECEIVED		
DISTRIBUTION		
SANTA FE		
FILE		
U.S.G.S.		
LAND OFFICE		
TRANSPORTER	OIL	
	GAS	
OPERATOR		
PRORATION OFFICE		

NEW MEXICO OIL CONSERVATION COMMISSION
REQUEST FOR ALLOWABLE
AND
AUTHORIZATION TO TRANSPORT OIL AND NATURAL GAS

Form C-104
Supersedes Old C-104 and C-110
Effective 1-1-65

RECEIVED

JAN 03 1990

OIL CON. DIV./

DIST. 3

Operator A.P.A. Development Inc.	
Address P.O. Box 215, Cortez, CO 81321	
Reason(s) for filing (Check proper box)	Other (Please explain)
New Well <input type="checkbox"/>	Change in Transporter of:
Recompletion <input type="checkbox"/>	Oil <input type="checkbox"/> Dry Gas <input type="checkbox"/>
Change in Ownership <input checked="" type="checkbox"/>	Casinghead Gas <input type="checkbox"/> Condensate <input type="checkbox"/>

If change of ownership give name and address of previous owner Texaco Inc., P.O. Box 2100, Denver, CO 80201

II. DESCRIPTION OF WELL AND LEASE

Lease Name Santa Fe Leggs	Well No. 2	Pool Name, Including Formation Leggs-Entrada	Kind of Lease State, Federal or Fee	Lease No. Fee
Location				
Unit Letter <u>N</u> : <u>990</u> Feet From The <u>South</u> Line and <u>2310</u> Feet From The <u>West</u>				
Line of Section <u>11</u> Township <u>21N</u> Range <u>10W</u> , NMPM, <u>San Juan</u> County				

III. DESIGNATION OF TRANSPORTER OF OIL AND NATURAL GAS

Name of Authorized Transporter of Oil <input checked="" type="checkbox"/> or Condensate <input type="checkbox"/>	Address (Give address to which approved copy of this form is to be sent)
Giant Refinery	P.O. Box 9156, Phoenix, AZ 85068
Name of Authorized Transporter of Casinghead Gas <input type="checkbox"/> or Dry Gas <input type="checkbox"/>	Address (Give address to which approved copy of this form is to be sent)
If well produces oil or liquids, give location of tanks.	Unit Sec. Twp. Rge. Is gas actually connected? When
	N 11 21N 10W

If this production is commingled with that from any other lease or pool, give commingling order number:

IV. COMPLETION DATA

Designate Type of Completion - (X)	Oil Well	Gas Well	New Well	Workover	Deepen	Plug Back	Same Res'v.	Diff. Res'v.
Date Spudded	Date Compl. Ready to Prod.		Total Depth		P.B.T.D.			
Elevations (DF, RKB, RT, GR, etc.)	Name of Producing Formation		Top Oil/Gas Pay		Tubing Depth			
Perforations					Depth Casing Shoe			
TUBING, CASING, AND CEMENTING RECORD								
HOLE SIZE	CASING & TUBING SIZE		DEPTH SET		SACKS CEMENT			

V. TEST DATA AND REQUEST FOR ALLOWABLE OIL WELL

(Test must be after recovery of total volume of load oil and must be equal to or exceed top allowable for this depth or be for full 24 hours)

Date First New Oil Run To Tanks	Date of Test	Producing Method (Flow, pump, gas lift, etc.)	
Length of Test	Tubing Pressure	Casing Pressure	Choke Size
Actual Prod. During Test	Oil - Bbls.	Water - Bbls.	Gas - MCF

OIL CON. DIV.

DIST. 3

GAS WELL

Actual Prod. Test - MCF/D	Length of Test	Bbls. Condensate/MCF	Gravity of Condensate
Testing Method (pilot, back pr.)	Tubing Pressure (Shut-in)	Casing Pressure (Shut-in)	Choke Size

VI. CERTIFICATE OF COMPLIANCE

I hereby certify that the rules and regulations of the Oil Conservation Commission have been complied with and that the information given above is true and complete to the best of my knowledge and belief.

Patsie B. Woolley
(Signature)
Pres. A.P.A.
(Title)
1/2/90
(Date)

OIL CONSERVATION COMMISSION

APPROVED SEP 27 1990, 19

BY

TITLE Superior District

This form SUPERIOR DISTRICT RULE 1104.

If this is a request for allowable for a newly drilled or deepened well, this form must be accompanied by a tabulation of the deviation tests taken on the well in accordance with RULE 111.

All sections of this form must be filled out completely for allowable on new and recompleted wells.

Fill out only Sections I, II, III, and VI for changes of owner, well name or number, or transporter, or other such change of condition.

Separate Forms C-104 must be filed for each pool in multiply completed wells.



STATE OF NEW MEXICO
ENERGY, MINERALS AND NATURAL RESOURCES DEPARTMENT
OIL CONSERVATION DIVISION

GARREY CARRUTHERS
GOVERNOR

September 21, 1990

POST OFFICE BOX 2088
STATE LAND OFFICE BUILDING
SANTA FE, NEW MEXICO 87504
(505) 827-5800

Santa Fe Log #2

A.P.A. Development Inc.
P. O. Box 215
Cortez, Co. 81321

Attention: Patrick B. Woosley

Re: \$7,500 One-Well Plugging Bond
A.P.A. Development, Inc., Operator
2310' FWL and 990' FSL of Sec. 11,
~ T-21-N, R-10-W, San Juan County
Bond No. OCD-246

Dear Mr. Woosley:

The Oil Conservation Division hereby approves the above-captioned one-well plugging bond effective this date.

Sincerely,

WILLIAM J. LEMAY,
Director

dr/

cc: Oil Conservation Division
Aztec, New Mexico

RECEIVED
SEP 26 1990



STATE OF NEW MEXICO
ENERGY, MINERALS and NATURAL RESOURCES DEPARTMENT
OIL CONSERVATION DIVISION
AZTEC DISTRICT OFFICE

1000 RIO BRAZOS ROAD
AZTEC, NEW MEXICO 87410
(505) 334-6178

April 22, 1992

Mr. Patrick Woosley
APA Development Inc.
P.O. Box 215
Cortez, CO 82321

WELL FILE
SANTA FE LEGGS # 2
N-11-21N-10W

RE: Santa Fe Leggs Lease

Dear Mr. Woosley:

A field inspection conducted by personnel from this office on 4-20-92 revealed that the referenced lease is in a deplorable condition. Specifically the central tank battery has run over, the fire wall is half full of oil and sludge and the tanks are covered with oil. The #1 well has a 20'x 30' unfenced pit which is full of oil and produced water, there is no well sign and the entire location is oil stained and junky. The #2 well has puddles of oil and junk on location.

You are in violation of the following rules and regulations. Rule 116 unreported oil spill at tank battery. Rule 310-B - No sign on tank battery. Rule 103 - No well sign on well #1. Migratory bird order R-8952 all pits are to be netted in accordance with the order.

You are hereby directed to immediately file a spill report and initiate clean up activity. We will reinspect the lease within the next 2 weeks. If progress has not been made toward cleanup, I will recommend that the lease be shut in until cleanup is completed.

Yours, truly,

Charles Gholson
Deputy Oil & Gas Inspector

CG/dj

xc: Bob Stoval
Operator File



**NEW MEXICO ENERGY, MINERALS
& NATURAL RESOURCES DEPARTMENT**

OIL CONSERVATION DIVISION
AZTEC DISTRICT OFFICE
AZTEC NM 87410
(505) 334-6170 FAX: (505) 334-6170
<http://emnrd.state.nm.us/ocd/District%20Aztec.htm>

GARY E. JOHNSON
GOVERNOR

Jennifer A. Salisbury
CABINET SECRETARY

November 24, 1997

Rand Carroll
EMNRD General Counsel
2040 S Pacheco
Santa Fe NM 87505

RE: APA Development Corp
Santa Fe Leggs #1, O-11-21N-10W, 30-045-22633
Santa Fe Leggs #2, N-11-21N-10W, 30-045-23027

Dear Rand:

I have enclosed a copy of the inactive well letter dated June 5, 1997, requiring the operator to submit a plan to bring the wells into compliance within 30 days. To this date, I have received no plans for these wells nor have my phone calls been returned. Please docket a case for hearing to show cause why the referenced well should not be plugged and abandoned according to a Division-approved plugging program using the OCD 246 plugging bond (\$7500 per well).

Sincerely,

Johnny Robinson
Deputy O&G Inspector

JR/sh

enc.

cc: Well files

TA file

APA Dev Corp
PO Box 215
Cortez CO 81321



**NEW MEXICO ENERGY, MINERALS
& NATURAL RESOURCES DEPARTMENT**

OIL CONSERVATION DIVISION
AZTEC DISTRICT OFFICE
1000 RIO BRAZOS ROAD
AZTEC, NEW MEXICO 87410
(505) 334-6170 Fax (505) 334-6170

GARY E. JOHNSON
GOVERNOR

JENNIFER A. SALISBURY
CABINET SECRETARY

June 5, 1997

APA Development Corp
PO Box 215
Cortez CO 81321

RE: Inactive Wells

To Whom It May Concern:

Our records indicate that the wells on the attached list are inactive and not in compliance with Rule #201.B.

Please submit plans to bring these wells into compliance within 30 days. Review Rules #202 and #203 for the necessary filing requirements to plug and abandon or temporarily abandon these wells.

Contact this office if you have any questions.

Sincerely,

Johnny Robinson
Deputy O&G Inspector

JR/sh

attachment

XC: TA File JDR File Well Files

APA DEVELOPMENT CORP

<u>API#</u>	<u>PROPERTY NAME</u>	<u>NUMBER</u>	<u>LOCATION</u>
30-045-22633	Santa Fe Leggs	1	O-11-21N-10W
30-045-23027	Santa Fe Leggs	2	N-11-21N-10W