

AMERADA HESS CORPORATION

P. O. BOX 840
SEMINOLE, TEXAS 79360
915-758-6700

November 17, 1999

Attn: Lori Wrotenbery
State of New Mexico
Energy, Minerals and Natural Resources Department
Oil Conservation Division
2040 South Pacheco Street
Santa Fe, New Mexico 87505-5472

Re: Application for Injection Permit
North Monument Grayburg San Andres Unit
Order No. R-9596

Dear Ms. Wrotenbery,

Amerada Hess Corporation respectfully request administrative amendment to Exhibit "A" of Division Order No. R-9596 on North Monument Grayburg San Andres Unit adding NMGSAU Well's No. 215 & 503 to order.

Enclosed is Form C-108 and supporting documents for your review.

If additional information is needed, please contact Mr. Chad McGehee at the above address or phone number at your earliest convenience.

Your consideration in this matter is appreciated.

Sincerely,

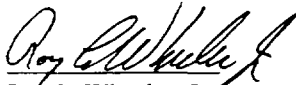
Roy L. Wheeler, Jr.

Xc: Mr. Chris Williams – NMOCD, Hobbs

BEFORE THE OIL CONSERVATION DIVISION
Santa Fe, New Mexico
Case No. 12432 Exhibit No. 9
Submitted by:
Amerada Hess Corporation
Hearing Date: October 5, 2000

APPLICATION FOR AUTHORIZATION TO INJECT

- I. PURPOSE: X Secondary Recovery _____ Pressure Maintenance _____ Disposal _____ Storage
Application qualifies for administrative approval? X Yes _____ No
- II. OPERATOR: Amerada Hess Corporation
ADDRESS: P. O. Box 840, Seminole, Texas
CONTACT PARTY: Chad McGehee PHONE: 915 758-6700
- III. WELL DATA: Complete the data required on the reverse side of this form for each well proposed for injection.
Additional sheets may be attached if necessary.
- IV. Is this an expansion of an existing project? X Yes _____ No
If yes, give the Division order number authorizing the project: R-9596
- V. Attach a map that identifies all wells and leases within two miles of any proposed injection well with a one-half mile radius circle drawn around each proposed injection well. This circle identifies the well's area of review.
- *VI. Attach a tabulation of data on all wells of public record within the area of review which penetrate the proposed injection zone. Such data shall include a description of each well's type, construction, date drilled, location, depth, record of completion, and a schematic of any plugged well illustrating all plugging detail.
- VII. Attach data on the proposed operation, including:
1. Proposed average and maximum daily rate and volume of fluids to be injected;
 2. Whether the system is open or closed;
 3. Proposed average and maximum injection pressure;
 4. Sources and an appropriate analysis of injection fluid and compatibility with the receiving formation if other than reinjected produced water; and,
 5. If injection is for disposal purposes into a zone not productive of oil or gas at or within one mile of the proposed well, attach a chemical analysis of the disposal zone formation water (may be measured or inferred from existing literature, studies, nearby wells, etc.).
- *VIII. Attach appropriate geologic data on the injection zone including appropriate lithologic detail, geologic name, thickness, and depth. Give the geologic name, and depth to bottom of all underground sources of drinking water (aquifers containing waters with total dissolved solids concentrations of 10,000 mg/l or less) overlying the proposed injection zone as well as any such sources known to be immediately underlying the injection interval.
- IX. Describe the proposed stimulation program, if any.
- *X. Attach appropriate logging and test data on the well. (If well logs have been filed with the Division, they need not be resubmitted).
- *XI. Attach a chemical analysis of fresh water from two or more fresh water wells (if available and producing) within one mile of any injection or disposal well showing location of wells and dates samples were taken.
- XII. Applicants for disposal wells must make an affirmative statement that they have examined available geologic and engineering data and find no evidence of open faults or any other hydrologic connection between the disposal zone and any underground sources of drinking water.
- XIII. Applicants must complete the "Proof of Notice" section on the reverse side of this form.
- XIV. Certification: I hereby certify that the information submitted with this application is true and correct to the best of my knowledge and belief.

NAME: Chad McGehee TITLE: Petroleum Engineer

SIGNATURE: Chad McGehee DATE: November 17, 1999

- * If the information required under Sections VI, VIII, X, and XI above has been previously submitted, it need not be resubmitted. Please show the date and circumstances of the earlier submittal: August 2, 1991, original C-108 submitted by Amerada Hess Corporation on North Monument Grayburg San Andres Unit.

DISTRIBUTION: Original and one copy to Santa Fe with one copy to the appropriate District Office

III. WELL DATA

A. The following well data must be submitted for each injection well covered by this application. The data must be both in tabular and schematic form and shall include:

- (1) Lease name; Well No.; Location by Section, Township and Range; and footage location within the section.
- (2) Each casing string used with its size, setting depth, sacks of cement used, hole size, top of cement, and how such top was determined.
- (3) A description of the tubing to be used including its size, lining material, and setting depth.
- (4) The name, model, and setting depth of the packer used or a description of any other seal system or assembly used.

Division District Offices have supplies of Well Data Sheets which may be used or which may be used as models for this purpose. Applicants for several identical wells may submit a "typical data sheet" rather than submitting the data for each well.

B. The following must be submitted for each injection well covered by this application. All items must be addressed for the initial well. Responses for additional wells need be shown only when different. Information shown on schematics need not be repeated.

- (1) The name of the injection formation and, if applicable, the field or pool name.
- (2) The injection interval and whether it is perforated or open-hole.
- (3) State if the well was drilled for injection or, if not, the original purpose of the well.
- (4) Give the depths of any other perforated intervals and detail on the sacks of cement or bridge plugs used to seal off such perforations.
- (5) Give the depth to and the name of the next higher and next lower oil or gas zone in the area of the well, if any.

XIV. PROOF OF NOTICE

All applicants must furnish proof that a copy of the application has been furnished, by certified or registered mail, to the owner of the surface of the land on which the well is to be located and to each leasehold operator within one-half mile of the well location.

Where an application is subject to administrative approval, a proof of publication must be submitted. Such proof shall consist of a copy of the legal advertisement which was published in the county in which the well is located. The contents of such advertisement must include:

- (1) The name, address, phone number, and contact party for the applicant;
- (2) The intended purpose of the injection well; with the exact location of single wells or the Section, Township, and Range location of multiple wells;
- (3) The formation name and depth with expected maximum injection rates and pressures; and,
- (4) A notation that interested parties must file objections or requests for hearing with the Oil Conservation Division, 2040 South Pacheco, Santa Fe, New Mexico 87505, within 15 days.

NO ACTION WILL BE TAKEN ON THE APPLICATION UNTIL PROPER PROOF OF NOTICE HAS BEEN SUBMITTED.

NOTICE: Surface owners or offset operators must file any objections or requests for hearing of administrative applications within 15 days from the date this application was mailed to them.

INDEX

C-108 ATTACHMENTS

Section III – Well Data , Wellbore Schematic	PAGE
North Monument Grayburg San Andres Unit Well No. 215	1 - 3
North Monument Grayburg San Andres Unit Well No. 503	4 - 6
Section V – Maps	
North Monument Grayburg San Andres Unit Map	7
North Monument Grayburg San Andres Unit Well No. 215	8
North Monument Grayburg San Andres Unit Well No. 503	9
Section VII – Data on Proposed Operation & Section IX – Stimulation	10
Section XIII & XIV – Proof of Notice	
Surface Owner Listing & Leasehold Operator Listing	11
Publication	12

Note: Item Nos. VI, VIII, & XI were submitted with original C-108 filed August 2, 1991

Item No. X – Logs & test data have previously been submitted.

INJECTION WELL DATA SHEET

OPERATOR: Amerada Hess Corporation

WELL NAME & NUMBER: North Monument Grayburg San Andres Unit Blk. 2, Well 15 (API No. 30-025-05634, Fed. Lsc. No. LC-30475)

WELL LOCATION: 660' FSL & 1980' FEL O 18-19S-37E

FOOTAGE LOCATION UNIT LETTER SECTION TOWNSHIP RANGE

WELLBORE SCHEMATIC

WELL CONSTRUCTION DATA

Surface Casing

Hole Size: 17-1/2" Casing Size: 15-1/2" 70# @254'

Cemented with: 250 sx. Or _____ ft³

Top of Cement: Surface Method Determined: Circulated

Intermediate Casing

Hole Size: 14-3/4" Casing Size: 9-5/8" 40# @1368'

Cemented with: 800 sx. Or _____ ft³

Top of Cement: Surface Method Determined: Circulated

Production Casing

Hole Size: 8-5/8" Casing Size: 7" 24# @3875'

Cemented with: 400 sx. Or _____ ft³

Top of Cement: 1675' Method Determined: Calculated

Total Depth: 4000'

Injection Interval

Perforations fr. 3810' - 3863' & Open Hole fr. 3875' - 4000'

(Perforated or Open Hole; indicate which)

INJECTION WELL DATA SHEETTubing Size: 2-3/8"Lining Material: PolyethyleneType of Packer: 7" Arrowset 1-XSPacker Setting Depth: 3760'

Other Type of Tubing/Casing Seal (if applicable): _____

Additional Data

1. Is this a new well drilled for injection? Yes X No

If no, for what purpose was the well originally drilled? Grayburg San Andres Producer

2. Name of the Injection Formation: Grayburg San Andres

3. Name of Field or Pool (if applicable): Eunice Monument Grayburg San Andres

4. Has the well ever been perforated in any other zone(s)? List all such perforated intervals and give plugging detail, i.e. sacks of cement or plug(s) used. No

5. Give the name and depths of any oil or gas zones underlying or overlying the proposed injection zone in this area: _____

Higher Gas Zone – Eunmont at +/- 3600'

Lower Oil Zone – Paddock at +/- 4900'

Name: 3002505634
Date: 19990707
NMGSAU #215
660' FSL, 1980' FEL,
SEC. 18, T19S, R37E

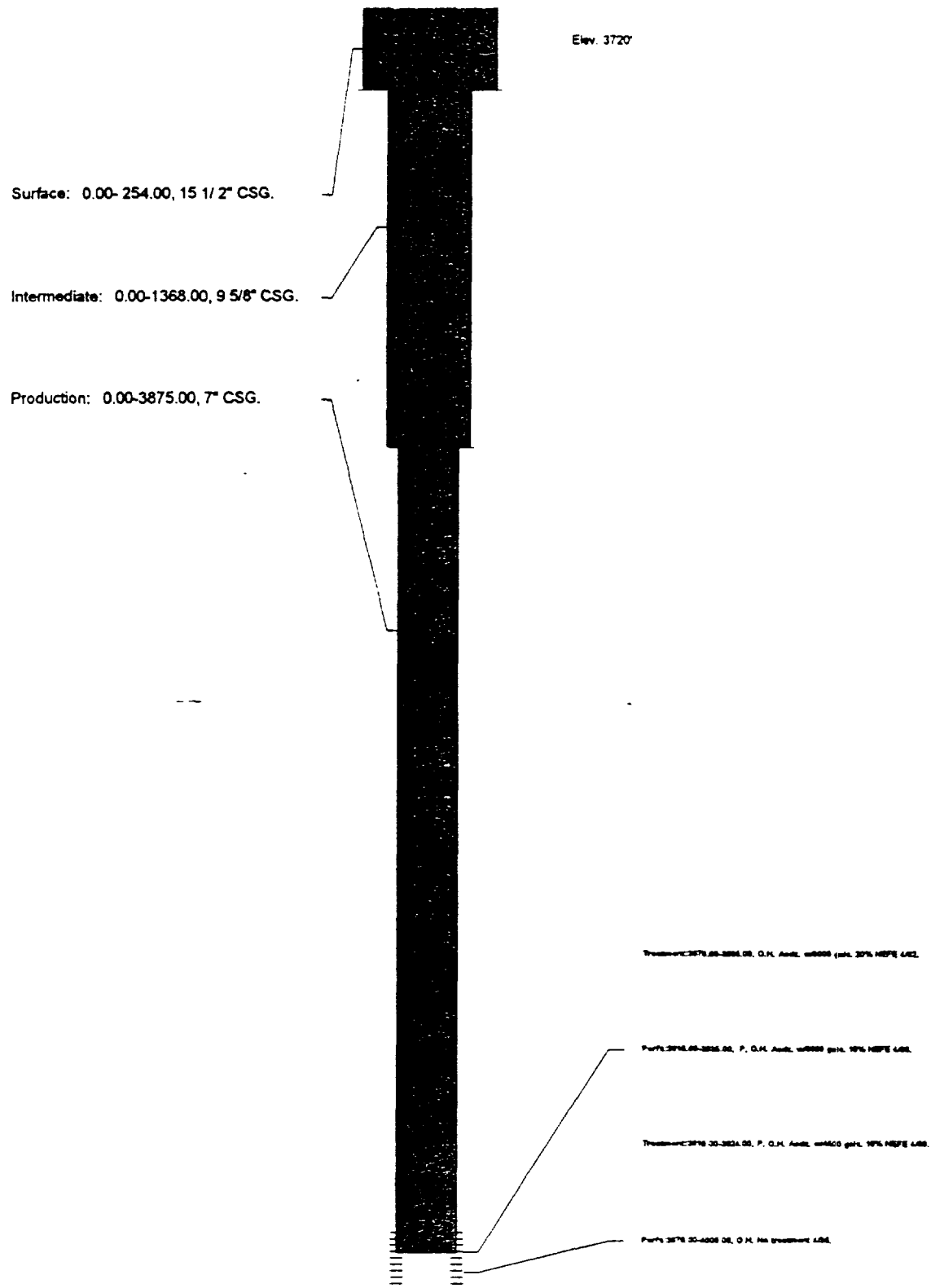

INJECTION WELL DATA SHEET

OPERATOR: Amerada Hess Corporation

WELL NAME & NUMBER: North Monument Grayburg San Andres Unit Blk. 5, Well 3 (API No. 30-025-05641)

WELL LOCATION: 660' FNL. & 1980' FWL C 19-19S-37E
FOOTAGE LOCATION UNIT LETTER SECTION TOWNSHIP RANGE

WELLBORE SCHEMATIC

WELL CONSTRUCTION DATA

Surface Casing

Hole Size: 15" Casing Size: 13" 50# @ 241'

Cemented with: 225 sx. or ft³

Top of Cement: Surface Method Determined: Calculated

Intermediate Casing

Hole Size: 12-1/4" Casing Size: 9-5/8" 36# @ 2512'

Cemented with: 875 sx. Or ft³

Top of Cement: Surface Method Determined: Calculated

Production Casing

Hole Size: 8-5/8" Casing Size: 7" 24# @ 3760'

Cemented with: 150 sx. Or ft³

Top of Cement: 2330' Method Determined: Calculated

Total Depth: 3970' PBD: 3864'

Liner

*4-1/2" Liner fr. 3530' - 3954', Cml. w/50 Sx. Top of cml. At 3530' - Calculated.

Injection Interval

Perforations fr. 3766 feet To 3864 feet

(Perforated or Open Hole; indicate which)

Lining Material: Polyethylene

Other Type of Tubing/Casing Seal (if applicable): _____

1. Is this a new well drilled for injection? : Yes X No

2. Name of the Injection Formation: Grayburg San Andres

4. Has the well ever been perforated in any other zone(s)? List all such perforated intervals and give plugging detail, i.e. sacks of cement or plug(s) used. _____

5. Give the name and depths of any oil or gas zones underlying or overlying the proposed injection zone in this area: _____

Lower Oil Zone - Paddock at +/- 4900'

Name: 3002505641
Date: 19990714
NMGSAU # 503
SEC. 19, T19S, R37E

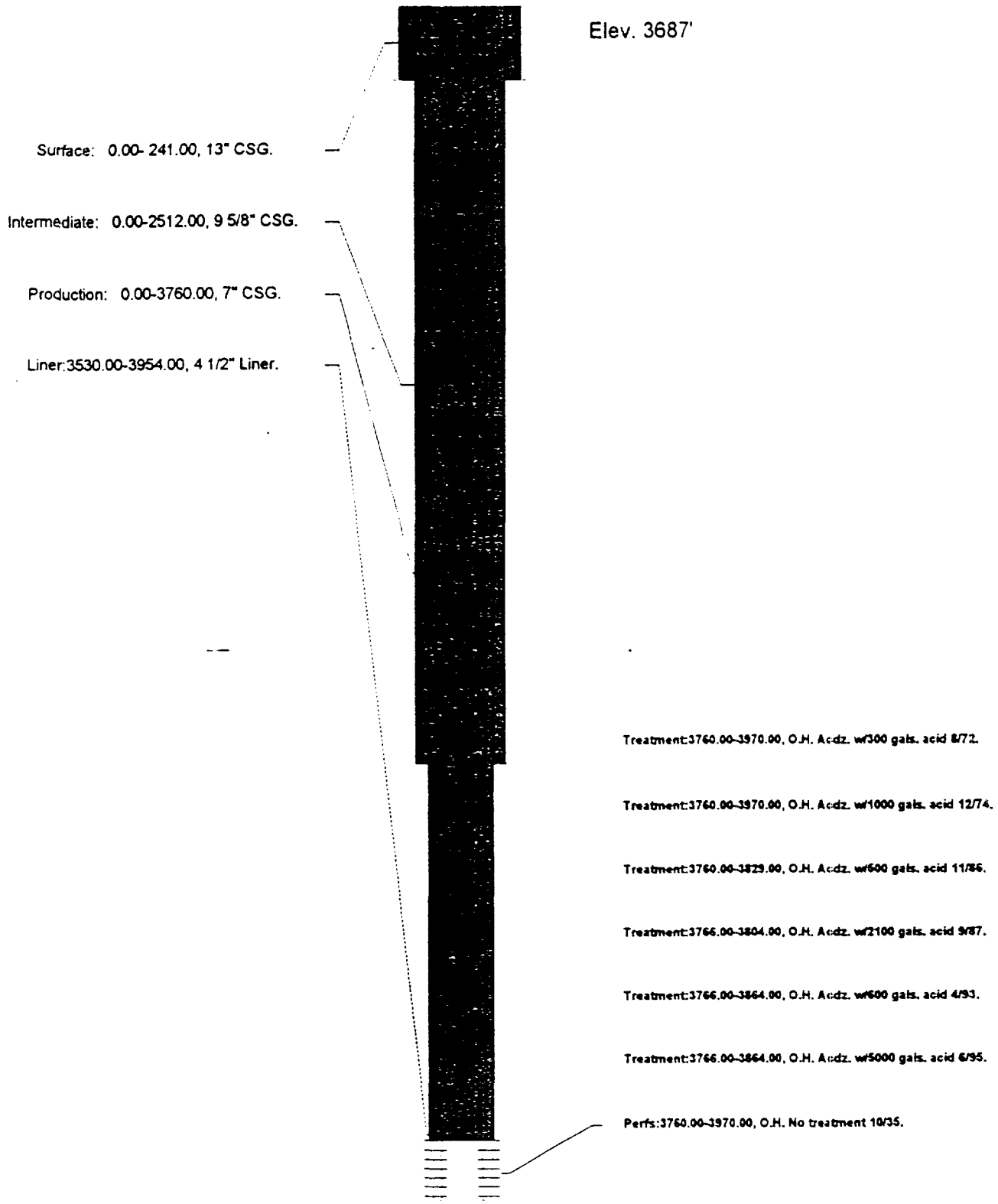

North Monument Grayburg/San Andres Unit

0 5,139 10,278

FEET

POSTED WELL DATA

Well Number

WELL SYMBOLS

- Abandoned Gas
- Gas (Non-Unit)
- Oil Well
- Location Only
- Abandoned Oil
- Injection Well
- Temp Abandoned
- Plugged and Abandoned
- Service Well
- Gas Well

November 9, 1999 8:27 AM

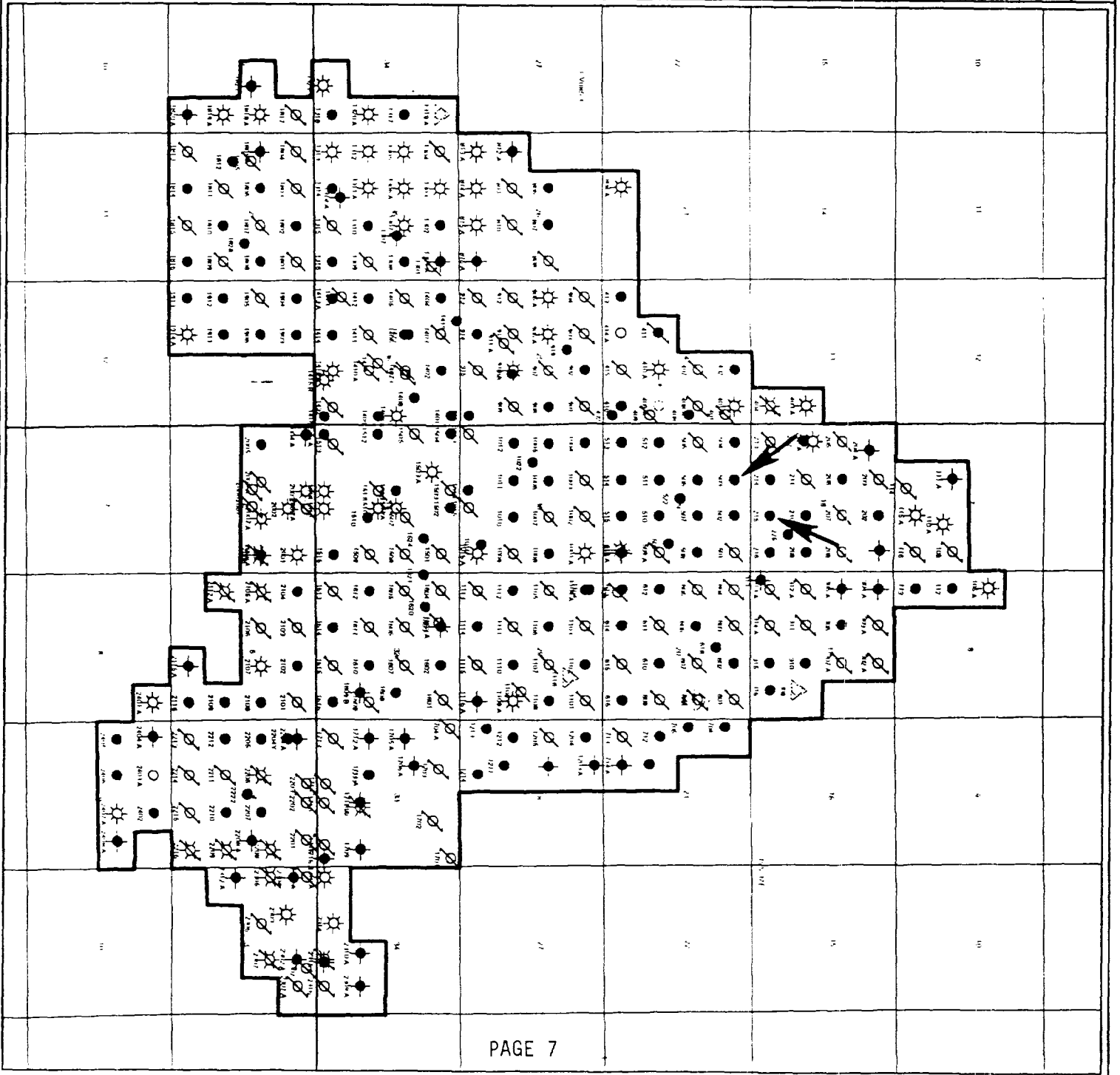

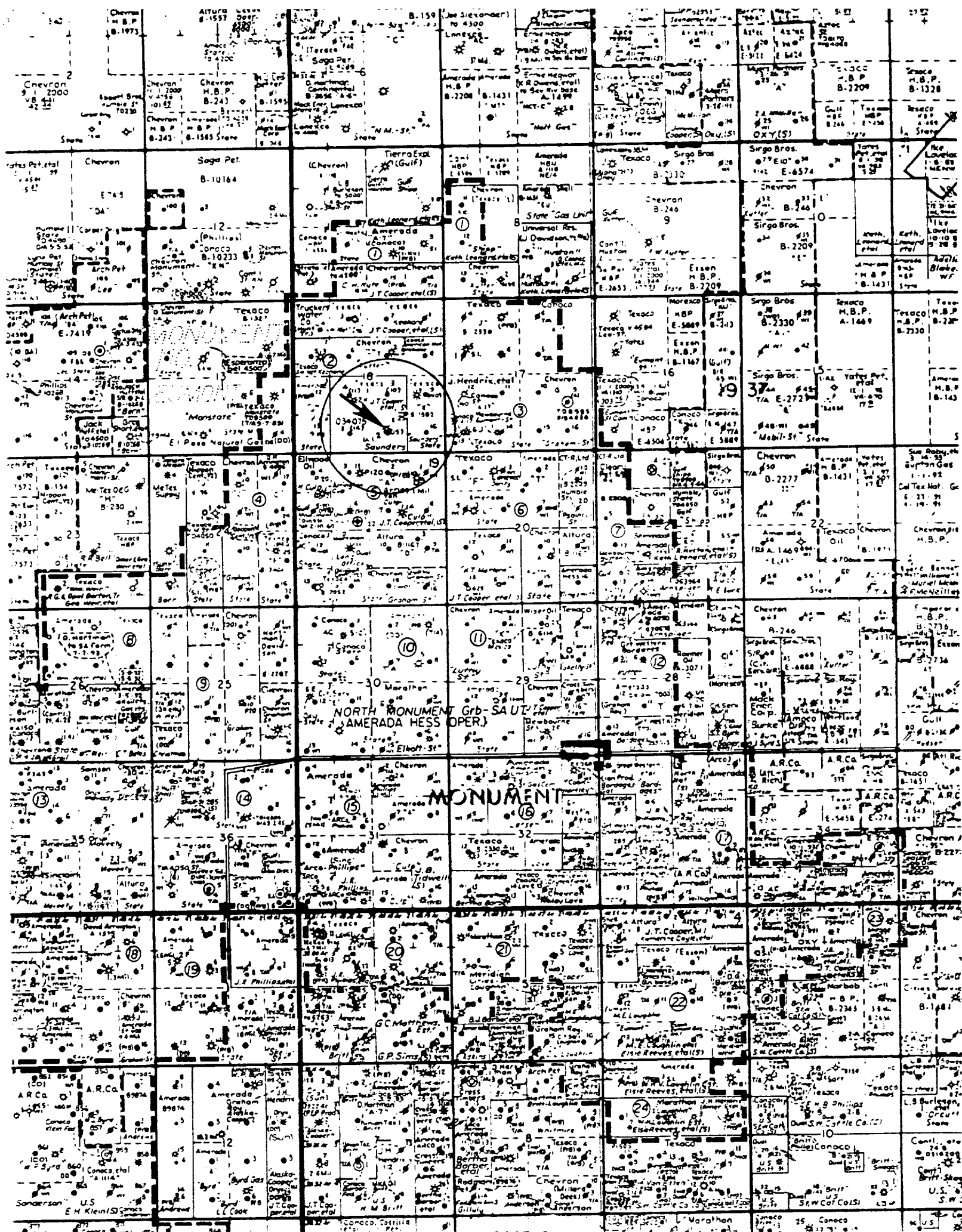

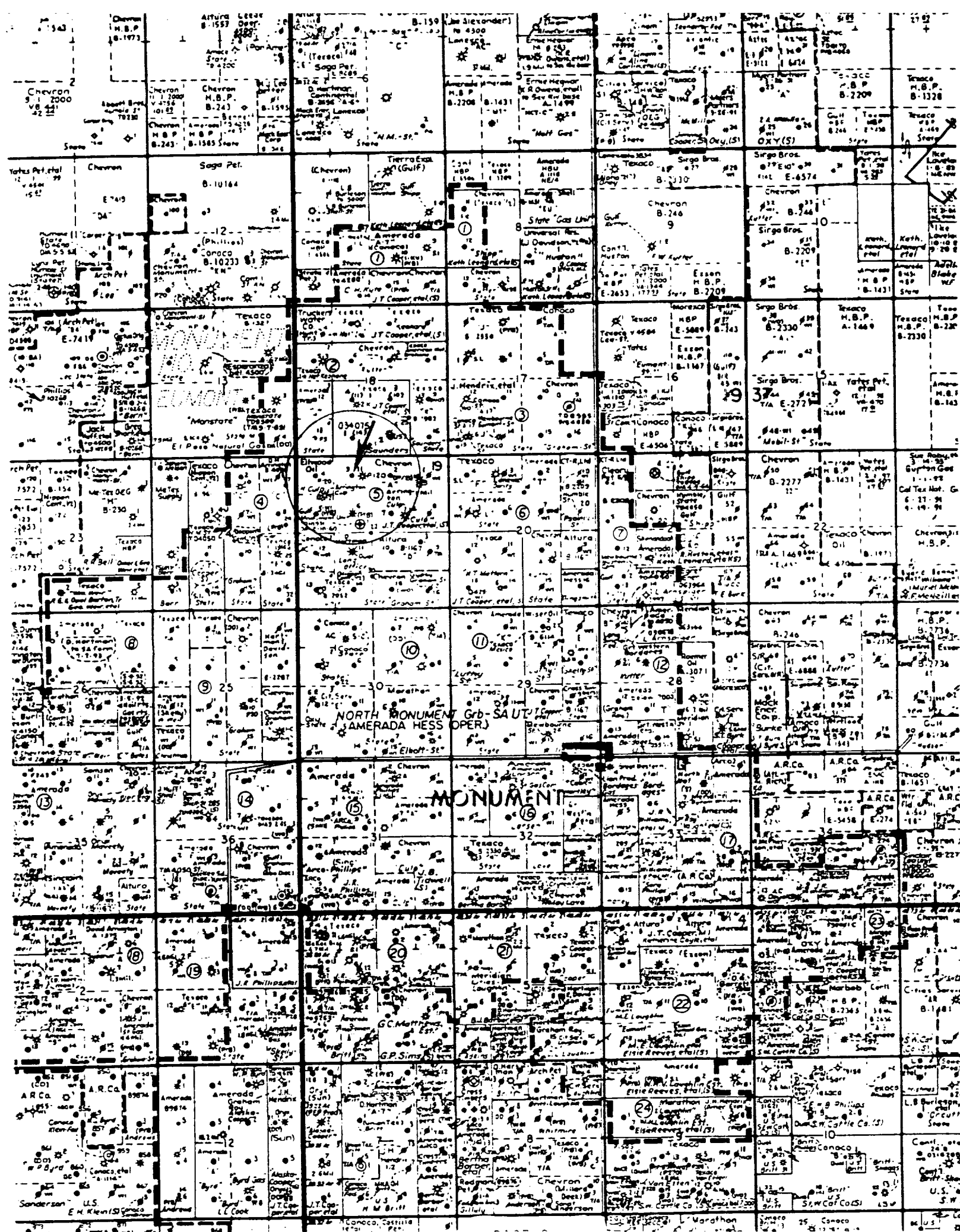

C-108 ATTACHMENT

A. Section VII – Data on Proposed Operation

1. Proposed Average & Maximum Daily Rate and Volume of Fluids to be Injected:

Average Daily Rate: 750 B.W./D.
Maximum Daily Rate: 1000 B.W./D.

The injection volume is expected to reach 196,000,000 barrels of water at 100% Fillup. This volume may reach 620,000,000 barrels of water by abandonment.

2. Open or Closed System:

Injection system is a closed system.

3. Proposed Average & Maximum* Injection Pressures:

Average injection pressure: 350 PSI
Maximum injection pressure: 710 PSI

*Until a fracture gradient is determined, maximum injection pressure will be based on a .2 PSI/foot gradient.

4. Sources of Appropriate Analysis of Injection Fluid:

The source of injection water will be from San Andres water supply wells and produced water from existing North Monument Grayburg San Andres Unit producers. The San Andres formation is compatible with the produced water from the unit wells.

B. Section IX. Proposed Stimulation Program:

1. NMGSAU Well No. 215

Acidize w/2000 gal. 15% NEFE acid.

2. NMGSAU Well No. 503

Acidize w/2000 gal. 15% NEFE acid.

C-108 ATTACHMENT

A. Sections VIII & XIV – Proof of Notice.

1. Surface Owners – Application mailed by Certified Mail to following:
 - United States Department of the Interior
Bureau of Land Management
2909 West Second Street
Roswell, New Mexico 88201
 - Jimmie T. Cooper
P. O. Box 55
Monument, New Mexico 88265
2. Leasehold Operators within ½ mile of proposed injection wells – application mailed by Certified Mail to following:
 - Altura Energy, LTD
P. O. Box 4294
Houston, Texas 77210
 - Arrington, David H., Oil & Gas, Inc.
P. O. Box 2071
Midland, Texas 79702
 - Chevron U.S.A., Inc.
Claydesta Plaza, 15 Smith Road
Midland, Texas 79705
 - Conoco, Inc.
10 Desta Drive, Ste. 100W
Midland, Texas 79705
 - Gruy Petroleum Management Co.
P. O. Box 140907
Irving, Texas 75014
 - Doyle Hartman
500 N. Main
Midland, Texas 79701
 - Magnum Hunter Production, Inc.
P. O. Box 140907
Irving, Texas 75014
 - Phillips Petroleum Co.
4001 Penbrook Street
Odessa, Texas 79762
 - Texaco Exploration & Production, Inc.
205 E. Bender
Hobbs, New Mexico 88240
3. Publication – (Attached)

AFFIDAVIT OF PUBLICATION

State of New Mexico,
County of Lea.

I, KATHI BEARDEN

Publisher

of the Hobbs News-Sun, a
newspaper published at
Hobbs, New Mexico, do solemnly
swear that the clipping attached
hereto was published once a
week in the regular and entire
issue of said paper, and not a
supplement thereof for a period.

of 1

 weeks.

Beginning with the issue dated

November 14 1999

and ending with the issue dated

November 14 1999

Kathi Bearden

Publisher

Sworn and subscribed to before

me this 15th day of

November 1999

Jodi Benson

Notary Public.

My Commission expires
October 18, 2000
(Seal)

This newspaper is duly qualified
to publish legal notices or adver-
tisements within the meaning of
Section 3, Chapter 167, Laws of
1937, and payment of fees for
said publication has been made.

LEGAL NOTICE

November 14, 1999

Amerada Hess Corporation,
operator of record for the
North Monument Grayburg
San Andres Unit, (NMGSAU),
hereby notifies of their desire
to inject water into the follow-
ing two wells: NMGSAU Well
No. 215, located in Unit O,
Sec. 18, T19S, R37E, and
NMGSAU Well No. 503, locat-
ed in Unit C, Sec. 19, T19S,
R37E, Lea County, N.M. The
NMGSAU "Authorization to In-
ject" is covered under State of
New Mexico, Energy Minerals
and Natural Resources De-
partment, Oil Conservation
Division Case No. 10252, Di-
vision Order No. R-9596
Amerada Hess Corporation
hereby gives notice that appli-
cation has been made for ad-
ministrative regulatory
amendment of Exhibit "A" of
said division order to include
the aforementioned wells to
inject water into Grayburg
San Andres formation, Eunice
Monument Grayburg San An-
dres pool through the gross
perforated and/or open hole
interval from approximately
3720 feet to 3965 feet with a
maximum injection pressure
of 710 PSI.

Contact Mr. Chad McGehee,
Amerada Hess Corporation,
P.O. Box 840, Seminole,
Texas 79360, Phone 915-
758-6700 concerning ques-
tions regarding application.
Objections or requests for
hearing concerning this appli-
cation should be filed with the
State of New Mexico, Energy,
Minerals and Natural Resour-
ces Department, Oil Conser-
vation Division, 2040 South
Pacheco Street, Santa Fe,
New Mexico 87505-5472
within 15 days of publication.
#16989

01100986000

02532881

AMERADA HESS CORPORATION
PO BOX 840
SEMINOLE, TX 79360

AMERADA HESS CORPORATION

P. O. BOX 840
SEMINOLE, TEXAS 79360
915-758-6700

November 17, 1999

Altura Energy, LTD
P. O. Box 4294
Houston, Texas 77210

Re: Application for injection Permit
North Monument Grayburg San Andres Unit
Lea County, New Mexico

Dear Sir,

Enclosed, for your information, is a copy of Form C-108 and supporting documents filed with State of New Mexico Oil Conservation Division requesting administrative approval to add North Monument Grayburg San Andres Unit Well No's. 215 & 503 as water injection wells in unit.

If additional information is needed, please let us know at your earliest convenience.

Sincerely,

Roy L. Wheeler, Jr.

AMERADA HESS CORPORATION

P. O. BOX 840
SEMINOLE, TEXAS 79360
915-758-6700

November 17, 1999

Arrington, David H., Oil & Gas, Inc.
P. O. Box 2071
Midland, Texas 79702

Re: Application for injection Permit
North Monument Grayburg San Andres Unit
Lea County, New Mexico

Dear Sir,

Enclosed, for your information, is a copy of Form C-108 and supporting documents filed with State of New Mexico Oil Conservation Division requesting administrative approval to add North Monument Grayburg San Andres Unit Well No's. 215 & 503 as water injection wells in unit.

If additional information is needed, please let us know at your earliest convenience.

Sincerely,



Roy L. Wheeler, Jr.

AMERADA HESS CORPORATION

P. O. BOX 840
SEMINOLE, TEXAS 79360
915-758-6700

November 17, 1999

Chevron U.S.A., Inc.
Claydesta Plaza, 15 Smith Road
Midland, Texas 79705

Re: Application for injection Permit
North Monument Grayburg San Andres Unit
Lea County, New Mexico

Dear Sir,

Enclosed, for your information, is a copy of Form C-108 and supporting documents filed with State of New Mexico Oil Conservation Division requesting administrative approval to add North Monument Grayburg San Andres Unit Well No's. 215 & 503 as water injection wells in unit.

If additional information is needed, please let us know at your earliest convenience.

Sincerely,



Roy L. Wheeler, Jr.

AMERADA HESS CORPORATION

P. O. BOX 840
SEMINOLE, TEXAS 79360
915-758-6700

November 17, 1999

Conoco, Inc.
10 Desta Drive, Ste. 100W
Midland, Texas 79705

Re: Application for injection Permit
North Monument Grayburg San Andres Unit
Lea County, New Mexico

Dear Sir,

Enclosed, for your information, is a copy of Form C-108 and supporting documents filed with State of New Mexico Oil Conservation Division requesting administrative approval to add North Monument Grayburg San Andres Unit Well No's. 215 & 503 as water injection wells in unit.

If additional information is needed, please let us know at your earliest convenience.

Sincerely,

Roy L. Wheeler, Jr.

AMERADA HESS CORPORATION

P. O. BOX 840
SEMINOLE, TEXAS 79360
915-758-6700

November 17, 1999

Gruy Petroleum Management Co.
P. O. Box 140907
Irving, Texas 75014

Re: Application for injection Permit
North Monument Grayburg San Andres Unit
Lea County, New Mexico

Dear Sir,

Enclosed, for your information, is a copy of Form C-108 and supporting documents filed with State of New Mexico Oil Conservation Division requesting administrative approval to add North Monument Grayburg San Andres Unit Well No's. 215 & 503 as water injection wells in unit.

If additional information is needed, please let us know at your earliest convenience.

Sincerely,

Roy L. Wheeler, Jr.

AMERADA HESS CORPORATION

P. O. BOX 840
SEMINOLE, TEXAS 79360
915-758-6700

November 17, 1999

Doyle Hartman
500 N. Main
Midland, Texas 79701

Re: Application for injection Permit
North Monument Grayburg San Andres Unit
Lea County, New Mexico

Dear Sir,

Enclosed, for your information, is a copy of Form C-108 and supporting documents filed with State of New Mexico Oil Conservation Division requesting administrative approval to add North Monument Grayburg San Andres Unit Well No's. 215 & 503 as water injection wells in unit.

If additional information is needed, please let us know at your earliest convenience.

Sincerely,

Roy L. Wheeler, Jr.

AMERADA HESS CORPORATION

P. O. BOX 840
SEMINOLE, TEXAS 79360
915-758-6700

November 17, 1999

Magnum Hunter Production, Inc.
P. O. Box 140907
Irving, Texas 75014

Re: Application for injection Permit
North Monument Grayburg San Andres Unit
Lea County, New Mexico

Dear Sir,

Enclosed, for your information, is a copy of Form C-108 and supporting documents filed with State of New Mexico Oil Conservation Division requesting administrative approval to add North Monument Grayburg San Andres Unit Well No's. 215 & 503 as water injection wells in unit.

If additional information is needed, please let us know at your earliest convenience.

Sincerely,



Roy L. Wheeler, Jr.

AMERADA HESS CORPORATION

P. O. BOX 840
SEMINOLE, TEXAS 79360
915-758-6700

November 17, 1999

Phillips Petroleum Co.
4001 Penbrook Street
Odessa, Texas 79762

Re: Application for injection Permit
North Monument Grayburg San Andres Unit
Lea County, New Mexico

Dear Sir,

Enclosed, for your information, is a copy of Form C-108 and supporting documents filed with State of New Mexico Oil Conservation Division requesting administrative approval to add North Monument Grayburg San Andres Unit Well No's. 215 & 503 as water injection wells in unit.

If additional information is needed, please let us know at your earliest convenience.

Sincerely,

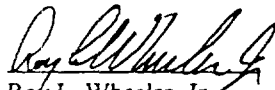
Roy L. Wheeler, Jr.

AMERADA HESS CORPORATION

P. O. BOX 840
SEMINOLE, TEXAS 79360
915-758-6700

November 17, 1999

Texaco Exploration & Production, Inc.
205 E. Bender
Hobbs, New Mexico 88240

Re: Application for injection Permit
North Monument Grayburg San Andres Unit
Lea County, New Mexico

Dear Sir,

Enclosed, for your information, is a copy of Form C-108 and supporting documents filed with State of New Mexico Oil Conservation Division requesting administrative approval to add North Monument Grayburg San Andres Unit Well No's. 215 & 503 as water injection wells in unit.

If additional information is needed, please let us know at your earliest convenience.

Sincerely,



Roy L. Wheeler, Jr.

AMERADA HESS CORPORATION

P. O. BOX 840
SEMINOLE, TEXAS 79360
915-758-6700

November 17, 1999

Mr. Jimmie T. Cooper
P. O. Box 55
Monument, New Mexico 88265

Re: Application for injection Permit
North Monument Grayburg San Andres Unit
Lea County, New Mexcio

Dear Mr. Cooper,

Enclosed, for your information, is a copy of Form C-108 and supporting documents filed with State of New Mexico Oil Conservation Division requesting administrative approval to add North Monument Grayburg San Andres Unit Well No's. 215 & 503 as water injection wells in unit.

If additional information is needed, please let us know at your earliest convenience.

Sincerely,

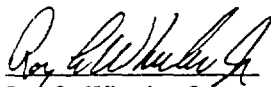
Roy L. Wheeler, Jr.

AMERADA HESS CORPORATION

P. O. BOX 840
SEMINOLE, TEXAS 79360
915-758-6700

November 17, 1999

United States Department of the Interior
Bureau of Land Management
2909 West Second Street
Roswell, New Mexico 88201

Re: Application for injection Permit
 North Monument Grayburg San Andres Unit
 Lea County, New Mexico

Dear Sir,

Enclosed, for your information, is a copy of Form C-108 and supporting documents filed with State of New Mexico Oil Conservation Division requesting administrative approval to add North Monument Grayburg San Andres Unit Well No's. 215 & 503 as water injection wells in unit.

If additional information is needed, please let us know at your earliest convenience.

Sincerely,

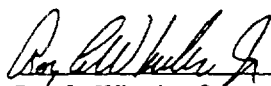
Rdy L. Wheeler, Jr.

Z 437 801 846

US Postal Service

Receipt for Certified Mail

No Insurance Coverage Provided.

Do not use for International Mail (See reverse)

Sent to	
ALTEra Energy, LTD.	
Street & Number	
P.O. Box 4294	
Post Office, State, & ZIP Code	
New York, Texas 77210	
Postage	\$.99
Certified Fee	1.40
Special Delivery Fee	
Restricted Delivery Fee	
Return Receipt Showing to Whom & Date Delivered	
Return Receipt Showing to Whom, Date, & Addressee's Address	
TOTAL Postage & Fees	\$ 2.39
Postmark or Date	

PS Form 3800, April 1995

Z 437 801 845

US Postal Service

Receipt for Certified Mail

No Insurance Coverage Provided.

Do not use for International Mail (See reverse)

Sent to	
Jimmie T. Cooper	
Street & Number	
P.O. Box 55	
Post Office, State, & ZIP Code	
MORRIS, N.M. 88265	
Postage	\$.99
Certified Fee	1.40
Special Delivery Fee	
Restricted Delivery Fee	
Return Receipt Showing to Whom & Date Delivered	
Return Receipt Showing to Whom, Date, & Addressee's Address	
TOTAL Postage & Fees	\$ 2.39
Postmark or Date	

US Postal Service

Receipt for Certified Mail

No Insurance Coverage Provided.

Do not use for International Mail (See reverse)

Sent to	
United States Dept. of the Interior	
Street & Number	
2909 West Second Street	
Post Office, State, & ZIP Code	
ROSWELL, N.M. 88201	
Postage	\$.99
Certified Fee	1.40
Special Delivery Fee	
Restricted Delivery Fee	
Return Receipt Showing to Whom & Date Delivered	
Return Receipt Showing to Whom, Date, & Addressee's Address	
TOTAL Postage & Fees	\$ 2.39
Postmark or Date	

PS Form 3800, April 1995

Z 437 801 872

US Postal Service

Receipt for Certified Mail

No Insurance Coverage Provided.

Do not use for International Mail (See reverse)

Sent to	
Conoco, Inc.	
Street & Number	
10 Delta Drive, Ste. 100W	
Post Office, State, & ZIP Code	
Midland, TX 79705	
Postage	\$.99
Certified Fee	1.40
Special Delivery Fee	
Restricted Delivery Fee	
Return Receipt Showing to Whom & Date Delivered	
Return Receipt Showing to Whom, Date, & Addressee's Address	
TOTAL Postage & Fees	\$ 2.39
Postmark or Date	

PS Form 3800, April 1995

Z 437 801 871

US Postal Service

Receipt for Certified Mail

No Insurance Coverage Provided.

Do not use for International Mail (See reverse)

Sent to	
Chevron U.S.A., Inc.	
Street & Number	
Clayton Plaza, 15 South Rd.	
Post Office, State, & ZIP Code	
Midland, TX 79705	
Postage	\$.99
Certified Fee	1.40
Special Delivery Fee	
Restricted Delivery Fee	
Return Receipt Showing to Whom & Date Delivered	
Return Receipt Showing to Whom, Date, & Addressee's Address	
TOTAL Postage & Fees	\$ 2.39
Postmark or Date	

US Postal Service

Receipt for Certified Mail

No Insurance Coverage Provided.

Do not use for International Mail (See reverse)

Sent to	
Arrington, David H. OEG	
Street & Number	
P.O. Box 2071	
Post Office, State, & ZIP Code	
Midland, TX 79702	
Postage	\$.99
Certified Fee	1.40
Special Delivery Fee	
Restricted Delivery Fee	
Return Receipt Showing to Whom & Date Delivered	
Return Receipt Showing to Whom, Date, & Addressee's Address	
TOTAL Postage & Fees	\$ 2.39
Postmark or Date	

PS Form 3800, April 1995

Z 437 801 875

US Postal Service

Receipt for Certified Mail

No Insurance Coverage Provided.

Do not use for International Mail (See reverse)

Sent to	
Magnum Hunter Prod. Inc.	
Street & Number	
P.O. Box 140907	
Post Office, State, & ZIP Code	
Irving, Texas 75014	
Postage	\$ 21.99
Certified Fee	1.40
Special Delivery Fee	
Restricted Delivery Fee	
Return Receipt Showing to Whom & Date Delivered	
Return Receipt Showing to Whom, Date, & Addressee's Address	
TOTAL Postage & Fees	\$ 2.17
Postmark or Date	2.39

PS Form 3800, April 1995

Z 437 801 874

US Postal Service

Receipt for Certified Mail

No Insurance Coverage Provided.

Do not use for International Mail (See reverse)

Sent to	
Day Le Har Tman	
Street & Number	
500 N. Main	
Post Office, State, & ZIP Code	
Midland, Tx. 79701	
Postage	\$ 21.99
Certified Fee	1.40
Special Delivery Fee	
Restricted Delivery Fee	
Return Receipt Showing to Whom & Date Delivered	
Return Receipt Showing to Whom, Date, & Addressee's Address	
TOTAL Postage & Fees	\$ 2.17
Postmark or Date	2.39

PS Form 3800, April 1995

Z 437 801 873

US Postal Service

Receipt for Certified Mail

No Insurance Coverage Provided.

Do not use for International Mail (See reverse)

Sent to	
Grung Petroleum Mgt. Co.	
Street & Number	
P.O. Box 140907	
Post Office, State, & ZIP Code	
Irving, TX. 75014	
Postage	\$.99
Certified Fee	1.40
Special Delivery Fee	
Restricted Delivery Fee	
Return Receipt Showing to Whom & Date Delivered	
Return Receipt Showing to Whom, Date, & Addressee's Address	
TOTAL Postage & Fees	\$ 2.39
Postmark or Date	

PS Form 3800, April 1995

Z 437 801 902

US Postal Service

Receipt for Certified Mail

No Insurance Coverage Provided.

Do not use for International Mail (See reverse)

Sent to	
Texaco Expl. & Prod. Inc.	
Street & Number	
205 E. Bender	
Post Office, State, & ZIP Code	
Abo, N.M. 88240	
Postage	\$.99
Certified Fee	1.40
Special Delivery Fee	
Restricted Delivery Fee	
Return Receipt Showing to Whom & Date Delivered	
Return Receipt Showing to Whom, Date, & Addressee's Address	
TOTAL Postage & Fees	\$ 2.39
Postmark or Date	

PS Form 3800, April 1995

Z 437 801 901

US Postal Service

Receipt for Certified Mail

No Insurance Coverage Provided.

Do not use for International Mail (See reverse)

Sent to	
Phillips Petroleum Co.	
Street & Number	
4001 Pembroke Street	
Post Office, State, & ZIP Code	
Odessa, Texas 79762	
Postage	99\$.21
Certified Fee	1.40
Special Delivery Fee	
Restricted Delivery Fee	
Return Receipt Showing to Whom & Date Delivered	
Return Receipt Showing to Whom, Date, & Addressee's Address	
TOTAL Postage & Fees	\$ 2.17
Postmark or Date	2.39

PS Form 3800, April 1995