

Mary State "12" Com No. 1 Ownership Map

**Plat of Proposed Communitized Area covering the East Half
(E/2) of Section 12, Township 21 South, Range 34 East
Lea County, New Mexico.**

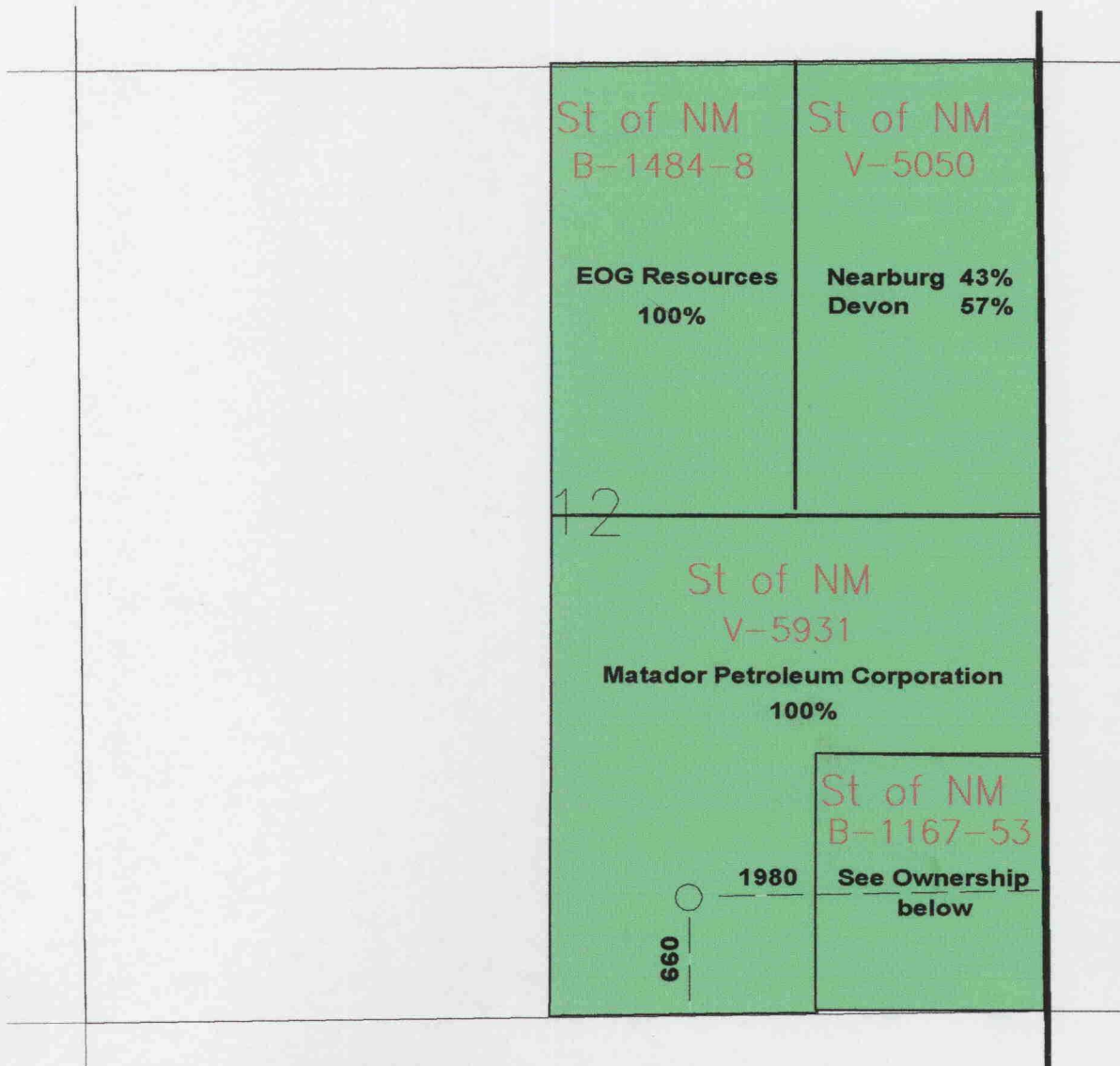

UNIT OUTLINE = E/2 SECTION

ST of NM B-1167-53

EOG Resources, Inc. 50%
Matador Petroleum Corporation 31.25%
Parks & Luttrell Energy, Inc. 7.5%
Asher Fund 1990 Ltd., a Texas limited partnership 11.25%

BEFORE THE
OIL CONSERVATION DIVISION
Case No. 12519 Exhibit No. 1
Submitted By:
Matador Petroleum Corp.
Hearing Date: October 19, 2000