

KELLAHIN AND KELLAHIN

ATTORNEYS AT LAW

EL PATIO BUILDING

117 NORTH GUADALUPE

POST OFFICE BOX 2265

SANTA FE, NEW MEXICO 87504-2265

TELEPHONE (505) 982-4285
TELEFAX (505) 982-2047

W. THOMAS KELLAHIN*

*NEW MEXICO BOARD OF LEGAL SPECIALIZATION
RECOGNIZED SPECIALIST IN THE AREA OF
NATURAL RESOURCES-OIL AND GAS LAW

JASON KELLAHIN (RETIRED 1991)

February 26, 2002

HAND DELIVERED

Ms. Lori Wrotenbery, Director
Oil Conservation Division
1220 South Saint Francis Drive
Santa Fe, New Mexico 87505

Case 12836

CEFE26 FM 1:24

Re: Quinn Well No. 339-R
W/2 Section 20, T31N, R8W, NMPM
Application of Burlington Resources Oil & Gas Company, P. L.
for an Unorthodox Gas Well Location,
Rio Arriba County, New Mexico

Dear Ms. Wrotenbery:

On behalf of Burlington Resources Oil & Gas Company, L.P. please find enclosed our application for an unorthodox (off-Pattern) Coal gas well location which we request be set for hearing on the next available Examiner's docket now scheduled for March 21, 2002. Also enclosed is our proposed notice for the advertisement.

Very truly yours,



W. Thomas Kellahin

cc: Burlington Resources Oil & Gas Company L. P.
Attn: Alan Alexander

Case 12836: Application of Burlington Resources Oil & Gas Company, L. P. for an unorthodox gas well location, San Juan County, New Mexico. Applicant seeks approval to drill its proposed Quinn Well No. 339-R at an unorthodox gas well (off-pattern) location 770 feet from the North line and 725 feet from the West line (Unit D) of Section 20, Township 31 North, Range 8 West, NMPM, said location being unorthodox for any and all gas production from the Basin Fruitland Coal Gas Pool and, if productive, to be dedicated to a standard 320-acre gas spacing and proration unit consisting of the W/2 of said Section 20. Said location is located approximately 9 miles north northwest from the Navajo Dam spillway

STATE OF NEW MEXICO
ENERGY, MINERALS AND NATURAL RESOURCES DEPARTMENT
OIL CONSERVATION DIVISION

**IN THE MATTER OF THE APPLICATION OF
BURLINGTON RESOURCES OIL & GAS COMPANY, L.P.
FOR AN UNORTHODOX GAS WELL,
SAN JUAN COUNTY, NEW MEXICO**

CASE: 12836

APPLICATION

Comes now BURLINGTON RESOURCES OIL & GAS COMPANY, LP ("Burlington") by and through its attorneys, KELLAHIN and KELLAHIN, and applies to the New Mexico Oil Conservation Division ("NMOCD") for approval to drill its proposed Quinn Well No. 339-R at an unorthodox gas well (off-pattern) location 770 feet from the north line and 725 feet from the West line (Unit D) of Section 20, Township 31 North, Range 8 West, NMPM, said location being unorthodox for any and all gas production from the Basin Fruitland Coal Gas Pool and, if productive, to be dedicated to a standard 320-acre gas spacing and proration unit consisting of the W/2 of said Section 20.

In support thereof, Applicant states:

1. Burlington is the proposes operator for the Quinn Well No. 339-R to be drilled at an unorthodox gas well (off-pattern) location 770 feet from the north line and 725 feet from the west line (Unit D) of Section 20, Township 31 North, Range 8 West, NMPM. See Exhibit "A".
2. Burlington proposes to drill Well 339 R to a depth sufficient to test for gas production from the Basin-Fruitland Coal Gas Pool within a proposed standard gas proration and spacing unit consisting of the W/2 of said Section 20.

3. This Well is a replacement well for the Quinn 339 Well 835 feet from the West line and 1825 feet from the south line (Unit 1) of Section 20.

4. The Quinn 339 well drilled 68 feet of coal with similar coal character as offsetting wells. The Quinn 339 Well tested poorly at this original bottom hole location and was sidetracked in an attempt to improve this production. The new bottom hole location performed poorly and appeared to be affected by a localized permeability problem.

5. Burlington believes that there is a significant amount of gas remaining in this gas unit based upon a log from a Mesaverde well in the NW/4 of this section.

6. Burlington would like to relocate the well and re-drill the well in the NW/4 of Section 20 in an attempt to avoid the a localized permeability problem.

7. Approval of this application will afford the owners of this unit the opportunity to produce their just and equitable share of the gas underlying this unit and will otherwise prevent waste and protect correlative rights.

8. Notification of this application to affected parties towards whom the well encroaches are as set forth on Exhibit "B".

WHEREFORE, Applicant requests that, after notice and hearing, this Application be approved as requested.

KELLAHIN and KELLAHIN

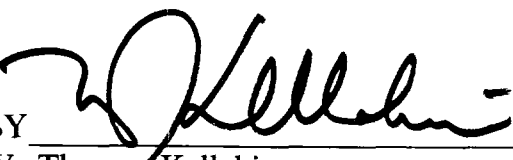
BY 
W. Thomas Kellahin
P. O. Box 2265
Santa Fe, New Mexico 87504
(505) 982-4285

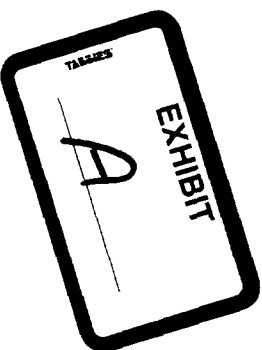

P2000 Well Header
FRUITLAND COAL
Lot_text
Federal Unit_text
Section_text
Township_text
Town Outlines
San Juan Federal Units
Sections
Townships

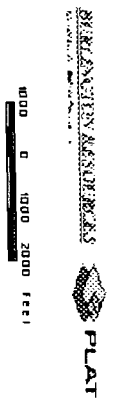

BURLINGTON RESOURCES	
SAN JUAN DIVISION	
Map Title	
< Location Description	
Prepared By: ALAN ALKASHER	Date: 02/20/02
File No: < NUMBERED BY NUMBER >	Revised: < Revision Date >

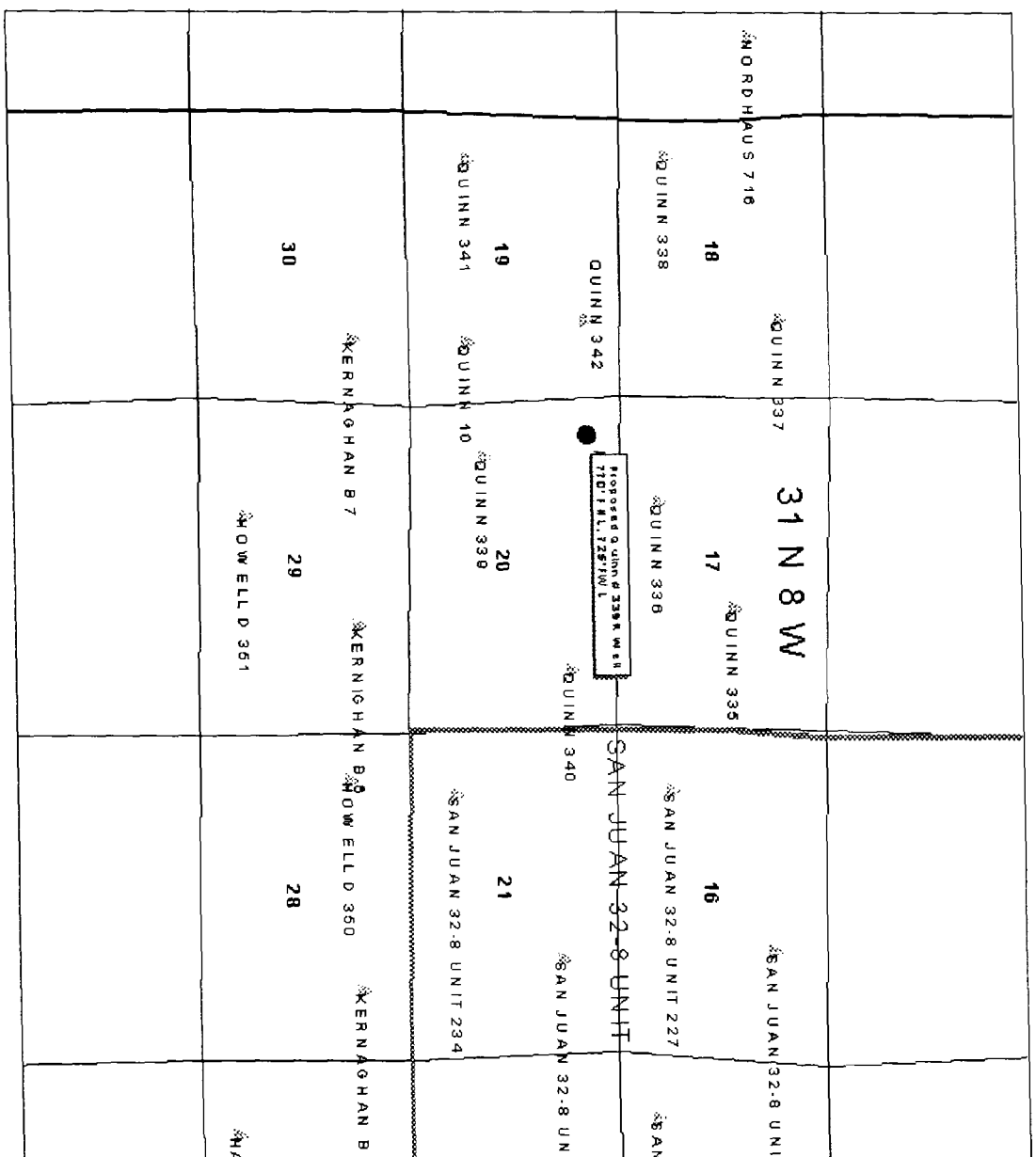

St. John Institutional Investors, LP
Attn: Lisa Lavin
800 E. Northwest Hwy, Suite 203
Mount Prospect, IL 60056

BP Amoco / BP Vastar Resources, Inc.
Attn: Bryan G. Anderson, OSO Engineer
501 Westlake Park Blvd
Houston, TX 77079

Phillips Petroleum
Attn: Jim Ball
5525 Hwy 64 NBU 3004
Farmington, NM 87499

Four Star Oil & Gas Company
Attn: Land Manager
P.O. Box 36366
Houston, TX 77236

Koch Exploration Co. LLC
Attn: Lance Harmon
P.O. Box 1478
Houston, TX 77251-1478

Williams Production
Attn: Vern Hansen
One Williams Center
P.O. Box 3102 MS37-5
Tulsa, OK 74101

