

R-37-E

Exhibit 3  
Case 914

STANOLIND OIL AND GAS COMPANY TULSA, OKLA.				
PORTION OF EUMONT GAS POOL				
DR. RQH	TR.	CK.	AP.	NO.
SCALE 1" = 2000'				DATE 4-13-55

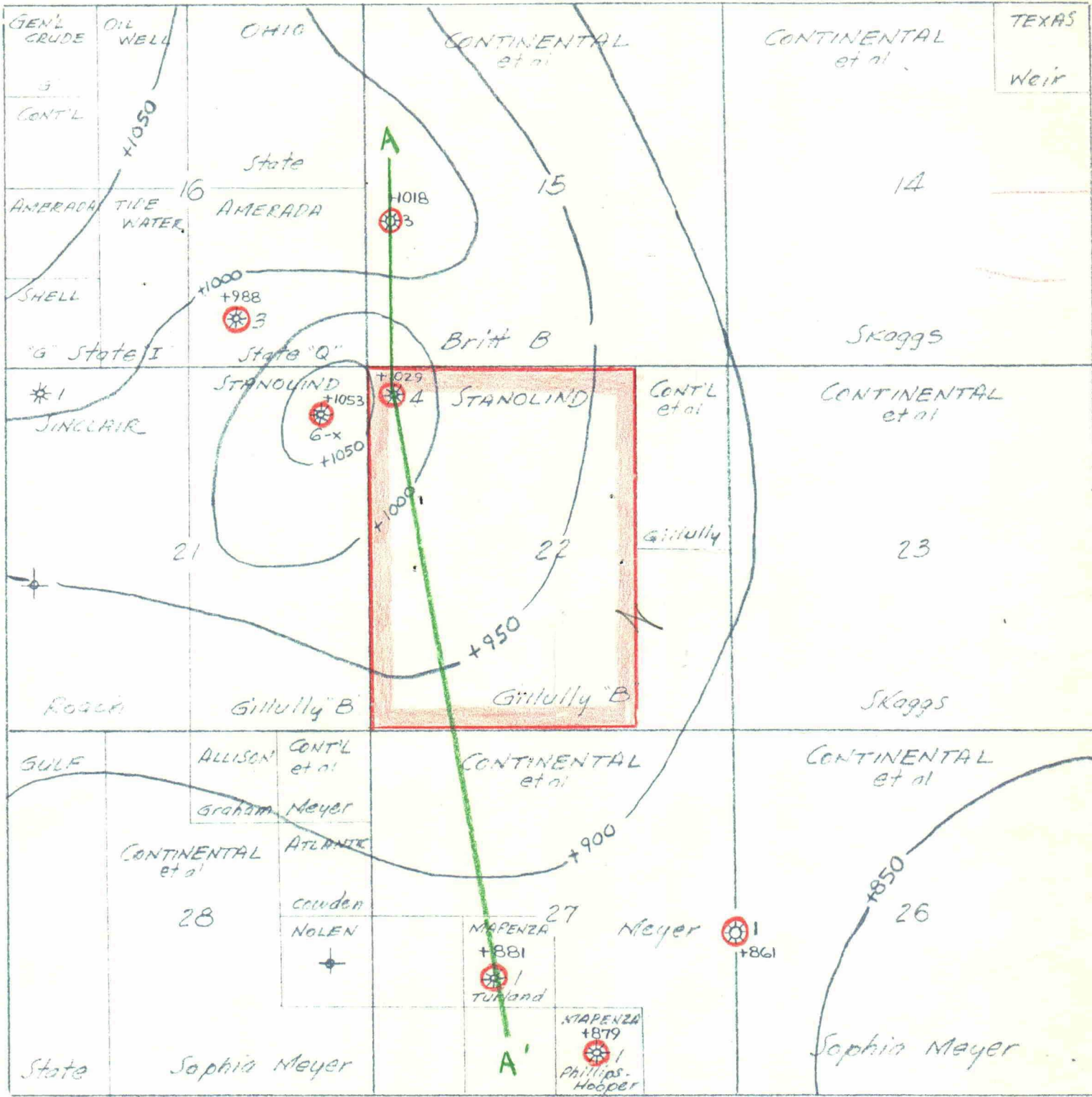

T  
20  
S

R-37-E

Exhibit No 1  
Case 914

STANOLIND OIL AND GAS COMPANY  
TULSA, OKLA.

PORTION OF  
EUMONT GAS POOL

DR.	TR.	CK.	AP.	NO.
RGH				

SCALE 1" = 2000' DATE 4-13-55

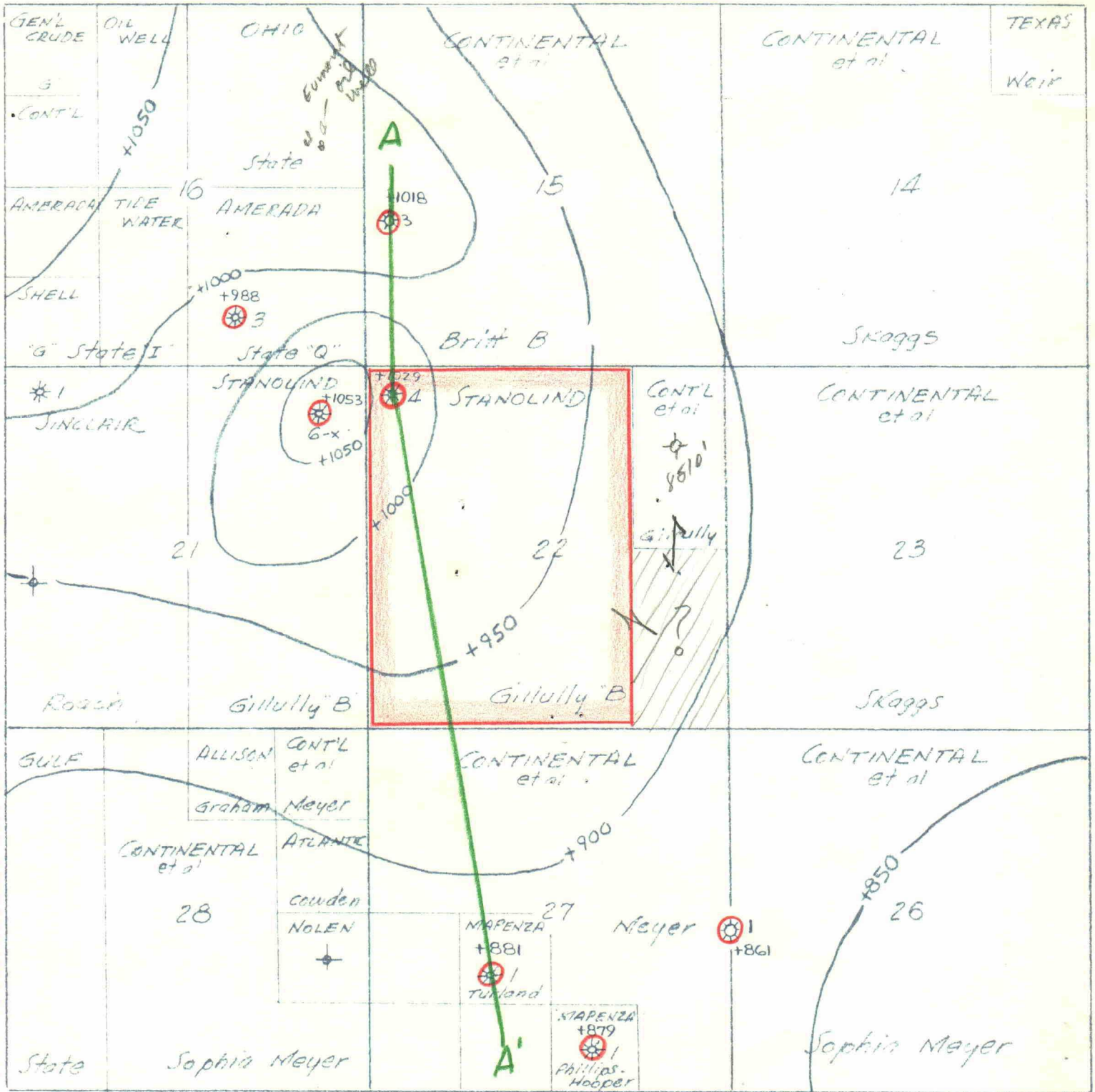

R-37-E

STANOLIND OIL AND GAS COMPANY  
TULSA, OKLA.

PORTION OF  
EUMONT GAS POOL

DR.	TR.	CK.	AP.	NO.
R3H				
SCALE 1" = 2000'				DATE 4-13-55