

CLASS OF SERVICE

This is
Telegram
gram un
ferred ch
dicated b
symbol a
coding th

4014531



Christmas and
New Year's
Greetings

WESTERN
UNION

P. MARSHALL, PRESIDENT

EX-1201

SYMBOLS

DL=Day Letter.

NL=Night Letter

LT=Int'l Letter Telegram

VLT=Int'l Victory Ltr.

The filing t

STANDARD TIME at point of origin. Time of receipt is STANDARD TIME at point of destination

EXTRA SPECIAL WAY TO SAY HAPPY HOLIDAY.

1953 DEC 8 PM 3 41

D. FWC796 PD=FAX FORT WORTH TEX 8 416P MC=

R R SPURRIER=

NEW MEXICO OIL CONSERVATION COMM SANTA FE NMEX=

RE CASE NO. 627. PLEASE CONTINUE THIS MATTER UNTIL JANUARY
HEARING IN VIEW OF INCORRECT LOCATION IN ADVERTISEMENT.
CORRECTED APPLICATION WILL BE FORWARDED IMMEDIATELY=

S V MCCOLLUM CONTINENTAL OIL CO=

THE COMPANY WILL APPRECIATE SUGGESTIONS FROM ITS PATRONS CONCERNING ITS SERVICE



Case 627

CONTINENTAL OIL COMPANY

FAIR BUILDING
FORT WORTH 2, TEXAS

H. L. JOHNSTON
REGIONAL MANAGER OF PRODUCTION
SOUTHWESTERN REGION

November 10, 1953

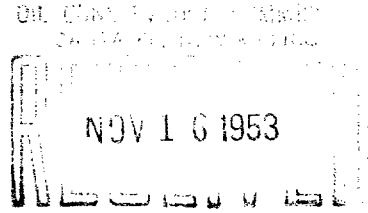

New Mexico Oil Conservation Commission
P. O. Box 871
Santa Fe, New Mexico

Attention of Mr. R. R. Spurrier

Gentlemen:

Re: Sophia Meyer B-26
Well No. 1, Section 26-20-37
Lea County, New Mexico

The Sophia Meyer B-26 well No. 1 was drilled in 1929, and completed as a shut-in gas well for lack of market. El Paso Natural Gas Company recently surveyed the location in preparation of connecting the well to their system. That survey showed the well to be located on the west line of Section 26. El Paso has refused to proceed with the connection until the Commission has given their approval of the unorthodox location and the allocation of acreage to the well.

Our Mr. V. T. Lyon discussed this matter by telephone with Mr. W. B. Macey of your office, and in conformance with that conversation we are enclosing the following:

1. Two copies of the re-survey plat showing the results of the original survey and the results of the re-survey to the effect that the well is located on the section line.

2. Two copies of the gas well plat showing the acreage attributed to said well to be the SW/4 of Section 26.

It is respectfully requested that your approval of the location and acreage attribution be given. We shall be glad to furnish any additional information on this matter which you may require.

Yours very truly,

A handwritten signature in cursive script, appearing to read "J. H. Johnston".

HLJ-MC
Enc

NEW MEXICO
OIL CONSERVATION COMMISSION

Gas Well Plat

Date Oct. 19th 1953

Continental Oil Co. Sophie Meyer B-26 1
Operator Lease Well No.

Name of Producing Formation Queen Pool Undesignated

No. Acres Dedicated to the Well 160

SECTION 26 TOWNSHIP 20 RANGE 37

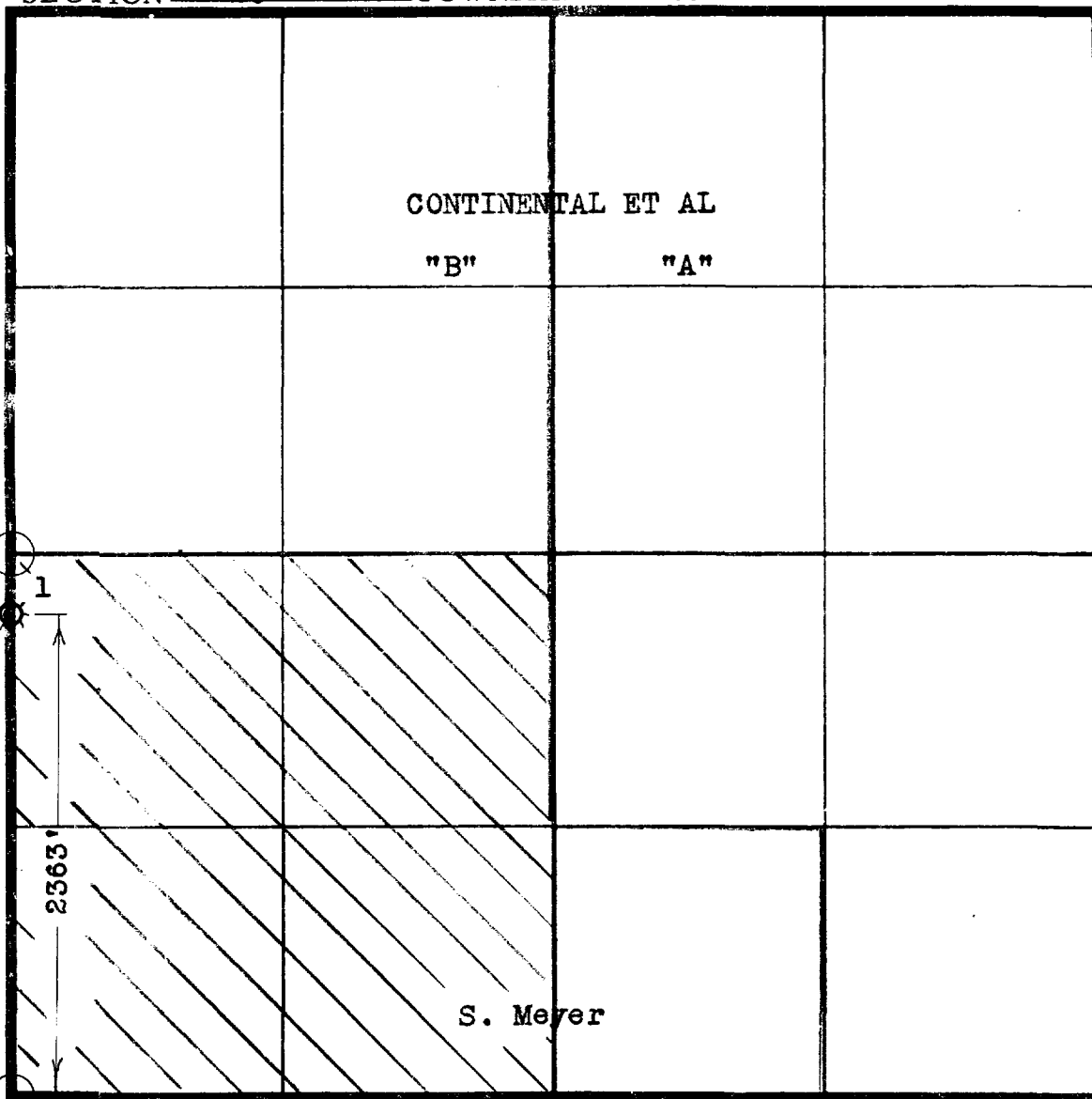

2" I.P.
Start. Pt. I hereby certify that the information given above is true and complete
to the best of my knowledge.

Name Ed Wilson
Position Dist. Supt.
Representing Continental Oil Co.
Address Box 427 Hobbs, N. M.

(over)

INSTRUCTIONS

1. Is this gas well a dual completion? Yes _____ No _____
2. If the answer to Question 1 is Yes, are there any other dually completed wells within the dedicated acreage? Yes _____ No _____

A separate plat must be filed for each gas well, outlining the area dedicated to such well and showing the location of all other wells (oil and gas) within the outlined area.

Mail in duplicate to the district office for the district in which the well is located.

NEW MEXICO
OIL CONSERVATION COMMISSION

Gas Well Plat

Date Oct. 19th 1953

Continental Oil Co. Sophie Meyer B-26 1
Operator Lease Well No.

Name of Producing Formation Queen Pool Undesignated

No. Acres Dedicated to the Well 160

SECTION 26 TOWNSHIP 20 RANGE 37

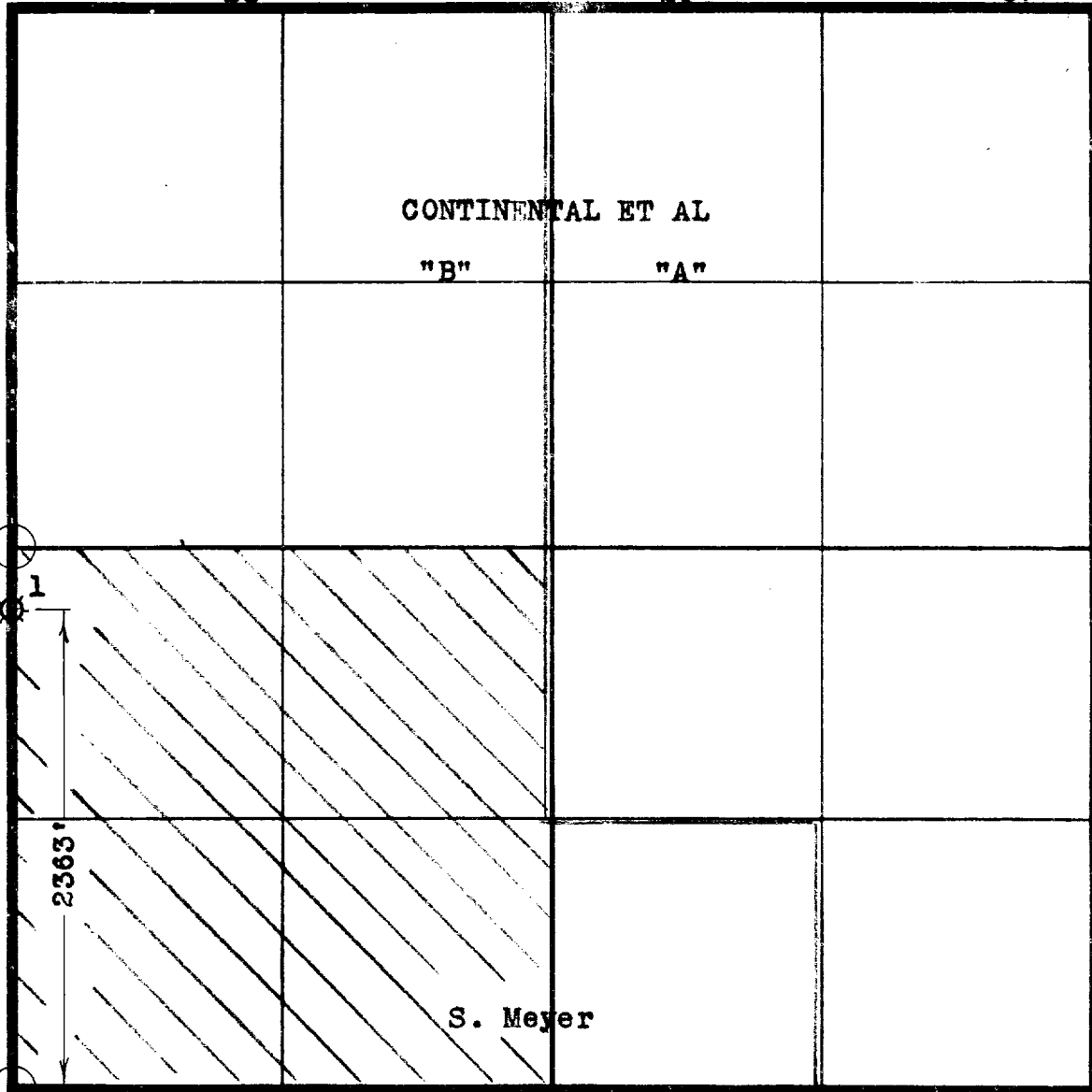

2" I.P.
Start. Pt. I hereby certify that the information given above is true and complete to the best of my knowledge.

Name Ed Wilson
Position Dist. Supt.
Representing Continental Oil Co.
Address Box 427 Hobbs, N. M.

(over)

INSTRUCTIONS

1. Is this gas well a dual completion? Yes ____ No ____
2. If the answer to Question 1 is Yes, are there any other dually completed wells within the dedicated acreage? Yes _____ No _____

A separate plat must be filed for each gas well, outlining the area dedicated to such well and showing the location of all other wells (oil and gas) within the outlined area.

Mail in duplicate to the district office for the district in which the well is located.

RE-SURVEY
of
Continental - S. Meyer B-26 No.1
(Drilled 2-21-1929.)

Original survey showed well: 2970' from south, 330' from west
lines of section 26-20-37.

This survey shows well at: 2363' north of intersection of
sections 26, 27, 34 & 35 in T-20-S,
R-37-E, Lea County, New Mexico.

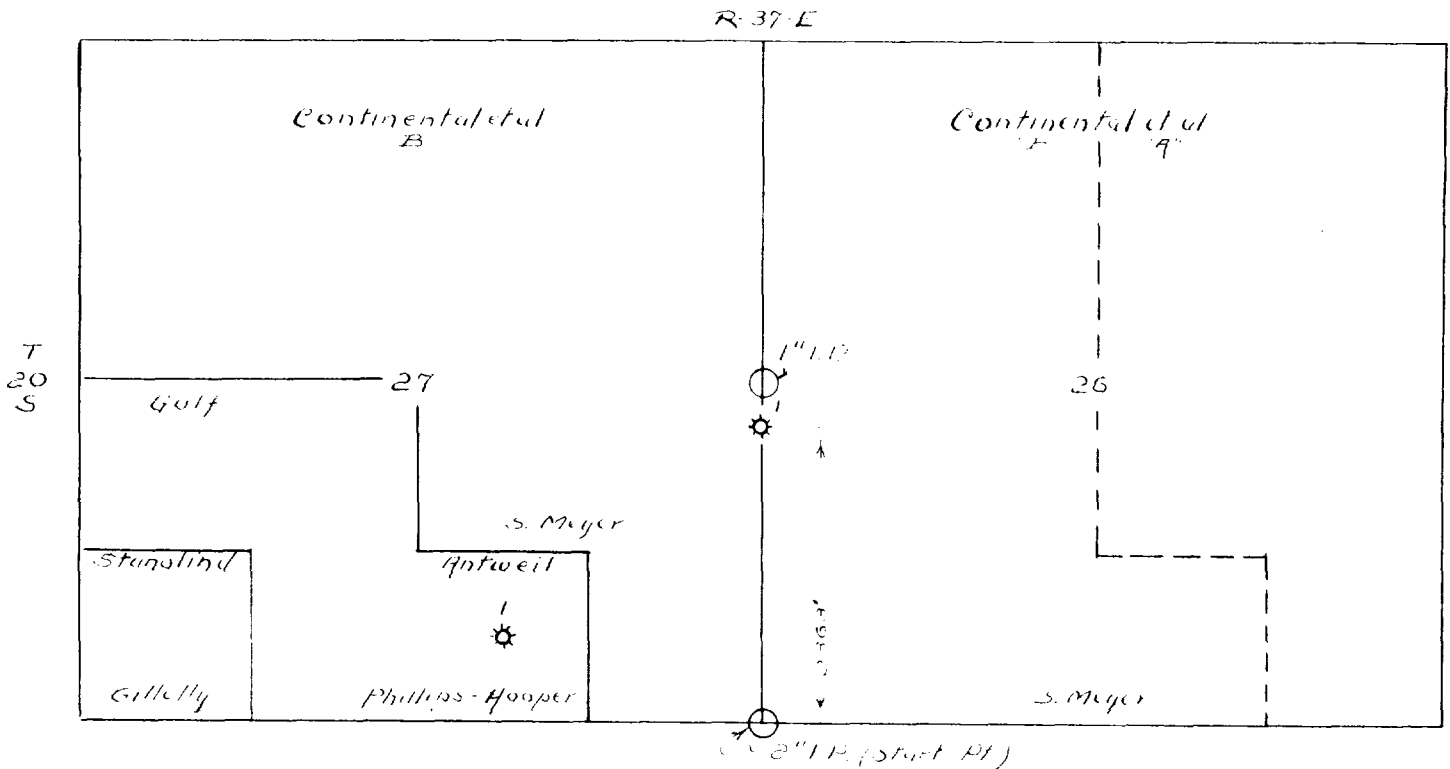

scale: 1"=1500'

CONTINENTAL OIL COMPANY,
Well No.1, S. Meyer B-26 & B-27
Leases, Lea County, New Mexico.

I, Jack Collins, do hereby certify that
this new location is correct and was ~~xxx~~ surveyed
on the ground by me,

Jack B Collins

RE-SURVEY
of
Continental - S. Meyer B-26 No.1
(Drilled 2-21-1929.)

Original survey showed well: 2970' from south, 330' from west lines of section 26-20-37.

This survey shows well at: 2363' north of intersection of sections 26, 27, 34 & 35 in T-20-S, R-37-E, Lea County, New Mexico.

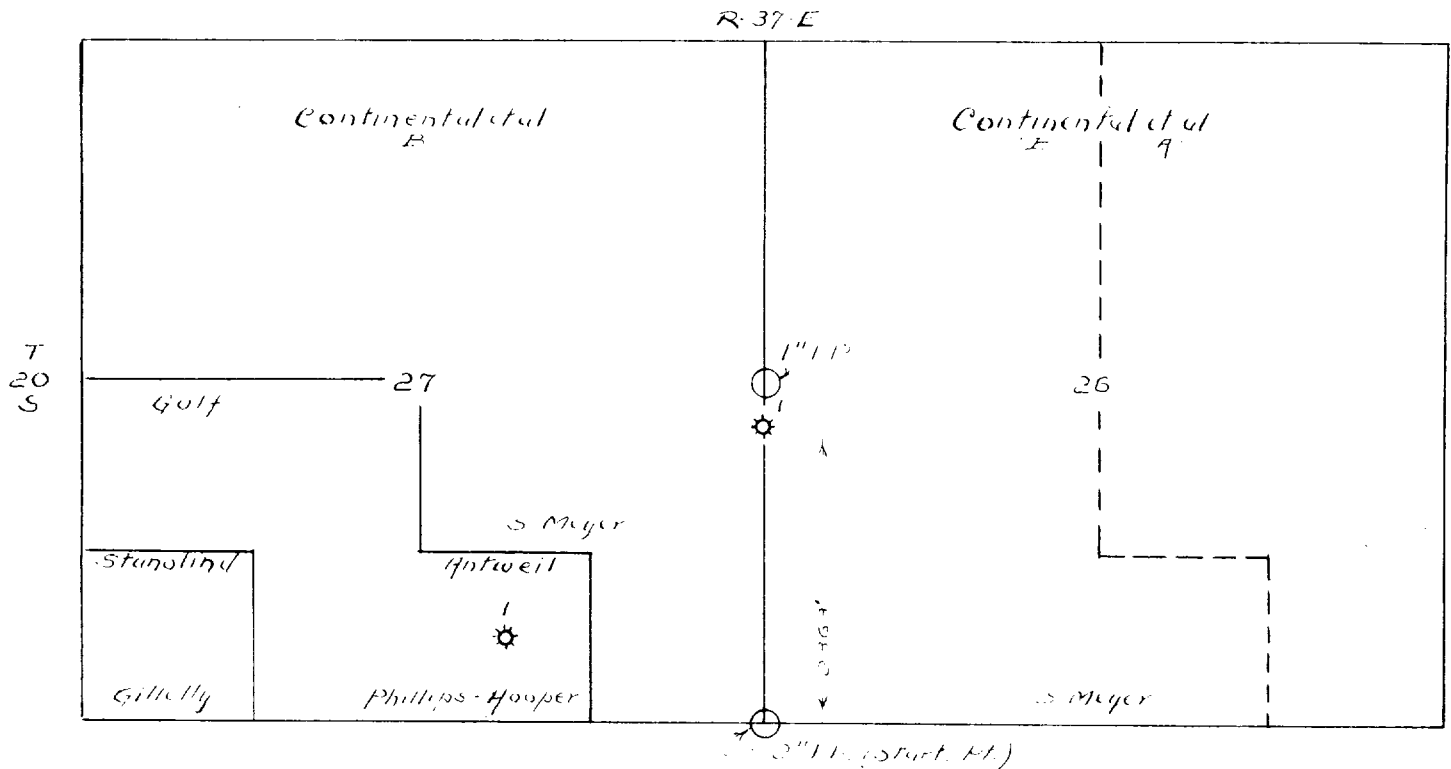

scale: 1"=1500'

CONTINENTAL OIL COMPANY,
Well No.1, S. Meyer B-26 & B-27
Leases, Lea County, New Mexico.

I, Jack^B Collins, do hereby certify that
this new location is correct and was ~~made~~ surveyed
on the ground by me,

Jack B Collins

Chas 627

OIL CONSERVATION COMMISSION
P. O. BOX 871
SANTA FE, NEW MEXICO

November 10, 1953

Mr. V. T. Lyons
Continental Oil Company
1710 Fair Building
FORT WORTH - TEXAS

Dear Sir:

RE: Continental Oil Co. Meyer B-26 No. 1
(26-308-37E)

Reference is made to your telephone conversation with Mr. Macey pertaining to the above-captioned well.

An examination of our records and orders indicates that this well was originally thought to be in SE NW Section 26, whereas it is actually located 2360' from the south line and 0' from the west line of this section.

The well is located outside the boundary of the Eumont Pool, but is in an area which is in all probability part of the Eumont Pool.

Please consider this as temporary approval to produce the well into a gas transportation facility. At such time as the area is taken into the pool it will then be in order for you to apply for approval of an unorthodox location in conformance with the pool rules.

Furthermore, it is our understanding that the well is to be considered as being in Section 26, and the SW/4 of that section will in all probability be dedicated to the well.

A copy of this letter is being sent to El Paso Natural Gas Company and other interested parties.

Yours very truly,

R. R. Spurrier
Secretary - Director

RRS:mr

cc: OGC, Hobbs
Continental, Hobbs
El Paso Natural Gas Co., Jal

C
O
P
Y

Cont E No 2
Case 627
1-20-54

RE-SURVEY
of
CONTINENTAL - S. MEYER B-26 NO.1
(Drilled 2/21/1929)

Original survey showed well: 2970' from South, 330' from west
lines of Section 26-20-37.

This survey shows well to be: 2363' north of intersection of
sections 26, 27, 34 & 35 in T-20-S,
R-37-E, Lea Co, N. M.

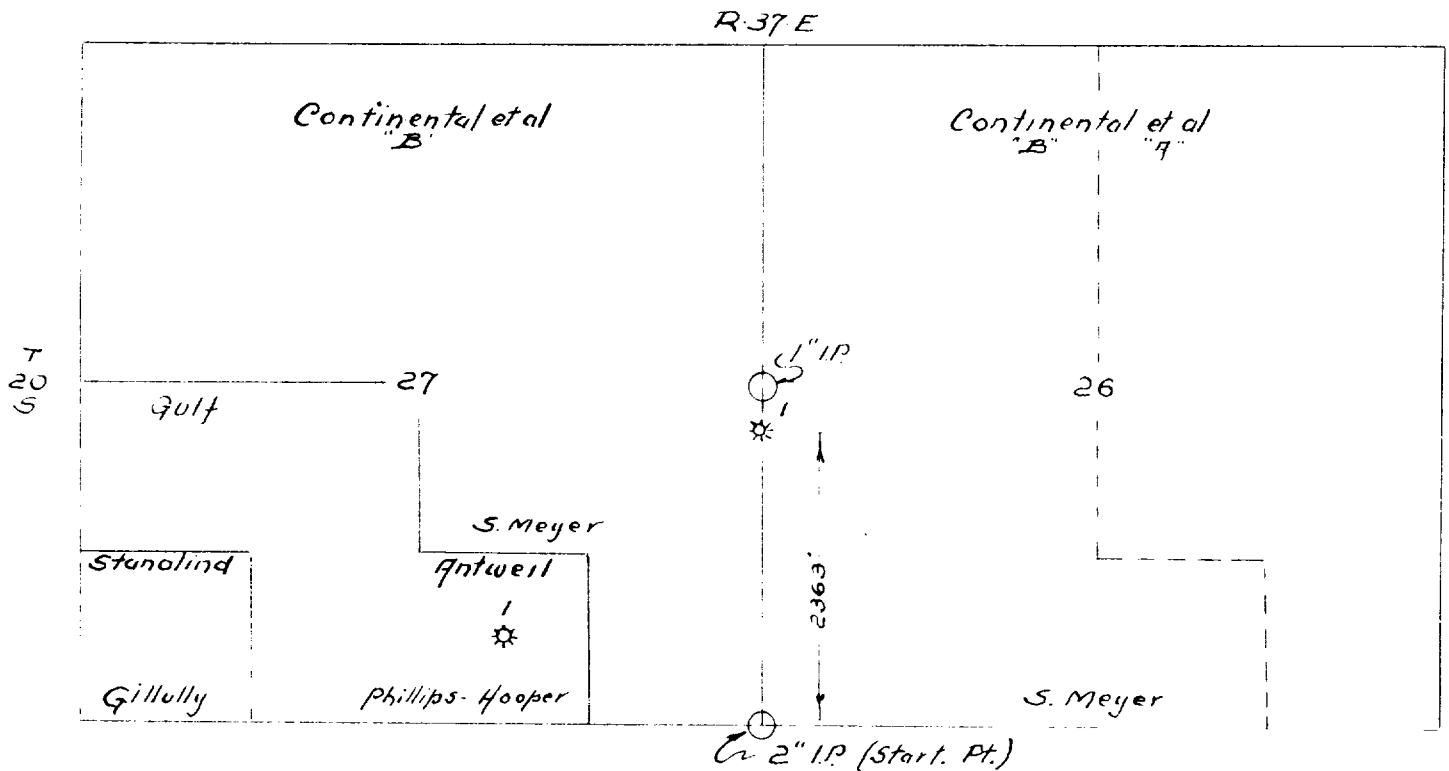

scale: 1" - 1,500'

CONTINENTAL OIL COMPANY
Well no.1, S. Meyer B-26 & B-27
Leases, Lea County, New Mexico.

I, Jack B. Collins, do hereby certify that this well
was re-surveyed by me on the ground and that the
location shown hereon is correct,

Jack B Collins