

County LEAPool PEARL-BONE SPRINGTOWNSHIP 19 South, RANGE 35 East, NEW MEXICO PRINCIPAL MERIDIAN

	6	5	4	3	2	1
7	8	9	10	11	12	
13	17	16	15	14	13	
19	20	21	22	23	24	
30	29	28	27	26	25	
31	32	33	34	35	36	

Producing Formation -Bone SpringDepth Range 8-9

Purpose: To create a new pool for

Shell Oil Co. Hooper #1-G Sec. 27-19-35 comp. in Bone Spring (from former
Atoka comp.) 9/12/55 t. perf. 8198Proposed Boundary: NE/4 of Section 27

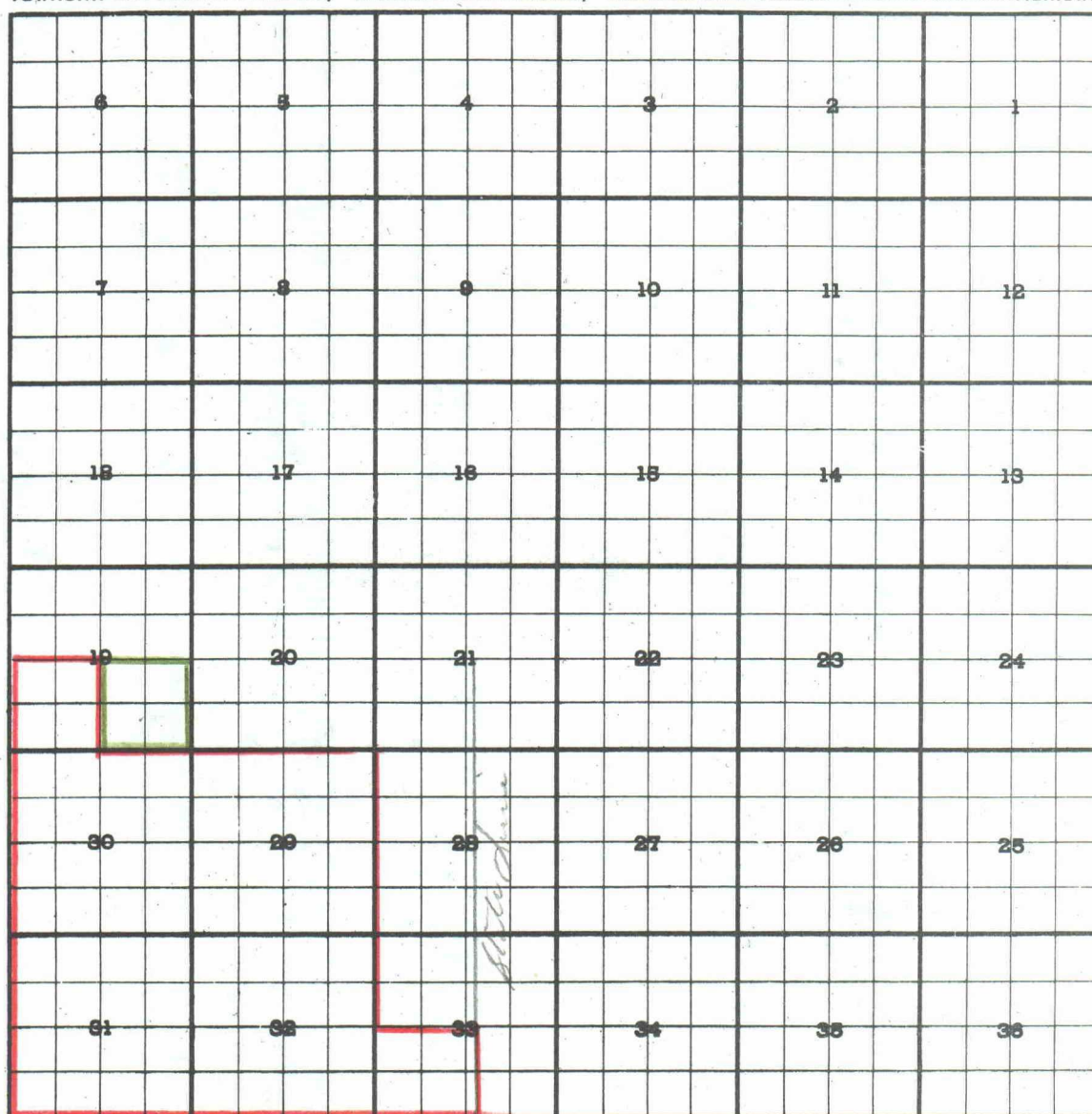
County LEA Pool DOLLARHIDE-QUEENTOWNSHIP 24 South, RANGE 38 East, NEW MEXICO PRINCIPAL MERIDIAN

Producing Formation -Queen Depth Range 0-5

Purpose: To extend the pool for the inclusion of -

Sinclair Oil & Gas J. H. McClure Fed. #15-0 Sec. 19-24-38 comp. in Queen9/23/55 t. perf. 3696

Existing Boundary : Colored in Red

Proposed Extension: Colored in Green SE/4 of Section 19

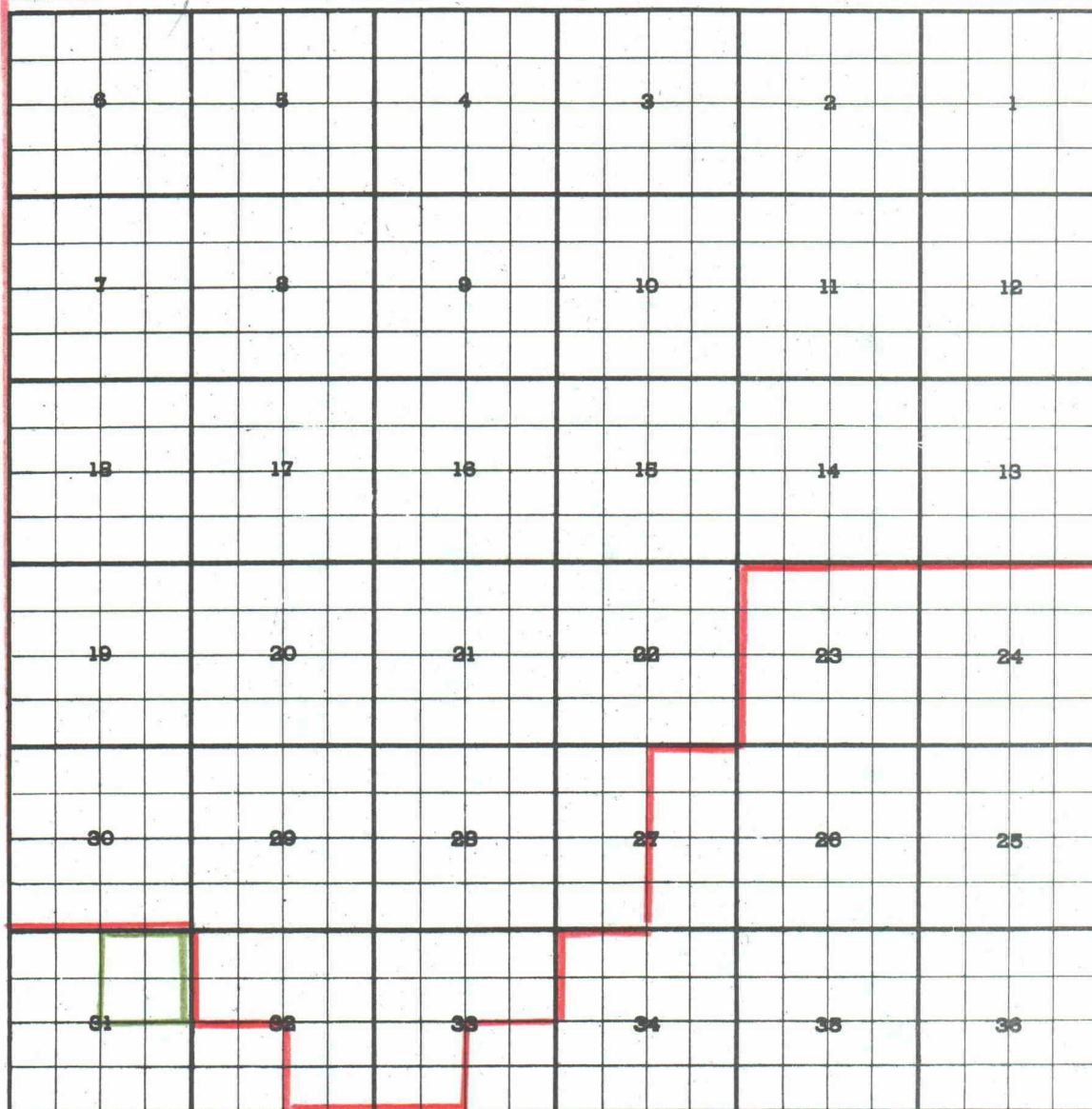
County LEAPool EUMONTTOWNSHIP 21 South, RANGE 36 East, NEW MEXICO PRINCIPAL MERIDIANProducing Formation-Y-SR-Qu.Purpose: To extend the pool for NSP unit for Texas Co. Rector leaseExisting Boundary : Colored in RedProposed Extension: Colored in Green

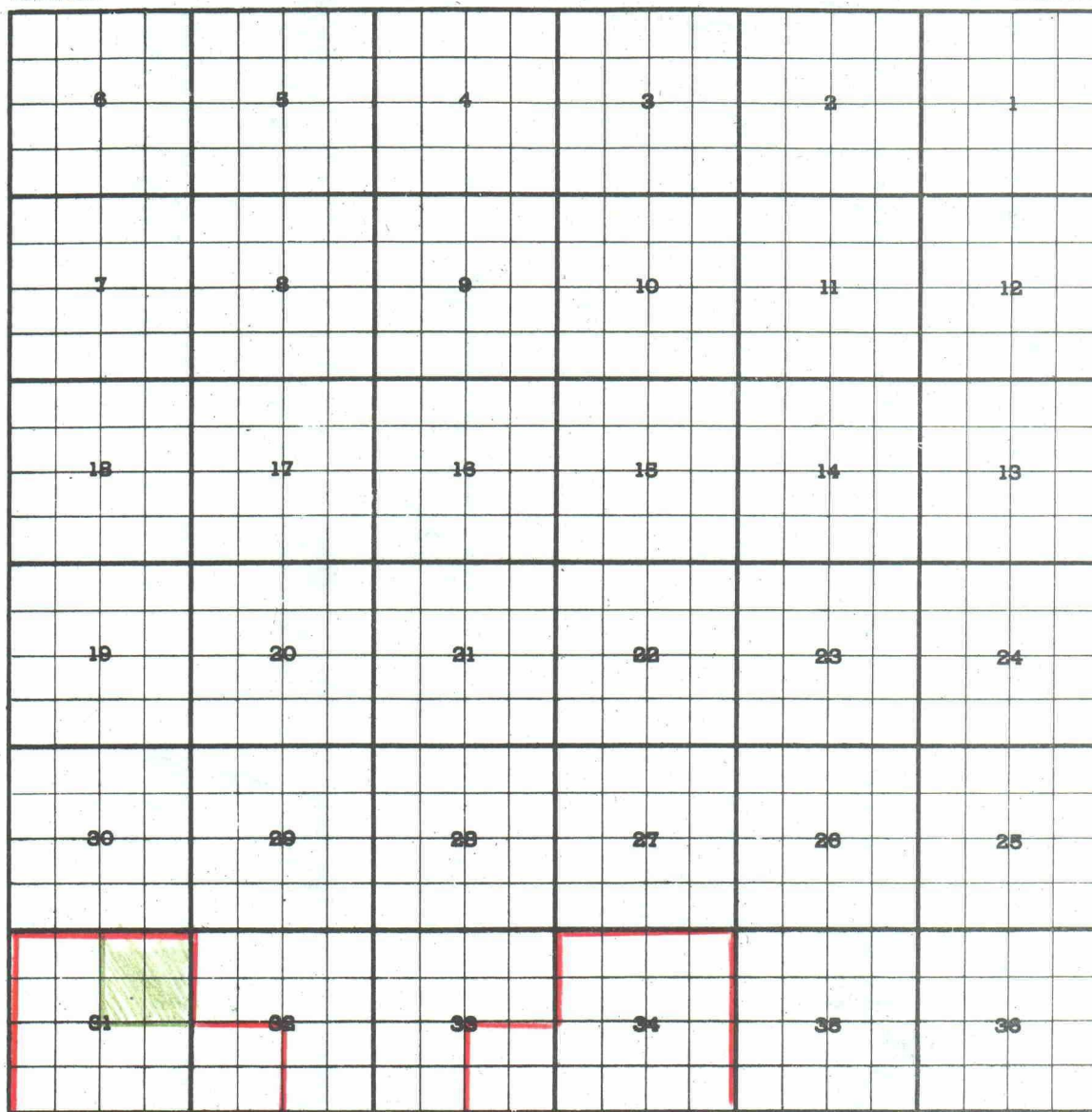
County LEAPool JALMATTOWNSHIP 21 South, RANGE 36 East, NEW MEXICO PRINCIPAL MERIDIAN

Purpose- To delete an area from the Jalmat to be added to the Eumont
for NSP for Texas Co. Rector lease

Existing Boundary : Colored in Red

Proposed Deletion: Colored in Green NE/4 Sec. 31

County LEAPool LANGLIE-MATTIXTOWNSHIP 25 South, RANGE 38 East, NEW MEXICO PRINCIPAL MERIDIAN

	6	5	4	3	2	1
7	8	9	10	11	12	
13	17	16	15	14	13	
19	20	21	22	23	24	
29	28	27	26	25		
31	32	33	34	35	36	

Producing Formation: Part of SR and all Queen 0-5

Purpose: To extend the pool to include -

Leonard Oil Co. Ginsberg #5-D Sec. 31-25-38 Queen producer comp.
9/16/55 dcs. 3258

Existing Boundary : Colored in Red

Proposed Extension: Colored in Green W/2 Sec. 31

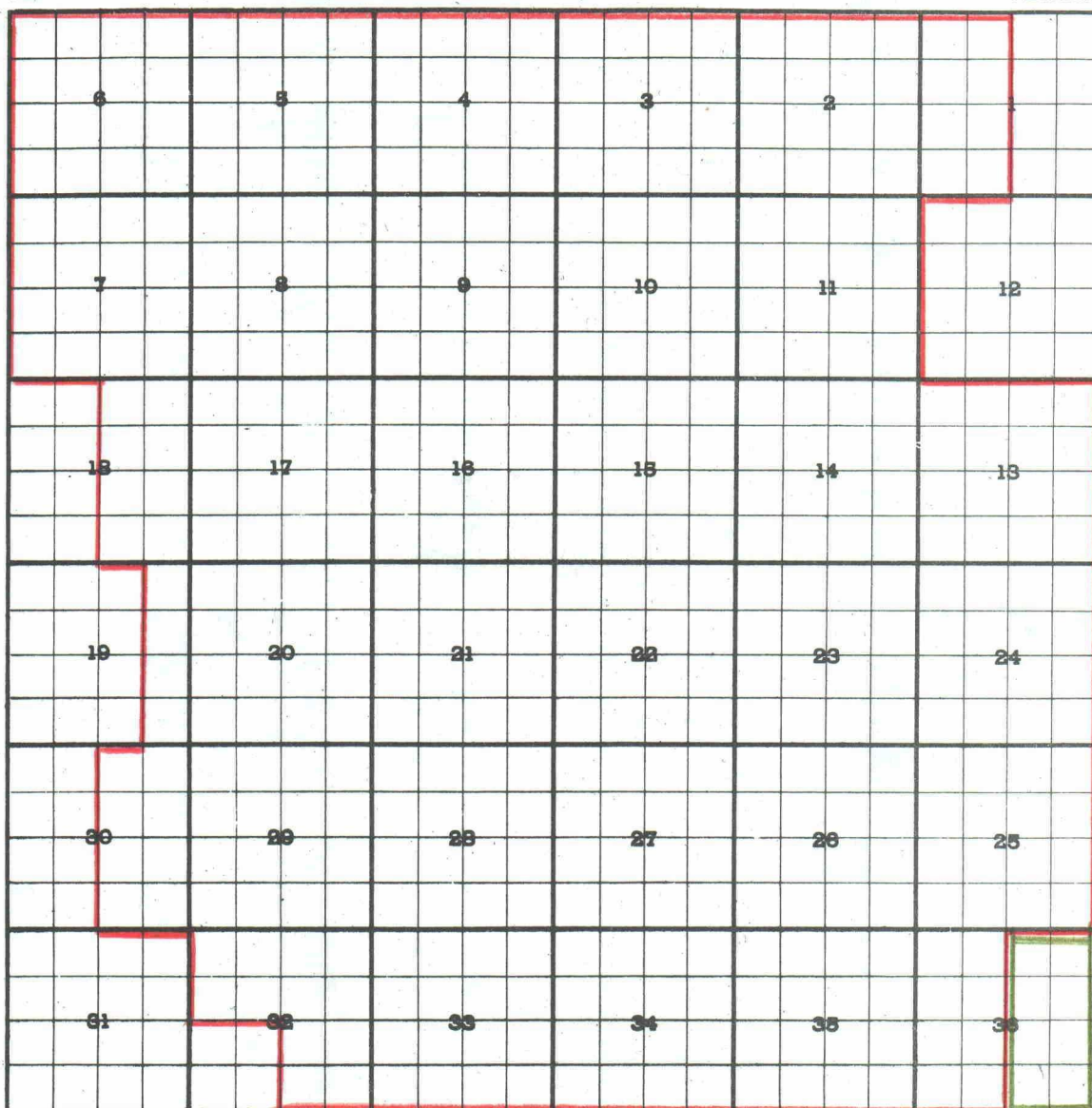
County LEA Pool LANGLIE-MATTIXTOWNSHIP 25 South, RANGE 37 East, NEW MEXICO PRINCIPAL MERIDIAN

Producing Formation : Part of Seven Rivers, all Queen

Purpose: To make 31-25-38 contiguous to pool, see next plat

Existing Boundary : Colored in Red

Proposed Extension: Colored in Green E/2 Sec/36

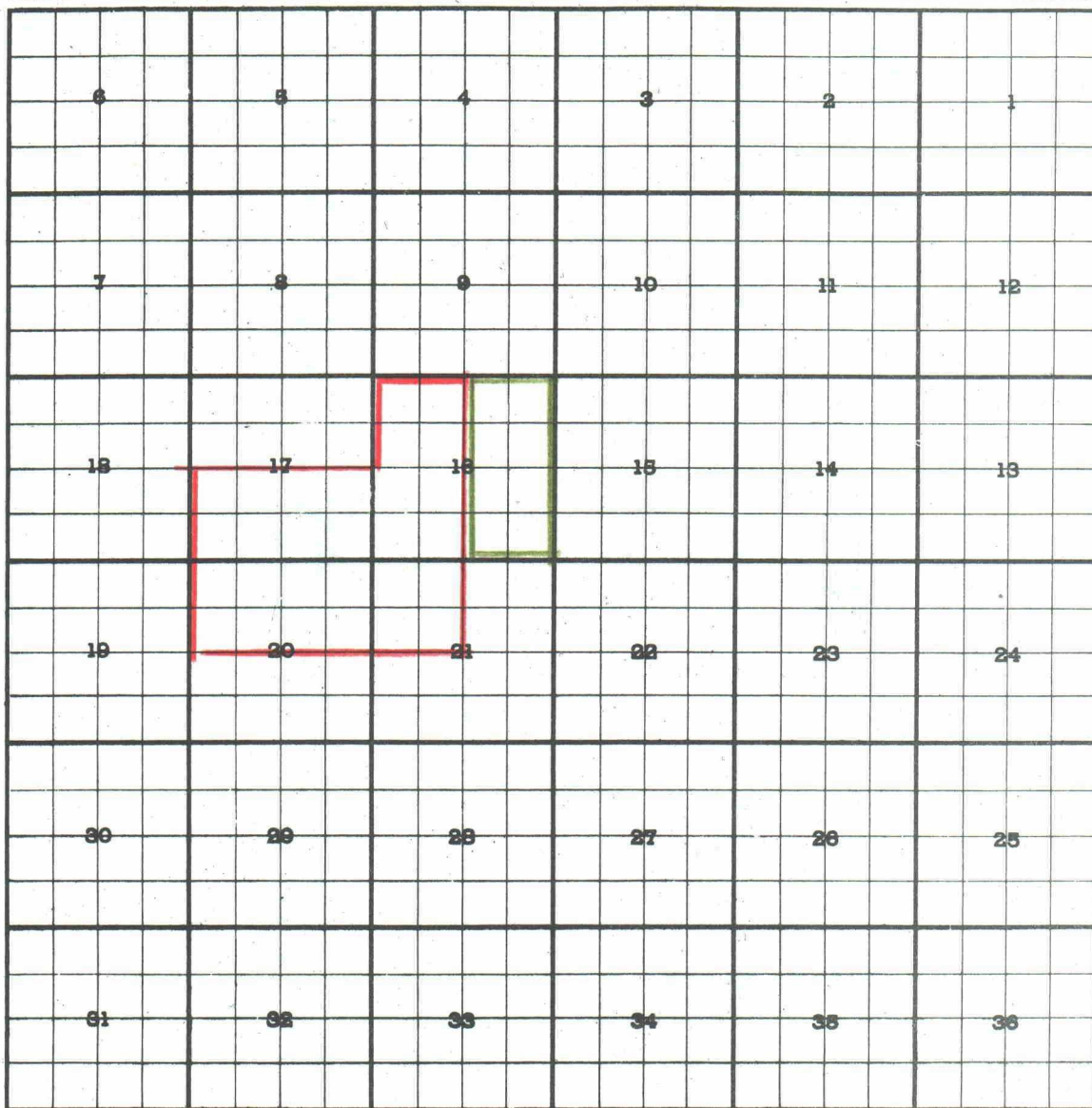
County EDDY Pool HIGH LONESOMETOWNSHIP 16 South, RANGE 29 East, NEW MEXICO PRINCIPAL MERIDIAN

Depth Range 0-5 Producing Formation-Queen

Purpose: To extend the pool for the inclusion of-

Moab Drilling Co. Skelly State #6-G Sec. 16-16-29 comp. 8/27/55 in Qu.
t.pay 1856" Skelly State #7-H Sec. 16-16-29 comp. 8/24/55 in Qu.
des. 1879

" State #1-J comp. 9/5/55 in Queen tp.1854

Existing Boundary: Colored in Red

Proposed Extension: Colored in Green E/2 Sec. 16

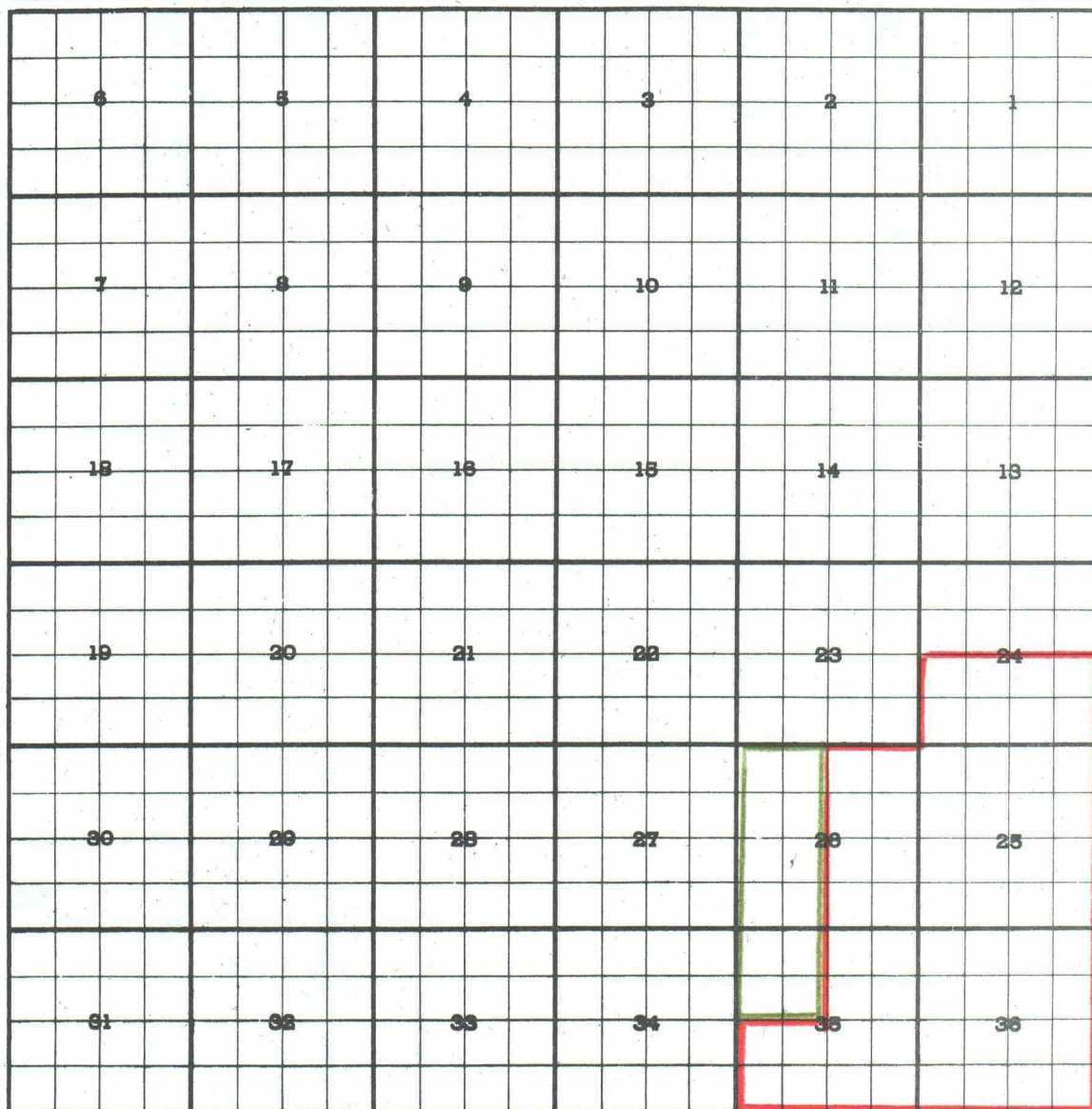
County LEA Pool ARROWTOWNSHIP 21 South, RANGE 36 East, NEW MEXICO PRINCIPAL MERIDIAN

Purpose: To extend the pool for NSP Unit for Humble

Existing Boundary : Colored in Red

Proposed Extension: Colored in Green W/2 Sec. 26 and NW/4 Sec. 35

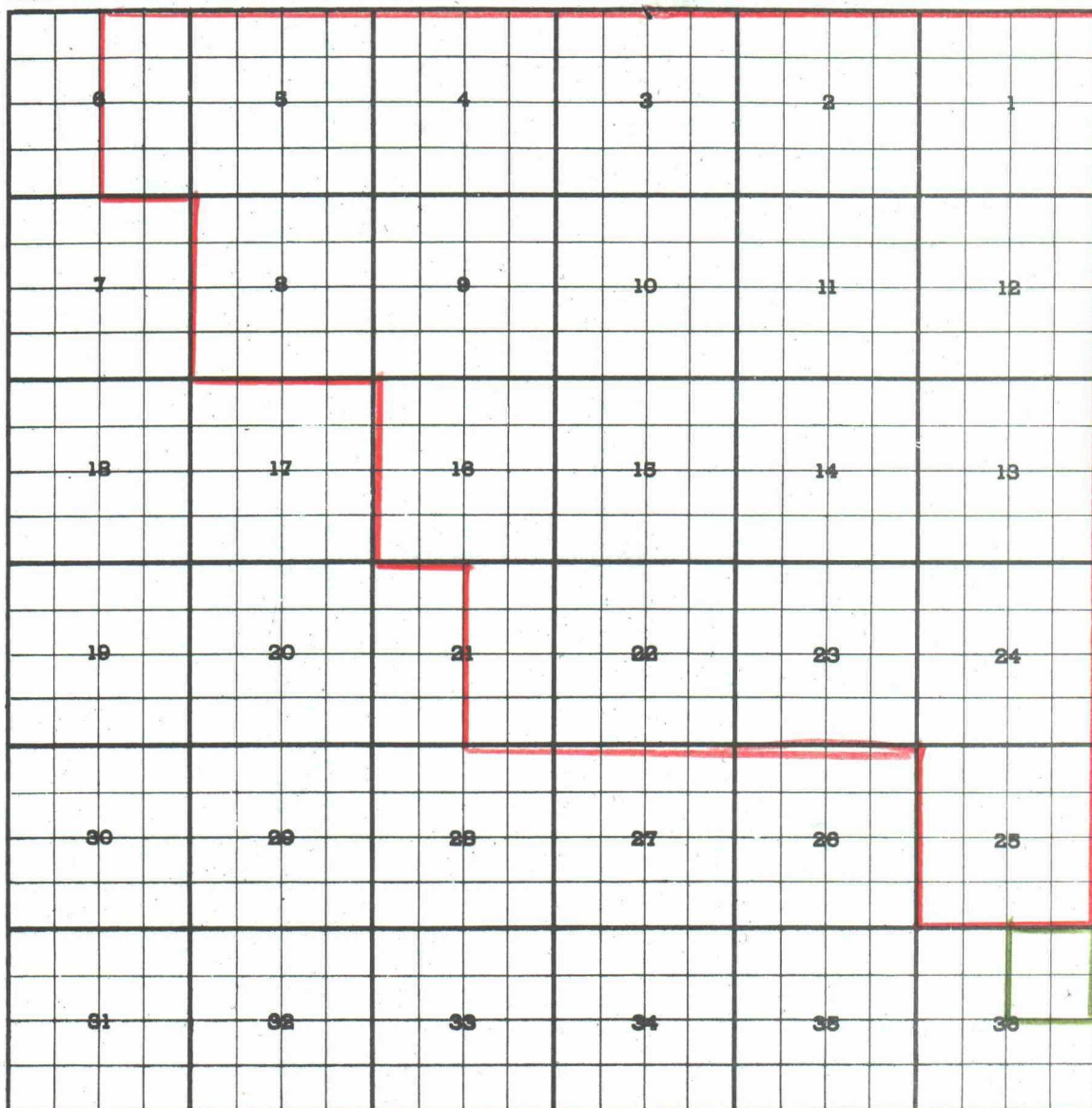
County LEAPool TUBBTOWNSHIP 22 South, RANGE 37 East, NEW MEXICO PRINCIPAL MERIDIAN

Purpose: To extend the pool for the inclusion of-

Western Oil Fields Gulf-State #1-A Sec 36-22-37 comp. 12/19/53 in Tubb
t.p. 6004

Existing Boundary : Colored in Red

Proposed Extension: Colored in Green NE/4 Sec. 36-22-37