

WHN:am  
Attachment

R. R. MCCARTY  
DIV. SUPERINTENDENT  
L. H. BYRD  
ASST. DIV. SUPERINTENDENT  
H. L. HENSLEY  
ASST. DIV. SUPERINTENDENT  
H. E. MEADOWS  
ASST. DIV. SUPERINTENDENT  
J. W. GRAYBEAL  
DIV. PETROLEUM ENGINEER  
R. A. ESTES  
DIV. CIVIL ENGINEER

# HUMBLE OIL & REFINING COMPANY

WESTERN DIVISION

P. O. BOX 1600

MIDLAND, TEXAS

October 17, 1957

Re: Humble Oil & Refining Company  
Application for Two Well  
640-Acres Gas Proration Unit  
for its Eumont Gas Unit,  
Eumont Pool, Lea County,  
New Mexico

New Mexico Oil Conservation Commission  
Box 871  
Santa Fe, New Mexico

Attention: Mr. W. L. Porter, Jr.

Gentlemen:

Humble Oil & Refining Company respectfully requests administrative approval of a two-well gas proration unit for its Eumont Gas Unit No. 1. The unit consists of 640 acres, being Section 4, Township 20 South, Range 37 East, Lea County, New Mexico.

This unit was authorized originally on February 10, 1956 as a standard gas proration unit in the Eumont Gas Pool. Well No. 1 is located 2310 feet from the South line and 1980 feet from the East line of Section 4. This well is incapable of producing the 640-acre unit allowable and well No. 2 was drilled, located 660 feet from the West line and 2180 feet from the South line of Section 4. It is requested that approval be given to produce the 640-acre allowable from either or both of these wells within the Unit.

We support our application with the following statements:

1. The proposed unit complies with the requirements of the Special Rules and Regulations for the Eumont Gas Pool of Order No. R-520.
2. The unit consists of 640 acres lying wholly within a single governmental section.
3. The unit consists of contiguous quarter-quarter sections.
4. The length and width of the proration unit does not exceed 5280 feet.
5. The entire gas proration unit may reasonable be presumed to be productive.
6. All operators owning interest within 1500 feet of the wells are being notified by registered mail.

October 17, 1957

7. We have attached a gas proration unit plat which dedicates 640 acres to the two wells.

A plat is attached hereto showing to the best of our knowledge and belief the proposed unit, the location of the wells and the offset ownership.

In view of the facts set out herein it is respectfully requested that the Commission approve of production allocated to this 640-acre standard gas proration unit being produced from either or both the wells located on this unit.

I hereby certify that the information given above is true and complete to the best of my knowledge.

Yours very truly,

HUMBLE OIL & REFINING COMPANY

R. R. McCarty  
Division Superintendent

By: H. L. Hensley  
H. L. Hensley  
Assistant Division Superintendent

WHN:am  
Attachments

Sworn to and subscribed before me this 17th day of October, 1957.

Frances Vick Lincecum  
Frances Vick Lincecum  
Notary Public in and for  
Midland County, Texas

CLASS OF SERVICE

This is a fast message unless its deferred character is indicated by the proper symbol.

# WESTERN UNION

## TELEGRAM

W. P. MARSHALL, PRESIDENT

1201

SYMBOLS

DL=Day Letter

NL=Night Letter

LT=International Letter Telegram

The filing time shown in the date line on domestic telegrams is STANDARD TIME at point of origin. Time of receipt is STANDARD TIME at point of destination

LA175 DC278

MAIN OFFICE OCC

(13)...

D MDA205 PD=MIDLAND TEX 24 408 PM

1957 OCT 24

3:27 OCT 24 PM 3 37

NMEX OIL CONSERVATION COMM=

SANTA FE NMEX=

Case 1343

REFERENCE IS MADE TO HUMBLE OIL AND REFINING COMPANYS LETTER OF OCT 17 1957 CONCERNING APPLICATION FOR TWO WELL GAS PRORATION UNIT FOR HUMBLES EUMONT GAS UNIT #1 SECTION 4, TOWNSHIP 20 SOUTH, RANGE 37 EAST, LEA COUNTY NEW MEXICO. PLEASE CONSIDER APPLICATION AS A REQUEST FOR EXAMINER HEARING AT THE EARLIEST POSSIBLE TIME. REQUEST FOR WAIVERS TO BE MAILED OCTOBER 25 1957, TO OFFSET OPERATORS=

HUMBLE OIL AND REFINING CO R R MCCARTY=

THE COMPANY WILL APPRECIATE SUGGESTIONS FROM ITS PATRONS CONCERNING ITS SERVICE

encl 1343

File 11-70

R. R. MCCARTY  
DIV. SUPERINTENDENT  
L. H. BYRD  
ASST. DIV. SUPERINTENDENT  
H. L. HENSLEY  
ASST. DIV. SUPERINTENDENT  
H. E. MEADOWS  
ASST. DIV. SUPERINTENDENT  
J. W. GRAYBEAL  
DIV. PETROLEUM ENGINEER  
R. A. ESTES  
DIV. CIVIL ENGINEER

## HUMBLE OIL & REFINING COMPANY

WESTERN DIVISION  
P. O. BOX 1600

MIDLAND, TEXAS

October 28, 1957

Re: Humble Oil & Refining Company's  
Amended Application for Two-Well  
640 Acre Gas Proration Unit for  
its Eumont Gas Unit No. 1, Eumont  
Pool, Lea County, New Mexico

New Mexico Oil Conservation Commission  
Box 871  
Santa Fe, New Mexico

Attention: Mr. A. L. Porter, Jr.

Gentlemen:

Humble Oil & Refining Company respectfully submits this amended request for a two-well gas proration unit for its Eumont Gas Unit No. 1. This request is filed to amend our previous request as contained in our letter of October 17, 1957. It is requested that this application be set for an Examiner Hearing at your earliest convenience.

This unit was authorized originally on February 10, 1956 as a standard gas proration unit in the Eumont Gas Pool. The unit consists of 640 acres, being Section 4, Township 20 South, Range 37 East, Lea County, New Mexico. Well No. 1 is located 2310 feet from the South line and 1910 feet from the East line of Section 4. Well No. 2 is located 660 feet from the West line and 2180 feet from the South line of Section 4. It is requested that approval be given for allocation to Well No. 2 a portion of the 640 acre unit allowable, not to exceed fifty per cent, and that both wells be allocated as a standard 640 acre unit.

We support our application with the following statements:

1. The unit consists of 640 acres lying wholly within a single governmental section.
2. The unit consists of contiguous quarter-quarter sections.
3. The length and width of the proration unit does not exceed 5280 feet.
4. The entire gas proration unit may reasonably be presumed to be productive.
5. All operators owning interest within 1500 feet of the wells have been notified by copy of this amended request and waivers requested from each.

Gas proration unit plats, well location plats and plats showing offset ownership were filed with our original request.

Locked  
11-6-57  
B.F.

October 28, 1957

In view of the facts set out herein, it is respectfully requested that the Commission approve our application for a 640 acre two-well standard proration unit and since Well No. 2 was drilled as an unorthodox location that said well be assigned a portion of the 640 acre unit allowable not to exceed fifty per cent of said unit allowable.

Yours very truly,

HUMBLE OIL & REFINING COMPANY

  
R. R. McCarty

Division Superintendent

By:

WHN:am

NEW MEXICO OIL CONSERVATION COMMISSION  
Well Location and Acreage Dedication Plat

Section A.

Date October 15, 1957

Operator HUMBLE OIL & REFG. CO Lease EUMONT GAS UNIT NO. 1 (M.E. Laughlin Lse)  
Well No. 1 Unit Letter "J" Section 4 Township 20 South Range 37 East NMPM  
Located 2310 Feet From South Line, 1980 Feet From East Line  
County LEA G. L. Elevation \_\_\_\_\_ Dedicated Acreage 640 Acres  
Name of Producing Formation QUEENS GAS Pool EUMONT

1. Is the Operator the only owner\* in the dedicated acreage outlined on the plat below?  
Yes \_\_\_\_\_ No ✓.
2. If the answer to question one is "no," have the interests of all the owners been consolidated by communitization agreement, or otherwise? Yes ✓ No \_\_\_\_\_. If answer is "yes," Type of Consolidation Unitization
3. If the answer to question two is "no," list all the owners and their respective interests below:

Owner

Land Description

Section B

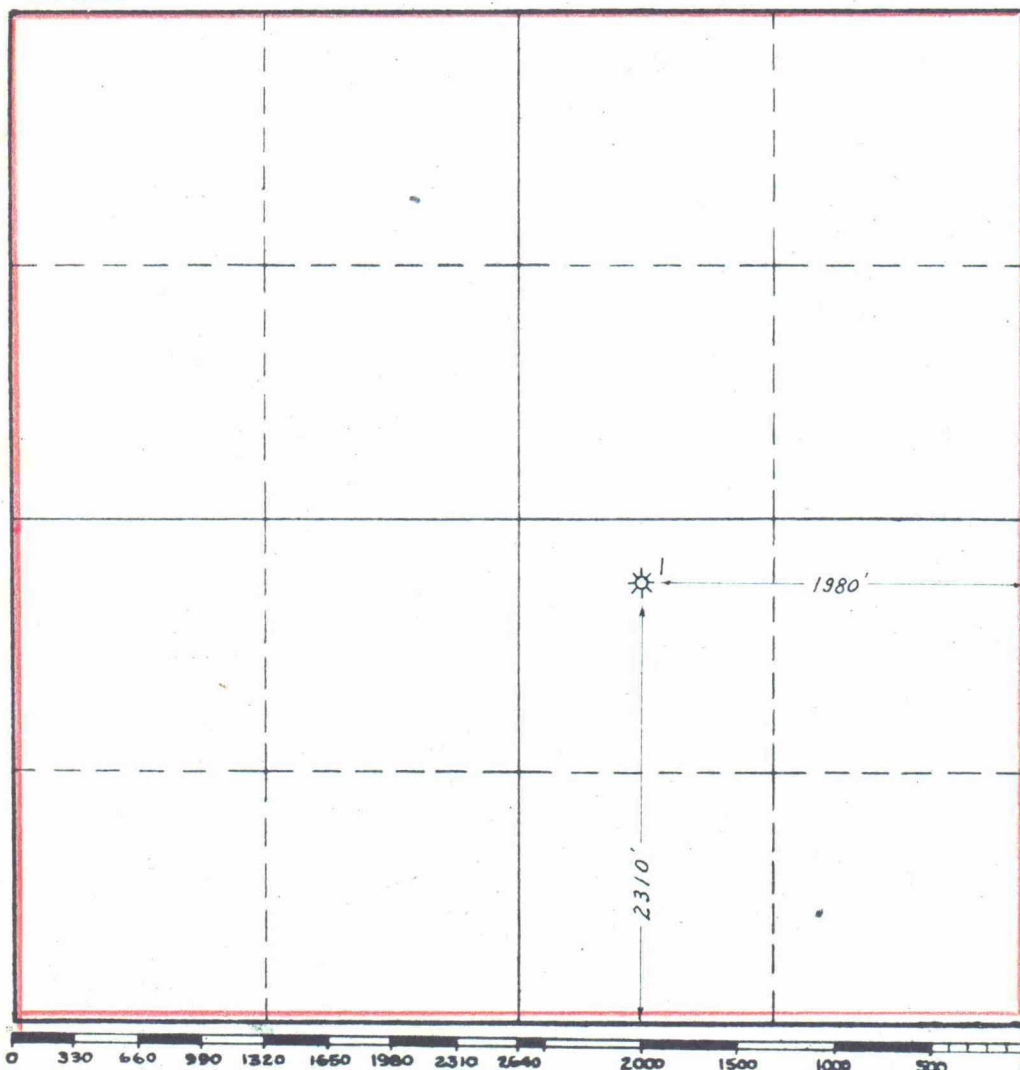

This is to certify that the information in Section A above is true and complete to the best of my knowledge and belief.

HUMBLE OIL & REFG. CO  
(Operator)  
H. L. Henoley  
(Representative) ✓  
Assistant Division Supt.  
Box 1600 Midland, Texas  
Address

This is to certify that the well location shown on the plat in Section B was plotted from field notes of actual surveys made by me or under my supervision and that the same is true and correct to the best of my knowledge and belief.  
Date Surveyed 9-8-55

E. T. Mahan  
Registered Professional  
Engineer and/or Land Surveyor.

Certificate No. 1513

LEASE NO. 22312

W-A - 1693



NEW MEXICO OIL CONSERVATION COMMISSION  
Well Location and Acreage Dedication Plat

Section A.

Date 8-28-57

Operator HUMBLE OIL & REFG. CO Lease EUMONT GAS UNIT NO.1 (M.E. LAUGHLIN LSE)  
Well No. 2 Unit Letter "L" Section 4 Township -20-S Range -37-E NMPM  
Located 2180 Feet From SOUTH Line, 660 Feet From WEST Line  
County LEA G. L. Elevation \_\_\_\_\_ Dedicated Acreage 640 Acres  
Name of Producing Formation QUEENS GAS Pool EUMONT

1. Is the Operator the only owner\* in the dedicated acreage outlined on the plat below?  
Yes \_\_\_\_\_ No L.
2. If the answer to question one is "no," have the interests of all the owners been consolidated by communitization agreement or otherwise? Yes L No \_\_\_\_\_. If answer is "yes," Type of Consolidation UNITIZATION
3. If the answer to question two is "no," list all the owners and their respective interests below:

Owner

Land Description

Section B

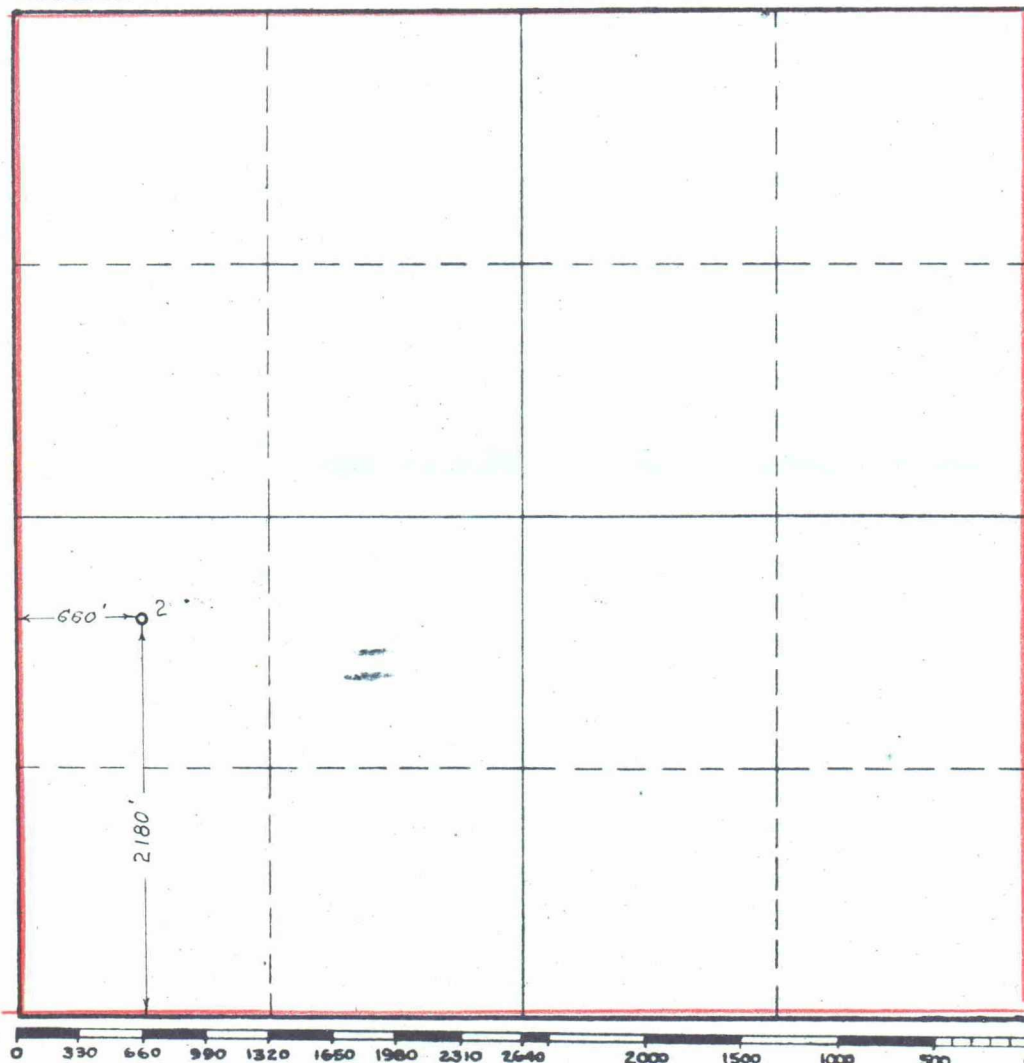

This is to certify that the information in Section A above is true and complete to the best of my knowledge and belief.

HUMBLE OIL & REFG. CO

(Operator)

Kenneth E. McAdams  
(Representative)

Assistant Division Supt.  
Box 1600 Midland, Texas  
Address

This is to certify that the well location shown on the plat in Section B was plotted from field notes of actual surveys made by me or under my supervision and that the same is true and correct to the best of my knowledge and belief.

Date Surveyed 8-13-57

E. T. Shahan  
Registered Professional  
Engineer and/or Land Surveyor.

Certificate No. 1513

LEASE NO. 22312

W-A - 1693



NEW MEXICO  
OIL CONSERVATION COMMISSION

Gas Well Plat

Date 8-27-57

HUMBLE OIL & REFINING CO.

EUMONT GAS UNIT NO.1

1 & 2

Operator

Lease

Well No.

Name of Producing Formation QUEENS GAS Pool EUMONT

No. Acres Dedicated to the Well 640

SECTION 4 TOWNSHIP -20-S RANGE -37-E

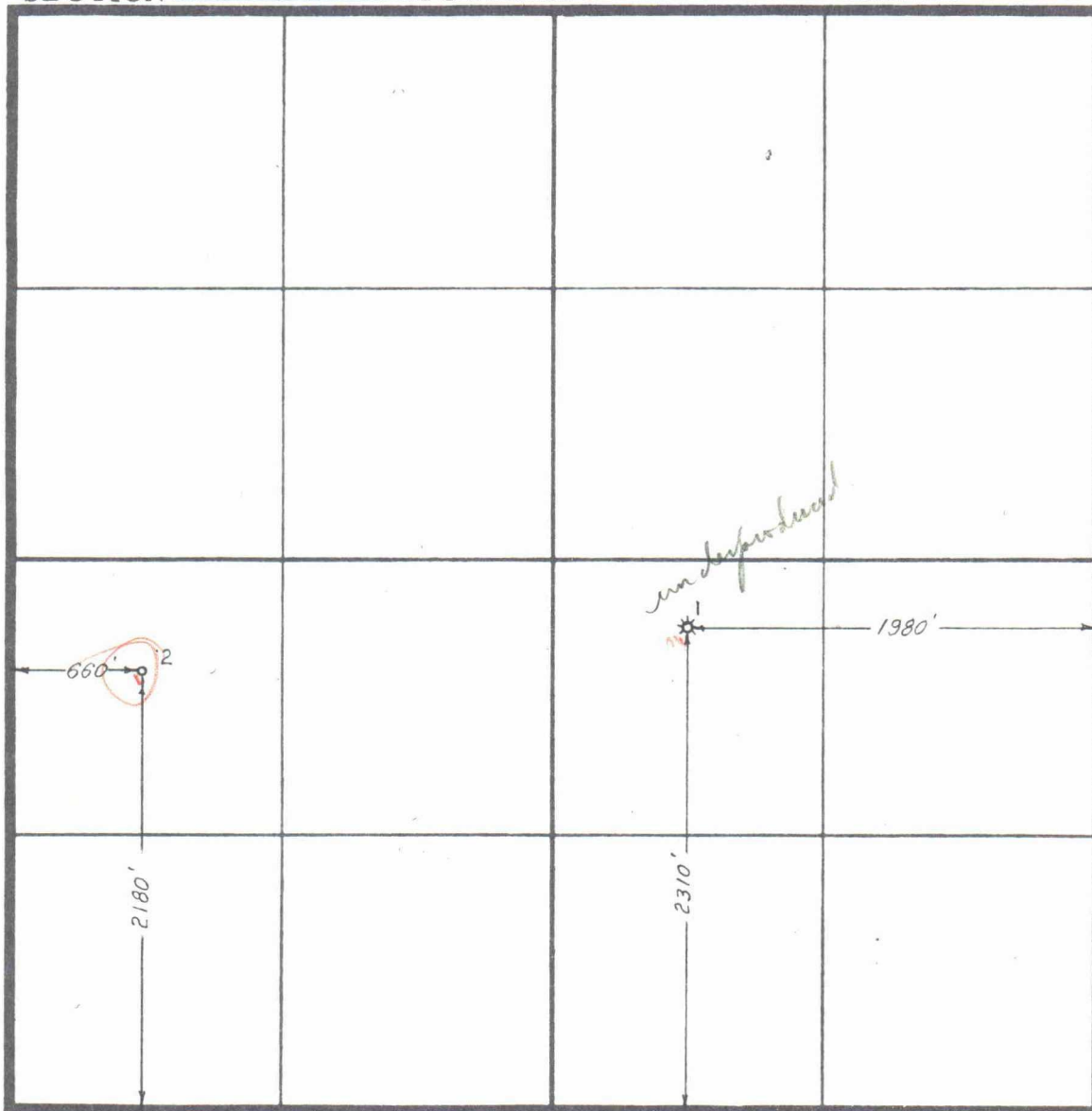

I hereby certify that the information given above is true and complete to the best of my knowledge.

1. Is this gas well a dual completion? ~~Yes~~ No
2. Are there any other dually completed wells within the dedicated acreage? Yes No

Name Mary E. Meadows  
Position ASSISTANT DIVISION SUPERINTENDENT  
Representing HUMBLE OIL & REFINING CO  
Address BOX 1600 MIDLAND, TEXAS

LEASE 22312

W-A 1693

