

T-17-S

LEGENDE

PROPOSED LINE

ALTERNATE LINE

BEFORE EXAMINER NUTTER

OIL CONSERVATION

EXHIBIT
ZC

CASE NO

208

A = 1.375 miles

075

0 0
0 0
0 0
0 0

$$C = 0.812$$
$$D = 0.750$$
$$F = 0.250$$

PHILLIPS PETROLEUM CO
BARTLESVILLE, OKLAHOMA

VACUUM POOL - SANTA FE LEASE

LEA COUNTY NEW MEXICO

A.F.E.
NO.

No.

SCA

$A'' = 1 \text{ MILE}$

DW

20

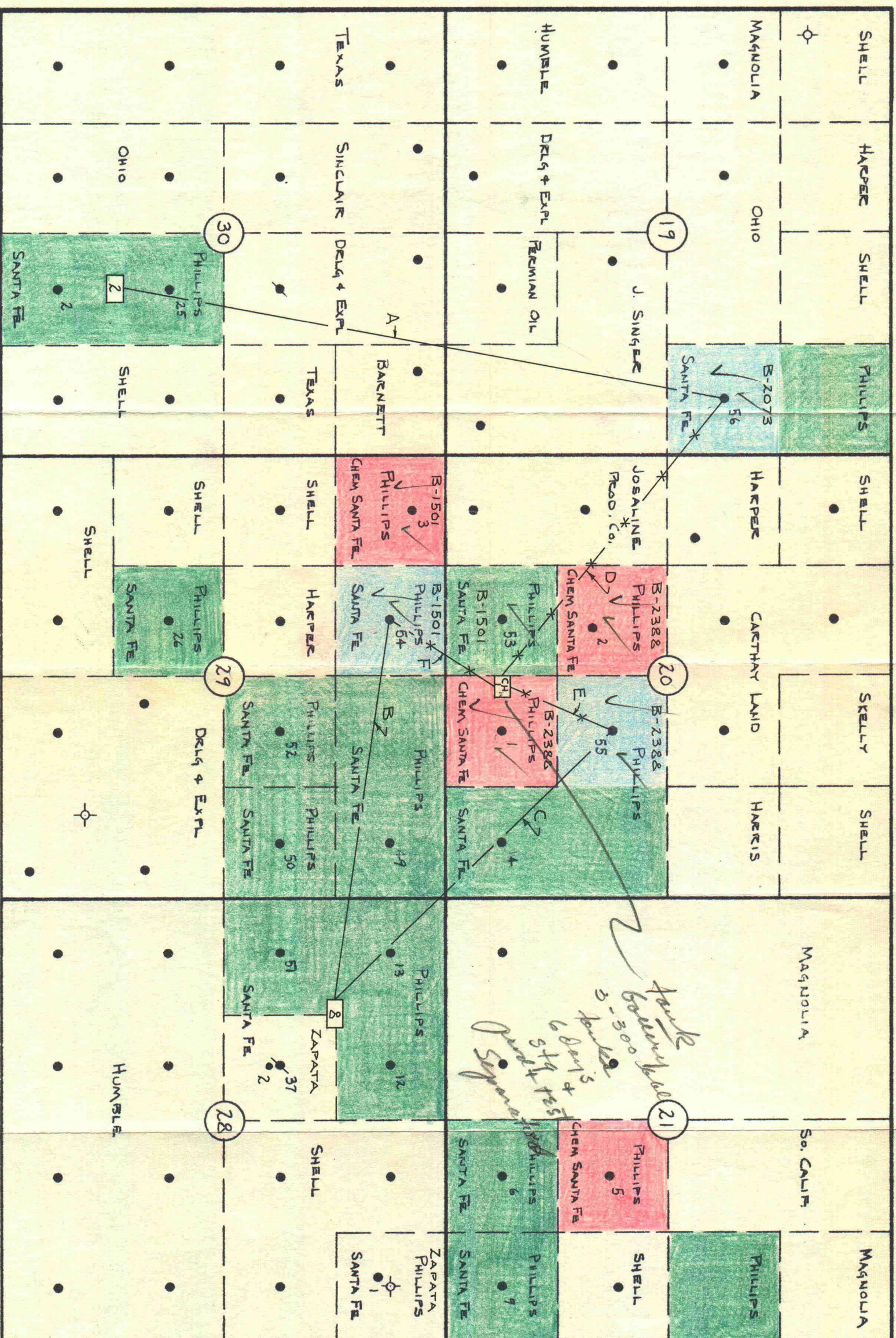

BEFORE EXAMINER NUTTER

OIL CONSERVATION COMMISSION

Appl EXHIBIT NO. 2

CASE NO. 2081

Refer Reply To:
Oil & Gas Royalty Division

September 14, 1960

Case file
2081

Phillips Petroleum Company
P. O. Box 791
Midland, Texas

Attention: Carl W. Jones

Gentlemen:

Permit is hereby granted to you to commingle the Grayburg-San Andres
production from six 40-acre tracts in Township 17 South, Range 35 East,
as outlined in your application, Lea County, New Mexico.

All of this acreage is committed to one beneficiary, that being Common
Schools.

Sincerely yours,

MURRAY E. MORGAN,
Commissioner of Public Lands
ET:

Ted Hilberry, Supervisor
Oil & Gas Royalty Division

TB:ML

cc: Mr. Charles C. Spann
904 Sims Building
Albuquerque, New Mexico

cc: Oil Conservation Commission
P. O. Box 871
Santa Fe, New Mexico

ILLEGIBLE

C
O
P
Y

State of New Mexico



Commissioner of Public Lands

MURRAY E. MORGAN
COMMISSIONER



P.O. BOX 791
SANTA FE, NEW MEXICO

Sept. 23, 1960

Oil & Gas Division

*Amended applicant's
Exhibit # 2
Case 2081*

Oil Conservation Commission
State Capitol Building
Santa Fe, New Mexico

Gentlemen:

On September 16, 1960, permission was granted to Phillips Petroleum Company to commingle the Grayburg-San Andres production from six 40-acre tracts in Twp. 17S, Range 35E, which acreage is embraced under State Leases B-1501, B-2388, and B-2073.

We have been requested to include the SE $\frac{1}{4}$ SW $\frac{1}{4}$, Section 20, Twp. 17S, Range 35E, which acreage is also embraced in Lease No. B-2388, in the approval to commingle. It is our understanding that an amended request was filed with the Oil Conservation Commission to include this 40-acre tract, making a total of seven 40-acre tracts. This acreage also belongs to the same beneficiary, that is Common Schools, therefore, permission is hereby granted to commingle the production from this 40-acre tract with the production from the six 40-acre tracts, where permission has already been granted.

Very truly yours,

MURRAY E. MORGAN
COMMISSIONER OF PUBLIC LANDS

By:

Ted Bilberry

Ted Bilberry, Supervisor
Oil and Gas Division

TB:jr

cc: Carl W. Jones
Charles C. Spann