

STATE	
FILE	
U.S.G.A.	
LAND OFFICE	
TRANSPORTER	OIL
	GAS
PRODUCTION OFFICE	
OPERATOR	

BEST AVAILABLE COPY

MEXICO OIL CONSERVATION COMMISSION  
**WELL LOCATION AND ACREAGE DEDICATION PLAT**  
 SEE INSTRUCTIONS FOR COMPLETING THIS FORM ON THE REVERSE SIDE

**SECTION A**

Operator	S.P. Yates Etal	Lease	Knox Federal	Well No.	1
Unit Letter	0	Section	21	Township	T-19-S
		Range	R-30-E	County	Eddy
Actual Footage Location of Well: 660 feet from the South line and 1980 feet from the East line					
Ground Level Elev.	3318.7	Producing Formation		Pool	
				Dedicated Acreage:	40 Acres

1. Is the Operator the only owner in the dedicated acreage outlined on the plat below? YES  NO  . ("Owner" means the person who has the right to drill into and to produce from any pool and to appropriate the production either for himself or for himself and another. (65-3-29 (e) NMSA 1935 Comp.)
2. If the answer to question one is "no," have the interests of all the owners been consolidated by communitization agreement or otherwise? YES  NO  . If answer is "yes," Type of Consolidation \_\_\_\_\_
3. If the answer to question two is "no," list all the owners and their respective interests below:

Owner	Land Description

**SECTION B**

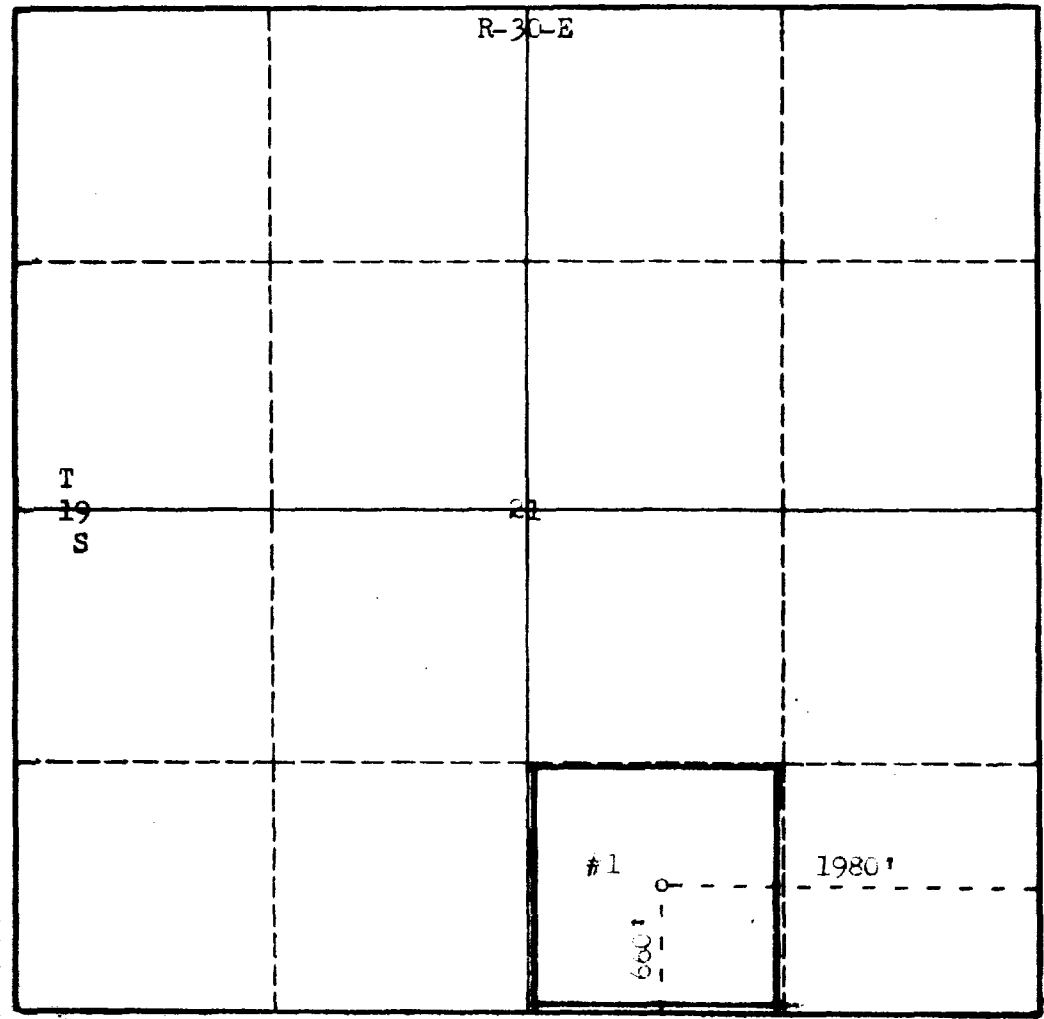

**CERTIFICATION**

I hereby certify that the information in SECTION A above is true and complete to the best of my knowledge and belief.

*R.W. Landenberger, Jr.*  
 Name  
 R.W. Landenberger, Jr.  
 Position  
 Geologist  
 Company  
 S.P. Yates  
 Date  
 11-13-61

I hereby certify that the well location shown on the plat in SECTION B was plotted from field notes of actual surveys made by me or under my supervision, and that the same is true and correct to the best of my knowledge and belief.

Date Surveyed  
 November 11, 1961  
 Registered Professional Engineer and/or Land Surveyor  
*[Signature]*  
 Certificate No. 32-30

