

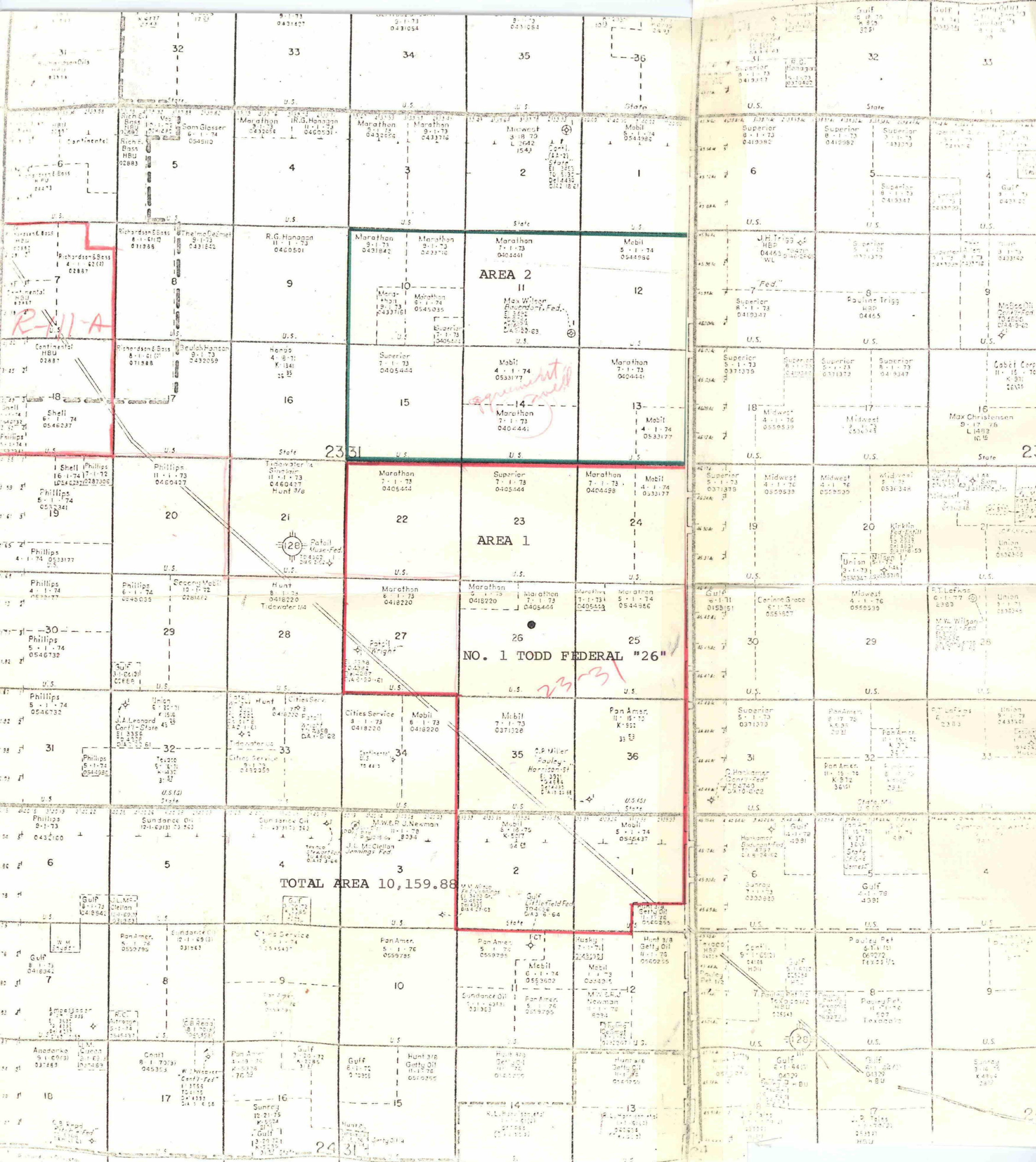

LARGE FORMAT  
EXHIBIT HAS  
BEEN REMOVED  
AND IS LOCATED  
IN THE NEXT FILE

LARGE FORMAT  
EXHIBIT HAS  
BEEN REMOVED  
AND IS LOCATED  
IN THE NEXT FILE







BEFORE EXAMINER UTZ  
C/L OF EXAMINING COMMISSION  
APP.                      /                       
4300

BEFORE EXAMINER NILTTER	
OIL CONSERVATION	EXHIBIT NO. 4
CASE NO. 4300	

(reopened)

31.2

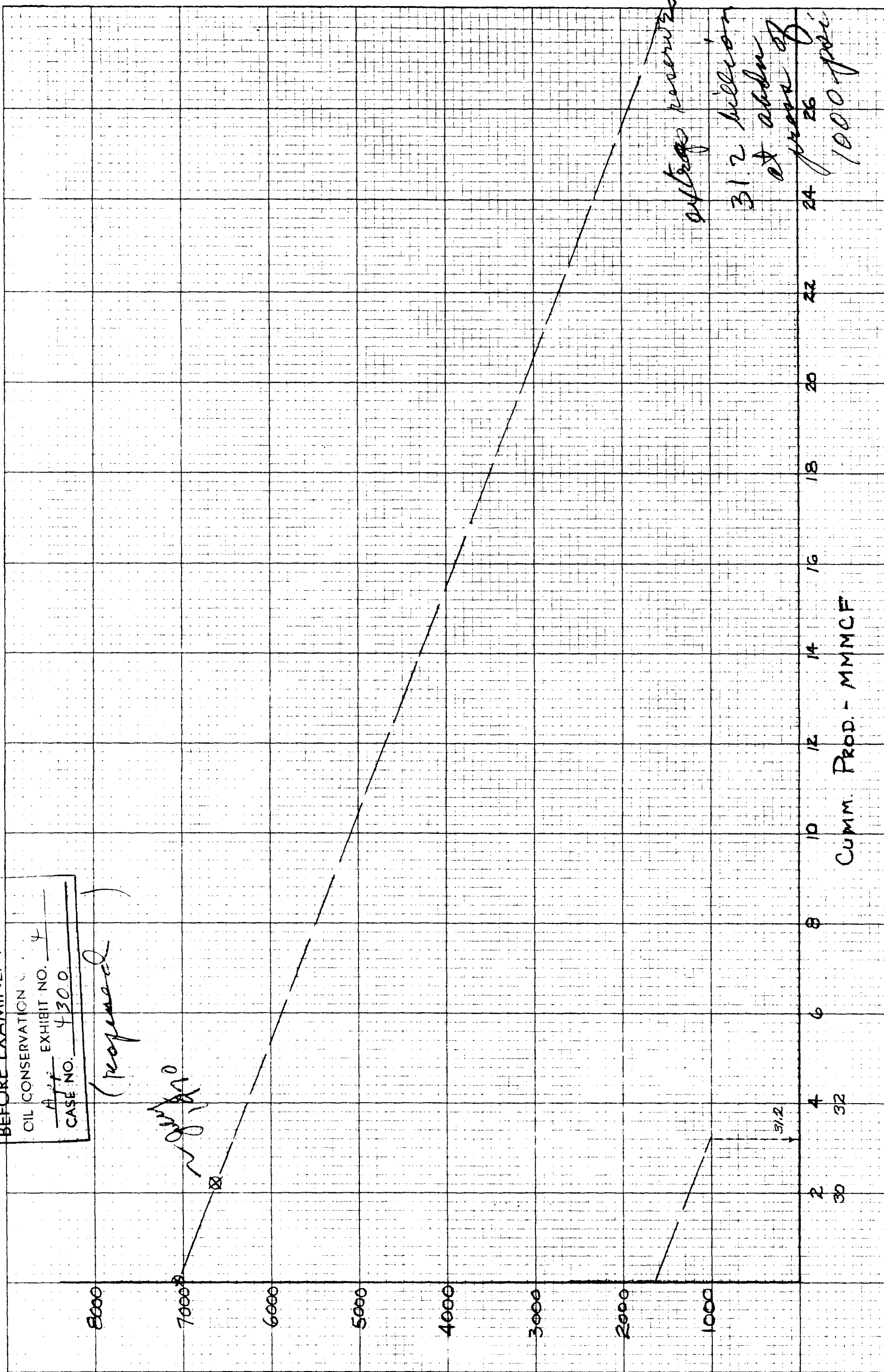

31.2 billion

of addn of

press of

1000 per

P/N

LARGE FORMAT  
EXHIBIT HAS  
BEEN REMOVED  
AND IS LOCATED  
IN THE NEXT FILE

LARGE FORMAT  
EXHIBIT HAS  
BEEN REMOVED  
AND IS LOCATED  
IN THE NEXT FILE