

AMERICAN HUNTER EXPLORATION

JICARILLA 24N (27-2)

SESW SECTION 24 T27N R2W

BEFORE EXAMINER CATANACH

OIL CONSERVATION DIVISION

AM. HUNTER EXHIBIT NO. 4

CASE NO. 10535-10538

SECTION 24

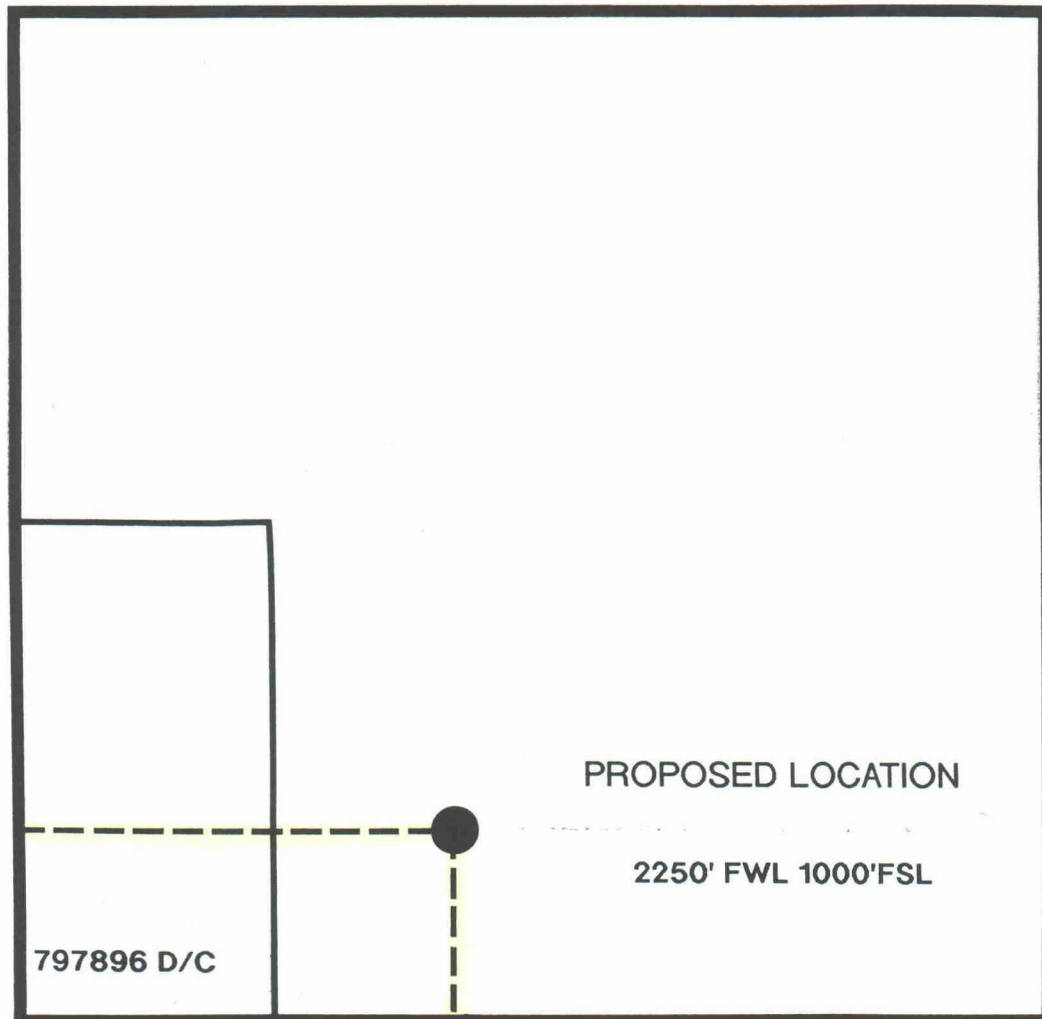

640 ACRES

SCALE: 1"=1000'

BLM MINERAL TITLE PLAT

AMERICAN HUNTER EXPLORATION

JICARILLA 24N-1 (27-2)

SESW SECTION 24 T27N R2W

PROPOSED LOCATION

2250' FWL 1000'FSL

FRACTURED TARGET AREA

SEISMIC LINE SHOT POINTS

LEAVRY CANYON QUAD.

$$1'' = 1000'$$

American Hunter Exploration, Ltd.
410 Seventeenth St., Suite 1220
Denver, CO 80202
Bus: (303) 825-5212



Jim

american hunter

July 20, 1992

BY FEDERAL EXPRESS

Earl Beecher
Bureau of Land Management
1235 La Plata Highway
Farmington, New Mexico 87401

RE: American Hunter Exploration Ltd.
NOS Submittals
T27N R2W
Rio Arriba Co., New Mexico

Dear Earl,

By this correspondence and enclosures, American Hunter Exploration submits a Notice of Staking for the following proposed wells:

- | | |
|--|--|
| 1) Jicarilla 2A (27-2)
Section 2 T27N R2W | 4) Jicarilla 14P (27-2)
Section 14 T27N R2W |
| 2) Jicarilla 6K (27-2)
Section 6 T27N R2W | 5) Jicarilla 24N (27-2)
Section 24 T27N R2W |
| 3) Jicarilla 18I (27-2)
Section 18 T27N R2W | 6) Jicarilla 28B (27-2)
Section 28 T27N R2W |

Such information is being supplied to you in advance of an APD for each, to allow preparatory work by affected departments within the BLM. .

Your cooperation in distributing and processing these applications is appreciated.

Very Truly Yours,

AMERICAN HUNTER EXPLORATION LTD.

James C. Lister
Senior Geologist

JCL:mh
Enclosure

cc: Bruce Thistle/w attachments
Don Snyder
Don Myers

NOTICE OF STAKING (Not to be used in place of Application for Permit to Drill Form 3160-3)		6. Lease Number <div style="text-align: center; font-size: 1.5em;">N/A</div>	
1. Oil Well <input checked="" type="checkbox"/> Gas Well <input type="checkbox"/> Other <input type="checkbox"/> (Specify)		7. If Indian Allottee or Tribe Name Jicarilla - Apache Contract # 701-90-0001	
2. Name of Operator American Hunter Exploration, Ltd.		8. Unit Agreement Name <div style="text-align: center; font-size: 1.5em;">N/A</div>	
3. Name of Specific Contact Person Jim Lister		9. Farm or Lease Name Jicarilla 24N (27-2)	
4. Address and Telephone Number of Operator or Agent 410 17th St. Suite 1220 Denver Colo. 80202 303-825-5212		10. Well Number <div style="text-align: center; font-size: 1.5em;">#1</div>	
5. Surface Location of Well <div style="font-size: 1.2em;">2250' FWL, 1000' FSL (sesw)</div> Attach: a) Sketch showing road entry onto pad, pad dimensions and reserve pit. b) Topographical or other acceptable map showing location, access road and lease boundaries.		11. Field or Wildcat Name (WILDCAT) Right Hand Canyon Prospect <hr/> 12. Section, Twnshp, Range, Meridian or Blk and Survey of Area <div style="font-size: 1.2em;">Section 24 T27N R2W</div>	
15. Formation Objective(s) Cretaceous Mancos	16. Estimated Well Depth <div style="font-size: 1.5em;">7800'</div>	13. County, Parish or Borough Rio Arriba	14. State New Mexico
Additional information (as appropriate; must include surface owner's name, address and telephone number)			
Jicarilla Apache Tribe P.O. Box 507 Dulce, New Mexico 87528		Attn: Thurman Velarde O & G Administrator 505-759-3485 / 759-3242	
18. Signed <u>James Cluth</u>		Title Senior Exploration Geologist Date 7/20/92	

Note: Upon receipt of this Notice, the Bureau of Land Management (BLM) will schedule the date of the onsite predrill inspection and notify you accordingly. The location must be staked and access road must be flagged prior to the onsite.

Operators must consider the following prior to the onsite:

- a) H2S Potential
- b) Cultural Resources (Archaeology)
- c) Federal Right of Way or Special Use Permit

