

Submit to Appropriate
District Office
State Lease - 4 copies
Fee Lease - 3 copies

State of New Mexico
Energy, Minerals and Natural Resources Department

Form C-102
Revised 1-1-89

OIL CONSERVATION DIVISION

P.O. Box 2088
Santa Fe, New Mexico 87504-2088

DISTRICT I
P.O. Box 1980, Hobbs, NM 88240

DISTRICT II
P.O. Drawer DD, Artesia, NM 88210

DISTRICT III
1000 Rio Brazos Rd., Artec, NM 87410

WELL LOCATION AND ACREAGE DEDICATION PLAT

All Distances must be from the outer boundaries of the section

Operator CONOCO INC.			Lease BARBARA FEDERAL		Well No. 16
Unit Letter F	Section 18	Township 19 SOUTH	Range 25 EAST	NMPM	County EDDY
Actual Footage Location of Well: 1980 feet from the NORTH line and 1530 feet from the WEST line					
Ground Level Elev. 3605.0	Producing Formation Cisco	Pool North Dagger Draw		Dedicated Acreage: 160 Acres	

- Outline the acreage dedicated to the subject well by colored pencil or hatchure marks on the plat below.
- If more than one lease is dedicated to the well, outline each and identify the ownership thereof (both as to working interest and royalty).
- If more than one lease of different ownership is dedicated to the well, have the interest of all owners been consolidated by communitization, unitization, force-pooling, etc.?
☐ Yes ☐ No If answer is "yes" type of consolidation _____

If answer is "no" list of owners and tract descriptions which have actually been consolidated. (Use reverse side of this form necessary.)

No allowable will be assigned to the well unit all interests have been consolidated (by communitization, unitization, forced-pooling, otherwise) or until a non-standard unit, eliminating such interest, has been approved by the Division.

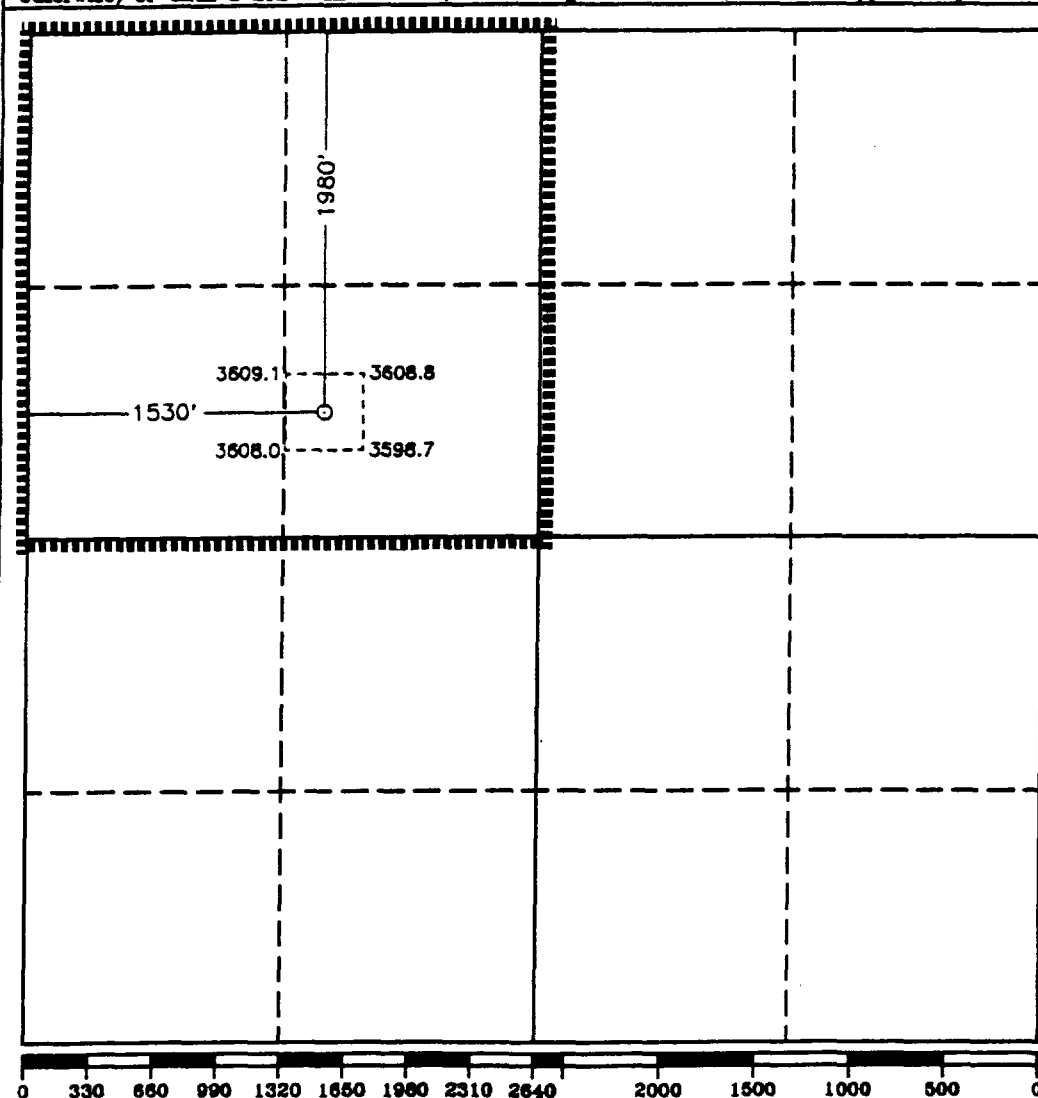

OPERATOR CERTIFICATION

I hereby certify the the information
contained herein is true and complete to the
best of my knowledge and belief.

Signature
Jerry W. Hoover

Printed Name
Jerry W. Hoover

Position
Sr. Conservation Coord.

Company
Conoco Inc.

Date
12/8/92

SURVEYOR CERTIFICATION

I hereby certify that the well location shown
on this plat was plotted from field notes of
actual surveys made by me or under my
supervision, and that the same is true and
correct to the best of my knowledge and
belief.

Date Surveyed
OCTOBER 21, 1992

Signature & Seal of
Professional Surveyor

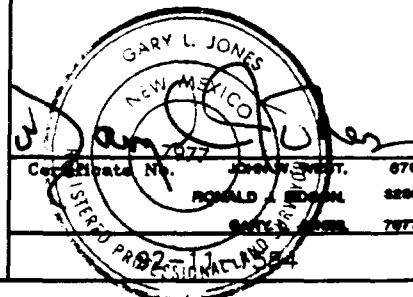

OIL CONSERVATION DIVISION

EXHIBIT NO. 2
CASE NO.: 10633
Submitted by: Conoco Inc.
Hearing Date: Dec. 17, 1992