

Submit to Appropriate
District Office
State Lease - 6 copies
Fee Lease - 5 copies
DISTRICT I
P.O. Box 1980, Hobbs, NM 88240

DISTRICT II
P.O. Drawers 1057
Santa Fe, New Mexico 87504-2088

DISTRICT III
1000 Rio Brazos Rd., Aztec, NM 87410

State of New Mexico
Energy, Minerals and Natural Resources Department
OIL CONSERVATION DIVISION
P.O. Box 2088
Santa Fe, New Mexico 87504-2088
OCT - 2 '90

Form C-105
Revised 1-1-89

WELL API NO.
30-005-62794

5. Indicate Type of Lease
STATE ☒ FEE ☐

6. State Oil & Gas Lease No.
L-794

7. Lease Name or Unit Agreement Name
Hanlad

8. Well No.
1

9. Pool name or Wildcat
Wildcat Penn.

WELL COMPLETION OR RECOMPLETION REPORT AND LOG

1a. Type of Well:
OIL WELL ☐ GAS WELL ☒ DRY ☐ OTHER _____

b. Type of Completion:
NEW WELL ☒ WORK OVER ☐ DEEPEN ☐ PLUG BACK ☐ DEEP RESER ☐ OTHER _____

2. Name of Operator
Stevens Operating Corporation ✓

3. Address of Operator
P. O. Box 2408, Roswell, New Mexico 88202

4. Well Location
Unit Letter K: 1980 Feet From The South Line and 2310 Feet From The West Line
Section 16 Township 10S Range 27E NMPM Chaves County

10. Date Spudded
8-10-90

11. Date T.D. Reached
9-6-90

12. Date Compl. (Ready to Prod.)
10-1-90

13. Elevations (DFA, RKB, RT, GR, etc.)
3889 GR, 3901 KB

14. Elev. Casinghead
3889

15. Total Depth
6986'

16. Plug Back T.D.
6986'

17. If Multiple Compl. How Many Zones?
1

18. Intervals Drilled By
Rotary Tools
0-TD

19. Producing Interval(s), of this completion - Top, Bottom, Name
6547-98 Pennsylvanian

20. Was Directional Survey Made
NO

21. Type Electric and Other Logs Run
GR-CNL-FDC, DLL, MSFL

22. Was Well Cored
NO

23. **CASING RECORD (Report all strings set in well)**

CASING SIZE	WEIGHT LB./FT.	DEPTH SET	HOLE SIZE	CEMENTING RECORD	AMOUNT PULLED
16"		30'	20"	RediMix	
10 3/4"	40.5 lb.	1006'	14 3/4"	Circulate to Surface	
5 1/2"	17 lb.	6986'	8 3/4"	W/420 sxs cmt top 5500'	

24. **LINER RECORD**

SIZE	TOP	BOTTOM	SACKS CEMENT	SCREEN

25. **TUBING RECORD**

SIZE	DEPTH SET	PACKER SET
2 3/8	6584	None

26. Perforation record (interval, size, and number)
6547, 51, 52 1/2, 53 1/2, 57, 61, 63, 64, 67
6584, 86, 88, 90, 92, 94, 96, 98, 6600

27. **ACID, SHOT, FRACTURE, CEMENT, SQUEEZE, ETC.**

DEPTH INTERVAL	AMOUNT AND KIND MATERIAL USED
6547-67	A/3000gls 7 1/2% Frac 3000#
6584-98	A/1500gls MA, Frac 1200#

28. **PRODUCTION**

Date First Production _____ Production Method (Flowing, gas lift, pumping - Size and type pump) _____ Well Status (Prod. or Shut-in) SI

Flowing

Date of Test	Hours Tested	Choke Size	Prod'n For Test Period	Oil - Bbl.	Gas - MCF	Water - Bbl.	Gas - Oil Ratio
10-1-90	4	1"			168	1	

Flow Tubing Press.	Casing Pressure	Calculated 24-Hour Rate	Oil - Bbl.	Gas - MCF	Water - Bbl.	Oil Gravity - API - (Corr.)
				1005	6	

29. Disposition of Gas (Sold, used for fuel, vented, etc.) _____ Test Witnessed By Al Cho

30. List Attachments
GR-CNL-FDL, DLL, Micro-FSL

31. I hereby certify that the information shown on both sides of this form is true and complete to the best of my knowledge and belief

Printed Donald G. Stevens Title President Date 10-2-90

INSTRUCTIONS

This form is to be filed with the appropriate District Office of the Division not later than 20 days after the completion of any newly-drilled or deepened well. It shall be accompanied by one copy of all electrical and radio-activity logs run on the well and a summary of all special tests conducted, including drill stem tests. All depths reported shall be measured depths. In the case of directionally drilled wells, true vertical depths shall also be reported. For multiple completions, Items 25 through 29 shall be reported for each zone. The form is to be filed in quintuplicate except on state land, where six copies are required. See Rule 1105.

INDICATE FORMATION TOPS IN CONFORMANCE WITH GEOGRAPHICAL SECTION OF STATE

Southeastern New Mexico

Northwestern New Mexico

T. Anhy _____	T. Canyon _____	T. Ojo Alamo _____	T. Penn. "B" _____
T. Salt _____	T. Strawn _____	T. Kirtland-Fruitland _____	T. Penn. "C" _____
B. Salt _____	T. Atoka _____	T. Pictured Cliffs _____	T. Penn. "D" _____
T. Yates _____	T. Miss 6624	T. Cliff House _____	T. Leadville _____
T. 7 Rivers _____	T. Devonian _____	T. Menefee _____	T. Madison _____
T. Queen _____	T. Silurian Fusselman 6719	T. Point Lookout _____	T. Elbert _____
T. Grayburg _____	T. Montoya _____	T. Mancos _____	T. McCracken _____
T. San Andres 1513	T. Simpson _____	T. Gallup _____	T. Ignacio Otzte _____
T. Glorieta 2560	T. McKee _____	Base Greenhorn _____	T. Granite _____
T. Paddock _____	T. Ellenburger _____	T. Dakota _____	T. _____
T. Blinebry _____	T. Gr. Wash _____	T. Morrison _____	T. _____
T. Tubb _____	T. Delaware Sand _____	T. Todilto _____	T. _____
T. Drinkard _____	T. Bone Springs _____	T. Entrada _____	T. _____
T. Abo 4988	T. _____	T. Wingate _____	T. _____
T. Wolfcamp 5716	T. _____	T. Chinle _____	T. _____
T. Penn _____	T. _____	T. Permian _____	T. _____
T. Cisco (Bough C) 6039	T. _____	T. Penn "A" _____	T. _____

OIL OR GAS SANDS OR ZONES

No. 1, from 6547 to 67 Gas
 No. 2, from 6584 to 98 Gas
 No. 3, from _____ to _____
 No. 4, from _____ to _____

IMPORTANT WATER SANDS

Include data on rate of water inflow and elevation to which water rose in hole.

No. 1, from _____ to _____ feet
 No. 2, from _____ to _____ feet
 No. 3, from _____ to _____ feet

LITHOLOGY RECORD (Attach additional sheet if necessary)

From	To	Thickness in Feet	Lithology	From	To	Thickness in Feet	Lithology
0	240	24	Sand & Shale				
240	446	206	Shale & Sand				
446	1265	819	Anhydrite, Sand & Shale				
1265	1512	247	Salt, Anhy, Sand & Shale				
1512	2214	702	Dolomite, Anhydrite				
2214	2560	346	Limestone				
2560	4988	2428	Sand, Shale, Anhy, Salt				
4988	5612	624	Shale & Anhydrite				
5612	5716	104	Dolomite & Anhydrite				
5716	6039	323	Lime, Shale, Sand				
6039	6624	585	Lime, & Shale				
6624	6717	93	Lime, Chert, Shale				
6717	6986	269	Dolomite, Chert				

Submit to Appropriate
District Office
State Lease - 4 copies
Fee Lease - 3 copies

State of New Mexico
Energy, Minerals and Natural Resources Department

RECEIVED

Form C-102
Revised 1-1-89

NOV 9 '90

OIL CONSERVATION DIVISION

P.O. Box 2088
Santa Fe, New Mexico 87504-2088

O. C. D.
ARTESIA, OFFICE

DISTRICT I
P.O. Box 1980, Hobbs, NM 88240

DISTRICT II
P.O. Drawer DD, Artesia, NM 88210

DISTRICT III
1000 Rio Brazos Rd., Aztec, NM 87410

WELL LOCATION AND ACREAGE DEDICATION PLAT

All Distances must be from the outer boundaries of the section

Operator Stevens Operating Company		Lease Hanlad State		Well No. 1
Unit Letter K	Section 16	Township 10 South	Range 27 East	County Chaves
Actual Footage Location of Well: 1980 feet from the South line and 2310 feet from the West line				
Ground level Elev. 3889' GR	Producing Formation Pennsylvanian	Pool Diablo WK Penn	Dedicated Acreage: 320 Acres	

1. Outline the acreage dedicated to the subject well by colored pencil or hatchure marks on the plat below.
2. If more than one lease is dedicated to the well, outline each and identify the ownership thereof (both as to working interest and royalty).
3. If more than one lease of different ownership is dedicated to the well, have the interest of all owners been consolidated by communization, unitization, force-pooling, etc.?
☐ Yes ☐ No If answer is "yes" type of consolidation _____
If answer is "no" list the owners and tract descriptions which have actually been consolidated. (Use reverse side of this form if necessary).
No allowable will be assigned to the well until all interests have been consolidated (by communization, unitization, forced-pooling, or otherwise) or until a non-standard unit, eliminating such interest, has been approved by the Division.

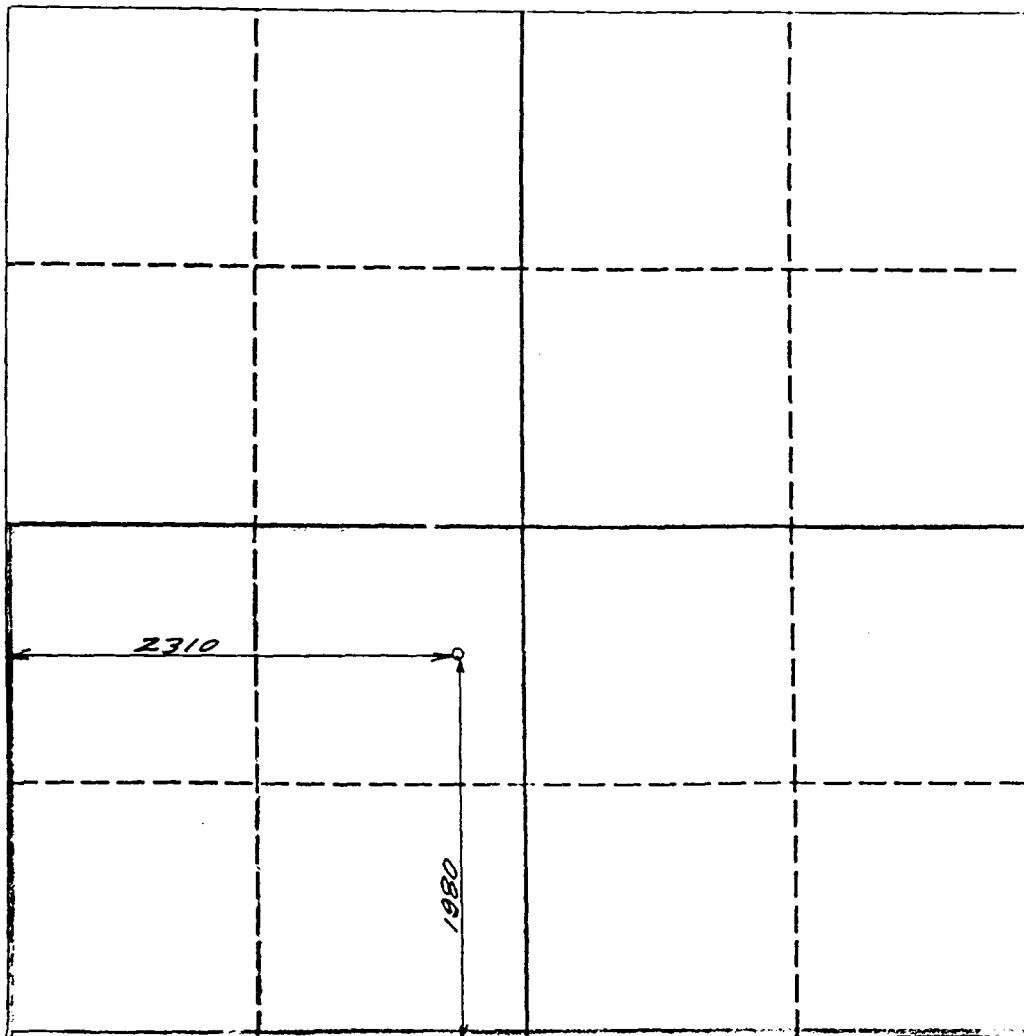

OPERATOR CERTIFICATION

I hereby certify that the information contained herein is true and complete to the best of my knowledge and belief.

Signature *Bob Farmer*
Printed Name **Bob Farmer**
Position **Production Supt.**
Company **Stevens Oper. Corp.**
Date **August 8, 1990**

SURVEYOR CERTIFICATION

I hereby certify that the well location shown on this plat was plotted from field notes of actual surveys made by me or under my supervision, and that the same is true and correct to the best of my knowledge and belief.

Date Surveyed **August 8, 1990**
Signature & Seal of Professional Surveyor
F. R. Pachon
8142
Certificate No. _____

Submit 3 Copies
to Appropriate
District Office

Oil Conservation Division
New Mexico
Energy, Minerals and Natural Resources Department

Form C-103
Revised 1-1-89

DISTRICT I
P.O. Box 1980, Hobbs, NM 88240

DISTRICT II
P.O. Drawer DD, Artesia, NM 88210

DISTRICT III
1000 Rio Brazos Rd., Aztec, NM 87410

OIL CONSERVATION DIVISION

P.O. Box 2088
Santa Fe, New Mexico 87504-2088

WELL API NO.

30-005-62794

5. Indicate Type of Lease

STATE ☒

FEE ☐

6. State Oil & Gas Lease No.

L-794

7. Lease Name or Unit Agreement Name

Hanlad State

8. Well No.

1

9. Pool name or Wildcat

Diablo W/C Penn

SUNDRY NOTICES AND REPORTS ON WELLS
(DO NOT USE THIS FORM FOR PROPOSALS TO DRILL OR TO DEEPEN OR PLUG BACK TO A
DIFFERENT RESERVOIR. USE "APPLICATION FOR PERMIT"
(FORM C-101) FOR SUCH PROPOSALS.)

1. Type of Well:

OIL
WELL ☐

GAS
WELL ☒

OTHER

2. Name of Operator

Stevens Operating Corporation

3. Address of Operator

P. O. Box 2408, Roswell, New Mexico 88202

4. Well Location

Unit Letter K : 1980 Feet From The South Line and 2310 Feet From The West Line

Section 16

Township 10S

Range 27E

NMPM

Chaves

County

10. Elevation (Show whether DF, RKB, RT, GR, etc.)

3889 GR. 3901 KB

11. Check Appropriate Box to Indicate Nature of Notice, Report, or Other Data

NOTICE OF INTENTION TO:

PERFORM REMEDIAL WORK ☐

PLUG AND ABANDON ☐

TEMPORARILY ABANDON ☐

CHANGE PLANS ☐

PULL OR ALTER CASING ☐

OTHER: ☐

SUBSEQUENT REPORT OF:

REMEDIAL WORK ☐ ALTERING CASING ☐

COMMENCE DRILLING OPNS. ☐ PLUG AND ABANDONMENT ☐

CASING TEST AND CEMENT JOB ☒

OTHER: Completion ☒

12. Describe Proposed or Completed Operations (Clearly state all pertinent details, and give pertinent dates, including estimated date of starting any proposed work) SEE RULE 1103.

Ran 5 1/2 17# casing to TD 6986, cemented with 420 sxs 63/35 POZ, w. 10 Halad-4, 3/10 CFR3, 5# salt, 3# gilsonite, Plug down 12:40 pm 9-7-90, Temp. survey showed cement top @ 5500'. WOC 72 hours. Perf 6547-67, A/1500g 7 1/2%, Frac 1200#, Perf 6547-67, A/3000g 7 1/2%, Frac 3000#.

I hereby certify that the information above is true and complete to the best of my knowledge and belief.

SIGNATURE Donald G. Stevens TITLE President DATE Oct. 2, 1990

TYPE OR PRINT NAME Donald G. Stevens TELEPHONE NO. 622-7273

(This space for State Use)

APPROVED BY [Signature] TITLE SUPERVISOR, DISTRICT II DATE NOV 16 1990

CONDITIONS OF APPROVAL, IF ANY:

Submit 3 Copies
to Appropriate
District Office

State of New Mexico
Energy, Minerals and Natural Resources Department

Form C-103
Revised 1-1-89

DISTRICT I
P.O. Box 1980, Hobbs, NM 88240

DISTRICT II
P.O. Drawer DD, Artesia, NM 88210

DISTRICT III
1000 Rio Brazos Rd., Aztec, NM 87410

OIL CONSERVATION DIVISION

Santa Fe, New Mexico 87504-2088

SEP 05 '90

WELL API NO.

30-005-62794

5. Indicate Type of Lease

STATE ☒

FEE ☐

6. State Oil & Gas Lease No.

L-794

SUNDRY NOTICES AND REPORTS ON WELLS
(DO NOT USE THIS FORM FOR PROPOSALS TO DRILL OR TO DEEPEN OR PLUG BACK TO A
DIFFERENT RESERVOIR. USE "APPLICATION FOR PERMIT"
(FORM C-101) FOR SUCH PROPOSALS.)

1. Type of Well:

OIL
WELL ☒

GAS
WELL ☐

OTHER

2. Name of Operator

Stevens Operating Corporation

3. Address of Operator

P. O. Box 2408, Roswell, New Mexico 88202

4. Well Location

Unit Letter K : 1980 Feet From The South Line and 2310 Feet From The West Line

Section 16

Township 10S

Range 27E

NMPM Chaves

County

10. Elevation (Show whether DF, RKB, RT, GR, etc.)

3889 GR, 3901 KB

11. Check Appropriate Box to Indicate Nature of Notice, Report, or Other Data

NOTICE OF INTENTION TO:

PERFORM REMEDIAL WORK ☐

PLUG AND ABANDON ☐

TEMPORARILY ABANDON ☐

CHANGE PLANS ☐

PULL OR ALTER CASING ☐

OTHER: ☐

SUBSEQUENT REPORT OF:

REMEDIAL WORK ☐ ALTERING CASING ☐

COMMENCE DRILLING OPNS. ☒ PLUG AND ABANDONMENT ☐

CASING TEST AND CEMENT JOB ☒

OTHER: ☐

12. Describe Proposed or Completed Operations (Clearly state all pertinent details, and give pertinent dates, including estimated date of starting any proposed work) SEE RULE 1103.

August 10, 1990 Rig up Frank's Rat Hole Service, spud @1:25 a.m. 08/10/90. Drilled 40' of 20" surface hole, ran 40'/16" surface Csg., sealed in w/2 1/2 yards Ready Mix.

August 12, 1990 L & M Rig #1 - Rig up, commenced drilling 5:00 p.m.

August 13, 1990 Ran 25 Jts 10 3/4" 40.6# Csg, set @1006', Cmt. w/100 sxs thick set class "C" cmt., 1/2# flo seal, 10# gilsonite, 3%CaCl2 + 450 sxs halite, 1/2# flo seal, 10# gilsonite and 2% CaCl2 and tail in w/250 sxs class "C" cmt., 2% CaCl2. Plug down 5:00 a.m. 08/14/90. Cmt. did not circulate to surface.

August 14, 1990 Ran 1" pipe & Cmt. w/225 sxs class "C" cmt., 2% CaCl2 1 1/2 hrs, WOC 18 hrs., Pressure up 1000# for 30 min. logging no pressure decrease.

I hereby certify that the information above is true and complete to the best of my knowledge and belief.

SIGNATURE Robert C. Farmer TITLE Production Supt. DATE Sept. 4, 1990

TYPE OR PRINT NAME Robert C. Farmer TELEPHONE NO. 505-622-7273

(This space for State Use)

APPROVED BY Mark Williams TITLE SUPERVISOR, DISTRICT II DATE SEP 11 1990

CONDITIONS OF APPROVAL, IF ANY:

Submit to Appropriate
District Office
State Lease - 8 copies
Fee Lease - 5 copies

DISTRICT I
P.O. Box 1980, Roswell, NM 88201

DISTRICT II
P.O. Drawer DD, Artesia, NM 88210

DISTRICT III
1000 Rio Brazos Rd., Aztec, NM 87410

State of New Mexico

Energy, Minerals and Natural Resources Department

Form C-101
Revised 1-1-89

Santa Fe, New Mexico 87504-2088

AUG -9 '90

API NO. (assigned by OCD on New Wells)

30-105-62794

5. Indicate Type of Lease

STATE ☒

FEE ☐

6. State Oil & Gas Lease No.

L-794

APPLICATION FOR PERMIT TO DRILL, DEEPEN, OR PLUG BACK

1a. Type of Work:

DRILL ☒

RE-ENTER ☐

DEEPEN ☐

PLUG BACK ☐

b. Type of Well:

OIL
WELL ☒

GAS
WELL ☐

OTHER ☐

SINGLE
ZONE ☒

MULTIPLE
ZONE ☐

7. Lease Name or Unit Agreement Name

Hanlad State

2. Name of Operator

Stevens Operating Corporation

8. Well No.

#1

3. Address of Operator

P. O. Box 2203, Roswell, New Mexico 88201

9. Pool name or Wildcat

Diablo Fusselman

4. Well Location

Unit Letter K : 1980 Feet From The South Line and 2310 Feet From The West Line

Section 16

Township 10S

Range 27E

NMPM

Chaves

County

10. Proposed Depth

6800'

11. Formation

Fusselman

12. Rotary or C.T.

Rotary

13. Elevations (Show whether DF, RT, GR, etc.)

3889 GR

14. Kind & Status Plug. Bond

Statewide

15. Drilling Contractor

L & M Drilling

16. Approx. Date Work will start

August 10, 1990

17.

PROPOSED CASING AND CEMENT PROGRAM

SIZE OF HOLE	SIZE OF CASING	WEIGHT PER FOOT	SETTING DEPTH	SACKS OF CEMENT	EST. TOP
20"	16"		30'	Redi mix	
14 3/4"	10 3/4"	40.5#	1000'	Circ to Surface	
8 3/4"	7"	23#-26#	6800'	2000 sxs	2 Stage 900'

1. Proposed to drill to a depth of 6800'. All potential zones will be evaluated. If commercial production is indicated, well will be cased, cemented 2 stage back to surface casing with cement plug on bottom and tested.

APPROVAL VALID FOR 180 DAYS
PERMIT EXPIRES 2/5/90
UNLESS DRILLING UNDERWAY

IN ABOVE SPACE DESCRIBE PROPOSED PROGRAM: IF PROPOSAL IS TO DEEPEN OR PLUG BACK, GIVE DATA ON PRESENT PRODUCTIVE ZONE AND PROPOSED NEW PRODUCTIVE ZONE. GIVE BLOWOUT PREVENTER PROGRAM, IF ANY.

I hereby certify that the information above is true and complete to the best of my knowledge and belief.

SIGNATURE Bob Farmer TITLE Production Supt. DATE August 8, 1990

TYPE OR PRINT NAME Bob Farmer

505-622-7273

TELEPHONE NO.

(This space for State Use)

APPROVED BY Mike Walker

TITLE

SUPERVISOR, DISTRICT II

DATE

AUG 9 1990

CONDITIONS OF APPROVAL, IF ANY:

Submit to Appropriate
District Office
State Lease - 4 copies
Fee Lease - 3 copies

State of New Mexico
Energy, Minerals and Natural Resources Department

Form C-102
Revised 1-1-89

OIL CONSERVATION DIVISION

P.O. Box 2088
Santa Fe, New Mexico 87504-2088

DISTRICT I
P.O. Box 1980, Hobbs, NM 88240

DISTRICT II
P.O. Drawer DD, Artesia, NM 88210

DISTRICT III
1000 Rio Brazos Rd., Aztec, NM 87410

WELL LOCATION AND ACREAGE DEDICATION PLAT

All Distances must be from the outer boundaries of the section

Operator Stevens Operating Company			Lease Hanlad State		Well No. 1
Unit Letter K	Section 16	Township 10 South	Range 27 East	County Chaves	
Actual Footage Location of Well: 1980 feet from the South line and 2310 feet from the West line					
Ground level Elev. 3889' GR		Producing Formation Fusselman		Pool Diablo	Dedicated Acreage: 80 Acres

1. Outline the acreage dedicated to the subject well by colored pencil or hatchure marks on the plat below.
2. If more than one lease is dedicated to the well, outline each and identify the ownership thereof (both as to working interest and royalty).
3. If more than one lease of different ownership is dedicated to the well, have the interest of all owners been consolidated by communitization, unitization, force-pooling, etc.?
☐ Yes ☐ No If answer is "yes" type of consolidation _____
If answer is "no" list the owners and tract descriptions which have actually been consolidated. (Use reverse side of this form if necessary.) _____
No allowable will be assigned to the well until all interests have been consolidated (by communitization, unitization, forced-pooling, or otherwise) or until a non-standard unit, eliminating such interest, has been approved by the Division.

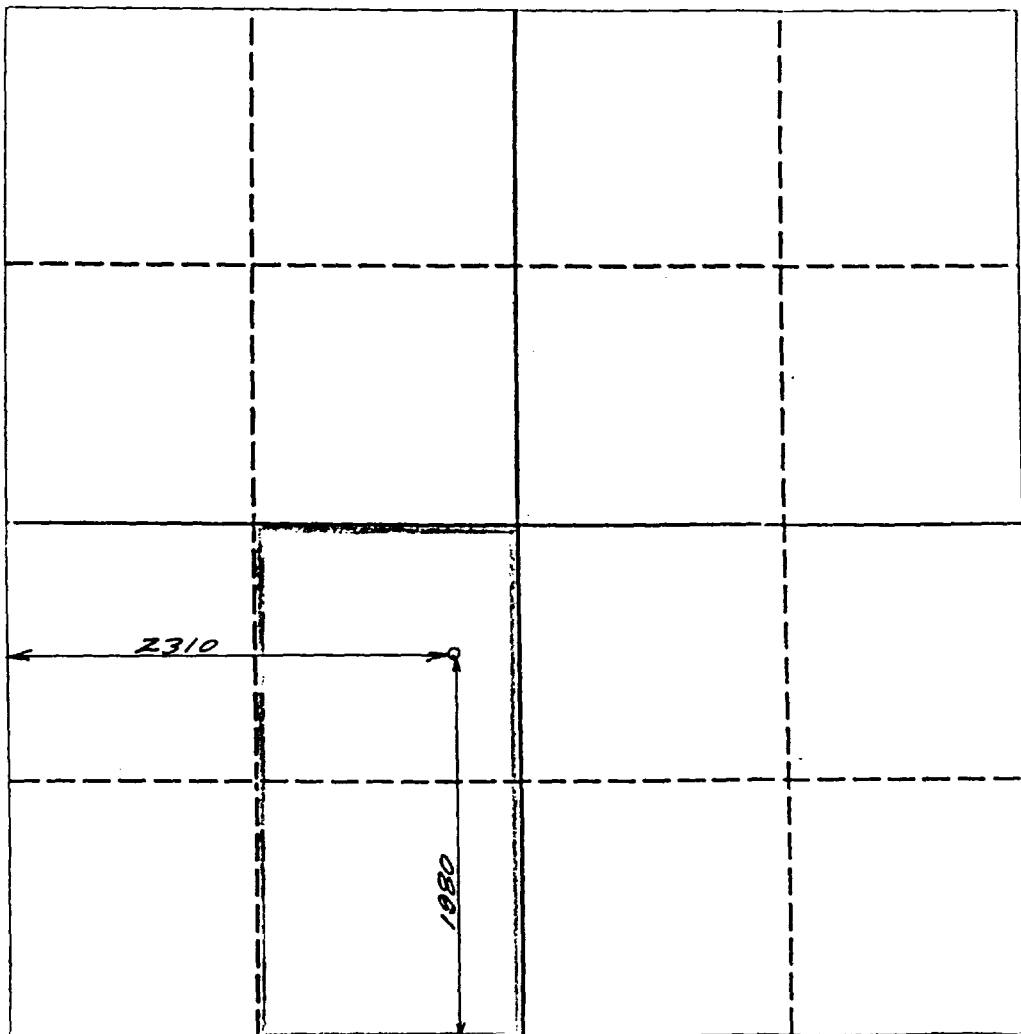

OPERATOR CERTIFICATION

I hereby certify that the information contained herein is true and complete to the best of my knowledge and belief.

Signature

Bob Farmer

Printed Name

Bob Farmer

Position

Production Supt.

Company

Stevens Oper. Corp.

Date

August 8, 1990

SURVEYOR CERTIFICATION

I hereby certify that the well location shown on this plat was plotted from field notes of actual surveys made by me or under my supervision, and that the same is true and correct to the best of my knowledge and belief.

Date Surveyed

August 8, 1990

Signature & Seal of
Professional Surveyor

P. R. Pacheco

Certificate No.

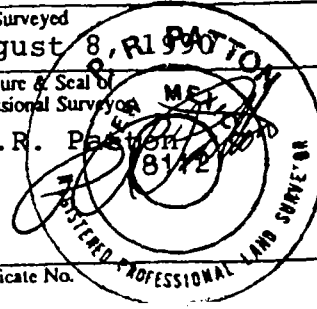

B O P & CHOKE MANIFOLD

SERIES 900

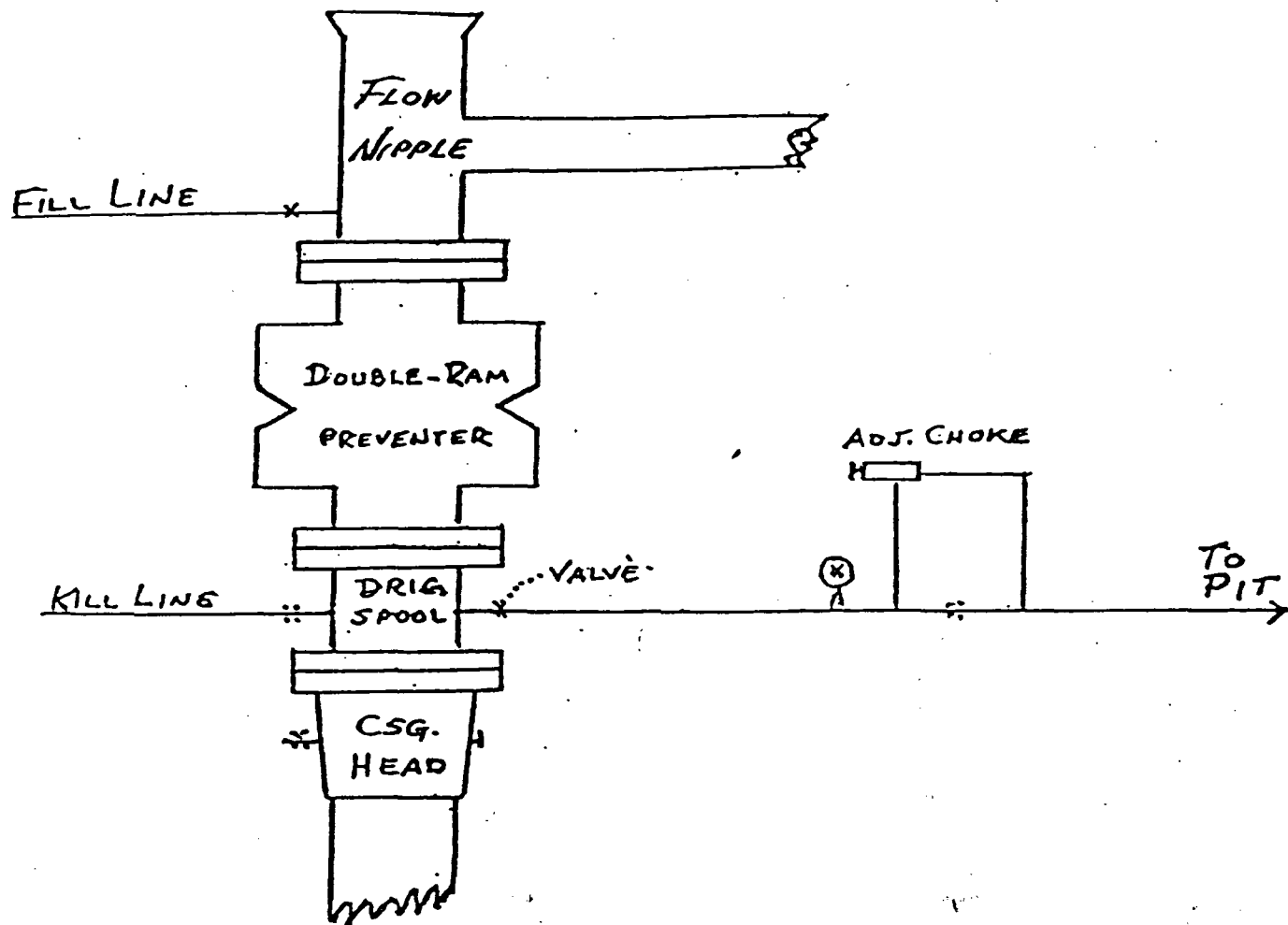

County CHAVES

Pool DIABLO - FUSSELMAN

TOWNSHIP 10 SOUTH

Range 27 EAST

NMPM

	6	5	4	3	2	1
7	8	9	10	11	12	
18	17	16	15	14	13	
19	20	21	22	23	24	
30	29	28	27	26	25	
31	32	33	34	35	36	

DESC: S/2 SEC 21, N/2 SEC 28 (R-9131, 3-2-90)

Ext: N/2 SEC 21 (A-9241, 7-31-90)