

CAULKINS OIL COMPANY

SUITE 2100 - 1600 BROADWAY
DENVER, COLORADO 80202

AREA CODE 303
861-4230

January 6, 1984

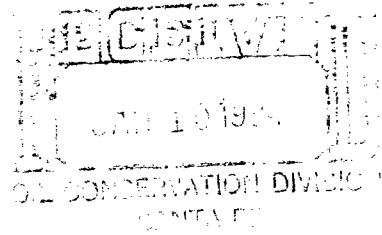

State of New Mexico
Oil Conservation Division
PO Box 2088
Santa Fe, New Mexico 87501

Gentlemen:

Enclosed are Caulkins Oil Company's Exemption Certificates
for the following wells.

The wells are as follows:

Breech F	Dak	1 E	Breech D	Dak	341 M	
Breech D	Dak	140 M		MV	341 M	
		MV	140 M	State A	Dak	62 M
Breech A	Dak	229 M		MV	62 M	
		MV	229 M			
Breech	Dak	307 M				
		MV	307 M			

If there are any questions regarding these certificates,
please do not hesitate to contact us.

Sincerely,

CAULKINS OIL COMPANY

Carol Keeton
Office Manager

nb
Enclosures

CAULKINS OIL COMPANY

SUITE 2100 - 1600 BROADWAY
DENVER, COLORADO 80202

AREA CODE 303
861.4230

SPECIAL RULES AND REGULATIONS
NATURAL GAS PRICING ACT SECTION 6
ADMINISTRATIVE EXEMPTION PROCEDURE

Rule 1

- (B) Caulkins Oil Company Well Breech F 1 E
is an infill well in the Dakota Zone as per R-1670-V.

Rule 5

Caulkins Oil Company plat showing proration units
in Section 33-T27N-R6W and all offset units.

Rule 7

- (A) R-1670-V for Dakota Zone.
- (C) I hereby certify that Breech F Dakota 1 E, the
original/or existing well on the referenced proration unit
has not had from date of first delivery of gas, and shall
not have its ability to produce into the pipeline
restricted by the operator by any affirmative mechanical
act such as unreasonably shutting-in, choking down or
intentionally damaging the wellbore for the purpose of
restricting the ability of the well to produce into
the pipeline.

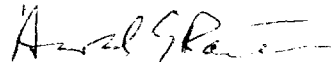

CAULKINS OIL COMPANY
Arnold E. Raether, Treasurer

SUBSCRIBED AND SWORN to this 6th day of January, 1984,

by Arnold E. Raether.

Notary Public

My Commission Expires:

August 18, 1986

All distances must be from the outer boundaries of the Section

Operator CAULKINS OIL COMPANY			Lease Breech F		Well No. 1-E
Unit Letter M	Section 33	Township 27 NORTH	Range 6 WEST	County RIO ARRIBA	
Actual Footage Location of Well: 1043 feet from the SOUTH line and 983 feet from the WEST line					
Ground Level Elev. 6643.0	Producing Formation Mesa Verde Dakota		Pool Basin Dakota Blanco Mesa Verde		Dedicated Acreage: 320 Acres

1. Outline the acreage dedicated to the subject well by colored pencil or hatchure marks on the plat below.
2. If more than one lease is dedicated to the well, outline each and identify the ownership thereof (both as to working interest and royalty).
3. If more than one lease of different ownership is dedicated to the well, have the interests of all owners been consolidated by communitization, unitization, force-pooling, etc?

☐ Yes ☐ No If answer is "yes," type of consolidation _____

If answer is "no," list the owners and tract descriptions which have actually been consolidated. (Use reverse side of this form if necessary.) _____

No allowable will be assigned to the well until all interests have been consolidated (by communitization, unitization, forced-pooling, or otherwise) or until a non-standard unit, eliminating such interests, has been approved by the Division

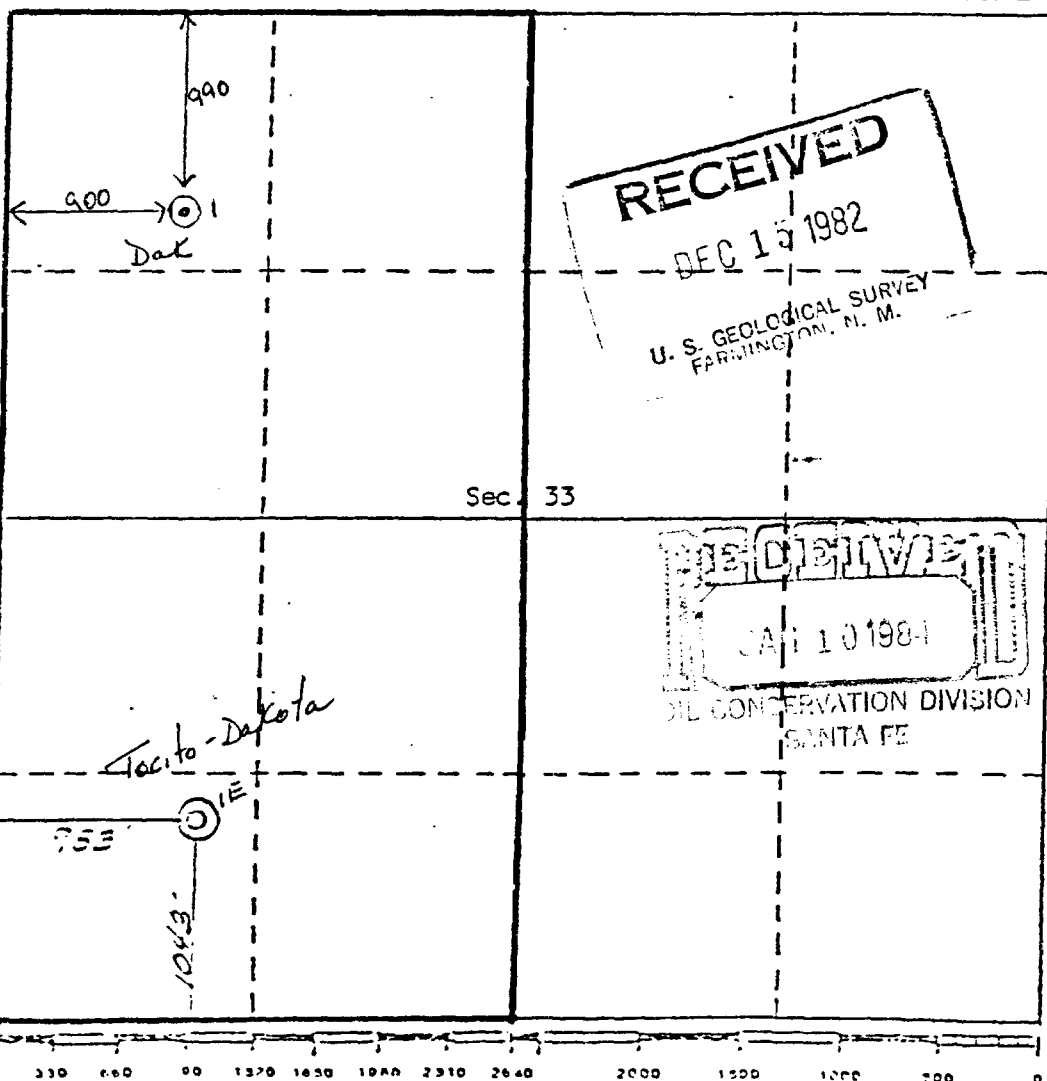

CERTIFICATION

I hereby certify that the information contained herein is true and complete to the best of my knowledge and belief.

Name Charles Verquer
Position Superintendent
Company Caulkins Oil Company
Date 12-13-82

I hereby certify that the well location shown on this plat was plotted from field notes of actual surveys made by me or under my supervision, and that the same is true and correct to the best of my knowledge and belief.

21 October

Date Surveyed 21 October 1982
Registered Professional Engineer and/or Land Surveyor
Curtis C. Stucking
Certificate No. 5980

CAULKINS OIL COMPANY

SUITE 2100 — 1600 BROADWAY
DENVER, COLORADO 80202

AREA CODE 303
861-4230

SPECIAL RULES AND REGULATIONS
NATURAL GAS PRICING ACT SECTION 6
ADMINISTRATIVE EXEMPTION PROCEDURE

Rule 1

- (B) Caulkins Oil Company Well State A 62 M
is an infill well in the Mesa Verde Zone as per R-1670-T.

Rule 5

Caulkins oil Company plat showing proration units in
Section 2-T26N-R6W and all offset units.

Rule 7

- (A) R-1670-T for Mesa Verde Zones.
- (C) I hereby certify that State A Mesa Verde 62 M, the
original/or existing well on the referenced proration unit
has not had from date of first delivery of gas, and shall
not have its ability to produce into the pipeline
restricted by the operator by any affirmative mechanical
act such as unreasonably shutting-in, choking down or
intentionally damaging the wellbore for the purpose
of restricting the ability of the well to produce into
the pipeline.



CAULKINS OIL COMPANY
Arnold E. Raether, Treasurer

SUBSCRIBED AND SWORN to this 6th day of January, 1984,
by Arnold E. Raether.

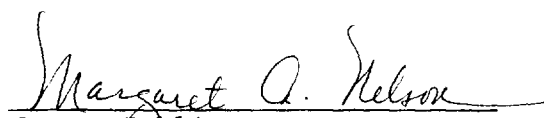
Notary Public

My Commission Expires:

August 18, 1986

All distances must be from the outer boundaries of the Section.

Operator CAULKINS OIL COMPANY			Lease State "A"		Well No. 62-M
Unit Letter D	Section 2	Township 26N	Range 6W	County Rio Arriba	
Actual Footage Location of Well: 1040 feet from the North line and 1120 feet from the West line					
Ground Level Elev. 6592	Producing Formation Mesa Verde - Dakota		Pool Blanco Mesa Verde - Basin Dakota		Dedicated Acreage: A 32.3 Acres

1. Outline the acreage dedicated to the subject well by colored pencil or hachure marks on the plat below.
2. If more than one lease is dedicated to the well, outline each and identify the ownership thereof (both as to working interest and royalty).
3. If more than one lease of different ownership is dedicated to the well, have the interests of all owners been consolidated by communization, unitization, force-pooling, etc?

☐ Yes ☐ No If answer is "yes," type of consolidation _____

If answer is "no," list the owners and tract descriptions which have actually been consolidated. (Use reverse side of this form if necessary.) _____

No allowable will be assigned to the well until all interests have been consolidated (by communization, unitization, forced-pooling, or otherwise) or until a non-standard unit, eliminating such interests, has been approved by the Division.

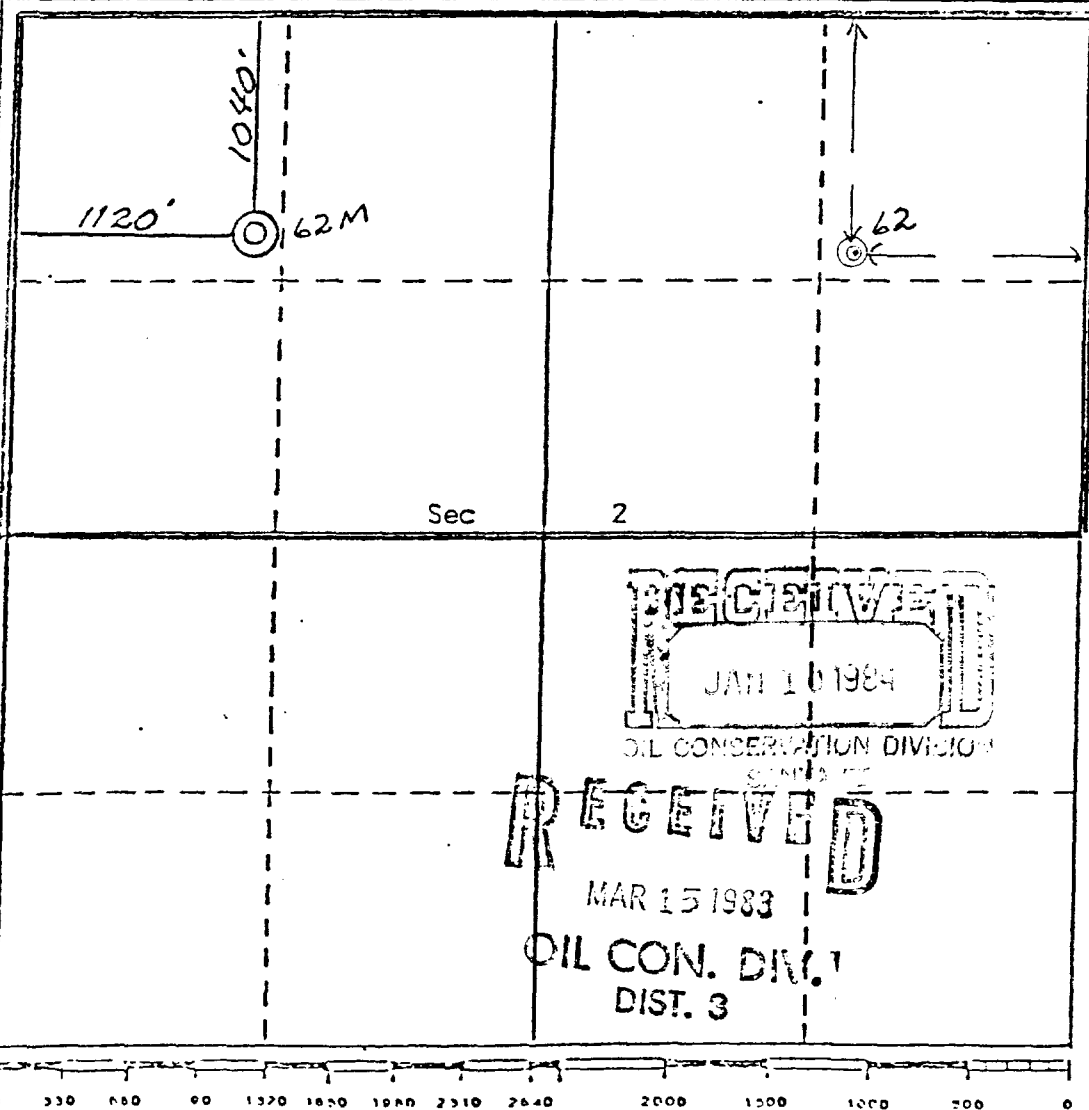

CERTIFICATION

I hereby certify that the information contained herein is true and complete to the best of my knowledge and belief.

Charles Verquer
Charles Verquer

Name
Superintendent
Position
Caulkins Oil Company
Company
3-4-83
Date

I hereby certify that the well location shown on this plat was plotted from field notes of actual surveys made by me or under my supervision, and that the same is true and correct to the best of my knowledge and belief.

October 1980
Date Surveyed
Curtis L. Stucking
Registered Professional Engineer
and/or Land Surveyor
5980
Certificate No.

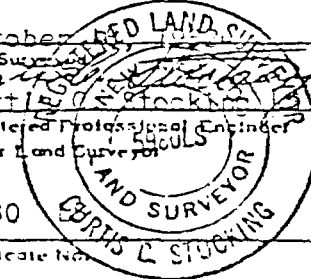

CAULKINS OIL COMPANY

SUITE 2100 — 1600 BROADWAY
DENVER, COLORADO 80202

AREA CODE 303
861-4230

SPECIAL RULES AND REGULATIONS
NATURAL GAS PRICING ACT SECTION 6
ADMINISTRATIVE EXEMPTION PROCEDURE

Rule 1

- (B) Caulkins Oil Company Well State A 62 M
is an infill well in the Dakota Zone as per R-1670-V.

Rule 5

Caulkins Oil Company plat showing proration units
in Section 2-T26N-R6W and all offset units.

Rule 7

- (A) R-1670-V for Dakota Zone.
- (C) I hereby certify that State A Dakota 62 M, the
original/or existing well on the referenced proration unit
has not had from date of first delivery of gas, and shall
not have its ability to produce into the pipeline
restricted by the operator by any affirmative mechanical
act such as unreasonably shutting-in, choking down or
intentionally damaging the wellbore for the purpose of
restricting the ability of the well to produce into
the pipeline.

Arnold E. Raether

CAULKINS OIL COMPANY
Arnold E. Raether, Treasurer

SUBSCRIBED AND SWORN to this 6th day of January, 1984,

by Arnold E. Raether.

Margaret A. Nelson
Notary Public

My Commission Expires:

August 18, 1986

All distances must be from the outer boundaries of the Section.

Operator CAULKINS OIL COMPANY			Lease State "A"		Well No. 62-M
Unit Letter D	Section 2	Township 26N	Range 6W	County Rio Arriba	
Actual Footage Location of Well: 1040 feet from the North line and 1120 feet from the West line					
Ground Level Elev. 6592	Producing Formation Mesa Verde - Dakota		Pool Blanco Mesa Verde - Basin Dakota		Dedicated Acreage: 32.3 Acres

1. Outline the acreage dedicated to the subject well by colored pencil or hatchure marks on the plat below.
2. If more than one lease is dedicated to the well, outline each and identify the ownership thereof (both as to working interest and royalty).
3. If more than one lease of different ownership is dedicated to the well, have the interests of all owners been consolidated by communitization, unitization, force-pooling, etc?

☐ Yes ☐ No If answer is "yes," type of consolidation _____

If answer is "no," list the owners and tract descriptions which have actually been consolidated. (Use reverse side of this form if necessary.) _____

No allowable will be assigned to the well until all interests have been consolidated (by communitization, unitization, forced-pooling, or otherwise) or until a non-standard unit, eliminating such interests, has been approved by the Division.

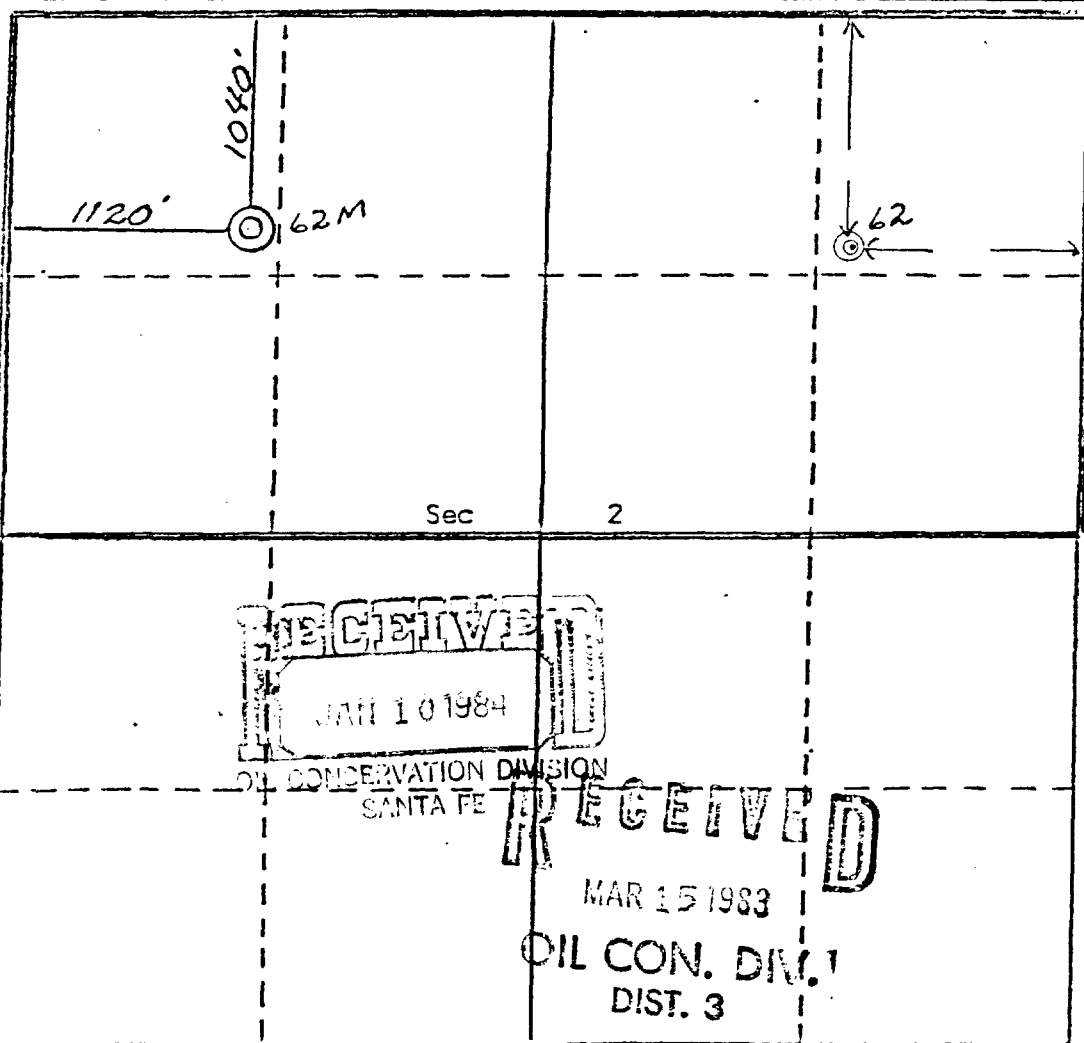

CERTIFICATION

I hereby certify that the information contained herein is true and complete to the best of my knowledge and belief.

Charles Verquer
Charles Verquer

Name

Superintendent

Position

Caulkins Oil Company

Company

3-4-83

Date

I hereby certify that the well location shown on this plat was plotted from field notes of actual surveys made by me or under my supervision, and that the same is true and correct to the best of my knowledge and belief.

October 1983
Date Surveyed
Curtis C. Stocking
Curtis C. Stocking
Registered Professional Engineer
and/or Land Surveyor
5980
Certificate No.

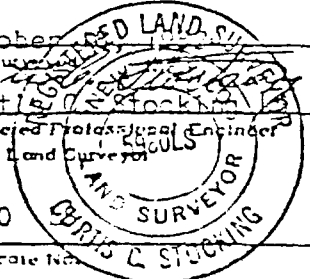

330 660 990 1320 1650 1980 2310 2640 2000 1500 1000 500 0

CAULKINS OIL COMPANY

SUITE 2100 - 1600 BROADWAY
DENVER, COLORADO 80202

AREA CODE 303
861-4230

SPECIAL RULES AND REGULATIONS
NATURAL GAS PRICING ACT SECTION 6
ADMINISTRATIVE EXEMPTION PROCEDURE

Rule 1

- (B) Caulkins Oil Company Well Breech D 341 M
is an infill well in the Mesa Verde Zone as per R-1670-T.

Rule 5

Caulkins oil Company plat showing proration units in
Section 21-T26N-R6W and all offset units.

Rule 7

- (A) R-1670-T for Mesa Verde Zones.
- (C) I hereby certify that Breech D Mesa Verde 341 M, the
original/or existing well on the referenced proration unit
has not had from date of first delivery of gas, and shall
not have its ability to produce into the pipeline
restricted by the operator by any affirmative mechanical
act such as unreasonably shutting-in, choking down or
intentionally damaging the wellbore for the purpose
of restricting the ability of the well to produce into
the pipeline.

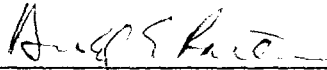

CAULKINS OIL COMPANY
Arnold E. Raether, Treasurer

SUBSCRIBED AND SWORN to this 6th day of January, 1984,
by Arnold E. Raether.

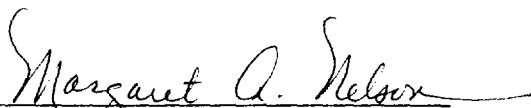
Notary Public

My Commission Expires:

August 18, 1986

All distances must be from the outer boundaries of the Section

Operator CAULKINS OIL COMPANY			Lease Breach "D"		Well No. 341-M
Unit Letter F	Section 21	Township 26N	Range 6W	County Rio Arriba	
Actual Postage Location of Wells: 1850 feet from the North line and 1800 feet from the West line					
Ground Level Elev. 5675	Producing Formation Mesa Verde Dakota		Pool Blanco Mesa Verde-Basin Dakota		Dedicated Acreage: 320

1. Outline the acreage dedicated to the subject well by colored pencil or hachure marks on the plat below.
2. If more than one lease is dedicated to the well, outline each and identify the ownership thereof (both as to working interest and royalty).
3. If more than one lease of different ownership is dedicated to the well, have the interests of all owners been consolidated by communitization, unitization, force-pooling, etc?

☐ Yes ☐ No If answer is "yes," type of consolidation _____

If answer is "no," list the owners and tract descriptions which have actually been consolidated. (Use reverse side of this form if necessary.) _____

No allowable will be assigned to the well until all interests have been consolidated (by communitization, unitization, forced-pooling, or otherwise) or until a non-standard unit, eliminating such interests, has been approved by the Division.

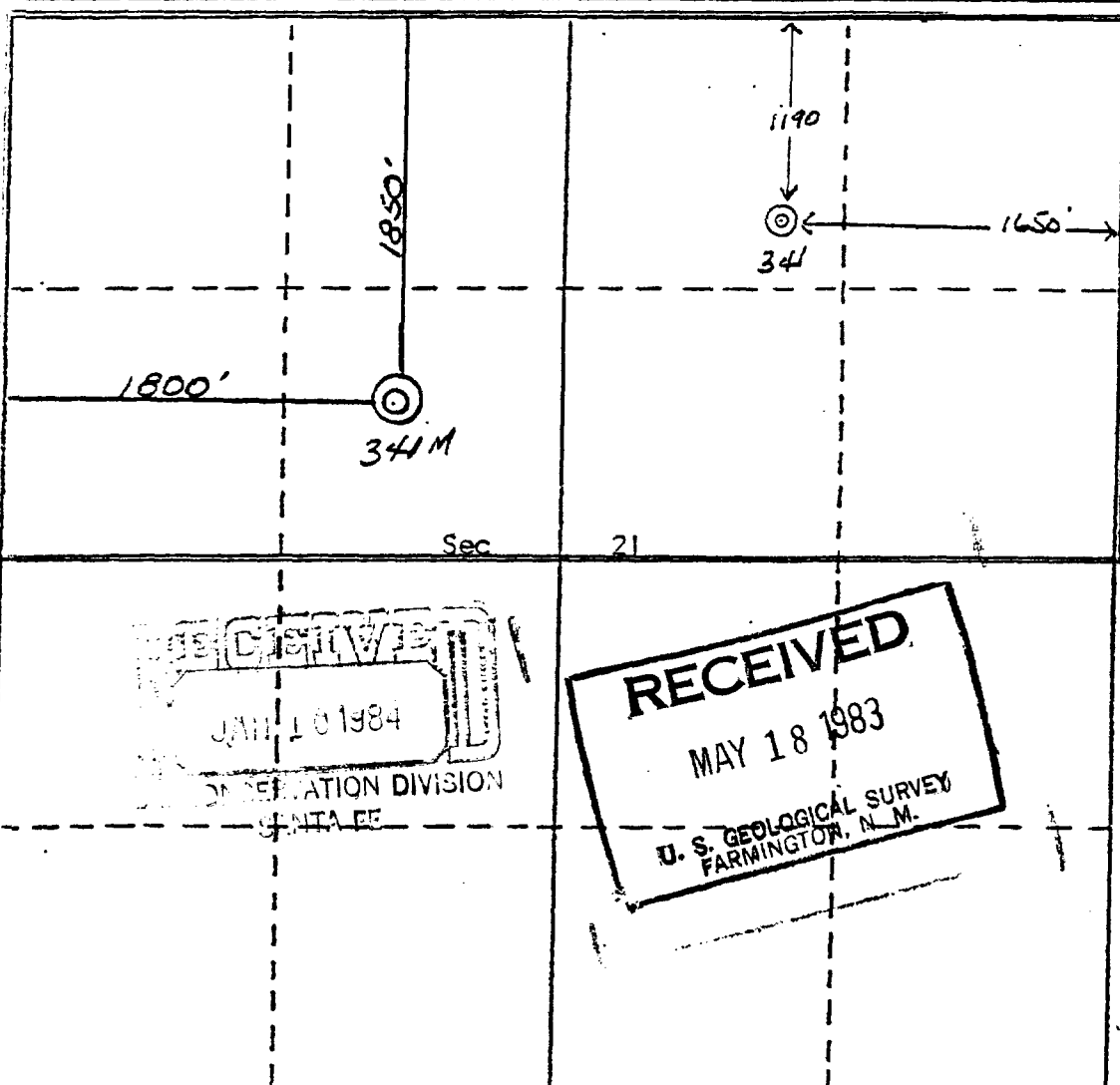

CERTIFICATION

I hereby certify that the information contained herein is true and complete to the best of my knowledge and belief.

Charles E. Verquer
Name

Charles E. Verquer

Position
Superintendent

Company
Caulkins Oil Company

Date
5-16-83

I hereby certify that the well location shown on this plat was plotted from field notes of actual surveys made by me or under my supervision, and that the same is true and correct to the best of my knowledge and belief.

October 1983
Date Surveyed
Curtis G. Stucking
Curtis G. Stucking, O.S.
Registered Professional Engineer
and/or Land Surveyor
5980
Certificate No.

CAULKINS OIL COMPANY

SUITE 2100 — 1600 BROADWAY
DENVER, COLORADO 80202

AREA CODE 303
861.4230

SPECIAL RULES AND REGULATIONS
NATURAL GAS PRICING ACT SECTION 6
ADMINISTRATIVE EXEMPTION PROCEDURE

Rule 1

- (B) Caulkins Oil Company Well Breech D 341 M
is an infill well in the Dakota Zone as per R-1670-V.

Rule 5

Caulkins Oil Company plat showing proration units
in Section 21-T26N-R6W and all offset units.

Rule 7

- (A) R-1670-V for Dakota Zone.
- (C) I hereby certify that Breech D Dakota 341 M, the
original/or existing well on the referenced proration unit
has not had from date of first delivery of gas, and shall
not have its ability to produce into the pipeline
restricted by the operator by any affirmative mechanical
act such as unreasonably shutting-in, choking down or
intentionally damaging the wellbore for the purpose of
restricting the ability of the well to produce into
the pipeline.

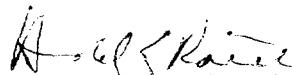

CAULKINS OIL COMPANY
Arnold E. Raether, Treasurer

SUBSCRIBED AND SWORN to this 6th day of January, 1984,
by Arnold E. Raether.

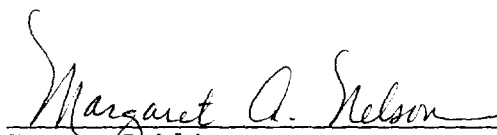
Notary Public

My Commission Expires:

August 18, 1986

Operator CAULKINS OIL COMPANY			Lease Breach "D"		Well No. 341-M
Unit Letter F	Section 21	Township 25N	Range 6W	County Rio Arriba	
Actual Footage Location of Well:					
1850 feet from the North line and		1800 feet from the West line			
Ground Level Elev. 5675	Producing Formation Mesa Verde Dakota		Pool Blanco Mesa Verde-Basin Dakota		Dedicated Acreages 320 Ac

1. Outline the acreage dedicated to the subject well by colored pencil or hatchure marks on the plat below.
2. If more than one lease is dedicated to the well, outline each and identify the ownership thereof (both as to work interest and royalty).
3. If more than one lease of different ownership is dedicated to the well, have the interests of all owners been consolidated by communitization, unitization, force-pooling, etc?

☐ Yes ☐ No If answer is "yes," type of consolidation _____

If answer is "no," list the owners and tract descriptions which have actually been consolidated. (Use reverse side this form if necessary.) _____

No allowable will be assigned to the well until all interests have been consolidated (by communitization, unitization, forced-pooling, or otherwise) or until a non-standard unit, eliminating such interests, has been approved by the Division.

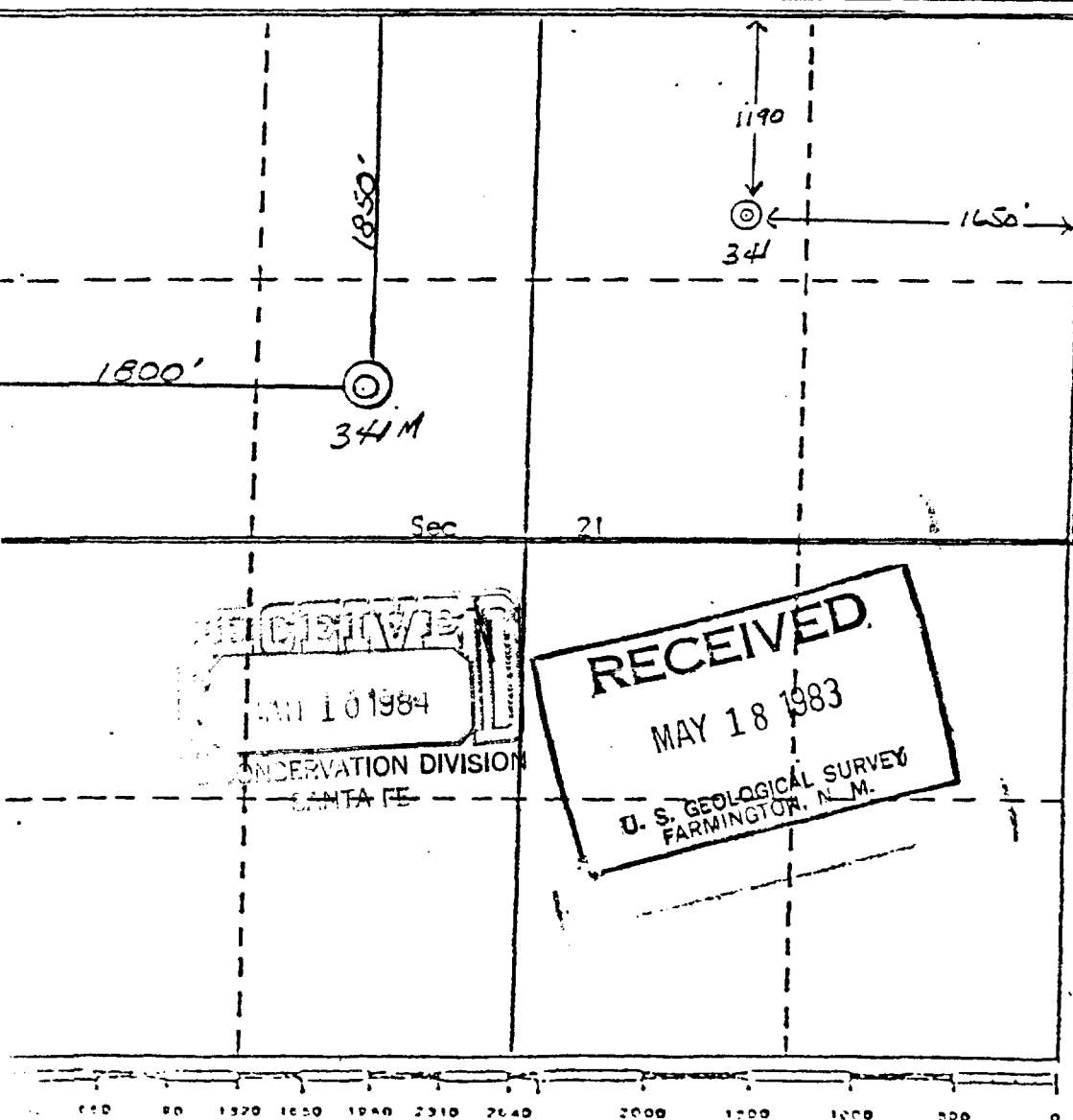

CERTIFICATION

I hereby certify that the information contained herein is true and complete to the best of my knowledge and belief.

Charles E. Verquer
Name

Charles E. Verquer

Position

Superintendent

Company

Caulkins Oil Company

Date

5-16-83

I hereby certify that the well location shown on this plat was plotted from field notes of actual surveys made by me or under my supervision, and that the same is true and correct to the best of my knowledge and belief.

October 10 1983
Date Surveyed
Charles E. Verquer
REGISTERED PROFESSIONAL ENGINEER
AND/OR LAND SURVEYOR
5080
Certificate No.

CAULKINS OIL COMPANY

SUITE 2100 - 1600 BROADWAY
DENVER, COLORADO 80202

AREA CODE 303
861-4230

SPECIAL RULES AND REGULATIONS
NATURAL GAS PRICING ACT SECTION 6
ADMINISTRATIVE EXEMPTION PROCEDURE

Rule 1

- (B) Caulkins Oil Company Well Breech 307 M
is an infill well in the Mesa Verde Zone as per R-1670-T.

Rule 5

Caulkins oil Company plat showing proration units in
Section 13-T26N-R7W and all offset units.

Rule 7

- (A) R-1670-T for Mesa Verde Zones.
- (C) I hereby certify that Breech Mesa Verde 307 M, the
original/or existing well on the referenced proration unit
has not had from date of first delivery of gas, and shall
not have its ability to produce into the pipeline
restricted by the operator by any affirmative mechanical
act such as unreasonably shutting-in, choking down or
intentionally damaging the wellbore for the purpose
of restricting the ability of the well to produce into
the pipeline.



CAULKINS OIL COMPANY
Arnold E. Raether, Treasurer

SUBSCRIBED AND SWORN to this 6th day of January, 1984,
by Arnold E. Raether.

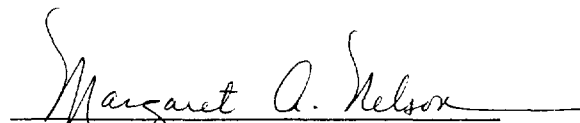
Notary Public

My Commission Expires:

August 18, 1986

All distances must be from the outer boundaries of the Section

Operator CAULKINS OIL COMPANY			Lease Breech		Well No. 337-4
Unit Letter 0	Section 13	Township 26 NORTH	Range 7 WEST	County RIO ARriba	
Actual Footage Location of Well: 1120 feet from the SOUTH line and 1520 feet from the EAST line					
Ground Level Elev. 6146.0	Producing Formation PC-Chacra-Mesa Verde-Dakota	Pool South Blanco PC-Otero Chacra		Dedicated Acreage: 160 PC & Chacra 820 MV & Dakota Acres	

1. Outline the acreage dedicated to the subject well by colored pencil or hachure marks on the plat below.
2. If more than one lease is dedicated to the well, outline each and identify the ownership thereof (both as to working interest and royalty).
3. If more than one lease of different ownership is dedicated to the well, have the interests of all owners been consolidated by communitization, unitization, force-pooling, etc?

☐ Yes ☐ No If answer is "yes," type of consolidation _____

If answer is "no," list the owners and tract descriptions which have actually been consolidated. (Use reverse side of this form if necessary.) _____

No allowable will be assigned to the well until all interests have been consolidated (by communitization, unitization, forced-pooling, or otherwise) or until a non-standard unit, eliminating such interests, has been approved by the Division

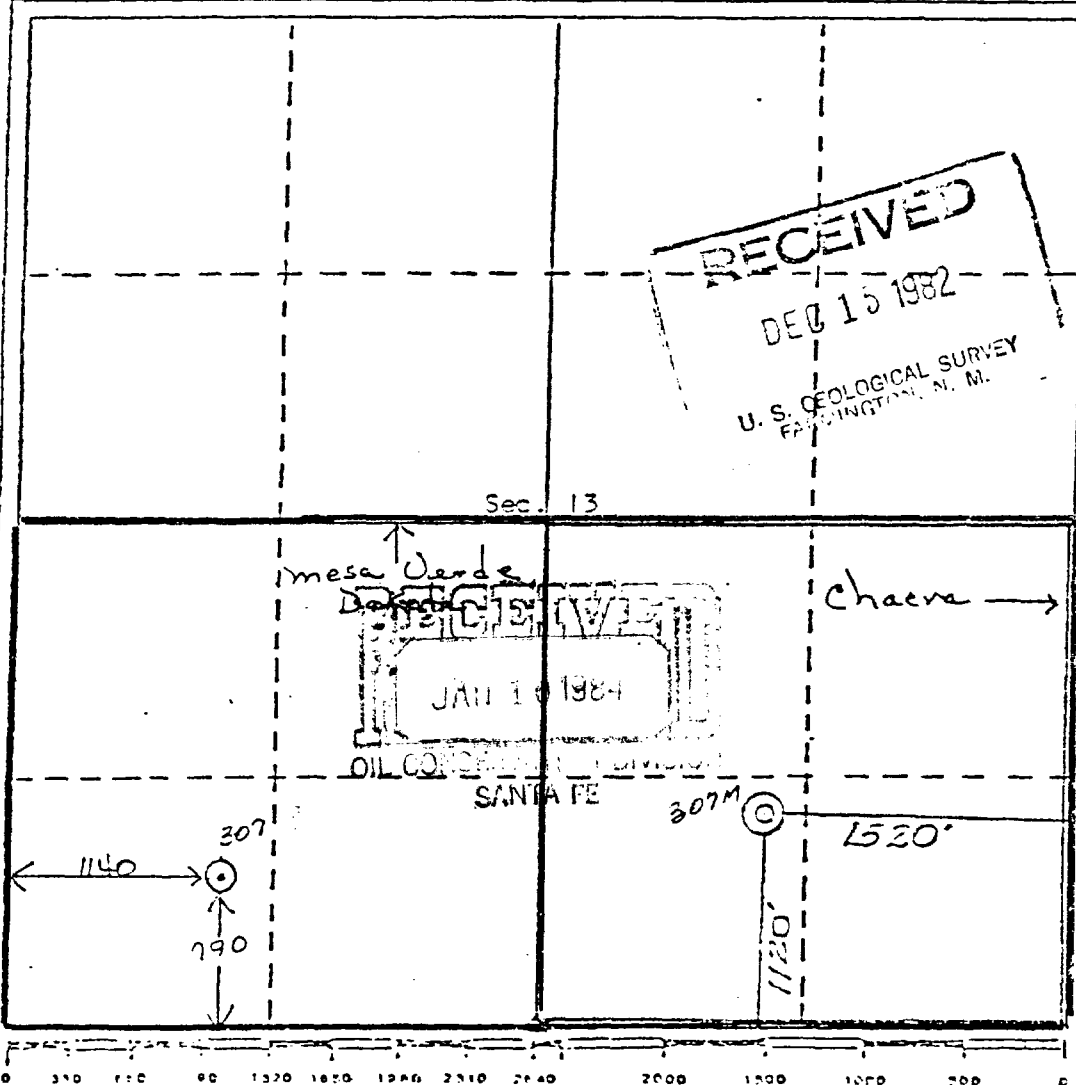

CERTIFICATION

I hereby certify that the information contained herein is true and complete to the best of my knowledge and belief.

Charles Verquer
Name

Charles Verquer

Position

Superintendent

Company

Caulkins Oil Company

Date

12-13-82

I hereby certify that the well location shown on this plat was plotted from field notes of actual surveys made by me or under my supervision, and that the same is true and correct to the best of my knowledge and belief.

21 October 1982

Date Survey

Registered Professional Engineer
and/or Land Surveyor
Curtis C. Stucking

Certificate No.
5980

CAULKINS OIL COMPANY

SUITE 2100 — 1600 BROADWAY
DENVER, COLORADO 80202

AREA CODE 303
861.4230

SPECIAL RULES AND REGULATIONS
NATURAL GAS PRICING ACT SECTION 6
ADMINISTRATIVE EXEMPTION PROCEDURE

Rule 1

- (B) Caulkins Oil Company Well Breech 307 M
is an infill well in the Dakota Zone as per R-1670-V.

Rule 5

Caulkins Oil Company plat showing proration units
in Section 13-T26N-R7W and all offset units.

Rule 7

- (A) R-1670-V for Dakota Zone.
- (C) I hereby certify that Breech Dakota 307 M, the
original/or existing well on the referenced proration unit
has not had from date of first delivery of gas, and shall
not have its ability to produce into the pipeline
restricted by the operator by any affirmative mechanical
act such as unreasonably shutting-in, choking down or
intentionally damaging the wellbore for the purpose of
restricting the ability of the well to produce into
the pipeline.

Arnold E. Raether

CAULKINS OIL COMPANY
Arnold E. Raether, Treasurer

SUBSCRIBED AND SWORN to this 6th day of January, 1984,
by Arnold E. Raether.

Margaret A. Nelson
Notary Public

My Commission Expires:

August 18, 1986

All distances must be from the outer boundaries of the Section

Operator CAULKINS OIL COMPANY			Lease Breech		Well No. 337-44
Unit Letter G	Section 13	Township 25 NORTH	Range 7 WEST	County RIO ARRIABA	
Actual Footage Location of Well: 1120 feet from the SOUTH line and 1520 feet from the EAST line					
Ground Level Elev. 6146.0	Producing Formation PC-Chacra-Mesa Verde-Dakota		Pool South Blanco PC-Otero Chacra		Dedicated Acreage: 180 PC & Chacra 820 MV & Dakota Acres

1. Outline the acreage dedicated to the subject well by colored pencil or hatchure marks on the plat below.
2. If more than one lease is dedicated to the well, outline each and identify the ownership thereof (both as to working interest and royalty).
3. If more than one lease of different ownership is dedicated to the well, have the interests of all owners been consolidated by communitization, unitization, force-pooling, etc?

☐ Yes ☐ No If answer is "yes," type of consolidation _____

If answer is "no," list the owners and tract descriptions which have actually been consolidated. (Use reverse side of this form if necessary.) _____

No allowable will be assigned to the well until all interests have been consolidated (by communitization, unitization, forced-pooling, or otherwise) or until a non-standard unit, eliminating such interests, has been approved by the Division

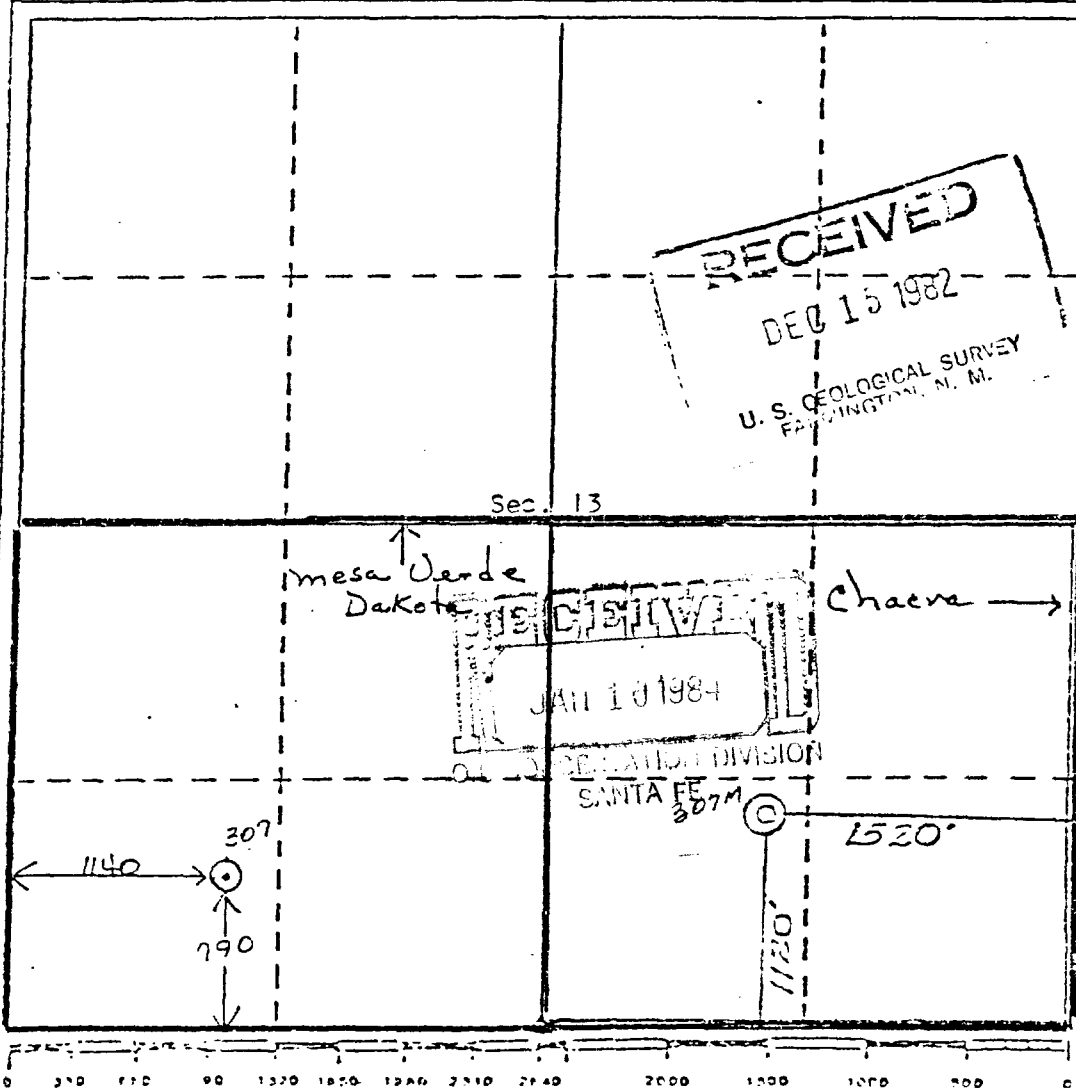

CERTIFICATION

I hereby certify that the information contained herein is true and complete to the best of my knowledge and belief.

Charles Verquer
Name

Charles Verquer

Position

Superintendent

Company

Caulkins Oil Company

Date

12-13-82

I hereby certify that the well location shown on this plat was plotted from field notes of actual surveys made by me or under my supervision, and that the same is true and correct to the best of my knowledge and belief.

21 October 1982

Date Surveyed

Registered Professional Engineer
and/or Land Surveyor
Curtis & Stocking

Certificate No.
5980

CAULKINS OIL COMPANY
SUITE 2100 - 1600 BROADWAY
DENVER, COLORADO 80202

AREA CODE 303
861.4230

SPECIAL RULES AND REGULATIONS
NATURAL GAS PRICING ACT SECTION 6
ADMINISTRATIVE EXEMPTION PROCEDURE

Rule 1

- (B) Caulkins Oil Company Well Breech A 229 M
is an infill well in the Mesa Verde Zone as per R-1670-T.

Rule 5

Caulkins oil Company plat showing proration units in
Section 17-T26N-R6W and all offset units.

Rule 7

- (A) R-1670-T for Mesa Verde Zones.
- (C) I hereby certify that Breech A Mesa Verde 229 M, the
original/or existing well on the referenced proration unit
has not had from date of first delivery of gas, and shall
not have its ability to produce into the pipeline
restricted by the operator by any affirmative mechanical
act such as unreasonably shutting-in, choking down or
intentionally damaging the wellbore for the purpose
of restricting the ability of the well to produce into
the pipeline.



CAULKINS OIL COMPANY
Arnold E. Raether, Treasurer

SUBSCRIBED AND SWORN to this 6th day of January, 1984,
by Arnold E. Raether.

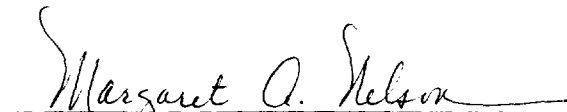
Notary Public

My Commission Expires:

August 18, 1986

All distances must be from the outer boundaries of the Section.

Operator CAULKINS OIL COMPANY			Lease Breach "A"		Well No. 229-M
Unit Letter A	Section 17	Township 26N	Range 6W	County Rio Arriba	
Actual Footage Location of Well: 1120 feet from the North line and 890 feet from the East line					
Ground Level Elev. 6754	Producing Formation Mesa Verde Dakota		Pool Blanco Mesa Verde Basin Dakota		Dedicated Acreage 320 Acres

1. Outline the acreage dedicated to the subject well by colored pencil or hatchure marks on the plat below.
2. If more than one lease is dedicated to the well, outline each and identify the ownership thereof (both as to working interest and royalty).
3. If more than one lease of different ownership is dedicated to the well, have the interests of all owners been consolidated by communitization, unitization, force-pooling, etc?

☐ Yes ☐ No If answer is "yes," type of consolidation _____

If answer is "no," list the owners and tract descriptions which have actually been consolidated. (Use reverse side of this form if necessary.) _____

No allowable will be assigned to the well until all interests have been consolidated (by communitization, unitization, forced-pooling, or otherwise) or until a non-standard unit, eliminating such interests, has been approved by the Division

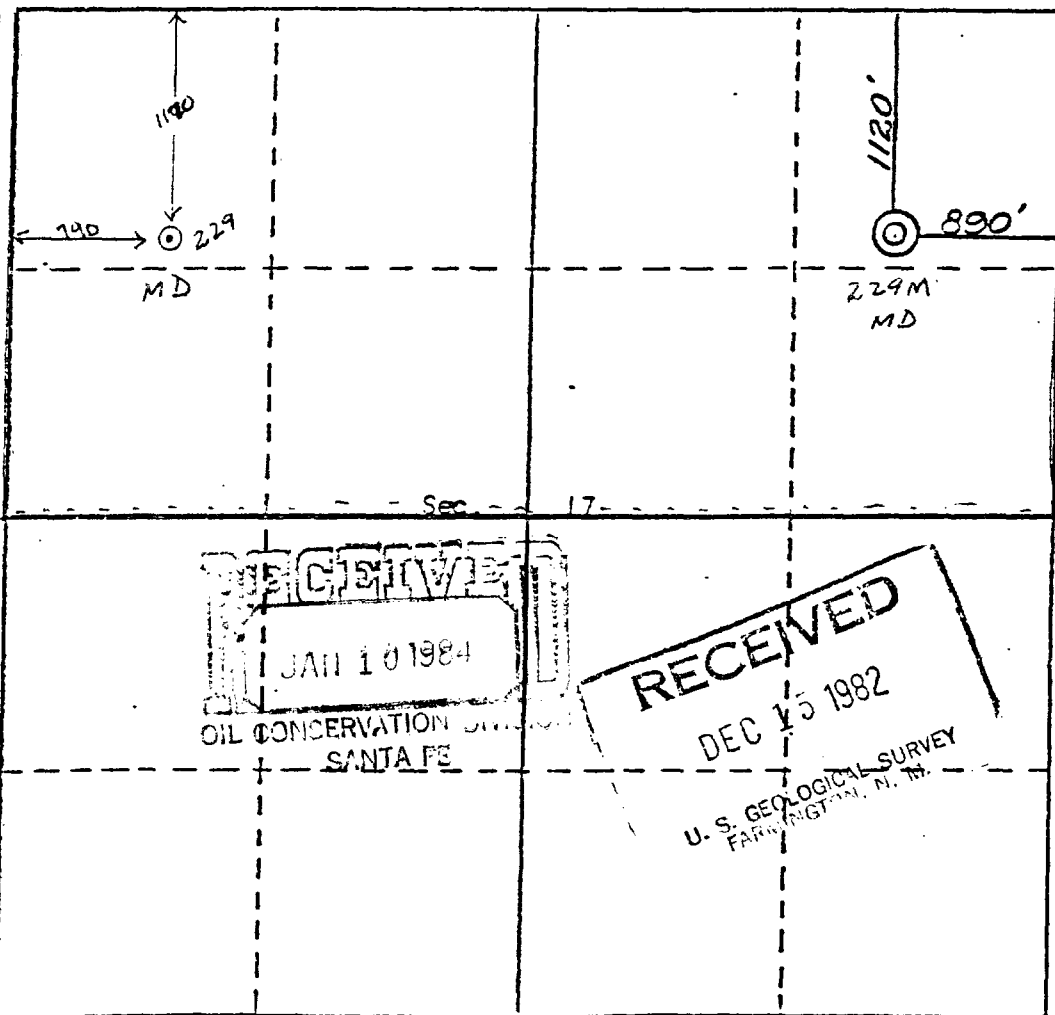

CERTIFICATION

I hereby certify that the information contained herein is true and complete to the best of my knowledge and belief.

Charles Verquer
Name

Charles Verquer
Position

Superintendent
Company

Caulkins Oil Company
Date

12-13-82

I hereby certify that the well location shown on this plat was plotted from field notes of actual surveys made by me or under my supervision, and that the same is true and correct to the best of my knowledge and belief.

October 1982
Date Surveyed
NEW MEXICO
REGISTERED PROFESSIONAL ENGINEER
and/or LAND SURVEYOR
509
Certificate No.

CAULKINS OIL COMPANY

SUITE 2100 — 1600 BROADWAY
DENVER, COLORADO 80202

AREA CODE 303
861-4230

SPECIAL RULES AND REGULATIONS
NATURAL GAS PRICING ACT SECTION 6
ADMINISTRATIVE EXEMPTION PROCEDURE

Rule 1

- (B) Caulkins Oil Company Well Breech A 229 M
is an infill well in the Dakota Zone as per R-1670-V.

Rule 5

Caulkins Oil Company plat showing proration units
in Section 17-T26N-R6W and all offset units.

Rule 7

- (A) R-1670-V for Dakota Zone.
- (C) I hereby certify that Breech A Dakota 229 M, the
original/or existing well on the referenced proration unit
has not had from date of first delivery of gas, and shall
not have its ability to produce into the pipeline
restricted by the operator by any affirmative mechanical
act such as unreasonably shutting-in, choking down or
intentionally damaging the wellbore for the purpose of
restricting the ability of the well to produce into
the pipeline.



CAULKINS OIL COMPANY
Arnold E. Raether, Treasurer

SUBSCRIBED AND SWORN to this 6th day of January, 1984,
by Arnold E. Raether.

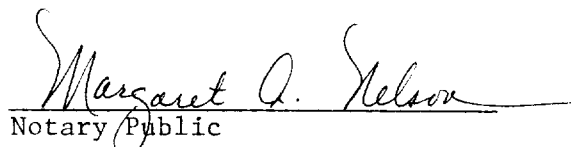
Notary Public

My Commission Expires:

August 18, 1986

All distances must be from the outer boundaries of the Section.

Operator CAULKINS OIL COMPANY			Lease Breach "A"		Well No. 229-M
Unit Letter A	Section 17	Township 26N	Range 6W	County Rio Arriba	
Actual Spillage Location of Well: 1120 feet from the North line and 890 feet from the East line					
Ground Level Elev. 6754	Producing Formation Mesa Verde Dakota		Pool Blanco Mesa Verde Basin Dakota		Dedicated Acreage 320 Acres

1. Outline the acreage dedicated to the subject well by colored pencil or hatchure marks on the plat below.
2. If more than one lease is dedicated to the well, outline each and identify the ownership thereof (both as to working interest and royalty).
3. If more than one lease of different ownership is dedicated to the well, have the interests of all owners been consolidated by communitization, unitization, force-pooling, etc?

☐ Yes ☐ No If answer is "yes," type of consolidation _____

If answer is "no," list the owners and tract descriptions which have actually been consolidated. (Use reverse side of this form if necessary.) _____

No allowable will be assigned to the well until all interests have been consolidated (by communitization, unitization, forced-pooling, or otherwise) or until a non-standard unit, eliminating such interests, has been approved by the Division

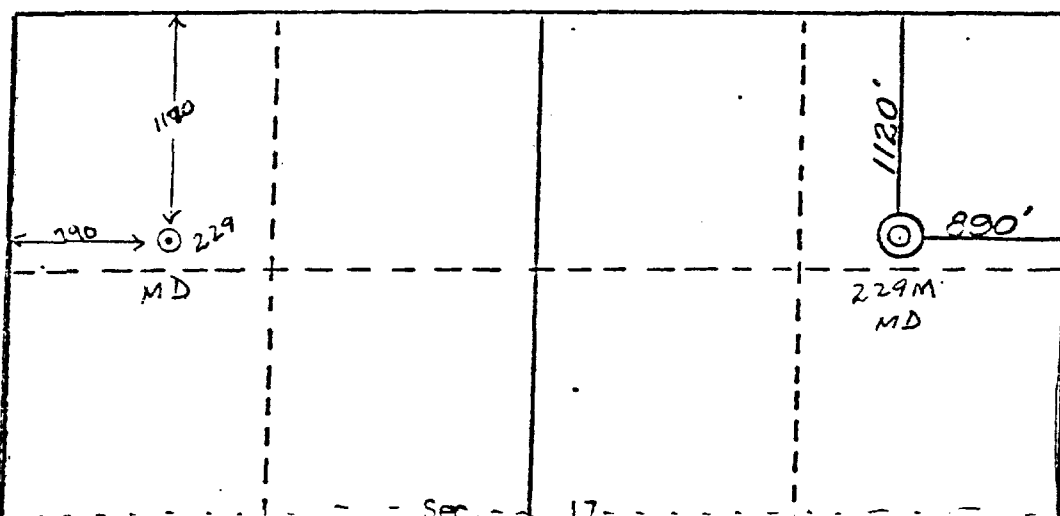

CERTIFICATION

I hereby certify that the information contained herein is true and complete to the best of my knowledge and belief.

Charles Verquer

Name

Charles Verquer

Position

Superintendent

Company

Caulkins Oil Company

Date

12-13-82

I hereby certify that the well location shown on this plat was plotted from field notes of actual surveys made by me or under my supervision, and that the same is true and correct to the best of my knowledge and belief.

October 1982
U.S. GEOLOGICAL SURVEY
FARMINGTON, N. M.
REGISTERED PROFESSIONAL ENGINEER
AND/OR LAND SURVEYOR
500
Certificate No. 10000

RECEIVED
JAN 10 1984
OIL CONSERVATION DIVISION
SANTA FE

RECEIVED
DEC 15 1982
U. S. GEOLOGICAL SURVEY
FARMINGTON, N. M.

0 330 660 990 1320 1650 1980 2310 2640 2970 3300 3630 3960 4290 4620 4950 5280 5610 5940 6270 6600

CAULKINS OIL COMPANY

SUITE 2100 — 1600 BROADWAY
DENVER, COLORADO 80202

AREA CODE 303
861-4230

SPECIAL RULES AND REGULATIONS
NATURAL GAS PRICING ACT SECTION 6
ADMINISTRATIVE EXEMPTION PROCEDURE

Rule 1

- (B) Caulkins Oil Company Well Breech D 140 M
is an infill well in the Dakota Zone as per R-1670-V.

Rule 5

Caulkins Oil Company plat showing proration units
in Section 11-T26N-R6W and all offset units.

Rule 7

- (A) R-1670-V for Dakota Zone.
- (C) I hereby certify that Breech D Dakota 140 M, the
original/or existing well on the referenced proration unit
has not had from date of first delivery of gas, and shall
not have its ability to produce into the pipeline
restricted by the operator by any affirmative mechanical
act such as unreasonably shutting-in, choking down or
intentionally damaging the wellbore for the purpose of
restricting the ability of the well to produce into
the pipeline.

Arnold E. Raether
CAULKINS OIL COMPANY
Arnold E. Raether, Treasurer

SUBSCRIBED AND SWORN to this 6th day of January, 1984,
by Arnold E. Raether.

Margaret A. Nelson
Notary Public

My Commission Expires:

August 18, 1986

OIL CONSERVATION DIVISION

STATE OF NEW MEXICO
ENERGY AND MINERALS DEPARTMENTP. O. BOX 2088
SANTA FE, NEW MEXICO 87501Form C-102
Revised 10-1-7

All distances must be from the outer boundaries of the Section.

Operator CAULKINS OIL COMPANY		Lease Breech D		Well No. 140-M	
Unit Letter D	Section 11	Township 26 NORTH	Range 6 WEST	County RIO ARriba	
Actual Postage Location of Well: 880 feet from the NORTH line and 1028 feet from the WEST line					
Ground Level Elev. 6597.0	Producing Formation Mesa Verde & Dakota		Pool Blanco Mesa Verde & Basin Dakota	Dedicated Acreage: 320 Acres	

1. Outline the acreage dedicated to the subject well by colored pencil or hatchure marks on the plat below.
2. If more than one lease is dedicated to the well, outline each and identify the ownership thereof (both as to working interest and royalty).
3. If more than one lease of different ownership is dedicated to the well, have the interests of all owners been consolidated by communitization, unitization, force-pooling, etc?

☐ Yes ☐ No If answer is "yes," type of consolidation _____

If answer is "no," list the owners and tract descriptions which have actually been consolidated. (Use reverse side of this form if necessary.) _____

No allowable will be assigned to the well until all interests have been consolidated (by communitization, unitization, forced-pooling, or otherwise) or until a non-standard unit, eliminating such interests, has been approved by the Division

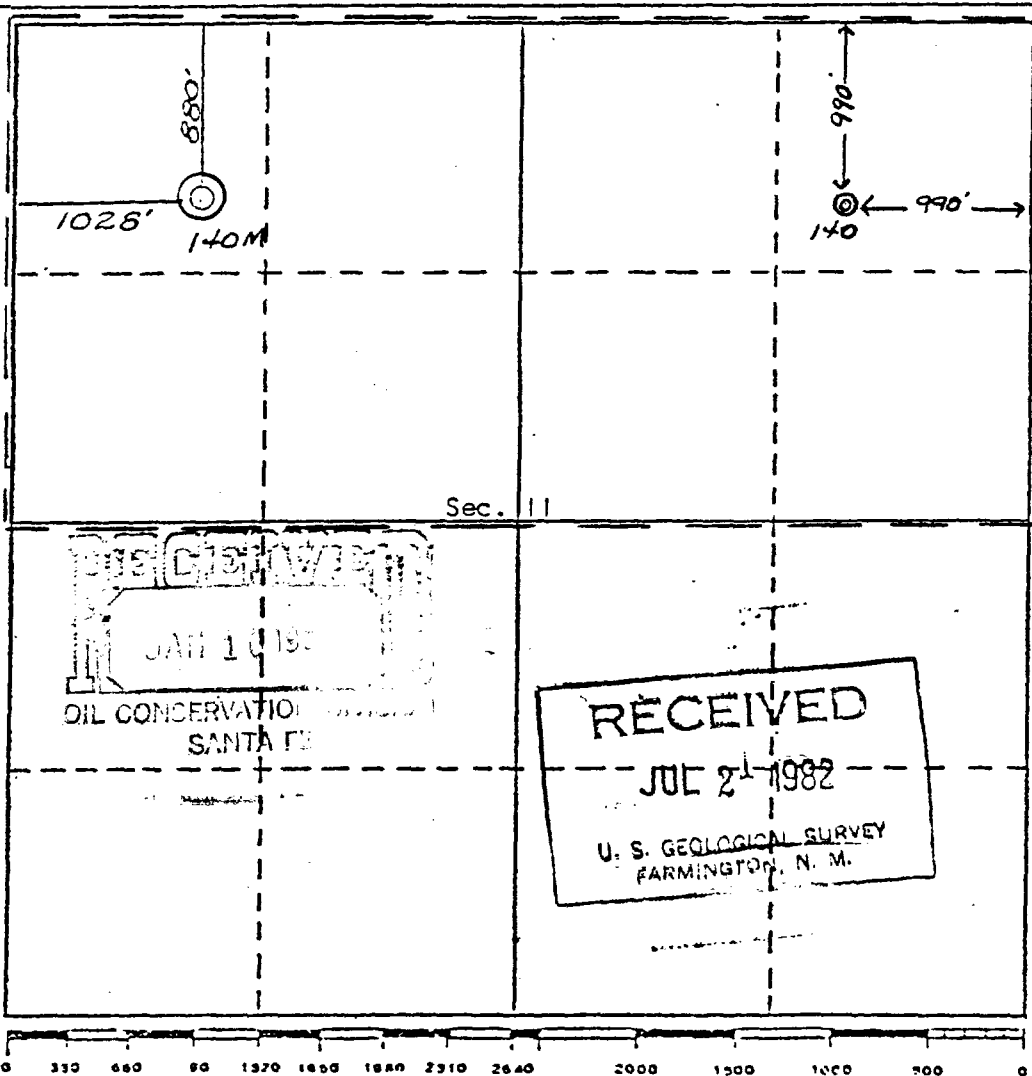

CERTIFICATION

I hereby certify that the information contained herein is true and complete to the best of my knowledge and belief.

Charles E. Verquer
Name

Charles E. Verquer
Position

Superintendent
Company

Caulkins Oil Company
Date

July 20, 1982

I hereby certify that the well location shown on this plat was plotted from field notes of actual surveys made by me or under my supervision, and that the same is true and correct to the best of my knowledge and belief.

REGISTERED LAND SURVEYOR
NEW MEXICO
JULY 1982
Date Surveyed
REGISTERED PROFESSIONAL ENGINEER
and/or LAND SURVEYOR
C. E. STOKING

Certificate No.

5980

CAULKINS OIL COMPANY

SUITE 2100 — 1600 BROADWAY
DENVER, COLORADO 80202

AREA CODE 303
861-4230

January 6, 1984

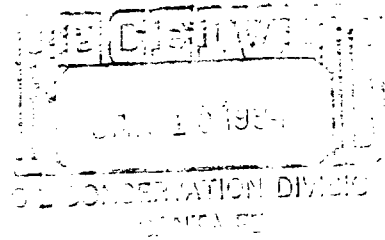

State of New Mexico
Oil Conservation Division
PO Box 2088
Santa Fe, New Mexico 87501

Gentlemen:

Enclosed are Caulkins Oil Company's Exemption Certificates
for the following wells.

The wells are as follows:

Breech F	Dak	1 E	Breech D	Dak	341 M
Breech D	Dak	140 M		MV	341 M
	MV	140 M	State A	Dak	62 M
Breech A	Dak	229 M		MV	62 M
	MV	229 M			
Breech	Dak	307 M			
	MV	307 M			

If there are any questions regarding these certificates,
please do not hesitate to contact us.

Sincerely,

CAULKINS OIL COMPANY

Carol Keeton
Office Manager

nb
Enclosures

CAULKINS OIL COMPANY

SUITE 2100 — 1600 BROADWAY
DENVER, COLORADO 80202

AREA CODE 303
861-4230

SPEICAL RULES AND REGULATIONS
NATURAL GAS PRICING ACT SECTION 6
ADMINISTRATIVE EXEMPTION PROCEDURE

Rule 1

- (B) Caulkins Oil Company Well Breech D 140 M
is an infill well in the Mesa Verde Zone as per R-1670-T.

Rule 5

Caulkins oil Company plat showing proration units in
Section 11-T26N-R6W and all offset units.

Rule 7

- (A) R-1670-T for Mesa Verde Zones.
- (C) I hereby certify that Breech D Mesa Verde 140 M, the
original/or existing well on the referenced proration unit
has not had from date of first delivery of gas, and shall
not have its ability to produce into the pipeline
restricted by the operator by any affirmative mechanical
act such as unreasonably shutting-in, choking down or
intentionally damaging the wellbore for the purpose
of restricting the ability of the well to produce into
the pipeline.

Arnold E. Raether

CAULKINS OIL COMPANY
Arnold E. Raether, Treasurer

SUBSCRIBED AND SWORN to this 6th day of January, 1984,

by Arnold E. Raether.

Margaret A. Nelson
Notary Public

My Commission Expires:

August 18, 1986

All distances must be from the outer boundaries of the Section.

Operator CAULKINS OIL COMPANY			Lease Breach D		Well No. 140-M
Unit Letter D	Section 11	Township 26 NORTH	Range 6 WEST	County RIO ARriba	
Actual Footage Location of Well: 880 feet from the NORTH line and 1028 feet from the WEST line					
Ground Level Elev. 6597.0	Producing Formation Mesa Verde & Dakota		Pool Blanco Mesa Verde & Basin Dakota		Dedicated Acreage: 320 Acres

1. Outline the acreage dedicated to the subject well by colored pencil or hachure marks on the plat below.
2. If more than one lease is dedicated to the well, outline each and identify the ownership thereof (both as to working interest and royalty).
3. If more than one lease of different ownership is dedicated to the well, have the interests of all owners been consolidated by communitization, unitization, force-pooling, etc?

☐ Yes ☐ No If answer is "yes," type of consolidation _____

If answer is "no," list the owners and tract descriptions which have actually been consolidated. (Use reverse side of this form if necessary.) _____

No allowable will be assigned to the well until all interests have been consolidated (by communitization, unitization, forced-pooling, or otherwise) or until a non-standard unit, eliminating such interests, has been approved by the Division

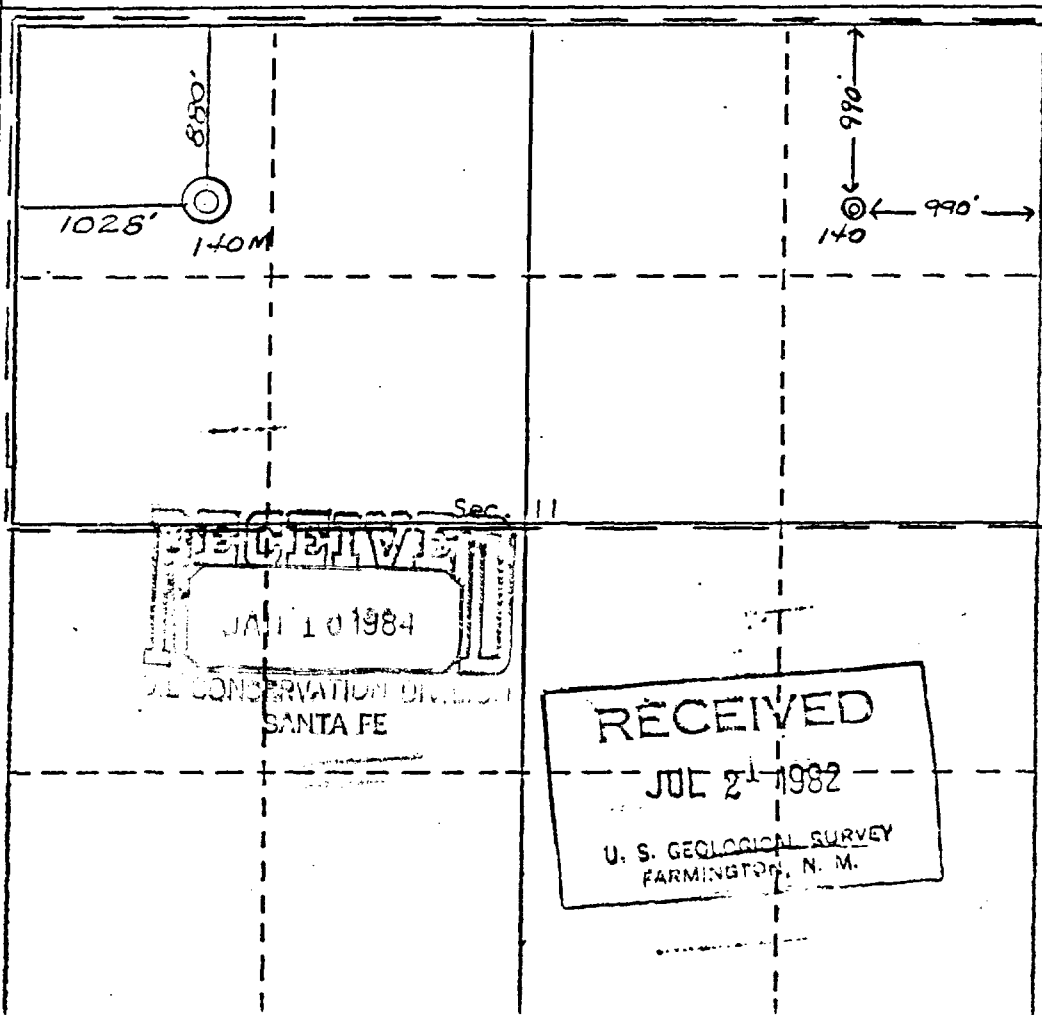

CERTIFICATION

I hereby certify that the information contained herein is true and complete to the best of my knowledge and belief.

Charles E. Verquer
Name

Charles E. Verquer
Position

Superintendent

Company
Caulkins Oil Company

Date
July 20, 1982

I hereby certify that the well location shown on this plat was plotted from field notes of actual surveys made by me or under my supervision, and that the same is true and correct to the best of my knowledge and belief.

REGISTERED LAND SURVEYOR
NEW MEXICO
Date Surveyed

Registered Professional Engineer
and/or Land Surveyor
C. J. C. STOKING

Certificate No.
5980

Attorney General



PAUL BARDACKE
Attorney General

Department of Justice

P.O. Drawer 1508
Santa Fe, New Mexico 87504
Telephone: (505) 827 6000

JOHN BIGELOW
Deputy Attorney General

February 16, 1984

Mr. Joe D. Ramey, Director
Oil Conservation Commission
P. O. Box 2088
Santa Fe, NM 87501

Re: Requests for Exemptions from New Mexico Natural Gas
Pricing Act

Dear Mr. Ramey:

Upon receipt of your letter of November 1, 1983, informing the Attorney General of possible violations of the New Mexico Natural Gas Pricing Act, this office undertook an investigation of those charges. As a result, the Attorney General determined that there have been and continue to be violations of the pricing provisions of the Act, and a decision was made to seek damages in district court.

These damages arise because several producers failed to obtain exemptions from coverage of the Act for infill wells and yet sold the gas from those wells at the price which would have been applicable if an exemption had been granted. Some of these producers have now filed requests for exemptions.

The decision of the Attorney General to enforce the Act under Section 62-7-7 (E) NMSA 1978 (1983 Cum. Supp.) pre-empts the authority of the Oil Conservation Commission to consider or act on any request for retroactive exemptions. However, subject to certain procedural steps, we have come to the conclusion that it would be appropriate for the Commission to proceed to process these applications for possible prospective exemptions.

Because of the pending litigation, the Commission should consider and act on applications for exemption status on production from wells occurring after the date of the filing of the lawsuit, November 15, 1983. Any production occurring before that date is the subject of the counterclaims and cross-claims filed by the Attorney General and the Commission

Mr. Joe D. Ramey, Director
February 16, 1984
Page 2

may not therefore act on requests involving that production. In addition, the Attorney General reserves the right to bring enforcement action against producers or purchasers for violations of the New Mexico Natural Gas Pricing Act for production occurring after November 15, 1984, depending on the findings and the outcome of the Commission hearings.

The additional procedural steps which we recommend should be taken are:

- 1) The administrative procedure established in order R-5436 may be used to establish application requirements but these prospective applications should not be approved administratively.
- 2) Each of these exemption requests should be brought to a hearing before the Oil Conservation Commission.
- 3) At the hearing of these exemptions requests, the applicant for exemption should have the burden of demonstrating that the exemption criteria set forth in Section 62-7-5 are met. In addition, the applicant should be required to certify, under oath or by affidavit, that the existing well on the proration unit has not had its ability to produce into the pipeline restricted in any manner since the drilling of the infill well.
- 4) The exemption hearing should be open to public participation under the same conditions that are applicable to all other Oil Conservation Commission hearings.
- 5) In the absence of objections by any party, the Commission may approve these applications based upon the filing made in accordance with the administrative procedure set forth in Order No. R-5436 and the additional requirements of paragraph No. 3, above.
- 6) It may be that a review of this infill problem will indicate that some additional reporting requirement is advisable. The order resulting from the hearing, whether opposed or not, will provide an opportunity to impose those reporting requirements.

I understand that in addition to the normal Commission notice procedure, the Public Service Commission has requested that it be given specific notice of any exemption hearing and I request that this office also receive such special notice.

Mr. Joe D. Ramey, Director
February 16, 1984
Page 3

Because many applications for exemption are now pending, I recommend that the Commission immediately take action to begin processing them, consistent with the suggestions contained in this letter. I shall appreciate your notifying me of your decision to proceed at your earliest opportunity, so that appropriate representations may be made to the court at a hearing now scheduled in the litigation for February 23, 1984. It would be helpful if your notification to me were in writing.

Thank you very much for your assistance. Please feel free to call on me at any time regarding this matter.

Sincerely,

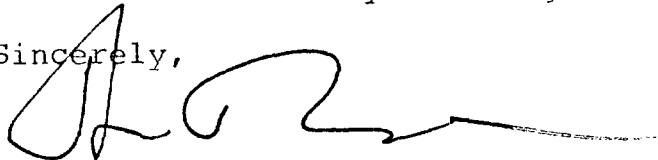
A handwritten signature in black ink, appearing to be 'John Bigelow', with a long horizontal flourish extending to the right.

JOHN BIGELOW
Deputy Attorney General

JB:lm

cc: Mr. Perry Pearce
Mr. Gary Epler

PROSPECTIVE

<u>DATE</u>	<u>OPERATOR</u>	<u>WELL NAME</u>	<u>LOCATION</u>
4-5-84	Caulkins Oil Co.	State "C" Com Well No. 235-R Pictured Cliffs	Sec. 16, T-26-N, R-6-W, Rio Arriba
4-5-84	Caulkins Oil Co.	✓ Breech Well No. 307-M Pictured Cliffs	Sec. 13, T-26-N, R-7-W, Rio Arriba
4-5-84	Caulkins Oil Co.	✓ Breech B Well No. 220-R Basin Dakota p.c.	Sec. 14, T-26-N, R-7-W, Rio Arriba

Jason Kellahin
W. Thomas Kellahin
Karen Aubrey
James B. Grant

KELLAHIN and KELLAHIN
Attorneys at Law
El Patio - 117 North Guadalupe
Post Office Box 2265
Santa Fe, New Mexico 87504-2265

Telephone 982-4285
Area Code 505

April 5, 1984

Mr. Joe D. Ramey
Oil Conservation Commission
Post Office Box 2088
Santa Fe, New Mexico 87501

APR 5 1984

RECEIVED

Re: Applications of Caulkins Oil Company for Exemption
from the Application of the New Mexico Natural Gas
Pricing Act for Three Replacement Wells

Dear Mr. Ramey:

Enclosed please find Applications for Exemption from the
Provisions of the New Mexico Natural Gas Pricing Act for
the following wells:

- (1) Replacement Well R325-R
- (2) Replacement Well 307-M
- (3) Replacement Well 220-R

Caulkins Oil Company requests that these exemptions be
effective as of the date of first production from the well.

By filing these applications Caulkins does not admit that
the granting of applications is anything but a nondiscretionary
ministerial act.

While Caulkins Oil Company does not believe that a hearing
is required in order to obtain approval of these applications
in the event the Commission determines that a hearing is
necessary we would appreciate it if one could be set as
soon as possible.

By copy of this letter we are filing a duplicate set of
applications with the Aztec office.

Thank you for your assistance.

Sincerely,

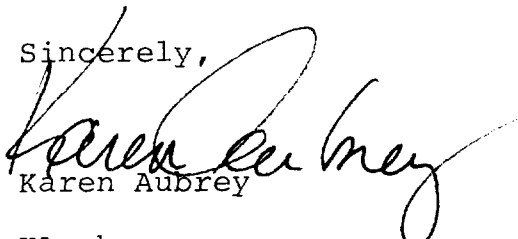
Karen Aubrey

KA:mh

Enclosures

cc: Mr. Arnold Raether, Caulkins Oil Company
Mr. Frank Chavez, Aztec office

APR 5 1984

Rule #1

Replacement well 235-R, located 1070' From North and 920' From East of Section 16, 26N 6W drilled to replace well No. 235 located 990' From North and 1800' From East of Section 16, 26N 6W.

Rule #2

235 well spudded 11-22-51 open hole Completion.
Interval 3029' to 3105' shot with 660 Qt. SNG 1-9-52.
No record of when well turned on line.

11-17-61 Open hole interval 3036' to 3065' Fractured with 50,000# 10-20 sand and 29,540 gallons water. Test after Fracture treatment 534 MCFPD. Test before Fracture treatment 103 MCFPD.

7-5-62 Moved in Rig to pull 1" tubing plugged with sand. Tubing was dropped in dry hole while coming out. Fished for 1" tubing and cleaned out to 2730' leaving 21 joints 1" tubing in hole. Reran 1" tubing to 2726' and turned well on line.

Rule #4

Set for hearing.

Rule # 5

Plat attached.

Rule #6

- (a) Cost of replacing 235 Pictured Cliffs in new well 235-R as allocated from total cost of new well, \$46,856.90.
- (b) 235 has formation damage due to not being able to remove fluids below 2726'.
- (d) Plugging information on 235 attached.

Rule #8

(235-R) Copy of spudding notice, Completion report and Gas Company of New Mexico Notice of 1st delivery of gas.

CAULKINS OIL COMPANY

P. O. BOX 780
FARMINGTON, NEW MEXICO 87401

PRORATION UNIT: NE 1/4 of Section 16 26N 6W, Rio Arriba County, N.M.

Well No. 235 - Original well Pictured Cliffs Zone, marked with arrow

Well No. 235 R - Replacement well Pictured Cliffs Zone, marked with circle

All acreage on this plat, not otherwise identified, operated by Caulkins

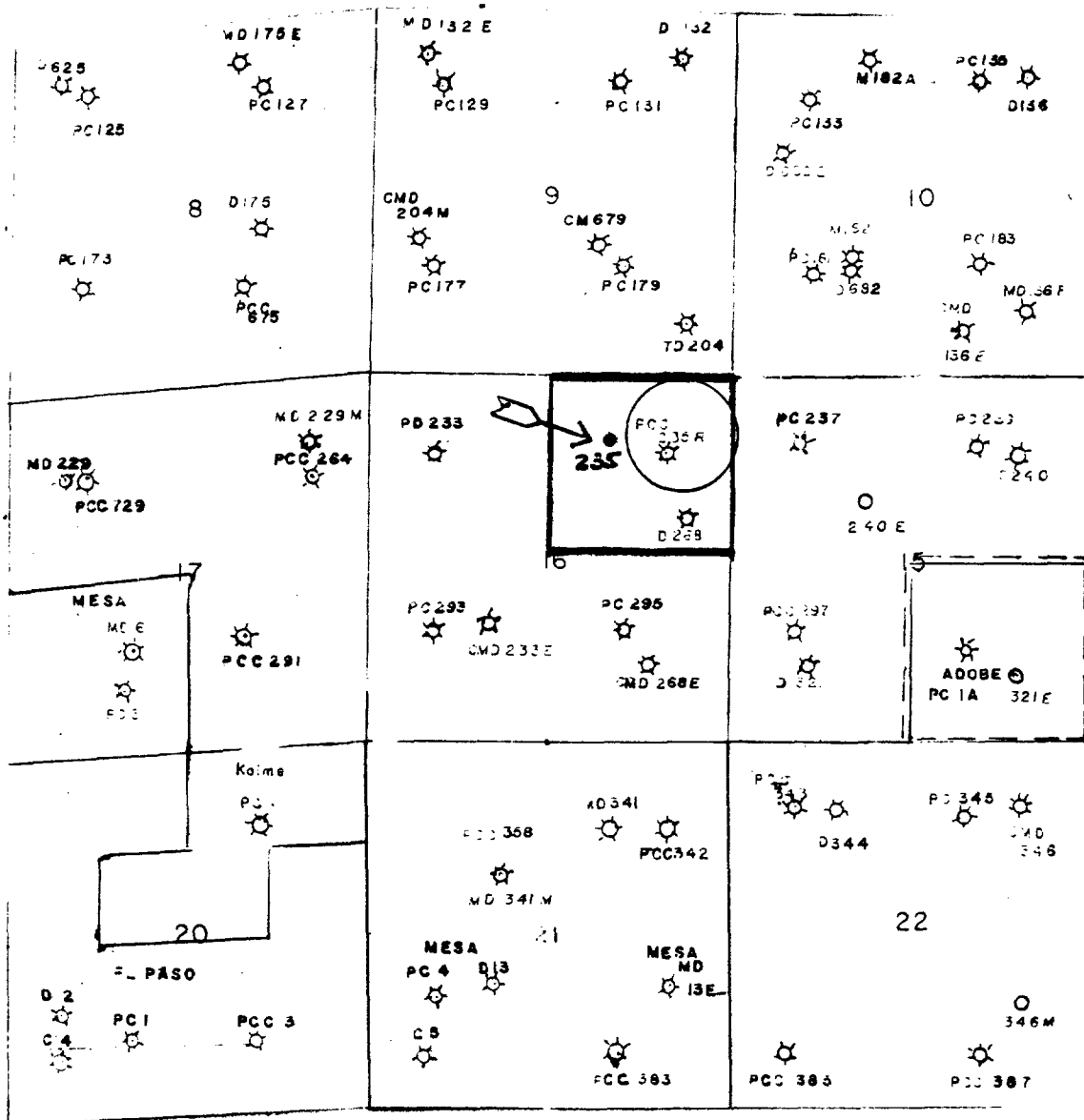

P or PC = Pictured Cliffs Completion
C = Chacra Completion
M or MV = Mesa Verde Completion
D = Dakota Completion

NO. OF COPIES RECEIVED	5
DISTRIBUTION	
SANTA FE	
FILE	
U.S.G.S.	
LAND OFFICE	
OPERATOR	3

NEW MEXICO OIL CONSERVATION COMMISSION

Form C-103
Supersedes Old
C-102 and C-103
Effective 1-1-65

5a. Indicate Type of Lease	
State <input checked="" type="checkbox"/>	Fee <input type="checkbox"/>
5. State Oil & Gas Lease No.	
E-291-25	
7. Unit Agreement Name	
8. Farm or Lease Name	
State C. Comm.	
9. Well No.	
235	
10. Field and Pool, or Wildcat	
South Blanco PC	
12. County	
Rio Arriba	

SUNDRY NOTICES AND REPORTS ON WELLS	
(DO NOT USE THIS FORM FOR PROPOSALS TO DRILL OR TO DEEPEN OR PLUG BACK TO A DIFFERENT RESERVOIR. USE "APPLICATION FOR PERMIT -" (FORM C-101) FOR SUCH PROPOSALS.)	
1. OIL WELL <input type="checkbox"/> GAS WELL <input checked="" type="checkbox"/> OTHER- <input type="checkbox"/>	
2. Name of Operator	
Caulkins Oil Company	
3. Address of Operator	
Post Office Box 780, Farmington, New Mexico	
4. Location of Well	
UNIT LETTER B, 990 FEET FROM THE North LINE AND 1800 FEET FROM	
THE East LINE, SECTION 16 TOWNSHIP 26-N RANGE 6-W NMPM.	
15. Elevation (Show whether DF, RT, GR, etc.)	
6654 DF	

16. Check Appropriate Box To Indicate Nature of Notice, Report or Other Data	
NOTICE OF INTENTION TO:	
PERFORM REMEDIAL WORK <input type="checkbox"/>	PLUG AND ABANDON <input checked="" type="checkbox"/>
TEMPORARILY ABANDON <input type="checkbox"/>	CHANGE PLANS <input type="checkbox"/>
PULL OR ALTER CASING <input type="checkbox"/>	OTHER <input type="checkbox"/>
SUBSEQUENT REPORT OF:	
REMEDIAL WORK <input type="checkbox"/>	ALTERING CASING <input type="checkbox"/>
COMMENCE DRILLING OPNS. <input type="checkbox"/>	PLUG AND ABANDONMENT <input type="checkbox"/>
CASING TEST AND CEMENT JOB <input type="checkbox"/>	OTHER <input type="checkbox"/>

17. Describe Proposed or Completed Operations (Clearly state all pertinent details, and give pertinent dates, including estimated date of starting any proposed work) SEE RULE 1703.

Present condition: Flowing avg. 33 MCFPD to pipeline.
TD 3105'
8 5/8" casing cemented top to bottom 605'
5 1/2" casing cemented 3019' to approx 1600' (top of Alamo 2315')
1" line pipe tubing at 2726'.
Junk 1" tubing below 2726'. (Junk in well makes it impossible to clean well.)
Replacement well has been drilled in this proration unit. It is now proposed to plug and abandon this well in following manner:

Pull 1" tubing now set at 2726'.
Run 2" tubing with packer and set at approx 2700' and spot cement plug 2700' to TD. Then fill pipe 2700' to 100' with 9# Gel Base Mud.
Spot 100' cement plug 100' to surface, and install marker.

18. I hereby certify that the information above is true and complete to the best of my knowledge and belief.		
SIGNED <u>Charles E. Vergara</u>	TITLE <u>Superintendent</u>	DATE <u>7-10-78</u>
APPROVED BY <u>AR Kendrick</u>	TITLE _____	DATE _____
CONDITIONS OF APPROVAL, IF ANY:		

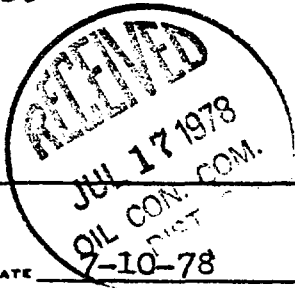

NO. OF COPIES RECEIVED	6
DISTRIBUTION	
SANTA FE	1
FILE	
U.S.G.S.	
LAND OFFICE	
OPERATOR	4

NEW MEXICO OIL CONSERVATION COMMISSION

Form C-103
Supersedes Old
C-102 and C-103
Effective 1-1-65

5a. Indicate Type of Lease
State <input checked="" type="checkbox"/> Fee <input type="checkbox"/>
5. State Oil & Gas Lease No.
E-291-25
7. Unit Agreement Name
8. Farm or Lease Name
State C Comm.
9. Well No.
235
10. Field and Pool, or Wildcat
South Flanco PC
12. County
Rio Arriba

SUNDRY NOTICES AND REPORTS ON WELLS

(DO NOT USE THIS FORM FOR PROPOSALS TO DRILL OR TO DEEPEN OR PLUG BACK TO A DIFFERENT RESERVOIR.
USE "APPLICATION FOR PERMIT -" (FORM C-101) FOR SUCH PROPOSALS.)

1. OIL WELL <input type="checkbox"/> GAS WELL <input checked="" type="checkbox"/> OTHER <input type="checkbox"/>	7. Unit Agreement Name
2. Name of Operator	8. Farm or Lease Name
Caulkins Oil Company	State C Comm.
3. Address of Operator	9. Well No.
P.O. Box 780, Farmington, New Mexico 87401	235
4. Location of Well	10. Field and Pool, or Wildcat
UNIT LETTER B 990 FEET FROM THE North LINE AND 1800 FEET FROM	South Flanco PC
THE East LINE, SECTION 16 TOWNSHIP 26 N RANGE 6E NMPM.	
15. Elevation (Show whether DF, RT, GR, etc.)	12. County
6654 Gr	Rio Arriba

16. Check Appropriate Box To Indicate Nature of Notice, Report or Other Data

NOTICE OF INTENTION TO:

PERFORM REMEDIAL WORK <input type="checkbox"/>	PLUG AND ABANDON <input type="checkbox"/>
TEMPORARILY ABANDON <input type="checkbox"/>	CHANGE PLANS <input type="checkbox"/>
PULL OR ALTER CASING <input type="checkbox"/>	OTHER <input type="checkbox"/>

SUBSEQUENT REPORT OF:

REMEDIAL WORK <input type="checkbox"/>	ALTERING CASING <input type="checkbox"/>
COMMENCE DRILLING OPNS. <input type="checkbox"/>	PLUG AND ABANDONMENT <input checked="" type="checkbox"/>
CASING TEST AND CEMENT JOBS <input type="checkbox"/>	OTHER <input type="checkbox"/>

17. Describe Proposed or Completed Operations (Clearly state all pertinent details, and give pertinent dates, including estimated date of starting any proposed work) SEE RULE 1103.

8-11-78 - Pulled 1" tubing set at 2626'.

Ran 2" tubing with packer set at 2680 and squeezed cement away 2680 to 3105.
Used 75 sacks cement.

8-12-78 Spotted 9.1# Gel based mud 2680 to 650'.

Spotted cement 650 to 550 inside and outside of 5 1/2" casing to tie 8 5/8" surface casing to formation.

Spotted 100' plug 0 to 180' in top of 5 1/2" casing.

8-15-78 Welded 4 1/2" OD marker to top of 5 1/2" casing.

SEP 15 1978
OIL CON. COM.
DIST. 3

Note: Will submit subsequent report when location cleaned and ready for final inspection.

18. I hereby certify that the information above is true and complete to the best of my knowledge and belief.

SIGNED <u>Charles E. Vergues</u>	TITLE <u>Superintendent</u>	DATE <u>9-8-78</u>
APPROVED BY <u>AR Kendrick</u>	SUPERVISOR DISTRICT <u>3</u>	DATE <u>JUL 10 1979</u>
CONDITIONS OF APPROVAL, IF ANY:		

DISTRIBUTION		
SANTA FE	/	
FILE	/	
U.S.G.S.		
LAND OFFICE		
OPERATOR	/	

NEW MEXICO OIL CONSERVATION COMMISSION

Supersedes
C-102 and C-103
Effective 1-1-65

5a. Indicate Type of Lease
State <input checked="" type="checkbox"/> Fee <input type="checkbox"/>
5. State Oil & Gas Lease No.
E-291-17 & E-291-25

SUNDRY NOTICES AND REPORTS ON WELLS (DO NOT USE THIS FORM FOR PROPOSALS TO DRILL OR TO DEEPEN OR PLUG BACK TO A DIFFERENT RESERVOIR. USE "APPLICATION FOR PERMIT -" (FORM C-101) FOR SUCH PROPOSALS.)	
1. <input type="checkbox"/> OIL WELL <input checked="" type="checkbox"/> GAS WELL <input type="checkbox"/> OTHER-	7. Unit Agreement Name
2. Name of Operator Caulkins Oil Company	8. Farm or Lease Name
3. Address of Operator P.O. Box 780 Farmington, New Mexico	State "C" Com
4. Location of Well UNIT LETTER <u>A</u> <u>1070</u> FEET FROM THE <u>North</u> LINE AND <u>920</u> FEET FROM THE <u>East</u> LINE, SECTION <u>16</u> TOWNSHIP <u>26N</u> RANGE <u>6W</u> NMPM.	9. Well No. 235-R
	10. Field and Pool or Wildcat South Blanco PC Otero-Chacra
15. Elevation (Show whether DF, RT, GR, etc.) 6530 Gr	12. County Rio Arriba

16. Check Appropriate Box To Indicate Nature of Notice, Report or Other Data/ NOTICE OF INTENTION TO:		SUBSEQUENT REPORT OF:	
PERFORM REMEDIAL WORK <input type="checkbox"/>	PLUS AND ABANDON <input type="checkbox"/>	REMEDIAL WORK <input type="checkbox"/>	ALTERING CASING <input type="checkbox"/>
TEMPORARILY ABANDON <input type="checkbox"/>	CHANGE PLANS <input type="checkbox"/>	COMMENCE DRILLING OPNS. <input type="checkbox"/>	PLUS AND ABANDONMENT <input type="checkbox"/>
PLUG OR ALTER CASING <input type="checkbox"/>	OTHER <input type="checkbox"/>	CASING TEST AND CEMENT JOB <input checked="" type="checkbox"/>	OTHER <input type="checkbox"/>

17. Describe Proposed or Completed Operations (Clearly state all pertinent details, and give pertinent dates, including estimated date of starting any proposed work) SEE RULE 1103.

Spud at 2:00 PM 6-21-78

Drilled 12 1/4" hole to 100'.

Cemented 8 5/8" 24# J-55 New Casing at 97' with 100 sacks 2% CaCL.

Plug down at 9:15 pm 6-21-78

Cement circulated to surface.

Tested casing with 500# 6-22-78.

No decrease in pressure.



18. I hereby certify that the information above is true and complete to the best of my knowledge and belief.

SIGNED Deane B. Blaggett TITLE Prod. Foreman
Frank E. Gray DEPUTY OIL & GAS INSPECTOR, DIST. #3
JUL 3 1978
JUL 6 1978

NO. OF COPIES RECEIVED	6
DISTRIBUTION	
SANTA FE	1
FILE	1
U.S.G.S.	2
LAND OFFICE	1
OPERATOR	1

NEW MEXICO OIL CONSERVATION COMMISSION
WELL COMPLETION OR RECOMPLETION REPORT AND LOG

Form C-105
Revised 11-6-68

5a. Indicate Type of Lease
State <input checked="" type="checkbox"/> Fee <input type="checkbox"/>
5. State Oil & Gas Lease No.
E-291-17 and E-291-25

1a. TYPE OF WELL
OIL WELL <input type="checkbox"/> GAS WELL <input checked="" type="checkbox"/> DRY <input type="checkbox"/> OTHER <input type="checkbox"/>
b. TYPE OF COMPLETION
NEW WELL <input checked="" type="checkbox"/> WORK OVER <input type="checkbox"/> DEEPEN <input type="checkbox"/> PLUG BACK <input type="checkbox"/> DIFF. RESVR. <input type="checkbox"/> OTHER <input type="checkbox"/>

7. Unit Agreement Name
8. Form or Lease Name
STATE C COMM
9. Well No.
235 R.
10. Operator and Other Wildcat
OTERO CHACRA
SOUTH BLANCO PC

2. Name of Operator
CAULKINS OIL COMPANY
3. Address of Operator
P.O. BOX 780, FARMINGTON, NEW MEXICO
4. Location of Well

UNIT LETTER	A	LOCATED	1070	FEET FROM THE	North	LINE AND	920	FEET FROM
THE East	LINE OF SEC.	16	TWP.	26N	RGE.	6W	NMPM	

15. Date Spudded	16. Date T.D. Reached	17. Date Compl. (Ready to Prod.)	18. Elevations (DF, RKB, RT, GR, etc.)	19. Elev. Casinghead	
6-21-78	6-29-78	8-8-78	6530 GR	6531	
20. Total Depth	21. Plug Back T.D.	22. If Multiple Compl., How Many	23. Intervals Drilled By	Rotary Tools	Cable Tools
3976	3976	two	0-3976		
24. Producing Interval(s), of this completion - Top, Bottom, Name	25. Was Directional Survey Made				
2920- 3017 Pictured Cliffs	No				
3800- 3906 Chacra					

26. Type Electric and Other Logs Run	27. Was Well Cored
GRN	No

28. CASING RECORD (For all casing used in well)					
CASING SIZE	WEIGHT LB./FT.	DEPTH SET	HOLE SIZE	CEMENTING RECORD	AMOUNT PULLED
8 5/8	24	100	12 1/2	100	None
4 1/2	10.5	3976	7 7/8	740	None

29. LINER RECORD				30. TUBING RECORD			
SIZE	TOP	BOTTOM	SACKS CEMENT	SCREEN	SIZE	DEPTH SET	PACKER SET
					1 1/2	3901	None

31. Perforation Record (Interval, size and number)	32. ACID, SHOT, FRACTURE, CEMENT SQUEEZE, ETC.	
Two .38 hole at each of the following: 3800, 3808, 3814, 3819, 3825, 3833, 3845, 3854, 3862, 3883, and 3905. One .38 hole for: 2920, 2926, 2940, 2945, 2950, 2957, 2970, 2984, 3006, and 3017.	DEPTH INTERVAL	AMOUNT AND KIND MATERIAL USED
	2920- 3017	fraced w/ 60,000 20-40 sand and 1474 bbls water.
	3800- 3906	fraced w/ 50,000 #20-40 sand and 1400 bbls water.

33. PRODUCTION							
Date First Production		Production Method (Flowing, gas lift, pumping - Size and type pump)				Well Status (Prod. or Shut-in)	
8-15-78		flowing				Shut In	
Date of Test	Hours Tested	Choke Size	Prod'n. For Test Period	Oil - Bbl.	Gas - MCF	Water - Bbl.	Gas-Oil Ratio
8-15-78	3	3/4			199		
Flow Tubing Press.	Casing Pressure	Calculated 24-Hour Rate	Oil - Bbl.	Gas - MCF	Water - Bbl.	Oil Gravity - API (Corr.)	
40	435			1597			

34. Disposition of Gas (Sold, used for fuel, vented, etc.)	Test Witnessed By
VENTED	

35. List of Attachments

36. I hereby certify that the information shown on both sides of this form is true and complete to the best of my knowledge and belief.		
SIGNED	Charles E. Vergara	Supt.
		DATE 9-8-78

DISTRIBUTION		6
SANTA FE		1
FILE		1
U.S.G.S.		
LAND OFFICE		
TRANSPORTER	OIL	
	GAS	1
OPERATOR		3
PRORATION OFFICE		

NEW MEXICO OIL CONSERVATION COMMISSION
REQUEST FOR ALLOWABLE
AND
AUTHORIZATION TO TRANSPORT OIL AND NATURAL GAS

Form C-104
Supersedes Old C-104 and C-110
Effective 1-1-65

Operator Caulkins Oil Company	
Address Post Office Box 780, Farmington, New Mexico	
Reason(s) for filing (Check proper box)	
New Well <input checked="" type="checkbox"/>	Change in Transporter of:
Recompletion <input type="checkbox"/>	Oil <input type="checkbox"/> Dry Gas <input type="checkbox"/>
Change in Ownership <input type="checkbox"/>	Casinghead Gas <input type="checkbox"/> Condensate <input type="checkbox"/>
Other (Please explain) <i>Commingled</i>	

If change of ownership give name
and address of previous owner

II. DESCRIPTION OF WELL AND LEASE

Lease Name State C Comm	Well No. 235 R	Pool Name, including Formation South Blanco Pictured Cliff	Kind of Lease State, Federal or Fee	State	Lease No. 291 17 291 25
Location Unit Letter A ; 1070 Feet From The North Line and 920 Feet From The East					
Line of Section 16 Township 26 North Range 6 West , NMPM, Rio Arriba County					

III. DESIGNATION OF TRANSPORTER OF OIL AND NATURAL GAS

Name of Authorized Transporter of Oil <input type="checkbox"/> or Condensate <input type="checkbox"/>	Address (Give address to which approved copy of this form is to be sent)					
Name of Authorized Transporter of Casinghead Gas <input type="checkbox"/> or Dry Gas <input checked="" type="checkbox"/>	Address (Give address to which approved copy of this form is to be sent)					
Gas Company of New Mexico	1508 Pacific Ave., Dallas, Texas					
If well produces oil or liquids, give location of tanks.	Unit	Sec.	Twp.	Pge.	Is gas actually connected? No	When

If this production is commingled with that from any other lease or pool, give commingling order number:

R-5648

IV. COMPLETION DATA

Designate Type of Completion - (X)	Oil Well	Gas Well	New Well	Workover	Deepen	Plug Back	Same Res'r.	Diff. Res'r.
		X	X					
Date Spudded 6-21-78	Date Compl. Ready to Prod. 8-8-78	Total Depth 3976	P.B.T.D. 3976					
Elevations (DF, RKB, RT, GR, etc.) 6530 Gr.	Name of Producing Formation Pictured Cliffs	Top Oil/Gas Pay 2920 + 3800	Tubing Depth 3901					
Perforations 2920 to 3017 + 3800 - 3906	Chasera					Depth Casing Shoe 3976		

TUBING, CASING, AND CEMENTING RECORD

HOLE SIZE	CASING & TUBING SIZE	DEPTH SET	SACKS CEMENT
12 1/4	8 5/8	100'	100
7 7/8	4 1/2	3976	740
	1 1/4	3901	

V. TEST DATA AND REQUEST FOR ALLOWABLE OIL WELL

(Test must be after recovery of total volume of load oil and must be equal to or exceed top allowable for this depth or be for full 24 hours)

Date First New Oil Run To Tanks	Date of Test	Producing Method (Flow, pump, gas lift, etc.)	
Length of Test	Tubing Pressure	Casing Pressure	Choke Size
Actual Prod. During Test	Oil-Bbls.	Water-Bbls.	Gas-MCF

GAS WELL

Actual Prod. Test-MCF/D 1118 1597	Length of Test 3 hours	Bbls. Condensate/MMCF	Gravity of Condensate
Testing Method (pilot, back pr.) Back Pressure	Tubing Pressure (Shut-in) 545	Casing Pressure (Shut-in) 540	Choke Size 3/4

CERTIFICATE OF COMPLIANCE

I hereby certify that the rules and regulations of the Oil Conservation Commission have been complied with and that the information given above is true and complete to the best of my knowledge and belief.

Charles E. Vesper
(Signature)
Superintendent
(Title)
9-8-78
(Date)

OIL CONSERVATION COMMISSION

APPROVED SEP 15 1978
BY *DR. J. J. Smith*
TITLE SUPERVISOR DIST. #2

This form is to be filed in compliance with RULE 1104.

If this is a request for allowable for a newly drilled or deepened well, this form must be accompanied by a tabulation of the deviation tests taken on the well in accordance with RULE 111.

All sections of this form must be filled out completely for allowable on new and recompleted wells.

Fill out only Sections I, II, III, and VI for changes of owner, well name or number, or transporter, or other such change of condition. Separate Forms C-104 must be filed for each well in multiple.

OIL CONSERVATION COMMISSION

1000 Rio Drazos Road

AZTEC, NEW MEXICO 87410

NOTICE OF GAS CONNECTION

DATE January 26, 1979

THIS IS TO NOTIFY THE OIL CONSERVATION COMMISSION THAT CONNECTION FOR THE PURCHASE OF

GAS FROM THE Caulkins Oil Company
OPERATOR

State C Comm

235-R

(A)16-26N-06W

LEASE

WELL UNIT

S - T - R

South Blanco Pictured Cliffs

Gas Company of New Mexico

POOL

NAME OF PURCHASER

WAS MADE ON 1-25-79
DATE

, FIRST DELIVERY 1-27-79
DATE

INITIAL POTENTIAL

NOTE: COMINGLED WITH OTERO CHACRA POOL.

Gas Company of New Mexico
PURCHASER

James R. Large
REPRESENTATIVE
James R. Large
Dispatch Manager
TITLE

/sw

cc: OPERATOR

New Mexico Oil Conservation Commission - Aztec
U. S. Geological Survey
Mr. E. R. Corliss, Engineering
Mr. R. J. McCrary, Prorations
Mr. W. B. Richardson, Gas Measurement
Mr. Dan McFearn, Gas Accting.
Ms. Gail Atkins, Gas Supply
Mr. Ron Coffee, Kutz
File

RULES AND REGULATIONS NGPA SECTION 6

APR 5 1984

Rule #1

RECEIVED

307-M located 1120' From South and 1520' From East of Section 13, 26N 7W, Rio Arriba County, New Mexico to replace 310 located 965' From South and 1125' From East of Section 13, 26N 7W.

Rule #2

Well history on attached Sundry Notice form.

Rule #4

Set for hearing for exemption.

Rule #5

Plat attached.

Rule #6

- (a) Cost of replacing 310 Pictured Cliffs in new well No. 307-M as allocated from total cost of new well \$28,076.11.
- (b) 310 casing failure also caused formation damage due to water migrating from Alamo Water Sands into Pictured Cliffs Sand.
- (d) Plugging information attached.

Rule #8

(307-M) Copy of Spudding Notice, Completion Report and C-104 ~~4~~ Copy of Gas Company of New Mexico Notice of 1st delivery of Gas.

UNITED STATES
DEPARTMENT OF THE INTERIOR
GEOLOGICAL SURVEY

SUNDRY NOTICES AND REPORTS ON WELLS

(Do not use this form for proposals to drill or to deepen or plug back to a different reservoir. Use Form 9-331-C for such proposals.)

1. oil ☐ gas ☒ well ☐ other ☐
2. NAME OF OPERATOR
Caukins Oil Company
3. ADDRESS OF OPERATOR
P.O. Box 780 Farmington, New Mexico
4. LOCATION OF WELL (REPORT LOCATION CLEARLY. See space 17 below.)
AT SURFACE: 965' From South & 1125' From East
AT TOTAL DEPTH: Same

16. CHECK APPROPRIATE BOX TO INDICATE NATURE OF NOTICE.
REPORT, OR OTHER DATA

REQUEST FOR APPROVAL TO: SUBSEQUENT REPORT OF
TEST WATER SHUT-OFF ☐
FRACTURE TREAT ☐
SHOOT OR ACIDIZE ☐
REPAIR WELL ☐
PULL OR ALTER CASING ☐
MULTIPLE COMPLETE ☐
CHANGE ZONES ☐
ABANDON (other) ☐

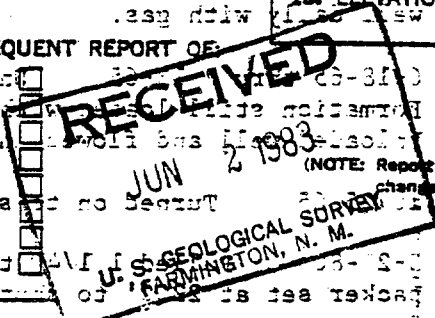

17. DESCRIBE PROPOSED OR COMPLETED OPERATIONS (Clearly state all pertinent details, and give pertinent dates, including estimated date of starting any proposed work. If well is directionally drilled, give subsurface locations and measured and true vertical depths for all markers and zones pertinent to this work.)

Well History:
Spud 6:00 AM 10-16-58.
8 5/8" 24# J-55 casing cemented 127' with 100 sacks.
Cement circulated. Plug down 2:00 PM 10-16-58.
Drilled 7 7/8" hole to TD 2475'. Cemented 5 1/2" I-4# J-55 casing at 2460' with 200 sacks. Plug down 10-21-58. No temperature survey run. Calculated top 1395'.
Completed ready to produce thru perforations 2356' to 2390' 10-21-58.
(Continued on attached sheet)
Subsurface Safety Valve: Manu. and Type

18. I hereby certify that the foregoing is true and correct

SIGNED Charles E. Quinn TITLE Superintendent DATE 6-1-83

(This space for Federal or State office use)

APPROVED BY
CONDITIONS OF APPROVAL, IF ANY:

TITLE
DATE

DISTRICT ENGINEER

*See Instructions on Reverse Side

OPERATOR

ILLEGIBLE

5. LEASE
NM 03733
6. IF INDIAN, ALLOTTEE OR TRIBE NAME
7. UNIT AGREEMENT NAME
8. FARM OR LEASE NAME
Breech
9. WELL NO.
310
10. FIELD OR WILDCAT NAME
South Blanco Pictured Cliffs
11. SEC., T., R., M. OR BLK. AND SURVEY OR AREA
Section 13 26 North 7 West
12. COUNTY OR PARISH 13. STATE
Rio Arriba New Mexico
14. API NO.
15. ELEVATIONS (SHOW OF, KOB, AND WD)
6155 DF

Continued

1977	24,343	Annual Gas Production
1978	17,754	"
1979	18,576	"
1980	2,437	"
1981	167	"
1982	3,897	"

It is now proposed to Plug and Abandon Pictured Cliffs formation in this well and replace it in Well No. 307-M, to be drilled 1120' from South and 1520' from East of Section 13, 26 North, 6 West.

Formation Tops:

Ojo Alamo	1608'
Pictured Cliffs	2350'

We propose to pull tubing with Packer then run Bond Log from 2400' to surface to determine cement top and also cement top and bottoms of squeeze job done in 1965.

Cement Plugs will then be set over perforations 2356' to 2390' and up the hole to 2250'.

If cement covered Ojo Alamo 1608' to 1830' a 100' Plug will be set inside casing 1550' to 1650'. If it is not covered 5 1/2" casing will be perforated and then squeezed at the top of the Alamo.

A Cement Plug will be spotted 50' below previous leak area 1360' to 1100' (60' above top of bad casing.)

5 1/2" casing will be perforated at 127' and a 25 sack squeeze job done to tie in surface casing and production casing.

A Cement Plug will be spotted from 127' to surface.

A Monument will be permanently welded to top of 5 1/2" casing and engraved with required information.

Proposed starting date of plugging operations, August 1, 1983.

CAULKINS OIL COMPANY

P. O. BOX 780
FARMINGTON, NEW MEXICO 87401

PRORATION UNIT: SE 1/4 of Section 13 26N 7W, Rio Arriba County, N.M.

Well No. 310 - Original well Pictured Cliffs Zone, marked with arrow

Well No. 307 M - Replacement well Pictured Cliffs Zone, marked with circle

All acreage on this plat, not otherwise identified, operated by Caulkins

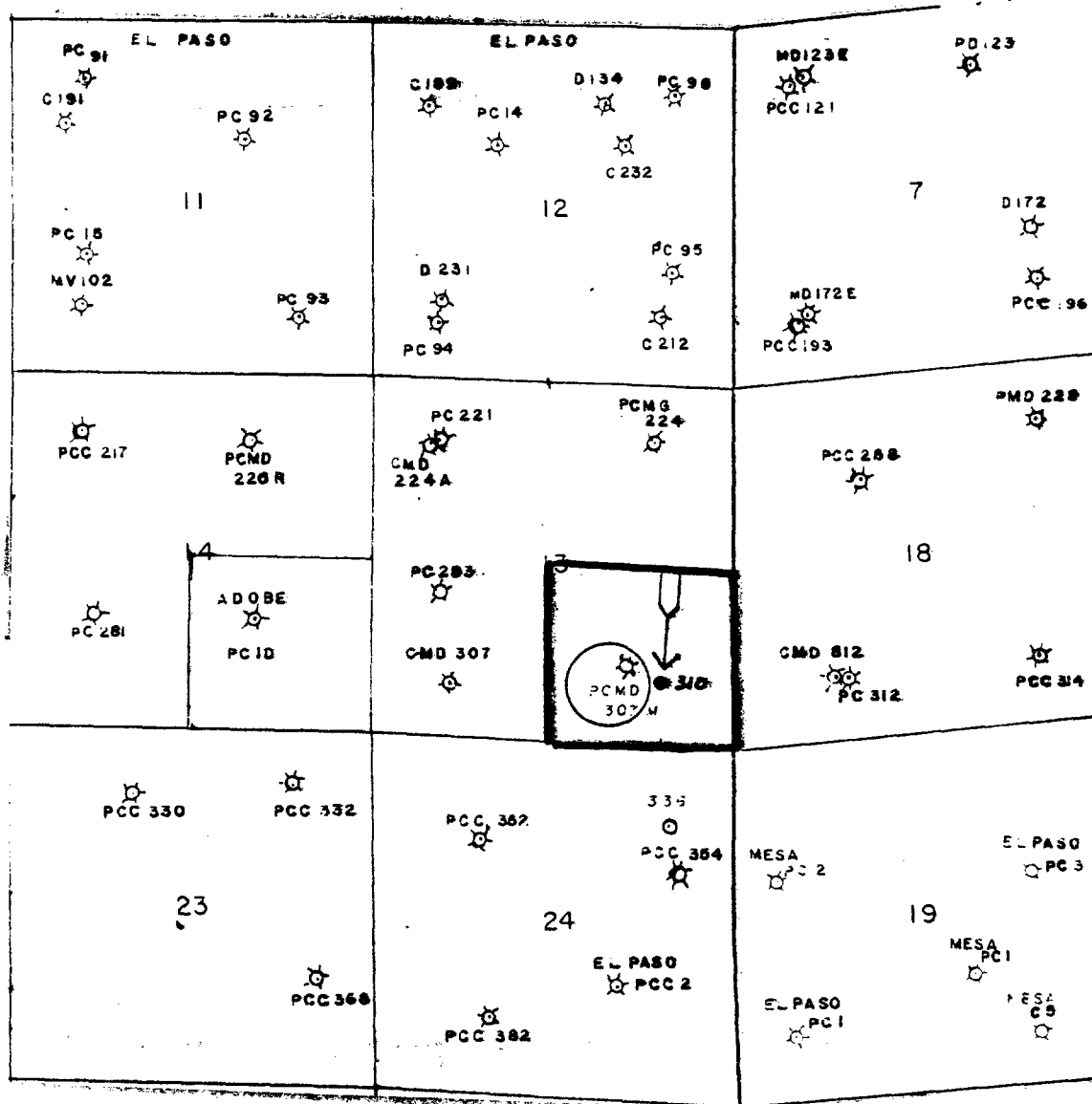

P or PC = Pictured Cliffs Completion
C = Chacra Completion
M or MV = Mesa Verde Completion
G = Greenhorn Completion
D = Dakota Completion

UNITED STATES
DEPARTMENT OF THE INTERIOR
GEOLOGICAL SURVEY

SUNDRY NOTICES AND REPORTS ON WELLS

(Do not use this form for proposals to drill or to deepen or plug back to a different reservoir. Use Form 9-331-C for such proposals.)

1. oil well ☐ gas well ☒ other ☐
2. NAME OF OPERATOR
Caulkins Oil Company
3. ADDRESS OF OPERATOR
P.O. Box 780 Farmington, New Mexico
4. LOCATION OF WELL (REPORT LOCATION CLEARLY. See space 17 below.)
AT SURFACE: 965' From South & 1125' From East
AT TOP PROD. INTERVAL: Same
AT TOTAL DEPTH: Same

16. CHECK APPROPRIATE BOX TO INDICATE NATURE OF NOTICE, REPORT, OR OTHER DATA:

REQUEST FOR APPROVAL TO:

TEST WATER SHUT-OFF ☐
FRACTURE TREAT ☐
SHOOT OR ACIDIZE ☐
REPAIR WELL ☐
PULL OR ALTER CASING ☐
MULTIPLE COMPLETE ☐
CHANGE ZONES ☐
ABANDON* ☐
(other) ☐

SUBSEQUENT REPORT OF:

☐
☐
☐
☐
☐
☐
☐
☒

5. LEASE
NM 03733
6. IF INDIAN, ALLOTTEE OR TRIBE NAME
7. UNIT AGREEMENT NAME
8. FARM OR LEASE NAME
Breach
9. WELL NO.
310
10. FIELD OR WILDCAT NAME
South Blanco Pictured Cliffs
11. SEC., T., R., M., OR BLK. AND SURVEY OR AREA
Section 13, 26 North, 7 West
12. COUNTY OR PARISH
Rio Arriba
13. STATE
New Mexico
14. API NO.
15. ELEVATIONS (SHOW OF, KDB, AND WD)
6155 DF

(NOTE: Report results of multiple completion or zone change on Form 9-330.)

17. DESCRIBE PROPOSED OR COMPLETED OPERATIONS (Clearly state all pertinent details, and give pertinent dates, including estimated date of starting any proposed work. If well is directionally drilled, give subsurface locations and measured and true vertical depths for all markers and zones pertinent to this work.)*

8-2-83 Ran Cement Bond Log.
Found cement covering Alamo. Cement top 1200'.
Perforated 2 holes in 5 1/2" Casing at 126'.
Ran 2 3/8" Tubing to 2400'.
Spotted cement 2400' to 2100'. (41 Cu.Ft.)
Spotted 9# Gel Based Mud 2100' to 1900'.
Spotted Cement Plug inside pipe 1900' to 1550'. (58 Cu.Ft.)
Spotted 9# Gel Based Mud 1550' to 1200'.
Spotted Cement Plug 1200' to 900'. (41 Cu.Ft.)
Spotted 9# Gel Based Mud 900' to 126'.
Circulated Cement surface to 126' (perforations) and back to surface thru Bradenhead. (Over)

Subsurface Safety Valve: Make and Type _____ Set @ _____ Ft.

18. I hereby certify that the foregoing is true and correct

SIGNED Charles E. Vergara TITLE Superintendent

DATE 8-17-83

(This space for Federal or State use)

APPROVED BY _____ TITLE _____
CONDITIONS OF APPROVAL, IF ANY: _____

DATE _____

Instructions

General: This form is designed for submitting proposals to perform certain well operations, and reports of such operations when completed, as indicated, on Federal and Indian lands pursuant to applicable Federal law and regulations, and, if approved or accepted by any State, on all lands in such State, pursuant to applicable State law and regulations. Any necessary special instructions concerning the use of this form and the number of copies to be submitted, particularly with regard to local, area, or regional procedures and practices, either are shown below or will be issued by, or may be obtained from, the local Federal and/or State office.

Item 4: If there are no applicable State requirements, locations on Federal or Indian land should be described in accordance with Federal requirements. Consult local State or Federal office for specific instructions.

Item 17: Proposals to abandon a well and subsequent reports of abandonment should include such special information as is required by local Federal and/or State offices. In addition, such proposals and reports should include reasons for the abandonment; data on any former or present productive zones, or other zones with present significant fluid contents not sealed off by cement or otherwise; depths (top and bottom) and method of placement of cement plugs; mud or other material placed below, between and above plugs; amount, size, method of parting of any casing, liner or tubing pulled and the depth to top of any left in the hole; method of closing top of well; and date well site conditioned for final inspection looking to approval of the abandonment.

GPO : 1981 O - 347-166

8-3-83

Built Monument.

A 4 1/2" X 10' Monument has been welded to top of Surface Casing then hole filled with gravel.

Monument is permanently inscribed with following information:

Caulkins Oil Company
Well No. Breech 310
Lease No. NM 03733
SE 1/4 SE 1/4 Sec. 13 26N 7W
Rio Arriba County, New Mexico

Surface will be cleaned, bar ditches built and reseeding done before September 1, 1983.

Sunray Notice will be filed when Location is ready for inspection.

UNITED STATES
DEPARTMENT OF THE INTERIOR
GEOLOGICAL SURVEY

SUNDRY NOTICES AND REPORTS ON WELLS

(Do not use this form for proposals to drill or to deepen or plug back to a different reservoir. Use Form 9-331-C for such proposals.)

1. oil ☐ gas ☒ other ☐
2. NAME OF OPERATOR
Caulkins Oil Company
3. ADDRESS OF OPERATOR
P.O. Box 780 Farmington, New Mexico
4. LOCATION OF WELL (REPORT LOCATION CLEARLY. See space 17 below.)
AT SURFACE: 1120' From South & 1520' From East
AT TOP PROD. INTERVAL: Same
AT TOTAL DEPTH: Same
16. CHECK APPROPRIATE BOX TO INDICATE NATURE OF NOTICE, REPORT, OR OTHER DATA

REQUEST FOR APPROVAL TO:
TEST WATER SHUT-OFF ☐
FRACTURE TREAT ☐
SHOOT OR ACIDIZE ☐
REPAIR WELL ☐
PULL OR ALTER CASING ☐
MULTIPLE COMPLETE ☐
CHANGE ZONES ☐
ABANDON* ☐
(other) _____

SUBSEQUENT REPORT OF

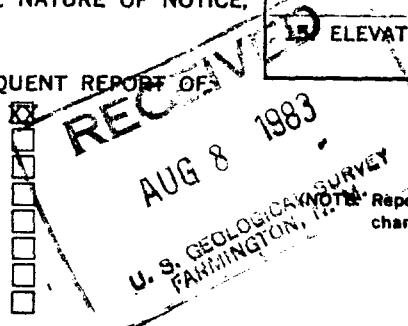

5. LEASE
NM 03733
6. IF INDIAN, ALLOTTEE OR TRIBE NAME
7. UNIT AGREEMENT NAME
8. FARM OR LEASE NAME
Breech
9. WELL NO.
307-M
10. FIELD OR WILDCAT NAME
Blanco Mesa Verde Basin Dakota
11. SEC., T., R., M., OR BLK. AND SURVEY OR AREA
Section 13, 26 North, 7 West
12. COUNTY OR PARISH
Rio Arriba
13. STATE
New Mexico
14. API NO.
6146 GR
15. ELEVATIONS (SHOW DF, KDB, AND WD)

17. DESCRIBE PROPOSED OR COMPLETED OPERATIONS (Clearly state all pertinent details, and give pertinent dates, including estimated date of starting any proposed work. If well is directionally drilled, give subsurface locations and measured and true vertical depths for all markers and zones pertinent to this work.)*

Spud at 5:00 PM 7-30-83

Drilled 12 1/4" hole to 615'.

Cemented New 9 5/8" 36# H-40 Casing to 610' with 500 sacks (590 Cu.Ft.)
Neat Cement containing 2% CaCl per sack.

Cement circulated to surface.

Plug down 9:30 AM 7-31-83.

Tested surface casing with 1200#. Held OK.

Subsurface Safety Valve: Manu. and Type _____ Set @ _____ Ft.

18. I hereby certify that the foregoing is true and correct

SIGNED Charles J. Jumper TITLE Superintendent DATE 8-2-83

(This space for Federal or State office use)

ACCEPTED FOR RECORD

APPROVED BY _____ TITLE _____ DATE _____
CONDITIONS OF APPROVAL, IF ANY:

AUG 19 1983

*See instructions on Reverse Side

OPERATOR

FARMINGTON RESOURCE AREA
FARMINGTON, NEW MEXICO
BY Smh

UNITED STATES
DEPARTMENT OF THE INTERIOR
GEOLOGICAL SURVEY

SUBMIT IN DUPLICATE*

(See other in-
structions on
reverse side)

Form approved.
Budget Bureau No. 42-R355.5.

WELL COMPLETION OR RECOMPLETION REPORT AND LOG *

1a. TYPE OF WELL: OIL <input type="checkbox"/> GAS <input checked="" type="checkbox"/> DRY <input type="checkbox"/> Other _____		5. LEASE DESIGNATION AND SERIAL NO. NM 03733																			
b. TYPE OF COMPLETION: NEW <input checked="" type="checkbox"/> WORK OVER <input type="checkbox"/> DEEP-EN <input type="checkbox"/> PLUG BACK <input type="checkbox"/> DIFF. RESVR. <input type="checkbox"/> Other _____		6. IF INDIAN, ALLOTTEE OR TRIBE NAME																			
2. NAME OF OPERATOR Caulkins Oil Company		7. UNIT AGREEMENT NAME																			
3. ADDRESS OF OPERATOR P.O. Box 780 Farmington, New Mexico		8. FARM OR LEASE NAME Breech																			
4. LOCATION OF WELL (Report location clearly and in accordance with any State requirements)* At surface 1120' From South & 1520' From East At top prod. interval reported below Same At total depth Same		9. WELL NO. 307-M																			
14. PERMIT NO. _____ DATE ISSUED _____		10. FIELD AND POOL, OR WILDCAT South Blanco Pictured Cliffs																			
15. DATE SPUDDED 7-30-83		11. SEC., T., R., M., OR BLOCK AND SURVEY OR AREA Section 13, 26 North, 7 West																			
16. DATE T.D. REACHED 8-9-83		12. COUNTY OR PARISH Rio Arriba																			
17. DATE COMPL. (Ready to prod.) 9-21-83		13. STATE New Mexico																			
18. ELEVATIONS (DF, REB, RT, GR, ETC.)* 6146 GR		19. ELEV. CASINGHEAD 6888'																			
20. TOTAL DEPTH, MD & TVD 6888'		21. PLUG BACK T.D., MD & TVD 6888'																			
22. IF MULTIPLE COMPL., HOW MANY* (4) Four		23. INTERVALS DRILLED BY ROTARY TOOLS 0-6888 CABLE TOOLS No																			
24. PRODUCING INTERVAL(S), OF THIS COMPLETION—TOP, BOTTOM, NAME (MD AND TVD)* 2281' to 2362' (Pictured Cliffs)		25. WAS DIRECTIONAL SURVEY MADE No																			
26. TYPE ELECTRIC AND OTHER LOGS RUN Gamma Ray Neutron Log		27. WAS WELL CORED No																			
28. CASING RECORD (Report all strings set in well)																					
<table><tr><td>CASING SIZE</td><td>WEIGHT, LB./FT.</td><td>DEPTH SET (MD)</td><td>HOLE SIZE</td><td>CEMENTING RECORD</td><td>AMOUNT PULLED</td></tr><tr><td>9 5/8"</td><td>36# H-40</td><td>616'</td><td>12 1/4"</td><td>500 sacks (590 Cu.Ft.)</td><td>None</td></tr><tr><td>5 1/2"</td><td>15.5 & 17#</td><td>6888'</td><td>7 7/8"</td><td>1400 sacks (2122 Cu.Ft.)</td><td>None</td></tr></table>				CASING SIZE	WEIGHT, LB./FT.	DEPTH SET (MD)	HOLE SIZE	CEMENTING RECORD	AMOUNT PULLED	9 5/8"	36# H-40	616'	12 1/4"	500 sacks (590 Cu.Ft.)	None	5 1/2"	15.5 & 17#	6888'	7 7/8"	1400 sacks (2122 Cu.Ft.)	None
CASING SIZE	WEIGHT, LB./FT.	DEPTH SET (MD)	HOLE SIZE	CEMENTING RECORD	AMOUNT PULLED																
9 5/8"	36# H-40	616'	12 1/4"	500 sacks (590 Cu.Ft.)	None																
5 1/2"	15.5 & 17#	6888'	7 7/8"	1400 sacks (2122 Cu.Ft.)	None																
29. LINER RECORD																					
<table><tr><td>SIZE</td><td>TOP (MD)</td><td>BOTTOM (MD)</td><td>SACKS CEMENT*</td><td>SCREEN (MD)</td></tr><tr><td></td><td></td><td></td><td></td><td></td></tr></table>				SIZE	TOP (MD)	BOTTOM (MD)	SACKS CEMENT*	SCREEN (MD)													
SIZE	TOP (MD)	BOTTOM (MD)	SACKS CEMENT*	SCREEN (MD)																	
30. TUBING RECORD																					
<table><tr><td>SIZE</td><td>DEPTH SET (MD)</td><td>PACKER SET (MD)</td></tr><tr><td>1 1/4"</td><td>3300'</td><td>3337'</td></tr></table>				SIZE	DEPTH SET (MD)	PACKER SET (MD)	1 1/4"	3300'	3337'												
SIZE	DEPTH SET (MD)	PACKER SET (MD)																			
1 1/4"	3300'	3337'																			
31. PERFORATION RECORD (Interval, size and number)																					
<table><tr><td>1-.42-2281</td><td>1-.42-2302</td><td>1-.42-2362</td></tr><tr><td>1-.42-2286</td><td>1-.42-2321</td><td></td></tr><tr><td>1-.42-2292</td><td>1-.42-2342</td><td></td></tr><tr><td>1-.42-2295</td><td>1-.42-2346</td><td></td></tr><tr><td>1-.42-2298</td><td>1-.42-2352</td><td></td></tr></table>				1-.42-2281	1-.42-2302	1-.42-2362	1-.42-2286	1-.42-2321		1-.42-2292	1-.42-2342		1-.42-2295	1-.42-2346		1-.42-2298	1-.42-2352				
1-.42-2281	1-.42-2302	1-.42-2362																			
1-.42-2286	1-.42-2321																				
1-.42-2292	1-.42-2342																				
1-.42-2295	1-.42-2346																				
1-.42-2298	1-.42-2352																				
32. ACID, SHOT, FRACTURE, CEMENT SQUEEZE, ETC.																					
<table><tr><td>DEPTH INTERVAL (MD)</td><td>AMOUNT AND KIND OF MATERIAL USED</td></tr><tr><td>2281' to 2362'</td><td>750,000# 20-40 sand and 1451 bbls. Gel Fluid</td></tr></table>				DEPTH INTERVAL (MD)	AMOUNT AND KIND OF MATERIAL USED	2281' to 2362'	750,000# 20-40 sand and 1451 bbls. Gel Fluid														
DEPTH INTERVAL (MD)	AMOUNT AND KIND OF MATERIAL USED																				
2281' to 2362'	750,000# 20-40 sand and 1451 bbls. Gel Fluid																				
33. PRODUCTION																					
<table><tr><td>DATE FIRST PRODUCTION 9-28-83</td><td>PRODUCTION METHOD (Flowing, gas lift, pumping—size and type of pump) Flowing</td><td>WELL STATUS (Producing or shut-in) Shut-in</td></tr><tr><td>DATE OF TEST 9-28-83</td><td>HOURS TESTED 3 Hours</td><td>CHOKED SIZE 3/4"</td></tr><tr><td>PROD'N. FOR TEST PERIOD →</td><td>OIL—BBL. →</td><td>GAS—MCF. 249</td></tr><tr><td>WATER—BBL. →</td><td>GAS—MCF. 1,999</td><td>WATER—BBL. →</td></tr><tr><td>OIL GRAVITY-API (CORR.) 63</td><td>CASING PRESSURE 564</td><td>CALCULATED 24-HOUR RATE →</td></tr></table>				DATE FIRST PRODUCTION 9-28-83	PRODUCTION METHOD (Flowing, gas lift, pumping—size and type of pump) Flowing	WELL STATUS (Producing or shut-in) Shut-in	DATE OF TEST 9-28-83	HOURS TESTED 3 Hours	CHOKED SIZE 3/4"	PROD'N. FOR TEST PERIOD →	OIL—BBL. →	GAS—MCF. 249	WATER—BBL. →	GAS—MCF. 1,999	WATER—BBL. →	OIL GRAVITY-API (CORR.) 63	CASING PRESSURE 564	CALCULATED 24-HOUR RATE →			
DATE FIRST PRODUCTION 9-28-83	PRODUCTION METHOD (Flowing, gas lift, pumping—size and type of pump) Flowing	WELL STATUS (Producing or shut-in) Shut-in																			
DATE OF TEST 9-28-83	HOURS TESTED 3 Hours	CHOKED SIZE 3/4"																			
PROD'N. FOR TEST PERIOD →	OIL—BBL. →	GAS—MCF. 249																			
WATER—BBL. →	GAS—MCF. 1,999	WATER—BBL. →																			
OIL GRAVITY-API (CORR.) 63	CASING PRESSURE 564	CALCULATED 24-HOUR RATE →																			
34. DISPOSITION OF GAS (Sold, used for fuel, vented, etc.) Gas to be sold to Gas Company of New Mexico (Condensate to Shell Oil Co.)																					
35. LIST OF ATTACHMENTS Complete Cementing Records																					
36. I hereby certify that the foregoing and attached information is complete and correct as determined from all available data.																					
SIGNED <u>Charles Vargue</u> TITLE <u>Superintendent</u>		DATE <u>9-29-83</u> <u>OCT 05 1983</u>																			

*(See Instructions and Spaces for Additional Data on Reverse Side)

OPERATOR

FARMINGTON RESOURCE AREA

BY Sm m

INSTRUCTIONS

General: This form is designed for submitting a complete and correct well completion report and log on all types of lands and leases to either a Federal agency or a State agency, or both, pursuant to applicable Federal and/or State laws and regulations. Any necessary special instructions concerning the use of this form and the number of copies to be submitted, particularly with regard to local, area, or regional procedures and practices, either are shown below or will be issued by, or may be obtained from, the local Federal and/or State office. See instructions on Items 22 and 24, and 33, below regarding separate reports for separate completions.

If not filed prior to the time this summary record is submitted, copies of all currently available logs (drillers, geologists, sample and core analysis, all types electric, etc.), formation and pressure tests, and directional surveys, should be attached hereto, to the extent required by applicable Federal and/or State laws and regulations. All attachments should be listed on this form, see Item 35.

Item 4: If there are no applicable State requirements, locations on Federal or Indian land should be described in accordance with Federal requirements. Consult local State or Federal office for specific instructions.

Item 18: Indicate which elevation is used as reference (where not otherwise shown) for depth measurements given in other spaces on this form and in any attachments. Items 22 and 24: If this well is completed for separate production from more than one interval zone (multiple completion), so state in Item 22, and in Item 24 show the producing interval, or intervals, top(s), bottom(s) and name(s) (if any) for only the interval reported in Item 33. Submit a separate report (page) on this form, adequately identified, for each additional interval to be separately produced, showing the additional data pertinent to such interval.

Item 29: "Sacks Cement": Attached supplemental records for this well should show the details of any multiple stage cementing and the location of the cementing tool.

Item 33: Submit a separate completion report on this form for each interval to be separately produced. (See instruction for Items 22 and 24 above.)

37. SUMMARY OF POROUS ZONES: SHOW ALL IMPORTANT ZONES OF POROSITY AND CONTENTS THEREOF; CORED INTERVALS; AND ALL DRILL-STEM TESTS, INCLUDING DEPTH INTERVAL TESTED, CUSHION USED, TIME TOOL OPEN, FLOWING AND SHUT-IN PRESSURES, AND RECOVERIES				38. GEOLOGIC MARKERS		
FORMATION	TOP	BOTTOM	DESCRIPTION, CONTENTS, ETC.	NAME	MEAS. DEPTH	TRUE VERT. DEPTH
Alamo	1510	1798	Water Sand	Alamo	1510	1510
Pictured Cliffs	2274	2372	Gas Sand	Pictured Cliffs	2274	2274
Chacra	3224	3326	Gas Sand	Chacra	3224	3224
Mesa Verde	4204	4765	Gas Sand	Mesa Verde	4204	4204
Dakota	6642	6830	Gas Sand	Dakota	6642	6642
			Hole Deviation Test			
			Depth			
			615			
			1104			
			1618			
			2427			
			2887			
			3295			
			3784			
			4290			
			4803			
			5228			
			5725			
			6231			
			Degrees			
			2			
			2 1/2			
			2 3/4			
			2 3/4			
			2 1/2			
			2			
			2			
			1 1/2			
			2			
			1 3/4			
			1 3/4			
			1 1/2			

307-M

Ran 5 1/2" Production Casing as follows:

6888' to 127'	(6541')	New 5 1/2"	15.5#	ST&C	K-55 Smls Casing
127' to Surface	(127')	New 5 1/2"	17#	LT&C	K-55 Smls Casing

Stage Tools run in Casing string at 4812' and 3378'.

Cement Baskets run in Casing string at 4944' and 3393'.

Centralizers run on Casing string at following points:

6847', 6806', 6764', 6722', 6681', 6640', 6598', 6556', 6514', 6473', 6431', 6390', 6349', 6307', 4851', 4771', 4733', 4697', 4656', 3418', 3338', 3297', 2425', 2387', 2345' and 2305'.

Cemented 5 1/2" Casing in 3 Stages.

First Stage thru shoe at 6888' with 250 sacks (412.5 Cu.Ft.) 50-50 Poz, 6% Gel, 12 1/2# Gilsonite per sack followed by 100 sacks (118 Cu.Ft.) Neat Cement.
Plug down 10:45 PM 8-9-83.

Second Stage cemented thru Stage Tool set at 4812' with 150 sacks (247.5 Cu.Ft.) 50-50 Poz, 6% Gel, 12 1/2# Gilsonite per sack followed by 100 sacks (118 Cu.Ft.) Neat cement.
Plug down 11:45 PM 8-9-83.

Third Stage cemented thru Stage Tool set at 3378' with 600 sacks (990 Cu.Ft.) 50-50 Poz, 6% Gel, 12 1/2# Gilsonite per sack followed by 200 sacks (236 Cu.Ft.) Neat Cement.
Plug down 1:30 AM 8-10-83.

Circulated approx 5 bbl. slurry from both first and second stages.

Circulated no cement from third stage. Cement top 925' Temperature Survey attached.

OIL CONSERVATION COMMISSION

1000 Rio Brazos Road

AZTEC, NEW MEXICO 87410

NOTICE OF GAS CONNECTION

DATE November 21, 1983

THIS IS TO NOTIFY THE OIL CONSERVATION COMMISSION THAT CONNECTION FOR THE PURCHASE OF

GAS FROM THE Caulkins Oil Company

OPERATOR

Breech

307-M

(O)13-26N-07W

LEASE

WELL UNIT

S - T - R

* South Blanco Pictured Cliffs

Gas Company of New Mexico

POOL

NAME OF PURCHASER

WAS MADE ON 11-16-83

, FIRST DELIVERY 11-16-83

DATE

DATE

744

INITIAL POTENTIAL

*Downhole Commingled with Otero Chacra

Gas Company of New Mexico

PURCHASER

/kn

cc: OPERATOR

New Mexico Oil Conservation Commission - Aztec
Minerals Management Service - Oil & Gas
Mr. E.R. Corliss, Engineering
Mr. R.J. McCrary, Gas Contracts Adm.
Prorations Dept., Albuquerque
Mr. Robert Utay, Gas Accounting
Mr. Joel Levine, Gas Supply
Chart Office, Kutz
Mr. Perry McFarland, Kutz
File

J. R. Large
REPRESENTATIVE

J.R. Large

Dispatch Manager

TITLE

OIL CONSERVATION DIVISION
P. O. BOX 2088
SANTA FE, NEW MEXICO 87501

REQUEST FOR ALLOWABLE
AND
AUTHORIZATION TO TRANSPORT OIL AND NATURAL GAS

I. OPERATOR

Operator Caulkins Oil Company

Address P.O. Box 780 Farmington, New Mexico

Reason(s) for filing (Check proper box)

New Well	<input checked="" type="checkbox"/>	Change in Transporter of:		Other (Please explain)	
Recompletion	<input type="checkbox"/>	Oil	<input type="checkbox"/>	Dry Gas	<input type="checkbox"/>
Change in Ownership	<input type="checkbox"/>	Casinghead Gas	<input type="checkbox"/>	Condensate	<input type="checkbox"/>

If change of ownership give name and address of previous owner _____

II. DESCRIPTION OF WELL AND LEASE

Lease Name <u>Breech</u>	Well No. <u>307-M</u>	Pool Name, including Formation <u>South Blanco Pictured Cliffs -</u>	Kind of Lease <u>State, Federal or Fee Federal</u>	Lease No. <u>NM03733</u>
Location				
Unit Letter <u>0</u> ; <u>1120</u> Feet From The <u>South</u> Line and <u>1520</u> Feet From The <u>East</u>				
Line of Section <u>13</u> Township <u>26 North</u> Range <u>7 West</u> , NMPM, <u>Rio Arriba</u> County				

III. DESIGNATION OF TRANSPORTER OF OIL AND NATURAL GAS

Name of Authorized Transporter of Oil <input type="checkbox"/> or Condensate <input checked="" type="checkbox"/>	Address (Give address to which approved copy of this form is to be sent)					
<u>Giant Refinery Company</u>	<u>P.O. Box 256 Farmington, New Mexico</u>					
Name of Authorized Transporter of Casinghead Gas <input type="checkbox"/> or Dry Gas <input checked="" type="checkbox"/>	Address (Give address to which approved copy of this form is to be sent)					
<u>Gas Company of New Mexico</u>	<u>1508 Pacific Ave. Dallas, Texas</u>					
If well produces oil or liquids, give location of tanks.	Unit	Sec.	Twp.	Range	Is gas actually connected?	When
	<u>0</u>	<u>13</u>	<u>26N</u>	<u>7W</u>	<u>No</u>	

If this production is commingled with that from any other lease or pool, give commingling order number: R-5648

IV. COMPLETION DATA

Designate Type of Completion - (X)	Oil Well	Gas Well	New Well	Workover	Deepen	Plug Back	Same Res'v.	Diff. Res'v.
		<input checked="" type="checkbox"/>	<input checked="" type="checkbox"/>					
Date Spudded <u>7-30-83</u>	Date Compl. Ready to Prod. <u>9-21-83</u>		Total Depth <u>6888'</u>		P.B.T.D. <u>6888'</u>			
Elevations (DF, RKB, RT, GR, etc.) <u>6164 GR</u>	Name of Producing Formation <u>Pictured Cliffs Chacra</u>		Top Oil/Gas Pay <u>2281'</u>		Tubing Depth <u>3300'</u>			
Perforations <u>3231' to 3323' (Chacra) 2281' to 2362' (Pictured Cliffs)</u>					Depth Casing Shoe <u>3300'</u>			
TUBING, CASING, AND CEMENTING RECORD								
HOLE SIZE	CASING & TUBING SIZE		DEPTH SET		SACKS CEMENT			
<u>12 1/4"</u>	<u>9 5/8"</u>		<u>615'</u>		<u>500 sacks (590 Cu.Ft.)</u>			
<u>7 7/8"</u>	<u>5 1/2"</u>		<u>6888'</u>		<u>1400 sacks (2122 Cu.Ft.)</u>			
	<u>1 1/4"</u>		<u>3300'</u>					

V. TEST DATA AND REQUEST FOR ALLOWABLE OIL WELL

(Test must be after recovery of test volume of load oil and must be equal to or exceed top allowable for this depth or be for full 24 hours)

Date First New Oil Run To Tanks	Date of Test	Producing Method (Flow, pump, gas lift, etc.)	
		<u>Flow</u>	
Length of Test	Tubing Pressure	Casing Pressure	Choke Size
Actual Prod. During Test	Oil - Bbls.	Water - Bbls.	Gas - MCF

GAS WELL

Actual Prod. Test - MCF/D <u>1,062</u> <u>Chacra 319</u>	Length of Test <u>3 Hours</u>	Bbls. Condensate/MCF	Gravity of Condensate
Testing Method (pilot, back pr.) <u>Back Pressure</u>	Tubing Pressure (Shut-in) <u>661</u>	Casing Pressure (Shut-in) <u>642</u>	Choke Size <u>3/4"</u>

CERTIFICATE OF COMPLIANCE

I hereby certify that the rules and regulations of the Oil Conservation Division have been complied with and that the information given above is true and complete to the best of my knowledge and belief.

Charles E. Vesper
(Signature)
Superintendent
(Title)
9-29-83
(Date)

OIL CONSERVATION DIVISION

APPROVED [Signature] OCT 11 1983
BY [Signature]
TITLE SUPERVISOR DISTRICT # 3

This form is to be filed in compliance with RULE 1104.
If this is a request for allowable for a newly drilled or deepened well, this form must be accompanied by a tabulation of the deviation tests taken on the well in accordance with RULE 111.
All sections of this form must be filled out completely for allowable on new and recompleted wells.
Fill out only Sections I, II, III, and VI for changes of owner, well name or number, or transporter or other such change of condition.
Separate Forms C-104 must be filed for each pool in multiply completed wells.

RULES AND REGULATIONS NGPA SECTION 6

APR 5 1984

Rule #1

220-R located 1750' From East and 944' From North of Section 14, 26N 7W to replace well No. 220 located 990' From North and 990' From East of Section 14, 26N 7W, Rio Arriba County, New Mexico, Pictured Cliffs Zone only.

Rule #2

Downhole mechanical failure. Well making water from unknown source and as a well was being drilled to Dakota formation in this Quarter Section, approval to Plug and Abandon this well and open Pictured Cliffs in new well was obtained. Copy of approval attached.

Rule #4

Set for hearing for exemption.

Rule #5

Plat attached.

Rule # 6

- (a) Cost of replacing 220 Pictured Cliffs in new well 220-R \$68,289.04.
- (b) Rule #2 above.
- (d) Plugging Information attached.

Rule #8

- (220-R) Copy of Intention to Drill, Completion Report, C-104 and copy of Gas Company of New Mexico Notice of 1st delivery.

UNITED STATES
DEPARTMENT OF THE INTERIOR
GEOLOGICAL SURVEY

SUNDRY NOTICES AND REPORTS ON WELLS

(Do not use this form for proposals to drill or to deepen or plug back to a different reservoir. Use Form 9-331-C for such proposals.)

1. oil ☐ well gas ☒ well other ☐

2. NAME OF OPERATOR
Caulkins Oil Company

3. ADDRESS OF OPERATOR
P.O. Box 780, Farmington, New Mexico

4. LOCATION OF WELL (REPORT LOCATION CLEARLY. See space 17 below.)
AT SURFACE: 990' F/N 990' F/E
AT TOP PROD. INTERVAL: Same
AT TOTAL DEPTH: Same

16. CHECK APPROPRIATE BOX TO INDICATE NATURE OF NOTICE, REPORT, OR OTHER DATA

REQUEST FOR APPROVAL TO: SUBSEQUENT REPORT OF:

TEST WATER SHUT-OFF	<input type="checkbox"/>	<input type="checkbox"/>
FRACTURE TREAT	<input type="checkbox"/>	<input type="checkbox"/>
SHOOT OR ACIDIZE	<input type="checkbox"/>	<input type="checkbox"/>
REPAIR WELL	<input type="checkbox"/>	<input type="checkbox"/>
PULL OR ALTER CASING	<input type="checkbox"/>	<input type="checkbox"/>
MULTIPLE COMPLETE	<input type="checkbox"/>	<input type="checkbox"/>
CHANGE ZONES	<input type="checkbox"/>	<input type="checkbox"/>
ABANDON*	<input checked="" type="checkbox"/>	<input type="checkbox"/>
(other)		

5. CASE
NM-03381

6. IF INDIAN, ALLOTTEE OR TRIBE NAME

7. UNIT AGREEMENT NAME

8. FARM OR LEASE NAME
Breach B

9. WELL NO.
220

10. FIELD OR WILDCAT NAME
South Blanco-Pictured Cliffs

11. SEC., T., R., M., OR BLK. AND SURVEY OR AREA
Section 14, 26N 7W

12. COUNTY OR PARISH
Rio Arriba

13. STATE
New Mexico

14. API NO.

15. ELEVATIONS (SHOW DF, KDB, AND WD)
6537 Gr.

(NOTE: Report results of multiple completion or zone change on Form 9-330.)

17. DESCRIBE PROPOSED OR COMPLETED OPERATIONS (Clearly state all pertinent details, and give pertinent dates, including estimated date of starting any proposed work. If well is directionally drilled, give subsurface locations and measured and true vertical depths for all markers and zones pertinent to this work.)*

This well presently producing less than 20 MCFPD. Due to hole conditions now present in well it is impossible to keep well clean. A new well was drilled and completed in this Zone in 1979 on this proration Unit.

It is now proposed to plug and abandon this well. Leaving only one well on 160 acre Unit.

Present Condition:

10-13-57 8 5/8" 24# J-55 cemented at 105' with 80 sacks. Cement circulated to surface.

10-24-57 4 1/2" 9.5# casing set at 2810'. Cemented with 200 sacks. Cement top Est. 1610'. (OVER)

Subsurface Safety Valve: Manu. and Type _____ Set @ _____ Ft.

18. I hereby certify that the foregoing is true and correct

SIGNED Charles V. Vignier TITLE Superintendent DATE 2-13-80

APPROVED

(This space for Federal or State office use)

APPROVED BY _____ TITLE _____ DATE _____

CONDITIONS OF APPROVAL, IF ANY:

FEB 19 1980

CARL A. BARRICK

DISTRICT ENGINEER

*See Instructions on Reverse Side

FEB 15 1980

Instructions

General: This form is designed for submitting proposals to perform certain well operations, and reports of such operations when completed, as indicated, on Federal and Indian lands pursuant to applicable Federal law and regulations, and, if approved or accepted by any State, on all lands in such State, pursuant to applicable State law and regulations. Any necessary special instructions concerning the use of this form and the number of copies to be submitted, particularly with regard to local, area, or regional procedures and practices, either are shown below or will be issued by, or may be obtained from, the local Federal and/or State office.

Item 4: If there are no applicable State requirements, locations on Federal or Indian land should be described in accordance with Federal requirements. Consult local State or Federal office for specific instructions.

Item 17: Proposals to abandon a well and subsequent reports of abandonment should include such special information as is required by local Federal and/or State offices. In addition, such proposals and reports should include reasons for the abandonment; data on any former or present productive zones, or other zones with present significant fluid contents not sealed off by cement or otherwise; depths (top and bottom) and method of placement of cement plugs; mud or other material placed below, between and above plugs; amount, size, method of parting of any casing, liner or tubing pulled and the depth to top of any left in the hole; method of closing top of well; and data well site conditioned for final inspection looking to approval of the abandonment.

4 1/2" perforated with 4 holes per foot: 2727 to 2762 and 2788 to 2802.

Formation Tops:

Alamo 2015'

Pictured Cliffs 2725'

Plugging Plan:

Spot cement plug in 4 1/2" casing TD to 1500'.

9.0# Gel Based Mud 1500' to 150'. Cement plug 150' to surface inside and outside of 4 1/2" casing.

A 4 1/2" Monument will be welded to top of 4 1/2" casing.

Plugging operations to be Commenced immediately after receiving approval.

CAULKINS OIL COMPANY

P. O. BOX 780
FARMINGTON, NEW MEXICO 87401

PRORATION UNIT: NE 1/4 of Section 14 26N 7W, Rio Arriba County, N.M.

Well No. 220 - Original well Pictured Cliffs Zone, marked with arrow

Well No. 220 R - Replacement well Pictured Cliffs Zone, marked with circle

All acreage on this plat, not otherwise identified, operated by Caulkins

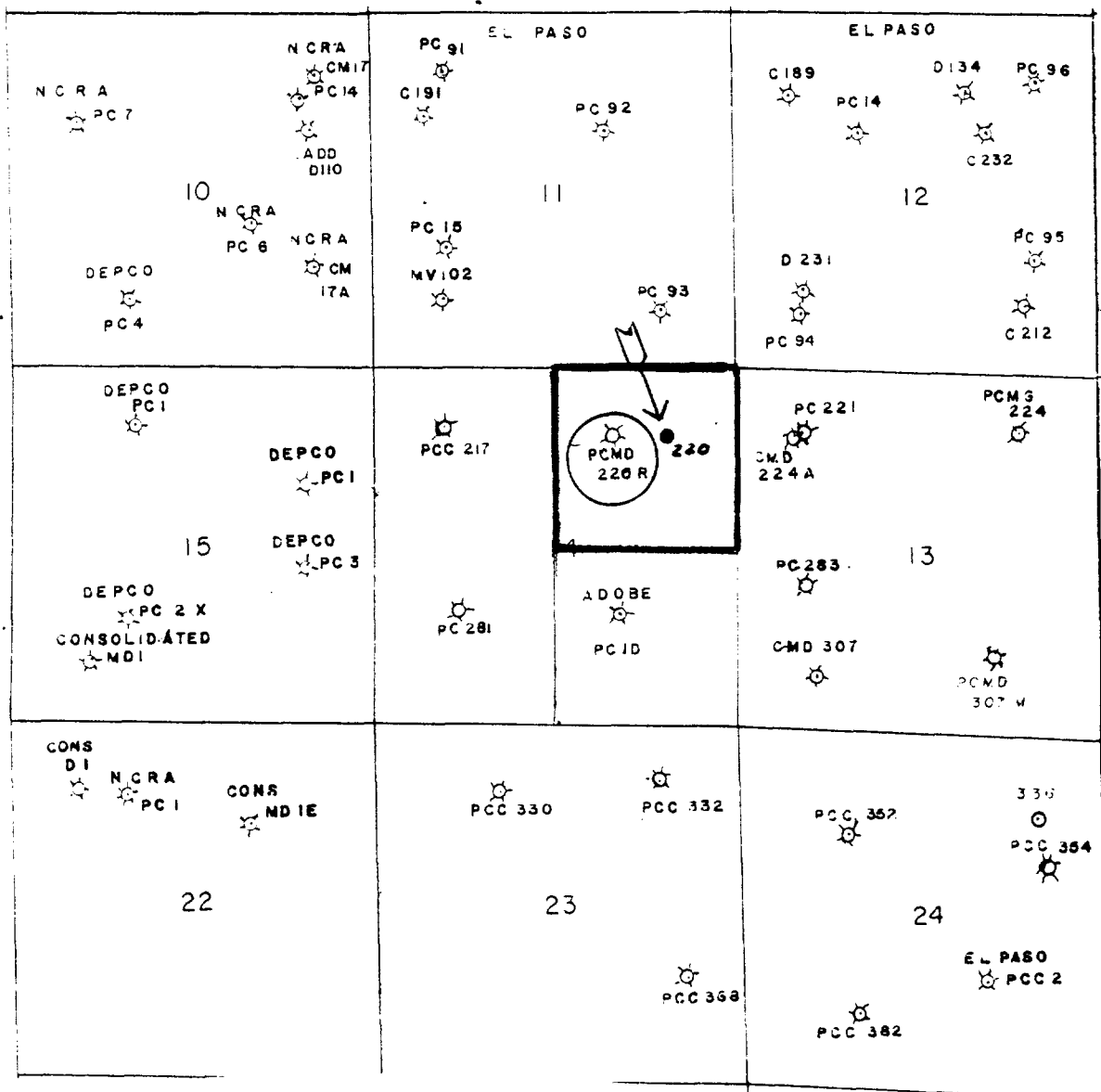

P or PC = Pictured Cliffs Completion
C = Chacra Completion
M or MV = Mesa Verde Completion
G = Greenhorn Completion
D = Dakota Completion

UNITED STATES
DEPARTMENT OF THE INTERIOR
GEOLOGICAL SURVEY

APPLICATION FOR PERMIT TO DRILL, DEEPEN, OR PLUG BACK

1a. TYPE OF WORK DRILL <input checked="" type="checkbox"/> DEEPEN <input type="checkbox"/> PLUG BACK <input type="checkbox"/>		5. LEASE DESIGNATION AND SERIAL NO. NM 03381	
1b. TYPE OF WELL OIL WELL <input type="checkbox"/> GAS WELL <input checked="" type="checkbox"/> OTHER <input type="checkbox"/> SINGLE ZONE <input type="checkbox"/> MULTIPLE ZONE <input checked="" type="checkbox"/>		6. IF INDIAN, ALLOTTEE OR TRIBE NAME	
2. NAME OF OPERATOR Caulkins Oil Company		7. UNIT AGREEMENT NAME	
3. ADDRESS OF OPERATOR Post Office Box 780, Farmington, New Mexico 87401		8. FARM OR LEASE NAME Breech "B"	
4. LOCATION OF WELL (Report location clearly and in accordance with any State requirements.) At surface 1750' from the East Line and 944' from the North Line. At proposed prod. zone Same		9. WELL NO. 220-R	
14. DISTANCE IN MILES AND DIRECTION FROM NEAREST TOWN OR POST OFFICE* 35 miles Southeast of Blanco, New Mexico		10. FIELD AND POOL, OR WILDCAT Basin Dakota	
15. DISTANCE FROM PROPOSED* LOCATION TO NEAREST PROPERTY OR LEASE LINE, FT. (Also to nearest drig. unit line, if any)		11. SEC., T., R., M., OR BLK. AND SURVEY OR AREA Sec. 14 26N 7W	
16. NO. OF ACRES IN LEASE 1120		12. COUNTY OR PARISH Rio Arriba	
17. NO. OF ACRES ASSIGNED TO THIS WELL 320		13. STATE New Mexico	
18. DISTANCE FROM PROPOSED LOCATION* TO NEAREST WELL, DRILLING, COMPLETED, OR APPLIED FOR, ON THIS LEASE, FT.		20. ROTARY OR CABLE TOOLS Rotary	
19. PROPOSED DEPTH 7300		22. APPROX. DATE WORK WILL START* April 1, 1979	
21. ELEVATIONS (Show whether DF, RT, GR, etc.) 6537 GR.			

PROPOSED CASING AND CEMENTING PROGRAM

SIZE OF HOLE	SIZE OF CASING	WEIGHT PER FOOT	SETTING DEPTH	QUANTITY OF CEMENT
13 3/4	9 5/8	36 #	300'	Sufficient to circulate
8 3/4	7"	23 and 26 #	7300'	1250 sacks

Surface formation San Jose. No abnormal pressure or temperature anticipated. It is proposed to drill well to 7300' using 9# Gel based mud. Float will be run in Drill Pipe at Bit. ES Ind., Density and Caliper logs will be run in open hole. New 7" 23# & 26# J-55 Smls/Casing will be cemented at TD with sufficient cement to circulate to surface. Pipe will be cemented in 3 stages. Casing will have rotating Scratchers over Pictured Cliffs, Chacra, Mesa Verde and Dakota Zones. Stage tools will be run below base of Point Lookout and below base of Pictured Cliffs sands. Centralizers and cement baskets will also be run on casing thru pay zones.

A Shaffer 10" Model LWP, 6000# test blowout preventor will be in use at all times while drilling and cementing. Blowout preventor will be tested each day.

It is proposed to run New 2 3/8" tubing to Dakota zone with packer set between Mesa Verde zone and Dakota zone. 2 3/8" EUE tubing will be run to Mesa Verde for (over) Mesa Verde, Chacra and Pictured Cliffs Production.

IN ABOVE SPACE DESCRIBE PROPOSED PROGRAM: If proposal is to deepen or plug back, give data on present productive zone and proposed new productive zone. If proposal is to drill or deepen directionally, give pertinent data on subsurface locations and measured and true vertical depths. Give blowout preventer program, if any.

24. SIGNED Charles E. Viquez TITLE Superintendent DATE 1-10-79

(This space for Federal or State office use)

APPROVED

PERMIT NO. _____ APPROVAL DATE _____
APPROVED BY MAY 9 1979 "APPROVAL TO PLACE GRANTED WHILE DRILLING AND TESTING."
COMMISSIONER OF GEOLOGY CARL A. BARRICK DATE JAN 11 1979

STIPULATIONS ATTACHED ACTING DISTRICT ENGINEER

*See Instructions On Reverse Side

Instructions

General: This form is designed for submitting proposals to perform certain well operations, as indicated, on all types of lands and leases for appropriate action by either a Federal or a State agency, or both, pursuant to applicable Federal and/or State laws and regulations. Any necessary special instructions concerning the use of this form and the number of copies to be submitted, particularly with regard to local, area, or regional procedures and practices, either are shown below or will be issued by, or may be obtained from, the local Federal and/or State office.

Item 1: If the proposal is to redrill to the same reservoir at a different subsurface location or to a new reservoir, use this form with appropriate notations. Consult applicable State or Federal regulations concerning subsequent work proposals or reports on the well.

Item 4: If there are no applicable State requirements, locations on Federal or Indian land should be described in accordance with Federal requirements. Consult local State or Federal office for specific instructions.

Item 14: Needed only when location of well cannot readily be found by road from the land or lease description. A plat, or plats, separate or on this reverse side, showing the roads to, and the surveyed location of, the well, and any other required information, should be furnished when required by Federal or State agency offices.

Items 15 and 18: If well is to be, or has been directionally drilled, give distances for subsurface location of hole in any present or objective production zone.

Item 23: Consult applicable Federal or State regulations, or appropriate officials, concerning approval of the proposal before operations are started.

Completion of this well as shown above subject to approval by New Mexico Oil Conservation Commission for commingling of Mesa Verde, Chacra and Pictured Cliffs in wellbore. If commingling denied well will be completed as Mesa Verde - Dakota Dual.

All zones to be completed will be fractured to stimulate production.

Form approved.
Budget Bureau No. 42-R355.5.

*** (See Instructions and Spaces for Additional Data on Reverse Side)**

INSTRUCTIONS

General: This form is designed for submitting a complete and correct well completion report and log on all types of lands and leases to either a Federal agency or a State agency, or both, pursuant to applicable Federal and/or State laws and regulations. Any necessary special instructions concerning the use of this form and the number of copies to be submitted, particularly with regard to local, area, or regional procedures and practices, either are shown below or will be issued by, or may be obtained from, the local Federal and/or State office. See instructions on items 22 and 24, and 33, below regarding separate reports for separate completions.

If not filed prior to the time this summary record is submitted, copies of all currently available logs (drillers, geologists, sample and core analysis, all types electric, etc.), formation and pressure tests, and directional surveys, should be attached hereto, to the extent required by applicable Federal and/or State laws and regulations. All attachments should be listed on this form, see item 35.

Item 4: If there are no applicable State requirements, locations on Federal or Indian land should be described in accordance with Federal requirements. Consult local State or Federal office for specific instructions.

Item 18: Indicate which elevation is used as reference (where not otherwise shown) for depth measurements given in other spaces on this form and in any attachments.

Items 22 and 24: If this well is completed for separate production from more than one interval zone (multiple completion), so state in item 22, and in item 24 show the producing interval or intervals, top(s), bottom(s) and name(s) (if any) for only the interval reported in item 33. Submit a separate report (page) on this form, adequately identified, for each additional interval to be separately produced, showing the additional data pertinent to such interval.

Item 29: "Sacks Cement": Attached supplemental records for this well should show the details of any multiple stage cementing and the location of the cementing tool.

Item 33: Submit a separate completion report on this form for each interval to be separately produced. (See instruction for items 22 and 24 above.)

TD 7323. Ran 7" 23 & 26# K-55 ST & C to 7323'. Cemented as follows: 1st thru shoe with 395 sacks 50-50 Poz, 6% Gel, 4 12 1/2# Gilsontite per sack followed by 125 sacks Latex cement. 2nd Stage thru stage tool set at 5212' with 278 sacks 50-50 Poz, 6% Gel, and 12 1/2# Gilsontite per sack followed 100 sacks Neat. 3rd Stage thru stage tool set at 3770' with 290 sacks 50-50 Poz, 6% Gel and 12 1/2# Gilsontite per sack followed by 100 sacks Neat.

Plug down on Final Stage 9:00 AM 6-19-79

37. SUMMARY OF POROSITY ZONES:
SHOW ALL IMPORTANT ZONES OF POROSITY AND CONTENTS THEREOF; CORRELATE INTERVALS; AND ALL DRILL-STEM TESTS, INCLUDING DEPTH INTERVAL TESTED, CUSHION USED, TIME TOOL OPEN, FLOWING AND SHUT-IN PRESSURES, AND RECOVERIES

FORMATION	TOP	BOTTOM	DESCRIPTION, CONTENTS, ETC.	NAME	TOP	
					MEAS. DEPTH	TRUE VERT. DEPTH
Ojo Alamo	2020	2190	Water Sand	Pictured Cliffs Chacra Point Lookout Dakota		
Pictured Cliffs	2708	2800	Gas Sand		2708	2708
Chacra	3608	3728	Gas Sand		3608	3608
Point Lookout	5020	5155	Gas Sand		5020	5020
Dakota	7050	7245	Gas Sand		7050	7050
Hole Deviation Test (Degree)						
260	1					
30	3/4					
1364	3/4					
1861	3/4					
2115	3/4					
2829	3/4					
3331	1					
3833	1					
4213	1					
4808	1					
5311	3/4					
5816	1					
6317	1					
6818	1					

6972 1 1/4
7340 1

UNITED STATES
DEPARTMENT OF THE INTERIOR
GEOLOGICAL SURVEY

SUNDRY NOTICES AND REPORTS ON WELLS

(Do not use this form for proposals to drill or to deepen or plug back to a different reservoir. Use Form 9-331-C for such proposals.)

1. oil well ☐ gas well ☒ other ☐
2. NAME OF OPERATOR
Caulkins Oil Company
3. ADDRESS OF OPERATOR
P.O. Box 780, Farmington, New Mexico
4. LOCATION OF WELL (REPORT LOCATION CLEARLY. See space 17 below.)
AT SURFACE: 1750' F E/L and 944' F N/L
AT TOP PROD. INTERVAL: Same
AT TOTAL DEPTH: Same

16. CHECK APPROPRIATE BOX TO INDICATE NATURE OF NOTICE, REPORT, OR OTHER DATA

REQUEST FOR APPROVAL TO:	SUBSEQUENT REPORT OF:
TEST WATER SHUT-OFF <input type="checkbox"/>	<input checked="" type="checkbox"/>
FRACTURE TREAT <input type="checkbox"/>	<input type="checkbox"/>
SHOOT OR ACIDIZE <input type="checkbox"/>	<input type="checkbox"/>
REPAIR WELL <input type="checkbox"/>	<input type="checkbox"/>
PULL OR ALTER CASING <input type="checkbox"/>	<input type="checkbox"/>
MULTIPLE COMPLETE <input type="checkbox"/>	<input type="checkbox"/>
CHANGE ZONES <input type="checkbox"/>	<input type="checkbox"/>
ABANDON* <input type="checkbox"/>	<input type="checkbox"/>
(other) <input type="checkbox"/>	<input type="checkbox"/>

5. LEASE
NM-03381
6. IF INDIAN, ALLOTTEE OR TRIBE NAME
7. UNIT AGREEMENT NAME
8. FARM OR LEASE NAME
Breech B
9. WELL NO.
220-R
10. FIELD OR WILDCAT NAME
Basin Dakota
11. SEC., T., R., M., OR BLK. AND SURVEY OR AREA
Section 14 26N 7W
12. COUNTY OR PARISH
Rio Arriba
13. STATE
New Mexico
14. API NO.
15. ELEVATIONS (SHOW DF, KDB, AND WD)
6537' GR.

(NOTE: Report results of multiple completion or zone change on Form 9-330.)

17. DESCRIBE PROPOSED OR COMPLETED OPERATIONS (Clearly state all pertinent details, and give pertinent dates, including estimated date of starting any proposed work. If well is directionally drilled, give subsurface locations and measured and true vertical depths for all markers and zones pertinent to this work.)*

Spud at 12:00 AM 6-1-79.

Drilled 15½" hole to 360'.

Cemented 10 3/4" New 32 75# H-40 casing at 360' with 225 sacks. Cement circulated to surface.

Plug down 12:00 PM 6-2-79.

Tested surface casing 6-3-79 with 600# for 30 minutes. No decrease in pressure.

Subsurface Safety Valve: Manu. and Type _____ Set @ _____ Ft.

18. I hereby certify that the foregoing is true and correct

SIGNED Charles E. Vargus TITLE Superintendent DATE 6-6-79

(This space for Federal or State office use)

APPROVED BY _____ TITLE _____ DATE _____
CONDITIONS OF APPROVAL, IF ANY:

OIL CONSERVATION DIVISION

P. O. BOX 7088

SANTA FE, NEW MEXICO 87501

REQUEST FOR ALLOWABLE
AND
AUTHORIZATION TO TRANSPORT OIL AND NATURAL GAS

GPJ 30-039-21998

REGISTRATION	1
LAND OFFICE	1
TRANSPORTER	1
OPERATION	1
LAND OFFICE	1

Caulkins Oil Company

Address

P.O. Box 780, Farmington, New Mexico

Reason(s) for filing (Check proper box)

New Well	<input checked="" type="checkbox"/>	Change in Transporter of:	
Recompletion	<input type="checkbox"/>	Oil	<input type="checkbox"/>
Change in Ownership	<input type="checkbox"/>	Casinghead Gas	<input type="checkbox"/>
		Dry Gas	<input type="checkbox"/>
		Condensate	<input type="checkbox"/>

Other (Please explain)

Commingled Pictured Cliffs, Chacra and
Mesa VerdeIf change of ownership give name
and address of previous owner

DESCRIPTION OF WELL AND LEASE

Lease Name Breach B	Well No. 220-R	Pool Name, including Formation South Blanco-PC, Blanco-MV	Kind of Lease State, Federal or Fee	Lease No. NM-03381
Location Unit Letter <u>B</u> : <u>1750</u> Feet From The <u>East</u> Line and <u>944</u> Feet From The <u>North</u> Line of Section <u>14</u> Township <u>26 North</u> Range <u>7 West</u> , NMPM, Rio Arriba County				

DESIGNATION OF TRANSPORTER OF OIL AND NATURAL GAS

Name of Authorized Transporter of Oil <input type="checkbox"/> or Condensate <input checked="" type="checkbox"/>	Address (Give address to which approved copy of this form is to be sent)
Shell Pipeline	P.O. Box 940, Bloomfield, New Mexico
Name of Authorized Transporter of Casinghead Gas <input type="checkbox"/> or Dry Gas <input checked="" type="checkbox"/>	Address (Give address to which approved copy of this form is to be sent)
Gas Company of New Mexico	1508 Pacific Ave., Dallas, Texas
If well produces oil or liquids, give location of tanks.	Unit Sec. Twp. Rge. C 9 26N 6W
	Is gas actually connected? When No

If this production is commingled with that from any other lease or pool, give commingling order number: R-5926

COMPLETION DATA

Designate Type of Completion - (X)	Oil Well	Gas Well	New Well	Workover	Deepen	Plug Back	Same Res'v.	Diff. Res'v.
		X	X					
Date Spudded 6-1-79	Date Compl. Ready to Prod. 10-15-79	Total Depth 7323	P.B.T.D. 7323					
Elevations (DF, RKB, RT, GR, etc.) 6537 Gr.	Name of Productive Formation Pictured Cliffs, Chacra	Top Oil/Gas Pay 2720	Tubing Depth 7230					
Perforations 2720 to 5162			Depth Casing Shoe 7323					

TUBING, CASING, AND CEMENTING RECORD

HOLE SIZE	CASING & TUBING SIZE	DEPTH SET	SACKS CEMENT
15 1/4	10 3/4	360	225
8 3/4	7	7323	1188
	2 3/8	5190	

TEST DATA AND REQUEST FOR ALLOWABLE
OIL WELL

(Test must be after recovery of total volume of load oil and must be equal to or exceed top allowable for this depth or be for full 24 hours)

Date First New Oil Run To Tanks	Date of Test	Producing Method (Flow, pump, gas lift, etc.)	
Length of Test	Tubing Pressure	Casing Pressure	Choke Size
Actual Prod. During Test	Oil-Bbls.	Water-Bbls.	Gas-MCF

GAS WELL

Actual Prod. Test-MCF/D 1005	Length of Test 3 hrs.	Bbls. Condensate/MMCF	Gravity of Condensate
Testing Method (pilot, back pr.) Back Pressure	Tubing Pressure (shut-in) 579	Casing Pressure (shut-in) 519	Choke Size 3/4"

CERTIFICATE OF COMPLIANCE

I hereby certify that the rules and regulations of the Oil Conservation
Division have been complied with and that the information given
above is true and complete to the best of my knowledge and belief.

Superintendent

(Title)

10-23-79

(Date)

OIL CONSERVATION DIVISION

APPROVED DEC 26 1979

BY

SUPERVISOR DISTRICT

TITLE

This form is to be filed in compliance with RULE 1104.

If this is a request for allowable for a newly drilled or deepened
well, this form must be accompanied by a tabulation of the deviation
tests taken on the well in accordance with RULE 111.All sections of this form must be filled out completely for allow-
able on new and recompleted wells.Fill out only Sections I, II, III, and VI for changes of owner,
well name or number, or transporter, or other such change of condition.

Leasehold Form C-104 must be filed for each pool in multiple

OIL CONSERVATION COMMISSION

1000 Rio Brazos Road

AZTEC, NEW MEXICO 87410

NOTICE OF GAS CONNECTION

DATE December 28, 1979

THIS IS TO NOTIFY THE OIL CONSERVATION COMMISSION THAT CONNECTION FOR THE PURCHASE OF

GAS FROM THE Caulkins Oil Company
OPERATOR

Breech B

LEASE

220-R

WELL UNIT

(B)14-26N-07W

S - T - R

South Blanco Pictured Cliffs

POOL

Gas Company of New Mexico

NAME OF PURCHASER

WAS MADE ON 12-27-79 , FIRST DELIVERY 12-27-79
DATE DATE

1356*

INITIAL POTENTIAL

*NOTE: Commingled with Blanco MV pool and Otero Chacra pool

2170 PC
3270 Chacra
4770 MV

Gas Company of New Mexico
PURCHASER

J. R. Large
REPRESENTATIVE
James R. Large
Dispatch Manager
TITLE

/sw

cc: OPERATOR

New Mexico Oil Conservation Commission - Aztec

U. S. Geological Survey

Mr. E. R. Corliss, Engineering

Mr. R. J. McCrary, Prorations

Mr. Dan McFearin, Gas Accting.

Mr. W. B. Richardson, Gas Measurement

Mr. G. L. Atkins, Gas Supply

Mr. Perry Williams, Engineering

File

UNITED STATES
DEPARTMENT OF THE INTERIOR
GEOLOGICAL SURVEY

SUNDRY NOTICES AND REPORTS ON WELLS

(Do not use this form for proposals to drill or to deepen or plug back to a different reservoir. Use Form 9-331-C for such proposals.)

1. oil ☐ well gas ☒ well other ☐
2. NAME OF OPERATOR
Caulkins Oil Company
3. ADDRESS OF OPERATOR
P.O. Box 780, Farmington, New Mexico
4. LOCATION OF WELL (REPORT LOCATION CLEARLY. See space 17 below.)
AT SURFACE: 990' F/N and 990' F/E
AT TOP PROD. INTERVAL: Same
AT TOTAL DEPTH: Same

16. CHECK APPROPRIATE BOX TO INDICATE NATURE OF NOTICE, REPORT, OR OTHER DATA

REQUEST FOR APPROVAL TO:

- TEST WATER SHUT-OFF ☐
- FRACTURE TREAT ☐
- SHOOT OR ACIDIZE ☐
- REPAIR WELL ☐
- PULL OR ALTER CASING ☐
- MULTIPLE COMPLETE ☐
- CHANGE ZONES ☐
- ABANDON* ☐
- (other) ☐

SUBSEQUENT REPORT OF:

- ☐
- ☐
- ☐
- ☐
- ☐
- ☐
- ☐
- ☒

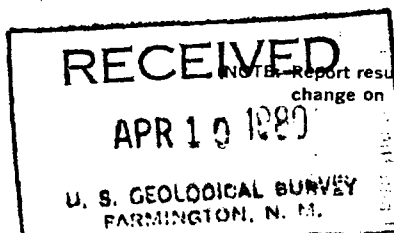

17. DESCRIBE PROPOSED OR COMPLETED OPERATIONS (Clearly state all pertinent details, and give pertinent dates, including estimated date of starting any proposed work. If well is directionally drilled, give subsurface locations and measured and true vertical depths for all markers and zones pertinent to this work.)*

4-2-80

Spotted cement Plug 2816' to 1500'.

Spotted 9.0# Gel Based Mud 1500' to 200'.

Perforated 4 1/2" casing at 200' and then circulated cement 200' to surface.

Welded marker to top of 4 1/2" casing.

Subsurface Safety Valve: Manu. and Type _____ Set @ _____ Ft.

18. I hereby certify that the foregoing is true and correct

SIGNED Charles E. Vergara TITLE Superintendent DATE 4-2-80

(This space for Federal or State office use)

APPROVED BY _____ TITLE _____ DATE _____
CONDITIONS OF APPROVAL, IF ANY:

OPERATOR

*See Instructions on Reverse Side

STATE OF NEW MEXICO
ENERGY AND MINERALS DEPARTMENT
OIL CONSERVATION COMMISSION

APPLICATIONS OF DEPCO, INC.,)	
ENERGY RESERVES GROUP,)	CASE NOS. 8103, 8104,
TENNECO OIL COMPANY,)	8107, 8108, 8109, 8110,
SOUTHERN UNION EXPLORATION CO.,)	8111, 8132, 8134, 8265,
UNION TEXAS PETROLEUM CORP.,)	8267, 8340
AMOCO PRODUCTION CO., LADD)	
PETROLEUM CORP., CAULKINS OIL)	
CO. AND SOUTHLAND ROYALTY CO. FOR)	
EXEMPTIONS FROM THE NEW MEXICO)	
NATURAL GAS PRICING ACT.)	

ORDER GRANTING EXTENSION OF TIME
IN WHICH TO FILE FINDINGS AND CONCLUSIONS

THIS MATTER having come before the Commission on the Motion of the New Mexico Public Service Commission for an extension of time up to and including October 19, 1984, in which to file its proposed findings and conclusions in the above-styled cases, and the Commission finding that no prejudice will result from the grant of such extension,

IT IS THEREFORE ORDERED THAT:

The New Mexico Public Service Commission is granted an extension of time up to and including October 19, 1984, in which to file proposed findings, conclusions and orders in the above-referenced proceedings.

DONE at Santa Fe, New Mexico this _____ day of October,
1984.

STATE OF NEW MEXICO
OIL CONSERVATION COMMISSION

JIM BACA, Member

ED KELLEY, Member

R. L. STAMETS, Acting Chairman
and Secretary

BEFORE THE NEW MEXICO OIL CONSERVATION COMMISSION

APPLICATIONS OF DEPCO,
TENNECO, ENERGY RESERVES
GROUP, SOUTHERN UNION
EXPLORATION, AMOCO,
UNION TEXAS, SOUTHLAND,
LADD AND CAULKINS OIL CO.
FOR EXEMPTION FROM THE
NEW MEXICO NATURAL GAS
PRICING ACT.

)
)
)
)
)
)
)
)
)
)
)

CASE NOS. 8103, 8104,
8107, 8108, 8109,
8110, 8111, 8132,
8134, 8265, 8267,
8340

RECEIVED

SEP 19 1984

**MOTION FOR EXTENSION
OF TIME TO FILE
FINDINGS AND CONCLUSIONS**

OIL CONSERVATION DIVISION

COMES NOW the New Mexico Public Service Commission and hereby requests an extension of time in which to file its proposed findings and conclusions of law in the above-styled cases until October 19, 1984. As reasons for the extension, the PSC states:

1. Currently the due date for proposed findings and conclusions in these cases is September 24, 1984.

2. Mrs. Sally Boyd, the court reporter of these cases, has informed PSC counsel that transcripts will probably not be available for the hearings held September 12 in these cases until approximately October 12, 1984.

3. The PSC would like to have the transcripts of the September 12 hearing available prior to submission of their proposed findings and conclusions.

4. The applicants in these cases will not be prejudiced by an extension of time because the exemptions will run from the date of application to June 30, 1984, regardless of the date actually granted by the OCC (if granted).

5. Public Service Company of New Mexico concurs in this Motion.

WHEREFORE, the Public Service Commission hereby requests an extension of time in which to file proposed findings and conclusions in the above-styled cases until October 19, 1984.

Respectfully submitted,

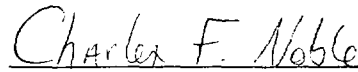

CHARLES F. NOBLE

Staff Counsel

JAMES C. MARTIN

Staff Counsel

New Mexico Public Service Commission

Bataan Memorial Building

Santa Fe, New Mexico 87503

(505) 827-6940

BEFORE THE NEW MEXICO OIL CONSERVATION COMMISSION

APPLICATIONS OF DEPCO,)	
TENNECO, ENERGY RESERVES)	CASE NOS. 8103, 8104,
GROUP, SOUTHERN UNION)	8107, 8108, 8109,
EXPLORATION, AMOCO,)	8110, 8111, 8132,
UNION TEXAS, SOUTHLAND,)	8134, 8265, 8267,
LADD AND CAULKINS OIL CO.)	8340

CERTIFICATE OF SERVICE

I HEREBY certify that a true and correct copy of the foregoing Motion For Extension Of Time To File Findings And Conclusions, filed on September 19, 1984, was mailed by First Class Mail, postage prepaid, to each of the following:

Karen Aubrey
Thomas Kellahin
Kellahin & Kellahin
P.O. Box 2265
Santa Fe, New Mexico 87501

Mark Adams
Rodey Law Firm
P.O. Box 1888
Albuquerque, New Mexico 87103

William F. Carr
Campbell & Black
P.O. Box 2208
Santa Fe, New Mexico 87501

Owen Lopez
Jim Wechsler
Hinkle Law Firm
P.O. Box 2068
Santa Fe, New Mexico 87501

Richard Alvidrez
Keleher & McLeod, P.A.
Public Service Bldg.
P.O. Drawer AA
Albuquerque, New Mexico 87103

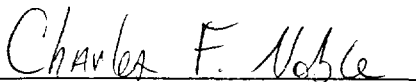
CHARLES F. NOBLE
Staff Counsel
JAMES C. MARTIN
Staff Counsel
New Mexico Public Service Commission
Bataan Memorial Building
Santa Fe, New Mexico 87503
(505) 827-6940

CFN/JCM/mm

BEFORE THE NEW MEXICO OIL CONSERVATION COMMISSION

SEP 25 1984

APPLICATIONS OF DEPCO,)
TENNECO AND CAULKINS,)
FOR EXEMPTION FROM)
THE NEW MEXICO NATURAL)
GAS PRICING ACT.)

OIL CONSERVATION DIVISION

CASE NOS: 8103, 8104
8132

OPPOSITION TO PUBLIC SERVICE COMMISSION'S
MOTION FOR AN EXTENSION OF
TIME TO FILE FINDINGS AND CONCLUSION

COMES NOW Tenneco, DEPCO Inc., and Caulkins Oil Company, by and through its attorneys, Kellahin & Kellahin, and object to the granting of an extension of time to the Public Service Commission (PSC) in which to file proposed orders with the Commission for the following reasons:

1. In Case #8103, which was reopened at the PSC's request, the PSC did not ask any questions of DEPCO's witness, Charles Crump, though he was available at the hearing. Consequently, there is nothing to be learned from the transcript in that case.

2. Likewise, in Case #8104, another case reopened at the PSC's request, Tenneco's witness, Bob Gibb, was only asked three questions and the transcript of such short, simple testimony is not required before a proposed order can be filed in a case that was originally heard six months before.

3. Hearings of all nine cases on September 12, 1984, took approximately 3 hours. It does not appear to Applicants that waiting on the transcript of three hours of hearings is sufficient reason to further delay cases which have been before the Commission for almost a year.

THEREFORE, applicants, Tenneco, DEPCO Inc., and Caulkins Oil Company request that the PSC's Motion for Extension of Time to File Findings and Conclusions be denied.

Respectfully submitted,

By

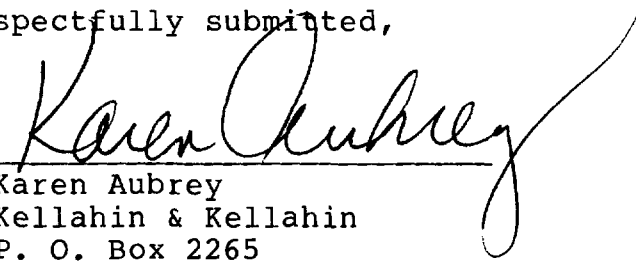
Karen Aubrey
Kellahin & Kellahin
P. O. Box 2265
Santa Fe, New Mexico 87501

Attorneys for Tenneco,
DEPCO Inc., and Caulkins
Oil Company

APPLICATIONS OF DEPCO,
TENNECO AND CAULKINS,
FOR EXEMPTION FROM
THE NEW MEXICO NATURAL
GAS PRICING ACT.

)
)
)
)
)

CASE NOS: 8103, 8104
8132

CERTIFICATE OF SERVICE

I hereby certify that a true and correct copy of the foregoing pleading was served by depositing same in the U. S. Mail, postage prepaid, on the 25th day of September, 1984, to the following counsel of record:

William F. Carr, Esq.
Campbell & Black
P. O. Box 2208
Santa Fe, New Mexico 87501

Richard Alvidrez, Esq.
Keleher & McLeod, P.A.
P. O. Drawer AA
Albuquerque, NM 87103

Jeffrey Taylor, Esq.
Assistant Attorney General
Oil Conservation Division
P. O. Box 2088
Santa Fe, New Mexico 87501

James C. Martin, Esq.
Staff Counsel
Public Service Commission
2nd Floor - Bataan Building
Santa Fe, New Mexico 87503

Mark Adams, Esq.
Rodey Law Firm
P. O. Box 1888
Albuquerque, NM 87103

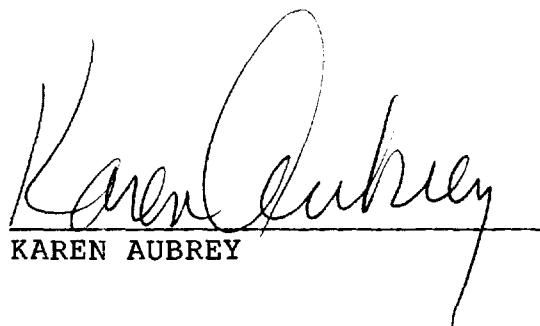
KAREN AUBREY