

## YATES DRILLING CO.

DOYAL #3

PARTIAL PRESSURE MAINTENANCE PROJECT

Sec. 27 - T12S - R31E

Chaves Co., New Mexico

Contoured on Top of Queen

C.I. = 10'

Scale: 1" = 1000'

BEFORE EXAMINER QUINTANA  
OIL CONSERVATION DIVISION

YATES EXHIBIT NO. 9

CASE NO. 8502

YATES DRILLING COMPANY

DOYAL NO. 3

Partial Pressure Maintenance Project

1980' FSL & 990' FEL Sec. 27-12S-31E

Chaves County, New Mexico

Exhibit No. 9-Revised

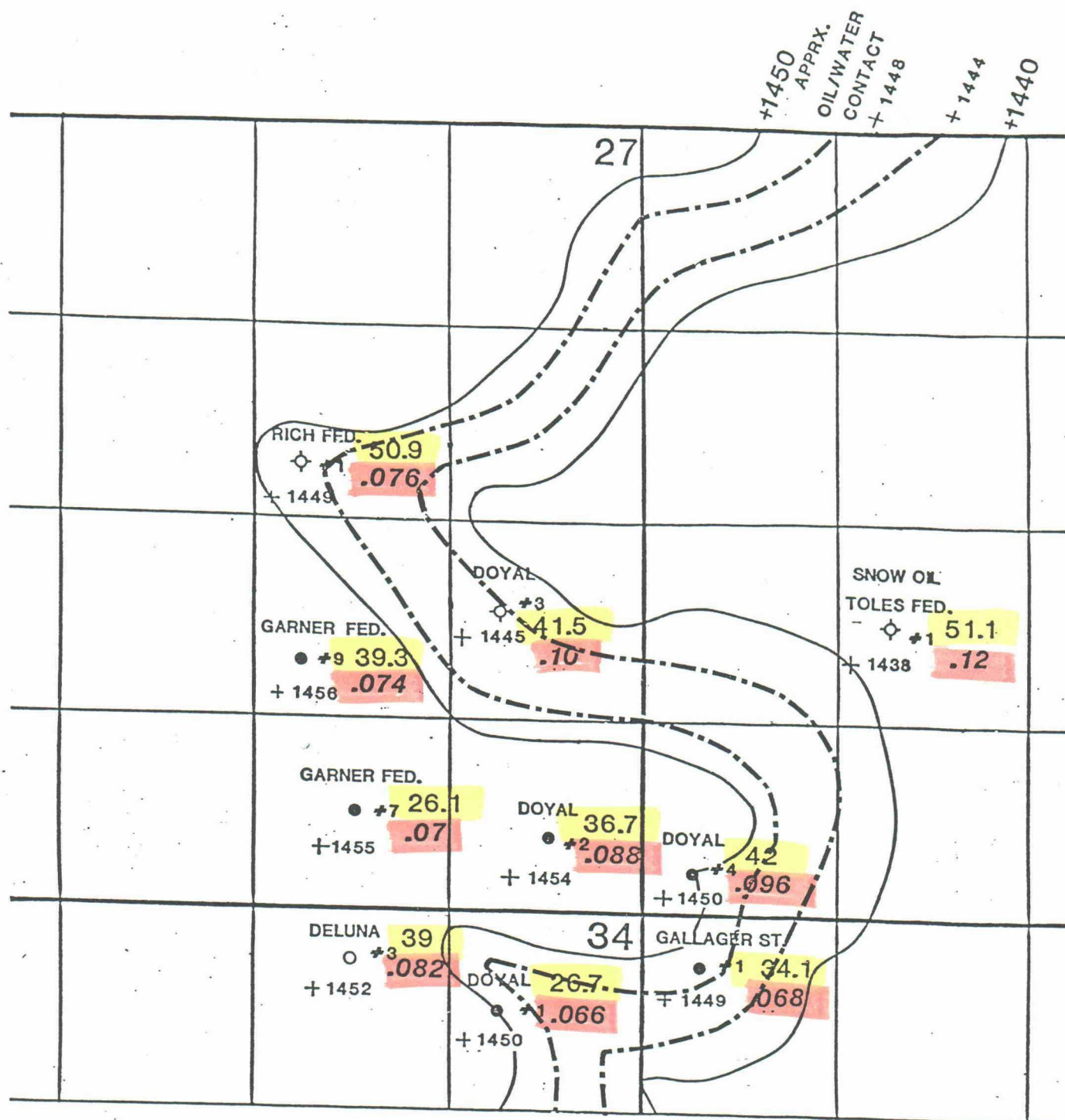

39 ..... Water Saturation Calculated From  $\phi$  & Resistivity Logs

$$S_w = \sqrt{\frac{R_w}{\phi^2} \cdot R_t}$$

.082 ..... Bulk Volume Of Free Water (Effective  $\phi \cdot S_w$ )

## YATES DRILLING CO.

DOYAL #3

PARTIAL PRESSURE MAINTENANCE PROJECT

Sec. 27 - T12S - R31E

Chaves Co., New Mexico

Scale: 1" : 1000'



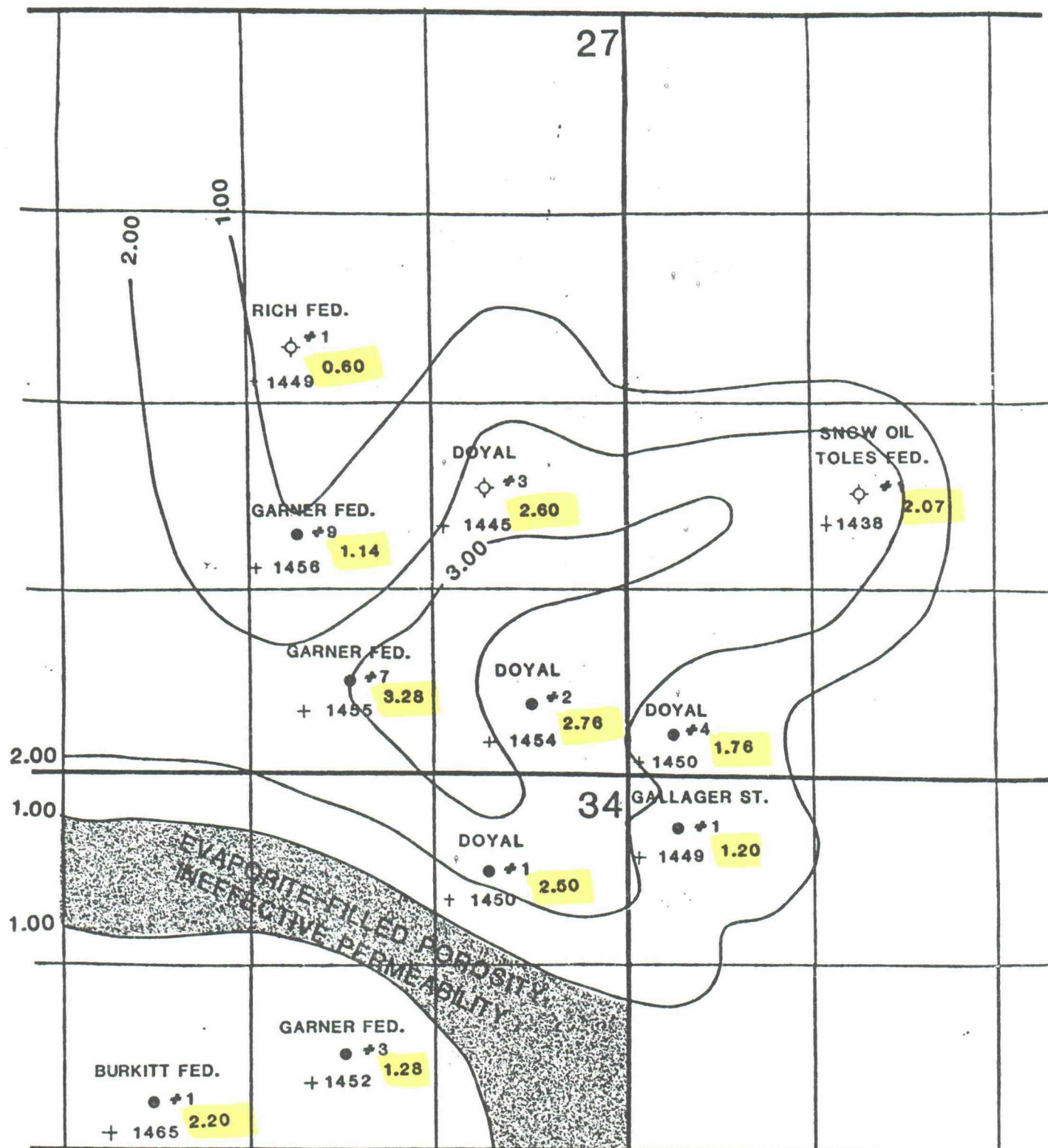

## YATES DRILLING CO.

DOYAL #3  
PARTIAL PRESSURE MAINTENANCE PROJECT  
Sec. 27 - T12S - R27E  
Chaves Co., New Mexico

Contoured on Queen Porosity Feet

$\emptyset$  = Max.  $\emptyset$   
Ft. = Ft. > 6%  $\emptyset$   
 $\emptyset$  · Ft. =  $\emptyset$  Ft.

C.I. = 1  $\emptyset$  Ft.

Scale: 1" = 1000'

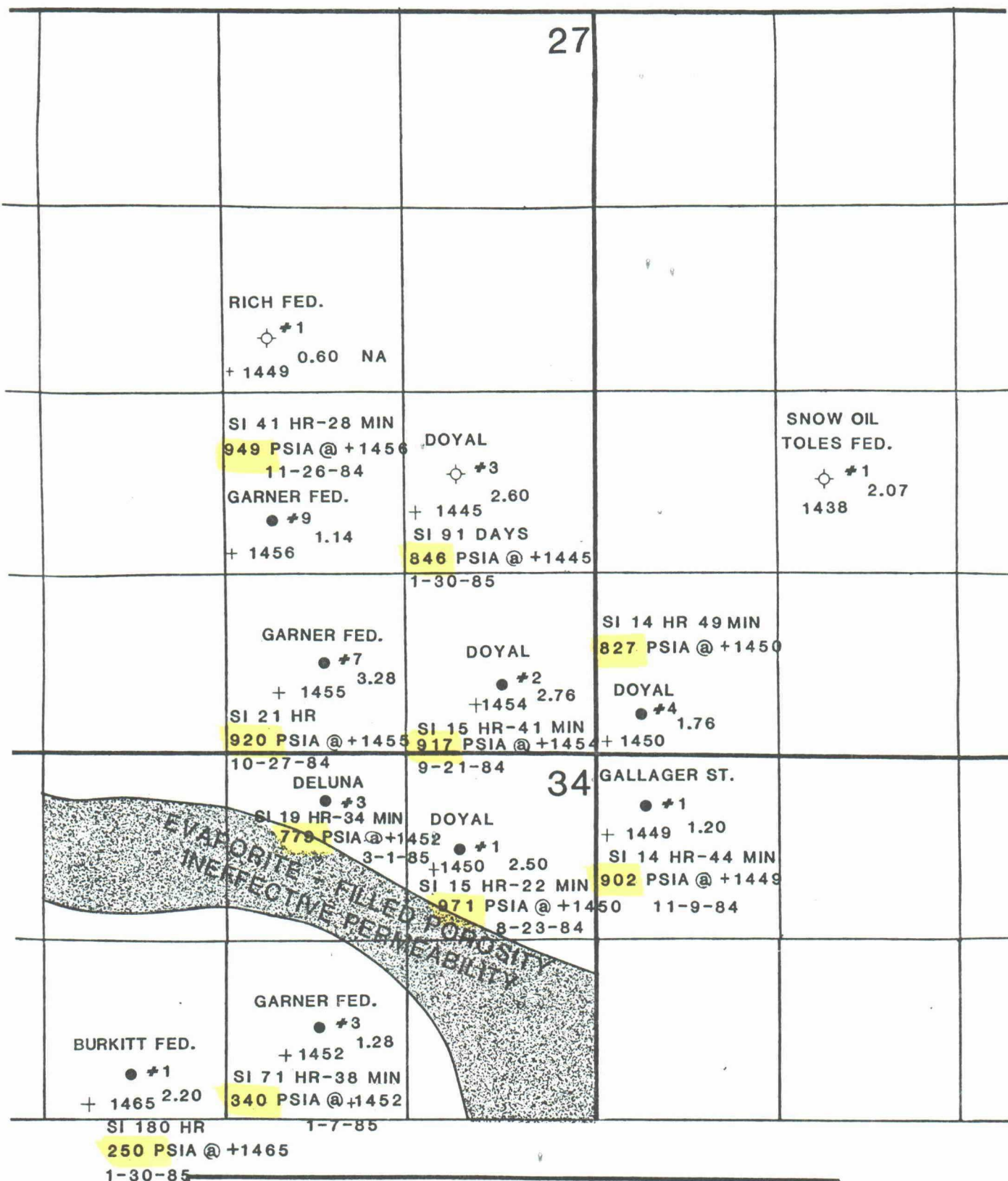

## YATES DRILLING COMPANY

DOYAL #3

PARTIAL PRESSURE MAINTENANCE PROJECT  
MOST RECENT SIBHP

SEC. 27 T12S-R27E

CHAVES CO. NEW MEXICO

SCALE : 1" - 1000'

Form 3811, July 1982

● SENDER: Complete Items 1, 2, 3, and 4.  
Add your address in the "RETURN TO" space on reverse.

(CONSULT POSTMASTER FOR FEES)

1. The following service is requested (check one).  
☐ Show to whom and date delivered .....  
☒ Show to whom, date, and address of delivery ..  
2. ☐ RESTRICTED DELIVERY .....  
(The restricted delivery fee is charged in addition to the return receipt fee.)

TOTAL \$ .....

3. ARTICLE ADDRESSED TO:  
*Raymond Spears*  
*307 North 7th*  
*Longview, NM 88260*

4. TYPE OF SERVICE: ARTICLE NUMBER  
☐ REGISTERED ☐ INSURED  
☒ CERTIFIED ☐ COD *498-192-112*  
☐ EXPRESS MAIL

(Always obtain signature of addressee or agent)

I have received the article described above.  
SIGNATURE ☐ Addressee ☐ Authorized agent  
*Raymond Spears*

5. DATE OF DELIVERY POSTMARK  
*2-15-85* (may be on reverse side)

6. ADDRESSEE'S ADDRESS (Only if requested)

7. UNABLE TO DELIVER BECAUSE: 7a. EMPLOYEE'S INITIALS

RETURN RECEIPT

GPO: 1982-379-593

PS Form 3811, July 1982

● SENDER: Complete Items 1, 2, 3, and 4.  
Add your address in the "RETURN TO" space on reverse.

(CONSULT POSTMASTER FOR FEES)

1. The following service is requested (check one).  
☐ Show to whom and date delivered .....  
☒ Show to whom, date, and address of delivery ..  
2. ☐ RESTRICTED DELIVERY .....  
(The restricted delivery fee is charged in addition to the return receipt fee.)

TOTAL \$ .....

3. ARTICLE ADDRESSED TO:  
*J. D. Spears*  
*PO Box 1017*  
*Orlinda, NM 88220*

4. TYPE OF SERVICE: ARTICLE NUMBER  
☐ REGISTERED ☐ INSURED  
☒ CERTIFIED ☐ COD *498-192-111*  
☐ EXPRESS MAIL

(Always obtain signature of addressee or agent)

I have received the article described above.  
SIGNATURE ☐ Addressee ☐ Authorized agent  
*J. D. Spears*

5. DATE OF DELIVERY POSTMARK  
*FEB 21 1985* (may be on reverse side)

6. ADDRESSEE'S ADDRESS (Only if requested)

7. UNABLE TO DELIVER BECAUSE: 7a. EMPLOYEE'S INITIALS

RETURN RECEIPT

GPO: 1982-379-593

YATES DRILLING COMPANY  
DOYAL NO. 3  
Partial Pressure Maintenance Project  
1980' FSL & 990' FEL Sec. 27-12S-31E  
Chaves County, New Mexico  
Exhibit No. 10

BEFORE EXAMINER QUINTANA  
OIL CONSERVATION DIVISION  
YATES EXHIBIT NO. 10  
CASE NO. 8502

● **SENDER:** Complete Items 1, 2, 3, and 4.  
Add your address in the "RETURN TO" space on reverse.

**(CONSULT POSTMASTER FOR FEES)**

1. The following service is requested (check one).  
☐ Show to whom and date delivered .....  
☒ Show to whom, date, and address of delivery ..  
 2. ☐ **RESTRICTED DELIVERY** .....  
 (The restricted delivery fee is charged in addition to the return receipt fee.)

**TOTAL \$** .....

3. **ARTICLE ADDRESSED TO:**  
*C. P. Gallagher et al.*  
*1005 Cedar Commerce Bank Bldg*  
*Fullerton, Calif 92601*

4. **TYPE OF SERVICE:** **ARTICLE NUMBER**  
☐ REGISTERED ☐ INSURED  
☒ CERTIFIED ☐ COD *498-192-115*  
☐ EXPRESS MAIL

(Always obtain signature of addressee or agent)

I have received the article described above.  
**SIGNATURE** ☐ Addressee ☒ Authorized agent  
*[Signature]*

5. **DATE OF DELIVERY** **POSTMARK**  
*2-14-85* *BOULDER TOWN ST*  
*FEB 14 1985*  
 (may be on reverse side)

6. **ADDRESSEE'S ADDRESS** (Only if requested)

7. **UNABLE TO DELIVER BECAUSE:** **7a. EMPLOYEE'S INITIALS**

RETURN RECEIPT

GPO: 1982-379-593

● **SENDER:** Complete Items 1, 2, 3, and 4.  
Add your address in the "RETURN TO" space on reverse.

**(CONSULT POSTMASTER FOR FEES)**

1. The following service is requested (check one).  
☐ Show to whom and date delivered .....  
☒ Show to whom, date, and address of delivery ..  
 2. ☐ **RESTRICTED DELIVERY** .....  
 (The restricted delivery fee is charged in addition to the return receipt fee.)

**TOTAL \$** .....

3. **ARTICLE ADDRESSED TO:**  
*The Sales Company*  
*PO Drawer 1300*  
*Rescue, NM 88201*

4. **TYPE OF SERVICE:** **ARTICLE NUMBER**  
☐ REGISTERED ☐ INSURED  
☒ CERTIFIED ☐ COD *498-192-114*  
☐ EXPRESS MAIL

(Always obtain signature of addressee or agent)

I have received the article described above.  
**SIGNATURE** ☐ Addressee ☐ Authorized agent  
*[Signature]*

5. **DATE OF DELIVERY** **POSTMARK**  
*2-14-85* *1985*  
 (may be on reverse side)

6. **ADDRESSEE'S ADDRESS** (Only if requested)

7. **UNABLE TO DELIVER BECAUSE:** **7a. EMPLOYEE'S INITIALS**

RETURN RECEIPT

GPO: 1982-379-593

● **SENDER:** Complete Items 1, 2, 3, and 4.  
Add your address in the "RETURN TO" space on reverse.

**(CONSULT POSTMASTER FOR FEES)**

1. The following service is requested (check one).  
☐ Show to whom and date delivered .....  
☒ Show to whom, date, and address of delivery ..  
 2. ☐ **RESTRICTED DELIVERY** .....  
 (The restricted delivery fee is charged in addition to the return receipt fee.)

**TOTAL \$** .....

3. **ARTICLE ADDRESSED TO:**  
*BullNose Petroleum Corp*  
*One Petroleum Center, Bldg 6, Intermont*  
*9300 Norwalk* *Switz*  
*Fullerton, Calif 92601*

4. **TYPE OF SERVICE:** **ARTICLE NUMBER**  
☐ REGISTERED ☐ INSURED  
☒ CERTIFIED ☐ COD *498-192-117*  
☐ EXPRESS MAIL

(Always obtain signature of addressee or agent)

I have received the article described above.  
**SIGNATURE** ☐ Addressee ☐ Authorized agent  
*A. Johnson*

5. **DATE OF DELIVERY** **POSTMARK**  
*2-15-85* *[Postmark]*  
 (may be on reverse side)

6. **ADDRESSEE'S ADDRESS** (Only if requested)

7. **UNABLE TO DELIVER BECAUSE:** **7a. EMPLOYEE'S INITIALS**

RETURN RECEIPT

- **SENDER:** Complete Items 1, 2, 3, and 4.  
Add your address in the "RETURN TO" space on reverse.

**(CONSULT POSTMASTER FOR FEES)**

1. The following service is requested (check one).

- ☐ Show to whom and date delivered ..... \$  
☒ Show to whom, date, and address of delivery ..... \$  
 2. ☐ **RESTRICTED DELIVERY** ..... \$  
 (The restricted delivery fee is charged in addition to the return receipt fee.)

TOTAL \$ \_\_\_\_\_

3. ARTICLE ADDRESSED TO:

HNC Oil Company  
 PO Box 2267  
 Midland, Texas 79702

4. TYPE OF SERVICE:

- ☐ REGISTERED ☐ INSURED  
☒ CERTIFIED ☐ COD  
☐ EXPRESS MAIL

ARTICLE NUMBER

498-192-119

(Always obtain signature of addressee or agent)

I have received the article described above.

SIGNATURE ☐ Addressee ☐ Authorized agent

5. DATE OF DELIVERY

POSTMARK  
 (may be on reverse side)  
 FEB 15 1985

6. ADDRESSEE'S ADDRESS (Only if requested)

7. UNABLE TO DELIVER BECAUSE:

7a. EMPLOYEE'S INITIALS

\* GPO: 1982-379-593

- **SENDER:** Complete Items 1, 2, 3, and 4.  
Add your address in the "RETURN TO" space on reverse.

**(CONSULT POSTMASTER FOR FEES)**

1. The following service is requested (check one).

- ☐ Show to whom and date delivered ..... \$  
☒ Show to whom, date, and address of delivery ..... \$  
 2. ☐ **RESTRICTED DELIVERY** ..... \$  
 (The restricted delivery fee is charged in addition to the return receipt fee.)

TOTAL \$ \_\_\_\_\_

3. ARTICLE ADDRESSED TO:

Rich Partnerships  
 2008 American Bank Bldg.  
 New Orleans, LA 70150

4. TYPE OF SERVICE:

- ☐ REGISTERED ☐ INSURED  
☒ CERTIFIED ☐ COD  
☐ EXPRESS MAIL

ARTICLE NUMBER

498-192-118

(Always obtain signature of addressee or agent)

I have received the article described above.

SIGNATURE ☐ Addressee ☐ Authorized agent

5. DATE OF DELIVERY

POSTMARK  
 (may be on reverse side)  
 FEB 15 1985

6. ADDRESSEE'S ADDRESS (Only if requested)

7. UNABLE TO DELIVER BECAUSE:

7a. EMPLOYEE'S INITIALS

\* GPO: 1982-379-593

- **SENDER:** Complete Items 1, 2, 3, and 4.  
Add your address in the "RETURN TO" space on reverse.

**(CONSULT POSTMASTER FOR FEES)**

1. The following service is requested (check one).

- ☒ Show to whom and date delivered ..... \$  
☒ Show to whom, date, and address of delivery ..... \$  
 2. ☐ **RESTRICTED DELIVERY** ..... \$  
 (The restricted delivery fee is charged in addition to the return receipt fee.)

TOTAL \$ \_\_\_\_\_

3. ARTICLE ADDRESSED TO:

Enserch Exploration, Inc.  
 PO Box 4815  
 Midland, Texas 79701

4. TYPE OF SERVICE:

- ☐ REGISTERED ☐ INSURED  
☒ CERTIFIED ☐ COD  
☐ EXPRESS MAIL

ARTICLE NUMBER

498-192-113

(Always obtain signature of addressee or agent)

I have received the article described above.

SIGNATURE ☐ Addressee ☐ Authorized agent

5. DATE OF DELIVERY

2-21-85

POSTMARK  
 (may be on reverse side)  
 FEB 21 1985

6. ADDRESSEE'S ADDRESS (Only if requested)

7. UNABLE TO DELIVER BECAUSE:

7a. EMPLOYEE'S INITIALS

\* GPO: 1982-379-593

- **SENDER:** Complete Items 1, 2, 3, and 4.  
Add your address in the "RETURN TO" space on reverse.

**(CONSULT POSTMASTER FOR FEES)**

1. The following service is requested (check one).

- ☐ Show to whom and date delivered ..... \$  
☒ Show to whom, date, and address of delivery ..... \$  
 2. ☐ **RESTRICTED DELIVERY** ..... \$  
 (The restricted delivery fee is charged in addition to the return receipt fee.)

TOTAL \$ \_\_\_\_\_

3. ARTICLE ADDRESSED TO:

Phillips Oil Company  
 PO Box 1967  
 Houston, Texas 77001

4. TYPE OF SERVICE:

- ☐ REGISTERED ☐ INSURED  
☒ CERTIFIED ☐ COD  
☐ EXPRESS MAIL

ARTICLE NUMBER

498-192-116

(Always obtain signature of addressee or agent)

I have received the article described above.

SIGNATURE ☐ Addressee ☐ Authorized agent

5. DATE OF DELIVERY

FEB 18 1985

POSTMARK  
 (may be on reverse side)

6. ADDRESSEE'S ADDRESS (Only if requested)

7. UNABLE TO DELIVER BECAUSE:

7a. EMPLOYEE'S INITIALS

\* GPO: 1982-379-593



**NEW MEXICO OIL CONSERVATION COMMISSION  
WELL LOCATION AND ACREAGE DEDICATION PLAT**

Form C-167  
Supersedes C-128  
Effective 1-1-66

All distances must be from the outer boundaries of the Section

Operator <b>YATES DRILLING COMPANY</b>			Lease <b>Doyle</b>		Well No. <b>2</b>
Tract Letter <b>P</b>	Section <b>27</b>	Township <b>12 South</b>	Range <b>31 East</b>	County <b>Chaves</b>	
Actual Footage Location of Well: <b>500</b> feet from the <b>South</b> line and <b>760</b> feet from the <b>East</b> line					
Ground Level Elev. <b>4427.</b>	Producing Formation <b>Queen</b>		Pool <b>SE Chaves Queen Gas Assoc.</b>		Estimated Acreage <b>40.00</b>

1. Outline the acreage dedicated to the subject well by colored pencil or hatchure marks on the plat below.
2. If more than one lease is dedicated to the well, outline each and identify the ownership thereof (both as to working interest and royalty).
3. If more than one lease of different ownership is dedicated to the well, have the interests of all owners been consolidated by communitization, unitization, force-pooling, etc?

☐ Yes    ☐ No    If answer is "yes," type of consolidation \_\_\_\_\_

If answer is "no," list the owners and tract descriptions which have actually been consolidated. (Use reverse side of this form if necessary.) \_\_\_\_\_

No allowable will be assigned to the well until all interests have been consolidated (by communitization, unitization, forced-pooling, or otherwise) or until a non-standard unit, eliminating such interests, has been approved by the Commission.

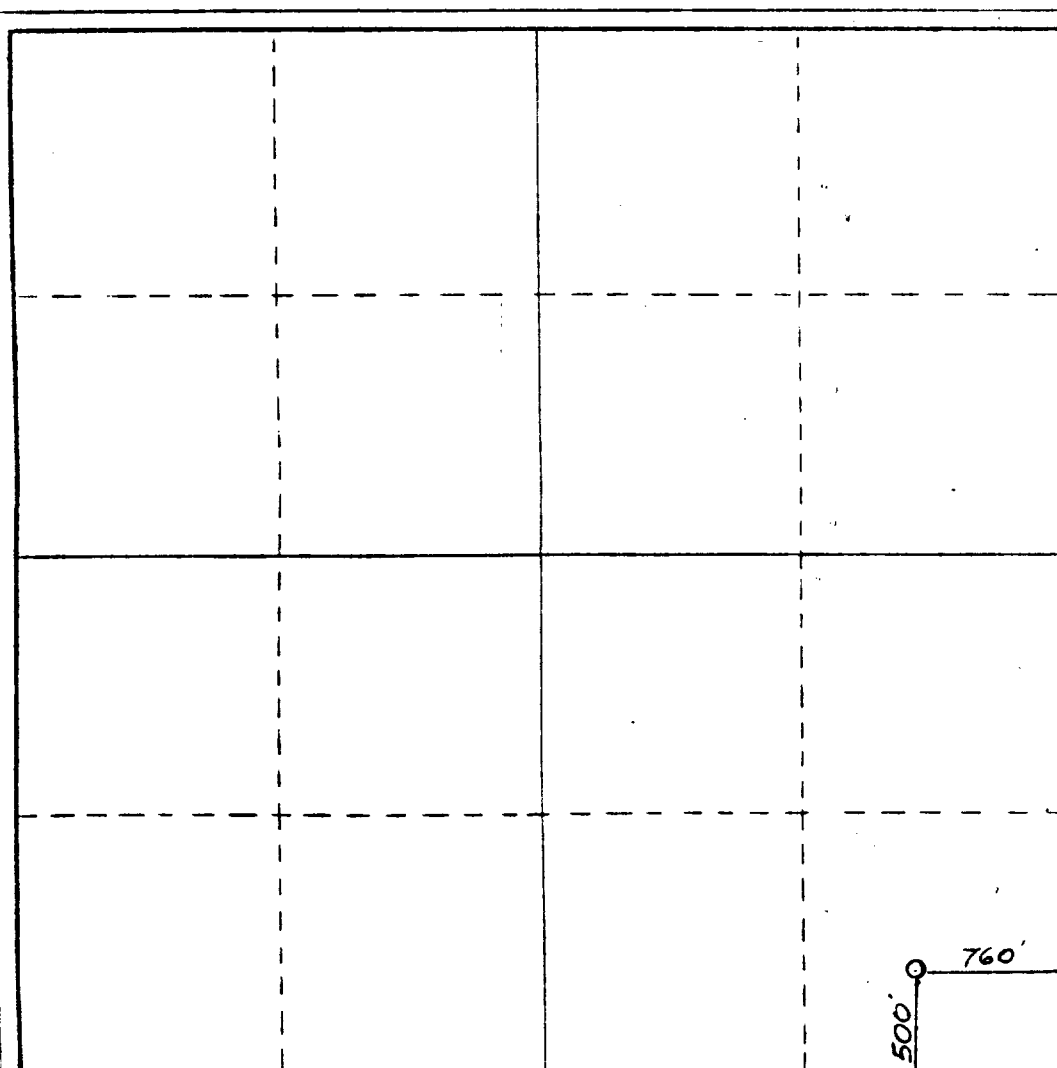

**CERTIFICATION**

I hereby certify that the information contained herein is true and complete to the best of my knowledge and belief

Signature: **Tobin Lyn Rhodes**  
 Title: **Engineer**  
 Company: **Yates Drilling Company**  
 Date: **8/30/84**

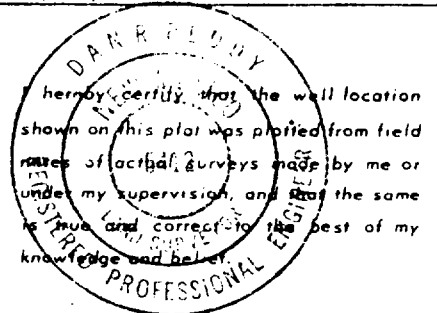

Date Surveyed: **August 30, 1984**  
 Registered Professional Engineer and/or Land Surveyor

Signature: *[Handwritten Signature]*  
 Certificate No. \_\_\_\_\_

**NM PE&LS NO. 5412**





# LOCATION AND ACREAGE DEDICATION PLAT

Form C-102  
Supersedes C-12P  
Effective 1-1-65

All distances must be from the outer boundaries of the Section.

Operator <b>YATES DRILLING COMPANY</b>			Lease <b>Doyal</b>		Well No. <b>3</b>
Tract Letter <b>I</b>	Section <b>27</b>	Township <b>12S</b>	Range <b>31E</b>	County <b>Chaves</b>	

Actual Location of Well:		1980' feet from the South		990' feet from the East	
Actual Well Elev. <b>4429' GL</b>	Dr. from 100' to 100'	Queen		SE Chaves Queen	Dedicated Acreage <b>40</b> Acres

1. Outline the acreage dedicated to the subject well by colored pencil or hatchure marks on the plat below.
2. If more than one lease is dedicated to the well, outline each and identify the ownership thereof (both as to working interest and royalty).
3. If more than one lease of different ownership is dedicated to the well, have the interests of all owners been consolidated by communitization, unitization, force-pooling, etc?

☒ Yes ☐ No If answer is "yes," type of consolidation \_\_\_\_\_

If answer is "no," list the owners and tract descriptions which have actually been consolidated. (Use reverse side of this form if necessary.) \_\_\_\_\_

No allowable will be assigned to the well until all interests have been consolidated (by communitization, unitization, force-pooling, or otherwise) or until a non-standard unit, eliminating such interests, has been approved by the Commission.

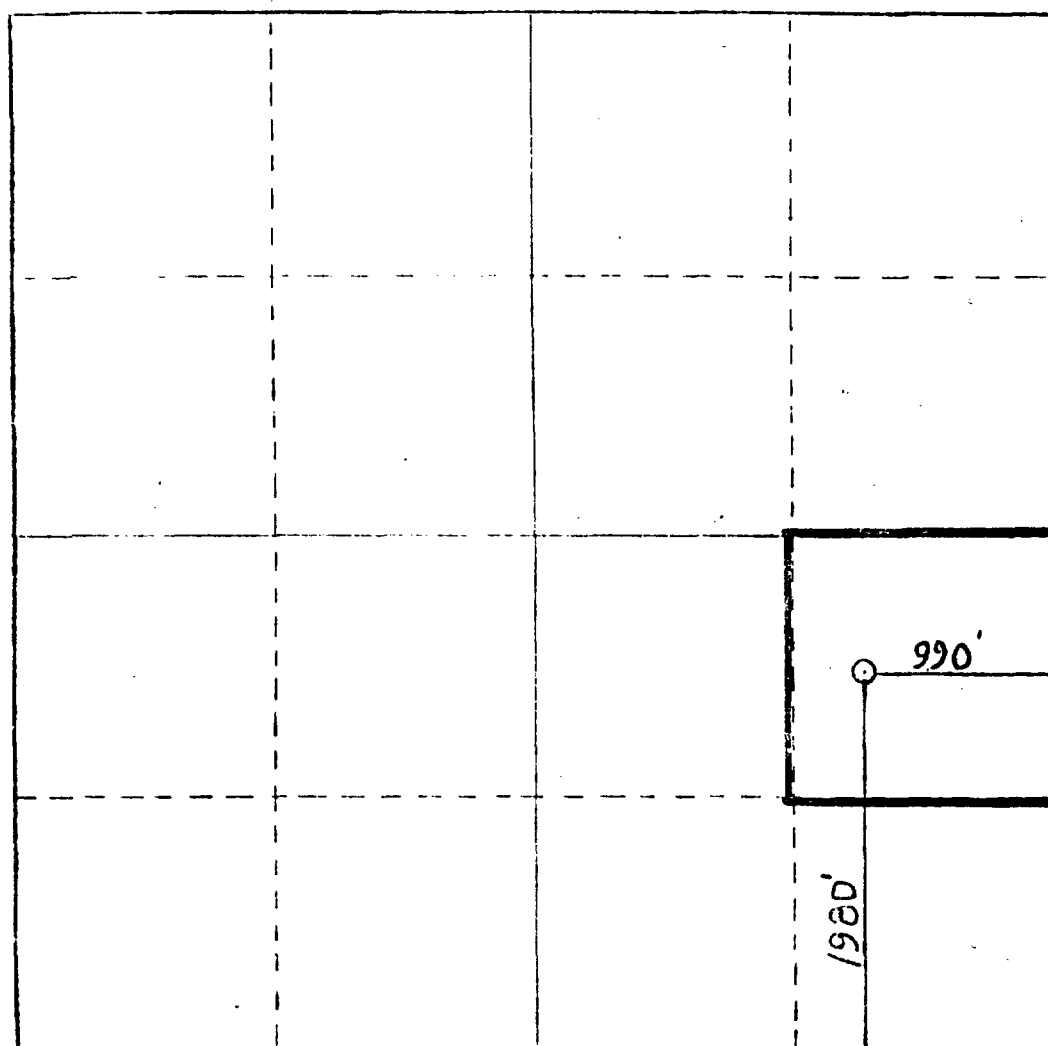

## CERTIFICATION

I hereby certify that the information contained herein is true and complete to the best of my knowledge and belief.

*Gliserio Rodriguez*  
Name

Gliserio Rodriguez

Position  
Regulatory Agent

Company  
Yates Drilling Company

Date  
9/18/84

I hereby certify that the well location shown on this plat was plotted from field notes of actual surveys made by me or under my supervision, and that the same is true and correct to the best of my knowledge and belief.

9/18/84

Date Surveyed

By \_\_\_\_\_  
Registered Professional Engineer  
and Surveyor

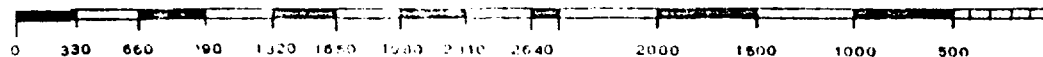
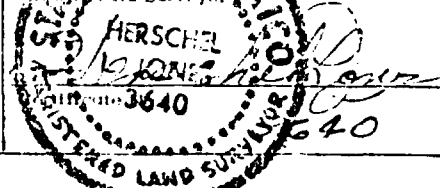

**MEXICO OIL CONSERVATION COMMISSION**  
**WELL LOCATION AND ACREAGE DEDICATION PLAT**

Form C-102  
 Supersedes C-128  
 Effective 1-1-65

All distances must be from the outer boundaries of the Section.

Operator <b>Yates Drilling Company</b>			Lease <b>Doyal</b>		Well No. <b>4</b>
Grid Letter <b>M</b>	Section <b>26</b>	Township <b>12 South</b>	Range <b>31 East</b>	County <b>Chaves</b>	
Actual Footage Location of Well:					
<b>330</b>	feet from the	<b>South</b>	line and	<b>330</b>	feet from the
					<b>West</b>
Ground Level Elev. <b>4425' GL</b>	Producing Formation <b>Queen</b>		Pool <b>SE Chaves Queen</b>		Dedicated Acreage: <b>40</b> Acres

1. Outline the acreage dedicated to the subject well by colored pencil or hatchure marks on the plat below.
2. If more than one lease is dedicated to the well, outline each and identify the ownership thereof (both as to working interest and royalty).
3. If more than one lease of different ownership is dedicated to the well, have the interests of all owners been consolidated by communitization, unitization, force-pooling, etc?

Yes ☐ No ☐ If answer is "yes," type of consolidation \_\_\_\_\_

If answer is "no," list the owners and tract descriptions which have actually been consolidated. (Use reverse side of plat if necessary.) \_\_\_\_\_

No allowable will be assigned to the well until all interests have been consolidated (by communitization, unitization, force-pooling, or otherwise) or until a non-standard unit, eliminating such interests, has been approved by the Commission.

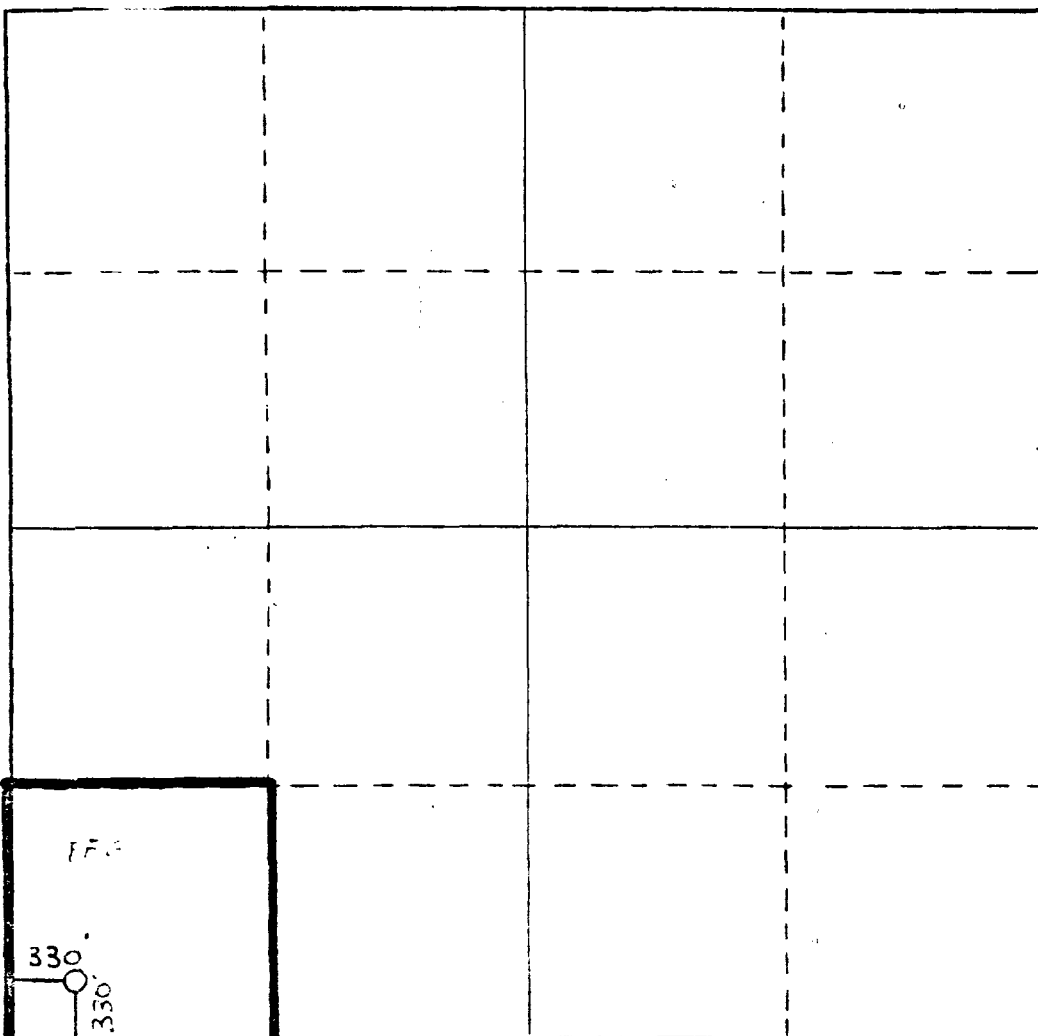

**CERTIFICATION**

*I hereby certify that the information contained herein is true and complete to the best of my knowledge and belief.*

*Gliserio Rodriguez*  
 Name  
**Gliserio Rodriguez**

Position  
**Regulatory Agent**

Company  
**Yates Drilling Company**

Date  
**11/14/84**

*I hereby certify that the well location shown on this plat was plotted from field notes of actual surveys made by me or under my supervision, and that the same is true and correct to the best of my knowledge and belief.*

Date Survey  
**11/13/84**

Registered Professional Engineer and/or Land Surveyor  
**L. JONES**

Certificate No. **3640**

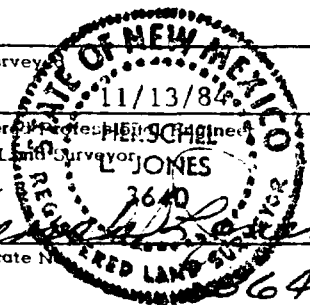

**MEXICO OIL CONSERVATION COMMISSION**  
**WELL LOCATION AND ACREAGE DEDICATION PLAT**

Form C-102  
 Supersedes C-128  
 Effective 1-1-85

All distances must be from the outer boundaries of the Section.

Operator <b>YATES DRILLING COMPANY</b>			Lease <b>Doyal</b>		Well No. <b>1</b>
Unit Letter <b>A</b>	Section <b>34</b>	Range <b>12 South</b>	Meridian <b>31 East</b>	County <b>Chaves</b>	
Actual Footage Location of Well:					
<b>660</b>	feet from the	<b>North</b>	<b>990</b>	feet from the	<b>East</b>
Ground Level Elev. <b>4428'</b>	Producing Formation <b>Queen</b>		Field <b>SE Chaves Queen</b>		Section A or B <b>40</b>

1. Outline the acreage dedicated to the subject well by colored pencil or hatchure marks on the plat below.
2. If more than one lease is dedicated to the well, outline each and identify the ownership thereof (both as to working interest and royalty).
3. If more than one lease of different ownership is dedicated to the well, have the interests of all owners been consolidated by communitization, unitization, force-pooling, etc?

☒ Yes ☐ No If answer is "yes," type of consolidation \_\_\_\_\_

If answer is "no," list the owners and tract descriptions which have actually been consolidated. (Use reverse side of form if necessary.) \_\_\_\_\_

Flowable will be assigned to the well until all interests have been consolidated by communitization, unitization, force-pooling, or otherwise) or until a non-standard unit, eliminating such interests, has been approved by the Commission.

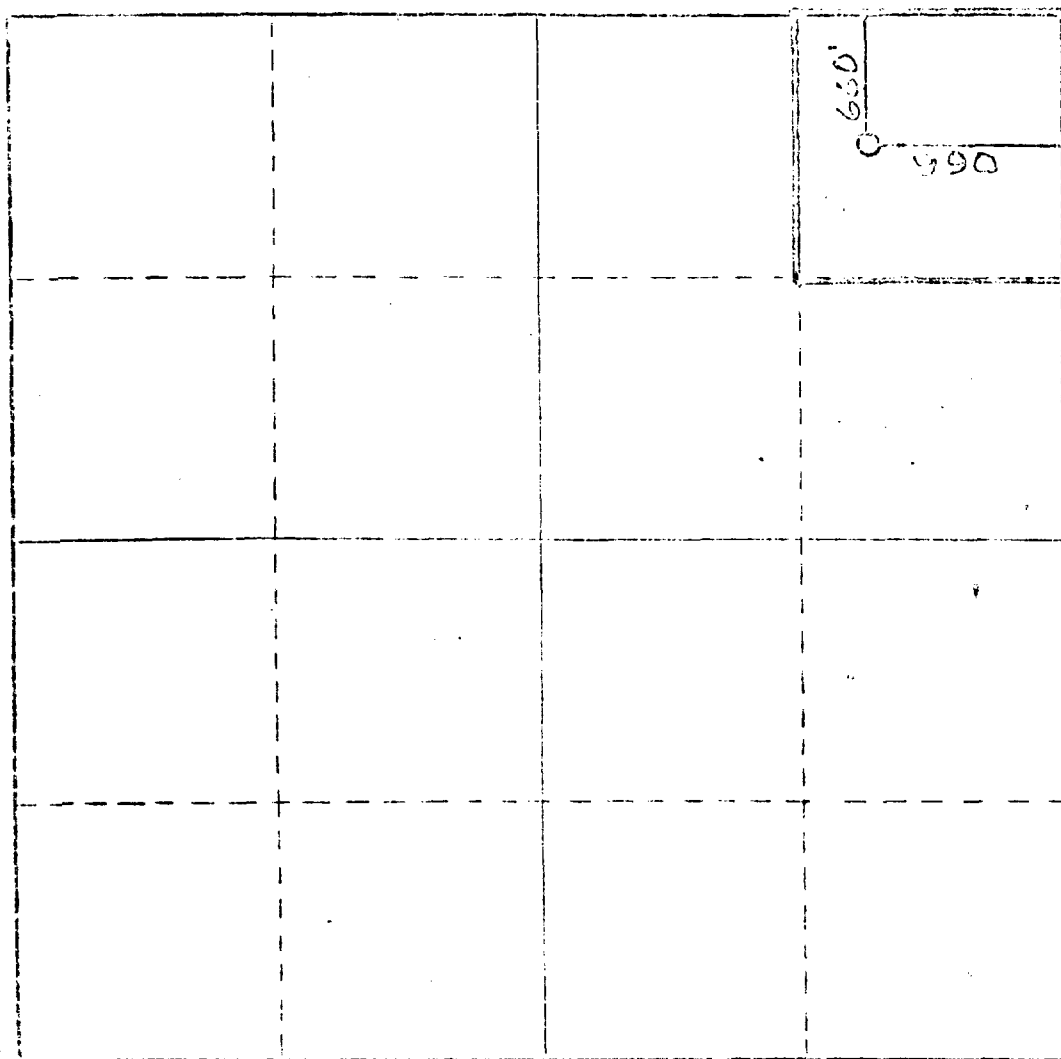

**CERTIFICATION**

I hereby certify that the information contained herein is true and complete to the best of my knowledge and belief.

*Gloria Rodriguez*  
 \_\_\_\_\_  
 Name

**Regulatory Agent**

**Yates Drilling Company**

**7/24/84**

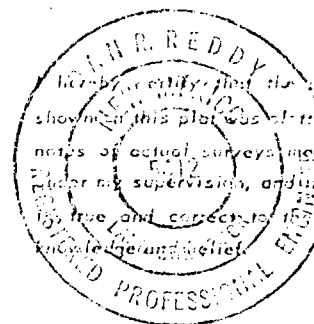

Date Certified

**July 23, 1984**

Signature of Engineer  
*John R. Reddy*

Certificate No.

**NM PERLS NO. 5412**

300 400 500 600 700 800 900 1000 1100 1200 1300 1400 1500 1600 1700 1800 1900 2000

# NEW MEXICO OIL CONSERVATION COMMISSION WELL LOCATION AND ACREAGE DEDICATION PLAT

Supersedes C-128  
Effective 1-1-65

All distances must be from the outer boundaries of the Section.

YATES DRILLING COMPANY			Lease Garner Federal		Well No. 9
Section Letter J	Section 27	Township 12 South	Range 31 East	County Chaves	
Actual Footage Location of Well:					
1650	feet from the South	Line and	2310	feet from the East	Line
Ground Level Elev. 4424' GL	Producing Formation Green	Pool 315 Chaves Queen Ben Area designated		Dedicated Acreage: 40 Acres	

1. Outline the acreage dedicated to the subject well by colored pencil or hachure marks on the plat below.
2. If more than one lease is dedicated to the well, outline each and identify the ownership thereof (both as to working interest and royalty).
3. If more than one lease of different ownership is dedicated to the well, have the interests of all owners been consolidated by communitization, unitization, force-pooling, etc?

☐ Yes ☐ No If answer is "yes," type of consolidation \_\_\_\_\_

If answer is "no," list the owners and tract descriptions which have actually been consolidated. (Use reverse side of this form if necessary.) \_\_\_\_\_

No allowable will be assigned to the well until all interests have been consolidated (by communitization, unitization, forced-pooling, or otherwise) or until a non-standard unit, eliminating such interests, has been approved by the Commission.

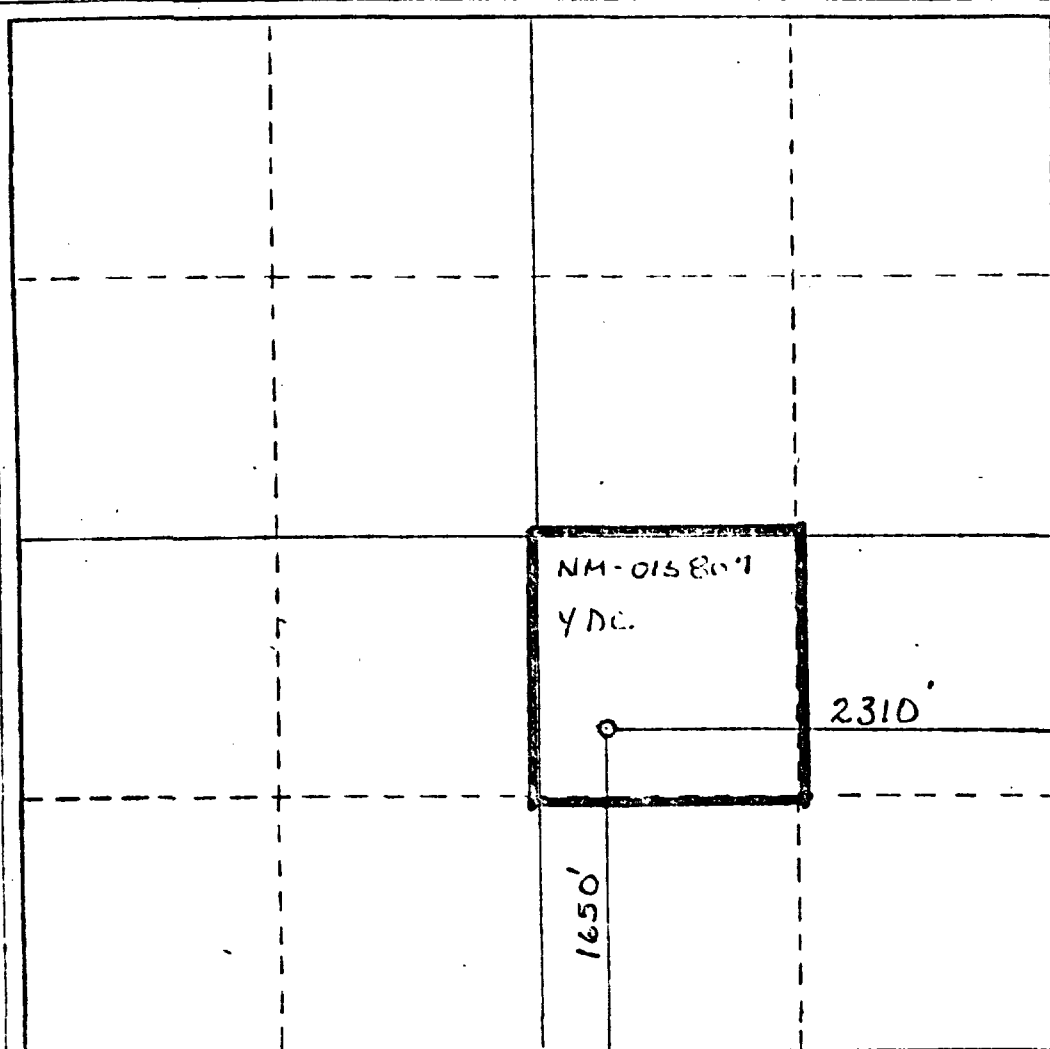

## CERTIFICATION

I hereby certify that the information contained herein is true and complete to the best of my knowledge and belief.

*Gliserio Rodriguez*  
Name

Gliserio Rodriguez

Position

Regulatory Agent

Company

Yates Drilling Company

Date

10/26/84

I hereby certify that the well location shown on this plat was plotted from field notes of actual surveys made by me or under my supervision, and that the same is true and correct to the best of my knowledge and belief.

10/25/84

Date Surveyed

Registered Professional Engineer and/or Land Surveyor

*Gliserio Rodriguez*  
Certificate No. \_\_\_\_\_  
STATE OF NEW MEXICO  
HERSCHEL JONES  
REGISTERED PROFESSIONAL ENGINEER AND LAND SURVEYOR



**NEW MEXICO OIL CONSERVATION COMMISSION  
WELL LOCATION AND ACREAGE DEDICATION PLAT**

Form C-102  
Supersedes C-128  
Effective 1-1-65

All distances must be from the outer boundaries of the Section.

Operator <b>YATES DRILLING COMPANY</b>			Lease <b>Garner Federal</b>		Well No. <b>7</b>
Unit Letter <b>0</b>	Section <b>27</b>	Township <b>12 South</b>	Range <b>31 East</b>	County <b>Chaves</b>	
Actual Footage Location of Well: <b>660</b> feet from the <b>South</b> line and <b>1980</b> feet from the <b>East</b> line					
Ground Level Elev. <b>4432.6</b>	Producing Formation <b>Queen</b>	Pool <b>SE CHAVES QUEEN GAS AREA ASSOC.</b>		Dedicated Acreage: <b>40</b> Acres	

1. Outline the acreage dedicated to the subject well by colored pencil or hatchure marks on the plat below.
2. If more than one lease is dedicated to the well, outline each and identify the ownership thereof (both as to working interest and royalty).
3. If more than one lease of different ownership is dedicated to the well, have the interests of all owners been consolidated by communitization, unitization, force-pooling, etc?

☐ Yes    ☐ No    If answer is "yes," type of consolidation \_\_\_\_\_

If answer is "no," list the owners and tract descriptions which have actually been consolidated. (Use reverse side of this form if necessary.) \_\_\_\_\_

No allowable will be assigned to the well until all interests have been consolidated (by communitization, unitization, forced-pooling, or otherwise) or until a non-standard unit, eliminating such interests, has been approved by the Commission.

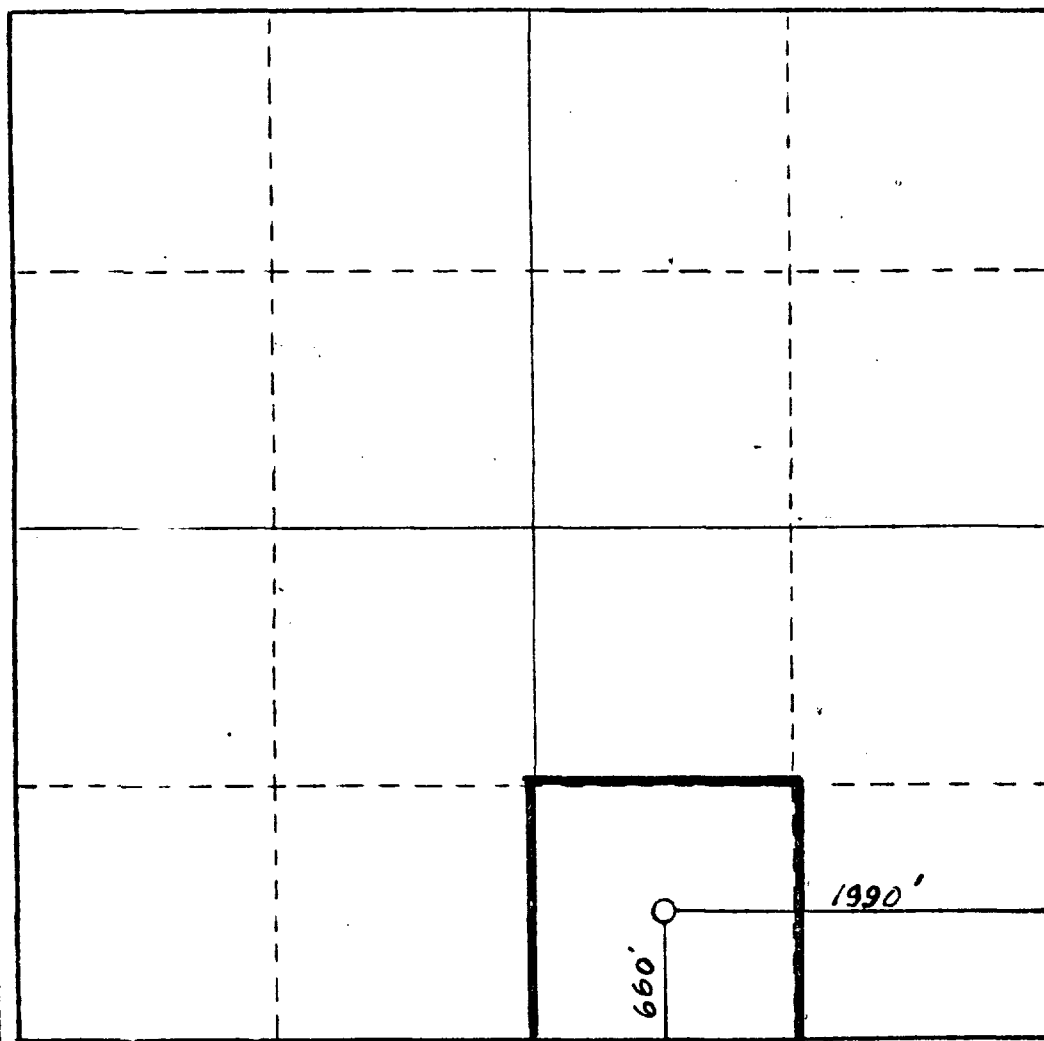

**CERTIFICATION**

I hereby certify that the information contained herein is true and complete to the best of my knowledge and belief.

*Gliserio Rodriguez*

Name

**Gliserio Rodriguez**

Position

**Regulatory Agent**

Company

**Yates Petroleum Corporation**

Date

**10-9-84**

I hereby certify that the well location shown on this plat was plotted from field notes of actual surveys made by me or under my supervision, and that the same is true and correct to the best of my knowledge and belief.

**10-8-84**

Date Surveyed

Registered Professional Engineer and/or Land Surveyor

**HERSCHEL JONES**

Certified

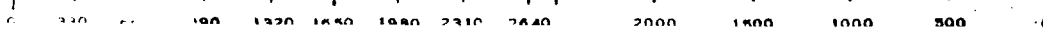
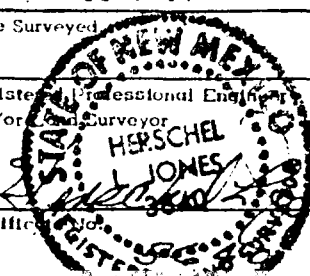

**NEW MEXICO OIL CONSERVATION COMMISSION**  
**WELL LOCATION AND ACREAGE DEDICATION PLAT**

Form C-102  
 Supersedes C-128  
 Effective 1-1-65

All distances must be from the outer boundaries of the Section.

Operator <b>Yates Drilling Company</b>			Lease <b>Gallagher State</b>		Well No. <b>1</b>
Unit Letter <b>D</b>	Section <b>35</b>	Township <b>12 South</b>	Range <b>31 East</b>	County <b>Chaves</b>	
Actual Footage Location of Well:					
<b>330</b> feet from the <b>North</b> line and		<b>330</b> feet from the <b>West</b> line			
Ground Level Elev. <b>4435.5 GL</b>	Producing Formation <b>Queen</b>	Pool <b>SE Chaves Queen</b>	Dedicated Acreage: <b>40</b> Acres		

1. Outline the acreage dedicated to the subject well by colored pencil or hatchure marks on the plat below.
2. If more than one lease is dedicated to the well, outline each and identify the ownership thereof (both as to working interest and royalty).
3. If more than one lease of different ownership is dedicated to the well, have the interests of all owners been consolidated by communitization, unitization, force-pooling, etc?

☐ Yes    ☐ No    If answer is "yes," type of consolidation \_\_\_\_\_

If answer is "no," list the owners and tract descriptions which have actually been consolidated. (Use reverse side of this form if necessary.) \_\_\_\_\_

No allowable will be assigned to the well until all interests have been consolidated (by communitization, unitization, forced-pooling, or otherwise) or until a non-standard unit, eliminating such interests, has been approved by the Commission.

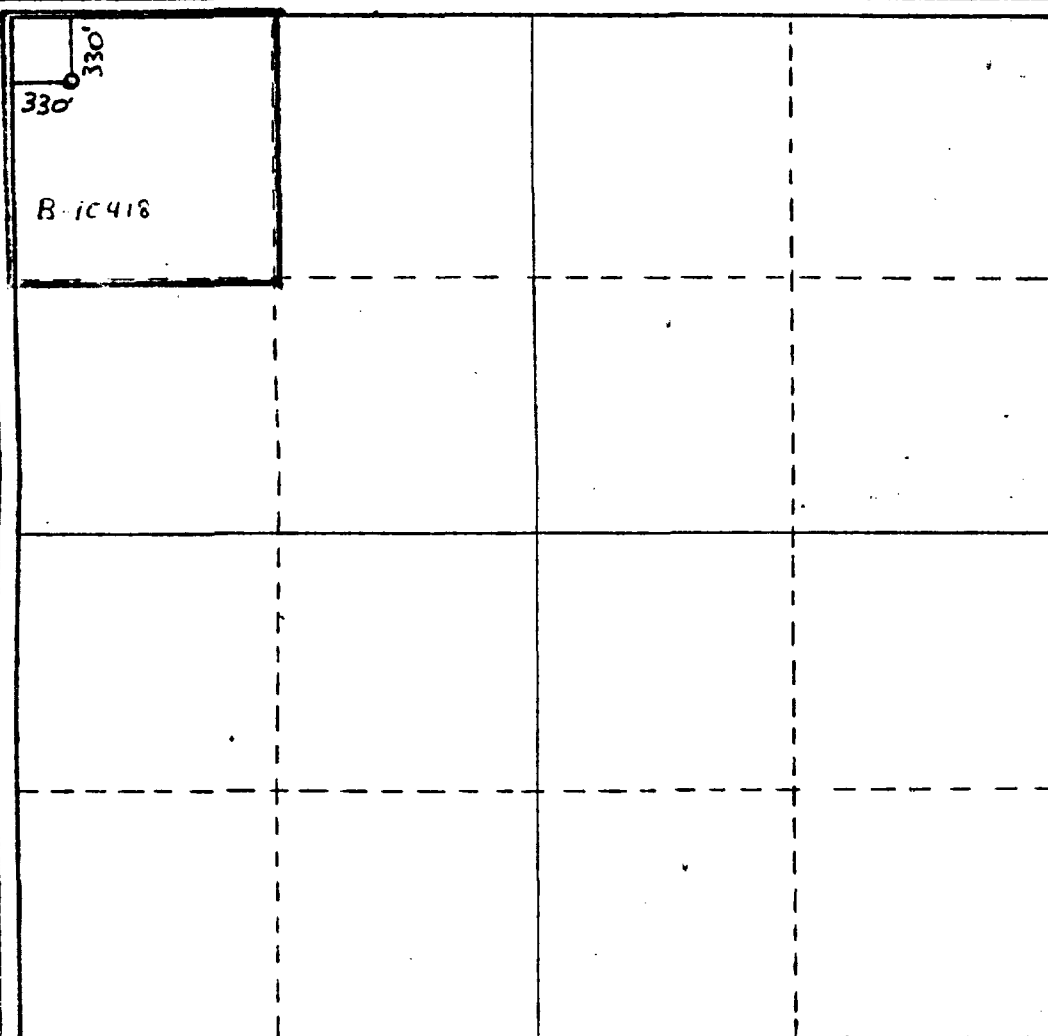

**CERTIFICATION**

I hereby certify that the information contained herein is true and complete to the best of my knowledge and belief.

*Gliserio Rodriguez*  
 Name

**Gliserio Rodriguez**  
 Position  
**Regulatory Agent**

Company  
**Yates Drilling Company**

Date  
**10/24/84**

I hereby certify that the well location shown on this plat was plotted from field notes of actual surveys made by me or under my supervision, and that the same is true and correct to the best of my knowledge and belief.

**10/23/84**

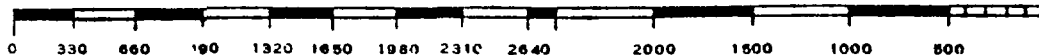
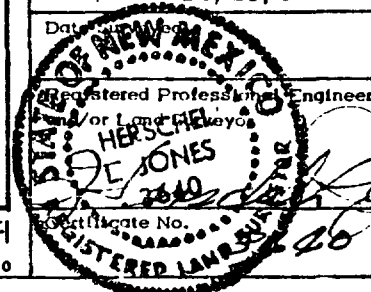

**MEXICO OIL CONSERVATION COMMISSION**  
**WELL LOCATION AND ACREAGE DEDICATION PLAT**

Form C-102  
 Supersedes C-12H  
 Effective 1-4-65

All distances must be from the outer boundaries of the Section.

Operator <b>YATES DRILLING COMPANY</b>			Lease <b>DeLuna Federal</b>		Well No. <b>#3</b>
Unit Letter <b>B</b>	Section <b>34</b>	Township <b>12S</b>	Range <b>31E</b>	County <b>Chaves</b>	
Actual Footage Location of Well: <b>330'</b> feet from the <b>North</b> line and <b>1980'</b> feet from the <b>East</b> line					
Ground Level Elev. <b>4433.4' GL</b>	Producing Formation <i>Green</i>		Dedicated Acreage: <i>Indio Caprock Queen</i>		Acres <b>4.0</b>

1. Outline the acreage dedicated to the subject well by colored pencil or hatchure marks on the plat below.
2. If more than one lease is dedicated to the well, outline each and identify the ownership thereof (both as to working interest and royalty).
3. If more than one lease of different ownership is dedicated to the well, have the interests of all owners been consolidated by communitization, unitization, force-pooling, etc?

☐ Yes ☐ No If answer is "yes," type of consolidation \_\_\_\_\_

If answer is "no," list the owners and tract descriptions which have actually been consolidated. (Use reverse side of this form if necessary.) \_\_\_\_\_

No allowable will be assigned to the well until all interests have been consolidated (by communitization, unitization, force-pooling, or otherwise) or until a non-standard unit, eliminating such interests, has been approved by the Commission.

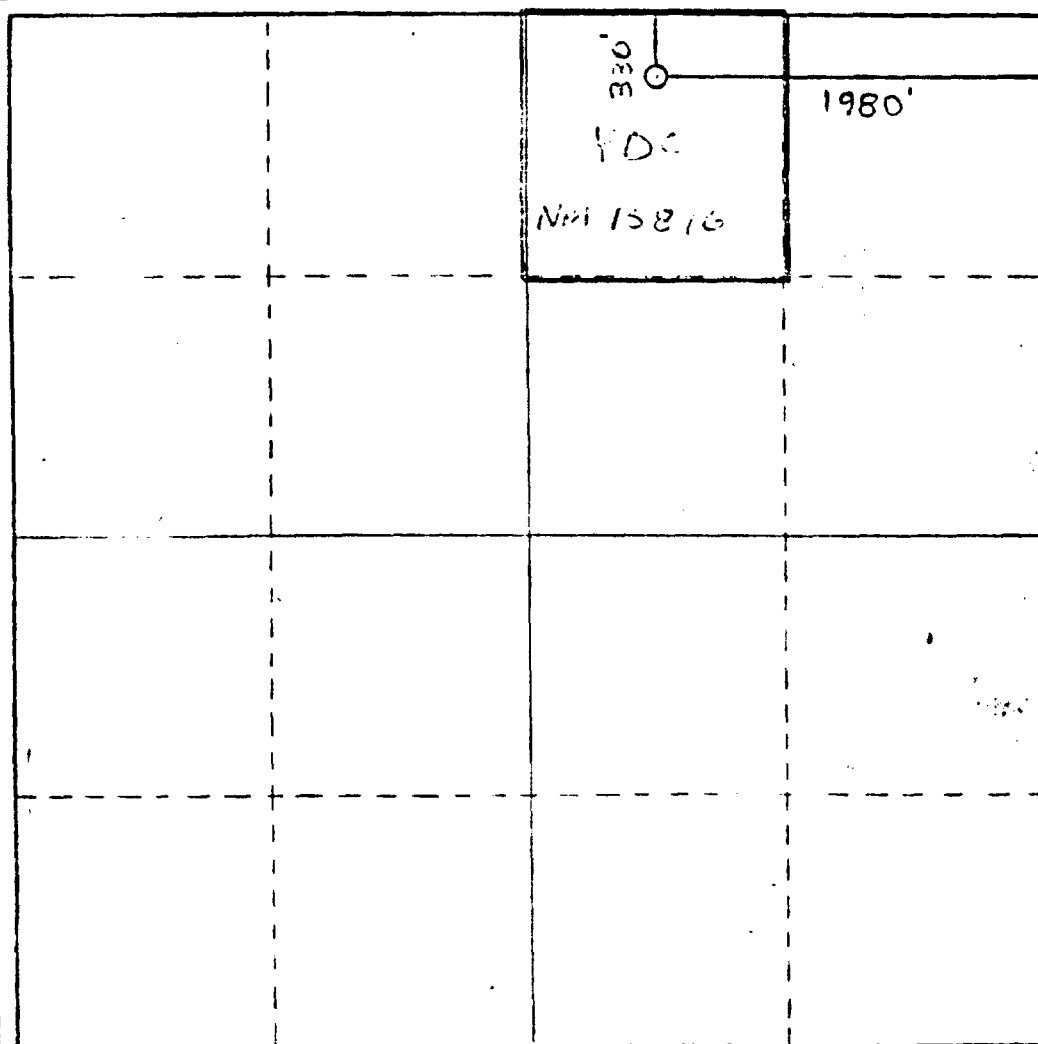

**CERTIFICATION**

I hereby certify that the information contained herein is true and complete to the best of my knowledge and belief.

*Gliserio Rodriguez*  
 Name

**Gliserio Rodriguez**  
 Position

**Regulatory Agent**  
 Company

**YATES DRILLING COMPANY**  
 Date

**1/31/85**

I hereby certify that the well location shown on this plat was plotted from field notes of actual surveys made by me or under my supervision, and that the same is true and correct to the best of my knowledge and belief.

Date Surveyed  
**January 22, 1985**

Registered Professional Engineer  
 and/or Land Surveyor

*[Signature]*  
 Certificate No.

**3640**

0 100 200 300 400 500 600 700 800 900 1000 1500 2000 2500 3000 3500 4000 4500 5000 5500 6000 6500 7000 7500 8000 8500 9000 9500 10000

**NEW MEXICO OIL CONSERVATION COMMISSION  
WELL LOCATION AND ACREAGE DEDICATION PLAT**

Form C-102  
Supersedes C-128  
Effective 1-1-65

All distances must be from the outer boundaries of the Section.

Operator <b>Yates Drilling Company</b>			Lease <b>Rich Federal</b>		Well No. <b>1</b>
Unit Letter <b>G</b>	Section <b>27</b>	Township <b>12</b>	Range <b>31</b>	County <b>Chaves</b>	
Actual Footage Location of Well: <div style="display: flex; justify-content: space-between;"> <span>2310 feet from the North line and</span> <span>2310 feet from the East line</span> </div>					
Ground Level Elev. <b>4485.6'</b>	Producing Formation <b>Queen</b>	Pool <b>SE CHAVES QUEEN GAS AREA ASSOC.</b>		Dedicated Acreage: <b>40</b> Acres	

1. Outline the acreage dedicated to the subject well by colored pencil or hachure marks on the plat below.
2. If more than one lease is dedicated to the well, outline each and identify the ownership thereof (both as to working interest and royalty).
3. If more than one lease of different ownership is dedicated to the well, have the interests of all owners been consolidated by communitization, unitization, force-pooling, etc?

☐ Yes    ☒ No    If answer is "yes," type of consolidation \_\_\_\_\_

If answer is "no," list the owners and tract descriptions which have actually been consolidated. (Use reverse side of this form if necessary.) \_\_\_\_\_

No allowable will be assigned to the well until all interests have been consolidated (by communitization, unitization, forced-pooling, or otherwise) or until a non-standard unit, eliminating such interests, has been approved by the Commission.

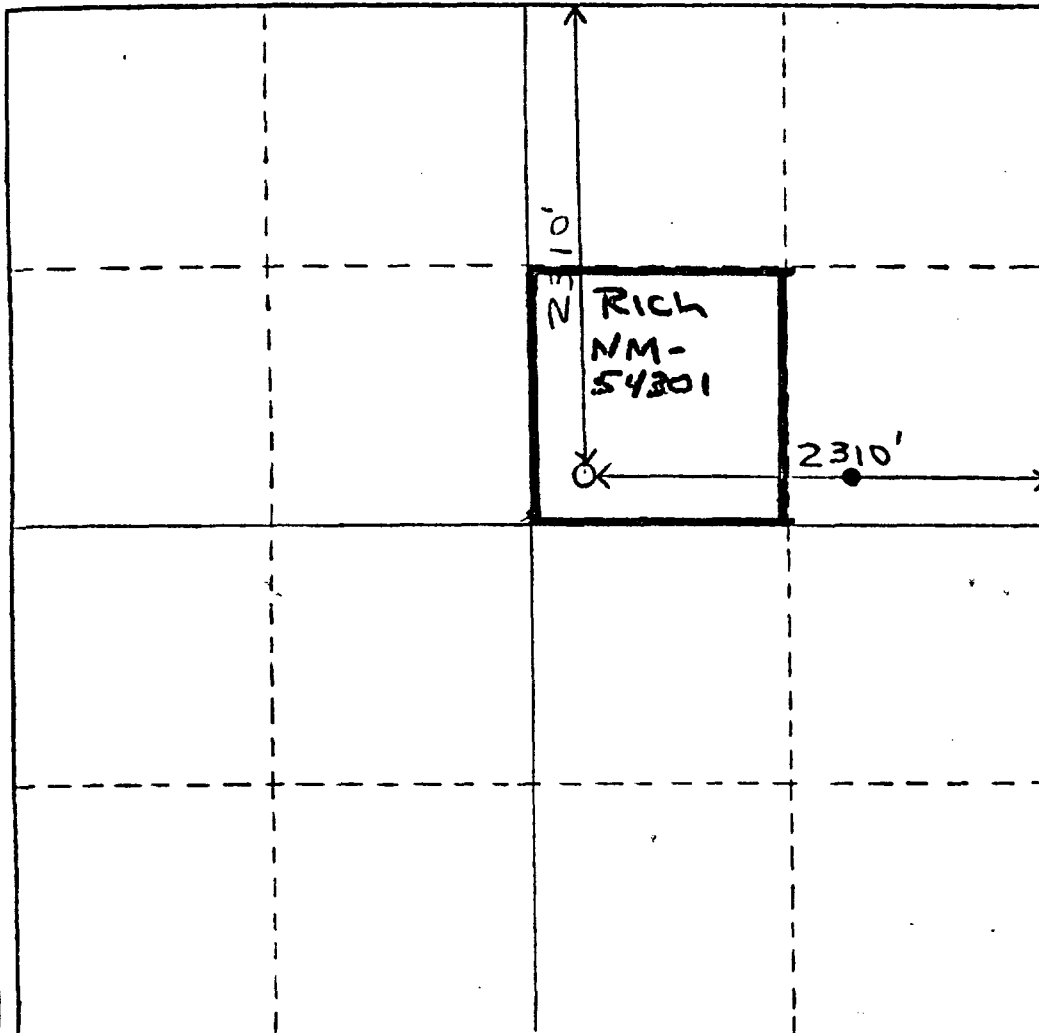

**CERTIFICATION**

I hereby certify that the information contained herein is true and complete to the best of my knowledge and belief.

*Cy Cowan*

Name  
**CY COWAN**

Position  
**Regulatory Agent**

Company  
**Yates Drilling Co.**

Date  
**11-26-84**

I hereby certify that the well location shown on this plat was plotted from field notes of actual surveys made by me or under my supervision, and that the same is true and correct to the best of my knowledge and belief.

Date  
**11-22-84**

Registered Professional Engineer  
and Land Surveyor  
**3640**

