



W. J. Holcomb
District Manager

February 8, 1985

Mr. Gilbert Quintana
New Mexico Oil Conservation Division
P. O. Box 2088
Santa Fe, NM 87501

File: DDL-183-400.1

Application for Unorthodox Location
Gallegos Canyon Unit No. 137E
Basin Dakota and Cha Cha Gallup Ext. Fields
San Juan County, New Mexico

Amoco Production Company hereby requests approval of an unorthodox well location for the Gallegos Canyon Unit No. 137E. The proposed location is 1110' FSL x 940' FWL of Section 36, T28N, R13W, San Juan County, New Mexico.

This well was staked in the location indicated above in order to place the well in an orthodox window for the Basin Dakota Formation. After the permit to drill was approved, it was decided to dual complete the well in the Cha Cha Gallup Formation as well.

There are no offset lease holders of Cha Cha Gallup Extension wells as indicated on the attached nine-section plat.

Sincerely,

KRJ/ct

Attachments

cc: Mr. Ernie Bush
New Mexico Oil Conservation Division
1000 Rio Brazos Road
Aztec, NM 87410

Amoco Production Company

Petroleum Center Building
501 Airport Drive
Farmington, New Mexico 87401
505-325-8841

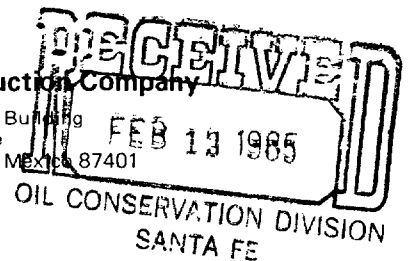

Case 8541

AM18

Case 8541

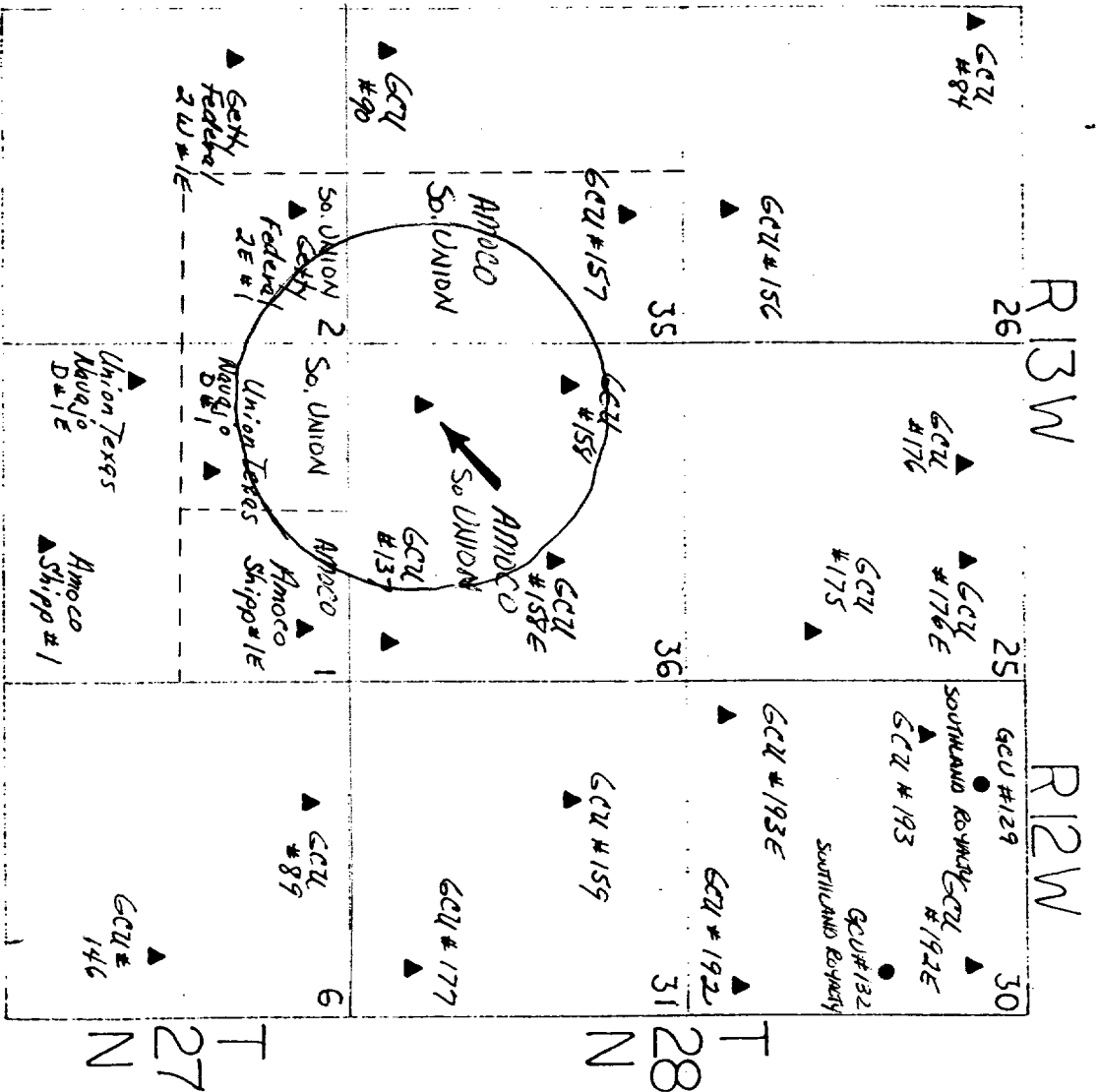

▲ BASIN DAKOTA WELLS
● CHA CHA GALLUP WELLS

OIL CONSERVATION DIVISION

STATE OF NEW MEXICO

P. O. BOX 2044

Form C-107
Revised 10-1-78

ENERGY AND MINERALS DEPARTMENT

SANTA FE, NEW MEXICO 87501

All distances must be from the outer boundaries of the Section.

Operator AMOCO PRODUCTION COMPANY			Lease GALLEGOS CANYON UNIT		Well No. 137E
Unit Letter M	Section 36	Township 28N	Range 13W	County San Juan	
Actual Footage Location of Well: 1110 feet from the South line and 940 feet from the West line					
Ground Level Elev. 5843	Producing Formation Dakota & Gallup		Pool Basin Dakota / Cha Cha Gallup Ext.		Dedicated Acreage: 320/80 Acres

1. Outline the acreage dedicated to the subject well by colored pencil or hatchure marks on the plat below.
2. If more than one lease is dedicated to the well, outline each and identify the ownership thereof (both as to working interest and royalty).
3. If more than one lease of different ownership is dedicated to the well, have the interests of all owners been consolidated by communitization, unitization, force-pooling, etc?

☒ Yes ☐ No If answer is "yes," type of consolidation Unitized

If answer is "no," list the owners and tract descriptions which have actually been consolidated. (Use reverse side of this form if necessary.)

No allowable will be assigned to the well until all interests have been consolidated (by communitization, unitization, forced-pooling, or otherwise) or until a non-standard unit, eliminating such interests, has been approved by the Commission.

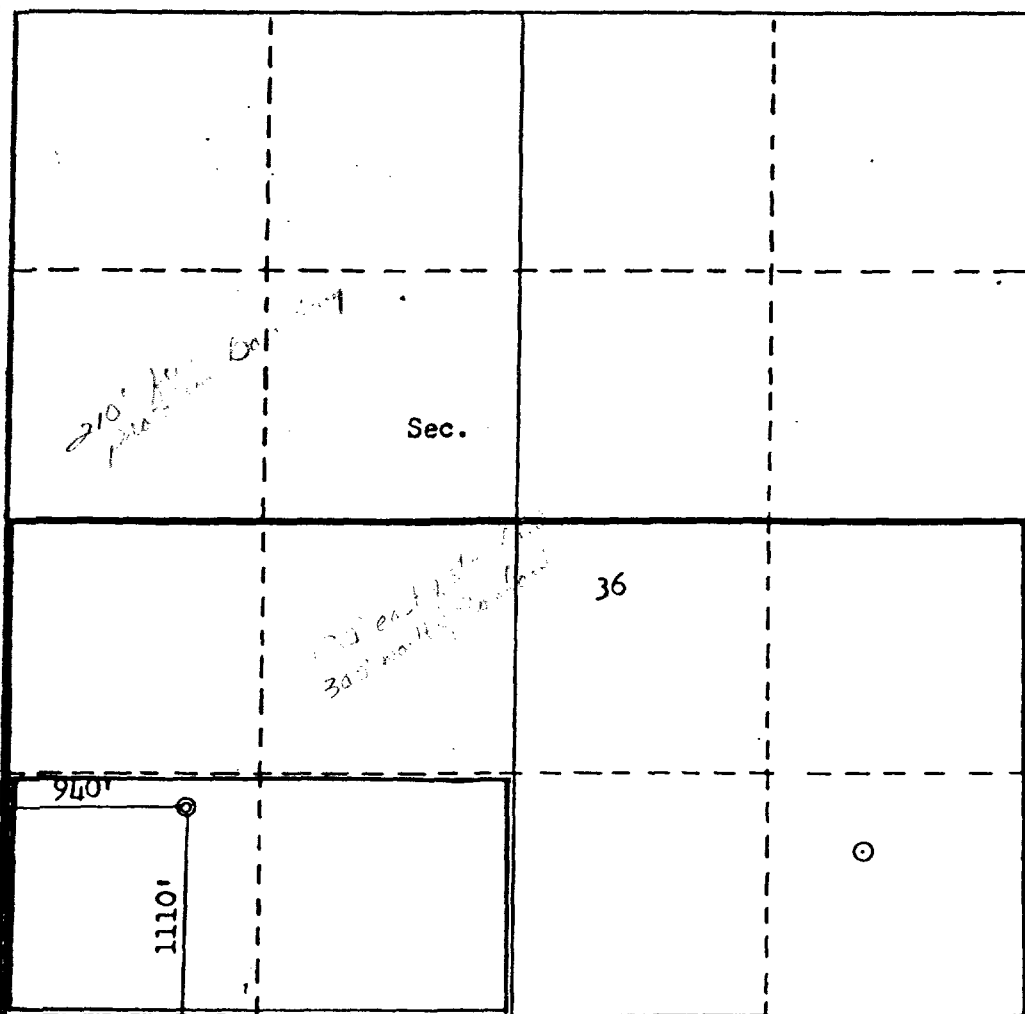

CERTIFICATION

I hereby certify that the information contained herein is true and complete to the best of my knowledge and belief.

Original Signed By

Name
B. D. Shaw

Position
Administrative Supervisor

Company
Amoco Production Company

Date
May 31, 1984

I hereby certify that the well location shown on this plat was plotted from field notes of actual surveys made by me or under my supervision, and that the same is true and correct to the best of my knowledge and belief.

Date Surveyed

December 10, 1984

Registered Professional Engineer
and/or Land Surveyor

Fred B. Kerr Jr.

Certificate No.

3950

8. KERR, J.



STATE OF NEW MEXICO
ENERGY AND MINERALS DEPARTMENT
OIL CONSERVATION DIVISION
AZTEC DISTRICT OFFICE

1000 RIO BRAZOS ROAD
AZTEC, NEW MEXICO 87410
(505) 334-6178

OIL CONSERVATION DIVISION
BOX 2088
SANTA FE, NEW MEXICO 87501

DATE 3-1-85

RE: Proposed MC _____
Proposed DHC _____
Proposed NSL X _____
Proposed SWD _____
Proposed WFX _____
Proposed PMX _____

Gentlemen:

I have examined the application dated 2-12-85
for the Amoco G.C.U. #137E M-36-28N-130
Operator Lease and Well No. Unit, S-T-R

and my recommendations are as follows:

Docket for hearing

Yours truly,

Jim Burt