

NEW MEXICO OIL CONSERVATION COMMISSION
WELL LOCATION AND ACREAGE DEDICATION PLAT

Form C-112
Supersedes C-128
Effective 1-1-85

All distances must be from the outer boundaries of the Section

Operator Nearburg Producing Co.		Lease Anderson 15		Acres 1	
Section Letter H	Section 15	Township 20 South	Range 25 East	County Eddy	
Actual Portage Location of Well: 1755 feet from the North line and 660 feet from the East line					
Ground Level Elev 3430.9	Producing Formation Morrow	Pool Cemetery Morrow	Dedicated Acreage 320.00		

1. Outline the acreage dedicated to the subject well by colored pencil or hatchure marks on the plat below.
2. If more than one lease is dedicated to the well, outline each and identify the ownership thereof (both as to working interest and royalty).
3. If more than one lease of different ownership is dedicated to the well, have the interests of all owners been consolidated by communitization, unitization, force-pooling, etc?

☒ Yes ☐ No If answer is "yes" type of consolidation Pooling

If answer is "no," list the owners and tract descriptions which have actually been consolidated (Use reverse side of this form if necessary.) _____

No allowable will be assigned to the well until all interests have been consolidated (by communitization, unitization, forced-pooling, or otherwise) or until a non-standard unit, eliminating such interests, has been approved by the Commission.

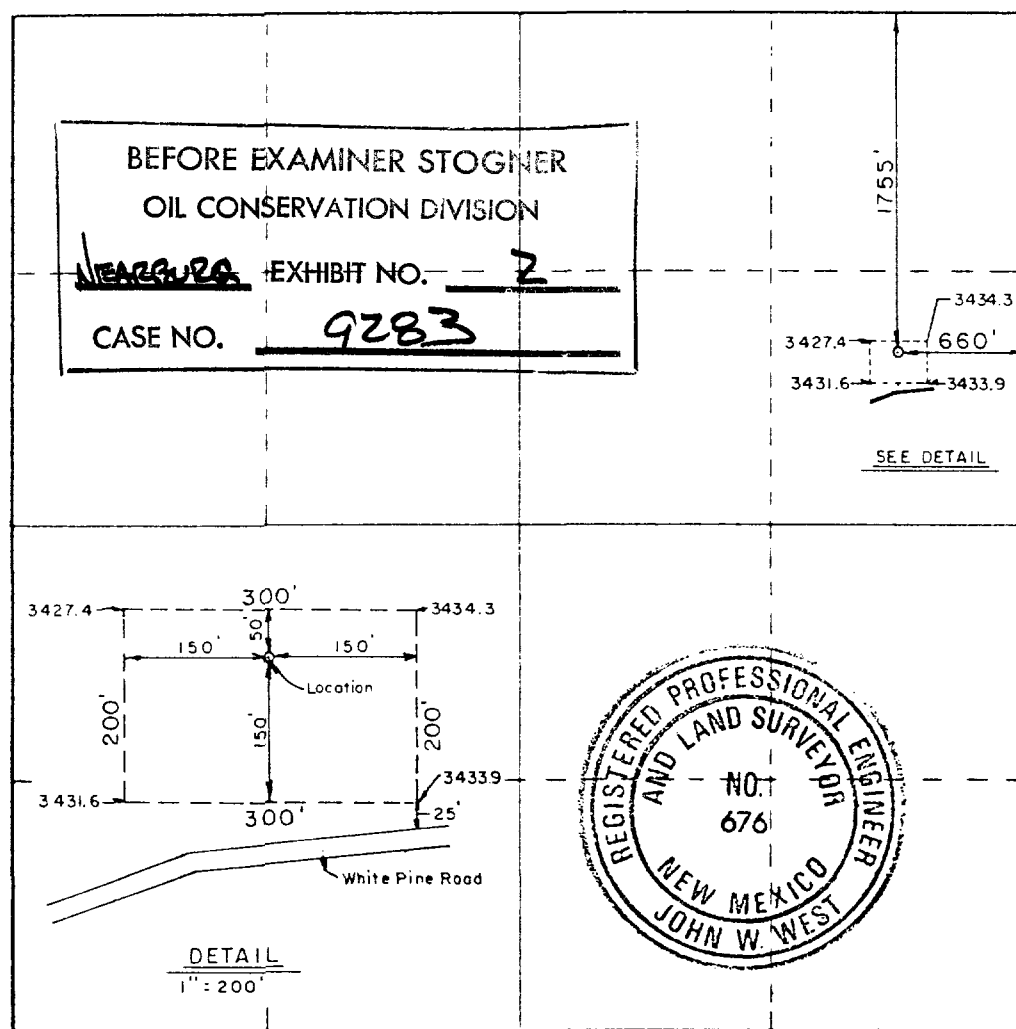

CERTIFICATION

I hereby certify that the information contained herein is true and complete to the best of my knowledge and belief.

Mark K. Nearburg
Name

Mark K. Nearburg

Vice President
Position

Nearburg Producing Co.
Company

December 16, 1987
Date

I hereby certify that the well location shown on this plat was plotted from field notes of actual surveys made by me or under my supervision, and that the same is true and correct to the best of my knowledge and belief.

December 9, 1987
Date Surveyed

Registered Professional Engineer and/or Land Surveyor

John W. West

Certificate No. JOHN W. WEST, 676
RONALD J. EIDSON, 3239

Nearburg Producing Company

Exploration and Production
P.O. Box 31405
5447 Glen Lakes Drive
Dallas, Texas 75231-0405
214-739-1778

December 11, 1987

Tierra Oil Company
P. O. Box 1354
Roswell, NM 88201

Re: Unorthodox Location
Anderson 15 Well #1
1755'FNL and 660'FEL
Section 15-20S-25E
Eddy County, New Mexico

Gentlemen:

Nearburg Producing Company has applied to the New Mexico Oil Conservation Commission for the captioned non-standard well location to be drilled on an E/2 proration unit. The non-standard location is necessitated by County Road #28, which prevents the drilling of a well at a standard location 1980'FNL and 660'FEL. As an offset lease owner or mineral owner, you have the right to appear before the Commission in opposition to this location, however, due to the location being unorthodox for topographic reasons, Nearburg hereby requests your waiver of opposition to the unorthodox location, which will enable administrative approval.

If you agree to waive opposition to this location, please so indicate by signing and dating where provided below, returning one copy of this letter to my attention. The other copy is for your files. Due to the upcoming holidays, it will be appreciated if your waiver can be returned prior to the Christmas holidays.

Please call me if you have any questions.

Yours truly,

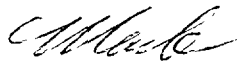

Mark K. Nearburg
Vice President-Land Manager

MKN:nf

BEFORE EXAMINER STOGNER	
OIL CONSERVATION DIVISION	
NEARBURG	EXHIBIT NO. <u>3</u>
CASE NO.	<u>9283</u>

The undersigned as of this 18th day of December, 1987, hereby waives opposition to the unorthodox well location captioned above.

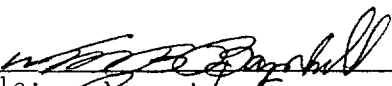
TIERRA OIL COMPANY

By: 
Title: President

Nearburg Producing Company

Exploration and Production
P.O. Box 31405
5447 Glen Lakes Drive
Dallas, Texas 75231-0405
214-739-1778

CERTIFIED LETTER
RETURN RECEIPT REQUESTED

December 11, 1987

J. M. Huber Corporation
2000 West Loop South
Houston, TX 77027

Attn: Mr. Paul Loyd or Ms. Barbara E. Riggan

Re: Unorthodox Location
Anderson 15 Well #1
1755'FNL and 660'FEL
Section 15-20S-25E
Eddy County, New Mexico

Gentlemen:

Nearburg Producing Company has applied to the New Mexico Oil Conservation Commission for the captioned non-standard well location to be drilled on an E/2 proration unit. The non-standard location is necessitated by County Road #28, which prevents the drilling of a well at a standard location 1980'FNL and 660'FEL. As an offset lease owner or mineral owner, you have the right to appear before the Commission in opposition to this location, however, due to the location being unorthodox for topographic reasons, Nearburg hereby requests your waiver of opposition to the unorthodox location, which will enable administrative approval.

If you agree to waive opposition to this location, please so indicate by signing and dating where provided below, returning one copy of this letter to my attention. The other copy is for your files. Due to the upcoming holidays, it will be appreciated if your waiver can be returned prior to the Christmas holidays.

Please call me if you have any questions.

Yours truly,

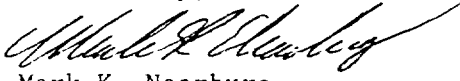
Mark K. Nearburg
Vice President-Land Manager

MKN:nf

The undersigned as of this 16th day of December, 1987, hereby waives opposition to the unorthodox well location captioned above.

J. M. HUBER CORPORATION

By:  Robert R. Glenn
Title: District Production Manager

NEW MEXICO OIL CONSERVATION DIVISION

IN THE MATTER OF THE APPLICATION OF
NEARBURG PRODUCING COMPANY FOR COMPULSORY
POOLING AND UNORTHODOX WELL LOCATION,
EDDY COUNTY, NEW MEXICO.

CASE NO. 9283

AFFIDAVIT

STATE OF NEW MEXICO)) ss.
COUNTY OF SANTA FE)

MARTE D. LIGHTSTONE, attorney in fact and authorized representative of Nearburg Producing Company, the Applicant herein, being first duly sworn, upon oath, states that the notice provisions of Rule 1207 of the New Mexico Oil Conservation Division have been complied with, that Applicant has caused to be conducted a good faith diligent effort to find the correct addresses of all interested persons entitled to receive notice for the unorthodox well location as shown by Exhibit "A" attached hereto, and that pursuant to Rule 1207, notice has been given at the correct addresses provided by such rule.

BEFORE EXAMINER STOGNER
OIL CONSERVATION DIVISION
NEARSBURG EXHIBIT NO. 4
CASE NO. 9283

MARTE D. LIGHTSTONE

SUBSCRIBED AND SWORN to before me this 5th day of
January, 1988.

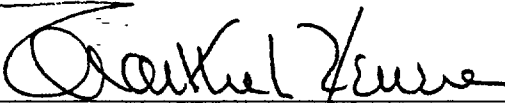
Notary Public

My Commission Expires:

August 19, 1991

EXHIBIT A

Tierra Oil Company
Post Office Box 1354
Roswell, New Mexico 88201

Exxon Company, U.S.A.
Post Office Box 1600
Midland, Texas 79702

J. M. Huber Corporation
2000 West Loop South
Houston, Texas 77027
Attn: Mr. Paul Loyd or
Ms Barbara E. Riggan

J. M. Huber Corporation
7120 I-40 West, Suite 232
Amarillo, Texas 79106
Attn: Mr. Robert Glenn

CAMPBELL & BLACK, P.A.

LAWYERS

JACK M. CAMPBELL
BRUCE D. BLACK
MICHAEL B. CAMPBELL
WILLIAM F. CARR
BRADFORD C. BERGE
J. SCOTT HALL
PETER N. IVES
JOHN H. BEMIS
MARTE D. LIGHTSTONE

GUADALUPE PLACE
SUITE 1 - 110 NORTH GUADALUPE
POST OFFICE BOX 2208
SANTA FE, NEW MEXICO 87504-2208
TELEPHONE: (505) 988-4421
TELECOPIER: (505) 983-6043

December 16, 1987

CERTIFIED MAIL
RETURN RECEIPT REQUESTED

Tierra Oil Company
Post Office Box 1354
Roswell, New Mexico 88201

Re: Application of Nearburg Producing Company for
Compulsory Pooling and Unorthodox Well Location,
Eddy County, New Mexico

Dear Sirs:

This letter is to advise you that Nearburg Producing Company has filed an application with the New Mexico Oil Conservation Division seeking the force pooling of all mineral interests from the surface of the base of the Mississippi Formation in and under the E/2 of Section 15, Township 20 South, Range 25 East, N.M.P.M., Eddy County, New Mexico. Nearburg Producing Company proposes to dedicate the referenced pooled unit to its Anderson 15 Well #1 located at an unorthodox location 1755 feet from the North line and 660 feet from the East line of said Section 15, and has also filed for approval of the unorthodox location with the New Mexico Oil Conservation Division.

This application has been set for hearing before a Division Examiner on January 6, 1988. You are not required to attend this hearing, but as an owner who has an interest that may be subject to pooling or an unorthodox well location, you may appear and present testimony. Failure to appear at that time and become a party of record will preclude you from challenging the matter at a later date.

Very truly yours,

Marte Lightstone

MARTE LIGHTSTONE
ATTORNEY FOR NEARBURG PRODUCING COMPANY

MDE:mlh

SENDER: Complete items 1 and 2 when additional services are desired, and complete items 3 and 4.

Put your address in the "RETURN TO" space on the reverse side. Failure to do this will prevent this card from being returned to you. The return receipt fee will provide you the name of the person delivered to and the date of delivery. For additional fees the following services are available. Consult postmaster for fees and check box(es) for additional service(s) requested.

1. ☒ Show to whom delivered, date, and addressee's address. 2. ☐ Restricted Delivery.

3. Article Addressed to:

Tierra Oil Company
Post Office Box 1354
Roswell, New Mexico 88201

4. Article Number

P 573 873 694

Type of Service:

☐ Registered
☒ Certified
☐ Insured
☐ COD
☐ Express Mail

Always obtain signature of addressee or agent and DATE DELIVERED.

8. Addressee's Address (ONLY if requested and fee paid)

POB 1354

5. Signature - Addressee

X

6. Signature - Agent

X

7. Date of Delivery

12/19/87

PS Form 3811, Feb. 1986

DOMESTIC RETURN RECEIPT

P-573 873 694

Tierra Oil Company
P. O. Box 1354
Roswell, NM 88201

1.22
1.75

1.70
1.67

12-16-87

CAMPBELL & BLACK, P.A.
LAWYERS

JACK M. CAMPBELL
BRUCE D. BLACK
MICHAEL B. CAMPBELL
WILLIAM F. CARR
BRADFORD C. BERGE
J. SCOTT HALL
PETER N. IVES
JOHN H. BEMIS
MARTE D. LIGHTSTONE

GUADALUPE PLACE
SUITE 1 - 110 NORTH GUADALUPE
POST OFFICE BOX 2208
SANTA FE, NEW MEXICO 87504-2208
TELEPHONE: (505) 988-4421
TELECOPIER: (505) 983-6043

December 16, 1987

CERTIFIED MAIL
RETURN RECEIPT REQUESTED

Exxon Company, U.S.A.
Post Office Box 1600
Midland, Texas 79702

Attn: Ms Martha Radke

Re: Application of Nearburg Producing Company for
Compulsory Pooling and Unorthodox Well Location,
Eddy County, New Mexico

Dear Sirs:

This letter is to advise you that Nearburg Producing Company has filed an application with the New Mexico Oil Conservation Division seeking the force pooling of all mineral interests from the surface of the base of the Mississippi Formation in and under the E/2 of Section 15, Township 20 South, Range 25 East, N.M.P.M., Eddy County, New Mexico. Nearburg Producing Company proposes to dedicate the referenced pooled unit to its Anderson 15 Well #1 located at an unorthodox location 1755 feet from the North line and 660 feet from the East line of said Section 15, and has also filed for approval of the unorthodox location with the New Mexico Oil Conservation Division.

This application has been set for hearing before a Division Examiner on January 6, 1988. You are not required to attend this hearing, but as an owner who has an interest that may be subject to pooling or an unorthodox well location, you may appear and present testimony. Failure to appear at that time and become a party of record will preclude you from challenging the matter at a later date.

Very truly yours,

Martha Lightstone

MARTE LIGHTSTONE
ATTORNEY FOR NEARBURG PRODUCING COMPANY

MDE:mlh

SENDER: Complete items 1 and 2 when additional services are desired, and complete items 3 and 4. Put your address in the "RETURN TO" space on the reverse side. Failure to do this will prevent this card from being returned to you. The return receipt fee will provide you the name of the person delivered to and the date of delivery. For additional fees the following services are available. Consult postmaster for fees and check boxes for additional service(s) requested.

1. <input checked="" type="checkbox"/> Show to whom delivered, date, and addressee's address.		2. <input type="checkbox"/> Restricted Delivery.	
3. Article Addressed to:		4. Article Number P 573 873 696	
Exxon Company, U.S.A. Post Office Box 1600 Midland, Texas 79702 Attn: Ms Martha Radke		Type of Service: <input checked="" type="checkbox"/> Registered <input type="checkbox"/> Certified <input type="checkbox"/> Express Mail <input type="checkbox"/> Insured <input type="checkbox"/> COD	
5. Signature - Addressee X		8. Addressee's Address (ONLY if requested and fee paid)	
6. Signature - Agent X <i>Martha Radke</i>		Always obtain signature of addressee or agent and DATE DELIVERED.	
7. Date of Delivery 12-21-87 <i>WTH</i>			

PS Form 3811, Feb. 1986

DOMESTIC RETURN RECEIPT

P-573 873 696

Attn: Ms Martha Radke
Exxon Co., U.S.A.
P. O. Box 1600
Midland, TX 79702

122
75

70
167

12-16-87

CAMPBELL & BLACK, P.A.

LAWYERS

JACK M. CAMPBELL
BRUCE D. BLACK
MICHAEL B. CAMPBELL
WILLIAM F. CARR
BRADFORD C. BERGE
J. SCOTT HALL
PETER N. IVES
JOHN H. BEMIS
MARTE D. LIGHTSTONE

GUADALUPE PLACE
SUITE 1 - 110 NORTH GUADALUPE
POST OFFICE BOX 2208
SANTA FE, NEW MEXICO 87504-2208
TELEPHONE: (505) 988-4421
TELECOPIER: (505) 983-6043

December 16, 1987

CERTIFIED MAIL
RETURN RECEIPT REQUESTED

J. M. Huber Corporation
2000 West Loop South
Houston, Texas 77027

Attn: Mr. Paul Loyd or
Ms Barbara E. Riggan

Re: Application of Nearburg Producing Company for
Compulsory Pooling and Unorthodox Well Location,
Eddy County, New Mexico

Dear Sirs:

This letter is to advise you that Nearburg Producing Company has filed an application with the New Mexico Oil Conservation Division seeking the force pooling of all mineral interests from the surface of the base of the Mississippi Formation in and under the E/2 of Section 15, Township 20 South, Range 25 East, N.M.P.M., Eddy County, New Mexico. Nearburg Producing Company proposes to dedicate the referenced pooled unit to its Anderson 15 Well #1 located at an unorthodox location 1755 feet from the North line and 660 feet from the East line of said Section 15, and has also filed for approval of the unorthodox location with the New Mexico Oil Conservation Division.

This application has been set for hearing before a Division Examiner on January 6, 1988. You are not required to attend this hearing, but as an owner who has an interest that may be subject to pooling or an unorthodox well location, you may appear and present testimony. Failure to appear at that time and become a party of record will preclude you from challenging the matter at a later date.

Very truly yours,

Marte Lightstone

MARTE LIGHTSTONE
ATTORNEY FOR NEARBURG PRODUCING COMPANY

MDE:mlh

● **SENDER:** Complete items 1 and 2 when additional services are desired, and complete items 3 and 4. Put your address in the "RETURN TO" space on the reverse side. Failure to do this will prevent this card from being returned to you. The return receipt fee will provide you the name of the person delivered to and the date of delivery. For additional fees the following services are available. Consult postmaster for fees and check box(es) for additional service(s) requested.

1. <input checked="" type="checkbox"/> Show to whom delivered, date, and addressee's address.		2. <input type="checkbox"/> Restricted Delivery.	
3. Article Addressed to: J. M. Huber Corporation 2000 West Loop South Houston, Texas 77027 Attn: Mr. Paul Loyd or Ms Barbara E. Riggan		4. Article Number P 573 873 695 Type of Service: <input checked="" type="checkbox"/> Registered <input type="checkbox"/> Certified <input type="checkbox"/> Express Mail <input type="checkbox"/> Insured <input type="checkbox"/> COD	
5. Signature - Addressee <input checked="" type="checkbox"/> <i>Paul Loyd</i>		Always obtain signature of addressee or agent and DATE DELIVERED.	
6. Signature - Agent <input checked="" type="checkbox"/>		8. Addressee's Address (ONLY if requested and fee paid) Same as above	
7. Date of Delivery 12-21-87			

PS Form 3811, Feb. 1986

DOMESTIC RETURN RECEIPT

P-573 873 695

Attn: Paul Loyd or
 J.M. Huber Corp.
 2000 W. Loop South
 Houston, TX 77027

Ms Barbara E. Riggan

22
75

70
1.67

12-16-87

CAMPBELL & BLACK, P.A.

LAWYERS

JACK M. CAMPBELL
BRUCE D. BLACK
MICHAEL B. CAMPBELL
WILLIAM F. CARR
BRADFORD C. BERGE
J. SCOTT HALL
PETER N. IVES
JOHN H. BEMIS
MARTE D. LIGHTSTONE

GUADALUPE PLACE
SUITE 1 - 110 NORTH GUADALUPE
POST OFFICE BOX 2208
SANTA FE, NEW MEXICO 87504-2208
TELEPHONE: (505) 988-4421
TELECOPIER: (505) 983-6043

December 16, 1987

CERTIFIED MAIL
RETURN RECEIPT REQUESTED

J. M. Huber Corporation
7120 I-40 West, Suite 232
Amarillo, Texas 79106

Attn: Mr. Robert Glenn

Re: Application of Nearburg Producing Company for
Compulsory Pooling and Unorthodox Well Location,
Eddy County, New Mexico

Dear Sirs:

This letter is to advise you that Nearburg Producing Company has filed an application with the New Mexico Oil Conservation Division seeking the force pooling of all mineral interests from the surface of the base of the Mississippi Formation in and under the E/2 of Section 15, Township 20 South, Range 25 East, N.M.P.M., Eddy County, New Mexico. Nearburg Producing Company proposes to dedicate the referenced pooled unit to its Anderson 15 Well #1 located at an unorthodox location 1755 feet from the North line and 660 feet from the East line of said Section 15, and has also filed for approval of the unorthodox location with the New Mexico Oil Conservation Division.

This application has been set for hearing before a Division Examiner on January 6, 1988. You are not required to attend this hearing, but as an owner who has an interest that may be subject to pooling or an unorthodox well location, you may appear and present testimony. Failure to appear at that time and become a party of record will preclude you from challenging the matter at a later date.

Very truly yours,

Marte Lightstone

MARTE LIGHTSTONE
ATTORNEY FOR NEARBURG PRODUCING COMPANY

MDE:mlh

SENDER: Complete items 1 and 2 when additional services are desired, and complete items 3 and 4. Put your address in the "RETURN TO" space on the reverse side. Failure to do this will prevent this card from being returned to you. The return receipt fee will provide you the name of the person delivered to and the date of delivery. For additional fees the following services are available. Consult postmaster for fees and check box(es) for additional service(s) requested.

1. ☒ Show to whom delivered, date, and addressee's address. 2. ☐ Restricted Delivery.

3. Article Addressed to: 4. Article Number P 573 873 697

J. M. Huber Corporation
7120 I-40 West, Suite 232
Amarillo, Texas 79106

Attn: Mr. Robert Glenn

5. Signature - Addressee
X

6. Signature Agent
X *[Signature]*

7. Date of Delivery
12-21-87

Type of Service:
☐ Registered ☐ Insured
☒ Certified ☐ COD
☐ Express Mail

Always obtain signature of addressee or agent and DATE DELIVERED.
8. Addressee's Address (ONLY if requested and fee paid)

PS Form 3811, Feb. 1986

DOMESTIC RETURN RECEIPT

P-573 873 697

Attn: Mr. Robert Glen
J.M. Huber Corp.
7120 I-40 W., Suite 232
Amarillo, TX 79106

22
75

70
1.67

12-16-87