

R 26 E

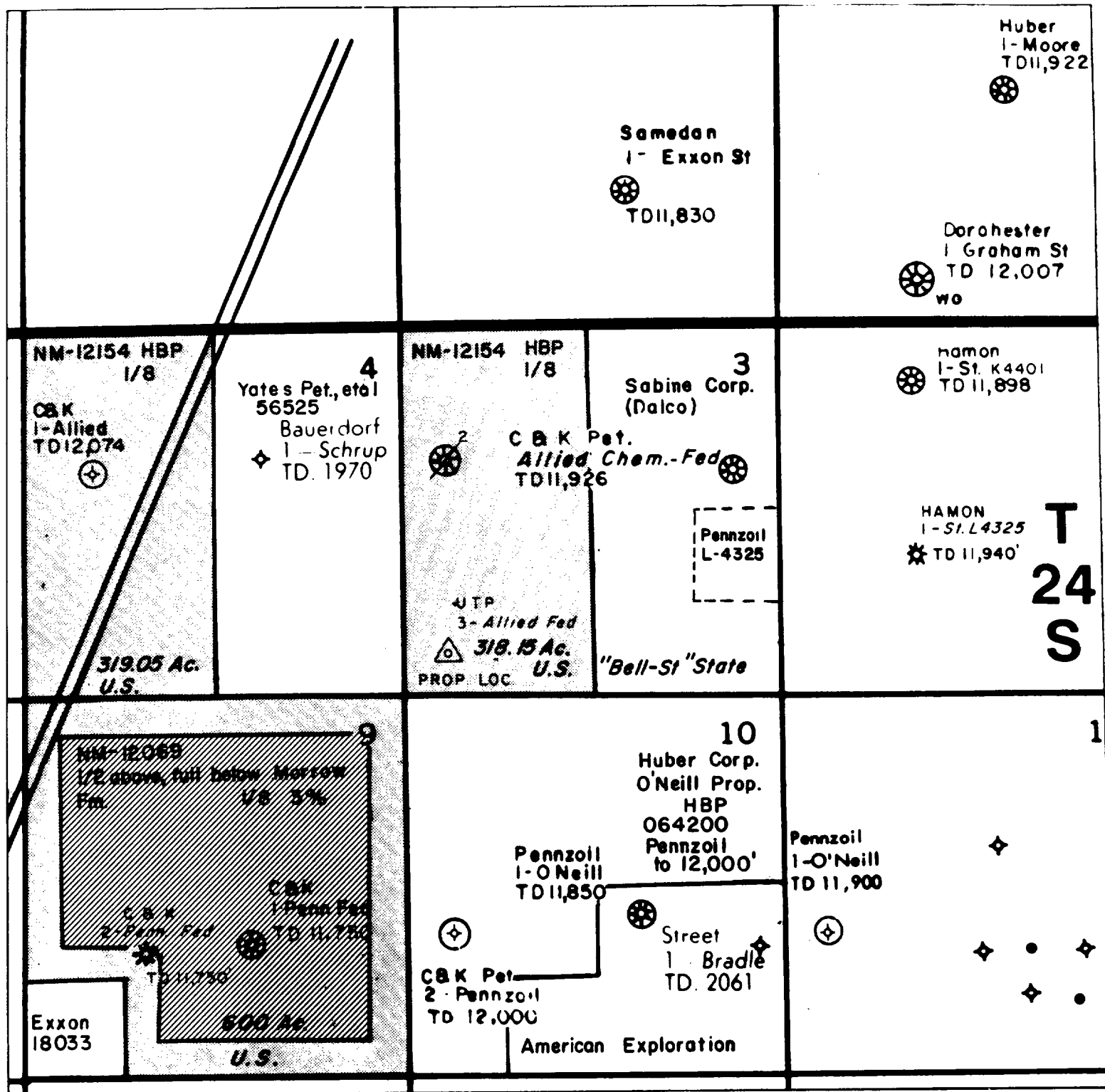

BEFORE EXAMINER CATANACH
OIL CONSERVATION DIVISION

UTP EXHIBIT NO. 1

CASE NO. 9485

EXHIBIT



UNION TEXAS PETROLEUM
WHITE CITY/CARLSBAD SOUTH FIELD
EDDY COUNTY, NEW MEXICO

LAND PLAT



EXHIBIT

NEW MEXICO OIL CONSERVATION COMMISSION
WELL LOCATION AND ACREAGE DEDICATION PLATForm C-102
Supersedes C-128
Effective 1-1-65

All distances must be from the outer boundaries of the Section

Operator UNION TEXAS PETROLEUM CORPORATION			Lease Allied Chemical Federal		Well No. 3
Unit Letter M	Section 3	Township 24 South	Range 26 East	County Eddy County, N.M.	
Actual Footage Location of Well: 660 feet from the South line and 660 feet from the West line					
Ground Level Elev. 3360.	Producing Formation Morrow		Pool Carlsbad South		Dedicated Acreage: 40 Acres

1. Outline the acreage dedicated to the subject well by colored pencil or hatchure marks on the plat below.
2. If more than one lease is dedicated to the well, outline each and identify the ownership thereof (both as to working interest and royalty).
3. If more than one lease of different ownership is dedicated to the well, have the interests of all owners been consolidated by communitization, unitization, force-pooling, etc?

☐ Yes ☒ No If answer is "yes," type of consolidation _____

If answer is "no," list the owners and tract descriptions which have actually been consolidated. (Use reverse side of this form if necessary.) _____

No allowable will be assigned to the well until all interests have been consolidated (by communitization, unitization, forced-pooling, or otherwise) or until a non-standard unit, eliminating such interests, has been approved by the Commission.

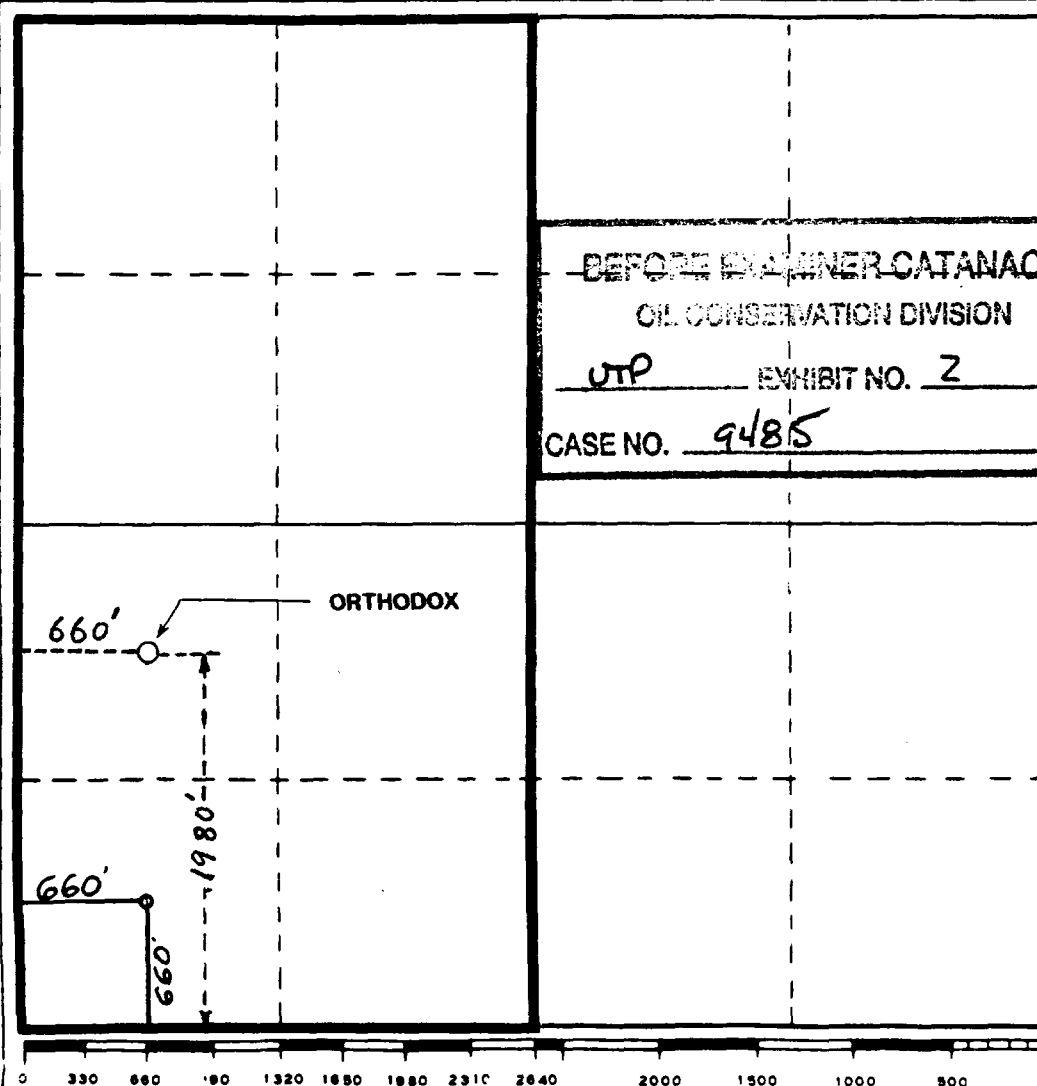

BEFORE EXAMINER CATANACH
OIL CONSERVATION DIVISION
UTP EXHIBIT NO. 2
CASE NO. 9485

CERTIFICATION

I hereby certify that the information contained herein is true and complete to the best of my knowledge and belief.

Name
JOHN WHITE
Position
UNION TEXAS PETROLEUM
Company
REG PERMIT COORD
Date
7/26/88

I hereby certify that the well location shown on this plat was plotted from field notes of actual surveys made by me or under my supervision, and that the same are true and correct to the best of my knowledge and belief.

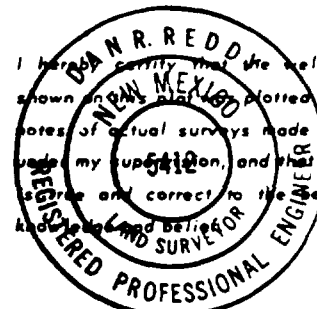

Date Surveyed
July 21, 1988
Registered Professional Engineer
and/or Land Surveyor

Dan R. Redd
Certificate No.
NM PE&LS NO. 5412

R 26 E

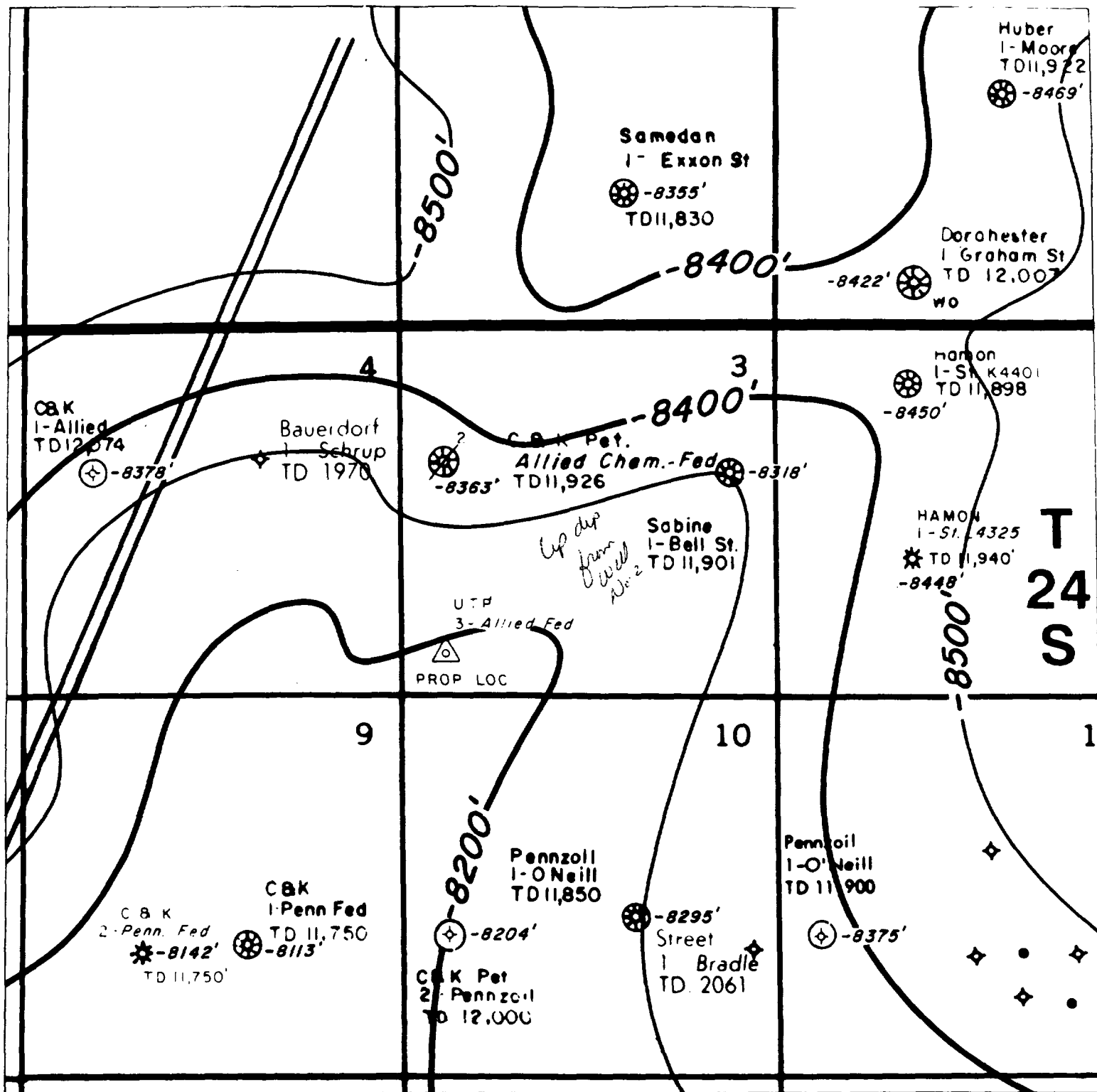

BEFORE EXAMINER CATANACH
OIL CONSERVATION DIVISION

UTP EXHIBIT NO. 3

CASE NO. 9485

EXHIBIT



UNION TEXAS PETROLEUM
WHITE CITY CARLSBAD SOUTH FIELD
EDDY COUNTY, NEW MEXICO

STRUCTURE
T / LOWER MORROW

C.I. : 100'

R. L. HODGE

07/88

