

ROBERT L. BAYLESS

PETROLEUM PLAZA BUILDING  
P. O. BOX 168  
FARMINGTON, NEW MEXICO 87499  
(505) 326-2659

September 19, 1988

Case 9495

State of New Mexico  
Oil Conservation Division  
P.O. Box 2088  
Santa Fe, NM 87504-2088

Attn: Mr. William J. LeMay

Gentlemen:

Please let this letter serve as written request to be placed on the docket for the next scheduled Examiner's Hearing to be held on October 12, 1988. This letter will serve as follow-up to our verbal request of September 19, 1988, in a telephone conversation with Florene Davidson of your office. We seek to establish Non-Standard Proration Units For Formations Requiring 160 Acres for the western tier of Sections 6, 7, 18, 19, 30, and 31 of Township 30 North, Range 3 West, Rio Arriba County, New Mexico, and Sections 6 and 7 of Township 29 North, Range 3 West, Rio Arriba County, New Mexico, as evidenced by the attached lease map.

Please find attached copies of contact letters mailed to the Offset Operators of Record requesting their waiver of objection to the aforementioned authorization request. Signed originals of these letters will be in our possession at the Examiner's Hearing.

Please contact us at the above telephone number if you have any questions, or there is a change of schedule.

Yours truly,

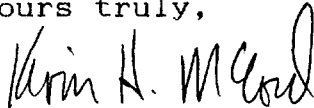

Kevin H. McCord  
Petroleum Engineer

gf

Attachments

R. 34.

T.  
31  
N.

T.  
31  
N.

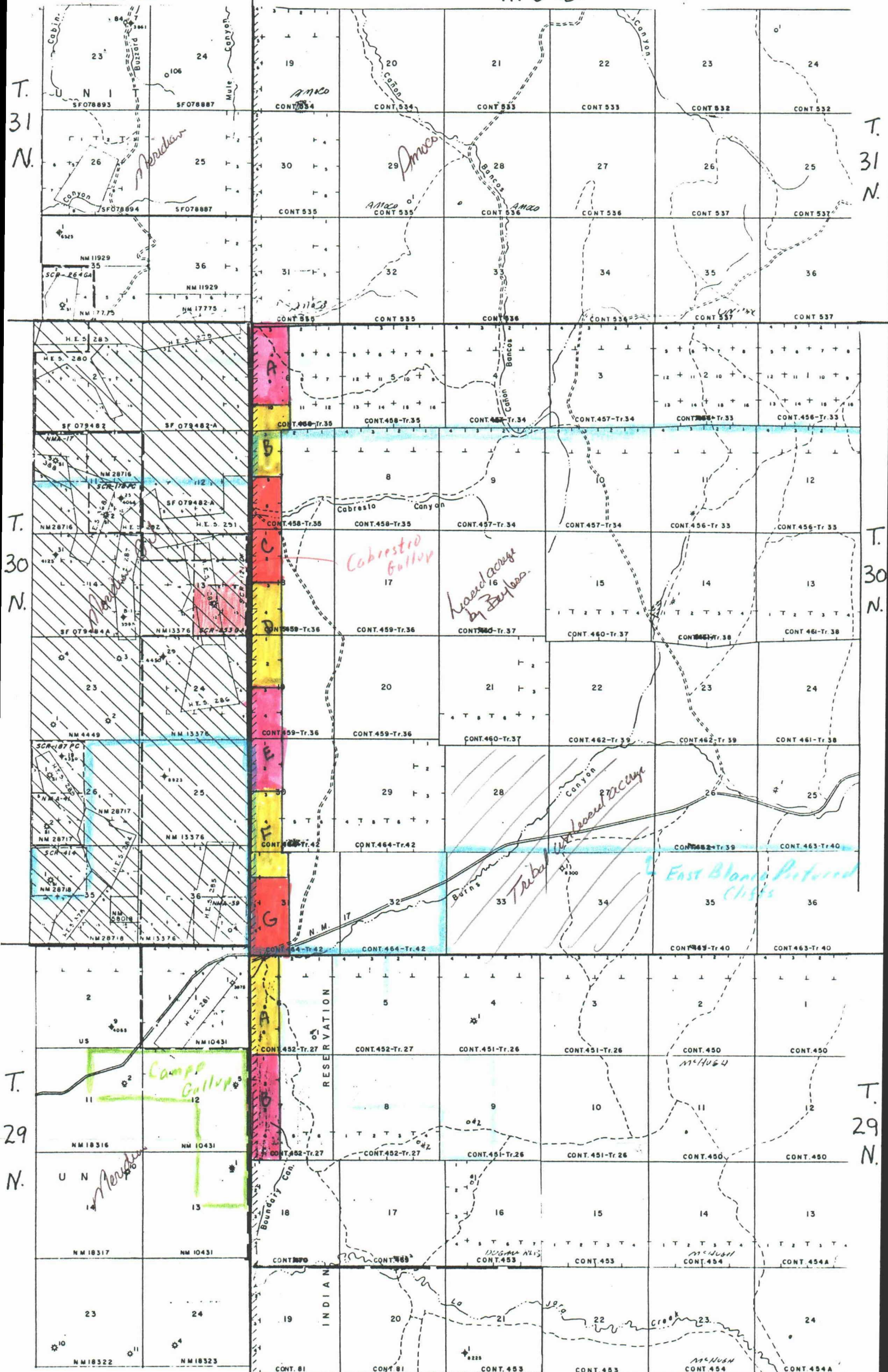

T.  
29  
N.

T.  
29  
N.

R. 4 W.

R. 3 W. Rio Arriba County, NM

NON-STANDARD PRORATION UNITS  
FOR FORMATIONS REQUIRING  
160 ACRES

EXHIBIT #1  
CASE # 9452  
EXAMINER: CATANACH

TOWNSHIP 29 NORTH, RANGE 3 WEST, RIO ARRIBA COUNTY, NEW MEXICO.

<u>TRACT</u>	<u>ACREAGE</u>	<u>SECTIONS</u>	<u>DESCRIPTION</u>
A	163.76	6	Lots 3,4,5 and 6 3- 36.87 5- 42.23 4- 42.27 6- 42.34
B	173.69	7	Lots 1,2,3 and 4 1- 42.52 3- 42.66 2- 42.66 4- 45.91
C	157.61	18	E/2 NW/4, NE/4 SW/4 and Lots 1,2 and 3
D	157.76	18 19	SE/4 SW/4 and Lot 4 E/2 NW/4, Lots 1 & 2
E	148.00	19 30	E/2 SW/4 & Lots 3 & 4 Lot 3
F	140.57	30	Lots 4,5 and 6
G	186.72	31	Lots 1,2,3 and 4

NON-STANDARD PRORATION UNITS  
FOR FORMATIONS REQUIRING  
160 ACRES

EXHIBIT #2  
CASE #9452  
EXAMINER: CATANACH

TOWNSHIP 30 NORTH, RANGE 3 WEST, RIO ARRIBA COUNTY, NEW  
MEXICO.

<u>TRACT</u>	<u>ACREAGE</u>	<u>SECTIONS</u>	<u>DESCRIPTION</u>
A	168.42	6	Lots 3, 4 and 9 <span style="float: right;">3-56.44 4-55.54 9-86.44</span>
B	133.39	6 7	Lot 10 <span style="float: right;">56.57</span> Lots 3 and 4 <span style="float: right;">3-38.57 4-43.25</span>
<div style="background-color: black; height: 20px; width: 100%;"></div>			
			<span style="float: right;">3-37 6-43.36 01 2-43.38</span>
D	173.21	18 19	Lots 3 and 4 <span style="float: right;">3-42.95 4-43.25</span> Lots 1 and 2 <span style="float: right;">1-43.54 2-43.43</span>
E	173.06	19 30	Lots 3 and 4 <span style="float: right;">3-43.33 4-43.27</span> Lots 1 and 2 <span style="float: right;">1-43.22 2-43.24</span>
F	151.01	30 31	Lots 3 and 4 <span style="float: right;">3-43.23 4-52.17</span> Lot 1, NE/4 NW/4 <span style="float: right;">1-22.83 15.61</span> <span style="float: right;">L-40</span>
<div style="background-color: black; height: 20px; width: 100%;"></div>			
			<span style="float: right;">15.70 3-15.80 4-15.89</span>

ROBERT L. BAYLESS

PETROLEUM PLAZA BUILDING  
P. O. BOX 168  
FARMINGTON, NEW MEXICO 87499  
(505) 326-2659

September 19, 1988

**COPY**

Meridian Oil, Inc.  
P.O. Box 4289  
Farmington, NM 87499-4289

Attn: Ms. Linda Donahue

Gentlemen:

A search of lease records indicate you to be an offset Operator to our Cabresto leases, as evidenced by the attached lease map. We are requesting the establishment of Non-Standard Proration Units For Formations Requiring 160 Acre Units from the State of New Mexico on the truncated sections of the western tier of the aforementioned leaseholdings which are indicated by the highlighted areas on the attached map.

Please acknowledge that you waive any objection to this request by signing on the space provided below, and returning the original copy of this letter to our office as soon as possible.

Yours truly,

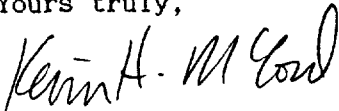

Kevin H. McCord  
Petroleum Engineer

gf

Enclosures

cc: State of New Mexico  
Oil Conservation Division  
P.O. Box 2088  
Santa Fe, NM 87504-2088

Attn: Mr. William J. LeMay

The undersigned has no objection to the request for Non-Standard Proration Units For Formations Requiring 160 Acres establishment.

Meridian Oil, Inc.

By: \_\_\_\_\_

Date: \_\_\_\_\_

*Exhibit IV*

ROBERT L. BAYLESS

PETROLEUM PLAZA BUILDING  
P. O. BOX 168  
FARMINGTON, NEW MEXICO 87499  
(505) 326-2659

September 19, 1988

**COPY**

Cecelia Wirt Simms  
Richard R. Simms  
P.O. Box 338  
Wagon Mound, NM 87752

Gentlemen:

A search of lease records indicate you to be an offset Operator to our Cabresto leases, as evidenced by the attached lease map. We are requesting the establishment of Non-Standard Proration Units For Formations Requiring 160 Acre Units from the State of New Mexico on the truncated sections of the western tier of the aforementioned leaseholdings which are indicated by the highlighted areas on the attached map.

Please acknowledge that you waive any objection to this request by signing on the space provided below, and returning the original copy of this letter to our office as soon as possible.

Yours truly,

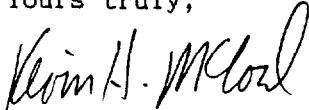

Kevin H. McCord  
Petroleum Engineer

gf

Enclosures

cc: State of New Mexico  
Oil Conservation Division  
P.O. Box 2088  
Santa Fe, NM 87504-2088

Attn: Mr. William J. LeMay

The undersigned has no objection to the request for Non-Standard Proration Units For Formations Requiring 160 Acres establishment.

Cecelia Wirt Simms  
Richard R. Simms

By: \_\_\_\_\_

Date: \_\_\_\_\_

ROBERT L. BAYLESS

PETROLEUM PLAZA BUILDING  
P. O. BOX 168  
FARMINGTON, NEW MEXICO 87499  
(505) 326-2659

September 19, 1988

**COPY**

Amoco Production Co.  
2325 E. 30th St.  
Farmington, NM 87401

Gentlemen:

A search of lease records indicate you to be an offset Operator to our Cabresto leases, as evidenced by the attached lease map. We are requesting the establishment of Non-Standard Proration Units For Formations Requiring 160 Acre Units from the State of New Mexico on the truncated sections of the western tier of the aforementioned leaseholdings which are indicated by the highlighted areas on the attached map.

Please acknowledge that you waive any objection to this request by signing on the space provided below, and returning the original copy of this letter to our office as soon as possible.

Yours truly,

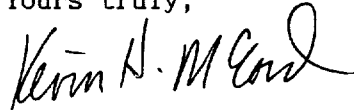

Kevin H. McCord  
Petroleum Engineer

gf

Enclosures

cc: State of New Mexico  
Oil Conservation Division  
P.O. Box 2088  
Santa Fe, NM 87504-2088

Attn: Mr. William J. LeMay

The undersigned has no objection to the request for Non-Standard Proration Units For Formations Requiring 160 Acres establishment.

Amoco Production Co.

By: \_\_\_\_\_

Date: \_\_\_\_\_