

NO. OF COPIES RECEIVED	
DISTRIBUTION	
SANTA FE	
FILE	
U.S.G.S.	
LAND OFFICE	
OPERATOR	

NEW MEXICO OIL CONSERVATION COMMISSION

AMENDED FORMATION

Form C-101
Revised 1-1-65

5A. Indicate Type of Lease - STATE <input type="checkbox"/> FEE <input checked="" type="checkbox"/>	
5. State Oil & Gas Lease No.	
7. Unit Agreement Name	
8. Farm or Lease Name Moore 34 Com.	
9. Well No. 1	
10. Field and Pool, or Wildcat Pitchfork Ranch (Morrow)	
12. County Lea	
19. Proposed Depth 15,600'	19A. Formation Morrow
20. Rotary or C.T. Rotary	
21. Elevations (Show whether DE, RT, etc.) 3401.6' GR	21A. Kind & Status Plug. Bond Blanket-Active
21B. Drilling Contractor Parker Drilling Company	
22. Approx. Date Work will start Spud 2/13/84	

APPLICATION FOR PERMIT TO DRILL, DEEPEN, OR PLUG BACK

1a. Type of Work DRILL <input checked="" type="checkbox"/> DEEPEN <input type="checkbox"/> PLUG BACK <input type="checkbox"/>	
b. Type of Well OIL WELL <input type="checkbox"/> GAS WELL <input checked="" type="checkbox"/> OTHER <input type="checkbox"/> SINGLE ZONE <input type="checkbox"/> MULTIPLE ZONE <input type="checkbox"/>	
2. Name of Operator HNG OIL COMPANY	
3. Address of Operator P. O. Box 2267, Midland, Texas 79702	
4. Location of Well UNIT LETTER G LOCATED 1980 FEET FROM THE north LINE AND 1980 FEET FROM THE east LINE OF SEC. 34 TWP. 24S RGE. 34E NMPM	
12. County Lea	
19. Proposed Depth 15,600'	
19A. Formation Morrow	
20. Rotary or C.T. Rotary	
21. Elevations (Show whether DE, RT, etc.) 3401.6' GR	
21A. Kind & Status Plug. Bond Blanket-Active	
21B. Drilling Contractor Parker Drilling Company	
22. Approx. Date Work will start Spud 2/13/84	

PROPOSED CASING AND CEMENT PROGRAM

SIZE OF HOLE	SIZE OF CASING	WEIGHT PER FOOT	SETTING DEPTH	SACKS OF CEMENT	EST. TOP
14-3/4"	11-3/4"	47# & 42#	615'	415	Circulated
10-5/8"	8-5/8"	32#	5233'	1575	Circulated
7-7/8"	5-1/2"	17#	13540'	1210	Cal. 7000'
4-3/4"	3-1/2"	15#	15600'	350	TOL: 12900'

BOP - Install at 5233 feet with 3000# cap. and 2450# annular preventor. At 13540 feet increase to 10,000# cap. with 5000# annular preventor. Will use standard surface controlled BOP installation.

Gas is dedicated.

Originally permitted 2/3/84 in the Atoka

ABOVE SPACE DESCRIBE PROPOSED PROGRAM: IF PROPOSAL IS TO DEEPEN OR PLUG BACK, GIVE DATA ON PRESENT PRODUCTIVE ZONE AND PROPOSED NEW PRODUCTIVE ZONE. GIVE BLOWOUT PREVENTER PROGRAM, IF ANY.

I hereby certify that the information above is true and complete to the best of my knowledge and belief.

Signed Betty Gilman Title Regulatory Analyst Date 4/6/84
(This space for State Use)

APPROVED BY [Signature] TITLE DISTRICT 1 SUPERVISOR DATE APR 9 1984

CONDITIONS OF APPROVAL, IF ANY:

**NEW MEXICO OIL CONSERVATION COMMISSION
WELL LOCATION AND ACREAGE DEDICATION PLAT**

Form C-102
Supersedes C-128
Effective 1-1-65

All distances must be from the outer boundaries of the Section.

Operator HNG OIL CO.			Lease MOORE 34 COM.		Well No. 1
Unit Letter G	Section 34	Township 24 S	Range 34 E	County LEA	
Actual Footage Location of Well: <div style="display: flex; justify-content: space-between;"> 1980 feet from the NORTH line and 1980 feet from the EAST line </div>					
Ground Level Elev. 3401.6	Producing Formation Morrow	Pool Pitchfork Ranch		Dedicated Acreage: 320 Acres	

1. Outline the acreage dedicated to the subject well by colored pencil or hachure marks on the plat below.
2. If more than one lease is dedicated to the well, outline each and identify the ownership thereof (both as to working interest and royalty).
3. If more than one lease of different ownership is dedicated to the well, have the interests of all owners been consolidated by communitization, unitization, force-pooling, etc?

☐ Yes ☐ No If answer is "yes," type of consolidation Communitization agreement being circulated for execution.

If answer is "no," list the owners and tract descriptions which have actually been consolidated. (Use reverse side of this form if necessary.) _____

No allowable will be assigned to the well until all interests have been consolidated (by communitization, unitization, forced-pooling, or otherwise) or until a non-standard unit, eliminating such interests, has been approved by the Commission.

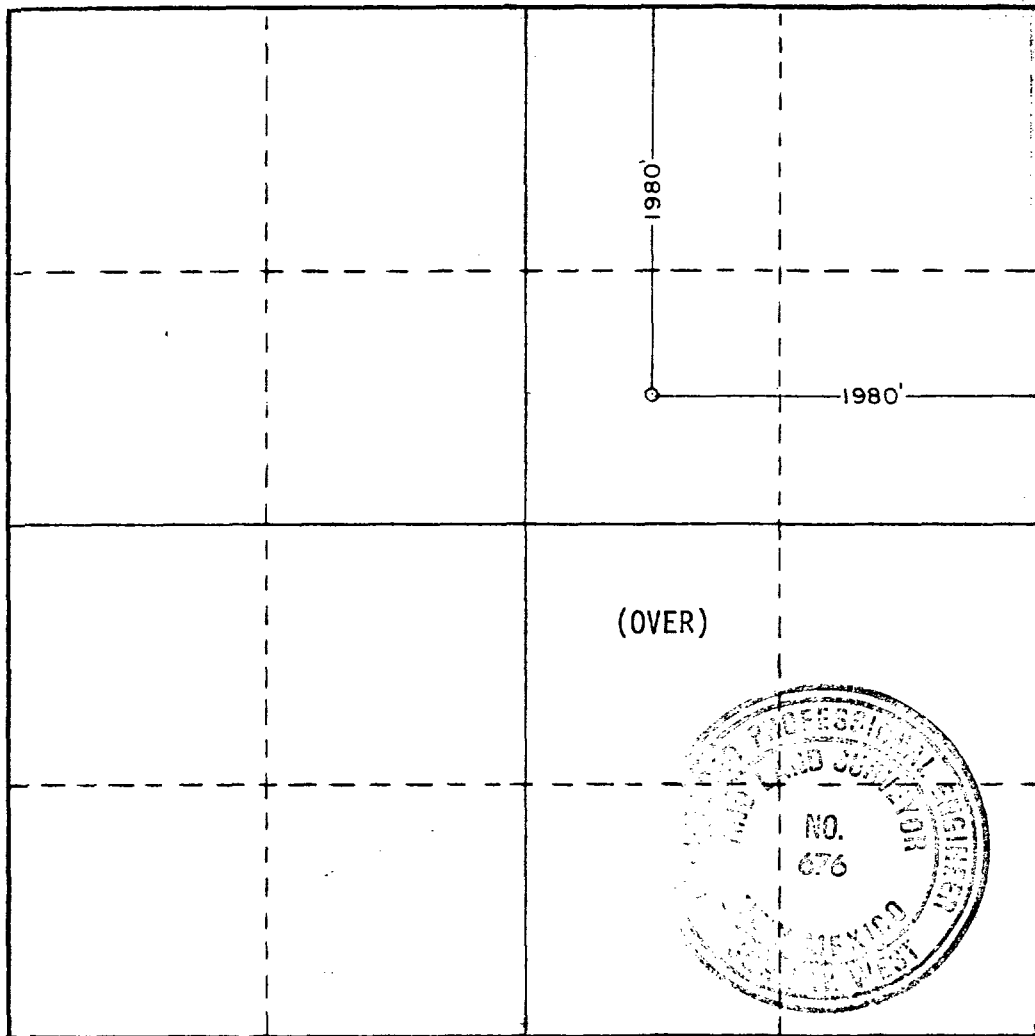

CERTIFICATION

I hereby certify that the information contained herein is true and complete to the best of my knowledge and belief.

Betty Gildon

Name
Betty Gildon

Position
Regulatory Analyst

Company
HNG OIL COMPANY

Date
April 6, 1984

I hereby certify that the well location shown on this plat was plotted from field notes of actual surveys made by me or under my supervision, and that the same is true and correct to the best of my knowledge and belief.

Date Surveyed
1-27-84

Registered Professional Engineer and/or Land Surveyor

John W. West

Certificate No. **JOHN W. WEST, 676**
RONALD J. EIDSON, 3239

0 330 660 990 1320 1650 1980 2310 2640 2970 3300 3630 3960 4290 4620 4950 5280 5610 5940 6270 6600

OIL CONSERVATION DIVISION

P. O. BOX 2088

SANTA FE, NEW MEXICO 87501

Form C-103
Revised 10-1-78

NO. OF COPIES RECEIVED	
DISTRIBUTION	
SANTA FE	
FILE	
U.S.G.S.	
LAND OFFICE	
OPERATOR	

5a. Indicate Type of Lease	
State <input type="checkbox"/>	Fee <input checked="" type="checkbox"/>
5. State Oil & Gas Lease No.	

SUNDRY NOTICES AND REPORTS ON WELLS
(DO NOT USE THIS FORM FOR PROPOSALS TO DRILL OR TO DEEPEN OR PLUG BACK TO A DIFFERENT RESERVOIR.
USE "APPLICATION FOR PERMIT -" (FORM C-101) FOR SUCH PROPOSALS.)

1. OIL <input type="checkbox"/> GAS <input checked="" type="checkbox"/> OTHER <input type="checkbox"/>	7. Unit Agreement Name
2. Name of Operator HNG OIL COMPANY	8. Farm or Lease Name Moore 34 Com.
3. Address of Operator P. O. Box 2267, Midland, Texas 79702	9. Well No. 1
4. Location of Well UNIT LETTER <u>G</u> <u>1980</u> FEET FROM THE <u>north</u> LINE AND <u>1980</u> FEET FROM <u>east</u> THE <u>LINE, SECTION 34</u> TOWNSHIP <u>24S</u> RANGE <u>34E</u> NMPM.	10. Field and Pool, or Wildcat Pitchfork Ranch (Atoka)
15. Elevation (Show whether DF, RT, GR, etc.) 3401.6' GR	12. County Lea

16. Check Appropriate Box To Indicate Nature of Notice, Report or Other Data			
NOTICE OF INTENTION TO:		SUBSEQUENT REPORT OF: 2/27/84	
PERFORM REMEDIAL WORK <input type="checkbox"/>	PLUG AND ABANDON <input type="checkbox"/>	REMEDIAL WORK <input type="checkbox"/>	ALTERING CASING <input type="checkbox"/>
TEMPORARILY ABANDON <input type="checkbox"/>	CHANGE PLANS <input type="checkbox"/>	COMMENCE DRILLING OPNS. <input type="checkbox"/>	PLUG AND ABANDONMENT <input type="checkbox"/>
PULL OR ALTER CASING <input type="checkbox"/>	OTHER <input type="checkbox"/>	CASING TEST AND CEMENT JOB <input checked="" type="checkbox"/>	OTHER <input type="checkbox"/>

17. Describe Proposed or Completed Operations (Clearly state all pertinent details, and give pertinent dates, including estimated date of starting any proposed work) SEE RULE 1503.

3-15-84 - Set 13,540 feet of 5-1/2" 17# P-110. Cemented with 760 sacks trinity lite weight 4 gel + 1/4#/Sx flocele, 8/10 of one percent Halad-9, 3/10 of one percent HR-7. 1.82 cubic feet/sack. 12.0 ppg. and 450 sacks Class H cement, 6/10 of one percent Halad 22A, 3/10 of one percent HR-7, 1.18 cubic feet/sack. 15.6 ppg.

30 minutes pressure tested to 2700#. WOC - 22-1/2 hours.

18. I hereby certify that the information above is true and complete to the best of my knowledge and belief.

SIGNED <u>Betty Gordon</u>	TITLE <u>Regulatory Analyst</u>	DATE <u>3/20/84</u>
APPROVED BY <u>[Signature]</u>	TITLE <u>DISTRICT 1 SUPERVISOR</u>	DATE <u>MAR 21 1984</u>
CONDITIONS OF APPROVAL, IF ANY:		

OIL CONSERVATION DIVISION

P. O. BOX 2088

SANTA FE, NEW MEXICO 87501

Form C-103
Revised 10-1-78

NO. OF COPIES RECEIVED	
DISTRIBUTION	
SANTA FE	
FILE	
U.S.G.S.	
LAND OFFICE	
OPERATOR	

5a. Indicate Type of Lease	
State <input type="checkbox"/>	Fee <input checked="" type="checkbox"/>
5. State Oil & Gas Lease No.	

SUNDRY NOTICES AND REPORTS ON WELLS

(DO NOT USE THIS FORM FOR PROPOSALS TO DRILL OR TO DEEPEN OR PLUG BACK TO A DIFFERENT RESERVOIR. USE "APPLICATION FOR PERMIT -" (FORM C-101) FOR SUCH PROPOSALS.)

1. OIL <input type="checkbox"/> GAS <input checked="" type="checkbox"/> OTHER-		7. Unit Agreement Name
2. Name of Operator HNG OIL OCMPCANY		8. Farm or Lease Name Moore 34 Com.
3. Address of Operator P. O. Box 2267, Midland, Texas 79702		9. Well No. 1
4. Location of Well UNIT LETTER <u>G</u> , <u>1930</u> FEET FROM THE <u>north</u> LINE AND <u>1980</u> FEET FROM THE <u>east</u> LINE, SECTION <u>34</u> TOWNSHIP <u>24S</u> RANGE <u>34E</u> NMPM.		10. Field and Pool, or Wildcat Pitchfork Ranch (Atoka)
15. Elevation (Show whether DF, RT, GR, etc.) 3401.6' GR		12. County Lea

16. Check Appropriate Box To Indicate Nature of Notice, Report or Other Data
NOTICE OF INTENTION TO:

SUBSEQUENT REPORT OF: 2/17/84

PERFORM REMEDIAL WORK <input type="checkbox"/>	PLUG AND ABANDON <input type="checkbox"/>	REMEDIAL WORK <input type="checkbox"/>	ALTERING CASING <input type="checkbox"/>
TEMPORARILY ABANDON <input type="checkbox"/>	CHANGE PLANS <input type="checkbox"/>	COMMENCE DRILLING OPNS. <input type="checkbox"/>	PLUG AND ABANDONMENT <input type="checkbox"/>
PULL OR ALTER CASING <input type="checkbox"/>	OTHER <input type="checkbox"/>	CASING TEST AND CEMENT JOBS <input checked="" type="checkbox"/>	OTHER <input type="checkbox"/>

17. Describe Proposed or Completed Operations (Clearly state all pertinent details, and give pertinent dates, including estimated date of starting any proposed work) SEE RULE 1103.

2-21-84 - Set 5233 feet of 8-5/8" 32# K-55 ST&C. Cemented with 1250 sacks HLW 1/4#/sx. flocele, 12.7 ppg. and 325 sacks Class C 14.8 ppg. Picked up 1 inch pipe tagged cement at 100 feet down, pumped 8 barrel slurry of Calss C cement weighted to 14.8 ppg through 1-inch- circulated to surface.

WOC - 19 hours. 30 minutes pressure tested to 1500#.

18. I hereby certify that the information above is true and complete to the best of my knowledge and belief.

SIGNED <u>Betty Gilson</u>	TITLE <u>Regulatory Analyst</u>	DATE <u>2/27/84</u>
APPROVED BY <u>Edd Wilson</u>	TITLE <u>OIL & GAS INSPECTOR</u>	DATE <u>FEB 29 1984</u>
CONDITIONS OF APPROVAL, IF ANY:		

OIL CONSERVATION DIVISION
P. O. BOX 2088
SANTA FE, NEW MEXICO 87501

Form C-103
Revised 10-1-78

NO. OF COPIES RECEIVED	
DISTRIBUTION	
SANTA FE	
FILE	
U.S.G.S.	
LAND OFFICE	
OPERATOR	

5a. Indicate Type of Lease	
State <input type="checkbox"/>	Fee <input checked="" type="checkbox"/>
5. State Oil & Gas Lease No.	

SUNDRY NOTICES AND REPORTS ON WELLS

(DO NOT USE THIS FORM FOR PROPOSALS TO DRILL OR TO DEEPEN OR PLUG BACK TO A DIFFERENT RESERVOIR. USE "APPLICATION FOR PERMIT -" FORM C-101) FOR SUCH PROPOSALS.)

1. OIL WELL <input type="checkbox"/> GAS WELL <input checked="" type="checkbox"/> OTHER-		7. Unit Agreement Name
2. Name of Operator HNG OIL COMPANY		8. Farm or Lease Name Moore 34 Com.
3. Address of Operator P. O. Box 2267, Midland, Texas 79702		9. Well No. 1
4. Location of Well UNIT LETTER <u>G</u> <u>1980</u> FEET FROM THE <u>north</u> LINE AND <u>1980</u> FEET FROM <u>east</u> LINE, SECTION <u>34</u> TOWNSHIP <u>24S</u> RANGE <u>34E</u> NMPM.		10. Field and Pool, or Wildcat Pitchfork Ranch (Atoka)
15. Elevation (Show whether DF, RT, GR, etc.) 3401.6' GR		12. County Lea

Check Appropriate Box To Indicate Nature of Notice, Report or Other Data
NOTICE OF INTENTION TO: SUBSEQUENT REPORT OF:

PERFORM REMEDIAL WORK <input type="checkbox"/>	PLUG AND ABANDON <input type="checkbox"/>	REMEDIAL WORK <input type="checkbox"/>	ALTERING CASING <input type="checkbox"/>
TEMPORARILY ABANDON <input type="checkbox"/>	CHANGE PLANS <input type="checkbox"/>	COMMENCE DRILLING OPNS. <input type="checkbox"/>	PLUG AND ABANDONMENT <input type="checkbox"/>
PULL OR ALTER CASING <input type="checkbox"/>	OTHER <input type="checkbox"/>	CASING TEST AND CEMENT JOBS <input checked="" type="checkbox"/>	OTHER <input type="checkbox"/>

17. Describe Proposed or Completed Operations (Clearly state all pertinent details, and give pertinent dates, including estimated date of starting any proposed work) SEE RULE 1103.

2-13-84 - Spud 8:30 a.m.

2-14-84 - Set 615 feet of 11-3/4" 47# K-55 ST&C and 42# H-40 ST&C. Cemented with 250 sacks halliburton lite cement 1/4# Flocele 2% CaCl mixed at 12.7 ppg and 165 sacks Class C 2% CaCl mixed at 14.8 ppg. Circulated to surface. WOC - 24 hours. 30 minutes pressure tested to 1500#.

18. I hereby certify that the information above is true and complete to the best of my knowledge and belief.

SIGNED <u>Betty Gildon</u>	TITLE <u>Regulatory Analyst</u>	DATE <u>2/17/84</u>
APPROVED BY <u>[Signature]</u>	TITLE <u>DISTRICT 1 SUPERVISOR</u>	DATE <u>FEB 20 1984</u>
CONDITIONS OF APPROVAL, IF ANY:		

30-025-28596

NO. OF COPIES RECEIVED	
DISTRIBUTION	
SANTA FE	
FILE	
U.S.G.S.	
LAND OFFICE	
OPERATOR	

NEW MEXICO OIL CONSERVATION COMMISSION

Form C-101
Revised 1-1-65

5A. Indicate Type of Lease	
STATE <input type="checkbox"/>	FEE <input checked="" type="checkbox"/>
5. State Oil & Gas Lease No.	

APPLICATION FOR PERMIT TO DRILL, DEEPEN, OR PLUG BACK

1a. Type of Work		7. Unit Agreement Name	
b. Type of Well OIL WELL <input type="checkbox"/> GAS WELL <input checked="" type="checkbox"/> OTHER <input type="checkbox"/>		8. Farm or Lease Name Moore 34 Com.	
2. Name of Operator HNG OIL COMPANY		9. Well No. 1	
3. Address of Operator P. O. Box 2267, Midland, Texas 79702		10. Field and Pool, or Wildcat Pitchfork Ranch (Atoka)	
4. Location of Well UNIT LETTER <u>G</u> LOCATED <u>1980</u> FEET FROM THE <u>north</u> LINE AND <u>1980</u> FEET FROM THE <u>east</u> LINE OF SEC. <u>34</u> TWP. <u>24S</u> RGE. <u>34E</u> NMPM		11. Designated UNDESIGNATED	
12. County Lea			
19. Proposed Depth 14,200'		19A. Formation Atoka	
20. Rotary or C.T. Rotary			
21. Elevations (Show whether DF, RT, etc.) 3401.6' GR		21A. Kind & Status Plug. Bond Blanket-Active	
21B. Drilling Contractor Parker Drilling Co.		22. Approx. Date Work will start before 6/6/84	

PROPOSED CASING AND CEMENT PROGRAM

SIZE OF HOLE	SIZE OF CASING	WEIGHT PER FOOT	SETTING DEPTH	SACKS OF CEMENT	EST. TOP
17-1/2"	13-3/8"	48#	550'	575	Circulated
12-1/4"	9-5/8"	36#	5000'	3000	Circulated
8-1/2"	7"	26#	13200'	1500	
6-1/8"	4-1/2" Liner	15#	14200'	350	TOL: 11,500'

BOP - Install at 5000 feet with 3000# cap. and 2450# annular preventor. At 13,200' increase to 10,000# cap. with 5000# annular preventor. Will use standard surface controlled BOP installation.

Gas is dedicated.

APPROVAL VALID FOR 180 DAYS
PERMIT EXPIRES 2/31/84
UNLESS DRILLING UNDERWAY

IN ABOVE SPACE DESCRIBE PROPOSED PROGRAM: IF PROPOSAL IS TO DEEPEN OR PLUG BACK, GIVE DATA ON PRESENT PRODUCTIVE ZONE AND PROPOSED NEW PRODUCTIVE ZONE. GIVE BLOWOUT PREVENTER PROGRAM, IF ANY.

hereby certify that the information above is true and complete to the best of my knowledge and belief.

Signed Betty G. Gordon Title Regulatory Analyst Date 1/31/84
(This space for State Use)

APPROVED BY [Signature] TITLE DISTRICT 1 SUPERVISOR DATE FEB 3 1984
CONDITIONS OF APPROVAL, IF ANY:

**NEW MEXICO OIL CONSERVATION COMMISSION
WELL LOCATION AND ACREAGE DEDICATION PLAT**

Form C-102
Supersedes C-128
Effective 1-1-65

All distances must be from the outer boundaries of the Section.

Operator HNG OIL CO.		Lease MOORE 34 COM.		Well No. 1
Unit Letter G	Section 34	Township 24 S	Range 34 E	County LEA
Actual Footage Location of Well: <div style="display: flex; justify-content: space-between;"> 1980 feet from the NORTH line and 1980 feet from the EAST line </div>				
Ground Level Elev. 3401.6	Producing Formation Atoka	Pool Pitchfork Ranch	Dedicated Acreage: 320 Acres	

1. Outline the acreage dedicated to the subject well by colored pencil or hachure marks on the plat below.
2. If more than one lease is dedicated to the well, outline each and identify the ownership thereof (both as to working interest and royalty).
3. If more than one lease of different ownership is dedicated to the well, have the interests of all owners been consolidated by communitization, unitization, force-pooling, etc?

☐ Yes ☐ No If answer is "yes," type of consolidation Communitization agreement is being circulated for execution.

If answer is "no," list the owners and tract descriptions which have actually been consolidated. (Use reverse side of this form if necessary.) _____

No allowable will be assigned to the well until all interests have been consolidated (by communitization, unitization, forced-pooling, or otherwise) or until a non-standard unit, eliminating such interests, has been approved by the Commission.

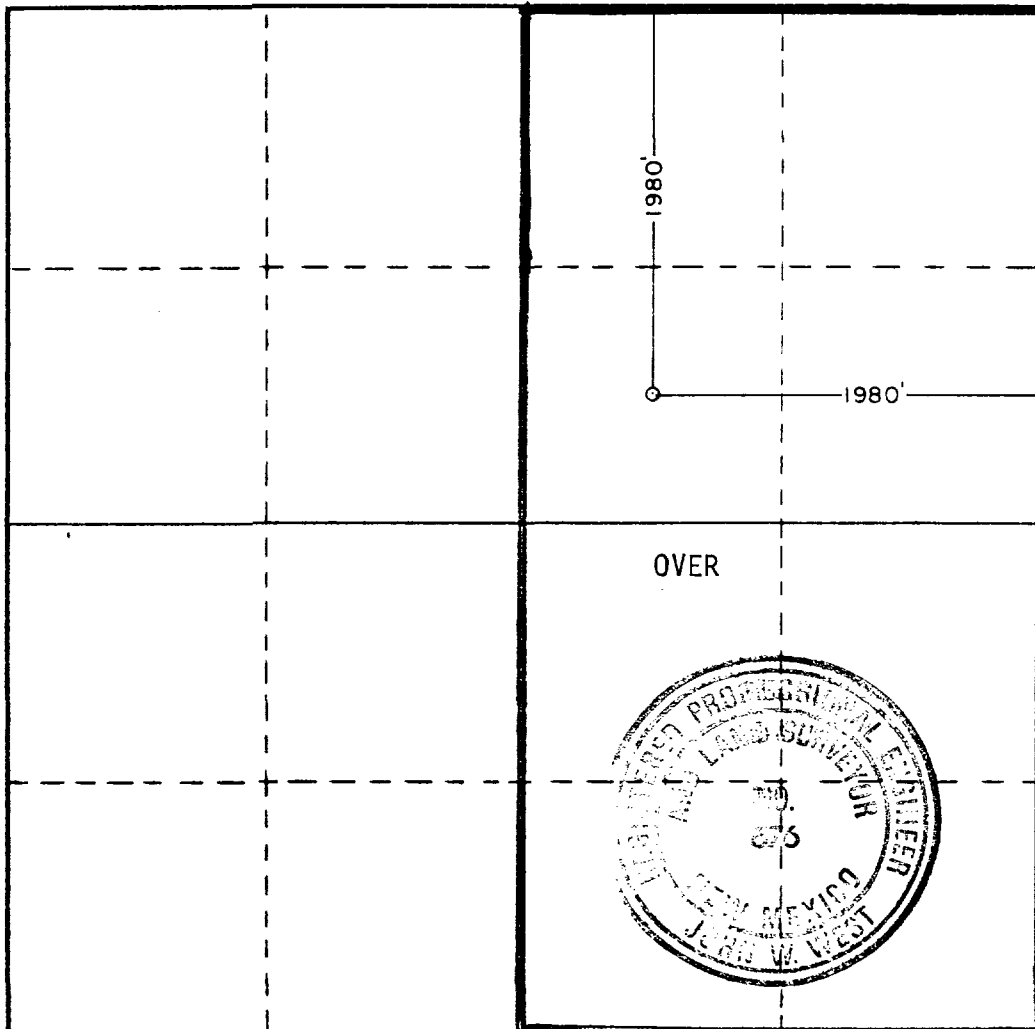

CERTIFICATION

I hereby certify that the information contained herein is true and complete to the best of my knowledge and belief.

Betty Gildon
Name

Betty Gildon

Position
Regulatory Analyst

Company
HNG OIL COMPANY

Date
1/31/84

I hereby certify that the well location shown on this plat was plotted from field notes of actual surveys made by me or under my supervision, and that the same is true and correct to the best of my knowledge and belief.

Date Surveyed
1-27-84

Registered Professional Engineer and/or Land Surveyor

John W. West

Certificate No. JOHN W. WEST, 676
RONALD J. EIDSON, 3239

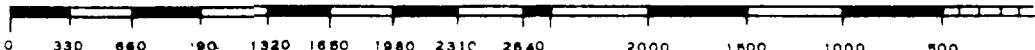

RECEIVED

O.C.O.

FEB 2 1984

RECEIVED

Working Interest:

HNG OIL COMPANY	-	.78228938
Samedan Oil Company	-	.06250000
Enserch Exploration	-	.13125000
Robert E. Landreth	-	.02396062

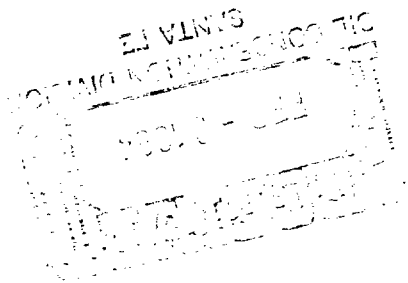

**NEW MEXICO OIL CONSERVATION COMMISSION
WELL LOCATION AND ACREAGE DEDICATION PLAT**

Form C-102
Supersedes C-128
Effective 1-1-65

All distances must be from the outer boundaries of the Section.

Operator HNG OIL CO.			Lease MOORE 34 COM.			Well No. 1		
Unit Letter G	Section 34	Township 24 S	Range 34 E	County LEA				
Actual Footage Location of Well: <div style="display: flex; justify-content: space-between;"> 1980 feet from the NORTH line and 1980 feet from the EAST line </div>								
Ground Level Elev. 3401.6	Producing Formation Wolfcamp		Pool Pitchfork Ranch			Dedicated Acreage: 320 Acres		

1. Outline the acreage dedicated to the subject well by colored pencil or hachure marks on the plat below.
2. If more than one lease is dedicated to the well, outline each and identify the ownership thereof (both as to working interest and royalty).
3. If more than one lease of different ownership is dedicated to the well, have the interests of all owners been consolidated by communitization, unitization, force-pooling, etc?

☐ Yes ☐ No If answer is "yes," type of consolidation _____

If answer is "no," list the owners and tract descriptions which have actually been consolidated. (Use reverse side of this form if necessary.) _____

No allowable will be assigned to the well until all interests have been consolidated (by communitization, unitization, forced-pooling, or otherwise) or until a non-standard unit, eliminating such interests, has been approved by the Commission.

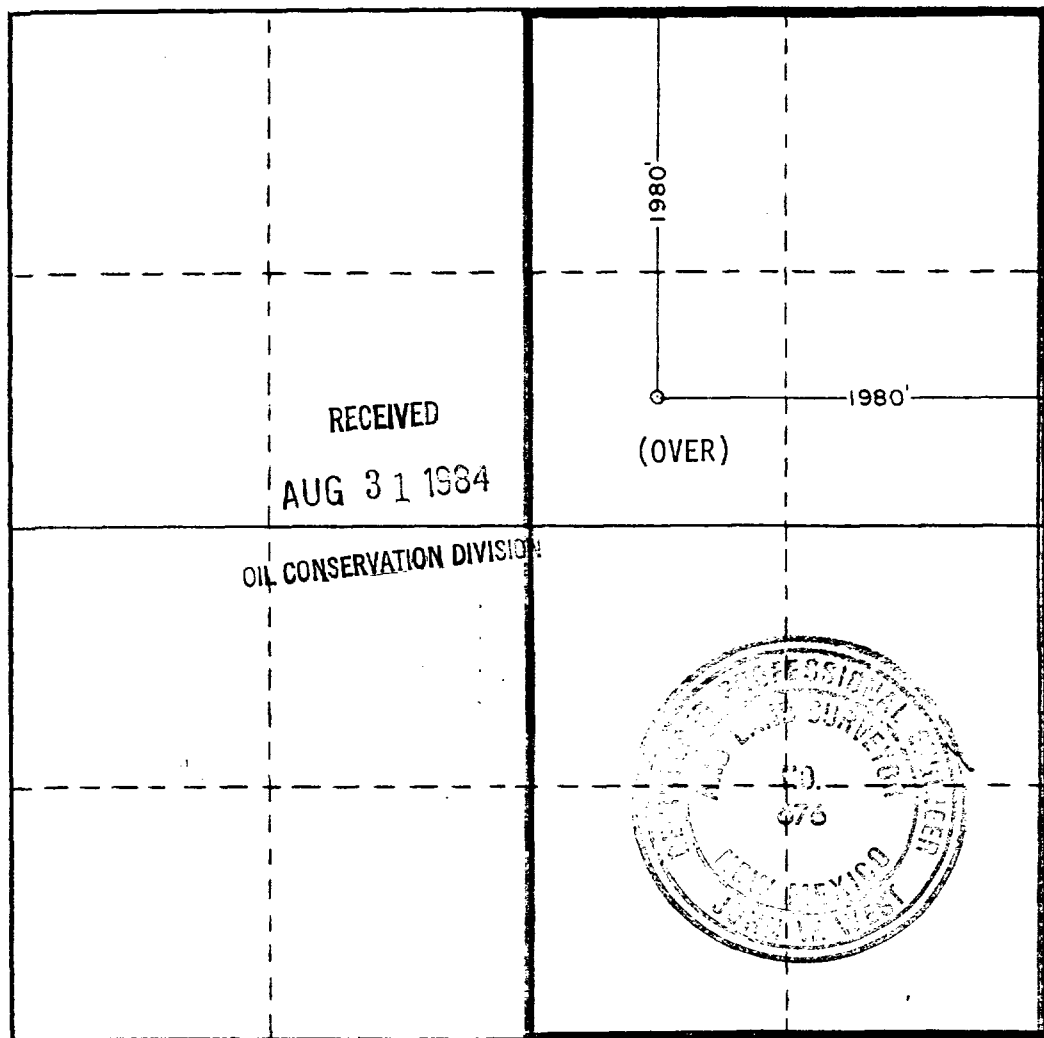

CERTIFICATION

I hereby certify that the information contained herein is true and complete to the best of my knowledge and belief.

Betty Gildon
Name

Betty Gildon

Position

Regulatory Analyst

Company

HNG OIL COMPANY

Date

August 27, 1984

I hereby certify that the well location shown on this plat was plotted from field notes of actual surveys made by me or under my supervision, and that the same is true and correct to the best of my knowledge and belief.

Date Surveyed

1-27-84

Registered Professional Engineer
and/or Land Surveyor

Ronald J. Eidson

Certificate No. JOHN W. WEST, 676

RONALD J. EIDSON, 3239

HOBBES OFFICE

AUG 28 1984

RECEIVED

Working Interest:

HNG OIL COMPANY	-	.78228938
Samedan Oil Company	-	.06250000
Enserch Exploration	-	.13125000
Robert E. Landreth	-	.02396062



COUNTY LEA

FIELD *Wildcat

STATE NM

OPR HNG OIL

API 30-025-28596

NO 1 LEASE Moore "34" Com.

MAP

Sec 34, T24S, R34E

CO-ORD

1980 FNL, 1980 FEL of Sec

7-4-47 NM

30 mi SE/Halfway

SPD 2-13-84

CMP *9-18-84

CSG

WELL CLASS: INIT D FIN *WSDLSE. CODE

*11 3/4-615-*415 sx

FORMATION

DATUM

FORMATION

DATUM

8 5/8-*5233-*1250 sx

5 1/2-13,540-*1210 sx

3 1/2-1nr-13,209-*15,370-*250 sx

*1 1/2-13,209

TD 15,376 *(MRRW) PBD *14,365

*IP (Wolfcamp) Perfs 13,490-13,500 F 168 BOPD. Pot based
on 24 hr test thru 14/64 chk. GOR 2750; gty 34; CP Pkr;
TP 1300

CONTR Parker #198

OPRSELEV 3402 GR

SUBS 28

F.R. 2-6-84

PD 14,200 RT *(Wolfcamp)

2-20-84

Drlg 4208

2-28-84

Drlg below 4208

3-5-84

Drlg 8890 sd & lm

3-12-84

Drlg 12,145 lm, sd & sh

3-19-84

Drlg 13,580 sh

4-2-84

Drlg 14,532 sh & lm

4-9-84

Drlg 15,007 sh & lm

4-16-84

Drlg 15,290 lm, sd & sh

4-23-84

TD 15,376; WOC

No Cores or DST's

4-30-84

TD 15,376; PBD 15,324; Tstg

Perf (Atoka) @ 15,167, 15,169, 15,171,

15,197, 15,200, 15,203, 15,206, 15,209,

15,213, 15,216, 15,219, 15,222 w/1 SPI

Acid (15,167-15,222) 5000 gals

7-4-47 NM

LEA
HNG OIL

Pitchfork Ranch

*Wildcat
1 Moore "34" Com.
Sec 34, T24S, R34E

NM
Page #2

4-30-84 Continued
Perf (Morrow) 15,228-15,234, 15,238-15,248
w/18 shots
Acid (15,167-15,248) 10,000 gals
5-7-84 TD 15,376; PBD 15,025; WO Rig Move
Jetted w/4 FT flare (15,167-15,248)
BP @ 15,025
Perf (Morrow) 14,606-14,625 w/1 SPF
Acid (14,606-14,625) 4000 gals
5-14-84 TD 15,376; PBD 15,025, SI
*8-28-84 TD 15,376; PBD 14,365; Circ
CIBP @ 14,365
Perf (Wolfcamp) 13,490-13,500 w/2 SPF
7-4-47 NM

*8-28-84 Continued
Swbd 65 BW w/tr oil in 13 hrs (13,490-13,500)
Att acid (13,490-13,500) 1000 gals, could not
pmp into perfs
Swbd 24 BF in 4 runs (13,490-13,500)
Acid (13,490-13,500) 2500 gals (7 1/2%)
*10-8-84 TD 15,376; PBD 14,365; Complete
*Wolfcamp Discovery
*LOG TOPS: Belaware Sand 5360, Cherry
Canyon 6360, Cherry Canyon Marker 6599,
Leonard 9093, Bone Spring 9248, 1st Bone
Spring Sand 10,358, 2nd Bone Spring Sand
10,908, Wolfcamp 12,249, Strawn 13,690,
Atoka 13,853, Morrow Lime 14,385, Morrow
Clastics 14,586, Morrow Shale 15,077
7-4-47 NM

LEA
HNG OIL

*Wildcat
1 Moore "34" Com.
Sec 34, T24S, R34E

NM
Page #3

*10-8-84

Continued

*LOGS RUN: CNL, FDC, DI, SFL

*Denotes Changes & Additions

7-28-84

TEMPORARY COMPLETION ISSUED

10-13-84

RE-ISSUE OF SUSPENDED COMPLETION:

Formerly Pitchfork Ranch (Atoka)

7-4-47 NM

IC 30-025-70032-84