

CASE NO. 10915
Hughes B #16R

Submitted by: Conoco Inc.
Hearing Date: Feb 17, 1994

CONOCO, INC.

PROPOSED HORIZONTAL FRUITLAND COAL WELL

HUGHES #B16R

**SURFACE LOCATION : 910'FNL 1100'FEL
SECTION 20-T29N-R8W**

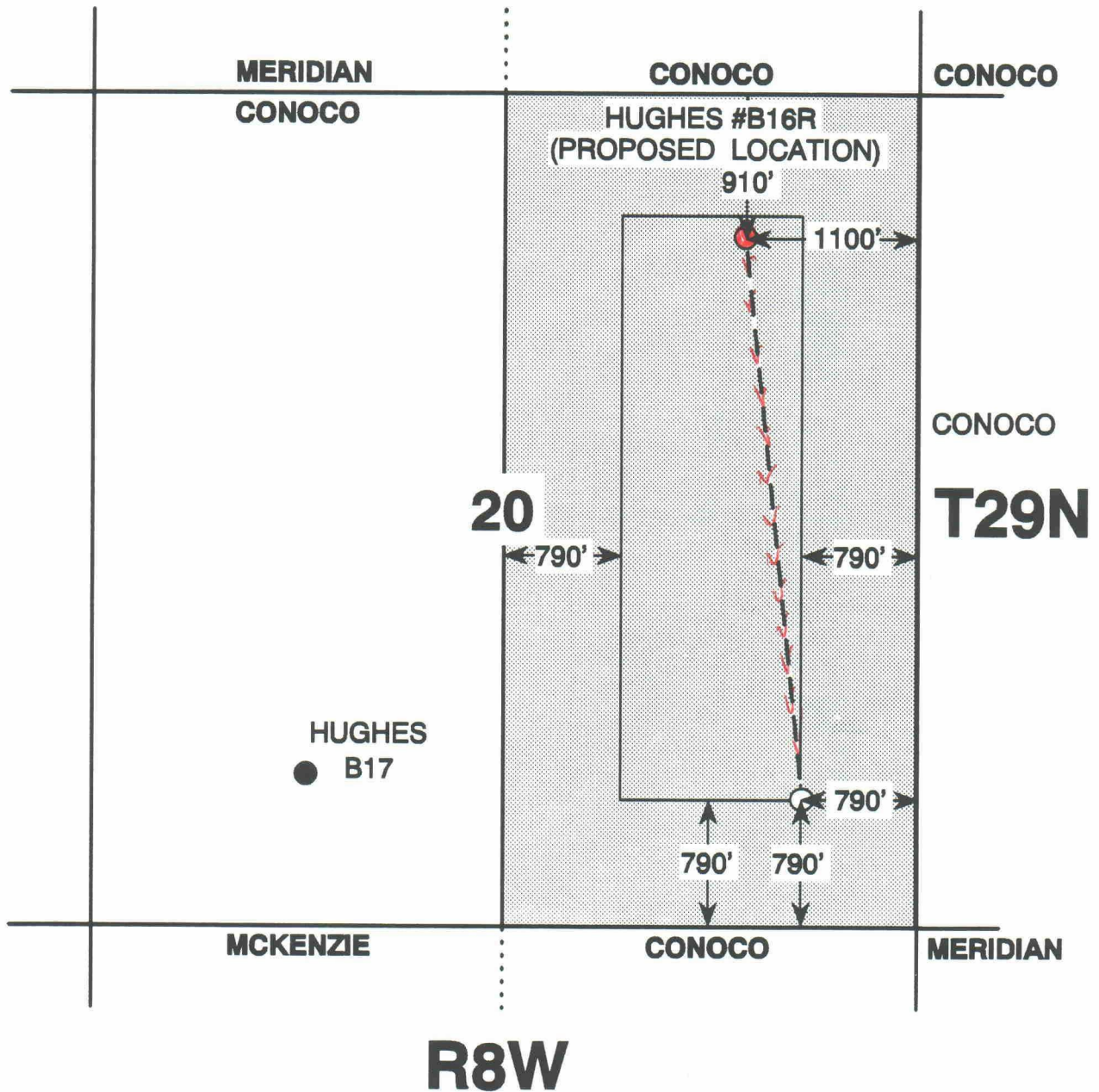

SAN JUAN CO., N.M.

**BEFORE AN EXAMINER OF THE
OIL CONSERVATION DIVISION**

EXHIBIT NO. 1
CASE NO.: 10915
Submitted by: Conoco Inc.
Hearing Date: Feb 17, 1994

T29N R8W

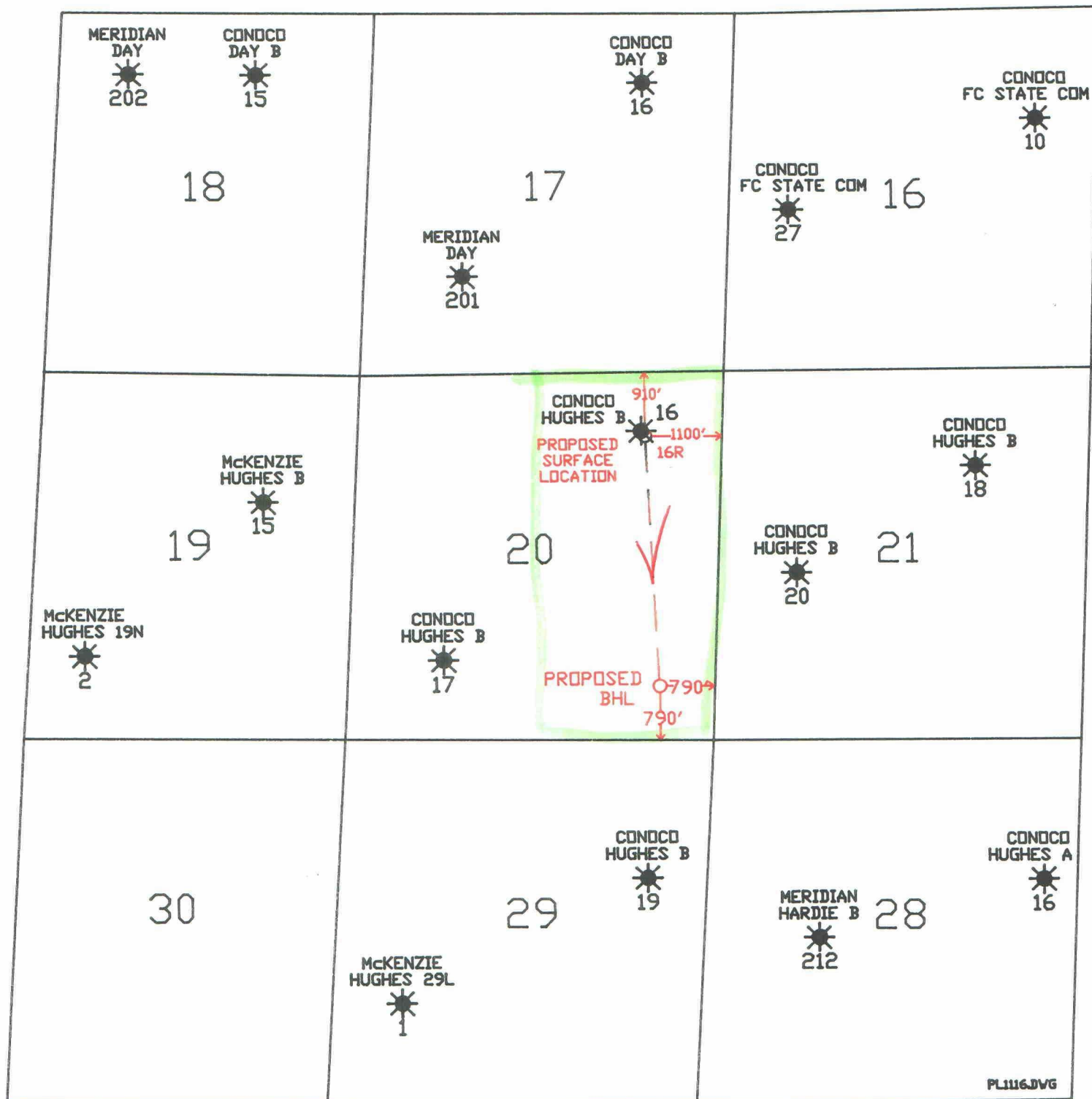

CONOCO
HUGHES B-16R
HORIZONTAL FRUITLAND WELL

BEFORE AN EXAMINER OF THE
OIL CONSERVATION DIVISION

EXHIBIT NO. 2
CASE NO.: 10915
Submitted by: Conoco Inc.
Hearing Date: Feb 17, 1994

Hughes B #16R - Sec. 20, T29N, R8W

Offset Well Data for Secs. 16, 17, 18, 19, 21, 28, 29, 30

all were owned and served privately.

LEASE	WNUM	OPERATOR	FDATE	LDATE	CUMGAS	YTD GAS	MCFD	LOCATION
FC STATE COM.	000010	CONOCO INC	9202	9308	71382	27782	110	29N08W16H
FC STATE COM.	000027	CONOCO INC	9202	9308	60816	19675	78	29N08W16L
DAY B	000016	CONOCO INC	9108	9308	36013	8173	32	29N08W17A
DAY	000201	MERIDIAN OIL INC	8904	9308	42189	2479	10	29N08W17K
DAY B	000015	CONOCO INC	9107	9308	86579	19886	79	29N08W18A
DAY	000202	MERIDIAN OIL INC	9004	9109	2352	0	0	29N08W18C
HUGHES B	000015	MCKENZIE METHANE COR	9112	9308	40295	11238	44	29N08W19H
HUGHES 19N	000002	MCKENZIE METHANE COR	9201	9308	40730	11109	44	29N08W19N
HUGHES B	000016	CONOCO INC	9107	9308	114884	21235	84	29N08W20A
HUGHES B	000017	CONOCO INC	9106	9308	56143	12815	51	29N08W20N
HUGHES B	000018	CONOCO INC	9105	9308	77824	20193	80	29N08W21G
HUGHES B	000020	CONOCO INC	9105	9308	114587	23340	92	29N08W21L
HUGHES A	000016	CONOCO INC	9109	9308	80928	19623	78	29N08W28H
HARDIE B	000212	MERIDIAN OIL INC	8902	9307	100057	9671	38	29N08W28K
HUGHES B	000019	CONOCO INC	9107	9308	81708	16385	65	29N08W29H
HUGHES 29 L	000001	MCKENZIE METHANE COR	9109	9308	34250	9172	36	29N08W29L

BEFORE AN EXAMINER OF THE
OIL CONSERVATION DIVISION

EXHIBIT NO. 3
CASE NO.: 10915
Submitted by: Conoco Inc.
Hearing Date: Feb 17, 1994

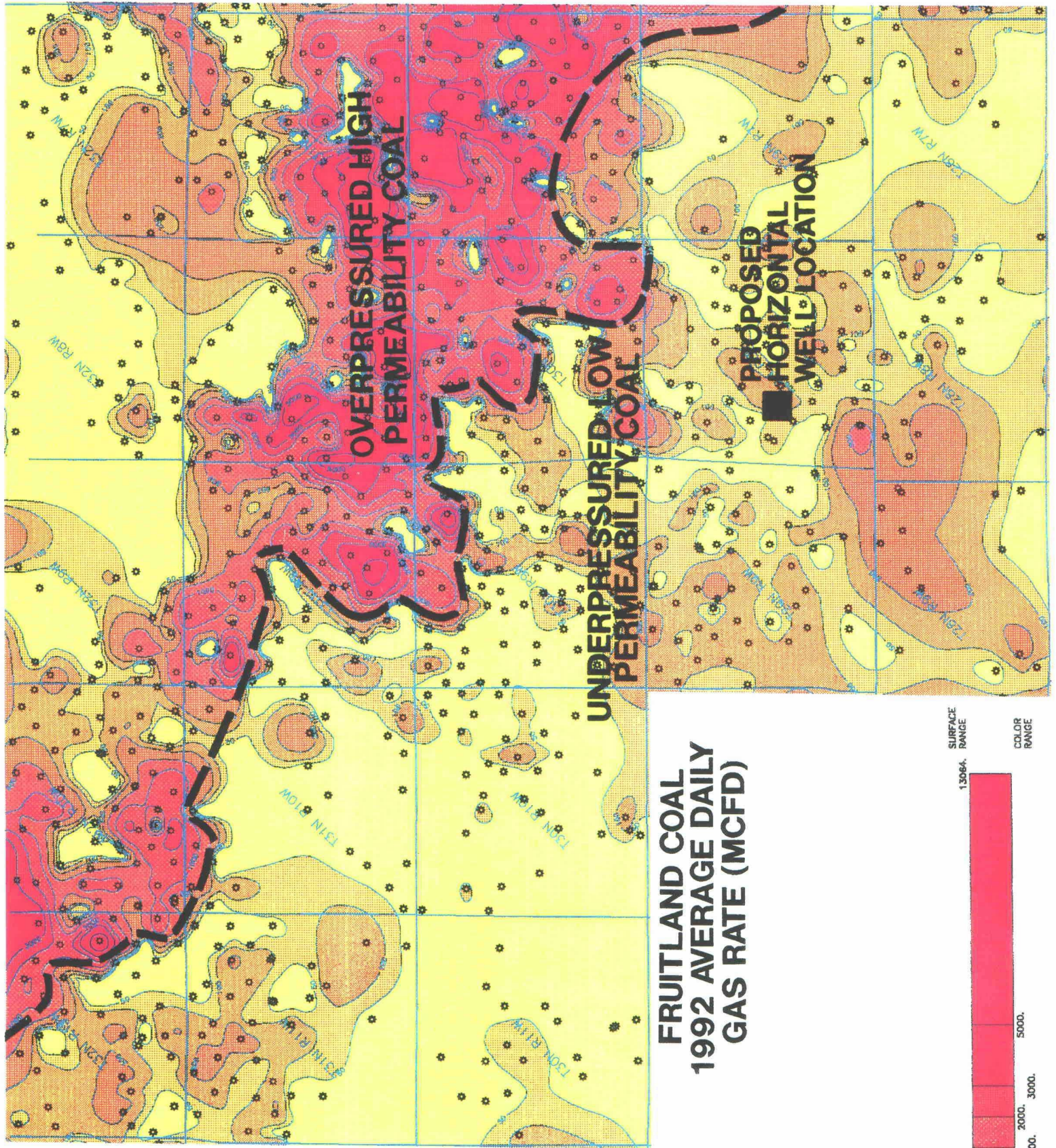

BEFORE AN EXAMINER OF THE
OIL CONSERVATION DIVISION

EXHIBIT NO. 4
CASE NO.: 10915
Submitted by: Conoco Inc.
Hearing Date: Feb 17, 1994

T29N R8W

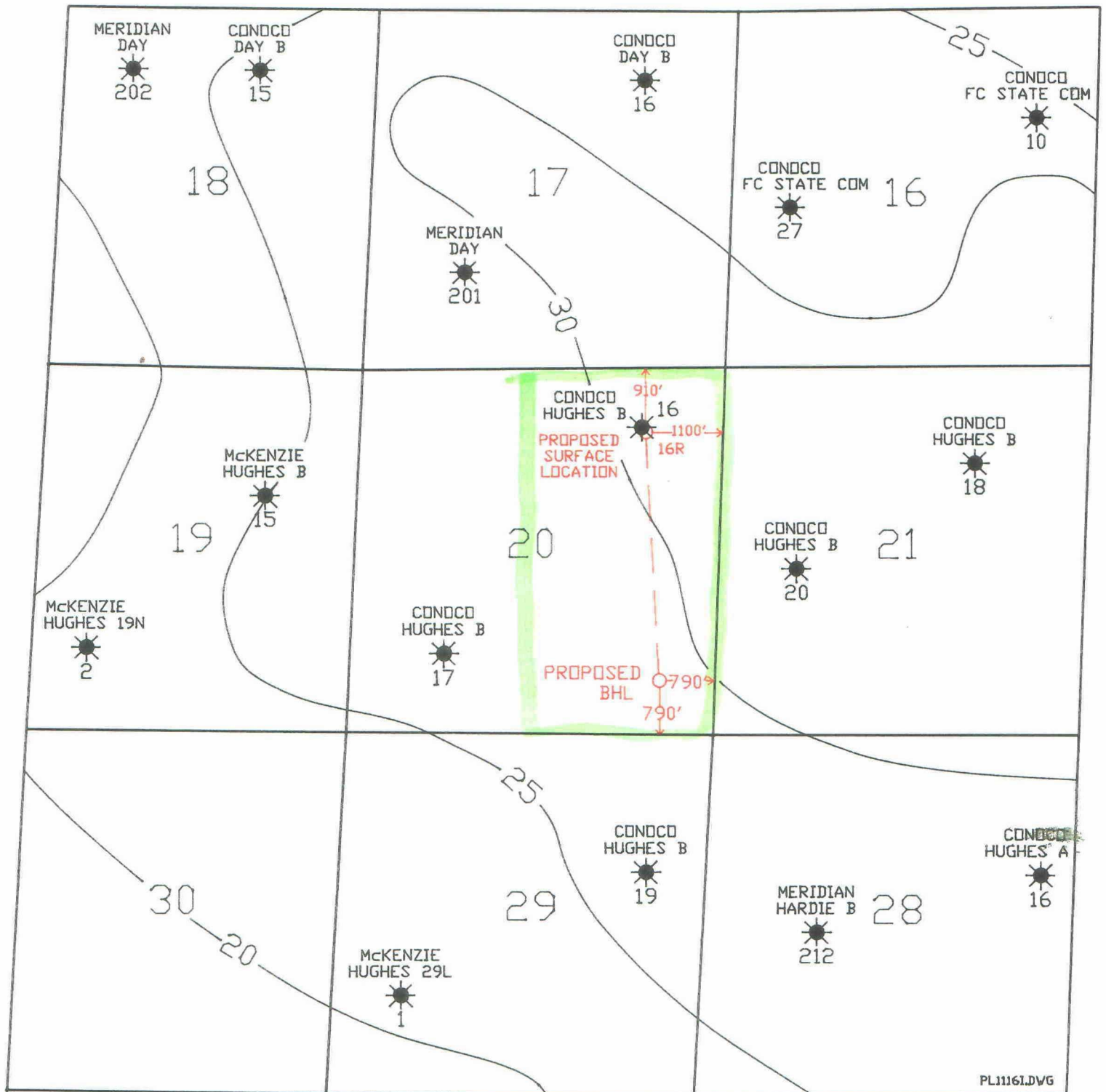

CONOCO
HUGHES B-16R
HORIZONTAL FRUITLAND WELL

ISOPACH
BASAL COAL SEAM

BEFORE AN EXAMINER OF THE
OIL CONSERVATION DIVISION

EXHIBIT NO. 5
CASE NO.: 10915
Submitted by: Conoco Inc.
Hearing Date: Feb 17, 1994

avg pressure
in core
is 800 psi

METHANE ADSORPTION ISOTHERM

CONOCO INC.

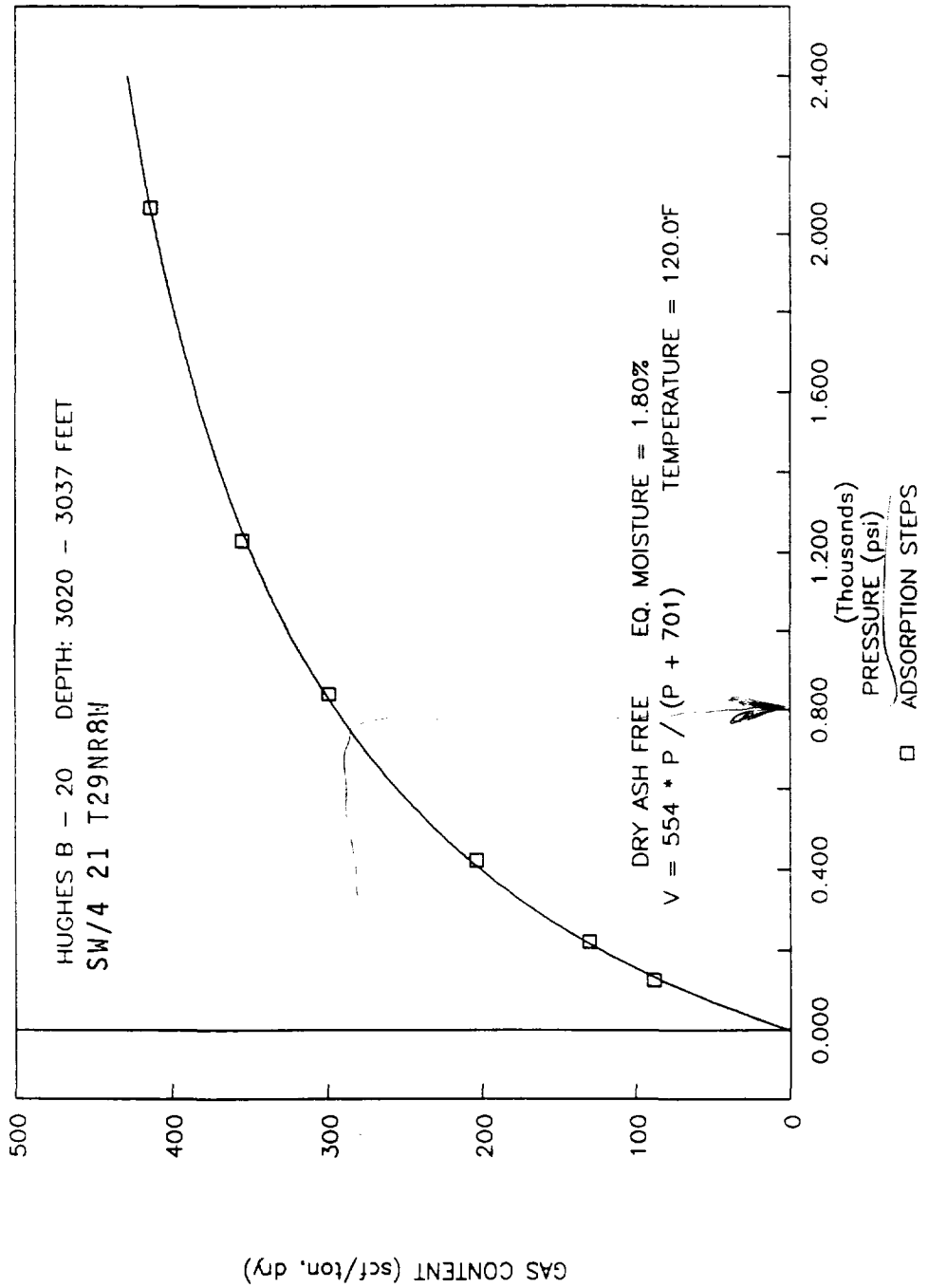

BEFORE AN EXAMINER OF THE OIL CONSERVATION DIVISION

EXHIBIT NO. 6
CASE NO.: 10915
Submitted by: Conoco Inc.
Hearing Date: Feb 17, 1994

Conventional and Coalbed Gas Storage and Flow Systems



Processes in the Transport of Coalbed Methane Gas

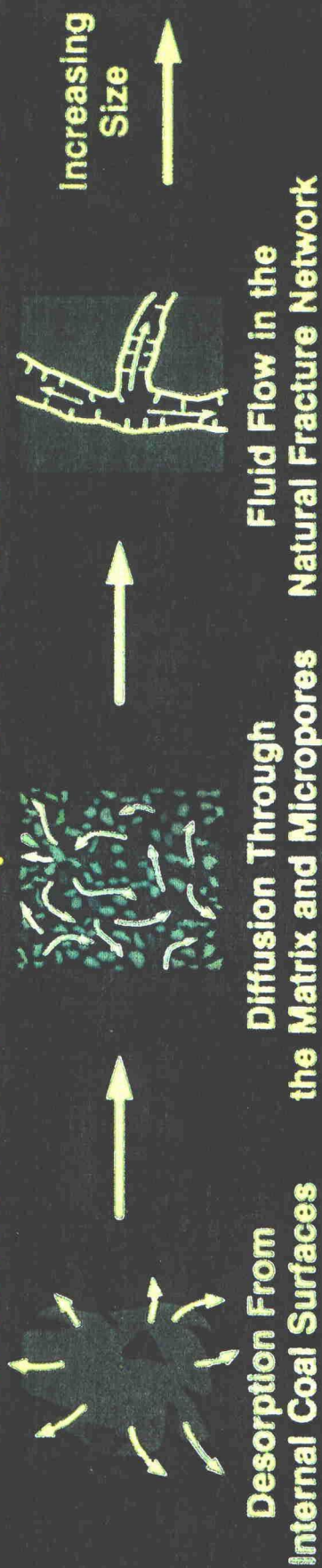

BEFORE AN EXAMINER OF THE
OIL CONSERVATION DIVISION

EXHIBIT NO. 7
CASE NO.: 10915
Submitted by: Conoco Inc.
Hearing Date: Feb 17, 1994

CONOCO, INC.

PROPOSED HORIZONTAL FRUITLAND COAL WELL

HUGHES #B16R

ANTICIPATED FACE CLEAT ORIENTATION
FRUITLAND COAL

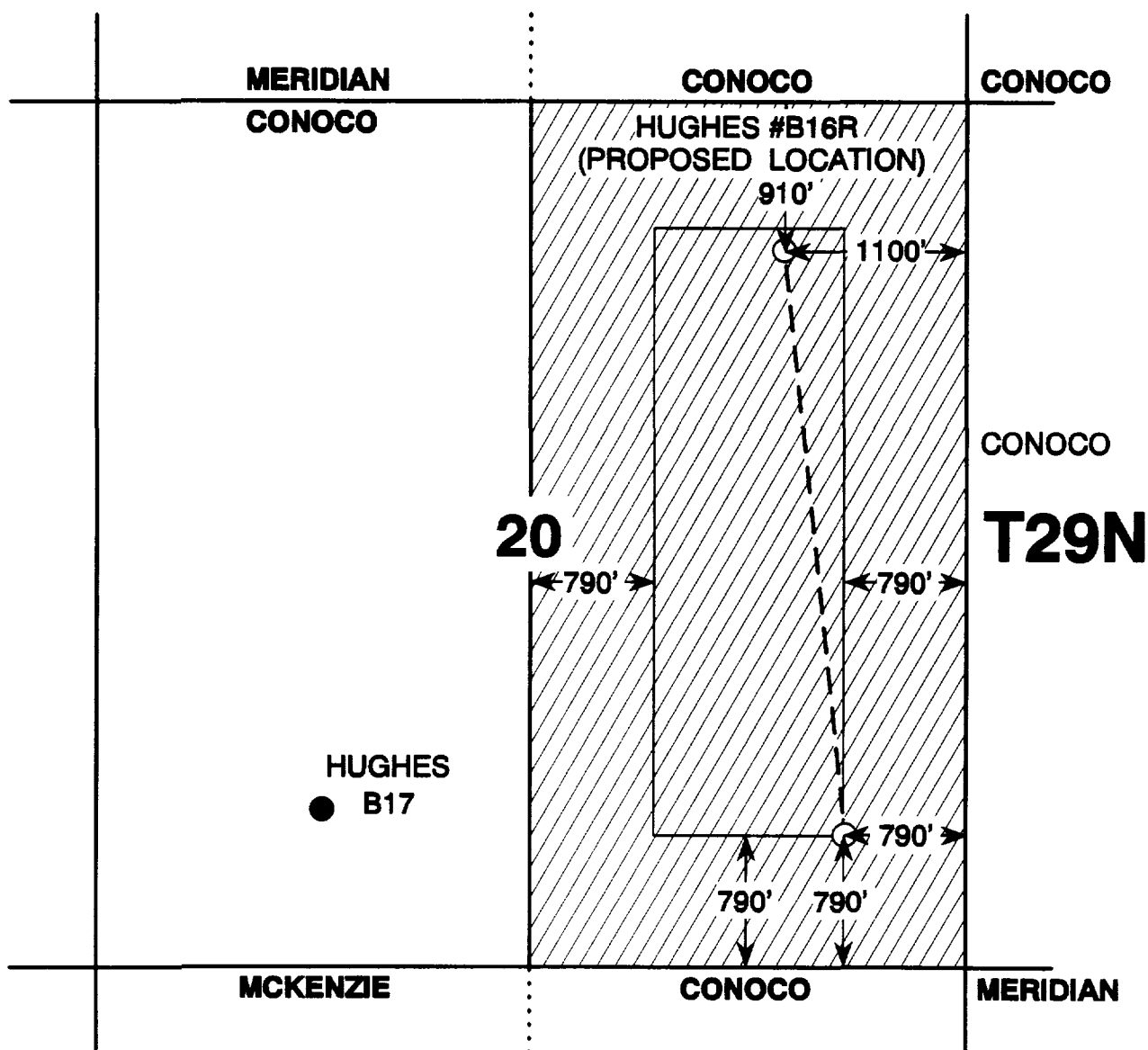

R8W

SAN JUAN CO., N.M.

BEFORE AN EXAMINER OF THE
OIL CONSERVATION DIVISION

EXHIBIT NO. 8
CASE NO.: 10915
Submitted by: Conoco Inc.
Hearing Date: Feb 17, 1994

T29N R8W

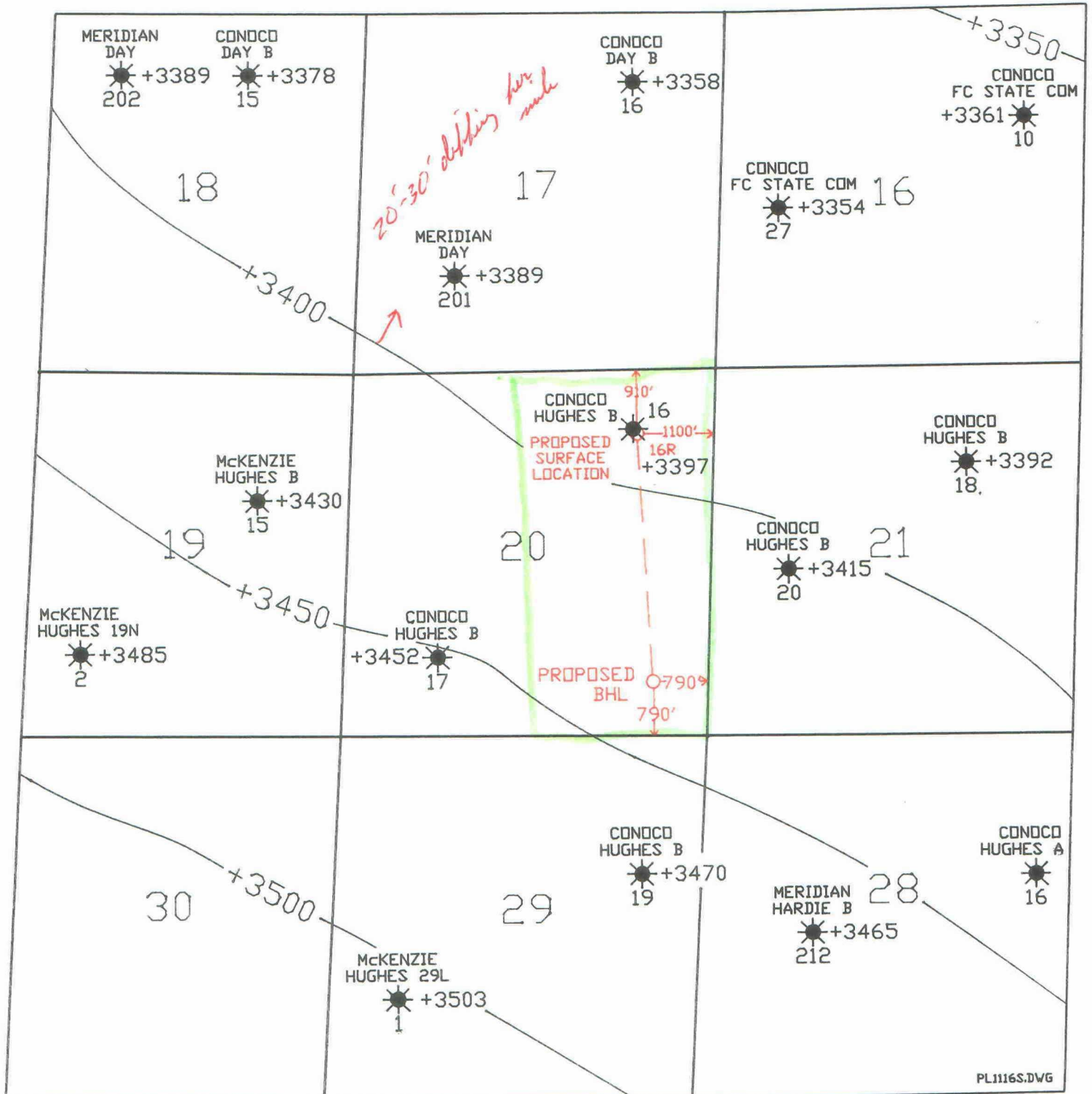

CONOCO
HUGHES B-16R
HORIZONTAL FRUITLAND WELL

STRUCTURE
TOP PICTURED CLIFFS

BEFORE AN EXAMINER OF THE
OIL CONSERVATION DIVISION

EXHIBIT NO. 9
CASE NO.: 10915
Submitted by: Conoco Inc.
Hearing Date: Feb 17, 1994

TYPE LOG
HUGHES B #16
T28N R8W SEC.20
820'FNL 1100'FEL

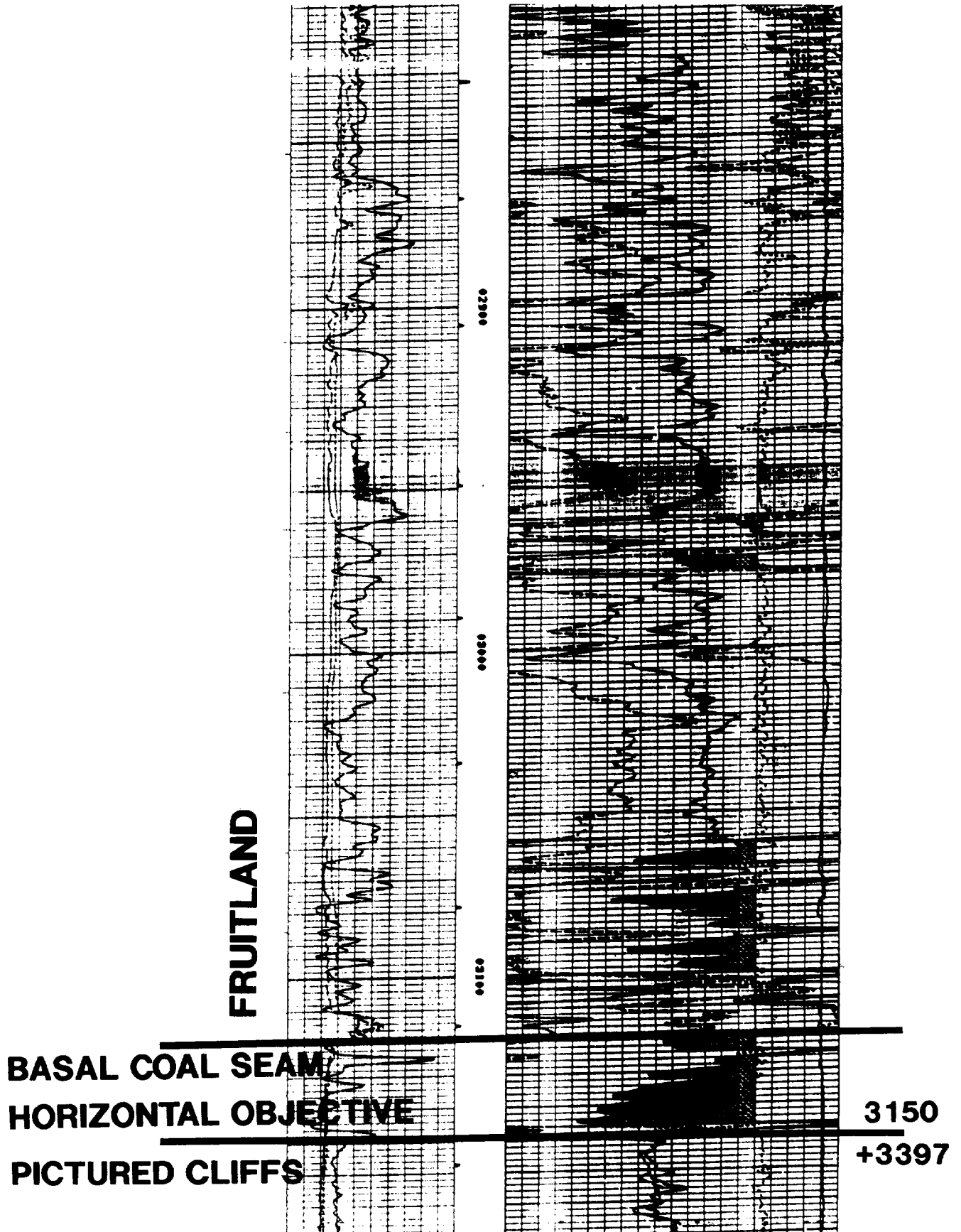

BEFORE AN EXAMINER OF THE
OIL CONSERVATION DIVISION

EXHIBIT NO. 10
CASE NO.: 10915
Submitted by: Conoco Inc.
Hearing Date: Feb 17, 1994

HUGHES B-16R HORIZONTAL PLAN

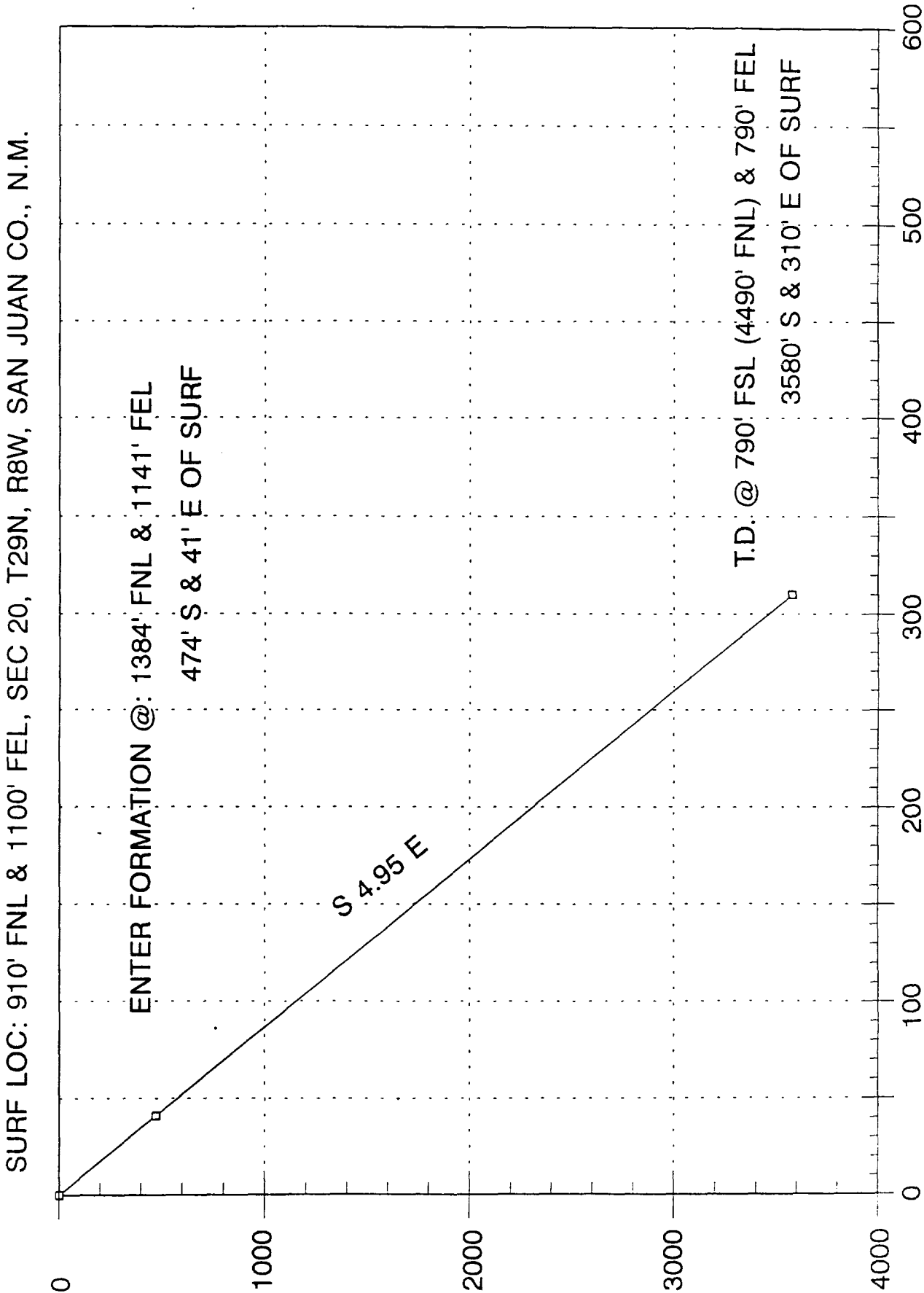

BEFORE AN EXAMINER OF THE
OIL CONSERVATION DIVISION

EXHIBIT NO. 12
CASE NO.: 10915
Submitted by: Conoco Inc.
Hearing Date: Feb 17, 1994

HUGHES B-16R VERTICAL SECTION

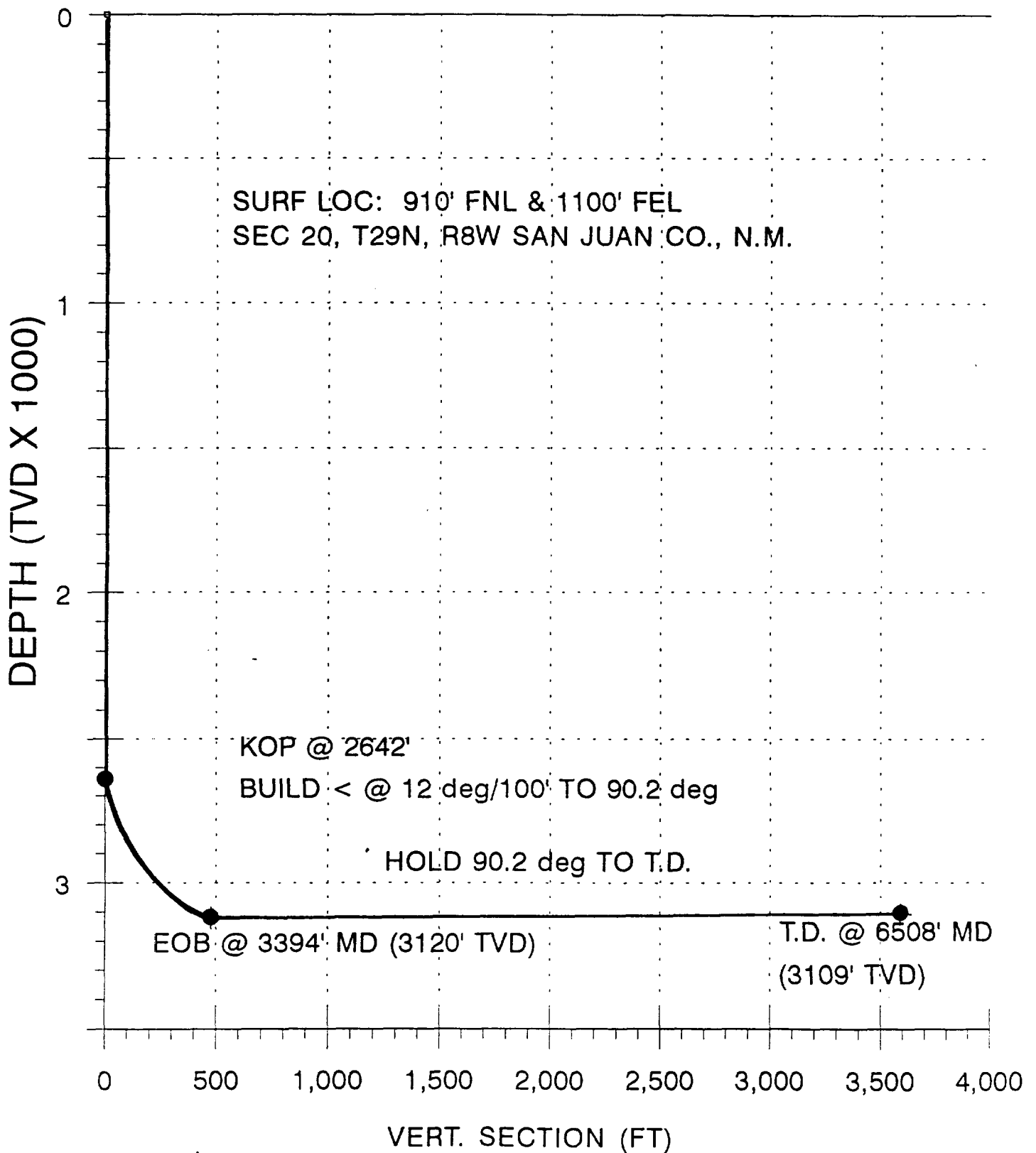

BEFORE AN EXAMINER OF THE
OIL CONSERVATION DIVISION

EXHIBIT NO. 13
CASE NO.: 10915
Submitted by: Conoco Inc.
Hearing Date: Feb 17, 1994

PROPOSED WELL PLAN OUTLINE

WELL NAME: HUGHES B-16R EST. KB = +6547'

LOCATION: 910' FNL & 1100' FEL, SEC 20, T29N, R8W, SAN JUAN CO., N.M.

TVD IN 1000'	MD	FORMATION TOPS & TYPE	DRILLING PROBLEMS	TYPE OF FORMATION EVALUATION	HOLE SIZE	CASING SIZE DEPTH	FRAC GRAD	FORMATION PRESSURE GRADIENT	MUD WT TYPE	DAYS
0					17-1/2"	13-3/8" 54.5# K-55 ST&C @ 250'		NORMAL	8.4 - 8.8# SPUD MUD	
				MUDLOGGERS ON @ 500'	11"			8.4 - 9.5#	8.4 - 10.0# LSD/POLYMER	
1										
		SAN JOSE SANDS @ 1670' (+ 4877')	POSSIBLE LOST CIRC							
		GIAM @ 2110' (+ 4437')	KOP @ 2642' BUILD < @ 12 deg/100' TO 90.2 deg							
2		KIRTLAND @ 2208' (+ 4339')	ROB @ 3398' MD (3120' TVD)							
			POSSIBLE OVERPRESSURE IN FRLD			8-5/8" 32# K-55 BTRC @ 3398'				
3		FLRD @ 2780' (+ 3767')								
		TOP FRLD BASAL SEAM TARGET @ 3120' (+3427')	HOLD 90.2 deg TO T.D. @ 6508' MD (3107' TVD)	MUDLOGGERS	7-7/8"	OPEN-HOLE COMPL T.D. @ 6508' MD (3120' TVD)		8.4 - 9.5#	AIR DRILL	14-15
4										
5										
6										
7										
8										

DATE: JANUARY 1994

PREPARED BY:

BEFORE AN EXAMINER OF THE
OIL CONSERVATION DIVISION

EXHIBIT NO. 14
CASE NO.: 10915
Submitted by: Conoco Inc.
Hearing Date: Feb 17, 1994

OFFSET OPERATORS

Notified by Certified Mail

Meridian Oil Inc.
P.O. Box 4289
Farmington, New Mexico 87499

McKenzie Methane Company,
now operated by :
Quintana Petroleum Corporation
P.O. Box 3331
Houston, Texas 77253

Northwest Pipeline
C/O Williams Production Company
P.O. Box 58900
Salt Lake City, Utah 84158-0900

Southland Royalty Company
C/O Meridian Oil Inc.
P.O. Box 4289
Farmington, New Mexico 87499

Amoco Production Company
P.O. Box 800
Denver, Colorado 80201

Emerald Gas Operating Company
501 West 1-44 Service Road, # 310
Oklahoma City, Oklahoma 73118-6054

Great Western Drilling Company
P.O. Box 1659
Midland, Texas 79701

BEFORE AN EXAMINER OF THE
OIL CONSERVATION DIVISION

EXHIBIT NO. 15
CASE NO.: 10915
Submitted by: Conoco Inc.
Hearing Date: Feb 17, 1994

STATE OF NEW MEXICO
ENERGY, MINERALS AND NATURAL RESOURCES DEPARTMENT
OIL CONSERVATION DIVISION

IN THE MATTER OF THE HEARING CALLED
BY THE OIL CONSERVATION DIVISION
FOR THE PURPOSE OF CONSIDERING:

CASE NO. 10915

APPLICATION OF CONOCO INC.
WILCH A-12 WELL
FOR A HIGH ANGLE/HORIZONTAL
DIRECTIONAL DRILLING PILOT PROJECT,
SPECIAL OPERATING RULES THEREFOR,
AND AND UNORTHODOX PRODUCING INTERVAL,
SAN JUAN COUNTY, NEW MEXICO.

CERTIFICATE OF MAILING

AND

COMPLIANCE WITH ORDER R-8054

W. THOMAS KELLAHIN, attorney in fact and authorized representative of Conoco Inc., states that the notice provisions of Division Rule 1207 (Order R-8054) have been complied with, that Applicant has caused to be conducted a good faith diligent effort to find the correct addresses of all interested parties entitled to receive notice, that on the 25th day of January 1994, I caused to be mailed by certified mail return-receipt requested notice of this hearing and a copy of the application for the above referenced case along with the cover letter, at least twenty days prior to the hearing set for February 17, 1994, to the parties shown in the application as evidenced by the attached copies of return receipt cards, and that pursuant to Division Rule 1207, notice has been given at the correct addresses provided by such rule.

Witnessed By
W. THOMAS KELLAHIN

W. Thomas Kellahin

SUBSCRIBED AND SWORN to before me this 16th day of FEBRUARY,
1994.

Michelle Guadagnoli
Notary Public

My Commission Expires:

June 9, 1997

SENDER:
Conoco Hughes B-16R
1/25/94

irm so that we can

1. also wish to receive the following services (for an extra fee):
1. ☐ Addressee's Address
2. ☐ Restricted Delivery
Consult postmaster for fee.

Write "Return Receipt Requested" on the mailpiece below the article number. The Return Receipt will show to whom the article was delivered and the date delivered.

3. Article Addressed to:
McKenzie Methane
1625 Broadway, Suite 2580
Denver Co. 80201

4a. Article Number
670 814 617

4b. Service Type
☒ Registered ☐ Insured
☐ Certified ☐ COD
☐ Express Mail ☒ Return Receipt for Merchandise

7. Date of Delivery
1-28-94

5. Signature (Addressee)
Monica Reden

6. Signature (Agent)

8. Addressee's Address (Only if requested and fee is paid)

PS Form 3811, December 1991 ★U.S. GPO: 1992-323-402

DOMESTIC RETURN RECEIPT

is your RETURN ADDRESS completed on the back of the mailpiece? **Yes**

Thank you for using Return Receipt Service.

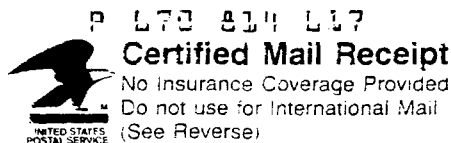

McKenzie Methane
1625 Broadway, Suite 2580
Denver Co. 80201

Postage	\$
Certified Fee	
Special Delivery Fee	
Restricted Delivery Fee	
Return Receipt Showing to Whom & Date Delivered	
Return Receipt Showing to Whom, Date, & Address of Delivery	
TOTAL Postage & Fees	\$

Conoco Hughes B-16R
1/25/94

is your RETURN ADDRESS completed on the reverse side?

SENDER:
Conoco Hughes B-16R
1/25/94

so that we can
back if space

I also wish to receive the
following services (for an extra
fee):
1. ☐ Addressee's Address
2. ☐ Restricted Delivery
Consult postmaster for fee.

Write "Return Receipt Requested" on the mailpiece below the article number.
The Return Receipt will show to whom the article was delivered and the date
delivered.

3. Article Addressed to:
Meridian Oil Inc
P.O. Box 4289
Farmington, New Mexico
87489

4a. Article Number
321 001 119

4b. Service Type
☒ Registered ☐ Insured
☐ Certified ☐ COB
☐ Express Mail ☒ Return Receipt for
Merchandise

7. Date of Delivery
1-27-94

5. Signature (Addressee)

6. Signature (Agent)

8. Addressee's Address (Only if requested
and fee is paid)

PS Form 3811, December 1991 ★U.S. GPO: 1992-323-402 **DOMESTIC RETURN RECEIPT**

Thank you for using Return Receipt Service

P 321 001 119



**Receipt for
Certified Mail**

No Insurance Coverage Provided
Do not use for International Mail
(See Reverse)

Meridian Oil Inc
P.O. Box 4289
Farmington, New Mexico
87489

Special Delivery Fee	
Restricted Delivery Fee	
Return Receipt Showing to Whom & Date Delivered	
Return Receipt Showing to Whom, Date, and Addressee's Address	
TOTAL Postage & Fees	\$2.75
Postmark or Date	

00, June 1991

Conoco Hughes B-16R
1/25/94

PS 1