

CASE NO. 10916
Wilch A #12R

Submitted by: Conoco Inc.
Hearing Date: Feb 17, 1994

CONOCO, INC.

PROPOSED HORIZONTAL FRUITLAND COAL WELL

WILCH # A 12R

SURFACE LOCATION : 1570'FSL 910'FWL
SECTION 23-T29N-R8W

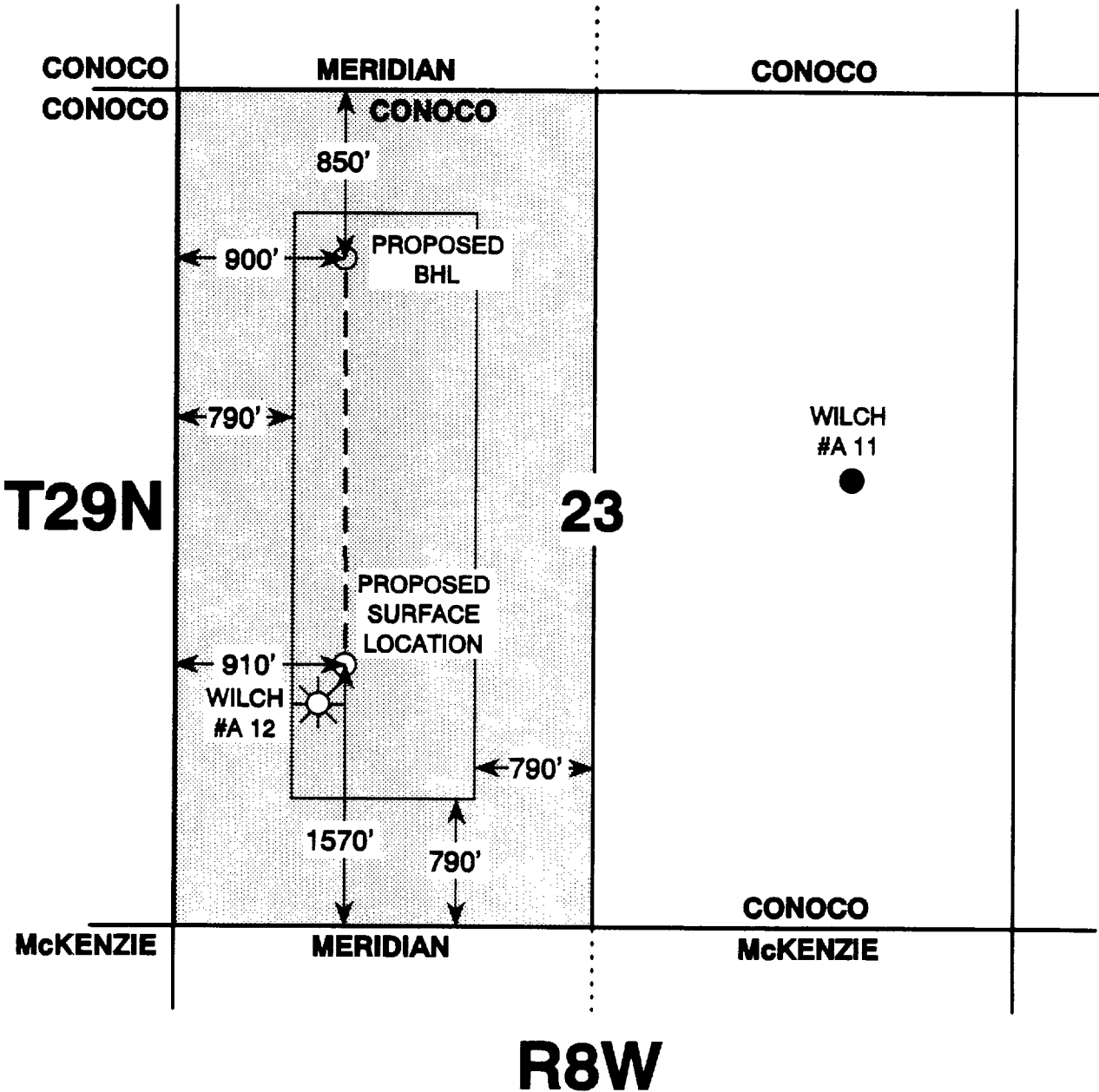

SAN JUAN CO., N.M.

BEFORE AN EXAMINER OF THE
OIL CONSERVATION DIVISION

EXHIBIT NO. 1
CASE NO.: 10916
Submitted by: Conoco Inc.
Hearing Date: Feb 17, 1994

T29N R8W

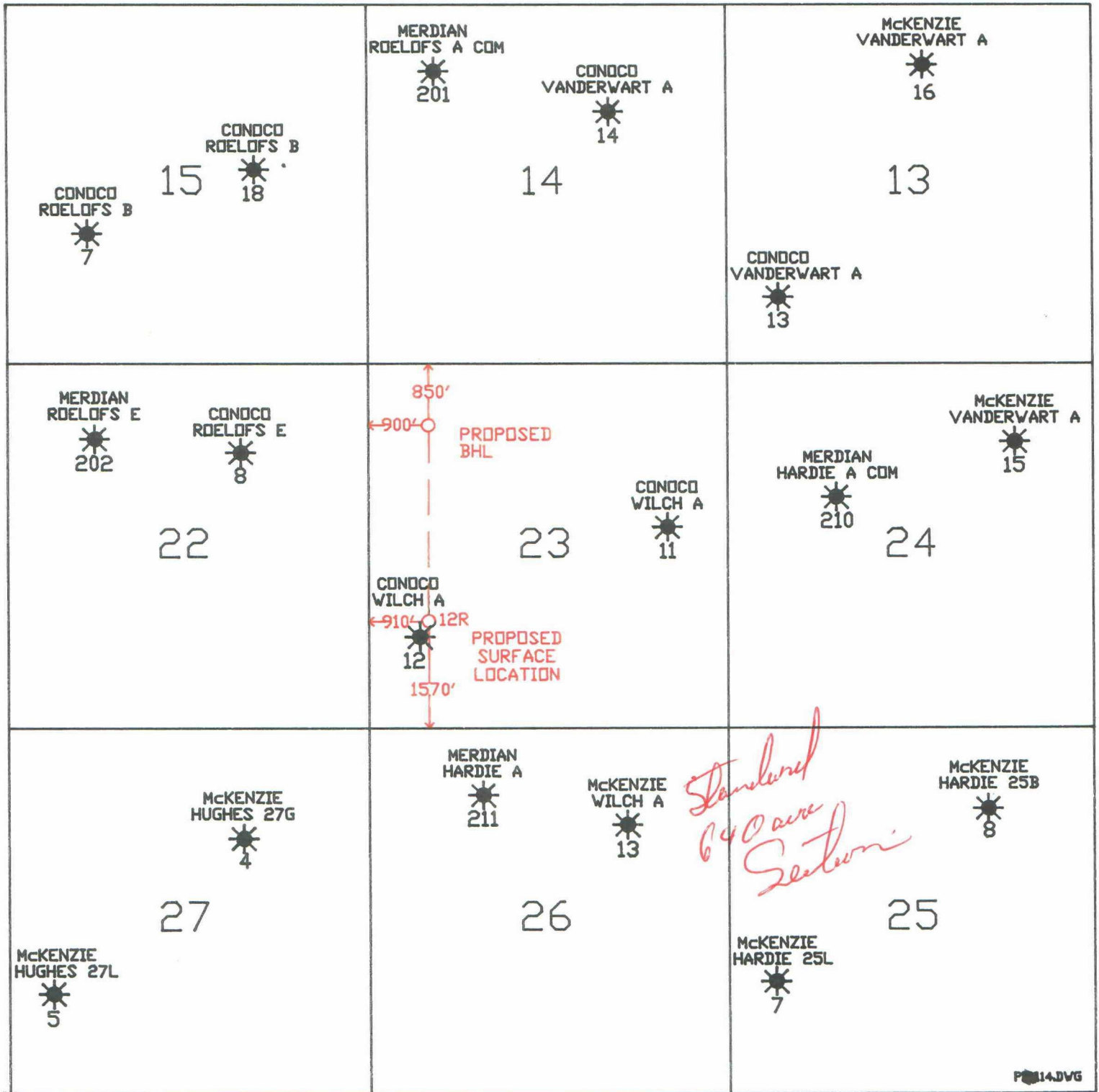

CONOCO
WILCH A-12R
HORIZONTAL FRUITLAND WELL

BEFORE AN EXAMINER OF THE
OIL CONSERVATION DIVISION

EXHIBIT NO. 2
CASE NO.: 10916
Submitted by: Conoco Inc.
Hearing Date: Feb 17, 1994

Wilch A #12R - Sec. 23, T29N, R8W

Offset Well Data for Secs. 13, 14, 15, 22, 24, 25, 27

LEASE	WNUM	OPERATOR	FPDATE	LPDATE	CUMGAS	YTD GAS	MCFD	LOCATION
VANDEWART A	000016	MCKENZIE METHANE COR	9203	9308	46742	18787	74	29N08W13B
VANDEWART A	000013	CONOCO INC	9108	9308	43245	11924	47	29N08W13M
ROELOFS A COM	000201	MERIDIAN OIL INC	8901	9110	127210	0	0	29N08W14D
VANDEWART A	000014	CONOCO INC	9109	9308	40878	10102	40	29N08W14G
ROELOFS B	000018	CONOCO INC	9108	9308	47698	16529	65	29N08W15G
ROELOFS B	000007	CONOCO INC	9103	9308	89903	18819	74	29N08W15L
ROELOFS B	000008	CONOCO INC	9104	9308	85682	14901	59	29N08W22B
ROELOFS E	000202	MERIDIAN OIL INC	8909	9308	156984	16413	65	29N08W22C
WILCH A	000011	CONOCO INC	9109	9308	35118	8089	32	29N08W23H
WILCH A	000012	CONOCO INC	9105	9308	32801	7787	31	29N08W23L
VANDEWART A	000015	MCKENZIE METHANE COR	9204	9308	78326	22554	89	29N08W24A
HARDIE A COM	000210	MERIDIAN OIL INC	8902	9308	418794	6516	26	29N08W24F
HARDIE 25 B	000008	MCKENZIE METHANE COR	9110	9308	47704	11907	47	29N08W25B
HARDIE 25 L	000007	MCKENZIE METHANE COR	9109	9308	65213	14498	57	29N08W25L
WILCH A	000013	MCKENZIE METHANE COR	9109	9308	66569	20013	79	29N08W26B
HARDIE A	000211	MERIDIAN OIL INC	8907	9308	65028	5313	21	29N08W26C
HUGHES 27 G	000004	MCKENZIE METHANE COR	9201	9308	31235	9952	39	29N08W27G
HUGHES 27L	000005	MCKENZIE METHANE COR	9108	9308	143066	36210	143	29N08W27L

BEFORE AN EXAMINER OF THE
OIL CONSERVATION DIVISION

EXHIBIT NO. 3
CASE NO.: 10916
Submitted by: Conoco Inc.
Hearing Date: Feb 17, 1994

T29N R8W

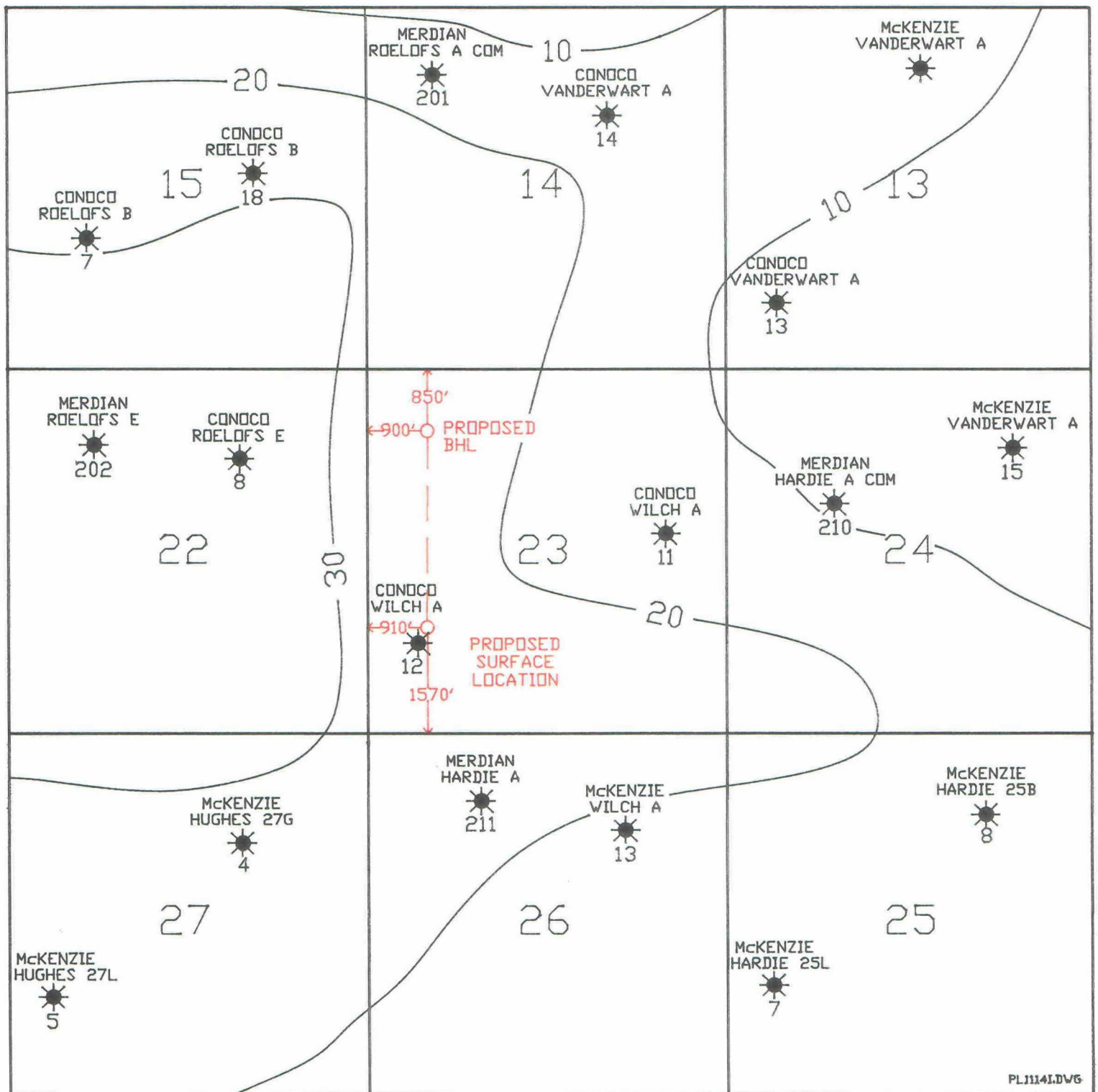

BEFORE AN EXAMINER OF THE
OIL CONSERVATION DIVISION

EXHIBIT NO. 5
CASE NO.: 10916
Submitted by: Conoco Inc.
Hearing Date: Feb 17, 1994

METHANE ADSORPTION ISOTHERM

CONOCO INC.

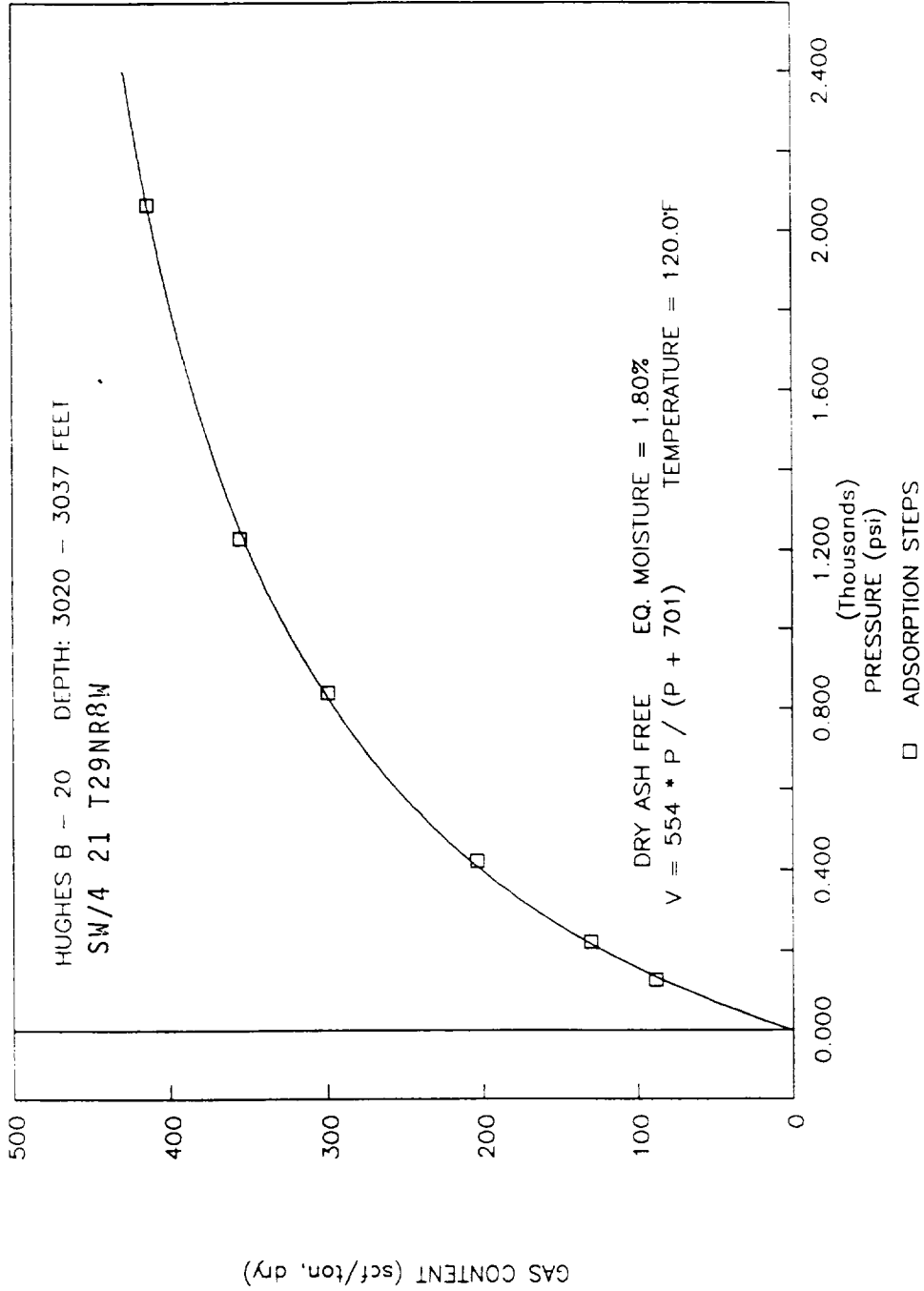

BEFORE AN EXAMINER OF THE
OIL CONSERVATION DIVISION

EXHIBIT NO. 6
CASE NO.: 10916
Submitted by: Conoco Inc.
Hearing Date: Feb 17, 1994

Conventional and Coalbed Gas Storage and Flow Systems



Processes in the Transport of Coalbed Methane Gas

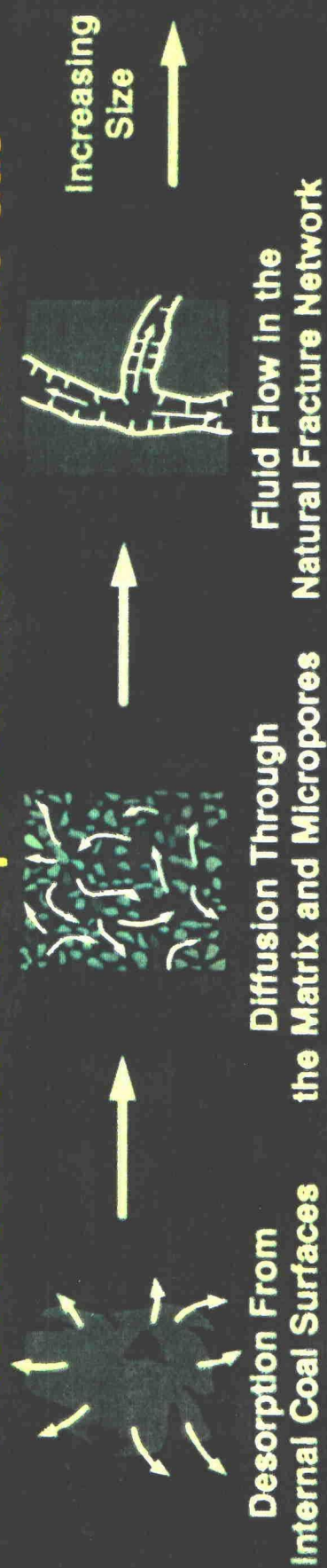

BEFORE AN EXAMINER OF THE
OIL CONSERVATION DIVISION

EXHIBIT NO. 7
CASE NO.: 10916
Submitted by: Conoco Inc.
Hearing Date: Feb 17, 1994

CONOCO, INC.

PROPOSED HORIZONTAL FRUITLAND COAL WELL

WILCH # A 12R

ANTICIPATED FACE CLEAT ORIENTATION
FRUITLAND COAL

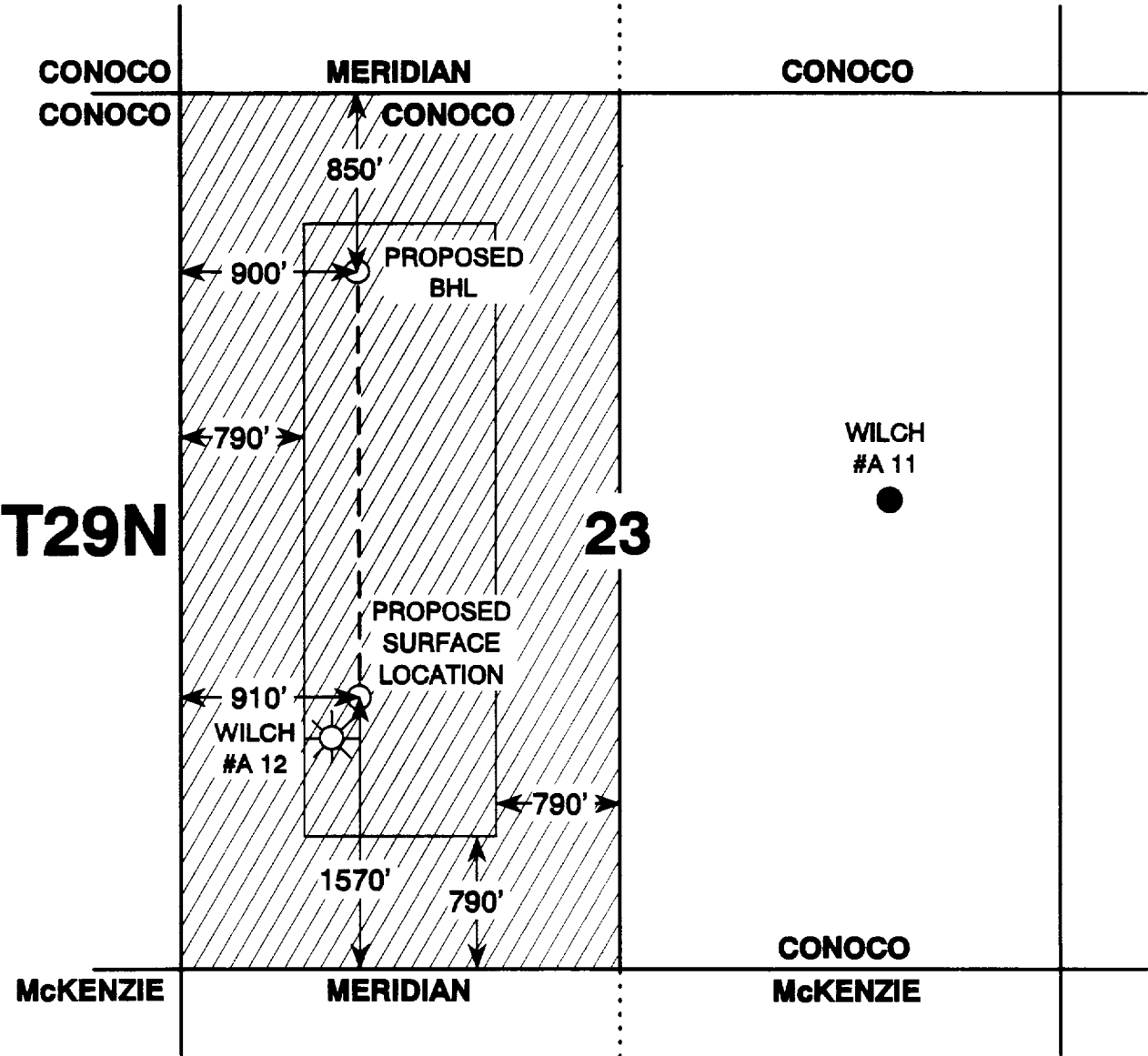

R8W

SAN JUAN CO., N.M.

BEFORE AN EXAMINER OF THE
OIL CONSERVATION DIVISION

EXHIBIT NO. 8
CASE NO.: 10916
Submitted by: Conoco Inc.
Hearing Date: Feb 17, 1994

T29N R8W

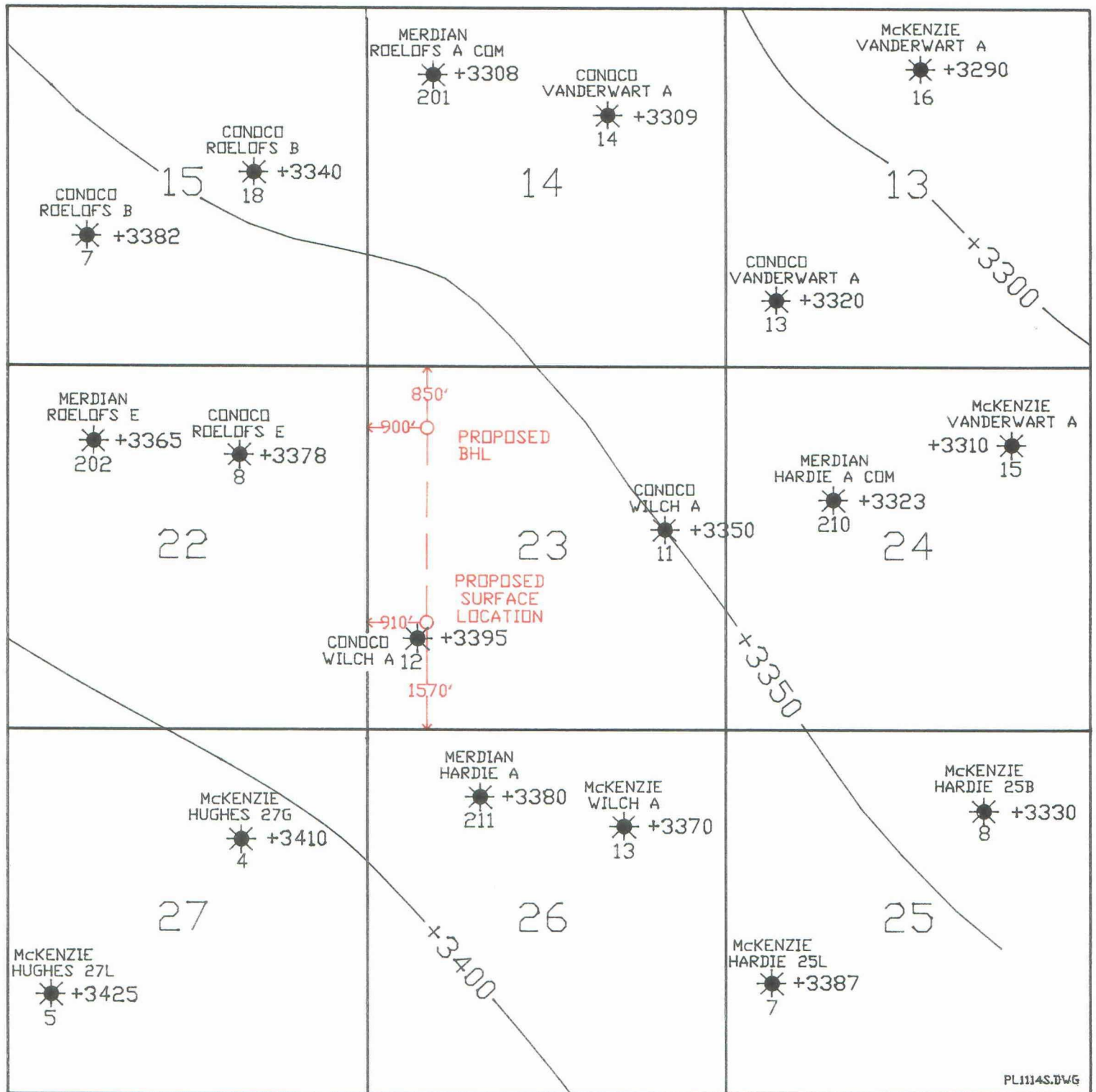

CONOCO
WILCH A-12R
HORIZONTAL FRUITLAND WELL

STURCTURE
TOP PICTURED CLIFFS

BEFORE AN EXAMINER OF THE
OIL CONSERVATION DIVISION

EXHIBIT NO. 9
CASE NO.: 10916
Submitted by: Conoco Inc.
Hearing Date: Feb 17, 1994

TYPE LOG
WILCH A #12
T29N R8W SEC.23
1490'FSL 910'FWL

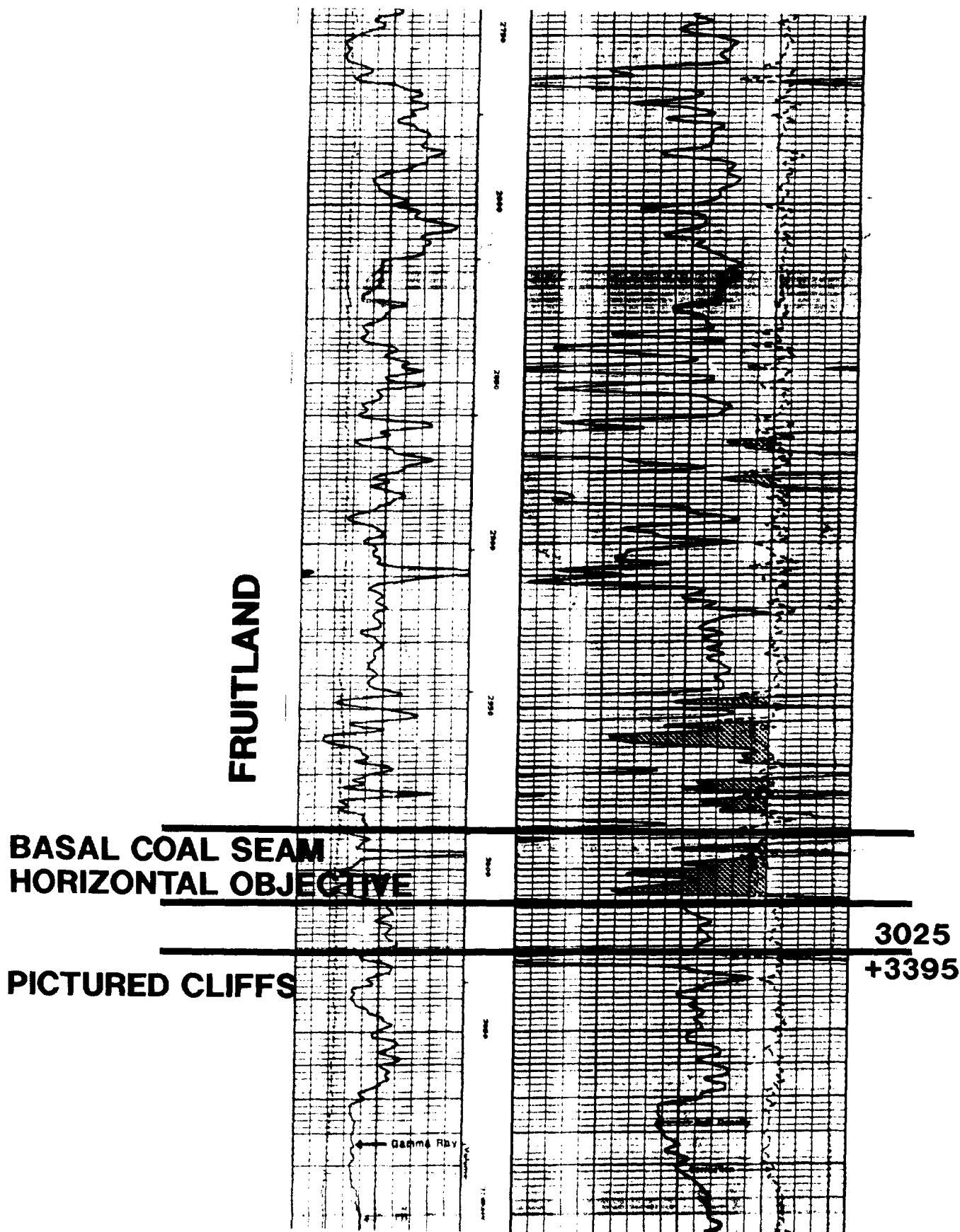

BEFORE AN EXAMINER OF THE
OIL CONSERVATION DIVISION

EXHIBIT NO. 10
CASE NO.: 10916
Submitted by: Conoco Inc.
Hearing Date: Feb 17, 1994

1570' FSL & 910' FWL

2046' FSL & 908' FWL

850' FNL (4430' FSL) & 900' FWL

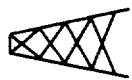

13 5/8 @ 250'

KICK-OFF POINT
@ 2514'

BUILD ANGLE @ 12 DEG/100 FT

8 5/8" SET IN TARGET ZONE

7-7/8" LATERAL @ 89.9 DEGREES

TOP OF FRUITLAND FORMATION
@ 2770'

TOP OF BASAL SEAM @ 2980'

BOTTOM OF BASAL SEAM
@ 3010'

END OF BUILD
@ 2992' (3263' M.D.)

PL1119

NOT TO SCALE

TOTAL DEPTH
@ 3000' (5647' M.D.)

WILCH A-12R
HORIZONTAL PROSPECT
SECTION VIEW

TOP FC @ 2780'

TOP BS @ 3000'

BOTTOM BS @ 3020'

BEFORE AN EXAMINER OF THE
OIL CONSERVATION DIVISION

EXHIBIT NO. 11
CASE NO.: 10916
Submitted by: Conoco Inc.
Hearing Date: Feb 17, 1994

WILCH A-12R HORIZONTAL PLAN

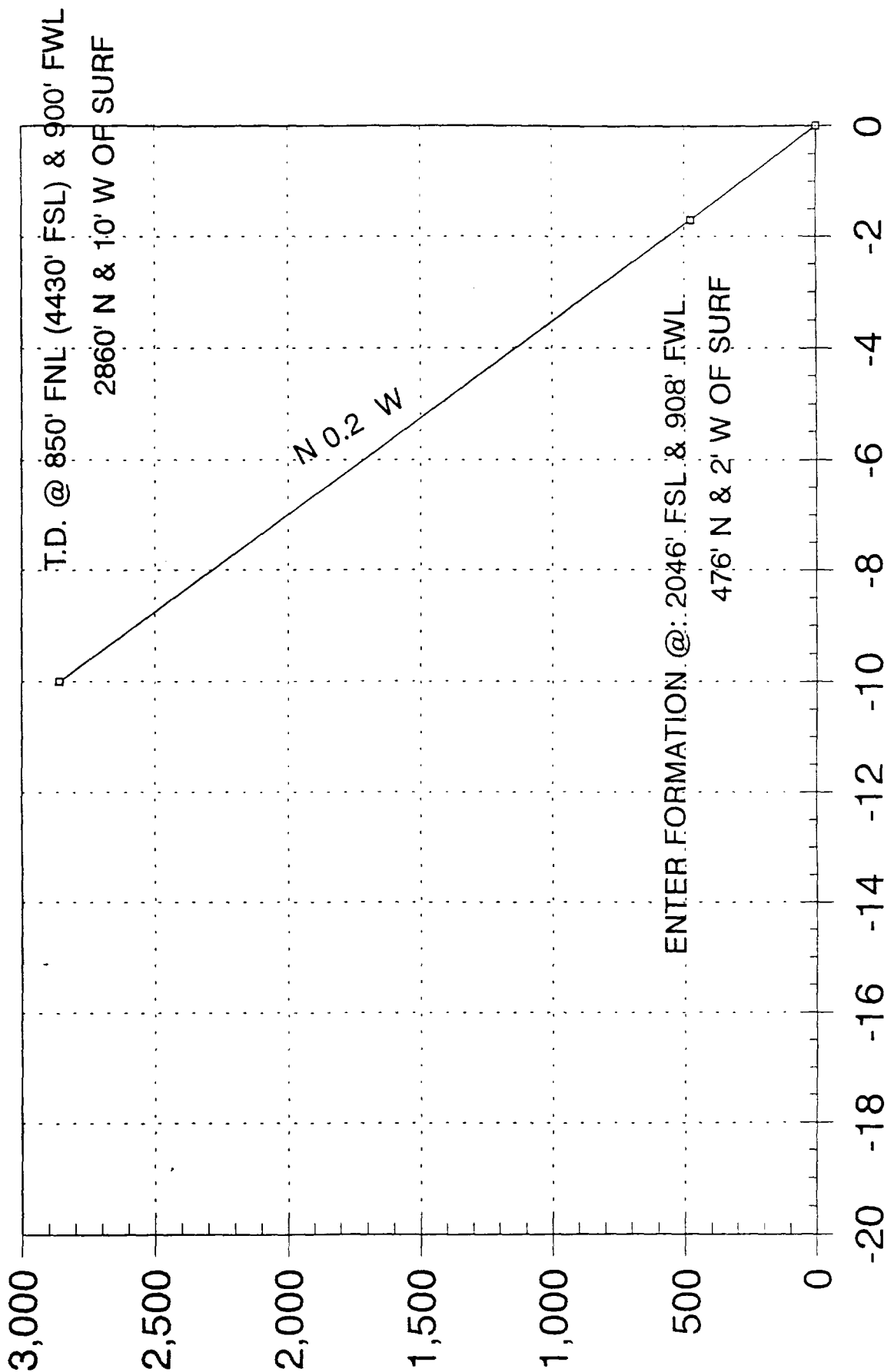

SURF LOC: 1570' FSL & 910' FWL, SEC 23, T29N, R8W, SAN JUAN CO., NM

BEFORE AN EXAMINER OF THE
OIL CONSERVATION DIVISION

EXHIBIT NO. 12
CASE NO.: 10916
Submitted by: Conoco Inc.
Hearing Date: Feb 17, 1994

WILCH A-12R VERTICAL SECTION

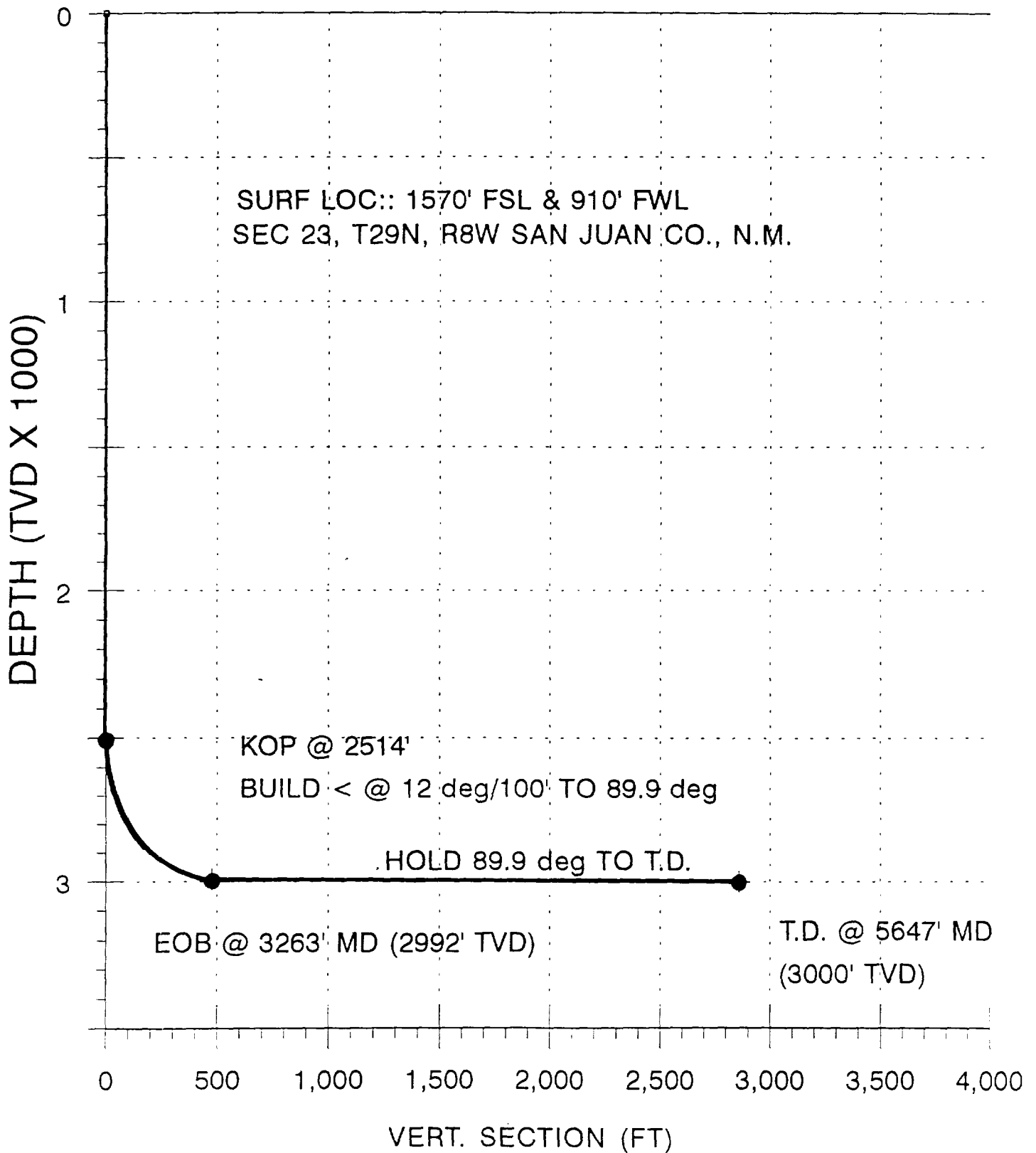

BEFORE AN EXAMINER OF THE
OIL CONSERVATION DIVISION

EXHIBIT NO. 13
CASE NO.: 10916
Submitted by: Conoco Inc.
Hearing Date: Feb 17, 1994

PROPOSEDWELL PLAN OUTLINE

WELL NAME: WILCH A-12R
LOCATION: 1570' F8L & 910' FWL, SEC 23, T29N, R8W, SAN JUAN CO., N.M.

EST. KB = +6425'

TVD IN 1000'	MD	FORMATION TOPS & TYPE	DRILLING PROBLEMS	TYPE OF FORMATION EVALUATION	HOLE SIZE	CASING SIZE DEPTH	FRAC GRAD	FORMATION PRESSURE GRADIENT	MUD WT TYPE	DAYS
0					17-1/2	13-3/8 545# K-35 ST&C @ 250'		NORMAL	8.4 - 8.8# SFUD MUD	
1				MUDLOGGERS ON @ 500'	11"			8.4 - 9.5#	8.4 - 10.0# LIND/POLYMER	
2		SAN JOSE SANDS @ 1780' (+ 465') OJAM @ 2245' (+ 4180') KIRTLAND @ 2280' (+ 4105')	POSSIBLE LOST CIRC KOP @ 2514' BUILD < @ 12 deg/100' TO 69.9 deg EOL @ 3248' MD (2992' TVD)							
3		FLD @ 2770' (+ 3685')	POSSIBLE OVERPRESSURE IN FLD			8-5/8 32# K-35 BTRC @ 3265'				
4		TOP FLD BASAL SEAM TARGET @ 2990' (+3433')	HOLD 89.9 deg TO T.D. @ 5647' MD (3000' TVD)	MUDLOGGERS	7-7/8	OPEN-HOLE COMPL T.D. @ 5647' MD (3000' TVD)		8.4 - 9.5#	AIR DRILL	
5										
6										
7										
8										

DATE: JANUARY 1994

PREPARED BY:

BEFORE AN EXAMINER OF THE
OIL CONSERVATION DIVISION

EXHIBIT NO. 14
CASE NO.: 10916
Submitted by: Conoco Inc.
Hearing Date: Feb 17, 1994

OFFSET OPERATORS

Notified by Certified Mail

Meridian Oil Inc.
P.O. Box 4289
Farmington, New Mexico 87499

McKenzie Methane Company,
now operated by :
Quintana Petroleum Corporation
P.O. Box 3331
Houston, Texas 77253

Northwest Pipeline
C/O Williams Production Company
P.O. Box 58900
Salt Lake City, Utah 84158-0900

Southland Royalty Company
C/O Meridian Oil Inc.
P.O. Box 4289
Farmington, New Mexico 87499

Amoco Production Company
P.O. Box 800
Denver, Colorado 80201

Emerald Gas Operating Company
501 West 1-44 Service Road, # 310
Oklahoma City, Oklahoma 73118-6054

Great Western Drilling Company
P.O. Box 1659
Midland, Texas 79701

BEFORE AN EXAMINER OF THE
OIL CONSERVATION DIVISION

EXHIBIT NO. 15
CASE NO.: 10916
Submitted by: Conoco Inc.
Hearing Date: Feb 17, 1994

STATE OF NEW MEXICO
ENERGY, MINERALS AND NATURAL RESOURCES DEPARTMENT
OIL CONSERVATION DIVISION

IN THE MATTER OF THE HEARING CALLED
BY THE OIL CONSERVATION DIVISION
FOR THE PURPOSE OF CONSIDERING:

CASE NO. 10916

APPLICATION OF CONOCO INC.
WILCH A-12 WELL
FOR A HIGH ANGLE/HORIZONTAL
DIRECTIONAL DRILLING PILOT PROJECT,
SPECIAL OPERATING RULES THEREFOR,
AND AND UNORTHODOX PRODUCING INTERVAL,
SAN JUAN COUNTY, NEW MEXICO.

CERTIFICATE OF MAILING

AND

COMPLIANCE WITH ORDER R-8054

W. THOMAS KELLAHIN, attorney in fact and authorized representative of Conoco Inc., states that the notice provisions of Division Rule 1207 (Order R-8054) have been complied with, that Applicant has caused to be conducted a good faith diligent effort to find the correct addresses of all interested parties entitled to receive notice, that on the 25th day of January 1994, I caused to be mailed by certified mail return-receipt requested notice of this hearing and a copy of the application for the above referenced case along with the cover letter, at least twenty days prior to the hearing set for February 17, 1994, to the parties shown in the application as evidenced by the attached copies of return receipt cards, and that pursuant to Division Rule 1207, notice has been given at the correct addresses provided by such rule.

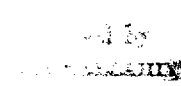

W. Thomas Kellahin

SUBSCRIBED AND SWORN to before me this 16th day of FEBRUARY,
1994.



Notary Public

My Commission Expires:

June 9, 1994

P 321 001 118



**Receipt for
Certified Mail**

No Insurance Coverage Provided
Do not use for International Mail
(See Reverse)

Meridian Oil Inc
P.O. Box 4289
Farmington, New Mexico
87489

100, June 1991

Certified Fee	
Special Delivery Fee	
Restricted Delivery Fee	
Return Receipt Showing to Whom & Date Delivered	
Return Receipt Showing to Whom, Date, and Addressee's Address	
TOTAL Postage & Fees	\$2.75
Postmark or Date	

Conoco Wilch 1-12
1/25/94

your RETURN ADDRESS completed on the reverse side?

SENTED

Conoco Wilch 1-12
1/25/94

- Attach this form to the front of the mailpiece, or on the back if space does not permit.
- Write "Return Receipt Requested" on the mailpiece below the article number.
- The Return Receipt will show to whom the article was delivered and the date delivered.

3. Article Addressed to:

McKenzie Methane
1625 Broadway, Suite 2580
Denver Co. 80201

5. Signature (Addressee)

6. Signature (Agent)

that we can

I also wish to receive the following services (for an extra fee):

- ☐ Addressee's Address
- ☐ Restricted Delivery

Consult postmaster for fee.

4a. Article Number

321 001 117

4b. Service Type

- ☒ Registered ☐ Insured
☐ Certified ☐ COD
☐ Express Mail ☐ Return Receipt for Merchandise

7. Date of Delivery

1-28-94

8. Addressee's Address (Only if requested and fee is paid)

Thank you for using Return Receipt Service.

P 321 001 117



**Receipt for
Certified Mail**

No Insurance Coverage Provided
Do not use for International Mail
(See Reverse)

McKenzie Methane
1625 Broadway, Suite 2580
Denver Co. 80201

PS Form 3800, June 1991

Certified Fee	
Special Delivery Fee	
Restricted Delivery Fee	
Return Receipt Showing to Whom & Date Delivered	
Return Receipt Showing to Whom, Date, and Addressee's Address	
TOTAL Postage & Fees	\$
Postmark or Date	

Conoco Wilch 1-12
1/25/94

SENDER: Conoco Wilch 1-12 1/25/94		I also wish to receive the following services (for an extra fee): 1. <input type="checkbox"/> Addressee's Address 2. <input type="checkbox"/> Restricted Delivery Consult postmaster for fee.	
3. Article Addressed to: Meridian Oil Inc P.O. Box 4289 Farmington, New Mexico 87489		4a. Article Number 321 001 118	
5. Signature (Addressee) [Signature]		4b. Service Type <input checked="" type="checkbox"/> Registered <input type="checkbox"/> Insured <input type="checkbox"/> Certified <input type="checkbox"/> CDD <input type="checkbox"/> Express Mail <input type="checkbox"/> Return Receipt for Merchandise	
6. Signature (Agent) [Signature]		7. Date of Delivery 1-27-94	
		8. Addressee's Address (Only if requested and fee is paid)	
PS Form 3811, December 1991 ★U.S. GPO: 1992-323-402 DOMESTIC RETURN RECEIPT			

Is your RETURN ADDRESS completed on the reverse?

Thank you for using Return Receipt Service.