

S. P. YATES

OIL OPERATOR AND PRODUCER

YATES BUILDING - 207 SOUTH 4TH STREET

ARTESIA, NEW MEXICO - 88210

December 15, 1969

Mr. A. L. Porter, Jr., Secretary - Director
Oil Conservation Commission
P. O. Box 2088
Santa Fe, New Mexico

Re: Expansion of S. P. Yates
West McMillan Anderson
Pressure Maintenance Pro-
ject, Order No. R-3852

Dear Mr. Porter:

Application is hereby submitted seeking administrative approval for expansion of the West McMillan Anderson Pressure Maintenance Project by completing the Anderson No. 3 well for injection of water into the Queen Formation. The Anderson No. 3 is located 2310 feet from the East line and 990 feet from the South line of Section 11, Township 20 South, Range 26 East, NMPM, Eddy County, New Mexico, and is presently shut in.

The proposed conversion is submitted in the interest of conservation and should result in greater ultimate recovery of oil, thereby preventing waste. The anticipated rate of injection is 20 BWPD at 400 psi through 2 3/8-inch coated tubing and packing at about 480', open hole pay at 531 feet to 539 feet.

The pressure maintenance project was initiated on November 23, 1969, in accordance with the provisions set out in Order No. R-3852, Case No. 4225, by injecting water into Anderson

DOCKET MAILED

Date 1-9-70

Mr. A. L. Porter, Jr., Secretary - Director
December 15, 1969
Page 2

No. 2, and is already showing a 1 BOPD increase in production from Anderson No. 1. You will note that the production for Anderson No. 1 for the month of October was 60 BO, was 80 BO for the month of November, and has produced approximately 4 BOPD for the first two weeks of December.

Offset Operator and USGS are notified of this intention by copy of this letter.

Thank you.

Yours very truly,

Eddie L. Lutz

for S. P. Yates

SPY/pt

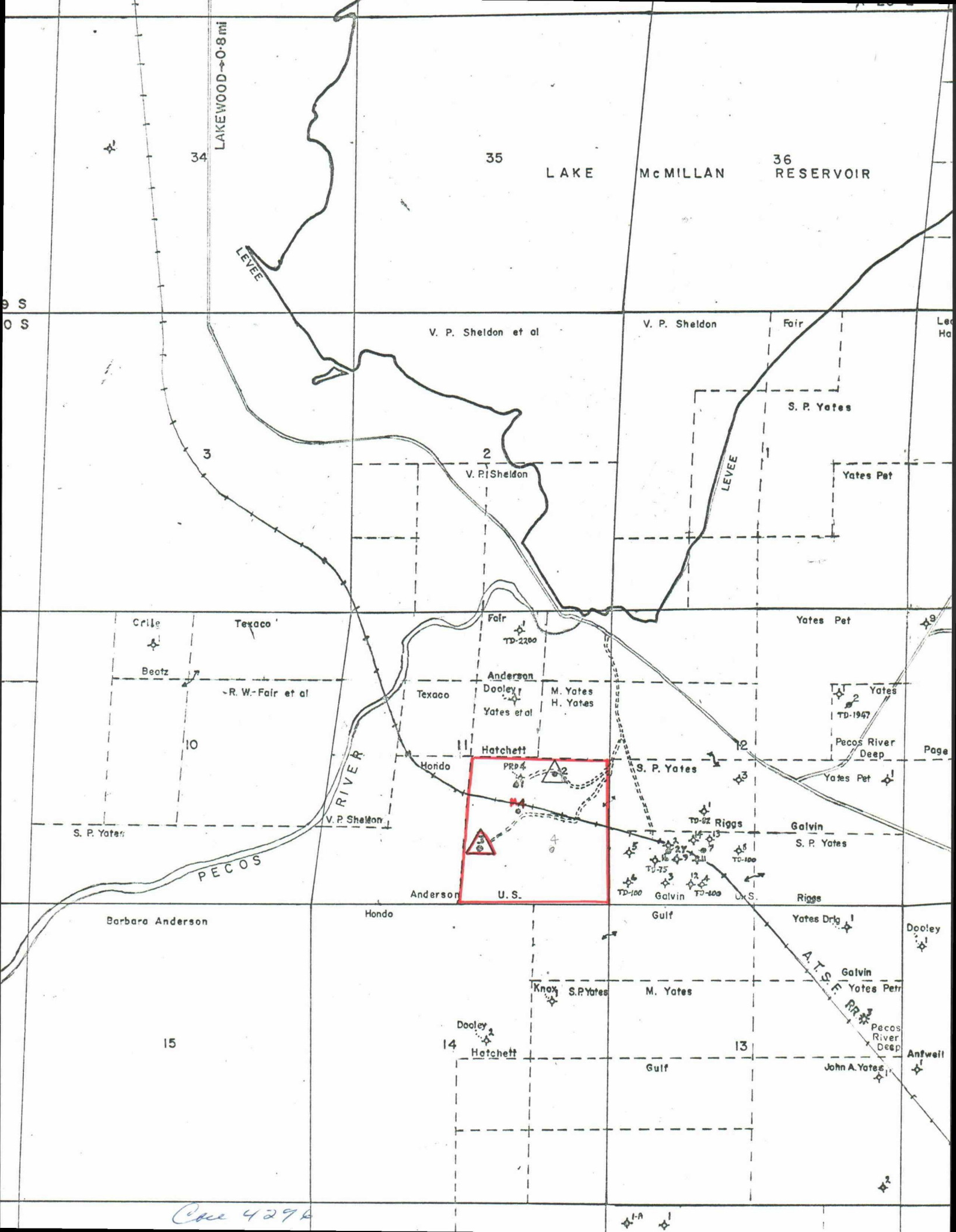

S.P. Yates - Anderson #3

2310 Pct. 900 fsl.
Eddy County, New
9-30-69

Sec 11-205-266

9412/100
Blow - 3281 ft

Correlation Log - ARSN

Neutron Scan 5 divergence left

No fluid in hole

Queen - +2834

Base 2nd Queen

Top 2nd Queen

5 1/2'

550

200

450

Cement
Sheath

1st
Fog good oil str.

v.f.g. oil. cem. oil str.

Total Depth Drilled - 556'

15
10
5

DIAGRAMMATIC SKETCH OF INJECTION WELL

S. P. Yates - Anderson No. 3
2310/E 990/S Unit 0-11-20-26
McMillan West, S.R.-Qn Pool
Eddy County, New Mexico

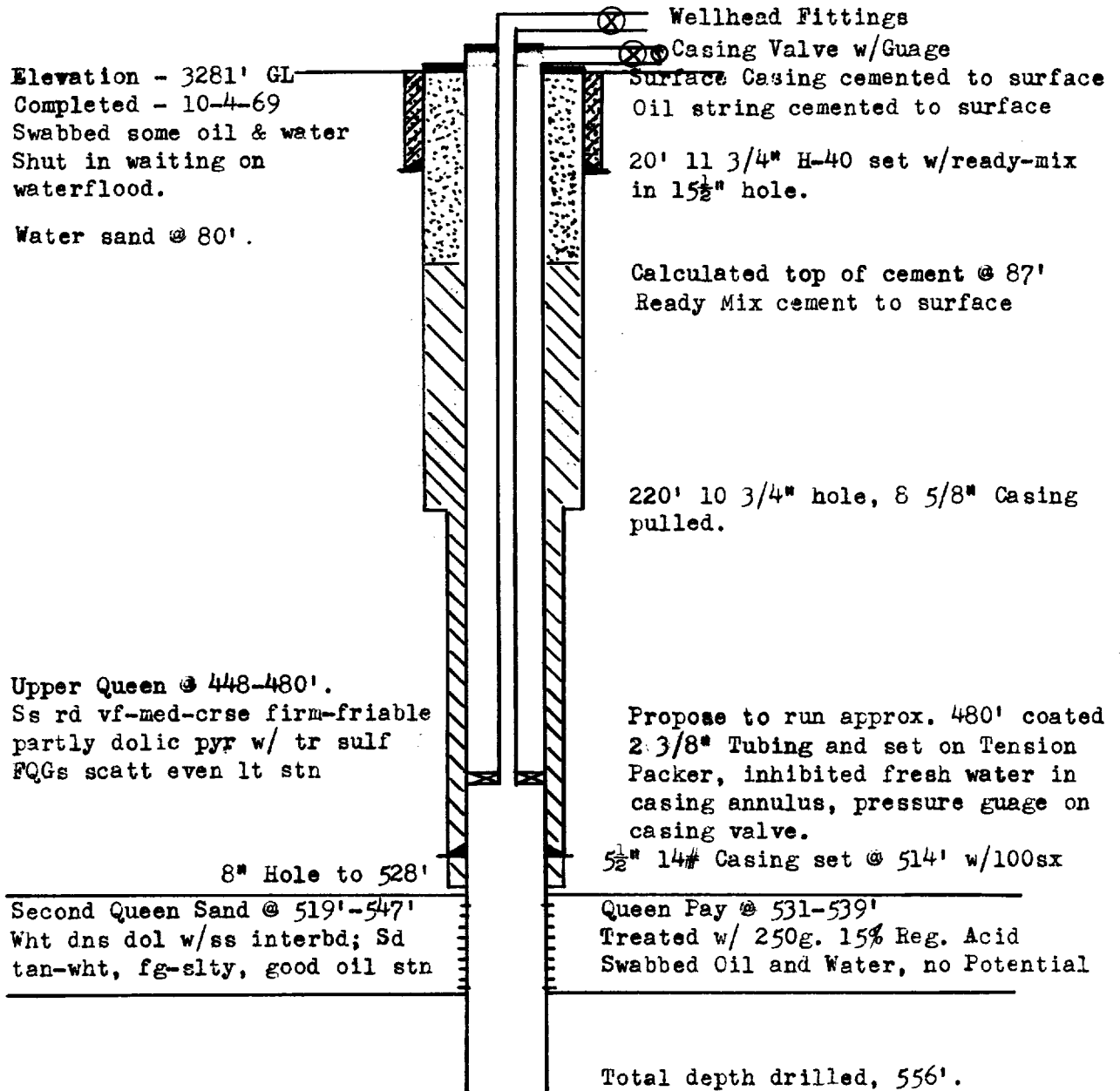

Case 4242

MONTHLY PRODUCTION REPORT

Case
4244.

LEASE Spryates FIELD Anderson #1 MONTH OF Nov 1969

TEST		GAUGES								Corrected GAUGES								DELIVERED							
DATE	TANK NO.	YES'DAY		TODAY		TOTAL		TOTAL BBLs.	TANK NO.	YES'DAY		TODAY		TOTAL		TOTAL BBLs.	TICKET NO.	FROM		TO		NET BBLs.			
		FT.	IN.	FT.	IN.	FT.	IN.			FT.	IN.	FT.	IN.	FT.	IN.			FT.	IN.						
1		7	3							7	0														
2																									
3		7	9							7	5														
4																									
5		8	2							7	10														
6																									
7		8	8							8	3														
8																									
9		9	2							8	8														
10																									
11		9	7							9	1														
12																									
13		10	1							9	6														
14																									
15		10	7							9	11														
16																									
17		11	-							10	4														
18																									
19		11	6							10	9														
20																									
21		12	-							11	2														
22		Electricity off								Electricity off															
23										Electricity off															
24		12	3							11	4 1/2														
25																									
26		12	9							11	9														
27																									
28		13	3							12	2 1/2														
29																									
30		13	8							12	8														
31																									

REMARKS:

12/1/69 Drained 1 foot BS & W

SHUT DOWN TIME:

Elec off 48 hrs. Nov 22 & 23.

FOR OFFICE USE ONLY

OPEN BALANCE 96.0 BBLs.

28 days

PRODUCTION 90.2 BBLs.

OIL SHIPPED BBLs.

CLOSING BALANCE 176.2 BBLs.

9518 - ARTESIA PRINTING CO.

Prepared by: Eddie L. Hallford from pumpers daily reports.

MONTHLY PRODUCTION REPORT

Case 4296

LEASE S. P. Yates

FIELD Anderson #1

MONTH OF December 1969

DATE	TANK NO.	GAUGES								TANK NO.	GAUGES								DELIVERED						
		YES'DAY		TODAY		TOTAL		TOTAL BBLs.	YES'DAY		TODAY		TOTAL		TOTAL BBLs.	TICKET NO.	FROM		TO		NET BBLs.				
		FT.	IN.	FT.	IN.	FT.	IN.		FT.		IN.	FT.	IN.	FT.			IN.	FT.	IN.						
1		14	0																						
2		Drained 1 foot BSW																							
3		13	4	- Down - fuse out																					
4		13	8																						
5		Elec off																							
6		Elec off																							
7		14	0																						
8		14	4																						
9		14	8																						
10		Shut in																							
11		Shut in - drained 4" BSW																							
12		14	8																						
13		15	0																						
14		Shut in - tank full																							
15																									
16																									
17																									
18																									
19																									
20																									
21																									
22																									
23																									
24																									
25																									
26																									
27																									
28																									
29																									
30																									
31																									

REMARKS:

SHUT DOWN TIME:

Fuse burnt out Dec 3 - REA
off Dec 5 & 6. Shut in Dec 10 & 11

FOR OFFICE USE ONLY

OPEN BALANCE 176.2 BBLS.

8 days PRODUCTION 30.8 BBLS.

OIL SHIPPED BBLS.

CLOSING BALANCE 207.0 BBLS.

Prepared by Eddie Lee checked from pumpers daily reports.