

Griffin, Ross & Burnett, Inc.

Oil Properties

KENNETH H. GRIFFIN
ROBERT B. ROSS
GARY G. BURNETT

2102 WILCO BUILDING
MIDLAND, TEXAS 79701
915 683-2705

April 17, 1974

Re: File No. 2293
Nash Unit
Eddy County, New Mexico

NEW MEXICO OIL CONSERVATION COMMISSION
State Land Office Building
Santa Fe, New Mexico 87501

Attention: Mrs. Ida Rodriquez

Gentlemen:

In behalf of Mesa Petroleum Company it is requested that the subject unit be included on the May 8, 1974, schedule for a hearing to approve same.

This unit, as outlined on the attached plat, covers 5,123.57 acres and is being formed for exploratory purposes. The character of ownership is as follows:

<u>OWNER</u>	<u>ACRES</u>	<u>PERCENTAGE</u>
USA	4,843.11	94.53
State of New Mexico	240.46	4.69
Fee	40.00	.78
	5,123.57	100.00%

Please advise if any additional information is needed prior to the hearing.

Yours very truly,

GRIFFIN, ROSS & BURNETT, INC.

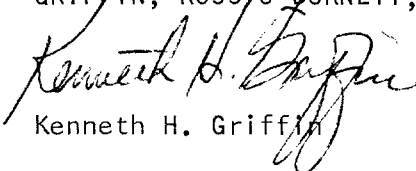
Kenneth H. Griffin

KHG:mw
Attach.

cc: Mr. Robert H. Northington
MESA PETROLEUM COMPANY
904 Gihls Tower West
Midland, Texas 79701

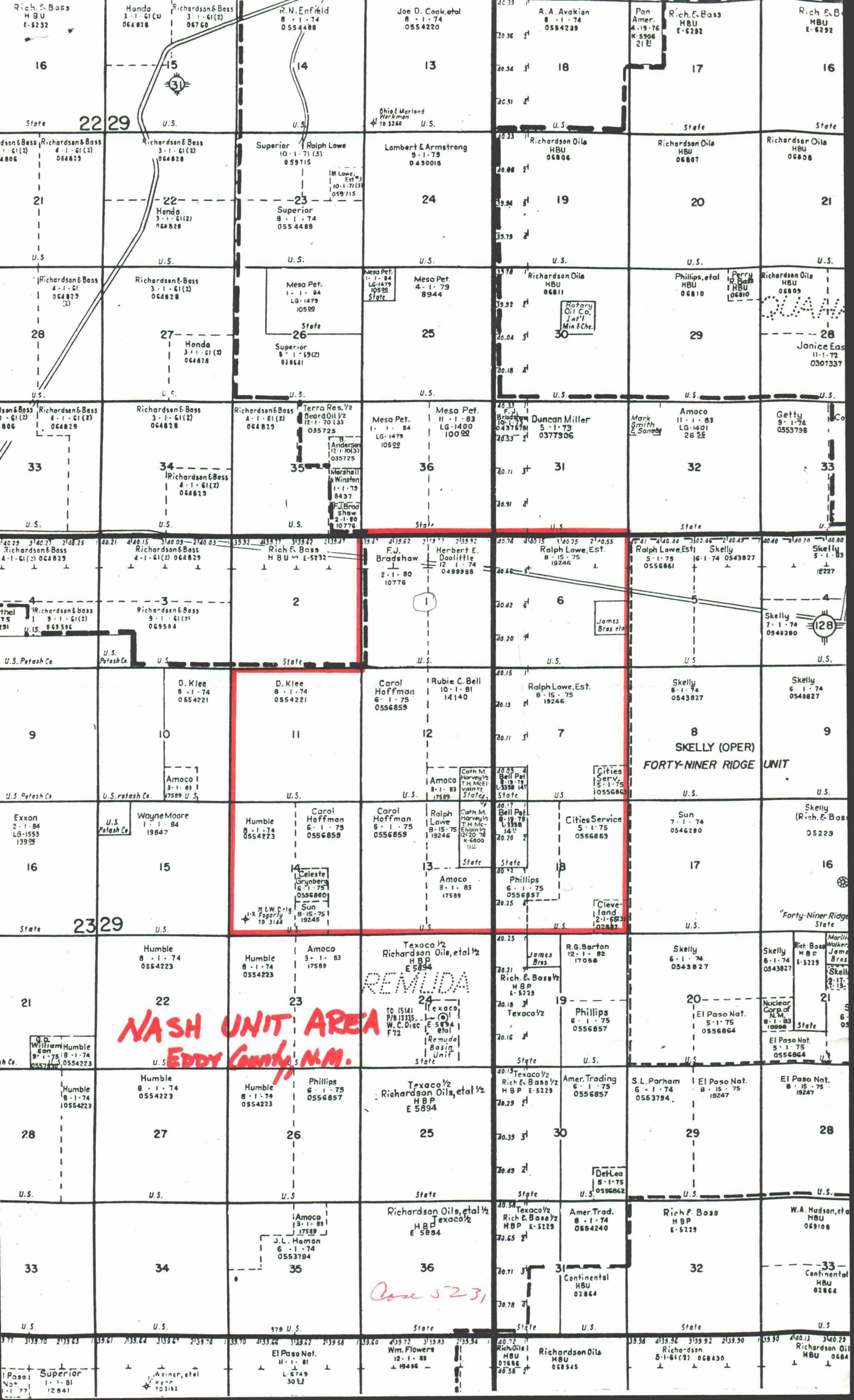

NASH UNIT AREA
EDDY COUNTY, N.M.

REMLIDA

Case 5231

SKELLY (OPER)
FORTY-NINER RIDGE UNIT

Forty-Niner Ridge
State