

P. O. BOX 2088

SANTA FE, NEW MEXICO 87501

NO. OF COPIES RECEIVED	
DISTRIBUTION	
SANTA FE	
FILE	
U.S.G.S.	
LAND OFFICE	
OPERATOR	

5A. Indicate Type of Lease STATE <input type="checkbox"/> FEE <input checked="" type="checkbox"/>
5. State Oil & Gas Lease No. _____
7. Unit Agreement Name _____
8. Farm or Lease Name El Poso Ranch
9. Well No. 2
10. Field and Pool, or Wildcat Wildcat <i>dk</i>
12. County Rio Arriba

APPLICATION FOR PERMIT TO DRILL, DEEPEN, OR PLUG BACK

1a. Type of Work DRILL <input checked="" type="checkbox"/> DEEPEN <input type="checkbox"/> PLUG BACK <input type="checkbox"/>		7. Unit Agreement Name _____	
b. Type of Well OIL WELL <input checked="" type="checkbox"/> GAS WELL <input type="checkbox"/> OTHER <input type="checkbox"/>		8. Farm or Lease Name El Poso Ranch	
2. Name of Operator TEXAS ROSE PETROLEUM, INC.		9. Well No. 2	
3. Address of Operator 16970 Dallas Parkway, Ste. 702 Dallas, Texas 75248		10. Field and Pool, or Wildcat Wildcat <i>dk</i>	
4. Location of Well UNIT LETTER <u>N</u> LOCATED <u>618'</u> FEET FROM THE <u>South</u> LINE (U.S. Public Land Grid projected to Tierra Amarilla Grant) AND <u>2418'</u> FEET FROM THE <u>West</u> LINE OF SEC. <u>14</u> TWP. <u>28N</u> RGE. <u>1E</u> NADP		12. County Rio Arriba	
19. Proposed Depth 2000'		19A. Formation Dakota	
20. Rotary or C.T. Rotary		21. Approx. Date Work will start See Below	
21A. Kind & Status Plug. Bond Blanket		21B. Drilling Contractor Salazar	
21. Elevations (show whether DF, KT, etc.) 7095' GL		22. Approx. Date Work will start See Below	

PROPOSED CASING AND CEMENT PROGRAM

SIZE OF HOLE	SIZE OF CASING	WEIGHT PER FOOT	SETTING DEPTH	SACKS OF CEMENT	EST. TOP
9-5/8"	7-5/8"	24.0# H-40	75'	50	Circulate
6-1/4"	4-1/2"	10.5# K-55	TD	100	To Cover Gallu

This delinquent report is being filed to obtain record approval of operations that were inadvertently conducted without prior Regulatory approval.

Operator proposes to drill to about 2000' to test Dakota and intermediate formations. Propose above casing program to isolate all water, gas and oil zones.

A 3000#WP Reagan bladder-type BOP will be installed on surface casing to control formation pressures. The BOP will be operated daily.

Administrative exception to Rule 104 (B), due to topographical reasons, is being requested by separate instrument.

IN ABOVE SPACE DESCRIBE PROPOSED PROGRAM: IF PROPOSAL IS TO DEEPEN OR PLUG BACK, GIVE DATA ON PRESENT PRODUCTIVE ZONE AND PROPOSED NEW PRODUCTIVE ZONE. GIVE BLOWOUT PREVENTER PROGRAM, IF ANY.

I hereby certify that the information above is true and complete to the best of my knowledge and belief.

Signed Jerry H. Long Title Agent Date February 25, 1985

(This space for State Use)

APPROVED BY [Signature] TITLE SUPERVISOR DISTRICT 3 DATE FEB 25 1985

CONDITIONS OF APPROVAL, IF ANY:

APPROVAL EXPIRES 8-26-85
UNLESS DRILLING IS COMMENCED.
SPUD NOTICE MUST BE SUBMITTED
WITHIN 10 DAYS.

Valid 104 for N52

All distances must be from the outer boundaries of the Section

Operator TEXAS ROSE PETROLEUM, INC.			Lease El Poso Ranch Texas Rose Petroleum		Well No. 2
Unit Letter N	Section 14	Township 28N	Range 1E	County Rio Arriba	
Actual Wellbore Location of Well:					
618		feet from the	FSL	line and	2418
Ground Level Elev.		Producing Formation		Pool	Dedicated Acreage:
7095'		Dakota		Wildcat	40
					Acres

1. Outline the acreage dedicated to the subject well by colored pencil or hatchure marks on the plat below.
2. If more than one lease is dedicated to the well, outline each and identify the ownership thereof (both as to working interest and royalty). SINGLE LEASE
3. If more than one lease of different ownership is dedicated to the well, have the interests of all owners been consolidated by communitization, unitization, force-pooling, etc?

☐ Yes ☐ No If answer is "yes," type of consolidation _____

If answer is "no," list the owners and tract descriptions which have actually been consolidated. (Use reverse side of this form if necessary.) _____

No allowable will be assigned to the well until all interests have been consolidated (by communitization, unitization, forced-pooling, or otherwise) or until a non-standard unit, eliminating such interests, has been approved by the Division

CERTIFICATION

I hereby certify that the information contained herein is true and complete to the best of my knowledge and belief.

Name

JERRY W. LONG

Position

Agent

Company

TEXAS ROSE PETROLEUM, INC.

Date

February 25, 1985

TEXAS ROSE PETROLEUM, INC.

No.2 El Poso Ranch
618'FSL 2418'FWL Sec.14-28N-1E
Rio Arriba County, N.M.

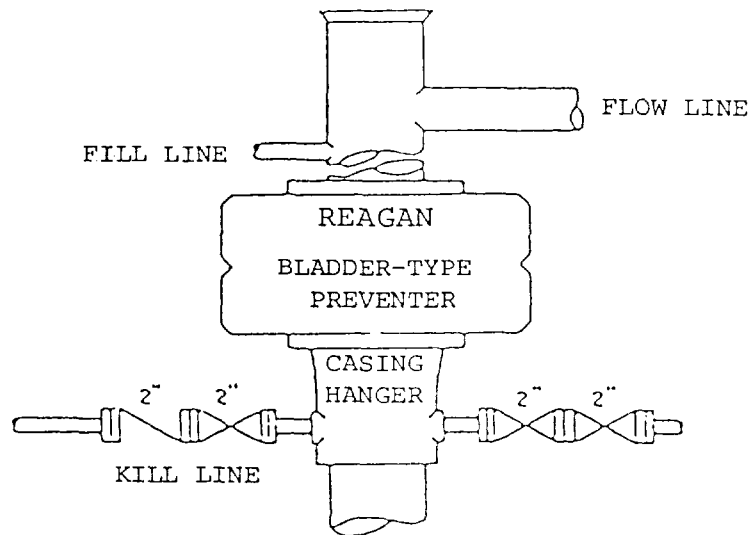

BOP STACK

3000 PSI WORKING PRESSURE

TEXAS ROSE PETROLEUM, INC.

No.2 El Poso Ranch
618'FSL 2418'FWL Sec.14-28N-1E
Rio Arriba County, N.M.

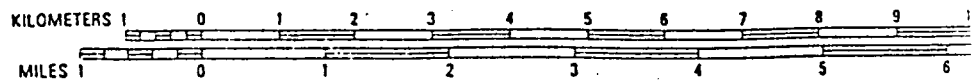
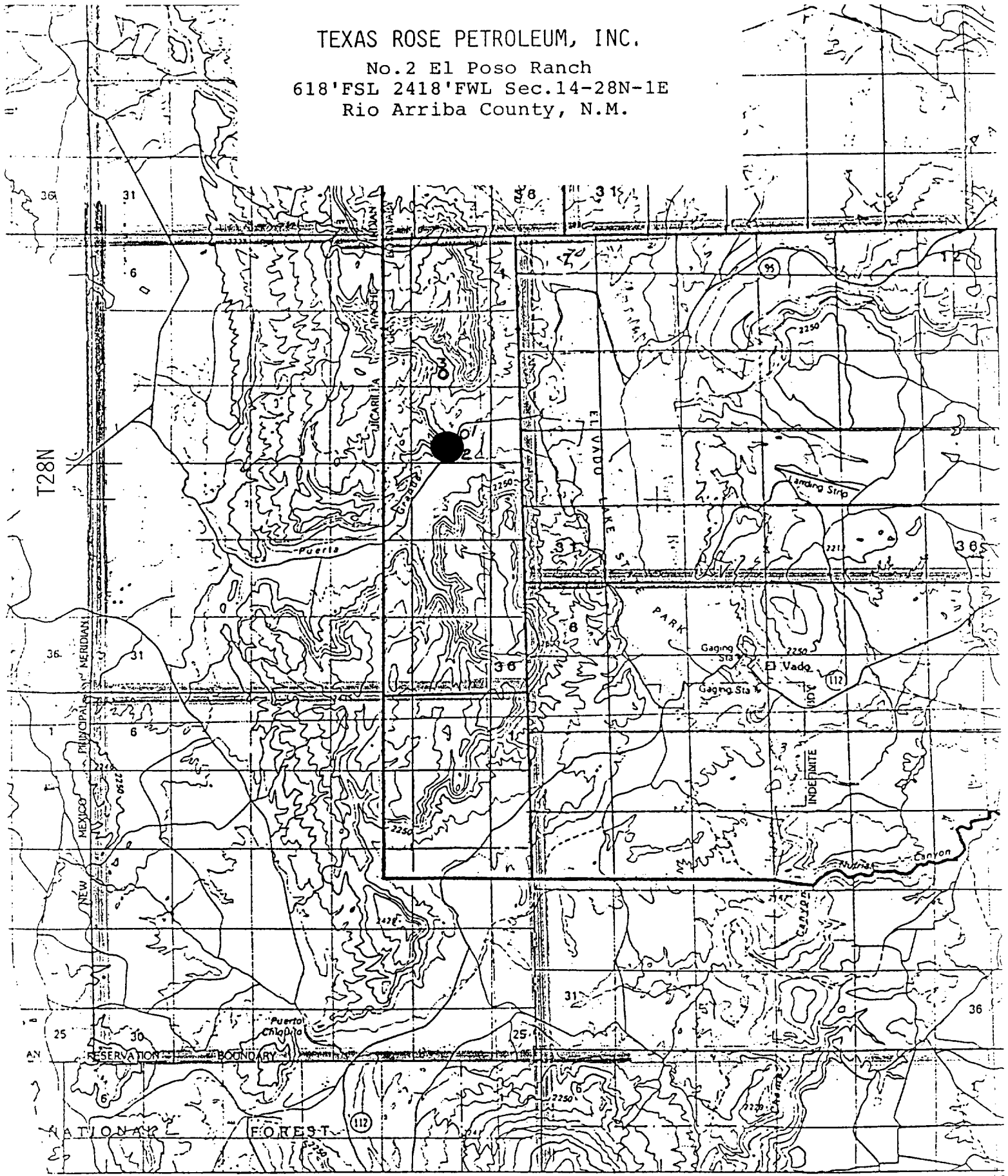



JERRY W. LONG
CONSULTANT

February 26, 1985

DIRECTOR
NEW MEXICO OIL CONSERVATION DIVISION
P. O. Box 2088
Santa Fe, New Mexico 87501

RECEIVED
FEB 27 1985
OIL CON. DIV.
DIST. 3

Re: Non-Standard Location
TEXAS ROSE PETROLEUM, INC.
No.2 El Poso Ranch
Unit N, Sec.14, T.28N., R.1E. (Projected Survey)

Gentlemen:

Texas Rose Petroleum, Inc. is an Out-of-State corporation, without prior experience in drilling in New Mexico. Referenced well was inadvertently drilled by Texas Rose Petroleum, Inc., with the understanding that the well had been permitted by the previous owner of the fee oil and gas lease. In order to correct this deficiency, the operator has engaged me to obtain record approval for drilling of the well.

Attached are copies of C-101 and C-102 which I have filed with your Aztec Office. As indicated by the C-102, the well is located 222' from a subdivision line, instead of the minimum 330'. The well was drilled at a non-standard location because of the rugged terrain.

It is respectfully requested that administration approval be granted for an exception to Rule 104(B) for topographic reason. Also attached is a contour map indicating the extreme topography where the standard location should be and a map indicating that all offset drilling units are under lease to Texas Rose Petroleum, Inc.

Reports advising of subsequent operations will be filed as soon as possible. Your assistance in correcting this deficiency is greatly appreciated.

Sincerely yours,

JERRY W. LONG
Agent for:
TEXAS ROSE PETROLEUM, INC.

JWL/bl1

COPY FOR AZTEC UNIT

TEXAS ROSE PETROLEUM, INC.
No. 2 El Poso Ranch
618' FSL 2418' FWL Sec. 14-28N-1E
Rio Arriba County, N.M.

LEASE OWNERSHIP

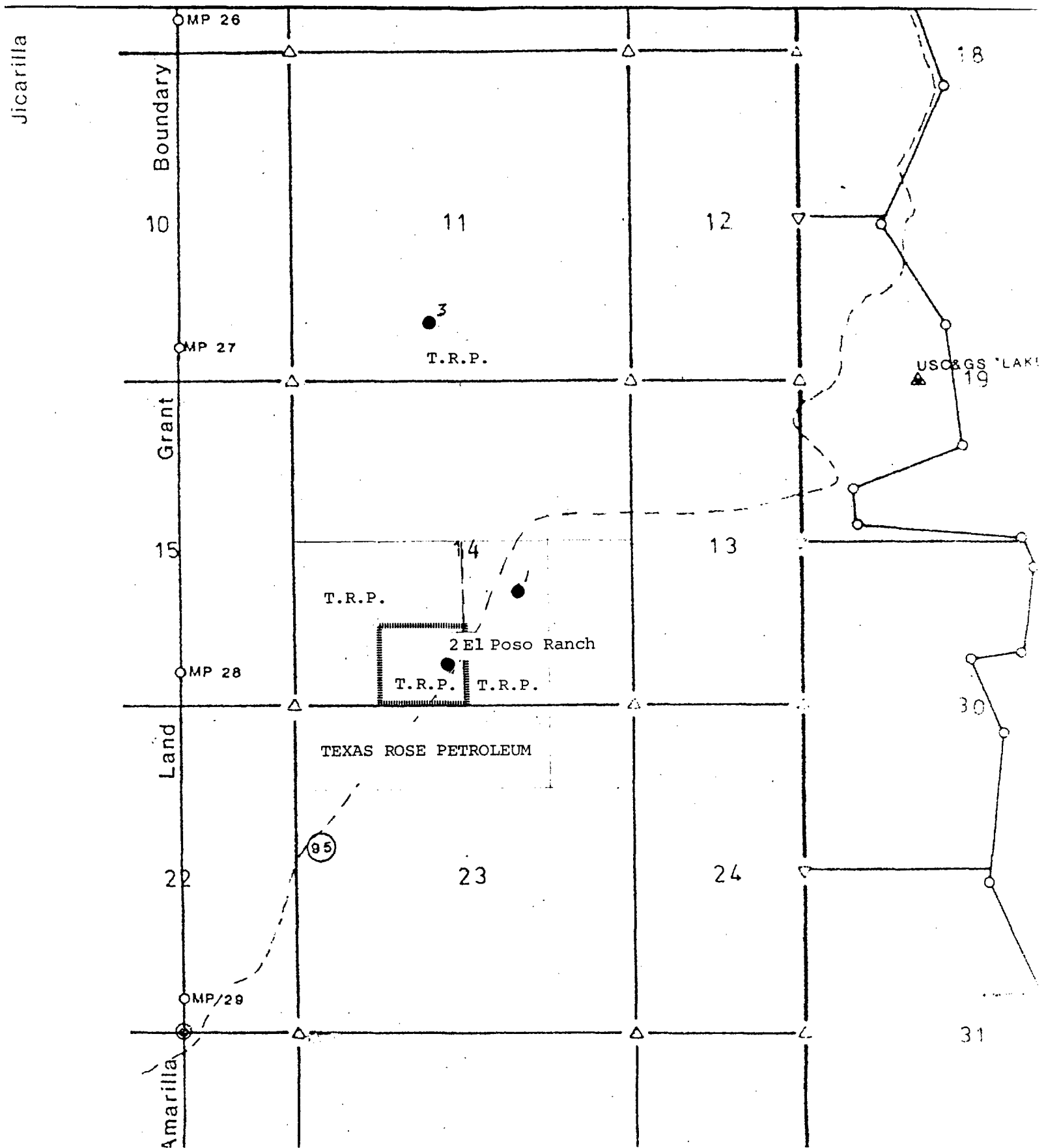

TEXAS ROSE PETROLEUM, INC.

No.2 El Poso Ranch
618'FSL 2418'FWL Sec.14-28N-1E
Rio Arriba County, N.M.

NO. OF COPIES RECEIVED	
DISTRIBUTION	
SANTA FE	
FILE	
U.S.G.S.	
LAND OFFICE	
OPERATOR	

P. O. BOX 2088
SANTA FE, NEW MEXICO 87501

OIL CONSERVATION

APPLICATION FOR PERMIT TO DRILL, DEEPEN, OR PLUG BACK

5A. Indicate Type of Lease
STATE <input type="checkbox"/> REC <input checked="" type="checkbox"/>
6. State Oil & Gas Lease No.
7. Unit Agreement Name
8. Farm or Lease Name
El Poso Ranch
9. Well No.
2
10. Field and Pool, or Wildcat
Wildcat
12. County
Rio Arriba

1a. Type of Work	DRILL <input checked="" type="checkbox"/> DEEPEN <input type="checkbox"/> PLUG BACK <input type="checkbox"/>
b. Type of Well	OIL WELL <input checked="" type="checkbox"/> GAS WELL <input type="checkbox"/> OTHER <input type="checkbox"/> SINGLE ZONE <input checked="" type="checkbox"/> MULTIPLE ZONE <input type="checkbox"/>
2. Name of Operator	TEXAS ROSE PETROLEUM, INC.
3. Address of Operator	16970 Dallas Parkway, Ste. 702 Dallas, Texas 75248
4. Location of Well	UNIT LETTER <u>N</u> LOCATED <u>618'</u> FEET FROM THE <u>South</u> LINE (U.S. Public Land Grid projected to Tierra Amarilla Grant) AND <u>2418'</u> FEET FROM THE <u>West</u> LINE OF SEC. <u>14</u> TWP. <u>28N</u> RGE. <u>1E</u> NMPM
19. Proposed Depth	2000'
19A. Formation	Dakota
19. Rotary or C.T.	Rotary
21. Elevations (Show whether DF, KT, etc.)	7095' GL
21A. Kind & Status Plug. Bond	Blanket
21B. Drilling Contractor	Salazar
22. Approx. Date Work will start	See Below

23.

PROPOSED CASING AND CEMENT PROGRAM

SIZE OF HOLE	SIZE OF CASING	WEIGHT PER FOOT	SETTING DEPTH	SACKS OF CEMENT	EST. TOP
9-5/8"	7-5/8"	24.0# H-40	75'	50	Circulate
6-1/4"	4-1/2"	10.5# K-55	TD	100	To Cover Gallu

This delinquent report is being filed to obtain record approval of operations that were inadvertently conducted without prior Regulatory approval.

Operator proposes to drill to about 2000' to test Dakota and intermediate formations. Propose above casing program to isolate all water, gas and oil zones.

A 3000#WP Reagan bladder-type BOP will be installed on surface casing to control formation pressures. The BOP will be operated daily.

Administrative exception to Rule 104 (B), due to topographical reasons, is being requested by separate instrument.

IN ABOVE SPACE DESCRIBE PROPOSED PROGRAM; IF PROPOSAL IS TO DEEPEN OR PLUG BACK, GIVE DATA ON PRESENT PRODUCTIVE ZONE AND PROPOSED NEW PRODUCTIVE ZONE. GIVE BLOWOUT PREVENTER PROGRAM, IF ANY.

I hereby certify that the information above is true and complete to the best of my knowledge and belief.

Signed Jerry H. Long Title Agent Date February 25, 1985
JERRY H. LONG
 (This space for State Use)

APPROVED BY _____ TITLE _____ DATE _____

CONDITIONS OF APPROVAL, IF ANY:

All distances must be from the outer boundaries of the Section.

Operator TEXAS ROSE PETROLEUM, INC.			Lease El Poso Ranch Texas Rose Petroleum		Well No. 2
Unit Letter N	Section 14	Township 28N	Range 1E	County Rio Arriba	
Actual Footage Location of Well:					
618 feet from the FSL line and		2418 feet from the FWL line			
Ground Level Elev. 7095'	Producing Formation Dakota	Pool Wildcat	Dedicated Acres 40		

1. Outline the acreage dedicated to the subject well by colored pencil or hatchure marks on the plat below. . . .
2. If more than one lease is dedicated to the well, outline each and identify the ownership thereof (both as to working interest and royalty). SINGLE LEASE
3. If more than one lease of different ownership is dedicated to the well, have the interests of all owners been consolidated by communitization, unitization, force-pooling, etc?

☐ Yes ☐ No If answer is "yes," type of consolidation _____

If answer is "no," list the owners and tract descriptions which have actually been consolidated. (Use reverse side of this form if necessary.) _____

No allowable will be assigned to the well until all interests have been consolidated (by communitization, unitization, forced-pooling, or otherwise) or until a non-standard unit, eliminating such interests, has been approved by the Division

RECEIVED
MAR 01 1985
OIL CONT. DIV.
DIST. 3

CERTIFICATION

I hereby certify that the information contained herein is true and complete to the best of my knowledge and belief.

Jerry W. Long
Name
JERRY W. LONG
Position
Agent

Company
TEXAS ROSE PETROLEUM, INC.

Date
February 25, 1985

Section

TEXAS ROSE PETROLEUM, INC.

No.2 El Poso Ranch
618'FSL 2418'FWL Sec.14-28N-1E
Rio Arriba County, N.M.

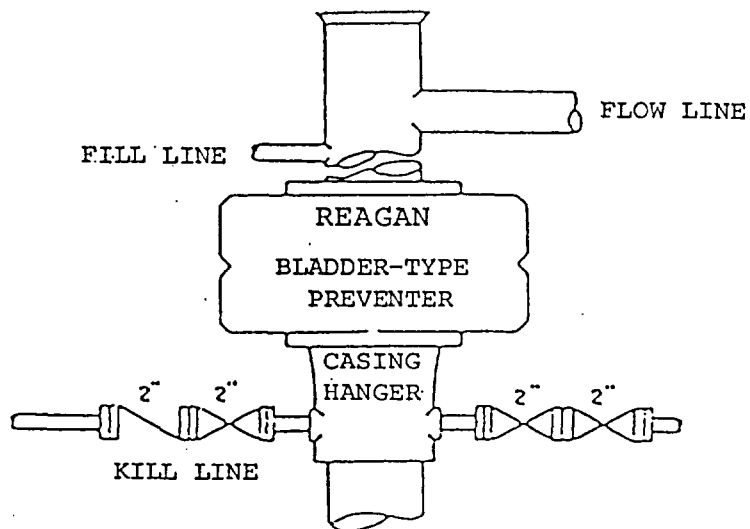

BOP STACK

3000 PSI WORKING PRESSURE

TEXAS ROSE PETROLEUM, INC.

No. 2 El Poso Ranch
618' FSL 2418' FWL Sec. 14-28N-1E
Rio Arriba County, N.M.

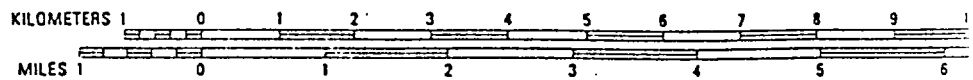
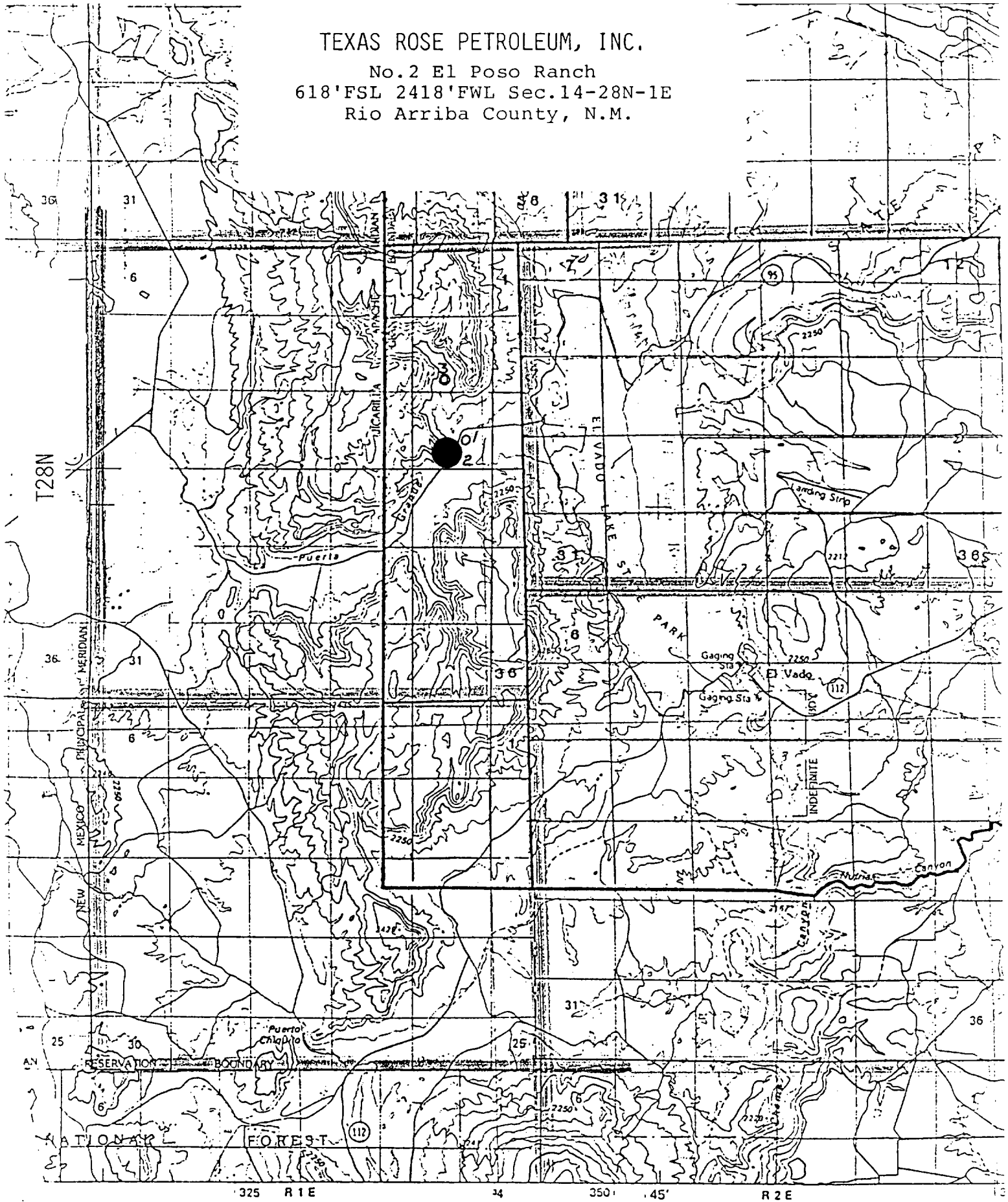



STATE OF NEW MEXICO
ENERGY AND MINERALS DEPARTMENT
OIL CONSERVATION DIVISION

March 6, 1985

TONY ANAYA
GOVERNOR

POST OFFICE BOX 2088
STATE LAND OFFICE BUILDING
SANTA FE, NEW MEXICO 87501
(505) 827-5800

Mr. Jerry W. Long
Consultant
2709 Resolana Drive
Roswell, New Mexico 88201

Administrative Order NSL_1996

Gentlemen:

Reference is made to your application on behalf of Texas Rose Petroleum, Inc. for a non-standard location for their El Poso Ranch Well No. 2 located 618 feet from the South line and 2418 feet from the West line of Section 14, Township 28 North, Range 1 East, NMPM, Undesignated Mancos Oil Pool, Rio Arriba County, New Mexico. The SE/4 SW/4 of said Section 14 is to be dedicated to the well.

By authority granted me under the provisions of Rule 104 F(I), the above-described unorthodox location is hereby approved.

Sincerely,

R. L. STAMETS, DIRECTOR

RLS/DC/dr

cc: Oil Conservation Division - Aztec
Oil & Gas Engineering Committee - Hobbs
Bureau of Land Management - Farmington

Copy of order to be sent 4-29-85

RECEIVED
MAR 13 1985
OIL CONSERVATION
DIVISION



TONY ANAYA
GOVERNOR

STATE OF NEW MEXICO
ENERGY AND MINERALS DEPARTMENT
OIL CONSERVATION DIVISION

March 6, 1985



1935 - 1985

POST OFFICE BOX 2088
STATE LAND OFFICE BUILDING
SANTA FE, NEW MEXICO 87501
(505) 827-5800

Mr. Jerry W. Long
Consultant
2709 Resolana Drive
Roswell, New Mexico 88201

AMENDED
Administrative Order NSL-1996

Gentlemen:

Reference is made to your application on behalf of Texas Rose Petroleum, Inc. for a non-standard location for their El Poso Ranch Well No. 2 located 618 feet from the South line and 2418 feet from the West line of Section 14, Township 28 North, Range 1 East, NMPM, Undesignated Dakota Pool, Rio Arriba County, New Mexico. The SE/4 SW/4 of said Section 14 is to be dedicated to the well.

By authority granted me under the provisions of Rule 104 F(1), the above-described unorthodox location is hereby approved.

Sincerely,

R. L. STAMETS, DIRECTOR

RLS/DC/dr

cc: Oil Conservation Division - Aztec
Oil & Gas Engineering Committee - Hobbs
Bureau of Land Management - Farmington

OIL CON. DIV.
DIST. 3



STATE OF NEW MEXICO
ENERGY AND MINERALS DEPARTMENT

OIL CONSERVATION DIVISION
AZTEC DISTRICT OFFICE

1000 RIO BRAZOS ROAD
AZTEC, NEW MEXICO 87410
(505) 334-6178

OIL CONSERVATION DIVISION
BOX 2088
SANTA FE, NEW MEXICO 87501

DATE 3-4-85

RE: Proposed MC _____
Proposed DHC _____
Proposed NSL X _____
Proposed SWD _____
Proposed WFX _____
Proposed PMX _____

Gentlemen:

I have examined the application dated 2-27-85
for the Texas Rose Petroleum El Paso Ranch #2 11-28N-1E
Operator Lease and Well No. Unit, S-T-R

and my recommendations are as follows:

Approve

Yours truly,

Tom Burch



STATE OF NEW MEXICO
ENERGY AND MINERALS DEPARTMENT
OIL CONSERVATION DIVISION
AZTEC DISTRICT OFFICE

TONY ANAYA
GOVERNOR

1000 RIO BRAZOS ROAD
AZTEC, NEW MEXICO 87410
(505) 334-6178

March 8, 1985

Texas Rose Petroleum Corp.
16970 Dallas Parkway, Suite 702
Dallas, TX 75248

Re: El Pozo Ranch #1 J-14-28N-1E
El Pozo Ranch #2 N-14-28N-1E
El Pozo Ranch #3 N-11-28N-1E

Gentlemen:

The referenced permits have now been approved by this office. This approval in no way removes or lessens the gravity of the violations of drilling these wells without bonding or permits. You are still in serious violation for not filing the appropriate sundry notices.

I have recommended that our attorney initiate legal action to assess fines for these violations.

If you have any questions, please contact this office.

Sincerely,

Frank T. Chavez
District Supervisor

FTC/dj

xc: Well Files
Operator File



JOE I. SALAZAR

Grants, N.M.
(505)

DRILLING, INC.



March 7, 1985

N-14-28N-1E

Texas Rose Petroleum, Inc.
16970 Dakkas Parkway, NO. 70
Dallas, Texas 75248

Dear Jim:

As per your request here is the information that
you requested per our telephone conversation today on
Directional Survey at total cost

El Pozo # 1 well was off 0 degree.
El Pozo # 2 well was off 2 degree ✓
El Pozo # 3 well was off 0 degree.

These well were drilled in Rio Arriba County in
New Mexico.

If you have any further questions please don't hesitate
to call us at any time.

Yours Truly,

Joe Salazar
Joe I. Salazar Drilling Inc.

My Commission expires July 10, 1985.

Rita Chang

RECEIVED

MAR 21 1985

OIL CON. DIV.
DIST. 3

ILLEGIBLE

SONDRY NOTICES AND REPORTS ON WELLS

DO NOT USE THIS FORM FOR NOTICES OF INTENTION TO TEST OR TO A DIFFERENT ADVERTISER.

DATE

DATE

OTHER

TEAS Rose Petroleum Inc

6970 Dallas Parkway Suite 702 Dallas Texas 75248

N

618

FSL

2418

West

SECTION

14

TOWNSHIP

28N

RANGE

1E

15. Elevation (State whether BP, AT, CP, etc.)

7095

16. County

Rio Arriba

Check Appropriate Box To Indicate Nature of Notice, Report or Other Data

NOTICE OF INTENTION TO:

SUBSEQUENT REPORT OF:

WELL IDENTIFICATION

☐

WELL HAS ALREADY

☐

WELL IS WORKING

☐

ALTERING CASING

WELL IS NOT WORKING

☐

WELL IS BEING DRY Laid OR OTHER

☐

WELL HAS BEEN ABANDONED

WELL IS BEING RE-ENTERED

☐

CHANGING PLANS

☐

CHANGING TEST AND CORRELATIONS

☐

OTHER

☐

(2) Describe Processes or Completed Operations (Clearly state all pertinent details, and give pertinent dates, including estimated date of starting any test.)

Well was spudded in at 7:30 AM., 10/22/84. Size of hole 9 7/8" to 120' depth. Set size 7" ", weight 19#, tested 2300 PSI, Range 2, cased to 120'. Cemented surface at 1:00 PM. on 10/22/84. Cementing application: 59 cu. ft., CLASS A brand cement, 4% cal. additives and cement circulated to surface with plug bumped. Cement in place for 3 hrs. prior to starting test. Casing and cement test was at 12:00 PM. on 10/22/84. 750 PSI of pressure was held for 10 hr. Size of hole 6 1/4" to 1710' depth. Set size 4 1/2" ", weight 10.5#, tested 4,000 PSI, Range II, tested to 1710'. Cementing application: 218 cu. ft., CLASS A Type II brand cement, 4% cal. additives and cement circulated to surface with plug bumped. Approximate temperature of cement slurry when mixed N/A°. Estimated formation temperature in zone of interest 35°. Cement in place for 12 hr. prior to starting test. Casing and cement test was at 3:35 AM. on 10/25/84. 150 PSI of pressure was held for 3 hr.

Original Signed by FRANK T. CHAVEZ

SUPERVISOR DISTRICT #3

MAR 27 1985

ILLEGIBLE



TONEY ANAYA
GOVERNOR

STATE OF NEW MEXICO
ENERGY AND MINERALS DEPARTMENT
OIL CONSERVATION DIVISION

March 6, 1985

50 YEARS



1935 - 1985

POST OFFICE BOX 2088
STATE LAND OFFICE BUILDING
SANTA FE, NEW MEXICO 87501
(505) 827-5800

14-282-13

Mr. Jerry W. Long
Consultant
2709 Resolana Drive
Roswell, New Mexico 88201

AMENDED
Administrative Order NSL-1996

Gentlemen:

Reference is made to your application on behalf of Texas Rose Petroleum, Inc. for a non-standard location for their El Poso Ranch Well No. 2 located 618 feet from the South line and 2418 feet from the West line of Section 14, Township 28 North, Range 1 East, NMPM, Undesignated Dakota Pool, Rio Arriba County, New Mexico. The SE/4 SW/4 of said Section 14 is to be dedicated to the well.

By authority granted me under the provisions of Rule 104 F(I), the above-described unorthodox location is hereby approved.

Sincerely,

R. L. STAMETS, DIRECTOR

RLS/DC/dr

cc: ✓ Oil Conservation Division - Aztec
Oil & Gas Engineering Committee - Hobbs
Bureau of Land Management - Farmington

RECEIVED
MAR 23 1985
OIL CON. DIV.
SANTA FE



TEXAS ROSE PETROLEUM, INC.

16970 DALLAS PARKWAY
SUITE 702
DALLAS, TEXAS 75248
(214) 931-3722

May 29, 1985

New Mexico Oil Conservation
1000 Rio Brazos Rd.
Aztec, New Mexico 87410

Gentlemen:

This letter is being written as an application for exemption of Rule 104 for an unorthodox location. The well is Well #2 in the El Poso Ranch. This well has been accepted as an unorthodox location but was stipulated as being drilled to the Dakota formation. The well, however, was only drilled to the Gallup.

Therefore, an additional request is being made for exemption of Rule 104 for an unorthodox location on Well #2, in the Gallup formation. The reason for this unorthodox location is that the topography of the area makes it impossible to drill a standard well.

Thank you and please forward any paperwork to my attention.

Best Regards,

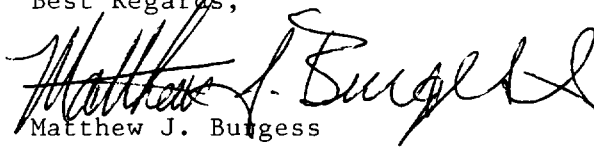
Matthew J. Burgess
Texas Rose Petroleum, Inc.

MB/kw

RECEIVED
MAY 31 1985
OIL CON. DIV.
DIST. 3



STATE OF NEW MEXICO
ENERGY AND MINERALS DEPARTMENT
OIL CONSERVATION DIVISION
AZTEC DISTRICT OFFICE

TONEY ANAYA
GOVERNOR

1000 RIO BRAZOS ROAD
AZTEC, NEW MEXICO 87410
(505) 334-6178

September 19, 1986

Mr. Jeff Taylor
Oil Conservation Div.
P.O. Box 2088
Santa Fe, NM 87504-2088

Re: Texas Rose Petroleum Corp.
El Poso Ranch #1 J-14-28N-1E
El Poso Ranch #2 N-14-28N-1E
El Poso Ranch #3 N-11-28N-1E
El Poso Ranch #7 O-14-28N-1E
El Poso Ranch #8 K-14-28N-1E

Dear Jeff:

The referenced wells have not produced in over one year and apparently no further effort will be made to produce them.

Please docket a case calling for Texas Rose Petroleum Corp., Travelers Insurance Companies and all other interested parties to appear and show cause why the El Poso Ranch #1, located 1824' from the south line and 1778' from the east line of Section 14, 28 North, 1 East, the El Poso Ranch #2, located 618' from the south line and 2418' from the west line of Section 14, 28 North, 1 East, the El Poso Ranch #3, located 967' from the south line and 2148' from the west line of Section 11, 28 North, 1 East, the El Poso Ranch #7, located 990' from the south line and 2310' from the west line of Section 14, 28 North, 1 East, and the El Poso Ranch #8, located 2310' from the south line and 2310' from the west line of Section 14, 28 North, 1 East, should not be plugged and abandoned in accordance with a Division approved plugging program.

Yours truly,

Charles Gholson
Oil & Gas Inspector

CG/dj

xc: Well Files

All distances must be from the outer boundaries of the section.

Operator TEXAS Rose Petroleum Inc		Lease El Paso Ranch		Well No. #2	
Unit Letter N	Section 14	Township 28N	Range 1E	County Rio Arriba	
Actual Postage Location of Well: 618 feet from the FSL line and 2418 feet from the FWL line					
Ground Level Elev. 7095	Producing Formation Growth Gallup		Pool Wildcat		Dedicated Acreage: 40 Acres

1. Outline the acreage dedicated to the subject well by colored pencil or hatchure marks on the plat below.
2. If more than one lease is dedicated to the well, outline each and identify the ownership thereof (both as to working interest and royalty). **single lease**
3. If more than one lease of different ownership is dedicated to the well, have the interests of all owners been consolidated by communitization, unitization, force-pooling, etc?

☐ Yes ☐ No If answer is "yes," type of consolidation _____

If answer is "no," list the owners and tract descriptions which have actually been consolidated. (Use reverse side of this form if necessary.) _____

No allowable will be assigned to the well until all interests have been consolidated (by communitization, unitization, forced-pooling, or otherwise) or until a non-standard unit, eliminating such interests, has been approved by the Division.

CERTIFICATION

I hereby certify that the information contained herein is true and complete to the best of my knowledge and belief.

David L. Ellis
Name **DAVID L. ELLIS**
CHAIRMAN
Position
Company **TEXAS Rose Petroleum Inc**

Date **27 March 85**

I hereby certify that the well location shown on this plat was plotted from field notes of actual surveys made by me or under my supervision, and that the same is true and correct to the best of my knowledge and belief.

Date Surveyed _____

Registered Professional Engineer
and/or Land Surveyor

Certificate No. _____

RECEIVED
OFFICE

2418'
618'

STATE OF NEW MEXICO
ENERGY AND MINERALS DEPARTMENT

NO. OF COPIES RECEIVED	
DISTRIBUTION	
SANTA FE	
FILE	
U.S.D.A.	
LAND OFFICE	
TRANSPORTER	OIL GAS
OPERATION	
ADDITIONAL OFFICE	

OIL CONSERVATION DIVISION

P. O. BOX 2083
SANTA FE, NEW MEXICO 87501

Form C-104
Revised 10-31-78
Format 05-01-83
Page 1

REQUEST FOR ALLOWABLE
AND
AUTHORIZATION TO TRANSPORT OIL AND NATURAL GAS

I. Operator Texas Rose Petroleum Inc
Address 16970 Dallas Parkway Suite 702 Dallas Texas 75248
Reason(s) for filing (Check proper box)
☒ New Well ☐ Change in Transporter of:
☐ Recompletion ☐ Oil ☐ Dry Gas
☐ Change in Ownership ☐ Costhead Gas ☐ Condensate
Other (Please explain)

If change of ownership give name and address of previous owner N/A

II. DESCRIPTION OF WELL AND LEASE

Lease Name <u>El Paso Ranch</u>	Well No. <u>2</u>	Pool Name, including Formation <u>Wildcat Gulch</u>	Kind of Lease State, Federal or Fee <u>Fee</u>	Lease No. <u>N/A</u>
Location Unit Letter <u>N</u> : <u>618</u> Feet From The <u>FS</u> Line and <u>2418</u> Feet From The <u>FWL</u> Line of Section <u>14</u> Township <u>28</u> Range <u>1E</u> , NMPM, <u>Rio Arriba</u> County				

III. DESIGNATION OF TRANSPORTER OF OIL AND NATURAL GAS

Name of Authorized Transporter of Oil <input checked="" type="checkbox"/> or Condensate <input type="checkbox"/> <u>Com. Energy Corp</u>	Address (Give address to which approved copy of this form is to be sent) <u>P.O. Box 159 Bloomfield, N.M. 8741</u>
Name of Authorized Transporter of Costhead Gas <input type="checkbox"/> or Dry Gas <input type="checkbox"/> <u>N/A</u>	Address (Give address to which approved copy of this form is to be sent) <u>N/A</u>
If well produces oil or liquids, give location of tanks. Unit <u>N</u> Sec. <u>14</u> Twp. <u>28N</u> Rge. <u>1E</u>	Is gas actually connected? <u>N/A</u> when <u>N/A</u>

If this production is commingled with that from any other lease or pool, give commingling order number: N/A

NOTE: Complete Parts IV and V on reverse side if necessary.

VI. CERTIFICATE OF COMPLIANCE

I hereby certify that the rules and regulations of the Oil Conservation Division have been complied with and that the information given is true and complete to the best of my knowledge and belief.

[Signature]
(Signature)
Chairman
(Title)
27 March 85
(Date)

OIL CONSERVATION DIVISION

APPROVED MAR 27 1985, 19
BY Original Signed by FRANK T. CHAVEZ
TITLE SUPERVISOR DISTRICT # 3

This form is to be filed in compliance with RULE 1106.

If this is a request for allowable for a newly drilled or deepened well, this form must be accompanied by a tabulation of the deviation tests taken on the well in accordance with RULE 111.

All sections of this form must be filled out completely for all wells on new and recompleted wells.

Fill out only Sections I, II, III, and VI for changes of owner, well name or number, or transporter, or other such change of condition.

Separate Forms C-104 must be filed for each pool in multiple completed wells.

228111
 MAR 2 1985
 OIL CO. & DIV.
 DIST. 9

Form C 104
 Revised 10-01-78
 Format OX-01-83
 Page 2

IV. COMPLETION DATA

Designate Type of Completion - (X)		Oil Well	Gas Well	New Well	Workover	Deepen	Plug Back	Some Rest'v.	Diff. Res.
		X		X					
Date Spudded	Date Compl. Ready to Prod.		Total Depth		P.B.T.D.				
10/22/84	12/14/84		1710		1540				
Elvations (DF, RAB, RT, GR, etc.)	Name of Producing Formation		Top Oil/Gas Pay		Tubing Depth				
7095	Winget Gallup		1428		1535				
Perforations		1428 - 1472			1 Shot Each 4 Feet		Depth Casing Shoe		
TUBING, CASING, AND CEMENTING RECORD									
HOLE SIZE		CASING & TUBING SIZE		DEPTH SET		SACKS CEMENT			
6 7/8"		4 1/2" Casing		1710'		185			
2 3/8"		2 3/8"		1535'		0			
9 1/8"		7 1/8"		120'		50			

V. TEST DATA AND REQUEST FOR ALLOWABLE (Test must be after recovery of total volume of load oil and must be equal to or exceed top allowable for this depth or be for full 24 hours)

Date First New Oil Run To Tanks	Date of Test	Producing Method (Flow, pump, gas lift, etc.)	
12/4/84	12/4/84	Pump	
Length of Test	Tubing Pressure	Casing Pressure	Choke Size
24 hrs.	20135	380 - 450 PSI	N/A
Actual Prod. During Test	Oil - Bbls.	Water - Bbls.	Gas - MCF
41	37	4	N/A

GAS WELL

Actual Prod. Test - MCF/D	Length of Test	Bbls. Condensate/MMCF	Gravity of Condensate
N/A			
Testing Method (pilot, back pr.)	Tubing Pressure (psia-in)	Casing Pressure (psia-in)	Choke Size

STATE OF NEW MEXICO

DEPARTMENT OF MINERAL RESOURCES

OIL CONSERVATION DIVISION

P.O. BOX 2088

SANTA FE, NEW MEXICO 87501

WELL COMPLETION OR RECOMPLETION REPORT AND LOG

1. Well Name and Type of Lease
Date ☒ ☐
2. Date of Well Completion No.

N/A

3. Unit Agreement Name

N/A

4. Field or Lease Name

EL Poso Ranch

5. Well No.

2

6. Field and State of Wellhead

Winecat Gallup

County
Rio Arriba

7. TYPE OF WELL

OIL WELL ☒ GAS WELL ☐ DRY ☐ OTHER ☐

8. TYPE OF COMPLETION

NEW ☒ WORK OVER ☐ DEEPEN ☐ PLUG BACK ☐ DIFF. FILTER ☐ OTHER ☐

9. Name of Operator

TEXAS ROSE Petroleum Inc.

10. Street Address of Operator

16975 Dallas Parkway Suite 702 Dallas Texas

11. Location of Well

UNIT LETTER N LOCATED 618 FEET FROM THE FS LINE AND 2418 FEET FROM

THE NEAREST CORNER OF SEC. 14 TWP. 28 N. R. 1 E.

12. Date Drilled

10-22-84

13. Date T.D. Reached

10/24/84

14. Date Comp. (Ready to Prod.)

10/24/84

15. Elevations (DF, RAS, RT, GR, etc.)

7595 GL

16. Elev. Casinghead

7095 GL

17. Total Depth

1710

18. Plug Back T.D.

1540

19. If Multiple Complet., How Many

N/A

20. Intervals Drilled By

Rotary Tools

20'

Cable Tools

21. Producing Interval(s), at this completion - Top, Bottom, Name

1428 - 1472 Greenhorn

22. Was Directional Survey Made

Yes

23. Type Electric and Other Logs Run

Gamma Ray Neutron

24. Was Well Cored

No

25. CASING RECORD (Report all strings set in well)

CASING SIZE	WEIGHT LB./FT.	DEPTH SET	HOLE SIZE	CEMENTING RECORD	AMOUNT PULLED
7" 5 1/2 Ch	19	120 FT.	4 7/8	50 Sacks	N/A
	10.5	1710	6 1/4	185 Sacks	N/A

26. LINER RECORD

SIZE	TOP	BOTTOM	SACKS CEMENT	SCREEN	SIZE	DEPTH SET	PACKER SET
N/A					2 3/8	1535	NOUL

27. Penetration Record (Interval, size and number)

28. ACID, SHOT, FRACTURE, CEMENT SQUEEZE, ETC.

DEPTH INTERVAL	AMOUNT AND KIND MATERIAL USED
1428 - 1472	500 Gal 7% HCL
1428 - 1472	650 Gal Gel Water
1428 - 1472	60,000 LB. 10-20 Sand

29. PRODUCTION

Date First Production		Production Method (Flowing, gas lift, pumping - Size and type pump)				Well Status (Prod. or Shut-in)	
12/4/84		Pumping				Prod.	
Date of Test	Hours Tested	Casing Size	Prod'n. For Test Period	Oil - Bbl.	Gas - MCF	Water - Bbl.	Gas - Oil Ratio
12/4/84	24	0	→ 37	37	TSJM	4	N/A
Flow - Tubing Press.	Casing Pressure	Calculated G - Hour Rate	Oil - Bbl.	Gas - MCF	Water - Bbl.	G - Gravity - API Comp.	
N/A	N/A	→ N/A	N/A	N/A	N/A	31	

30. Description of Well (Casing, liner, perforations, etc.)

Cased for 24'

31. List of All Tests

32. I hereby certify that the information furnished on this form is true and complete to the best of my knowledge and belief.

SIGNED

[Signature]

DATE

27 March 85



STATE OF NEW MEXICO
ENERGY AND MINERALS DEPARTMENT
OIL CONSERVATION DIVISION

June 20, 1985

TONEY ANAYA
GOVERNOR

POST OFFICE BOX 2088
STATE LAND OFFICE BUILDING
SANTA FE, NEW MEXICO 87501
(505) 827-5800

Mr. Jerry W. Long
Consultant
2709 Resolana Drive
Roswell, New Mexico 88201

RECEIVED
JUN 23 1985
OIL CONSERVATION DIV.
DIST. 3

SECOND AMENDED
Administrative Order NSL-1996

Gentlemen:

Reference is made to your application on behalf of Texas Rose Petroleum, Inc. for a non-standard location for their El Poso Ranch Well No. 2 located 618 feet from the South line and 2418 feet from the West line of Section 14, Township 28 North, Range 1 East, NMPM, Undesignated Gallup Pool, Rio Arriba County, New Mexico. The SE/4 SW/4 of said Section 14 is to be dedicated to the well.

By authority granted me under the provisions of Rule 104 F (I), the above-described unorthodox location is hereby approved.

Sincerely

R. L. STAMETS, DIRECTOR

RLS/DC/dr

cc: v Oil Conservation Division - Aztec
Oil & Gas Engineering Committee - Hobbs
Bureau of Land Management - Farmington

Texas Rose Petroleum Inc.
El Poso Ranch #2 N-14-28N-1E

Downhole conditions and equipment

7" casing at 120' with 59 cu. ft of cement
4 1/2" casing at 1710' with 218 cu. ft of cement *29*
2 3/8" tubing at 1535'

Division Approved Plugging Program

1. Set a cement plug inside casing from plugback total depth at 1535' to 1385'.
2. Wait on cement a minimum of 3 hours. Go in hole with tubing and tag plug #1. If plug is in place go to step 3. If not fill to 1385'. *3* Come out of hole to 850' and set a cement plug inside casing 850'-650'. Come out of hole with tubing.
- 4*. Take a strain on 4 1/2" casing to make sure cement was circulated. If stretch indicates casing is free below base of surface pipe, perforate casing at free point and circulate cement to surface. If no stretch is indicated circulate cement 170' to surface inside casing.
- 5*. Set a dry hole marker, fill pits, clean and level location.

All plugs will be with neat cement with or without an accelerator.

STATE OF NEW MEXICO
ENERGY AND MINERALS DEPARTMENT
OIL CONSERVATION DIVISION

CASE NO. 9074
Order No. R-8404

IN THE MATTER OF THE HEARING CALLED BY
THE OIL CONSERVATION DIVISION ON ITS
OWN MOTION TO PERMIT TEXAS ROSE PETROLEUM,
INC., THE TRAVELERS INDEMNITY COMPANY AND
ALL OTHER INTERESTED PARTIES TO APPEAR AND
SHOW CAUSE WHY FIVE CERTAIN WELLS ON THE EL
POSO RANCH LEASE IN RIO ARRIBA COUNTY, NEW
MEXICO, SHOULD NOT BE PLUGGED AND ABANDONED
IN ACCORDANCE WITH A DIVISION-APPROVED PLUGGING
PROGRAM.

RECEIVED
MAR 02 1987.
OIL CON. DIV.
DIST. 3

ORDER OF THE DIVISION

BY THE DIVISION:

This cause came on for hearing at 8:15 a.m. on February 18, 1987, at Santa Fe, New Mexico, before Examiner David R. Catanach.

NOW, on this 26th day of February, 1987, the Division Director, having considered the testimony, the record, and the recommendations of the Examiner, and being fully advised in the premises,

FINDS THAT:

- (1) Due public notice having been given as required by law, the Division has jurisdiction of this cause and the subject matter thereof.
- (2) At the time of the hearing Division Cases Nos. 9074 and 9075 were consolidated for purposes of testimony.
- (3) Texas Rose Petroleum, Inc. is the owner and operator of the following five wells, all on the El Poso Ranch Lease in Township 28 North, Range 1 East, NMPM, Rio Arriba County, New Mexico, as projected into the unsurveyed Tierra Amarilla Land Grant:

Well No. 1 located 1824 feet from the South line and 1778 feet from the East line (Unit J) of Section 14;

Well No. 2 located 618 feet from the South line and 2418 feet from the West line (Unit N) of Section 14;

Well No. 3 located 967 feet from the South line and 2148 feet from the West line (Unit N) of Section 11;

Well No. 7 located 990 feet from the South line and 2310 feet from the East line (Unit O) of Section 14; and,

Well No. 8 located 2310 feet from the South and West lines (Unit K) of Section 14.

(4) The Travelers Indemnity Company is the surety on the Oil Conservation Division blanket plugging bond on which Texas Rose Petroleum, Inc. is principal.

(5) The purpose of said bond is to assure the state that the subject wells will be properly plugged and abandoned when they are no longer capable of commercial production.

(6) In order to prevent waste, to protect correlative rights, and to protect fresh waters the above-described wells should be plugged and abandoned in accordance with a program approved by the Aztec District Office of the New Mexico Oil Conservation Division on or before March 31, 1987, or the wells should be returned to active drilling status or placed on production.

IT IS THEREFORE ORDERED THAT:

(1) Texas Rose Petroleum, Inc. and Travelers Indemnity Company are hereby ordered to plug and abandon the following five wells on or before March 31, 1987;

Well No. 1 located 1824 feet from the South line and 1778 feet from the East line (Unit J) of Section 14;

Well No. 2 located 618 feet from the South line and 2418 feet from the West line (Unit N) of Section 14;

Well No. 3 located 967 feet from the South line and 2148 feet from the West line (Unit N) of Section 11;

Well No. 7 located 990 feet from the South line and 2310 feet from the East line (Unit O) of Section 14; and,

Well No. 8 located 2310 feet from the South and West lines (Unit K) of Section 14.

All on the El Poso Ranch Lease in Township 28 North, Range 1 East, NMPM, Rio Arriba County, New Mexico, as projected into the unsurveyed Tierra Amarilla Land Grant.

(2) Texas Rose Petroleum, Inc. and Travelers Indemnity Company, prior to plugging and abandoning the above-described wells, shall obtain from the Aztec office of the Division, a Division-approved program for said plugging and abandoning, and shall notify said Aztec office of the date and hour said work is to be commenced whereupon the Division may, at its option, witness such work.

(3) IN THE ALTERNATIVE, the Supervisor of the Division's district office at Aztec may permit any of said wells to be completed or recompleted as a producer provided that an acceptable plan for such work is filed with such office prior to March 31, 1987, provided that such work shall be completed within 180 days following entry of this order.

(4) Should either party fail or refuse to carry out such provisions in accordance with the terms of this order, the Division shall then take such actions as are deemed necessary to have the wells properly plugged.

(5) Jurisdiction of this cause is retained for the entry of such further orders as the Division may deem necessary.

DONE at Santa Fe, New Mexico, on the day and year hereinabove designated.

STATE OF NEW MEXICO
OIL CONSERVATION DIVISION

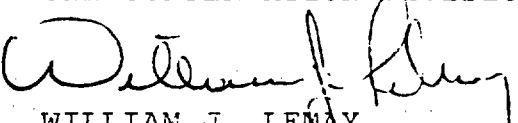
WILLIAM J. LENAY
Director

S E A L



The Travelers Companies
Two NorthPark East
P.O. Box 660055
Dallas, TX 75266-0055

Daniel L. Wolfe
Manager
Surety Department

Dallas Office

EL Poso #2

March 24, 1987

State of New Mexico
Energy & Minerals Department
Oil Conservation Division
1000 Rio Brazos Road
Aztec, New Mexico 87410

Attn: Mr. Charlie Golson

Re: Texas Rose Petroleum
Case 9074, Order No. R-8404
Case 9075, Order No. R-8405
Claim #039/5180F

Dear Mr. Golson:

The Travelers Indemnity Company acknowledges receipt of the above mentioned orders under our Blanket Plugging Bond, number 981F609A. This letter is to advise you of The Travelers intent to honor our obligation under the above mentioned Blanket Plugging Bond.

Presently, The Travelers is soliciting bids to properly plug the referenced wells in accordance with state guidelines from various plugging contractors in the Farmington area. To date, the contractors we have verbally requested to submit bids, are those plugging contractors that your office provided to us. We will review those bids, then submit a proposal that is acceptable to your department for consideration and acceptance.

Again, The Travelers Indemnity Company does intend to honor our bond obligation and see that these wells are properly plugged. Should you have a guide for properly plugging that we could review to assist us in our proposals to the various contractor, we would appreciate it if you would forward us a copy.

Very truly yours,
THE TRAVELERS INDEMNITY COMPANY

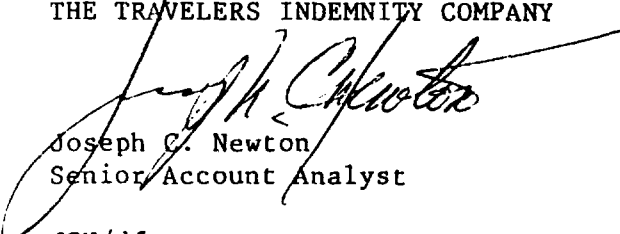
Joseph C. Newton
Senior Account Analyst

JCN/df

HOME OFFICE
One Tower Square
Hartford, CT 06115

RECEIVED

MAR 27 1987

OIL CON. DIV
DIST. 3

STATE OF NEW MEXICO
ENERGY AND MINERALS DEPARTMENT

NO. OF COPIES RECEIVED	
DISTRIBUTION	
SANTA FE	
FILE	
U.S.G.S.	
LAND OFFICE	
TRANSPORTER	OIL
OPERATOR	GAS
PROMOTION OFFICE	

OIL CONSERVATION DIVISION
P. O. BOX 2088
SANTA FE, NEW MEXICO 87501

Form C-104
Revised 10-01-78
Format 06-01-83
Page 1

RECEIVED
JUN 28 1988

REQUEST FOR ALLOWABLE
AND
AUTHORIZATION TO TRANSPORT OIL AND NATURAL GAS

I. Operator
SPUR OIL, INC.

Address
3107 N. HASKELL, DALLAS, TX. 75204

Reason(s) for filing (Check proper box)
☐ New Well
☐ Recompletion
☒ Change in Ownership
 Change in Transporter of:
☐ Oil
☐ Dry Gas
☐ Casinghead Gas
☐ Condensate
 Other (Please explain)

If change of ownership give name and address of previous owner
 TEXAS ROSE PETROLEUM, INC. 16970 N. DALLAS PARKWAY
 SUITE 702, DALLAS, TX. 75248

II. DESCRIPTION OF WELL AND LEASE

Lease Name EL POSO RANCH	Well No. 2	Pool Name, including Formation WILDCAT GALLUP	Kind of Lease State, Federal or Fee FEE	Lease No.
Location Unit Letter N : 618 Feet From The SOUTH Line and 2418 Feet From The WEST Line of Section 14 Township 28N Range 1E, NMPM, RIO ARRIBA County				

III. DESIGNATION OF TRANSPORTER OF OIL AND NATURAL GAS

Name of Authorized Transporter of Oil <input checked="" type="checkbox"/> or Condensate <input type="checkbox"/> GARY ENERGY CORP.	Address (Give address to which approved copy of this form is to be sent) P.O. BOX 159, BLOOMFIELD, N.M. 87413
Name of Authorized Transporter of Casinghead Gas <input type="checkbox"/> or Dry Gas <input type="checkbox"/> N/A	Address (Give address to which approved copy of this form is to be sent) N/A
If well produces oil or liquids, give location of tanks. Unit N Sec. 14 Twp. 28N Rge. 1E	Is gas actually connected? When N/A N/A

If this production is commingled with that from any other lease or pool, give commingling order number:

NOTE: Complete Parts IV and V on reverse side if necessary.

VI. CERTIFICATE OF COMPLIANCE

I hereby certify that the rules and regulations of the Oil Conservation Division have been complied with and that the information given is true and complete to the best of my knowledge and belief.

M. J. Smith
(Signature)

PROD. ENG.
(Title)

JUNE 20 1988

(Date)

OIL CONSERVATION DIVISION

JUN 28 1988

APPROVED _____, 19

BY *Barry J. Smith*

TITLE SUPERVISION DISTRICT #3

This form is to be filed in compliance with RULE 1104.

If this is a request for allowable for a newly drilled or deeper well, this form must be accompanied by a tabulation of the deviate tests taken on the well in accordance with RULE 111.

All sections of this form must be filled out completely for all wells on new and recompleted wells.

Fill out only Sections I, II, III, and VI for changes of owner, well name or number, or transporter or other such change of condition.

Separate Forms C-104 must be filed for each pool in multi-completed wells.

DISTRICT II
P.O. Drawer DD, Artesia, NM 88210

OIL CONSERVATION DIVISION

P.O. Box 2088

Santa Fe, New Mexico 87504-2088

DISTRICT III
1000 Rio Brazos Rd., Aztec, NM 87410

REQUEST FOR ALLOWABLE AND AUTHORIZATION
TO TRANSPORT OIL AND NATURAL GAS

Operator Petroleum Development Corporation	Well API No. 30-039-23672
Address 9720 B Candelaria N.E. Albuquerque, NM 87112	
Reason(s) for Filing (Check proper box) New Well <input type="checkbox"/> Change in Transporter of: <input checked="" type="checkbox"/> Other (Please explain) Recompletion <input type="checkbox"/> Oil <input type="checkbox"/> Dry Gas <input type="checkbox"/> <i>Name Change from #2</i> Change in Operator <input checked="" type="checkbox"/> Casinghead Gas <input type="checkbox"/> Condensate <input type="checkbox"/>	
If change of operator give name and address of previous operator Texas Rose Petroleum, Inc. no address available <i>Spur Oil, INC</i>	

II. DESCRIPTION OF WELL AND LEASE

Lease Name El Poso Ranch	Well No. 8	Pool Name, including Formation Greenhorn WC Gallup	Kind of Lease State, Federal or Fee	Lease No. none
Location Unit Letter <u>N</u> : <u>618</u> Feet From The <u>south</u> Line and <u>2418</u> Feet From The <u>west</u> Line Section <u>14</u> Township <u>28N</u> Range <u>1E</u> , NMPM, Rio Arriba County				

III. DESIGNATION OF TRANSPORTER OF OIL AND NATURAL GAS

Name of Authorized Transporter of Oil <input checked="" type="checkbox"/> or Condensate <input type="checkbox"/> <i>Permian GARY ENERGY</i>	Address (Give address to which approved copy of this form is to be sent) Box 838 Hobbs NM 88240
Name of Authorized Transporter of Casinghead Gas <input type="checkbox"/> or Dry Gas <input type="checkbox"/>	Address (Give address to which approved copy of this form is to be sent)
If well produces oil or liquids, give location of tanks.	Unit Sec. Twp. Rge. Is gas actually connected? When?

If this production is commingled with that from any other lease or pool, give commingling order number:

IV. COMPLETION DATA

Designate Type of Completion - (X)	Oil Well	Gas Well	New Well	Workover	Deepen	Plug Back	Same Res'v	Diff Res'v
Date Spudded	Date Compl. Ready to Prod.		Total Depth		P.B.T.D.			
Elevations (DF, RKB, RI, GR, etc.)	Name of Producing Formation		Top Oil/Gas Pay		Tubing Depth			
Perforations					Depth Casing Shoe			
TUBING, CASING AND CEMENTING RECORD								
HOLE SIZE	CASING & TUBING SIZE		DEPTH SET		SACKS CEMENT			

V. TEST DATA AND REQUEST FOR ALLOWABLE

OIL WELL (Test must be after recovery of total volume of load oil and must be equal to or exceed top allowable for this depth or be for full 24 hours.)

Date First New Oil Run To Tank	Date of Test	Producing Method (Flow, pump, gas lift, etc.)
Length of Test	Tubing Pressure	Casing Pressure
Actual Prod. During Test	Oil - Bbls.	Water - Bbls.

RECEIVED
AUG 30 1990
OIL CON. DIV
DIST. 3

GAS WELL

Actual Prod. Test - MCF/D	Length of Test	Bbls. Condensate/MCF	Gravity of Condensate
Testing Method (pilot, back pr.)	Tubing Pressure (Shut-in)	Casing Pressure (Shut-in)	Choke Size

VI. OPERATOR CERTIFICATE OF COMPLIANCE

I hereby certify that the rules and regulations of the Oil Conservation Division have been complied with and that the information given above is true and complete to the best of my knowledge and belief.

Signature Jim C. Johnson
Printed Name Jim C. Johnson Production Manager
Date 8-29-90 Telephone No. 505 293 4044

OIL CONSERVATION DIVISION

Date Approved SEP 05 1990
By Original Signed
Title DEPUTY OIL & GAS INSPECTOR, DIST. #

INSTRUCTIONS: This form is to be filed in compliance with Rule 1104

- 1) Request for allowable for newly drilled or deepened well must be accompanied by tabulation of deviation tests taken in accordance with Rule 111.
- 2) All sections of this form must be filled out for allowable on new and recompleated wells.
- 3) Fill out only Sections I, II, III, and VI for changes of operator, well name or number, transporter, or other such changes.
- 4) Separate Form C-101 must be filed for each change.



STATE OF NEW MEXICO

ENERGY, MINERALS and NATURAL RESOURCES DEPARTMENT

OIL CONSERVATION DIVISION

AZTEC DISTRICT OFFICE

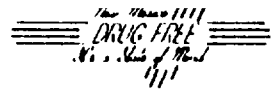

BRUCE KING
GOVERNOR

ANITA LOCKWOOD
CABINET SECRETARY

1000 RIO BRAZOS ROAD
AZTEC, NEW MEXICO 87410
(505) 334-6178

August 24, 1992

Petroleum Development Corp. N.W.
9720B Candelaria NE
Albuquerque, NM 87112

RE: Temporarily Abandoned Wells
El Poso Ranch #9, N-11-28N-01E
El Poso Ranch #8, N-14-28N-01E
Samantha #1, L-26-28N-01E
Samantha #3, N-26-28N-01E

To Whom It May Concern:

Our records indicate that you failed to respond to Memorandum (3-91-10) dated December 27, 1991. These wells are still inactive and require P&A or TA approval under Rules 201, 202 and 203. Plans to bring these wells into compliance were to be submitted to this office by June 30, 1992 and work completed by December 31, 1992. Rule 203 requires that a notice of intent to temporarily abandon a well be submitted on a Sundry Notice (OCD Form C-103) and that a mechanical integrity test (MIT) be conducted on the casing prior to final approval. If there is a notice of intent to P&A filed and approved for this well the work is to be completed by December 31, 1992, or the well is to be tested and approved for TA.

A case will be docketed for hearing to show cause why referenced well should not be plugged and abandoned in accordance with a Division approved plugging program.

Sincerely,

Dianna K. Fairhurst

Dianna K. Fairhurst
Deputy Oil & Gas Inspector

DKF/sh

CC: TA File
Well File
DKF File



STATE OF NEW MEXICO
ENERGY, MINERALS AND NATURAL RESOURCES DEPARTMENT

OIL CONSERVATION DIVISION
AZTEC DISTRICT OFFICE



BRUCE KING
GOVERNOR

ANITA LOCKWOOD
CABINET SECRETARY

1000 RIO BRAZOS ROAD
AZTEC, NEW MEXICO 87410
(505) 334-6178

Certified: P-987-892-092

December 29, 1994

Petroleum Dev Corp
97208 Candelaria NE
Albuquerque NM 87112

United New Mexico Bank
PO Box 1081
Albuquerque NM 87103

RE: ~~El Poso Ranch #8, N-14-28N-01E~~, API # 30-039-23672

The referenced well is in violation of Rule 201.

You are hereby directed to plug and abandon this well or bring it into compliance with Rule 203 for temporary abandonment within 30 days.

If you fail to bring this well into compliance we will schedule a show cause hearing to plug this well using the bond.

Sincerely,

Johnny Robinson
Deputy Oil & Gas Inspector

JR/sh

cc: Rand Carroll
United New Mexico Bank
Well file



STATE OF NEW MEXICO
ENERGY, MINERALS AND NATURAL RESOURCES DEPARTMENT
OIL CONSERVATION DIVISION
AZTEC DISTRICT OFFICE



GARY E. JOHNSON
GOVERNOR

JENNIFER A. SALISBURY
CABINET SECRETARY

1000 RIO BRAZOS ROAD
AZTEC, NEW MEXICO 87410
(505) 334-6178 FAX: (505) 334-6170

August 8, 1995

Rand Carroll
New Mexico Oil Conservation
2040 S Pacheco
Sante Fe NM 87505

RE :Petroleum Development Corp El Poso Ranch

Dear Rand:

Petroleum Development was notified January 3, 1995 in regards to the attached list of wells. I have issued a number of extensions and had several phone conversations pertaining to bringing the wells into compliance. To this date there has been no production reported or remedial work performed on the wells. Please docket a case calling Petroleum Development and all interested parties to appear and show cause why the listed wells should not be plugged and abandoned in accordance with a Division approved plugging program.

Yours Truly,

Johnny Robinson
Deputy Oil & Gas Inspector

cc: Well File
Petroleum Dev
Fred Shelton
Norwest Bank

Petroleum Development Corporation

List of wells :

El Poso Ranch # 5	K-11-28N-01E	30-039-23275
El Poso Ranch # 6	L-23-28N-01E	30-039-23278
El Poso Ranch # 8	N-14-28N-01E	30-039-23672
El Poso Ranch # 11	K-14-28N-01E	30-039-23671