



United States Department of the Interior

BUREAU OF LAND MANAGEMENT
Wyoming State Office Reservoir Management Group
2987 Prospector Drive
Casper, Wyoming 82604-2968



FEB 26 2018 PM 03:15

In Reply Refer To:
3186
(3186.1)
Poker Lake Unit
NMNM71016X

R-153

FEB 16 2018

BEPCO, L.P.
Attn: Law Armstrong
810 Houston Street
Fort Worth, Texas 76102-6298

Re: First Revision to the Bone Spring Formation Participating Area "G"
Poker Lake Unit
Eddy County, New Mexico

Gentlemen:

The first revision to the Bone Spring Formation Participating Area "G" is hereby approved effective as of July 1, 2009, pursuant to Section 11 of the Poker Lake Unit Agreement, Eddy County, New Mexico.

The application enlarges the Bone Spring Formation Participating Area "G" from 160.58 acres to 561.28 acres and is based upon the completion of unit well 265H, located in the SW $\frac{1}{4}$ SW $\frac{1}{4}$ (SHL) of Section 6, T.24S., R.30E., unit tract No. 44, Lease No. NMLC068545, and in the SE $\frac{1}{4}$ SW $\frac{1}{4}$ (BHL) of Section 5, T.24S., R.30E., unit tract No. 42, Lease No. NMLC068430, with an initial potential of 442 BOPD and 1,628 MCFPD on July 3, 2009, from the Bone Spring Formation.

Copies of the approved request are being distributed to the appropriate agencies and one copy of Exhibits "A" and "B" are returned herewith. Please advise all interested parties of the approval of the first revision to the Bone Spring Formation Participating Area "G" effective as of July 1, 2009.

Any production royalties that are due must be reported and paid within 30 days of the Bureau of Land Management's approval date or the payors will be assessed interest for late payment under the Federal Oil and Gas Royalty Management Act of 1982 (30 CFR 218.54). If you need assistance or clarification, please contact the Office of Natural Resources Revenue (ONRR) at 1-800-525-9167 or 303-231-3856.

If you have any questions, please call the undersigned at (307) 261-7685.

Sincerely,

/s/ J. David Chase

J. David Chase
Chief, Reservoir Management Group

1 Enclosure

Encl. 1 - Exhibits "A" and "B"

cc: NMSO, James Glover
CFO, Chris Walls
ONRR, Glen Reese
New Mexico State Land Office, Anchor Holm
New Mexico Oil Conservation Division, William Jones



Exhibit "A"
First Revision Bone Spring Formation Participating Area "G"
Poker Lake Unit
Eddy County, New Mexico
Effective July 1, 2009

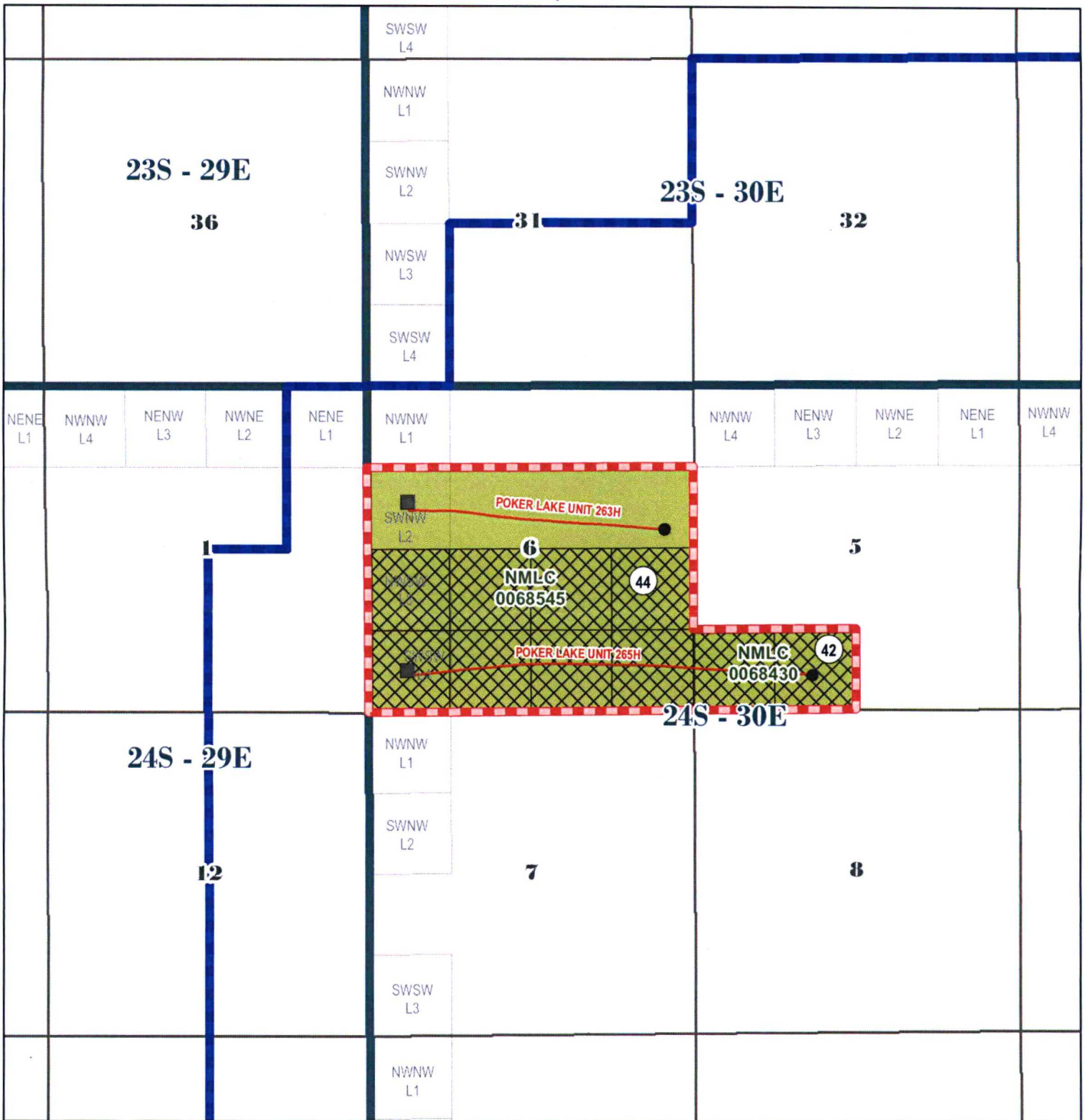

- POKER LAKE UNIT OUTLINE
- CAPABLE WELL (SHL)
- CAPABLE WELL (BHL)
- CAPABLE WELLBORE
- PROPOSED BONE SPRING PA "G"
- FEDERAL ACREAGE WITHIN PA "G" ONLY
- REVISED ACREAGE

0 0.25 0.5 1 1.5 Miles



Last GIS Dept. O:\ArcInfo\Projects\JAMON\Projects_NED\FLE_BSPG_Pa_Edougher_081008.mxd

RECEIVED 02/16/16 12:22 PM BLH WHPD/CASPER FIELD OFFICE

EXHIBIT "B"
 SCHEDULE OF LANDS AND TRACT PARTICIPATION
 FIRST REVISION BONE SPRING FORMATION PARTICIPATING AREA "G"
 POKER LAKE UNIT
 EDDY COUNTY, NEW MEXICO
 EFFECTIVE JULY 1, 2009

Tract No.	Lease No.	Description	Acres	Participation
42	NMLC068430 Federal	T24S-R30E, 23rd P.M. Section 5: S/2 SW/4	80.00	14.2531%
44	NMLC068545 Federal	T24S-R30E, 23rd P.M. Section 6: S/2 NE/4, SE/4NW/4, Lot 2 (40.58), E/2SW/4, Lot 3 (40.42), Lot 4 (40.28), SE/4	481.28	85.7469%
Totals			561.28	100.0000%

TYPE OF LAND	COMMITTED ACRES	NON-COMMITTED ACRES	PERCENT
FEDERAL	561.28	0.00	100.0000%
STATE	0.00	0.00	0.0000%
PATENTED	0.00	0.00	0.0000%
TOTAL	561.28	0.00	100.0000%