

Submit 1 Copy To Appropriate District Office
District I - (575) 393-6161
1625 N. French Dr., Hobbs, NM 88240
District II - (575) 748-1283
811 S. First St., Artesia, NM 88210
District III - (505) 334-6178
1000 Rio Brazos Rd., Aztec, NM 87410
District IV - (505) 476-3460
1220 S. St. Francis Dr., Santa Fe, NM 87505

State of New Mexico
Energy, Minerals and Natural Resources

Form C-103
Revised July 18, 2013

OIL CONSERVATION DIVISION
1220 South St. Francis Dr.
Santa Fe, NM 87505

WELL API NO.
30-025-45464

5. Indicate Type of Lease
STATE ☒ FEE ☐

6. State Oil & Gas Lease No.
VB-1743; VO-7378-1

7. Lease Name or Unit Agreement Name

Caravan 28 State Com

8. Well Number 602H

9. OGRID Number 7377

10. Pool name or Wildcat
Triste Draw, Bone Spring, East

SUNDRY NOTICES AND REPORTS ON WELLS

(DO NOT USE THIS FORM FOR PROPOSALS TO DRILL OR TO DEEPEN OR PLUG BACK TO A DIFFERENT RESERVOIR. USE "APPLICATION FOR PERMIT" (FORM C-101) FOR SUCH PROPOSALS.)

1. Type of Well: Oil Well ☒ Gas Well ☐ Other

2. Name of Operator
EOG Resources, Inc.

3. Address of Operator
P.O. Box 2267, Midland, Texas 79702

4. Well Location

Unit Letter D : 481 feet from the North line and 361 feet from the West line
Section 28 Township 24S Range 33E NMPM Lea County

11. Elevation (Show whether DR, RKB, RT, GR, etc.)
3532'

12. Check Appropriate Box to Indicate Nature of Notice, Report or Other Data

NOTICE OF INTENTION TO:

PERFORM REMEDIAL WORK ☐ PLUG AND ABANDON ☐
TEMPORARILY ABANDON ☐ CHANGE PLANS ☐
PULL OR ALTER CASING ☐ MULTIPLE COMPL ☐
DOWNHOLE COMMINGLE ☐
CLOSED-LOOP SYSTEM ☐
OTHER: Surface Commingle ☒

SUBSEQUENT REPORT OF:

REMEDIAL WORK ☐ ALTERING CASING ☐
COMMENCE DRILLING OPNS. ☐ P AND A ☐
CASING/CEMENT JOB ☐
OTHER: ☐

13. Describe proposed or completed operations. (Clearly state all pertinent details, and give pertinent dates, including estimated date of starting any proposed work). SEE RULE 19.15.7.14 NMAC. For Multiple Completions: Attach wellbore diagram of proposed completion or recompletion.

EOG respectfully requests an amendment to our approved surface commingling order PLC-502 to add the following wells to the Convoy Central CTB:

Caravan 28 State Com 602H	30-025-45464	(96682) Triste Draw; Bone Spring, East
Caravan 28 State Com 704H	30-025-45465	(98092) WC-025 G-09 S243336I; Upper Wolfcamp
Caravan 28 State Com 705H	30-025-45466	(98092) WC-025 G-09 S243336I; Upper Wolfcamp

Attached please find the C-102 plats and an updated facility diagram.

Spud Date:

Rig Release Date:

I hereby certify that the information above is true and complete to the best of my knowledge and belief.

SIGNATURE Sarah Mitchell TITLE Regulatory Contractor DATE 5/3/19

Type or print name Sarah Mitchell E-mail address: sarah_mitchell@eogresources.com PHONE: 432-848-9133

For State Use Only

APPROVED BY: [Signature] TITLE Engineering Bureau DATE MAY 6, 2019
Conditions of Approval (if any):

District I
1625 N. French Dr., Hobbs, NM 88240
Phone: (575) 393-6161 Fax: (575) 393-0720
District II
811 S. First St., Artesia, NM 88210
Phone: (575) 748-1283 Fax: (575) 748-9720
District III
1000 Rio Brazos Road, Aztec, NM 87410
Phone: (505) 334-6178 Fax: (505) 334-6170
District IV
1220 S. St. Francis Dr., Santa Fe, NM 87505
Phone: (505) 476-3460 Fax: (505) 476-3462

State of New Mexico
Energy, Minerals & Natural Resources
Department
OIL CONSERVATION DIVISION
1220 South St. Francis Dr.
Santa Fe, NM 87505

HOBBES OGD
JAN 04 2019
RECEIVED

FORM C-102

Revised August 1, 2011

Submit one copy to appropriate

District Office

☐ AMENDED REPORT

WELL LOCATION AND ACREAGE DEDICATION PLAT

¹ API Number 32-025- 45866	² Pool Code 98092	³ Pool Name WC-025 G-09 S2433361; Upper Wolfcamp
⁴ Property Code 322918	⁵ Property Name CARAVAN 28 STATE COM	⁶ Well Number #705H
⁷ GRID No. 7377	⁸ Operator Name EOG RESOURCES, INC.	⁹ Elevation 3532'

¹⁰Surface Location

UL or lot no.	Section	Township	Range	Lot Idn	Feet from the	North/South line	Feet from the	East/West line	County
D	28	24-S	33-E	-	481'	NORTH	328'	WEST	LEA

¹¹Bottom Hole Location If Different From Surface

UL or lot no.	Section	Township	Range	Lot Idn	Feet from the	North/South line	Feet from the	East/West line	County
M	33	24-S	33-E	-	100'	SOUTH	330'	WEST	LEA

¹² Dedicated Acres 640	¹³ Joint or Infill	¹⁴ Consolidation Code	¹⁵ Order No.
--------------------------------------	-------------------------------	----------------------------------	-------------------------

No allowable will be assigned to this completion until all interests have been consolidated or a non-standard unit has been approved by the division.

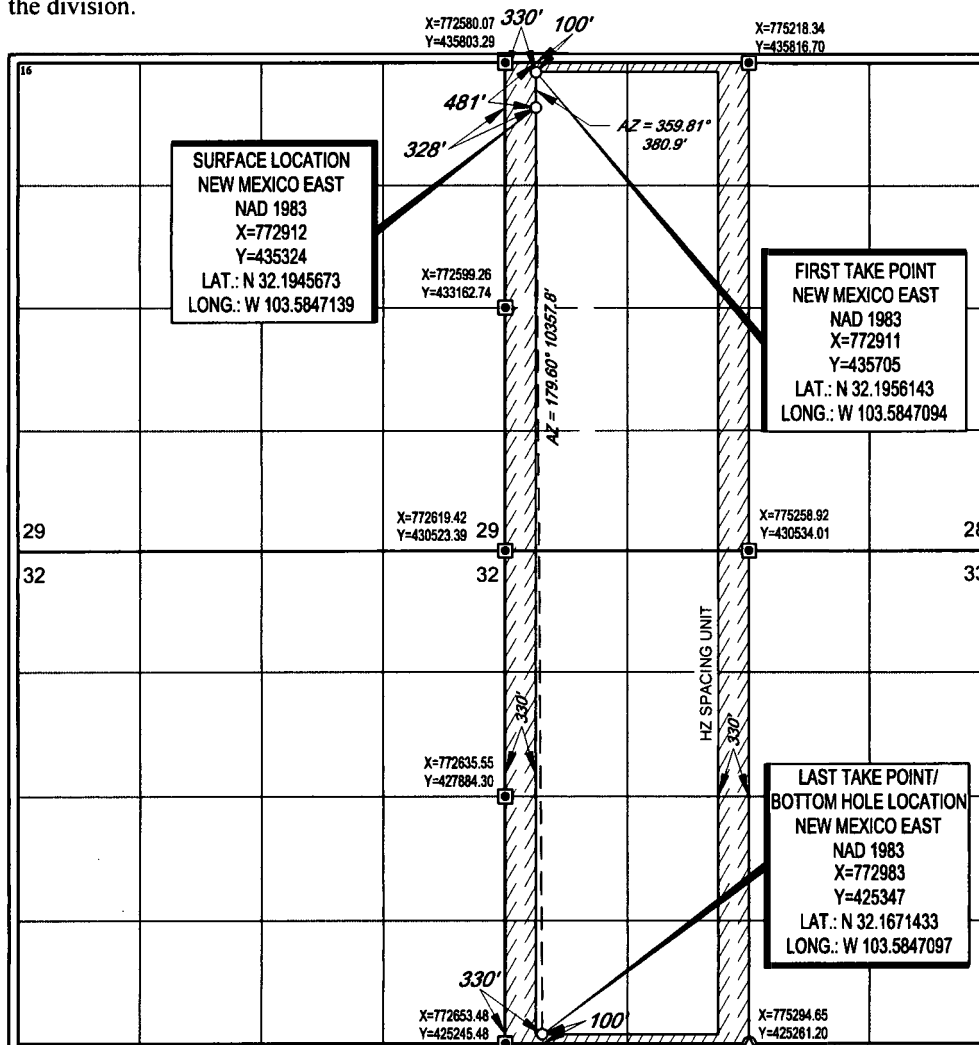

¹⁷OPERATOR CERTIFICATION

I hereby certify that the information contained herein is true and complete to the best of my knowledge and belief, and that this organization either owns a working interest or unleased mineral interest in the land including the proposed bottom hole location or has a right to drill this well at this location pursuant to a contract with an owner of such a mineral or working interest, or to a voluntary pooling agreement or a compulsory pooling order heretofore entered by the division.

Star L Harrell 12/27/18
Signature Date

Star Harrell
Printed Name

Star_Harrell@eogresources.com
E-mail Address

¹⁸SURVEYOR CERTIFICATION

I hereby certify that the well location shown on this plat was plotted from field notes of actual surveys made by me or under my supervision, and that the same is true to the best of my belief.

10/30/2018
Date of Survey
Signature and Seal of Professional Surveyor
MICHAEL B. BROWN
NEW MEXICO
18329
PROFESSIONAL SURVEYOR
Certificate Number

102050