

NO. OF COPIES RECEIVED	
DISTRIBUTION	
SANTA FE	
FILE	
U.S.G.S.	
LAND OFFICE	
OPERATOR	

NEW MEXICO OIL CONSERVATION COMMISSION

Form C-101
Revised 1-

API # 30-021-20132

APPLICATION FOR PERMIT TO DRILL, DEEPEN, OR PLUG BACK

1a. Type of Work			7. Unit Agreement Name	
b. Type of Well DRILL <input checked="" type="checkbox"/> DEEPEN <input type="checkbox"/> PLUG BACK <input type="checkbox"/>			8. Firm or Lease Name	
OIL WELL <input type="checkbox"/> GAS WELL <input checked="" type="checkbox"/> CO2 OTHER <input type="checkbox"/>			Sanford	
2. Name of Operator Amoco Production Company			9. Well No. 1	
3. Address of Operator P. O. Box 68 Hobbs, NM 88240			10. Field or Pool, or Wildcat Und. 1 Job	
4. Location of Well UNIT LETTER <u>J</u> LOCATED <u>1980</u> FEET FROM THE <u>South</u> LINE AND <u>1980</u> FEET FROM THE <u>East</u> LINE OF SEC. <u>7</u> TWP. <u>19-N</u> RGE. <u>33-E</u> NMPM			12. County Hardir	
18. Proposed Depth 2840'			19A. Formation Tubb	
21. Elevations (Show whether Dr., RT, etc.) 5012' GL		21A. Kind & Status Plug. Bond Blanket-on-file		22. Approval Date Work will start 2-27-81
23. PROPOSED CASING AND CEMENT PROGRAM			20. Rotary or C.T. Rotary	

SIZE OF HOLE	SIZE OF CASING	WEIGHT PER FOOT	SETTING DEPTH	SACKS OF CEMENT	EST. TOP
12-1/4	3-5/8"	24#	700'	Circ.	Surface
7-7/8"	5-1/2"	14#	2840'	Tie back to 8-5/8"	' BTM 8-5/8"

Propose to drill and equip well in the Tubb formation. After reaching TD loc ; will be run and evaluated. Perforate and stimulate as necessary in attempting commercial production.

MUD PROGRAM: 0'-700' Native mud and fresh water
700'-TD Commercial mud and brine with minimum properties for safe hole conditions.

BOP Program Attached
Gas is not dedicated

APPROVAL VALID FOR 180 DAYS
PERMIT EXPIRES 8-25-81
UNLESS DRILLING UNDERWAY

0+2-NMOCD, SF 1-Hou 1-Susp 1-BD

IN ABOVE SPACE DESCRIBE PROPOSED PROGRAM: IF PROPOSAL IS TO DEEPEN OR PLUG BACK, GIVE DATA ON PRESENT PRODUCTIVE ZONE. GIVE BLOWOUT PREVENTER PROGRAM, IF ANY.

I hereby certify that the information above is true and complete to the best of my knowledge and belief.

Signed Bob Laws Title Admin. Analyst Date 2-27-81

(This space for State Use)

APPROVED BY Carl King TITLE 1013 25 81 DATE 2/25/81

CONDITIONS OF APPROVAL, IF ANY:

NEW MEXICO OIL CONSERVATION COMMISSION
WELL LOCATION AND ACREAGE DEDICATION PLAT

Form C-102
Supersedes C-128
Effective 1-1-65

All distances must be from the outer boundaries of the Section.

Operator AMOCO		Lease SANFORD			Well No. 1
Unit Letter J	Section 7	Township T19N	Range R33E	County HARDING	
Actual Footage Location of Well: 1980		feet from the SOUTH		line and 1980 feet from the EAST	
Ground Level Elev. 5012	Producing Formation Tubb		Pool Und. Tubb	Dedicated Acreage: 0 Acres	

1. Outline the acreage dedicated to the subject well by colored pencil or hachure marks on the plat below.
2. If more than one lease is dedicated to the well, outline each and identify the ownership thereof both as to working interest and royalty.
3. If more than one lease of different ownership is dedicated to the well, have the interests of all owners been consolidated by communitization, unitization, force-pooling, etc?

Yes No If answer is "yes," type of consolidation _____

If answer is "no," list the owners and tract descriptions which have actually been consolidated. (Use reverse side of this form if necessary.) _____

No allowable will be assigned to the well until all interests have been consolidated (by communitization, unitization, forced-pooling, or otherwise) or until a non-standard unit, eliminating such interests, has been approved by the Commission.

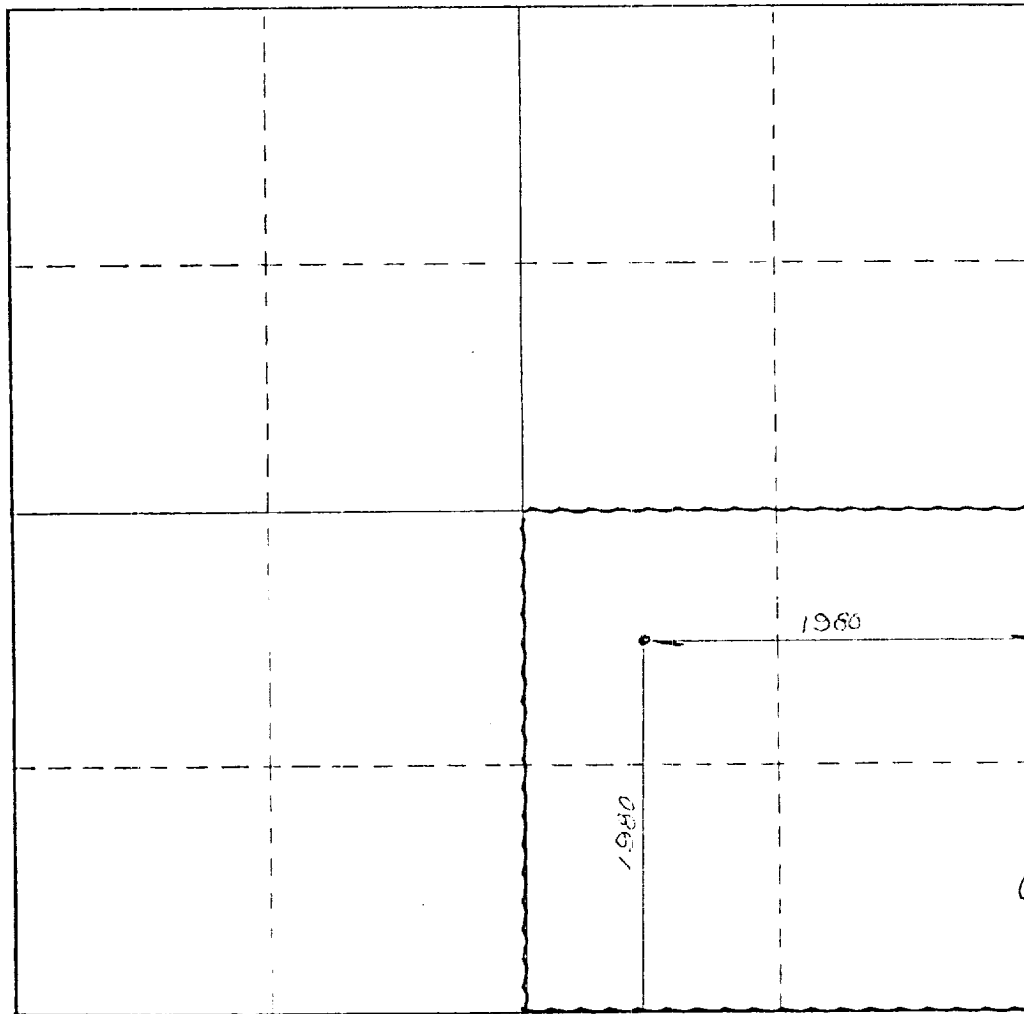

CERTIFICATION

I hereby certify that the information contained herein is true and complete to the best of my knowledge and belief.

Name: **Bob Davis**
Position: **Admin Analyst**
Company: **Amoco Production Company**
Date: **-20-81**

I hereby certify that the well location shown on this plat was plotted from field notes of actual surveys made by me or under my supervision, and that the same is true and correct to the best of my knowledge and belief.

FEB. 18 1981
Date Surveyed
[Signature]
Registered Professional Engineer
and of Land Surveyors
N.M.L.S. **0. 5103**
Certificate No. _____

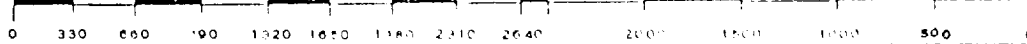

1. Blow-out preventers and master valve to be fluid operated and oil fittings must be in good condition, 3,000# W.P. (6,000 p.s.i. test), minimum.
2. Equipment through which bit must pass shall be as large as the inside diameter of the casing that is being drilled through.
3. Ripple above blow-out preventer shall be same size as casing being drilled through.
4. Kelly cock required, 3,000# W.P. (6,000 p.s.i. test) minimum.
5. OMSCO or comparable safety valve must be available on rig floor at all times with proper connection or sub, 3,000# W.P. (6,000 p.s.i. test), minimum.
6. Blow-out preventers and master valve while drilling intermediate hole to 6000' may be 2,000# W.P. (4,000 p.s.i. test), minimum.
7. Choke assembly, beyond second valve from cross, may be positioned (Optional) outside of derrick foundation.
8. Spool or cross may be eliminated if connections are available in the lower part of the blow-out preventer body.
9. Plug valves - gate valves are optional. Valves shown as 2" are minimum size.
10. Casing head and casing head spool, including attached valves, to be furnished by Amoco.
11. Rams in preventers will be installed as follows:

When drilling, use:		When running casing, use:	
Top Preventer	- Drill pipe rams	Top Preventer	- Casing rams
Bottom Preventer	- Blind rams or master valve	Bottom Preventer	- Blind rams or master valve

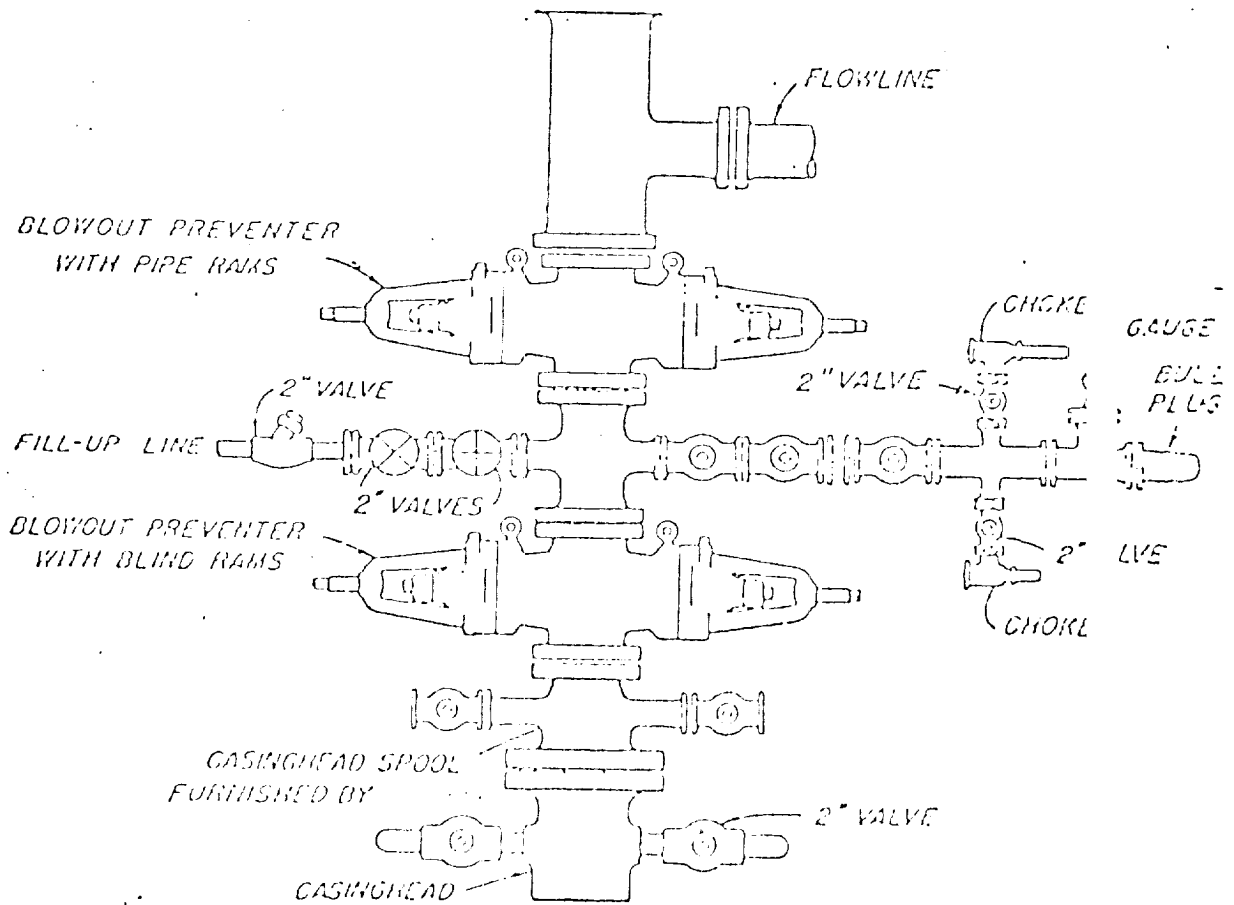

BLOWOUT PREVENTER HOOK-UP

AMOCO FIELD SERVICE COMPANY

EXHIBIT D-1 MODIFIED

JUNE 1, 1962