

All distances must be from the outer boundaries of the Section

Operator AMOCO		Lease Bravo Dome Carbon Dioxide Gas Unit			Well No. 2034 251F
Well Letter F	Section 25	Township T20N	Range R 34 E	County UNION	

Well Footage Location of Well:

1980 feet from the NORTH line and 1980 feet from the WEST line

Ground Level Elev. 4787	Producing Formation Tubb	Pool Bravo Dome 640-acre area	Dedicated Acreage: 640	Acres
----------------------------	-----------------------------	----------------------------------	---------------------------	-------

- Outline the acreage dedicated to the subject well by colored pencil or hachure marks on the plat below.
- If more than one lease is dedicated to the well, outline each and identify the ownership (both as to working interest and royalty).
- If more than one lease of different ownership is dedicated to the well, have the interests of all owners been consolidated by communitization, unitization, force-pooling etc?

RECEIVED
AUG 13 1984
OIL CONSERVATION DIVISION

Yes No If answer is "yes," type of consolidation Pooling Declaration

If answer is "no," list the owners and tract descriptions which have actually been consolidated. (Use reverse side of this form if necessary.)

No allowable will be assigned to the well until all interests have been consolidated (by communitization, unitization, forced-pooling, or otherwise) or until a non-standard unit, eliminating such interests, has been approved by the Division.

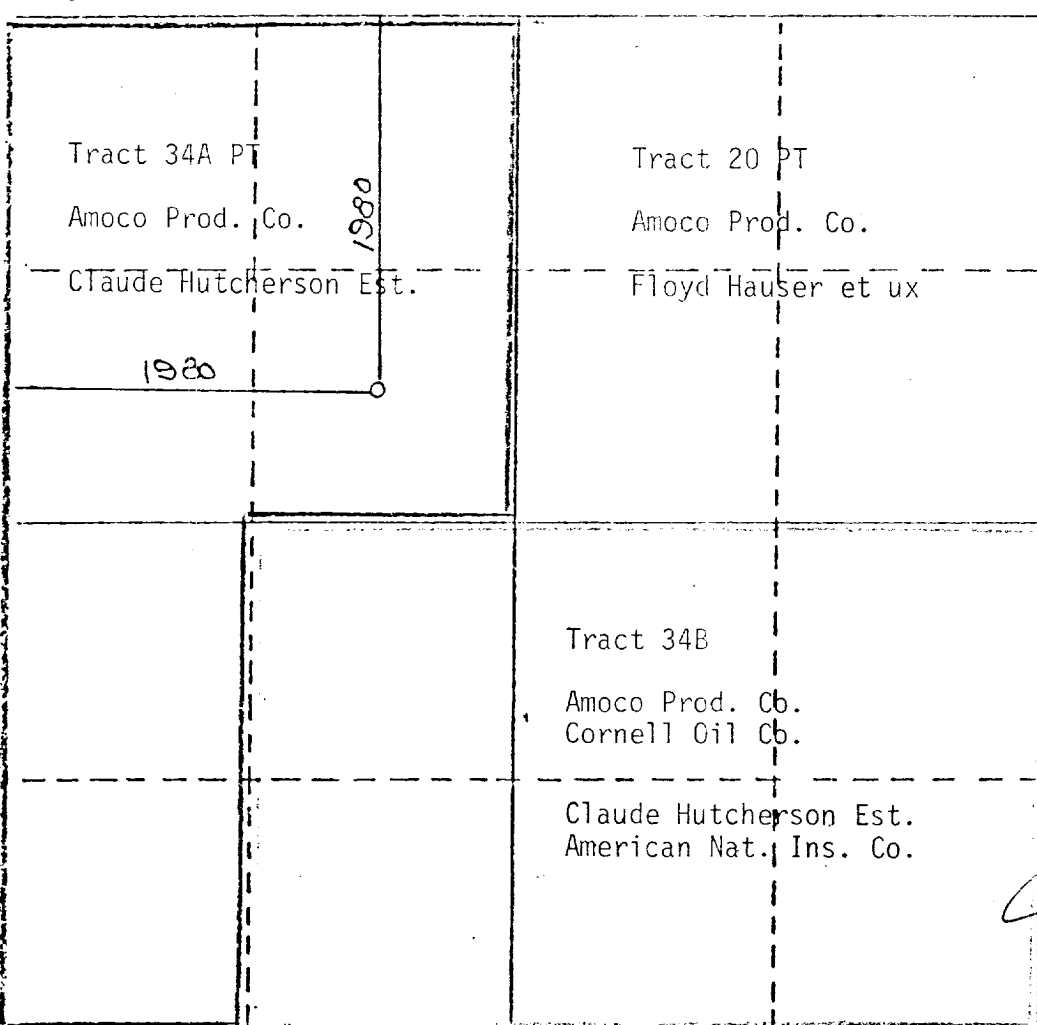

CERTIFICATION

I hereby certify that the information contained herein is true and complete to the best of my knowledge and belief.

Name: John D. McElroy
 Position: Asst. Admin. Analyst
 Company: Amoco Production Company
 Date: 8-8-84

I hereby certify that the well location shown on this plat was plotted from field notes of actual surveys made by me or under my supervision, and that the same is true and correct to the best of my knowledge and belief.

SEPT 26 1980
 State of New Mexico
 Registered Professional Engineer and/or Land Surveyor
 N.M.L.S. NO. 5103
 Certificate No. 31