

3R – 454

GEN COR

2013 - 2014



ENTERPRISE PRODUCTS PARTNERS L.P.
ENTERPRISE PRODUCTS HOLDINGS LLC
(General Partner)

ENTERPRISE PRODUCTS OPERATING LLC

LAT 2D-1LP (Olmer #4) /2011

May 2, 2013

EMNRD Oil Conservation Division
Aztec District III Office
Attn: Brandon Powell
1000 Rio Brazos Road
Aztec, NM 87410

Return Receipt Requested
7012 2920 0001 7977 4637

EMNRD Oil Conservation Division
Environmental Bureau
Attn: Glenn von Gonten
1220 South St. Francis Drive
Santa Fe, NM 87505

Return Receipt Requested
7012 2920 0001 7977 4644

BLM Farmington Field Office
Lands Team
Attn: Scott Hall/Sherrie Landon
6251 College Blvd. Suite A
Farmington, NM 87402

Return Receipt Requested
7012 2920 0001 7977 4651

RE: Lateral 2D-1LP (Olmer #4) August 2011 Pipeline Release
Approval Request for Plugging &
Abandonment of Groundwater Monitor Wells

Dear Sir or Madam:

Enclosed please find the Approval Request for Plugging and Abandonment of Groundwater Monitor Wells for Lateral 2D-1LP (Olmer #4) August 2011 Pipeline Release in San Juan County, NM.

If you have any questions or need more information, please contact Aaron Dailey, Field Environmental Representative, by phone at 505-599-2286, by email at amdailey@eprod.com or me at 713-381-6684.

Regards,

Matthew E. Marra
(En)

Matthew E. Marra
Sr. Director, Environmental

/bjm
enclosure

RECEIVED
OCD
701 2920-6 P 2:44



April 17, 2013

Glenn von Gonten
New Mexico Oil Conservation Division
1220 S. St. Francis Drive
Santa Fe, New Mexico 87505

624 E. Comanche
Farmington, NM 87401
800-454-6290

Director, Compliance
970-413-2084

**RE: Approval Request for Plugging and Abandonment of Groundwater Monitor Wells
Enterprise Field Services, LLC
Lateral 2D-1LP (Olmer #4) August 2011 Pipeline Release
SW¼ NE¼, Section 26, T28N, R10W
San Juan County, New Mexico**

Dear Mr. von Gonten:

Animas Environmental Services, LLC (AES), on behalf of Enterprise Field Services, LLC (Enterprise), has prepared this request for approval to plug and abandon (P&A) four groundwater monitor wells at the Lateral 2D-1LP (Olmer #4) August 2011 release site.

A release was reported at the Lateral 2D-1LP (Olmer #4) release site location on August 2, 2011, by Enterprise. The release is located along the Enterprise Lateral 2D-1LP leading from the Olmer #4 well tie within the SW¼ NE¼, Section 26, T28N, R10W, San Juan County, New Mexico. Latitude and longitude of the release were recorded as N36° 38.033' and W107° 51.832'. Note that the project area is located on U.S. Department of Interior (USDI) Bureau of Land Management (BLM) land with an active grazing lease. A topographic site location map is included as Figure 1, and an aerial site map showing groundwater monitor well locations is included as Figure 2.

1.0 Site Information

1.1 Release History

A release was reported at the location on August 2, 2011, by Enterprise personnel. The cause of the release was attributed to a line leak due to corrosion. Remedial excavation activities were conducted in August 2011, and AES collected soil samples from the base and mid-walls of the excavation, which measured approximately 20 feet by 20 feet by 8 feet deep. Benzene, toluene, ethylbenzene, and xylene (BTEX) and total petroleum hydrocarbon (TPH) concentrations for all three soil samples collected were either below laboratory detection limits or below applicable NMOCD action levels. A grab sample from shallow groundwater was also collected from near the base of the excavation for laboratory analysis. Dissolved

phase benzene, toluene, and total xylene concentrations were reported above the New Mexico Water Quality Control Commission (WQCC) standards for groundwater.

On August 23, 2011, the excavation was extended to approximately 4 feet below the pipeline, for a total depth of 12 feet bgs. The excavation was extended horizontally resulting in an excavation area approximately 30 feet by 20 feet. Prior to backfilling the excavation, one groundwater sample was collected from the excavation for laboratory analysis. Dissolved phase benzene concentrations were reported above the WQCC standard with 31 µg/L. Details of the release assessment were included in a continued site investigation letter report dated September 9, 2011.

1.2 Groundwater Investigation – November 2011

In November 2011, a groundwater investigation was conducted by AES in order to delineate the full extent of petroleum hydrocarbon impact on groundwater resulting from the release. The investigation included the installation of four soil borings (SB-1 through SB-4), which were completed as groundwater monitor wells (MW-1 through MW-4).

Soil analytical results confirmed that soil samples collected from SB-1 through SB-4 were below NMOCD action levels or below laboratory detection limits for benzene, total BTEX, and TPH. Groundwater analytical results for samples collected from MW-1 through MW-4 showed that concentrations for BTEX were below applicable WQCC standards, and TPH concentrations were below laboratory detection limits.

Based upon the results of the groundwater investigation associated with the Lateral 2D-1LP (Olmer #4) Pipeline release, it was determined groundwater was not impacted within the source area above applicable WQCC standards, and AES recommended at least three additional quarterly groundwater monitoring and sampling events to confirm contaminant concentrations remain below WQCC standards. Details of the groundwater investigation are included in the report entitled *Groundwater Investigation Report* dated March 12, 2012.

2.3 Groundwater Monitoring – March, June, and September 2012

AES conducted additional quarterly groundwater monitoring and sampling in March, June, and September 2012. Groundwater analytical results from these events showed that BTEX and TPH concentrations were either below laboratory detection limits or well below applicable WQCC standards for contaminants of concern. The highest benzene concentration reported during the four consecutive quarters was in MW-3 with 2.2 µg/L during the March 2012 sampling event. Sampling reports dated June 11, August 27, and December 13, 2012, were submitted to NMOCD and detailed groundwater monitoring and sampling activities.

3.0 Proposed Scope of Work

Based on current site data and in accordance with the project workplan, quarterly sampling has shown four consecutive quarters of groundwater contaminant concentrations well below applicable WQCC standards. AES proposes to plug and abandon (P&A) all site monitor wells (MW-1 through MW-4), and has requested No Further Action status for this site.

AES proposes to P&A MW-1 through MW-4 in accordance with applicable NMOCD and New Mexico Office of the State Engineer (NMOSE) requirements, which includes completion of the Well Plugging Plan of Operations (WD-08) for submittal to NMOSE prior to initiating site work. P&A activities will be completed upon approval from NMOCD and permit approval from NMOSE. Once completed, NMOSE well abandonment forms will be submitted, and P&A activities will be summarized in a letter report to NMOCD.

If you have any questions about this report or site conditions, please do not hesitate to contact me or Ross Kennemer at (505) 564-2281.

Respectfully submitted,



Tami C. Ross, CHMM
Project Manager

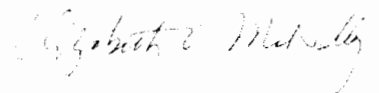

Elizabeth McNally, PE
Principal

Attachments:

Figure 1. Topographic Site Location Map

Figure 2. Aerial Site Map

cc: Brandon Powell
New Mexico Oil Conservation Division
1000 Rio Brazos Road
Aztec, New Mexico 87410

Glenn von Gonten
April 17, 2013
p. 4

Jim Griswold
New Mexico Oil Conservation Division
1220 S. St. Francis Drive
Santa Fe, New Mexico 87505

Aaron Dailey
Enterprise Field Services, LLC
614 Reilly Avenue
Farmington, New Mexico 87401

R:\Animas 2000\Dropbox\2013 Projects\Enterprise\Olmer #4\NMOCD Request Ltr for PA 041713.docx

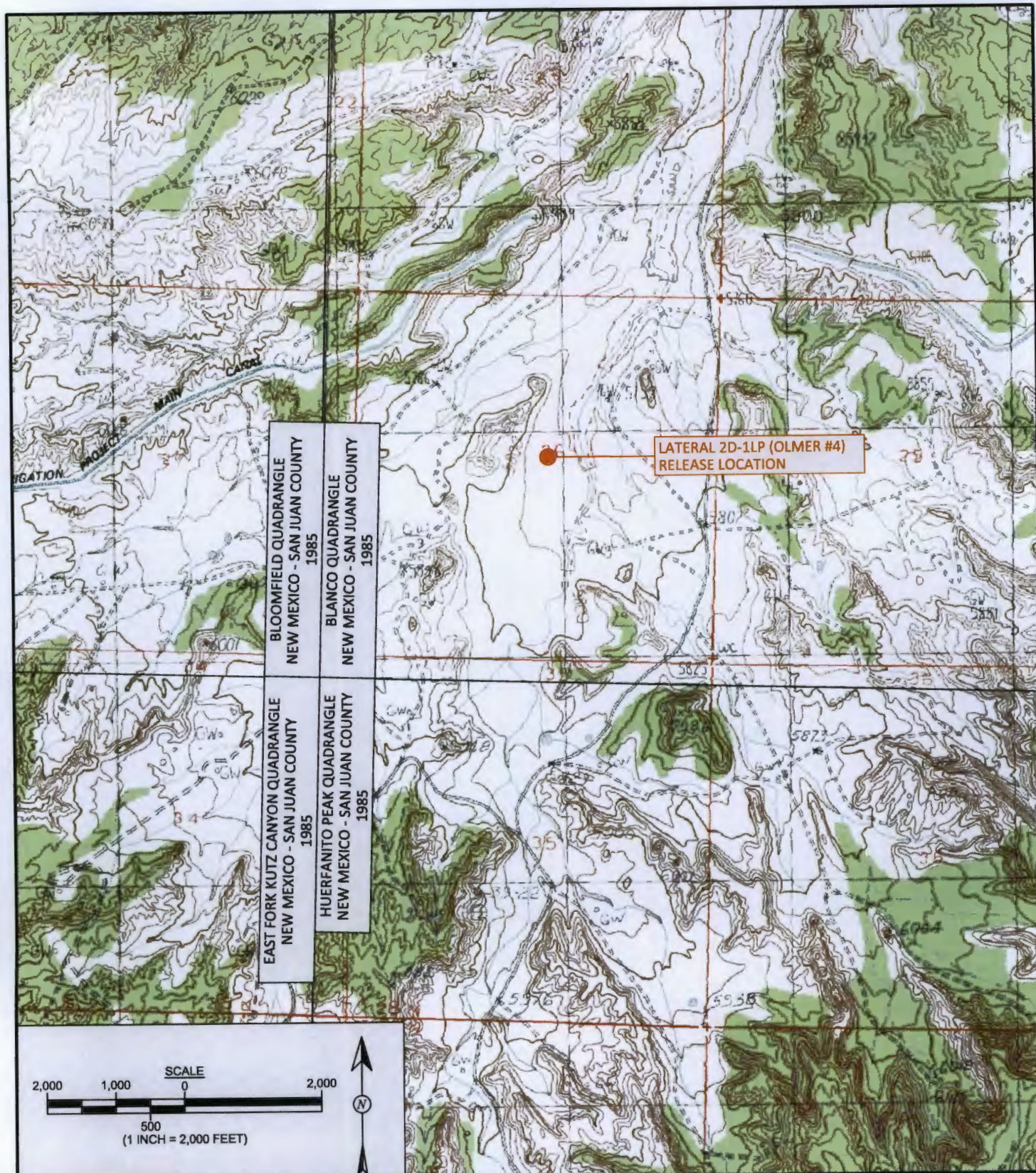

Animas Environmental Services, LLC

DRAWN BY: C. Lameman	DATE DRAWN: January 19, 2012
REVISIONS BY: C. Lameman	DATE REVISED: December 4, 2012
CHECKED BY: T. Ross	DATE CHECKED: December 4, 2012
APPROVED BY: E. McNally	DATE APPROVED: December 4, 2012

FIGURE 1

TOPOGRAPHIC SITE LOCATION MAP
ENTERPRISE FIELD SERVICES, LLC
LATERAL 2D-1LP (OLMER #4)
2011 PIPELINE RELEASE
SAN JUAN COUNTY, NEW MEXICO
SW¼ NE¼, SEC. 26, T28N, R10W
N36.63388, W107.86387

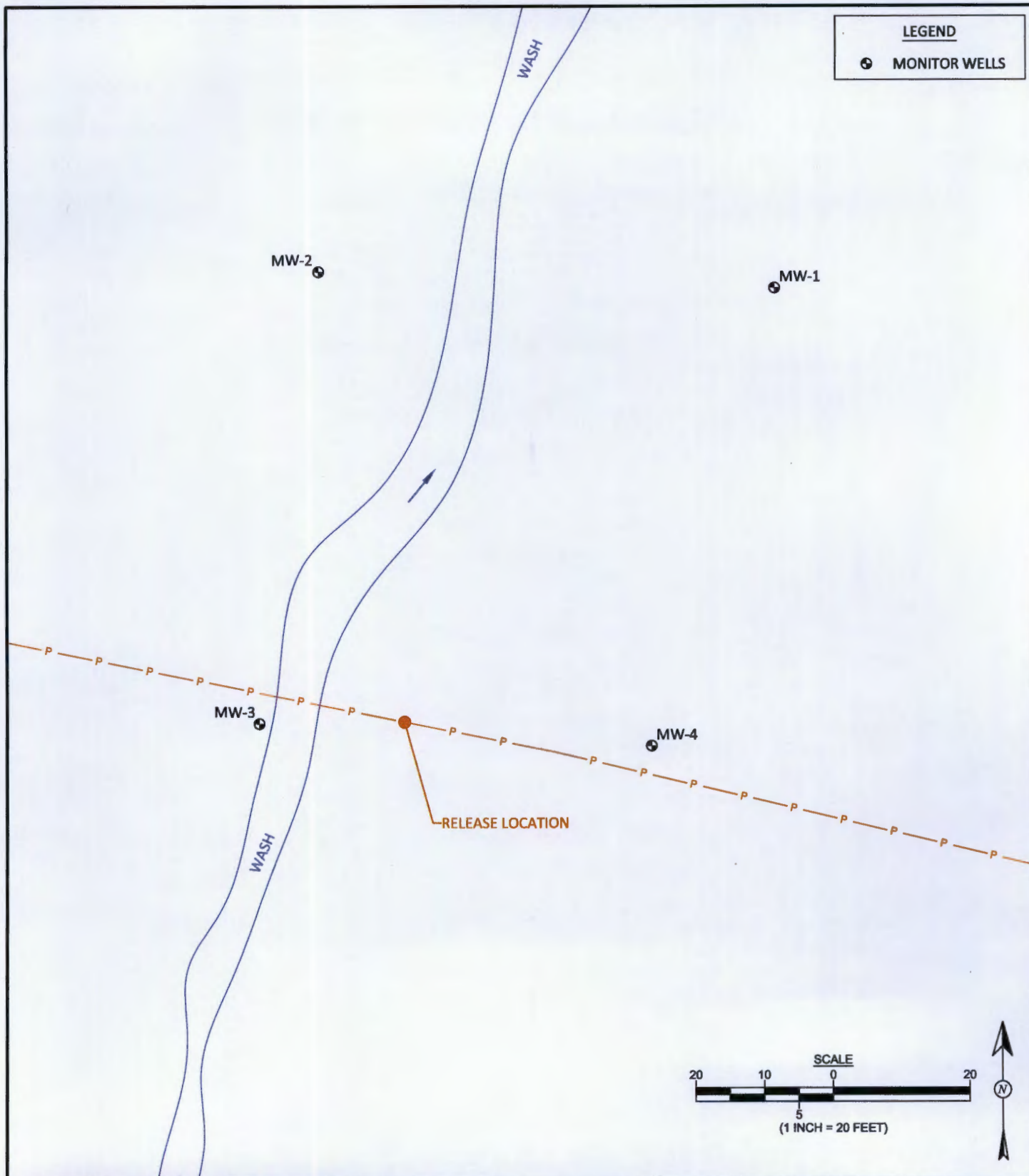

DRAWN BY: C. Lameman	DATE DRAWN: January 19, 2012
REVISIONS BY: C. Lameman	DATE REVISED: December 4, 2012
CHECKED BY: T. Ross	DATE CHECKED: December 4, 2012
APPROVED BY: E. McNally	DATE APPROVED: December 4, 2012

FIGURE 2

GENERAL SITE MAP
ENTERPRISE FIELD SERVICES, LLC
LATERAL 2D-1LP (OLMER #4)
2011 PIPELINE RELEASE
SAN JUAN COUNTY, NEW MEXICO
SW¼ NE¼, SEC. 26, T28N, R10W
N36.63388, W107.86387