

APPROVED

By OCD; Dr. Oberding at 10:19 am, Feb 24, 2015

**OXY USA, Inc.
South Hobbs Unit 29
Delineation Report and Work Plan
3526
Section 5, T19S, R38E
Lea County, New Mexico**

February 23, 2015



RECEIVED

By OCD; Dr. Oberding at 10:14 am, Feb 24, 2015

Prepared for:

**OXY USA, Inc.
1017 W Stanolind Road
Hobbs, New Mexico 88240**

By:

**Safety & Environmental Solutions, Inc.
703 East Clinton Street
Hobbs, New Mexico 88240
(575) 397-0510**

TABLE OF CONTENTS

I. COMPANY CONTACTS.....	1
II. BACKGROUND.....	1
III. SURFACE AND GROUND WATER.....	1
IV. CHARACTERIZATION.....	1
V. WORK PERFORMED.....	1
VI. ACTION PLAN.....	3
VII. FIGURES & APPENDICES	3
Figure 1 – Vicinity Map.....	5
Figure 2 – Site Plan	7
Appendix A – Analytical Results	9
Appendix B – C-141	39
Appendix C – Site Photographs.....	Error! Bookmark not defined.

I. Company Contacts

Representative	Company	Telephone	E-mail
Raymond Aguilar	OXY USA, INC.	575-390-6312	Raymond_aguilar@oxy.com
Bob Allen	SESI	575-397-0510	ballen@sesi-nm.com

II. Background

Safety and Environmental Solutions, Inc. (SESI) was engaged by OXY USA, INC to perform site assessment of a release area at the South Hobbs Unit 29 located in Section 5 of Township 19 South, Range 38 East, Lea County, New Mexico.

According to the C-141 the cause of release was external corrosion.

III. Surface and Ground Water

The nearest groundwater of record is approximately 1.0 mile from the site. The New Mexico Office of State Engineer record is in Section 5 Range 38 East and Township 19 South. The reported depth was 26 feet below ground surface (BGS).

IV. Characterization

The target cleanup levels are determined using the *Guidelines for Remediation of Leaks, Spills and Releases* published by the NMOCD (August 13, 1993). Based on the ranking criteria presented below, the applicable Recommended Remediation Action Levels (RRAL) are 10 parts per million (ppm) Benzene, 50 ppm combined benzene, toluene, ethylbenzene, and total xylenes (BTEX), and 5,000 ppm Total Petroleum Hydrocarbons (TPH).

Depth to Ground Water:			
(Vertical distance from contaminants to seasonal high water elevation of groundwater)	Less than 50 feet	20 points	
	50 feet to 99 feet	10 points	
	>100 feet	0 points	X
Wellhead Protection Area:			
(Less than 200 feet from a private domestic water source; or less than 1000 feet from all other water sources)	Yes	20 points	
	No	0 points	X
Distance to Surface Water:			
(Horizontal distance to perennial lakes, ponds, rivers, streams, creeks, irrigation canals and ditches)	Less than 200 feet	20 points	
	200 feet to 1000 feet	10 points	
	>1000 feet	0 points	X
RANKING SCORE (TOTAL POINTS)			0

V. Work Performed

On January 27, 2015, SESI was onsite to determine vertical extent of contamination using boreholes. Samples BH-1 was taken at a depth of 2' ft., 4' ft. and 6.5' ft. Samples BH-2 were taken at 2' ft. and 4 ft. BH-3 were taken at 2' ft. and 4 ft. BH-4 were taken at 2' ft. and 3' ft. BH-5 were taken at 2' ft. and 3.5-3.8' ft. BH-6 were taken at 2' ft. and 3-3.4' ft. BH-7 were taken at 2' ft. and 3-3.8' ft. BH-8 were taken at 2' ft. and 3.5-4' ft. All samples were properly packaged, preserved and transported to the Laboratory, Hobbs

New Mexico and analyzed for Benzene, Toluene, Ethylbenzene, Xylenes, Total BTEX and Chloride (Cl⁻) (Method SM4500Cl-B). The results of the analysis are presented in the table below:

Sample Date 1/27/2015	Sample ID	Benzene (mg/kg)	Toluene (mg/kg)	Ethylbenzene (mg/kg)	Xylenes (mg/kg)	Total BTEX
Depth	Method					
BH-1 at 2'	BTEX 8021B	<0.050	<0.050	<0.050	<0.150	<0.300
BH-1 at 4'	BTEX 8021B	<0.050	<0.050	<0.050	<0.150	<0.300
BH-1 at 6.5'	BTEX 8021B	<0.050	<0.050	<0.050	<0.150	<0.300
BH-2 at 2'	BTEX 8021B	<0.050	<0.050	<0.050	<0.150	<0.300
BH-2 at 4'	BTEX 8021B	<0.050	<0.050	<0.050	<0.150	<0.300
BH-3 at 2'	BTEX 8021B	<0.050	<0.050	<0.050	<0.150	<0.300
BH-3 at 4'	BTEX 8021B	<0.050	<0.050	<0.050	<0.150	<0.300
BH-4 at 2'	BTEX 8021B	<0.050	<0.050	<0.050	<0.150	<0.300
BH-4 at 3'	BTEX 8021B	<0.050	<0.050	<0.050	<0.150	<0.300

Sample Date 01/27/2015	Sample ID	Chloride (Cl)	Sample ID	GRO (C ₆ -C ₁₀) (mg/kg)	DRO (>C ₁₀ -C ₂₈) (mg/kg)
Depth	Method		Method		
BH-1 at 2'	SM4500Cl-B	464	TPH 8015M	<10.0	<10.0
BH-1 at 4'	SM4500Cl-B	496	TPH 8015M	<10.0	<10.0
BH-1 at 6.5'	SM4500Cl-B	384	TPH 8015M	<10.0	<10.0
BH-2 at 2'	SM4500Cl-B	464	TPH 8015M	<10.0	<10.0
BH-2 at 4'	SM4500Cl-B	368	TPH 8015M	<10.0	<10.0
BH-3 at 2'	SM4500Cl-B	416	TPH 8015M	<10.0	<10.0
BH-3 at 4'	SM4500Cl-B	272	TPH 8015M	<10.0	<10.0
BH-4 at 2'	SM4500Cl-B	544	TPH 8015M	<10.0	<10.0
BH-4 at 3'	SM4500Cl-B	480	TPH 8015M	<10.0	<10.0

Sample Date 1/28/2015	Sample ID	Benzene (mg/kg)	Toluene (mg/kg)	Ethylbenzene (mg/kg)	Xylenes (mg/kg)	Total BTEX
Depth	Method					
BH-5 at 2'	BTEX 8021B	<0.050	<0.050	<0.050	<0.150	<0.300
BH-5 at 3.5-3.8'	BTEX 8021B	<0.050	<0.050	<0.050	<0.150	<0.300
BH-6 at 2'	BTEX 8021B	<0.050	<0.050	<0.050	<0.150	<0.300
BH-6 at 3-3.4'	BTEX 8021B	<0.050	<0.050	<0.050	<0.150	<0.300
BH-7 at 2'	BTEX 8021B	<0.050	<0.050	<0.050	<0.150	<0.300
BH-7 at 3-3.8'	BTEX 8021B	<0.050	<0.050	<0.050	<0.150	<0.300
BH-8 at 2'	BTEX 8021B	<0.050	<0.050	<0.050	<0.150	<0.300
BH-8 at 3.5-4'	BTEX 8021B	<0.050	<0.050	<0.050	<0.150	<0.300

Sample Date 01/28/2015	Sample ID	Chloride (Cl)	Sample ID	GRO (C ₆ -C ₁₀) (mg/kg)	DRO (>C ₁₀ -C ₂₈) (mg/kg)
Depth	Method		Method		
BH-5 at 2'	SM4500Cl-B	3160	TPH 8015M	<10.0	<10.0
BH-5 at 3.5-3.8'	SM4500Cl-B	1660	TPH 8015M	<10.0	<10.0
BH-6 at 2'	SM4500Cl-B	96.0	TPH 8015M	<10.0	<10.0
BH-6 at 3-3.4'	SM4500Cl-B	96.0	TPH 8015M	<10.0	<10.0
BH-7 at 2'	SM4500Cl-B	32.0	TPH 8015M	<10.0	<10.0
BH-7 at 3-3.8'	SM4500Cl-B	16.0	TPH 8015M	<10.0	<10.0
BH-8 at 2'	SM4500Cl-B	544	TPH 8015M	<10.0	<10.0
BH-8 at 3.5-4'	SM4500Cl-B	272	TPH 8015M	<10.0	<10.0

Sample Date 01/28/2015	Sample ID	Benzene (mg/kg)	Toluene (mg/kg)	Ethylbenzene (mg/kg)	Xylenes (mg/kg)	Total BTEX
Depth	Method					
AH-1 at 2'	BTEX 8021B	<0.050	<0.050	<0.050	<0.150	<0.300
AH-1 at 3'6"	BTEX 8021B	<0.050	<0.050	<0.050	<0.150	<0.300

Sample Date 01/28/2015	Sample ID	Chloride (Cl)	Sample ID	GRO (C ₆ -C ₁₀) (mg/kg)	DRO (>C ₁₀ -C ₂₈) (mg/kg)
Depth	Method		Method		
AH-1 at 2'	SM4500Cl-B	432	TPH 8015M	<10.0	<10.0
AH-1 at 3'6"	SM4500Cl-B	464	TPH 8015M	<10.0	<10.0

VI. Action Plan

Due to the results listed above the following action plan is proposed:

Excavate and remove all Chloride contaminated soil to the depth where the concentration is 250 PPM chlorides and 100 TPH. Contaminated soils will be transported to an approved NMOCD facility for disposal. The excavated area will be backfilled with native soil and returned to natural grade. Composite confirmation samples will be taken from the sides and bottom of the excavation area.

VII. Figures & Appendices

Figure 1 – Vicinity Map
 Figure 2 – Site Plan
 Appendix A – Analytical Results
 Appendix B – C-141

Figure 1

Vicinity Map

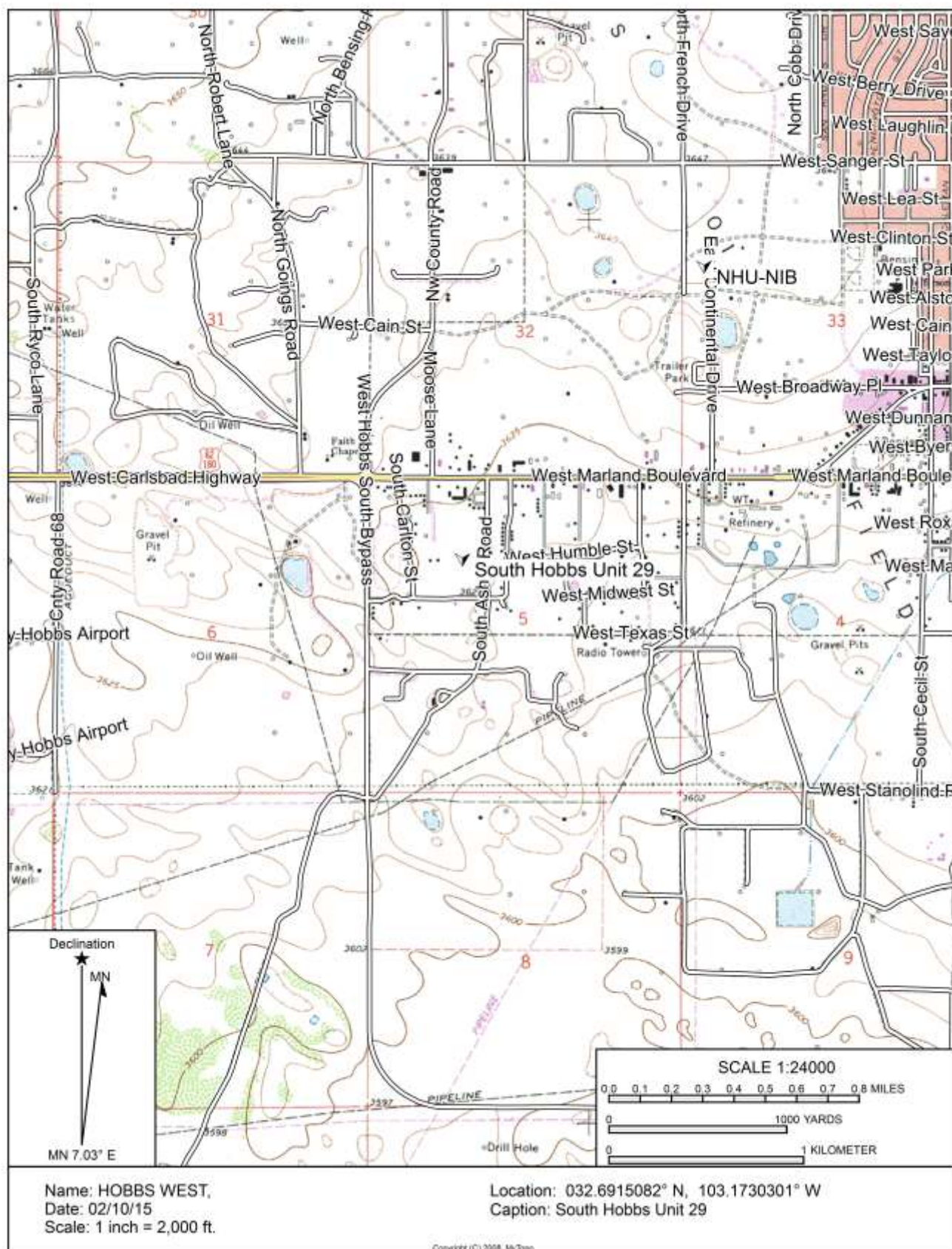

Figure 2

Site Plan



South Hobbs Unit 29

Appendix A

Analytical Results



PHONE (575) 393-2326 • 101 E. MARLAND • HOBBS, NM 88240

February 03, 2015

Bob Allen
Safety & Environmental Solutions
703 East Clinton
Hobbs, NM 88240

RE: SOUTH HOBBS UNIT #29

Enclosed are the results of analyses for samples received by the laboratory on 01/28/15 14:10.

Cardinal Laboratories is accredited through Texas NELAP under certificate number T104704398-13-5. Accreditation applies to drinking water, non-potable water and solid and chemical materials. All accredited analytes are denoted by an asterisk (*). For a complete list of accredited analytes and matrices visit the TCEQ website at www.tceq.texas.gov/field/qa/lab_accred_certif.html.

Cardinal Laboratories is accredited through the State of Colorado Department of Public Health and Environment for:

Method EPA 552.2	Haloacetic Acids (HAA-5)
Method EPA 524.2	Total Trihalomethanes (TTHM)
Method EPA 524.4	Regulated VOCs (V1, V2, V3)

Accreditation applies to public drinking water matrices.

This report meets NELAP requirements and is made up of a cover page, analytical results, and a copy of the original chain-of-custody. If you have any questions concerning this report, please feel free to contact me.

Sincerely,

Celey D. Keene
Lab Director/Quality Manager



PHONE (575) 393-2326 • 101 E. MARLAND • HOBBS, NM 88240

Analytical Results For:

Safety & Environmental Solutions
Bob Allen
703 East Clinton
Hobbs NM, 88240
Fax To: (575) 393-4388

Received: 01/28/2015
Reported: 02/03/2015
Project Name: SOUTH HOBBS UNIT #29
Project Number: OXY-15-006
Project Location: HOBBS, NM

Sampling Date: 01/27/2015
Sampling Type: Soil
Sampling Condition: Cool & Intact
Sample Received By: Jodi Henson

Sample ID: BH - 1 2' (H500262-01)

BTX 8021B		mg/kg		Analyzed By: ms						
Analyte	Result	Reporting Limit	Analyzed	Method Blank	BS	% Recovery	True Value QC	RPD	Qualifier	
Benzene*	<0.050	0.050	01/30/2015	ND	1.84	92.0	2.00	9.13		
Toluene*	<0.050	0.050	01/30/2015	ND	1.75	87.3	2.00	9.81		
Ethylbenzene*	<0.050	0.050	01/30/2015	ND	1.67	83.7	2.00	10.2		
Total Xylenes*	<0.150	0.150	01/30/2015	ND	5.00	83.3	6.00	9.92		
Total BTX	<0.300	0.300	01/30/2015	ND						

Surrogate: 4-Bromofluorobenzene (PID) 99.4 % 61-154

Chloride, SM4500Cl-B		mg/kg		Analyzed By: AP					
Analyte	Result	Reporting Limit	Analyzed	Method Blank	BS	% Recovery	True Value QC	RPD	Qualifier
Chloride	464	16.0	01/29/2015	ND	416	104	400	0.00	
TPH 8015M		mg/kg		Analyzed By: MS					

Surrogate: 1-Chlorooctane 104 % 47.2-157

Surrogate: 1-Chlorooctadecane 124 % 52.1-176

Cardinal Laboratories

*=Accredited Analyte

DISCLAIMER: Liability and Damages. Cardinal's liability and clients exclusive remedy for any claim arising, whether based in contract or tort, shall be limited to the amount paid by client for analyses. All claims, including those for negligence and any other cause whatsoever shall be deemed waived unless made in writing and received by Cardinal within thirty (30) days after completion of the applicable service. In no event shall Cardinal be liable for incidental or consequential damages, including, without limitation, business interruptions, loss of use, or loss of profits incurred by client, its subsidiaries, affiliates or successors arising out of or related to the performance of the services hereunder by Cardinal, regardless of whether such claim is based upon any of the above stated reasons or otherwise. Results relate only to the samples identified above. This report shall not be reproduced except in full with written approval of Cardinal Laboratories.

Celey D. Keene, Lab Director/Quality Manager



PHONE (575) 393-2326 • 101 E. MARLAND • HOBBS, NM 88240

Analytical Results For:

Safety & Environmental Solutions
Bob Allen
703 East Clinton
Hobbs NM, 88240
Fax To: (575) 393-4388

Received: 01/28/2015
Reported: 02/03/2015
Project Name: SOUTH HOBBS UNIT #29
Project Number: OXY-15-006
Project Location: HOBBS, NM

Sampling Date: 01/27/2015
Sampling Type: Soil
Sampling Condition: Cool & Intact
Sample Received By: Jodi Henson

Sample ID: BH - 1 4' (H500262-02)

BTX 8021B		mg/kg		Analyzed By: ms					
Analyte	Result	Reporting Limit	Analyzed	Method Blank	BS	% Recovery	True Value QC	RPD	Qualifier
Benzene*	<0.050	0.050	01/30/2015	ND	1.84	92.0	2.00	9.13	
Toluene*	<0.050	0.050	01/30/2015	ND	1.75	87.3	2.00	9.81	
Ethylbenzene*	<0.050	0.050	01/30/2015	ND	1.67	83.7	2.00	10.2	
Total Xylenes*	<0.150	0.150	01/30/2015	ND	5.00	83.3	6.00	9.92	
Total BTX	<0.300	0.300	01/30/2015	ND					

Surrogate: 4-Bromofluorobenzene (PID) 99.9 % 61-154

Chloride, SM4500Cl-B		mg/kg		Analyzed By: AP					
Analyte	Result	Reporting Limit	Analyzed	Method Blank	BS	% Recovery	True Value QC	RPD	Qualifier
Chloride	496	16.0	01/29/2015	ND	416	104	400	0.00	
TPH 8015M		mg/kg		Analyzed By: MS					

Surrogate: 1-Chlorooctane 108 % 47.2-157

Surrogate: 1-Chlorooctadecane 129 % 52.1-176

Cardinal Laboratories

*=Accredited Analyte

PLEASE NOTE: Liability and Damages. Cardinal's liability and clients exclusive remedy for any claim arising, whether based in contract or tort, shall be limited to the amount paid by client for analyses. All claims, including those for negligence and any other cause whatsoever shall be deemed waived unless made in writing and received by Cardinal within thirty (30) days after completion of the applicable services. In no event shall Cardinal be liable for incidental or consequential damage, including, without limitation, business interruptions, loss of use, or loss of profits incurred by client, its subsidiaries, affiliates or associates arising out of or related to the performance of the services hereunder by Cardinal, regardless of whether such claim is based upon any of the above stated reasons or otherwise. Results relate only to the samples identified above. This report shall not be reproduced except in full with written approval of Cardinal Laboratories.

Celey D. Keene, Lab Director/Quality Manager



PHONE (575) 393-2326 • 101 E. MARLAND • HOBBS, NM 88240

Analytical Results For:

Safety & Environmental Solutions
Bob Allen
703 East Clinton
Hobbs NM, 88240
Fax To: (575) 393-4388

Received:	01/28/2015	Sampling Date:	01/27/2015
Reported:	02/03/2015	Sampling Type:	Soil
Project Name:	SOUTH HOBBS UNIT #29	Sampling Condition:	Cool & Intact
Project Number:	OXY-15-006	Sample Received By:	Jodi Henson
Project Location:	HOBBS, NM		

Sample ID: BH - 1 6.5' (H500262-03)

BTX 8021B		mg/kg		Analyzed By: ms						
Analyte	Result	Reporting Limit	Analyzed	Method Blank	BS	% Recovery	True Value QC	RPD	Qualifier	
Benzene*	<0.050	0.050	01/30/2015	ND	1.84	92.0	2.00	9.13		
Toluene*	<0.050	0.050	01/30/2015	ND	1.75	87.3	2.00	9.81		
Ethylbenzene*	<0.050	0.050	01/30/2015	ND	1.67	83.7	2.00	10.2		
Total Xylenes*	<0.150	0.150	01/30/2015	ND	5.00	83.3	6.00	9.92		
Total BTX	<0.300	0.300	01/30/2015	ND						

Surrogate: 4-Bromofluorobenzene (PID) 99.0 % 61-154

Chloride, SM4500Cl-B		mg/kg		Analyzed By: AP					
Analyte	Result	Reporting Limit	Analyzed	Method Blank	BS	% Recovery	True Value QC	RPD	Qualifier
Chloride	384	16.0	01/29/2015	ND	416	104	400	0.00	
TPH 8015M	mg/kg		Analyzed By: MS						

TPH 8015M		mg/kg		Analyzed By: MS					
Analyte	Result	Reporting Limit	Analyzed	Method Blank	BS	% Recovery	True Value QC	RPD	Qualifier
GRO C6-C10	<10.0	10.0	01/29/2015	ND	202	101	200	1.67	
DRO >C10-C28	<10.0	10.0	01/29/2015	ND	201	100	200	5.99	

Surrogate: 1-Chlorooctane 111 % 47.2-157

Surrogate: 1-Chlorooctadecane 133 % 52.1-176

Cardinal Laboratories

*=Accredited Analyte

DISCLAIMER: Liability and Damages. Cardinal's liability and clients exclusive remedy for any claim arising, whether based in contract or tort, shall be limited to the amount paid by client for analyses. All claims, including those for negligence and any other cause whatsoever shall be deemed waived unless made in writing and received by Cardinal within thirty (30) days after completion of the applicable service. In no event shall Cardinal be liable for incidental or consequential damages, including, without limitation, business interruptions, loss of use, or loss of profits incurred by client, its subsidiaries, affiliates or successors arising out of or related to the performance of the services hereunder by Cardinal, regardless of whether such claim is based upon any of the above stated reasons or otherwise. Results relate only to the samples identified above. This report shall not be reproduced except in full with written approval of Cardinal Laboratories.

Celey D. Keene, Lab Director/Quality Manager



PHONE (575) 393-2326 • 101 E. MARLAND • HOBBS, NM 88240

Analytical Results For:

Safety & Environmental Solutions
Bob Allen
703 East Clinton
Hobbs NM, 88240
Fax To: (575) 393-4388

Received:	01/28/2015	Sampling Date:	01/27/2015
Reported:	02/03/2015	Sampling Type:	Soil
Project Name:	SOUTH HOBBS UNIT #29	Sampling Condition:	Cool & Intact
Project Number:	OXY-15-006	Sample Received By:	Jodi Henson
Project Location:	HOBBS, NM		

Sample ID: BH - 2' (H500262-04)

BTEX 8021B		mg/kg		Analyzed By: ms						
Analyte	Result	Reporting Limit	Analyzed	Method Blank	BS	% Recovery	True Value QC	RPD	Qualifier	
Benzene*	<0.050	0.050	01/30/2015	ND	1.84	92.0	2.00	9.13		
Toluene*	<0.050	0.050	01/30/2015	ND	1.75	87.3	2.00	9.81		
Ethylbenzene*	<0.050	0.050	01/30/2015	ND	1.67	83.7	2.00	10.2		
Total Xylenes*	<0.150	0.150	01/30/2015	ND	5.00	83.3	6.00	9.92		
Total BTEX	<0.300	0.300	01/30/2015	ND						

Surrogate: 4-Bromofluorobenzene (PID) 100 % 61-154

Chloride, SM4500Cl-B		mg/kg		Analyzed By: AP						
Analyte	Result	Reporting Limit	Analyzed	Method Blank	BS	% Recovery	True Value QC	RPD	Qualifier	
Chloride	464	16.0	01/29/2015	ND	416	104	400	0.00		
TPH 8015M		mg/kg		Analyzed By: MS						

Surrogate: 1-Chlorooctane 105 % 47.2-157

Surrogate: 1-Chlorooctadecane 122 % 52.1-176

Cardinal Laboratories

*=Accredited Analyte

DISCLAIMER: Liability and Damages. Cardinal's liability and clients exclusive remedy for any claim arising, whether based in contract or tort, shall be limited to the amount paid by client for analyses. All claims, including those for negligence and any other cause whatsoever shall be deemed waived unless made in writing and received by Cardinal within thirty (30) days after completion of the applicable service. In no event shall Cardinal be liable for incidental or consequential damages, including, without limitation, business interruptions, loss of use, or loss of profits incurred by client, its subsidiaries, affiliates or successors arising out of or related to the performance of the services hereunder by Cardinal, regardless of whether such claim is based upon any of the above stated reasons or otherwise. Results relate only to the samples identified above. This report shall not be reproduced except in full with written approval of Cardinal Laboratories.

Celey D. Keene, Lab Director/Quality Manager



PHONE (575) 393-2326 • 101 E. MARLAND • HOBBS, NM 88240

Analytical Results For:

Safety & Environmental Solutions
Bob Allen
703 East Clinton
Hobbs NM, 88240
Fax To: (575) 393-4388

Received: 01/28/2015
Reported: 02/03/2015
Project Name: SOUTH HOBBS UNIT #29
Project Number: OXY-15-006
Project Location: HOBBS, NM

Sampling Date: 01/27/2015
Sampling Type: Soil
Sampling Condition: Cool & Intact
Sample Received By: Jodi Henson

Sample ID: BH - 2 4' (H500262-05)

BTEX 8021B		mg/kg		Analyzed By: MS					
Analyte	Result	Reporting Limit	Analyzed	Method Blank	BS	% Recovery	True Value QC	RPD	Qualifier
Benzene*	<0.050	0.050	01/30/2015	ND	1.84	92.0	2.00	9.13	
Toluene*	<0.050	0.050	01/30/2015	ND	1.75	87.3	2.00	9.81	
Ethylbenzene*	<0.050	0.050	01/30/2015	ND	1.67	83.7	2.00	10.2	
Total Xylenes*	<0.150	0.150	01/30/2015	ND	5.00	83.3	6.00	9.92	
Total BTEX	<0.300	0.300	01/30/2015	ND					

Surrogate: 4-Bromofluorobenzene (PID) 99.3 % 61-154

Chloride, SM4500Cl-B		mg/kg		Analyzed By: AP					
Analyte	Result	Reporting Limit	Analyzed	Method Blank	BS	% Recovery	True Value QC	RPD	Qualifier
Chloride	368	16.0	01/29/2015	ND	416	104	400	0.00	
TPH 8015M		mg/kg		Analyzed By: MS					
Analyte	Result	Reporting Limit	Analyzed	Method Blank	BS	% Recovery	True Value QC	RPD	Qualifier
GRO C6-C10	<10.0	10.0	01/29/2015	ND	201	100	200	7.96	
DRO >C10-C28	<10.0	10.0	01/29/2015	ND	213	107	200	10.8	

Surrogate: 1-Chlorooctane 103 % 47.2-157

Surrogate: 1-Chlorooctadecane 121 % 52.1-176

Cardinal Laboratories

*=Accredited Analyte

PLEASE NOTE: Liability and Damages. Cardinal's liability and clients exclusive remedy for any claim arising, whether based in contract or tort, shall be limited to the amount paid by client for analyses. All claims, including those for negligence and any other cause whatsoever shall be deemed waived unless made in writing and received by Cardinal within thirty (30) days after completion of the applicable service. In no event shall Cardinal be liable for incidental or consequential damages, including, without limitation, business interruptions, loss of use, or loss of profits incurred by client, its subsidiaries, affiliates or successors arising out of or related to the performance of the services hereunder by Cardinal, regardless of whether such claim is based upon any of the above stated reasons or otherwise. Results relate only to the samples identified above. This report shall not be reproduced except in full with written approval of Cardinal Laboratories.

Celey D. Keene, Lab Director/Quality Manager



PHONE (575) 393-2326 • 101 E. MARLAND • HOBBS, NM 88240

Analytical Results For:

Safety & Environmental Solutions
Bob Allen
703 East Clinton
Hobbs NM, 88240
Fax To: (575) 393-4388

Received: 01/28/2015
Reported: 02/03/2015
Project Name: SOUTH HOBBS UNIT #29
Project Number: OXY-15-006
Project Location: HOBBS, NM

Sampling Date: 01/27/2015
Sampling Type: Soil
Sampling Condition: Cool & Intact
Sample Received By: Jodi Henson

Sample ID: BH - 3 2' (H500262-06)

BTEX 8021B		mg/kg		Analyzed By: ms						
Analyte	Result	Reporting Limit	Analyzed	Method Blank	BS	% Recovery	True Value QC	RPD	Qualifier	
Benzene*	<0.050	0.050	02/02/2015	ND	1.84	92.2	2.00	2.11		
Toluene*	<0.050	0.050	02/02/2015	ND	1.75	87.5	2.00	3.16		
Ethylbenzene*	<0.050	0.050	02/02/2015	ND	1.66	82.9	2.00	3.88		
Total Xylenes*	<0.150	0.150	02/02/2015	ND	4.93	82.2	6.00	4.21		
Total BTEX	<0.300	0.300	02/02/2015	ND						

Surrogate: 4-Bromofluorobenzene (PID) 98.7 % 61-154

Chloride, SM4500Cl-B		mg/kg		Analyzed By: AP					
Analyte	Result	Reporting Limit	Analyzed	Method Blank	BS	% Recovery	True Value QC	RPD	Qualifier
Chloride	416	16.0	01/29/2015	ND	416	104	400	0.00	
TPH 8015M		mg/kg		Analyzed By: MS					

Surrogate: 1-Chlorooctane 102 % 47.2-157

Surrogate: 1-Chlorooctadecane 119 % 52.1-176

Cardinal Laboratories

*=Accredited Analyte

PUBLIC NOTE: Liability and Damages. Cardinal's liability and clients exclusive remedy for any claim arising, whether based in contract or tort, shall be limited to the amount paid by client for analyses. All claims, including those for negligence and any other cause whatsoever shall be deemed waived unless made in writing and received by Cardinal within thirty (30) days after completion of the applicable service. In no event shall Cardinal be liable for incidental or consequential damages, including, without limitation, business interruptions, loss of use, or loss of profits incurred by client, its subsidiaries, affiliates or successors arising out of or related to the performance of the services hereunder by Cardinal, regardless of whether such claim is based upon any of the above stated reasons or otherwise. Results relate only to the samples identified above. This report shall not be reproduced except in full with written approval of Cardinal Laboratories.

Celey D. Keene, Lab Director/Quality Manager



PHONE (575) 393-2326 • 101 E. MARLAND • HOBBS, NM 88240

Analytical Results For:

Safety & Environmental Solutions
Bob Allen
703 East Clinton
Hobbs NM, 88240
Fax To: (575) 393-4388

Received: 01/28/2015
Reported: 02/03/2015
Project Name: SOUTH HOBBS UNIT #29
Project Number: OXY-15-006
Project Location: HOBBS, NM

Sampling Date: 01/27/2015
Sampling Type: Soil
Sampling Condition: Cool & Intact
Sample Received By: Jodi Henson

Sample ID: BH - 3 4' (H500262-07)

BTEX 8021B		mg/kg		Analyzed By: MS					
Analyte	Result	Reporting Limit	Analyzed	Method Blank	BS	% Recovery	True Value QC	RPD	Qualifier
Benzene*	<0.050	0.050	02/02/2015	ND	1.84	92.2	2.00	2.11	
Toluene*	<0.050	0.050	02/02/2015	ND	1.75	87.5	2.00	3.16	
Ethylbenzene*	<0.050	0.050	02/02/2015	ND	1.66	82.9	2.00	3.88	
Total Xylenes*	<0.150	0.150	02/02/2015	ND	4.93	82.2	6.00	4.21	
Total BTEX	<0.300	0.300	02/02/2015	ND					

Surrogate: 4-Bromofluorobenzene (PID) 99.2 % 61-154

Chloride, SM4500Cl-B		mg/kg		Analyzed By: AP					
Analyte	Result	Reporting Limit	Analyzed	Method Blank	BS	% Recovery	True Value QC	RPD	Qualifier
Chloride	272	16.0	01/29/2015	ND	416	104	400	0.00	
TPH 8015M		mg/kg		Analyzed By: MS					
Analyte	Result	Reporting Limit	Analyzed	Method Blank	BS	% Recovery	True Value QC	RPD	Qualifier
GRO C6-C10	<10.0	10.0	01/29/2015	ND	201	100	200	7.96	
DRO >C10-C28	<10.0	10.0	01/29/2015	ND	213	107	200	10.8	

Surrogate: 1-Chlorooctane 102 % 47.2-157

Surrogate: 1-Chlorooctadecane 118 % 52.1-176

Cardinal Laboratories

*=Accredited Analyte

PLEASE NOTE: Liability and Damages. Cardinal's liability and clients exclusive remedy for any claim arising, whether based in contract or tort, shall be limited to the amount paid by client for analyses. All claims, including those for negligence and any other cause whatsoever shall be deemed waived unless made in writing and received by Cardinal within thirty (30) days after completion of the applicable service. In no event shall Cardinal be liable for incidental or consequential damages, including, without limitation, business interruptions, loss of use, or loss of profits incurred by client, its subsidiaries, affiliates or successors arising out of or related to the performance of the services hereunder by Cardinal, regardless of whether such claim is based upon any of the above stated reasons or otherwise. Results relate only to the samples identified above. This report shall not be reproduced except in full with written approval of Cardinal Laboratories.

Celey D. Keene, Lab Director/Quality Manager



PHONE (575) 393-2326 • 101 E. MARLAND • HOBBS, NM 88240

Analytical Results For:

Safety & Environmental Solutions
Bob Allen
703 East Clinton
Hobbs NM, 88240
Fax To: (575) 393-4388

Received: 01/28/2015
Reported: 02/03/2015
Project Name: SOUTH HOBBS UNIT #29
Project Number: OXY-15-006
Project Location: HOBBS, NM

Sampling Date: 01/27/2015
Sampling Type: Soil
Sampling Condition: Cool & Intact
Sample Received By: Jodi Henson

Sample ID: BH - 4 2' (H500262-08)

BTEX 8021B		mg/kg	Analyzed By: ms						
Analyte	Result	Reporting Limit	Analyzed	Method Blank	BS	% Recovery	True Value QC	RPD	Qualifier
Benzene*	<0.050	0.050	02/02/2015	ND	1.84	92.2	2.00	2.11	
Toluene*	<0.050	0.050	02/02/2015	ND	1.75	87.5	2.00	3.16	
Ethylbenzene*	<0.050	0.050	02/02/2015	ND	1.66	82.9	2.00	3.88	
Total Xylenes*	<0.150	0.150	02/02/2015	ND	4.93	82.2	6.00	4.21	
Total BTEX	<0.300	0.300	02/02/2015	ND					

Surrogate: 4-Bromofluorobenzene (PID) 102 % 61-154

Chloride, SM4500Cl-B		mg/kg	Analyzed By: AP						
Analyte	Result	Reporting Limit	Analyzed	Method Blank	BS	% Recovery	True Value QC	RPD	Qualifier
Chloride	544	16.0	01/29/2015	ND	416	104	400	0.00	

TPH 8015M		mg/kg	Analyzed By: MS						
Analyte	Result	Reporting Limit	Analyzed	Method Blank	BS	% Recovery	True Value QC	RPD	Qualifier
GRO C6-C10	<10.0	10.0	01/29/2015	ND	201	100	200	7.96	
DRO >C10-C28	<10.0	10.0	01/29/2015	ND	213	107	200	10.8	

Surrogate: 1-Chlorooctane 104 % 47.2-157

Surrogate: 1-Chlorooctadecane 123 % 52.1-176

Cardinal Laboratories

*=Accredited Analyte

PLEASE NOTE: Liability and Damages. Cardinal's liability and clients' exclusive remedy for any claim arising, whether based in contract or tort, shall be limited to the amount paid by client for analyses. All claims, including those for negligence and any other cause whatsoever shall be deemed waived unless made in writing and received by Cardinal within thirty (30) days after completion of the applicable service. In no event shall Cardinal be liable for incidental or consequential damages, including, without limitation, business interruptions, loss of use, or loss of profits incurred by client, its subsidiaries, affiliates or successors arising out of or related to the performance of the services hereunder by Cardinal, regardless of whether such claim is based upon any of the above stated reasons or otherwise. Results relate only to the samples identified above. This report shall not be reproduced except in full with written approval of Cardinal Laboratories.

Ceiley D. Keene

Ceiley D. Keene, Lab Director/Quality Manager

Page 9 of 12



PHONE (575) 393-2326 • 101 E. MARLAND • HOBBS, NM 88240

Analytical Results For:

Safety & Environmental Solutions
Bob Allen
703 East Clinton
Hobbs NM, 88240
Fax To: (575) 393-4388

Received: 01/28/2015
Reported: 02/03/2015
Project Name: SOUTH HOBBS UNIT #29
Project Number: OXY-15-006
Project Location: HOBBS, NM

Sampling Date: 01/27/2015
Sampling Type: Soil
Sampling Condition: Cool & Intact
Sample Received By: Jodi Henson

Sample ID: BH - 4 3' (H500262-09)

BTEX 8021B		mg/kg		Analyzed By: ms					
Analyte	Result	Reporting Limit	Analyzed	Method Blank	BS	% Recovery	True Value QC	RPD	Qualifier
Benzene*	<0.050	0.050	02/02/2015	ND	1.84	92.2	2.00	2.11	
Toluene*	<0.050	0.050	02/02/2015	ND	1.75	87.5	2.00	3.16	
Ethylbenzene*	<0.050	0.050	02/02/2015	ND	1.66	82.9	2.00	3.88	
Total Xylenes*	<0.150	0.150	02/02/2015	ND	4.93	82.2	6.00	4.21	
Total BTEX	<0.300	0.300	02/02/2015	ND					

Surrogate: 4-Bromofluorobenzene (PID) 102 % 61-154

Chloride, SM4500Cl-B		mg/kg		Analyzed By: AP					
Analyte	Result	Reporting Limit	Analyzed	Method Blank	BS	% Recovery	True Value QC	RPD	Qualifier
Chloride	480	16.0	01/29/2015	ND	416	104	400	0.00	
TPH 8015M	mg/kg		Analyzed By: MS						

TPH 8015M		mg/kg		Analyzed By: MS					
Analyte	Result	Reporting Limit	Analyzed	Method Blank	BS	% Recovery	True Value QC	RPD	Qualifier
GRO C6-C10	<10.0	10.0	01/29/2015	ND	201	100	200	7.96	
DRO >C10-C28	<10.0	10.0	01/29/2015	ND	213	107	200	10.8	

Surrogate: 1-Chlorooctane 105 % 47.2-157

Surrogate: 1-Chlorooctadecane 121 % 52.1-176

Cardinal Laboratories

*=Accredited Analyte

PUBLIC NOTE: Liability and Damages. Cardinal's liability and clients exclusive remedy for any claim arising, whether based in contract or tort, shall be limited to the amount paid by client for analyses. All claims, including those for negligence and any other cause whatsoever shall be deemed waived unless made in writing and received by Cardinal within thirty (30) days after completion of the applicable service. In no event shall Cardinal be liable for incidental or consequential damages, including, without limitation, business interruptions, loss of use, or loss of profits incurred by client, its subsidiaries, affiliates or successors arising out of or related to the performance of the services hereunder by Cardinal, regardless of whether such claim is based upon any of the above stated reasons or otherwise. Results relate only to the samples identified above. This report shall not be reproduced except in full with written approval of Cardinal Laboratories.

Celey D. Keene, Lab Director/Quality Manager

Notes and Definitions

ND	Analyte NOT DETECTED at or above the reporting limit
RPD	Relative Percent Difference
**	Samples not received at proper temperature of 6°C or below.
***	Insufficient time to reach temperature.
-	Chloride by SM4500Cl-B does not require samples be received at or below 6°C Samples reported on an as received basis (wet) unless otherwise noted on report

Cardinal Laboratories

*=Accredited Analyte

PLEASE NOTE: Liability and Damages. Cardinal's liability and client's exclusive remedy for any claim arising, whether based in contract or tort, shall be limited to the amount paid by client for analyses. All claims, including those for negligence and any other cause whatsoever shall be deemed waived unless made in writing and received by Cardinal within thirty (30) days after completion of the applicable service. In no event shall Cardinal be liable for incidental or consequential damages, including, without limitation, business interruptions, loss of use, or loss of profits incurred by client, its subsidiaries, affiliates or successors arising out of or related to the performance of the services hereunder by Cardinal, regardless of whether such claim is based upon any of the above stated reasons or otherwise. Results relate only to the samples identified above. This report shall not be reproduced except in full with written approval of Cardinal Laboratories.



Celey D. Keene, Lab Director/Quality Manager

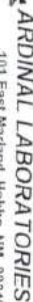

CHAIN-OF-CUSTODY AND ANALYSIS REQUEST

Page 0

Company Name: Safety & Environmental Solutions, Inc.		P.O. #:		BILL TO		ANALYSIS REQUEST	
Project Manager: Bob Allen		Company: Same					
Address: 703 East Clinton		City: Hobbs					
City: Hobbs		State: NM		Zip: 88240			
Phone #: 575-397-0510		Fax #: 575-393-4388					
Project #: OXY-15-006		Project Owner: OXY					
Project Name: South Hobbs Unit 21		City:					
Project Location: Hobbs		State:					
Sample Name: 2015 Beyer		Phone #:					
FOR LAB USE ONLY		Fax #:					
Lab I.D.		Sample I.D.					
H500000		1					
2							
3							
4							
5							
6							
7							
8							
9							
10							
11							
12							
13							
14							
15							
16							
17							
18							
19							
20							
21							
22							
23							
24							
25							
26							
27							
28							
29							
30							
31							
32							
33							
34							
35							
36							
37							
38							
39							
40							
41							
42							
43							
44							
45							
46							
47							
48							
49							
50							
51							
52							
53							
54							
55							
56							
57							
58							
59							
60							
61							
62							
63							
64							
65							
66							
67							
68							
69							
70							
71							
72							
73							
74							
75							
76							
77							
78							
79							
80							
81							
82							
83							



PHONE (575) 393-2326 • 101 E. MARLAND • HOBBS, NM 88240

February 03, 2015

Bob Allen

Safety & Environmental Solutions

703 East Clinton

Hobbs, NM 88240

RE: SOUTH HOBBS UNIT #29

Enclosed are the results of analyses for samples received by the laboratory on 01/28/15 16:45.

Cardinal Laboratories is accredited through Texas NELAP under certificate number T104704398-13-5. Accreditation applies to drinking water, non-potable water and solid and chemical materials. All accredited analytes are denoted by an asterisk (*). For a complete list of accredited analytes and matrices visit the TCEQ website at www.tceq.texas.gov/field/qa/lab_accred_certif.html.

Cardinal Laboratories is accredited through the State of Colorado Department of Public Health and Environment for:

Method EPA 552.2	Haloacetic Acids (HAA-5)
Method EPA 524.2	Total Trihalomethanes (TTHM)
Method EPA 524.4	Regulated VOCs (V1, V2, V3)

Accreditation applies to public drinking water matrices.

This report meets NELAP requirements and is made up of a cover page, analytical results, and a copy of the original chain-of-custody. If you have any questions concerning this report, please feel free to contact me.

Sincerely,

Celey D. Keene

Lab Director/Quality Manager



PHONE (575) 393-2326 • 101 E. MARLAND • HOBBS, NM 88240

Analytical Results For:

Safety & Environmental Solutions
Bob Allen
703 East Clinton
Hobbs NM, 88240
Fax To: (575) 393-4388

Received: 01/28/2015
Reported: 02/03/2015
Project Name: SOUTH HOBBS UNIT #29
Project Number: OXY-15-006
Project Location: HOBBS, NM

Sampling Date: 01/28/2015
Sampling Type: Soil
Sampling Condition: Cool & Intact
Sample Received By: Jodi Henson

Sample ID: AH-1 2' (H500267-01)

BTX 8021B		mg/kg		Analyzed By: ms					
Analyte	Result	Reporting Limit	Analyzed	Method Blank	BS	% Recovery	True Value QC	RPD	Qualifier
Benzene*	<0.050	0.050	02/02/2015	ND	1.84	92.2	2.00	2.11	
Toluene*	<0.050	0.050	02/02/2015	ND	1.75	87.5	2.00	3.16	
Ethylbenzene*	<0.050	0.050	02/02/2015	ND	1.66	82.9	2.00	3.88	
Total Xylenes*	<0.150	0.150	02/02/2015	ND	4.93	82.2	6.00	4.21	
Total BTX	<0.300	0.300	02/02/2015	ND					

Surrogate: 4-Bromofluorobenzene (PID) 100 % 61-154

Chloride, SM4500Cl-B		mg/kg		Analyzed By: AP					
Analyte	Result	Reporting Limit	Analyzed	Method Blank	BS	% Recovery	True Value QC	RPD	Qualifier
Chloride	432	16.0	01/29/2015	ND	416	104	400	0.00	

TPH 8015M		mg/kg		Analyzed By: MS					
Analyte	Result	Reporting Limit	Analyzed	Method Blank	BS	% Recovery	True Value QC	RPD	Qualifier
GRO C6-C10	<10.0	10.0	01/29/2015	ND	201	100	200	7.96	
DRO >C10-C28	<10.0	10.0	01/29/2015	ND	213	107	200	10.8	

Surrogate: 1-Chlorooctane 98.1 % 47.2-157

Surrogate: 1-Chlorooctadecane 118 % 52.1-176

Cardinal Laboratories

*=Accredited Analyte

PLEASE NOTE: Liability and Damages. Cardinal's liability and direct exclusive remedy for any claim arising, whether based in contract or tort, shall be limited to the amount paid by client for analyses. All claims, including those for negligence and any other cause whatsoever shall be deemed waived unless made in writing and received by Cardinal within thirty (30) days after completion of the applicable service. In no event shall Cardinal be liable for incidental or consequential damages, including without limitation, business interruptions, loss of use, or loss of profits incurred by client, its subsidiaries, affiliates or successors arising out of or related to the performance of the services hereunder by Cardinal, regardless of whether such claim is based upon any of the above stated reasons or otherwise. Results relate only to the samples identified above. This report shall not be reproduced except in full with written approval of Cardinal Laboratories.

Celey D. Keene, Lab Director/Quality Manager



PHONE (575) 393-2326 • 101 E. MARLAND • HOBBS, NM 88240

Analytical Results For:

Safety & Environmental Solutions
Bob Allen
703 East Clinton
Hobbs NM, 88240
Fax To: (575) 393-4388

Received: 01/28/2015
Reported: 02/03/2015
Project Name: SOUTH HOBBS UNIT #29
Project Number: OXY-15-006
Project Location: HOBBS, NM

Sampling Date: 01/28/2015
Sampling Type: Soil
Sampling Condition: Cool & Intact
Sample Received By: Jodi Henson

Sample ID: AH-1 3'6" (H500267-02)

BTEX 8021B		mg/kg		Analyzed By: ms					
Analyte	Result	Reporting Limit	Analyzed	Method Blank	BS	% Recovery	True Value QC	RPD	Qualifier
Benzene*	<0.050	0.050	02/02/2015	ND	1.84	92.2	2.00	2.11	
Toluene*	<0.050	0.050	02/02/2015	ND	1.75	87.5	2.00	3.16	
Ethylbenzene*	<0.050	0.050	02/02/2015	ND	1.66	82.9	2.00	3.88	
Total Xylenes*	<0.150	0.150	02/02/2015	ND	4.93	82.2	6.00	4.21	
Total BTEX	<0.300	0.300	02/02/2015	ND					

Surrogate: 4-Bromofluorobenzene (PID) 103 % 61-154

Chloride, SM4500Cl-B		mg/kg		Analyzed By: AP					
Analyte	Result	Reporting Limit	Analyzed	Method Blank	BS	% Recovery	True Value QC	RPD	Qualifier
Chloride	464	16.0	01/29/2015	ND	416	104	400	0.00	
TPH 8015M		mg/kg		Analyzed By: MS					
Analyte	Result	Reporting Limit	Analyzed	Method Blank	BS	% Recovery	True Value QC	RPD	Qualifier
GRO C6-C10	<10.0	10.0	01/29/2015	ND	201	100	200	7.96	
DRO >C10-C28	<10.0	10.0	01/29/2015	ND	213	107	200	10.8	

Surrogate: 1-Chlorooctane 102 % 47.2-157

Surrogate: 1-Chlorooctadecane 117 % 52.1-176

Cardinal Laboratories

*=Accredited Analyte

PLEASE NOTE: Liability and Damages. Cardinal's liability and client's exclusive remedy for any claim arising, whether based in contract or tort, shall be limited to the amount paid by client for analyses. All claims, including those for negligence and any other cause whatsoever shall be deemed waived unless made in writing and received by Cardinal within thirty (30) days after completion of the applicable service. In no event shall Cardinal be liable for incidental or consequential damages, including, without limitation, business interruptions, loss of use, or loss of profits incurred by client, its subsidiaries, affiliates or successors arising out of or related to the performance of the services hereunder by Cardinal, regardless of whether such claim is based upon any of the above stated reasons or otherwise. Results relate only to the samples identified above. This report shall not be reproduced except in full with written approval of Cardinal Laboratories.

Celey D. Keene, Lab Director/Quality Manager

Notes and Definitions

ND	Analyte NOT DETECTED at or above the reporting limit
RPD	Relative Percent Difference
**	Samples not received at proper temperature of 6°C or below.
***	Insufficient time to reach temperature.
-	Chloride by SM4500Cl-B does not require samples be received at or below 6°C
	Samples reported on an as received basis (wet) unless otherwise noted on report

Cardinal Laboratories

*=Accredited Analyte

PLEASE NOTE: Liability and Damages. Cardinal's liability and client's exclusive remedy for any claim arising, whether based in contract or tort, shall be limited to the amount paid by client for analyses. All claims, including those for negligence and any other cause whatsoever shall be deemed waived unless made in writing and received by Cardinal within thirty (30) days after completion of the applicable service. In no event shall Cardinal be liable for incidental or consequential damages, including, without limitation, business interruptions, loss of use, or loss of profits incurred by client, its subsidiaries, affiliates or successors arising out of or related to the performance of the services hereunder by Cardinal, regardless of whether such claim is based upon any of the above stated reasons or otherwise. Results relate only to the samples identified above. This report shall not be reproduced except in full with written approval of Cardinal Laboratories.



Celey D. Keene, Lab Director/Quality Manager



Page 5 of 5

27



PHONE (575) 393-2326 • 101 E. MARLAND • HOBBS, NM 88240

February 05, 2015

Bob Allen
Safety & Environmental Solutions
703 East Clinton
Hobbs, NM 88240

RE: SOUTH HOBBS UNIT #29

Enclosed are the results of analyses for samples received by the laboratory on 01/29/15 14:15.

Cardinal Laboratories is accredited through Texas NELAP under certificate number T104704398-13-5. Accreditation applies to drinking water, non-potable water and solid and chemical materials. All accredited analytes are denoted by an asterisk (*). For a complete list of accredited analytes and matrices visit the TCEQ website at www.tceq.texas.gov/field/qa/lab_accred_certif.html.

Cardinal Laboratories is accredited through the State of Colorado Department of Public Health and Environment for:

Method EPA 552.2	Haloacetic Acids (HAA-5)
Method EPA 524.2	Total Trihalomethanes (TTHM)
Method EPA 524.4	Regulated VOCs (V1, V2, V3)

Accreditation applies to public drinking water matrices.

This report meets NELAP requirements and is made up of a cover page, analytical results, and a copy of the original chain-of-custody. If you have any questions concerning this report, please feel free to contact me.

Sincerely,

Celey D. Keene
Lab Director/Quality Manager



PHONE (575) 393-2326 • 101 E. MARLAND • HOBBS, NM 88240

Analytical Results For:

Safety & Environmental Solutions
Bob Allen
703 East Clinton
Hobbs NM, 88240
Fax To: (575) 393-4388

Received: 01/29/2015
Reported: 02/05/2015
Project Name: SOUTH HOBBS UNIT #29
Project Number: OXY-15-006
Project Location: HOBBS, NM

Sampling Date: 01/28/2015
Sampling Type: Soil
Sampling Condition: Cool & Intact
Sample Received By: Jodi Henson

Sample ID: BH-5 2' (H500275-01)

BTEX 8021B		mg/kg		Analyzed By: ms					
Analyte	Result	Reporting Limit	Analyzed	Method Blank	BS	% Recovery	True Value QC	RPD	Qualifier
Benzene*	<0.050	0.050	02/02/2015	ND	1.84	92.2	2.00	2.11	
Toluene*	<0.050	0.050	02/02/2015	ND	1.75	87.5	2.00	3.16	
Ethylbenzene*	<0.050	0.050	02/02/2015	ND	1.66	82.9	2.00	3.88	
Total Xylenes*	<0.150	0.150	02/02/2015	ND	4.93	82.2	6.00	4.21	
Total BTEX	<0.300	0.300	02/02/2015	ND					

Surrogate: 4-Bromofluorobenzene (PID) 99.2 % 61-154

Chloride, SM4500Cl-B		mg/kg		Analyzed By: AP					
Analyte	Result	Reporting Limit	Analyzed	Method Blank	BS	% Recovery	True Value QC	RPD	Qualifier
Chloride	3160	16.0	02/02/2015	ND	432	108	400	3.77	

TPH 8015M		mg/kg		Analyzed By: MS					
Analyte	Result	Reporting Limit	Analyzed	Method Blank	BS	% Recovery	True Value QC	RPD	Qualifier
GRO C6-C10	<10.0	10.0	01/30/2015	ND	201	100	200	7.96	
DRO >C10-C28	<10.0	10.0	01/30/2015	ND	213	107	200	10.8	

Surrogate: 1-Chlorooctane 100 % 47.2-157

Surrogate: 1-Chlorooctadecane 119 % 52.1-176

Cardinal Laboratories

*=Accredited Analyte

PLEASE NOTE: Liability and Damages. Cardinal's liability and clients exclusive remedy for any claim arising, whether based in contract or tort, shall be limited to the amount paid by client for analyses. All claims, including those for negligence and any other cause whatsoever shall be deemed waived unless made in writing and received by Cardinal within thirty (30) days after completion of the applicable service. In no event shall Cardinal be liable for incidental or consequential damages, including, without limitation, business interruptions, loss of use, or loss of profits incurred by client, its subsidiaries, affiliates or successors arising out of or related to the performance of the services hereunder by Cardinal, regardless of whether such claim is based upon any of the above stated reasons or otherwise. Results relate only to the samples identified above. This report shall not be reproduced except in full with written approval of Cardinal Laboratories.

Celey D. Keene

Celey D. Keene, Lab Director/Quality Manager

Page 2 of 11



PHONE (575) 393-2326 • 101 E. MARLAND • HOBBS, NM 88240

Analytical Results For:

Safety & Environmental Solutions
Bob Allen
703 East Clinton
Hobbs NM, 88240
Fax To: (575) 393-4388

Received: 01/29/2015
Reported: 02/05/2015
Project Name: SOUTH HOBBS UNIT #29
Project Number: OXY-15-006
Project Location: HOBBS, NM

Sampling Date: 01/28/2015
Sampling Type: Soil
Sampling Condition: Cool & Intact
Sample Received By: Jodi Henson

Sample ID: BH-5 3.5-3.8' (H500275-02)

BTX 80218			mg/kg		Analyzed By: MS				
Analyte	Result	Reporting Limit	Analyzed	Method Blank	BS	% Recovery	True Value QC	RPD	Qualifier
Benzene*	<0.050	0.050	02/02/2015	ND	1.84	92.2	2.00	2.11	
Toluene*	<0.050	0.050	02/02/2015	ND	1.75	87.5	2.00	3.16	
Ethylbenzene*	<0.050	0.050	02/02/2015	ND	1.66	82.9	2.00	3.88	
Total Xylenes*	<0.150	0.150	02/02/2015	ND	4.93	82.2	6.00	4.21	
Total BTX	<0.300	0.300	02/02/2015	ND					

Surrogate: 4-Bromofluorobenzene (PID) 101 % 61-154

Chloride, SM4500Cl-B			mg/kg		Analyzed By: AP				
Analyte	Result	Reporting Limit	Analyzed	Method Blank	BS	% Recovery	True Value QC	RPD	Qualifier
Chloride	1660	16.0	02/02/2015	ND	432	108	400	3.77	
TPH 8015M			mg/kg		Analyzed By: MS				
Analyte	Result	Reporting Limit	Analyzed	Method Blank	BS	% Recovery	True Value QC	RPD	Qualifier
GRO C6-C10	<10.0	10.0	01/30/2015	ND	207	104	200	1.08	
DRO >C10-C28	<10.0	10.0	01/30/2015	ND	215	107	200	2.00	

Surrogate: 1-Chlorooctane 98.9 % 47.2-157

Surrogate: 1-Chlorooctadecane 117 % 52.1-176

Cardinal Laboratories

*=Accredited Analyte

PLEASE NOTE: Liability and Damages. Cardinal's liability and clients exclusive remedy for any claim arising, whether based in contract or tort, shall be limited to the amount paid by client for analyses. All claims, including those for negligence and any other cause whatsoever shall be deemed waived unless made in writing and received by Cardinal within thirty (30) days after completion of the applicable service. In no event shall Cardinal be liable for incidental or consequential damages, including, without limitation, business interruptions, loss of use, or loss of profit incurred by client, its subsidiaries, affiliates or successors arising out of or related to the performance of the services hereunder by Cardinal, regardless of whether such claim is based upon any of the above stated reasons or otherwise. Results relate only to the samples identified above. This report shall not be reproduced except in full with written approval of Cardinal Laboratories.

Celey D. Keene, Lab Director/Quality Manager



PHONE (575) 393-2326 • 101 E. MARLAND • HOBBS, NM 88240

Analytical Results For:

Safety & Environmental Solutions
Bob Allen
703 East Clinton
Hobbs NM, 88240
Fax To: (575) 393-4388

Received: 01/29/2015
Reported: 02/05/2015
Project Name: SOUTH HOBBS UNIT #29
Project Number: OXY-15-006
Project Location: HOBBS, NM

Sampling Date: 01/28/2015
Sampling Type: Soil
Sampling Condition: Cool & Intact
Sample Received By: Jodi Henson

Sample ID: BH-6 2' (H500275-03)

BTEX 8021B		mg/kg		Analyzed By: ms					
Analyte	Result	Reporting Limit	Analyzed	Method Blank	BS	% Recovery	True Value QC	RPD	Qualifier
Benzene*	<0.050	0.050	02/02/2015	ND	1.84	92.2	2.00	2.11	
Toluene*	<0.050	0.050	02/02/2015	ND	1.75	87.5	2.00	3.16	
Ethylbenzene*	<0.050	0.050	02/02/2015	ND	1.66	82.9	2.00	3.88	
Total Xylenes*	<0.150	0.150	02/02/2015	ND	4.93	82.2	6.00	4.21	
Total BTEX	<0.300	0.300	02/02/2015	ND					

Surrogate: 4-Bromofluorobenzene (PID) 101 % 01-154

Chloride, SM4500Cl-B		mg/kg		Analyzed By: AP					
Analyte	Result	Reporting Limit	Analyzed	Method Blank	BS	% Recovery	True Value QC	RPD	Qualifier
Chloride	96.0	16.0	02/02/2015	ND	432	108	400	3.77	

TPH 8015M		mg/kg		Analyzed By: MS					
Analyte	Result	Reporting Limit	Analyzed	Method Blank	BS	% Recovery	True Value QC	RPD	Qualifier
GRO C6-C10	<10.0	10.0	01/30/2015	ND	207	104	200	1.08	
DRO >C10-C28	<10.0	10.0	01/30/2015	ND	215	107	200	2.00	

Surrogate: 1-Chlorooctane 103 % 47.2-157

Surrogate: 1-Chlorooctadecane 118 % 52.1-176

Cardinal Laboratories

*=Accredited Analyte

PLEASE NOTE: Liability and Damages. Cardinal's liability and direct exclusive remedy for any claim arising, whether based in contract or tort, shall be limited to the amount paid by client for analyses. All claims, including those for negligence and any other cause whatsoever shall be deemed waived unless made in writing and received by Cardinal within thirty (30) days after completion of the applicable service. In no event shall Cardinal be liable for incidental or consequential damage, including, without limitation, business interruptions, loss of use, or loss of profits incurred by client, its subsidiaries, affiliates or successors arising out of or related to the performance of the services hereunder by Cardinal, regardless of whether such claim is based upon any of the above stated reasons or otherwise. Results relate only to the samples identified above. This report shall not be reproduced except in full with written approval of Cardinal Laboratories.

Coley D. Keene

Coley D. Keene, Lab Director/Quality Manager

Page 4 of 11



PHONE (575) 393-2326 • 101 E. MARLAND • HOBBS, NM 88240

Analytical Results For:

Safety & Environmental Solutions
Bob Allen
703 East Clinton
Hobbs NM, 88240
Fax To: (575) 393-4388

Received: 01/29/2015
Reported: 02/05/2015
Project Name: SOUTH HOBBS UNIT #29
Project Number: OXY-15-006
Project Location: HOBBS, NM

Sampling Date: 01/28/2015
Sampling Type: Soil
Sampling Condition: Cool & Intact
Sample Received By: Jodi Henson

Sample ID: BH-6 3-3.4' (H500275-04)

BTX 8021B		mg/kg		Analyzed By: ms					
Analyte	Result	Reporting Limit	Analyzed	Method Blank	BS	% Recovery	True Value QC	RPD	Qualifier
Benzene*	<0.050	0.050	02/02/2015	ND	1.84	92.2	2.00	2.11	
Toluene*	<0.050	0.050	02/02/2015	ND	1.75	87.5	2.00	3.16	
Ethylbenzene*	<0.050	0.050	02/02/2015	ND	1.66	82.9	2.00	3.88	
Total Xylenes*	<0.150	0.150	02/02/2015	ND	4.93	82.2	6.00	4.21	
Total BTX	<0.300	0.300	02/02/2015	ND					

Surrogate: 4-Bromofluorobenzene (PID) 100 % 61-154

Chloride, SM4500Cl-B		mg/kg		Analyzed By: AP					
Analyte	Result	Reporting Limit	Analyzed	Method Blank	BS	% Recovery	True Value QC	RPD	Qualifier
Chloride	96.0	16.0	02/02/2015	ND	432	108	400	3.77	

TPH 8015M		mg/kg		Analyzed By: MS					
Analyte	Result	Reporting Limit	Analyzed	Method Blank	BS	% Recovery	True Value QC	RPD	Qualifier
GRO C6-C10	<10.0	10.0	01/30/2015	ND	207	104	200	1.08	
DRO >C10-C28	<10.0	10.0	01/30/2015	ND	215	107	200	2.00	

Surrogate: 1-Chlorooctane 95.7 % 47.2-157

Surrogate: 1-Chlorooctadecane 111 % 52.1-176

Cardinal Laboratories

*=Accredited Analyte

PLEASE NOTE: Liability and Damages. Cardinal's liability and clients exclusive remedy for any claim arising, whether based in contract or tort, shall be limited to the amount paid by client for analyses. All claims, including those for negligence and any other cause whatsoever shall be deemed waived unless made in writing and received by Cardinal within thirty (30) days after completion of the applicable service. In no event shall Cardinal be liable for incidental or consequential damage, including, without limitation, business interruptions, loss of use, or loss of profits incurred by client, its subsidiaries, affiliates or associates arising out of or related to the performance of the services hereunder by Cardinal, regardless of whether such claim is based upon any of the above stated reasons or otherwise. Results relate only to the samples identified above. This report shall not be reproduced except in full with written approval of Cardinal Laboratories.

Celey D. Keene, Lab Director/Quality Manager



PHONE (575) 393-2326 • 101 E. MARLAND • HOBBS, NM 88240

Analytical Results For:

Safety & Environmental Solutions
Bob Allen
703 East Clinton
Hobbs NM, 88240
Fax To: (575) 393-4388

Received: 01/29/2015
Reported: 02/05/2015
Project Name: SOUTH HOBBS UNIT #29
Project Number: OXY-15-006
Project Location: HOBBS, NM

Sampling Date: 01/28/2015
Sampling Type: Soil
Sampling Condition: Cool & Intact
Sample Received By: Jodi Henson

Sample ID: BH-7 2' (H500275-05)

BTEX 8021B		mg/kg		Analyzed By: ms						
Analyte	Result	Reporting Limit	Analyzed	Method Blank	BS	% Recovery	True Value QC	RPD	Qualifier	
Benzene*	<0.050	0.050	02/02/2015	ND	1.84	92.2	2.00	2.11		
Toluene*	<0.050	0.050	02/02/2015	ND	1.75	87.5	2.00	3.16		
Ethylbenzene*	<0.050	0.050	02/02/2015	ND	1.66	82.9	2.00	3.88		
Total Xylenes*	<0.150	0.150	02/02/2015	ND	4.93	82.2	6.00	4.21		
Total BTEX	<0.300	0.300	02/02/2015	ND						

Surrogate: 4-Bromofluorobenzene (PID) 99.6 % 61-154

Chloride, SM4500Cl-B		mg/kg		Analyzed By: AP					
Analyte	Result	Reporting Limit	Analyzed	Method Blank	BS	% Recovery	True Value QC	RPD	Qualifier
Chloride	32.0	16.0	02/02/2015	ND	416	104	400	7.41	

TPH 8015M		mg/kg		Analyzed By: MS					
Analyte	Result	Reporting Limit	Analyzed	Method Blank	BS	% Recovery	True Value QC	RPD	Qualifier
GRO C6-C10	<10.0	10.0	01/30/2015	ND	207	104	200	1.08	
DRO >C10-C28	<10.0	10.0	01/30/2015	ND	215	107	200	2.00	

Surrogate: 1-Chlorooctane 102 % 47.2-157

Surrogate: 1-Chlorooctadecane 118 % 52.1-176

Cardinal Laboratories

*=Accredited Analyte

PLEASE NOTE: Liability and Damages. Cardinal's liability and client's exclusive remedy for any claim arising, whether based in contract or tort, shall be limited to the amount paid by client for analyses. All claims, including those for negligence and any other cause whatsoever shall be deemed waived unless made in writing and received by Cardinal within thirty (30) days after completion of the applicable service. In no event shall Cardinal be liable for incidental or consequential damages, including, without limitation, business interruptions, loss of use, or loss of profits incurred by client, its subsidiaries, affiliates or successors arising out of or related to the performance of the services hereunder by Cardinal, regardless of whether such claim is based upon any of the above stated causes or otherwise. Results relate only to the samples identified above. This report shall not be reproduced except in full with written approval of Cardinal Laboratories.

Celestine D. Keene

Celestine D. Keene, Lab Director/Quality Manager

Page 6 of 11



PHONE (575) 393-2326 • 101 E. MARLAND • HOBBS, NM 88240

Analytical Results For:

Safety & Environmental Solutions
Bob Allen
703 East Clinton
Hobbs NM, 88240
Fax To: (575) 393-4388

Received: 01/29/2015
Reported: 02/05/2015
Project Name: SOUTH HOBBS UNIT #29
Project Number: OXY-15-006
Project Location: HOBBS, NM

Sampling Date: 01/28/2015
Sampling Type: Soil
Sampling Condition: Cool & Intact
Sample Received By: Jodi Henson

Sample ID: BH-7 3 - 3.8' (H500275-06)

BTEX 8021B		mg/kg		Analyzed By: ms					
Analyte	Result	Reporting Limit	Analyzed	Method Blank	BS	% Recovery	True Value QC	RPD	Qualifier
Benzene*	<0.050	0.050	02/02/2015	ND	1.84	92.2	2.00	2.11	
Toluene*	<0.050	0.050	02/02/2015	ND	1.75	87.5	2.00	3.16	
Ethylbenzene*	<0.050	0.050	02/02/2015	ND	1.66	82.9	2.00	3.88	
Total Xylenes*	<0.150	0.150	02/02/2015	ND	4.93	82.2	6.00	4.21	
Total BTEX	<0.300	0.300	02/02/2015	ND					

Surrogate: 4-Bromofluorobenzene (PID) 98.9 % 61-154

Chloride, SM4500Cl-B		mg/kg		Analyzed By: AP					
Analyte	Result	Reporting Limit	Analyzed	Method Blank	BS	% Recovery	True Value QC	RPD	Qualifier
Chloride	16.0	16.0	02/02/2015	ND	416	104	400	7.41	

TPH 8015M		mg/kg		Analyzed By: MS					
Analyte	Result	Reporting Limit	Analyzed	Method Blank	BS	% Recovery	True Value QC	RPD	Qualifier
GRO C6-C10	<10.0	10.0	01/30/2015	ND	207	104	200	1.08	
DRO >C10-C28	<10.0	10.0	01/30/2015	ND	215	107	200	2.00	

Surrogate: 1-Chlorooctane 108 % 47.2-157

Surrogate: 1-Chlorooctadecane 119 % 52.1-176

Cardinal Laboratories

*=Accredited Analyte

PLEASE NOTE: Liability and Damages: Cardinal's liability and clients exclusive remedy for any claim arising, whether based in contract or tort, shall be limited to the amount paid by client for analyses. All claims, including those for negligence and any other cause whatsoever shall be deemed waived unless made in writing and received by Cardinal within thirty (30) days after completion of the applicable service. In no event shall Cardinal be liable for incidental or consequential damages, including, without limitation, business interruptions, loss of use, or loss of profits incurred by client, its subsidiaries, affiliates or successors arising out of or related to the performance of the services hereunder by Cardinal, regardless of whether such claim is based upon any of the above stated reasons or otherwise. Results relate only to the samples identified above. This report shall not be reproduced except in full with written approval of Cardinal Laboratories.

Coley D. Keene

Coley D. Keene, Lab Director/Quality Manager

Page 7 of 11



PHONE (575) 393-2326 • 101 E. MARLAND • HOBBS, NM 88240

Analytical Results For:

Safety & Environmental Solutions
Bob Allen
703 East Clinton
Hobbs NM, 88240
Fax To: (575) 393-4388

Received: 01/29/2015
Reported: 02/05/2015
Project Name: SOUTH HOBBS UNIT #29
Project Number: OXY-15-006
Project Location: HOBBS, NM

Sampling Date: 01/28/2015
Sampling Type: Soil
Sampling Condition: Cool & Intact
Sample Received By: Jodi Henson

Sample ID: BH-8 2' (H500275-07)

BTEX 8021B		mg/kg		Analyzed By: ms						
Analyte	Result	Reporting Limit	Analyzed	Method Blank	BS	% Recovery	True Value QC	RPD	Qualifier	
Benzene*	<0.050	0.050	02/02/2015	ND	1.84	92.2	2.00	2.11		
Toluene*	<0.050	0.050	02/02/2015	ND	1.75	87.5	2.00	3.16		
Ethylbenzene*	<0.050	0.050	02/02/2015	ND	1.66	82.9	2.00	3.88		
Total Xylenes*	<0.150	0.150	02/02/2015	ND	4.93	82.2	6.00	4.21		
Total BTEX	<0.300	0.300	02/02/2015	ND						

Surrogate: 4-Bromofluorobenzene (PID) 101 % 61-154

Chloride, SM4500Cl-B		mg/kg		Analyzed By: AP					
Analyte	Result	Reporting Limit	Analyzed	Method Blank	BS	% Recovery	True Value QC	RPD	Qualifier
Chloride	544	16.0	02/02/2015	ND	416	104	400	7.41	
TPH 8015M	mg/kg		Analyzed By: MS						

TPH 8015M		mg/kg		Analyzed By: MS					
Analyte	Result	Reporting Limit	Analyzed	Method Blank	BS	% Recovery	True Value QC	RPD	Qualifier
GRO C6-C10	<10.0	10.0	01/30/2015	ND	207	104	200	1.08	
DRO >C10-C28	<10.0	10.0	01/30/2015	ND	215	107	200	2.00	

Surrogate: 1-Chlorooctane 101 % 47.2-157

Surrogate: 1-Chlorooctadecane 120 % 52.1-176

Cardinal Laboratories

*=Accredited Analyte

PUBLIC NOTE: Liability and Damages. Cardinal's liability and clients exclusive remedy for any claim arising, whether based in contract or tort, shall be limited to the amount paid by client for analyses. All claims, including those for negligence and any other cause whatsoever shall be deemed waived unless made in writing and received by Cardinal within thirty (30) days after completion of the applicable service. In no event shall Cardinal be liable for incidental or consequential damages, including, without limitation, business interruptions, loss of use, or loss of profits incurred by client, its subsidiaries, affiliates or successors arising out of or related to the performance of the services hereunder by Cardinal, regardless of whether such claim is based upon any of the above stated reasons or otherwise. Results relate only to the samples identified above. This report shall not be reproduced except in full with written approval of Cardinal Laboratories.

Celey D. Keene, Lab Director/Quality Manager



PHONE (575) 393-2326 • 101 E. MARLAND • HOBBS, NM 88240

Analytical Results For:

Safety & Environmental Solutions
Bob Allen
703 East Clinton
Hobbs NM, 88240
Fax To: (575) 393-4388

Received: 01/29/2015
Reported: 02/05/2015
Project Name: SOUTH HOBBS UNIT #29
Project Number: OXY-15-006
Project Location: HOBBS, NM

Sampling Date: 01/28/2015
Sampling Type: Soil
Sampling Condition: Cool & Intact
Sample Received By: Jodi Henson

Sample ID: BH-8 3.5 - 4' (H500275-08)

BTEX 8021B		mg/kg		Analyzed By: ms					
Analyte	Result	Reporting Limit	Analyzed	Method Blank	BS	% Recovery	True Value QC	RPD	Qualifier
Benzene*	<0.050	0.050	02/02/2015	ND	1.84	92.2	2.00	2.11	
Toluene*	<0.050	0.050	02/02/2015	ND	1.75	87.5	2.00	3.16	
Ethylbenzene*	<0.050	0.050	02/02/2015	ND	1.66	82.9	2.00	3.88	
Total Xylenes*	<0.150	0.150	02/02/2015	ND	4.93	82.2	6.00	4.21	
Total BTEX	<0.300	0.300	02/02/2015	ND					

Surrogate: 4-Bromofluorobenzene (PID) 102 % 01-154

Chloride, SM4500Cl-B		mg/kg		Analyzed By: AP					
Analyte	Result	Reporting Limit	Analyzed	Method Blank	BS	% Recovery	True Value QC	RPD	Qualifier
Chloride	272	16.0	02/02/2015	ND	416	104	400	7.41	

TPH 8015M		mg/kg		Analyzed By: MS					
Analyte	Result	Reporting Limit	Analyzed	Method Blank	BS	% Recovery	True Value QC	RPD	Qualifier
GRO C6-C10	<10.0	10.0	01/30/2015	ND	207	104	200	1.08	
DRO >C10-C28	<10.0	10.0	01/30/2015	ND	215	107	200	2.00	

Surrogate: 1-Chlorooctane 103 % 47.2-157

Surrogate: 1-Chlorooctadecane 117 % 52.1-176

Cardinal Laboratories

*=Accredited Analyte

PLEASE NOTE: Liability and Damages. Cardinal's liability and direct exclusive remedy for any claim arising, whether based in contract or tort, shall be limited to the amount paid by client for analyses. All claims, including those for negligence and any other cause whatsoever shall be deemed waived unless made in writing and received by Cardinal within thirty (30) days after completion of the applicable service. In no event shall Cardinal be liable for incidental or consequential damage, including, without limitation, business interruptions, loss of use, or loss of profits incurred by client, its subsidiaries, affiliates or successors arising out of or related to the performance of the services hereunder by Cardinal, regardless of whether such claim is based upon any of the above stated reasons or otherwise. Results relate only to the samples identified above. This report shall not be reproduced except in full with written approval of Cardinal Laboratories.

Coley D. Keene

Coley D. Keene, Lab Director/Quality Manager

Page 9 of 11

Notes and Definitions

ND	Analyte NOT DETECTED at or above the reporting limit
RPD	Relative Percent Difference
**	Samples not received at proper temperature of 6°C or below.
***	Insufficient time to reach temperature.
-	Chloride by SM4500Cl-B does not require samples be received at or below 6°C Samples reported on an as received basis (wet) unless otherwise noted on report

Cardinal Laboratories

*=Accredited Analyte

PLEASE NOTE: Liability and Damages. Cardinal's liability and client's exclusive remedy for any claim arising, whether based in contract or tort, shall be limited to the amount paid by client for analyses. All claims, including those for negligence and any other cause whatsoever shall be deemed waived unless made in writing and received by Cardinal within thirty (30) days after completion of the applicable service. In no event shall Cardinal be liable for incidental or consequential damages, including, without limitation, business interruptions, loss of use, or loss of profits incurred by client, its subsidiaries, affiliates or successors arising out of or related to the performance of the services hereunder by Cardinal, regardless of whether such claim is based upon any of the above stated reasons or otherwise. Results relate only to the samples identified above. This report shall not be reproduced except in full with written approval of Cardinal Laboratories.



Celey D. Keene, Lab Director/Quality Manager



CHAIN-OF-CUSTODY AND ANALYSIS REQUEST

101 East Marland, Hobbs, NM 88240
(505) 393-2326 Fax (505) 393-2476

Page 1 of 1

Company Name: Safety & Environmental Solutions, Inc.		P.O. #:	
Project Manager: Bob Allen		Billing:	
Address: 703 East Clinton		Company: Same as above	
City: Hobbs		Attn: [Signature]	
State: NM Zip: 88240			
Phone #: 575-397-0510 Fax #: 575-393-4388		Address:	
Project #:		City:	
Project Name: SHU-22		State:	
Project Location: Hobbs		Zip:	
Sample Name: [Signature]		Phone #:	
For Lab Use Only		Fax #:	

Lab I.D.	Sample I.D.	(G)RAB OR (C)OMP.	# CONTAINERS	MATRIX						PRESERV.	SAMPLING	DATE	TIME	TPH	BTEX	CHLORIDE	
				GROUNDWATER	WASTEWATER	SOIL	OIL	SILUDGE	OTHER :								ACID/BASE
1	PH-5 2'		61	X								20.5	1450	X	X	X	
2	PH-5 3.5-3.8'		61	X								1133	1450	X	X	X	
3	PH-6 2'			X									1505				
4	PH-6 3-3.4'												1522				
5	PH-7 2'												1522				
6	PH-7 3-3.8'												1540				
7	PH-8 2'												1540				
8	PH-8 3.5-4'		61	X								128	1540	X	X	X	

Delivered By: (Circle One)	Temp.	Sample Condition	Checked By:
Driver	2.22	Good	[Signature]
Smpler - UPS - Bus - Other:		<input type="checkbox"/> Good <input type="checkbox"/> Bad <input type="checkbox"/> No	

Relinquished By:	Date:	Received By:	Date:
[Signature]	12/29/15	[Signature]	12/29/15
Relinquished By:	Date:	Received By:	Date:

Phone Result:	Yes	No	Add Phone #:
Fax Result:	Yes	No	Add Fax #:
REMARKS:			

Appendix B

C-141

District I
1625 N. French Dr., Hobbs, NM 88240
District II
811 S. First St., Artesia, NM 88210
District III
1000 Rio Brazos Road, Aztec, NM 87410
District IV
1220 S. St. Francis Dr., Santa Fe, NM 87505

State of New Mexico
Energy Minerals and Natural Resources

Oil Conservation Division
1220 South St. Francis Dr.
Santa Fe, NM 87505

Form C-141
Revised August 8, 2011

Submit 1 Copy to appropriate District Office in
accordance with 19.15.29 NMAC.

Release Notification and Corrective Action

OPERATOR

☒ Initial Report ☐ Final Report

Name of Company: OXY	Contact: Raymond Aguilar
Address: 1017 W Stanolind Road	Telephone No. 575-390-6312
Facility Name: South Hobbs Unit 29 Injection 7	Facility Type:

Surface Owner	Mineral Owner	API No. 30-025-07620
---------------	---------------	----------------------

LOCATION OF RELEASE

Unit Letter	Section: 5	Township: 19S	Range: 38E	Feet from the	North/South Line	Feet from the	East/West Line	County:
-------------	------------	---------------	------------	---------------	------------------	---------------	----------------	---------

Latitude 32.691010 Longitude -103.1680

NATURE OF RELEASE

Type of Release: Produced Water	Volume of Release: 200BBLS	Volume Recovered: 25 BBLS
Source of Release: 3" Steel Injection	Date and Hour of Occurrence: 1-19-2015 11:00PM	Date and Hour of Discovery
Was Immediate Notice Given? <input checked="" type="checkbox"/> Yes <input type="checkbox"/> No <input type="checkbox"/> Not Required	If YES, To Whom?	
By Whom? Raymond Aguilar	Date and Hour: 1-19-2015 12:34 AM (left message)	
Was a Watercourse Reached? <input type="checkbox"/> Yes <input checked="" type="checkbox"/> No	If YES, Volume Impacting the Watercourse.	

If a Watercourse was Impacted, Describe Fully.*

Describe Cause of Problem and Remedial Action Taken.*

The cause of leak was external corrosion

Describe Area Affected and Cleanup Action Taken.*

Safety & Environmental Solutions, Inc. will delineate the spill area and submit an appropriate work plan.

I hereby certify that the information given above is true and complete to the best of my knowledge and understand that pursuant to NMOCD rules and regulations all operators are required to report and/or file certain release notifications and perform corrective actions for releases which may endanger public health or the environment. The acceptance of a C-141 report by the NMOCD marked as "Final Report" does not relieve the operator of liability should their operations have failed to adequately investigate and remediate contamination that pose a threat to ground water, surface water, human health or the environment. In addition, NMOCD acceptance of a C-141 report does not relieve the operator of responsibility for compliance with any other federal, state, or local laws and/or regulations.

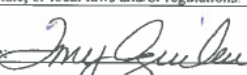
Signature: 	OIL CONSERVATION DIVISION	
Printed Name: Tony Aguilar	Approved by Environmental Specialist:	
Title: HES Specialist	Approval Date:	Expiration Date:
E-mail Address: Raymond_Aguilar@oxy.com	Conditions of Approval:	Attached <input type="checkbox"/>
Date: 2-5-15	Phone: 575-390-6312	

* Attach Additional Sheets If Necessary