



EXPLORING WHAT'S POSSIBLE

RECEIVED

By OCD; Dr. Oberding at 3:29 pm, Mar 16, 2015

APACHE CORPORATION

P.O.Box 1849
Eunice, NM 88231
Phone 575.394.3159

WBDU #42
(1RP-3435)

Termination Request

API No. 30-025-20178

Release Date: November 11th, 2014

Unit Letter I, Section 9, Township 21S, Range 37E

March 11th, 2015

Dr. Tomáš Oberding, PhD

Hydrologist – New Mexico Oil Conservation Division
Energy, Minerals and Natural Resources Department
1625 N. French Dr.
Hobbs, NM 88240

**RE: Termination Request
Apache WBDU #42 (1RP-3435)
UL/I sec. 9 T21S R37E
API No. 30-025-20178**

Dr. Oberding:

Apache Corporation (Apache) has retained Rice Environmental Consulting and Safety (RECS) to address potential environmental concerns at the above-referenced site.

Background and Previous Work

The site is located approximately 3.4 miles north of Eunice, New Mexico at UL/I sec. 9 T21S R37E. Based on records from NM OSE, USGS and RECS installed monitor wells near the site, the depth to groundwater at the site is approximately +/- 60 ft bgs.

On November 11th, 2014, Apache discovered a release of produced water from a hole in a 2 inch 90 degree fitting on the well head. A total of 15 barrels of produced water was released over 21,131 square feet of lease pad and pasture land. The line was shut in, and a vacuum truck was dispatched to the site to pick up the standing fluid. The vacuum truck recovered 5 barrels of produced water. BLM was notified of the release on November 12th, 2014, and an initial C-141 was submitted to NMOCD and BLM for their approval. NMOCD approved the initial C-141 on December 8th, 2014.

RECS personnel were on site beginning November 12th, 2014 to assess the release. Based on the assessment, the release was scraped, and samples were taken from the bottom and walls of the scrape. The samples were field tested for chlorides and organic vapors. If field testing indicated that the samples would return chloride, Gasoline Range Organics (GRO) and Diesel Range Organics (DRO) readings below regulatory standards, the samples were taken to a commercial laboratory for analyses. If field testing did not show that all constituents would be below regulatory standards, the scrape was expanded until field testing shows that all constituents would be below regulatory standards.

Using these standards, the site was excavated in four portions (Figure 1). The lease pad was scraped down to 6 inches bgs. Various portions of the pasture area were scraped down to 1 ft bgs, 1.5 ft bgs and 2 ft bgs. Once the 6 inch scrape on the lease pad was completed, final bottom

samples were taken and field tested for chlorides and organic vapors. The two composite samples and the two grab samples were then sent to a commercial laboratory for analyses (Appendix B). The composite samples and the two grab samples returned chloride, GRO and DRO readings at or near non-detectable levels.

Once the scrapes in the pasture areas were completed, final wall and bottom samples were taken and field tested for chlorides and organic vapors. Representative samples were then sent to a commercial laboratory for analyses. All samples returned chloride levels below the regulatory standard of 250 mg/kg. GRO and DRO readings returned values of non-detect.

A request to backfill the site was sent to NMOCD on January 9th, 2015. NMOCD approved the backfill request on January 12th, 2015.

All excavated soil was taken to a NMOCD approved facility for disposal. Clean caliche was imported to the site to backfill the lease pad, and clean top soil was imported to the site to backfill the pasture area. The lease pad and pasture areas were backfilled and contoured to the surrounding location.

Photo documentation of field activities can be found in Appendix C.

Given that Apache removed the contaminated soil and replaced it with clean, imported soil, Apache respectfully requests 'remediation termination' and site closure. A final C-141 can be found in Appendix D.

RECS appreciates the opportunity to work with you on this project. Please call Hack Conder at (575) 393-2967 or me if you have any questions or wish to discuss the site.

Sincerely,

A handwritten signature in dark ink, appearing to read 'Lara Weinheimer', with a stylized flourish at the end.

Lara Weinheimer
Project Scientist
RECS
(575) 441-0431

Attachments:

- Figure 1 – Excavation Data
- Appendix A – Initial C-141
- Appendix B – Laboratory Analyses
- Appendix C – Photo Documentation
- Appendix D – Final C-141

Figures

Excavation Data

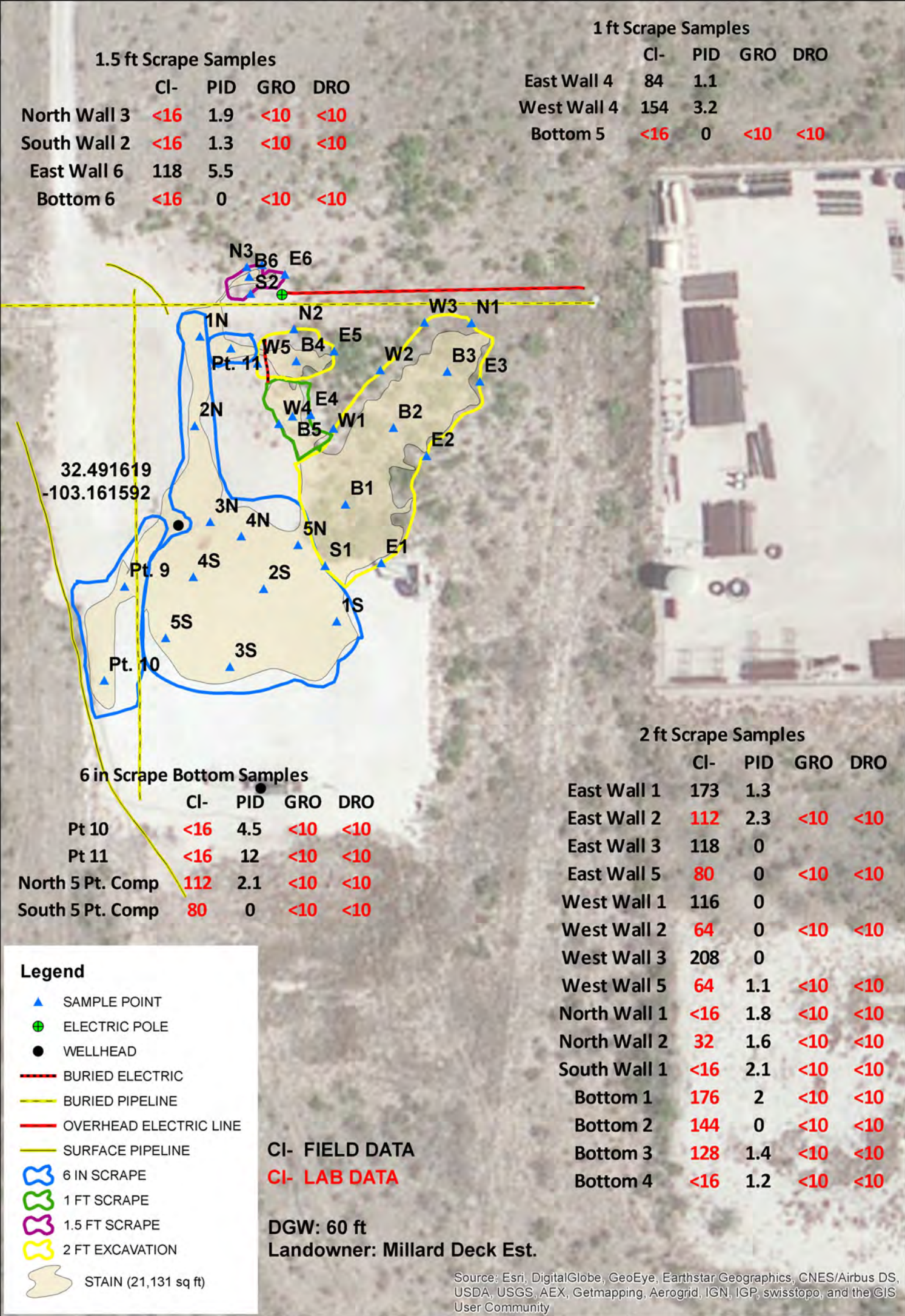

Appendix A

Initial C-141

District I
1625 N. French Dr., Hobbs, NM 88240
District II
811 S. First St., Artesia, NM 88210
District III
1000 Rio Brazos Road, Aztec, NM 87410
District IV
1220 S. St. Francis Dr., Santa Fe, NM 87505

HOBBS OCD

DEC 08 2014

RECEIVED

State of New Mexico
Energy Minerals and Natural Resources
Oil Conservation Division
1220 South St. Francis Dr.
Santa Fe, NM 87505

Form C-141
Revised August 8, 2011

Submit 1 Copy to appropriate District Office in
accordance with 19.15.29 NMAC.

Release Notification and Corrective Action

OPERATOR

☒ Initial Report ☐ Final Report

Name of Company Apache Corporation	Contact Bruce Baker
Address 2350 Marland Blvd Hobbs NM 88240	Telephone No. 432-631-6982
Facility Name WBDU # 42	Facility Type injection well
Surface Owner Millard Deck Estates	Mineral Owner BLM
API No. 30-025-20178	

LOCATION OF RELEASE

Unit Letter I	Section 9	Township 21S	Range 37E	Feet from the 198'	North/South Line FSL	Feet from the 660'	East/West Line FEL	County Lea
------------------	--------------	-----------------	--------------	-----------------------	-------------------------	-----------------------	-----------------------	---------------

Latitude _____ Longitude _____

NATURE OF RELEASE

Type of Release Produced Water	Volume of Release 15 Barrels of water	Volume Recovered 5 Barrels of water
Source of Release injection line	Date and Hour of Occurrence 11/11/14	Date and Hour of Discovery 11/11/2014
Was Immediate Notice Given? <input checked="" type="checkbox"/> Yes <input type="checkbox"/> No <input type="checkbox"/> Not Required	If YES, To Whom? Jeffery Robertson (BLM)	
By Whom? Bruce Baker	Date and Hour 11/12/2014	
Was a Watercourse Reached? <input type="checkbox"/> Yes <input checked="" type="checkbox"/> No	If YES, Volume Impacting the Watercourse.	

If a Watercourse was Impacted, Describe Fully.*

Describe Cause of Problem and Remedial Action Taken.*

The release occurred due to a hole in 2 inch 90 degree fitting on the well head. The line was shut in and a vacuum truck was dispatched to pick up standing fluid.

Describe Area Affected and Cleanup Action Taken.* The majority of the release was contained to the pad with about 2,500 square feet of pasture affected on east side of well pad. The area was mapped and the wet area has been scraped and contaminated soil was hauled to a NMOCD approved facility.

I hereby certify that the information given above is true and complete to the best of my knowledge and understand that pursuant to NMOCD rules and regulations all operators are required to report and/or file certain release notifications and perform corrective actions for releases which may endanger public health or the environment. The acceptance of a C-141 report by the NMOCD marked as "Final Report" does not relieve the operator of liability should their operations have failed to adequately investigate and remediate contamination that pose a threat to ground water, surface water, human health or the environment. In addition, NMOCD acceptance of a C-141 report does not relieve the operator of responsibility for compliance with any other federal, state, or local laws and/or regulations.

Signature: <i>Bruce Baker</i>	OIL CONSERVATION DIVISION	
Printed Name: Bruce Baker	Approved by Environmental Specialist:	
Title: Environmental Technician	Approval Date: 12-8-14	Expiration Date: 2-8-14
E-mail Address: larry.baker@apachecorp.com	Conditions of Approval: <i>Site Super signed</i> <i>Delante E. Gonzalez</i>	Attached <input type="checkbox"/> <i>1AP-3435</i>
Date: 11/26/14 Phone: (432) 631-6982	<i>NMOCD guide - Submit Form C-141</i> <i>by 2-8-14.</i>	

* Attach Additional Sheets If Necessary

DEC 11 2014

701439 234516
701439 234688

Appendix B

Laboratory Analyses

RICE Environmental Consulting and Safety (RECS)
P.O. Box 2948 Hobbs, NM 88241
Phone 575.393.2967



PHONE (575) 393-2326 ° 101 E. MARLAND ° HOBBS, NM 88240

November 17, 2014

BRUCE BAKER

APACHE CORP - HOBBS

2350 W. MARLAND BLVD.

HOBBS, NM 88240

RE: WBDU #42

Enclosed are the results of analyses for samples received by the laboratory on 11/14/14 12:16.

Cardinal Laboratories is accredited through Texas NELAP under certificate number T104704398-13-5. Accreditation applies to drinking water, non-potable water and solid and chemical materials. All accredited analytes are denoted by an asterisk (*). For a complete list of accredited analytes and matrices visit the TCEQ website at www.tceq.texas.gov/field/qa/lab_accred_certif.html.

Cardinal Laboratories is accredited through the State of Colorado Department of Public Health and Environment for:

Method EPA 552.2	Haloacetic Acids (HAA-5)
Method EPA 524.2	Total Trihalomethanes (TTHM)
Method EPA 524.4	Regulated VOCs (V1, V2, V3)

Accreditation applies to public drinking water matrices.

This report meets NELAP requirements and is made up of a cover page, analytical results, and a copy of the original chain-of-custody. If you have any questions concerning this report, please feel free to contact me.

Sincerely,

A handwritten signature in black ink that reads "Celey D. Keene". The signature is written in a cursive, flowing style.

Celey D. Keene

Lab Director/Quality Manager

Analytical Results For:

 APACHE CORP - HOBBS
 BRUCE BAKER
 2350 W. MARLAND BLVD.
 HOBBS NM, 88240
 Fax To: (575) 393-2432

Received:	11/14/2014	Sampling Date:	11/14/2014
Reported:	11/17/2014	Sampling Type:	Soil
Project Name:	WBDU #42	Sampling Condition:	Cool & Intact
Project Number:	NONE GIVEN	Sample Received By:	Kathy Perez
Project Location:	NOT GIVEN		

Sample ID: NORTH 5 PT. COMP (H403522-01)

Chloride, SM4500Cl-B		mg/kg		Analyzed By: AP					
Analyte	Result	Reporting Limit	Analyzed	Method Blank	BS	% Recovery	True Value QC	RPD	Qualifier
Chloride	112	16.0	11/17/2014	ND	400	100	400	3.92	
TPH 8015M		mg/kg		Analyzed By: MS					
Analyte	Result	Reporting Limit	Analyzed	Method Blank	BS	% Recovery	True Value QC	RPD	Qualifier
GRO C6-C10	<10.0	10.0	11/15/2014	ND	223	111	200	0.588	
DRO >C10-C28	<10.0	10.0	11/15/2014	ND	220	110	200	0.939	
Surrogate: 1-Chlorooctane	113 %	47.2-157							
Surrogate: 1-Chlorooctadecane	117 %	52.1-176							

Sample ID: SOUTH 5 PT. COMP (H403522-02)

Chloride, SM4500Cl-B		mg/kg		Analyzed By: AP					
Analyte	Result	Reporting Limit	Analyzed	Method Blank	BS	% Recovery	True Value QC	RPD	Qualifier
Chloride	80.0	16.0	11/17/2014	ND	400	100	400	3.92	
TPH 8015M		mg/kg		Analyzed By: MS					
Analyte	Result	Reporting Limit	Analyzed	Method Blank	BS	% Recovery	True Value QC	RPD	Qualifier
GRO C6-C10	<10.0	10.0	11/15/2014	ND	223	111	200	0.588	
DRO >C10-C28	<10.0	10.0	11/15/2014	ND	220	110	200	0.939	
Surrogate: 1-Chlorooctane	117 %	47.2-157							
Surrogate: 1-Chlorooctadecane	122 %	52.1-176							

Cardinal Laboratories

*=Accredited Analyte

PLEASE NOTE: Liability and Damages. Cardinal's liability and client's exclusive remedy for any claim arising, whether based in contract or tort, shall be limited to the amount paid by client for analyses. All claims, including those for negligence and any other cause whatsoever shall be deemed waived unless made in writing and received by Cardinal within thirty (30) days after completion of the applicable service. In no event shall Cardinal be liable for incidental or consequential damages, including, without limitation, business interruptions, loss of use, or loss of profits incurred by client, its subsidiaries, affiliates or successors arising out of or related to the performance of the services hereunder by Cardinal, regardless of whether such claim is based upon any of the above stated reasons or otherwise. Results relate only to the samples identified above. This report shall not be reproduced except in full with written approval of Cardinal Laboratories.



Celey D. Keene, Lab Director/Quality Manager

Notes and Definitions

ND	Analyte NOT DETECTED at or above the reporting limit
RPD	Relative Percent Difference
**	Samples not received at proper temperature of 6°C or below.
***	Insufficient time to reach temperature.
-	Chloride by SM4500Cl-B does not require samples be received at or below 6°C Samples reported on an as received basis (wet) unless otherwise noted on report

Cardinal Laboratories

*=Accredited Analyte

PLEASE NOTE: Liability and Damages. Cardinal's liability and client's exclusive remedy for any claim arising, whether based in contract or tort, shall be limited to the amount paid by client for analyses. All claims, including those for negligence and any other cause whatsoever shall be deemed waived unless made in writing and received by Cardinal within thirty (30) days after completion of the applicable service. In no event shall Cardinal be liable for incidental or consequential damages, including, without limitation, business interruptions, loss of use, or loss of profits incurred by client, its subsidiaries, affiliates or successors arising out of or related to the performance of the services hereunder by Cardinal, regardless of whether such claim is based upon any of the above stated reasons or otherwise. Results relate only to the samples identified above. This report shall not be reproduced except in full with written approval of Cardinal Laboratories.



Celey D. Keene, Lab Director/Quality Manager



101 East Marland, Hobbs, NM 88240 2111 Beechwood, Abilene, TX 79603
(505) 393-2326 FAX (505) 393-2476 (325) 673-7001 FAX (325) 673-7020

CHAIN-OF-CUSTODY AND ANALYSIS REQUEST

PLEASE NOTE: Liability and Damages. Cardinal's liability and client's exclusive remedy for any claim arising whether based in contract or tort, shall be limited to the amount paid by the client for the analyses. All claims including those for negligence and any other cause whatsoever shall be deemed waived unless made in writing and received by Cardinal within 30 days after completion of the applicable service. In no event shall Cardinal be liable for incidental or consequential damages, including without limitation, business interruption, loss of use, or loss of profits incurred by client, its subsidiaries, affiliates or successors arising out of or related to the performance of services hereunder by Cardinal, regardless of whether such claim is based upon any of the above stated reasons or otherwise.

Relinquished By: <i>Rare Henry</i>		Date: <i>11-14-14</i>		Received By: <i>Patmy Perry</i>		Phone Result: <input type="checkbox"/> Yes <input checked="" type="checkbox"/> No		Add'l Phone #:	
		Time: <i>12:16</i>				Fax Result: <input type="checkbox"/> Yes <input checked="" type="checkbox"/> No		Add'l Fax #:	
Relinquished By:		Date:		Received By:		REMARKS: email: hconder@riceswd.com; lflores@rice-ecs.com; lweinheimer@rice-ecs.com; knorman@rice-ecs.com; jkamplain@rice-ecs.com; sedwards@rice-ecs.com; cursanic@rice-ecs.com Environmental Tech: <i>K Humphrey</i> @rice-ecs.com			
		Time:							
Delivered By: (Circle One)				Sample Condition		CHECKED BY:			
Sampler - UPS - Bus - Other:				Cool Intact		(Initials)			
				<input checked="" type="checkbox"/> Yes <input type="checkbox"/> No		<i>KP</i>			

† Cardinal cannot accept verbal changes. Please fax written changes to 505-393-2476

#54



PHONE (575) 393-2326 ° 101 E. MARLAND ° HOBBS, NM 88240

December 05, 2014

BRUCE BAKER

APACHE CORP - HOBBS

2350 W. MARLAND BLVD.

HOBBS, NM 88240

RE: WBDU #42

Enclosed are the results of analyses for samples received by the laboratory on 12/04/14 13:20.

Cardinal Laboratories is accredited through Texas NELAP under certificate number T104704398-13-5. Accreditation applies to drinking water, non-potable water and solid and chemical materials. All accredited analytes are denoted by an asterisk (*). For a complete list of accredited analytes and matrices visit the TCEQ website at www.tceq.texas.gov/field/qa/lab_accred_certif.html.

Cardinal Laboratories is accredited through the State of Colorado Department of Public Health and Environment for:

Method EPA 552.2	Haloacetic Acids (HAA-5)
Method EPA 524.2	Total Trihalomethanes (TTHM)
Method EPA 524.4	Regulated VOCs (V1, V2, V3)

Accreditation applies to public drinking water matrices.

This report meets NELAP requirements and is made up of a cover page, analytical results, and a copy of the original chain-of-custody. If you have any questions concerning this report, please feel free to contact me.

Sincerely,

A handwritten signature in black ink that reads "Celey D. Keene". The signature is written in a cursive, flowing style.

Celey D. Keene

Lab Director/Quality Manager

Analytical Results For:

APACHE CORP - HOBBS
BRUCE BAKER
2350 W. MARLAND BLVD.
HOBBS NM, 88240
Fax To: (575) 393-2432

Received: 12/04/2014
Reported: 12/05/2014
Project Name: WBDU #42
Project Number: NONE GIVEN
Project Location: NOT GIVEN

Sampling Date: 12/04/2014
Sampling Type: Soil
Sampling Condition: Cool & Intact
Sample Received By: Jodi Henson

Sample ID: BOTTOM 4 (H403695-01)

Chloride, SM4500Cl-B		mg/kg		Analyzed By: AP					
Analyte	Result	Reporting Limit	Analyzed	Method Blank	BS	% Recovery	True Value QC	RPD	Qualifier
Chloride	<16.0	16.0	12/05/2014	ND	400	100	400	3.92	
TPH 8015M		mg/kg		Analyzed By: CK					
Analyte	Result	Reporting Limit	Analyzed	Method Blank	BS	% Recovery	True Value QC	RPD	Qualifier
GRO C6-C10	<10.0	10.0	12/04/2014	ND	201	101	200	0.950	
DRO >C10-C28	<10.0	10.0	12/04/2014	ND	209	105	200	2.49	
Surrogate: 1-Chlorooctane	125 %	47.2-157							
Surrogate: 1-Chlorooctadecane	143 %	52.1-176							

Sample ID: BOTTOM 5 (H403695-02)

Chloride, SM4500Cl-B		mg/kg		Analyzed By: AP					
Analyte	Result	Reporting Limit	Analyzed	Method Blank	BS	% Recovery	True Value QC	RPD	Qualifier
Chloride	<16.0	16.0	12/05/2014	ND	400	100	400	3.92	
TPH 8015M		mg/kg		Analyzed By: CK					
Analyte	Result	Reporting Limit	Analyzed	Method Blank	BS	% Recovery	True Value QC	RPD	Qualifier
GRO C6-C10	<10.0	10.0	12/04/2014	ND	201	101	200	0.950	
DRO >C10-C28	<10.0	10.0	12/04/2014	ND	209	105	200	2.49	
Surrogate: 1-Chlorooctane	129 %	47.2-157							
Surrogate: 1-Chlorooctadecane	147 %	52.1-176							

Cardinal Laboratories

*=Accredited Analyte

PLEASE NOTE: Liability and Damages. Cardinal's liability and client's exclusive remedy for any claim arising, whether based in contract or tort, shall be limited to the amount paid by client for analyses. All claims, including those for negligence and any other cause whatsoever shall be deemed waived unless made in writing and received by Cardinal within thirty (30) days after completion of the applicable service. In no event shall Cardinal be liable for incidental or consequential damages, including, without limitation, business interruptions, loss of use, or loss of profits incurred by client, its subsidiaries, affiliates or successors arising out of or related to the performance of the services hereunder by Cardinal, regardless of whether such claim is based upon any of the above stated reasons or otherwise. Results relate only to the samples identified above. This report shall not be reproduced except in full with written approval of Cardinal Laboratories.



Celey D. Keene, Lab Director/Quality Manager

Analytical Results For:

APACHE CORP - HOBBS
BRUCE BAKER
2350 W. MARLAND BLVD.
HOBBS NM, 88240
Fax To: (575) 393-2432

Received: 12/04/2014
Reported: 12/05/2014
Project Name: WBDU #42
Project Number: NONE GIVEN
Project Location: NOT GIVEN

Sampling Date: 12/04/2014
Sampling Type: Soil
Sampling Condition: Cool & Intact
Sample Received By: Jodi Henson

Sample ID: BOTTOM 6 (H403695-03)

Chloride, SM4500Cl-B		mg/kg		Analyzed By: AP					
Analyte	Result	Reporting Limit	Analyzed	Method Blank	BS	% Recovery	True Value QC	RPD	Qualifier
Chloride	<16.0	16.0	12/05/2014	ND	400	100	400	3.92	
TPH 8015M		mg/kg		Analyzed By: CK					
Analyte	Result	Reporting Limit	Analyzed	Method Blank	BS	% Recovery	True Value QC	RPD	Qualifier
GRO C6-C10	<10.0	10.0	12/04/2014	ND	201	101	200	0.950	
DRO >C10-C28	<10.0	10.0	12/04/2014	ND	209	105	200	2.49	
Surrogate: 1-Chlorooctane		131 %	47.2-157						
Surrogate: 1-Chlorooctadecane		152 %	52.1-176						

Sample ID: NORTH WALL 2 (H403695-04)

Chloride, SM4500Cl-B		mg/kg		Analyzed By: AP					
Analyte	Result	Reporting Limit	Analyzed	Method Blank	BS	% Recovery	True Value QC	RPD	Qualifier
Chloride	32.0	16.0	12/05/2014	ND	400	100	400	3.92	
TPH 8015M		mg/kg		Analyzed By: CK					
Analyte	Result	Reporting Limit	Analyzed	Method Blank	BS	% Recovery	True Value QC	RPD	Qualifier
GRO C6-C10	<10.0	10.0	12/04/2014	ND	201	101	200	0.950	
DRO >C10-C28	<10.0	10.0	12/04/2014	ND	209	105	200	2.49	
Surrogate: 1-Chlorooctane		125 %	47.2-157						
Surrogate: 1-Chlorooctadecane		143 %	52.1-176						

Cardinal Laboratories

*=Accredited Analyte

PLEASE NOTE: Liability and Damages. Cardinal's liability and client's exclusive remedy for any claim arising, whether based in contract or tort, shall be limited to the amount paid by client for analyses. All claims, including those for negligence and any other cause whatsoever shall be deemed waived unless made in writing and received by Cardinal within thirty (30) days after completion of the applicable service. In no event shall Cardinal be liable for incidental or consequential damages, including, without limitation, business interruptions, loss of use, or loss of profits incurred by client, its subsidiaries, affiliates or successors arising out of or related to the performance of the services hereunder by Cardinal, regardless of whether such claim is based upon any of the above stated reasons or otherwise. Results relate only to the samples identified above. This report shall not be reproduced except in full with written approval of Cardinal Laboratories.



Celey D. Keene, Lab Director/Quality Manager

Analytical Results For:

APACHE CORP - HOBBS
BRUCE BAKER
2350 W. MARLAND BLVD.
HOBBS NM, 88240
Fax To: (575) 393-2432

Received: 12/04/2014
Reported: 12/05/2014
Project Name: WBDU #42
Project Number: NONE GIVEN
Project Location: NOT GIVEN

Sampling Date: 12/04/2014
Sampling Type: Soil
Sampling Condition: Cool & Intact
Sample Received By: Jodi Henson

Sample ID: NORTH WALL 3 (H403695-05)

Chloride, SM4500Cl-B		mg/kg		Analyzed By: AP					
Analyte	Result	Reporting Limit	Analyzed	Method Blank	BS	% Recovery	True Value QC	RPD	Qualifier
Chloride	<16.0	16.0	12/05/2014	ND	400	100	400	3.92	
TPH 8015M		mg/kg		Analyzed By: CK					
Analyte	Result	Reporting Limit	Analyzed	Method Blank	BS	% Recovery	True Value QC	RPD	Qualifier
GRO C6-C10	<10.0	10.0	12/04/2014	ND	201	101	200	0.950	
DRO >C10-C28	<10.0	10.0	12/04/2014	ND	209	105	200	2.49	
Surrogate: 1-Chlorooctane	123 %	47.2-157							
Surrogate: 1-Chlorooctadecane	141 %	52.1-176							

Sample ID: EAST WALL S (H403695-06)

Chloride, SM4500Cl-B		mg/kg		Analyzed By: AP					
Analyte	Result	Reporting Limit	Analyzed	Method Blank	BS	% Recovery	True Value QC	RPD	Qualifier
Chloride	80.0	16.0	12/05/2014	ND	400	100	400	3.92	
TPH 8015M		mg/kg		Analyzed By: CK					
Analyte	Result	Reporting Limit	Analyzed	Method Blank	BS	% Recovery	True Value QC	RPD	Qualifier
GRO C6-C10	<10.0	10.0	12/04/2014	ND	201	101	200	0.950	
DRO >C10-C28	<10.0	10.0	12/04/2014	ND	209	105	200	2.49	
Surrogate: 1-Chlorooctane	125 %	47.2-157							
Surrogate: 1-Chlorooctadecane	142 %	52.1-176							

Cardinal Laboratories

*=Accredited Analyte

PLEASE NOTE: Liability and Damages. Cardinal's liability and client's exclusive remedy for any claim arising, whether based in contract or tort, shall be limited to the amount paid by client for analyses. All claims, including those for negligence and any other cause whatsoever shall be deemed waived unless made in writing and received by Cardinal within thirty (30) days after completion of the applicable service. In no event shall Cardinal be liable for incidental or consequential damages, including, without limitation, business interruptions, loss of use, or loss of profits incurred by client, its subsidiaries, affiliates or successors arising out of or related to the performance of the services hereunder by Cardinal, regardless of whether such claim is based upon any of the above stated reasons or otherwise. Results relate only to the samples identified above. This report shall not be reproduced except in full with written approval of Cardinal Laboratories.



Celey D. Keene, Lab Director/Quality Manager

Analytical Results For:

APACHE CORP - HOBBS
BRUCE BAKER
2350 W. MARLAND BLVD.
HOBBS NM, 88240
Fax To: (575) 393-2432

Received: 12/04/2014
Reported: 12/05/2014
Project Name: WBDU #42
Project Number: NONE GIVEN
Project Location: NOT GIVEN

Sampling Date: 12/04/2014
Sampling Type: Soil
Sampling Condition: Cool & Intact
Sample Received By: Jodi Henson

Sample ID: WEST WALL S (H403695-07)

Chloride, SM4500Cl-B		mg/kg		Analyzed By: AP					
Analyte	Result	Reporting Limit	Analyzed	Method Blank	BS	% Recovery	True Value QC	RPD	Qualifier
Chloride	64.0	16.0	12/05/2014	ND	400	100	400	3.92	
TPH 8015M		mg/kg		Analyzed By: CK					
Analyte	Result	Reporting Limit	Analyzed	Method Blank	BS	% Recovery	True Value QC	RPD	Qualifier
GRO C6-C10	<10.0	10.0	12/05/2014	ND	201	101	200	0.950	
DRO >C10-C28	<10.0	10.0	12/05/2014	ND	209	105	200	2.49	
Surrogate: 1-Chlorooctane	119 %	47.2-157							
Surrogate: 1-Chlorooctadecane	132 %	52.1-176							

Sample ID: SOUTH WALL 2 (H403695-08)

Chloride, SM4500Cl-B		mg/kg		Analyzed By: AP					
Analyte	Result	Reporting Limit	Analyzed	Method Blank	BS	% Recovery	True Value QC	RPD	Qualifier
Chloride	<16.0	16.0	12/05/2014	ND	400	100	400	3.92	
TPH 8015M		mg/kg		Analyzed By: CK					
Analyte	Result	Reporting Limit	Analyzed	Method Blank	BS	% Recovery	True Value QC	RPD	Qualifier
GRO C6-C10	<10.0	10.0	12/05/2014	ND	201	101	200	0.950	
DRO >C10-C28	<10.0	10.0	12/05/2014	ND	209	105	200	2.49	
Surrogate: 1-Chlorooctane	131 %	47.2-157							
Surrogate: 1-Chlorooctadecane	146 %	52.1-176							

Cardinal Laboratories

*=Accredited Analyte

PLEASE NOTE: Liability and Damages. Cardinal's liability and client's exclusive remedy for any claim arising, whether based in contract or tort, shall be limited to the amount paid by client for analyses. All claims, including those for negligence and any other cause whatsoever shall be deemed waived unless made in writing and received by Cardinal within thirty (30) days after completion of the applicable service. In no event shall Cardinal be liable for incidental or consequential damages, including, without limitation, business interruptions, loss of use, or loss of profits incurred by client, its subsidiaries, affiliates or successors arising out of or related to the performance of the services hereunder by Cardinal, regardless of whether such claim is based upon any of the above stated reasons or otherwise. Results relate only to the samples identified above. This report shall not be reproduced except in full with written approval of Cardinal Laboratories.



Celey D. Keene, Lab Director/Quality Manager

Analytical Results For:

APACHE CORP - HOBBS
BRUCE BAKER
2350 W. MARLAND BLVD.
HOBBS NM, 88240
Fax To: (575) 393-2432

Received: 12/04/2014
Reported: 12/05/2014
Project Name: WBDU #42
Project Number: NONE GIVEN
Project Location: NOT GIVEN

Sampling Date: 12/04/2014
Sampling Type: Soil
Sampling Condition: Cool & Intact
Sample Received By: Jodi Henson

Sample ID: POINT 10 @ 6" (H403695-09)

Chloride, SM4500Cl-B		mg/kg		Analyzed By: AP					
Analyte	Result	Reporting Limit	Analyzed	Method Blank	BS	% Recovery	True Value QC	RPD	Qualifier
Chloride	<16.0	16.0	12/05/2014	ND	400	100	400	3.92	
TPH 8015M		mg/kg		Analyzed By: CK					
Analyte	Result	Reporting Limit	Analyzed	Method Blank	BS	% Recovery	True Value QC	RPD	Qualifier
GRO C6-C10	<10.0	10.0	12/05/2014	ND	201	101	200	0.950	
DRO >C10-C28	<10.0	10.0	12/05/2014	ND	209	105	200	2.49	
Surrogate: 1-Chlorooctane		124 %	47.2-157						
Surrogate: 1-Chlorooctadecane		138 %	52.1-176						

Sample ID: POINT 11 @ 6" (H403695-10)

Chloride, SM4500Cl-B		mg/kg		Analyzed By: AP					
Analyte	Result	Reporting Limit	Analyzed	Method Blank	BS	% Recovery	True Value QC	RPD	Qualifier
Chloride	<16.0	16.0	12/05/2014	ND	400	100	400	3.92	
TPH 8015M		mg/kg		Analyzed By: CK					
Analyte	Result	Reporting Limit	Analyzed	Method Blank	BS	% Recovery	True Value QC	RPD	Qualifier
GRO C6-C10	<10.0	10.0	12/05/2014	ND	201	101	200	0.950	
DRO >C10-C28	<10.0	10.0	12/05/2014	ND	209	105	200	2.49	
Surrogate: 1-Chlorooctane		122 %	47.2-157						
Surrogate: 1-Chlorooctadecane		137 %	52.1-176						

Cardinal Laboratories

*=Accredited Analyte

PLEASE NOTE: Liability and Damages. Cardinal's liability and client's exclusive remedy for any claim arising, whether based in contract or tort, shall be limited to the amount paid by client for analyses. All claims, including those for negligence and any other cause whatsoever shall be deemed waived unless made in writing and received by Cardinal within thirty (30) days after completion of the applicable service. In no event shall Cardinal be liable for incidental or consequential damages, including, without limitation, business interruptions, loss of use, or loss of profits incurred by client, its subsidiaries, affiliates or successors arising out of or related to the performance of the services hereunder by Cardinal, regardless of whether such claim is based upon any of the above stated reasons or otherwise. Results relate only to the samples identified above. This report shall not be reproduced except in full with written approval of Cardinal Laboratories.



Celey D. Keene, Lab Director/Quality Manager

Notes and Definitions

ND	Analyte NOT DETECTED at or above the reporting limit
RPD	Relative Percent Difference
**	Samples not received at proper temperature of 6°C or below.
***	Insufficient time to reach temperature.
-	Chloride by SM4500Cl-B does not require samples be received at or below 6°C Samples reported on an as received basis (wet) unless otherwise noted on report

Cardinal Laboratories

*=Accredited Analyte

PLEASE NOTE: Liability and Damages. Cardinal's liability and client's exclusive remedy for any claim arising, whether based in contract or tort, shall be limited to the amount paid by client for analyses. All claims, including those for negligence and any other cause whatsoever shall be deemed waived unless made in writing and received by Cardinal within thirty (30) days after completion of the applicable service. In no event shall Cardinal be liable for incidental or consequential damages, including, without limitation, business interruptions, loss of use, or loss of profits incurred by client, its subsidiaries, affiliates or successors arising out of or related to the performance of the services hereunder by Cardinal, regardless of whether such claim is based upon any of the above stated reasons or otherwise. Results relate only to the samples identified above. This report shall not be reproduced except in full with written approval of Cardinal Laboratories.



Celey D. Keene, Lab Director/Quality Manager

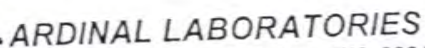

101 East Marland, Hobbs, NM 88240 2111 Beechwood, Abilene, TX 79603
(505) 393-2326 FAX (505) 393-2476 (325) 673-7001 FAX (325) 673-7020

Page 8 of 8

[illegible]

PLEASE NOTE: Liability and Damages. Cardinal's liability and client's exclusive remedy for any claim arising whether based in contract or tort, shall be limited to the amount paid by the client for the analyses. All claims including those for negligence and any other cause whatsoever shall be deemed waived unless made in writing and received by Cardinal within 30 days after completion of the applicable service. In no event shall Cardinal be liable for incidental or consequential damages, including without limitation, business interruptions, loss of use, or loss of profits incurred by client, its subsidiaries, affiliates or successors arising out of or related to the performance of services hereunder by Cardinal, regardless of whether such claim is based upon any of the above stated reasons or otherwise.

Relinquished By: <i>Kare Hany</i>		Date: <i>12/4/14</i>	Received By: <i>Jodi Henson</i>	Phone Result: <input type="checkbox"/> Yes <input checked="" type="checkbox"/> No	Add'l Phone #:
Relinquished By:		Time: <i>1:20</i>	Received By:	Fax Result: <input type="checkbox"/> Yes <input checked="" type="checkbox"/> No	Add'l Fax #:
Delivered By: (Circle One)		Date:	Sample Condition	REMARKS:	
Sampler - UPS - Bus - Other:		Time:	Cool <input checked="" type="checkbox"/> Intact <input checked="" type="checkbox"/>	email results	
			<input checked="" type="checkbox"/> Yes <input checked="" type="checkbox"/> Yes	Knorman@rice-ecs.com	
			<input type="checkbox"/> No <input type="checkbox"/> No	Kjones@riceswd.com; jkamplain@rice-ecs.com hconder@rice-ecs.com;	
				Lweinheimer@rice-ecs.com	
				Khumphrey@rice-ecs.com	
				sedwards@rice-ecs.com, lflores@rice-ecs.com	

† Cardinal cannot accept verbal changes. Please fax written changes to 505-396-2476

#54



PHONE (575) 393-2326 ° 101 E. MARLAND ° HOBBS, NM 88240

December 05, 2014

BRUCE BAKER

APACHE CORP - HOBBS

2350 W. MARLAND BLVD.

HOBBS, NM 88240

RE: WBDU #42

Enclosed are the results of analyses for samples received by the laboratory on 12/04/14 13:20.

Cardinal Laboratories is accredited through Texas NELAP under certificate number T104704398-13-5. Accreditation applies to drinking water, non-potable water and solid and chemical materials. All accredited analytes are denoted by an asterisk (*). For a complete list of accredited analytes and matrices visit the TCEQ website at www.tceq.texas.gov/field/qa/lab_accred_certif.html.

Cardinal Laboratories is accredited through the State of Colorado Department of Public Health and Environment for:

Method EPA 552.2	Haloacetic Acids (HAA-5)
Method EPA 524.2	Total Trihalomethanes (TTHM)
Method EPA 524.4	Regulated VOCs (V1, V2, V3)

Accreditation applies to public drinking water matrices.

This report meets NELAP requirements and is made up of a cover page, analytical results, and a copy of the original chain-of-custody. If you have any questions concerning this report, please feel free to contact me.

Sincerely,

A handwritten signature in black ink that reads "Celey D. Keene". The signature is written in a cursive, flowing style.

Celey D. Keene

Lab Director/Quality Manager

Analytical Results For:

 APACHE CORP - HOBBS
 BRUCE BAKER
 2350 W. MARLAND BLVD.
 HOBBS NM, 88240
 Fax To: (575) 393-2432

 Received: 12/04/2014
 Reported: 12/05/2014
 Project Name: WBDU #42
 Project Number: NONE GIVEN
 Project Location: NOT GIVEN

 Sampling Date: 12/03/2014
 Sampling Type: Soil
 Sampling Condition: Cool & Intact
 Sample Received By: Jodi Henson

Sample ID: BOTTOM 1 (H403696-01)

Chloride, SM4500Cl-B		mg/kg		Analyzed By: AP					
Analyte	Result	Reporting Limit	Analyzed	Method Blank	BS	% Recovery	True Value QC	RPD	Qualifier
Chloride	176	16.0	12/05/2014	ND	400	100	400	3.92	
TPH 8015M		mg/kg		Analyzed By: CK					
Analyte	Result	Reporting Limit	Analyzed	Method Blank	BS	% Recovery	True Value QC	RPD	Qualifier
GRO C6-C10	<10.0	10.0	12/05/2014	ND	201	101	200	0.950	
DRO >C10-C28	<10.0	10.0	12/05/2014	ND	209	105	200	2.49	
Surrogate: 1-Chlorooctane	133 %	47.2-157							
Surrogate: 1-Chlorooctadecane	152 %	52.1-176							

Sample ID: BOTTOM 2 (H403696-02)

Chloride, SM4500Cl-B		mg/kg		Analyzed By: AP					
Analyte	Result	Reporting Limit	Analyzed	Method Blank	BS	% Recovery	True Value QC	RPD	Qualifier
Chloride	144	16.0	12/05/2014	ND	400	100	400	3.92	
TPH 8015M		mg/kg		Analyzed By: CK					
Analyte	Result	Reporting Limit	Analyzed	Method Blank	BS	% Recovery	True Value QC	RPD	Qualifier
GRO C6-C10	<10.0	10.0	12/05/2014	ND	201	101	200	0.950	
DRO >C10-C28	<10.0	10.0	12/05/2014	ND	209	105	200	2.49	
Surrogate: 1-Chlorooctane	129 %	47.2-157							
Surrogate: 1-Chlorooctadecane	145 %	52.1-176							

Cardinal Laboratories

*=Accredited Analyte

PLEASE NOTE: Liability and Damages. Cardinal's liability and client's exclusive remedy for any claim arising, whether based in contract or tort, shall be limited to the amount paid by client for analyses. All claims, including those for negligence and any other cause whatsoever shall be deemed waived unless made in writing and received by Cardinal within thirty (30) days after completion of the applicable service. In no event shall Cardinal be liable for incidental or consequential damages, including, without limitation, business interruptions, loss of use, or loss of profits incurred by client, its subsidiaries, affiliates or successors arising out of or related to the performance of the services hereunder by Cardinal, regardless of whether such claim is based upon any of the above stated reasons or otherwise. Results relate only to the samples identified above. This report shall not be reproduced except in full with written approval of Cardinal Laboratories.



Celey D. Keene, Lab Director/Quality Manager

Analytical Results For:

APACHE CORP - HOBBS
BRUCE BAKER
2350 W. MARLAND BLVD.
HOBBS NM, 88240
Fax To: (575) 393-2432

Received: 12/04/2014
Reported: 12/05/2014
Project Name: WBDU #42
Project Number: NONE GIVEN
Project Location: NOT GIVEN

Sampling Date: 12/03/2014
Sampling Type: Soil
Sampling Condition: Cool & Intact
Sample Received By: Jodi Henson

Sample ID: BOTTOM 3 (H403696-03)

Chloride, SM4500Cl-B		mg/kg		Analyzed By: AP					
Analyte	Result	Reporting Limit	Analyzed	Method Blank	BS	% Recovery	True Value QC	RPD	Qualifier
Chloride	128	16.0	12/05/2014	ND	400	100	400	3.92	
TPH 8015M		mg/kg		Analyzed By: CK					
Analyte	Result	Reporting Limit	Analyzed	Method Blank	BS	% Recovery	True Value QC	RPD	Qualifier
GRO C6-C10	<10.0	10.0	12/05/2014	ND	201	101	200	0.950	
DRO >C10-C28	<10.0	10.0	12/05/2014	ND	209	105	200	2.49	
Surrogate: 1-Chlorooctane	126 %	47.2-157							
Surrogate: 1-Chlorooctadecane	140 %	52.1-176							

Sample ID: NORTH WALL 1 (H403696-04)

Chloride, SM4500Cl-B		mg/kg		Analyzed By: AP					
Analyte	Result	Reporting Limit	Analyzed	Method Blank	BS	% Recovery	True Value QC	RPD	Qualifier
Chloride	<16.0	16.0	12/05/2014	ND	400	100	400	3.92	
TPH 8015M		mg/kg		Analyzed By: CK					
Analyte	Result	Reporting Limit	Analyzed	Method Blank	BS	% Recovery	True Value QC	RPD	Qualifier
GRO C6-C10	<10.0	10.0	12/05/2014	ND	201	101	200	0.950	
DRO >C10-C28	<10.0	10.0	12/05/2014	ND	209	105	200	2.49	
Surrogate: 1-Chlorooctane	126 %	47.2-157							
Surrogate: 1-Chlorooctadecane	144 %	52.1-176							

Cardinal Laboratories

*=Accredited Analyte

PLEASE NOTE: Liability and Damages. Cardinal's liability and client's exclusive remedy for any claim arising, whether based in contract or tort, shall be limited to the amount paid by client for analyses. All claims, including those for negligence and any other cause whatsoever shall be deemed waived unless made in writing and received by Cardinal within thirty (30) days after completion of the applicable service. In no event shall Cardinal be liable for incidental or consequential damages, including, without limitation, business interruptions, loss of use, or loss of profits incurred by client, its subsidiaries, affiliates or successors arising out of or related to the performance of the services hereunder by Cardinal, regardless of whether such claim is based upon any of the above stated reasons or otherwise. Results relate only to the samples identified above. This report shall not be reproduced except in full with written approval of Cardinal Laboratories.



Celey D. Keene, Lab Director/Quality Manager

Analytical Results For:

APACHE CORP - HOBBS
BRUCE BAKER
2350 W. MARLAND BLVD.
HOBBS NM, 88240
Fax To: (575) 393-2432

Received: 12/04/2014
Reported: 12/05/2014
Project Name: WBDU #42
Project Number: NONE GIVEN
Project Location: NOT GIVEN

Sampling Date: 12/03/2014
Sampling Type: Soil
Sampling Condition: Cool & Intact
Sample Received By: Jodi Henson

Sample ID: SOUTH WALL 1 (H403696-05)

Chloride, SM4500Cl-B		mg/kg		Analyzed By: AP					
Analyte	Result	Reporting Limit	Analyzed	Method Blank	BS	% Recovery	True Value QC	RPD	Qualifier
Chloride	<16.0	16.0	12/05/2014	ND	400	100	400	3.92	
TPH 8015M		mg/kg		Analyzed By: CK					
Analyte	Result	Reporting Limit	Analyzed	Method Blank	BS	% Recovery	True Value QC	RPD	Qualifier
GRO C6-C10	<10.0	10.0	12/05/2014	ND	201	101	200	0.950	
DRO >C10-C28	<10.0	10.0	12/05/2014	ND	209	105	200	2.49	
Surrogate: 1-Chlorooctane	126 %	47.2-157							
Surrogate: 1-Chlorooctadecane	142 %	52.1-176							

Sample ID: EAST WALL 2 (H403696-06)

Chloride, SM4500Cl-B		mg/kg		Analyzed By: AP					
Analyte	Result	Reporting Limit	Analyzed	Method Blank	BS	% Recovery	True Value QC	RPD	Qualifier
Chloride	112	16.0	12/05/2014	ND	400	100	400	3.92	
TPH 8015M		mg/kg		Analyzed By: CK					
Analyte	Result	Reporting Limit	Analyzed	Method Blank	BS	% Recovery	True Value QC	RPD	Qualifier
GRO C6-C10	<10.0	10.0	12/05/2014	ND	201	101	200	0.950	
DRO >C10-C28	<10.0	10.0	12/05/2014	ND	209	105	200	2.49	
Surrogate: 1-Chlorooctane	123 %	47.2-157							
Surrogate: 1-Chlorooctadecane	136 %	52.1-176							

Cardinal Laboratories

*=Accredited Analyte

PLEASE NOTE: Liability and Damages. Cardinal's liability and client's exclusive remedy for any claim arising, whether based in contract or tort, shall be limited to the amount paid by client for analyses. All claims, including those for negligence and any other cause whatsoever shall be deemed waived unless made in writing and received by Cardinal within thirty (30) days after completion of the applicable service. In no event shall Cardinal be liable for incidental or consequential damages, including, without limitation, business interruptions, loss of use, or loss of profits incurred by client, its subsidiaries, affiliates or successors arising out of or related to the performance of the services hereunder by Cardinal, regardless of whether such claim is based upon any of the above stated reasons or otherwise. Results relate only to the samples identified above. This report shall not be reproduced except in full with written approval of Cardinal Laboratories.



Celey D. Keene, Lab Director/Quality Manager

Analytical Results For:

APACHE CORP - HOBBS
BRUCE BAKER
2350 W. MARLAND BLVD.
HOBBS NM, 88240
Fax To: (575) 393-2432

Received: 12/04/2014
Reported: 12/05/2014
Project Name: WBDU #42
Project Number: NONE GIVEN
Project Location: NOT GIVEN

Sampling Date: 12/03/2014
Sampling Type: Soil
Sampling Condition: Cool & Intact
Sample Received By: Jodi Henson

Sample ID: WEST WALL 2 (H403696-07)

Chloride, SM4500Cl-B		mg/kg		Analyzed By: AP					
Analyte	Result	Reporting Limit	Analyzed	Method Blank	BS	% Recovery	True Value QC	RPD	Qualifier
Chloride	64.0	16.0	12/05/2014	ND	400	100	400	3.92	
TPH 8015M		mg/kg		Analyzed By: CK					
Analyte	Result	Reporting Limit	Analyzed	Method Blank	BS	% Recovery	True Value QC	RPD	Qualifier
GRO C6-C10	<10.0	10.0	12/05/2014	ND	201	101	200	0.950	
DRO >C10-C28	<10.0	10.0	12/05/2014	ND	209	105	200	2.49	
Surrogate: 1-Chlorooctane	134 %	47.2-157							
Surrogate: 1-Chlorooctadecane	152 %	52.1-176							

Cardinal Laboratories

*=Accredited Analyte

PLEASE NOTE: Liability and Damages. Cardinal's liability and client's exclusive remedy for any claim arising, whether based in contract or tort, shall be limited to the amount paid by client for analyses. All claims, including those for negligence and any other cause whatsoever shall be deemed waived unless made in writing and received by Cardinal within thirty (30) days after completion of the applicable service. In no event shall Cardinal be liable for incidental or consequential damages, including, without limitation, business interruptions, loss of use, or loss of profits incurred by client, its subsidiaries, affiliates or successors arising out of or related to the performance of the services hereunder by Cardinal, regardless of whether such claim is based upon any of the above stated reasons or otherwise. Results relate only to the samples identified above. This report shall not be reproduced except in full with written approval of Cardinal Laboratories.



Celey D. Keene, Lab Director/Quality Manager

Notes and Definitions

ND	Analyte NOT DETECTED at or above the reporting limit
RPD	Relative Percent Difference
**	Samples not received at proper temperature of 6°C or below.
***	Insufficient time to reach temperature.
-	Chloride by SM4500Cl-B does not require samples be received at or below 6°C Samples reported on an as received basis (wet) unless otherwise noted on report

Cardinal Laboratories

*=Accredited Analyte

PLEASE NOTE: Liability and Damages. Cardinal's liability and client's exclusive remedy for any claim arising, whether based in contract or tort, shall be limited to the amount paid by client for analyses. All claims, including those for negligence and any other cause whatsoever shall be deemed waived unless made in writing and received by Cardinal within thirty (30) days after completion of the applicable service. In no event shall Cardinal be liable for incidental or consequential damages, including, without limitation, business interruptions, loss of use, or loss of profits incurred by client, its subsidiaries, affiliates or successors arising out of or related to the performance of the services hereunder by Cardinal, regardless of whether such claim is based upon any of the above stated reasons or otherwise. Results relate only to the samples identified above. This report shall not be reproduced except in full with written approval of Cardinal Laboratories.



Celey D. Keene, Lab Director/Quality Manager

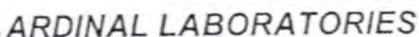

CHAIN-OF-CUSTODY AND ANALYSIS REQUEST

Page 7 of 7

PLEASE NOTE: Liability and Damages: Cardinal's policy and client's exclusive remedy for any claim arising whether based in contract or tort, shall be limited to the amount paid by the client for the analyses. All claims, including those for negligence and any other cause whatsoever shall be deemed waived unless in writing and received by Cardinal within 30 days after completion of the applicable service. In no event shall Cardinal be liable for incidental or consequential damages, including without limitation, business interruptions, loss of use, or loss of profits incurred by client, its subsidiaries, or affiliates. Cardinal's liability shall be limited to the performance of services hereunder by Cardinal, regardless of whether such claim is based upon any of the above stated reasons or otherwise.

Relinquished By: <i>Kyle Henson</i>		Date: <i>7/4/14</i>		Received By: <i>Jodi Henson</i>		Phone Result: <input type="checkbox"/> Yes <input checked="" type="checkbox"/> No		Add'l Phone #:	
		Time: <i>7:20</i>				Fax Result: <input type="checkbox"/> Yes <input checked="" type="checkbox"/> No		Add'l Fax #:	
Relinquished By:		Date:		Received By:		REMARKS: email results Knorman@rice-ecs.com Kjones@riceswd.com; jkamplain@rice-ecs.com hconder@rice-ecs.com; Lweinheimer@rice-ecs.com Khumphrey@rice-ecs.com sedwards@rice-ecs.com, lflores@rice-ecs.com			
		Time:							
Delivered By: (Circle One)				Sample Condition		CHECKED BY:			
Sampler - UPS - Bus - Other:				Cool <input checked="" type="checkbox"/> Intact <input checked="" type="checkbox"/> Yes <input checked="" type="checkbox"/> No <input checked="" type="checkbox"/>		(Initials) <i>CH</i>			

† Cardinal cannot accept verbal changes. Please fax written changes to 505-393-2476

#54

Appendix C

Photo Documentation

RICE Environmental Consulting and Safety (RECS)
P.O. Box 2948 Hobbs, NM 88241
Phone 575.393.2967

Apache WBDU #42

Unit Letter I, Section 9, T21S, R37E



Initial site photo, facing north

11/12/14



Initial site photo, facing northwest

11/12/14



Initial site photo, facing east

11/12/14



Initial site photo, facing east

11/12/14



Installing trench, facing west

11/12/14



Scraping release, facing northeast

11/12/14



Exporting soil, facing north

11/13/14



Continue to scrape site, facing west

11/14/14



Excavating pasture, facing southwest 12/2/14



Excavating, facing southwest 12/4/14



Excavation completed, facing east 12/4/14



Excavating pasture, facing south 12/4/14



Site completed, facing north

3/4/15



Site completed, facing northeast

3/4/15



Site completed, facing southwest

3/4/15



Site completed, facing north

3/4/15

Appendix D

Final C-141

RICE Environmental Consulting and Safety (RECS)
P.O. Box 2948 Hobbs, NM 88241
Phone 575.393.2967

District I
1625 N. French Dr., Hobbs, NM 88240
District II
811 S. First St., Artesia, NM 88210
District III
1000 Rio Brazos Road, Aztec, NM 87410
District IV
1220 S. St. Francis Dr., Santa Fe, NM 87505

State of New Mexico
Energy Minerals and Natural Resources

Oil Conservation Division
1220 South St. Francis Dr.
Santa Fe, NM 87505

Form C-141
Revised August 8, 2011

Submit 1 Copy to appropriate District Office in
accordance with 19.15.29 NMAC.

Release Notification and Corrective Action

OPERATOR

☐ Initial Report ☒ Final Report

Name of Company	Apache Corporation	Contact	Bruce Baker
Address	2350 Marland Blvd., Hobbs, NM 88240	Telephone No.	(432) 631-6982
Facility Name	WBDU #42	Facility Type	Injection Well

Surface Owner	Millard Deck Estates	Mineral Owner	BLM	API No.	30-025-20178
---------------	----------------------	---------------	-----	---------	--------------

LOCATION OF RELEASE

Unit Letter	Section	Township	Range	Feet from the	North/South Line	Feet from the	East/West Line	County
I	9	21S	37E	198	FSL	660	FEL	Lea

Latitude _____ Longitude _____

NATURE OF RELEASE

Type of Release	Produced Water	Volume of Release	15 Barrels of water	Volume Recovered	5 Barrels of water
Source of Release	injection line	Date and Hour of Occurrence	11/11/14	Date and Hour of Discovery	11/11/14
Was Immediate Notice Given?	<input checked="" type="checkbox"/> Yes <input type="checkbox"/> No <input type="checkbox"/> Not Required	If YES, To Whom?	Jeffery Robertson (BLM)		
By Whom?	Bruce Baker	Date and Hour	11/12/2014		
Was a Watercourse Reached?	<input type="checkbox"/> Yes <input checked="" type="checkbox"/> No	If YES, Volume Impacting the Watercourse.			

If a Watercourse was Impacted, Describe Fully.*

Describe Cause of Problem and Remedial Action Taken.*

The release occurred due to a hole in 2 inch 90 degree fitting on the well head. The line was shut in and a vacuum truck was dispatched to pick up standing fluid.

Describe Area Affected and Cleanup Action Taken.*

RECS personnel were on site beginning November 12th, 2014 to assess the release. Based on the assessment, the release was scraped, and samples were taken from the bottom and walls of the scrape. The samples were field tested for chlorides and organic vapors. If field testing indicated that the samples would return chloride, GRO and DRO readings below regulatory standards, the samples were taken to a commercial laboratory for analyses. If field testing did not show that all constituents would be below regulatory standards, the scrape was expanded until field testing shows that all constituents would be below regulatory standards. Using these standards, the site was excavated in four portions. The lease pad was scraped down to 6 inches bgs. Various portions of the pasture area were scraped down to 1 ft bgs, 1.5 ft bgs and 2 ft bgs. A request to backfill the site was sent to NMOCD on January 9th, 2015. NMOCD approved the backfill request on January 12th, 2015. All excavated soil was taken to a NMOCD approved facility for disposal. Clean caliche was imported to the site to backfill the lease pad, and clean top soil was imported to the site to backfill the pasture area. The lease pad and pasture areas were backfilled and contoured to the surrounding location.

I hereby certify that the information given above is true and complete to the best of my knowledge and understand that pursuant to NMOCD rules and regulations all operators are required to report and/or file certain release notifications and perform corrective actions for releases which may endanger public health or the environment. The acceptance of a C-141 report by the NMOCD marked as "Final Report" does not relieve the operator of liability should their operations have failed to adequately investigate and remediate contamination that pose a threat to ground water, surface water, human health or the environment. In addition, NMOCD acceptance of a C-141 report does not relieve the operator of responsibility for compliance with any other federal, state, or local laws and/or regulations.

Signature: <i>Bruce Baker</i>		OIL CONSERVATION DIVISION	
Printed Name: Bruce Baker		Approved by Environmental Specialist:	
Title: Environmental Technician		Approval Date:	Expiration Date:
E-mail Address: larry.baker@apachecorp.com		Conditions of Approval:	
Date: 3-11-15		Attached <input type="checkbox"/>	
Phone: (432) 631-6982			