

RECEIVED

By OCD; Dr. Oberding at 10:23 am, Mar 31, 2015

**Sharp Oilfield Services
Waste Oil Cleanup
Closure Report
Section 4, T23S, R37E
Lea County, New Mexico
RP-3483**

March 26, 2015

APPROVED

By OCD; Dr. Oberding at 10:24 am, Mar 31, 2015



Prepared for:

**Sharp Oilfield Services
211 West Main
Gainesville, Texas 76241**

By:

***Safety & Environmental Solutions, Inc.
703 East Clinton Street
Hobbs, New Mexico 88240
(575) 397-0510***

TABLE OF CONTENTS

I. COMPANY CONTACTS.....	1
II. BACKGROUND.....	1
III. SURFACE AND GROUND WATER.....	1
IV. CHARACTERIZATION.....	1
V. WORK PERFORMED.....	1
VI. ACTION PLAN.....	2
VII. FIGURES & APPENDICES	3
Figure 1 – Vicinity Map.....	4
Figure 2 – Site Plan	5
Appendix A – Analytical Results	9
Appendix B – C-141	29

I. Company Contacts

Representative	Company	Telephone	E-mail
Taylor Allbritton	Sharp Oilfield Services	940-312-3858	tallbritton@sharpoilfieldservices.com
Bob Allen	SESI	575-397-0510	ballen@sesi-nm.com

II. Background

Safety and Environmental Solutions, Inc. (SESI) was engaged by Sharp Oilfield Services to perform site assessment of a release area located in Section 4 of Township 23 South, Range 37 East, Lea County, New Mexico.

According to the C-141 the cause of release was truck turnover.

III. Surface and Ground Water

The nearest groundwater of record is approximately 1.0 mile south of the site. The New Mexico Office of State Engineer record is in Section 9 Range 37 East and Township 23 South. The reported depth was 100 feet below ground surface (BGS).

IV. Characterization

The target cleanup levels are determined using the *Guidelines for Remediation of Leaks, Spills and Releases* published by the NMOCD (August 13, 1993). Based on the ranking criteria presented below, the applicable Recommended Remediation Action Levels (RRAL) are 10 parts per million (ppm) Benzene, 50 ppm combined benzene, toluene, ethylbenzene, and total xylenes (BTEX), and 5,000 ppm Total Petroleum Hydrocarbons (TPH).

Depth to Ground Water:			
(Vertical distance from contaminants to seasonal high water elevation of groundwater)	Less than 50 feet	20 points	
	50 feet to 99 feet	10 points	
	>100 feet	0 points	X
Wellhead Protection Area:			
(Less than 200 feet from a private domestic water source; or less than 1000 feet from all other water sources)	Yes	20 points	
	No	0 points	X
Distance to Surface Water:			
(Horizontal distance to perennial lakes, ponds, rivers, streams, creeks, irrigation canals and ditches)	Less than 200 feet	20 points	
	200 feet to 1000 feet	10 points	
	>1000 feet	0 points	X
RANKING SCORE (TOTAL POINTS)			0

V. Work Performed

On December 29, 2014, Safety & Environmental Solutions, Inc. was onsite to determine vertical extent of impact. Samples AH-1 and AH-2 was taken at a depth of 1.5', Sample AH-3 was taken at a depth of 2' and sample AH-4 was taken at a depth of 1'. All samples were properly packaged, preserved and transported to a commercial Laboratory, Hobbs New Mexico and analyzed for Benzene, Toluene, Ethylbenzene,

Xylenes, Total BTEX and Chloride (Cl⁻) (Method SM4500Cl-B). The results of the analysis are presented in the table below:

Sample Date 12/29/2014	Sample ID	Benzene (mg/kg)	Toluene (mg/kg)	Ethylbenzene (mg/kg)	Xylenes (mg/kg)	Total BTEX
Depth	Method					
AH-1 at 1.5'	BTEX 8021B	<0.050	<0.050	<0.050	<0.150	<0.300
AH-2 at 1.5'	BTEX 8021B	<0.050	<0.050	<0.050	<0.150	<0.300
AH-3 at 2'	BTEX 8021B	<0.050	<0.050	<0.050	<0.150	<0.300
AH-4 at 1'	BTEX 8021B	<0.050	<0.050	<0.050	<0.150	<0.300

Sample Date 05/03/2014	Sample ID	GRO (C ₆ -C ₁₀) (mg/kg)	DRO (>C ₁₀ -C ₂₈) (mg/kg)	EXT DRO (>C ₂₈ -C ₃₅) (mg/kg)
Depth	Method			
AH-1 at 1.5'	TPH 8015M	<10.0	<10.0	<10.0
AH-2 at 1.5'	TPH 8015M	<10.0	380	120
AH-3 at 2'	TPH 8015M	<10.0	52	<10.0
AH-4 at 1'	TPH 8015M	<10.0	<10.0	<10.0

Sample Date 02/25/2015	Sample ID	Sample ID Total BTEX	Sample ID	GRO (C ₆ -C ₁₀) (mg/kg)	DRO (>C ₁₀ -C ₂₈) (mg/kg)
Depth	Method		Method		
SP-1 Bottom	BTEX 8021B	<0.300	TPH 8015M	<10.0	<10.0
SP-2 Bottom	BTEX 8021B	<0.300	TPH 8015M	<10.0	<10.0
SP-3 Bottom	BTEX 8021B	<0.300	TPH 8015M	<10.0	<10.0
SP-4 Bottom	BTEX 8021B	<0.300	TPH 8015M	<10.0	<10.0
SP-5 West Wall	BTEX 8021B	<0.300	TPH 8015M	<10.0	<10.0
SP-6 West Wall	BTEX 8021B	<0.300	TPH 8015M	<10.0	<10.0
SP-7 East Wall	BTEX 8021B	<0.300	TPH 8015M	<10.0	<10.0
SP-8 East Wall	BTEX 8021B	<0.300	TPH 8015M	<10.0	<10.00

VI. Closure

The entire impacted area was excavated to a depth of 2' bgs. And all contaminated soil was removed and transported to the Gandy Marley, an NMOCD approved facility. On February 25, 2015 Safety and Environmental Solutions, Inc. personnel were on site following remediation activities to retrieve representative soil samples of the bottom excavation floor, as well as vertical side wall samples. These were sent to a commercial laboratory in Hobbs, NM for analyses. The results returned were within NMOCD guidelines; therefore the excavation was backfilled and returned to grade. No further remediation is required.

Safety and Environmental Solutions, Inc. respectfully requests closure of the regulatory file for this site.

VII. Figures & Appendices

Figure 1 – Vicinity Map
Figure 2 – Site Plan
Figure 3 – NMOCD Trend Map
Appendix A – Analytical Results
Appendix B – C-141

Figure 1
Vicinity Map

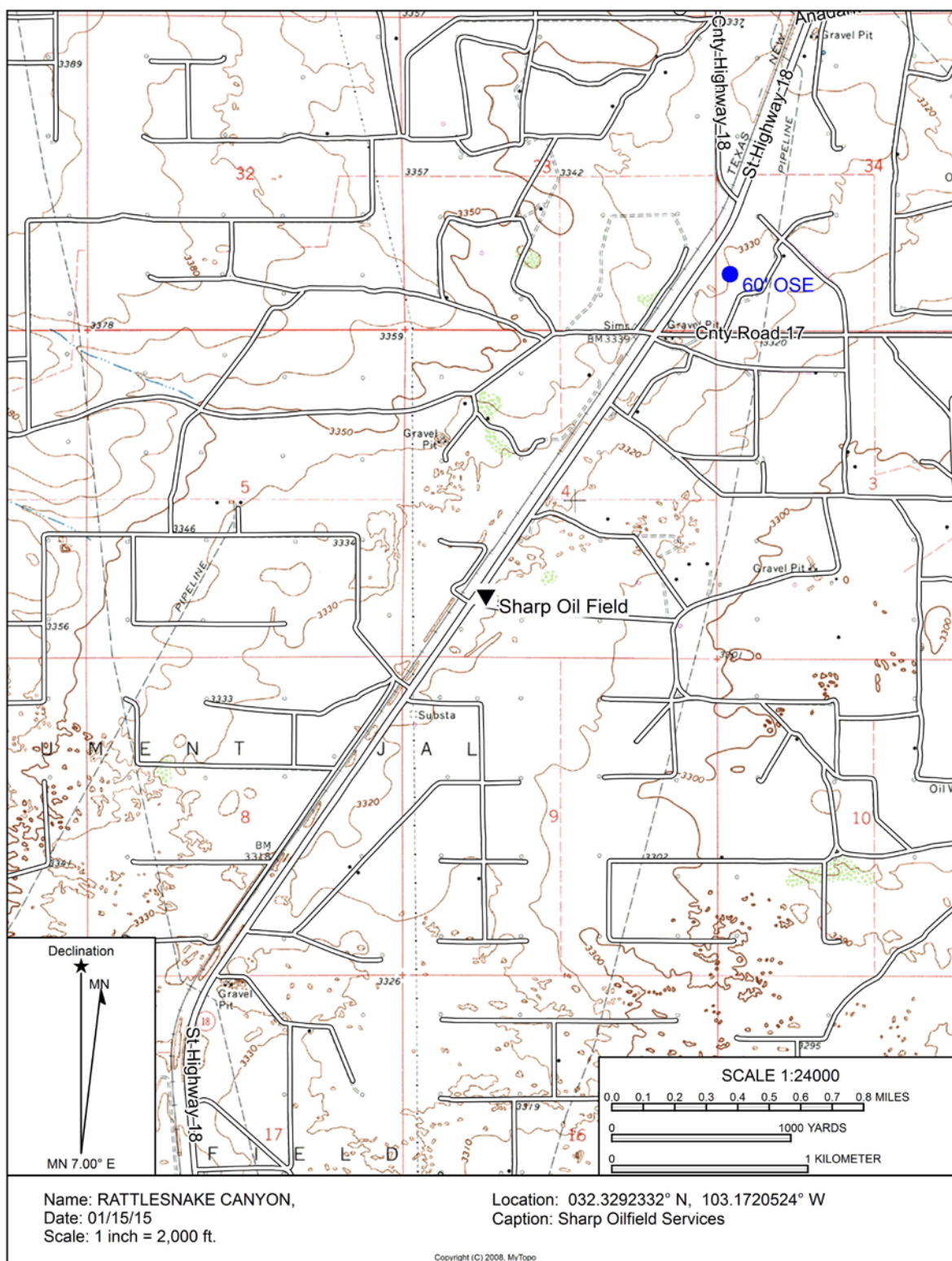

Figure 2
Site Plan



Sharp Oilfield Services

Appendix A

Analytical Results



PHONE (575) 393-2326 • 101 E. MARLAND • HOBBS, NM 88240

January 05, 2015

Bob Allen
Safety & Environmental Solutions
703 East Clinton
Hobbs, NM 88240

RE: SHARP WASTE OIL CLEAN-UP

Enclosed are the results of analyses for samples received by the laboratory on 12/29/14 14:30.

Cardinal Laboratories is accredited through Texas NELAP under certificate number T104704398-13-5. Accreditation applies to drinking water, non-potable water and solid and chemical materials. All accredited analytes are denoted by an asterisk (*). For a complete list of accredited analytes and matrices visit the TCEQ website at www.tceq.texas.gov/field/ga/lab_accred_certif.html.

Cardinal Laboratories is accredited through the State of Colorado Department of Public Health and Environment for:

Method EPA 552.2	Haloacetic Acids (HAA-5)
Method EPA 524.2	Total Trihalomethanes (TTHM)
Method EPA 524.4	Regulated VOCs (V1, V2, V3)

Accreditation applies to public drinking water matrices.

This report meets NELAP requirements and is made up of a cover page, analytical results, and a copy of the original chain-of-custody. If you have any questions concerning this report, please feel free to contact me.

Sincerely,

A handwritten signature in black ink that reads "Celey D. Keene".

Celey D. Keene
Lab Director/Quality Manager



PHONE (575) 393-2326 • 101 E. MARLAND • HOBBS, NM 88240

Analytical Results For:

Safety & Environmental Solutions
Bob Allen
703 East Clinton
Hobbs NM, 88240
Fax To: (575) 393-4388

Received:	12/29/2014	Sampling Date:	12/29/2014
Reported:	01/05/2015	Sampling Type:	Soil
Project Name:	SHARP WASTE OIL CLEAN-UP	Sampling Condition:	Cool & Intact
Project Number:	SHA-14-001	Sample Received By:	Jodi Henson
Project Location:	LEA COUNTY, NM		

Sample ID: AH-1 1.5' BGS (H403935-01)

BTEX 80218		mg/kg		Analyzed By: MS						
Analyte	Result	Reporting Limit	Analyzed	Method Blank	BS	% Recovery	True Value QC	RPD	Qualifier	
Benzene*	<0.050	0.050	12/30/2014	ND	1.83	91.3	2.00	6.81		
Toluene*	<0.050	0.050	12/30/2014	ND	1.83	91.5	2.00	5.49		
Ethylbenzene*	<0.050	0.050	12/30/2014	ND	1.75	87.3	2.00	4.81		
Total Xylenes*	<0.150	0.150	12/30/2014	ND	5.27	87.9	6.00	5.31		
Total BTEX	<0.300	0.300	12/30/2014	ND						

Surrogate: 4-Bromofluorobenzene (PID) 97.2 % 66.2-142

TPH 8015M		mg/kg		Analyzed By: MS						
Analyte	Result	Reporting Limit	Analyzed	Method Blank	BS	% Recovery	True Value QC	RPD	Qualifier	
GRO C6-C10	<10.0	10.0	12/30/2014	ND	180	90.0	200	2.63		
DRO >C10-C28	<10.0	10.0	12/30/2014	ND	186	93.0	200	9.74		
EXT DRO >C28-C35	<10.0	10.0	12/30/2014	ND						

Surrogate: 1-Chlorooctane 89.8 % 47.2-157

Surrogate: 1-Chlorooctadecane 85.8 % 52.1-176

Cardinal Laboratories

*=Accredited Analyte

PLEASE NOTE: Liability and Damages. Cardinal's liability and client's exclusive remedy for any claim arising, whether based in contract or tort, shall be limited to the amount paid by client for analyses. All claims, including those for negligence and any other cause whatsoever shall be deemed waived unless made in writing and received by Cardinal within thirty (30) days after completion of the applicable service. In no event shall Cardinal be liable for incidental or consequential damages, including, without limitation, business interruptions, loss of use, or loss of profits incurred by client, its subsidiaries, affiliates or successors arising out of or related to the performance of the services hereunder by Cardinal, regardless of whether such claim is based upon any of the above stated reasons or otherwise. Results relate only to the samples identified above. This report shall not be reproduced except in full with written approval of Cardinal Laboratories.

Celey D. Keene, Lab Director/Quality Manager



PHONE (575) 393-2326 • 101 E. MARLAND • HOBBS, NM 88240

Analytical Results For:

Safety & Environmental Solutions
Bob Allen
703 East Clinton
Hobbs NM, 88240
Fax To: (575) 393-4388

Received:	12/29/2014	Sampling Date:	12/29/2014
Reported:	01/05/2015	Sampling Type:	Soil
Project Name:	SHARP WASTE OIL CLEAN-UP	Sampling Condition:	Cool & Intact
Project Number:	SHA-14-001	Sample Received By:	Jodi Henson
Project Location:	LEA COUNTY, NM		

Sample ID: AH-2 1.5' BGS (H403935-02)

BTEX 8021B		mg/kg		Analyzed By: MS						
Analyte	Result	Reporting Limit	Analyzed	Method Blank	BS	% Recovery	True Value QC	RPD	Qualifier	
Benzene*	<0.050	0.050	12/30/2014	ND	1.83	91.3	2.00	6.81		
Toluene*	<0.050	0.050	12/30/2014	ND	1.83	91.5	2.00	5.49		
Ethylbenzene*	<0.050	0.050	12/30/2014	ND	1.75	87.3	2.00	4.81		
Total Xylenes*	<0.150	0.150	12/30/2014	ND	5.27	87.9	6.00	5.31		
Total BTEX	<0.300	0.300	12/30/2014	ND						

Surrogate: 4-Bromofluorobenzene (PID) 96.7 % 66.2-142

TPH 8015M		mg/kg		Analyzed By: MS						
Analyte	Result	Reporting Limit	Analyzed	Method Blank	BS	% Recovery	True Value QC	RPD	Qualifier	
GRO C6-C10	<10.0	10.0	12/30/2014	ND	180	90.0	200	2.63		
DRO >C10-C28	380	10.0	12/30/2014	ND	186	93.0	200	9.74		
EXT DRO >C28-C35	120	10.0	12/30/2014	ND						

Surrogate: 1-Chlorooctane 90.2 % 47.2-157

Surrogate: 1-Chlorooctadecane 88.0 % 52.1-176

Cardinal Laboratories

*=Accredited Analyte

PLEASE NOTE: Liability and Damages. Cardinal's liability and client's exclusive remedy for any claim arising, whether based in contract or tort, shall be limited to the amount paid by client for analyses. All claims, including those for negligence and any other cause whatsoever shall be deemed waived unless made in writing and received by Cardinal within thirty (30) days after completion of the applicable service. In no event shall Cardinal be liable for incidental or consequential damages, including, without limitation, business interruptions, loss of use, or loss of profits incurred by client, its subsidiaries, affiliates or successors arising out of or related to the performance of the services hereunder by Cardinal, regardless of whether such claim is based upon any of the above stated reasons or otherwise. Results relate only to the samples identified above. This report shall not be reproduced except in full with written approval of Cardinal Laboratories.

Celey D. Keene, Lab Director/Quality Manager



PHONE (575) 393-2326 • 101 E. MARLAND • HOBBS, NM 88240

Analytical Results For:

Safety & Environmental Solutions
Bob Allen
703 East Clinton
Hobbs NM, 88240
Fax To: (575) 393-4388

Received:	12/29/2014	Sampling Date:	12/29/2014
Reported:	01/05/2015	Sampling Type:	Soil
Project Name:	SHARP WASTE OIL CLEAN-UP	Sampling Condition:	Cool & Intact
Project Number:	SHA-14-001	Sample Received By:	Jodi Henson
Project Location:	LEA COUNTY, NM		

Sample ID: AH-3 2' BGS (H403935-03)

BTEX 8021B		mg/kg		Analyzed By: MS					
Analyte	Result	Reporting Limit	Analyzed	Method Blank	BS	% Recovery	True Value QC	RPD	Qualifier
Benzene*	<0.050	0.050	12/30/2014	ND	1.83	91.3	2.00	6.81	
Toluene*	<0.050	0.050	12/30/2014	ND	1.83	91.5	2.00	5.49	
Ethylbenzene*	<0.050	0.050	12/30/2014	ND	1.75	87.3	2.00	4.81	
Total Xylenes*	<0.150	0.150	12/30/2014	ND	5.27	87.9	6.00	5.31	
Total BTEX	<0.300	0.300	12/30/2014	ND					

Surrogate: 4-Bromofluorobenzene (PID) 97.3 % 66.2-142

TPH 8015M		mg/kg		Analyzed By: MS					
Analyte	Result	Reporting Limit	Analyzed	Method Blank	BS	% Recovery	True Value QC	RPD	Qualifier
GRO C6-C10	<10.0	10.0	12/30/2014	ND	197	98.5	200	1.82	
DRO >C10-C28	52.8	10.0	12/30/2014	ND	231	115	200	0.909	
EXT DRO >C28-C35	<10.0	10.0	12/30/2014	ND					

Surrogate: 1-Chlorooctane 85.7 % 47.2-157

Surrogate: 1-Chlorooctadecane 84.9 % 52.1-176

Cardinal Laboratories

*=Accredited Analyte

PLEASE NOTE: Liability and Damages. Cardinal's liability and clients exclusive remedy for any claim arising, whether based in contract or tort, shall be limited to the amount paid by client for analyses. All claims, including those for negligence and any other cause whatsoever shall be deemed waived unless made in writing and received by Cardinal within thirty (30) days after completion of the applicable service. In no event shall Cardinal be liable for incidental or consequential damages, including, without limitation, business interruptions, loss of use, or loss of profits incurred by client, its subsidiaries, affiliates or successors arising out of or related to the performance of the services hereunder by Cardinal, regardless of whether such claim is based upon any of the above stated reasons or otherwise. Results relate only to the samples identified above. This report shall not be reproduced except in full with written approval of Cardinal Laboratories.

Celey D. Keene, Lab Director/Quality Manager



PHONE (575) 393-2326 • 101 E. MARLAND • HOBBS, NM 88240

Analytical Results For:

Safety & Environmental Solutions
Bob Allen
703 East Clinton
Hobbs NM, 88240
Fax To: (575) 393-4388

Received:	12/29/2014	Sampling Date:	12/29/2014
Reported:	01/05/2015	Sampling Type:	Soil
Project Name:	SHARP WASTE OIL CLEAN-UP	Sampling Condition:	Cool & Intact
Project Number:	SHA-14-001	Sample Received By:	Jodi Henson
Project Location:	LEA COUNTY, NM		

Sample ID: AH-4 1' BGS (H403935-04)

BTEX 8021B		mg/kg		Analyzed By: MS						
Analyte	Result	Reporting Limit	Analyzed	Method Blank	BS	% Recovery	True Value QC	RPD	Qualifier	
Benzene*	<0.050	0.050	12/30/2014	ND	1.83	91.3	2.00	6.81		
Toluene*	<0.050	0.050	12/30/2014	ND	1.83	91.5	2.00	5.49		
Ethylbenzene*	<0.050	0.050	12/30/2014	ND	1.75	87.3	2.00	4.81		
Total Xylenes*	<0.150	0.150	12/30/2014	ND	5.27	87.9	6.00	5.31		
Total BTEX	<0.300	0.300	12/30/2014	ND						

Surrogate: 4-Bromofluorobenzene (PID) 97.9 % 66.2-142

TPH 8015M		mg/kg		Analyzed By: MS					
Analyte	Result	Reporting Limit	Analyzed	Method Blank	BS	% Recovery	True Value QC	RPD	Qualifier
GRO C6-C10	<10.0	10.0	12/30/2014	ND	197	98.5	200	1.82	
DRO >C10-C28	<10.0	10.0	12/30/2014	ND	231	115	200	0.909	
EXT DRO >C28-C35	<10.0	10.0	12/30/2014	ND					

Surrogate: 1-Chlorooctane 84.3 % 47.2-157

Surrogate: 1-Chlorooctadecane 83.1 % 52.1-176

Cardinal Laboratories

*=Accredited Analyte

PLEASE NOTE: Liability and Damages. Cardinal's liability and client's exclusive remedy for any claim arising, whether based in contract or tort, shall be limited to the amount paid by client for analyses. All claims, including those for negligence and any other cause whatsoever shall be deemed waived unless made in writing and received by Cardinal within thirty (30) days after completion of the applicable service. In no event shall Cardinal be liable for incidental or consequential damages, including, without limitation, business interruptions, loss of use, or loss of profits incurred by client, its subsidiaries, affiliates or successors arising out of or related to the performance of the services hereunder by Cardinal, regardless of whether such claim is based upon any of the above stated reasons or otherwise. Results relate only to the samples identified above. This report shall not be reproduced except in full with written approval of Cardinal Laboratories.

Celey D. Keene, Lab Director/Quality Manager

Notes and Definitions

ND	Analyte NOT DETECTED at or above the reporting limit
RPD	Relative Percent Difference
**	Samples not received at proper temperature of 6°C or below.
***	Insufficient time to reach temperature.
-	Chloride by SM4500Cl-B does not require samples be received at or below 6°C Samples reported on an as received basis (wet) unless otherwise noted on report

Cardinal Laboratories

*=Accredited Analyte

PLEASE NOTE: Liability and Damages. Cardinal's liability and clients exclusive remedy for any claim arising, whether based in contract or tort, shall be limited to the amount paid by client for analyses. All claims, including those for negligence and any other cause whatsoever shall be deemed waived unless made in writing and received by Cardinal within thirty (30) days after completion of the applicable service. In no event shall Cardinal be liable for incidental or consequential damages, including, without limitation, business interruptions, loss of use, or loss of profits incurred by client, its subsidiaries, affiliates or successors arising out of or related to the performance of the services hereunder by Cardinal, regardless of whether such claim is based upon any of the above stated reasons or otherwise. Results relate only to the samples identified above. This report shall not be reproduced except in full with written approval of Cardinal Laboratories.



Celey D. Keene, Lab Director/Quality Manager



Page ____ of ____

+ Cardinal cannot accept verbal changes. Please fax written changes to 576-893-2476.

March 24, 2015

Bob Allen

Safety & Environmental Solutions

703 East Clinton

Hobbs, NM 88240

RE: WASTE OIL CLEANUP

Enclosed are the results of analyses for samples received by the laboratory on 02/25/15 15:30.

Cardinal Laboratories is accredited through Texas NELAP under certificate number T104704398-13-5. Accreditation applies to drinking water, non-potable water and solid and chemical materials. All accredited analytes are denoted by an asterisk (*). For a complete list of accredited analytes and matrices visit the TCEQ website at www.tceq.texas.gov/field/qa/lab_accred_certif.html.

Cardinal Laboratories is accredited through the State of Colorado Department of Public Health and Environment for:

Method EPA 552.2	Haloacetic Acids (HAA-5)
Method EPA 524.2	Total Trihalomethanes (TTHM)
Method EPA 524.4	Regulated VOCs (V1, V2, V3)

Accreditation applies to public drinking water matrices.

This report meets NELAP requirements and is made up of a cover page, analytical results, and a copy of the original chain-of-custody. If you have any questions concerning this report, please feel free to contact me.

Sincerely,



Celey D. Keene

Lab Director/Quality Manager

Analytical Results For:

 Safety & Environmental Solutions
 Bob Allen
 703 East Clinton
 Hobbs NM, 88240
 Fax To: (575) 393-4388

Received:	02/25/2015	Sampling Date:	02/25/2015
Reported:	03/24/2015	Sampling Type:	Soil
Project Name:	WASTE OIL CLEANUP	Sampling Condition:	Cool & Intact
Project Number:	SHA-14-001	Sample Received By:	Jodi Henson
Project Location:	LEA COUNTY, NM		

Sample ID: SP-1 BOTTOM (H500538-01)

BTEX 8021B		mg/kg		Analyzed By: ms						
Analyte	Result	Reporting Limit	Analyzed	Method Blank	BS	% Recovery	True Value QC	RPD	Qualifier	
Benzene*	<0.050	0.050	02/28/2015	ND	1.96	98.1	2.00	2.69		
Toluene*	<0.050	0.050	02/28/2015	ND	1.79	89.3	2.00	2.69		
Ethylbenzene*	<0.050	0.050	02/28/2015	ND	2.05	103	2.00	2.86		
Total Xylenes*	<0.150	0.150	02/28/2015	ND	5.52	92.0	6.00	3.40		
Total BTEX	<0.300	0.300	02/28/2015	ND						

Surrogate: 4-Bromofluorobenzene (PID) 106 % 61-154

TPH 8015M		mg/kg		Analyzed By: MS						
Analyte	Result	Reporting Limit	Analyzed	Method Blank	BS	% Recovery	True Value QC	RPD	Qualifier	
GRO C6-C10	<10.0	10.0	02/27/2015	ND	208	104	200	0.0756		
DRO >C10-C28	<10.0	10.0	02/27/2015	ND	191	95.7	200	2.78		

Surrogate: 1-Chlorooctane 79.6 % 47.2-157

Surrogate: 1-Chlorooctadecane 76.0 % 52.1-176

Cardinal Laboratories

*=Accredited Analyte

PLEASE NOTE: Liability and Damages. Cardinal's liability and client's exclusive remedy for any claim arising, whether based in contract or tort, shall be limited to the amount paid by client for analyses. All claims, including those for negligence and any other cause whatsoever shall be deemed waived unless made in writing and received by Cardinal within thirty (30) days after completion of the applicable service. In no event shall Cardinal be liable for incidental or consequential damages, including, without limitation, business interruptions, loss of use, or loss of profits incurred by client, its subsidiaries, affiliates or successors arising out of or related to the performance of the services hereunder by Cardinal, regardless of whether such claim is based upon any of the above stated reasons or otherwise. Results relate only to the samples identified above. This report shall not be reproduced except in full with written approval of Cardinal Laboratories.



Celey D. Keene, Lab Director/Quality Manager

Analytical Results For:

Safety & Environmental Solutions
Bob Allen
703 East Clinton
Hobbs NM, 88240
Fax To: (575) 393-4388

Received: 02/25/2015
Reported: 03/24/2015
Project Name: WASTE OIL CLEANUP
Project Number: SHA-14-001
Project Location: LEA COUNTY, NM

Sampling Date: 02/25/2015
Sampling Type: Soil
Sampling Condition: Cool & Intact
Sample Received By: Jodi Henson

Sample ID: SP-2 BOTTOM (H500538-02)

BTEx 8021B		mg/kg		Analyzed By: ms						
Analyte	Result	Reporting Limit	Analyzed	Method Blank	BS	% Recovery	True Value QC	RPD	Qualifier	
Benzene*	<0.050	0.050	02/28/2015	ND	1.96	98.1	2.00	2.69		
Toluene*	<0.050	0.050	02/28/2015	ND	1.79	89.3	2.00	2.69		
Ethylbenzene*	<0.050	0.050	02/28/2015	ND	2.05	103	2.00	2.86		
Total Xylenes*	<0.150	0.150	02/28/2015	ND	5.52	92.0	6.00	3.40		
Total BTEx	<0.300	0.300	02/28/2015	ND						

Surrogate: 4-Bromofluorobenzene (PID) 104 % 61-154

TPH 8015M		mg/kg		Analyzed By: MS					
Analyte	Result	Reporting Limit	Analyzed	Method Blank	BS	% Recovery	True Value QC	RPD	Qualifier
GRO C6-C10	<10.0	10.0	02/27/2015	ND	208	104	200	0.0756	
DRO >C10-C28	<10.0	10.0	02/27/2015	ND	191	95.7	200	2.78	

Surrogate: 1-Chlorooctane 81.6 % 47.2-157

Surrogate: 1-Chlorooctadecane 81.2 % 52.1-176

Cardinal Laboratories

*=Accredited Analyte

PLEASE NOTE: Liability and Damages. Cardinal's liability and client's exclusive remedy for any claim arising, whether based in contract or tort, shall be limited to the amount paid by client for analyses. All claims, including those for negligence and any other cause whatsoever shall be deemed waived unless made in writing and received by Cardinal within thirty (30) days after completion of the applicable service. In no event shall Cardinal be liable for incidental or consequential damages, including, without limitation, business interruptions, loss of use, or loss of profits incurred by client, its subsidiaries, affiliates or successors arising out of or related to the performance of the services hereunder by Cardinal, regardless of whether such claim is based upon any of the above stated reasons or otherwise. Results relate only to the samples identified above. This report shall not be reproduced except in full with written approval of Cardinal Laboratories.



Celey D. Keene, Lab Director/Quality Manager

Analytical Results For:

Safety & Environmental Solutions
Bob Allen
703 East Clinton
Hobbs NM, 88240
Fax To: (575) 393-4388

Received: 02/25/2015
Reported: 03/24/2015
Project Name: WASTE OIL CLEANUP
Project Number: SHA-14-001
Project Location: LEA COUNTY, NM

Sampling Date: 02/25/2015
Sampling Type: Soil
Sampling Condition: Cool & Intact
Sample Received By: Jodi Henson

Sample ID: SP-3 BOTTOM (H500538-03)

BTEx 8021B		mg/kg		Analyzed By: ms						
Analyte	Result	Reporting Limit	Analyzed	Method Blank	BS	% Recovery	True Value QC	RPD	Qualifier	
Benzene*	<0.050	0.050	02/28/2015	ND	1.96	98.1	2.00	2.69		
Toluene*	<0.050	0.050	02/28/2015	ND	1.79	89.3	2.00	2.69		
Ethylbenzene*	<0.050	0.050	02/28/2015	ND	2.05	103	2.00	2.86		
Total Xylenes*	<0.150	0.150	02/28/2015	ND	5.52	92.0	6.00	3.40		
Total BTEx	<0.300	0.300	02/28/2015	ND						

Surrogate: 4-Bromofluorobenzene (PID) 104 % 61-154

TPH 8015M		mg/kg		Analyzed By: MS					
Analyte	Result	Reporting Limit	Analyzed	Method Blank	BS	% Recovery	True Value QC	RPD	Qualifier
GRO C6-C10	<10.0	10.0	02/27/2015	ND	208	104	200	0.0756	
DRO >C10-C28	<10.0	10.0	02/27/2015	ND	191	95.7	200	2.78	

Surrogate: 1-Chlorooctane 79.4 % 47.2-157

Surrogate: 1-Chlorooctadecane 85.1 % 52.1-176

Cardinal Laboratories

*=Accredited Analyte

PLEASE NOTE: Liability and Damages. Cardinal's liability and client's exclusive remedy for any claim arising, whether based in contract or tort, shall be limited to the amount paid by client for analyses. All claims, including those for negligence and any other cause whatsoever shall be deemed waived unless made in writing and received by Cardinal within thirty (30) days after completion of the applicable service. In no event shall Cardinal be liable for incidental or consequential damages, including, without limitation, business interruptions, loss of use, or loss of profits incurred by client, its subsidiaries, affiliates or successors arising out of or related to the performance of the services hereunder by Cardinal, regardless of whether such claim is based upon any of the above stated reasons or otherwise. Results relate only to the samples identified above. This report shall not be reproduced except in full with written approval of Cardinal Laboratories.



Celey D. Keene, Lab Director/Quality Manager

Analytical Results For:

Safety & Environmental Solutions
Bob Allen
703 East Clinton
Hobbs NM, 88240
Fax To: (575) 393-4388

Received: 02/25/2015
Reported: 03/24/2015
Project Name: WASTE OIL CLEANUP
Project Number: SHA-14-001
Project Location: LEA COUNTY, NM

Sampling Date: 02/25/2015
Sampling Type: Soil
Sampling Condition: Cool & Intact
Sample Received By: Jodi Henson

Sample ID: SP-4 BOTTOM (H500538-04)

BTEX 8021B		mg/kg		Analyzed By: ms						
Analyte	Result	Reporting Limit	Analyzed	Method Blank	BS	% Recovery	True Value QC	RPD	Qualifier	
Benzene*	<0.050	0.050	02/28/2015	ND	1.96	98.1	2.00	2.69		
Toluene*	<0.050	0.050	02/28/2015	ND	1.79	89.3	2.00	2.69		
Ethylbenzene*	<0.050	0.050	02/28/2015	ND	2.05	103	2.00	2.86		
Total Xylenes*	<0.150	0.150	02/28/2015	ND	5.52	92.0	6.00	3.40		
Total BTEX	<0.300	0.300	02/28/2015	ND						

Surrogate: 4-Bromofluorobenzene (PID) 106 % 61-154

TPH 8015M		mg/kg		Analyzed By: MS					
Analyte	Result	Reporting Limit	Analyzed	Method Blank	BS	% Recovery	True Value QC	RPD	Qualifier
GRO C6-C10	<10.0	10.0	02/27/2015	ND	211	106	200	0.431	
DRO >C10-C28	<10.0	10.0	02/27/2015	ND	210	105	200	0.00906	

Surrogate: 1-Chlorooctane 102 % 47.2-157

Surrogate: 1-Chlorooctadecane 107 % 52.1-176

Cardinal Laboratories

*=Accredited Analyte

PLEASE NOTE: Liability and Damages. Cardinal's liability and client's exclusive remedy for any claim arising, whether based in contract or tort, shall be limited to the amount paid by client for analyses. All claims, including those for negligence and any other cause whatsoever shall be deemed waived unless made in writing and received by Cardinal within thirty (30) days after completion of the applicable service. In no event shall Cardinal be liable for incidental or consequential damages, including, without limitation, business interruptions, loss of use, or loss of profits incurred by client, its subsidiaries, affiliates or successors arising out of or related to the performance of the services hereunder by Cardinal, regardless of whether such claim is based upon any of the above stated reasons or otherwise. Results relate only to the samples identified above. This report shall not be reproduced except in full with written approval of Cardinal Laboratories.



Celey D. Keene, Lab Director/Quality Manager

Analytical Results For:

Safety & Environmental Solutions
Bob Allen
703 East Clinton
Hobbs NM, 88240
Fax To: (575) 393-4388

Received: 02/25/2015
Reported: 03/24/2015
Project Name: WASTE OIL CLEANUP
Project Number: SHA-14-001
Project Location: LEA COUNTY, NM

Sampling Date: 02/25/2015
Sampling Type: Soil
Sampling Condition: Cool & Intact
Sample Received By: Jodi Henson

Sample ID: SP-5 WEST WALL (H500538-05)

BTEx 8021B		mg/kg		Analyzed By: ms						
Analyte	Result	Reporting Limit	Analyzed	Method Blank	BS	% Recovery	True Value QC	RPD	Qualifier	
Benzene*	<0.050	0.050	02/28/2015	ND	1.96	98.1	2.00	2.69		
Toluene*	<0.050	0.050	02/28/2015	ND	1.79	89.3	2.00	2.69		
Ethylbenzene*	<0.050	0.050	02/28/2015	ND	2.05	103	2.00	2.86		
Total Xylenes*	<0.150	0.150	02/28/2015	ND	5.52	92.0	6.00	3.40		
Total BTEx	<0.300	0.300	02/28/2015	ND						

Surrogate: 4-Bromofluorobenzene (PID) 104 % 61-154

TPH 8015M		mg/kg		Analyzed By: MS					
Analyte	Result	Reporting Limit	Analyzed	Method Blank	BS	% Recovery	True Value QC	RPD	Qualifier
GRO C6-C10	<10.0	10.0	02/27/2015	ND	211	106	200	0.431	
DRO >C10-C28	<10.0	10.0	02/27/2015	ND	210	105	200	0.00906	

Surrogate: 1-Chlorooctane 108 % 47.2-157

Surrogate: 1-Chlorooctadecane 111 % 52.1-176

Cardinal Laboratories

*=Accredited Analyte

PLEASE NOTE: Liability and Damages. Cardinal's liability and client's exclusive remedy for any claim arising, whether based in contract or tort, shall be limited to the amount paid by client for analyses. All claims, including those for negligence and any other cause whatsoever shall be deemed waived unless made in writing and received by Cardinal within thirty (30) days after completion of the applicable service. In no event shall Cardinal be liable for incidental or consequential damages, including, without limitation, business interruptions, loss of use, or loss of profits incurred by client, its subsidiaries, affiliates or successors arising out of or related to the performance of the services hereunder by Cardinal, regardless of whether such claim is based upon any of the above stated reasons or otherwise. Results relate only to the samples identified above. This report shall not be reproduced except in full with written approval of Cardinal Laboratories.



Celey D. Keene, Lab Director/Quality Manager

Analytical Results For:

Safety & Environmental Solutions
Bob Allen
703 East Clinton
Hobbs NM, 88240
Fax To: (575) 393-4388

Received: 02/25/2015
Reported: 03/24/2015
Project Name: WASTE OIL CLEANUP
Project Number: SHA-14-001
Project Location: LEA COUNTY, NM

Sampling Date: 02/25/2015
Sampling Type: Soil
Sampling Condition: Cool & Intact
Sample Received By: Jodi Henson

Sample ID: SP-6 WEST WALL (H500538-06)

BTEX 8021B		mg/kg		Analyzed By: ms						
Analyte	Result	Reporting Limit	Analyzed	Method Blank	BS	% Recovery	True Value QC	RPD	Qualifier	
Benzene*	<0.050	0.050	02/28/2015	ND	1.96	98.1	2.00	2.69		
Toluene*	<0.050	0.050	02/28/2015	ND	1.79	89.3	2.00	2.69		
Ethylbenzene*	<0.050	0.050	02/28/2015	ND	2.05	103	2.00	2.86		
Total Xylenes*	<0.150	0.150	02/28/2015	ND	5.52	92.0	6.00	3.40		
Total BTEX	<0.300	0.300	02/28/2015	ND						

Surrogate: 4-Bromofluorobenzene (PID) 106 % 61-154

TPH 8015M		mg/kg		Analyzed By: MS						
Analyte	Result	Reporting Limit	Analyzed	Method Blank	BS	% Recovery	True Value QC	RPD	Qualifier	
GRO C6-C10	<10.0	10.0	02/27/2015	ND	211	106	200	0.431		
DRO >C10-C28	<10.0	10.0	02/27/2015	ND	210	105	200	0.00906		

Surrogate: 1-Chlorooctane 103 % 47.2-157

Surrogate: 1-Chlorooctadecane 107 % 52.1-176

Cardinal Laboratories

*=Accredited Analyte

PLEASE NOTE: Liability and Damages. Cardinal's liability and client's exclusive remedy for any claim arising, whether based in contract or tort, shall be limited to the amount paid by client for analyses. All claims, including those for negligence and any other cause whatsoever shall be deemed waived unless made in writing and received by Cardinal within thirty (30) days after completion of the applicable service. In no event shall Cardinal be liable for incidental or consequential damages, including, without limitation, business interruptions, loss of use, or loss of profits incurred by client, its subsidiaries, affiliates or successors arising out of or related to the performance of the services hereunder by Cardinal, regardless of whether such claim is based upon any of the above stated reasons or otherwise. Results relate only to the samples identified above. This report shall not be reproduced except in full with written approval of Cardinal Laboratories.



Celey D. Keene, Lab Director/Quality Manager

Analytical Results For:

 Safety & Environmental Solutions
 Bob Allen
 703 East Clinton
 Hobbs NM, 88240
 Fax To: (575) 393-4388

 Received: 02/25/2015
 Reported: 03/24/2015
 Project Name: WASTE OIL CLEANUP
 Project Number: SHA-14-001
 Project Location: LEA COUNTY, NM

 Sampling Date: 02/25/2015
 Sampling Type: Soil
 Sampling Condition: Cool & Intact
 Sample Received By: Jodi Henson

Sample ID: SP-7 EAST WALL (H500538-07)

BTEx 8021B		mg/kg		Analyzed By: ms					
Analyte	Result	Reporting Limit	Analyzed	Method Blank	BS	% Recovery	True Value QC	RPD	Qualifier
Benzene*	<0.050	0.050	03/02/2015	ND	1.92	96.0	2.00	5.92	
Toluene*	<0.050	0.050	03/02/2015	ND	1.77	88.7	2.00	4.73	
Ethylbenzene*	<0.050	0.050	03/02/2015	ND	1.98	99.1	2.00	6.84	
Total Xylenes*	<0.150	0.150	03/02/2015	ND	5.33	88.9	6.00	8.22	
Total BTEX	<0.300	0.300	03/02/2015	ND					

Surrogate: 4-Bromofluorobenzene (PID) 109 % 61-154

TPH 8015M		mg/kg		Analyzed By: MS					
Analyte	Result	Reporting Limit	Analyzed	Method Blank	BS	% Recovery	True Value QC	RPD	Qualifier
GRO C6-C10	<10.0	10.0	02/27/2015	ND	211	106	200	0.431	
DRO >C10-C28	<10.0	10.0	02/27/2015	ND	210	105	200	0.00906	

Surrogate: 1-Chlorooctane 99.1 % 47.2-157

Surrogate: 1-Chlorooctadecane 103 % 52.1-176

Cardinal Laboratories

*=Accredited Analyte

PLEASE NOTE: Liability and Damages. Cardinal's liability and client's exclusive remedy for any claim arising, whether based in contract or tort, shall be limited to the amount paid by client for analyses. All claims, including those for negligence and any other cause whatsoever shall be deemed waived unless made in writing and received by Cardinal within thirty (30) days after completion of the applicable service. In no event shall Cardinal be liable for incidental or consequential damages, including, without limitation, business interruptions, loss of use, or loss of profits incurred by client, its subsidiaries, affiliates or successors arising out of or related to the performance of the services hereunder by Cardinal, regardless of whether such claim is based upon any of the above stated reasons or otherwise. Results relate only to the samples identified above. This report shall not be reproduced except in full with written approval of Cardinal Laboratories.



Celey D. Keene, Lab Director/Quality Manager

Analytical Results For:

Safety & Environmental Solutions
Bob Allen
703 East Clinton
Hobbs NM, 88240
Fax To: (575) 393-4388

Received: 02/25/2015
Reported: 03/24/2015
Project Name: WASTE OIL CLEANUP
Project Number: SHA-14-001
Project Location: LEA COUNTY, NM

Sampling Date: 02/25/2015
Sampling Type: Soil
Sampling Condition: Cool & Intact
Sample Received By: Jodi Henson

Sample ID: SP-8 EAST WALL (H500538-08)

BTEX 8021B		mg/kg		Analyzed By: ms						
Analyte	Result	Reporting Limit	Analyzed	Method Blank	BS	% Recovery	True Value QC	RPD	Qualifier	
Benzene*	<0.050	0.050	03/02/2015	ND	1.92	96.0	2.00	5.92		
Toluene*	<0.050	0.050	03/02/2015	ND	1.77	88.7	2.00	4.73		
Ethylbenzene*	<0.050	0.050	03/02/2015	ND	1.98	99.1	2.00	6.84		
Total Xylenes*	<0.150	0.150	03/02/2015	ND	5.33	88.9	6.00	8.22		
Total BTEX	<0.300	0.300	03/02/2015	ND						

Surrogate: 4-Bromofluorobenzene (PID) 111 % 61-154

TPH 8015M		mg/kg		Analyzed By: MS					
Analyte	Result	Reporting Limit	Analyzed	Method Blank	BS	% Recovery	True Value QC	RPD	Qualifier
GRO C6-C10	<10.0	10.0	02/27/2015	ND	211	106	200	0.431	
DRO >C10-C28	<10.0	10.0	02/27/2015	ND	210	105	200	0.00906	

Surrogate: 1-Chlorooctane 113 % 47.2-157

Surrogate: 1-Chlorooctadecane 113 % 52.1-176

Cardinal Laboratories

*=Accredited Analyte

PLEASE NOTE: Liability and Damages. Cardinal's liability and client's exclusive remedy for any claim arising, whether based in contract or tort, shall be limited to the amount paid by client for analyses. All claims, including those for negligence and any other cause whatsoever shall be deemed waived unless made in writing and received by Cardinal within thirty (30) days after completion of the applicable service. In no event shall Cardinal be liable for incidental or consequential damages, including, without limitation, business interruptions, loss of use, or loss of profits incurred by client, its subsidiaries, affiliates or successors arising out of or related to the performance of the services hereunder by Cardinal, regardless of whether such claim is based upon any of the above stated reasons or otherwise. Results relate only to the samples identified above. This report shall not be reproduced except in full with written approval of Cardinal Laboratories.



Celey D. Keene, Lab Director/Quality Manager

Notes and Definitions

ND	Analyte NOT DETECTED at or above the reporting limit
RPD	Relative Percent Difference
**	Samples not received at proper temperature of 6°C or below.
***	Insufficient time to reach temperature.
-	Chloride by SM4500Cl-B does not require samples be received at or below 6°C Samples reported on an as received basis (wet) unless otherwise noted on report

Cardinal Laboratories

*=Accredited Analyte

PLEASE NOTE: Liability and Damages. Cardinal's liability and client's exclusive remedy for any claim arising, whether based in contract or tort, shall be limited to the amount paid by client for analyses. All claims, including those for negligence and any other cause whatsoever shall be deemed waived unless made in writing and received by Cardinal within thirty (30) days after completion of the applicable service. In no event shall Cardinal be liable for incidental or consequential damages, including, without limitation, business interruptions, loss of use, or loss of profits incurred by client, its subsidiaries, affiliates or successors arising out of or related to the performance of the services hereunder by Cardinal, regardless of whether such claim is based upon any of the above stated reasons or otherwise. Results relate only to the samples identified above. This report shall not be reproduced except in full with written approval of Cardinal Laboratories.



Celey D. Keene, Lab Director/Quality Manager

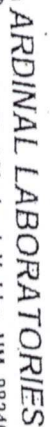

101 East Marland, Hobbs, NM 88240
(505) 393-2326 Fax (505) 393-2476

Page ____ of ____

CHAIN-OF-CUSTODY AND ANALYSIS REQUEST

Company Name: Safety & Environmental Solutions, Inc.		P.O. #:		BILL TO		ANALYSIS REQUEST	
Project Manager: Bob Allen		Company: Same					
Address: 703 East Clinton		City: Hobbs		State: NM		Zip: 88240	
Phone #: 575-397-0510		Fax #: 575-393-4388		City: Same		State: Same	
Project #: 575-15-001		Project Owner: SITARD		City: Same		State: Same	
Project Name: WASTE OIL CLEAN UP		Project Location: LEA COUNTY		Phone #:		Zip:	
Sampler Name: Sosa, Jerry		Fax #:		PRESERV:		SAMPLING	
FOR LAB USE ONLY							
Lab I.D.:		Sample I.D.:					
H560538 1 SP-1 BOTTOM 2 SP-2 BOTTOM 3 SP-3 BOTTOM 4 SP-4 BOTTOM 5 SP-5 WEST WALL 6 SP-6 WEST WALL 7 SP-7 EAST WALL 8 SP-8 EAST WALL		(G)RAB OR (C)OMP.					
		# CONTAINERS					
		GROUNDWATER					
		WASTEWATER					
		SOIL					
		OIL					
		SLUDGE					
		OTHER:					
		ACID/BASE:					
		ICE / COOL					
OTHER:							
		DATE		TIME			
		02/25		0945			
		02/25		1000			
		02/25		1015			
		02/25		1030			
		02/25		1040			
		02/25		1050			
		02/25		1100			
		02/25		1110			

☐ Yes ☐ No ☐ Add'l Phone #:
 Phone Result: ☐ Yes ☐ No ☐ Add'l Fax #:
 Fax Result:

REMARKS: ** Changed as per Rebecca. 3/24/56*

Delivered By: (Circle One) **2.20**
 Sampler - UPS - Bus - Other:

Relinquished By: *[Signature]*
 Date: **02/25/15**
 Received By: *[Signature]*
 Date: **02/25/15**

Temp. Sample Condition: ☐ Cool ☐ Intact ☐ No ☐ Yes
 CHECKED BY: *[Signature]*

PLEASE NOTE: Liability and Damages: Certain liability and others' activities remain for any third-party whether based in contract or tort, shall be limited to the amount paid by the client for the analysis. All claims including those for negligence and any other cause whatsoever shall be deemed waived unless made in writing and received by Customer within 30 days after completion of the applicable analysis. In no event shall Cardinal be liable for incidental or consequential damages, including without limitation, business interruptions, loss of use, or loss of profits incurred by Client, its subsidiaries, affiliates or successors arising out of or related to the performance of services rendered by Cardinal regardless of whether such claim is based upon any of the above stated reasons or otherwise.

Terms and Conditions: Interest will be charged on all accounts more than 30 days past due at the rate of 24% per annum from the original date of invoice and all costs of collections, including attorney's fees.

Appendix B

C-141

District I
1625 N. French Dr., Hobbs, NM 88240
District II
811 S. First St., Artesia, NM 88210
District III
1000 Rio Brazos Road, Aztec, NM 87410
District IV
1220 S. St. Francis Dr., Santa Fe, NM 87505

State of New Mexico
Energy Minerals and Natural Resources

Oil Conservation Division
1220 South St. Francis Dr.
Santa Fe, NM 87505

Form C-141
Revised August 8, 2011

Submit 1 Copy to appropriate District Office in
accordance with 19.15.29 NMAC.

Release Notification and Corrective Action

OPERATOR

☐ Initial Report ☒ Final Report

Name of Company: Sharp Oilfield Services	Contact: Tayler Allbritton	
Address: 211 West Main	Telephone No. (940) 312-3858	
Facility Name	Facility Type:	
Surface Owner: Floyd Simms	Mineral Owner: Chevron	API No.

LOCATION OF RELEASE

Unit Letter	Section 4	Township 23S	Range 37E	Feet from the	North/South Line	Feet from the	East/West Line	County Lea
-------------	--------------	-----------------	--------------	---------------	------------------	---------------	----------------	---------------

Latitude 32.327276745 Longitude 103.172939766

NATURE OF RELEASE

Type of Release: Used Oil and lube	Volume of Release: 12 BBLS	Volume Recovered: 0
Source of Release: Truck Rollover	Date and Hour of Occurrence: 12/27/2014 11:00 pm	Date and Hour of Discovery: 12/27/2014
Was Immediate Notice Given? <input type="checkbox"/> Yes <input checked="" type="checkbox"/> No <input type="checkbox"/> Not Required	If YES, To Whom?	
By Whom?	Date and Hour:	
Was a Watercourse Reached? <input type="checkbox"/> Yes <input checked="" type="checkbox"/> No	If YES, Volume Impacting the Watercourse.	
If a Watercourse was Impacted, Describe Fully.*		
Describe Cause of Problem and Remedial Action Taken.* Truck Rollover causing spillage.		
Describe Area Affected and Cleanup Action Taken.* Safety & Environmental Solutions, Inc. has assessed and remediated the site according to said and approved remediation plan submitted to the NMOCD Lea County on January 15, 2015, and approved on January 21, 2015. All impacted soils were removed to an NMOCD approved facility and no further action is necessary. Safety & Environmental Solutions respectfully requests closure of the regulatory file for this site.		

I hereby certify that the information given above is true and complete to the best of my knowledge and understand that pursuant to NMOCD rules and regulations all operators are required to report and/or file certain release notifications and perform corrective actions for releases which may endanger public health or the environment. The acceptance of a C-141 report by the NMOCD marked as "Final Report" does not relieve the operator of liability should their operations have failed to adequately investigate and remediate contamination that pose a threat to ground water, surface water, human health or the environment. In addition, NMOCD acceptance of a C-141 report does not relieve the operator of responsibility for compliance with any other federal, state, or local laws and/or regulations.

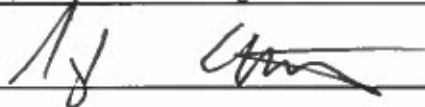
Signature: 		OIL CONSERVATION DIVISION	
Printed Name: Taylor Allbritton		Approved by Environmental Specialist:	
Title: Regional Manager		Approval Date:	Expiration Date:
E-mail Address: tallbritton@sharpoilfieldservices.com		Conditions of Approval:	
Date: 12-29-2014 Phone: (940) 312-3858		Attached <input type="checkbox"/>	

* Attach Additional Sheets If Necessary