

RECEIVED

By OCD; Dr. Oberding at 9:56 am, Mar 31, 2015

**OXY USA, Inc.
South Hobbs Unit Satellite 5
Closure Report**

**Section 4, T19S, R38E
Lea County, New Mexico**

**1RP-3533-0
March 26, 2015**

APPROVED

By OCD; Dr. Oberding at 9:57 am, Mar 31, 2015



Prepared for:

**OXY USA, Inc.
1017 W Stanolind Road
Hobbs, New Mexico 88240**

By:

**Safety & Environmental Solutions, Inc.
703 East Clinton Street
Hobbs, New Mexico 88240
(575) 397-0510**

TABLE OF CONTENTS

I. COMPANY CONTACTS.....	1
II. BACKGROUND.....	1
III. SURFACE AND GROUND WATER.....	1
IV. CHARACTERIZATION.....	1
V. WORK PERFORMED.....	1
VI. ACTION PLAN.....	2
VII. FIGURES & APPENDICES	2
Figure 1 – Vicinity Map.....	5
Figure 2 – Site Plan	7
Appendix A – Analytical Results	9
Appendix B – C-141	16
Appendix C – Site Photographs.....	20

I. Company Contacts

Representative	Company	Telephone	E-mail
Raymond Aguilar	OXY USA, INC.	575-390-6312	Raymond_aguilar@oxy.com
Bob Allen	SESI	575-397-0510	ballen@sesi-nm.com

II. Background

Safety and Environmental Solutions, Inc. (SESI) was engaged by OXY USA, INC to perform site assessment of a release area at the South Hobbs Unit Satellite 5 located in Section 4 of Township 19 South, Range 38 East, Lea County, New Mexico.

According to the C-141 the cause of release was due to human error and a line struck by track hoe. Approximately 42 bbls of fluids were released into the excavated area. The fluids were recovered by a vacuum truck.

III. Surface and Ground Water

The nearest groundwater of record is approximately 1.0 mile Northeast of the site. The New Mexico Office of State Engineer record is in Section 4 Range 38 East and Township 19 South. The reported depth was 100 feet below ground surface (BGS).

IV. Characterization

The target cleanup levels are determined using the *Guidelines for Remediation of Leaks, Spills and Releases* published by the NMOC (August 13, 1993). Based on the ranking criteria presented below, the applicable Recommended Remediation Action Levels (RRAL) are 10 parts per million (ppm) Benzene, 50 ppm combined benzene, toluene, ethylbenzene, and total xylenes (BTEX), and 5,000 ppm Total Petroleum Hydrocarbons (TPH).

Depth to Ground Water:			
(Vertical distance from contaminants to seasonal high water elevation of groundwater)	Less than 50 feet	20 points	
	50 feet to 99 feet	10 points	X
	>100 feet	0 points	
Wellhead Protection Area:			
(Less than 200 feet from a private domestic water source; or less than 1000 feet from all other water sources)	Yes	20 points	
	No	0 points	X
Distance to Surface Water:			
(Horizontal distance to perennial lakes, ponds, rivers, streams, creeks, irrigation canals and ditches)	Less than 200 feet	20 points	
	200 feet to 1000 feet	10 points	
	>1000 feet	0 points	X
RANKING SCORE (TOTAL POINTS)			10

V. Work Performed

On March 5, 2015, SESI was onsite to determine vertical extent of contamination. Sample Bottom hole was taken at a depth of 11' ft. Sample South Wall was taken from the south wall of the excavation area. All samples were properly packaged, preserved and transported to the Laboratory, Hobbs New Mexico and analyzed for Benzene,

Toluene, Ethylbenzene, Xylenes, Total BTEX and Chloride (Cl⁻) (Method SM4500Cl-B).
The results of the analysis are presented in the table below:

Sample Date 03/05/2015	Sample ID	Benzene (mg/kg)	Toluene (mg/kg)	Ethylbenzene (mg/kg)	Xylenes (mg/kg)	Total BTEX
Location	Method					
Bottom at 11'	BTEX 8021B	<0.050	<0.050	<0.056	<0.150	<0.300
South Wall	BTEX 8021B	<0.050	<0.050	<0.050	<0.150	<0.300

Sample Date 03/05/2015	Sample ID	Chloride (Cl)	Sample ID	GRO (C ₆ -C ₁₀) (mg/kg)	DRO (>C ₁₀ -C ₂₈) (mg/kg)
Depth	Method		Method		
Bottom at 11'	SM4500Cl-B	64	TPH 8015M	<10.0	<10.0
South Wall	SM4500Cl-B	144	TPH 8015M	<10.0	<10.0

VI. Closure

On March 05, 2015 Safety and Environmental Solutions, Inc. personnel revisited the site and retrieved the aforementioned soil representative samples from the excavation floor and South sidewall. The aforementioned results returned confirmation of acceptable regulatory levels for BTEX and TPH analyses. According to visual examination, as documented by photos there is no visual staining present. Due to the number of lines in the area, no further action is prudent. Therefore, Safety and Environmental Solutions, Inc. respectfully requests closure of the regulatory file on the aforementioned site.

VII. Figures & Appendices

Figure 1 – Vicinity Map
Figure 2 – Site Plan
Appendix A – Analytical Results
Appendix B – C-141

Figure 1
Vicinity Map

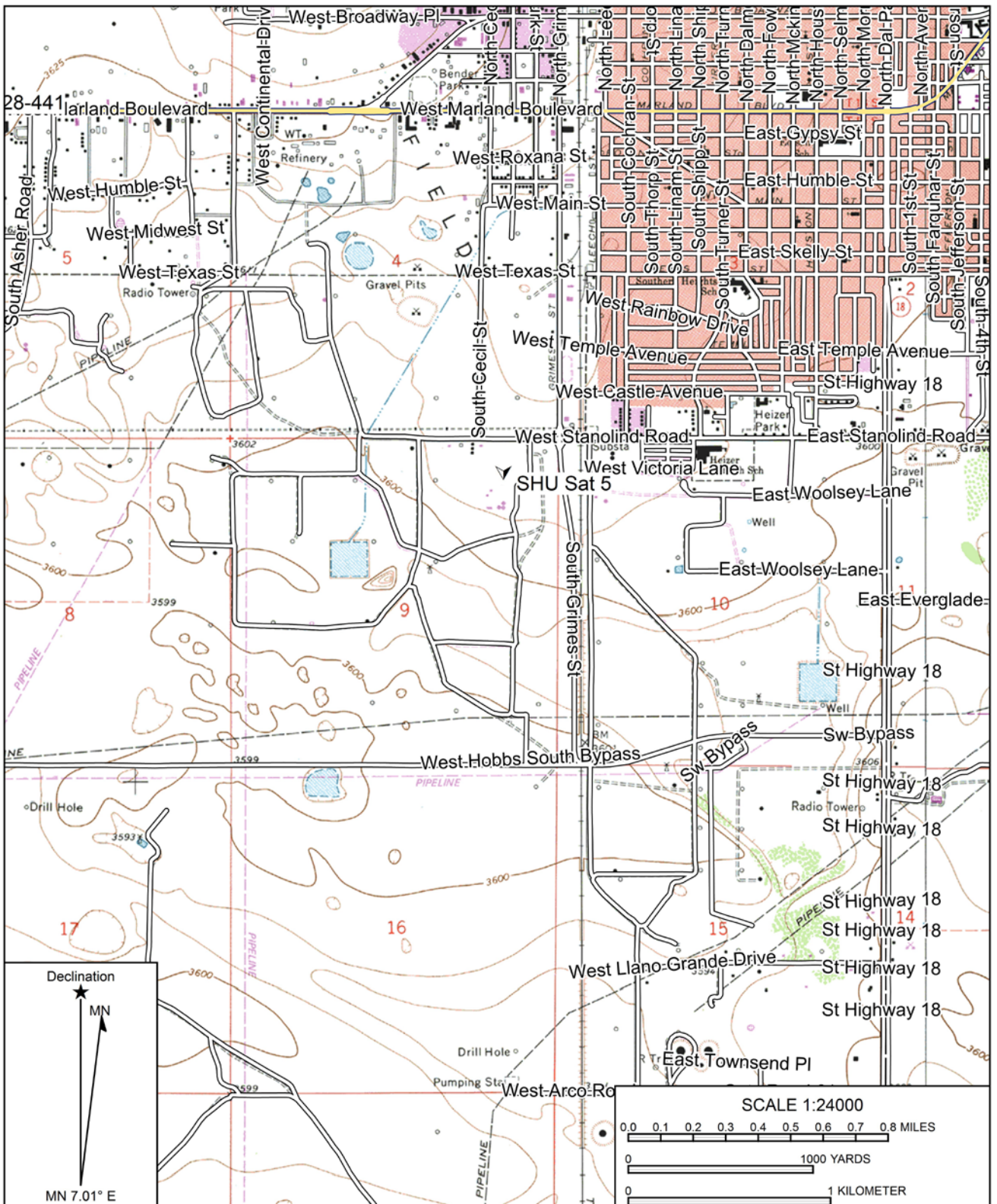

Name: HOBBS WEST,
Date: 02/25/15
Scale: 1 inch = 2,000 ft.

Location: 032.6745994° N, 103.1481305° W
Caption: South Hobbs Unit Satellite 5

Figure 2
Site Plan



South Hobbs Unit Satellite 5

Appendix A

Analytical Results



PHONE (575) 393-2326 • 101 E. MARLAND • HOBBS, NM 88240

March 10, 2015

Bob Allen

Safety & Environmental Solutions

703 East Clinton

Hobbs, NM 88240

RE: SHU- SATELITE #5

Enclosed are the results of analyses for samples received by the laboratory on 03/05/15 11:00.

Cardinal Laboratories is accredited through Texas NELAP under certificate number T104704398-13-5. Accreditation applies to drinking water, non-potable water and solid and chemical materials. All accredited analytes are denoted by an asterisk (*). For a complete list of accredited analytes and matrices visit the TCEQ website at www.tceq.texas.gov/field/qa/lab_accred_certif.html.

Cardinal Laboratories is accredited through the State of Colorado Department of Public Health and Environment for:

Method EPA 552.2	Haloacetic Acids (HAA-5)
Method EPA 524.2	Total Trihalomethanes (TTHM)
Method EPA 524.4	Regulated VOCs (V1, V2, V3)

Accreditation applies to public drinking water matrices.

This report meets NELAP requirements and is made up of a cover page, analytical results, and a copy of the original chain-of-custody. If you have any questions concerning this report, please feel free to contact me.

Sincerely,

Celey D. Keene

Lab Director/Quality Manager



PHONE (575) 393-2326 • 101 E. MARLAND • HOBBS, NM 88240

Analytical Results For:

Safety & Environmental Solutions
Bob Allen
703 East Clinton
Hobbs NM, 88240
Fax To: (575) 393-4388

Received:	03/05/2015	Sampling Date:	03/05/2015
Reported:	03/10/2015	Sampling Type:	Soil
Project Name:	SHU- SATELLITE #5	Sampling Condition:	Cool & Intact
Project Number:	OXY-14-022	Sample Received By:	Jodi Henson
Project Location:	HOBBS, NM		

Sample ID: BOTTOM 11' BGS (H500611-01)

BTX 8021B		mg/kg		Analyzed By: ms					
Analyte	Result	Reporting Limit	Analyzed	Method Blank	BS	% Recovery	True Value QC	RPD	Qualifier
Benzene*	<0.050	0.050	03/09/2015	ND	1.96	97.8	2.00	10.5	
Toluene*	<0.050	0.050	03/09/2015	ND	1.84	91.9	2.00	6.52	
Ethylbenzene*	<0.050	0.050	03/09/2015	ND	2.09	105	2.00	7.91	
Total Xylenes*	<0.150	0.150	03/09/2015	ND	5.64	94.0	6.00	9.81	
Total BTX	<0.300	0.300	03/09/2015	ND					

Surrogate: 4-Bromofluorobenzene (PID) 116 % 61-154

Chloride, SM4500Cl-B		mg/kg		Analyzed By: AP					
Analyte	Result	Reporting Limit	Analyzed	Method Blank	BS	% Recovery	True Value QC	RPD	Qualifier
Chloride	64.0	16.0	03/05/2015	ND	400	100	400	0.00	
TPH 8015M		mg/kg		Analyzed By: MS					

Surrogate: 1-Chlorooctane 86.6 % 47.2-157

Surrogate: 1-Chlorooctadecane 92.0 % 52.1-176

Cardinal Laboratories

*=Accredited Analyte

PLEASE NOTE: Liability and Damages. Cardinal's liability and clients exclusive remedy for any claim arising, whether based in contract or tort, shall be limited to the amount paid by client for analyses. All claims, including those for negligence and any other cause whatsoever shall be deemed waived unless made in writing and received by Cardinal within thirty (30) days after completion of the applicable service. In no event shall Cardinal be liable for incidental or consequential damages, including, without limitation, business interruptions, loss of use, or loss of profits incurred by client, its subsidiaries, affiliates or successors arising out of or related to the performance of the services hereunder by Cardinal, regardless of whether such claim is based upon any of the above stated reasons or otherwise. Results relate only to the samples identified above. This report shall not be reproduced except in full with written approval of Cardinal Laboratories.

Celey D. Keene, Lab Director/Quality Manager



PHONE (575) 393-2326 • 101 E. MARLAND • HOBBS, NM 88240

Analytical Results For:

Safety & Environmental Solutions
Bob Allen
703 East Clinton
Hobbs NM, 88240
Fax To: (575) 393-4388

Received:	03/05/2015	Sampling Date:	03/05/2015
Reported:	03/10/2015	Sampling Type:	Soil
Project Name:	SHU- SATELITE #5	Sampling Condition:	Cool & Intact
Project Number:	OXY-14-022	Sample Received By:	Jodi Henson
Project Location:	HOBBS, NM		

Sample ID: SOUTH WALL (H500611-02)

BTEX 8021B		mg/kg		Analyzed By: ms					
Analyte	Result	Reporting Limit	Analyzed	Method Blank	BS	% Recovery	True Value QC	RPD	Qualifier
Benzene*	<0.050	0.050	03/09/2015	ND	1.96	97.8	2.00	10.5	
Toluene*	<0.050	0.050	03/09/2015	ND	1.84	91.9	2.00	6.52	
Ethylbenzene*	<0.050	0.050	03/09/2015	ND	2.09	105	2.00	7.91	
Total Xylenes*	<0.150	0.150	03/09/2015	ND	5.64	94.0	6.00	9.81	
Total BTEX	<0.300	0.300	03/09/2015	ND					

Surrogate: 4-Bromofluorobenzene (PID		114 %	61-154							
Chloride, SM4500Cl-B		mg/kg		Analyzed By: AP						

Analyte	Result	Reporting Limit	Analyzed	Method Blank	BS	% Recovery	True Value QC	RPD	Qualifier
Chloride	144	16.0	03/05/2015	ND	400	100	400	0.00	
TPH 8015M	mg/kg		Analyzed By: MS						

Analyte	Result	Reporting Limit	Analyzed	Method Blank	BS	% Recovery	True Value QC	RPD	Qualifier	
GRO C6-C10	<10.0	10.0	03/06/2015	ND	188	94.0	200	1.83		
DRO >C10-C28	<10.0	10.0	03/06/2015	ND	196	98.2	200	1.27		

Surrogate: 1-Chlorooctane 81.2 % 47.2-157

Surrogate: 1-Chlorooctadecane 86.8 % 52.1-176

Cardinal Laboratories

*=Accredited Analyte

PLEASE NOTE: Liability and Damages. Cardinal's liability and client's exclusive remedy for any claim arising, whether based in contract or tort, shall be limited to the amount paid by client for analyses. All claims, including those for negligence and any other cause whatsoever shall be deemed waived unless made in writing and received by Cardinal within thirty (30) days after completion of the applicable service. In no event shall Cardinal be liable for incidental or consequential damages, including, without limitation, business interruptions, loss of use, or loss of profits incurred by client, its subsidiaries, affiliates or successors arising out of or related to the performance of the services hereunder by Cardinal, regardless of whether such claim is based upon any of the above stated reasons or otherwise. Results relate only to the samples identified above. This report shall not be reproduced except in full with written approval of Cardinal Laboratories.

Celey D. Keene, Lab Director/Quality Manager

Notes and Definitions

ND	Analyte NOT DETECTED at or above the reporting limit
RPD	Relative Percent Difference
**	Samples not received at proper temperature of 6°C or below.
***	Insufficient time to reach temperature.
-	Chloride by SM4500Cl-B does not require samples be received at or below 6°C Samples reported on an as received basis (wet) unless otherwise noted on report

Cardinal Laboratories

*=Accredited Analyte

PLEASE NOTE: Liability and Damages. Cardinal's liability and client's exclusive remedy for any claim arising, whether based in contract or tort, shall be limited to the amount paid by client for analyses. All claims, including those for negligence and any other cause whatsoever shall be deemed waived unless made in writing and received by Cardinal within thirty (30) days after completion of the applicable service. In no event shall Cardinal be liable for incidental or consequential damages, including, without limitation, business interruptions, loss of use, or loss of profits incurred by client, its subsidiaries, affiliates or successors arising out of or related to the performance of the services hereunder by Cardinal, regardless of whether such claim is based upon any of the above stated reasons or otherwise. Results relate only to the samples identified above. This report shall not be reproduced except in full with written approval of Cardinal Laboratories.



Celey D. Keene, Lab Director/Quality Manager

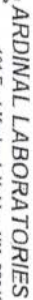

CHAIN-OF-CUSTODY AND ANALYSIS REQUEST

Company Name: Safety & Environmental Solutions, Inc. Project Manager: Bob Allen Address: 703 East Clinton City: Hobbs State: NM Zip: 88240 Phone #: 575-397-0510 Fax #: 575-393-4388 Project #: OKY-14-022 Project Owner: OKY Project Name: STH - SAREMEAS Project Location: Hobbs N.W. Sample Name: Sore-Jern <small>For Lab Use Only</small>																																									
Client: Same OKY Attn: Aquila Tany Address: 107 Stracy City: Hobbs State: NM Zip: 88240 Phone #: 575-398-6712																																									
Lab I.D. H500611 Sample I.D.																																									
<table border="1" style="width:100%; border-collapse: collapse;"> <tr> <th rowspan="2">ID</th> <th rowspan="2">Bottom (Ltr) Pass</th> <th rowspan="2">G.I.</th> <th rowspan="2">K</th> <th rowspan="2">DATE</th> <th rowspan="2">TIME</th> <th colspan="2">MATRIX</th> <th colspan="2">PRESERVE</th> <th rowspan="2">SAMPLING</th> </tr> <tr> <th>(G)RAB OR (C)OMP.</th> <th>#CONTAINERS</th> <th>GROUNDWATER</th> <th>WASTEWATER</th> <th>SOIL</th> <th>SLUDGE</th> <th>OTHER :</th> <th>ICE / COOL</th> <th>OTHER :</th> </tr> <tr> <td>2</td> <td>South Well</td> <td>51</td> <td>X</td> <td>03/05</td> <td>0915</td> <td>X</td> <td>X</td> <td>X</td> <td>X</td> <td>X</td> <td>X</td> </tr> </table>										ID	Bottom (Ltr) Pass	G.I.	K	DATE	TIME	MATRIX		PRESERVE		SAMPLING	(G)RAB OR (C)OMP.	#CONTAINERS	GROUNDWATER	WASTEWATER	SOIL	SLUDGE	OTHER :	ICE / COOL	OTHER :	2	South Well	51	X	03/05	0915	X	X	X	X	X	X
ID	Bottom (Ltr) Pass	G.I.	K	DATE	TIME	MATRIX		PRESERVE								SAMPLING																									
						(G)RAB OR (C)OMP.	#CONTAINERS	GROUNDWATER	WASTEWATER	SOIL	SLUDGE	OTHER :	ICE / COOL	OTHER :																											
2	South Well	51	X	03/05	0915	X	X	X	X	X	X																														
Temp. 5.0°C Sample Condition Cool Intact Checked By: [Signature] Delivered By: (Circle One) Temp. 5.0°C Sample Condition Cool Intact Checked By: [Signature] Sampler Relinquished: [Signature] Received By: [Signature] Relinquished By: [Signature] Received By: [Signature]																																									
Remarks:																																									

Appendix B

C-141

District I
1625 N. French Dr., Hobbs, NM 88240
District II
1301 W. Grand Avenue, Artesia, NM 88210
District III
1000 Rio Brazos Road, Aztec, NM 87410
District IV
1220 S. St. Francis Dr., Santa Fe, NM 87505

State of New Mexico
Energy Minerals and Natural Resources

Oil Conservation Division
1220 South St. Francis Dr.
Santa Fe, NM 87505

Form C-141
Revised October 10, 2003

Submit 2 Copies to appropriate
District Office in accordance
with Rule 116 on back
side of form

Release Notification and Corrective Action

OPERATOR

☐ Initial Report ☒ Final Report

Name of Company: OXY	Contact: Raymond Aguilar	
Address: 1017 W Stanolind Road	Telephone No. 575-390-6312	
Facility Name: Satellite 5 Liquid Trunkline	Facility Production Trunkline	
Surface Owner: OXY	Mineral Owner:	API No.

LOCATION OF RELEASE

Unit Letter K	Section 4	Township 19S	Range 38E	Feet from the	North/South Line	Feet from the	East/West Line	County Lea
------------------	--------------	-----------------	--------------	---------------	------------------	---------------	----------------	---------------

Latitude: 32.688280 Longitude: -103.1569

NATURE OF RELEASE

Type of Release: Oil and Produced Water	Volume of Release: 2 BBLS oil 40 BBLS water	Volume Recovered:
Source of Release: 6in fiberglass production trunkline	Date and Hour of Occurrence: 8/15/2014	Date and Hour of Discovery 8/15/2014
Was Immediate Notice Given? <input checked="" type="checkbox"/> Yes <input type="checkbox"/> No <input type="checkbox"/> Not Required	If YES, To Whom? Tomas Oberding	
By Whom? Raymond (Tony) Aguilar	Date and Hour: 8/15/2014 12:20pm	
Was a Watercourse Reached? <input type="checkbox"/> Yes <input checked="" type="checkbox"/> No	If YES, Volume Impacting the Watercourse	

If a Watercourse was Impacted, Describe Fully.*

Describe Cause of Problem and Remedial Action Taken.*

Cause of leak was by human error. A line was struck by a track hoe.

Describe Area Affected and Cleanup Action Taken.*

Safety & Environmental Solutions, Inc. has remediated the site in accordance with NMOCD guidelines and respectfully requests closure of the regulatory file for this site.

I hereby certify that the information given above is true and complete to the best of my knowledge and understand that pursuant to NMOCD rules and regulations all operators are required to report and/or file certain release notifications and perform corrective actions for releases which may endanger public health or the environment. The acceptance of a C-141 report by the NMOCD marked as "Final Report" does not relieve the operator of liability should their operations have failed to adequately investigate and remediate contamination that pose a threat to ground water, surface water, human health or the environment. In addition, NMOCD acceptance of a C-141 report does not relieve the operator of responsibility for compliance with any other federal, state, or local laws and/or regulations.

OIL CONSERVATION DIVISION

Signature: 
Printed Name: Tony Aguilar

Approved by District Supervisor:

Title: HES Specialist

Approval Date:

Expiration Date:

E-mail Address: Raymond_Aguilar@oxy.com

Conditions of Approval:

Attached ☐

Date: 8-26-15 Phone: 575-390-6312

* Attach Additional Sheets If Necessary

Appendix C

Site Photographs

