

AP-125

2017 Annual Report

March 2018

**2 of 2
(Appendix G)**



Environmental Challenges
BUSINESS SOLUTIONS®

Roswell Station Remediation Site

Chaves County, NM

EarthCon Plume Analytics™ Services

Transwestern Pipeline Company, LLC

Date

The material contained in this presentation, including text, graphic representations and the oral description thereof, is the sole and exclusive property of EarthCon Consultants, Inc. and is considered Proprietary and Confidential. This material, or any copy, facsimile, photograph or other reproduction of whatever kind, may not be disseminated to any third party without the express written consent of EarthCon Consultants, Inc.

1,1-DCA

1,1-DCE

Benzene

PSH

1,1-DCA

1,1-DCA
Jan-1996

Concentration ($\mu\text{g/L}$)

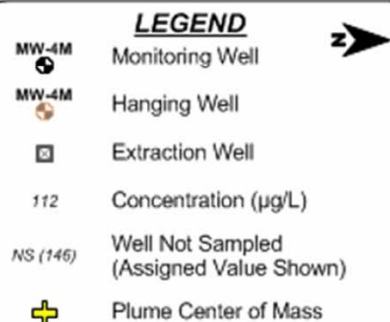
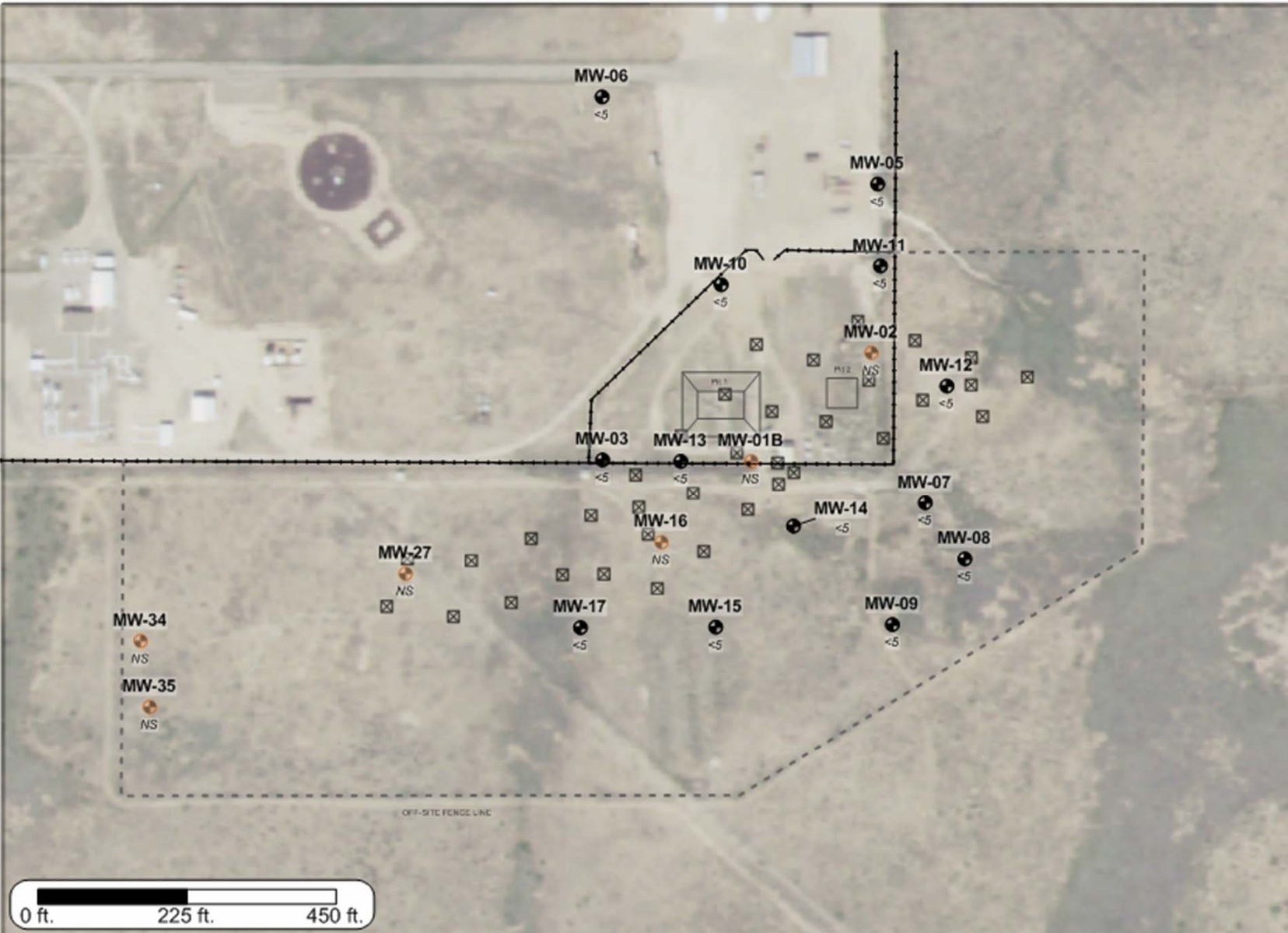
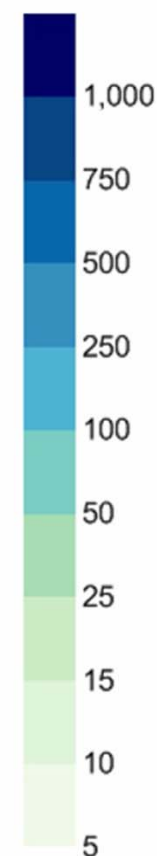

Plume Characteristics

Plume Area: **0.000 acres**
 Plume Average Concentration: **< 5.0 $\mu\text{g/L}$**
 Plume Mass Indicator: **0.000 lbs**

This analysis requires fixed data points within a fixed area for the purposes of assessing relative changes of area, average concentration, and mass indicator over time. Therefore, any created isopleth maps are not intended to be a depiction or model of the actual plume but rather is meant to show conceptual behavior of the aforementioned metrics over time.

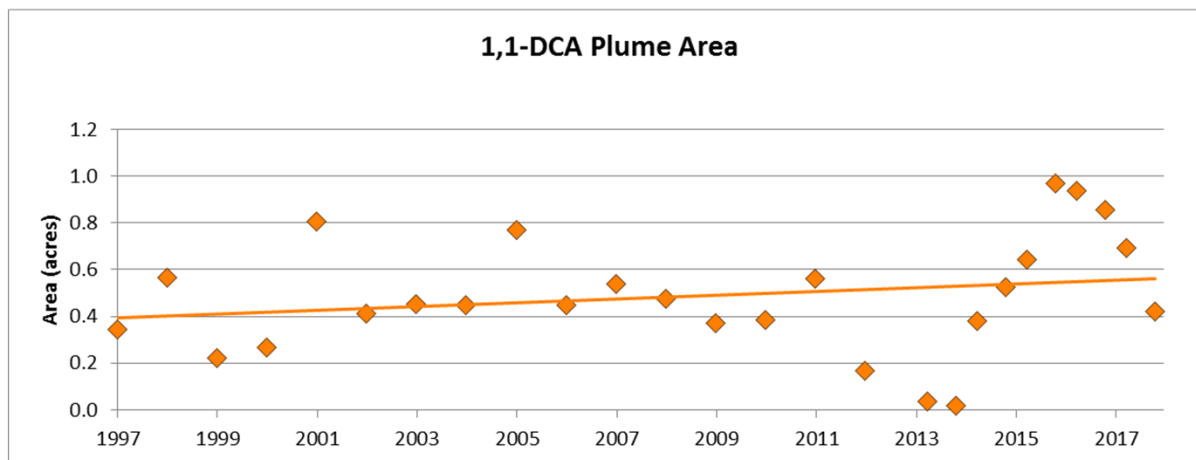

Jan-1997 to Nov-2017
 No Trend
 Mann-Kendall: 90% Confidence
 Regression: 71% Confidence

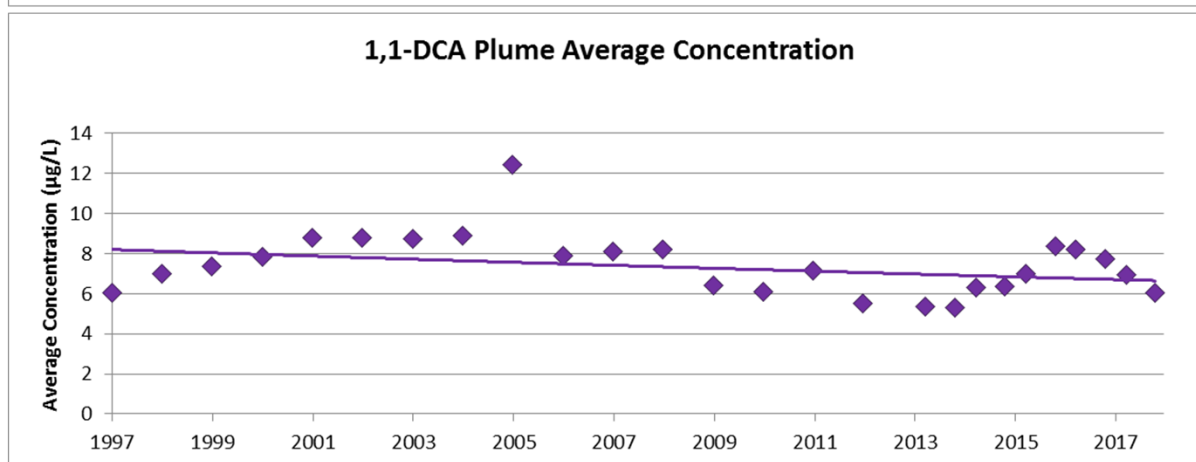

Jan-1997 to Nov-2017
 Decreasing Trend
 Mann-Kendall: 93% Confidence
 Regression: 92% Confidence

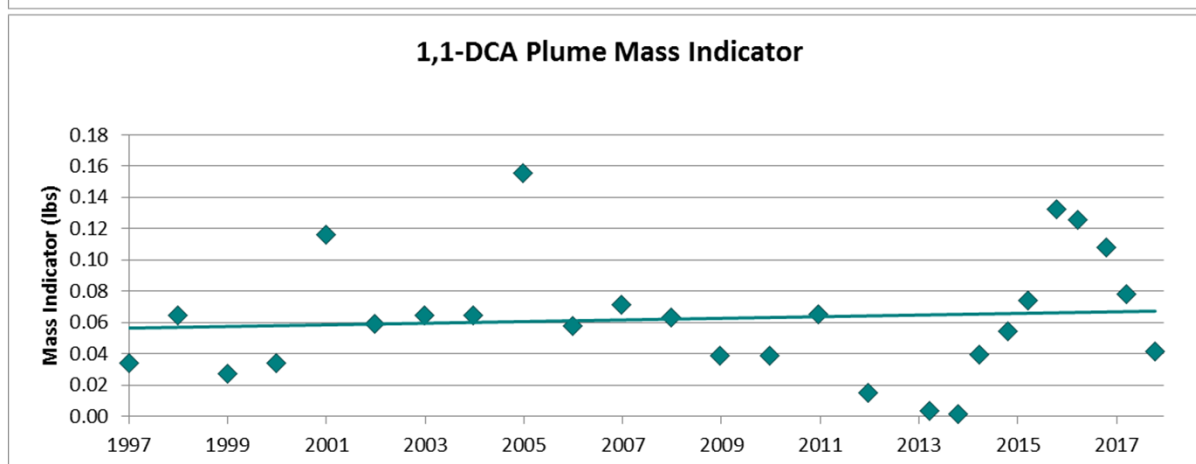

Jan-1997 to Nov-2017
 No Trend
 Mann-Kendall: 82% Confidence
 Regression: 33% Confidence

Groundwater Elevation Correlation

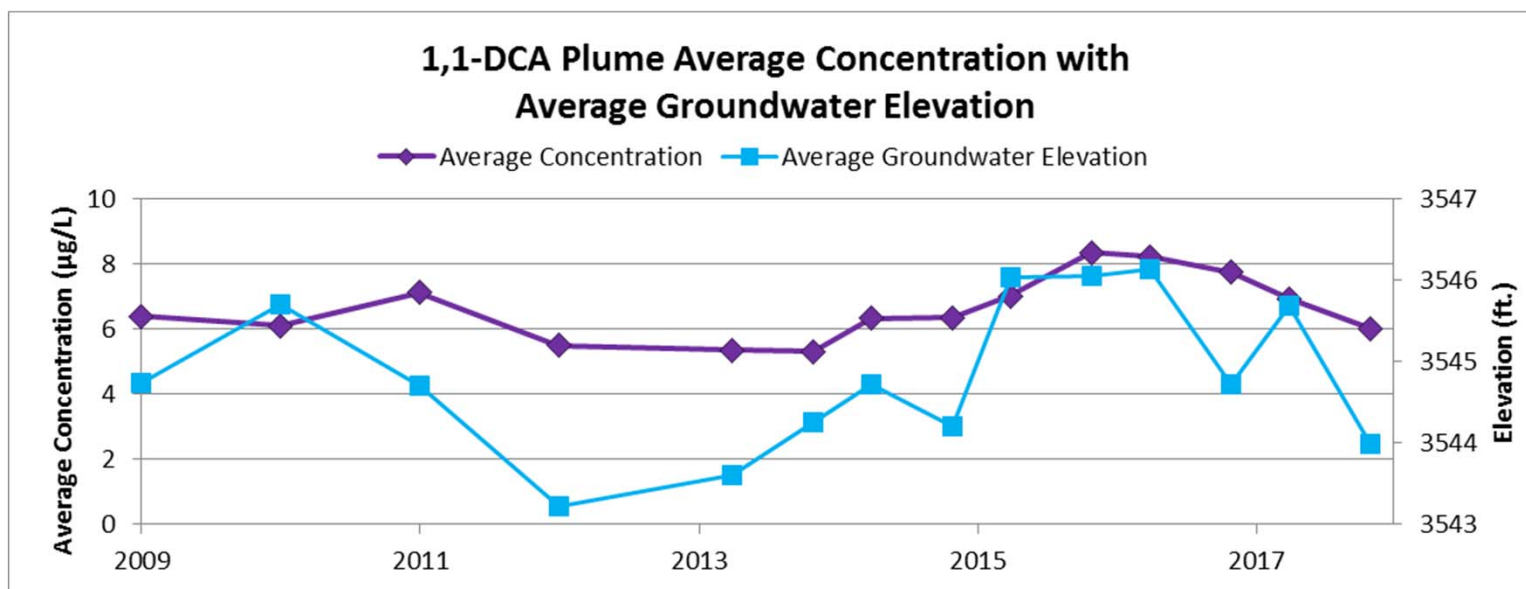

Correlation: 0.75

1,1-DCA Center of Mass

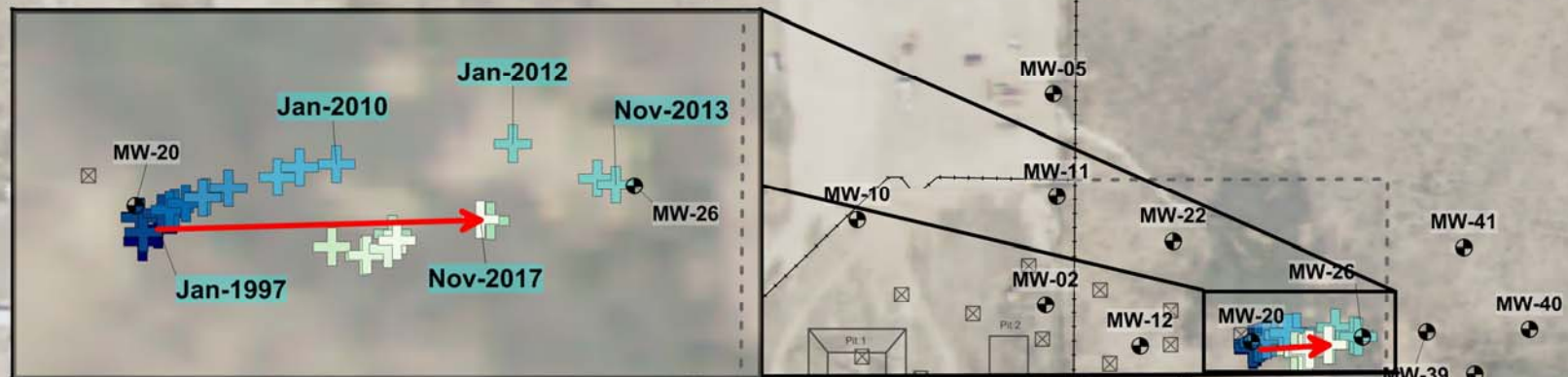

0 ft. 50 ft. 100 ft.

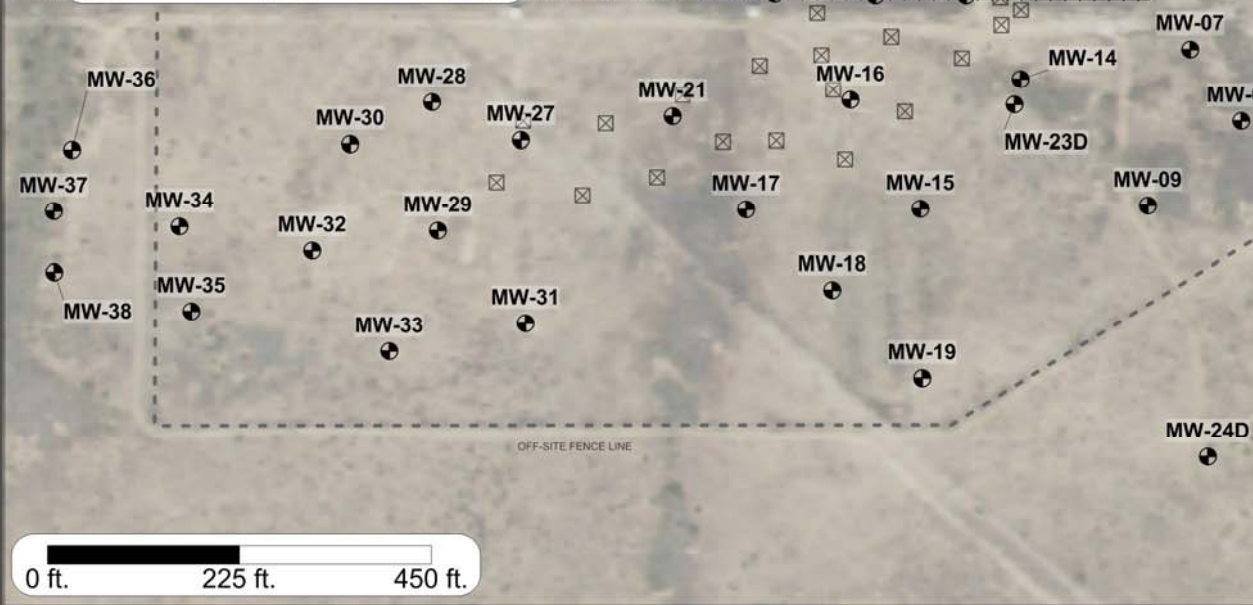

0 ft. 225 ft. 450 ft.

- LEGEND**
- MW-4M Monitoring Well
 - Extraction Well
 - Center of Mass Movement
 - Net Movement

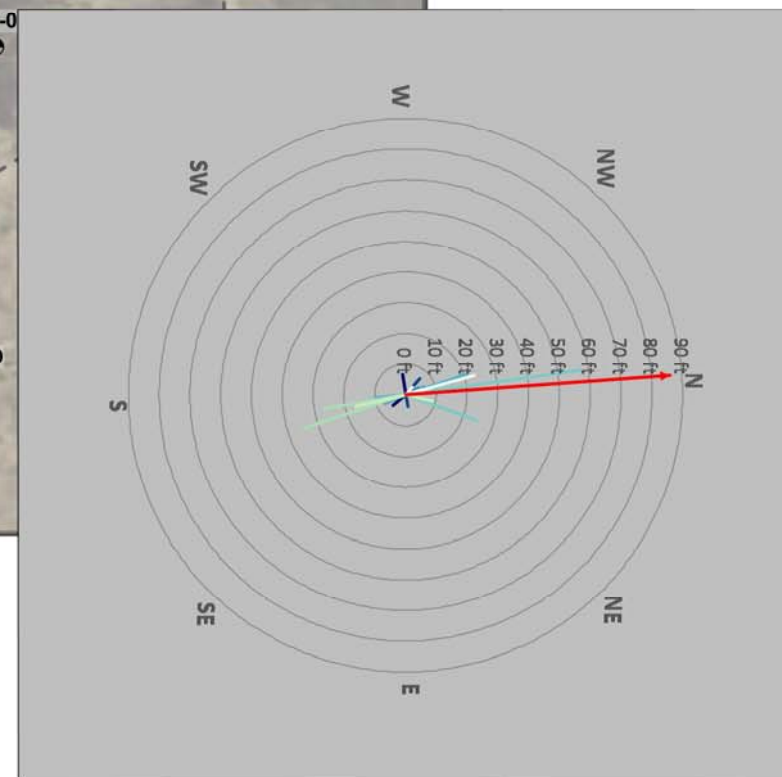
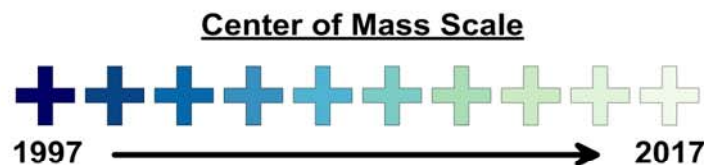

This analysis requires fixed data points within a fixed area for the purposes of assessing relative changes of area, average concentration, and mass indicator over time. Therefore, any created isopleth maps are not intended to be a depiction or model of the actual plume but rather is meant to show conceptual behavior of the aforementioned metrics over time.



Environmental Challenges
BUSINESS SOLUTIONS®

© EarthCon 2018

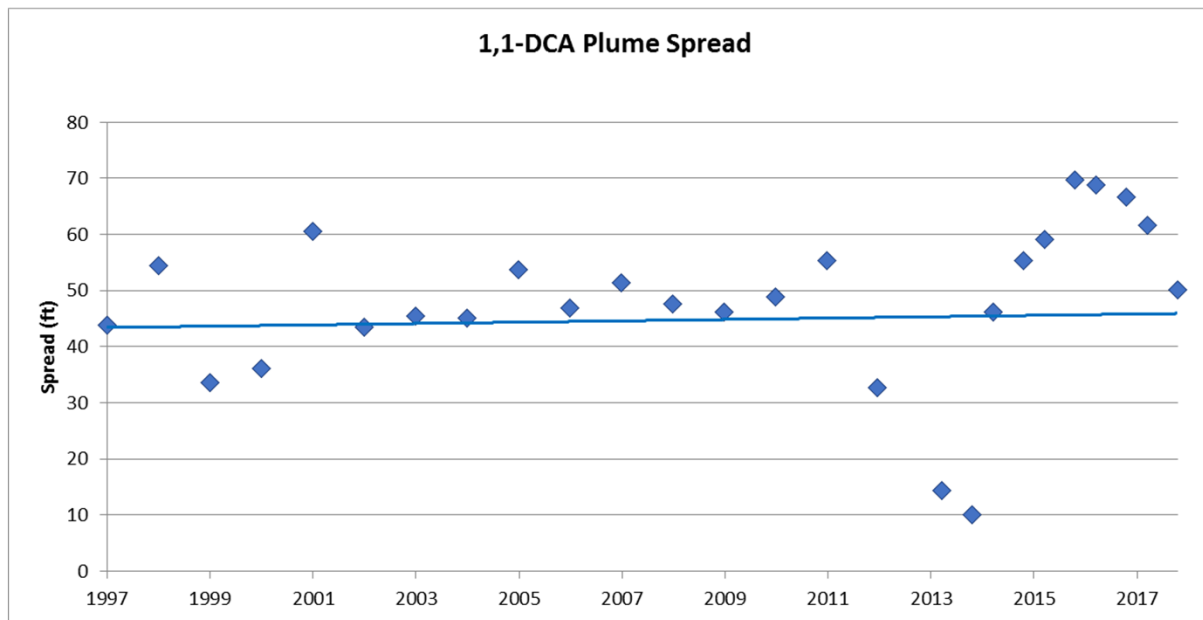

Jan-1997 to Nov-2017
No Trend/Increasing Trend
Mann-Kendall: 99% Confidence
Regression: 69% Confidence

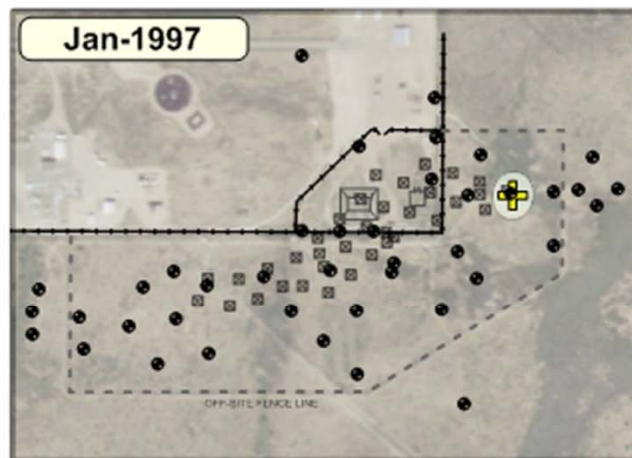

Concentration ($\mu\text{g/L}$)

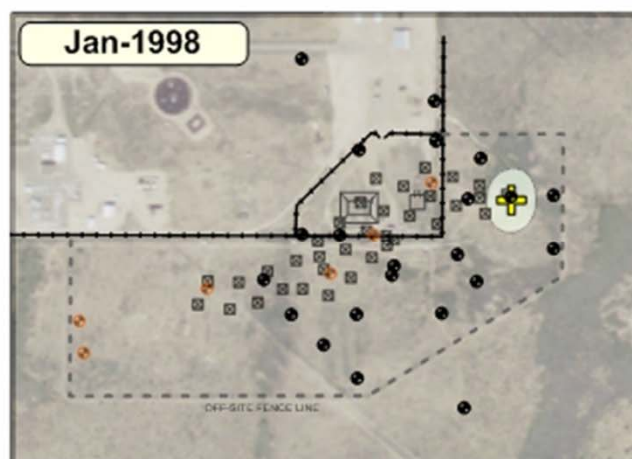
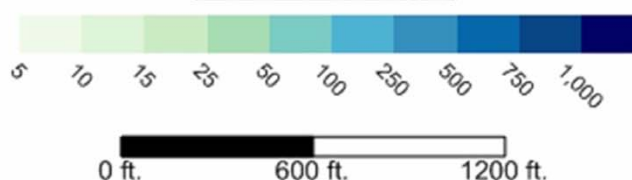

1,1-DCA

Plume Differences Jan-1997 vs Jan-1998

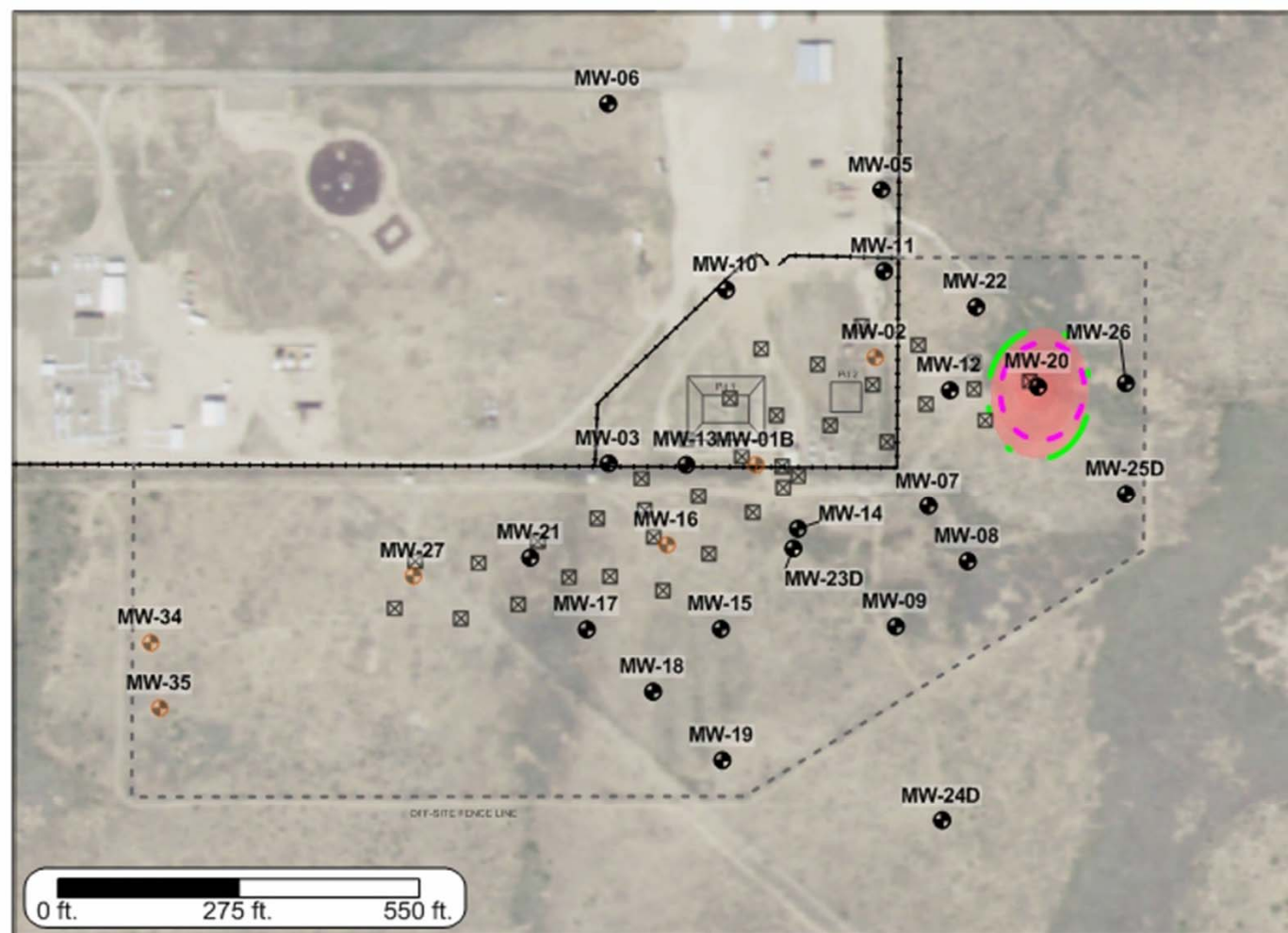

Spatial Change Indicator

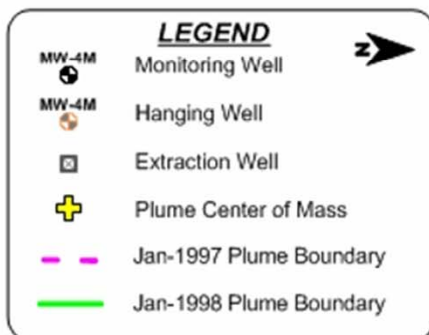

Plume Characteristics

- Area: **65% Increase**
- Average Concentration: **15% Increase**
- Mass Indicator: **90% Increase**
- Mass Increase: **0.01 lbs Increase**
- Mass Decrease: **0.00 lbs Decrease**

This analysis requires fixed data points within a fixed area for the purposes of assessing relative changes of area, average concentration, and mass indicator over time. Therefore, any created isopleth maps are not intended to be a depiction or model of the actual plume but rather is meant to show conceptual behavior of the aforementioned metrics over time.

1,1-DCE

1,1-DCE
Jan-1996

Concentration ($\mu\text{g/L}$)

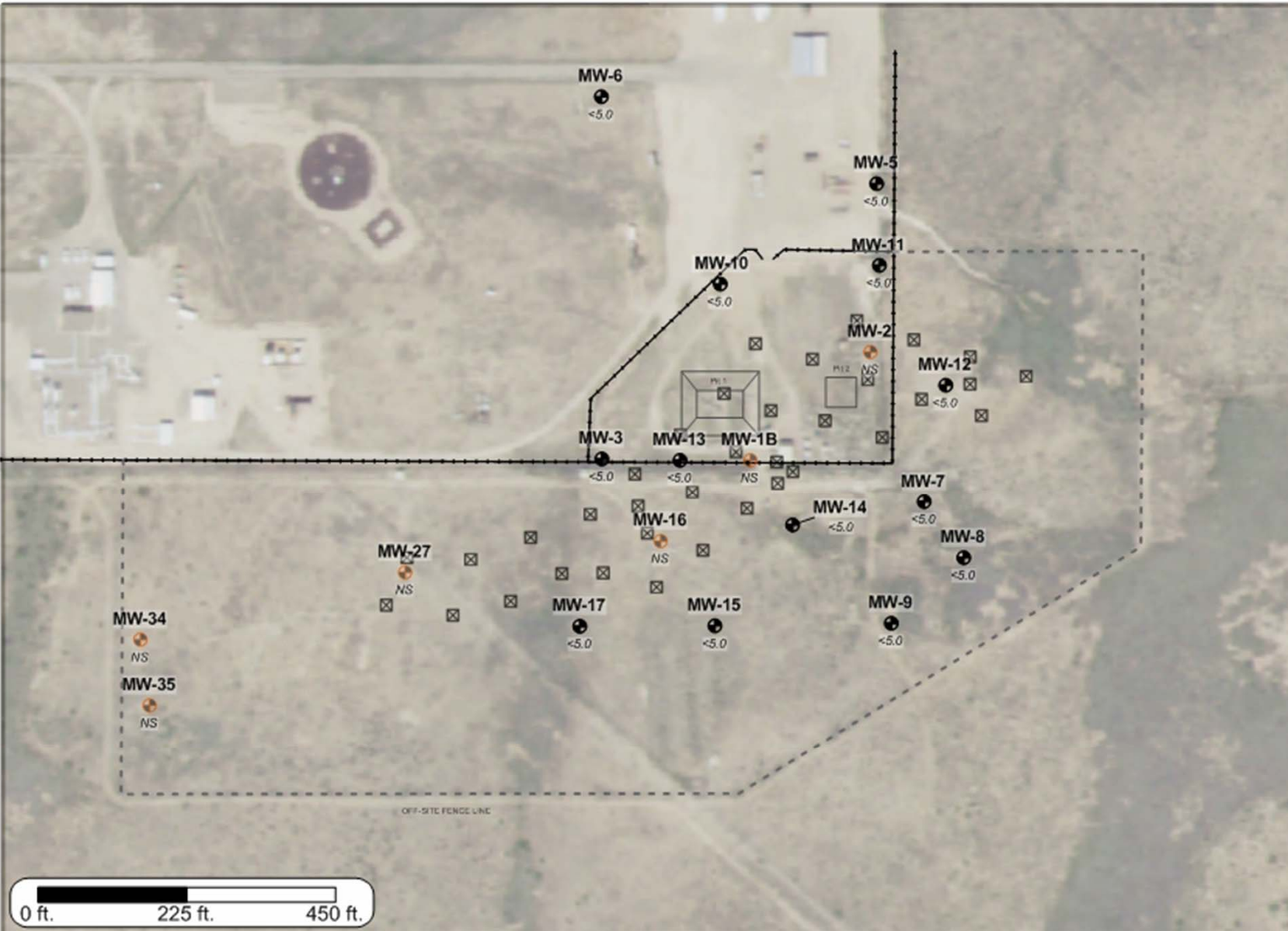
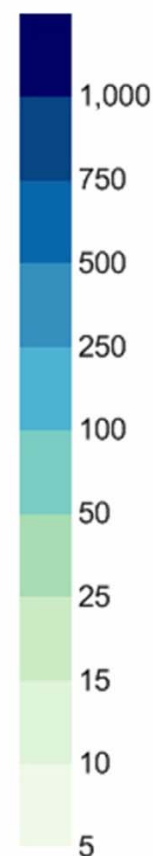

LEGEND

- MW-4M Monitoring Well
- MW-4M Hanging Well
- Extraction Well
- 112 Concentration ($\mu\text{g/L}$)
- NS (146) Well Not Sampled (Assigned Value Shown)
- Plume Center of Mass

Plume Characteristics

Plume Area: **0.000 acres**
 Plume Average Concentration: **< 5.0 $\mu\text{g/L}$**
 Plume Mass Indicator: **0.000 lbs**

This analysis requires fixed data points within a fixed area for the purposes of assessing relative changes of area, average concentration, and mass indicator over time. Therefore, any created isopleth maps are not intended to be a depiction or model of the actual plume but rather is meant to show conceptual behavior of the aforementioned metrics over time.

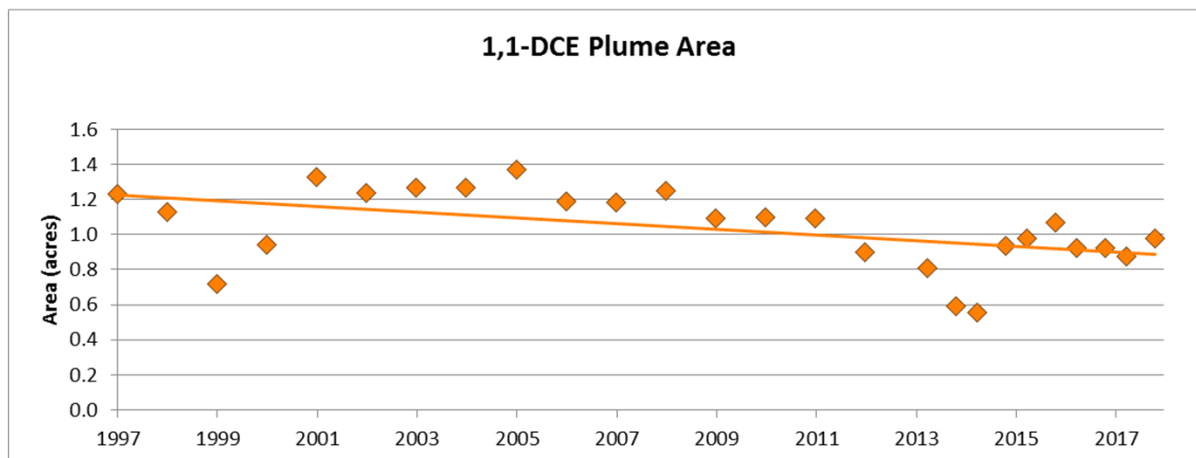

Jan-1997 to Nov-2017
 Decreasing Trend
 Mann-Kendall: 100% Confidence
 Regression: 99% Confidence

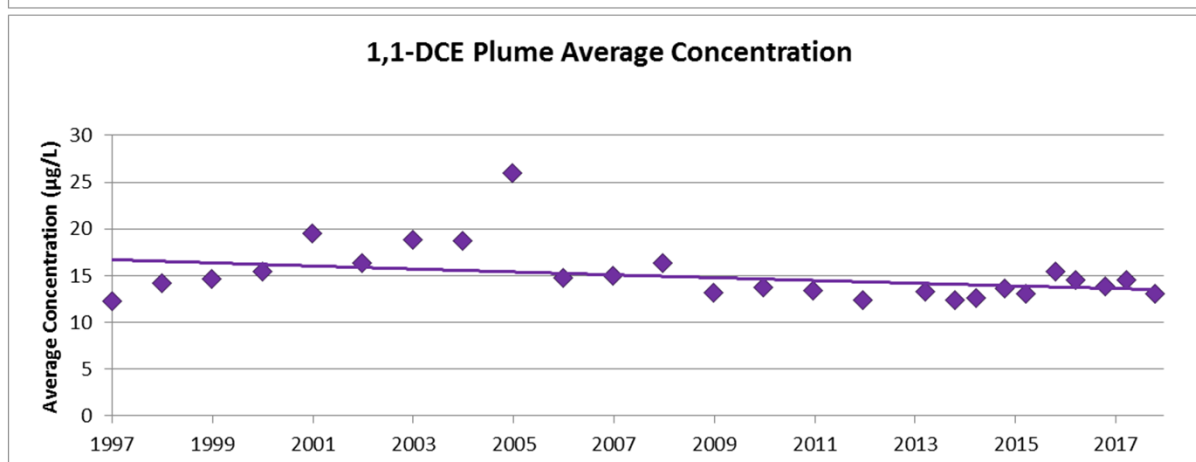

Jan-1997 to Nov-2017
 Decreasing Trend
 Mann-Kendall: 95% Confidence
 Regression: 95% Confidence

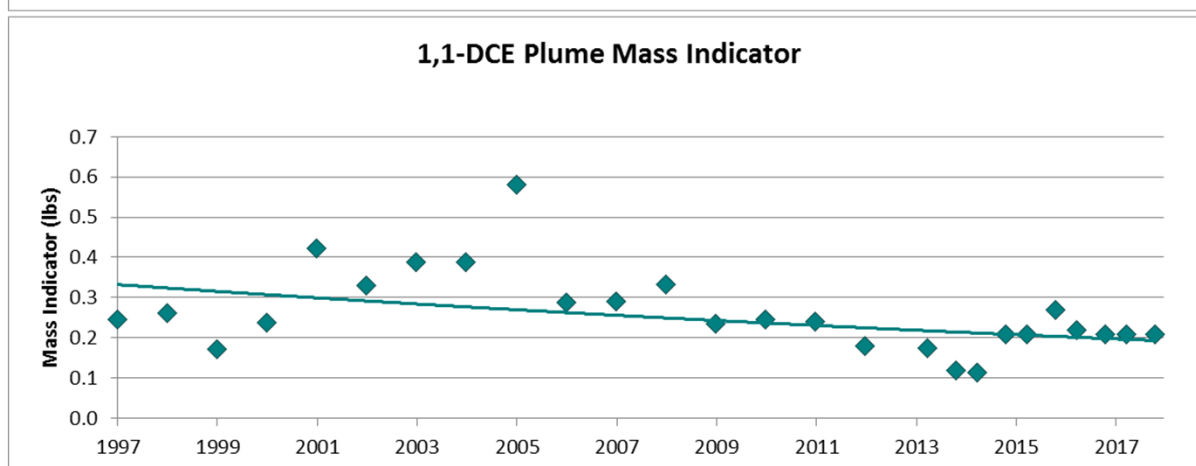

Jan-1997 to Nov-2017
 Decreasing Trend
 Mann-Kendall: 100% Confidence
 Regression: 99% Confidence

Groundwater Elevation Correlation

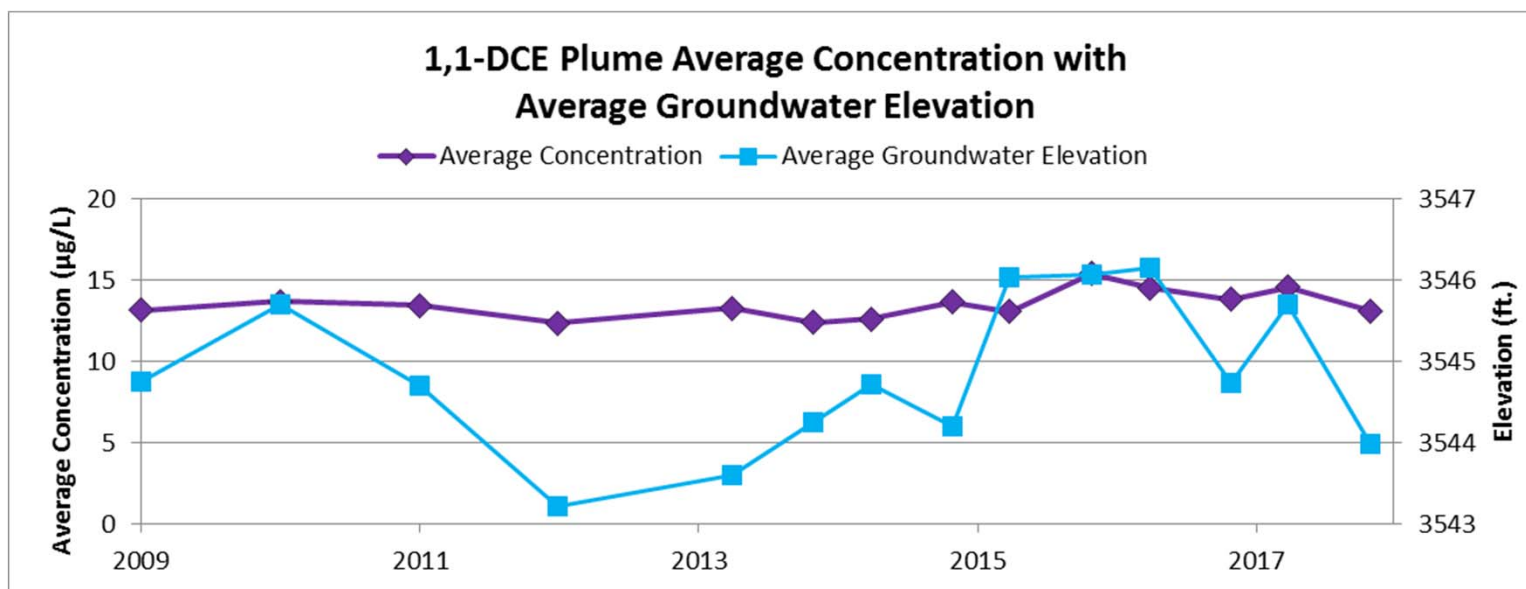

Correlation: 0.69

1,1-DCE Center of Mass

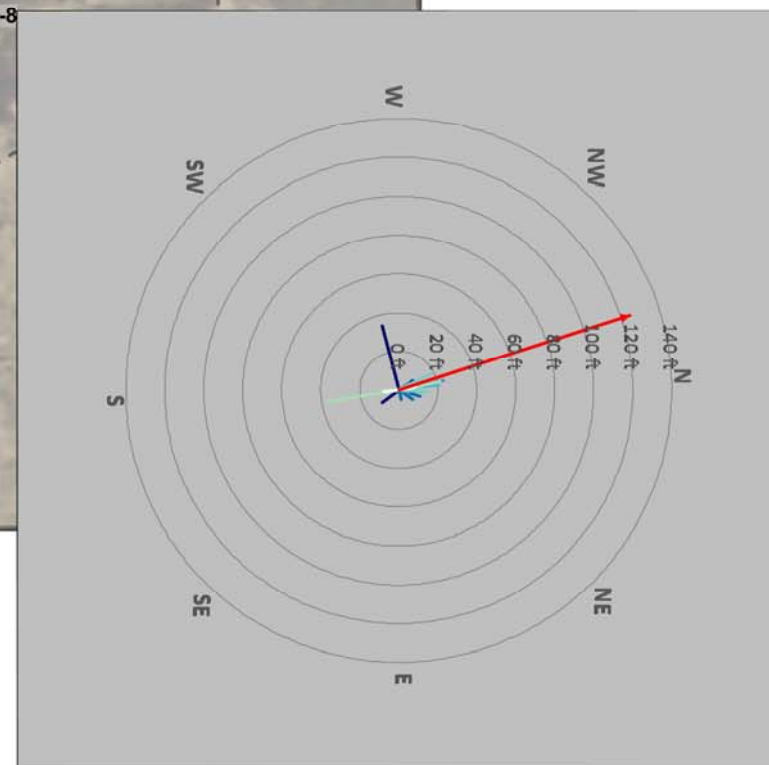
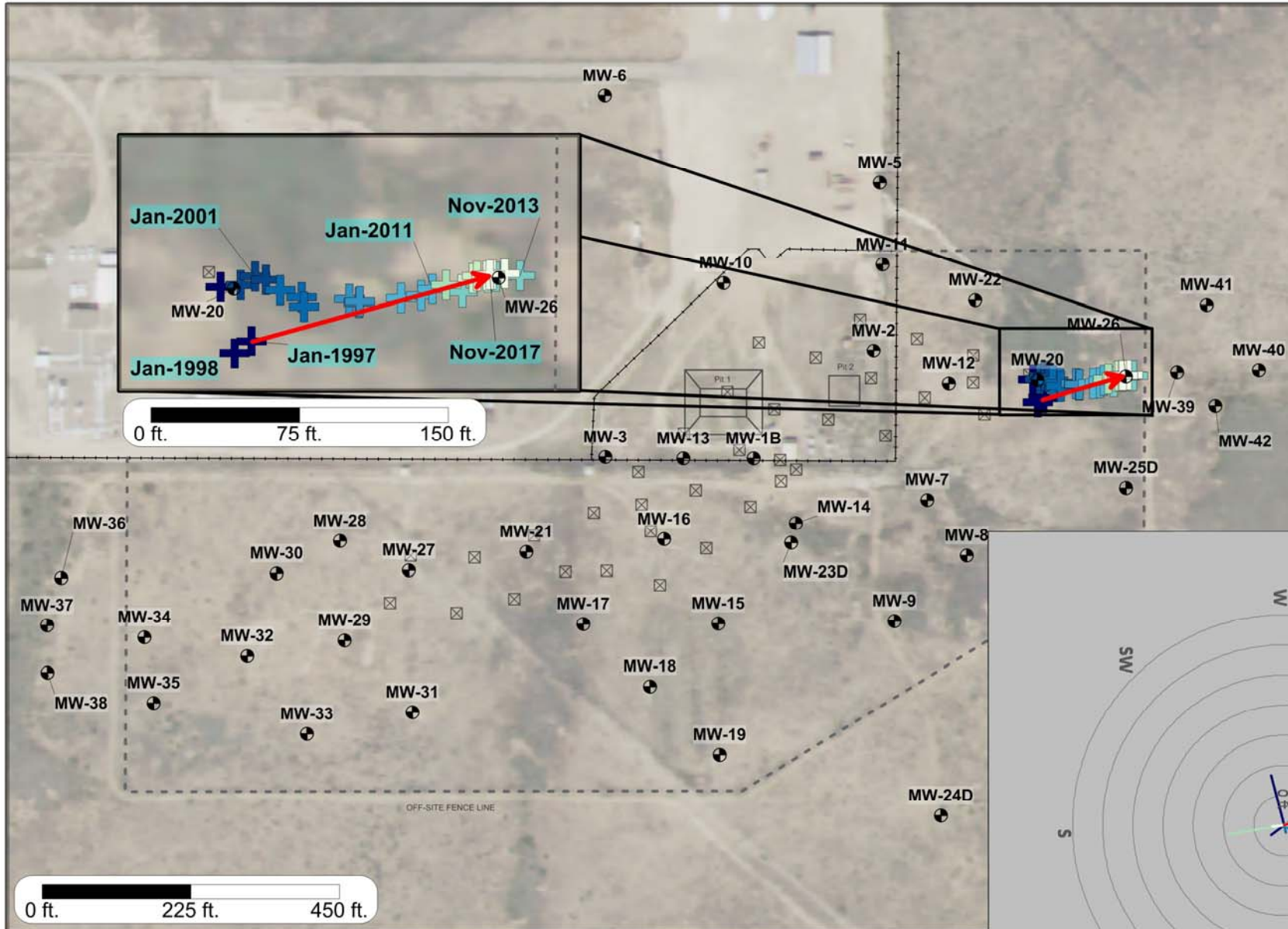

This analysis requires fixed data points within a fixed area for the purposes of assessing relative changes of area, average concentration, and mass indicator over time. Therefore, any created isopleth maps are not intended to be a depiction or model of the actual plume but rather is meant to show conceptual behavior of the aforementioned metrics over time.



Environmental Challenges
BUSINESS SOLUTIONS®

© EarthCon 2018

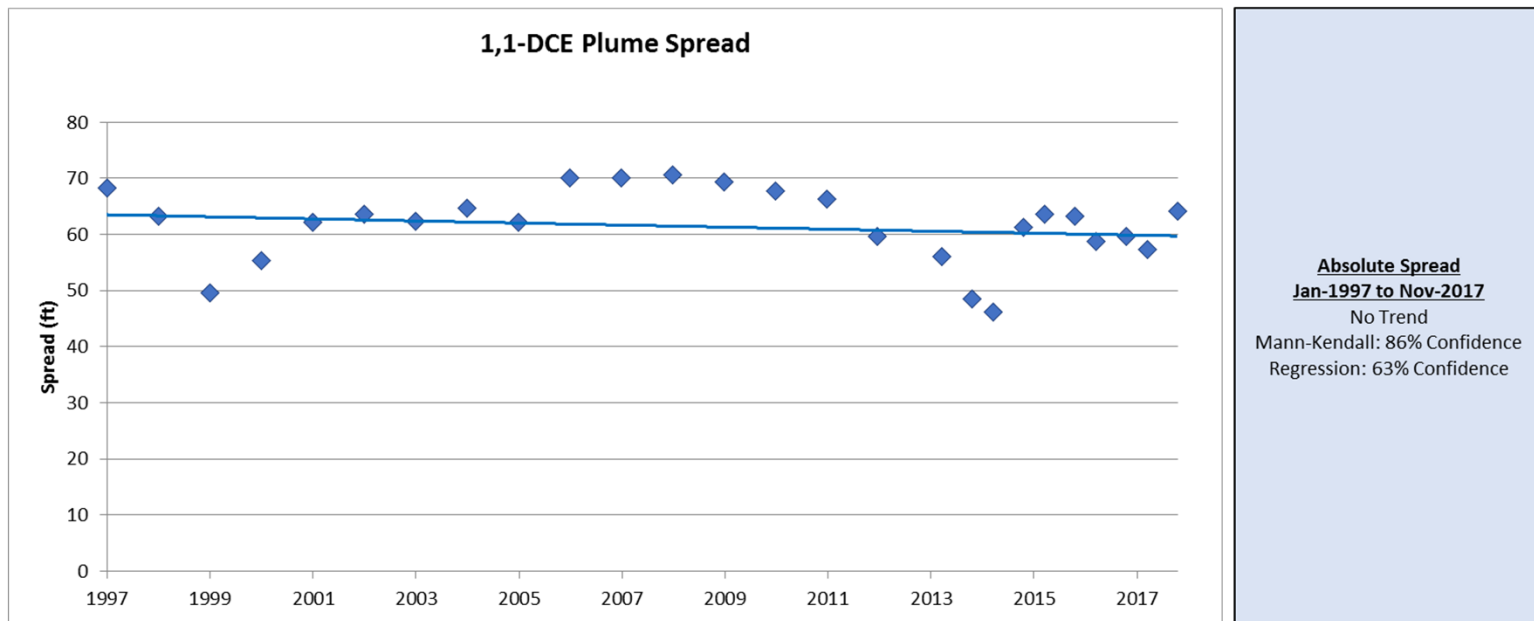

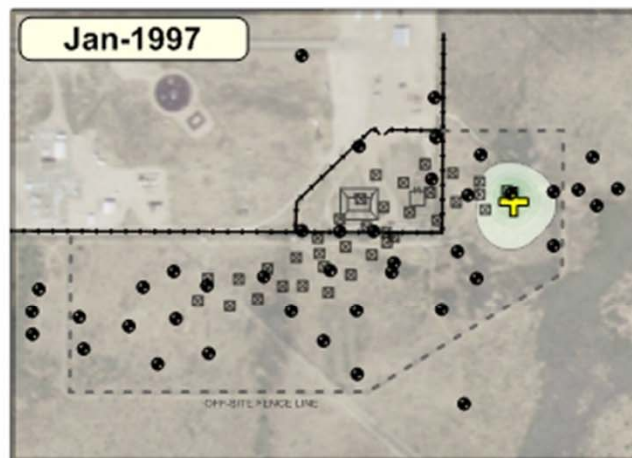

Concentration ($\mu\text{g/L}$)

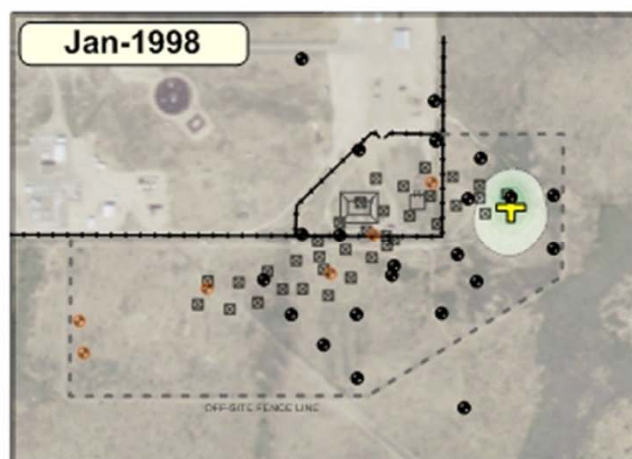
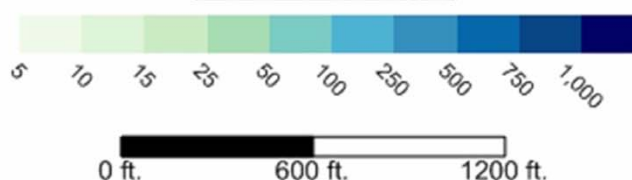

1,1-DCE

Plume Differences Jan-1997 vs Jan-1998

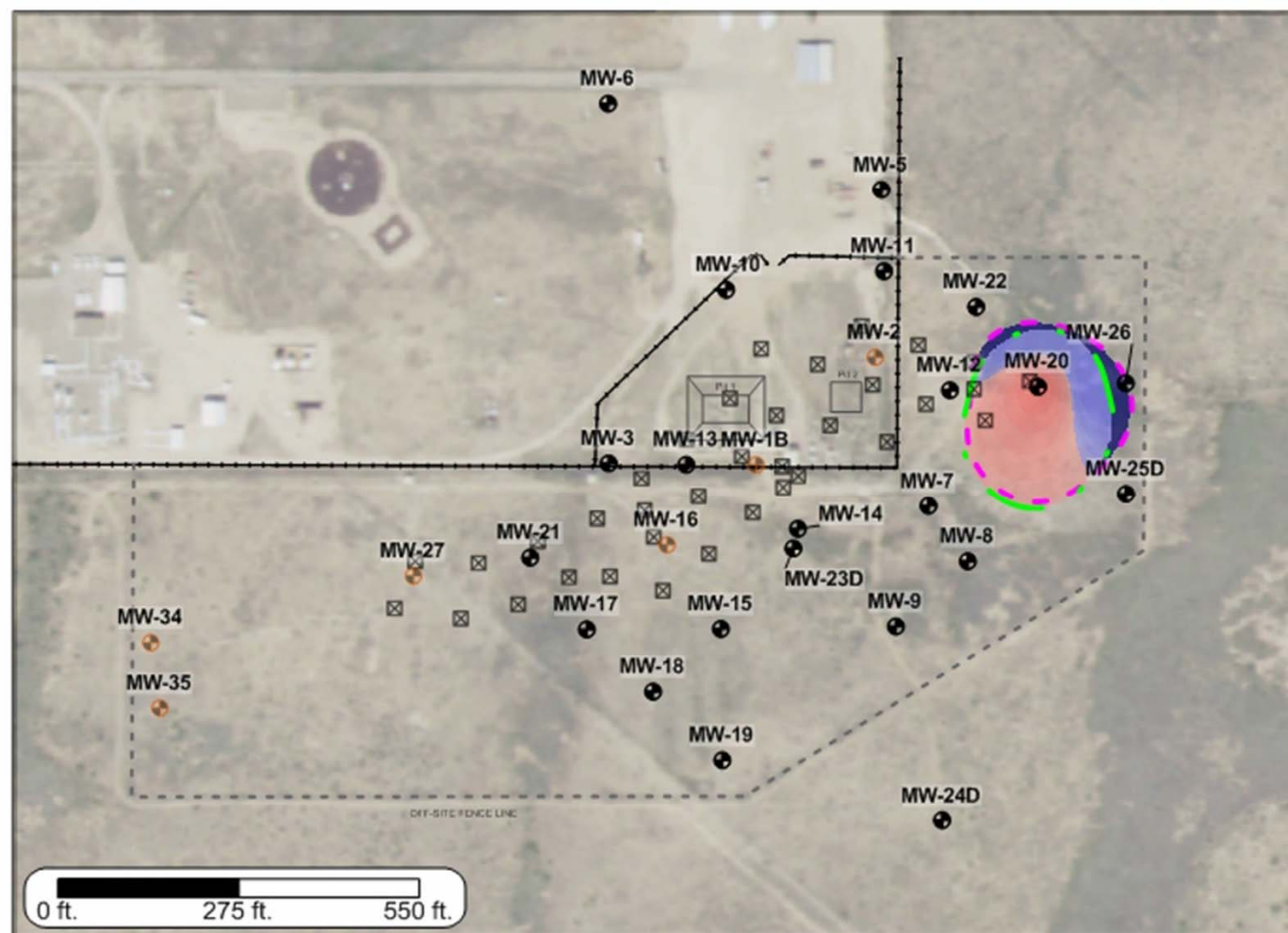

Spatial Change Indicator



LEGEND

- MW-4M Monitoring Well
- MW-4M Hanging Well
- Extraction Well
- Plume Center of Mass
- Jan-1997 Plume Boundary
- Jan-1998 Plume Boundary

Plume Characteristics

Area: **8% Decrease**
 Average Concentration: **16% Increase**
 Mass Indicator: **6% Increase**
 Mass Increase: **0.03 lbs Increase**
 Mass Decrease: **0.01 lbs Decrease**

This analysis requires fixed data points within a fixed area for the purposes of assessing relative changes of area, average concentration, and mass indicator over time. Therefore, any created isopleth maps are not intended to be a depiction or model of the actual plume but rather is meant to show conceptual behavior of the aforementioned metrics over time.



Environmental Challenges
BUSINESS SOLUTIONS

© EarthCon 2018

Benzene

Benzene Jan-1996

Concentration ($\mu\text{g/L}$)

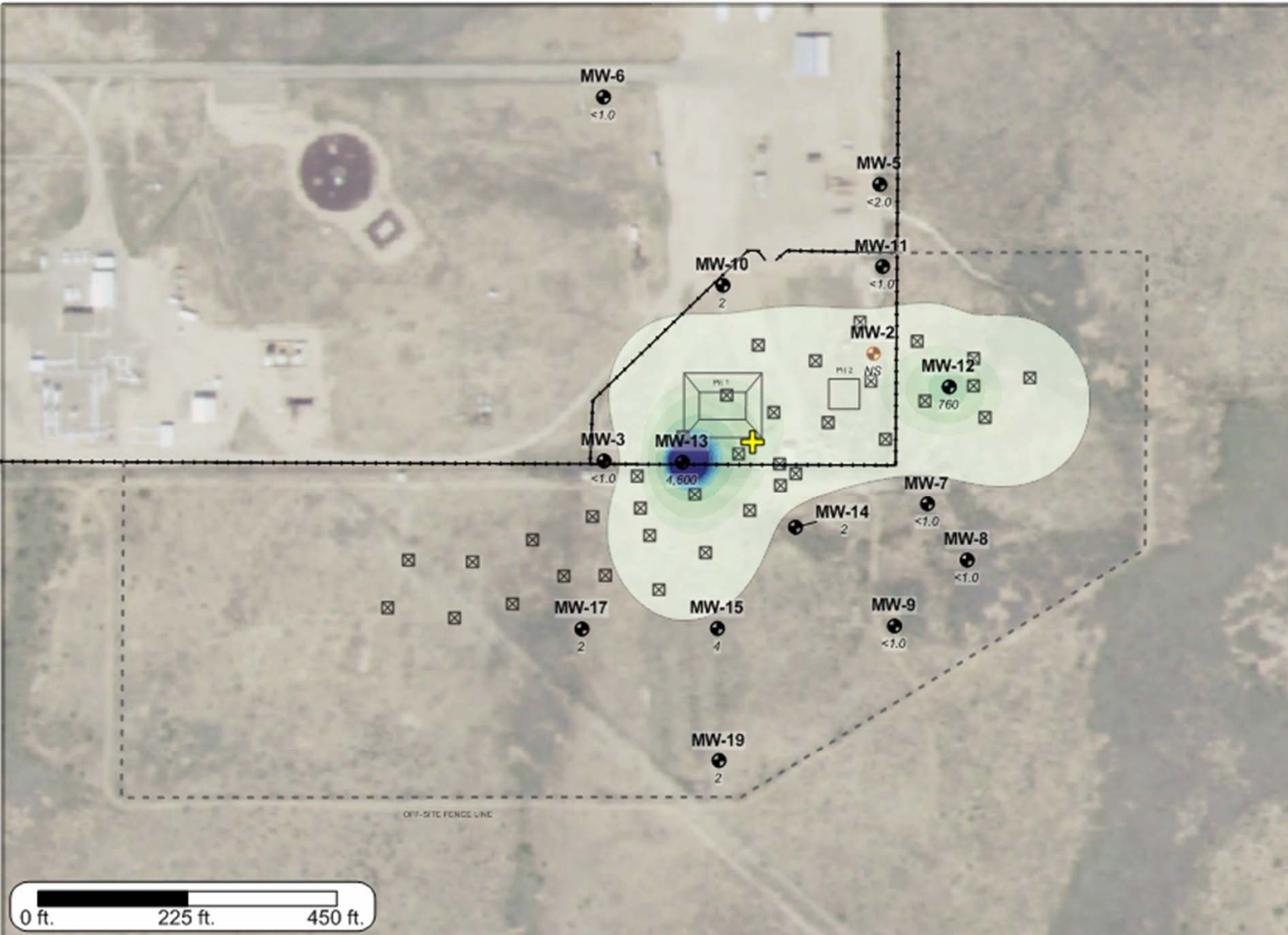
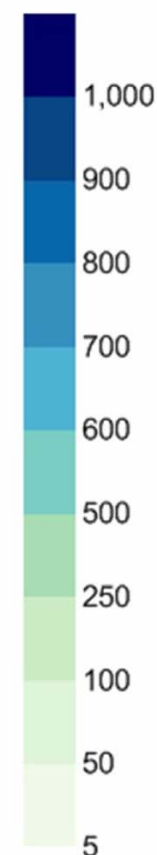

- LEGEND**
- MW-4M Monitoring Well
 - MW-4M Hanging Well
 - Extraction Well
 - 112 Concentration ($\mu\text{g/L}$)
 - NS (146) Well Not Sampled (Assigned Value Shown)
 - Plume Center of Mass

Plume Characteristics

Plume Area: **5.1 acres**
 Plume Average Concentration: **82.8 $\mu\text{g/L}$**
 Plume Mass Indicator: **6.9 lbs**

This analysis requires fixed data points within a fixed area for the purposes of assessing relative changes of area, average concentration, and mass indicator over time. Therefore, any created isopleth maps are not intended to be a depiction or model of the actual plume but rather is meant to show conceptual behavior of the aforementioned metrics over time.



Environmental Challenges
 BUSINESS SOLUTIONS[®]
 © EarthCon 2018

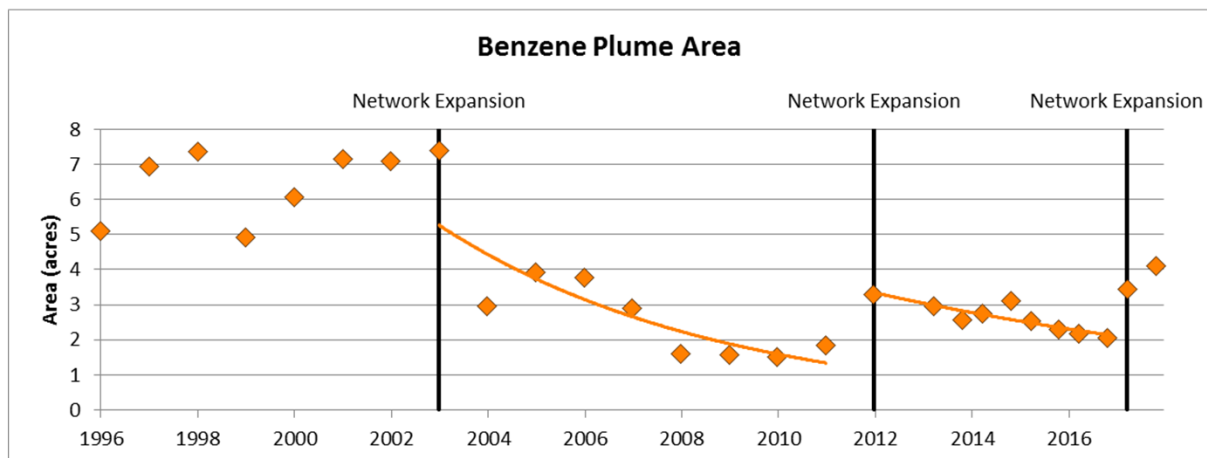

Jan-2003 to Jan-2011
Decreasing Trend
Mann-Kendall: >99% Confidence
Regression: >99% Confidence

Jan-2012 to Nov-2016
Decreasing Trend
Mann-Kendall: >99% Confidence
Regression: >99% Confidence

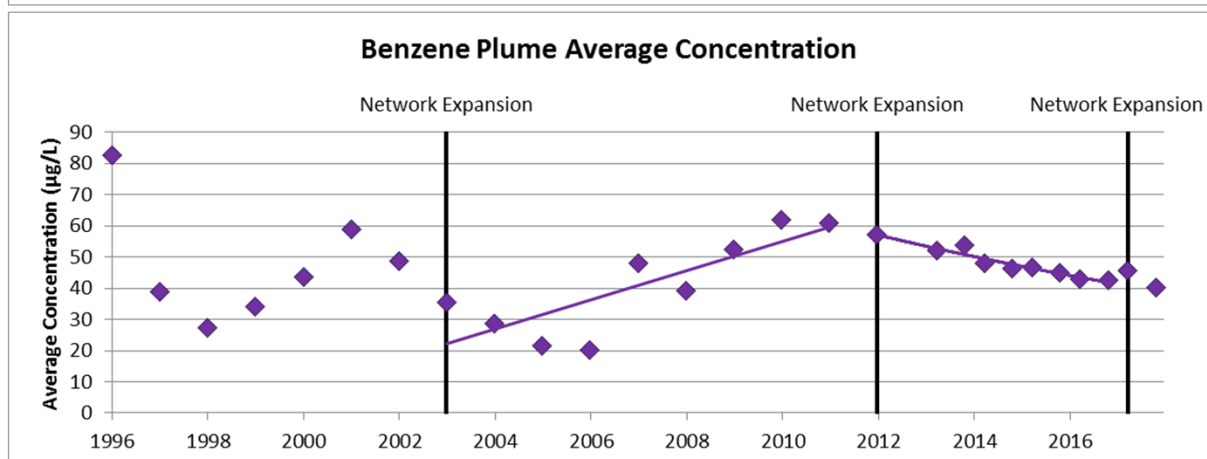

Jan-2003 to Jan-2011
Increasing Trend
Mann-Kendall: 98% Confidence
Regression: 99% Confidence

Jan-2012 to Nov-2016
Decreasing Trend
Mann-Kendall: >99% Confidence
Regression: >99% Confidence

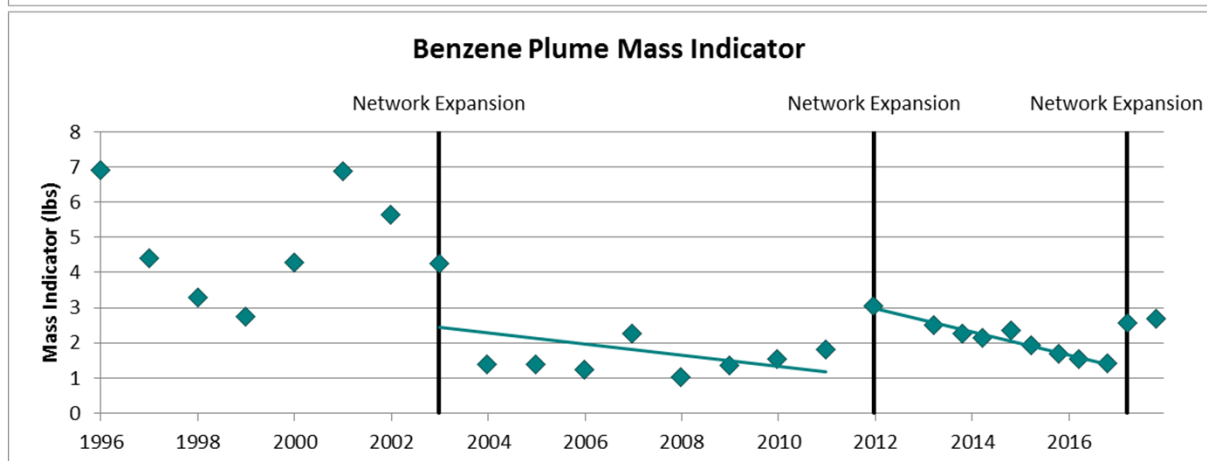

Jan-2003 to Jan-2011
No Trend
Mann-Kendall: 54% Confidence
Regression: 77% Confidence

Jan-2012 to Nov-2016
Decreasing Trend
Mann-Kendall: >99% Confidence
Regression: >99% Confidence

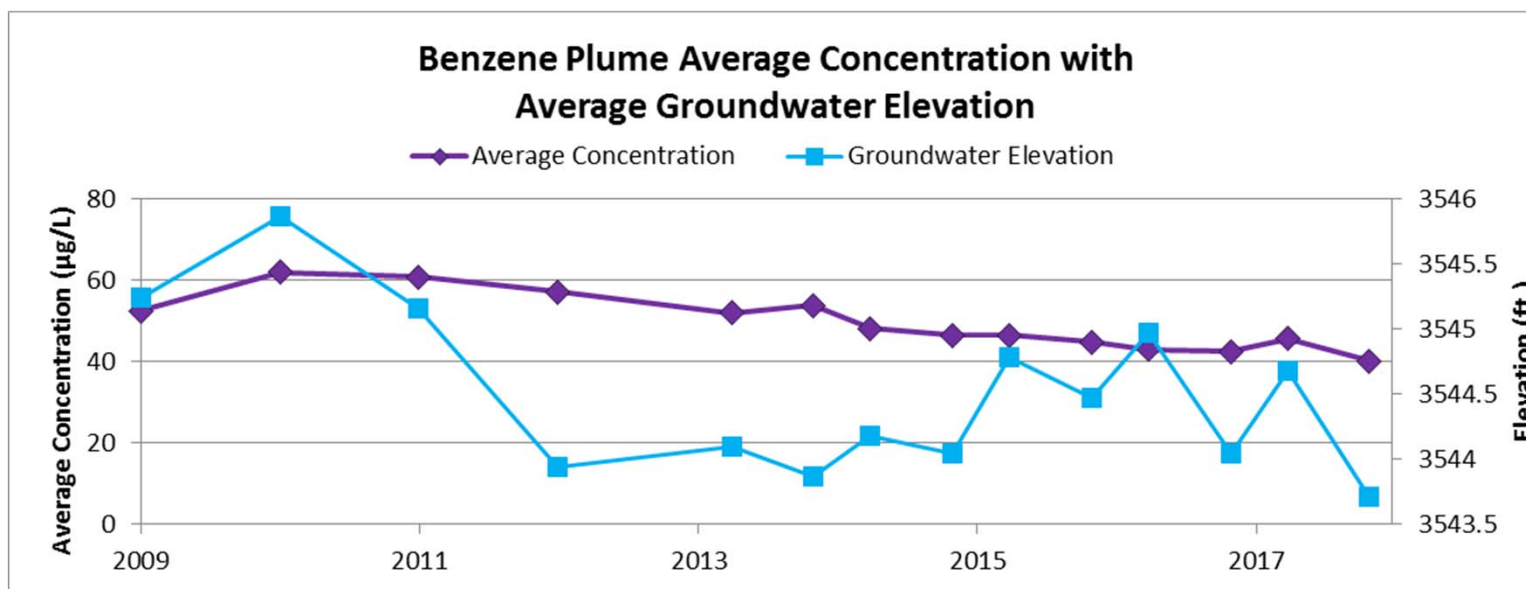

Benzene Center of Mass

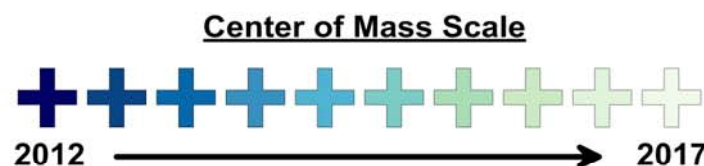
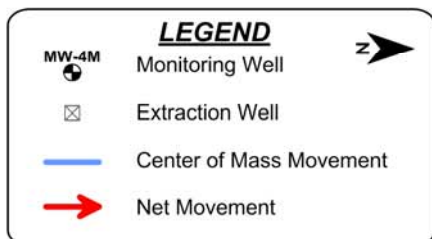
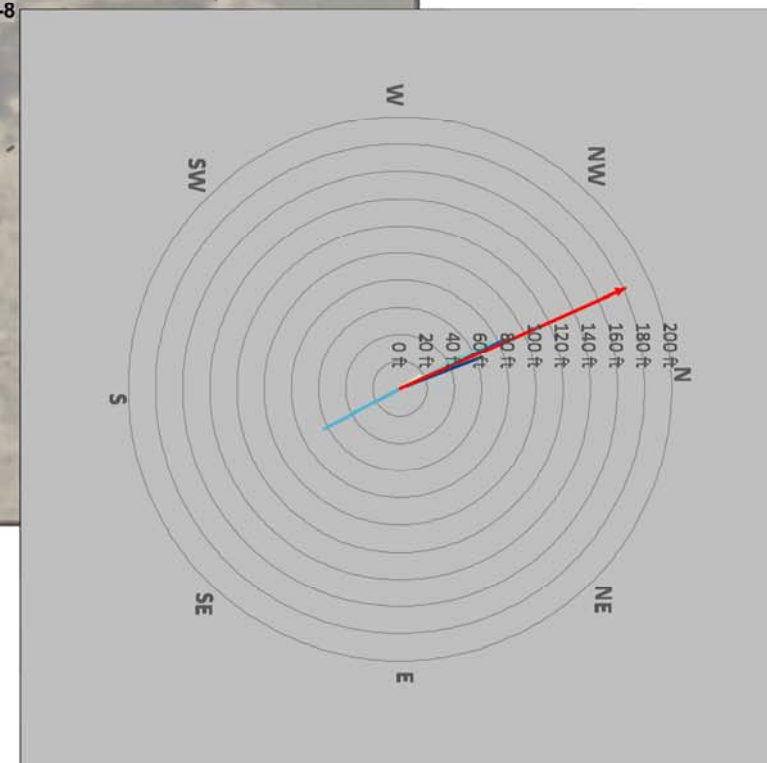
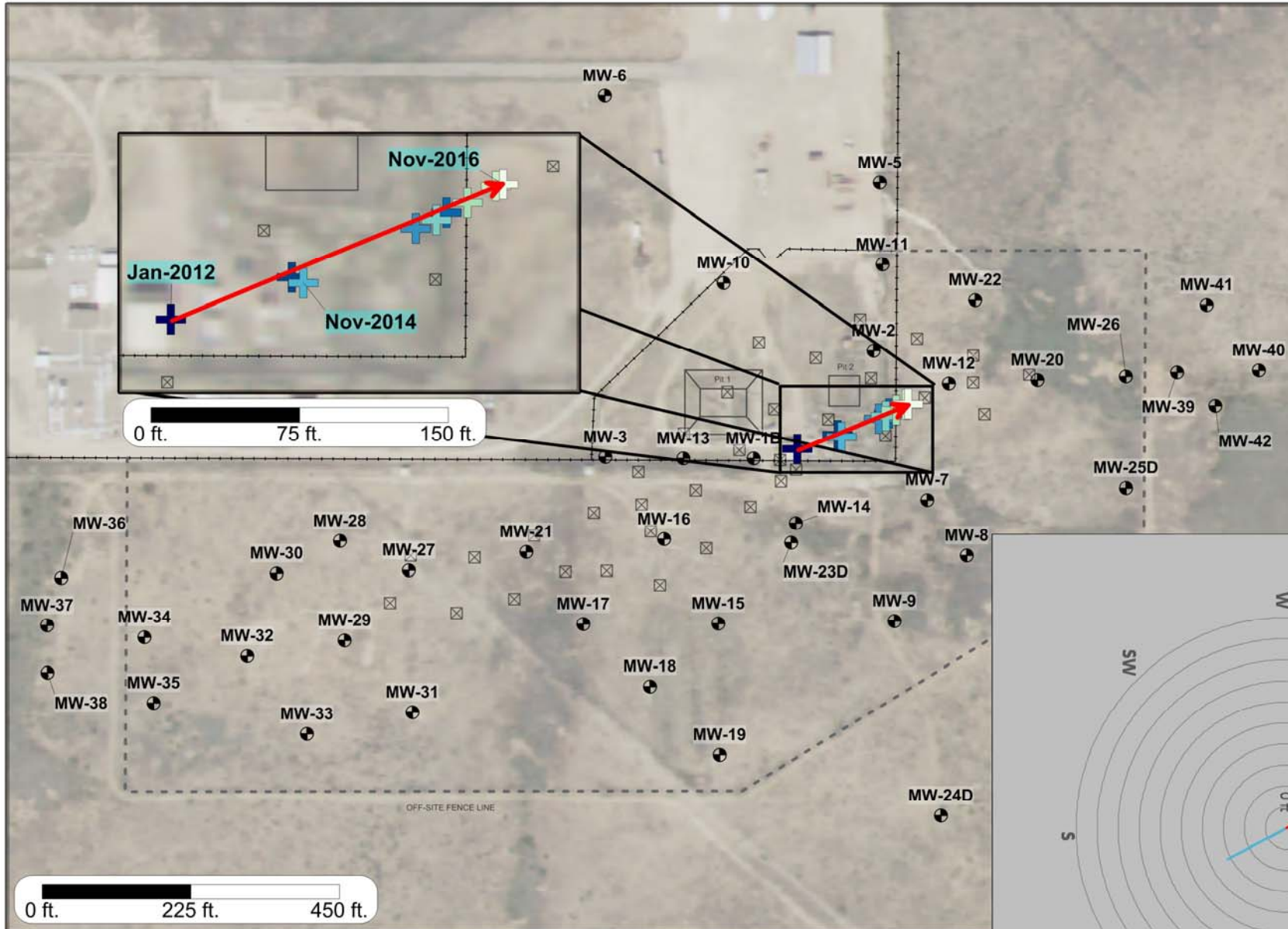

This analysis requires fixed data points within a fixed area for the purposes of assessing relative changes of area, average concentration, and mass indicator over time. Therefore, any created isopleth maps are not intended to be a depiction or model of the actual plume but rather is meant to show conceptual behavior of the aforementioned metrics over time.

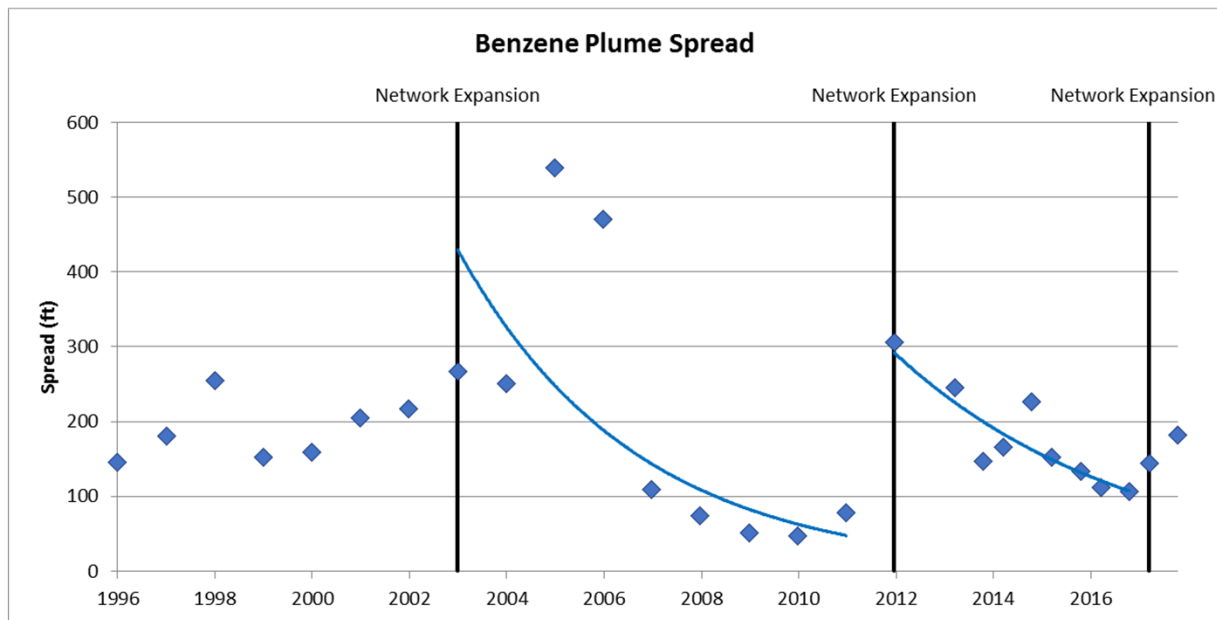

Jan-2003 to Jan-2011
Decreasing Trend
Mann-Kendall: 99% Confidence
Regression: 99% Confidence

Jan-2012 to Nov-2016
Decreasing Trend
Mann-Kendall: >99% Confidence
Regression: >99% Confidence

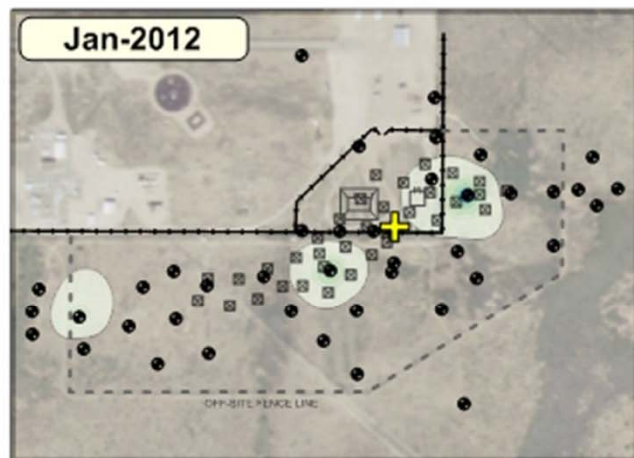

Concentration ($\mu\text{g/L}$)

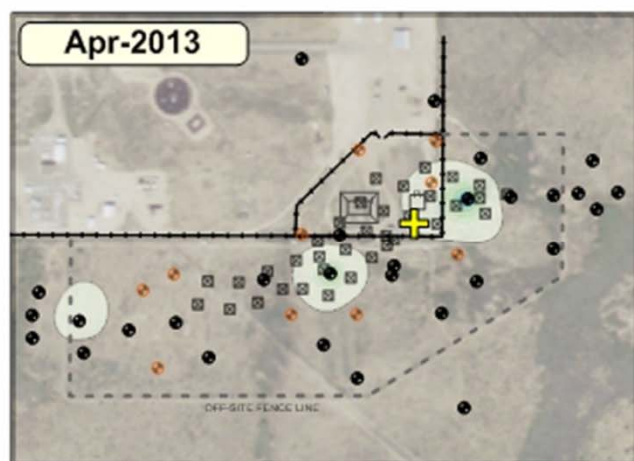
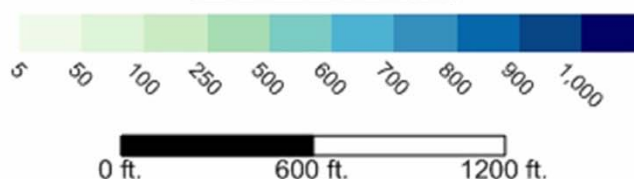

Benzene

Plume Differences Jan-2012 vs Apr-2013

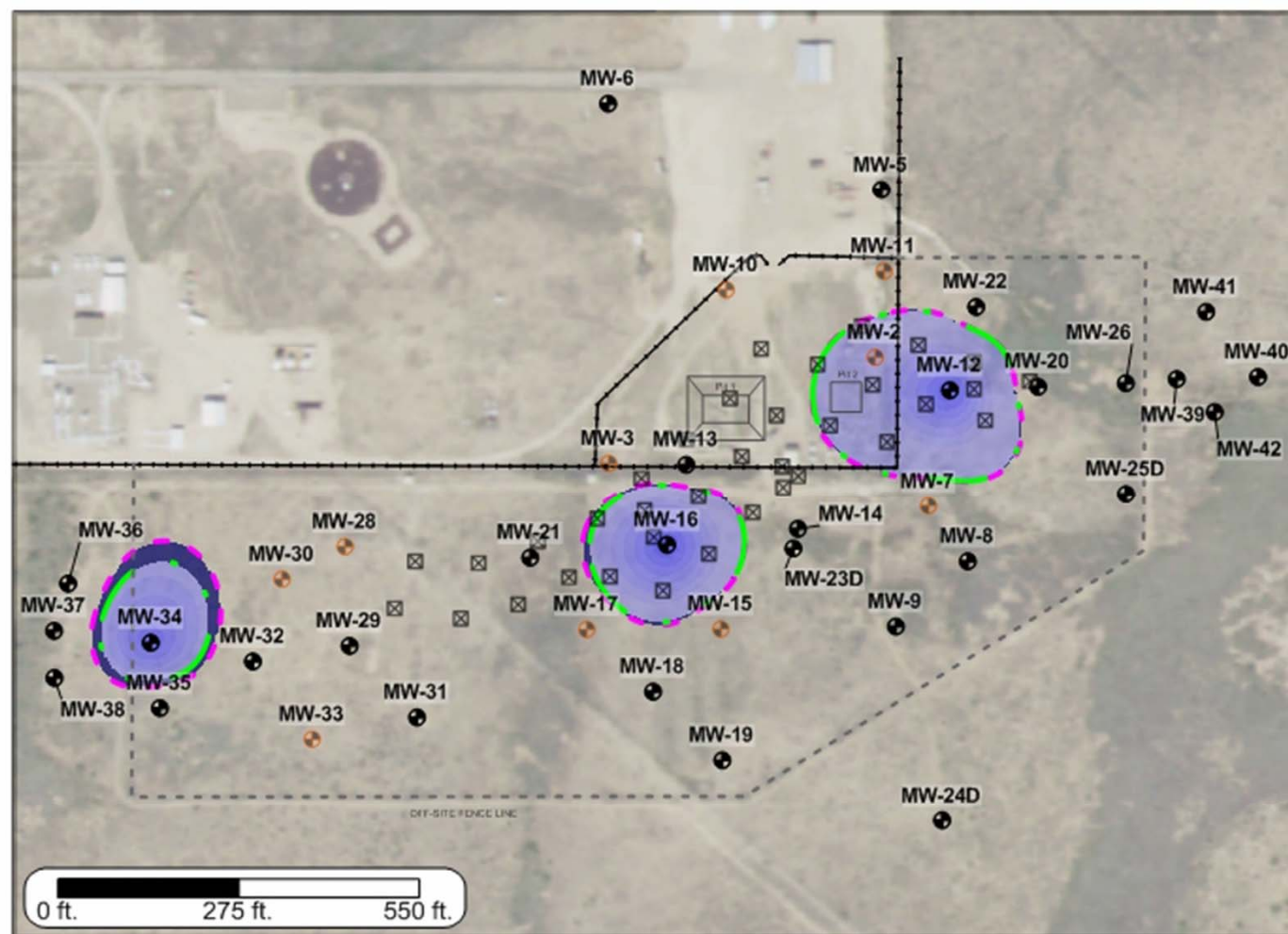

Spatial Change Indicator

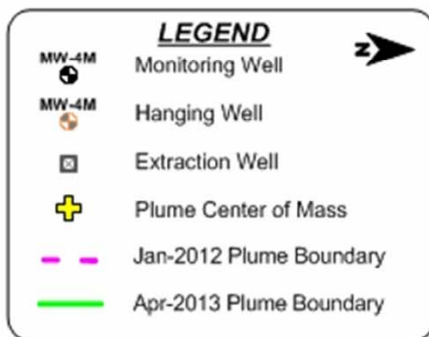

Plume Characteristics

Area: **10% Decrease**
 Average Concentration: **9% Decrease**
 Mass Indicator: **18% Decrease**
 Mass Increase: **0.00 lbs Increase**
 Mass Decrease: **0.52 lbs Decrease**

This analysis requires fixed data points within a fixed area for the purposes of assessing relative changes of area, average concentration, and mass indicator over time. Therefore, any created isopleth maps are not intended to be a depiction or model of the actual plume but rather is meant to show conceptual behavior of the aforementioned metrics over time.

BTEX

BTEX Jan-1996

Concentration ($\mu\text{g/L}$)

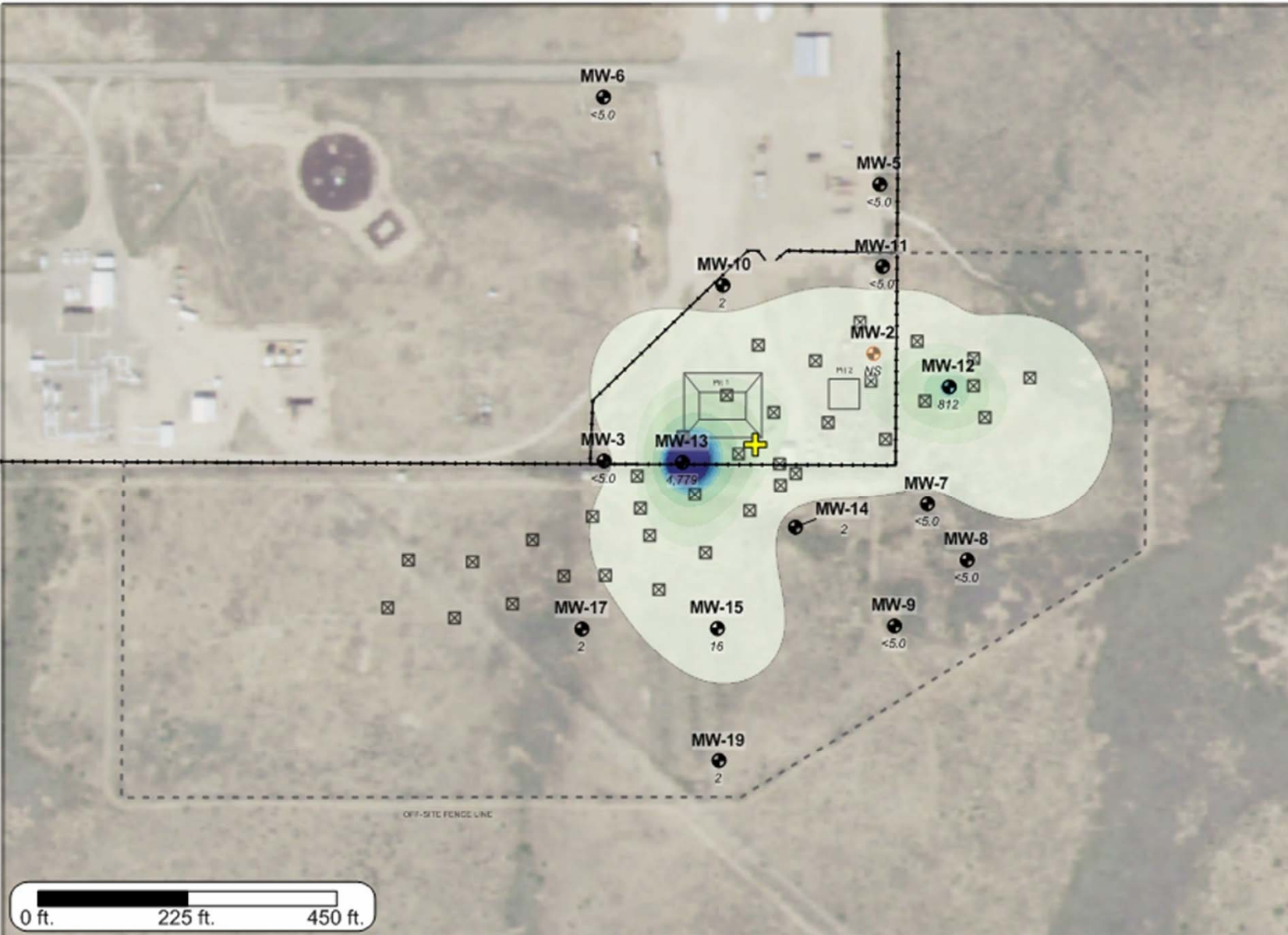
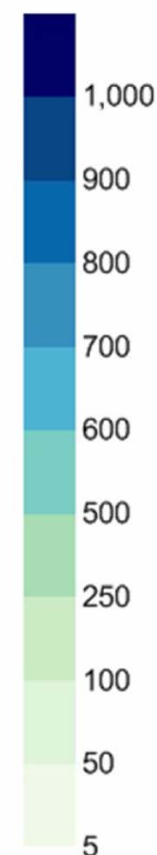

LEGEND	
MW-4M	Monitoring Well
MW-4M	Hanging Well
□	Extraction Well
112	Concentration ($\mu\text{g/L}$)
NS (146)	Well Not Sampled (Assigned Value Shown)
+	Plume Center of Mass

Plume Characteristics

Plume Area: **6.6 acres**
 Plume Average Concentration: **76.6 $\mu\text{g/L}$**
 Plume Mass Indicator: **8.3 lbs**

This analysis requires fixed data points within a fixed area for the purposes of assessing relative changes of area, average concentration, and mass indicator over time. Therefore, any created isopleth maps are not intended to be a depiction or model of the actual plume but rather is meant to show conceptual behavior of the aforementioned metrics over time.



Environmental Challenges
 BUSINESS SOLUTIONS[®]
 © EarthCon 2018

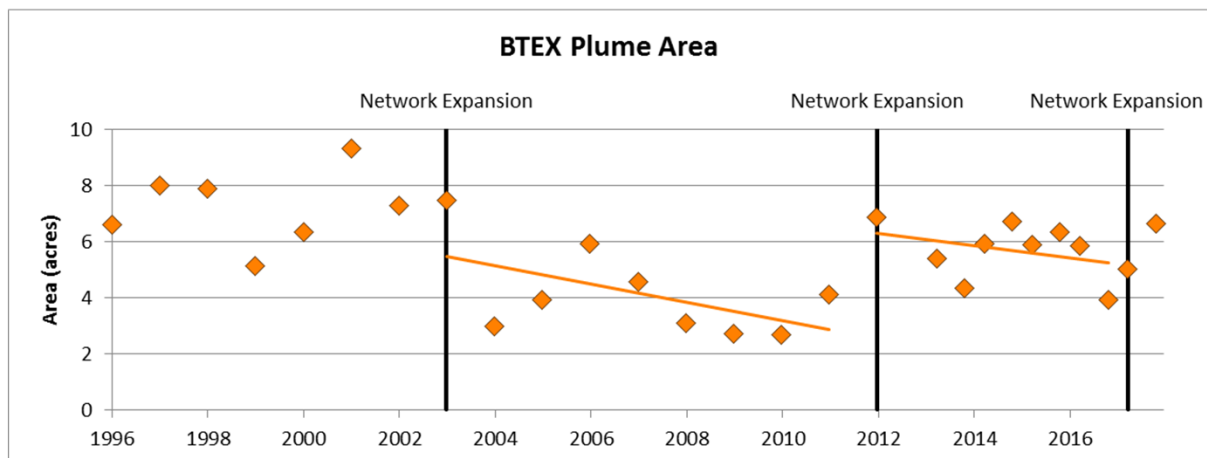

Jan-2003 to Jan-2011
 No Trend/Decreasing Trend
 Mann-Kendall: 91% Confidence
 Regression: 88% Confidence

Jan-2012 to Nov-2016
 No Trend
 Mann-Kendall: 82% Confidence
 Regression: 62% Confidence

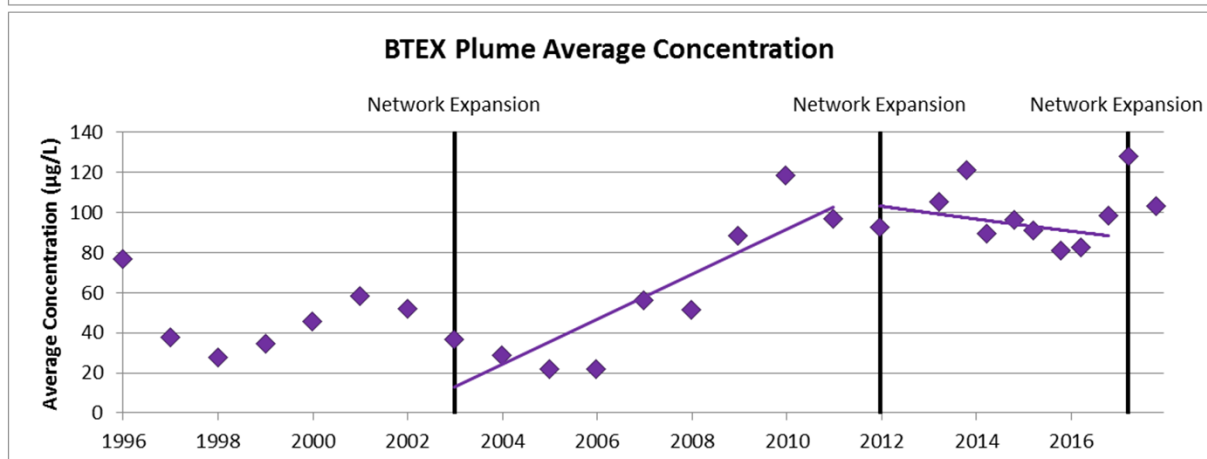

Jan-2003 to Jan-2011
 Increasing Trend
 Mann-Kendall: 98% Confidence
 Regression: >99% Confidence

Jan-2012 to Nov-2016
 No Trend
 Mann-Kendall: 82% Confidence
 Regression: 71% Confidence

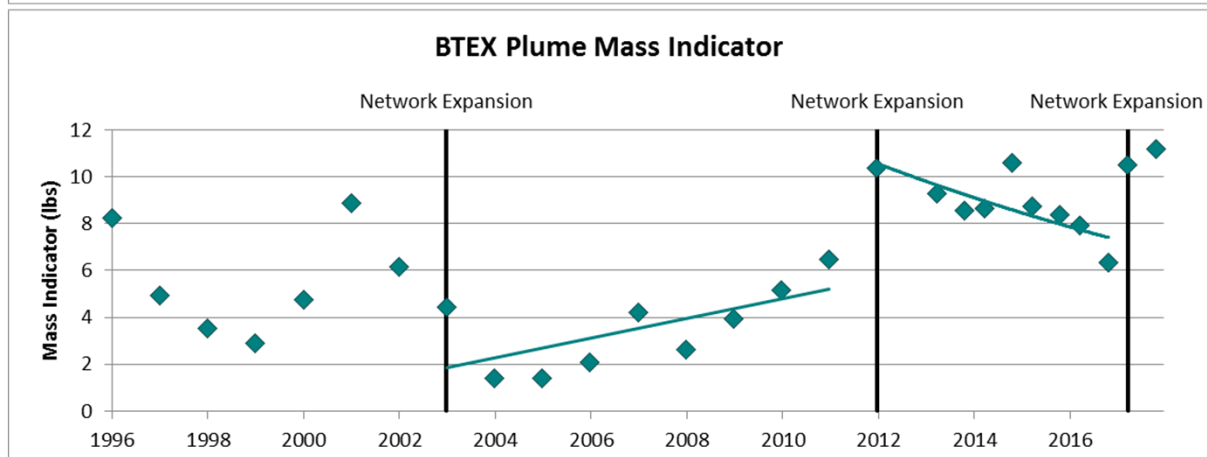

Jan-2003 to Jan-2011
 Increasing Trend
 Mann-Kendall: 98% Confidence
 Regression: 94% Confidence

Jan-2012 to Nov-2016
 Decreasing Trend
 Mann-Kendall: 99% Confidence
 Regression: 98% Confidence

Groundwater Elevation Correlation

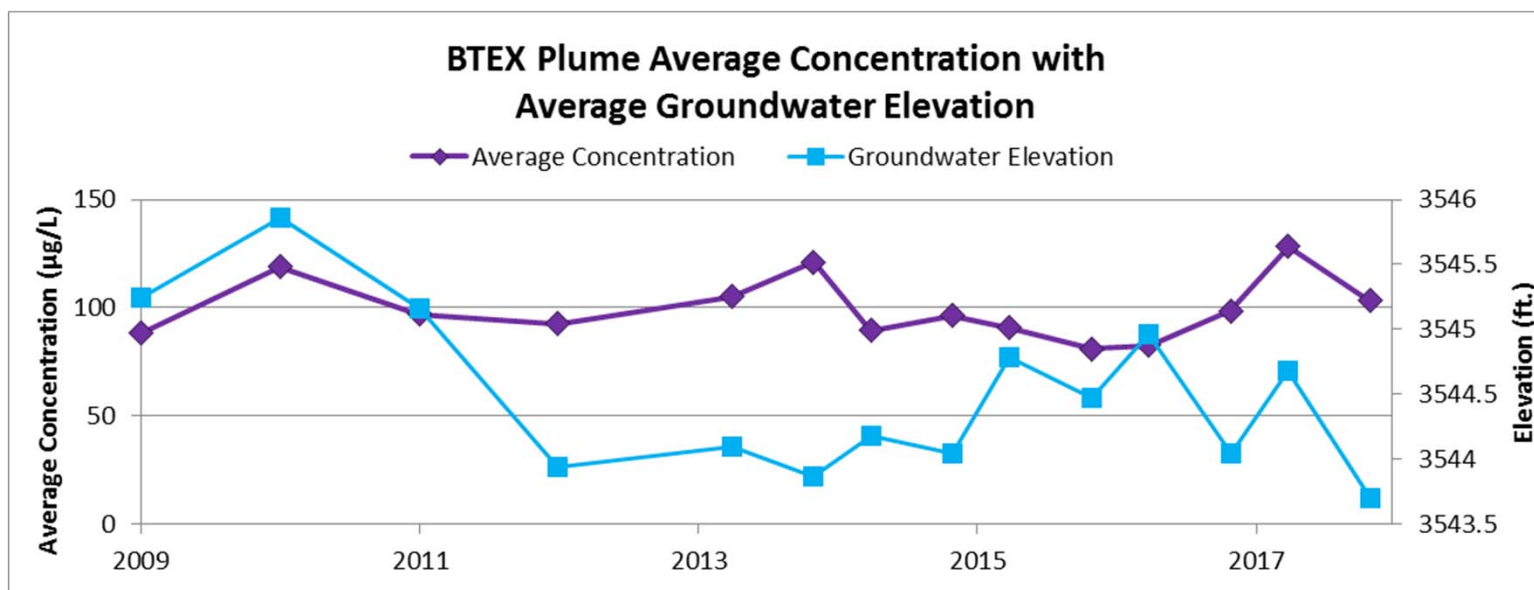

BTEX Center of Mass

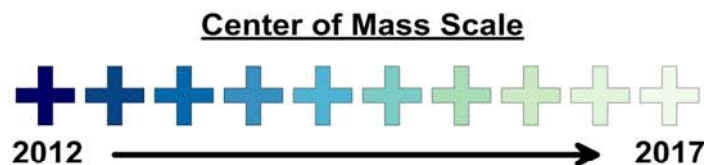
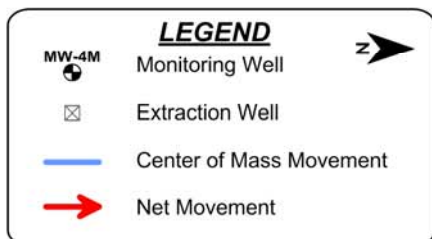
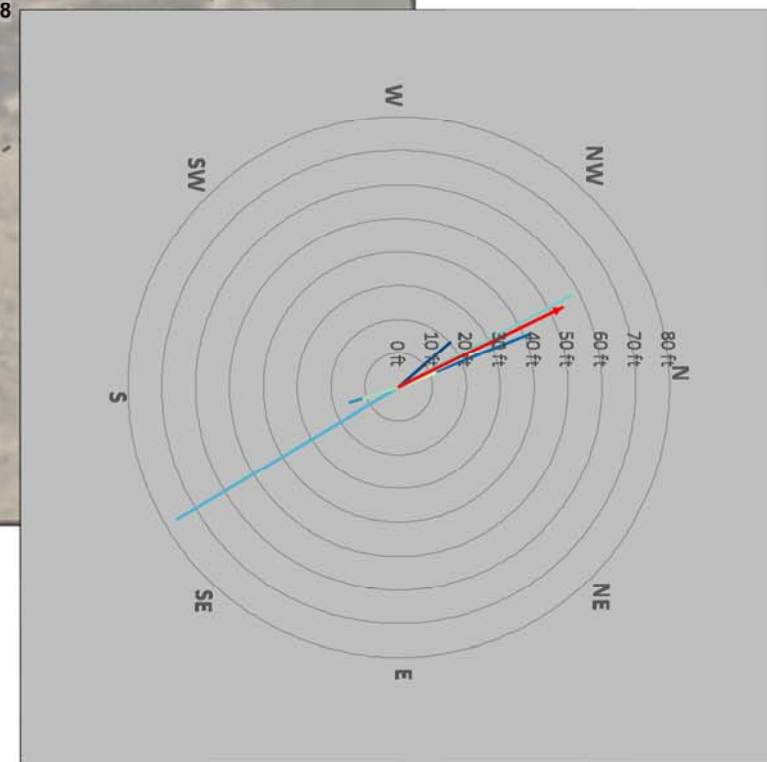
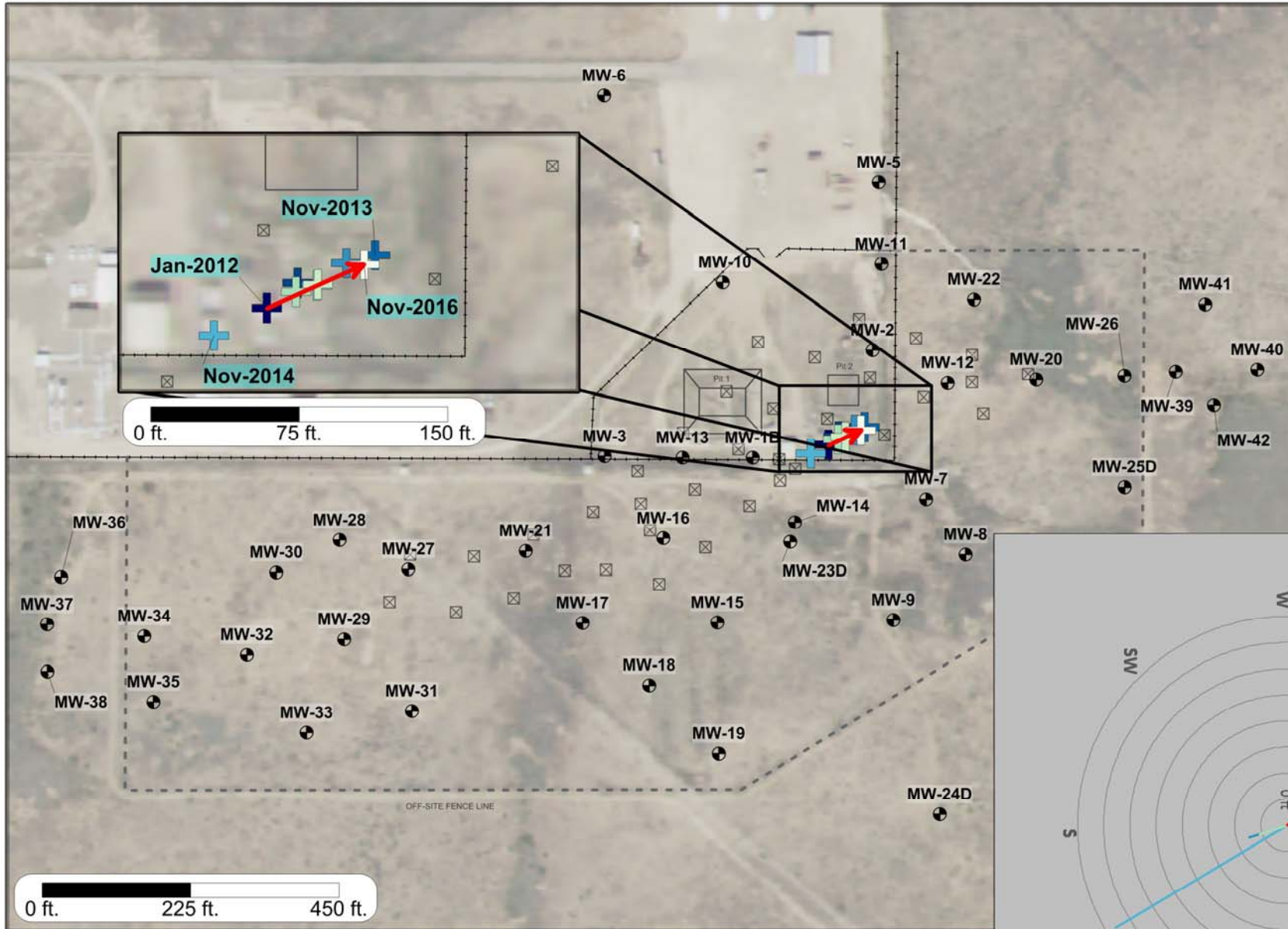

This analysis requires fixed data points within a fixed area for the purposes of assessing relative changes of area, average concentration, and mass indicator over time. Therefore, any created isopleth maps are not intended to be a depiction or model of the actual plume but rather is meant to show conceptual behavior of the aforementioned metrics over time.

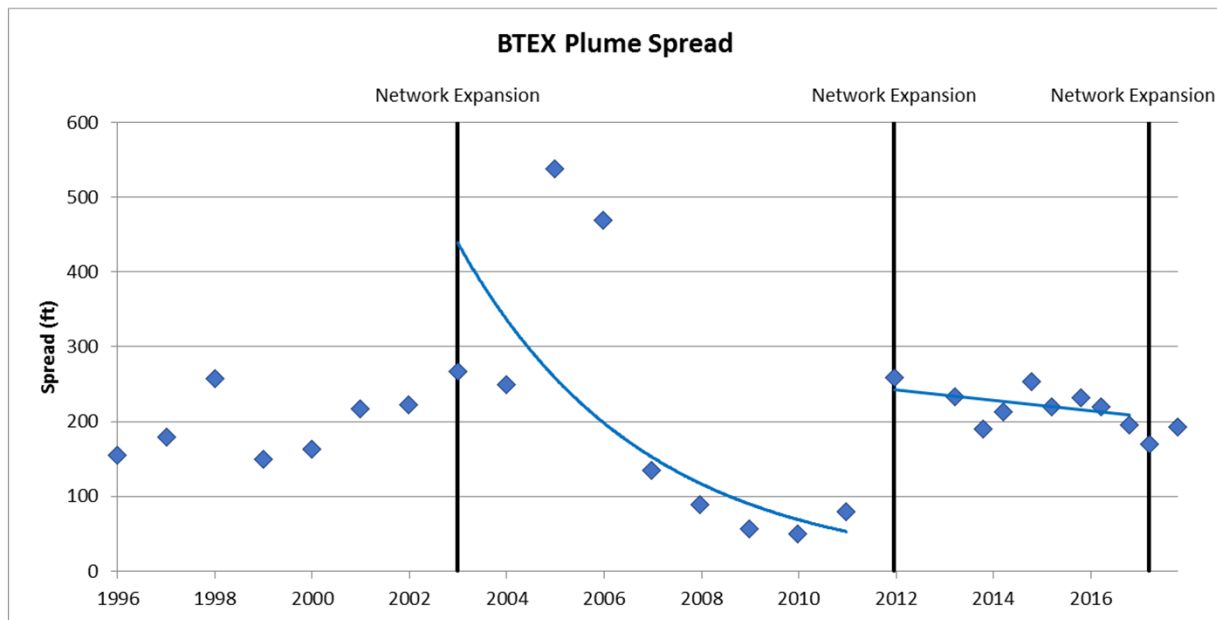

Jan-2003 to Jan-2011
Decreasing Trend
Mann-Kendall: 99% Confidence
Regression: 99% Confidence

Jan-2012 to Nov-2016
No Trend
Mann-Kendall: 87% Confidence
Regression: 78% Confidence

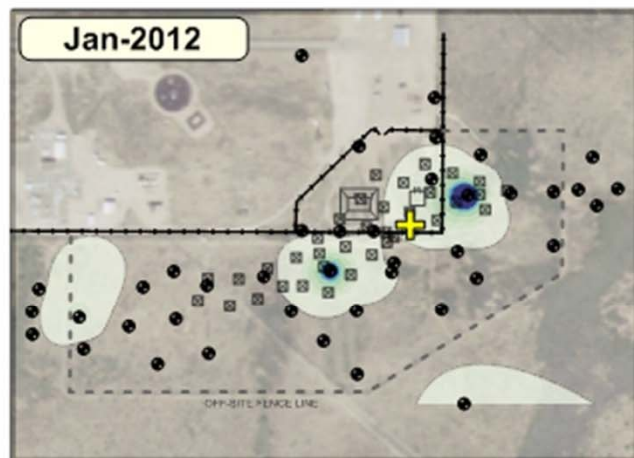

Concentration ($\mu\text{g/L}$)

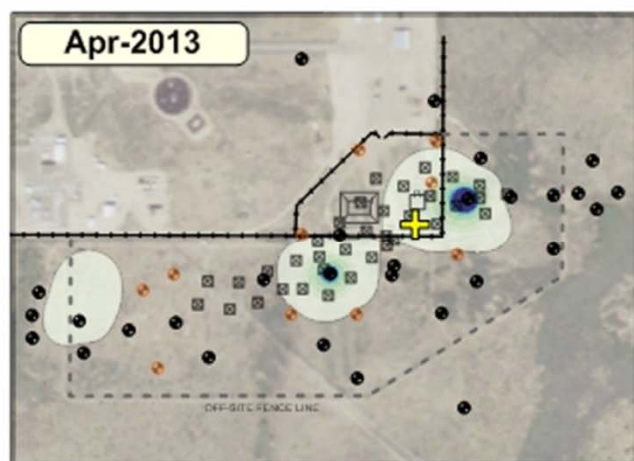
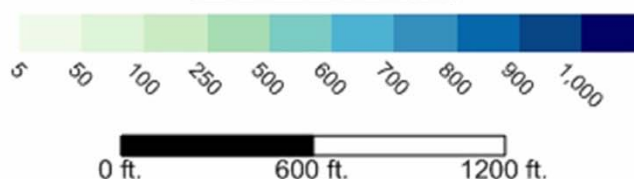

BTEX

Plume Differences Jan-2012 vs Apr-2013

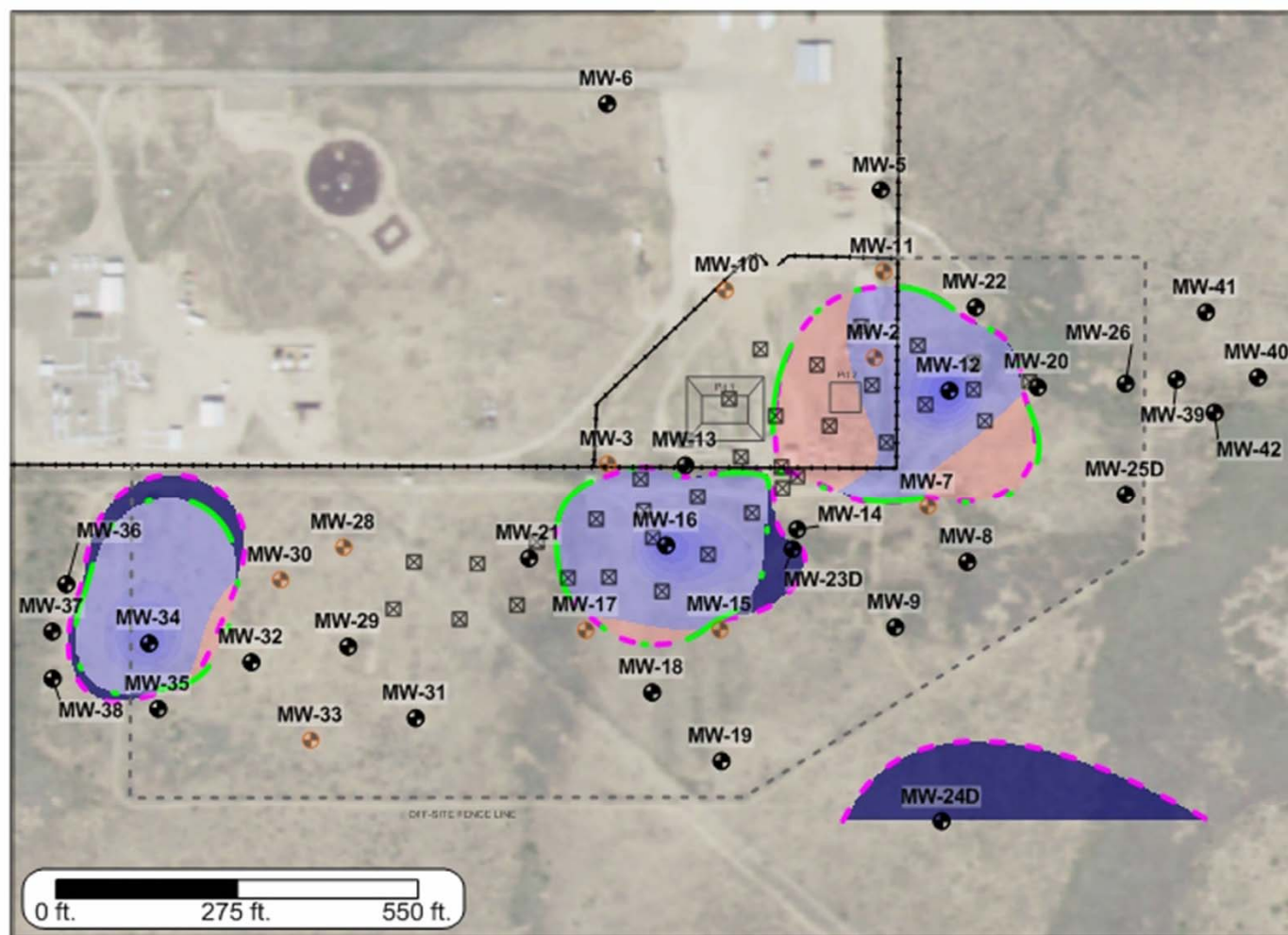

Spatial Change Indicator



LEGEND

- MW-4M Monitoring Well
- MW-4M Hanging Well
- Extraction Well
- Plume Center of Mass
- Jan-2012 Plume Boundary
- Apr-2013 Plume Boundary

Plume Characteristics

Area: **21% Decrease**
 Average Concentration: **14% Increase**
 Mass Indicator: **11% Decrease**
 Mass Increase: **0.01 lbs Increase**
 Mass Decrease: **1.02 lbs Decrease**

This analysis requires fixed data points within a fixed area for the purposes of assessing relative changes of area, average concentration, and mass indicator over time. Therefore, any created isopleth maps are not intended to be a depiction or model of the actual plume but rather is meant to show conceptual behavior of the aforementioned metrics over time.

EARTHCON

© EarthCon 2018

Environmental Challenges
BUSINESS SOLUTIONS

GWE

Groundwater Elevation Jan-2009

Elevation (ft.)

3,550
3,548
3,546
3,544
3,542
3,540
3,538
3,536
3,534
3,532
3,530

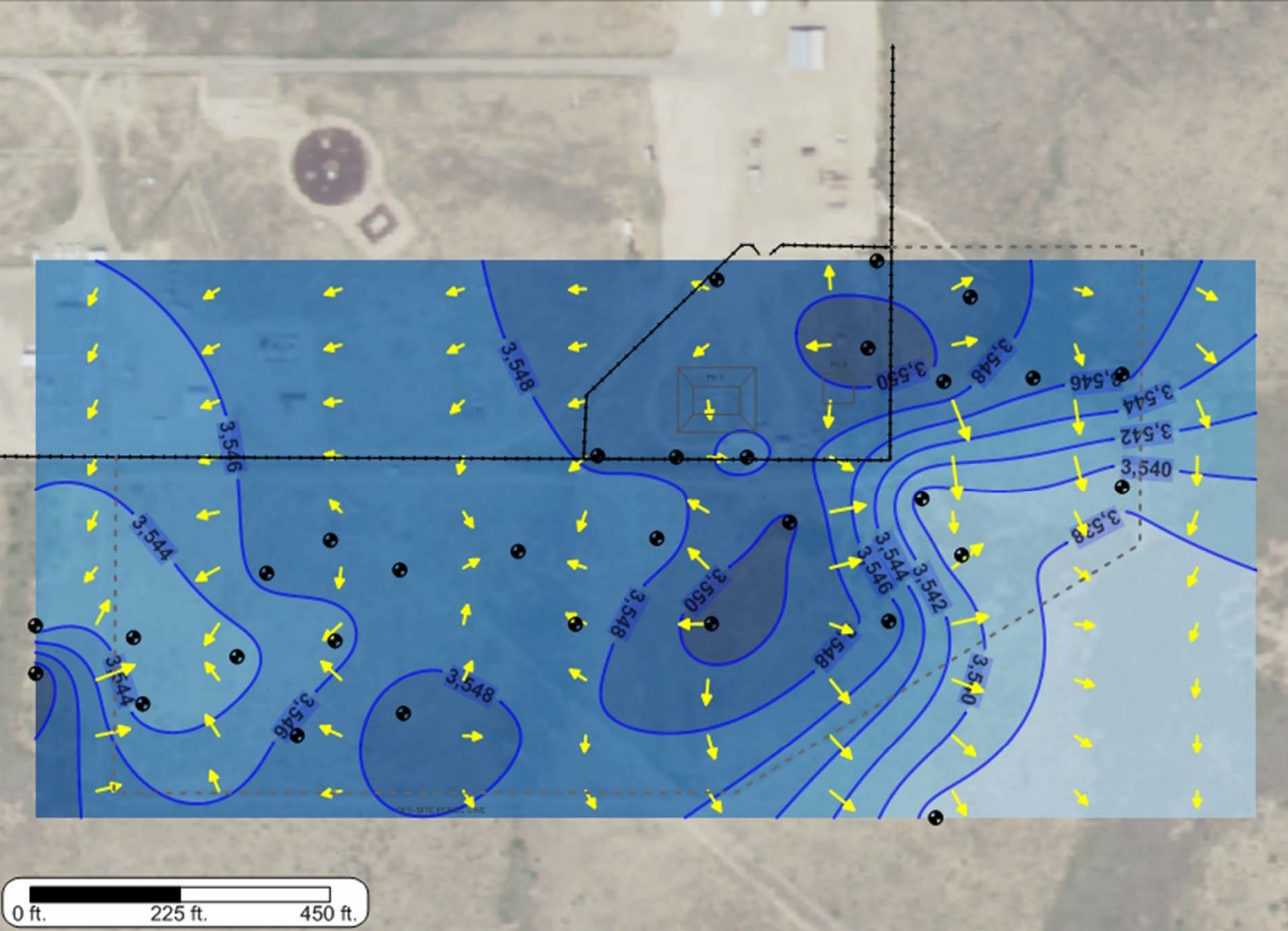

0 ft. 225 ft. 450 ft.

LEGEND

- MW-4M Monitoring Well
- MW-4M Hanging Well
- Extraction Well
- Groundwater Elevation Contour
- Groundwater Flow Direction

Plume Characteristics

Average Groundwater Elevation: **3,545 ft.**

This analysis requires fixed data points within a fixed area for the purposes of assessing relative changes of area, average concentration, and mass indicator over time. Therefore, any created isopleth maps are not intended to be a depiction or model of the actual plume but rather is meant to show conceptual behavior of the aforementioned metrics over time.



Environmental Challenges
BUSINESS SOLUTIONS

© EarthCon 2018

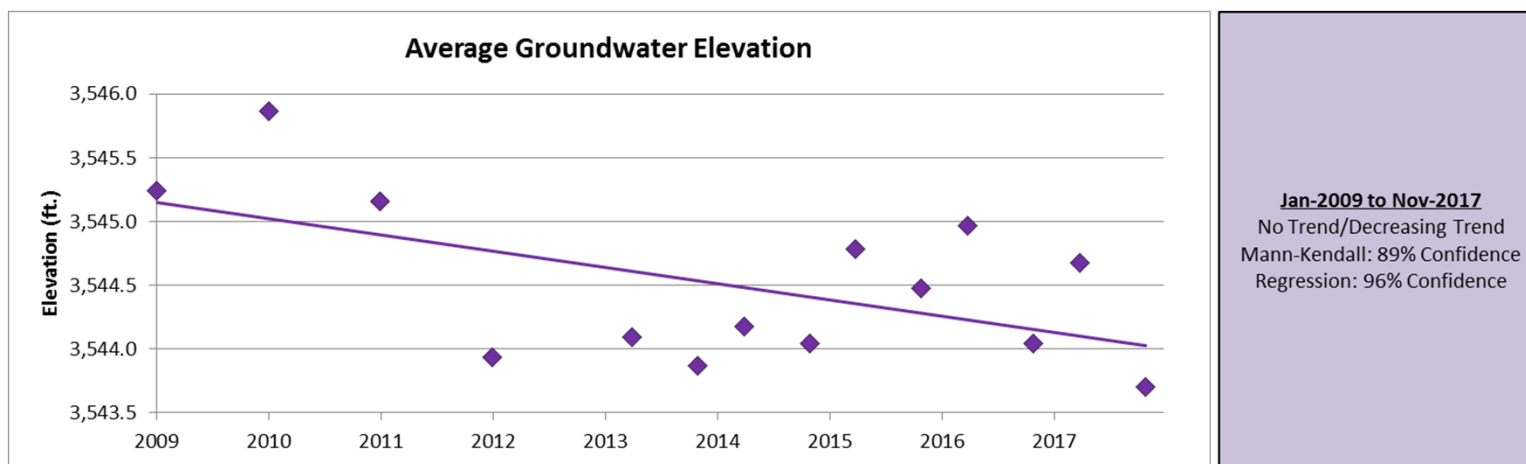

Groundwater Elevation Jan-2009

Potentiometric Surface Variance (ft.)

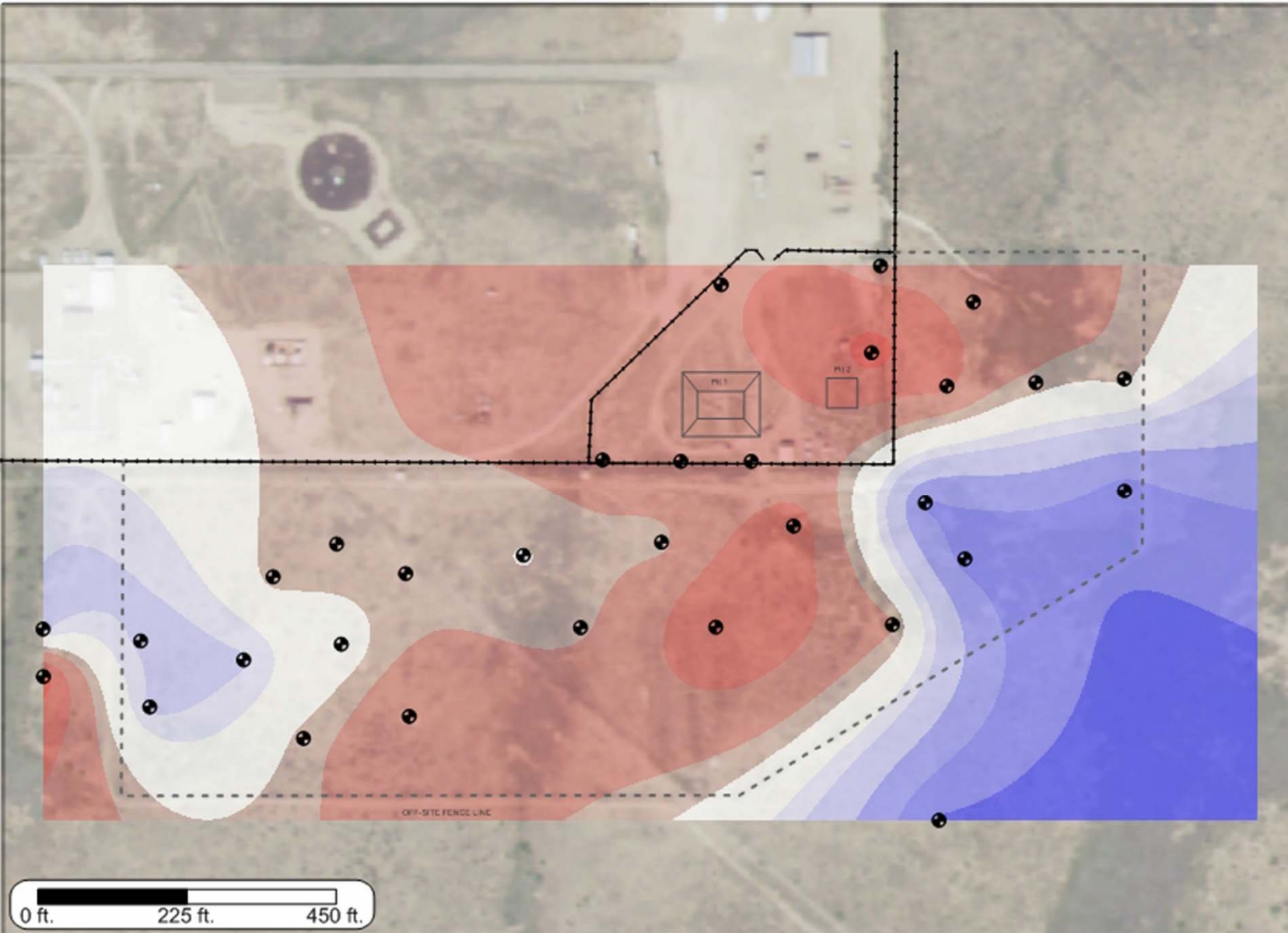
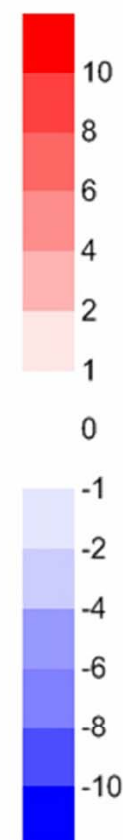

LEGEND

MW-4M Monitoring Well

MW-4M Hanging Well

Extraction Well

Plume Characteristics

Average Groundwater Elevation: **3,545 ft.**

This analysis requires fixed data points within a fixed area for the purposes of assessing relative changes of area, average concentration, and mass indicator over time. Therefore, any created isopleth maps are not intended to be a depiction or model of the actual plume but rather is meant to show conceptual behavior of the aforementioned metrics over time.



© EarthCon 2018 **Environmental Challenges
BUSINESS SOLUTIONS**

PSH
Jan-2009

Thickness (ft.)

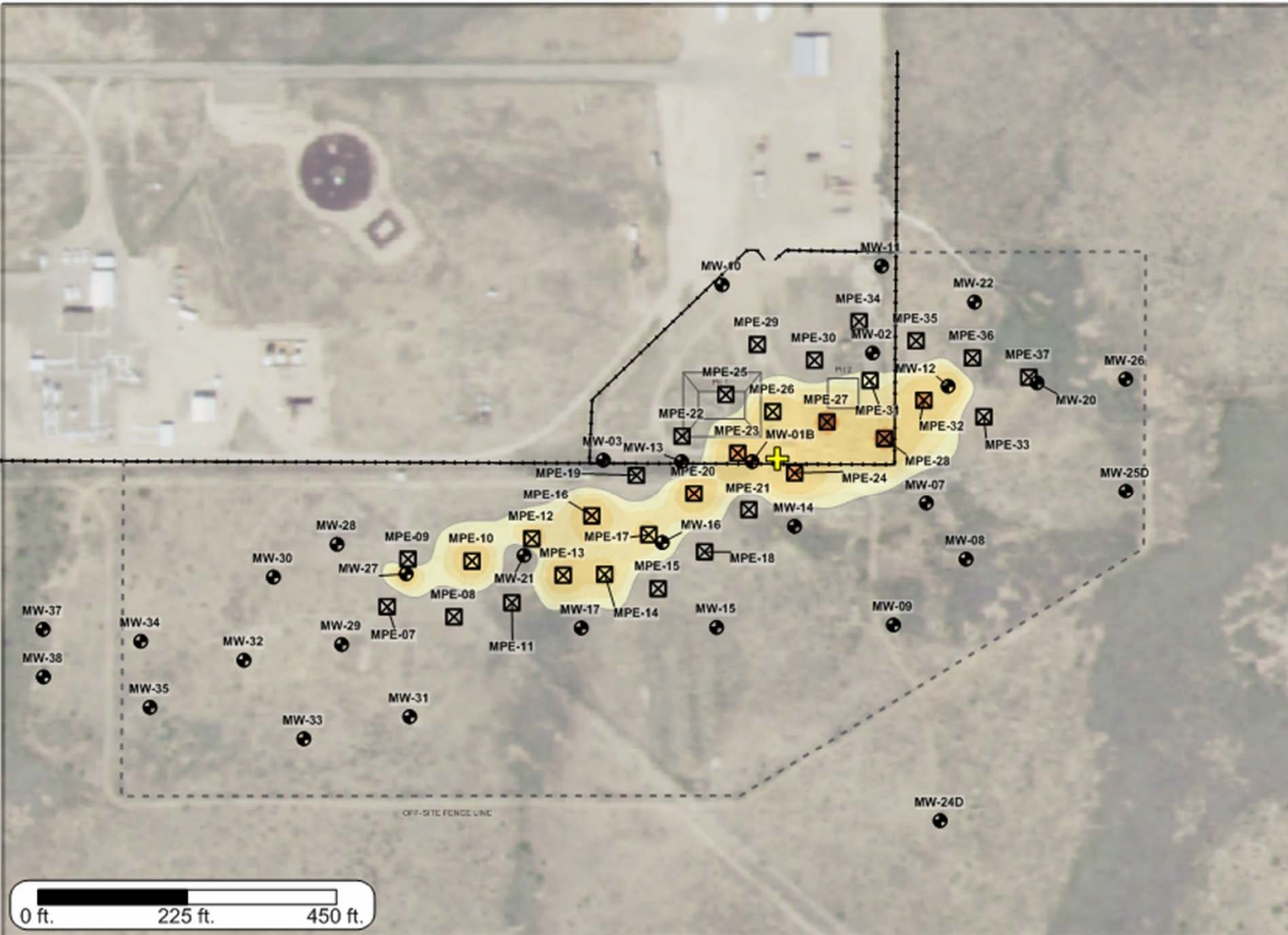
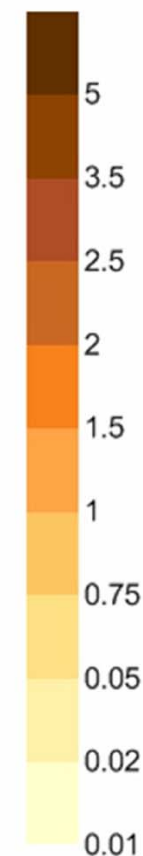

- LEGEND**
- MW-4M Monitoring Well
 - Extraction Well
 - Hanging Well
 - 112 Thickness (ft.)
 - NS (146) Well Not Sampled (Assigned Value Shown)
 - Plume Center of Mass

Plume Characteristics

Plume Area: **2.7 acres**
Plume Average Thickness: **0.15 ft.**

This analysis requires fixed data points within a fixed area for the purposes of assessing relative changes of area, average concentration, and mass indicator over time. Therefore, any created isopleth maps are not intended to be a depiction or model of the actual plume but rather is meant to show conceptual behavior of the aforementioned metrics over time.

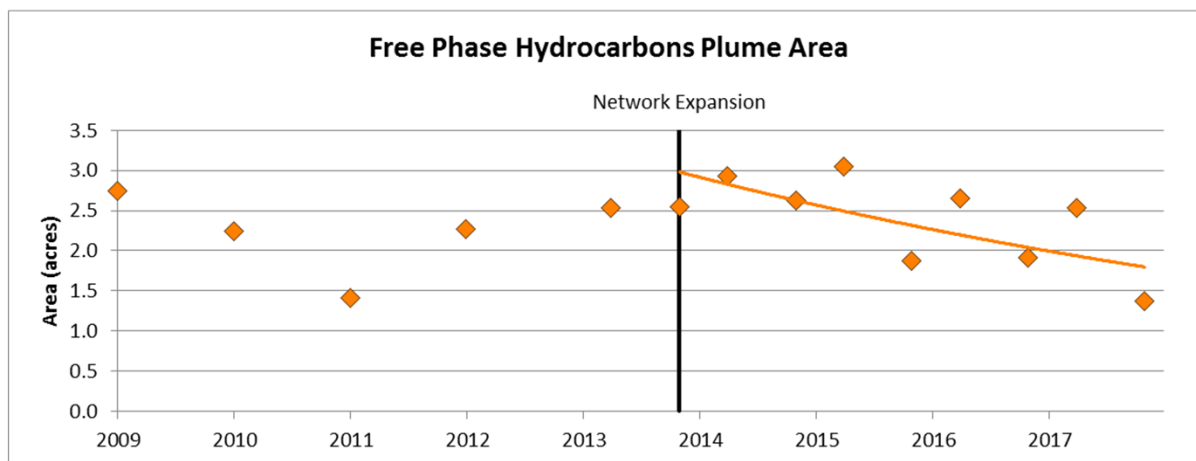

Nov-2013 to Nov-2017
 Decreasing Trend
 Mann-Kendall: 91% Confidence
 Regression: 95% Confidence

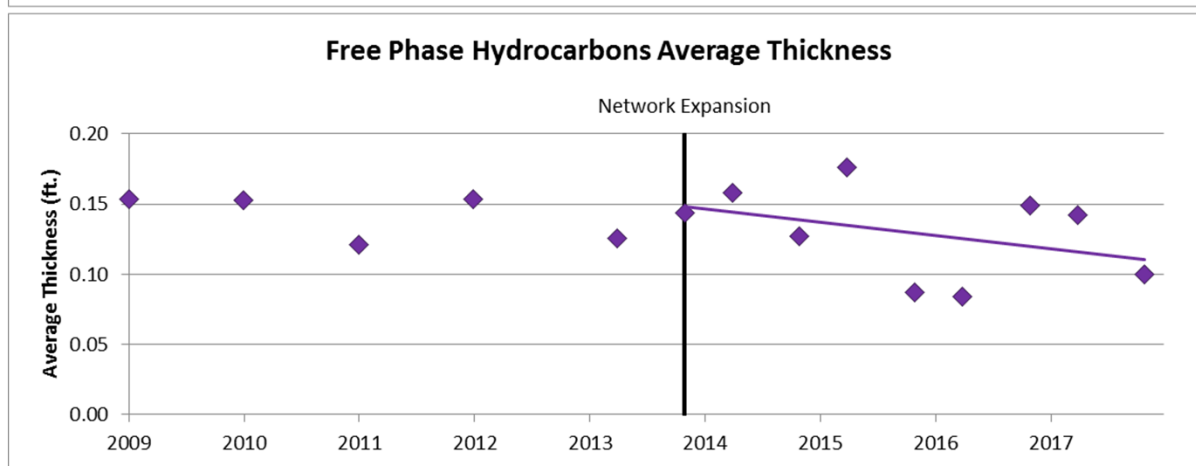

Nov-2013 to Nov-2017
 No Trend
 Mann-Kendall: 82% Confidence
 Regression: 70% Confidence

**PSH
Center of Mass**

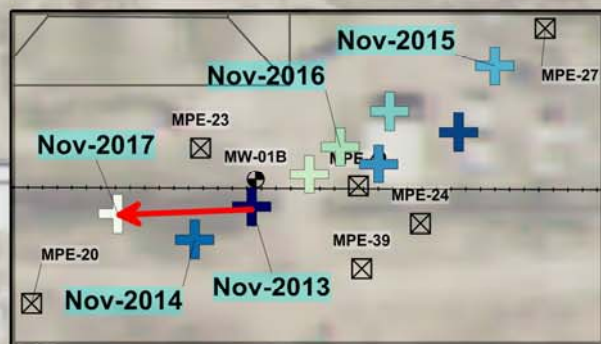

0 ft. 75 ft. 150 ft.

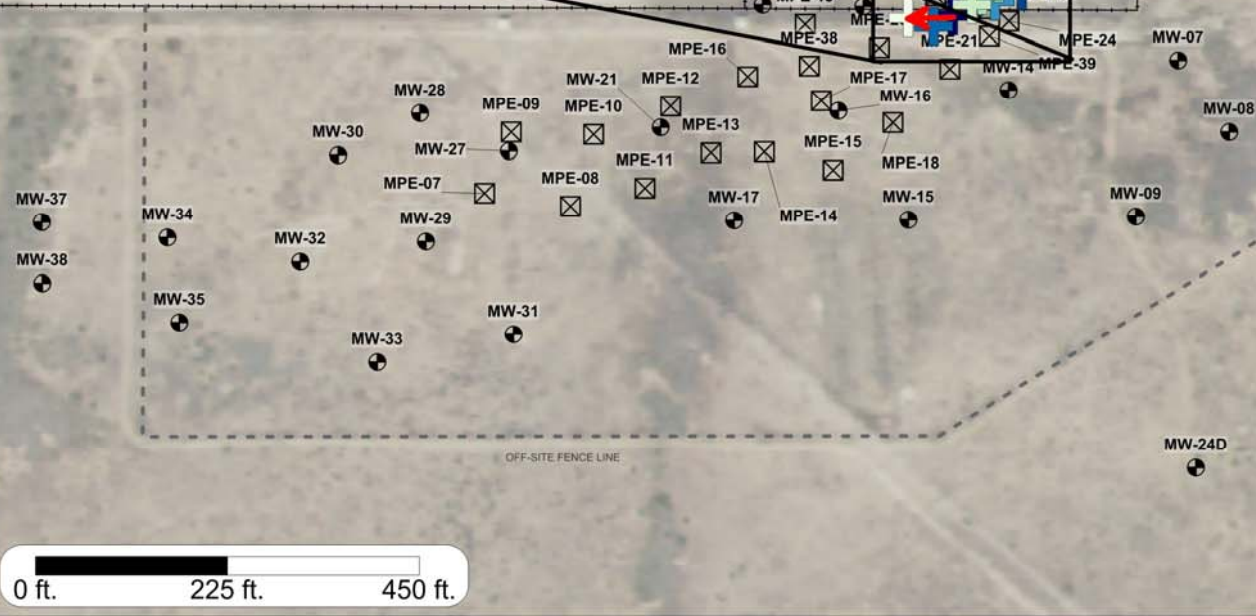

0 ft. 225 ft. 450 ft.

- LEGEND**
- MW-4M Monitoring Well
 - Extraction Well
 - Center of Mass Movement
 - Net Movement

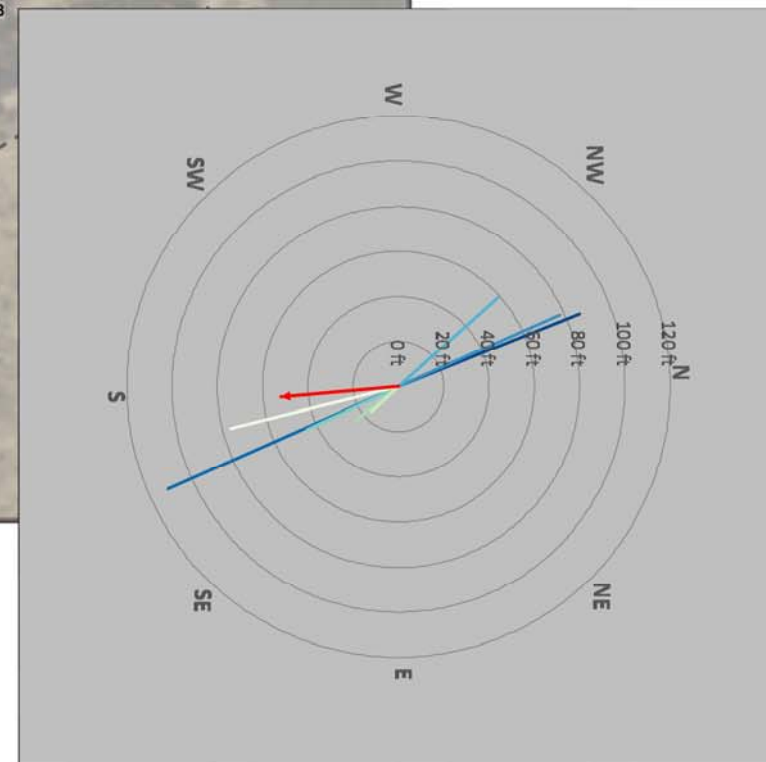
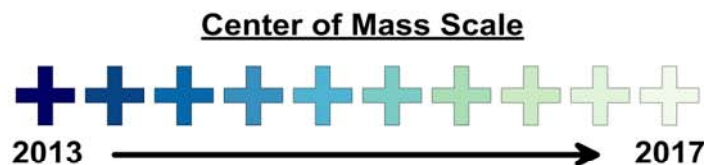

This analysis requires fixed data points within a fixed area for the purposes of assessing relative changes of area, average concentration, and mass indicator over time. Therefore, any created isopleth maps are not intended to be a depiction or model of the actual plume but rather is meant to show conceptual behavior of the aforementioned metrics over time.



© EarthCon 2018 Environmental Challenges
BUSINESS SOLUTIONS

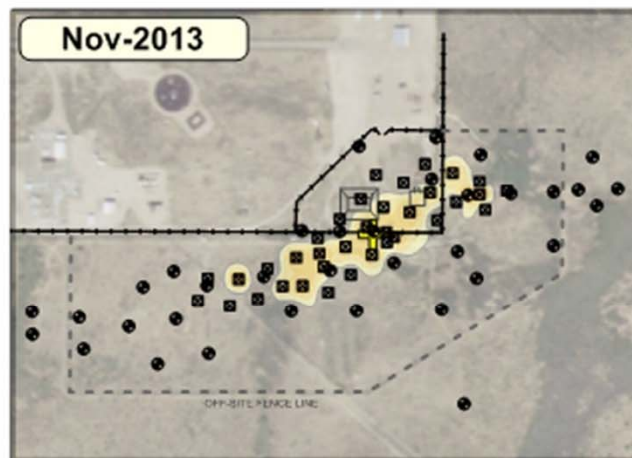

Concentration ($\mu\text{g/L}$)

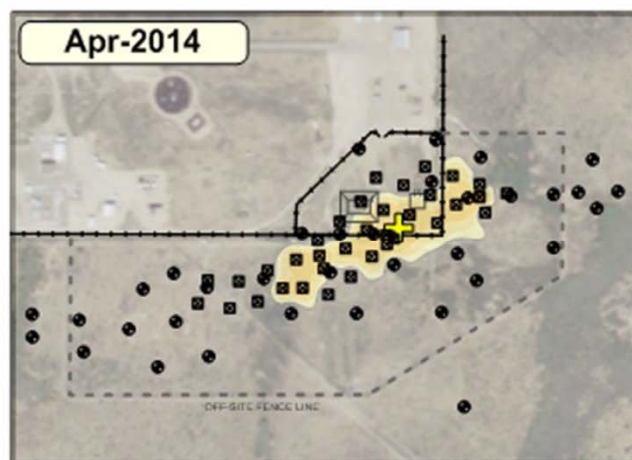
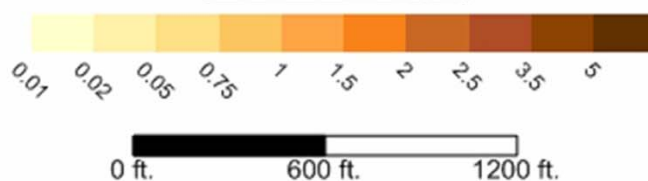

PSH

Plume Differences Nov-2013 vs Apr-2014

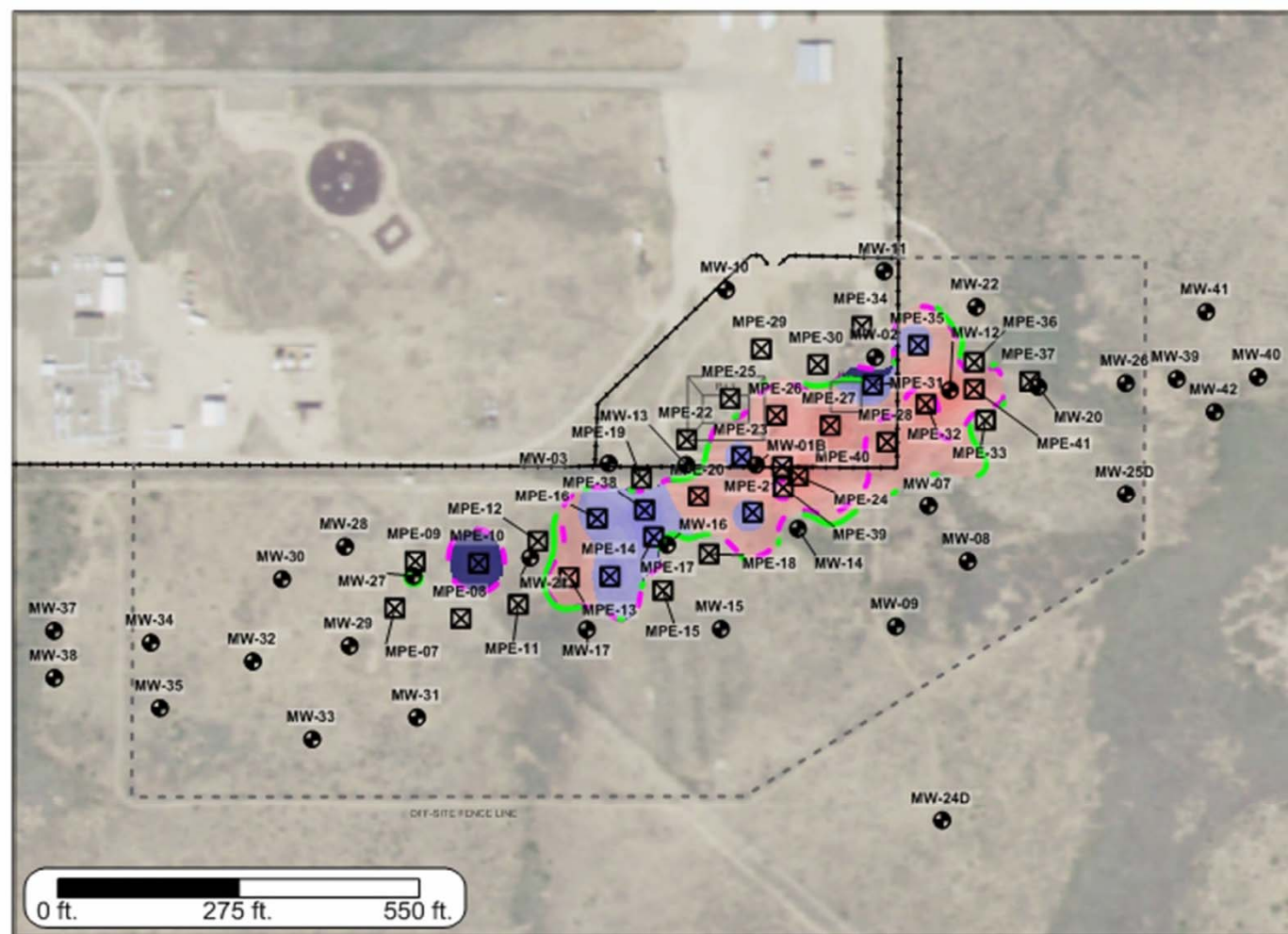

Spatial Change Indicator



LEGEND

- MW-4M Monitoring Well
- MW-4M Hanging Well
- Extraction Well
- Plume Center of Mass
- Nov-2013 Plume Boundary
- Apr-2014 Plume Boundary

Plume Characteristics

Area: **15% Increase**
Average Thickness: **10% Increase**

This analysis requires fixed data points within a fixed area for the purposes of assessing relative changes of area, average concentration, and mass indicator over time. Therefore, any created isopleth maps are not intended to be a depiction or model of the actual plume but rather is meant to show conceptual behavior of the aforementioned metrics over time.

EARTHCON
Environmental Challenges
BUSINESS SOLUTIONS

© EarthCon 2018

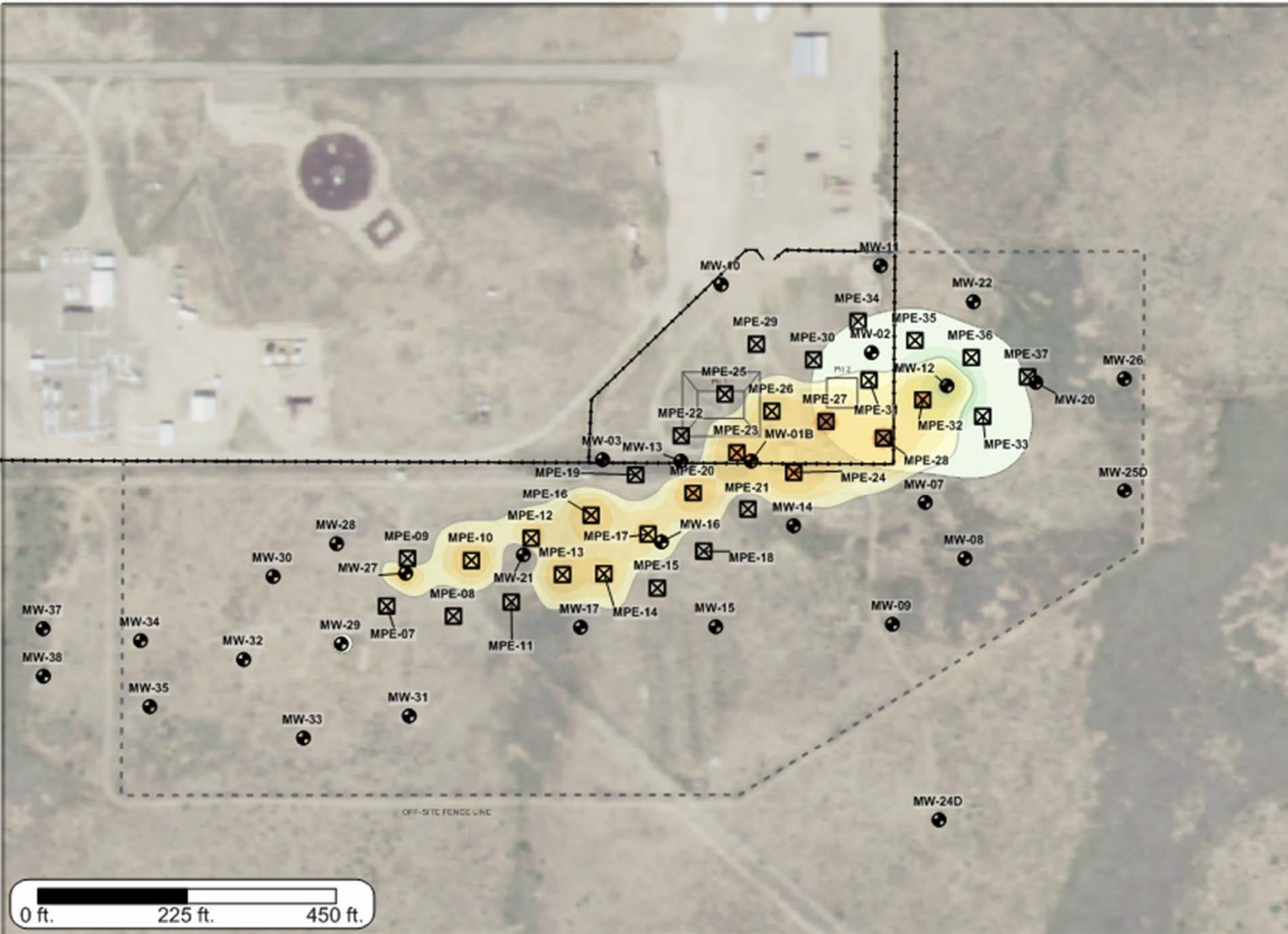

MW-4M
Monitoring Well

Extraction Well

Hanging Well



Plume Area: **1.6 acres**
Plume Average Concentration: **52.5 µg/L**
Plume Mass Indicator: **1.3 lbs**

Plume Area: **2.7 acres**
Plume Average Thickness: **0.15 ft.**

This analysis requires fixed data points within a fixed area for the purposes of assessing relative changes of area, average concentration, and mass indicator over time. Therefore, any created isopleth maps are not intended to be a depiction or model of the actual plume but rather is meant to show conceptual behavior of the aforementioned metrics over time.