

District I
1625 N. French Dr., Hobbs, NM 88240
District II
811 S. First St., Artesia, NM 88210
District III
1000 Rio Brazos Road, Aztec, NM 87410
District IV
1220 S. St. Francis Dr., Santa Fe, NM 87505

State of New Mexico
Energy Minerals and Natural Resources
Department
Oil Conservation Division
1220 South St. Francis Dr.
Santa Fe, NM 87505

Form C-147
Revised April 3, 2017

Recycling Facility Only

Type of action: ☐ Permit ☐ Registration ☐ Modification ☐ Closure ☐ Other (explain) _____

Be advised that approval of this request does not relieve the operator of liability should operations result in pollution of surface water, ground water or the environment. Nor does approval relieve the operator of its responsibility to comply with any other applicable governmental authority's rules, regulations or ordinances.

1.
Operator: Crowe Blanco Properties, LLC (For multiple operators attach page with information) OGRID #: _____
Address: 7277 US 64 Blanco, NM 87412
Facility or well name (include API# if associated with a well): _____
OCD Permit Number: NM1-50 (For new facilities the permit number will be assigned by the district office)
U/L or Qtr/Qtr ULO Section 16 Township 29N Range 09W County: San Juan
Surface Owner: ☐ Federal ☐ State ☒ Private ☐ Tribal Trust or Indian Allotment

2.
☒ **Recycling Facility:**
Location of recycling facility (if applicable): Latitude 36 43 22N Longitude 107 47 19W NAD83
Proposed Use: ☒ Drilling* ☒ Completion* ☒ Production* ☒ Plugging*
**The re-use of produced water may NOT be used until fresh water zones are cased and cemented*
☐ Other, requires permit for other uses. Describe use, process, testing, volume of produced water and ensure there will be no adverse impact on groundwater or surface water.
☒ Fluid Storage
☒ Above ground tanks ☐ Activity permitted under 19.15.17 NMAC explain type _____
☐ Activity permitted under 19.15.36 NMAC explain type: _____ ☐ Other explain _____
☐ Closure Report (required within 60 days of closure completion): ☐ Recycling Facility Closure Completion Date: _____

3.
Variances:
Justifications and/or demonstrations that the proposed variance will afford reasonable protection against contamination of fresh water, human health, and the environment.
Check the below box only if a variance is requested:
☐ Variance(s): Requests must be submitted to the appropriate division district for consideration of approval. If a Variance is requested, include the variance information on a separate page and attach it to the C-147 as part of the application.
If a Variance is requested, it must be approved prior to implementation.

4.
Operator Application Certification:
I hereby certify that the information and attachments submitted with this application are true, accurate and complete to the best of my knowledge and belief.
Name (Print): John Crowe Title: President/Owner
Signature: [Signature] Date: 10/17/2018
e-mail address: johncrowe@me.com Telephone: 816-668-9970

5.
OCD Representative Signature: [Signature] Approval/Registration Date: 23Oct18
Title: Hydrologist OCD Permit Number: tba 3RF-31
☐ OCD Conditions _____
☐ Additional OCD Conditions on Attachment _____

Crowe Blanco Properties, LLC / IEI Blanco Recycling Facility

19.15.34

Crowe Blanco Properties, LLC is submitting this registration for a Recycling Facility to treat produced water for reuse/recycling. Crowe Blanco Properties will use portable filtration units containing mechanical filters, a primary membrane, a secondary membrane and a portable post-treatment station to carry out filtration of contaminants from the produced water.

The Recycling Facility will be located at 7577 US 64 Blanco, NM 87412. The Recycling Facility will be located next to the Crowe Blanco Properties Surface Waste Management Facility (SWMF) Permit # NM1-50, but will not be part of the SWMF permitted activities.

19.15.34.8.A.1

The Recycling Facility will treat water produced or used in connection with the development or production of oil or gas (or both). The treated water would then be sold to local oilfield generators for reuse with their drilling, completion, production and plugging activities, in lieu of using fresh water.

19.15.34.8.A.3

The division has recently updated NMAC 19.15.34 to encourage the recycling, re-use or disposition of produced water.

This Recycling Facility would allow the local oil and gas industry to more environmentally friendly by using the treated water rather than using "fresh water" resources.

19.15.34.8.4

Dedicated above ground storage tanks will be used for storage. The Recycling Facility will be clearly marked and located within its own fenced area to distinguish it from the nearby SWMF activities. The Recycling Facility will be located on 3.5 acres as shown on the attached drawings.

19.15.34.8.5

H₂S treating agent will be utilized as needed to help neutralize gases in the tanks(s).

Produced Water containing NORM is prohibited from being accepted at the facility.

19.15.34.8.6

Any release from the recycling facility and/or re-use of produced water will be handled per 19.15.29 NMAC.

19.15.34.9.B.1

In addition to the other requirements set forth in 19.15.34 this registration is being submitted for a Recycling Facility, as required, when the recycling facility is an addition to a SWMF.

19.15.34.9.B.6

Dedicated above ground, unlined, hard-sided tanks will be used for storage of the pre-treatment and post-treatment produced water. The tanks will be contained in an earthen bermed area which will be constructed to hold 1 and 1/3 the volume of the largest tank or all interconnected tanks. The tanks will be visually inspected on a daily/weekly basis and the log of inspections will be kept on-site and made available to the division upon request. (Refer to the Recycling Facility Inspection and Maintenance Checklist)

19.15.34.9.E

A C-148 form will be used to record and report the following:

- Monthly total volume of produced water received for recycling; *and*
- Monthly total volume of treated water leaving the facility for reuse for drilling, completion, production and plugging activities.

In addition, “fresh” water received at the recycling facility will be recorded on the Fresh Water Recycling Facility Record (copy attached). A monthly total of fresh water received into the Recycling Facility will be listed separately on the C-148 form.

The C-148 form will be submitted to the division monthly.

19.15.34.9.F

The Daily Produced Water Intake Log (attached) will be an internal form which will be used to track the following:

- Date
- Generator of the Produced Water
- Source & Description of the Produced Water
- Amount of Produced Water brought into facility for treatment

The Produced Water Reuse/Disposition Log (attached) will be an internal form which will be used to track the following:

- Date
- Operator Obtaining the treated water
- Transportation Company, Driver Name & Truck Number
- Type of Reuse/Disposition i.e. Drilling, Completion, Production, Plugging
- Amount of treated water obtained for reuse
- Attendant & Driver Signatures

**These forms are subject to change per the company's needs.*

These records will be kept and made available for review by the division, upon request.

19.15.34.9.G

Produced water will be accepted into the recycling facility for reuse/recycling purposes, not for disposal purposes within the SWMF.

19.15.34.9.H

Within 60 days of ceasing operations all fluids will be removed from the recycling facility. If additional time is needed to remove fluids, a request can be made to the division district office, not to exceed two months.

District I
1625 N. French Dr., Hobbs, NM 88240
District II
811 S. First St., Artesia, NM 88210
District III
1000 Rio Brazos Road, Aztec, NM 87410
District IV
1220 S. St. Francis Dr., Santa Fe, NM 87505

State of New Mexico
Energy Minerals and Natural Resources
Department
Oil Conservation Division
1220 South St. Francis Dr.
Santa Fe, NM 87505

Form C-148
Revised March 31, 2015

Operator Name _____

OGRID _____

☐ I certify all recycling containments associated with our recycling facilities are using >20% of the containments' total fluid capacity every 6 months until closure in compliance with 19.15.34.13(C) NMAC.

Month/Year _____

Admin. #	Produced water received*	Other fluid received*	Volume discharged for Recycling/Reuse*

*Report volumes in barrels

Crowe Blanco Properties, LLC

Recycling Facility

DAILY PRODUCED WATER INTAKE LOG

[illegible]

DAILY INTAKE TOTAL

Crowe Blanco Properties, LLC

Recycling Facility

PRODUCED WATER REUSE/DISPOSITION LOG

Date: _____

OPERATOR OBTAINING TREATED WATER: _____

Transportation Company: _____

Driver: _____

TYPE OF REUSE

DRILLING ☐
COMPLETION ☐

PRODUCTION ☐
WELL PLUGGING ☐

AMOUNT

Load #1

Load #2

Load #3

Load #4

Load #5

Load #6

Load #7

Load #8

BARRELS

TRUCK #

TIME IN (AM/PM)

TIME OUT (AM/PM)

ATTENDANT INITIALS

DRIVER INITIALS

AMOUNT

Load #9

Load #10

Load #11

Load #12

Load #13

Load #14

Load #15

Load #16

BARRELS

TRUCK #

TIME IN (AM/PM)

TIME OUT (AM/PM)

ATTENDANT INITIALS

DRIVER INITIALS

Attendant Signature: _____

DAILY TOTAL: _____

Driver Signature: _____

Crowe Blanco Properties, LLC/Recycling Facility

Incoming Fresh Water Record

Date: _____

Trucking Information

Transported by: _____ Truck Number: _____

Truck Type: ☐ Water Truck ☐ Vacuum Truck ☐ Other _____

FROM:

☐ Bloomfield City Water

___ ☐ BBLs ☐ Gallons

___ ☐ BBLs ☐ Gallons

☐ Aztec City Water

___ ☐ BBLs ☐ Gallons

___ ☐ BBLs ☐ Gallons

☐ Agua Moss

___ ☐ BBLs ☐ Gallons

___ ☐ BBLs ☐ Gallons

☐ Other: _____

___ ☐ BBLs ☐ Gallons

___ ☐ BBLs ☐ Gallons

Daily Total: _____ ☐ BBLs ☐ Gallons

Driver _____
(Please Print)

Signature _____

Crowe Blanco Properties, LLC / IEI Blanco Recycling Facility Operating and Maintenance Plan

The purpose of this Operating and Maintenance Plan is to establish the procedures for operation and maintenance of the Recycling Facility located on the Crowe Blanco Properties Surface Waste Management Facility (SWMF) property.

To ensure there is no confusion or conflict, the Recycling Facility will be in its own fenced area and will be clearly marked to distinguish it from the nearby SWMF operations.

Supervisors and employees shall comply with the operating and maintenance procedures listed in this plan.

Responsible supervisor(s) and employee(s) shall make frequent inspections and maintain the data as outlined under the provisions of the plan.

Operation-employees shall operate the Recycling Facility in accordance with 19.15.34 NMAC as follows:

1. A highly visible sign, no smaller than 12" x 24" with 2" lettering, will be posted at the entrance to the Recycling Facility. The sign will distinguish the area as the Recycling Facility and will include the operator's name, ULSTR, and emergency contact phone number(s).
2. The Recycling Facility will be fenced with a four (4) foot field fence topped with barbed wire. The gate into the Recycling Facility shall remain locked when an employee/attendant is not on-site.
3. Only produced water will be accepted at the Recycling Facility for treatment. The treatment process will consist of two-53' semi-trailers containing mechanical filters, a primary membrane, a secondary membrane and a post-treatment station to filtrate contaminants from the produced water. The treated water will be sold to oil and gas producers to be reused/recycled with their drilling, completion, production and plugging activities.
4. A division approved C-133 "Authorization to Move Produced Water" shall accompany transporters hauling produced water to the Recycling Facility.
5. Acceptance of produced water into the Recycling Facility will only occur when an employee/attendant is on duty.
6. A C-148 form will be used to record the monthly total volume of produced water received for recycling and the monthly total volume of treated water leaving the facility for reuse for drilling, completion, production and plugging activities.
7. The "Incoming Fresh Water Record" form will be used to record fresh water used at the Recycling Facility. The monthly total volume of "fresh" water received at the recycling facility will also be listed separately on the C-148 form.
8. The C-148 form shall be submitted to the division monthly.

Maintenance-employees shall maintain the Recycling Facility in accordance with 19.15.34 NMAC as follows:

1. Employees shall inspect the Recycling Facility on a daily/weekly basis.
2. Routine inspection and maintenance activities will be conducted as follows:
 - a. General Housekeeping-daily;
 - b. Gates and Fencing-daily;
 - c. Freestanding Liquids-Within 24 hours;
 - d. Berms-Weekly and/or within 24 hours of the end of a major rainfall or windstorm;
 - e. Tanks (above ground hard sided-used per manufacturer's standards)-daily.
3. The tanks used at the Recycling Facility will be cleaned periodically to remove residue and BS&W. The BS&W and wash water from the tank cleaning activities will be transported off-site for disposal, with the proper manifest C-138 form, to a division approved SWMF or landfill pursuant to 19.15.35 NMAC.

The attached Recycling Facility Inspection and Maintenance Checklist shall be used to conduct routine maintenance and inspections. These reports will be kept on record and made available to the division for review upon request.

Crowe Blanco Properties, LLC / IEI Blanco
Recycling Facility Inspection and Maintenance Checklist

Week of/Date of Inspection: _____

Type of Inspection:

☐ Daily/Weekly

☐ After heavy rainfall or major windstorm

Area	Conditions When Maintenance Is Needed	Frequency	Results Expected	Comments-Describe maintenance completed and/or not yet completed (with anticipated completion date)
General Housekeeping (Daily)				
Recycling Facility	<ul style="list-style-type: none"> Stains (oils/gas/etc.) visible on the ground. Trash/debris. 	____ Mon ____ Tue ____ Wed ____ Thu ____ Fri	<ul style="list-style-type: none"> No visible staining present on the ground. Area free of trash and debris. 	
Gates and Fencing (Daily)				
Gate(s) -missing or broken parts	Any defect or damage to the gate which would allow easy entry to the area.	____ Mon ____ Tue ____ Wed ____ Thu ____ Fri	Gate(s) are repaired to proper working condition.	
Fence	Any defect or damage to the fence which would allow easy entry to the area.	____ Mon ____ Tue ____ Wed ____ Thu ____ Fri	Fencing is repaired to prevent unauthorized entry.	
Freestanding Liquids (Within 24 hours)				
Freestanding Liquids (19.15.36.15.C.8)	Freestanding liquids	Within 24 hrs.	Freestanding liquids removed within 24 hours.	
Berms (Weekly and/or After Major Storm Event)				
Berms	Settlement and/or erosion to berms which may compromise the integrity of the berm.	Weekly and/or after major storm	Berms are repaired to restore integrity and prevent erosion.	
Above Ground Tanks (Daily)				
Tanks (<i>above ground-which allows leak detection to be covered by visual inspections</i>)	<ul style="list-style-type: none"> Visible leaks or cracks in the walls or floor or on or around the supply pump(s) Any Stained soil around the tank(s) or hoses/pipes 	____ Mon ____ Tue ____ Wed ____ Thu ____ Fri	<ul style="list-style-type: none"> No additional fluids will be placed into a leaking tank(s) until it has been repaired. Spills/Leaks will be cleaned from the area and hoses/pipes checked for leaks & to ensure proper connection. <p>*Spills in excess of 5 bbls will be reported per 19.15.29 NMAC.</p>	

Inspector(s) Signature(s): _____

SEE FIG. 1 FOR
FENCE BOUNDARY

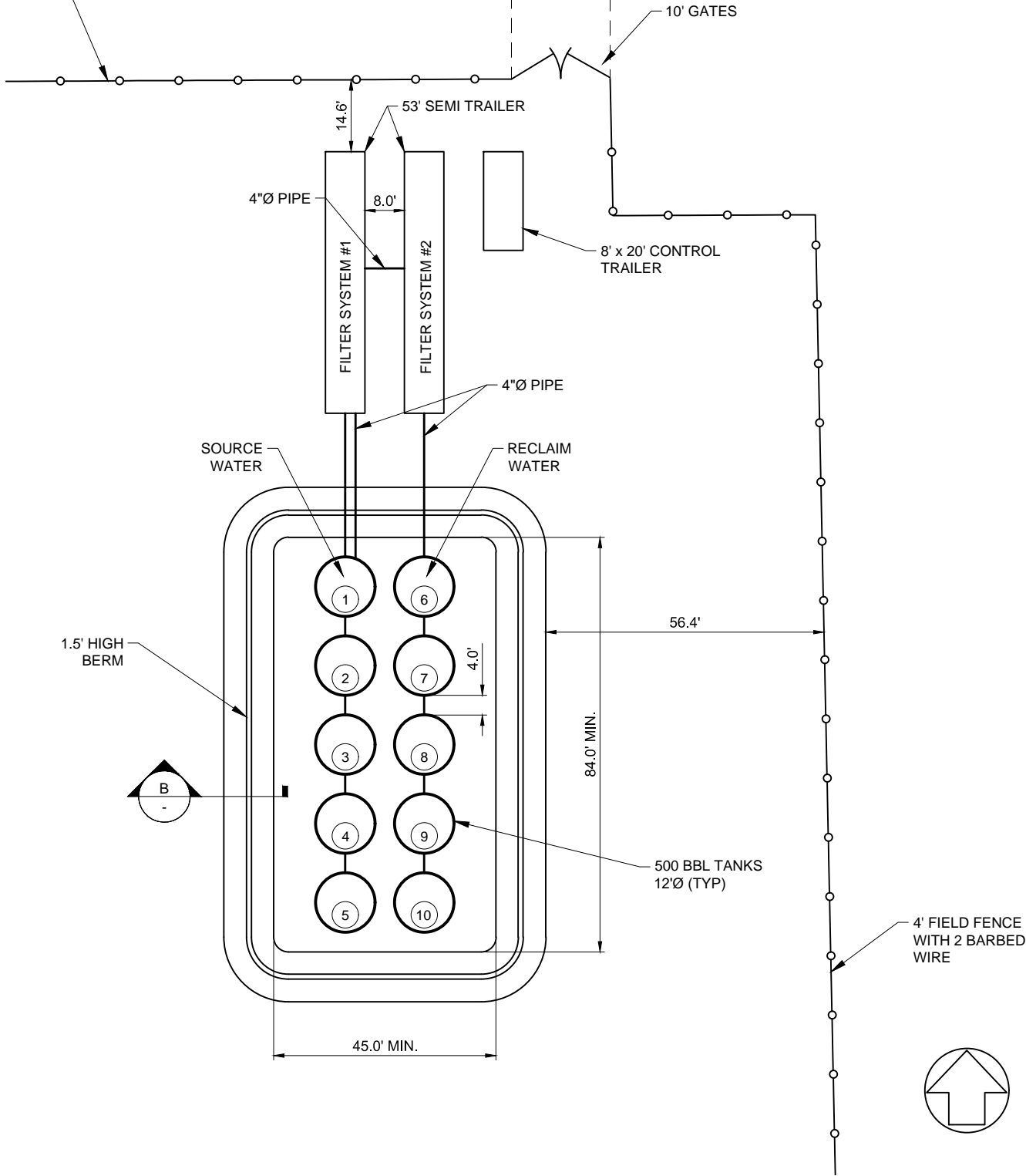

A SITE LAYOUT
Scale: 1" = 30'

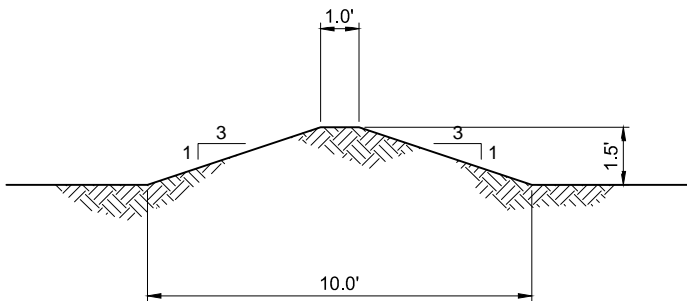

B SECTION OF BERM
Scale: 1" = 5'



SOUDER, MILLER & ASSOCIATES
401 West Broadway Avenue
Farmington, NM 87401-5907
Phone (505) 325-7535 Toll-Free (800) 519-0098 Fax (505) 326-0045
Serving the Southwest & Rocky Mountains
www.soudermiller.com

INDUSTRIAL ECOSYSTEM INC.

BLANCO, NM

**CROW BLANCO RECYCLING FACILITY
PROJECT LOCATION
SITE PLAN**

Designed GYQ	Drawn DJB	Checked GYQ
Date:	JULY 2018	
Scale:	Horiz: AS NOTED Vert: N/A	
Project No:	5127454	
Sheet:	FIG. 2	

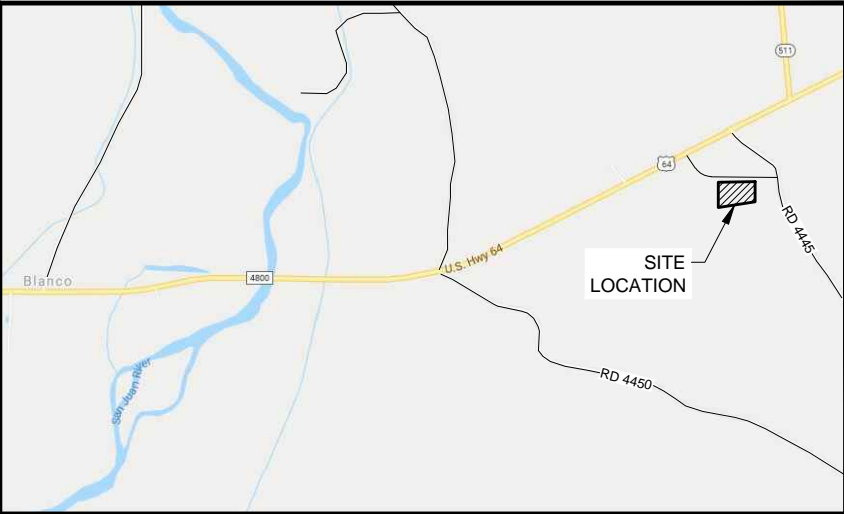

C VICINITY MAP
N.T.S.

RD 4445

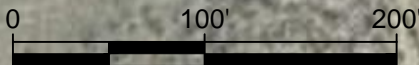

SCALE: 1" = 100'

SOUDER, MILLER & ASSOCIATES			Rev #	Date	Description
 SMA Engineering Environmental Surveying					
401 West Broadway Avenue Farmington, NM 87401 Phone (505) 325-7535 Toll-Free (800) 519-0098 Fax (505) 326-0045 Serving the Southwest & Rocky Mountains www.soudermiller.com					
INDUSTRIAL ECOSYSTEM INC.					
CROW BLANCO RECYCLING FACILITY					
LOCATION MAP					
Designed GYQ	Drawn DJB	Checked GYQ			
Date: October 2018					
Scale: Horiz: 1" = 100'					
Vert: N/A					
Project No: 5127454					
FIG. 1					

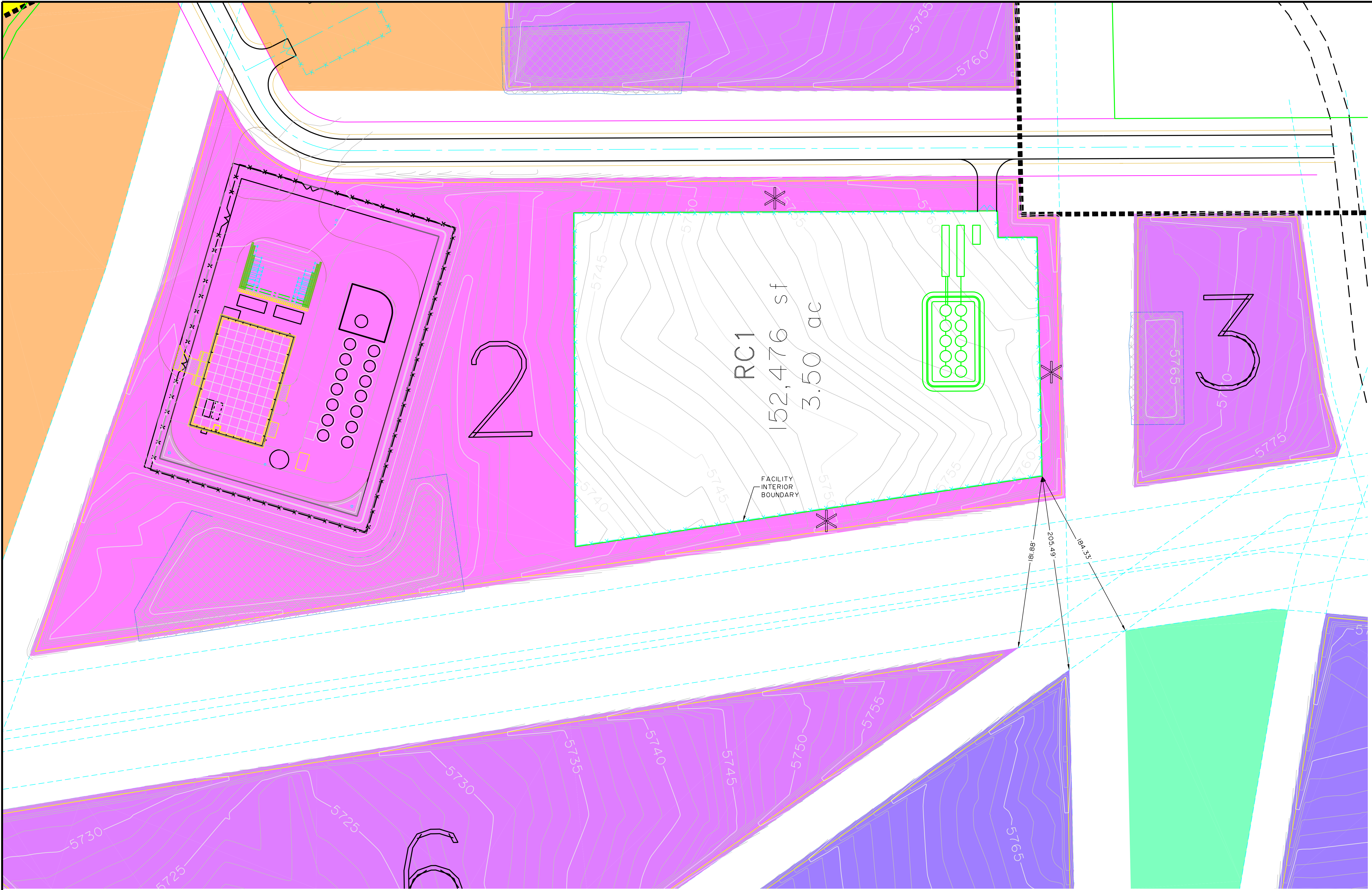

- = PROCESSING AREA CELL 2
- = RECYCLING FACILITY RC1

* NOTE:
AREA IN PINK OUTSIDE OF PROPOSED RECYCLING
FACILITY DENOTES THE AREA NEEDED TO
CONSTRUCT THE EARTHEN BERMS AS A PART
OF CELL 2 CONSTRUCTION.

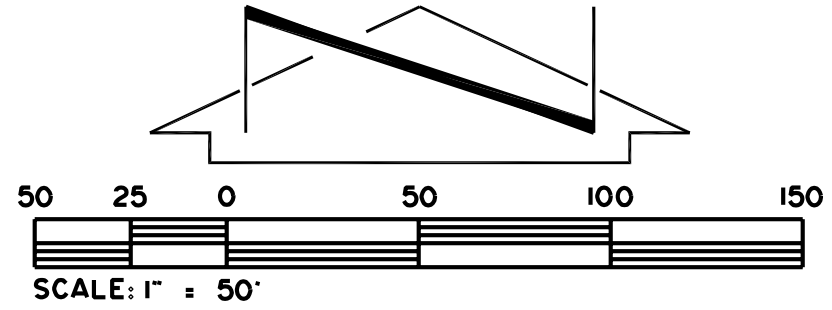

DATE	REVISION	BY

**CHENEY-WALTERS-ECHOLS**
ENGINEERS • SURVEYORS

909 W. APACHE • FARMINGTON, NEW MEXICO 87401 • (505)327-3303
PROJECT: 18183
FILE: D:\DWG-HWS\2018\18183\18183REVSET-091718.dwg



RECYCLING FACILITY
CROWE BLANCO PROPERTY LLC
OPERATED BY INDUSTRIAL ECOSYSTEMS
BLANCO, NEW MEXICO

DATE: 09/17/2018
DRAWN BY: LH-HWS
PROJ. 18183
SCALE: 1" = 50'
FILE: 18183REVSET-091718
SHEET
1
OF
1