

**1R -**

325

---

# **REPORTS**

**DATE:**

2001

---

1R325

**Chevron USA**  
**Phase II Site Assessment**  
**Elbert Shipp NCT-A #1**  
**Section 21, Township 19S, Range 37E**  
**Lea County, New Mexico**

**March 1, 2001**

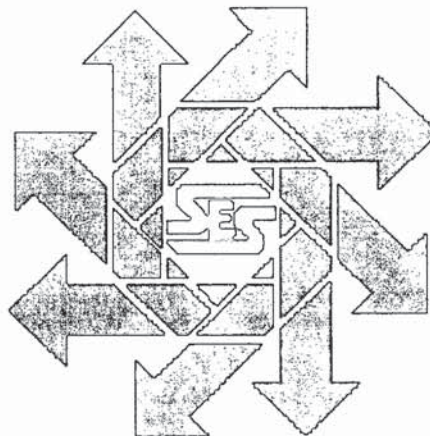

**RECEIVED**

**MAR 22 2001**

**ENVIRONMENTAL BUREAU  
OIL CONSERVATION DIVISION**

**Prepared For:**

**Chevron USA  
P.O. Box 1949  
Eunice, New Mexico 88231**

**Prepared By:**

***Safety & Environmental Solutions, Inc.  
703 E. Clinton Suite 102  
Hobbs, New Mexico 88240  
(505) 397-0510***

## TABLE OF CONTENTS

Background .....	2
Work Performed .....	2
Summary .....	5
Exhibits & Appendices .....	6

## **I. Background**

Safety & Environmental Solutions, Inc. (SESI) was engaged in March of 2001 to perform a Phase II site assessment of an old flare pit area on the lease known as Elbert Shipp NCT-A #1 which is located in Section 21, Township 19S, Range 37E in Lea County, New Mexico. (Appendix A – Vicinity Map). The scope of work for this assessment includes excavation with a backhoe for delineation of the suspected pit area to determine extent of possible contamination.

## **II. Work Performed**

SESI began the excavating and sampling services for this project at 1:00 p.m. on March 1, 2001. E.L. Gonzales of the NMOCD (New Mexico Oil Conservation Division) was on site and the work performed was as per his instruction and approval.

The total pit area measured 20 foot on all four sides. Excavation was performed at three different points. (See Site Plan). The first point of excavation was at the center of the pit area. Three samples were taken at this point. The first sample obtained was from surface to 6" and a field test was run for TPH (Total Petroleum Hydrocarbons), which read 2500ppm. The second sample was taken at 3' and field tested for TPH, which read 1030ppm. The third sample was taken at 4' and field tested for TPH, which read 153ppm. This sample was also preserved in an appropriate container and transported under chain of custody to Cardinal Laboratories of Hobbs, New Mexico for third party confirmation.

The second point of excavation was 30' east of the center of pit. A sample was taken from surface to 6" and field tested for TPH, which read 250ppm. The second sample was taken at 18" and the field test read 85ppm.

The third and final point of excavation was 30' south-southeast from the center of the pit. Two samples were obtained at this point. The first was from surface to 6" and the field test read 282ppm. The second sample was taken from 1.5-2' and the field test read 53ppm.

### **Summary**

All field tests were performed using a Mega TPH Analyzer, serial #01196, which was calibrated on February 9, 2001. The results of the lab analysis as well as the field testing revealed no elevated TPH levels.

**IV. Appendices**

A-Vicinity Map  
B-Site Plan  
C-Analytical Results

## Appendix A Vicinity Map



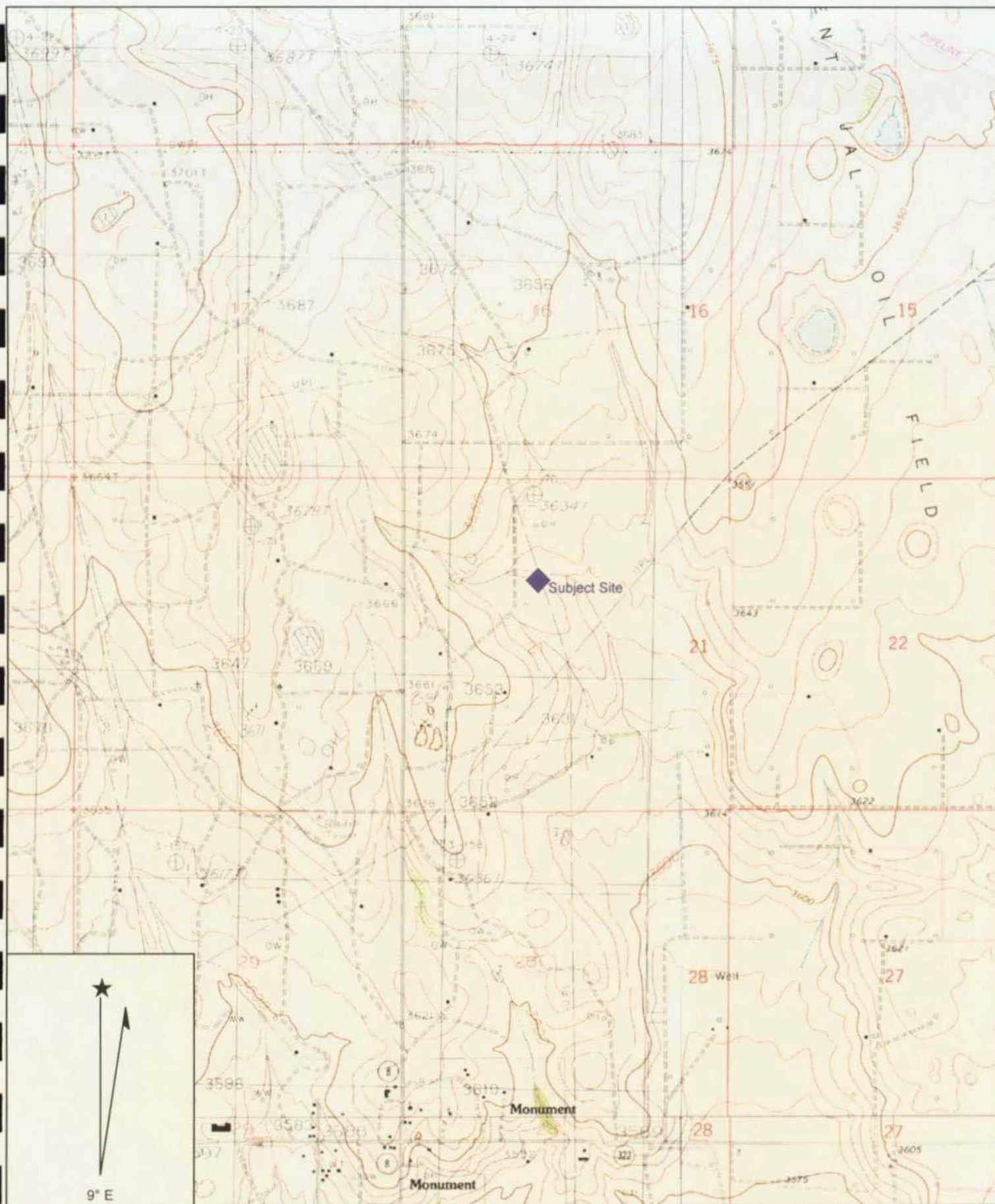

Name: MONUMENT NORTH  
Date: 3/5/2001  
Scale: 1 inch equals 2000 feet

Location: 032° 38' 50.2" N 103° 15' 33.4" W  
Caption: Chevron USA  
Elbert Shipp NCT-A #1  
Vicinity Map

## Appendix B

### Site Plan



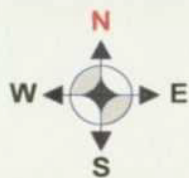

Old gas well

20'

Pit area

20'



Sample point #1

20'



Sample point #2

20'



Sample point #3

March 1, 2001

Not to scale

**Chevron USA**

**Site Plan**  
**Elbert Shipp NCT-A #1**  
**Unit F Section 21, T19S, R37E**

**Safety & Environmental**  
**Solutions, Inc.**



## Appendix C

### Analytical Results

2111 Beechwood, Abilene, TX 79603 101 East Marland, Hobbs, NM 88240  
(915) 673-7001 Fax (915) 673-7020 (505) 393-2326 Fax (505) 393-2476

Page \_\_\_\_ of \_\_\_\_

Company Name: <b>STEST</b>		P.O. #:	
Project Manager: <b>Dec Whately</b>		Company: <b>SESU</b>	
Address:		Attn:	
City:		Address:	
State:		City:	
Zip:		State:	
Phone #:		Phone #:	
Fax #:		Fax #:	
Project Name: <b>Elbert Shipp P.T</b>		Project Owner: <b>Chevron</b>	
Project Location: <b>Elbert Shipp NCT-A #1</b>		City:	
Sampler Name: <b>Dec Whately</b>		State:	
FOR LAB USE ONLY		Zip:	
Lab I.D.		Project #:	
Sample I.D.		Project Name:	
45664-1 #1 Center 4"		Project Location:	
#1 Center 4"		Project Manager:	
#1 Center 4"		Project Owner:	
#1 Center 4"		Project Location:	
#1 Center 4"		Project Manager:	
#1 Center 4"		Project Owner:	
#1 Center 4"		Project Location:	
#1 Center 4"		Project Manager:	
#1 Center 4"		Project Owner:	
#1 Center 4"		Project Location:	
#1 Center 4"		Project Manager:	
#1 Center 4"		Project Owner:	
#1 Center 4"		Project Location:	
#1 Center 4"		Project Manager:	
#1 Center 4"		Project Owner:	
#1 Center 4"		Project Location:	
#1 Center 4"		Project Manager:	
#1 Center 4"		Project Owner:	
#1 Center 4"		Project Location:	
#1 Center 4"		Project Manager:	
#1 Center 4"		Project Owner:	
#1 Center 4"		Project Location:	
#1 Center 4"		Project Manager:	
#1 Center 4"		Project Owner:	
#1 Center 4"		Project Location:	
#1 Center 4"		Project Manager:	
#1 Center 4"		Project Owner:	
#1 Center 4"		Project Location:	
#1 Center 4"		Project Manager:	
#1 Center 4"		Project Owner:	
#1 Center 4"		Project Location:	
#1 Center 4"		Project Manager:	
#1 Center 4"		Project Owner:	
#1 Center 4"		Project Location:	
#1 Center 4"		Project Manager:	
#1 Center 4"		Project Owner:	
#1 Center 4"		Project Location:	
#1 Center 4"		Project Manager:	
#1 Center 4"		Project Owner:	
#1 Center 4"		Project Location:	
#1 Center 4"		Project Manager:	
#1 Center 4"		Project Owner:	
#1 Center 4"		Project Location:	
#1 Center 4"		Project Manager:	
#1 Center 4"		Project Owner:	
#1 Center 4"		Project Location:	
#1 Center 4"		Project Manager:	
#1 Center 4"		Project Owner:	
#1 Center 4"		Project Location:	
#1 Center 4"		Project Manager:	
#1 Center 4"		Project Owner:	
#1 Center 4"		Project Location:	
#1 Center 4"		Project Manager:	
#1 Center 4"		Project Owner:	
#1 Center 4"		Project Location:	
#1 Center 4"		Project Manager:	
#1 Center 4"		Project Owner:	
#1 Center 4"		Project Location:	
#1 Center 4"		Project Manager:	
#1 Center 4"		Project Owner:	
#1 Center 4"		Project Location:	
#1 Center 4"		Project Manager:	
#1 Center 4"		Project Owner:	
#1 Center 4"		Project Location:	
#1 Center 4"		Project Manager:	
#1 Center 4"		Project Owner:	
#1 Center 4"		Project Location:	
#1 Center 4"		Project Manager:	
#1 Center 4"		Project Owner:	
#1 Center 4"		Project Location:	
#1 Center 4"		Project Manager:	
#1 Center 4"		Project Owner:	
#1 Center 4"		Project Location:	

\* Cardinal cannot accept verbal changes. Please fax written changes to 505-393-2476.



**ARDINAL**  
**LABORATORIES**

PHONE (815) 673-7001 • 2111 BEECHWOOD • ABILENE, TX 79603

PHONE (505) 393-2326 • 101 E. MARLAND • HOBBS, NM 88240

ANALYTICAL RESULTS FOR  
 SAFETY & ENVIRONMENTAL SOLUTIONS, INC.  
 ATTN: DEE WHATLEY  
 701 E. CLINTON, #103  
 HOBBS, NM 88240  
 FAX TO:

Receiving Date: 03/01/01  
 Reporting Date: 03/02/01  
 Project Owner: CHEVRON  
 Project Name: ELBERT SHIPP PIT  
 Project Location: ELBERT SHIPP NCT-A #1

Sampling Date: 03/01/01  
 Sample Type: SOIL  
 Sample Condition: COOL & INTACT  
 Sample Received By: GP  
 Analyzed By: BC

LAB NUMBER	SAMPLE ID	GRO (C <sub>6</sub> -C <sub>10</sub> ) (mg/Kg)	DRO (C <sub>10</sub> -C <sub>28</sub> ) (mg/Kg)
ANALYSIS DATE:		03/01/01	03/01/01
H5664-1	#1 CENTER 4'	<50	<50
Quality Control		732	744
True Value QC		800	800
% Recovery		91.6	93.0
Relative Percent Difference		8.2	2.1

METHOD: SW-846 8015 M

*Burgess & Co.*  
 Chemist

*3/2/01*  
 Date

H5664.XLS  
 PLEASE NOTE: Liability and Damages. Cardinal's liability and client's exclusive remedy for any claim arising, whether based in contract or tort, shall be limited to the amount paid by client for analyses. All claims, including those for negligence and any other cause whatsoever shall be deemed waived unless made in writing and received by Cardinal within thirty (30) days after completion of the applicable service. In no event shall Cardinal be liable for incidental or consequential damages, including, without limitation, business interruptions, loss of use, or loss of profits incurred by client, its subsidiaries, affiliates or successors arising out of or related to the performance of services hereunder by Cardinal, regardless of whether such claim is based upon any of the above-stated reasons or otherwise.