

HIP - 75

**GENERAL
CORRESPONDENCE**

YEAR(S):

2001

ACKNOWLEDGEMENT OF RECEIPT
OF CHECK/CASH

I hereby acknowledge receipt of check No. 07453623 dated 11-26-01,
or cash received on 11-27-01 in the amount of \$ 250.00
from EL PASO Natural Gas Company
for EL PASO NATURAL GAS COMPANY 14E-075
(Facility Name) (CP No.)
Submitted by: Martynne Kieling Date: 11-27-01
Submitted to ASD by: Martynne J. M. Date: 11-27-01
Received in ASD by: _____ Date: _____

Filing Fee ☒ New Facility _____ Renewal _____
Modification _____ Other _____
(Quantity)

Organization Code 521.07 Applicable FY 2001

To be deposited in the Water Quality Management Fund.

Full Payment _____ or Annual Increment _____

EL PASO NATURAL GAS COMPANY
P.O. BOX 4430
HOUSTON, TX 77210-4430

CITIBANK DELAWARE
A Subsidiary of Citicorp
One Penn's Way
New Castle, DE 19720

CHECK DATE 11/26/2001 CHECK NUMBER 07453632

62-20
311

Amount

***\$250.00

VOID AFTER ONE YEAR

Pay ***TWO HUNDRED FIFTY AND XX / 100 US DOLLAR***

To The
Order Of

NEW MEXICO ENVIRONMENT DEPT
WATER QUALITY MANAGEMENT FUND
NMOCD ENVIRONMENTAL BUREAU
ATTN MARTYNE KIELING
1220 SOUTH ST FRANCIS DRIVE
SANTE FE, NM 87505

H. Brent Austin

Authorized Signature

EL PASO NATURAL GAS COMPANY

P.O. BOX 4430

HOUSTON, TX 77210-4430

CHECK DATE

11/26/2001

CHECK NUMBER

07453632

NEW MEXICO ENVIRONMENT DEPT
WATER QUALITY MANAGEMENT FUND
NMOCD ENVIRONMENTAL BUREAU
ATTN MARTYNE KIELING
1220 SOUTH ST FRANCIS DRIVE
SANTE FE, NM 87505

REMITTANCE ADVICE**RETAIN FOR YOUR RECORDS**

Refer Payment Inquires to EPGTR - 713-420-4200

VENDOR 0000002667

NEW MEXICO ENVIRONMENT DEPT

<u>Voucher ID</u>	<u>Invoice Number</u>	<u>Invoice Date</u>	<u>Description</u>	<u>Discount</u>	<u>Paid Amount</u>
00118387	CKREQ011120	11/20/2001	RAD NO. 01-0115	0.00	250.00

TOTAL**\$0.00****\$250.00**

ENERGY, MINERALS AND NATURAL RESOURCES DEPT.

-521

NO. 116746

Official Receipt

Date: 11-27 ¹⁹2001

Received from: RC EL PASO NATURAL GAS CO.

Dollar Amount 250.00

DR CR.	AMOUNT NUMBER	CENTER NUMBER	CREDIT AMOUNT	DEPOSIT NUMBER	WORK ORDER NO.
60	4290				
60	4291				
60	3450				
60	3451				
60	3410				
60	4210				
60	4240				
60			250.00		
60					
60					
60					
TOTAL			250.00		

By Thayne Jenkins

**Energy, Minerals & Natural Resources Department
CASH REMITTANCE REPORT (CRR)**

CRR0006514



Location Name ①

Location Code ②

Santa Fe EMV Bureau

0701

Today's Date: 11 MONTH 27 DAY ③ 2001 YEAR

Collection Period: 11 / 27 / 2001 through 11 / 27 / 2001 ④
MM DD YYYY MM DD YYYY

Cost Center ⑤	Revenue Code ⑥	Receipt Amount ⑦	Collected Amount ⑧
		600.00	600.00
		250.00	250.00

Total == == == == == → \$ 850.00 ⑨ \$ 850.00 ⑩

Over/Short Amount \$ — ⑪

CRR Deposit Amount \$ _____ ⑫

Print Name: Martyn J. Kieling ⑬ Signature: Martyn J. Kieling ⑬

Print Name: _____ ⑬ Signature: _____ ⑬

Distribution: White and Yellow copy to Accounts Receivable-ASD.
Pink copy retained at CRR submitting location.

Official Use Only

Completed by the Accounts Receivable

Date Received: _____ ①

Notes: _____ ②

Amount Received: _____ ③

State Treasurer Deposit Number: _____ ④

Verified by: _____ ⑥

Deposit Date: _____ ⑤



November 9, 2001

Ms. Martyne Kieling, Environmental Engineer
New Mexico Oil Conservation Division
Environmental Bureau—District 4
1220 South St. Francis Dr.
Santa Fe, New Mexico 87505

Re: Request for a Permit to Discharge Hydrostatic Test Water from El Paso Natural Gas Company's Silver City Line (Line No. 2008) near Silver City, New Mexico

Dear Ms. Kieling:

El Paso Natural Gas Company (El Paso) is planning to hydrostatically test its No. 2008 pipeline between Valve No.'s 3 and 4 in Grant and Luna Counties, New Mexico. The test is scheduled to occur on or around the week of November 26, 2001. The information attached herein is provided in accordance with the New Mexico Oil Conservation Divisions (NMOCD's) *Guidelines for Hydrostatic Test Dewatering* (May 1989). In brief, if the proposed conditions are met, then El Paso is will discharge the test water via land application as a dust suppressant or will use the test water during hydro mulching and reseeding on El Paso's right-of-way.

The enclosed proposed hydrostatic test discharge application is associated with the Silver City Line replacement project, involving the replacement of an existing pipe segment with a larger diameter pipe to transport additional gas volumes to Phelps Dodge Corporation and the Silver City area.

I will contact you early next week to confirm the appropriate application fee. Upon confirming the application fee, El Paso will issue a check immediately to your office. In the interim, you can begin processing our application.

If you have any questions regarding any of this information or require additional information, please contact me at 719.520.4652.

Sincerely,

A handwritten signature in black ink, appearing to read "Daniel I. Padilla".

Daniel I. Padilla
Environmental Scientist
Pipelines West Environmental Department

Enclosures

Cc: Joe Provenza, El Paso Project Engineer

File: Blanket Certificate File: RAD No.: 01-0115

Daniel Padilla @ElPaso.com

**NMOCD Hydrostatic Test Information
El Paso's Pipeline No. 2008 Near Silver City, NM
November 8, 2001**

Hydrostatic Test Information

a) Map showing the location of the pipeline to be tested;

Five (5) topographic maps attached.

b) Description of the test;

El Paso is proposing to test 12 miles of new 10- $\frac{3}{4}$ -inch pipe. The test water will be delivered to the project site in frac-tanks and used to test the newly constructed pipe. The test water will then be recollected in frac-tanks, where the water will remain in the frac-tanks for a minimum of eight hours before it will be used for dust control, hydro mulching, and/or reseeded portions of the project. El Paso is conducting the hydrostatic test to satisfy the pipeline safety requirements of the U.S. Department of Transportation—Pipeline Safety Regulations for determining the Maximum Allotted Operating Pressure (MAOP). Title 49 CFR Part 192 prescribes the procedures used by the Research and Special Programs Administration in carrying out the duties regarding the pipeline safety under the laws of 49 USC 60101 and other laws (the pipeline safety laws).

El Paso transports pipeline quality gas (sweet and dry) in this pipeline system that is suitable for consumer usage. This gas is supplied to El Paso by various shippers and other transporters and has been treated to remove all liquids and deleterious substances prior to entry into El Paso's pipeline system. El Paso has an elaborate gas quality monitoring system for all natural gas entering the pipeline. This system is utilized to ensure that El Paso meets with the Natural Gas Tariff on file with the federal Energy Regulatory Commission (FERC), which maintains strict and minimal standards for natural gas entering into El Paso's system.

El Paso is proposing to conduct the test by filling the new pipeline segment with approximately 274,000 gallons of water and hydrostatically testing the pipeline segment. If all applicable criteria are met, then the water will be land applied onto El Paso's right-of-way.

10- $\frac{3}{4}$ " of new pipe
Begin Milepost 17+3772.3 (E.S. 934+42.30)
End Milepost 29+3457.6 (E.S. 1568+22.6)
Sections 1, 6, 7, 11, 12, 13, 24, 25, 36, Townships 20, 21, 22 South, Ranges 12, 13 West, Grant and Luna Counties, New Mexico

c) Source and analysis of test water;

El Paso will obtain the water from a private well, (Phelps Dodge Chino Mines Well) in the vicinity of the test. The well provides potable water. A sample of the source water will be acquired prior to the test and analyzed for organic compounds, major anions and cations, heavy metals, aromatic and halogenated hydrocarbons, TDS, Fe, Mn, pH, PAH's, and conductivity, as recommended by the NMOCD guidelines.

This water analysis will establish the baseline water quality levels.

d) Point of Discharge of the test water;

The test water will be land applied onto El Paso's right-of-way within the segment of pipeline being tested; provided the water-quality criteria (mentioned below) are met. The water will be sprayed onto the land using tank-trucks with sprayers. No water will be allowed to pond or enter into a dry arroyo or canal. As part of El Paso's right-of-way agreement with the landowners, El Paso is allowed to conduct operation and maintenance (such as dust suppressant practices) to operate the pipeline.

e) Method and location for collection and retention of fluids and solids;

Hydrostatic Test Water: the test water will be collected in frac-tanks prior to and after the test. The water will be retained in the frac-tanks for eight hours after the test to allow for sediment settling.

f) Monitoring program;

El Paso is proposing to collect one composite water sample from the beginning, middle, and end of the discharge and analyze it for the same constituents performed on the water source (Phelps Dodge Chino Mines Well). El Paso's Environmental Inspector (EI) will be on hand to see that the samples are collected properly.

g) Depth of ground water at discharge and collection/retention site;

Depth to ground water is estimated at 300 feet.

h) Geological characteristics;

Soils of the project area belong to the Lonti-Poley Pastura and Mohave-Stellar associations. These associations consist of gravelly old alluvium and old valley-filling sediments dominated by materials of acid igneous origin.

i) Plan for disposal of test water and solids;

After the test, all water will be retained in frac-tanks. If the water is not contaminated beyond any preexisting level (baseline established under section "c" above), El Paso is proposing to land-apply the water as dust control, hydro mulching, and reseeding portions of the project on the affected right-of-way. Should the water reveal an increase in any constituent level, El Paso will notify the NMOCD and develop a separate disposal plan for evaluation and approval by NMOCD. Any solids left in the frac-tanks will be collected, characterized, and disposed accordingly.

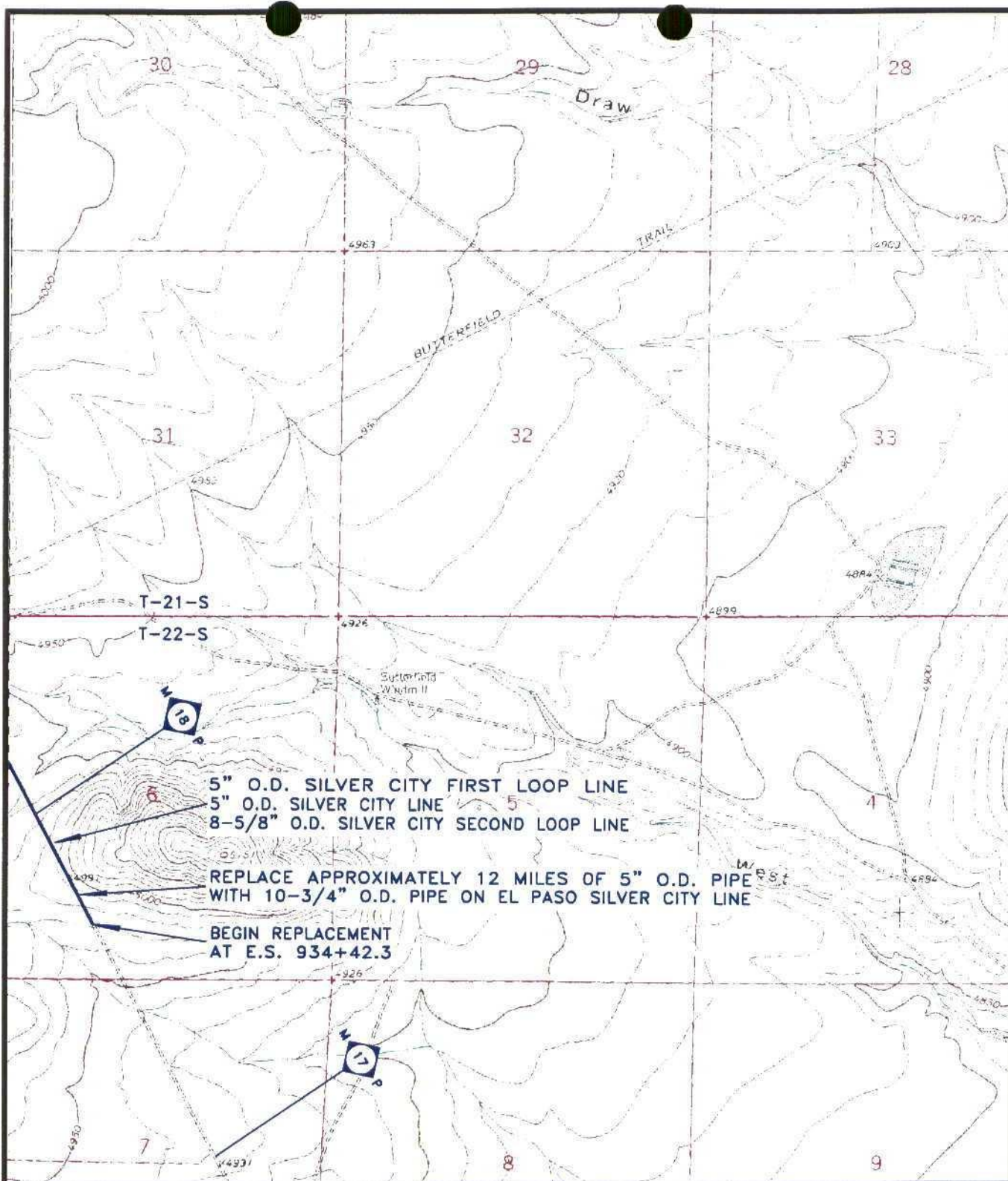

0 1000 2000 3000
SCALE IN FEET

REFERENCE:
ANTELOPE HILL QUADRANGLE
NEW MEXICO-LUNA COUNTY
7.5 MINUTE SERIES (TOPOGRAPHIC)



REPLACE A SEGMENT OF THE
SILVER CITY LINE
Section 6
Township 22 South, Range 12 West
Luna County, New Mexico

RA010115

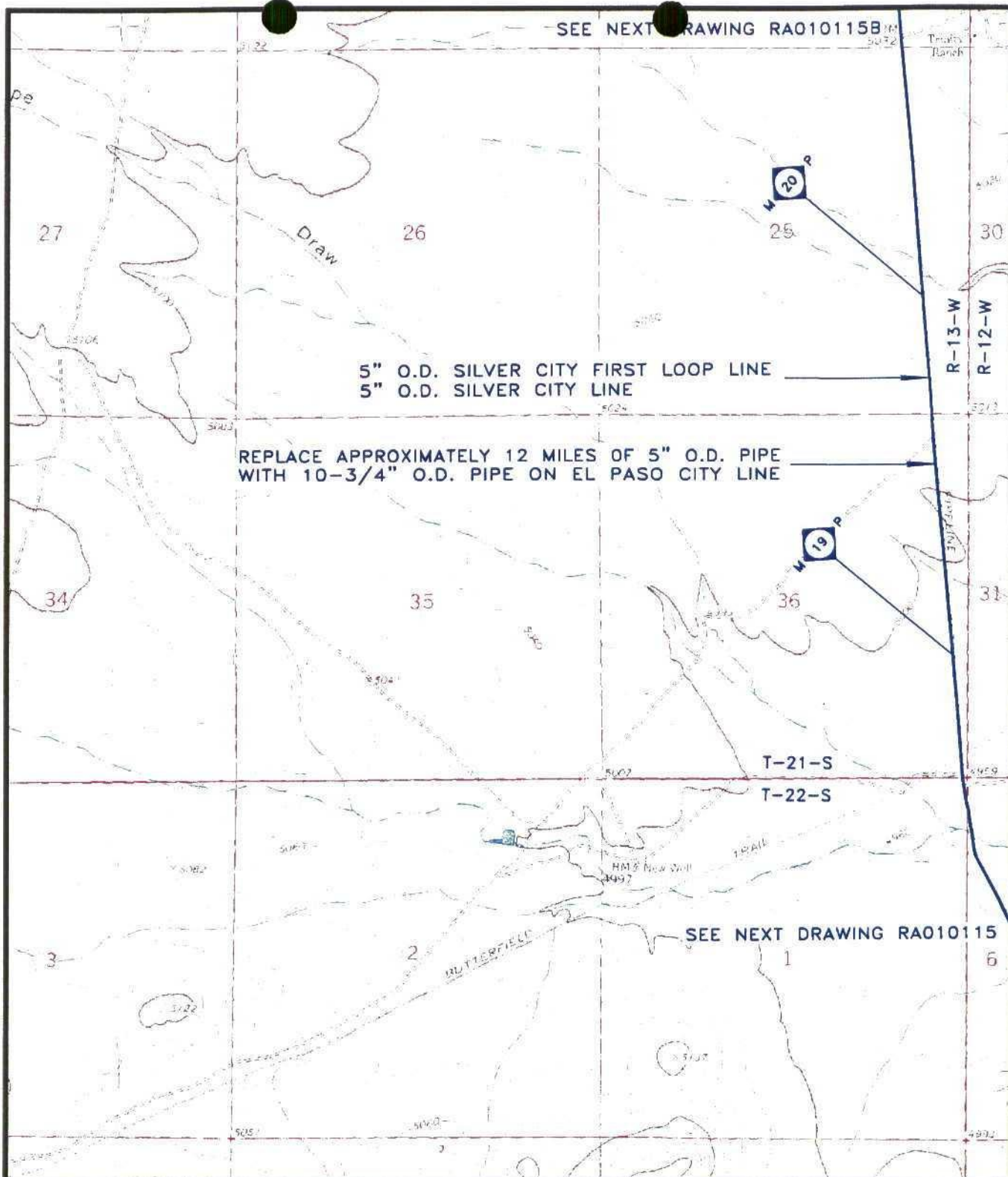

REPLACE A SEGMENT OF THE
SILVER CITY LINE

Sections 36, 25 & 24 Township 21 South, Range 13 West
Section 1, Township 22 South, Range 13 West
Section 8, Township 22 South, Range 12 West
Luna County, New Mexico

RA010115A

REFERENCE:
ANTELOPE HILL QUADRANGLE
NEW MEXICO-LUNA COUNTY
7.5 MINUTE SERIES (TOPOGRAPHIC)

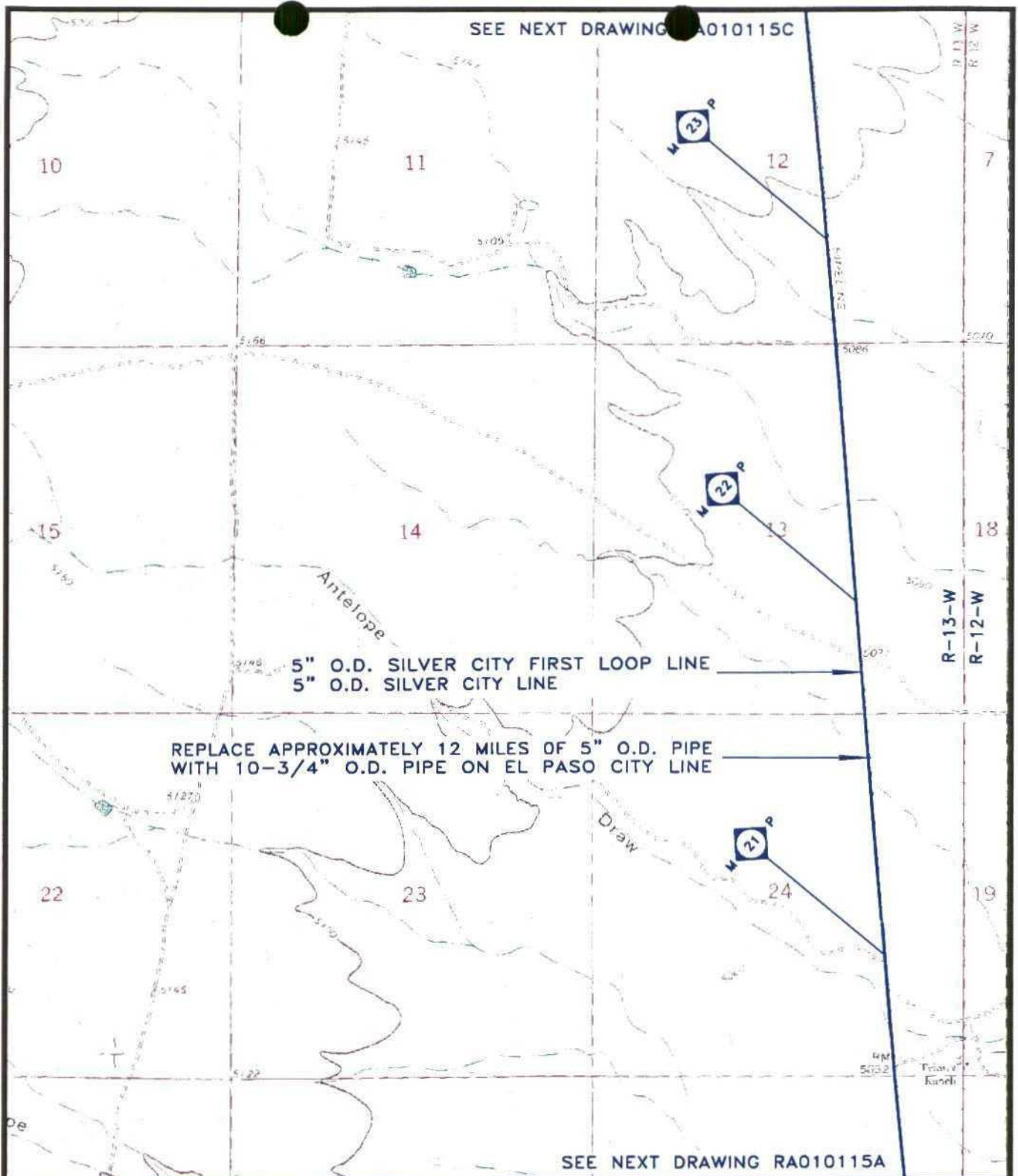

0 1000 2000 3000
SCALE IN FEET

REFERENCE:
ANTELOPE HILL QUADRANGLE
NEW MEXICO-LUNA COUNTY
7.5 MINUTE SERIES (TOPOGRAPHIC)



REPLACE A SEGMENT OF THE
SILVER CITY LINE
Sections 24, 13 & 12
Township 21 South, Range 13 West
Luna County, New Mexico

RA010115B

SEE NEXT DRAWING RA010115D

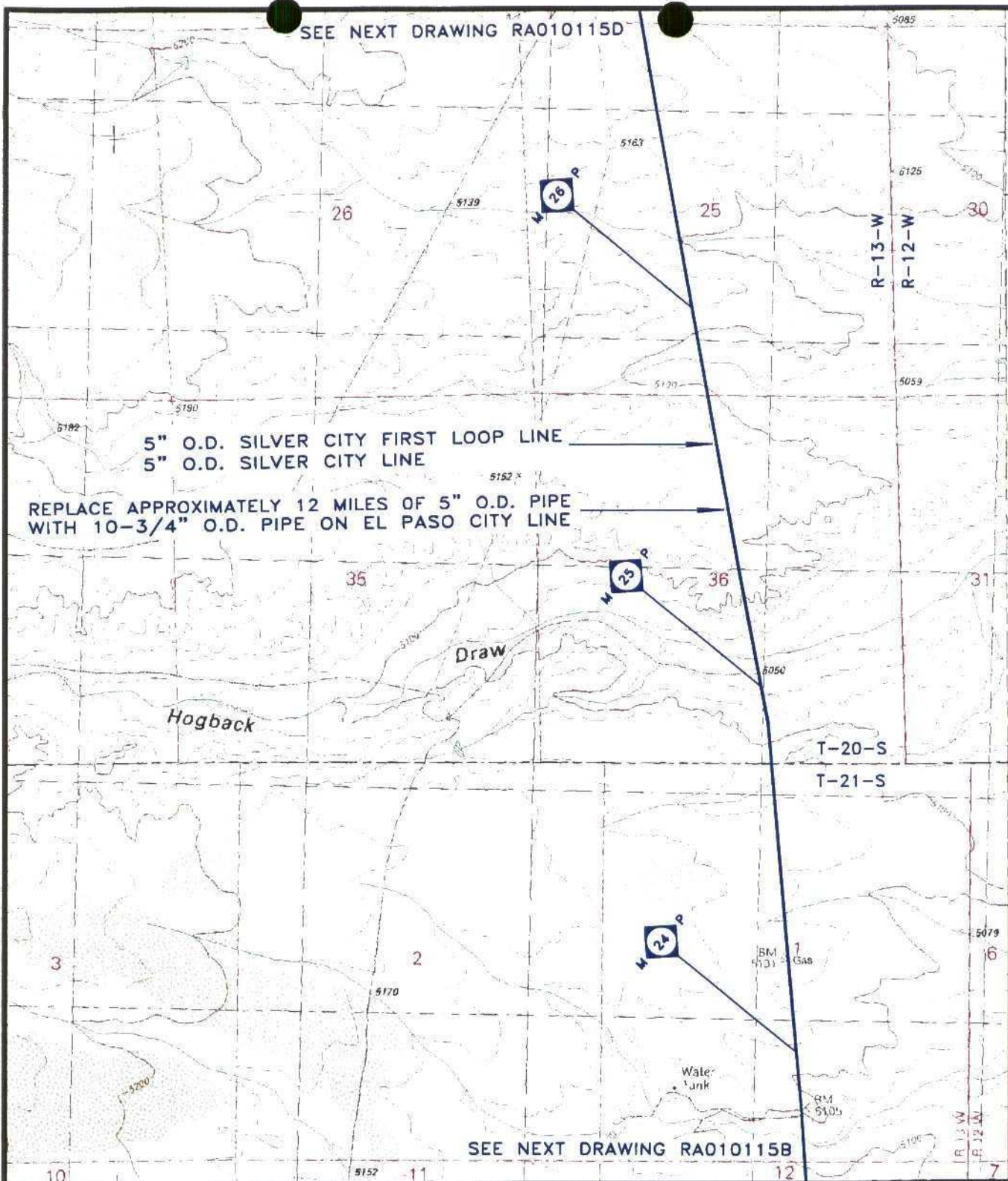

5" O.D. SILVER CITY FIRST LOOP LINE
5" O.D. SILVER CITY LINE

REPLACE APPROXIMATELY 12 MILES OF 5" O.D. PIPE
WITH 10-3/4" O.D. PIPE ON EL PASO CITY LINE

SEE NEXT DRAWING RA010115B

0 1000 2000 3000
SCALE IN FEET

REFERENCE:
WHITWATER QUADRANGLE
NEW MEXICO-LUNA & GRANT COUNTY
7.5 MINUTE SERIES (TOPOGRAPHIC)

el paso Natural Gas

REPLACE A SEGMENT OF THE
SILVER CITY LINE
Sections 12 & 1, Township 21 South, Range 13 West
Sections 38 & 25 Township 20 South, Range 13 West
Luna & Grant County, New Mexico

RA010115C

